

DATE 6/18/03	SUSPENSE NA	ENGINEER WJS	LOGGED IN RV	TYPE DHC	PRG 0317045908
--------------	-------------	--------------	--------------	----------	----------------

ABOVE THIS LINE FOR DIVISION USE ONLY

## NEW MEXICO OIL CONSERVATION DIVISION

- Engineering Bureau -

1220 South St. Francis Drive, Santa Fe, NM 87505



JUN 18 2003

CONSERVATION  
DIVISION

### ADMINISTRATIVE APPLICATION CHECKLIST

THIS CHECKLIST IS MANDATORY FOR ALL ADMINISTRATIVE APPLICATIONS FOR EXCEPTIONS TO DIVISION RULES AND REGULATIONS WHICH REQUIRE PROCESSING AT THE DIVISION LEVEL IN SANTA FE

#### Application Acronyms:

[NSL-Non-Standard Location] [NSP-Non-Standard Proration Unit] [SD-Simultaneous Dedication]  
 [DHC-Downhole Commingling] [CTB-Lease Commingling] [PLC-Pool/Lease Commingling]  
 [PC-Pool Commingling] [OLS - Off-Lease Storage] [OLM-Off-Lease Measurement]  
 [WFX-Waterflood Expansion] [PMX-Pressure Maintenance Expansion]  
 [SWD-Salt Water Disposal] [IPI-Injection Pressure Increase]  
 [EOR-Qualified Enhanced Oil Recovery Certification] [PPR-Positive Production Response]

- [1] **TYPE OF APPLICATION** - Check Those Which Apply for [A]  
 [A] Location - Spacing Unit - Simultaneous Dedication  
☐ NSL ☐ NSP ☐ SD
- Check One Only for [B] or [C]  
 [B] Commingling - Storage - Measurement  
☒ DHC ☐ CTB ☐ PLC ☐ PC ☐ OLS ☐ OLM
- [C] Injection - Disposal - Pressure Increase - Enhanced Oil Recovery  
☐ WFX ☐ PMX ☐ SWD ☐ IPI ☐ EOR ☐ PPR
- [D] Other: Specify \_\_\_\_\_
- [2] **NOTIFICATION REQUIRED TO:** - Check Those Which Apply, or Does Not Apply  
 [A] ☐ Working, Royalty or Overriding Royalty Interest Owners  
 [B] ☐ Offset Operators, Leaseholders or Surface Owner  
 [C] ☐ Application is One Which Requires Published Legal Notice  
 [D] ☐ Notification and/or Concurrent Approval by BLM or SLO  
U.S. Bureau of Land Management - Commissioner of Public Lands, State Land Office  
 [E] ☐ For all of the above, Proof of Notification or Publication is Attached, and/or,  
 [F] ☐ Waivers are Attached

[3] **SUBMIT ACCURATE AND COMPLETE INFORMATION REQUIRED TO PROCESS THE TYPE OF APPLICATION INDICATED ABOVE.**

[4] **CERTIFICATION:** I hereby certify that the information submitted with this application for administrative approval is **accurate** and **complete** to the best of my knowledge. I also understand that **no action** will be taken on this application until the required information and notifications are submitted to the Division.

Note: Statement must be completed by an individual with managerial and/or supervisory capacity.

James W. Pringle  
 Print or Type Name

*James W. Pringle*  
 Signature

Operations Engineer  
 Title

6-4-03  
 Date

e-mail Address

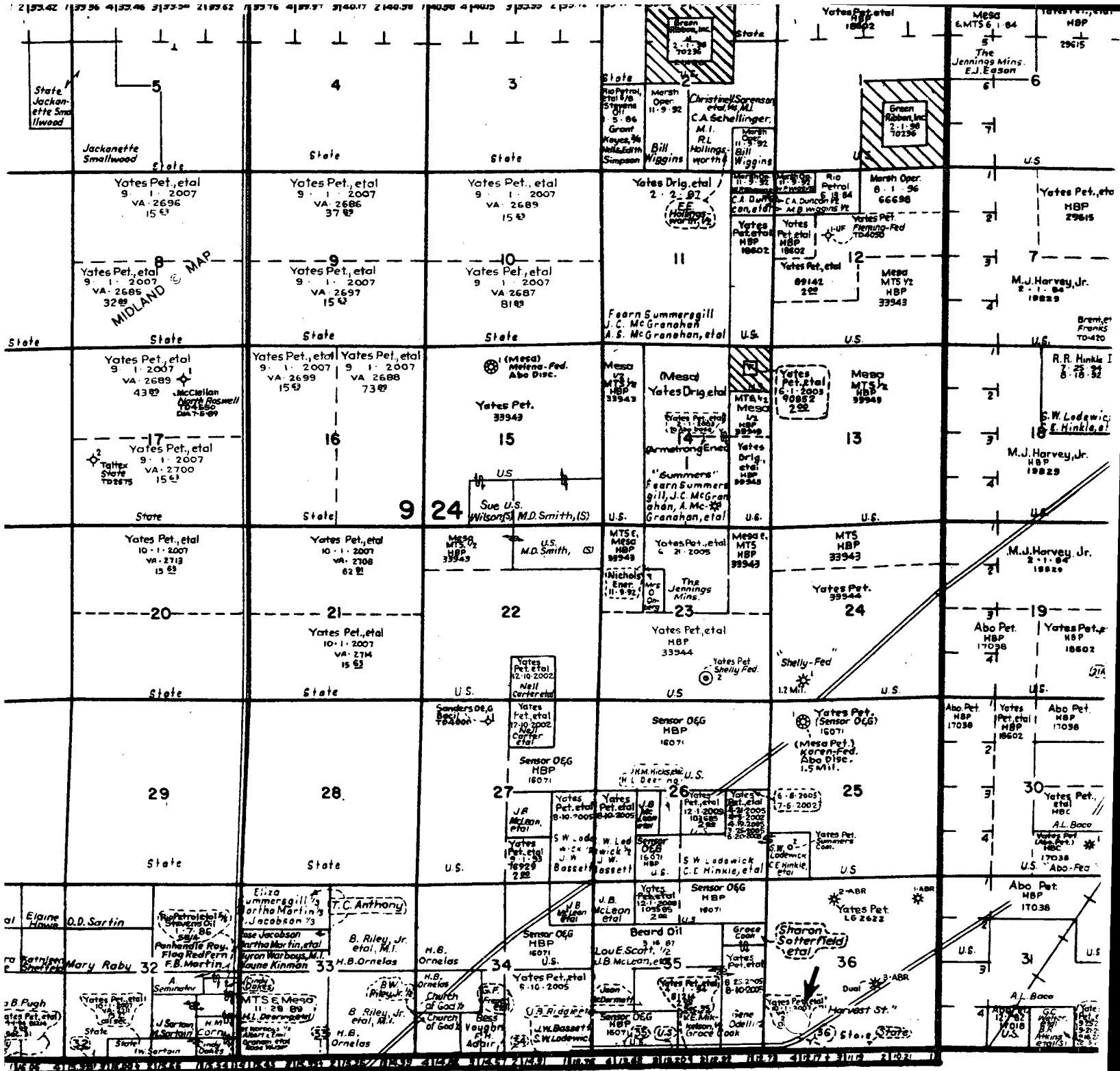

R-24-E

CHAVES, West Central

### Lease and Fee Information

Posted to 9 · 21 · 2002

Oil Conservation Commission Well Information

Posted to

Date Sold

Yates Petroleum Corporation  
Operator

105 South Fourth Street  
Address

Artesia, New Mexico 88210

Harvest ABR State  
Lease

4  
Well No.

K 36 9S 24E  
Unit Letter-Section-Township-Range

Chaves  
County

OGRID No. 025575 Property Code \_\_\_\_\_ API No. 30-005-63447 Lease Type: ☐ Federal ☒ State ☐ Fee

DATA ELEMENT	UPPER ZONE	INTERMEDIATE ZONE	LOWER ZONE
Pool Name	Pecos Slope Abo		<del>Four Ranch</del> Wolfcamp
Pool Code	82730		
Top and Bottom of PaySection (Perforated or Open-Hole Interval)	3421-3732'		4296-4300' 4509-4519'
Method of Production (Flowing or Artificial Lift)	Flowing		Flowing
Bottomhole Pressure (Note: Pressure data will not be required if the bottom perforation in the lower zone is within 150% of the depth of the top perforation in the upper zone)	NA		NA
Oil Gravity or Gas BTU (Degree API or Gas BTU)	NA		NA
Producing, Shut-In or New Zone	New Zone		New Zone
Date and Oil/Gas/Water Rates of Last Production. (Note: For new zones with no production history, applicant shall be required to attach production estimates and supporting data.)	Date: Rate: 800 mcf/d 0 bop/d 0 bw/d	Date: Rate:	Date: 6/10/03 Rate: 200 mcf/d 0 bop/d 1 bw/d
Fixed Allocation Percentage (Note: If allocation is based upon something other than current or past production, supporting data or explanation will be required.)	Oil Gas % 80 %	Oil Gas	Oil Gas % 20%

ADDITIONAL DATA

Are all working, royalty and overriding royalty interests identical in all commingled zones?  
If not, have all working, royalty and overriding royalty interest owners been notified by certified mail?

Yes ☒ No ☐  
Yes ☐ No ☐

Are all produced fluids from all commingled zones compatible with each other?

Yes ☒ No ☐

Will commingling decrease the value of production?

Yes ☐ No ☒

If this well is on, or communitized with, state or federal lands, has either the Commissioner of Public Lands or the United States Bureau of Land Management been notified in writing of this application?

Yes ☐ No ☐

NMOCD Reference Case No. applicable to this well: \_\_\_\_\_

Attachments:

- C-102 for each zone to be commingled showing its spacing unit and acreage dedication.
- Production curve for each zone for at least one year. (If not available, attach explanation.)
- For zones with no production history, estimated production rates and supporting data.
- Data to support allocation method or formula.
- Notification list of working, royalty and overriding royalty interests for uncommon interest cases.
- Any additional statements, data or documents required to support commingling.

PRE-APPROVED POOLS

If application is to establish Pre-Approved Pools, the following additional information will be required:

- List of other orders approving downhole commingling within the proposed Pre-Approved Pools
- List of all operators within the proposed Pre-Approved Pools
- Proof that all operators within the proposed Pre-Approved Pools were provided notice of this application.
- Bottomhole pressure data.

I hereby certify that the information above is true and complete to the best of my knowledge and belief.

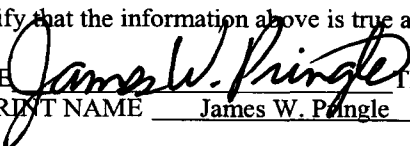
SIGNATURE 

TITLE Operations Engineer

DATE June 11, 2003

TYPE OR PRINT NAME James W. Pangle

TELEPHONE NO. (505)-748-4182

MARTIN YATES, III  
1912 - 1985  
FRANK W. YATES  
1936 - 1986



105 SOUTH FOURTH STREET  
ARTESIA, NEW MEXICO 88210-2118  
TELEPHONE (505) 748-1471

S. P. YATES  
CHAIRMAN OF THE BOARD  
JOHN A. YATES  
PRESIDENT  
PEYTON YATES  
EXECUTIVE VICE PRESIDENT  
RANDY G. PATTERSON  
SECRETARY  
DENNIS G. KINSEY  
TREASURER

June 11, 2003

David Catanach  
State of New Mexico  
OIL CONSERVATION DIVISION  
1220 South Saint Francis Drive  
Santa Fe, NM 87505

Dear Mr. Catanach,

Yates Petroleum Corporation hereby seeks administrative approval to downhole commingle the production from the Pecos Slope Abo and the Foor Ranch Wolfcamp, in our Harvest ABR State #4, located in Unit K of Section 36, Township 9 South, Range 24 East, Chaves County.

If you have any questions or need additional information, please call me at (505) 748-4182

Sincerely,

James W. Pringle  
Operations Engineer

JWP/cm

Enclosures

MARTIN YATES, III  
1912 - 1985  
FRANK W. YATES  
1936 - 1986



105 SOUTH FOURTH STREET  
ARTESIA, NEW MEXICO 88210-2118  
TELEPHONE (505) 748-1471

S. P. YATES  
CHAIRMAN OF THE BOARD  
JOHN A. YATES  
PRESIDENT  
PEYTON YATES  
EXECUTIVE VICE PRESIDENT  
RANDY G. PATTERSON  
SECRETARY  
DENNIS G. KINSEY  
TREASURER

June 11, 2003

Tim Gum  
State of New Mexico  
OIL CONSERVATION DIVISION  
1301 W. Grand  
Artesia, New Mexico 88210

Dear Mr. Gum,

Yates Petroleum Corporation hereby seeks administrative approval to downhole commingle the production from the Pecos Slope Abo and the Foor Ranch Wolfcamp, in our Harvest ABR State #4, located in Unit K of Section 36, Township 9 South, Range 24 East, Chaves County

If you have any questions or need additional information, please call me at (505) 748-4182

Sincerely,

James W. Pringle  
Operations Engineer

JWP/cm

Enclosures

MARTIN YATES, III  
1912 - 1985  
FRANK W. YATES  
1936 - 1986



105 SOUTH FOURTH STREET  
ARTESIA, NEW MEXICO 88210-2118  
TELEPHONE (505) 748-1471

S. P. YATES  
CHAIRMAN OF THE BOARD  
JOHN A. YATES  
PRESIDENT  
PEYTON YATES  
EXECUTIVE VICE PRESIDENT  
RANDY G. PATTERSON  
SECRETARY  
DENNIS G. KINSEY  
TREASURER

June 11, 2003

Pete Martinez  
State of New Mexico  
Commissioner of Public Lands  
P. O. Box 1148  
Santa Fe, NM 87504-1148

Dear Mr. Martinez,

Pursuant to the State Land Office Rule Nos. 1.053, 1.054 and 1.055, you will find enclosed the \$30.00 filing fee and a copy of the commingling application for the Harvest ABR State #4

Should you have any questions, feel free to contact me at (505) 748-4182.  
Thank you.

Sincerely,

A handwritten signature in cursive script that reads 'James W. Pringle'.

James W. Pringle  
Operations Engineer

JWP/cm

Enclosures

**District I**  
1625 N. French Dr., Hobbs, NM 88240

State of New Mexico  
Energy, Minerals & Natural Resources Department

Form C-102  
Revised August 15, 2000

**District II**  
811 South First, Artesia, NM 88210

**District III**  
1000 Rio Brazos Rd., Aztec, NM 87410

**District IV**  
1220 S. St. Francis Dr., Santa Fe, NM 87505

OIL CONSERVATION DIVISION  
1220 South St. Francis Dr.  
Santa Fe, NM 87505

Submit to Appropriate District Office  
State Lease - 4 Copies  
Fee Lease - 3 Copies

☐ AMENDED REPORT

<sup>1</sup> API Number 30-005-63447		<sup>2</sup> Pool Code		<sup>3</sup> Pool Name Pecos Slope Abo	
<sup>4</sup> Property Code		<sup>5</sup> Property Name Harvest ABR State			<sup>6</sup> Well Number 4
<sup>7</sup> OGRID No. 025575		<sup>8</sup> Operator Name Yates Petroleum Corporation			<sup>9</sup> Elevation 3547

<sup>10</sup> Surface Location									
UL or lot no. K	Section 36	Township 9S	Range 24E	Lot Idn	Feet from the 1980	North/South line South	Feet from the 1650	East/West line West	County Chaves

<sup>11</sup> Bottom Hole Location If Different From Surface									
UL or lot no.	Section	Township	Range	Lot Idn	Feet from the	North/South line	Feet from the	East/West line	County
<sup>12</sup> Dedicated Acres 320	<sup>13</sup> Joint or Infill	<sup>14</sup> Consolidation Code		<sup>15</sup> Order No.					

NO ALLOWABLE WILL BE ASSIGNED TO THIS COMPLETION UNTIL ALL INTERESTS HAVE BEEN CONSOLIDATED OR A NON-STANDARD UNIT HAS BEEN APPROVED BY THE DIVISION

<div> <div>16</div> <div> <div>1650'</div> <div> </div> <div>1980'</div> </div> </div>	<div> <div>17 OPERATOR CERTIFICATION</div> <div>I hereby certify that the information contained herein is true and complete to the best of my knowledge and belief.</div> <div> <div>Cherry Matchus</div> <div>Signature</div> </div> <div> <div>Cherry Matchus</div> <div>Printed Name</div> </div> <div> <div>Engineering Tech</div> <div>Title</div> </div> <div> <div>6/4/03</div> <div>Date</div> </div> </div>			
	<div> <div>18 SURVEYOR CERTIFICATION</div> <div>I hereby certify that the well location shown on this plat was plotted from field notes of actual surveys made by me or under my supervision, and that the same is true and correct to the best of my belief.</div> <div> <div>Date of Survey</div> <div>Signature and Seal of Professional Surveyor:</div> </div> <div>Certificate Number</div> </div>			

The Pecos Slope Abo is a new zone and production curves are not available.



District I  
1625 N. French Dr., Hobbs, NM 88240

State of New Mexico  
Energy, Minerals & Natural Resources Department

Form C-102  
Revised August 15, 2000

District II  
811 South First, Artesia, NM 88210

OIL CONSERVATION DIVISION

Submit to Appropriate District Office

District III  
1000 Rio Brazos Rd., Aztec, NM 87410

1220 South St. Francis Dr.  
Santa Fe, NM 87505

State Lease - 4 Copies  
Fee Lease - 3 Copies

District IV  
1220 S. St. Francis Dr., Santa Fe, NM 87505

☐ AMENDED REPORT

WELL LOCATION AND ACREAGE DEDICATION PLAT

<sup>1</sup> API Number 30-005-63447	<sup>2</sup> Pool Code	<sup>3</sup> Pool Name Foor Ranch Wolfcamp
<sup>4</sup> Property Code	<sup>5</sup> Property Name Harvest ABR State	<sup>6</sup> Well Number 4
<sup>7</sup> OGRID No. 025575	<sup>8</sup> Operator Name Yates Petroleum Corporation	<sup>9</sup> Elevation 3547

<sup>10</sup> Surface Location

UL or lot no. K	Section 36	Township 9S	Range 24E	Lot Idn	Feet from the 1980	North/South line South	Feet from the 1650	East/West line West	County Chaves
--------------------	---------------	----------------	--------------	---------	-----------------------	---------------------------	-----------------------	------------------------	------------------

<sup>11</sup> Bottom Hole Location If Different From Surface

UL or lot no.	Section	Township	Range	Lot Idn	Feet from the	North/South line	Feet from the	East/West line	County
<sup>12</sup> Dedicated Acres 320	<sup>13</sup> Joint or Infill	<sup>14</sup> Consolidation Code	<sup>15</sup> Order No.						

NO ALLOWABLE WILL BE ASSIGNED TO THIS COMPLETION UNTIL ALL INTERESTS HAVE BEEN CONSOLIDATED OR A NON-STANDARD UNIT HAS BEEN APPROVED BY THE DIVISION

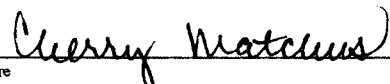
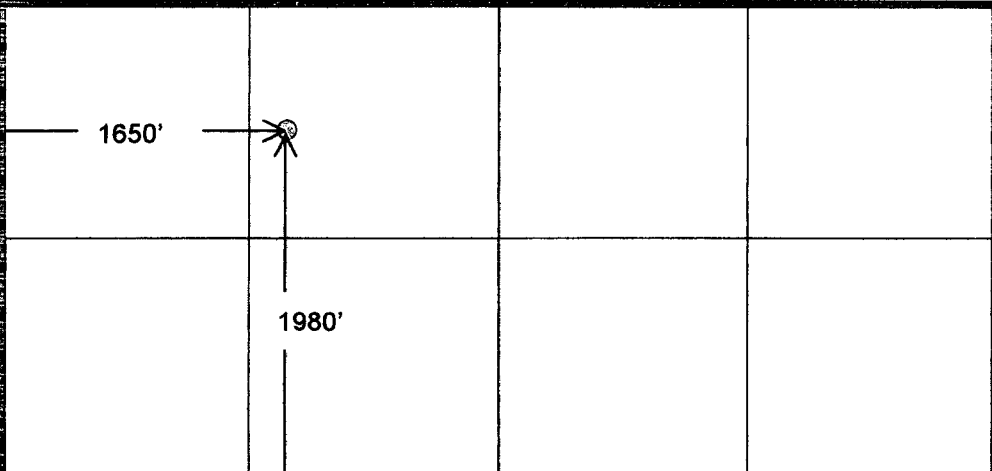
<sup>16</sup>				<sup>17</sup> OPERATOR CERTIFICATION I hereby certify that the information contained herein is true and complete to the best of my knowledge and belief.  Signature Cherry Matchus Printed Name Title_ Engineering Tech Date 6/4/03
				<sup>18</sup> SURVEYOR CERTIFICATION I hereby certify that the well location shown on this plat was plotted from field notes of actual surveys made by me or under my supervision, and that the same is true and correct to the best of my belief. Date of Survey Signature and Seal of Professional Surveyor:  Certificate Number

The Foor Ranch Wolfcamp is a new zone and production curves are not available.