

UNITED STATES
DEPARTMENT OF THE INTERIOR
GEOLOGICAL SURVEY

APPLICATION FOR PERMIT TO DRILL, DEEPEN, OR PLUG BACK

1a. TYPE OF WORK

DRILL ☒DEEPEN ☐PLUG BACK ☐

b. TYPE OF WELL

OIL
WELL ☐GAS
WELL ☒

OTHER

SINGLY

MULTIPLE

2. NAME OF OPERATOR

El Paso Natural Gas Company

3. ADDRESS OF OPERATOR

Box 990, Farmington, New Mexico

4. LOCATION OF WELL (Report location clearly and in accordance with any State requirements.)

At surface

1140' S, 1720' E

At proposed prod. zone

14. DISTANCE IN MILES AND DIRECTION FROM NEAREST TOWN OR POST OFFICE*

15. DISTANCE FROM PROPOSED*

LOCATION TO NEAREST
PROPERTY OR LEASE LINE, FT.
(Also to nearest drlg. unit line, if any)

16. NO. OF ACRES IN LEASE

17. NO. OF ACRES ASSIGNED
TO THIS WELL

320

18. DISTANCE FROM PROPOSED LOCATION*
TO NEAREST WELL, DRILLING, COMPLETED,
OR APPLIED FOR, ON THIS LEASE, FT.

19. PROPOSED DEPTH

8165'

20. ROTARY OR CABLE TOOLS

Rotary

21. ELEVATIONS (Show whether DF, RT, GR, etc.)

6406' GL

22. APPROX. DATE WORK WILL START*

23.

PROPOSED CASING AND CEMENTING PROGRAM

SIZE OF HOLE	SIZE OF CASING	WEIGHT PER FOOT	SETTING DEPTH	QUANTITY OF CEMENT
13 3/4"	9 5/8"	32.3#	200	190 sks. to circulate
8 3/4"	7"	20#	3575	160 sks. to cover the Ojo Alamo
6 1/4"	4 1/2"	10.5 & 11.6#	8165	395 sks. to fill to 3575'.

Selectively perforate and sandwater fracture the Dakota formation.

The E/2 of Section 28 is dedicated to this well.

IN ABOVE SPACE DESCRIBE PROPOSED PROGRAM: If proposal is to deepen or plug back, give data on present productive zone and proposed new productive zone. If proposal is to drill or deepen directionally, give pertinent data on subsurface locations and measured and true vertical depths. Give blowout preventer program, if any.

24.

SIGNED Original Signed F. H. WOOD TITLE Petroleum Engineer DATE August 23, 1971

(This space for Federal or State office use)

PERMIT NO. _____ APPROVAL DATE _____

APPROVED BY [Signature] TITLE _____ DATE _____

CONDITIONS OF APPROVAL, IF ANY:

*See Instructions On Reverse Side

NEW MEXICO OIL CONSERVATION COMMISSION
WELL LOCATION AND ACREAGE DEDICATION PLAT

All distances must be in feet.

EL PASO NATURAL GAS COMPANY

EPNG "B"

(NM-12014)

1

0

28

32-N

6-W

SAN JUAN

1140

SOUTH

1720

EAST

6406

DAKOTA

BASIN DAKOTA

320.00

1. Outline the acreage dedicated to the subject well by colored pencil or hatching marks on the plat below.
2. If more than one lease is dedicated to the well, outline each and identify the ownership, term, whether an oil or gas lease, interest and royalty.
3. If more than one lease of different ownership is dedicated to the well, have the interests consolidated by communitization, unitization, force-pooling, etc?

Yes No If answer is "yes," type of consolidation

If answer is "no," list the owners and tract descriptions which have actually been consolidated (reverse side of this form if necessary).

No allocation will be assigned to the well until all interests have been consolidated by communitization, unitization, force-pooling, or otherwise or until a non-standard unit, eliminating such interests, has been approved by the Commission.

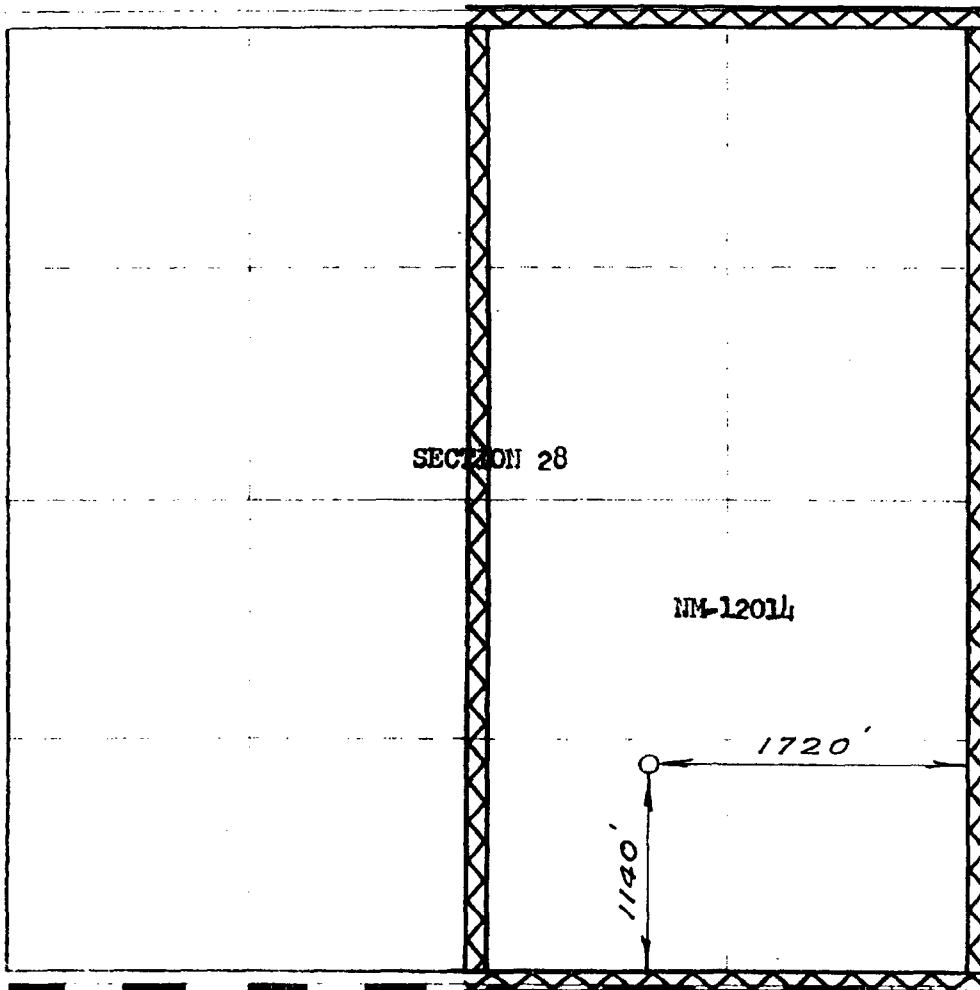
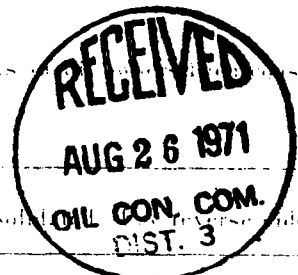

CERTIFICATION

I hereby certify that the information furnished herein is true and complete to the best of my knowledge and belief.

Original Signed F. H. WOOD

Petroleum Engineer

El Paso Natural Gas

August 23, 1971

I hereby certify that the well location and acreage shown on this plat was properly located, noted, and all surveys made by me or under my supervision and that the same are correct and true to the best of my knowledge and belief.

MAY 25, 1971

David O. Kilmer
1760

NEW MEXICO OIL CONSERVATION COMMISSION
WELL LOCATION AND ACREAGE DEDICATION PLAT

Form C-102
Supersedes C-128
Effective 1-1-65

All distances must be from the outer boundaries of the Section.

Operator EL PASO NATURAL GAS COMPANY		Lease EPNG B (NM-12014)		Well No. 1
Unit Letter 0	Section 28	Township 32-N	Range 6-W	County SAN JUAN
Actual Footage Location of Well: 1140 feet from the SOUTH line and 1720 feet from the EAST line				
Ground Level Elev. 6406	Producing Formation MESA VERDE-DAKOTA	Pool BLANCO MESA VERDE-BASIN DAKOTA	Dedicated Acreage: 320.00 & 320.00 Acres	

1. Outline the acreage dedicated to the subject well by colored pencil or hatchure marks on the plat below.
2. If more than one lease is dedicated to the well, outline each and identify the ownership thereof (both as to working interest and royalty).
3. If more than one lease of different ownership is dedicated to the well, have the interests of all owners been consolidated by communitization, unitization, force-pooling, etc?

☐ Yes ☐ No If answer is "yes," type of consolidation _____

If answer is "no," list the owners and tract descriptions which have actually been consolidated. (Use reverse side of this form if necessary.) _____

No allowable will be assigned to the well until all interests have been consolidated (by communitization, unitization, forced-pooling, or otherwise) or until a non-standard unit, eliminating such interests, has been approved by the Commission. NOTE: THIS PLAT IS REISSUED TO INCLUDE MESA VERDE FORMATION. 11-14-78

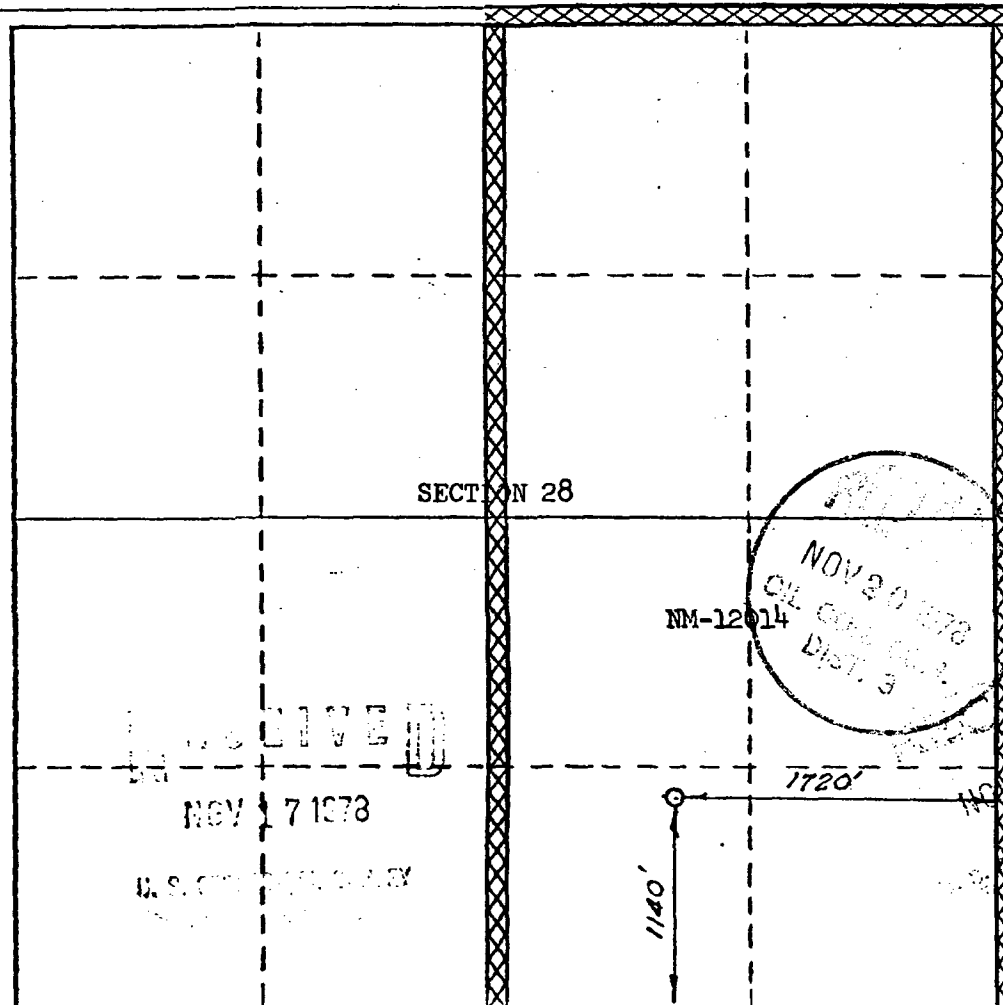

CERTIFICATION

I hereby certify that the information contained herein is true and complete to the best of my knowledge and belief.

D. P. Buico

Name
Drilling Clerk
Position
El Paso Natural Gas Co.
Company
November 15, 1978
Date

I hereby certify that the well location shown on this plat was plotted from field notes of actual surveys made by me or under my supervision, and that the same is true and correct to the best of my knowledge and belief.

Date Surveyed
MAY 25, 1971
Registered Professional Engineer and/or Land Surveyor
ORIGINAL SIGNED BY:
DAVID O. VILVEN

Certificate No. **1760**

0 330 660 990 1320 1650 1980 2310 2640 2000 1500 1000 500 C