

NSL-5250

30 025-00010

Finding Paragraph Nos.

(4) +

(6)

NO. OF COPIES RECEIVED	
DISTRIBUTION	
SANTA FE	
FILE	
U.S.G.S.	
LAND OFFICE	
OPERATOR	

## NEW MEXICO OIL CONSERVATION COMMISSION

Form C-103  
Supersedes Old  
C-102 and C-103  
Effective 1-1-65

<b>SUNDRY NOTICES AND REPORTS ON WELLS</b> <small>(DO NOT USE THIS FORM FOR PROPOSALS TO DRILL OR TO DEEPEN OR PLUG BACK TO A DIFFERENT RESERVOIR. USE "APPLICATION FOR PERMIT" (FORM C-101) FOR SUCH PROPOSALS.)</small>		5a. Indicate Type of Lease State <input checked="" type="checkbox"/> Fee <input type="checkbox"/>
		5. State Oil & Gas Lease No. E-9713
1. <input type="checkbox"/> OIL WELL <input type="checkbox"/> GAS WELL <input type="checkbox"/> OTHER- Salt Water Disposal		7. Unit Agreement Name
2. Name of Operator Texas Oil & Gas Corp.		8. Farm or Lease Name N. M. "K" St.
3. Address of Operator 900 Wilco Building, Midland, Texas 79701		9. Well No. 1
4. Location of Well UNIT LETTER <u>0</u> <u>1980</u> FEET FROM THE <u>East</u> LINE AND <u>660</u> FEET FROM THE <u>South</u> LINE, SECTION <u>11</u> TOWNSHIP <u>10S</u> RANGE <u>32E</u> NMPM.		10. Field and Pool, or Wildcat Mescalero (San Andres)
15. Elevation (Show whether DF, RT, GR, etc.) 4274' DF		12. County Lea

16. Check Appropriate Box To Indicate Nature of Notice, Report or Other Data	
NOTICE OF INTENTION TO:	SUBSEQUENT REPORT OF:
PERFORM REMEDIAL WORK <input type="checkbox"/> TEMPORARILY ABANDON <input type="checkbox"/> PULL OR ALTER CASING <input type="checkbox"/> OTHER <input type="checkbox"/>	PLUG AND ABANDON <input type="checkbox"/> CHANGE PLANS <input type="checkbox"/> OTHER <input type="checkbox"/>
REMEDIAL WORK <input type="checkbox"/> COMMENCE DRILLING OPNS. <input type="checkbox"/> CASING TEST AND CEMENT JOB <input type="checkbox"/> OTHER <input type="checkbox"/>	

17. Describe Proposed or Completed Operations (Clearly state all pertinent details, and give pertinent dates, including estimated date of starting any proposed work) SEE RULE 1103.

8-16-76 Set CIBP @ 3990' Capped w/35' cmt

8-17-76 Cut 5-1/2" csg @ 3212' Rec 78 jts.

8-18-76 Circ hole w/9.5 PG Mud

8-19-76 WIH w/tbg to 3663' Spotted 30 sx plg @ 3662  
45 sx @ 1785, 10 sx @ top WELL P & A

18. I hereby certify that the information above is true and complete to the best of my knowledge and belief.

SIGNED J. R. Colter TITLE Staff Engineer DATE August 20, 1976

APPROVED BY Apple F. Turner TITLE OIL & GAS INSPECTOR DATE DEC 10 1991

CONDITIONS OF APPROVAL, IF ANY:

NO. OF COPIES RECEIVED	
DISTRIBUTION	
SANTA FE	
FILE	
U.S.G.S.	
LAND OFFICE	
OPERATOR	

**RECEIVED**  
NEW MEXICO OIL CONSERVATION COMMISSION

**JUL 9 1976**

**O.C.C.**  
**ARTESIA, OFFICE**

Form C-103  
Supersedes Old  
C-102 and C-103  
Effective 1-1-65

5a. Indicate Type of Lease State <input checked="" type="checkbox"/> Fee <input type="checkbox"/>
5. State Oil & Gas Lease No. E-9713

**SUNDRY NOTICES AND REPORTS ON WELLS**  
(DO NOT USE THIS FORM FOR PROPOSALS TO DRILL OR TO DEEPEN OR PLUG BACK TO A DIFFERENT RESERVOIR.  
USE "APPLICATION FOR PERMIT -" (FORM C-101) FOR SUCH PROPOSALS.)

1. OIL WELL <input type="checkbox"/> GAS WELL <input type="checkbox"/> OTHER: Salt Water Disposal	7. Unit Agreement Name
2. Name of Operator Texas Oil & Gas Corp.	8. Farm or Lease Name N. M. "K" St.
3. Address of Operator 900 Wilco Building, Midland, Texas 79701	9. Well No. 1
4. Location of Well UNIT LETTER <u>0</u> , <u>1980</u> FEET FROM THE <u>East</u> LINE AND <u>660</u> FEET FROM THE <u>South</u> LINE, SECTION <u>11</u> TOWNSHIP <u>10S</u> RANGE <u>32E</u> NMPM.	10. Field and Pool, or Wildcat Mescalero (San Andres)
15. Elevation (Show whether DF, RT, CR, etc.) 4274' DF	12. County

16. Check Appropriate Box To Indicate Nature of Notice, Report or Other Data  
NOTICE OF INTENTION TO:

PERFORM REMEDIAL WORK ☐  
TEMPORARILY ABANDON ☐  
PULL OR ALTER CASING ☐  
OTHER ☐

PLUG AND ABANDON ☒  
CHANGE PLANS ☐  
OTHER ☐

SUBSEQUENT REPORT OF:

REMEDIAL WORK ☐  
COMMENCE DRILLING OPNS. ☐  
CASING TEST AND CEMENT JOB ☐  
OTHER ☐

ALTERING CASING ☐  
PLUG AND ABANDONMENT ☐

17. Describe Proposed or Completed Operations (Clearly state all pertinent details, and give pertinent dates, including estimated date of starting any proposed work) SEE RULE 1103.

- MIRUPU. Pull tubing and packer.
- Run CIBP on wireline and set at approximately 3990'. Cap BP with 35' cement plug.
- Freepoint 5½" casing. Shoot off casing at freepoint and pull.
- Run tubing to 50' inside casing stub and displace hole with 9.5#/gal. brine mud containing 25#/bbls. bentonite. Spot 100' cement plug in and above casing stub.
- If casing shot point is below 3538', pull tubing to 3538' and spot 100' cement plug across 9-5/8" casing shoe.
- Pull tubing to 1785' and spot 100' cement plug across salt section.
- Spot 10 sx. cement plug at surface and weld steel cap on casing.
- Weld 4' diameter, 4' (above ground) dry hole marker on steel cap and label with Texas Oil & Gas Corp., N.M. "K" St. #1, Loc. 0-11-10-32.
- Move surplus equipment and clean location.

THE COMMISSION MUST BE NOTIFIED  
24 HOURS PRIOR TO ~~SETTING~~ *setting*  
~~bottom plug~~ *bottom plug*.

*Expires 11/1/77*

18. I hereby certify that the information above is true and complete to the best of my knowledge and belief.

SIGNED <u>Thomas E. Runyan</u> Orig. Signed By John Runyan Geologist	TITLE <u>Production Engineer</u>	DATE <u>July 8, 1976</u>
APPROVED BY _____	TITLE _____	DATE _____
CONDITIONS OF APPROVAL, IF ANY:		

**JUL 12 1976**

NO. OF COPIES RECEIVED	
DISTRIBUTION	
SANTA FE	
FILE	
U.S.G.S.	
LAND OFFICE	
OPERATOR	

# NEW MEXICO OIL CONSERVATION COMMISSION

Form C-103  
Supersedes Old  
C-102 and C-103  
Effective 1-1-65

5a. Indicate Type of Lease State <input checked="" type="checkbox"/> Fee <input type="checkbox"/>
5. State Oil & Gas Lease No. E-9713
7. Unit Agreement Name
8. Farm or Lease Name New Mexico "K" St.
9. Well No. 1
10. Field and Pool, or Wildcat Mescalero San Andres
12. County Lea

**SUNDRY NOTICES AND REPORTS ON WELLS**  
(DO NOT USE THIS FORM FOR PROPOSALS TO DRILL OR TO DEEPEN OR PLUG BACK TO A DIFFERENT RESERVOIR.  
USE "APPLICATION FOR PERMIT -" (FORM C-101) FOR SUCH PROPOSALS.)

1. OIL WELL <input type="checkbox"/> GAS WELL <input type="checkbox"/> OTHER- Salt Water Disposal Well
2. Name of Operator Texas Oil & Gas Corp.
3. Address of Operator P. O. Box 591, Midland, Texas 79701
4. Location of Well UNIT LETTER <u>O</u> <u>1980</u> FEET FROM THE <u>east</u> LINE AND <u>660</u> FEET FROM THE <u>south</u> LINE, SECTION <u>11</u> TOWNSHIP <u>10-S</u> RANGE <u>32-E</u> NMPM.
15. Elevation (Show whether DF, RT, GR, etc.) 4274' DF

16. Check Appropriate Box To Indicate Nature of Notice, Report or Other Data

NOTICE OF INTENTION TO:		SUBSEQUENT REPORT OF:	
PERFORM REMEDIAL WORK <input type="checkbox"/>	PLUG AND ABANDON <input type="checkbox"/>	REMEDIAL WORK <input type="checkbox"/>	ALTERING CASING <input type="checkbox"/>
TEMPORARILY ABANDON <input checked="" type="checkbox"/>	CHANGE PLANS <input type="checkbox"/>	COMMENCE DRILLING OPNS. <input type="checkbox"/>	PLUG AND ABANDONMENT <input type="checkbox"/>
PULL OR ALTER CASING <input type="checkbox"/>	OTHER <input type="checkbox"/>	CASING TEST AND CEMENT JOB <input type="checkbox"/>	OTHER <input type="checkbox"/>

17. Describe Proposed or Completed Operations (Clearly state all pertinent details, and give pertinent dates, including estimated date of starting any proposed work) SEE RULE 1103.

- Closed in salt water disposal well
- Texas Oil & Gas Corp. assumed operation from The Wil-Mc Oil Corp. on August 1, 1974
- Well was closed in before Texas Oil & Gas Corp. took over operation
- Plan to leave well closed in for possible future use as a disposal well

*Expires 1/1/76*

18. I hereby certify that the information above is true and complete to the best of my knowledge and belief.

SIGNED <u>J. R. Colter</u>	TITLE <u>Staff Engineer</u>	DATE <u>1-30-75</u>
APPROVED BY <u>Joe D. [Signature]</u>	TITLE <u></u>	DATE <u></u>
CONDITIONS OF APPROVAL, IF ANY: <u>Dist. I, [Signature]</u>		

NO. OF COPIES RECEIVED	
DISTRIBUTION	
SANTA FE	
FILE	
U.S.G.S.	
LAND OFFICE	
TRANSPORTER	OIL GAS
OPERATOR	
PRORATION OFFICE	

**NEW MEXICO OIL CONSERVATION COMMISSION**  
**REQUEST FOR ALLOWABLE**  
**AND**  
**AUTHORIZATION TO TRANSPORT OIL AND NATURAL GAS**

Form C-104  
 Supersedes Old C-104 and C-110  
 Effective 1-1-65

**I. Operator**  
Texas Oil & Gas Corp.  
**Address:**  
P. O. Box 591, Midland, Texas 79701  
**Reason(s) for filing (Check proper box)**  
 New Well ☐ Extension of Transporter's ☐  
 Recompletion ☐ Oil ☐ Dry Gas ☐  
 Change in Ownership ☒ Change in Oil Gas ☐ Condensate ☐  
**Other (Please explain)**

If change of ownership give name and address of previous owner The Wil-Mc Oil Corp., P. O. Box 1411, Dallas, Texas 75221

**II. DESCRIPTION OF WELL AND LEASE**

Lease Name <b>New Mexico "K" State</b>	Well No. <b>1</b>	Pool Name, including Formation <b>Mescalero (San Andres)</b>	Kind of Lease State, Federal or Fee <b>State</b>
Location Unit Letter <b>O</b> : <b>1980</b> feet from the <b>east</b> line and <b>660</b> feet from the <b>south</b> Line of Section <b>11</b> , Township <b>10-S</b> Range <b>32-E</b> , N.M.P.M., <b>Lea</b> County			

**III. DESIGNATION OF TRANSPORTER OF OIL AND NATURAL GAS**

Name of Authorized Transporter of Oil <input type="checkbox"/> or Condensate <input type="checkbox"/> <b>None</b>	Address (Give address to which approved copy of this form is to be sent)
Name of Authorized Transporter of Crude Oil <input type="checkbox"/> or Dry Gas <input type="checkbox"/> <b>None</b>	Address (Give address to which approved copy of this form is to be sent)
If well produces oil or liquids, give location of tanks.	Unit Sec. Twp. Rge. Is gas actually connected? When

If this production is commingled with that from any other lease or pool, give commingling order number:

**IV. COMPLETION DATA**

Designate Type of Completion - (X)		Oil Well	Gas Well	New Well	Workover	Deepen	Plug Back	Same Res'v.	Diff. Res'v.
Date Spurred	Date Cased, Ready to Prod.	Total Depth		P.B.T.D.					
Pool	Name of Producing Formation	Top Oil/Gas Pay		Tubing Depth					
Perforations		Depth Casing Shoe							
<b>TUBING, CASING, AND CEMENTING RECORD</b>									
HOLE SIZE	CASING & TUBING SIZE	DEPTH SET		SACKS CEMENT					

**V. TEST DATA AND REQUEST FOR ALLOWABLE OIL WELL**

(Test must be after recovery of total volume of load oil and must be equal to or exceed top allowable for this depth or be for full 24 hours)

Date First New Oil Run To Tanks	Date of Test	Producing Method (Flow, pump, gas lift, etc.)	
Length of Test	Tubing Pressure	Casing Pressure	Choke Size
Actual Prod. During Test	Oil-Bbls.	Water-Bbls.	Gas-MCF

**GAS WELL**

Actual Prod. Test-MCF/D	Length of Test	Bbls. Condensate/MMCF	Gravity of Condensate
Testing Method (pilot, back pr.)	Tubing Pressure	Casing Pressure	Choke Size

**VI. CERTIFICATE OF COMPLIANCE**

I hereby certify that the rules and regulations of the Oil Conservation Commission have been complied with and that the information given above is true and complete to the best of my knowledge and belief.

  
 (Signature)

Staff Engineer

(Title)

1-30-75

(Date)

**OIL CONSERVATION COMMISSION**

APPROVED \_\_\_\_\_, 19\_\_\_\_

BY Joe D. Egan

TITLE Dist. I, Sec.

This form is to be filed in compliance with RULE 1104.

If this is a request for allowable for a newly drilled or deepened well, this form must be accompanied by a tabulation of the deviation tests taken on the well in accordance with RULE 111.

All sections of this form must be filled out completely for allowable on new and recompleted wells.

Fill out Sections I, II, III, and VI only for changes of owner, well name or number, or transporter, or other such change of condition.

Separate Forms C-104 must be filed for each pool in multiple completed wells.

NO. OF COPIES RECEIVED		
DISTRIBUTION		
SANTA FE		
FILE		
U.S.G.S.		
LAND OFFICE		
OPERATOR		

# NEW MEXICO OIL CONSERVATION COMMISSION

Form C-103  
Supersedes Old  
C-102 and C-103  
Effective 1-1-65

5a. Indicate Type of Lease	
State <input checked="" type="checkbox"/>	Fee <input type="checkbox"/>
5. State Oil & Gas Lease No. <b>E-9713</b>	
7. Unit Agreement Name	
8. Farm or Lease Name <b>New Mexico State "K"</b>	
9. Well No. <b>1</b>	
10. Field and Pool, or Wildcat <b>Mescalero San Andres</b>	
12. County <b>Lea</b>	

**SUNDRY NOTICES AND REPORTS ON WELLS**  
(DO NOT USE THIS FORM FOR PROPOSALS TO DRILL OR TO DEEPEN OR PLUG BACK TO A DIFFERENT RESERVOIR. USE "APPLICATION FOR PERMIT -" (FORM C-101) FOR SUCH PROPOSALS.)

1. ☐ OIL WELL ☐ GAS WELL ☒ OTHER- **Salt Water Disposal Well**

2. Name of Operator  
**THE WIL-MC OIL CORP.**

3. Address of Operator  
**1108 Fidelity Union Life Bldg., Dallas, Tex. 75201**

4. Location of Well  
UNIT LETTER **0** **1980** FEET FROM THE **East** LINE AND **660** FEET FROM  
THE **South** LINE, SECTION **11** TOWNSHIP **10S** RANGE **32E** NMPM.

15. Elevation (Show whether DF, RT, GR, etc.)  
**4274 DF**

16. Check Appropriate Box To Indicate Nature of Notice, Report or Other Data

NOTICE OF INTENTION TO:		SUBSEQUENT REPORT OF:	
PERFORM REMEDIAL WORK <input type="checkbox"/>	PLUG AND ABANDON <input type="checkbox"/>	REMEDIAL WORK <input type="checkbox"/>	ALTERING CASING <input type="checkbox"/>
TEMPORARILY ABANDON <input type="checkbox"/>	CHANGE PLANS <input type="checkbox"/>	COMMENCE DRILLING OPNS. <input type="checkbox"/>	PLUG AND ABANDONMENT <input type="checkbox"/>
PULL OR ALTER CASING <input type="checkbox"/>	OTHER <input type="checkbox"/>	CASING TEST AND CEMENT JOBS <input type="checkbox"/>	OTHER <input checked="" type="checkbox"/> <b>Convert to Salt Water Disposal Well.</b>

17. Describe Proposed or Completed Operations (Clearly state all pertinent details, and give pertinent dates, including estimated date of starting any proposed work) SEE RULE 1103.

- 1) Pulled tubing with packer.
- 2) Redressed packer and reran tubing with packer and holdown set @ 4020'.
- 3) Ran injectivity test. Max. injection press. 1000 psi @ 4 BPM.
- 4) Hooked up storage tank & Bethlehem TP-3 Triplex with associated controls.
- 5) Began injecting produced water from Wil-Mc New Mex. State, Wil-Mc White State #2A and Redfern Sunray State Lses.

18. I hereby certify that the information above is true and complete to the best of my knowledge and belief.

SIGNED **Paul B. Mc Cully** TITLE **President** DATE **2/12/71**

APPROVED BY **[Signature]** TITLE **SUPERVISOR DISTRICT** DATE **FEB 15 1971**

CONDITIONS OF APPROVAL, IF ANY:

NUMBER OF COPIES RECEIVED	
DISTRIBUTION	
SANTA FE	
FILE	
U.S.G.S.	
LAND OFFICE	
TRANSPORTER	OIL GAS
PRODUCTION OFFICE	
OPERATOR	

# NEW MEXICO OIL CONSERVATION COMMISSION

FORM C-103  
(Rev 3-55)

## MISCELLANEOUS REPORTS ON WELLS

(Submit to appropriate District Office as per Commission Rule 1106)

MAR 17 49 AM '65

Name of Company <b>THE WIL-Mc OIL CORPORATION</b>		Address <b>1108 Fidelity Union Life Bldg., Dallas, Texas</b>				
Lease <b>NEW MEXICO STATE #2</b>	Well No. <b>1</b>	Unit Letter <b>0</b>	Section <b>11</b>	Township <b>10 South</b>	Range <b>32 East</b>	
Date Work Performed <b>12/1/64 to 1/20/64</b>	Pool <b>North Mescalero</b>	County <b>(San Andrea)</b>			Lea	

THIS IS A REPORT OF: (Check appropriate block)

- ☐ Beginning Drilling Operations
 ☐ Casing Test and Cement Job
 ☐ Other (Explain):  
☐ Plugging
 ☒ Remedial Work

Detailed account of work done, nature and quantity of materials used, and results obtained.

1. Pull rods & tubing.
2. Perforate with 1 shot/ ft. 4138, 4158, 4162 & 4179.
3. Rerun tubes with packers set @ 3550'.
4. acidize with 250 gallons gelled acid.
5. re-acidize using 2500 gallons of non- emulsion low surface tension acid.
6. Swab acid water & load.
7. Rerun rods with pump.
8. Place well on pump & test.

Witnessed by <i>Sam B. Mc Cully</i>	Position <b>Exec. Vice-Pres.</b>	Company <b>THE WIL-Mc OIL CORPORATION</b>
--	-------------------------------------	--

FILL IN BELOW FOR REMEDIAL WORK REPORTS ONLY

### ORIGINAL WELL DATA

D F Elev. <b>4269</b>	T D <b>10,775</b>	P B T D <b>4200</b>	Producing Interval <b>4042-4179</b>	Completion Date <b>1-20-64</b>
Tubing Diameter <b>2 3/8"</b>	Tubing Depth <b>3950</b>	Oil String Diameter <b>5 1/4</b>	Oil String Depth <b>10,270</b>	
Perforated Interval(s) <b>4042-45, 4060-62, 4067-69, 4080-82, 4092-94, 4101-03, 4116-20, 4138-4159, 4166, 4179</b>				
Open Hole Interval		Producing Formation(s) <b>San Andrea</b>		

### RESULTS OF WORKOVER

Test	Date of Test	Oil Production BPD	Gas Production MCFPD	Water Production BPD	GOR Cubic feet/Bbl	Gas Well Potential MCFPD
Before Workover	<b>12-15-64</b>	<b>3</b>	<b>TSTM</b>	<b>22</b>	<b>TSTM</b>	
After Workover	<b>1-20-65</b>	<b>9</b>	<b>TSTM</b>	<b>26</b>	<b>TSTM</b>	

### OIL CONSERVATION COMMISSION

I hereby certify that the information given above is true and complete to the best of my knowledge.

Approved by <i>[Signature]</i>	Name <b>Sam B. Mc Cully</b>
Title	Position <b>Executive Vice-President</b>
Date	Company <b>THE WIL-Mc OIL CORPORATION 1108 Fidelity</b>

NUMBER OF COPIES RECEIVED	
DISTRIBUTION	
SANTA FE	
FILE	
U.S.G.S.	
LAND OFFICE	
TRANSPORTER	OIL
	GAS
PRODUCTION OFFICE	
OPERATOR	

**NEW MEXICO OIL CONSERVATION COMMISSION**  
**SANTA FE, NEW MEXICO**  
**CERTIFICATE OF COMPLIANCE AND AUTHORIZATION**  
**TO TRANSPORT OIL AND NATURAL GAS**

**FORM C-110**  
 (Rev. 7-60)

FILE THE ORIGINAL AND 4 COPIES WITH THE APPROPRIATE OFFICE

Company or Operator <b>THE WIL-Mc OIL CORPORATION</b>				Lease <b>New Mexico, State</b>		Well No. <b>#1</b>	
Unit Letter <b>0</b>	Section <b>11</b>	Township <b>10 South</b>	Range <b>32 East</b>		County <b>Lea</b>		
Pool <b>Mescalero-San Andres</b>				Kind of Lease <b>State, Fed, Fee</b>			
If well produces oil or condensate give location of tanks		Unit Letter <b>0</b>	Section <b>11</b>	Township <b>10 South</b>	Range <b>32 East</b>		
Authorized transporter of oil <input checked="" type="checkbox"/> or condensate <input type="checkbox"/> <b>McWood Corporation</b>				Address (give address to which approved copy of this form is to be sent) <b>Abilene, Texas</b>			
Is Gas Actually Connected? Yes <input type="checkbox"/> No <input checked="" type="checkbox"/>							
Authorized transporter of casing head gas <input type="checkbox"/> or dry gas <input type="checkbox"/>		Date Connected	Address (give address to which approved copy of this form is to be sent)				

If gas is not being sold, give reasons and also explain its present disposition:

**No casinghead gas line near. Gas presently being flared.**

**REASON(S) FOR FILING (please check proper box)**

New Well ..... ☐  
 Change in Transporter (check one)  
 Oil ..... ☐ Dry Gas .... ☐  
 Casing head gas . ☐ Condensate.. ☐



Change in Ownership ..... ☒  
 Other (explain below)

**Remarks**

**Effective November 1, 1964, The Wil-Mc Oil Corporation purchased the above well, located in unit "0", Section 11, 10 South, 32 East, Lea County, New Mexico from Sunray DX Oil Company.**

The undersigned certifies that the Rules and Regulations of the Oil Conservation Commission have been complied with.

Executed this the **16th** day of **November**, 19**64**.

<b>OIL CONSERVATION COMMISSION</b>		By 	<b>CLAY MOORE</b>
Approved by 		Title <b>SECRETARY</b>	
Title		Company <b>THE WIL-Mc OIL CORPORATION</b>	
Date		Address <b>1108 Fidelity Union Life Building, Dallas 1, Texas 75201</b>	

NUMBER OF COPIES RECEIVED	
DISTRIBUTION	
SANTA FE	
FILE	
U.S.G.S.	
LAND OFFICE	
TRANSPORTER	HIL
	GAS
PRODUCTION OFFICE	
OPERATOR	

**NEW MEXICO OIL CONSERVATION COMMISSION**  
**SANTA FE, NEW MEXICO**  
**CERTIFICATE OF COMPLIANCE AND AUTHORIZATION**  
**TO TRANSPORT OIL AND NATURAL GAS**

FORM C-110  
 (Rev. 7-60)  
 SEP 2 11 06 AM '64  
 HOBBS, N.M.

FILE THE ORIGINAL AND 4 COPIES WITH THE APPROPRIATE OFFICE

Company or Operator <b>Sunray Oil Company</b>				Lease <b>N.M. State "K"</b>		Well No. <b>1</b>	
Unit Letter <b>0</b>	Section <b>11</b>	Township <b>10S</b>	Range <b>32E</b>	County <b>Lea</b>			
Pool <b>Mescalero - San Andres</b>				Kind of Lease (State, Fed, Fee) <b>State</b>			
If well produces oil or condensate give location of tanks		Unit Letter <b>0</b>	Section <b>11</b>	Township <b>10S</b>	Range <b>32E</b>		
Authorized transporter of oil <input checked="" type="checkbox"/> or condensate <input type="checkbox"/>  <b>McWood Corp.</b>				Address (give address to which approved copy of this form is to be sent)  <b>364 Petroleum Bldg. Arlene, Texas</b>			
Is Gas Actually Connected? Yes <input type="checkbox"/> No <input checked="" type="checkbox"/>							
Authorized transporter of casing head gas <input type="checkbox"/> or dry gas <input type="checkbox"/>		Date Connected	Address (give address to which approved copy of this form is to be sent)				

If gas is not being sold, give reasons and also explain its present disposition:

**Vented**

**REASON(S) FOR FILING (please check proper box)**

New Well ..... <input type="checkbox"/>	Change in Ownership ..... <input type="checkbox"/>
Change in Transporter (check one)	Other (explain below) <b>Change in Pool Designation</b>
Oil ..... <input type="checkbox"/> Dry Gas ..... <input type="checkbox"/>	
Casing head gas . <input type="checkbox"/> Condensate.. <input type="checkbox"/>	

Remarks

The undersigned certifies that the Rules and Regulations of the Oil Conservation Commission have been complied with.

Executed this the **1st** day of **September**, 19**64**.

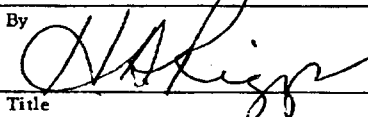
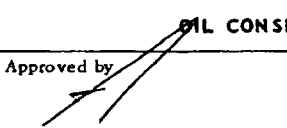
OIL CONSERVATION COMMISSION		By 
Approved by 		<b>H.A. Riggs</b>
Title		<b>Production Engineer</b>
Date <b>SEP 2 1964</b>		Company <b>Sunray Oil Company</b>
		Address <b>Hobbs, New Mexico P.O. Box 128</b>



NUMBER OF COPIES RECEIVED	
DISTRIBUTION	
SANTA FE	
FILE	
U.S.S.S.	
LAND OFFICE	
TRANSPORTER	OIL GAS
PRODUCTION OFFICE	
OPERATOR	

# NEW MEXICO OIL CONSERVATION COMMISSION

(Form C-104)  
Revised 7/1/57

Santa Fe, New Mexico

## REQUEST FOR (OIL) - ~~(GAS)~~ ALLOWABLE

This form shall be submitted by the operator before an initial allowable will be assigned to any completed Oil or Gas well. Form C-104 is to be submitted in QUADRUPLICATE to the same District Office to which Form C-101 was sent. The allowable will be assigned effective 7:00 A.M. on date of completion or recompletion, provided this form is filed during calendar month of completion or recompletion. The completion date shall be that date in the case of an oil well when new oil is delivered into the stock tanks. Gas must be reported on 15.025 psia at 60° Fahrenheit.

Hobbs, New Mexico

(Place)

6-4-64

(Date)

WE ARE HEREBY REQUESTING AN ALLOWABLE FOR A WELL KNOWN AS:

Sunray Oil Company  
(Company or Operator)

N.M. State "K"  
(Lease)

Well No. 1, in SW 1/4 SE 1/4,

Unit Letter

Sec. 11

T. 10S

R. 32E

NMPM,

Mescalero San Andres

Pool

Lea

County. Date Spudded -

Date Drilling Completed

Please indicate location:

R32E

Elevation 4269

Total Depth 10,775

PBTD 4200

Top Oil/Gas Pay 4042

Name of Prod. Form. San Andres

PRODUCING INTERVAL -

4042-45, 4060-62, 4067-69, 4080-82, 4092-94,

Perforations 4101-03, 4116-20 w/2 bullets /ft.

Open Hole -

Depth

Casing Shoe 10,270

Depth

Tubing 3975

10 OIL WELL TEST -

Natural Prod. Test: bbls. oil, bbls water in hrs, min. Size

Test After Acid or Fracture Treatment (after recovery of volume of oil equal to volume of load oil used): 9 bbls. oil, 22 bbls water in 24 hrs, min. Size

GAS WELL TEST -

Natural Prod. Test: MCF/Day; Hours flowed Choke Size

Method of Testing (pitot, back pressure, etc.):

Test After Acid or Fracture Treatment: MCF/Day; Hours flowed

Choke Size Method of Testing:

Acid or Fracture Treatment (Give amounts of materials used, such as acid, water, oil, and sand): Acidize w/2500 gal BDA & 1000 gal XM38 Frac w/20,000 gal

Casing Press. Tubing Press. Date first new oil run to tanks ref oil & 20,000# sand. 5-31-64

Oil Transporter McWood Corp.

Gas Transporter

Remarks:

GOR 1771/1

Oil Gravity - 19 deg API

I hereby certify that the information given above is true and complete to the best of my knowledge.

Approved: 11/1/64, 19

Sunray Oil Company

(Company or Operator)

OIL CONSERVATION COMMISSION

By:

H.A. Riggs

H.A. Riggs

(Signature)

By:

Title:

Production Engineer

Send Communications regarding well to:

Name:

C.T. McClanahan

Box 128, Hobbs, New Mexico

Title

NUMBER OF COPIES RECEIVED	
DISTRIBUTION	
SANTA FE	
FILE	
U.S.C.S.	
LAND OFFICE	
TRANSPORTER	OIL
	GAS
PRODUCTION OFFICE	
OPERATOR	

NEW MEXICO OIL CONSERVATION COMMISSION SANTA FE, NEW MEXICO <b>CERTIFICATE OF COMPLIANCE AND AUTHORIZATION          TO TRANSPORT OIL AND NATURAL GAS</b>	<b>FORM C-110</b> (Rev. 7-60)
FILE THE ORIGINAL AND 4 COPIES WITH THE APPROPRIATE OFFICE	

Company or Operator <b>Sunray DX Oil Company</b>				Lease <b>N.M. State "K"</b>		Well No. <b>1</b>	
Unit Letter <b>0</b>	Section <b>11</b>	Township <b>10</b>	Range <b>32E</b>	County <b>Lea</b>			
Pool <b>Mescalero San Andres</b>				Kind of Lease (State, Fed, Fee) <b>State</b>			
If well produces oil or condensate give location of tanks		Unit Letter <b>0</b>	Section <b>11</b>	Township <b>10</b>	Range <b>32E</b>		
Authorized transporter of oil <input checked="" type="checkbox"/> or condensate <input type="checkbox"/>  <b>McWood Corp.</b>				Address (give address to which approved copy of this form is to be sent)  <b>364 Petroleum Bldg. Abilene, Texas</b>			
Is Gas Actually Connected? Yes <input type="checkbox"/> No <input checked="" type="checkbox"/>							
Authorized transporter of casing head gas <input type="checkbox"/> or dry gas <input type="checkbox"/>		Date Connected <b>7/1</b>	Address (give address to which approved copy of this form is to be sent)				

If gas is not being sold, give reasons and also explain its present disposition:

**REASON(S) FOR FILING (please check proper box)**

New Well ..... ☐      Change in Ownership ..... ☐  
 Change in Transporter (check one)      Other (explain below)  
     Oil ..... ☐ Dry Gas ..... ☐  
     Casing head gas . ☐ Condensate . ☐

**Plugged back from Wolfcamp and recompleted in San Andres.**

Remarks

The undersigned certifies that the Rules and Regulations of the Oil Conservation Commission have been complied with.

Executed this the 4th day of June, 19 64

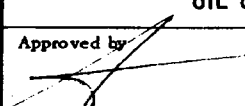
OIL CONSERVATION COMMISSION		By
Approved by 		<b>H.A. Riggs</b>
Title		<b>Production Engineer</b>
Date		<b>Sunray DX Oil Company</b>
		<b>P.O. Box 128, Hobbs, New Mexico</b>

NUMBER OF COPIES RECEIVED	
DISTRIBUTION	
SANTA FE	
FILE	
U.S.G.S.	
LAND OFFICE	
TRANSPORTER	OIL
	GAS
PRODUCTION OFFICE	
OPERATOR	

# NEW MEXICO OIL CONSERVATION COMMISSION

FORM C-103  
(Rev 3-55)

## MISCELLANEOUS REPORTS ON WELLS

(Submit to appropriate District Office as per Commission Rules)

HOBBS OFFICE O. C. C.  
JUN 5 1964 11:10 AM '64

Name of Company <b>Sunray DX Oil Company</b>				Address <b>Box 128, Hobbs, New Mexico</b>			
Lease <b>N.M. State "X"</b>	Well No. <b>1</b>	Unit Letter <b>0</b>	Section <b>11</b>	Township <b>10S</b>	Range <b>32E</b>		
Date Work Performed <b>3-22-64</b>		Pool <b>Mescalero San Andres</b>			County <b>Lea</b>		
THIS IS A REPORT OF: (Check appropriate block)							
<input type="checkbox"/> Beginning Drilling Operations		<input type="checkbox"/> Casing Test and Cement Job		<input checked="" type="checkbox"/> Other (Explain): <b>Plug-back</b>			
<input type="checkbox"/> Plugging		<input type="checkbox"/> Remedial Work		<b>Wolfcamp &amp; recomplete in San Andres</b>			

Detailed account of work done, nature and quantity of materials used, and results obtained.

1. Spot 35 sx cmt plug 8740-8430 (Wolfcamp), test plug to 2000# OK.
2. Perf 4397-98 & cmt w/275 sx. Drill cmt 3290-4200. Perf 4137-38 & Block Squeeze w/100 sx cmt. Perf 4039-40 for Upper Block Squeeze & squeeze w/100 sx cmt. Drill cmt & test to 2000#, OK.
3. Perf 4042045, 4060-62, 4067-69, 4080-82, 4092-94, 4101-03, 4116-20 w/2 bullets /ft. Acidize w/2,500 gal BDA. Frac w/20,000 gal ref oil & 20,000# sand using 1,000 gal KM38 ahead. of frac.
4. Run pump & rods & put well on production. Potential for allowable.

Witnessed by <b>Taney Burger</b>	Position <b>Drlg. Foreman</b>	Company <b>Sunray DX Oil Company</b>
-------------------------------------	----------------------------------	---

### FILL IN BELOW FOR REMEDIAL WORK REPORTS ONLY



#### ORIGINAL WELL DATA

OF Elev. <b>4269</b>	TD <b>10,775</b>	PBTD <b>4,200</b>	Producing Interval <b>4042 - 4120</b>	Completion Date <b>8-12-63</b>
Tubing Diameter <b>2 3/8</b>	Tubing Depth	Oil String Diameter <b>5 1/2</b>	Oil String Depth <b>10,270'</b>	

Perforated Interval(s) <b>4042-45, 4060-62, 4067-69, 4080-82, 4092-94, 4101-03, 4116-20</b>	Producing Formation(s) <b>San Andres</b>
Open Hole Interval <b>-</b>	

#### RESULTS OF WORKOVER

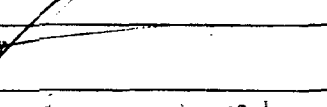
Test	Date of Test	Oil Production BPD	Gas Production MCFPD	Water Production BPD	GOR Cubic feet/Bbl	Gas Well Potential MCFPD
Before Workover	<b>0</b>	<b>0</b>	<b>0</b>	<b>0</b>	<b>0</b>	<b>0</b>
After Workover	<b>6-3-64</b>	<b>9</b>	<b>16</b>	<b>22</b>	<b>1777</b>	<b>-</b>

OIL CONSERVATION COMMISSION		I hereby certify that the information given above is true and complete to the best of my knowledge.	
Approved by 	Name <b>H.A. Riggs</b>	by 	
Title <b>Production Engineer</b>	Position		
Date <b>6-3-64</b>	Company <b>Sunray DX Oil Company</b>		

NEW MEXICO OIL CONSERVATION COMMISSION

Well Location and Acreage Dedication Plat **HOBBS OFFICE O.C.C.**

Section A.

Date Jun 5 10 14 AM '64

Operator Sunray Oil Company Lease N.M. State "K"  
Well No. 1 Unit Letter 0 Section 11 Township 10S Range 32E NMPM  
Located 660 Feet From South Line, 1980 Feet From East Line  
County Lea G. L. Elevation \_\_\_\_\_ Dedicated Acreage \_\_\_\_\_ Acres  
Name of Producing Formation San Andres Pool Mescalero San Andres

1. Is the Operator the only owner\* in the dedicated acreage outlined on the plat below?  
Yes X No \_\_\_\_\_.
2. If the answer to question one is "no," have the interests of all the owners been consolidated by communitization agreement or otherwise? Yes \_\_\_\_\_ No \_\_\_\_\_. If answer is "yes," Type of Consolidation \_\_\_\_\_
3. If the answer to question two is "no," list all the owners and their respective interests below:

Owner

Land Description

Section B

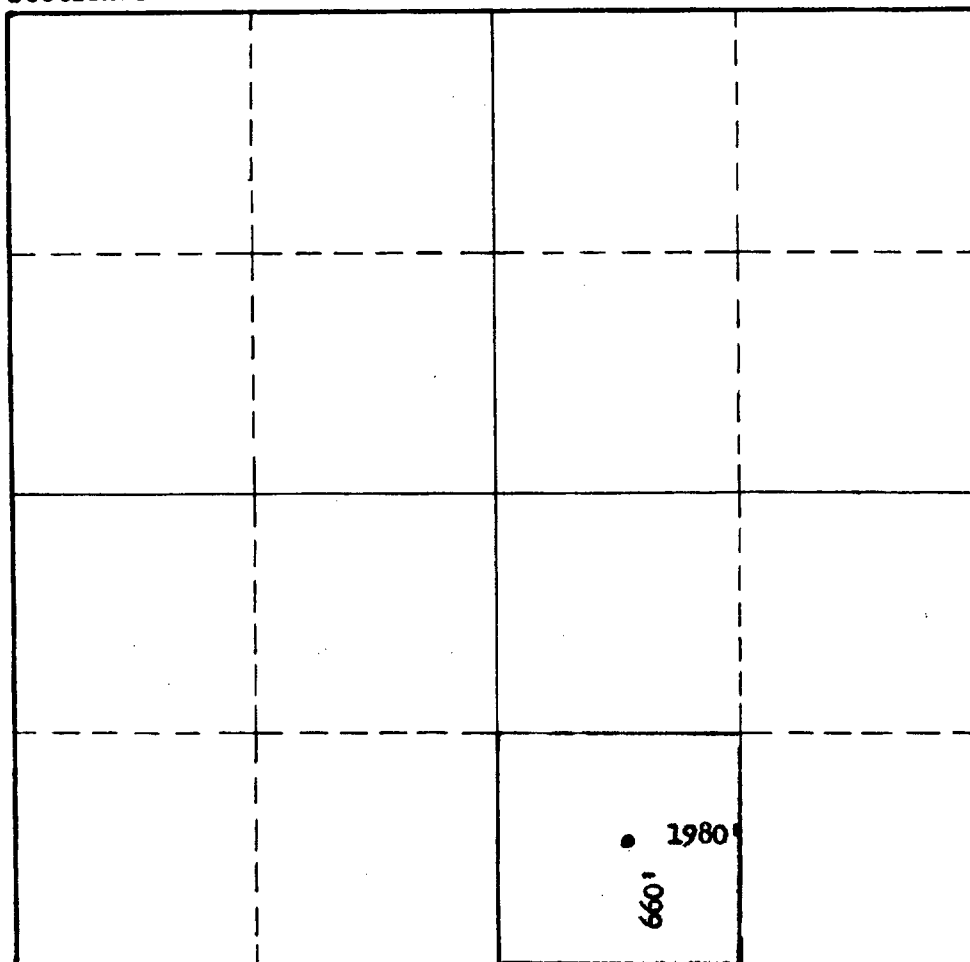

This is to certify that the information in Section A above is true and complete to the best of my knowledge and belief.

Sunray Oil Company  
(Operator)

H.A. Riggs H.A. Riggs  
(Representative) by JWA

P.O. Box 128 Hobbs, New Mex.  
Address

This is to certify that the well location shown on the plat in Section B was plotted from field notes of actual surveys made by me or under my supervision and that the same is true and correct to the best of my knowledge and belief.

Date Surveyed 2-29-56

John W. West  
Registered Professional  
Engineer and/or Land Surveyor.

0 330 660 990 1320 1650 1980 2310 2640 2000 1500 1000 500 0

(See instructions for completing this form on the reverse side) Certificate No. 676

NUMBER OF COPIES RECEIVED	
DISTRIBUTION	
SANTA FE	
FILE	
U.S.G.S.	
LAND OFFICE	
TRANSPORTER	OIL GAS
PRODUCTION OFFICE	
OPERATOR	

(Form C-102)  
(Revised 7/1/53)

# NEW MEXICO OIL CONSERVATION COMMISSION

Santa Fe, New Mexico

HOBBS OFFICE C. C. C.

## MISCELLANEOUS NOTICES

strict Office, Oil Conservation Commission, before the work specified is to begin. A copy will be returned to the Bureau on which will be given the approval, with any modifications considered advisable, or the rejection by the Commission or agent, of the plan submitted. The plan as approved should be followed, and work should not begin until approval is obtained. See additional instructions in the Rules and Regulations of the Commission.

Indicate Nature of Notice by Checking Below

NOTICE OF INTENTION TO CHANGE PLANS		NOTICE OF INTENTION TO TEMPORARILY ABANDON WELL		NOTICE OF INTENTION TO DRILL DEEPER	
NOTICE OF INTENTION TO PLUG WELL		NOTICE OF INTENTION TO PLUG BACK	X	NOTICE OF INTENTION TO SET LINER	
NOTICE OF INTENTION TO SQUEEZE		NOTICE OF INTENTION TO ACIDIZE		NOTICE OF INTENTION TO SHOOT (Nitro)	
NOTICE OF INTENTION TO GUN PERFORATE		NOTICE OF INTENTION (OTHER)		NOTICE OF INTENTION (OTHER)	

OIL CONSERVATION COMMISSION  
SANTA FE, NEW MEXICO

Hobbs, New Mexico  
(Place)

March 16, 1964  
(Date)

Gentlemen:

Following is a Notice of Intention to do certain work as described below at the

Sunray DX Oil Company

N.M. State "K"

Well No. 1

in 0

(Unit)

SW

1/4 SE

1/4 of Sec. 11

T. 10S

R. 32E

NMPM,

North Mescalero San Andres

Pool

Lease

SW

1/4 SE

1/4 of Sec. 11

T. 10S

R. 32E

(40-acre Subdivision)

Lea

County.

## FULL DETAILS OF PROPOSED PLAN OF WORK (FOLLOW INSTRUCTIONS IN THE RULES AND REGULATIONS)

Propose to recomplete in the San Andres as follows:

1. Spot cement plug 8748 to 8430'
2. Block Squeeze 4137-38 w/175 sx cement and 4039-40 w/50 sx cement.
3. Drill cement to 4060 and test squeeze job to 2000#, Drill to 4160 and test squeeze job to 2000#.
4. Perf 4116-4045, Acidize w/2500 gal BDA, If necessary frac w/20,000 gal ref oil & 20,000# sand.
5. If well will not flow, run pump and rods and put well on production.

Approved \_\_\_\_\_, 19\_\_\_\_  
Except as follows:

Approved  
OIL CONSERVATION COMMISSION

By \_\_\_\_\_

Title \_\_\_\_\_

Sunray DX Oil Company

Company or Operator

By

V.R. Mayabb

V.R. Mayabb

Position

DISTRICT ENGINEER

Send Communications regarding well to:

Name

C. T. McClanahan

Address

Box 128, Hobbs, New Mexico



NUMBER OF COPIES RECEIVED	
DISTRIBUTION	
SANTA FE	
FILE	
U.S.G.S.	
LAND OFFICE	
TRANSPORTER	OIL GAS
PRODUCTION OFFICE	
OPERATOR	

# NEW MEXICO OIL CONSERVATION COMMISSION

FORM C-103

(Rev 3-55)

## MISCELLANEOUS REPORTS ON WELLS

HOBBS OFFICE O. C. C.

(Submit to appropriate District Office as per Commission Order No. 12710 AM '63)

DEC 6 10 27 AM '63

Name of Company **Sunray DX Oil Company** Address **Box 128**

Lease **New Mex. State "K"** Well No. **1** Unit Letter **0** Section **11** Township **10S** Range **32E**

Date Work Performed **11-5-63** Pool **North Mescalero Wolfcamp** County **Lea**

THIS IS A REPORT OF: (Check appropriate block)

- ☐ Beginning Drilling Operations
 ☐ Casing Test and Cement Job
 ☐ Other (Explain): **TA Report**  
☐ Plugging
 ☐ Remedial Work

Detailed account of work done, nature and quantity of materials used, and results obtained.

**Pulled rods and pump. Moved off pumping unit.**  
**Above well is temporary abandoned effective 11-5-63.**  
**Will be TA pending study to re-complete in shallower pay.**

Witnessed by **O. T. Owen** Position **Field Foreman** Company **Sunray DX Oil Company**

### FILL IN BELOW FOR REMEDIAL WORK REPORTS ONLY

#### ORIGINAL WELL DATA

D F Elev. T D P BTD Producing Interval Completion Date

Tubing Diameter Tubing Depth Oil String Diameter Oil String Depth

Perforated Interval(s)

Open Hole Interval Producing Formation(s)

#### RESULTS OF WORKOVER

Test	Date of Test	Oil Production BPD	Gas Production MCFPD	Water Production BPD	GOR Cubic feet/Bbl	Gas Well Potential MCFPD
Before Workover	10-18-63	1.5	-	15	-	-
After Workover	TA					

OIL CONSERVATION COMMISSION

I hereby certify that the information given above is true and complete to the best of my knowledge.

Approved by  Name **V. R. Mayabb**

Title Position **District Engineer**

Date Company **Sunray DX Oil Company**

NUMBER OF COPIES RECEIVED	
DISTRIBUTION	
SANTA FE	
FILE	
U.S.G.S.	
LAND OFFICE	
TRANSPORTER	OIL
	GAS
PRODUCTION OFFICE	
OPERATOR	

**NEW MEXICO OIL CONSERVATION COMMISSION**  
**SANTA FE, NEW MEXICO**  
**CERTIFICATE OF COMPLIANCE AND AUTHORIZATION**  
**TO TRANSPORT OIL AND NATURAL GAS**

**FORM C-110**  
 (Rev. 7-60)

FILE THE ORIGINAL AND 4 COPIES WITH THE APPROPRIATE OFFICE

Company or Operator <b>Sunray DX Oil Company</b>				Lease <b>N. M. State "K"</b>		Well No. <b>1</b>
Unit Letter <b>0</b>	Section <b>11</b>	Township <b>10</b>	Range <b>32E</b>	County <b>Lea</b>		
Pool <b>NORTH MESCALERO WOLFCAMP</b>				Kind of Lease (State, Fed, Fee) <b>State</b>		
If well produces oil or condensate give location of tanks			Unit Letter <b>0</b>	Section <b>11</b>	Township <b>10</b>	Range <b>32E</b>
Authorized transporter of oil <input checked="" type="checkbox"/> or condensate <input type="checkbox"/> <b>McWood Corp</b>				Address (give address to which approved copy of this form is to be sent) <b>364 Petroleum Bldg. Abilene, Tex.</b>		

Is Gas Actually Connected? Yes ☒ No ☐

Authorized transporter of casing head gas <input checked="" type="checkbox"/> or dry gas <input type="checkbox"/> <b>El Paso Natural Gas Company</b>		Date Connected <b>Already Connected</b>	Address (give address to which approved copy of this form is to be sent) <b>Box 1384 Jal, New Mexico</b>
---	--	--	---

If gas is not being sold, give reasons and also explain its present disposition:

**REASON(S) FOR FILING (please check proper box)**

New Well ..... ☐ Change in Ownership ..... ☐  
 Change in Transporter (check one) Other (explain below) **Change in Pool Designation.**  
 Oil ..... ☐ Dry Gas ..... ☐  
 Casing head gas . ☐ Condensate.. ☐

Remarks

The undersigned certifies that the Rules and Regulations of the Oil Conservation Commission have been complied with.

Executed this the 18th day of November, 19 63.

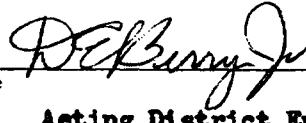
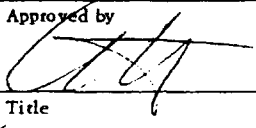
OIL CONSERVATION COMMISSION		By  <b>D. E. Berry, Jr.</b>
Approved by 		Title <b>Acting District Engineer</b>
Title		Company <b>SUNRAY DX OIL COMPANY</b>
Date		Address <b>Box 128, Hobbs, New Mexico</b>



NUMBER OF COPIES RECEIVED	
DISTRIBUTION	
SANTA FE	
FILE	
U.S.G.S.	
LAND OFFICE	
TRANSPORTER	OIL
	GAS
PRODUCTION OFFICE	
OPERATOR	

# NEW MEXICO OIL CONSERVATION COMMISSION

(Form C-104)  
Revised 7/1/57

Santa Fe, New Mexico

## REQUEST FOR (OIL) - (GAS) ALLOWABLE

New Well  
Recompletion

This form shall be submitted by the operator before an initial allowable will be assigned to any completed Oil or Gas well. Form C-104 is to be submitted in QUADRUPPLICATE to the same District Office to which Form C-101 was sent. The allowable will be assigned effective 7:00 A.M. on date of completion or recompletion, provided this form is filed during calendar month of completion or recompletion. The completion date shall be that date in the case of an oil well when new oil is delivered into the stock tanks. Gas must be reported on 15.025 psia at 60° Fahrenheit.

Hobbs, New Mexico  
(Place)

8-13-63  
(Date)

WE ARE HEREBY REQUESTING AN ALLOWABLE FOR A WELL KNOWN AS:

Sunray DX

N.M. State "K"

Well No. 1, in SW 1/4, SE 1/4,

(Company or Operator)

(Lease)

0

Sec. 11

T. 108

R. 32E

NMPM, (Mescalero Wolfcamp North) Pool

U.S. Letter

Les

County. Date Spudded

Date Drilling Completed

Please indicate location:

Elevation 4269 DF Total Depth 10,775 PBTD 8846

Top Oil/Gas Pay 8622 Name of Prod. Form. Wolfcamp

PRODUCING INTERVAL

8685-87, 8696-98, 8727-24, 8736-38, 8759-61, 8777-79,

Perforations 8804-06, 8816-18, 8820-30, 8610-22, 8516-30,

Open Hole Depth Casing Shoe 10,270 Tubing 8621

OIL WELL TEST -

Natural Prod. Test: bbls. oil, bbls. water in hrs, min. Size

Test After Acid or Fracture Treatment (after recovery of volume of oil equal to volume of load oil used): bbls. oil, bbls. water in hrs, min. Size

GAS WELL TEST -

Natural Prod. Test: MCF/Day; Hours flowed Choke Size

Method of Testing (pitot, back pressure, etc.):

Test After Acid or Fracture Treatment: MCF/Day; Hours flowed

Choke Size Method of Testing:

Acid or Fracture Treatment (Give amounts of materials used, such as acid, water, oil, and sand): 3500 gal HCl in 4 stages using 96-801.

Casing Press. Tubing Press. Date first new oil run to tanks 8/1/63

Oil Transporter McLeod Corp.

Gas Transporter El Paso Natural Gas Company

Remarks:

I hereby certify that the information given above is true and complete to the best of my knowledge.

Approved, 19

Sunray DX Oil Company

(Company or Operator)

By: V. E. Mayabb

(Signature)

V. E. Mayabb

Title District Engineer

Send Communications regarding well to:

Name C. T. McClanahan

1963 Hobbs, New Mexico

OIL CONSERVATION COMMISSION

By:

Title

NUMBER OF COPIES RECEIVED	
DISTRIBUTION	
SANTA FE	
FILE	
U.S.C.S.	
LAND OFFICE	
TRANSPORTER	OIL
	GAS
PRODUCTION OFFICE	
OPERATOR	

NEW MEXICO OIL CONSERVATION COMMISSION  
SANTA FE, NEW MEXICO  
**CERTIFICATE OF COMPLIANCE AND AUTHORIZATION  
TO TRANSPORT OIL AND NATURAL GAS**

**FORM C-110**  
(Rev. 7-60)

FILE THE ORIGINAL AND 4 COPIES WITH THE APPROPRIATE OFFICE

Company or Operator <b>Sunray Oil Company</b>				Lease No. <b>15313 15 3 45</b>		Well No. <b>1</b>	
Unit Letter <b>0</b>	Section <b>11</b>	Township <b>10S</b>	Range <b>32E</b>		County <b>Lea</b>		
Pool <b>Mescalero Wolfcamp, North</b>				Kind of Lease (State, Fed, Fee) <b>State</b>			
If well produces oil or condensate give location of tanks		Unit Letter <b>0</b>	Section <b>11</b>	Township <b>10S</b>	Range <b>32E</b>		
Authorized transporter of oil <input checked="" type="checkbox"/> or condensate <input type="checkbox"/> <b>McWood Corp - no change in transporter</b>				Address (give address to which approved copy of this form is to be sent) <b>306 V &amp; J Tower Bldg. Midland, Texas</b>			
Is Gas Actually Connected? Yes <input checked="" type="checkbox"/> No <input type="checkbox"/>							
Authorized transporter of casing head gas <input checked="" type="checkbox"/> or dry gas <input type="checkbox"/> <b>El Paso Natural Gas Co.</b>		Date Connected <b>8-1-63</b>		Address (give address to which approved copy of this form is to be sent) <b>Box 1192 El Paso, Texas</b>			

If gas is not being sold, give reasons and also explain its present disposition:

**REASON(S) FOR FILING (please check proper box)**

New Well ..... <input type="checkbox"/>	Change in Ownership ..... <input type="checkbox"/>
Change in Transporter (check one)	Other (explain below) <input checked="" type="checkbox"/>
Oil ..... <input type="checkbox"/> Dry Gas ..... <input type="checkbox"/>	<b>recomplete in Wolfcamp</b>
Casing head gas . <input type="checkbox"/> Condensate.. <input type="checkbox"/>	

Remarks

The undersigned certifies that the Rules and Regulations of the Oil Conservation Commission have been complied with.

Executed this the **16** day of **August**, 19**63**.

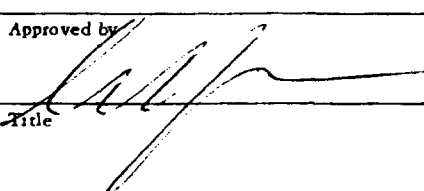
OIL CONSERVATION COMMISSION		By <b>J. R. Mayabb</b>
Approved by 	Title <b>J. R. Mayabb</b>	
Title	Company <b>District Engineer</b>	
Date	Address <b>Sunray Oil Company</b>	
<b>P.O. Box 128, Hobbs, New Mexico</b>		

NE. MEXICO OIL CONSERVATION COMMISSION  
Well Location and Acreage Dedication Plat

Date 8-16-63

Section A.

Operator Sunray Oil Company Lease N.M. State "K" 108 108 15 PM 3145  
Well No. 1 Unit Letter 0 Section 11 Township 108 Range 32E NMPM  
Located 660 Feet From South Line, 1980 Feet From East Line  
County Lea G. L. Elevation 4257 Dedicated Acreage 10 Acres  
Name of Producing Formation Wolfcamp Pool Nasaslers Wolfcamp, North

1. Is the Operator the only owner\* in the dedicated acreage outlined on the plat below?  
Yes X No       .
2. If the answer to question one is "no," have the interests of all the owners been consolidated by communitization agreement or otherwise? Yes        No       . If answer is "yes," Type of Consolidation
3. If the answer to question two is "no," list all the owners and their respective interests below:

Owner

Land Description

Section B

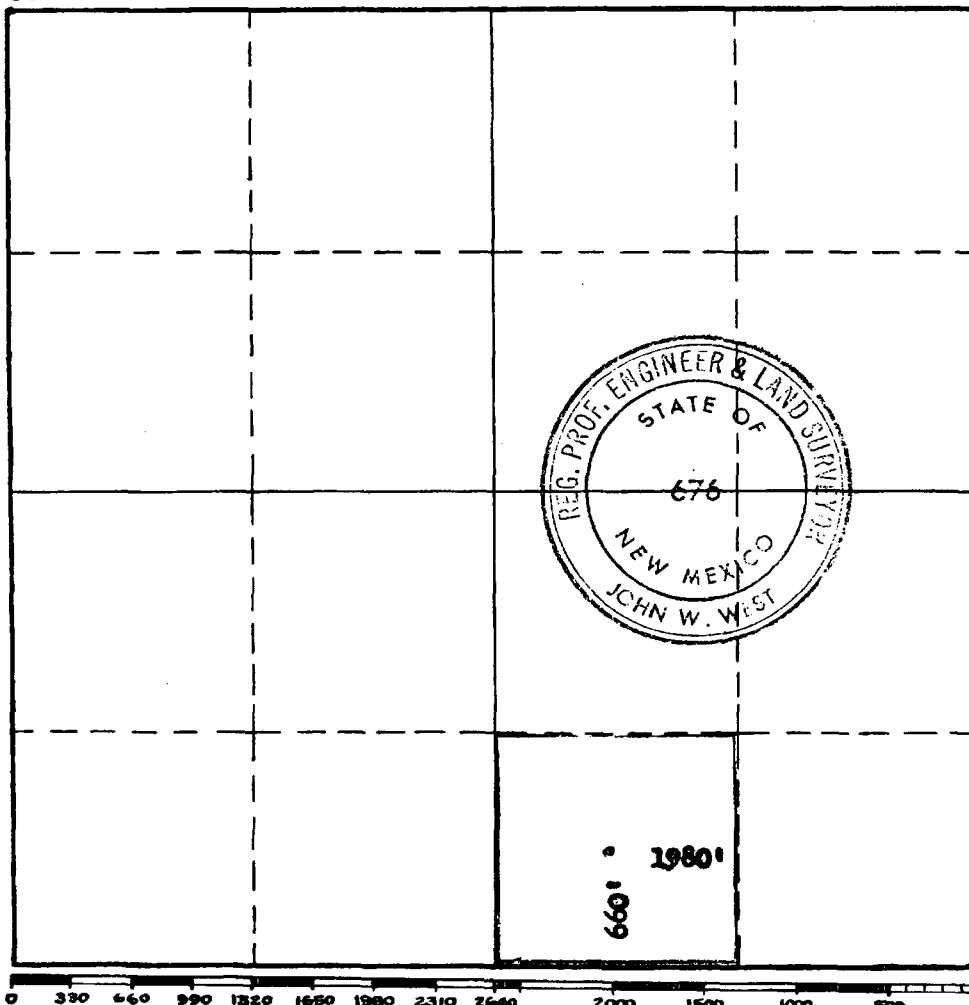

This is to certify that the information in Section A above is true and complete to the best of my knowledge and belief.

Sunray Oil Company

(Operator)

V.R. Mayatt V.R. Mayatt  
(Representative)

P.O. Box 128, Hobbs, N.M.  
Address

This is to certify that the well location shown on the plat in Section B was plotted from field notes of actual surveys made by me or under my supervision and that the same is true and correct to the best of my knowledge and belief.

Date Surveyed 8-22-56

John W. West

Registered Professional Engineer and/or Land Surveyor.

John W. West 676  
Certificate No.

(See instructions for completing this form on the reverse side)

NUMBER OF COPIES RECEIVED	
DISTRIBUTION	
SANTA FE	
FILE	
U.S.G.S.	
LAND OFFICE	
TRANSPORTER	OIL GAS
PRORATION OFFICE	
OPERATOR	

# NEW MEXICO OIL CONSERVATION COMMISSION

FORM C-103  
(Rev 3-55)

## MISCELLANEOUS REPORTS ON WELLS

(Submit to appropriate District Office as per Commission Rule 1106)

Name of Company <b>Sumray DX Oil Company</b>		Address <b>1000 AUG 1- AM 9 53</b>	
Lease <b>N.M. State "K"</b>	Well No. <b>1</b>	Unit Letter <b>0</b>	Section <b>11</b>
Date Work Performed <b>6-10-63</b>	Pool <b>Mescalero Wolfcamp North</b>	County <b>Lee</b>	Township <b>32N</b>

THIS IS A REPORT OF: (Check appropriate block)

<input type="checkbox"/> Beginning Drilling Operations	<input type="checkbox"/> Casing Test and Cement Job	<input checked="" type="checkbox"/> Other (Explain): <b>Recomplete in Wolfcamp</b>
<input type="checkbox"/> Plugging	<input type="checkbox"/> Remedial Work	

Detailed account of work done, nature and quantity of materials used, and results obtained.

1. Pull tbg, drop trip 'bob' on Model "D" packer at 10,174, dump 2 sz cnt on top packer.
2. Perf at 8848 and squeeze with 50 sz cnt., perf at 8696 and squeeze with 50 sz. Perf at 8300 and squeeze with 50 sz. Drill out cnt from 8300-8848 and test to 2000#, O.K.
3. Perf 8685-87, 8696-98, 8722-24, 8736-38, 8759-61, 8777-79, 8804-06, 8816-18, 8820-30.
4. Acidize with 1000 gal BDA with 36 RB's. Acidize 8685-8738 with 1500 gal KM38.
5. Perf 8640-8622, 8546-30, Acidize perfs 8622-40 with 500 gal BDA and perfs 8530-46 with 500 gal BDA.
6. Install Pumping Unit. Potintial Test 8-12-63, Pump 3 BW and 55 BW, 24 hrs,

Witnessed by <b>Taney Dargen</b>	Position <b>District Foreman</b>	Company <b>Sumray DX Oil Company</b>
-------------------------------------	-------------------------------------	---

FILL IN BELOW FOR REMEDIAL WORK REPORTS ONLY

### ORIGINAL WELL DATA

D F Elev. <b>1269</b>	T D <b>10,775</b>	P B T D <b>8846</b>	Producing Interval <b>8635-85, 8622-40</b>	Completion Date <b>8-12-63</b>
Tubing Diameter <b>2 3/8</b>	Tubing Depth <b>8621</b>	Oil String Diameter <b>5 1/2</b>	Oil String Depth <b>9923'</b>	
Perforated Interval(s) <b>8640-22, 8546-30, 8685-87, 8696-98, 8722-24, 8736-38, 8759-61, 8777-79, 8804-06, 8816-18, 8820-30</b>				
Open Hole Interval		Producing Formation(s) <b>Wolfcamp</b>		

### RESULTS OF WORKOVER

Test	Date of Test	Oil Production BPD	Gas Production MCFPD	Water Production BPD	GOR Cubic feet/Bbl	Gas Well Potential MCFPD
Before Workover						
After Workover	<b>8-12-63</b>	<b>3</b>		<b>55</b>		

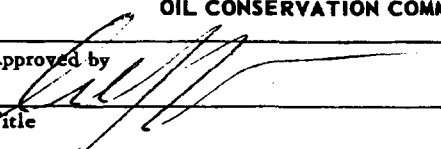
OIL CONSERVATION COMMISSION		I hereby certify that the information given above is true and complete to the best of my knowledge.	
Approved by 	Name <b>V. R. Mayabb</b>		
Title	Position <b>District Engineer</b>		
Date	Company <b>Sumray DX Oil Company</b>		

NUMBER OF COPIES RECEIVED	
DISTRIBUTION	
SANTA FE	
FILE	
U.S.G.S.	
LAND OFFICE	
TRANSPORTER	OIL
	GAS
PRODUCTION OFFICE	
OPERATOR	

# NEW MEXICO OIL CONSERVATION COMMISSION

Santa Fe, New Mexico

FE-4

## MISCELLANEOUS NOTICES

strict Office, Oil Conservation Commission, before the work specified is to begin. A copy will be furnished to the Bureau on which will be given the approval, with any modifications considered advisable, or the rejection by the Commission or agent, of the plan submitted. The plan as approved should be followed, and work should not begin until approval is obtained. See additional instructions in the Rules and Regulations of the Commission.

Indicate Nature of Notice by Checking Below

NOTICE OF INTENTION TO CHANGE PLANS		NOTICE OF INTENTION TO TEMPORARILY ABANDON WELL		NOTICE OF INTENTION TO DRILL DEEPER	
NOTICE OF INTENTION TO PLUG WELL		NOTICE OF INTENTION TO PLUG BACK	X	NOTICE OF INTENTION TO SET LINER	
NOTICE OF INTENTION TO SQUEEZE	X	NOTICE OF INTENTION TO ACIDIZE	X	NOTICE OF INTENTION TO SHOOT (Nitro)	
NOTICE OF INTENTION TO GUN PERFORATE	X	NOTICE OF INTENTION (OTHER)		NOTICE OF INTENTION (OTHER)	

OIL CONSERVATION COMMISSION  
SANTA FE, NEW MEXICO

Hobbs, N. M.

June 7, 1963

(Place)

(Date)

Gentlemen:

Following is a Notice of Intention to do certain work as described below at the

Sunray Oil Company N. M. State "K"

Well No. 1 in 9 (Unit)

SW 1/4 SE 1/4 of Sec. 11, T. 10S, R. 32E, NMPM, North Mesalero Pool

County.

## Recomplete from Atoka to Wile. FULL DETAILS OF PROPOSED PLAN OF WORK

1. MI derrick unit. Kill w/wr. Install BOP. Pull tbg. Drop trip bob on Mod D. Spot 2 sk cnt on top trip bob w/WL dump bailer. Run LW GR-N log 8900' - 8200' and 4500' - 3900', regular and detail scales.
2. Perf 4 holes @ 8848 (Sohl GR meas.) Run tbg w/FB and test cnt plug on Mod D to 2000'. Pull back FB and sq cnt w/50 sk Incon Pos batches as req (Howeo). Run tbg gun and perf 4 holes @ 8696 and sq cnt as before. Ditto squeeze on 4 holes @ 8300. Drill out squeeze plugs and test to 2000'. Perf 2' sections, 2 holes/ft in interval 8700-8840' as selected from GR-N log. Keep number of sections perf'd to a minimum and sections as far apart as practical to allow individual testing/plugging if needed. Run tbg w/FB and acidize w/1000 gal Dowell BDA. Drop balls (equal in No. as perfs) continuously thru treatment. Swab and test as necessary for evaluation of interval. May need to run retrievable BP and/or do additional treating. For additional treating, anticipate IM38 and then acid petrefrac w/volumes dependent on previous vals and test perf'd. If interval proves non-commercial, sq cnt w/100 sk batches Incon Pos as required.
3. If previous completion interval is capable of strong flow at top allowable (108 MCFD w/36 unit

continued on reverse side...

Approved \_\_\_\_\_, 19\_\_\_\_  
Except as follows:

Sunray Oil Company  
Company of Operator  
By: J.R. Mayabb V.R. Mayabb  
Position: District Engineer  
Send Communications regarding well to:

Approved \_\_\_\_\_  
OIL CONSERVATION COMMISSION

By: \_\_\_\_\_  
Title: \_\_\_\_\_

Name: G. T. McGlennahan  
Address: SDX P. O. Box 128, Hobbs, N. M.

continued from reverse side...

pull test packer and run back w/Baker Mod B and set approx 50' above top perf. If previous completion interval has recoverable oil but does not appear to be long life top allowable, set retr SP above top perf and cap w/20' sand. Perf two-foot sections in interval 8300-8700 w/selection, number, and spacing similar to Step No. 2. Treatment and evaluation of sections will also be similar to Step No. 2. If one interval will flow and other won't, may separate flowing interval and produce separate until more equal to other interval.

- h. Final completion equipment will depend on fluids obtained. If pumping required, run 2-3/8" tbg, 7/8 and 3/4 rods, and 1 1/2" pump for volumes of less than about 200 BPD.

**OIL CONSERVATION COMMISSION**

**HOBBS, NEW MEXICO**

Sept. 1, 1959

Sunray Mid-Continent Oil Co.  
P. O. Box 128  
Hobbs, New Mexico

Gentlemen:

Forms C-104 and C-110 have been approved for your New Mexico State "K" No. 1 in Unit O of Section 11, T-10-C, R-32-E and a 160 acre unit is being assigned for the well in the North Mescalero Pennsylvanian Gas Pool effective August 25, 1959.

Yours very truly,

OIL CONSERVATION COMMISSION

R. F. Montgomery  
Proration Manager

mc  
cc-Elvis Utz, Gas Engineer  
OCC, Santa Fe

El Paso Natural Gas Co.  
Jal, New Mexico

C  
O  
P  
Y

## NEW MEXICO OIL CONSERVATION COMMISSION

Santa Fe, New Mexico

1959 OCT 10 AM 2:55

## WELL RECORD

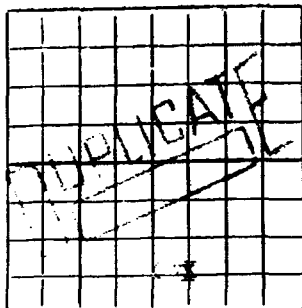
AREA 640 ACRES  
LOCATE WELL CORRECTLY

Mail to District Office, Oil Conservation Commission, to which Form C-101 was sent not later than twenty days after completion of well. Follow instructions in Rules and Regulations of the Commission. Submit in QUINTUPLICATE.

Sunray Mid-Continent Oil Company

N.M. State "K"

(Company or Operator)

(Lease)

Well No. 1, in SW  $\frac{1}{4}$  of SE  $\frac{1}{4}$  of Sec. 11, T. 10-S, R. 32-E, NMPM.

Undesignated

Pool,

Lea

County.

Well is 660 feet from South line and 1980 feet from East lineof Section 11. If State Land the Oil and Gas Lease No. is E-9713Drilling Commenced 3-11, 1956. Drilling was Completed 5-26, 1956Name of Drilling Contractor McVay & Stafford Drilling CompanyAddress 1110 Philtower Building - Tulsa 3, OklahomaElevation above sea level at Top of Tubing Head 4265. The information given is to be kept confidential untilcan be released, 19    

## OIL SANDS OR ZONES

No. 1, from 10,184 to 10,195 No. 4, from      to     No. 2, from      to      No. 5, from      to     No. 3, from      to      No. 6, from      to     

## IMPORTANT WATER SANDS

Include data on rate of water inflow and elevation to which water rose in hole.

No. 1, from      to      feet.No. 2, from      to      feet.No. 3, from      to      feet.No. 4, from      to      feet.

## CASING RECORD

SIZE	WEIGHT PER FOOT	NEW OR USED	AMOUNT	KIND OF SHOE	CUT AND PULLED FROM	PERFORATIONS	PURPOSE
13 3/8	36	New	339	Tex. Patt			Surface
9 5/8	32 3/4 36	New	3488	Baker			Intermediate
5 1/2	17 & 20	New	10,270	Baker		10,184 to 10,195	Oil String

## MUDDING AND CEMENTING RECORD

SIZE OF HOLE	SIZE OF CASING	WHERE SET	NO. BAGS OF CEMENT	METHOD USED	MUD GRAVITY	AMOUNT OF MUD USED
17 1/4	13 3/8	339	365	Pmp & Plug		Cemented to Surface
12 1/2	9 5/8	3488	2800	" " "		" " "
7 7/8	5 1/2	10270	500	" " "		" " 7042

## RECORD OF PRODUCTION AND STIMULATION

(Record the Process used, No. of Qts. or Gals. used, interval treated or shot.)

No stimulation used.

Result of Production Stimulation

Depth Cleaned Out



# CORD OF DRILL-STEM AND SPECIAL TESTS

If drill-stem or other special tests or deviation surveys were made, submit report on separate sheet and attach hereto

## TOOLS USED

Rotary tools were used from 0 feet to 10,775 feet, and from \_\_\_\_\_ feet to \_\_\_\_\_ feet.  
Cable tools were used from \_\_\_\_\_ feet to \_\_\_\_\_ feet, and from \_\_\_\_\_ feet to \_\_\_\_\_ feet.

## PRODUCTION

Put to Producing 5-30-56, 19\_\_\_\_

OIL WELL: The production during the first 24 hours was \_\_\_\_\_ barrels of liquid of which \_\_\_\_\_% was oil; \_\_\_\_\_% was emulsion; \_\_\_\_\_% water; and \_\_\_\_\_% was sediment. A.P.I.

Gravity 50 at 60degrees

GAS WELL: The production during the first 24 hours was 4,000 M.C.F. plus 120 barrels of

liquid Hydrocarbon. Shut in Pressure 2285 lbs.

Length of Time Shut in 72 hours

PLEASE INDICATE BELOW FORMATION TOPS (IN CONFORMANCE WITH GEOGRAPHICAL SECTION OF STATE):

Southeastern New Mexico

Northwestern New Mexico

T. Anhy. <u>1550</u>	T. Devonian <u>10,758</u>	T. Ojo Alamo _____
T. Salt _____	T. Silurian _____	T. Kirtland-Fruitland _____
B. Salt _____	T. Montoya _____	T. Farmington _____
T. Yates <u>2160</u>	T. Simpson _____	T. Pictured Cliffs _____
T. 7 Rivers _____	T. McKee _____	T. Menefee _____
T. Queen <u>2840</u>	T. Ellenburger _____	T. Point Lookout _____
T. Grayburg _____	T. Gr. Wash _____	T. Mancos _____
T. San Andres <u>3370</u>	T. Granite _____	T. Dakota _____
T. Glorieta <u>4780</u>	T. _____	T. Morrison _____
T. Drinkard _____	T. _____	T. Penn. _____
T. Tubbs <u>6210</u>	T. _____	T. _____
T. Abo <u>7060</u>	T. _____	T. _____
T. <del>Permian</del> <u>8180</u>	T. _____	T. _____
T. Penn. <u>10,264</u>	T. _____	T. _____
T. Miss. <u>10,264</u>	T. _____	T. _____
Woodford <u>10,664</u>		

## FORMATION RECORD

From	To	Thickness in Feet	Formation	From	To	Thickness in Feet	Formation
0	348	348	Surf. Sand, Shale & Caliche				
348	1400	1052	Red Beds				
1400	1620	220	Anhydrite				
1620	3150	1530	Anhydrite & Salt				
3150	3460	310	Anhydrite				
3460	7060	3600	Lime				
7060	7550	490	Shale				
7550	7940	390	Lime & Shale				
7940	10060	2120	Lime				
10060	10180	120	Lime & Shale				
10180	10260	80	Lime & Sand				
10260	10310	50	Lime & Chert				
10310	10602	292	Lime				
10602	10690	88	Lime & Shale				
10690	10758	68	Lime & Sand				
10758	10775	17	Lime				

ATTACH SEPARATE SHEET IF ADDITIONAL SPACE IS NEEDED

I hereby swear or affirm that the information given herewith is a complete and correct record of the well and all work done on it so far as can be determined from available records.

October 18, 1956

Company or Operator Sunray Mid-Continent Oil Co Address Box 128 - Hobbs, New Mexico (Date)  
Name January Position or Title Hobbs Area Superintendent

## NEW MEXICO OIL CONSERVATION COMMISSION

Santa Fe, New Mexico

(Form C-104)

Revised 7/1/59

## REQUEST FOR (OIL) - (GAS) ALLOWABLE

New Well  
Recompletion

This form shall be submitted by the operator before an initial allowable will be assigned and completed for Oil or Gas well. Form C-104 is to be submitted in QUADRUPLICATE to the same District Office to which Form C-101 was sent. The allowable will be assigned effective 7:00 A.M. on date of completion or recompletion, provided this form is filed during calendar month of completion or recompletion. The completion date shall be that date in which a well when new oil is delivered into the stock tanks. Gas must be reported on 15.025 psia at 60° Fahrenheit.

Hobbs, New Mexico

(Place)

August 20, 1959

(Date)

WE ARE HEREBY REQUESTING AN ALLOWABLE FOR A WELL KNOWN AS:

Sunray Mid-Continent Oil Co., N.M. State "X", Well No. 1, in SW 1/4 SE 1/4,  
(Company or Operator) (Lease)

0, Sec. 11, T. 10S, R. 2E, NMPM, North Mesquite-Pennsylvanian Pool  
Unit Letter

Lee

County. Date Spudded 3-11-56Date Drilling Completed 5-26-56

Please indicate location:

Elevation 4274' NW Total Depth 10,775 PBTD 10,420Top Oil/Gas Pay 10,184 Name of Prod. Form. Atoka Sand

## PRODUCING INTERVAL -

Perforations 10,184 - 10,195Open Hole \_\_\_\_\_ Depth \_\_\_\_\_ Casing Shoe 10,270 Depth \_\_\_\_\_ Tubing 10,174

## OIL WELL TEST -

Natural Prod. Test: \_\_\_\_\_ bbls. oil, \_\_\_\_\_ bbls water in \_\_\_\_\_ hrs, \_\_\_\_\_ min. Size \_\_\_\_\_ Choke

Test After Acid or Fracture Treatment (after recovery of volume of oil equal to volume of load oil used): \_\_\_\_\_ bbls. oil, \_\_\_\_\_ bbls water in \_\_\_\_\_ hrs, \_\_\_\_\_ min. Size \_\_\_\_\_ Choke

## GAS WELL TEST -

Natural Prod. Test: 1000 cfm MCF/Day; Hours flowed \_\_\_\_\_ Choke Size \_\_\_\_\_Method of Testing (pitot, back pressure, etc.): 3" TesterTest After Acid or Fracture Treatment: None MCF/Day; Hours flowed \_\_\_\_\_

Choke Size \_\_\_\_\_ Method of Testing: \_\_\_\_\_

Acid or Fracture Treatment (Give amounts of materials used, such as acid, water, oil, and sand): NoneCasing \_\_\_\_\_ Tubing \_\_\_\_\_ Date first new \_\_\_\_\_  
Press. \_\_\_\_\_ Press. \_\_\_\_\_ oil run to tanks \_\_\_\_\_Oil Transporter Yellowknife PipelineGas Transporter El Paso Natural Gas

Remarks: This is a refill of Form C-104 submitted 10-18-56, at which time there was no transporter of oil or gas. This well has been shut in since completion 5-26-59

I hereby certify that the information given above is true and complete to the best of my knowledge.

Approved \_\_\_\_\_, 19 \_\_\_\_\_

SUNRAY MID-CONTINENT OIL COMPANY  
(Company or Operator)

By: \_\_\_\_\_

(Signature)

OIL CONSERVATION COMMISSION

By: \_\_\_\_\_

Title District Engineer

Send Communications regarding well to:

Title \_\_\_\_\_

Name G. T. McGlashanAddress Box 128, Hobbs, New Mexico

NEW MEXICO OIL CONSERVATION COMMISSION

Well Location and Acreage Dedication Plat

Section A

Date **HOBBS OFFICE, NCC**  
**1959 AUG 21 AM 9:23**

**DUPLICATE**  
Operator **Sanrey Mid-Continent Oil Company** Lease **N. M. State "N"**  
Well No. **1** Unit Letter **0** Section **11** Township **10S** Range **9E** NMPM  
Located **660** Feet From **South** Line, **1980** Feet From **West** Line  
County **Lea** G. L. Elevation **4257** Dedicated Acreage **280** Acres  
Name of Producing Formation **Atoka** Pool **North Mesquite-Pennsylvanian (Gas)**

1. Is the Operator the only owner\* in the dedicated acreage outlined on the plat below?  
Yes ☒ No ☐.
2. If the answer to question one is "no," have the interests of all the owners been consolidated by communitization agreement or otherwise? Yes ☐ No ☐. If answer is "yes," Type of Consolidation \_\_\_\_\_
3. If the answer to question two is "no," list all the owners and their respective interests below:

Owner

Land Description

<u>Owner</u>	<u>Land Description</u>

Section B

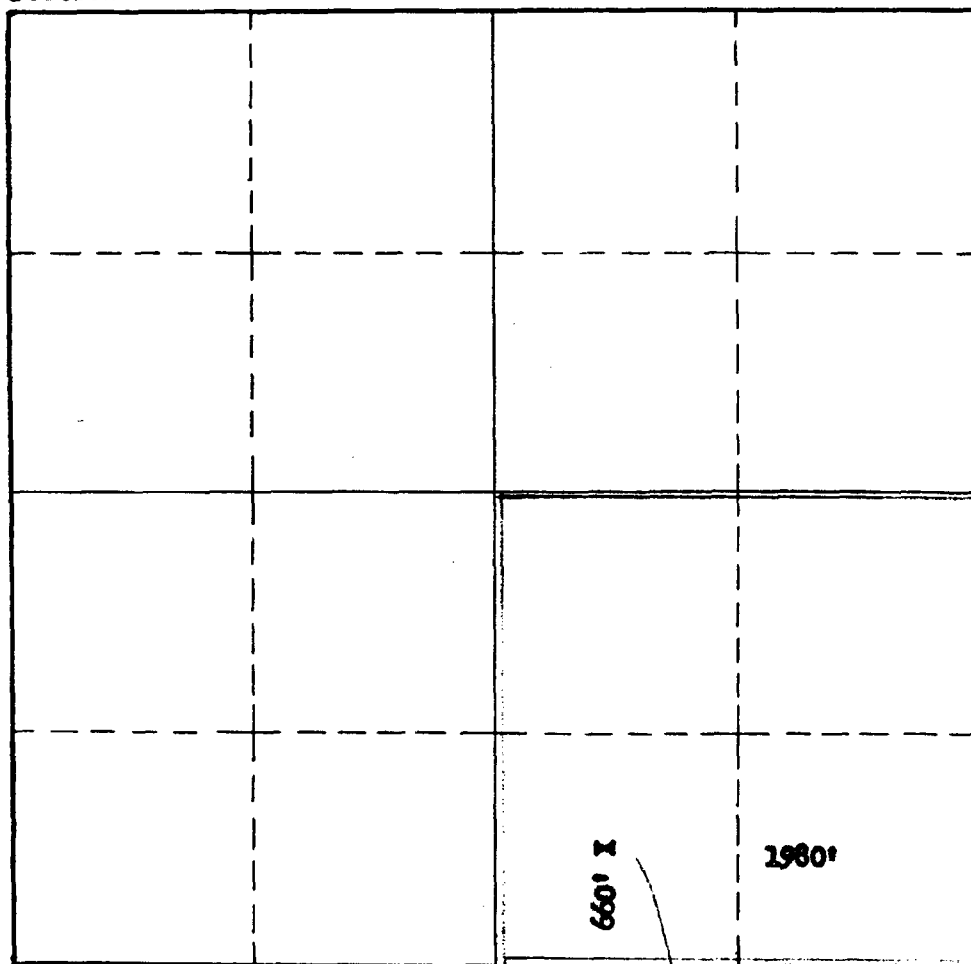

This is to certify that the information in Section A above is true and complete to the best of my knowledge and belief.

**Sanrey Mid-Continent Oil Co.**

(Operator)

*[Signature]*  
(Representative)

**P. O. Box 128 Hobbs, New Mex.**

Address

This is to certify that the well location shown on the plat in Section B was plotted from field notes of actual surveys made by me or under my supervision and that the same is true and correct to the best of my knowledge and belief.

Date Surveyed **2-29-56**

**John W. West**

Registered Professional  
Engineer and/or Land Surveyor.

Certificate No. **676**

(See instructions for completing this form on the reverse side)

NEW MEX. OIL CONSERVATION COMMISSION  
SANTA FE, NEW MEXICO

Form C-110  
Revised 7/1/55

(File the original and 4 copies with the appropriate district office)

HOBBS OFFICE OCC

CERTIFICATE OF COMPLIANCE AND AUTHORIZATION  
TO TRANSPORT OIL AND NATURAL GAS

1959 AUG 21 AM 7:36

Company or Operator Sunray Mid-Continent Oil Company Lease N. M. State "T"  
Well No. 1 Unit Letter O S 11 T 106 R 321 Pool North Mesalero-Pennsylvanian  
County Log Kind of Lease (State, Fed. or Patented) State  
If well produces oil or condensate, give location of tanks: Unit O S 11 T 106 R 321  
Authorized Transporter of Oil or Condensate \_\_\_\_\_

Address \_\_\_\_\_  
(Give address to which approved copy of this form is to be sent)  
Authorized Transporter of Gas El Paso Natural Gas Company  
Address Box 1384 Jal, New Mexico  
(Give address to which approved copy of this form is to be sent)  
If Gas is not being sold, give reasons and also explain its present disposition:  
\_\_\_\_\_  
\_\_\_\_\_

Reasons for Filing: (Please check proper box) New Well ☒  
Change in Transporter of (Check One): Oil ( ) Dry Gas ( ) C'head ( ) Condensate ( )  
Change in Ownership ( ) Other ( )  
Remarks: \_\_\_\_\_ (Give explanation below)

**This well has been shut in since completion 5-26-56**

The undersigned certifies that the Rules and Regulations of the Oil Conservation Commission have been complied with.

Executed this the 20th day of August 19 59

By [Signature]  
Title District Engineer

Approved \_\_\_\_\_ 19 \_\_\_\_\_

OIL CONSERVATION COMMISSION

By [Signature]  
Title \_\_\_\_\_

Company Sunray Mid-Continent Oil Company  
Address Box 128  
Hobbs, New Mexico

NEW MEX. OIL CONSERVATION COMMISSION  
SANTA FE, NEW MEXICO

Form C-110  
Revised 7/1/55

(File the original and 4 copies with the appropriate district office)

HOBBS OFFICE OCC

CERTIFICATE OF COMPLIANCE AND AUTHORIZATION  
TO TRANSPORT OIL AND NATURAL GAS

1958 AUG 26 PM 3:32

Company or Operator Sunray Mid-Continent Oil Company Lease State "K"  
Well No. 1 Unit Letter 0 S 11 T 108 R 32E Pool North Maculata Pennsylvania  
County Lee Kind of Lease (State, Fed. or Patented) State  
If well produces oil or condensate, give location of tanks: Unit 0 S 11 T 108 R 32E  
Authorized Transporter of Oil or Condensate McWood Corporation  
Address 361 Petroleum Building, Abilene, Texas  
(Give address to which approved copy of this form is to be sent)  
Authorized Transporter of Gas \_\_\_\_\_  
Address \_\_\_\_\_  
(Give address to which approved copy of this form is to be sent)  
If Gas is not being sold, give reasons and also explain its present disposition:

Reasons for Filing: (Please check proper box) New Well (X)  
Change in Transporter of (Check One): Oil ( ) Dry Gas ( ) C'head ( ) Condensate ( )  
Change in Ownership ( ) Other ( )  
Remarks: (Give explanation below)

**This well has been shut in since completion 5-26-56**

The undersigned certifies that the Rules and Regulations of the Oil Conservation Commission have been complied with.

Executed this the 26th day of August 19 59

By Robert E. Statton

Approved \_\_\_\_\_ 19 \_\_\_\_\_

Title District Engineer

OIL CONSERVATION COMMISSION

Company Sunray Mid-Continent Oil Co.

By John W. Runyan

Address P. O. Box 128

Title \_\_\_\_\_

Hobbs, New Mexico

OIL CONSERVATION COMMISSION

BOX 2045

HOBBS, NEW MEXICO

HOBBS OFFICE OCC

1959 AUG 27 PM 3:41

NOTICE OF GAS CONNECTION

DATE August 25, 1959

THIS IS TO NOTIFY THE OIL CONSERVATION COMMISSION THAT CONNECTION FOR THE

PURCHASE OF GAS FROM THE Sunray Mid-Continent Oil Co., N. M. State K,  
OPERATOR LEASE  
1-0, 11-10-32, N. Mescalero Penn. Gas El Paso Natural Gas Co.,  
WELL UNIT S.T.R. POOL NAME OF PURCHASER

WAS MADE ON August 25, 1959.  
DATE

El Paso Natural Gas Company  
PURCHASER

A. O. Shiplet  
REPRESENTATIVE  
A. O. Shiplet

Chief Field Dispatcher  
TITLE

CC: TO OPERATOR

OIL CONSERVATION COMMISSION - SANTA FE

NEW MEXICO  
OIL CONSERVATION COMMISSION  
Back Pressure Data Sheet

Form C-122

Pool: **Wildcat** Date: **June 15, 1956**  
Company: **Sunray Mid-Continent** Lease: **N.M. State "K" 7:22** Well No. **1**  
County: **Lea** Sec. **11** Twp. **10S** Rge. **32E** Loc. **660' FSL & 1980' FEL**  
**5-1/2" OD** casing set @ **10270'**; ID tubing **2-3/8** OD tubing set @ **10,172'**  
Pay zone from **10184** to **10195**; Separator gas gr. **.600 assumed** Barometer rdg. **-**  
Reservoir temperature **170** ° Produced through: csg. **-** tbg. **X**  
Average gas/liquid ratio during test: **23.8 M** Cu. ft. / bbl. gravity of liquid **60 assumed** ° API  
Size of meter run or prover: **3" X 2"**

OBSERVED DATA

Wellhead shut-in pressure,  $P_w$  Casing \_\_\_\_\_ Tubing **2258.2** PSIA

Critical flow prover (3" tester)

Run No.	Orifice Size	Orifice Line	Meter Pressures		Coefficient C Flg. tap _____ Pipe tap _____	Wellhead Pr.		Flowing Temp.	
			Static $P_m$ Abs.	Diff. $P_w$ Comp. factor		Casing $P_{wc}$ Abs.	Tubing $P_{wc}$ Abs.	Meter	Wellhead Temp. factor
1	2"	3"	43" Hg	1.000	3100	1.000	928.2	29	1.0312
2	2"	3"	35" Hg	1.000	2714	1.000	1018.2	29	1.0312
3	2"	3"	29" Hg	1.000	2406	1.000	1175.2	31	1.0291
4	2"	3"	18" Hg	1.000	1821	1.000	1313.2	31	1.0291

$\theta = 45^\circ$   
 $n = 1.000$

DATA FOR PLOTTING CURVE

Run No.	Delivery Rate in MCF per 24 hours (Q)	$P_f^2 - P_s^2$ (thousands)
1	3197	8250.6
2	2799	7977.6
3	2476	6812.5
4	1874	5142.5
5	0	10694.2 $P_s^2$ shut in

Absolute Open Flow **4000** MCF

CERTIFICATION: I hereby swear or affirm that, to the best of my knowledge, the information given above is true and correct.

Name: **Robert E. Statton** Position: **Engineer**

Company: **Sunray Mid-Continent Oil Co.** Address: **201 Midland Nat'l Bank Bldg., Midland, Tex**

Please plot curve on back

COUNTY Lea, New Mexico

FIELD wildcat

OPERATOR Sunray Mid-Continent Oil Company

LEASE New Mexico State "K" WELL NO. 1

VOLUME 4.000 MCF/Day DATE 6-12-56

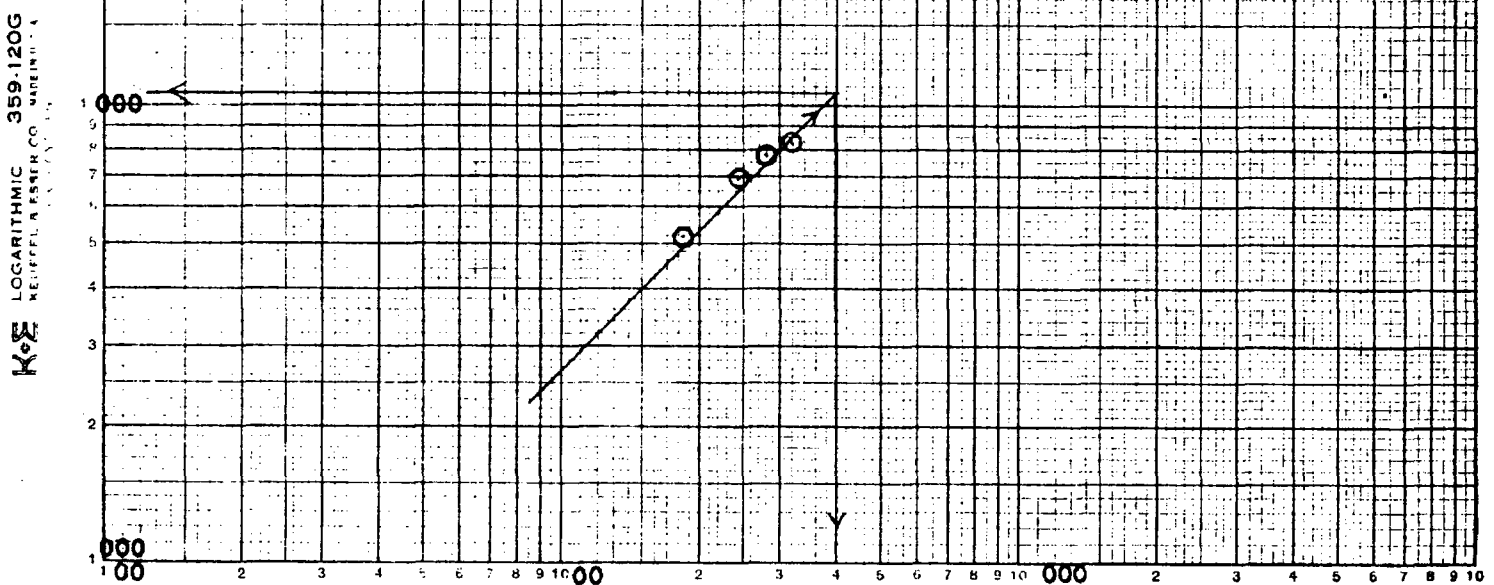

$Q = 4,000$  MCF

 $\theta = 45^\circ$ 

N = 1.00



## NEW MEXICO OIL CONSERVATION COMMISSION

FORM C-103  
(Rev 3-55)

## MISCELLANEOUS REPORTS ON WELLS

(Submit to appropriate District Office as per Commission Rule 1106)

Name of Company Energy Mid-Continent Oil Company				Address Box 124, Hobbs, New Mexico			
Lease A.M. State "X"	Well No. 1	Unit Letter 0	Section 11	Township 10S	Range 32E		
Date Work Performed	Pool Designated			County Lea			

THIS IS A REPORT OF: (Check appropriate block)

- ☐ Beginning Drilling Operations   
 ☐ Casing Test and Cement Job   
 ☒ Other (Explain): Gas Shut In  
☐ Plugging   
 ☐ Remedial Work

Detailed account of work done, nature and quantity of materials used, and results obtained.

Re 1-actual report of SI gas well. Awaiting gas market.

THE STATE OF NEW MEXICO  
 EXCELLENCE IN OIL SERVICE  
 AS TO THE WELL SITE AND YOUR  
 FUTURE PLANS FOR THIS WELL

Witnessed by	Position	Company
--------------	----------	---------

## FILL IN BELOW FOR REMEDIAL WORK REPORTS ONLY

## ORIGINAL WELL DATA

D F Elev.	T D	P B T D	Producing Interval	Completion Date
Tubing Diameter	Tubing Depth	Oil String Diameter	Oil String Depth	
Perforated Interval(s)				
Open Hole Interval			Producing Formation(s)	

## RESULTS OF WORKOVER

Test	Date of Test	Oil Production BPD	Gas Production MCFPD	Water Production BPD	GOR Cubic feet/Bbl	Gas Well Potential MCFPD
Before Workover						
After Workover						

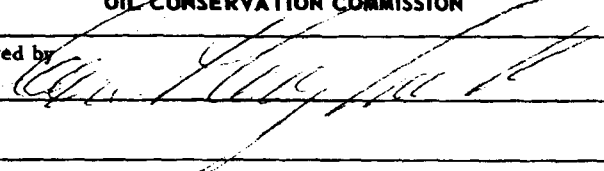
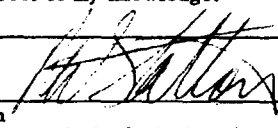
OIL CONSERVATION COMMISSION		I hereby certify that the information given above is true and complete to the best of my knowledge.	
Approved by		Name	
Title		Position	District Engineer
Date		Company	Energy Mid-Continent Oil Company

**NEW MEXICO OIL CONSERVATION COMMISSION**  
**MISCELLANEOUS REPORTS ON WELLS**  
(Submit to appropriate District Office as per Commission Rule 1106)

COMPANY Sunray Mid-Continent Oil Company Box 128 - Hobbs, N.M.  
(Address)

LEASE N. M. State K WELL NO. 1 UNIT 0 S11 T 10S R 32E  
DATE WORK PERFORMED 5-22-56 POOL Undesignated

This is a Report of: (Check appropriate block) ☒ Results of Test of Casing Shut-off

☐ Beginning Drilling Operations

☐ Remedial Work

☐ Plugging

☐ Other \_\_\_\_\_

Detailed account of work done, nature and quantity of materials used and results obtained.

Drilled 7 7/8 hole to 10,775'. Tested salt water in Devonian 10,745-10,775'. Plugged back to 10,420' w/cement.

Set 5 1/2" OD - 17# & 20# N-80 @ 10,270' w/500 sacks cement. Cement came to 7042' by Temperature Survey.

Tested casing to 1500#/30 minutes with no pressure drop. Cleaned out to 10,214'. Perforated - 10,184-10,195' w/44 holes. Tested gas w/trace of Distillate.

**FILL IN BELOW FOR REMEDIAL WORK REPORTS ONLY**

Original Well Data:

DF Elev. \_\_\_\_\_ TD \_\_\_\_\_ PBD \_\_\_\_\_ Prod. Int. \_\_\_\_\_ Compl Date \_\_\_\_\_

Tbng. Dia \_\_\_\_\_ Tbng Depth \_\_\_\_\_ Oil String Dia \_\_\_\_\_ Oil String Depth \_\_\_\_\_

Perf Interval (s) \_\_\_\_\_

Open Hole Interval \_\_\_\_\_ Producing Formation (s) \_\_\_\_\_

**RESULTS OF WORKOVER:**

**BEFORE**

**AFTER**

Date of Test \_\_\_\_\_

Oil Production, bbls. per day \_\_\_\_\_

Gas Production, Mcf per day \_\_\_\_\_

Water Production, bbls. per day \_\_\_\_\_

Gas-Oil Ratio, cu. ft. per bbl. \_\_\_\_\_

Gas Well Potential, Mcf per day \_\_\_\_\_

Witnessed by \_\_\_\_\_

(Company)

OIL CONSERVATION COMMISSION

I hereby certify that the information given above is true and complete to the best of my knowledge.

Name \_\_\_\_\_

Name \_\_\_\_\_

Title \_\_\_\_\_

Position Hobbs Area Superintendent

Date \_\_\_\_\_

Company Sunray Mid-Continent Oil Co.

MAY 29 1956

HOBBS OFFICE OCC

NEW MEXICO OIL CONSERVATION COMMISSION  
MISCELLANEOUS REPORTS ON WELLS

(Submit to appropriate District Office as per Commission Rule 1100)

Company Sunray Mid-Continent Oil Company Box 128 - Hobbs, New Mexico  
(Address)

Lease N. M. State "K" Well No. 1 Unit 0 S 11 T 10S R 32E

Date work performed 3-20-56 POOL Undesignated

This is a Report of (Check appropriate block) ☒ Result of Test of Casing Shut-off

☐ Beginning Drilling Operations

☐ Remedial Work

☐ Plugging

☐ Other \_\_\_\_\_

Detailed account of work done, nature and quantity of materials used and results obtained.

Drilled 12 1/4" hole to 3490'. Set 9 5/8" OD - 36# and 32# casing with Baker Float Collar and Shoe @ 3488' with 2600 sacks of 1:1 Mix Dia-Mix Cement and 200 sacks of neat. Cement circulated to surface.

Casing was tested after 36 hours by applying 1500# pump pressure for 30 minutes with no pressure drop.

FILL IN BELOW FOR REMEDIAL WORK REPORTS ONLY

Original Well Data:

DF Elev. \_\_\_\_\_ TD \_\_\_\_\_ PBD \_\_\_\_\_ Prod. Int. \_\_\_\_\_ Compl. Date \_\_\_\_\_

Tbng. Dia. \_\_\_\_\_ Tbng. Depth \_\_\_\_\_ Oil String Dia \_\_\_\_\_ Oil String Depth \_\_\_\_\_

Perf. Interval (s) \_\_\_\_\_

Open Hole Interval \_\_\_\_\_ Producing Formation (s) \_\_\_\_\_

RESULTS OF WORKOVER:

BEFORE

AFTER

Date of Test \_\_\_\_\_

Oil Production, bbls. per day \_\_\_\_\_

Gas Production, Mcf per day \_\_\_\_\_

Water Production, bbls. per day \_\_\_\_\_

Gas-Oil Ratio, cu. ft. per bbl. \_\_\_\_\_

Gas Well Potential, Mcf per day \_\_\_\_\_

Witnessed by \_\_\_\_\_

(Company)

Oil Conservation Commission

I hereby certify that the information given above is true and complete to the best of my knowledge.

Name \_\_\_\_\_

Name \_\_\_\_\_

Title \_\_\_\_\_

Position J. A. Parry  
Hobbs Area Superintendent

Date \_\_\_\_\_

Company Sunray Mid-Continent Oil Company

DUPLICATE

Form C-103  
(Revised 3-55)

HOBBS OFFICE OCC

NEW MEXICO OIL CONSERVATION COMMISSION

MISCELLANEOUS REPORTS ON WELLS

(Submit to appropriate District Office as per Commission Rule 1106)

APR 2 AM 10:00

Company Sunray Mid-Continent Oil Company  
(Address)

Lease N. M. State "E" Well No. 1 Unit 0 S 11 T 10S R 32E

Date work performed \_\_\_\_\_ POOL Undesignated

This is a Report of (Check appropriate block) ☒ Result of Test of Casing Shut-off

☐ Beginning Drilling Operations

☐ Remedial Work

☐ Plugging

☐ Other \_\_\_\_\_

Detailed account of work done, nature and quantity of materials used and results obtained.

Spudded 3-11-56. Drilled 17" hole to 365'. Set 13 3/8" OD - 36# Armac Spiral Weld Casing at 358.80' with Texas Pattern Shoe. Cemented to surface with 365 sacks common cement with 4% Gel. Casing was tested after 24 hours with 800 psi for 30 minutes with no pressure drop.

FILL IN BELOW FOR REMEDIAL WORK REPORTS ONLY

Original Well Data:

DF Elev. \_\_\_\_\_ TD \_\_\_\_\_ PBD \_\_\_\_\_ Prod. Int. \_\_\_\_\_ Compl. Date \_\_\_\_\_

Tbng. Dia. \_\_\_\_\_ Tbng. Depth \_\_\_\_\_ Oil String Dia \_\_\_\_\_ Oil String Depth \_\_\_\_\_

Perf. Interval (s) \_\_\_\_\_

Open Hole Interval \_\_\_\_\_ Producing Formation (s) \_\_\_\_\_

RESULTS OF WORKOVER:

	BEFORE	AFTER
Date of Test	_____	_____
Oil Production, bbls. per day	_____	_____
Gas Production, Mcf per day	_____	_____
Water Production, bbls. per day	_____	_____
Gas-Oil Ratio, cu. ft. per bbl.	_____	_____
Gas Well Potential, Mcf per day	_____	_____
Witnessed by _____		

(Company)

Oil Conservation Commission	I hereby certify that the information given above is true and complete to the best of my knowledge.
Name <u>P. M. Lueder</u>	Name <u>J. A. Parry</u>
Title _____	Position <u>Hobbs Area Superintendent</u>
Date <u>APR 2 1956</u>	Company <u>Sunray Mid-Continent Oil Company</u>

NEW MEXICO OIL CONSERVATION COMMISSION

Santa Fe, New Mexico

NOTICE OF INTENTION TO DRILL OR RECOMPLETE

Notice must be given to the District Office of the Oil Conservation Commission and approval obtained before drilling or recompletion begins. If changes in the proposed plan are considered advisable, a copy of this notice showing such changes will be returned to the sender. Submit this notice in QUINTUPLICATE. One copy will be returned following approval. See additional instructions in Rules and Regulations of the Commission. If State Land submit 6 Copies

Hebbs, New Mexico

(Place)

March 1, 1956

(Date)

OIL CONSERVATION COMMISSION  
SANTA FE, NEW MEXICO

Gentlemen:

You are hereby notified that it is our intention to commence the (Drilling) ~~(Recompletion)~~ of a well to be known as

Sunray Mid-Continent Oil Company

(Company or Operator)

New Mexico State "K"

(Lease)

Well No. 1, in 0

(Unit)

The well is

located 1980 feet from the East line and 660 feet from the

North

line of Section 11, T. 10-S, R. 32-E, NMPM.

(GIVE LOCATION FROM SECTION LINE)

Wildcat

Pool,

Lea

County

If State Land the Oil and Gas Lease is No. E-9713

If patented land the owner is

Address

We propose to drill well with drilling equipment as follows: Rotary tools to

approximately 11,000'

The status of plugging bond is Approved

Drilling Contractor McVay & Stafford Drilling Company

Tulsa, Oklahoma

We intend to complete this well in the Devonian

formation at an approximate depth of 10,560 feet.

CASING PROGRAM

We propose to use the following strings of Casing and to cement them as indicated:

Size of Hole	Size of Casing	Weight per Foot	New or Second Hand	Depth	Sacks Cement
17 1/2	13 1/2	36#	New	335'	350 w/4% Gel.
12 1/4	9 5/8	36#	New	4,000'	1700 w/4% Gel.
8 3/4	5 1/2	20# & 17#	New	10,560'	350 w/4% Gel. & 100 ex. Neat

If changes in the above plans become advisable we will notify you immediately.

ADDITIONAL INFORMATION (If recompletion give full details of proposed plan of work.)

Approved \_\_\_\_\_, 19\_\_\_\_  
Except as follows:

OIL CONSERVATION COMMISSION

By \_\_\_\_\_

Sincerely yours,

Sunray Mid-Continent Oil Company

(Company or Operator)

By J. A. Parry

Position Hebbs Area Superintendent

Send Communications regarding well to

Name Sunray Mid-Continent Oil Company

Address Box 128 - Hebbs, New Mexico

COUNTY	LEA	FIELD	Mescalero-SA	STATE	NM.	OWWO
OPR	SUNRA DX OIL COMPANY					MAP
1 New Mexico State "K"						
Sec. 11, T-10-S, R-32-E					CO-ORD	
660' fr S Line & 1980' fr E Line of Sec.						
Re-Spud 3-22-64			CLASS			
Re-Comp 5-31-64			P.W.D. EL 42748			
		FORMATION	DATUM	FORMATION	DATUM	
CSG & SX - TUBING						
13 3/8"	339'	365				
9 5/8"	3488'	2800				
5 1/2"	10270'	500				
LOGS EL GR RA IND HC A						
TD 10775', PBD 4200'						

IP San Andres Perfs 4042-4120' Pmpd 9 BOPD + 22 BW. Pot. Based on 24 hr test, gravity 19., GOR 1771.

Distribution limited and publication prohibited by subscribers' agreement.  
Reproduction rights reserved by Williams & Lee Scouting Service, Inc.

CONT.	PROP DEPTH	TYPE
DATE		

F.R.C. 6-18-64; OWWO, OTD 10775'  
Re-complete from Wolfcamp 8530-8830 and Temp.  
Abd. 11-5-63  
6-15-64 TD 10775', PBD 4200', COMPLETED  
Spotted 35 sx plug 8740-8430'  
Perf 4397-98' & sq. w/275 sx.  
DO to 4200'  
Perf 4137-38' & sq. w/100 sx.  
Perf 4039-40' & sq. w/100 sx.  
Perf 4042-45', 4060-62', 4067-69', 4080-82',  
4092-94', 4101-03' & 4116-20' W/2 SPF  
Ac. 3500 gals.  
Frac 20,000 gals oil + 20,000# sd.