

Submit to Appropriate
District Office
State Lease - 4 copies
Fee Lease - 3 copies

State of New Mexico
Energy, Minerals and Natural Resources Department

Form C-102
Revised 1-1-89

OIL CONSERVATION DIVISION

P.O. Box 2088
Santa Fe, New Mexico 87504-2088

DISTRICT I

P.O. Box 1980, Hobbs, NM 88240

DISTRICT II

P.O. Drawer DD, Artesia, NM 88210

DISTRICT III

1000 Rio Brazos Rd., Aztec, NM 87410

WELL LOCATION AND ACREAGE DEDICATION PLAT

All Distances must be from the outer boundaries of the section

Operator MACK ENERGY CORPORATION			Lease McINTYRE DK FEDERAL		Well No. 8
Unit Letter N	Section 17	Township 17 SOUTH	Range 30 EAST	NMPM	County EDDY
Actual Footage Location of Well: 330 feet from the SOUTH line and 1650 feet from the WEST line					
Ground Level Elev. 3649.5'	Producing Formation San Andres		Pool Grayburg Jackson		Dedicated Acreage: 40 Acres

1. Outline the acreage dedicated to the subject well by colored pencil or hachure marks on the plat below.
2. If more than one lease is dedicated to the well, outline each and identify the ownership thereof (both as to working interest and royalty).
3. If more than one lease of different ownership is dedicated to the well, have the interest of all owners been consolidated by communitization, unitization, force-pooling, etc.?
☐ Yes ☐ No If answer is "yes" type of consolidation _____

If answer is "no" list of owners and tract descriptions which have actually been consolidated. (Use reverse side of this form necessary.)

No allowable will be assigned to the well unit all interests have been consolidated (by communitization, unitization, forced-pooling, otherwise) or until a non-standard unit, eliminating such interest, has been approved by the Division.

OPERATOR CERTIFICATION

I hereby certify that the information contained herein is true and complete to the best of my knowledge and belief.

Signature *Jerry W. Sherrell*
Printed Name **Jerry W. Sherrell**
Position **Production Clerk**
Company **Mack Energy Corporation**
Date **8/3/2005**

SURVEYOR CERTIFICATION

I hereby certify that the well location shown on this plat was plotted from field notes of actual surveys made by me or under my supervision and that the same is true and correct to the best of my knowledge and belief.

Date Surveyed
FEBRUARY 26, 1993

Signature & Seal of
Professional Surveyor

Gary L. Jones
Certificate No. **JOHN W. WEST** 676
RONALD J. EIDSON 3239
GARY L. JONES 7977
95-11-0316

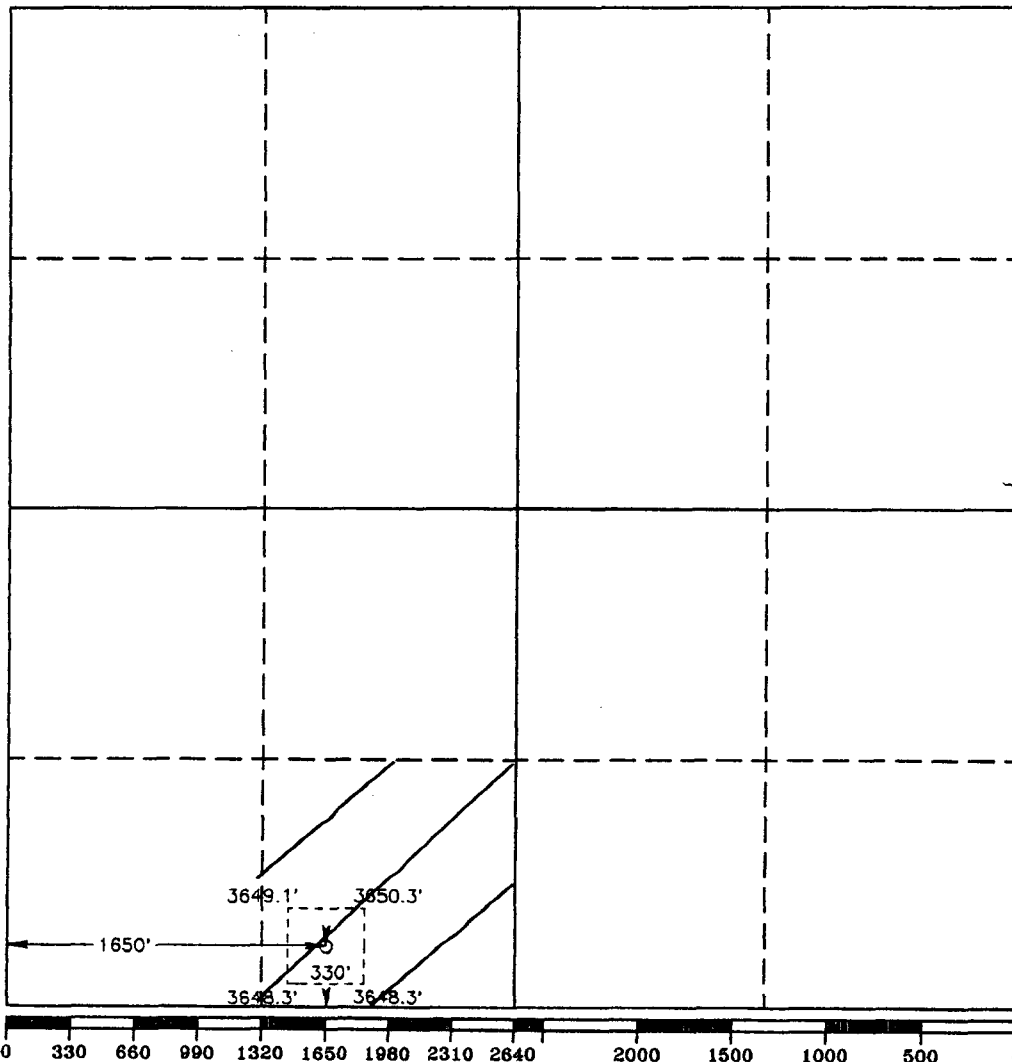

Submit to Appropriate
District Office
State Lease - 4 copies
Fee Lease - 3 copies

State of New Mexico
Energy, Minerals and Natural Resources Department

Form C-102
Revised 1-1-89

OIL CONSERVATION DIVISION

P.O. Box 2088

Santa Fe, New Mexico 87504-2088

DISTRICT I

P.O. Box 1980, Hobbs, NM 88240

DISTRICT II

P.O. Drawer DD, Artesia, NM 88210

DISTRICT III

1000 Rio Brazos Rd., Aztec, NM 87410

WELL LOCATION AND ACREAGE DEDICATION PLAT

All Distances must be from the outer boundaries of the section

Operator MACK ENERGY CORPORATION			Lease MCINTYRE OK FEDERAL		Well No. 8
Unit Letter N	Section 17	Township 17 SOUTH	Range 30 EAST	NMPM	County EDDY
Actual Footage Location of Well: 330 feet from the SOUTH line and 1650 feet from the WEST line					
Ground Level Elev. 3649.5'	Producing Formation Paddock		Pool Loco Hills		Dedicated Acreage: 40 Acres

1. Outline the acreage dedicated to the subject well by colored pencil or hachure marks on the plat below.
2. If more than one lease is dedicated to the well, outline each and identify the ownership thereof (both as to working interest and royalty).
3. If more than one lease of different ownership is dedicated to the well, have the interest of all owners been consolidated by communitization, unitization, force-pooling, etc.?
☐ Yes ☐ No If answer is "yes" type of consolidation _____

If answer is "no" list of owners and tract descriptions which have actually been consolidated. (Use reverse side of this form necessary.)

No allowable will be assigned to the well unit all interests have been consolidated (by communitization, unitization, forced-pooling, otherwise) or until a non-standard unit, eliminating such interest, has been approved by the Division.

OPERATOR CERTIFICATION

I hereby certify the the information contained herein is true and complete to the best of my knowledge and belief.

Signature
Jerry W. Sherrell
Printed Name
Jerry W. Sherrell
Position
Production Clerk
Company
Mack Energy Corporation
Date
8/3/2005

SURVEYOR CERTIFICATION

I hereby certify that the well location shown on this plat was plotted from field notes of actual surveys made by me or under my supervision, and that the same is true and correct to the best of my knowledge and belief.

Date Surveyed
FEBRUARY 26, 1993

Signature & Seal of
Professional Surveyor

[Signature]
Certificate No. **JOHN W. WEST 676**
RONALD J. EDSON 3239
GARY L. JONES 7977
93-11-0316

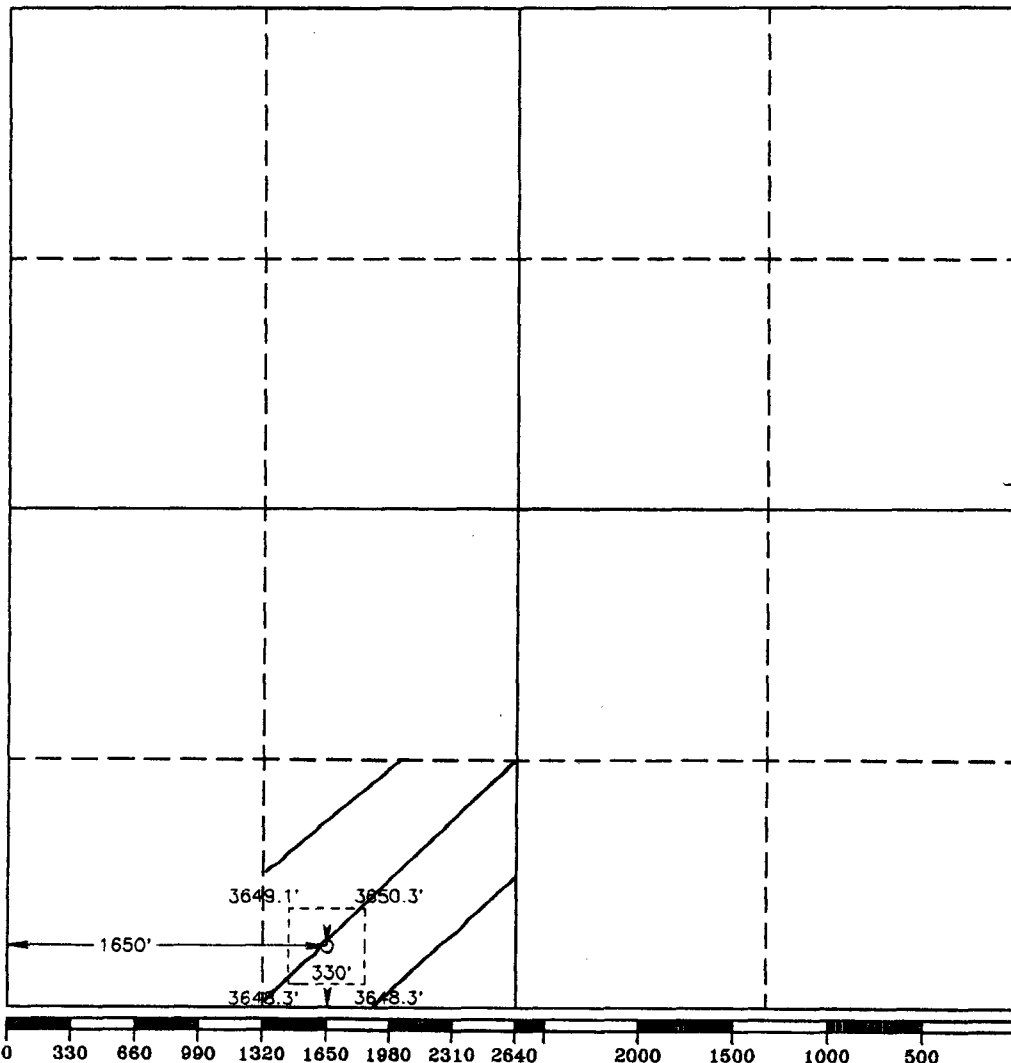



P.O. Box 960
Artesia, NM 88211-0960
Office (505) 748-1288
Fax (505) 746-9539

August 4, 2005

Oil Conservation Division
Attn: David Catanach
1220 South St. Francis Dr.
Santa Fe, NM 87505

Re: Downhole Commingling, and measurement of
Hydrocarbon Production for:
McIntyre DK #1,3,7,8,9,10,11,12Y,13
Section 17, T17S, R30E
Eddy County, New Mexico

Mack Energy Corporation as operator of the aforementioned (9) wells respectfully requests administrative approval for down hole commingling and measurement of production.

Mack Energy proposes to commingle Grayburg Jackson;SR-Q-G-SA(28509) and Loco Hills Paddock(96718) production in the above mentioned McIntyre DK wells(Lease NMNM-86025). Production of both pools will be measured at the McIntyre DK Tank Battery located in the SE/4 SW/4 Sec. 17 T17S R30E. This lease has common interest in both pools. Notification has been made to all parties owning an interest in this lease, including the oil purchaser, of the intent to commingle. Testing will be conducted and allocation percentages will be sent to OCD after completion of these wells.

Should you require any additional information concerning this application, please call Jerry W. Sherrell at the above number. Thank you for your consideration of this request.

Sincerely,

MACK ENERGY CORPORATION

Jerry W. Sherrell
Production Clerk
jerrys@mackenergycorp.com

JWS/

Enclosures