

DATE IN 05/13/13	SUSPENSE 6/2	ENGINEER DB	LOGGED IN 05/15/13	TYPE PLC	APP NO. PPRG 1313561525
------------------	--------------	-------------	--------------------	----------	-------------------------

ABOVE THIS LINE FOR DIVISION USE ONLY

NEW MEXICO OIL CONSERVATION DIVISION
 RECEIVED OGD Engineering Bureau -
 1220 South St. Francis Drive, Santa Fe, NM 87505
 2017 MAY 13 P 2:26



PPRG 1313561525

ADMINISTRATIVE APPLICATION CHECKLIST

THIS CHECKLIST IS MANDATORY FOR ALL ADMINISTRATIVE APPLICATIONS FOR EXCEPTIONS TO DIVISION RULES AND REGULATIONS WHICH REQUIRE PROCESSING AT THE DIVISION LEVEL IN SANTA FE

Application Acronyms:

[NSL-Non-Standard Location] [NSP-Non-Standard Proration Unit] [SD-Simultaneous Dedication]
 [DHC-Downhole Commingling] [CTB-Lease Commingling] [PLC-Pool/Lease Commingling]
 [PC-Pool Commingling] [OLS - Off-Lease Storage] [OLM-Off-Lease Measurement]
 [WFX-Waterflood Expansion] [PMX-Pressure Maintenance Expansion]
 [SWD-Salt Water Disposal] [IPI-Injection Pressure Increase]
 [EOR-Qualified Enhanced Oil Recovery Certification] [PPR-Positive Production Response]

[1] TYPE OF APPLICATION - Check Those Which Apply for [A]

- [A] Location - Spacing Unit - Simultaneous Dedication
☐ NSL ☐ NSP ☐ SD

Check One Only for [B] or [C]

- [B] Commingling - Storage - Measurement
☐ DHC ☐ CTB ☒ PLC ☐ PC ☐ OLS ☐ OLM

- [C] Injection - Disposal - Pressure Increase - Enhanced Oil Recovery
☐ WFX ☐ PMX ☐ SWD ☐ IPI ☐ EOR ☐ PPR

- [D] Other: Specify Amend existing order PLC - 358-A

30-025-40891

Hemlock BSH
 State #2H

Yates Petroleum

[2] NOTIFICATION REQUIRED TO: - Check Those Which Apply, or Does Not Apply

- [A] ☒ Working, Royalty or Overriding Royalty Interest Owners
 [B] ☐ Offset Operators, Leaseholders or Surface Owner
 [C] ☐ Application is One Which Requires Published Legal Notice
 [D] ☒ Notification and/or Concurrent Approval by BLM or SLO
U.S. Bureau of Land Management - Commissioner of Public Lands, State Land Office
 [E] ☒ For all of the above, Proof of Notification or Publication is Attached, and/or,
 [F] ☒ Waivers are Attached

[3] SUBMIT ACCURATE AND COMPLETE INFORMATION REQUIRED TO PROCESS THE TYPE OF APPLICATION INDICATED ABOVE.

[4] **CERTIFICATION:** I hereby certify that the information submitted with this application for administrative approval is **accurate** and **complete** to the best of my knowledge. I also understand that **no action** will be taken on this application until the required information and notifications are submitted to the Division.

Note: Statement must be completed by an individual with managerial and/or supervisory capacity.

Miriam Morales
 Print or Type Name

Signature

Production Analyst
 Title

Date

mmorales@yatespetroleum.com
 e-mail Address

District I
1625 N. French Drive, Hobbs, NM 88240
District II
1301 W. Grand Ave, Artesia, NM 88210
District III
1000 Rio Brazos Road, Aztec, NM 87410
District IV
1220 S. St Francis Dr, Santa Fe, NM
87505

State of New Mexico
Energy, Minerals and Natural Resources Department

Form C-107-B
Revised June 10, 2003

OIL CONSERVATION DIVISION

1220 S. St Francis Drive
Santa Fe, New Mexico 87505

Submit the original
application to the Santa Fe
office with one copy to the
appropriate District Office.

2013 MAY 13 P 2: 21

APPLICATION FOR SURFACE COMMINGLING (DIVERSE OWNERSHIP)

OPERATOR NAME: Yates Petroleum Corporation

OPERATOR ADDRESS: 105 South Fourth St. Artesia, NM 88210

APPLICATION TYPE:

☐ Pool Commingling ☐ Lease Commingling ☒ Pool and Lease Commingling ☐ Off-Lease Storage and Measurement (Only if not Surface Commingled)

LEASE TYPE: ☐ Fee ☒ State ☐ Federal

Is this an Amendment to existing Order? ☒ Yes ☐ No If "Yes", please include the appropriate Order No. PLC-358-A

Have the Bureau of Land Management (BLM) and State Land office (SLO) been notified in writing of the proposed commingling

☒ Yes ☐ No

(A) POOL COMMINGLING

Please attach sheets with the following information

(1) Pool Names and Codes	Gravities / BTU of Non-Commingled Production	Calculated Gravities / BTU of Commingled Production		Calculated Value of Commingled Production	Volumes
Triple X; Bone Spring 59900	43.0/1450	41.1/1438			
Brinninstool; Delaware 96193	35.4/1390				

(2) Are any wells producing at top allowables? ☐ Yes ☒ No

(3) Has all interest owners been notified by certified mail of the proposed commingling? ☒ Yes ☐ No.

(4) Measurement type: ☒ Metering ☐ Other (Specify)

(5) Will commingling decrease the value of production? ☐ Yes ☒ No If "yes", describe why commingling should be approved

(B) LEASE COMMINGLING

Please attach sheets with the following information

(1) Pool Name and Code.

(2) Is all production from same source of supply? ☐ Yes ☐ No

(3) Has all interest owners been notified by certified mail of the proposed commingling? ☐ Yes ☐ No

(4) Measurement type: ☐ Metering ☐ Other (Specify)

(C) POOL and LEASE COMMINGLING

Please attach sheets with the following information

(1) Complete Sections A and E.

(D) OFF-LEASE STORAGE and MEASUREMENT

Please attached sheets with the following information

(1) Is all production from same source of supply? ☐ Yes ☐ No

(2) Include proof of notice to all interest owners.

(E) ADDITIONAL INFORMATION (for all application types)

Please attach sheets with the following information

(1) A schematic diagram of facility, including legal location.

(2) A plat with lease boundaries showing all well and facility locations. Include lease numbers if Federal or State lands are involved.

(3) Lease Names, Lease and Well Numbers, and API Numbers.

I hereby certify that the information above is true and complete to the best of my knowledge and belief.

SIGNATURE: *Miriam Morales*

TITLE: Production Analyst

DATE: 5/9/13

TYPE OR PRINT NAME: Miriam Morales

TELEPHONE NO.: (575) 748-1471

E-MAIL ADDRESS: mmorales@yatespetroleum.com

District I - (575) 393-6161
1625 N. French Dr., Hobbs, NM 88240
District II - (575) 748-1283
811 S. First St., Artesia, NM 88210
District III - (505) 334-6178
1000 Rio Brazos Rd., Aztec, NM 87410
District IV - (505) 476-3460
1220 S. St. Francis Dr., Santa Fe, NM 87505

OIL CONSERVATION DIVISION
1220 South St. Francis Dr.
Santa Fe, NM 87505

RECEIVED

WELL API NO. 30-025-40891
5. Indicate Type of Lease STATE <input checked="" type="checkbox"/> FEE <input type="checkbox"/>
6. State Oil & Gas Lease No. VB-1169
7. Lease Name or Unit Agreement Name Hemlock BSH State
8. Well Number 2H
9. OGRID Number 025575
10. Pool name or Wildcat Triple X; Bone Spring

SUNDRY NOTICES AND REPORTS ON WELLS
(DO NOT USE THIS FORM FOR PROPOSALS TO DRILL OR TO DEEPEN OR PLUG BACK TO A DIFFERENT RESERVOIR. USE "APPLICATION FOR PERMIT" (FORM C-101) FOR SUCH PROPOSALS.)

1. Type of Well: Oil Well <input checked="" type="checkbox"/> Gas Well <input type="checkbox"/> Other <input type="checkbox"/>
2. Name of Operator Yates Petroleum Corporation
3. Address of Operator 105 S. Fourth Street Artesia, NM 88210
4. Well Location Unit Letter <u>D</u> : <u>220</u> feet from the <u>N</u> line and <u>580</u> feet from the <u>W</u> line Section <u>32</u> Township <u>23S</u> Range <u>33E</u> NMPM County <u>Lea</u>
11. Elevation (Show whether DR, RKB, RT, GR, etc.) 3667' GR

12. Check Appropriate Box to Indicate Nature of Notice, Report or Other Data

<p>NOTICE OF INTENTION TO:</p> <p>PERFORM REMEDIAL WORK <input type="checkbox"/> PLUG AND ABANDON <input type="checkbox"/></p> <p>TEMPORARILY ABANDON <input type="checkbox"/> CHANGE PLANS <input type="checkbox"/></p> <p>PULL OR ALTER CASING <input type="checkbox"/> MULTIPLE COMPL <input type="checkbox"/></p> <p>DOWNHOLE COMMINGLE <input type="checkbox"/></p>	<p>SUBSEQUENT REPORT OF:</p> <p>REMEDIAL WORK <input type="checkbox"/> ALTERING CASING <input type="checkbox"/></p> <p>COMMENCE DRILLING OPNS. <input type="checkbox"/> P AND A <input type="checkbox"/></p> <p>CASING/CEMENT JOB <input type="checkbox"/></p>
OTHER: Amend PLC-358-A to include oil & additional wells <input checked="" type="checkbox"/>	OTHER: <input type="checkbox"/>

13. Describe proposed or completed operations. (Clearly state all pertinent details, and give pertinent dates, including estimated date of starting any proposed work). SEE RULE 19.15.7.14 NMAC. For Multiple Completions: Attach wellbore diagram of proposed completion or recompletion.

Yates Petroleum respectfully requests administrative approval to amend PLC-358-A previously approved on 3/22/13. This request consists of the addition of oil and gas commingle as follows:

Hemlock #1H & 2H oil commingled at the Hemlock battery located at Sec. 32-T23S-R33E- ownership diversified
Yarrow 1, 2, 3H, 4H & 5H oil commingled at the Yarrow battery located at Sec. 32-T23S-R33E- diverse pools, same ownership
Gas from all the wells to be commingled at CDP- ownership/pools diversified

Please see attached list of all wells and site facility diagrams.
All owners have been notified and copies of certified receipts and letters are attached.

Oil Measurement

Each of these wells will be equipped with continuously metering separators for oil production prior to oil being commingled for sales at the battery. Total sales/production will be allocated back to each individual well using the metered (daily well tests) volumes. Metered volumes will be compared to totals battery volumes daily and monthly for accuracy. Any vapor recovery gas shall be included in this application.

Estimated daily oil production for the Hemlock #1H is 250 bbls with a gravity of 43.0 and for the Hemlock #2H is 300 bbls.

Estimated daily oil production for the Yarrow #1 is marginal, 0-3 bbls with gravity of 35.4 and for the Yarrow 2-5 is 300 bbls for each well.

Gas Measurement- Yarrow CDP

Total gas production and sales will be based on the measurement at the CDP and allocated back to each well based on EFM readings.
The Agave's meter #10982 is located at the Yarrow #1. DCP meter #7222112 alternate route, if needed.

Estimated daily gas production for the Hemlock #1H is 165 MCF, for the Hemlock #2H is 300 MCF with 1450 BTU. The Yarrow #1 gas production is marginal, 0-5 MCF with 1390 BTU and estimated daily production for the Yarrow #2- #5 is 500 MCF for each well.

The purpose of the Surface Pool/Lease Commingle is in the interest of conservation, economic feasibility, the reduction of environmental impact area, and overall emissions. It will not result in reduced royalty or improper measurement of production. Without approval for utilizing the same battery, it will become necessary to build separate facilities for each well. This will greatly increase costs and shorten the economic life of all the wells.

I hereby certify that the information above is true and complete to the best of my knowledge and belief.

SIGNATURE Miriam Morales TITLE Production Analyst DATE 5/1/13

Type or print name Miriam Morales E-mail address: mmorales@yatespetroleum.com PHONE: 575-748-4200

For State Use Only

APPROVED BY: _____ TITLE _____ DATE _____

Conditions of Approval (if any):

Attachment for Hemlock BSH State #2H, amended PLC-358-A

Hemlock BSH St. #1H
Triple X; Bone Spring
Sec. 32-T23S-R33E
API #30-025-40489
St. Lease #VB-1169
Lea County, NM

Hemlock BSH State #2H
Triple X; Bone Spring
Sec. 32-T23S-R33E
API #30-025-40891
St. Lease #VB-1169
Lea County, NM

Yarrow BHY State #1
Brinningstool; Delaware
Sec. 32-T23S-R33E
API #30-025-37561
St. Lease #VO-6276
Lea County, NM

Yarrow BHY State #2(not yet drilled)
Triple X; Bone Spring
Sec. 32-T23S-R33E
API #30-025-40878
St. Lease #VO-6276
Lea County, NM

Yarrow BHY State #3H (not yet drilled)
Brinningstool; Delaware
Sec. 32-T23S-R33E
API #30-025-40314
St. lease #VO-6276
Lea County, NM

Yarrow BHY State #4H(not yet drilled)
Triple X; Bone Spring
Sec. 32-T23S-R33E
API #30-025-41054
St. Lease #VO-6276
Lea County, NM

Yarrow BHY St. #5H(not yet drilled)
Triple X; Bone Spring
Sec. 32-T23S-R33E
API #30-025-40907
St. Lease #VO-6276
Lea County, NM

District I
1625 N. French Dr., Hobbs, NM 88240

District II
1301 W. Grand Avenue, Artesia, NM 88210

District III
1000 Rio Brazos Rd., Aztec, NM 87410

District IV
1220 S. St. Francis Dr., Santa Fe, NM 87505

State of New Mexico
Energy, Minerals & Natural Resources Department
OIL CONSERVATION DIVISION
1220 South St. Francis Dr.
Santa Fe, NM 87505

Form C-102
Revised June 10, 2003
Submit to Appropriate District Office
State Lease - 4 Copies
Fee Lease - 3 Copies

☐ AMENDED REPORT

WELL LOCATION AND ACREAGE DEDICATION PLAT

¹ API Number 30-025-37561	² Pool Code 96193	³ Pool Name Brinninstool; Delaware
⁴ Property Code 35240	⁵ Property Name Yarrow BHY State	⁶ Well Number 1
⁷ OGRID No. 025575	⁸ Operator Name Yates Petroleum Corporation	⁹ Elevation 3672' GR

¹⁰ Surface Location

UL or lot no.	Section	Township	Range	Lot Idn	Feet from the	North/South line	Feet from the	East/West line	County
A	32	23S	33E	A	990	North	990	East	Lea

¹¹ Bottom Hole Location If Different From Surface

UL or lot no.	Section	Township	Range	Lot Idn	Feet from the	North/South line	Feet from the	East/West line	County

¹² Dedicated Acres 40	¹³ Joint or Infill	¹⁴ Consolidation Code	¹⁵ Order No.
--	-------------------------------	----------------------------------	-------------------------

NO ALLOWABLE WILL BE ASSIGNED TO THIS COMPLETION UNTIL ALL INTERESTS HAVE BEEN CONSOLIDATED OR A NON-STANDARD UNIT HAS BEEN APPROVED BY THE DIVISION

16				17 OPERATOR CERTIFICATION I hereby certify that the information contained herein is true and complete to the best of my knowledge and belief. Signature
				Stormi Davis Printed Name Regulatory Compliance Technician Title and E-mail Address stormid@ypornm.com
				Date 6-29-06
				18 SURVEYOR CERTIFICATION I hereby certify that the well location shown on this plat was plotted from field notes of actual surveys made by me or under my supervision, and that the same is true and correct to the best of my belief.
				Date of Survey Signature and Seal of Professional Surveyor:
				Certificate Number

DISTRICT I
1625 N. French Dr., Hobbs, NM 88240

DISTRICT II
811 South First, Artesia, NM 88201

DISTRICT III
1000 Rio Briscoe Rd., Artesia, NM 87410

DISTRICT IV
2040 South Pecos, Santa Fe, NM 87505

State of New Mexico
Energy, Minerals and Natural Resources Department

FORM L-106
Revised March 17, 1989
Instruction on back
Submit to Appropriate District Office
State Lease - 4 Copies
Fee Lease - 3 Copies

OIL CONSERVATION DIVISION
P.O. Box 2088
Santa Fe, New Mexico 87504-2088

☐ AMENDED REPORT

RECEIVED WELL LOCATION AND ACREAGE DEDICATION PLAT

API Number 30-025-40878		Pool Code 59900	Pool Name Triple X; Bone Spring
Property Code 35240	Property Name YARROW "BHY" STATE		Well Number 2
OCRED No. 025575	Operator Name YATES PETROLEUM CORPORATION		Elevation 3670

Surface Location

UL or lot No.	Section	Township	Range	Lot Idn	Feet from the	North/South line	Feet from the	East/West line	County
H	32	23S	33E		2310	NORTH	330	EAST	LEA

Bottom Hole Location If Different From Surface

UL or lot No.	Section	Township	Range	Lot Idn	Feet from the	North/South line	Feet from the	East/West line	County

Dedicated Acres 40 SENE	Joint or Infill	Consolidation Code	Order No.
-----------------------------------	-----------------	--------------------	-----------

NO ALLOWABLE WILL BE ASSIGNED TO THIS COMPLETION UNTIL ALL INTERESTS HAVE BEEN CONSOLIDATED
OR A NON-STANDARD UNIT HAS BEEN APPROVED BY THE DIVISION

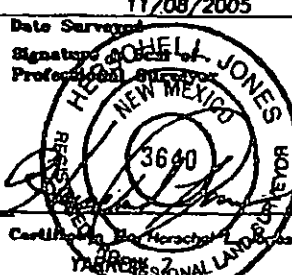
<div style="position: relative; height: 300px;"> <div style="position: absolute; right: 0; top: 0; transform: rotate(90deg);">2310'</div> <div style="position: absolute; right: 0; bottom: 0;">330'</div> <div style="position: absolute; top: 50%; left: 50%; transform: translate(-50%, -50%);"> N.32°15'43.5" W.103°35'12.8" N.459823.7 E.730888.3 (NAD-27) </div> </div>	OPERATOR CERTIFICATION I hereby certify that the information contained herein is true and complete to the best of my knowledge and belief. <div style="text-align: center;">  Signature Printed Name Title Date </div>	
	SURVEYOR CERTIFICATION I hereby certify that the well location shown on this plat was plotted from field notes of actual surveys made by me or under my supervision, and that the same is true and correct to the best of my belief. <div style="text-align: center;"> 11/08/2005 Date Surveyed Signature of Professional Surveyor  Certifying the Accuracy of YATES PETROLEUM CORPORATION GENERAL SURVEYING COMPANY </div>	
	0 330' 660' 990' 1650' 1980' 2310' 2310' 1980' 1650' 990' 660' 330' 0'	

District III
 1000 Rio Brazos Rd., Aztec, NM 87410
 Phone:(505) 334-6178 Fax:(505) 334-6170
District IV
 1220 S. St Francis Dr., Santa Fe, NM 87505
 Phone:(505) 475-3470 Fax:(505) 475-3461

**1220 S. St Francis Dr.
 Santa Fe, NM 87505**

WELL LOCATION AND ACREAGE DEDICATION PLAT

1. API Number 30-025-40314	2. Pool Code 96193	3. Pool Name BRINNENSTOOL,DELAWARE
4. Property Code 35240	5. Property Name YARROW BHY STATE	6. Well No. 003H
7. OGRID No. 25575	8. Operator Name YATES PETROLEUM CORPORATION	9. Elevation 3668

10. Surface Location

UL - Lot B	Section 32	Township 23S	Range 33E	Lot Ldr.	Feet From 330	N/S Line N	Feet From 2280	E/W Line E	County LEA
---------------	---------------	-----------------	--------------	----------	------------------	---------------	-------------------	---------------	---------------

11. Bottom Hole Location If Different From Surface

UL - Lot O	Section 32	Township 23S	Range 33E	Lot Ldr. O	Feet From 330	N/S Line S	Feet From 1980	E/W Line E	County LEA
12. Dedicated Acres 160.00		13. Joint or Infill		14. Consolidation Code			15. Order No.		

NO ALLOWABLE WILL BE ASSIGNED TO THIS COMPLETION UNTIL ALL INTERESTS HAVE BEEN CONSOLIDATED OR A NON-STANDARD UNIT HAS BEEN APPROVED BY THE DIVISION

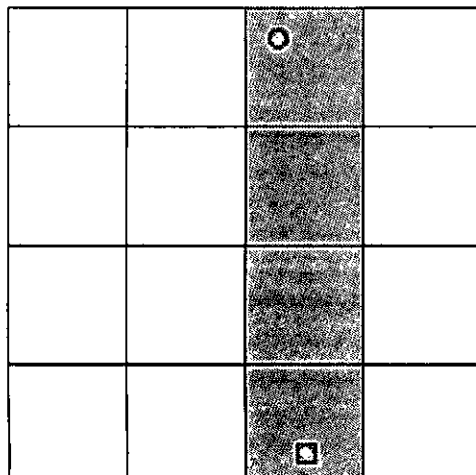

OPERATOR CERTIFICATION

I hereby certify that the information contained herein is true and complete to the best of my knowledge and belief, and that this organization either owns a working interest or unleased mineral interest in the land including the proposed bottom hole location(s) or has a right to drill this well at this location pursuant to a contract with an owner of such a mineral or working interest, or to a voluntary pooling agreement or a compulsory pooling order heretofore entered by the division.

E-Signed By: Monti Sanders

Title:

Date: 10/19/2011

SURVEYOR CERTIFICATION

I hereby certify that the well location shown on this plat was plotted from field notes of actual surveys made by me or under my supervision, and that the same is true and correct to the best of my belief.

Surveyed By: Gary Jones

Date of Survey: 9/13/2011

Certificate Number: 7977

DISTRICT I
1825 N. French Dr., Hobbs, NM 88240
Phone (575) 393-6161 Fax: (575) 393-0720
DISTRICT II
1301 W. Grand Avenue, Artesia, NM 88210
Phone (505) 744-1283 Fax: (575) 744-0720
DISTRICT III
1000 Rio Brazos Rd., Aztec, NM 87410
Phone (505) 334-8176 Fax: (505) 334-8170
DISTRICT IV
1220 S. St. Francis Dr., Santa Fe, NM 87505
Phone (505) 476-3460 Fax: (505) 476-3462

HOESOOD

MAR 10 10 13

State of New Mexico
Energy, Minerals and Natural Resources Department

CONSERVATION DIVISION
1220 South St. Francis Dr.
Santa Fe, New Mexico 87505

Form C-102
Revised August 1, 2011

Submit one copy to appropriate
District Office

RECEIVED

WELL LOCATION AND ACREAGE DEDICATION PLAT

☐ AMENDED REPORT

API Number 30-025-41054	Pool Code 59900	Pool Name Triple X Wildcat/2nd Bone Springs
Property Code 35240	Property Name YARROW BHY STATE	Well Number 4H
OGRID No. 025575	Operator Name YATES PETROLEUM CORP.	Elevation 3667'

Surface Location

UL or lot No.	Section	Township	Range	Lot Idn	Feet from the	North/South line	Feet from the	East/West line	County
B	32	23 S	33 E		475	NORTH	2043	EAST	LEA

Bottom Hole Location If Different From Surface

UL or lot No.	Section	Township	Range	Lot Idn	Feet from the	North/South line	Feet from the	East/West line	County
O	32	23 S	33 E		330	SOUTH	1980	EAST	LEA

Dedicated Acres	Joint or Infill	Consolidation Code	Order No.
160			

NO ALLOWABLE WILL BE ASSIGNED TO THIS COMPLETION UNTIL ALL INTERESTS HAVE BEEN CONSOLIDATED
OR A NON-STANDARD UNIT HAS BEEN APPROVED BY THE DIVISION

N 462171.359 E 767105.970 (NAD-83)	N 462182.406 E 769762.803 (NAD-83)	N 462194.004 E 772384.561 (NAD-83)	<p>OPERATOR CERTIFICATION</p> <p>I hereby certify that the information contained herein is true and complete to the best of my knowledge and belief, and that this organization either owns a working interest or unleased mineral interest in the land including the proposed bottom hole location or has a right to drill this well at this location pursuant to a contract with an owner of such a mineral or working interest, or to a voluntary pooling agreement or a compulsory pooling order heretofore entered by the division.</p> <p><i>[Signature]</i> 3/8/2013 Signature Date</p> <p>Travis Hahn Printed Name</p> <p>thahn@yatespetroleum.com Email Address</p> <p>SURVEYOR CERTIFICATION</p> <p>I hereby certify that the well location shown on this plat was plotted from field notes of actual surveys made by me or under my supervision, and that the same is true and correct to the best of my belief.</p> <p>DECEMBER 2012 Date Surveyed</p> <p><i>[Signature]</i> Signature of Professional Surveyor</p> <p>7977 No.</p> <p>Certificate No. Barry L. Jones 7977</p> <p>BASIN SURVEYS 27776</p>
<p>SURFACE LOCATION</p> <p>Lat - N 32°16'01.72" Long - W 103°35'32.73" NAD-83 N 461710.238 E 770345.045 (NAD-83)</p>			
<p>PROPOSED BOTTOM HOLE LOCATION</p> <p>Lat - N 32°15'17.43" Long - W 103°35'31.94" NAD-83 N 457235.172 E 770443.455 (NAD-83)</p>			
N 561784.32 E 780341.29 (NAD-83)	N 459553.375 E 772402.870 (NAD-83)	N 456914.598 E 772425.942 (NAD-83)	

MAR 13 2013

DISTRICT I
1625 N. French Dr., Hobbs, NM 88240
Phone (575) 393-8181 Fax: (575) 393-0722
DISTRICT II
1301 W. Grand Avenue, Artesia, NM 88210
Phone (575) 748-1253 Fax: (575) 748-9720
DISTRICT III
1000 Rio Brazos Rd., Aztec, NM 87410
Phone (505) 334-8178 Fax: (505) 334-8170
DISTRICT IV
1220 S. St. Francis Dr., Santa Fe, NM 87505
Phone (505) 476-3400 Fax: (505) 476-3482

State of New Mexico
Energy, Minerals and Natural Resources Department

Form C-102
Revised August 1, 2011

Submit one copy to appropriate
District Office

OIL CONSERVATION DIVISION
1220 South St. Francis Dr.
Santa Fe, New Mexico 87505

WELL LOCATION AND ACREAGE DEDICATION PLAT

☐ AMENDED REPORT

API Number 30-025-40907	Pool Code 5990	Pool Name Triple X 2nd Bone Springs
Property Code 35240	Property Name YARROW BHY STATE	Well Number 5H
GRID No. 025575	Operator Name YATES PETROLEUM CORP.	Elevation 3663'

Surface Location

UL or lot No.	Section	Township	Range	Lot Idn	Feet from the	North/South line	Feet from the	East/West line	County
A	32	23 S	33 E		200	NORTH	660	EAST	LEA

Bottom Hole Location If Different From Surface

UL or lot No.	Section	Township	Range	Lot Idn	Feet from the	North/South line	Feet from the	East/West line	County
P	32	23 S	33 E		330	SOUTH	660	EAST	LEA

Dedicated Acres 160	Joint or Infill	Consolidation Code	Order No.
------------------------	-----------------	--------------------	-----------

NO ALLOWABLE WILL BE ASSIGNED TO THIS COMPLETION UNTIL ALL INTERESTS HAVE BEEN CONSOLIDATED
OR A NON-STANDARD UNIT HAS BEEN APPROVED BY THE DIVISION

N 462171.359 E 767105.970 (NAD-83)	N 462182.406 E 769762.803 (NAD-83)	<p>SURFACE LOCATION Lat - N 32°16'04.40" Long - W 103°35'16.62" NAD83 - N 461991.118 E 771726.081 (NAD-83)</p> <p>Penetration Point: 672' FNL & 660' FWL</p> <p>Producing Zone: →</p> <p>Project Area: →</p>	<p>SL N 462194.004 E 772384.561 (NAD-83)</p> <p>660'</p> <p>200'</p> <p>4750.8'</p> <p>N 459553.375 E 772402.870 (NAD-83)</p> <p>660'</p> <p>B.H. N 456914.598 E 772425.942 (NAD-83)</p> <p>330'</p>	<p>OPERATOR CERTIFICATION I hereby certify that the information contained herein is true and complete to the best of my knowledge and belief, and that this organization either owns a working interest or unleased mineral interest in the land including the proposed bottom hole location or has a right to drill this well at this location pursuant to a contract with an owner of such a mineral or working interest, or to a voluntary pooling agreement or a compulsory pooling order heretofore entered by the division.</p> <p><i>Travis Hahn</i> 1/3/12 Signature Date</p> <p>Travis Hahn Printed Name thahn@yatespetroleum.com Email Address</p>
N 459529.883 E 767123.302 (NAD-83)	N 456902.094 E 769781.465 (NAD-83)	<p>PROPOSED BOTTOM HOLE LOCATION Lat - N 32°15'17.40" Long - W 103°35'16.57" NAD83 - N 457241.405 E 771763.198 (NAD-83)</p>	<p>SURVEYOR CERTIFICATION I hereby certify that the well location shown on this plat was plotted from field notes of actual surveys made by me or under my supervision, and that the same is true and correct to the best of my belief.</p> <p>NOVEMBER 13 2012 Date Surveyed</p> <p><i>[Signature]</i> Signature of Professional Surveyor</p> <p>No. 27691 Certificate No. 7977</p> <p>BASIN SURVEYS 27691</p>	

District I
1625 N. French Dr., Hobbs, NM 88240
Phone: (575) 393-6161 Fax: (575) 393-0720
District II
811 S First St., Artesia, NM 88210
Phone: (575) 748-1283 Fax: (575) 748-9720
District III
1000 Rio Brazos Road, Aztec, NM 87410
Phone: (505) 334-6178 Fax: (505) 334-6170
District IV
1220 S. St. Francis Dr., Santa Fe, NM 87505
Phone: (505) 476-3460 Fax: (505) 476-3462

State of New Mexico
Energy, Minerals & Natural Resources Department
OIL CONSERVATION DIVISION
1220 South St. Francis Dr.
Santa Fe, NM 87505

Form C-102
Revised August 1, 2011
Submit one copy to appropriate
District Office

☐ AMENDED REPORT

WELL LOCATION AND ACREAGE DEDICATION PLAT

¹ API Number 30-025-40489		² Pool Code 59900	³ Pool Name Triple X; Bone Spring
⁴ Property Code 39118	⁵ Property Name Hemlock BSH State		⁶ Well Number 1H
⁷ OGRID No. 025575	⁸ Operator Name Yates Petroleum Corporation		⁹ Elevation 3667' GR

¹⁰ Surface Location

UL or lot no.	Section	Township	Range	Lot Idn	Feet from the	North/South line	Feet from the	East/West line	County
C	32	23S	33E		330	North	1980	West	Lea

¹¹ Bottom Hole Location If Different From Surface

UL or lot no.	Section	Township	Range	Lot Idn	Feet from the	North/South line	Feet from the	East/West line	County
N	32	23S	33E		355	South	1982	West	Lea
¹² Dedicated Acres 160	¹³ Joint or Infill	¹⁴ Consolidation Code	¹⁵ Order No. 49260						

No allowable will be assigned to this completion until all interests have been consolidated or a non-standard unit has been approved by the division.

¹⁶ 	¹⁷ OPERATOR CERTIFICATION I hereby certify that the information contained herein is true and complete to the best of my knowledge and belief, and that this organization either owns a working interest or leased mineral interest in the land including the proposed bottom hole location or has a right to drill this well at this location pursuant to a contract with an owner of such a mineral or working interest, or to a voluntary pooling agreement or a compulsory pooling order heretofore entered by the division. Signature Date November 15, 2012 Tina Huerta Printed Name tina@yatespetroleum.com E-mail Address	
	¹⁸ SURVEYOR CERTIFICATION I hereby certify that the well location shown on this plat was plotted from field notes of actual surveys made by me or under my supervision, and that the same is true and correct to the best of my belief. Date of Survey Signature and Seal of Professional Surveyor:	
	Certificate Number	

DISTRICT I

1625 N. French Dr., Hobbs, NM 88240

Phone (505) 393-6161 Fax: (505) 393-6162

DISTRICT II

1301 W. Grand Avenue, Artesia, NM 88210

Phone (505) 748-1253 Fax: (505) 748-9720

DISTRICT III

1000 Rio Brazos Rd., Aztec, NM 87410

Phone (505) 334-6176 Fax: (505) 334-6170

DISTRICT IV

1220 S. St. Francis Dr., Santa Fe, NM 87505

Phone (505) 476-3486 Fax: (505) 476-3482

State of New Mexico
Energy, Minerals and Natural Resources Department

Form C-102

Revised August 1, 2011

Submit one copy to appropriate
District Office

OIL CONSERVATION DIVISION

1220 South St. Francis Dr.
Santa Fe, New Mexico 87505

WELL LOCATION AND ACREAGE DEDICATION PLAT

□ AMENDED REPORT

API Number 30-025-40891	Pool Code 59900	Pool Name Triplex Undesignated/2nd Bone Springs
Property Code 39118	Property Name HEMLOCK BSH STATE	Well Number 2H
OGRID No. 025575	Operator Name YATES PETROLEUM CORP.	Elevation 3671'

Surface Location

UL or lot No.	Section	Township	Range	Lot Idn	Feet from the	North/South line	Feet from the	East/West line	County
D	32	23 S	33 E		220	NORTH	580	WEST	LEA

Bottom Hole Location If Different From Surface

UL or lot No.	Section	Township	Range	Lot Idn	Feet from the	North/South line	Feet from the	East/West line	County
M	32	23 S	33 E		330	SOUTH	660	WEST	LEA
Dedicated Acres 160	Joint or Infill	Consolidation Code	Order No.						

NO ALLOWABLE WILL BE ASSIGNED TO THIS COMPLETION UNTIL ALL INTERESTS HAVE BEEN CONSOLIDATED
OR A NON-STANDARD UNIT HAS BEEN APPROVED BY THE DIVISION

<p>580' SL</p> <p>N 462171.359 E 767105.970 (NAD-83)</p> <p>SURFACE LOCATION Lot - N 32°16'04.31" Long - W 103°36'03.66" NMSPC- N 461953.770 E 767687.410 (NAD-83)</p> <p>Penetration Point: 695' FNL & 586' FWL</p> <p>Producing Zone</p> <p>Project Area</p> <p>N 459529.883 E 767123.302 (NAD-83)</p> <p>N 456889.460 E 767141.634 (NAD-83)</p> <p>680' B.H.</p> <p>330'</p> <p>PROPOSED BOTTOM HOLE LOCATION Lot - N 32°15'17.48" Long - W 103°36'02.73" NMSPC- N 457222.511 E 767799.187 (NAD-83)</p> <p>N 462182.406 E 769762.803 (NAD-83)</p> <p>N 462194.004 E 772384.561 (NAD-83)</p> <p>N 459553.375 E 772402.870 (NAD-83)</p> <p>N 456902.094 E 769781.465 (NAD-83)</p> <p>N 456914.598 E 772425.942 (NAD-83)</p>			<p>OPERATOR CERTIFICATION</p> <p>I hereby certify that the information contained herein is true and complete to the best of my knowledge and belief, and that this organization either owns a working interest or unleased mineral interest in the land including the proposed bottom hole location or has a right to drill this well at this location pursuant to a contract with an owner of such a mineral or working interest, or to a voluntary pooling agreement or a compulsory pooling order heretofore entered by the division.</p> <p><i>Travis Hahn</i> 1/9/13 Signature Date</p> <p>Travis Hahn Printed Name</p> <p>thahn@yatespetroleum.com Email Address</p>	
			<p>SURVEYOR CERTIFICATION</p> <p>I hereby certify that the well location shown on this plat was plotted from field notes of actual surveys made by me or under my supervision and that the same is true and correct to the best of my belief.</p> <p>JANUARY 08 2013 Date Surveyed</p> <p><i>[Signature]</i> Signature of Professional Surveyor</p> <p>No. 27777</p> <p>Certificate No. Gary L. Jones 7977</p> <p>BASIN SURVEYS 27777</p>	

★ Amended



105 South 4th Street
Artesia, NM 88210
(575) 748-1471

Joe Chaves
May 2013

Yarrow BHY State #1 Battery

990' FNL & 990' FEL Sec 32-T23S-R33E Unit A
Eddy County, NM
API #3002537561

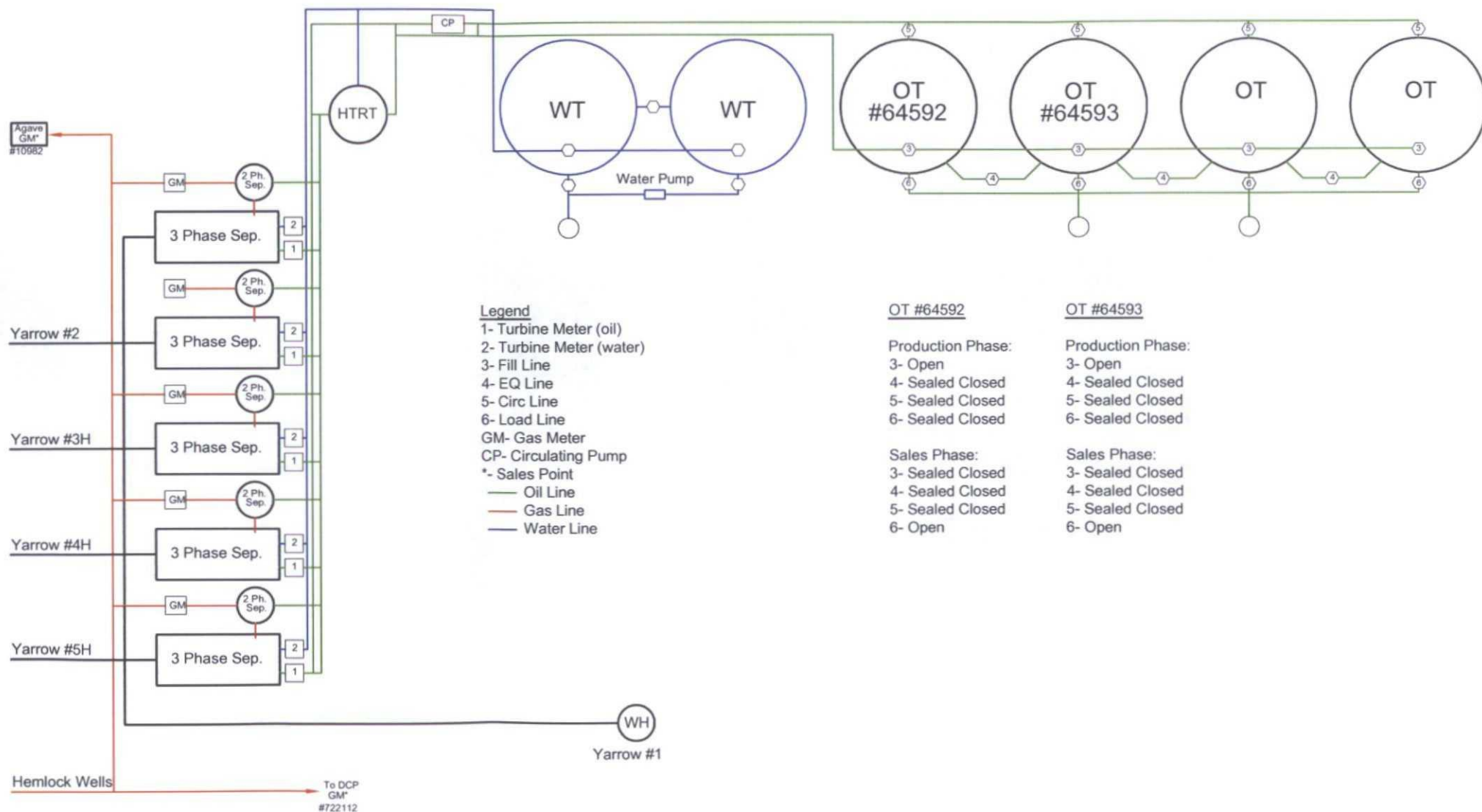

This diagram is subject to the Yates Petroleum Corporation August 1983 Security Plan which is on file at 105 South 4th Street, Artesia, NM.



105 South 4th Street
Artesia, NM 88210
(575) 748-1471

Joe Chaves
July 2012

Hemlock BSH State #1H Battery

330' FNL & 1980' FWL Sec 32-T23S-R33E Unit C

Eddy County, NM

API #3002540489

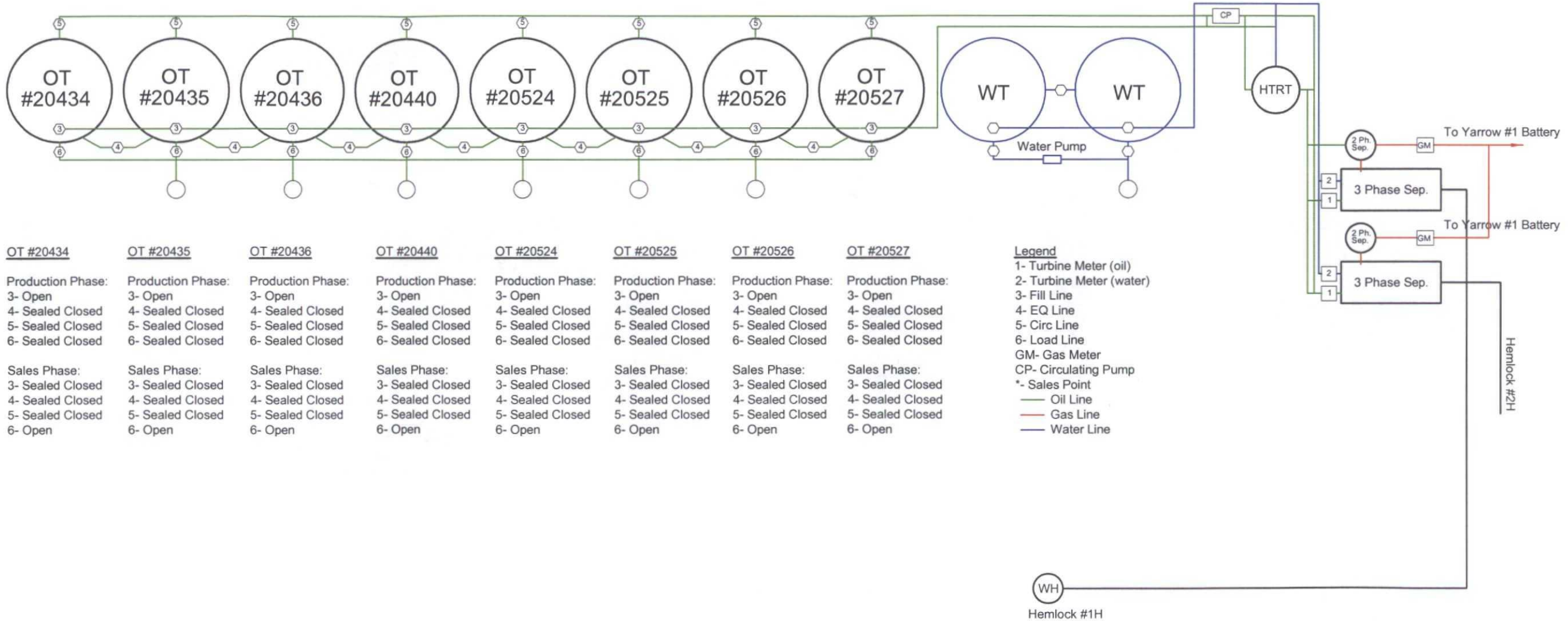

This diagram is subject to the Yates Petroleum Corporation August 1983 Security Plan which is on file at 105 South 4th Street, Artesia, NM.

MARTIN YATES, III
1912-1985

FRANK W. YATES
1936-1986

S.P. YATES
1914-2008



105 SOUTH FOURTH STREET
ARTESIA, NEW MEXICO 88210-2118

TELEPHONE (575) 748-1471

www.yatespetroleum.com

JOHN A. YATES
CHAIRMAN EMERITUS

JOHN A. YATES JR.
CHAIRMAN OF THE BOARD
PRESIDENT

JOHN D. PERINI
EXECUTIVE VICE PRESIDENT
CHIEF FINANCIAL OFFICER

JAMES S. BROWN
CHIEF OPERATING OFFICER

May 9, 2013

RE: Surface Pool/Lease Commingle
Hemlock BSH State #2H
Lea County, New Mexico

Dear Interest Owner,

Yates Petroleum is notifying you of an amendment to PLC-358-A previously approved on 3/22/13. This request consists of the addition of oil and gas commingled as follows:

Hemlock #1H & 2H oil commingled at the Hemlock battery located at Sec. 32-T23S-R33E- ownership diversified
Yarrow 1, 2, 3H, 4H & 5H oil commingled at the Yarrow battery located at Sec. 32-T23S-R33E- diverse pools, same ownership
Gas from all the wells to be commingled at CDP- ownership/pools diversified

Oil Measurement

Each of these wells will be equipped with continuously metering separators for oil production prior to oil being commingled for sales at the battery. Total sales/production will be allocated back to each individual well using the metered (daily well tests) volumes. Metered volumes will be compared to totals battery volumes daily and monthly for accuracy. Any vapor recovery gas shall be included in this application.

Estimated daily oil production for the Hemlock #1H is 250 bbls with a gravity of 43.0 and for the Hemlock #2H is 300 bbls.

Estimated daily oil production for the Yarrow #1 is marginal, 0-3 bbls with gravity of 35.4 and for the Yarrow 2-5 is 300 bbls for each well.

Gas Measurement- Yarrow CDP

Total gas production and sales will be based on the measurement at the CDP and allocated back to each well based on EFM readings. The Agave's meter #10982 is located at the Yarrow #1. DCP meter #722112 alternate route, if needed.

Estimated daily gas production for the Hemlock #1H is 165 MCF, for the Hemlock #2H is 300 MCF with 1450 BTU. The Yarrow #1 gas production is marginal, 0-5 MCF with 1390 BTU and estimated daily production for the Yarrow #2- #5 is 500 MCF for each well.

The purpose of the Surface Pool/Lease Commingle is in the interest of conservation, economic feasibility, the reduction of environmental impact area, and overall emissions. It will not result in reduced royalty or improper measurement of production. Without approval for utilizing the same battery, it will become necessary to build separate facilities for each well. This will greatly increase costs and shorten the economic life of all the wells.

Please see attached list of all wells.

If you have any questions, please call me at (575) 748-4200

Sincerely,

Miriam Morales

I hereby approve this application

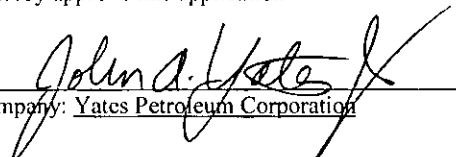
Company: Yates Petroleum Corporation

KATHY H. PORTER
SECRETARY

DENNIS G. KINSEY
TREASURER

MARTIN YATES, III
1912-1985

FRANK W. YATES
1936-1986

S.P. YATES
1914-2008



105 SOUTH FOURTH STREET
ARTESIA, NEW MEXICO 88210-2118

TELEPHONE (575) 748-1471

www.yatespetroleum.com

JOHN A. YATES
CHAIRMAN EMERITUS

JOHN A. YATES JR.
CHAIRMAN OF THE BOARD
PRESIDENT

JOHN D. PERINI
EXECUTIVE VICE PRESIDENT
CHIEF FINANCIAL OFFICER

JAMES S. BROWN
CHIEF OPERATING OFFICER

May 9, 2013

RE: Surface Pool/Lease Commingle
Hemlock BSH State #2H
Lea County, New Mexico

Dear Interest Owner,

Yates Petroleum is notifying you of an amendment to PLC-358-A previously approved on 3/22/13. This request consists of the addition of oil and gas commingled as follows:

Hemlock #1H & 2H oil commingled at the Hemlock battery located at Sec. 32-T23S-R33E- ownership diversified
Yarrow 1, 2, 3H, 4H & 5H oil commingled at the Yarrow battery located at Sec. 32-T23S-R33E- diverse pools, same ownership
Gas from all the wells to be commingled at CDP- ownership/pools diversified

Oil Measurement

Each of these wells will be equipped with continuously metering separators for oil production prior to oil being commingled for sales at the battery. Total sales/production will be allocated back to each individual well using the metered (daily well tests) volumes. Metered volumes will be compared to totals battery volumes daily and monthly for accuracy. Any vapor recovery gas shall be included in this application.

Estimated daily oil production for the Hemlock #1H is 250 bbls with a gravity of 43.0 and for the Hemlock #2H is 300 bbls.

Estimated daily oil production for the Yarrow #1 is marginal, 0-3 bbls with gravity of 35.4 and for the Yarrow 2-5 is 300 bbls for each well.

Gas Measurement- Yarrow CDP

Total gas production and sales will be based on the measurement at the CDP and allocated back to each well based on EFM readings. The Agave's meter #10982 is located at the Yarrow #1. DCP meter #722112 alternate route, if needed.

Estimated daily gas production for the Hemlock #1H is 165 MCF, for the Hemlock #2H is 300 MCF with 1450 BTU. The Yarrow #1 gas production is marginal, 0-5 MCF with 1390 BTU and estimated daily production for the Yarrow #2- #5 is 500 MCF for each well.

The purpose of the Surface Pool/Lease Commingle is in the interest of conservation, economic feasibility, the reduction of environmental impact area, and overall emissions. It will not result in reduced royalty or improper measurement of production. Without approval for utilizing the same battery, it will become necessary to build separate facilities for each well. This will greatly increase costs and shorten the economic life of all the wells.

Please see attached list of all wells.

If you have any questions, please call me at (575) 748-4200

Sincerely,

Miriam Morales

I hereby approve this application

Company: Abo Petroleum Corporation

KATHY H. PORTER
SECRETARY

DENNIS G. KINSEY
TREASURER

MARTIN YATES, III
1912-1985

FRANK W. YATES
1936-1986

S.P. YATES
1914-2008



105 SOUTH FOURTH STREET
ARTESIA, NEW MEXICO 88210-2118

TELEPHONE (575) 748-1471

www.yatespetroleum.com

JOHN A. YATES
CHAIRMAN EMERITUS

JOHN A. YATES JR.
CHAIRMAN OF THE BOARD
PRESIDENT

JOHN D. PERINI
EXECUTIVE VICE PRESIDENT
CHIEF FINANCIAL OFFICER

JAMES S. BROWN
CHIEF OPERATING OFFICER

May 9, 2013

RE: Surface Pool/Lease Commingle
Hemlock BSH State #2H
Lea County, New Mexico

Dear Interest Owner,

Yates Petroleum is notifying you of an amendment to PLC-358-A previously approved on 3/22/13. This request consists of the addition of oil and gas commingled as follows:

Hemlock #1H & 2H oil commingled at the Hemlock battery located at Sec. 32-T23S-R33E- ownership diversified
Yarrow 1, 2, 3H, 4H & 5H oil commingled at the Yarrow battery located at Sec. 32-T23S-R33E- diverse pools, same ownership
Gas from all the wells to be commingled at CDP- ownership/pools diversified

Oil Measurement

Each of these wells will be equipped with continuously metering separators for oil production prior to oil being commingled for sales at the battery. Total sales/production will be allocated back to each individual well using the metered (daily well tests) volumes. Metered volumes will be compared to totals battery volumes daily and monthly for accuracy. Any vapor recovery gas shall be included in this application.

Estimated daily oil production for the Hemlock #1H is 250 bbls with a gravity of 43.0 and for the Hemlock #2H is 300 bbls.

Estimated daily oil production for the Yarrow #1 is marginal, 0-3 bbls with gravity of 35.4 and for the Yarrow 2-5 is 300 bbls for each well.

Gas Measurement- Yarrow CDP

Total gas production and sales will be based on the measurement at the CDP and allocated back to each well based on EFM readings. The Agave's meter #10982 is located at the Yarrow #1. DCP meter #722112 alternate route, if needed.

Estimated daily gas production for the Hemlock #1H is 165 MCF, for the Hemlock #2H is 300 MCF with 1450 BTU. The Yarrow #1 gas production is marginal, 0-5 MCF with 1390 BTU and estimated daily production for the Yarrow #2- #5 is 500 MCF for each well.

The purpose of the Surface Pool/Lease Commingle is in the interest of conservation, economic feasibility, the reduction of environmental impact area, and overall emissions. It will not result in reduced royalty or improper measurement of production. Without approval for utilizing the same battery, it will become necessary to build separate facilities for each well. This will greatly increase costs and shorten the economic life of all the wells.

Please see attached list of all wells.

If you have any questions, please call me at (575) 748-4200

Sincerely,

Miriam Morales

I hereby approve this application

Company: Myco Industries, Inc

KATHY H. PORTER
SECRETARY

DENNIS G. KINSEY
TREASURER

MARTIN YATES, III
1912-1985

FRANK W. YATES
1936-1986

S.P. YATES
1914-2008



105 SOUTH FOURTH STREET
ARTESIA, NEW MEXICO 88210-2118

TELEPHONE (575) 748-1471

www.yatespetroleum.com

JOHN A. YATES
CHAIRMAN EMERITUS

JOHN A. YATES JR.
CHAIRMAN OF THE BOARD
PRESIDENT

JOHN D. PERINI
EXECUTIVE VICE PRESIDENT
CHIEF FINANCIAL OFFICER

JAMES S. BROWN
CHIEF OPERATING OFFICER

May 9, 2013

RE: Surface Pool/Lease Commingle
Hemlock BSH State #2H
Lea County, New Mexico

Dear Interest Owner,

Yates Petroleum is requesting administrative approval from the Oil Conservation Division and the State Land Office to amend PLC-358-A previously approved on 3/22/13. This request consists of an addition of oil and gas commingled as follows:

Hemlock #1H & 2H oil commingled at the Hemlock battery located at Sec. 32-T23S-R33E- ownership diversified
Yarrow 1, 2, 3H, 4H & 5H oil commingled at the Yarrow battery located at Sec. 32-T23S-R33E- diverse pools, same ownership
Gas from all the wells to be commingled at CDP- ownership/pools diversified

Oil Measurement

Each of these wells will be equipped with continuously metering separators for oil production prior to oil being commingled for sales at the battery. Total sales/production will be allocated back to each individual well using the metered (daily well tests) volumes. Metered volumes will be compared to totals battery volumes daily and monthly for accuracy. Any vapor recovery gas shall be included in this application.

Estimated daily oil production for the Hemlock #1H is 250 bbls with a gravity of 43.0 and for the Hemlock #2H is 300 bbls.

Estimated daily oil production for the Yarrow #1 is marginal, 0-3 bbls with gravity of 35.4 and for the Yarrow 2-5 is 300 bbls for each well.

Gas Measurement- Yarrow CDP

Total gas production and sales will be based on the measurement at the CDP and allocated back to each well based on EFM readings. The Agave's meter #10982 is located at the Yarrow #1. DCP meter #722112 alternate route, if needed.

Estimated daily gas production for the Hemlock #1H is 165 MCF, for the Hemlock #2H is 300 MCF with 1450 BTU. The Yarrow #1 gas production is marginal, 0-5 MCF with 1390 BTU and estimated daily production for the Yarrow #2- #5 is 500 MCF for each well.

The purpose of the Surface Pool/Lease Commingle is in the interest of conservation, economic feasibility, the reduction of environmental impact area, and overall emissions. It will not result in reduced royalty or improper measurement of production. Without approval for utilizing the same battery, it will become necessary to build separate facilities for each well. This will greatly increase costs and shorten the economic life of all the wells.

Please see attached list of all wells.

Any objection must be filed in writing with the Oil Conservation Division in Santa Fe within 20 days from the date the division receives the application. Application will be sent in conjunction with notification to owners.

If you have any questions, please call me at (575) 748-4200 (direct line)

Sincerely,

Miriam Morales
Production Analyst

KATHY H. PORTER
SECRETARY

DENNIS G. KINSEY
TREASURER

Attachment for Hemlock BSH State #2H, amended PLC-358-A

Hemlock BSH St. #1H
Triple X; Bone Spring
Sec. 32-T23S-R33E
API #30-025-40489
St. Lease #VB-1169
Lea County, NM

Hemlock BSH State #2H
Triple X; Bone Spring
Sec. 32-T23S-R33E
API #30-025-40891
St. Lease #VB-1169
Lea County, NM

Yarrow BHY State #1
Brinningstool; Delaware
Sec. 32-T23S-R33E
API #30-025-37561
St. Lease #VO-6276
Lea County, NM

Yarrow BHY State #2
Triple X; Bone Spring
Sec. 32-T23S-R33E
API #30-025-40878
St. Lease #VO-6276
Lea County, NM

Yarrow BHY State #3H
Brinningstool; Delaware
Sec. 32-T23S-R33E
API #30-025-40314
St. lease #VO-6276
Lea County, NM

Yarrow BHY State #4H
Triple X; Bone Spring
Sec. 32-T23S-R33E
API #30-025-41054
St. Lease #VO-6276
Lea County, NM

Yarrow BHY St. #5H
Triple X; Bone Spring
Sec. 32-T23S-R33E
API #30-025-40907
St. Lease #VO-6276
Lea County, NM



YATES BUILDING - 105 SOUTH FOURTH STREET
ARTESIA, NEW MEXICO 88210

ADDRESS SERVICE REQUESTED

CERTIFIED MAIL™

7012 3460 0001 7460 3642
7012 3460 0001 7460 3642

PS Form 3800, August 2006

See Reverse for Instructions

Sent to: SHARBRO ENERGY LLC
Street, Apt. No., or PO Box No. P O BOX 840
City, State, ZIP+4 ARTESIA, NM 88211-0840

Postage \$
Certified Fee
Return Receipt Fee (Endorsement Required)
Restricted Delivery Fee (Endorsement Required)
Total Postage & Fees \$

Postmark Here

U.S. Postal Service™
CERTIFIED MAIL™ RECEIPT
(Domestic Mail Only; No Insurance Coverage Provided)

For delivery information visit our website at www.usps.com

Handwritten: HERRINGTON, CALME 389 U.S. 1/3

SHARBRO ENERGY LLC
P O BOX 840
ARTESIA, NM 88211-0840

PLACE STICKER AT TOP OF ENVELOPE TO THE RIGHT OF THE RETURN ADDRESS, FOLD AT DOTTED LINE

SENDER: COMPLETE THIS SECTION		COMPLETE THIS SECTION ON DELIVERY	
<ul style="list-style-type: none">Complete items 1, 2, and 3. Also complete item 4 if Restricted Delivery is desired.Print your name and address on the reverse so that we can return the card to you.Attach this card to the back of the mailpiece, or on the front if space permits.		A. Signature X <input type="checkbox"/> Agent <input type="checkbox"/> Addressee	
1. Article Addressed to: SHARBRO ENERGY LLC P O BOX 840 ARTESIA, NM 88211-0840		B. Received by (Printed Name)	C. Date of Delivery
2. Article Number (Transfer from 5) 7012 3460 0001 7460 3642		D. Is delivery address different from item 1? <input type="checkbox"/> Yes If YES, enter delivery address below: <input type="checkbox"/> No	
		3. Service Type <input checked="" type="checkbox"/> Certified Mail <input type="checkbox"/> Express Mail <input type="checkbox"/> Registered <input type="checkbox"/> Return Receipt for Merchandise <input type="checkbox"/> Insured Mail <input type="checkbox"/> C.O.D.	
		4. Restricted Delivery? (Extra Fee) <input type="checkbox"/> Yes	

PS Form 3811, February 2004 Domestic Return Receipt 102595-02-M-1540



YATES BUILDING - 105 SOUTH FOURTH STREET
ARTESIA, NEW MEXICO 88210

ADDRESS SERVICE REQUESTED

7012 3460 0001 7460 3697

7012 3460 0001 7460 3697

U.S. Postal Service CERTIFIED MAIL RECEIPT (Domestic Mail Only; No Insurance Coverage Provided)	
For delivery information visit our website at www.usps.com	
New York, NY 10001-3460	
Postage	\$
Certified Fee	
Return Receipt Fee (Endorsement Required)	
Restricted Delivery Fee (Endorsement Required)	
Total Postage & Fees	\$
Postmark Here	
Sent To: OXY-Y-1 Company	
Street, Apt. No.: P.O. Box 841803	
or PO Box No. Dallas, TX 75284-1803	
City, State, ZIP	
PS Form 3800, August 2006 See Reverse for Instructions	

OXY-Y-1 Company
P.O. Box 841803
Dallas, TX 75284-1803

SENDER COMPLETE THIS SECTION

- Complete items 1, 2, and 3. Also complete item 4 if Restricted Delivery is desired.
- Print your name and address on the reverse so that we can return the card to you.
- Attach this card to the back of the mailpiece, or on the front if space permits.

1. Article Addressed to:

OXY-Y-1 Company
P.O. Box 841803
Dallas, TX 75284-1803

2. Article Number
(Transfer from se)

7012 3460 0001 7460 3697

COMPLETE THIS SECTION ON DELIVERY

A. Signature

X

☐ Agent

☐ Addressee

B. Received by (Printed Name)

C. Date of Delivery

D. Is delivery address different from item 1? ☐ Yes
If YES, enter delivery address below: ☐ No

3. Service Type

☒ Certified Mail

☐ Express Mail

☐ Registered

☐ Return Receipt for Merchandise

☐ Insured Mail

☐ C.O.D.

4. Restricted Delivery? (Extra Fee)

☐ Yes



YATES BUILDING - 105 SOUTH FOURTH STREET
ARTESIA, NEW MEXICO 88210

ADDRESS SERVICE REQUESTED

CERTIFIED MAIL

7012 3460 0001 7460 3659
7012 3460 0001 7460 3659

Sent to
Street, Apt. No.,
or PO Box No. **10 N SLO.**
City, State, ZIP+4[®] **310 Old Santa Fe Trail**
Santa Fe NM 87504
PS Form 3800, August 2006 See Reverse for Instructions

Postage \$
Certified Fee
Return Receipt Fee
(Endorsement Required)
Restricted Delivery Fee
(Endorsement Required)
Total Postage & Fees \$

Postmark
Here

Heard & H. Co. P.O. Box 1148 Santa Fe, NM 87504

For delivery information visit our website at www.usps.com

U.S. Postal Service
CERTIFIED MAIL™ RECEIPT
(Domestic Mail Only; No Insurance Coverage Provided)

New Mexico State Land C
Commissioner of Public L
310 Old Santa Fe Trail
P.O. Box 1148
Santa Fe, New Mexico 87

PLACE STICKER AT TOP OF ENVELOPE TO THE RIGHT
OF THE RETURN ADDRESS, FOLD AT DOTTED LINE

SENDER: COMPLETE THIS SECTION

- Complete items 1, 2, and 3. Also complete item 4 if Restricted Delivery is desired.
- Print your name and address on the reverse so that we can return the card to you.
- Attach this card to the back of the mailpiece, or on the front if space permits.

1. Article Addressed to:

New Mexico State Land Office
Commissioner of Public Lands
310 Old Santa Fe Trail
P.O. Box 1148
Santa Fe, New Mexico 87504-1148

2. Article Number
(Transfer from si

7012 3460 0001 7460 3659

COMPLETE THIS SECTION ON DELIVERY

A. Signature

X

☐ Agent

☐ Addressee

B. Received by (Printed Name)

C. Date of Delivery

D. Is delivery address different from item 1? ☐ Yes
If YES, enter delivery address below: ☐ No

3. Service Type

☒ Certified Mail

☐ Express Mail

☐ Registered

☐ Return Receipt for Merchandise

☐ Insured Mail

☐ C.O.D.

4. Restricted Delivery? (Extra Fee)

☐ Yes