



OIL CONSERVATION DIVISION
RECEIVED

APR 23 1996

5/22/96
DHC-1247

Southern

Rockies

Business

Unit

April 23, 1996

Mr. William J. LeMay, Director
New Mexico Oil Conservation Division
2040 S. Pacheco Street
P. O. Box 6429
Santa Fe, NM 87505

Application for Exception to Rule 303-C - Downhole Commingling
Barrett A #1E Well
Unit G Section 20-T31N-R9W
Basin Dakota and Blanco Mesaverde Pools
San Juan County, New Mexico

Enclosed please find an administrative application form (C-107-A) and attachments for downhole commingling for the captioned well. By copy of this application by certified mail, return receipt requested, Amoco is notifying all offset operators in the formations captioned above as well as all affected interest owners if the ownership of those formations is not common. The Division Director may approve the proposed downhole commingling in the absence of a valid objection from any offset operator or any interest owner in those instances where ownership is not common in the zones to be commingled within 20 days after the receipt of the application if, in his opinion, waste will not result thereby, and correlative rights will not be violated.

Should there be questions concerning this matter, please contact me at (303) 830-5344.

Sincerely,

Pamela W. Staley

Enclosures

cc: Mike Kutas
Patty Haefele
Wellfile
Proration File
Frank Chavez, Supervisor
NMOCD District III
1000 Rio Brazos Road
Aztec, NM 87410

Duane Spencer
Bureau of Land Management
1235 La Plata Hwy.
Farmington, NM 87401

DISTRICT I
P.O. Box 1980, Hobbs NM 88241-1980

State of New Mexico
Energy, Minerals and Natural Resources Department

Form C-107-A
New 3-12-96

OIL CONSERVATION DIVISION

APPROVAL PROCESS:

DISTRICT II
811 South First St., Artesia, NM 88210-2835

2040 S. Pacheco
Santa Fe, New Mexico 87505-6429

☒ Administrative ☐ Hearing

DISTRICT III
1000 Rio Brazos Rd. Aztec, NM 87410-1693

APPLICATION FOR DOWNHOLE COMMINGLING

EXISTING WELLBORE
☒ YES ☐ NO

Amoco Production Company		P.O. Box 800 Denver, CO 80201	
Operator BARRETT A	1E	Address G-20-31N-9W	San Juan
Lease	Well No.	Unit Ltr. - Sec Twp - Rge	County

Spacing Unit Lease Types: (check 1 or more)

OGRID NO. 000778 Property Code 000302 API NO. 3004525943 Federal ☒ State (and/or) Fee

The following facts are submitted in support of downhole commingling:	Upper Zone	Intermediate Zone	Lower Zone
1. Pool Name and Pool Code	BLANCO MESAVERDE 72319		BASIN DAKOTA 71599
2. Top and Bottom of Pay Section (Perforations)	4628' - 5685'		7490' - 7724'
3. Type of production (Oil or Gas)	GAS		GAS
4. Method of Production (Flowing or Artificial Lift)	FLOWING		FLOWING
5. Bottomhole Pressure Oil Zones - Artificial Lift: Gas & Oil - Flowing: All Gas Zones: Estimated Current Measured Current Estimated or Measured Original	a. (Current) 628 PSI (EST) b. (Original) 1238 PSI	a. b.	a. 726 PSI b. 2392 PSI
6. Oil Gravity (* API) or Gas BTU Content	1150 BTU / 41.5 DEG API		1050 BTU
7. Producing or Shut-In?	NEW		SHUT-IN
Production Marginal? (yes or no) • If Shut-In, give data and oil/gas/water rates of last production Note: For new zones with no production history, applicant shall be required to attach production estimates and supporting data • If Producing, give date and oil/gas/water rates of recent test (within 60 days)	NO Date: Rates: (EST) 400 MCFD 1 BCPD 1 BWPD	 Date: Rates: Date: Rates:	 Date: Rates: 8-9/94 60 MCFD 0 BCPD 0 BWPD Date: Rates:
8. Fixed Percentage Allocation Formula -% for each zone	Oil: % Gas %	Oil: % Gas %	Oil: % Gas %

9. If allocation formula is based upon something other than current or past production, or is based upon some other method, submit attachments with supporting data and/or explaining method and providing rate projections or other required data.

10. Are all working, overriding, and royalty interests identical in all commingled zones?
If not, have all working, overriding, and royalty interests been notified by certified mail?
Have all offset operators been given written notice of the proposed downhole commingling?

☒ Yes ☐ No
☐ Yes ☐ No
☒ Yes ☐ No

11. Will cross-flow occur? ☐ Yes ☒ No If yes, are fluids compatible, will the formations not be damaged, will any cross-flowed production be recovered, and will the allocation formula be reliable. ☐ Yes ☐ No (If No, attach explanation)

12. Are all produced fluids from all commingled zones compatible with each other? ☒ Yes ☐ No

13. Will the value of production be decreased by commingling? ☐ Yes ☒ No (If Yes, attach explanation)

15. If this well is on, or communitized with, state or federal lands, either the Commissioner of Public Lands or the United States Bureau of Land Management has been notified in writing of this application. ☒ Yes ☐ No SF-078336-B

16. ATTACHMENTS:

- * C-102 for each zone to be commingled showing its spacing unit and acreage dedication.
- * Production curve for each zone for at least one year. (If not available, attach explanation.)
- * For zones with no production history, estimated production rates and supporting data.
- * Data to support allocation method or formula. **XX See Attached**
- * Notification list of all offset operators.
- * Notification list of working, overriding, and royalty interests for uncommon interest cases.
- * Any additional statements, data, or documents required to support commingling.

I hereby certify that the information above is true and complete to the best of my knowledge and belief.

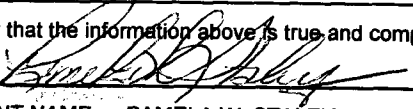
SIGNATURE  TITLE REGULATORY AFFAIRS REP DATE 4/23/96
TYPE OR PRINT NAME PAMELA W. STALEY TELEPHONE NO. (303) 830-5344

All distances must be from the outer boundaries of the Section.

TENNECO OIL COMPANY			Lease BARRETT "A"		Well No. 1E
Section 0	Section 20	Township 31N	Range 9W	County San Juan	
Actual Footage Location of Well: 1640 feet from the North line and 2215 feet from the East line					
Sound Level Elev. 6262	Producing Formation Dakota		Pool Basin Dakota		Dedicated Acreage: 320 Acres

1. Outline the acreage dedicated to the subject well by colored pencil or hatchure marks on the plat below.
2. If more than one lease is dedicated to the well, outline each and identify the ownership thereof (both as to working interest and royalty).
3. If more than one lease of different ownership is dedicated to the well, have the interests of all owners been consolidated by communitization, unitization, force-pooling, etc?

☐ Yes ☐ No If answer is "yes," type of consolidation _____

If answer is "no," list the owners and tract descriptions which have actually been consolidated. (Use reverse side of this form if necessary.) _____

No allowable will be assigned to the well until all interests have been consolidated (by communitization, unitization, forced-pooling, or otherwise) or until a non-standard unit, eliminating such interests, has been approved by the Commission.

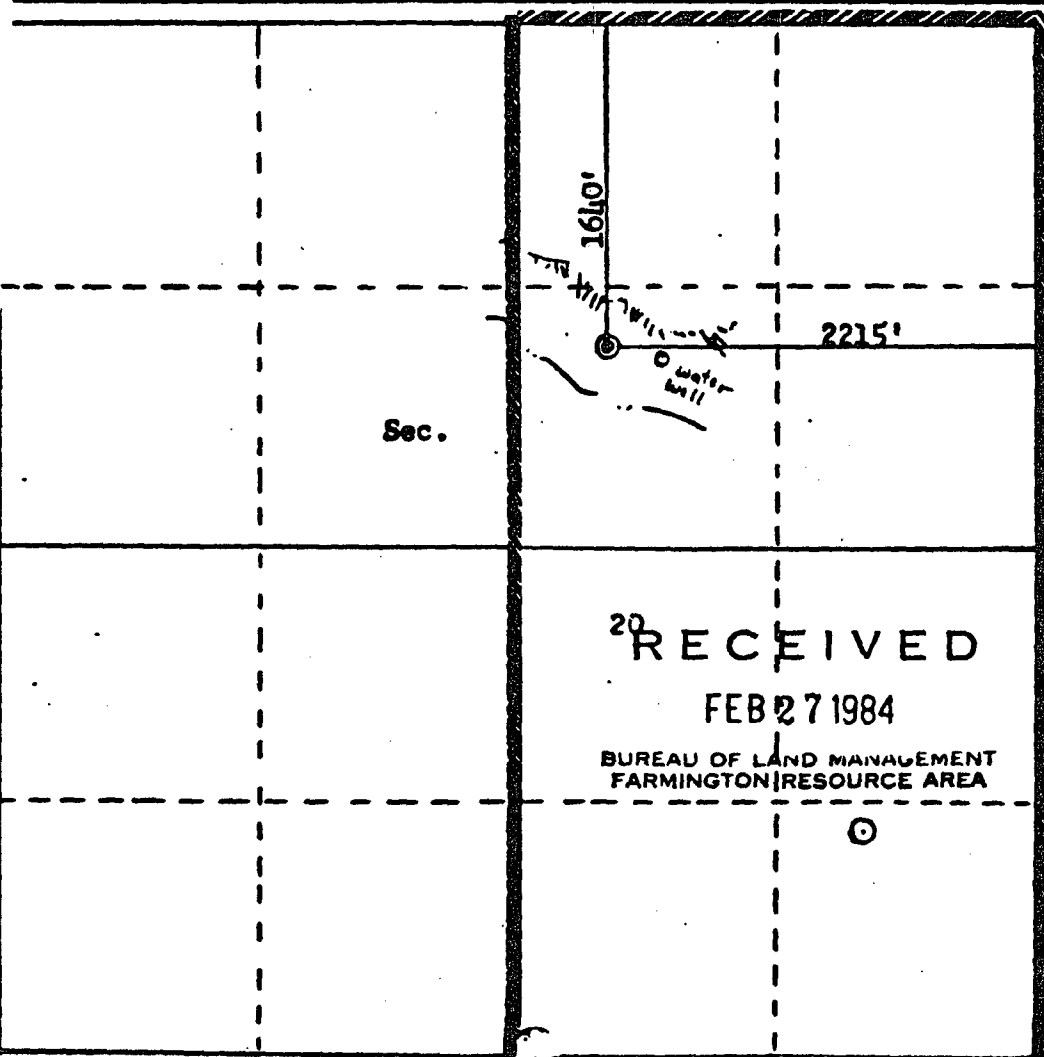

Scale: 1"=1000'

CERTIFICATION

I hereby certify that the information contained herein is true and complete to the best of my knowledge and belief.

Name
John Orr
Position
Production Analyst
Company
Tenneco Oil Company
Date
February 22, 1984

I hereby certify that the well location shown on this plat was plotted from field notes of actual surveys made by me or under my supervision, and that the same is true and correct to the best of my knowledge and belief.

Date Surveyed
December 30, 1983
Registered Professional Engineer and Land Surveyor
Fred B. Kerr Jr.
Certification No. 4112, 1st
3950

District I
PO Box 1980, Hobbs, NM 88241-1980
District II
811 South First, Artesia, NM 88210
District III
1000 Rio Brazos Rd., Aztec, NM 87410
District IV
2040 South Pacheco, Santa Fe, NM 87505

State of New Mexico
Energy, Minerals & Natural Resources Department

OIL CONSERVATION DIVISION
2040 South Pacheco
Santa Fe, NM 87505

Form C-102
Revised October 18, 1994
Instructions on back
Submit to Appropriate District Office
State Lease - 4 Copies
Fee Lease - 3 Copies

☐ AMENDED REPORT

WELL LOCATION AND ACREAGE DEDICATION PLAT

1 API Number 30-045-25943		2 Pool Code 72319		3 Pool Name Blanco Mesaverde		
4 Property Code 000302		5 Property Name Barrett A			6 Well Number 1E	
7 OGRID No. 000778		8 Operator Name Amoco Production Company			9 Elevation 6262'	

10 Surface Location

UL or lot no.	Section	Township	Range	Lot Idn	Feet from the	North/South line	Feet from the	East/West line	County
G	20	31N	9W		1640	North	2215	East	San Juan

11 Bottom Hole Location If Different From Surface

UL or lot no.	Section	Township	Range	Lot Idn	Feet from the	North/South line	Feet from the	East/West line	County

12 Dedicated Acres 320	13 Joint or Infill	14 Consolidation Code	15 Order No.
---------------------------	--------------------	-----------------------	--------------

NO ALLOWABLE WILL BE ASSIGNED TO THIS COMPLETION UNTIL ALL INTERESTS HAVE BEEN CONSOLIDATED
OR A NON-STANDARD UNIT HAS BEEN APPROVED BY THE DIVISION

16		1640'		2215'	17 OPERATOR CERTIFICATION I hereby certify that the information contained herein is true and complete to the best of my knowledge and belief Signature <u>Patty Haeefe</u> Patty Haeefe Printed Name Staff Assistant Title 4/16/96 Date	
					18 SURVEYOR CERTIFICATION I hereby certify that the well location shown on this plat was plotted from field notes of actual surveys made by me or under my supervision, and that the same is true and correct to the best of my belief. 12/30/83 Date of Survey Signature and Seal of Professional Surveyer: on file 3950 Certificate Number	

Chart1

Well: BARRETT A 001E-DK (97985001)

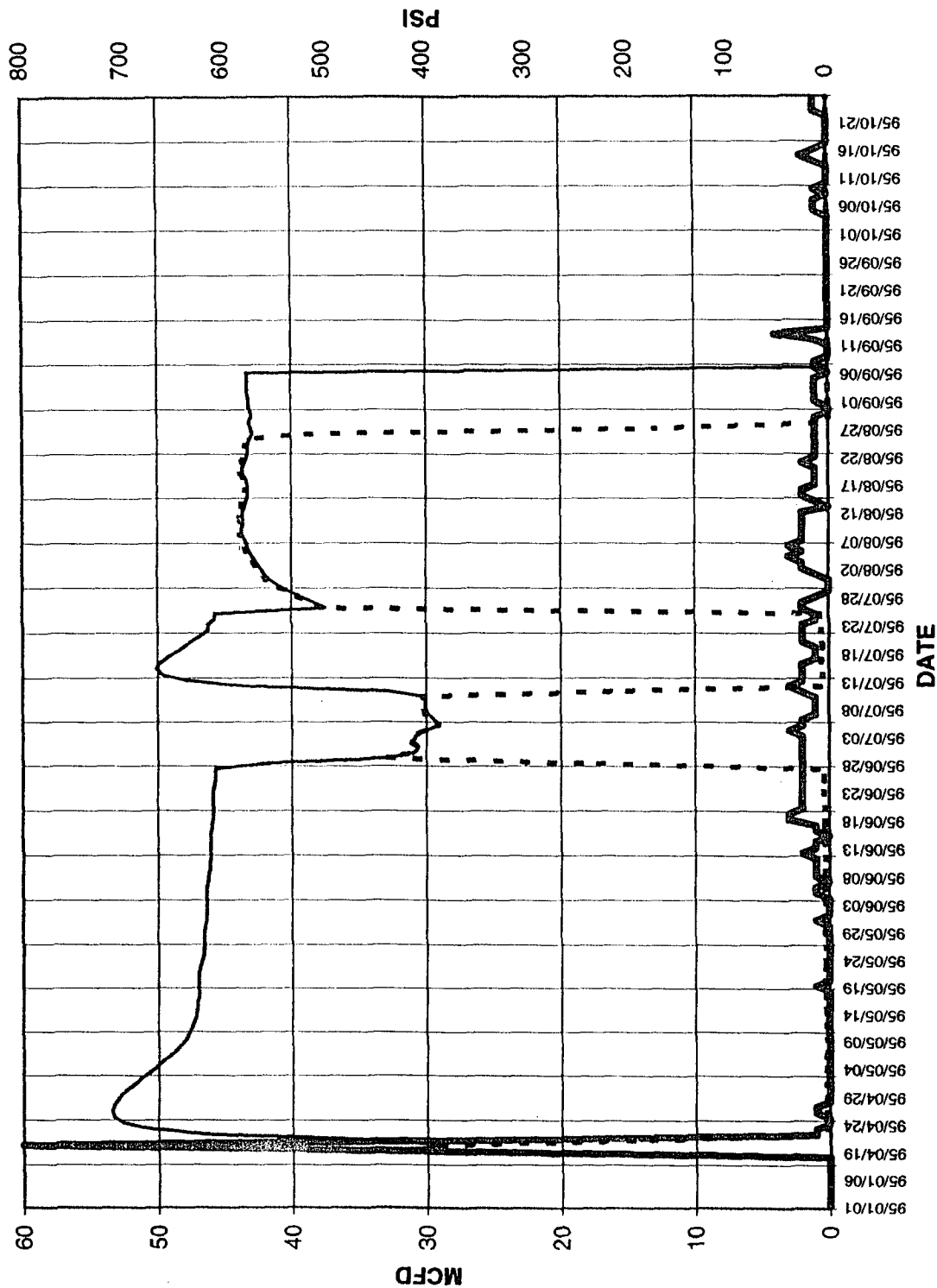

10/30/95
10:45 AM
2 MCFD
0 TP
574 CP
315 LP

Gas_Volume
Tubing_Press
Casing_Press

DK wells Sec 20-T31N-R9W Barrett A 1E

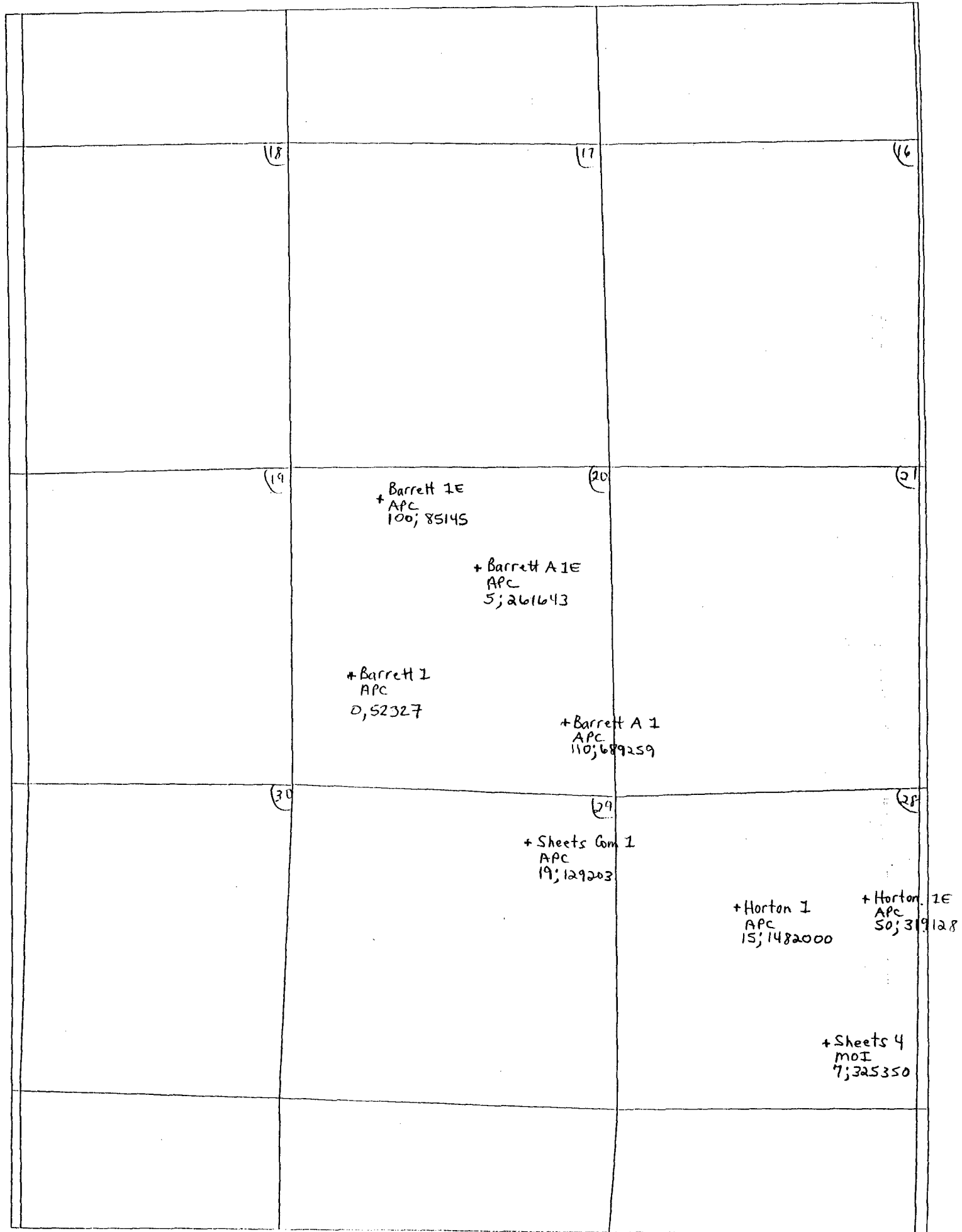

Dwights

Lease: BARRETT A 00001E

Retrieval Code: 251,045,31N09W20G00DK

04/17/96

3
10
3
10

3
10

2
10
2
10

2
10

10
10

10

1
1

1

1984 1986 1988 1990 1992 1994 1996

Gas (mcf/day)

County: SAN JUAN, NM

F.P. Date: 09/84

Oil (bbl/day)

Water (bbl/day)

Field: BASIN (DAKOTA) DK

Oil Cum: 18 bbl

Reservoir: DAKOTA

Gas Cum: 261.6 mmcf

Operator: AMOCO PRODUCTION CO

Location: 20G 31N 9W

OFFSET WELLS USED TO ESTIMATE MESAVERDE PRODUCTION
AVERAGE STABILIZED RATES FROM NEWER WELLS

San Juan 32-9 Unit 18R	K-17-31-9	375 MCFD
Sheets 1R	28-31-9	400 MCFD
Jacques LS #1R	B-29-31-9	400 MCFD

ALLOCATION METHOD

Allocation shall be established by testing the Mesaverde after frac and cleanup and before removing the bridge plug. Once that rate is established, the allocation will be set at the percentage contributed by the existing Dakota and the new rate established in the Mesaverde. We will forward those allocation percentages to you after the Mesaverde completion has been established.

Dwights

1000 Lease: JACQUES LS 00001R

Retrieval Code: 251,045,31N09W29B00M

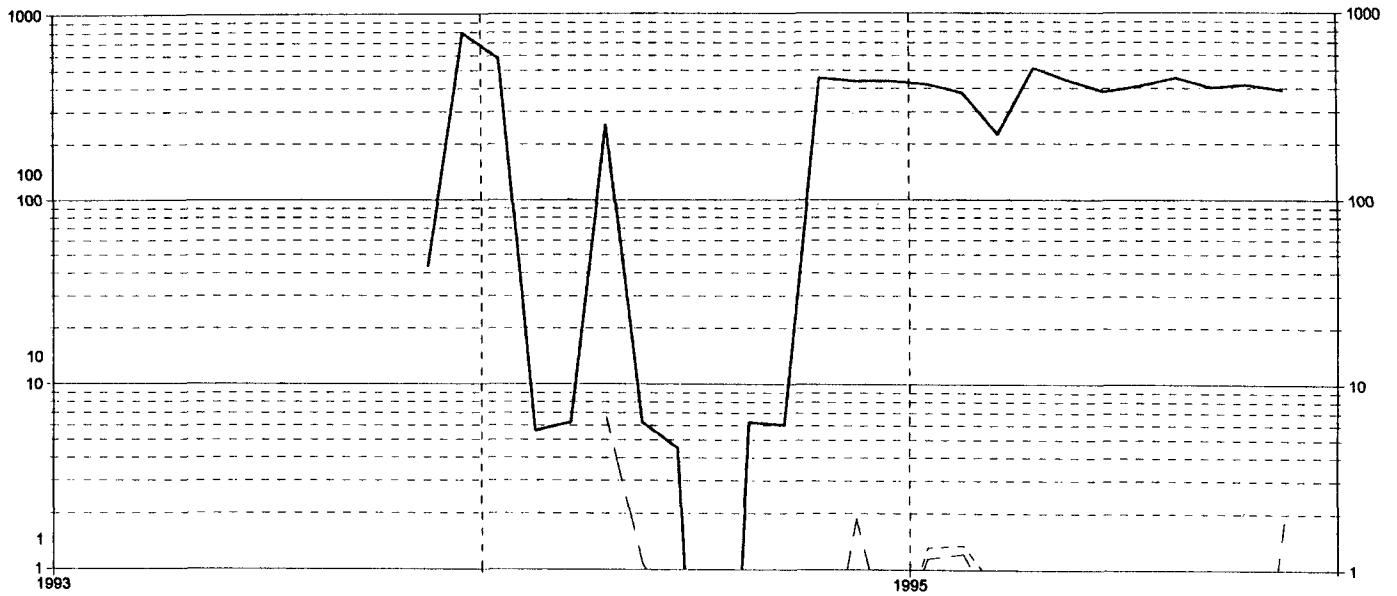

County: SAN JUAN

State: NM

F.P. Date: 11/93

Date: 04/04/96

Field: BLANCO (MESAVERDE) MV

Oil Cum: 599 bbl

Water (bbl/day)

Reservoir: MESAVERDE

Gas Cum: 226735 mcf

Gas (mcf/day)

Operator: AMOCO PRODUCTION CO

Location: 29B 31N 9W

Oil (bbl/day)

Dwights

Lease: SHEETS 001R

Retrieval Code: 251,045,045286477231

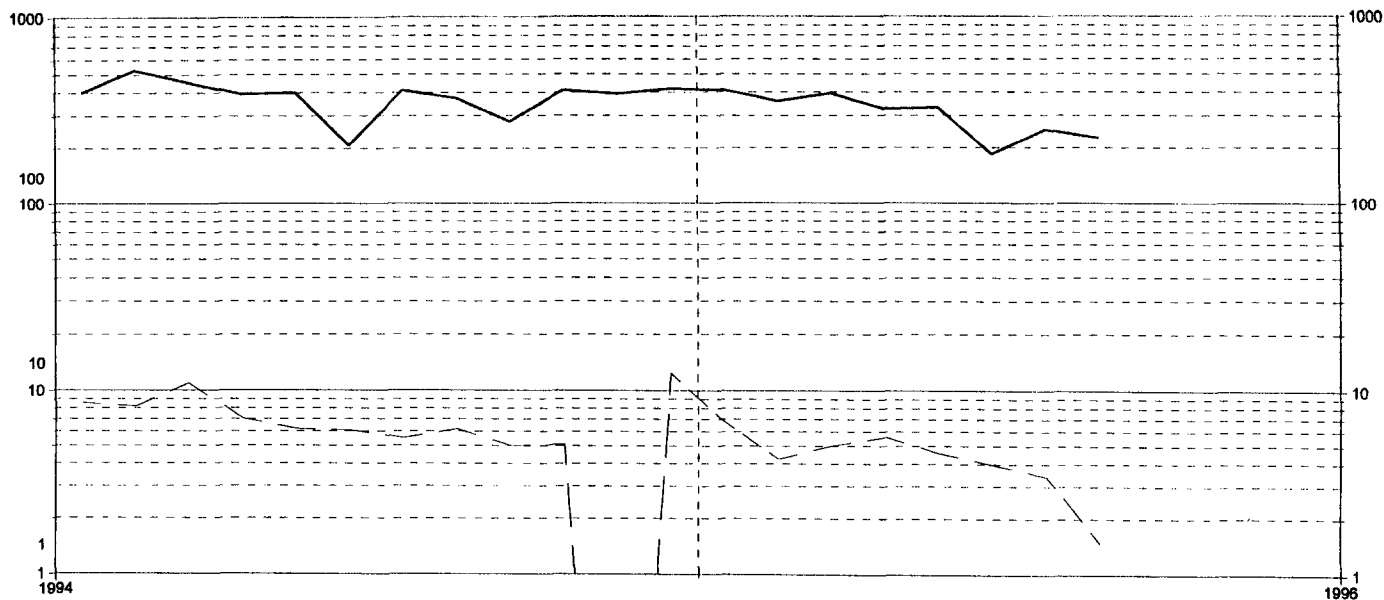

County: SAN JUAN

State: NM

F.P. Date: 01/94

Date: 04/04/96

Field: BLANCO (MESAVERDE) MV

Oil Cum: 3535 bbl

Reservoir: MESAVERDE

Gas Cum: 216846 mcf

Water (bbl/day)

Operator: MERIDIAN OIL INC

Location: 28 31N 9W

Gas (mcf/day)

Oil (bbl/day)

Dwights

Lease: SAN JUAN 32 9 UNIT 00018R

Retrieval Code: 251,045,31N09W17K00M

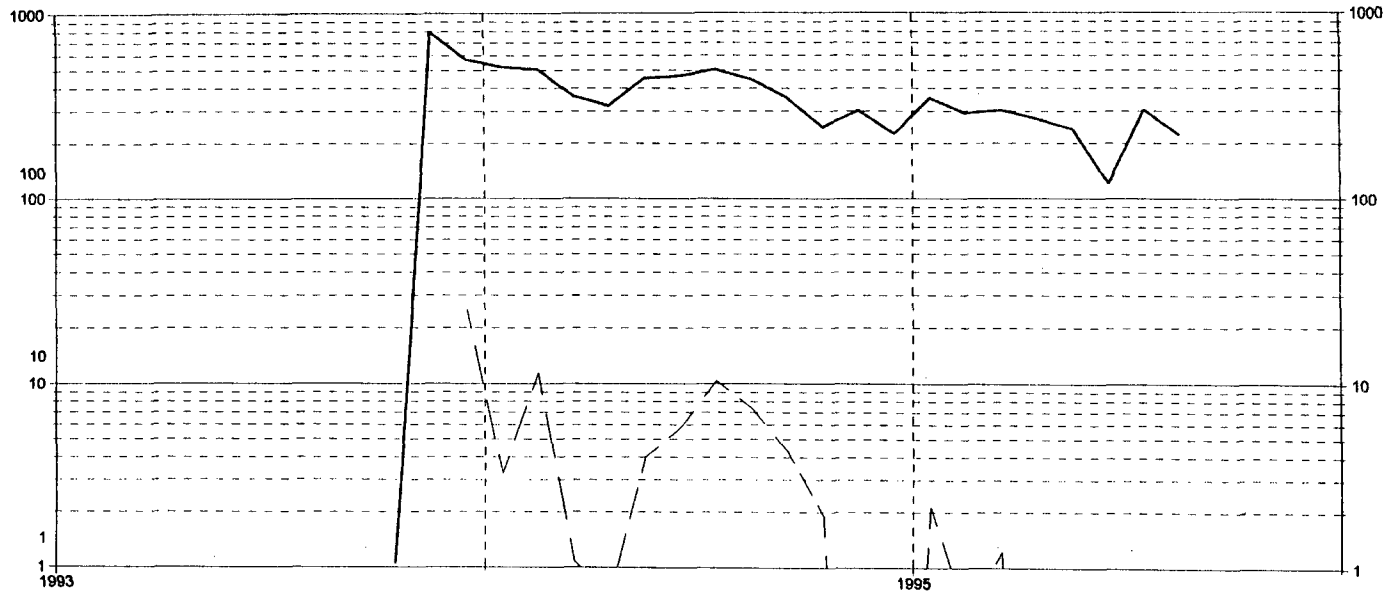

County: SAN JUAN

State: NM

F.P. Date: 10/93

Date: 04/04/96

Field: BLANCO (MESAVERDE) MV

Oil Cum: 2461 bbl

Reservoir: MESAVERDE

Gas Cum: 245588 mcf

Water (bbl/day)

Operator: MERIDIAN OIL INC

Location: 17K 31N 9W

Gas (mcf/day)

Oil (bbl/day)

Meridian Oil, Inc.
P.O. Box 4289
Farmington, NM 87499

OFFSET OPERATORS
BARRETT A #1E