



NEW MEXICO OIL CONSERVATION DIVISION
RECEIVED

MAY 1 8 52 AM '96

5/23/96
DHC-1249

Southern

Rockies

Business

Unit

May 1, 1996

Mr. William J. LeMay, Director
New Mexico Oil Conservation Division
2040 S. Pacheco Street
P. O. Box 6429
Santa Fe, NM 87505

Application for Exception to Rule 303-C
Downhole Commingling
Jicarilla 155 #29 Well
Unit F Section 32-T26N-R5W
Otero Chacra and Blanco Mesaverde Pools
Rio Arriba County, New Mexico

Enclosed please find an administrative application form (C-107-A) and attachments for downhole commingling for the captioned well. By copy of this application by certified mail, return receipt requested, Amoco is notifying all offset operators in the formations captioned above as well as all affected interest owners if the ownership of those formations is not common. Amoco is the only offset operator in both formations. The Division Director may approve the proposed downhole commingling in the absence of a valid objection from any offset operator or any interest owner in those instances where ownership is not common in the zones to be commingled within 20 days after the receipt of the application if, in his opinion, waste will not result thereby, and correlative rights will not be violated.

Should there be questions concerning this matter, please contact me at (303) 830-5344.

Sincerely,

Pamela W. Staley

Enclosures

cc: Steve Smethie

Patty Haefele

Wellfile

Proration file

Frank Chavez, Supervisor

NMOCD District III

1000 Rio Brazos Road

Aztec, NM 87410

Robert Kent

Bureau of Land Management

435 Montano NE

Albuquerque, NM 87107

Amoco Production Company

P.O. Box 800 Denver, CO 80201

Operator
Jicarilla Contract #155

29

Address
Unit F Section 32-T26N-R5W

Rio Arriba

Lease

Well No.

Unit Ltr. - Sec Twp - Rge

County

OGRID NO. 000778

Property Code 000741

API NO. 3003922531

Spacing Unit Lease Types: (check 1 or more)
Federal ☒ State ☐ (and/or) Fee ☐

The following facts are submitted in support of downhole commingling:	Upper Zone	Intermediate Zone	Lower Zone
1. Pool Name and Pool Code	OTERO CHACRA 82329		BLANCO MESAVERDE 72319
2. Top and Bottom of Pay Section (Perforations)	3751' - 3862'		5060' - 5236'
3. Type of production (Oil or Gas)	GAS		GAS
4. Method of Production (Flowing or Artificial Lift)	FLOWING		FLOWING
5. Bottomhole Pressure Oil Zones - Artificial Lift: Gas & Oil - Flowing: All Gas Zones: Estimated Current Measured Current Estimated or Measured Original	a. (Current) 424 PSI b. (Original) 1156 PSI	a. b.	a. 657 PSI b. 1349 PSI
6. Oil Gravity (° API) or Gas BTU Content	1205 BTU		1278 BTU / 49 DEG API
7. Producing or Shut-In?	PRODUCING		PRODUCING
Production Marginal? (yes or no) • If Shut-In, give data and oil/gas/water rates of last production Note: For new zones with no production history, applicant shall be required to attach production estimates and supporting data • If Producing, give date and oil/gas/water rates of recent test (within 60 days)	YES Date: Rates: 2/96 60 MCFD 0.01 BCPD 0.10 BWPD	 Date: Rates: Date: Rates:	YES Date: Rates: 2/96 109 MCFD 2.06 BCPD 1.99 BWPD
8. Fixed Percentage Allocation Formula -% for each zone	Oil: 0 % Gas 36 %	Oil: % Gas %	Oil: 100 % Gas 64 %

9. If allocation formula is based upon something other than current or past production, or is based upon some other method, submit attachments with supporting data and/or explaining method and providing rate projections or other required data.
10. Are all working, overriding, and royalty interests identical in all commingled zones?
If not, have all working, overriding, and royalty interests been notified by certified mail?
Have all offset operators been given written notice of the proposed downhole commingling?

☒ Yes ☐ No

☐ Yes ☐ No

☒ Yes ☐ No
11. Will cross-flow occur? ☐ Yes ☒ No If yes, are fluids compatible, will the formations not be damaged, will any cross-flowed production be recovered, and will the allocation formula be reliable. ☐ Yes ☐ No (If No, attach explanation)
12. Are all produced fluids from all commingled zones compatible with each other? ☒ Yes ☐ No
13. Will the value of production be decreased by commingling? ☐ Yes ☒ No (If Yes, attach explanation)
14. If this well is on, or communitized with, state or federal lands, either the Commissioner of Public Lands or the Untied States Bureau of Land Management has been notified in writing of this application. ☒ Yes ☐ No JICARILLA CONTRACT #155
15. NMOCDD Reference Cases for Rule 303(D) Exceptions: ORDER NO(S) _____
16. ATTACHMENTS:

* C-102 for each zone to be commingled showing its spacing unit and acreage dedication.

* Production curve for each zone for at least one year. (If not available, attach explanation.)

* For zones with no production history, estimated production rates and supporting data.

* Data to support allocation method or formula.

* Notification list of all offset operators.

* Notification list of working, overriding, and royalty interests for uncommon interest cases.

* Any additional statements, data, or documents required to support commingling.

I hereby certify that the information above is true and complete to the best of my knowledge and belief.

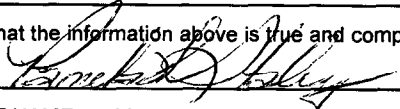
SIGNATURE 

TITLE REGULATORY AFFAIRS REP

DATE 4/22/96

TYPE OR PRINT NAME PAMELA W. STALEY

TELEPHONE NO. (303) 830-5344

OIL CONSERVATION DIVISION

P. O. BOX 2088

SANTA FE, NEW MEXICO 87501

Form C-102
Revised 10-1-77

STATE OF NEW MEXICO

ENERGY AND MINERALS DEPARTMENT

All distances must be from the outer boundaries of the Section.

Operator AMOCO PRODUCTION COMPANY			Lease JICARILLA CONTRACT 155		Well No. 29
Unit Letter F	Section 32	Township 26N	Range 5W	County Rio Arriba	
Actual Footage Location of Well: 1810 feet from the North line and 1520 feet from the West line					
Ground Level Elev. 6583	Producing Formation Chacra/Mesaverde		Pool Otero Chacra/Gonzales Mesaverde		Dedicated Acreage: 160 Acres

1. Outline the acreage dedicated to the subject well by colored pencil or hachure marks on the plat below.
2. If more than one lease is dedicated to the well, outline each and identify the ownership thereof (both as to working interest and royalty).
3. If more than one lease of different ownership is dedicated to the well, have the interests of all owners been consolidated by communitization, unitization, force-pooling, etc?

☐ Yes ☐ No If answer is "yes," type of consolidation _____

If answer is "no," list the owners and tract descriptions which have actually been consolidated. (Use reverse side of this form if necessary.) _____

No allowable will be assigned to the well until all interests have been consolidated (by communitization, unitization, forced-pooling, or otherwise) or until a non-standard unit, eliminating such interests, has been approved by the Commission.

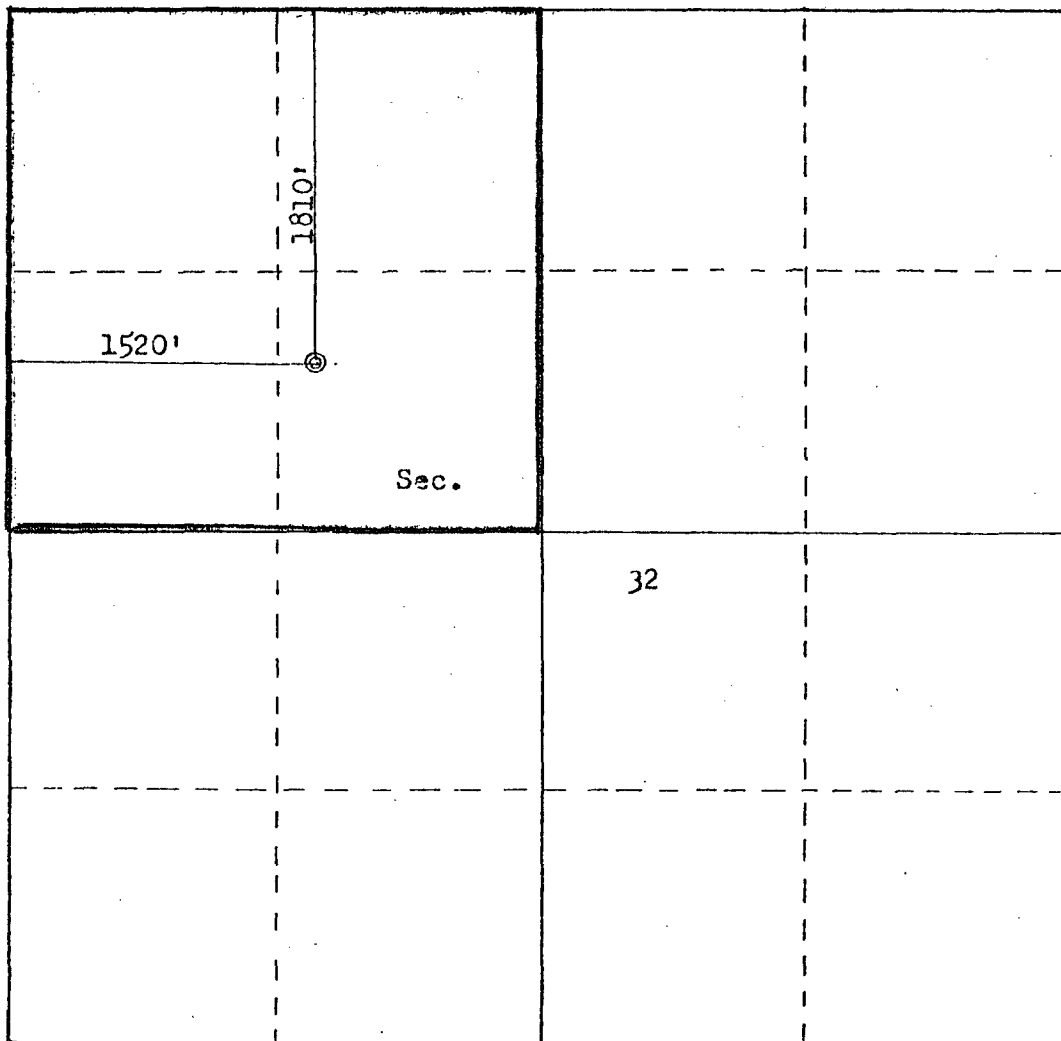

Scale: 1"=1000'

CERTIFICATION

I hereby certify that the information contained herein is true and complete to the best of my knowledge and belief.

R.A. Downey

Name

R.A. DOWNEY

Position

DISTRICT ENGINEER

Company

AMOCO PRODUCTION COMPANY

Date

SEPTEMBER 8, 1980

I hereby certify that the well location shown on this plat was plotted from field notes of actual surveys made by me or under my supervision, and that the same is true and correct to the best of my knowledge and belief.

Date Surveyed

July 29, 1980

Registered Professional Engineer
and Land Surveyor

Fred B. Kerr, Jr.

Certificate No. NEW MEXICO

3950

FRED B. KERR, JR.

FORM 24-11

Engr: zhab0b

JICARILLA CONTRACT 155 29

Operator- AMOCO PRODUCTION CO

300392253100CK F322605-029 CK

APC_WI - 1.0000000

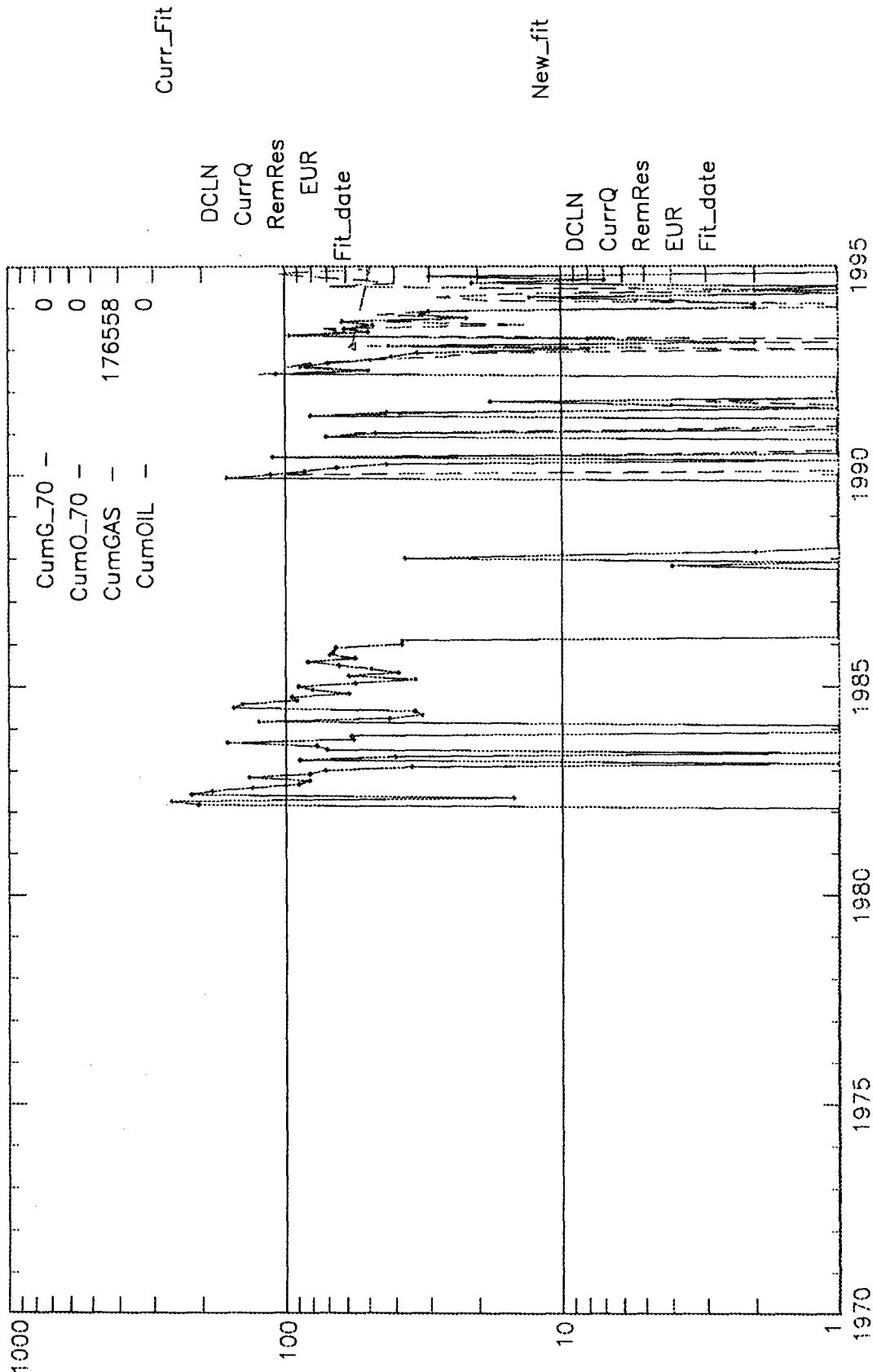

Engr: zhab0b

JICARILLA CONTRACT 155 29

Operator- AMOCO PRODUCTION CO

300392253100MV

F322605-029 MV

APC_WI - 1.0000000

