

## Bratcher, Mike, EMNRD

---

**From:** Amy Ruth <aruth@diversifiedfsi.com>  
**Sent:** Thursday, July 18, 2013 2:00 PM  
**To:** Bratcher, Mike, EMNRD  
**Cc:** gawink@linnenergy.com  
**Subject:** Linn Energy JL Keel B #91  
**Attachments:** Linn JL Keel B #91 Site Diagram w Sample Data.pdf; H301428 LINN surface.pdf; H301483 LINN exc bottom.pdf; C141.tiff

Mike,

Great talking with you this afternoon. We have begun excavating a few sites right away and need to request permission to go ahead with activities at their various junctures. Per our conversation, here is the data on the first site we'd like to discuss.

The Linn Energy site J.L. Keel B #91 (2RP-1294) spill that was previously being looked at by Etech has been excavated by Diversified to 1 and 2 ft. bgs and confirmation samples were collected. Attached are the site diagram and lab data. We would like permission to backfill the site and proceed to a site closure report. Please let me know if you would like to see photos or would rather set up a meeting in person. I still owe you lunch. Either way, here is the data. Thank you!

*Amy C. Ruth*

Diversified Field Services, Inc.  
315 S. Leech St.  
Hobbs, NM 88240  
Office: (575)397-6437  
Mobile: (575)390-5454  
Fax: (575)393-2981

*"Nothing will work unless you do." -Maya Angelou*

This email and any files transmitted with it are confidential and intended solely for the use of the individual or entity to whom they are addressed. If you have received this email in error please notify the system manager. This message contains confidential information and is intended only for the individual named. If you are not the named addressee you should not disseminate, distribute or copy this e-mail. Please notify the sender immediately by e-mail if you have received this e-mail by mistake and delete this e-mail from your system. If you are not the intended recipient you are notified that disclosing, copying, distributing or taking any action in reliance on the contents of this information is strictly prohibited.

# Site Diagram with Sample Data

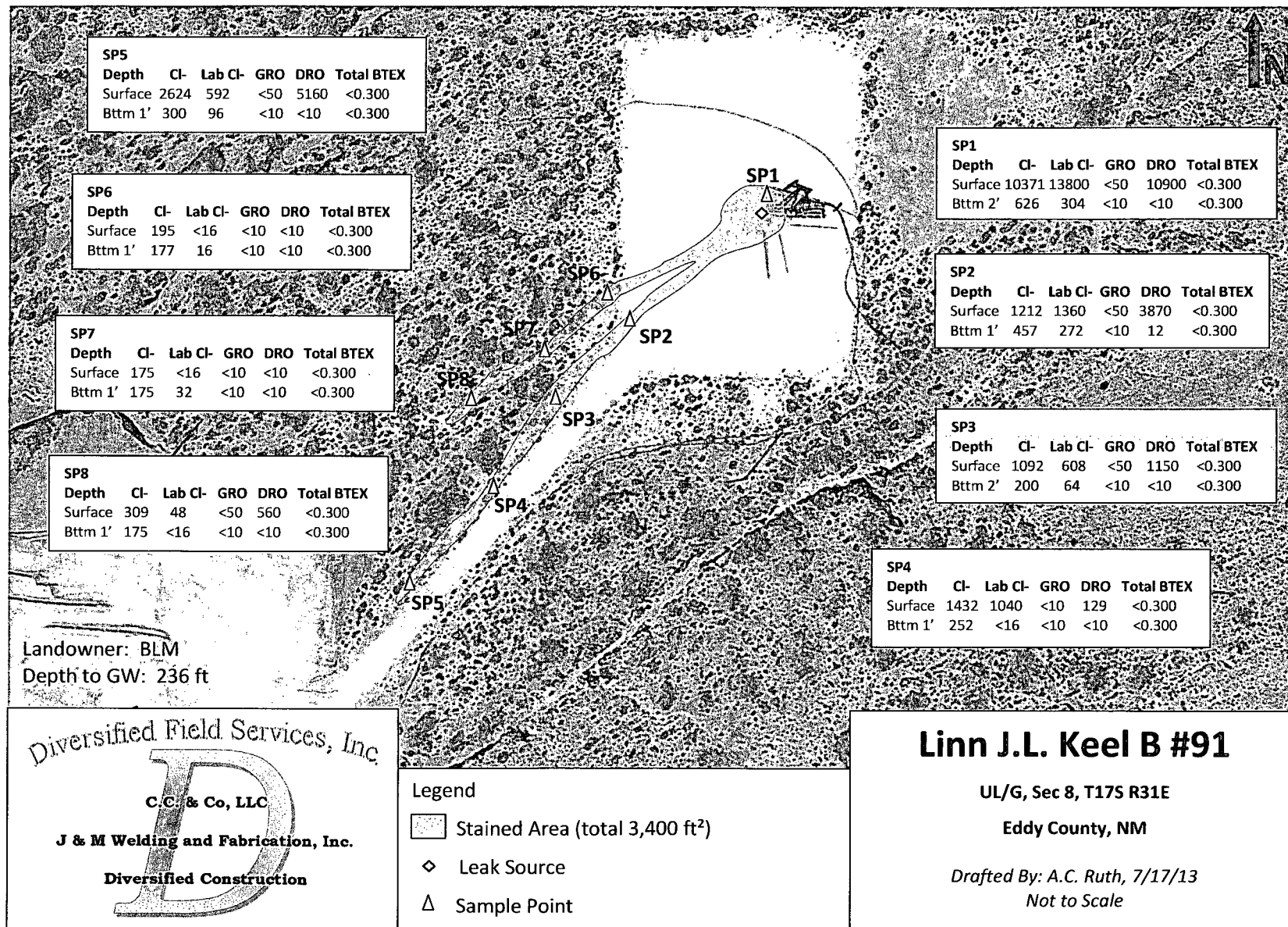



PHONE (575) 393-2326 ° 101 E. MARLAND ° HOBBS, NM 88240

June 27, 2013

GARY WINK

LINN ENERGY

RR1, BOX 24 B

KINGFISHER, OK 73750

RE: J L KEEL B #91

Enclosed are the results of analyses for samples received by the laboratory on 06/20/13 8:05.

Cardinal Laboratories is accredited through Texas NELAP under certificate number T104704398-11-3. Accreditation applies to drinking water, non-potable water and solid and chemical materials. All accredited analytes are denoted by an asterisk (\*). For a complete list of accredited analytes and matrices visit the TCEQ website at [www.tceq.texas.gov/field/qa/lab\\_accred\\_certif.html](http://www.tceq.texas.gov/field/qa/lab_accred_certif.html).

Cardinal Laboratories is accredited through the State of Colorado Department of Public Health and Environment for:

Method EPA 552.2	Haloacetic Acids (HAA-5)
Method EPA 524.2	Total Trihalomethanes (TTHM)
Method EPA 524.4	Regulated VOCs (V1, V2, V3)

Accreditation applies to public drinking water matrices.

This report meets NELAP requirements and is made up of a cover page, analytical results, and a copy of the original chain-of-custody. If you have any questions concerning this report, please feel free to contact me.

Sincerely,

Celey D. Keene

Lab Director/Quality Manager

**Analytical Results For:**

 LINN ENERGY  
 GARY WINK  
 RR1, BOX 24 B  
 KINGFISHER OK, 73750  
 Fax To: (405) 375-6693

 Received: 06/20/2013  
 Reported: 06/27/2013  
 Project Name: J L KEEL B #91  
 Project Number: NONE GIVEN  
 Project Location: NOT GIVEN

 Sampling Date: 06/17/2013  
 Sampling Type: Soil  
 Sampling Condition: Cool & Intact  
 Sample Received By: Jodi Henson

**Sample ID: SP 1 SURFACE (H301428-01)**

BTEX 8021B			mg/kg		Analyzed By: MS				
Analyte	Result	Reporting Limit	Analyzed	Method Blank	BS	% Recovery	True Value QC	RPD	Qualifier
Benzene*	<0.050	0.050	06/22/2013	ND	1.81	90.7	2.00	8.53	
Toluene*	<0.050	0.050	06/22/2013	ND	1.95	97.5	2.00	7.49	
Ethylbenzene*	<0.050	0.050	06/22/2013	ND	2.11	106	2.00	7.27	
Total Xylenes*	<0.150	0.150	06/22/2013	ND	6.35	106	6.00	6.93	
Total BTEX	<0.300	0.300	06/22/2013	ND					

Surrogate: 4-Bromofluorobenzene (PIL) 112 % 89.4-126

Chloride, SM4500Cl-B			mg/kg		Analyzed By: DW				
Analyte	Result	Reporting Limit	Analyzed	Method Blank	BS	% Recovery	True Value QC	RPD	Qualifier
Chloride	13800	16.0	06/24/2013	ND	432	108	400	3.77	

TPH 8015M			mg/kg		Analyzed By: MS					S-06
Analyte	Result	Reporting Limit	Analyzed	Method Blank	BS	% Recovery	True Value QC	RPD	Qualifier	
GRO C6-C10	<50.0	50.0	06/21/2013	ND	213	106	200	0.956		
DRO >C10-C28	10900	50.0	06/21/2013	ND	213	106	200	3.66		

Surrogate: 1-Chlorooctane 92.3 % 65.2-140

Surrogate: 1-Chlorooctadecane 403 % 63.6-154

Cardinal Laboratories

\*=Accredited Analyte

PLEASE NOTE: Liability and Damages. Cardinal's liability and client's exclusive remedy for any claim arising, whether based in contract or tort, shall be limited to the amount paid by client for analyses. All claims, including those for negligence and any other cause whatsoever shall be deemed waived unless made in writing and received by Cardinal within thirty (30) days after completion of the applicable service. In no event shall Cardinal be liable for incidental or consequential damages, including, without limitation, business interruptions, loss of use, or loss of profits incurred by client, its subsidiaries, affiliates or successors arising out of or related to the performance of the services hereunder by Cardinal, regardless of whether such claim is based upon any of the above stated reasons or otherwise. Results relate only to the samples identified above. This report shall not be reproduced except in full with written approval of Cardinal Laboratories.



Celey D. Keene, Lab Director/Quality Manager

**Analytical Results For:**

 LINN ENERGY  
 GARY WINK  
 RR1, BOX 24 B  
 KINGFISHER OK, 73750  
 Fax To: (405) 375-6693

 Received: 06/20/2013  
 Reported: 06/27/2013  
 Project Name: J L KEEL B #91  
 Project Number: NONE GIVEN  
 Project Location: NOT GIVEN

 Sampling Date: 06/17/2013  
 Sampling Type: Soil  
 Sampling Condition: Cool & Intact  
 Sample Received By: Jodi Henson

**Sample ID: SP 3 SURFACE (H301428-03)**

BTX 8021B			mg/kg		Analyzed By: MS					
Analyte	Result	Reporting Limit	Analyzed	Method Blank	BS	% Recovery	True Value QC	RPD	Qualifier	
Benzene*	<0.050	0.050	06/22/2013	ND	1.81	90.7	2.00	8.53		
Toluene*	<0.050	0.050	06/22/2013	ND	1.95	97.5	2.00	7.49		
Ethylbenzene*	<0.050	0.050	06/22/2013	ND	2.11	106	2.00	7.27		
Total Xylenes*	<0.150	0.150	06/22/2013	ND	6.35	106	6.00	6.93		
Total BTX	<0.300	0.300	06/22/2013	ND						

Surrogate: 4-Bromofluorobenzene (PIE) 117 % 89.4-126

Chloride, SM4500Cl-B		mg/kg		Analyzed By: DW						
Analyte	Result	Reporting Limit	Analyzed	Method Blank	BS	% Recovery	True Value QC	RPD	Qualifier	
Chloride	608	16.0	06/24/2013	ND	432	108	400	3.77		

TPH 8015M		mg/kg		Analyzed By: MS						
Analyte	Result	Reporting Limit	Analyzed	Method Blank	BS	% Recovery	True Value QC	RPD	Qualifier	
GRO C6-C10	<50.0	50.0	06/21/2013	ND	213	106	200	0.956		
DRO >C10-C28	1150	50.0	06/21/2013	ND	213	106	200	3.66		

Surrogate: 1-Chlorooctane 91.0 % 65.2-140

Surrogate: 1-Chlorooctadecane 120 % 63.6-154

Cardinal Laboratories

\*=Accredited Analyte

PLEASE NOTE: Liability and Damages. Cardinal's liability and client's exclusive remedy for any claim arising, whether based in contract or tort, shall be limited to the amount paid by client for analyses. All claims, including those for negligence and any other cause whatsoever shall be deemed waived unless made in writing and received by Cardinal within thirty (30) days after completion of the applicable service. In no event shall Cardinal be liable for incidental or consequential damages, including, without limitation, business interruptions, loss of use, or loss of profits incurred by client, its subsidiaries, affiliates or successors arising out of or related to the performance of the services hereunder by Cardinal, regardless of whether such claim is based upon any of the above stated reasons or otherwise. Results relate only to the samples identified above. This report shall not be reproduced except in full with written approval of Cardinal Laboratories.

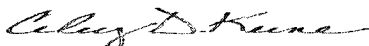

Celey D. Keene, Lab Director/Quality Manager

**Analytical Results For:**

LINN ENERGY  
GARY WINK  
RR1, BOX 24 B  
KINGFISHER OK, 73750  
Fax To: (405) 375-6693

Received: 06/20/2013  
Reported: 06/27/2013  
Project Name: J L KEEL B #91  
Project Number: NONE GIVEN  
Project Location: NOT GIVEN

Sampling Date: 06/17/2013  
Sampling Type: Soil  
Sampling Condition: Cool & Intact  
Sample Received By: Jodi Henson

**Sample ID: SP 4 SURFACE (H301428-04)**

BTEX 8021B			mg/kg		Analyzed By: MS				
Analyte	Result	Reporting Limit	Analyzed	Method Blank	BS	% Recovery	True Value QC	RPD	Qualifier
Benzene*	<0.050	0.050	06/21/2013	ND	1.81	90.7	2.00	8.53	
Toluene*	<0.050	0.050	06/21/2013	ND	1.95	97.5	2.00	7.49	
Ethylbenzene*	<0.050	0.050	06/21/2013	ND	2.11	106	2.00	7.27	
Total Xylenes*	<0.150	0.150	06/21/2013	ND	6.35	106	6.00	6.93	
Total BTEX	<0.300	0.300	06/21/2013	ND					

Surrogate: 4-Bromofluorobenzene (PIE) 110 % 89.4-126

Chloride, SM4500Cl-B		mg/kg		Analyzed By: DW						
Analyte	Result	Reporting Limit	Analyzed	Method Blank	BS	% Recovery	True Value QC	RPD	Qualifier	
Chloride	1040	16.0	06/24/2013	ND	432	108	400	3.77		

TPH 8015M		mg/kg		Analyzed By: MS					
Analyte	Result	Reporting Limit	Analyzed	Method Blank	BS	% Recovery	True Value QC	RPD	Qualifier
GRO C6-C10	<10.0	10.0	06/21/2013	ND	213	106	200	0.956	
DRO >C10-C28	129	10.0	06/21/2013	ND	213	106	200	3.66	

Surrogate: 1-Chlorooctane 92.2 % 65.2-140

Surrogate: 1-Chlorooctadecane 94.5 % 63.6-154

Cardinal Laboratories

\*=Accredited Analyte

PLEASE NOTE: Liability and Damages. Cardinal's liability and client's exclusive remedy for any claim arising, whether based in contract or tort, shall be limited to the amount paid by client for analyses. All claims, including those for negligence and any other cause whatsoever shall be deemed waived unless made in writing and received by Cardinal within thirty (30) days after completion of the applicable service. In no event shall Cardinal be liable for incidental or consequential damages, including, without limitation, business interruptions, loss of use, or loss of profits incurred by client, its subsidiaries, affiliates or successors arising out of or related to the performance of the services hereunder by Cardinal, regardless of whether such claim is based upon any of the above stated reasons or otherwise. Results relate only to the samples identified above. This report shall not be reproduced except in full with written approval of Cardinal Laboratories.



Celey D. Keene, Lab Director/Quality Manager

**Analytical Results For:**

 LINN ENERGY  
 GARY WINK  
 RR1, BOX 24 B  
 KINGFISHER OK, 73750  
 Fax To: (405) 375-6693

 Received: 06/20/2013  
 Reported: 06/27/2013  
 Project Name: J L KEEL B #91  
 Project Number: NONE GIVEN  
 Project Location: NOT GIVEN

 Sampling Date: 06/17/2013  
 Sampling Type: Soil  
 Sampling Condition: Cool & Intact  
 Sample Received By: Jodi Henson

**Sample ID: SP 6 SURFACE (H301428-06)**

BTEX 8021B			mg/kg		Analyzed By: MS				
Analyte	Result	Reporting Limit	Analyzed	Method Blank	BS	% Recovery	True Value QC	RPD	Qualifier
Benzene*	<0.050	0.050	06/21/2013	ND	1.81	90.7	2.00	8.53	
Toluene*	<0.050	0.050	06/21/2013	ND	1.95	97.5	2.00	7.49	
Ethylbenzene*	<0.050	0.050	06/21/2013	ND	2.11	106	2.00	7.27	
Total Xylenes*	<0.150	0.150	06/21/2013	ND	6.35	106	6.00	6.93	
Total BTEX	<0.300	0.300	06/21/2013	ND					

Surrogate: 4-Bromofluorobenzene (PIL) 118 % 89.4-126

Chloride, SM4500Cl-B			mg/kg		Analyzed By: DW				
Analyte	Result	Reporting Limit	Analyzed	Method Blank	BS	% Recovery	True Value QC	RPD	Qualifier
Chloride	<16.0	16.0	06/24/2013	ND	432	108	400	3.77	

TPH 8015M			mg/kg		Analyzed By: MS				
Analyte	Result	Reporting Limit	Analyzed	Method Blank	BS	% Recovery	True Value QC	RPD	Qualifier
GRO C6-C10	<10.0	10.0	06/21/2013	ND	213	106	200	0.956	
DRO >C10-C28	<10.0	10.0	06/21/2013	ND	213	106	200	3.66	

Surrogate: 1-Chlorooctane 94.3 % 65.2-140

Surrogate: 1-Chlorooctadecane 97.6 % 63.6-154

Cardinal Laboratories

\*=Accredited Analyte

PLEASE NOTE: Liability and Damages. Cardinal's liability and client's exclusive remedy for any claim arising, whether based in contract or tort, shall be limited to the amount paid by client for analyses. All claims, including those for negligence and any other cause whatsoever shall be deemed waived unless made in writing and received by Cardinal within thirty (30) days after completion of the applicable service. In no event shall Cardinal be liable for incidental or consequential damages, including, without limitation, business interruptions, loss of use, or loss of profits incurred by client, its subsidiaries, affiliates or successors arising out of or related to the performance of the services hereunder by Cardinal, regardless of whether such claim is based upon any of the above stated reasons or otherwise. Results relate only to the samples identified above. This report shall not be reproduced except in full with written approval of Cardinal Laboratories.



Celey D. Keene, Lab Director/Quality Manager

**Analytical Results For:**

 LINN ENERGY  
 GARY WINK  
 RR1, BOX 24 B  
 KINGFISHER OK, 73750  
 Fax To: (405) 375-6693

 Received: 06/20/2013  
 Reported: 06/27/2013  
 Project Name: J L KEEL B #91  
 Project Number: NONE GIVEN  
 Project Location: NOT GIVEN

 Sampling Date: 06/17/2013  
 Sampling Type: Soil  
 Sampling Condition: Cool & Intact  
 Sample Received By: Jodi Henson

**Sample ID: SP 7 SURFACE (H301428-07)**

BTEX 8021B			mg/kg		Analyzed By: DW					
Analyte	Result	Reporting Limit	Analyzed	Method Blank	BS	% Recovery	True Value QC	RPD	Qualifier	
Benzene*	<0.050	0.050	06/24/2013	ND	1.96	98.0	2.00	3.95		
Toluene*	<0.050	0.050	06/24/2013	ND	2.09	104	2.00	3.79		
Ethylbenzene*	<0.050	0.050	06/24/2013	ND	2.25	112	2.00	3.79		
Total Xylenes*	<0.150	0.150	06/24/2013	ND	6.79	113	6.00	3.17		
Total BTEX	<0.300	0.300	06/24/2013	ND				200		

Surrogate: 4-Bromofluorobenzene (PIC) 110 % 89.4-126

Chloride, SM4500Cl-B		mg/kg		Analyzed By: DW						
Analyte	Result	Reporting Limit	Analyzed	Method Blank	BS	% Recovery	True Value QC	RPD	Qualifier	
Chloride	<16.0	16.0	06/24/2013	ND	432	108	400	3.77		

TPH 8015M		mg/kg		Analyzed By: MS					
Analyte	Result	Reporting Limit	Analyzed	Method Blank	BS	% Recovery	True Value QC	RPD	Qualifier
GRO C6-C10	<10.0	10.0	06/21/2013	ND	213	106	200	0.956	
DRO >C10-C28	<10.0	10.0	06/21/2013	ND	213	106	200	3.66	

Surrogate: 1-Chlorooctane 93.4 % 65.2-140

Surrogate: 1-Chlorooctadecane 95.9 % 63.6-154

Cardinal Laboratories

\*=Accredited Analyte

PLEASE NOTE: Liability and Damages. Cardinal's liability and client's exclusive remedy for any claim arising, whether based in contract or tort, shall be limited to the amount paid by client for analyses. All claims, including those for negligence and any other cause whatsoever shall be deemed waived unless made in writing and received by Cardinal within thirty (30) days after completion of the applicable service. In no event shall Cardinal be liable for incidental or consequential damages, including, without limitation, business interruptions, loss of use, or loss of profits incurred by client, its subsidiaries, affiliates or successors arising out of or related to the performance of the services hereunder by Cardinal, regardless of whether such claim is based upon any of the above stated reasons or otherwise. Results relate only to the samples identified above. This report shall not be reproduced except in full with written approval of Cardinal Laboratories.



Celey D. Keene, Lab Director/Quality Manager





## Page 11 of 11

[illegible]

Relinquished By: <i>hus [Signature]</i>		Date: <i>6-17-13</i>		Received By: <i>[Signature]</i>		Phone Result: <input type="checkbox"/> Yes <input type="checkbox"/> No Add'l Phone #:	
Time: <i>1615</i>		Time: <i>1615</i>		Fax Result: <input type="checkbox"/> Yes <input type="checkbox"/> No Add'l Fax #:		REMARKS:	
Relinquished By: <i>[Signature]</i>		Date: <i>6-20-13</i>		Received By: <i>[Signature]</i>		Email:	
Time: <i>805</i>		Time: <i>805</i>		Sample Condition:		gawink@innEnergy.com	
Delivered By: (Circle One)		Cool <input checked="" type="checkbox"/> Intact <input checked="" type="checkbox"/>		CHECKED BY: <i>[Signature]</i>		Anuth @ diversified FSI.com	
Sampler - UPS - Bus - Other:		-3.4%		No <input type="checkbox"/> Yes <input type="checkbox"/>			

† Cardinal cannot accept verbal changes. Please fax written changes to (575) 393-2326



PHONE (575) 393-2326 • 101 E. MARLAND • HOBBS, NM 88240

---

July 02, 2013

GARY WINK

LINN OPERATING-HOBBS

2130 W. BENDER

HOBBS, NM 88240

RE: J L KEEL B #91

Enclosed are the results of analyses for samples received by the laboratory on 06/25/13 15:45.

Cardinal Laboratories is accredited through Texas NELAP under certificate number T104704398-11-3. Accreditation applies to drinking water, non-potable water and solid and chemical materials. All accredited analytes are denoted by an asterisk (\*). For a complete list of accredited analytes and matrices visit the TCEQ website at [www.tceq.texas.gov/field/qa/lab\\_accred\\_certif.html](http://www.tceq.texas.gov/field/qa/lab_accred_certif.html).

Cardinal Laboratories is accredited through the State of Colorado Department of Public Health and Environment for:

Method EPA 552.2	Haloacetic Acids (HAA-5)
Method EPA 524.2	Total Trihalomethanes (TTHM)
Method EPA 524.4	Regulated VOCs (V1, V2, V3)

Accreditation applies to public drinking water matrices.

This report meets NELAP requirements and is made up of a cover page, analytical results, and a copy of the original chain-of-custody. If you have any questions concerning this report, please feel free to contact me.

Sincerely,

Celey D. Keene

Lab Director/Quality Manager

**Analytical Results For:**

 LINN OPERATING-HOBBS  
 GARY WINK  
 2130 W. BENDER  
 HOBBS NM, 88240  
 Fax To: (575) 738-1740

 Received: 06/25/2013  
 Reported: 07/02/2013  
 Project Name: J L KEEL B #91  
 Project Number: NONE GIVEN  
 Project Location: NOT GIVEN

 Sampling Date: 06/24/2013  
 Sampling Type: Soil  
 Sampling Condition: Cool & Intact  
 Sample Received By: Jodi Henson

**Sample ID: SP 1 BOTTOM 2' (H301483-01)**

BTX 8021B			mg/kg		Analyzed By: AP				
Analyte	Result	Reporting Limit	Analyzed	Method Blank	BS	% Recovery	True Value QC	RPD	Qualifier
Benzene*	<0.050	0.050	06/28/2013	ND	1.80	89.8	2.00	15.2	
Toluene*	<0.100	0.100	06/28/2013	ND	1.94	97.1	2.00	15.4	
Ethylbenzene*	<0.050	0.050	06/28/2013	ND	2.05	102	2.00	16.5	
Total Xylenes*	<0.150	0.150	06/28/2013	ND	6.22	104	6.00	17.8	
Total BTX	<0.300	0.300	06/28/2013	ND					

Surrogate: 4-Bromofluorobenzene (PIE) 109 % 89.4-126

Chloride, SM4500Cl-B			mg/kg		Analyzed By: AP				
Analyte	Result	Reporting Limit	Analyzed	Method Blank	BS	% Recovery	True Value QC	RPD	Qualifier
Chloride	304	16.0	06/27/2013	ND	400	100	400	0.00	

TPH 8015M			mg/kg		Analyzed By: MS				
Analyte	Result	Reporting Limit	Analyzed	Method Blank	BS	% Recovery	True Value QC	RPD	Qualifier
GRO C6-C10	<10.0	10.0	06/26/2013	ND	208	104	200	0.798	
DRO >C10-C28	<10.0	10.0	06/26/2013	ND	220	110	200	0.475	

Surrogate: 1-Chlorooctane 93.7 % 65.2-140

Surrogate: 1-Chlorooctadecane 95.4 % 63.6-154

Cardinal Laboratories

\* = Accredited Analyte

PLEASE NOTE: Liability and Damages. Cardinal's liability and client's exclusive remedy for any claim arising, whether based in contract or tort, shall be limited to the amount paid by client for analyses. All claims, including those for negligence and any other cause whatsoever shall be deemed waived unless made in writing and received by Cardinal within thirty (30) days after completion of the applicable service. In no event shall Cardinal be liable for incidental or consequential damages, including, without limitation, business interruptions, loss of use, or loss of profits incurred by client, its subsidiaries, affiliates or successors arising out of or related to the performance of the services hereunder by Cardinal, regardless of whether such claim is based upon any of the above stated reasons or otherwise. Results relate only to the samples identified above. This report shall not be reproduced except in full with written approval of Cardinal Laboratories.

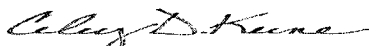

Celey D. Keene, Lab Director/Quality Manager

**Analytical Results For:**

 LINN OPERATING-HOBBS  
 GARY WINK  
 2130 W. BENDER  
 HOBBS NM, 88240  
 Fax To: (575) 738-1740

 Received: 06/25/2013  
 Reported: 07/02/2013  
 Project Name: J L KEEL B #91  
 Project Number: NONE GIVEN  
 Project Location: NOT GIVEN

 Sampling Date: 06/24/2013  
 Sampling Type: Soil  
 Sampling Condition: Cool & Intact  
 Sample Received By: Jodi Henson

**Sample ID: SP 2 BOTTOM 1' (H301483-02)**

BTEX 8021B			mg/kg		Analyzed By: AP				
Analyte	Result	Reporting Limit	Analyzed	Method Blank	BS	% Recovery	True Value QC	RPD	Qualifier
Benzene*	<0.050	0.050	06/28/2013	ND	1.80	89.8	2.00	15.2	
Toluene*	<0.050	0.050	06/28/2013	ND	1.94	97.1	2.00	15.4	
Ethylbenzene*	<0.050	0.050	06/28/2013	ND	2.05	102	2.00	16.5	
Total Xylenes*	<0.150	0.150	06/28/2013	ND	6.22	104	6.00	17.8	
Total BTEX	<0.300	0.300	06/28/2013	ND					

Surrogate: 4-Bromofluorobenzene (PIE) 92.3 % 89.4-126

Chloride, SM4500Cl-B			mg/kg		Analyzed By: AP				
Analyte	Result	Reporting Limit	Analyzed	Method Blank	BS	% Recovery	True Value QC	RPD	Qualifier
Chloride	272	16.0	06/27/2013	ND	400	100	400	0.00	

TPH 8015M			mg/kg		Analyzed By: MS				
Analyte	Result	Reporting Limit	Analyzed	Method Blank	BS	% Recovery	True Value QC	RPD	Qualifier
GRO C6-C10	<10.0	10.0	06/26/2013	ND	208	104	200	0.798	
DRO >C10-C28	12.0	10.0	06/26/2013	ND	220	110	200	0.475	

Surrogate: 1-Chlorooctane 89.0 % 65.2-140

Surrogate: 1-Chlorooctadecane 91.3 % 63.6-154

Cardinal Laboratories

\*=Accredited Analyte

PLEASE NOTE: Liability and Damages. Cardinal's liability and client's exclusive remedy for any claim arising, whether based in contract or tort, shall be limited to the amount paid by client for analyses. All claims, including those for negligence and any other cause whatsoever shall be deemed waived unless made in writing and received by Cardinal within thirty (30) days after completion of the applicable service. In no event shall Cardinal be liable for incidental or consequential damages, including, without limitation, business interruptions, loss of use, or loss of profits incurred by client, its subsidiaries, affiliates or successors arising out of or related to the performance of the services hereunder by Cardinal, regardless of whether such claim is based upon any of the above stated reasons or otherwise. Results relate only to the samples identified above. This report shall not be reproduced except in full with written approval of Cardinal Laboratories.



Celey D. Keene, Lab Director/Quality Manager

**Analytical Results For:**

 LINN OPERATING-HOBBS  
 GARY WINK  
 2130 W. BENDER  
 HOBBS NM, 88240  
 Fax To: (575) 738-1740

 Received: 06/25/2013  
 Reported: 07/02/2013  
 Project Name: J L KEEL B #91  
 Project Number: NONE GIVEN  
 Project Location: NOT GIVEN

 Sampling Date: 06/24/2013  
 Sampling Type: Soil  
 Sampling Condition: Cool & Intact  
 Sample Received By: Jodi Henson

**Sample ID: SP 3 BOTTOM 2' (H301483-03)**

BTX 8021B			mg/kg		Analyzed By: AP					
Analyte	Result	Reporting Limit	Analyzed	Method Blank	BS	% Recovery	True Value QC	RPD	Qualifier	
Benzene*	<0.050	0.050	06/28/2013	ND	1.80	89.8	2.00	15.2		
Toluene*	<0.050	0.050	06/28/2013	ND	1.94	97.1	2.00	15.4		
Ethylbenzene*	<0.050	0.050	06/28/2013	ND	2.05	102	2.00	16.5		
Total Xylenes*	<0.150	0.150	06/28/2013	ND	6.22	104	6.00	17.8		
Total BTX	<0.300	0.300	06/28/2013	ND						

Surrogate: 4-Bromofluorobenzene (PIE) 97.3 % 89.4-126

Chloride, SM4500Cl-B			mg/kg							
			Analyzed By: AP							
Analyte	Result	Reporting Limit	Analyzed	Method Blank	BS	% Recovery	True Value QC	RPD	Qualifier	
Chloride	64.0	16.0	06/27/2013	ND	400	100	400	0.00		

TPH 8015M			mg/kg							
			Analyzed By: MS							
Analyte	Result	Reporting Limit	Analyzed	Method Blank	BS	% Recovery	True Value QC	RPD	Qualifier	
GRO C6-C10	<10.0	10.0	06/26/2013	ND	208	104	200	0.798		
DRO >C10-C28	<10.0	10.0	06/26/2013	ND	220	110	200	0.475		

Surrogate: 1-Chlorooctane 92.0 % 65.2-140

Surrogate: 1-Chlorooctadecane 93.5 % 63.6-154

Cardinal Laboratories

\*=Accredited Analyte

PLEASE NOTE: Liability and Damages. Cardinal's liability and client's exclusive remedy for any claim arising, whether based in contract or tort, shall be limited to the amount paid by client for analyses. All claims, including those for negligence and any other cause whatsoever shall be deemed waived unless made in writing and received by Cardinal within thirty (30) days after completion of the applicable service. In no event shall Cardinal be liable for incidental or consequential damages, including, without limitation, business interruptions, loss of use, or loss of profits incurred by client, its subsidiaries, affiliates or successors arising out of or related to the performance of the services hereunder by Cardinal, regardless of whether such claim is based upon any of the above stated reasons or otherwise. Results relate only to the samples identified above. This report shall not be reproduced except in full with written approval of Cardinal Laboratories.

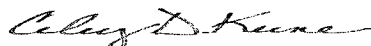

Celey D. Keene, Lab Director/Quality Manager

**Analytical Results For:**

LINN OPERATING-HOBBS  
 GARY WINK  
 2130 W. BENDER  
 HOBBS NM, 88240  
 Fax To: (575) 738-1740

Received: 06/25/2013  
 Reported: 07/02/2013  
 Project Name: J L KEEL B #91  
 Project Number: NONE GIVEN  
 Project Location: NOT GIVEN

Sampling Date: 06/24/2013  
 Sampling Type: Soil  
 Sampling Condition: Cool & Intact  
 Sample Received By: Jodi Henson

**Sample ID: SP 4 BOTTOM 1' (H301483-04)**

BTEX 8021B			mg/kg		Analyzed By: AP				
Analyte	Result	Reporting Limit	Analyzed	Method Blank	BS	% Recovery	True Value QC	RPD	Qualifier
Benzene*	<0.050	0.050	06/28/2013	ND	1.80	89.8	2.00	15.2	
Toluene*	<0.100	0.100	06/28/2013	ND	1.94	97.1	2.00	15.4	
Ethylbenzene*	<0.050	0.050	06/28/2013	ND	2.05	102	2.00	16.5	
Total Xylenes*	<0.150	0.150	06/28/2013	ND	6.22	104	6.00	17.8	
Total BTEX	<0.300	0.300	06/28/2013	ND					

Surrogate: 4-Bromofluorobenzene (PIL) 95.1 % 89.4-126

Chloride, SM4500Cl-B			mg/kg		Analyzed By: AP				
Analyte	Result	Reporting Limit	Analyzed	Method Blank	BS	% Recovery	True Value QC	RPD	Qualifier
Chloride	<16.0	16.0	06/27/2013	ND	400	100	400	0.00	

TPH 8015M			mg/kg		Analyzed By: MS				
Analyte	Result	Reporting Limit	Analyzed	Method Blank	BS	% Recovery	True Value QC	RPD	Qualifier
GRO C6-C10	<10.0	10.0	06/26/2013	ND	208	104	200	0.798	
DRO >C10-C28	<10.0	10.0	06/26/2013	ND	220	110	200	0.475	

Surrogate: 1-Chlorooctane 89.1 % 65.2-140

Surrogate: 1-Chlorooctadecane 88.2 % 63.6-154

Cardinal Laboratories

\*=Accredited Analyte

PLEASE NOTE: Liability and Damages. Cardinal's liability and client's exclusive remedy for any claim arising, whether based in contract or tort, shall be limited to the amount paid by client for analyses. All claims, including those for negligence and any other cause whatsoever shall be deemed waived unless made in writing and received by Cardinal within thirty (30) days after completion of the applicable service. In no event shall Cardinal be liable for incidental or consequential damages, including, without limitation, business interruptions, loss of use, or loss of profits incurred by client, its subsidiaries, affiliates or successors arising out of or related to the performance of the services hereunder by Cardinal, regardless of whether such claim is based upon any of the above stated reasons or otherwise. Results relate only to the samples identified above. This report shall not be reproduced except in full with written approval of Cardinal Laboratories.



Celey D. Keene, Lab Director/Quality Manager

**Analytical Results For:**

 LINN OPERATING-HOBBS  
 GARY WINK  
 2130 W. BENDER  
 HOBBS NM, 88240  
 Fax To: (575) 738-1740

 Received: 06/25/2013  
 Reported: 07/02/2013  
 Project Name: J L KEEL B #91  
 Project Number: NONE GIVEN  
 Project Location: NOT GIVEN

 Sampling Date: 06/24/2013  
 Sampling Type: Soil  
 Sampling Condition: Cool & Intact  
 Sample Received By: Jodi Henson

**Sample ID: SP 5 BOTTOM 1' (H301483-05)**

BTEX 8021B			mg/kg		Analyzed By: AP					
Analyte	Result	Reporting Limit	Analyzed	Method Blank	BS	% Recovery	True Value QC	RPD	Qualifier	
Benzene*	<0.050	0.050	06/28/2013	ND	1.80	89.8	2.00	15.2		
Toluene*	<0.050	0.050	06/28/2013	ND	1.94	97.1	2.00	15.4		
Ethylbenzene*	<0.050	0.050	06/28/2013	ND	2.05	102	2.00	16.5		
Total Xylenes*	<0.150	0.150	06/28/2013	ND	6.22	104	6.00	17.8		
Total BTEX	<0.300	0.300	06/28/2013	ND						

Surrogate: 4-Bromofluorobenzene (PIC) 91.5 % 89.4-126

Chloride, 5M4500Cl-B			mg/kg							
			Analyzed By: AP							
Analyte	Result	Reporting Limit	Analyzed	Method Blank	BS	% Recovery	True Value QC	RPD	Qualifier	
Chloride	96.0	16.0	06/27/2013	ND	400	100	400	0.00		

TPH 8015M			mg/kg							
			Analyzed By: MS							
Analyte	Result	Reporting Limit	Analyzed	Method Blank	BS	% Recovery	True Value QC	RPD	Qualifier	
GRO C6-C10	<10.0	10.0	06/26/2013	ND	208	104	200	0.798		
DRO >C10-C28	<10.0	10.0	06/26/2013	ND	220	110	200	0.475		

Surrogate: 1-Chlorooctane 104 % 65.2-140

Surrogate: 1-Chlorooctadecane 99.4 % 63.6-154

Cardinal Laboratories

\*=Accredited Analyte

PLEASE NOTE: Liability and Damages. Cardinal's liability and client's exclusive remedy for any claim arising, whether based in contract or tort, shall be limited to the amount paid by client for analyses. All claims, including those for negligence and any other cause whatsoever shall be deemed waived unless made in writing and received by Cardinal within thirty (30) days after completion of the applicable service. In no event shall Cardinal be liable for incidental or consequential damages, including, without limitation, business interruptions, loss of use, or loss of profits incurred by client, its subsidiaries, affiliates or successors arising out of or related to the performance of the services hereunder by Cardinal, regardless of whether such claim is based upon any of the above stated reasons or otherwise. Results relate only to the samples identified above. This report shall not be reproduced except in full with written approval of Cardinal Laboratories.

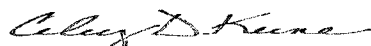

Celey D. Keene, Lab Director/Quality Manager

**Analytical Results For:**

 LINN OPERATING-HOBBS  
 GARY WINK  
 2130 W. BENDER  
 HOBBS NM, 88240  
 Fax To: (575) 738-1740

 Received: 06/25/2013  
 Reported: 07/02/2013  
 Project Name: J L KEEL B #91  
 Project Number: NONE GIVEN  
 Project Location: NOT GIVEN

 Sampling Date: 06/24/2013  
 Sampling Type: Soil  
 Sampling Condition: Cool & Intact  
 Sample Received By: Jodi Henson

**Sample ID: SP 6 BOTTOM 1' (H301483-06)**

BTEX 8021B			mg/kg		Analyzed By: AP					
Analyte	Result	Reporting Limit	Analyzed	Method Blank	BS	% Recovery	True Value QC	RPD	Qualifier	
Benzene*	<0.050	0.050	06/28/2013	ND	1.80	89.8	2.00	15.2		
Toluene*	<0.100	0.100	06/28/2013	ND	1.94	97.1	2.00	15.4		
Ethylbenzene*	<0.050	0.050	06/28/2013	ND	2.05	102	2.00	16.5		
Total Xylenes*	<0.150	0.150	06/28/2013	ND	6.22	104	6.00	17.8		
Total BTEX	<0.300	0.300	06/28/2013	ND						

Surrogate: 4-Bromofluorobenzene (PIE) 100 % 89.4-126

Chloride, SM4500Cl-B		mg/kg		Analyzed By: AP					
Analyte	Result	Reporting Limit	Analyzed	Method Blank	BS	% Recovery	True Value QC	RPD	Qualifier
Chloride	16.0	16.0	06/27/2013	ND	400	100	400	0.00	
TPH 8015M		mg/kg		Analyzed By: MS					

Analyte	Result	Reporting Limit	Analyzed	Method Blank	BS	% Recovery	True Value QC	RPD	Qualifier	
GRO C6-C10	<10.0	10.0	06/26/2013	ND	208	104	200	0.798		
DRO >C10-C28	<10.0	10.0	06/26/2013	ND	220	110	200	0.475		

Surrogate: 1-Chlorooctane 91.6 % 65.2-140

Surrogate: 1-Chlorooctadecane 90.9 % 63.6-154

Cardinal Laboratories

\*=Accredited Analyte

PLEASE NOTE: Liability and Damages. Cardinal's liability and client's exclusive remedy for any claim arising, whether based in contract or tort, shall be limited to the amount paid by client for analyses. All claims, including those for negligence and any other cause whatsoever shall be deemed waived unless made in writing and received by Cardinal within thirty (30) days after completion of the applicable service. In no event shall Cardinal be liable for incidental or consequential damages, including, without limitation, business interruptions, loss of use, or loss of profits incurred by client, its subsidiaries, affiliates or successors arising out of or related to the performance of the services hereunder by Cardinal, regardless of whether such claim is based upon any of the above stated reasons or otherwise. Results relate only to the samples identified above. This report shall not be reproduced except in full with written approval of Cardinal Laboratories.

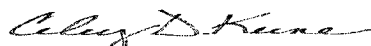

Caley D. Keene, Lab Director/Quality Manager





PHONE (575) 393-2326 • 101 E. MARLAND • HOBBS, NM 88240

**Analytical Results For:**

LINN OPERATING-HOBBS  
GARY WINK  
2130 W. BENDER  
HOBBS NM, 88240  
Fax To: (575) 738-1740

Received: 06/25/2013  
Reported: 07/02/2013  
Project Name: J L KEEL B #91  
Project Number: NONE GIVEN  
Project Location: NOT GIVEN

Sampling Date: 06/24/2013  
Sampling Type: Soil  
Sampling Condition: Cool & Intact  
Sample Received By: Jodi Henson

**Sample ID: SP 7 BOTTOM 1' (H301483-07)**

BTX 8021B			mg/kg		Analyzed By: AP					
Analyte	Result	Reporting Limit	Analyzed	Method Blank	BS	% Recovery	True Value QC	RPD	Qualifier	
Benzene*	<0.050	0.050	06/28/2013	ND	1.80	89.8	2.00	15.2		
Toluene*	<0.050	0.050	06/28/2013	ND	1.94	97.1	2.00	15.4		
Ethylbenzene*	<0.050	0.050	06/28/2013	ND	2.05	102	2.00	16.5		
Total Xylenes*	<0.150	0.150	06/28/2013	ND	6.22	104	6.00	17.8		
Total BTX	<0.300	0.300	06/28/2013	ND						

Surrogate: 4-Bromofluorobenzene (PID) 94.1 % 89.4-126

Chloride, SM4500CI-B			mg/kg							Analyzed By: AP	
Analyte	Result	Reporting Limit	Analyzed	Method Blank	BS	% Recovery	True Value QC	RPD	Qualifier		
Chloride	32.0	16.0	06/27/2013	ND	400	100	400	0.00			

TPH 8015M			mg/kg							Analyzed By: MS	
Analyte	Result	Reporting Limit	Analyzed	Method Blank	BS	% Recovery	True Value QC	RPD	Qualifier		
GRO C6-C10	<10.0	10.0	06/26/2013	ND	208	104	200	0.798			
DRO >C10-C28	<10.0	10.0	06/26/2013	ND	220	110	200	0.475			

Surrogate: 1-Chlorooctane 90.1 % 65.2-140

Surrogate: 1-Chlorooctadecane 82.2 % 63.6-154

Cardinal Laboratories

\*=Accredited Analyte

PLEASE NOTE: Liability and Damages. Cardinal's liability and client's exclusive remedy for any claim arising, whether based in contract or tort, shall be limited to the amount paid by client for analyses. All claims, including those for negligence and any other cause whatsoever shall be deemed waived unless made in writing and received by Cardinal within thirty (30) days after completion of the applicable service. In no event shall Cardinal be liable for incidental or consequential damages, including, without limitation, business interruptions, loss of use, or loss of profits incurred by client, its subsidiaries, affiliates or successors arising out of or related to the performance of the services hereunder by Cardinal, regardless of whether such claim is based upon any of the above stated reasons or otherwise. Results relate only to the samples identified above. This report shall not be reproduced except in full with written approval of Cardinal Laboratories.

Celest D. Keene, Lab Director/Quality Manager

**Analytical Results For:**

 LINN OPERATING-HOBBS  
 GARY WINK  
 2130 W. BENDER  
 HOBBS NM, 88240  
 Fax To: (575) 738-1740

 Received: 06/25/2013  
 Reported: 07/02/2013  
 Project Name: J L KEEL B #91  
 Project Number: NONE GIVEN  
 Project Location: NOT GIVEN

 Sampling Date: 06/24/2013  
 Sampling Type: Soil  
 Sampling Condition: Cool & Intact  
 Sample Received By: Jodi Henson

**Sample ID: SP 8 BOTTOM 1' (H301483-08)**

BTEX 8021B			mg/kg		Analyzed By: AP					
Analyte	Result	Reporting Limit	Analyzed	Method Blank	BS	% Recovery	True Value QC	RPD	Qualifier	
Benzene*	<0.050	0.050	06/28/2013	ND	1.80	89.8	2.00	15.2		
Toluene*	<0.050	0.050	06/28/2013	ND	1.94	97.1	2.00	15.4		
Ethylbenzene*	<0.050	0.050	06/28/2013	ND	2.05	102	2.00	16.5		
Total Xylenes*	<0.150	0.150	06/28/2013	ND	6.22	104	6.00	17.8		
Total BTEX	<0.300	0.300	06/28/2013	ND						

Surrogate: 4-Bromofluorobenzene (PIL) 106 % 89.4-126

Chloride, SM4500Cl-B			mg/kg							Analyzed By: AP	
Analyte	Result	Reporting Limit	Analyzed	Method Blank	BS	% Recovery	True Value QC	RPD	Qualifier		
Chloride	<16.0	16.0	06/27/2013	ND	400	100	400	0.00			

TPH 8015M			mg/kg							Analyzed By: MS	
Analyte	Result	Reporting Limit	Analyzed	Method Blank	BS	% Recovery	True Value QC	RPD	Qualifier		
GRO C6-C10	<10.0	10.0	06/26/2013	ND	208	104	200	0.798			
DRO >C10-C28	<10.0	10.0	06/26/2013	ND	220	110	200	0.475			

Surrogate: 1-Chlorooctane 90.1 % 65.2-140

Surrogate: 1-Chlorooctadecane 88.4 % 63.6-154

Cardinal Laboratories

\*=Accredited Analyte

PLEASE NOTE: Liability and Damages. Cardinal's liability and client's exclusive remedy for any claim arising, whether based in contract or tort, shall be limited to the amount paid by client for analyses. All claims, including those for negligence and any other cause whatsoever shall be deemed waived unless made in writing and received by Cardinal within thirty (30) days after completion of the applicable service. In no event shall Cardinal be liable for incidental or consequential damages, including, without limitation, business interruptions, loss of use, or loss of profits incurred by client, its subsidiaries, affiliates or successors arising out of or related to the performance of the services hereunder by Cardinal, regardless of whether such claim is based upon any of the above stated reasons or otherwise. Results relate only to the samples identified above. This report shall not be reproduced except in full with written approval of Cardinal Laboratories.

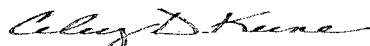

Celey D. Keene, Lab Director/Quality Manager

**Notes and Definitions**

ND	Analyte NOT DETECTED at or above the reporting limit
RPD	Relative Percent Difference
**	Samples not received at proper temperature of 6°C or below.
***	Insufficient time to reach temperature.
-	Chloride by SM4500Cl-B does not require samples be received at or below 6°C <i>Samples reported on an as received basis (wet) unless otherwise noted on report</i>

---

Cardinal Laboratories

\*=Accredited Analyte

PLEASE NOTE: Liability and Damages. Cardinal's liability and client's exclusive remedy for any claim arising, whether based in contract or tort, shall be limited to the amount paid by client for analyses. All claims, including those for negligence and any other cause whatsoever shall be deemed waived unless made in writing and received by Cardinal within thirty (30) days after completion of the applicable service. In no event shall Cardinal be liable for incidental or consequential damages, including, without limitation, business interruptions, loss of use, or loss of profits incurred by client, its subsidiaries, affiliates or successors arising out of or related to the performance of the services hereunder by Cardinal, regardless of whether such claim is based upon any of the above stated reasons or otherwise. Results relate only to the samples identified above. This report shall not be reproduced except in full with written approval of Cardinal Laboratories.



---

Celey D. Keene, Lab Director/Quality Manager



# CHAIN-OF-CUSTODY AND ANALYSIS REQUEST

101 East Marland, Hobbs, NM 88240  
(575) 393-2326 FAX (575) 393-2476

Company Name: <u>Linn Energy</u>				<b>BILL TO</b>				<b>ANALYSIS REQUEST</b>																					
Project Manager: <u>Gary Wink</u>				P.O. #:																									
Address:				Company:																									
City:		State:		Zip:		Attn:																							
Phone #:		Fax #:		Address:																									
Project #:		Project Owner:		City:																									
Project Name:				State:																									
Project Location: <u>JL Keel B #91</u>				Zip:																									
Sampler Name: <u>Luis Cardenas</u>				Phone #:																									
Fax #:																													
FOR LAB USE ONLY																													
Lab I.D.		Sample I.D.		GRAB OR (C)OMP.		# CONTAINERS		MATRIX				PRESERV.		SAMPLING															
								GROUNDWATER WASTEWATER SOIL OIL SLUDGE OTHER:				ACID/BASE ICE/COOL OTHER:		DATE		TIME													
<u>H301483</u>																													
<u>1</u>		<u>SP1 Bottom 2'</u>		<u>1</u>		<u>1</u>								<u>6/24</u>		<u>1305</u>		<u>Chlorides</u>											
<u>2</u>		<u>SP2 Bottom 1'</u>		<u>1</u>		<u>1</u>								<u>6/24</u>		<u>1322</u>		<u>TPH 8015m</u>											
<u>3</u>		<u>SP3 Bottom 2'</u>		<u>1</u>		<u>1</u>								<u>6/24</u>		<u>1407</u>		<u>BTEX</u>											
<u>4</u>		<u>SP4 Bottom 1'</u>		<u>1</u>		<u>1</u>								<u>6/24</u>		<u>1345</u>													
<u>5</u>		<u>SP5 Bottom 1'</u>		<u>1</u>		<u>1</u>								<u>6/24</u>		<u>1430</u>													
<u>6</u>		<u>SP6 Bottom 1'</u>		<u>1</u>		<u>1</u>								<u>6/24</u>		<u>1450</u>													
<u>7</u>		<u>SP7 Bottom 1'</u>		<u>1</u>		<u>1</u>								<u>6/24</u>		<u>1508</u>													
<u>8</u>		<u>SP8 Bottom 1'</u>		<u>1</u>		<u>1</u>								<u>6/24</u>		<u>1527</u>													

PLEASE NOTE: Liability and Damages. Cardinal's liability and client's exclusive remedy for any claim arising whether based in contract or tort, shall be limited to the amount paid by the client for the analyses. All claims, including those for negligence and any other cause whatsoever shall be deemed waived unless made in writing and received by Cardinal within 30 days after completion of the applicable service. In no event shall Cardinal be liable for incidental or consequential damages, including without limitation, business interruptions, loss of use, or loss of profits incurred by client, its subsidiaries, affiliates or successors arising out of or related to the performance of services hereunder by Cardinal, regardless of whether such claim is based upon any of the above stated reasons or otherwise.

Relinquished By: <u>Luis Cardenas</u>		Date: <u>6/25/13</u> Time: <u>2:45</u>		Received By: <u>Stephen McShan</u>		Phone Result: <input type="checkbox"/> Yes <input type="checkbox"/> No		Add'l Phone #:	
Relinquished By: <u>Stephen McShan</u>		Date: <u>6-25</u> Time: <u>3:45pm</u>		Received By: <u>Jodi Benson</u>		Fax Result: <input type="checkbox"/> Yes <input type="checkbox"/> No		Add'l Fax #:	
Delivered By: (Circle One)		Sample Condition		CHECKED BY:		REMARKS: <u>Email:</u> <u>gawink@linnenergy.com</u> <u>aruth@diversifiedpsi.com</u>			
Sampler - UPS - Bus - Other:		Cool <input checked="" type="checkbox"/> Intact <input type="checkbox"/> Yes <input type="checkbox"/> No <input type="checkbox"/>		Initials: <u>[Signature]</u>					

† Cardinal cannot accept verbal changes. Please fax written changes to (575) 393-2326

#54