



DHC 4.29.96

RC'd 4-8-96

Southern

Rockies

Business

Unit

April 4, 1996

Mr. William J. LeMay, Director
New Mexico Oil Conservation Division
2040 S. Pacheco Street
P. O. Box 6429
Santa Fe, NM 87505

DLP-1267

Application for Exception to Rule 303-C
Downhole Commingling
Jicarilla A Contract #3 Well
Unit A Section 19-T26N-R5W
Basin Dakota and Tapacito Gallup Pools
Rio Arriba County, New Mexico

Enclosed please find an administrative application form (C-107-A) and attachments for downhole commingling for the captioned well. Amoco is the only offset operator in both formations, so no offset operator notice is required.

Should you have questions concerning this matter, please contact me at (303) 830-5344.

Sincerely,

Pamela W. Staley

Enclosures

cc: Steve Smethie
Patty Haefele
Wellfile
Proration file

Frank Chavez, Supervisor
NMOCD District III
1000 Rio Brazos Road
Aztec, NM 87410

Robert Kent
Bureau of Land Management
435 Montano NE
Albuquerque, NM 87107

DISTRICT I
P.O. Box 1980, Hobbs NM 88241-1980

State of New Mexico
Energy, Minerals and Natural Resources Department

Form C-107-A
New 3-12-96

OIL CONSERVATION DIVISION

APPROVAL PROCESS:

DISTRICT II
811 South First St., Artesia, NM 88210-2835

2040 S. Pacheco
Santa Fe, New Mexico 87505-6429

☒ Administrative ☐ Hearing

DISTRICT III
1000 Rio Brazos Rd. Aztec, NM 87410-1693

APPLICATION FOR DOWNHOLE COMMINGLING

EXISTING WELLBORE
☒ YES ☐ NO

Amoco Production Company		P.O. Box 800 Denver, CO 80201	
Operator	Address	County	
Jicarilla /A/	3 Unit A Section 19-T26N-R5W	Rio Arriba	
Lease	Well No.	Unit Ltr. - Sec Twp - Rge	County
Spacing Unit Lease Types: (check 1 or more)			
OGRID NO. 000778	Property Code 000732	API NO. 3003908423	Federal <input checked="" type="checkbox"/> State <input type="checkbox"/> (and/or) Fee <input type="checkbox"/>

The following facts are submitted in support of downhole commingling:	Upper Zone	Intermediate Zone	Lower Zone
1. Pool Name and Pool Code	TAPACITO GALLUP 58090		BASIN DAKOTA 71599
2. Top and Bottom of Pay Section (Perforations)	6736' - 6740'		7227' - 7446'
3. Type of production (Oil or Gas)	GAS		GAS
4. Method of Production (Flowing or Artificial Lift)	FLOWING		FLOWING
5. Bottomhole Pressure Oil Zones - Artificial Lift: Estimated Current Gas & Oil - Flowing: Measured Current All Gas Zones: Estimated or Measured Original	a. (Current) 999 PSI	a.	a. 1126 PSI
	b. (Original) 1259 PSI	b.	b. 3042 PSI
6. Oil Gravity (° API) or Gas BTU Content	1259 BTU / 47.4 DEG API		1301 BTU / 55.6 DEG API
7. Producing or Shut-In?	PRODUCING		PRODUCING
Production Marginal? (yes or no) • If Shut-In, give data and oil/gas/water rates of last production Note: For new zones with no production history, applicant shall be required to attach production estimates and supporting data • If Producing, give date and oil/gas/water rates of recent test (within 60 days)	YES		NO
	Date: Rates:	Date: Rates:	Date: Rates:
	2/96 20 MCFD 0.25 BCPD 0 BWPD	Date: Rates:	2/96 94 MCFD 0.50 BCPD 0.01 BWPD
8. Fixed Percentage Allocation Formula -% for each zone	Oil: 33 % Gas 18 %	Oil: % Gas %	Oil: 67 % Gas 82 %

9. If allocation formula is based upon something other than current or past production, or is based upon some other method, submit attachments with supporting data and/or explaining method and providing rate projections or other required data.

10. Are all working, overriding, and royalty interests identical in all commingled zones? ☒ Yes ☐ No
If not, have all working, overriding, and royalty interests been notified by certified mail? ☐ Yes ☐ No
Have all offset operators been given written notice of the proposed downhole commingling? ☒ Yes ☐ No

11. Will cross-flow occur? ☐ Yes ☒ No If yes, are fluids compatible, will the formations not be damaged, will any cross-flowed production be recovered, and will the allocation formula be reliable. ☐ Yes ☐ No (If No, attach explanation)

12. Are all produced fluids from all commingled zones compatible with each other? ☒ Yes ☐ No

13. Will the value of production be decreased by commingling? ☐ Yes ☒ No (If Yes, attach explanation)

14. If this well is on, or communitized with, state or federal lands, either the Commissioner of Public Lands or the United States Bureau of Land Management has been notified in writing of this application. ☒ Yes ☐ No JICARILLA A (JICARILLA 110 LEASE)

15. NMOCD Reference Cases for Rule 303(D) Exceptions: ORDER NO(S) _____

16. ATTACHMENTS:

- * C-102 for each zone to be commingled showing its spacing unit and acreage dedication.
- * Production curve for each zone for at least one year. (If not available, attach explanation.)
- * For zones with no production history, estimated production rates and supporting data.
- * Data to support allocation method or formula.
- * Notification list of all offset operators.
- * Notification list of working, overriding, and royalty interests for uncommon interest cases.
- * Any additional statements, data, or documents required to support commingling.

I hereby certify that the information above is true and complete to the best of my knowledge and belief.

SIGNATURE Pamela W. Staley TITLE REGULATORY AFFAIRS REP DATE 4/3/96
TYPE OR PRINT NAME PAMELA W. STALEY TELEPHONE NO. (303) 830-5344

MEXICO OIL CONSERVATION COMMISS
WELL LOCATION AND ACREAGE DEDICATION PLAT

Form O-102
 Supersedes O-128
 Effective 1-1-66

All distances must be from the outer boundaries of the Section

Operator TENNECO OIL COMPANY			Lease JICORILLA "A"		Well No. 3
Unit Letter A	Section 19	Range 26 North	Range 5 West	County Rio Arriba	
Actual Tract Location of Well:					
900	feet from the	North	line and	990	feet from the
				East	line
Ground Level Elev. 6599' ungraded		Producing Formation Basin Dakota		Pool Basin Dakota	Dedicated Acreage 320 Acres

1. Outline the acreage dedicated to the subject well by colored pencil or hatchure marks on the plat below.
2. If more than one lease is dedicated to the well, outline each and identify the ownership thereof (both as to working interest and royalty).
3. If more than one lease of different ownership is dedicated to the well, have the interests of all owners been consolidated by communitization, unitization, force-pooling, etc?

☐ Yes ☐ No If answer is "yes," type of consolidation _____

If answer is "no," list the owners and tract descriptions which have actually been consolidated. (Use reverse side of this form if necessary.) _____

No allowable will be assigned to the well until all interests have been consolidated (by communitization, unitization, forced-pooling, or otherwise) or until a non-standard unit, eliminating such interests, has been approved by the Commission.

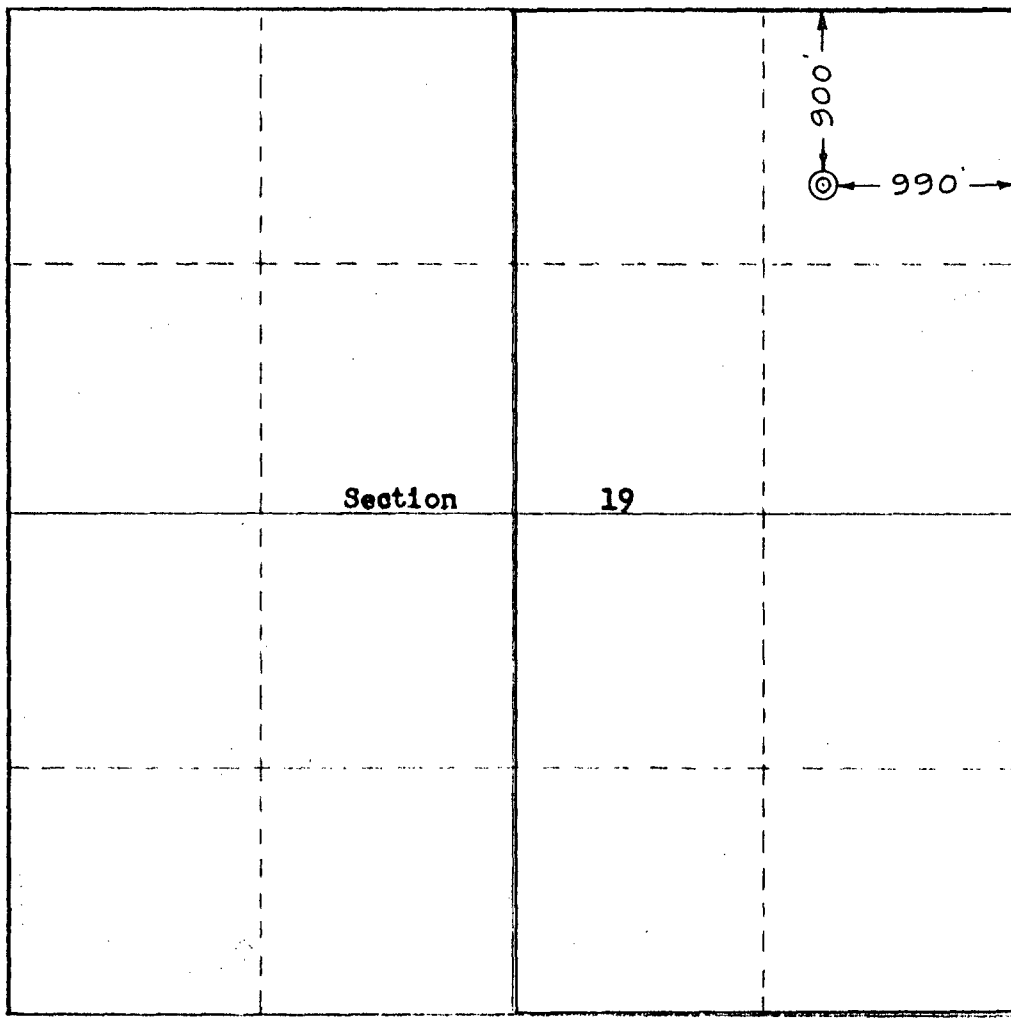

CERTIFICATION

I hereby certify that the information contained herein is true and complete to the best of my knowledge and belief.
 Signed By
W. C. NICHOLS

Name
Senior Production Clerk
 Position
Tenneco Oil Company
 Company
Box 1714, Durango, Colo.
 Date
8-18-65

I hereby certify that the well location shown on this plat was plotted from field notes of actual surveys made by me or under my supervision, and that the same is true and correct to the best of my knowledge and belief.

Date Surveyed
17 June 1965
 Surveyed By
Robert H. Ernst
 Signature
ROBERT H. ERNST

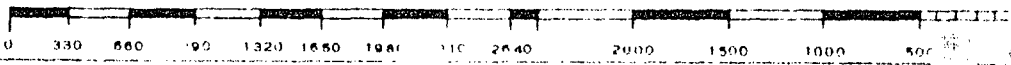

N. Mex. PE & LS 2463

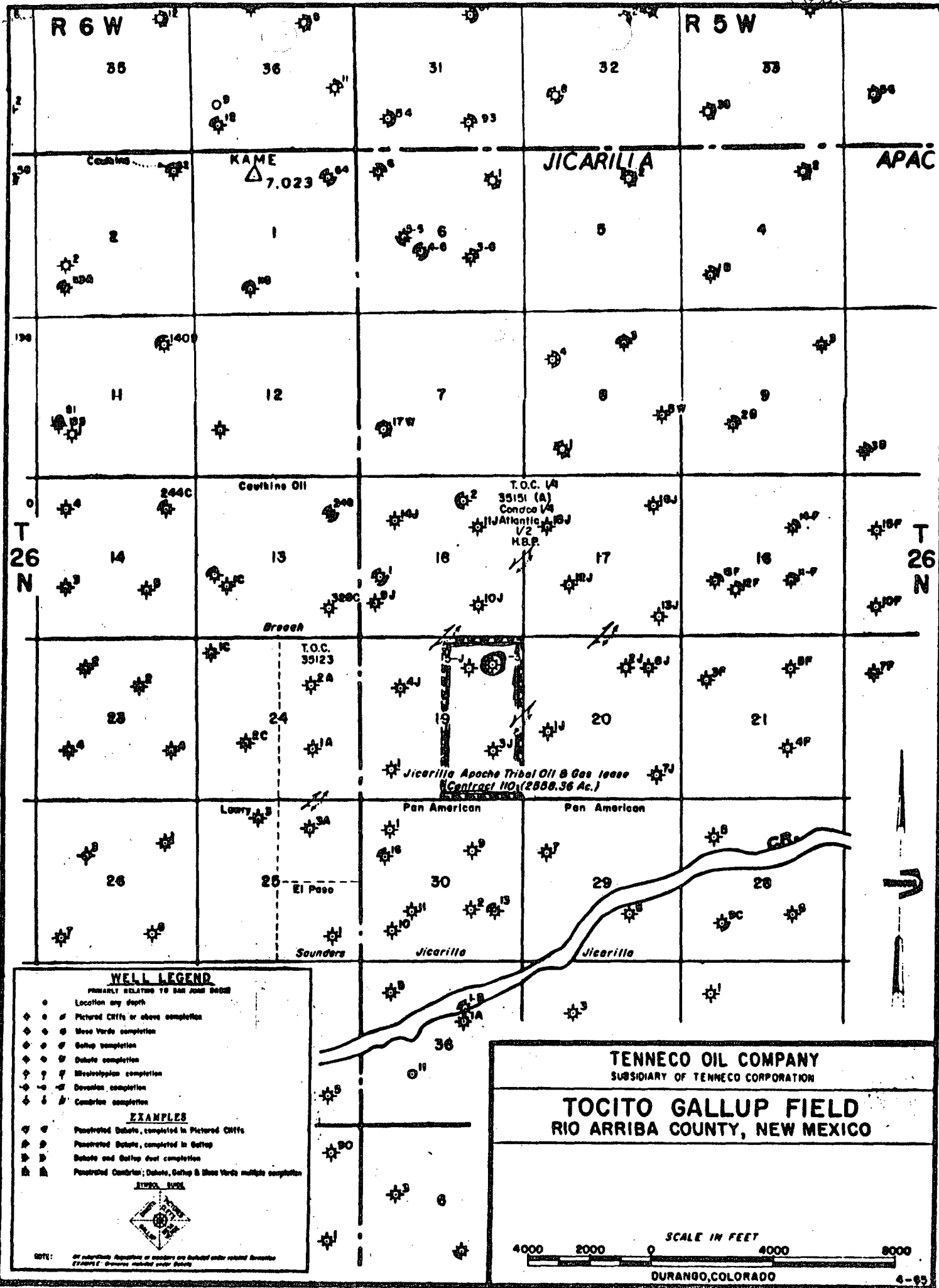

Engr: zhab0b

JICARILLA A 3

Operator- AMOCO PRODUCTION CO

300390642300DK A192605-003 DK

APC_WI - 0.75000000

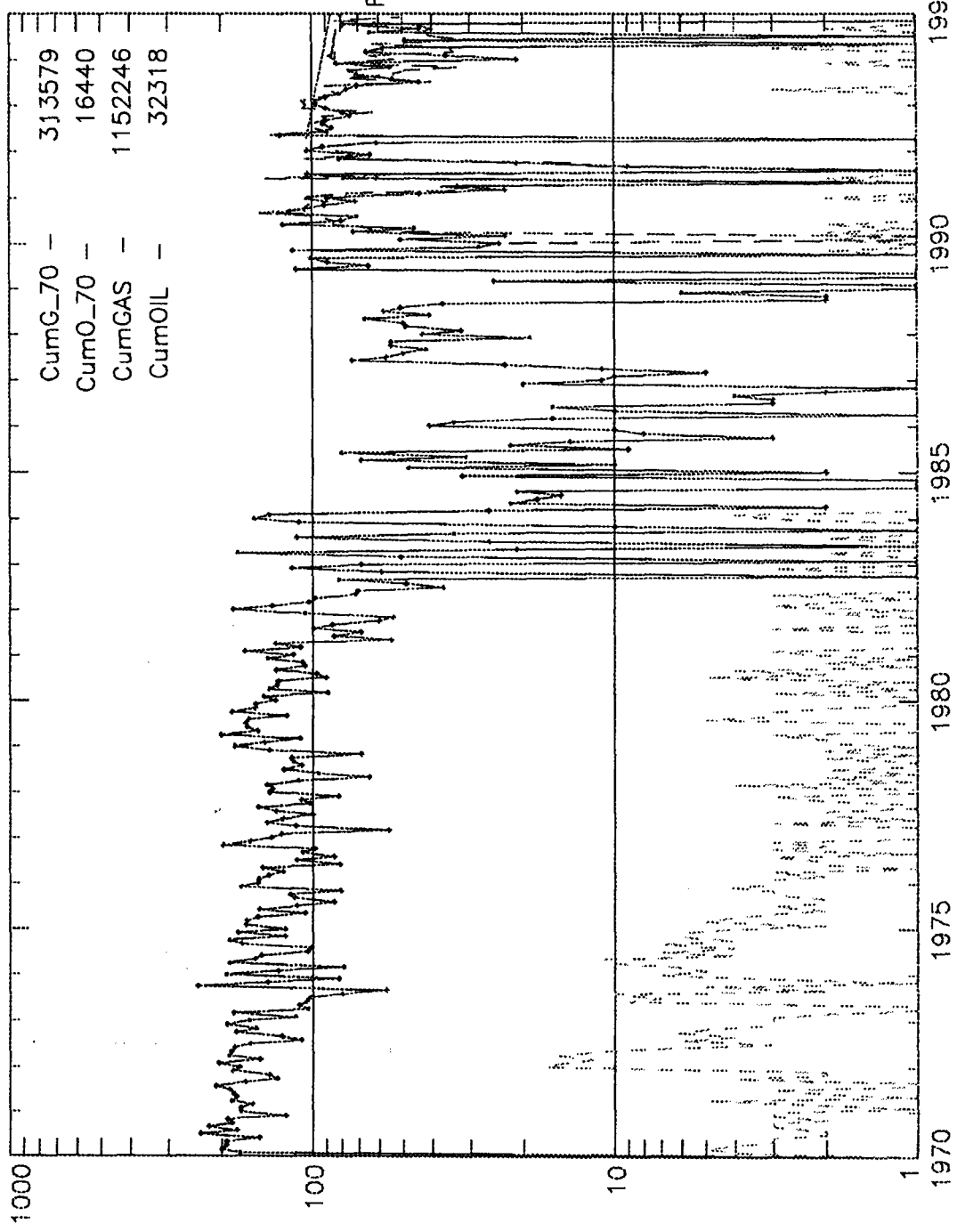

Engr: zhab0b

JICARILLA A 3

Operator- AMOCO PRODUCTION CO

300390642300GP A192605-003 GP

APC_WI - 0.75000000

