

DHC 129/

6/24/96

RECEIVED

DISTRICT I
P.O. Box 1980, Hobbs, NM 88241-1980
JUN - 3 1996
811 South First St., Artesia, NM 88210-2835
DISTRICT III
1000 Rio Brazos Rd., Aztec, NM 87410-1693

State of New Mexico
Energy, Minerals and Natural Resources Department

Form C-107-A
New 3-12-96

OIL CONSERVATION DIVISION

2040 S. Pacheco
Santa Fe, New Mexico 87505-6429

APPROVAL PROCESS:

☒ Administrative ☐ Hearing

EXISTING WELLBORE

☒ YES ☐ NO

APPLICATION FOR DOWNHOLE COMMINGLING

Operator Conoco Inc. Address 10 Desta Dr., Ste 100W, Midland TX 79705

Lease AXI Apache J Well No. 22 Unit Ltr. - Sec - Twp - Rge L-6-25N-5W County Rio Arriba

OGRID NO. 005073 Property Code 003132 API NO. 30-039-20438 Spacing Unit Lease Types: (check 1 or more)
Federal ☒ , State ☐ , (and/or) Fee ☐

The following facts are submitted in support of downhole commingling:	Upper Zone	Intermediate Zone	Lower Zone
1. Pool Name and Pool Code	Otero Chacra 82329		Blanco Mesaverde 72319
2. Top and Bottom of Pay Section (Perforations)	3566' - 3586'		4831' - 5058'
3. Type of production (Oil or Gas)	Gas		Gas
4. Method of Production (Flowing or Artificial Lift)	Flowing		Flowing
5. Bottomhole Pressure Oil Zones - Artificial Lift: Estimated Current Gas & Oil - Flowing: Measured Current All Gas Zones: Estimated Or Measured Original	a. (Current) 265 psia b. (Original) 886 psia	a. b.	a. 349 psia b. 1564 psia
6. Oil Gravity (° API) or Gas BTU Content	1233 BTU		1245 BTU
7. Producing or Shut-In?	Producing		Producing
Production Marginal? (yes or no)	Yes		Yes
* If Shut-In, give date and oil/gas/water rates of last production Note: For new zones with no production history, applicant shall be required to attach production estimates and supporting data * If Producing, give date and oil/gas/water rates of recent test (within 60 days)	Date: Rates: 1996 mid/yr Rates: .0015 bbl/mcf 33 mcf/gpd, 0 bwpd	Date: Rates: Date: Rates:	Date: Rates: 1996 mid/yr Rates: .0092 bbl/mcf 64 mcf/gpd, 0 bwpd
8. Fixed Percentage Allocation Formula - % for each zone	Oil: 0 % Gas: 34 %	Oil: % Gas: %	Oil: 100 % Gas: 66 %

9. If allocation formula is based upon something other than current or past production, or is based upon some other method, submit attachments with supporting data and/or explaining method and providing rate projections or other required data.

10. Are all working, overriding, and royalty interests identical in all commingled zones? ☒ Yes ☐ No
If not, have all working, overriding, and royalty interests been notified by certified mail? ☐ Yes ☐ No
Have all offset operators been given written notice of the proposed downhole commingling? ☒ Yes ☐ No

11. Will cross-flow occur? ☒ Yes ☐ No If yes, are fluids compatible, will the formations not be damaged, will any cross-flowed production be recovered, and will the allocation formula be reliable. ☒ Yes ☐ No (If No, attach explanation)

12. Are all produced fluids from all commingled zones compatible with each other? ☒ Yes ☐ No

13. Will the value of production be decreased by commingling? ☐ Yes ☒ No (If Yes, attach explanation)

14. If this well is on, or communitized with, state or federal lands, either the Commissioner of Public Lands or the United States Bureau of Land Management has been notified in writing of this application. ☒ Yes ☐ No

15. NMOCD Reference Cases for Rule 303(D) Exceptions: ORDER NO(S). _____

16. ATTACHMENTS:

- * C-102 for each zone to be commingled showing its spacing unit and acreage dedication.
- * Production curve for each zone for at least one year. (If not available, attach explanation.)
- * For zones with no production history, estimated production rates and supporting data.
- * Data to support allocation method or formula.
- * Notification list of all offset operators.
- * Notification list of working, overriding, and royalty interests for uncommon interest cases.
- * Any additional statements, data, or documents required to support commingling.

I hereby certify that the information above is true and complete to the best of my knowledge and belief.

SIGNATURE Jerry W. Hoover Sr. Conservation TITLE Coordinator DATE 5/31/96

TYPE OR PRINT NAME Jerry W. Hoover TELEPHONE NO. (915) 686-6548

AXI APACHE J NO. 22 CHACRA PRODUCTION
SECTION 6L-25N-05W

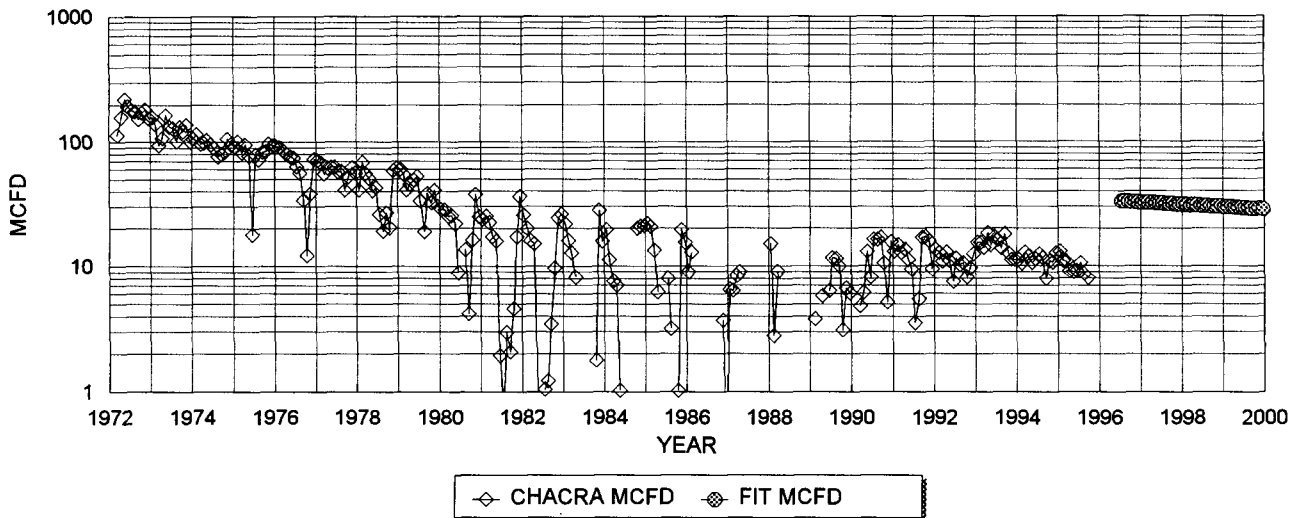

CHACRA HISTORICAL DATA:		1ST PROD: 3/72	CHACRA	PROJECTED DATA
OIL CUM:	0.43	MBO	7/1/96 Qi:	33 MCFD; RISKED ANTICIPATED RATE
GAS CUM:	293.5	MMCF	DECLINE RATE:	4.0% (EXPONENTIAL)
OIL YIELD:	0.0015	BBL/MCF		

AXI APACHE J NO. 22 MESAVERDE PRODUCTION
SECTION 6L-25N-05W

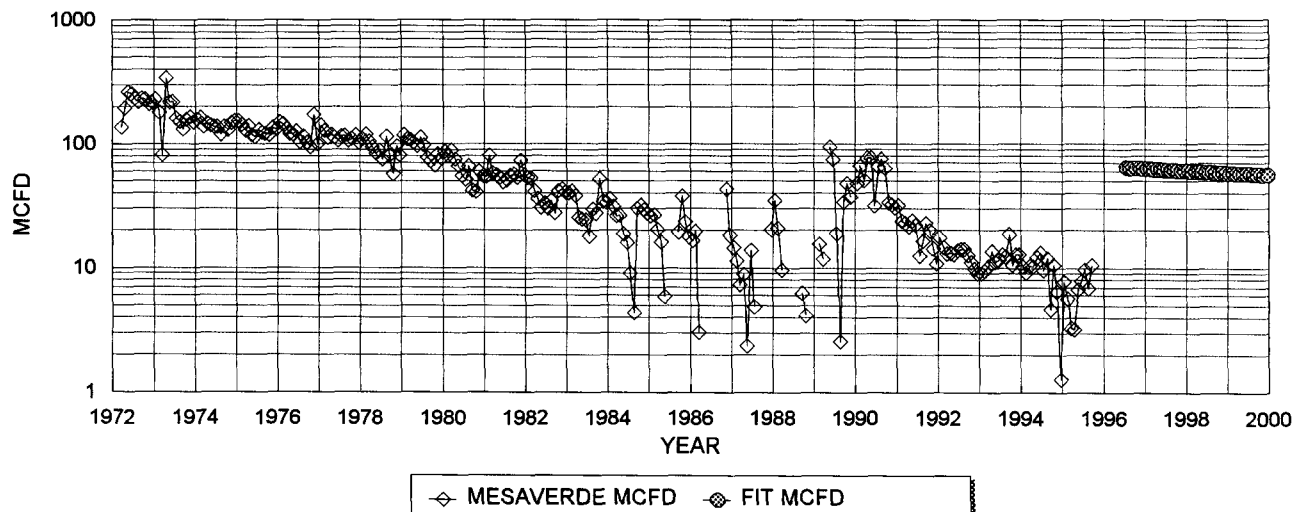

MESAVERDE HISTORICAL DATA		1ST PROD: 3/72	MESAVERDE PROJECTED DATA	
OIL CUM:	4.9	MBO	7/1/96 Qi:	64 MCFD; RISKED ANTICIPATED RATE
GAS CUM:	531.6	MMCF	DECLINE RATE:	4.0% (EXPONENTIAL)
OIL YIELD:	0.0092	BBL/MCF		

FIXED COMMINGLE ALLOCATION FACTORS:		
	GAS	OIL
MESAVERDE	66%	100.00%
CHACRA	34%	0%

GAS ALLOCATION BASED ON PROJECTED 1996 RATES
OIL ALLOCATION BASED ON WEIGHTED CUM OIL YIELDS

NOTE: ALL PRODUCTION DATA FROM DWIGHTS ENERGYDATA

NEW MEXICO OIL CONSERVATION COMMISSION
WELL LOCATION AND ACREAGE DEDICATION PLAT

Form C-102
Supersedes C-128
Effective 1-1-65

All distances must be from the outer boundaries of the Section.

Operator CONOCO INC.			Lease AXI APACHE J		Well No. 22
Unit Letter L	Section 6	Township 25-N	Range 5-W	County RIO ARriba	
Actual Postage Location of Well: 1695 feet from the SOUTH line and 950 feet from the WEST line					
Ground Level Elev. 6524'	Producing Formation MESAVERDE	Pool BLANCO MESAVERDE	Dedicated Acreage: 319.11 Acres		

1. Outline the acreage dedicated to the subject well by colored pencil or hachure marks on the plat below.
2. If more than one lease is dedicated to the well, outline each and identify the ownership thereof (both as to working interest and royalty).
3. If more than one lease of different ownership is dedicated to the well, have the interests of all owners been consolidated by communization, unitization, force-pooling, etc?

☐ Yes ☐ No If answer is "yes," type of consolidation _____

If answer is "no," list the owners and tract descriptions which have actually been consolidated. (Use reverse side of this form if necessary.) _____

No allowable will be assigned to the well until all interests have been consolidated (by communization, unitization, forced-pooling, or otherwise) or until a non-standard unit, eliminating such interests, has been approved by the Commission.

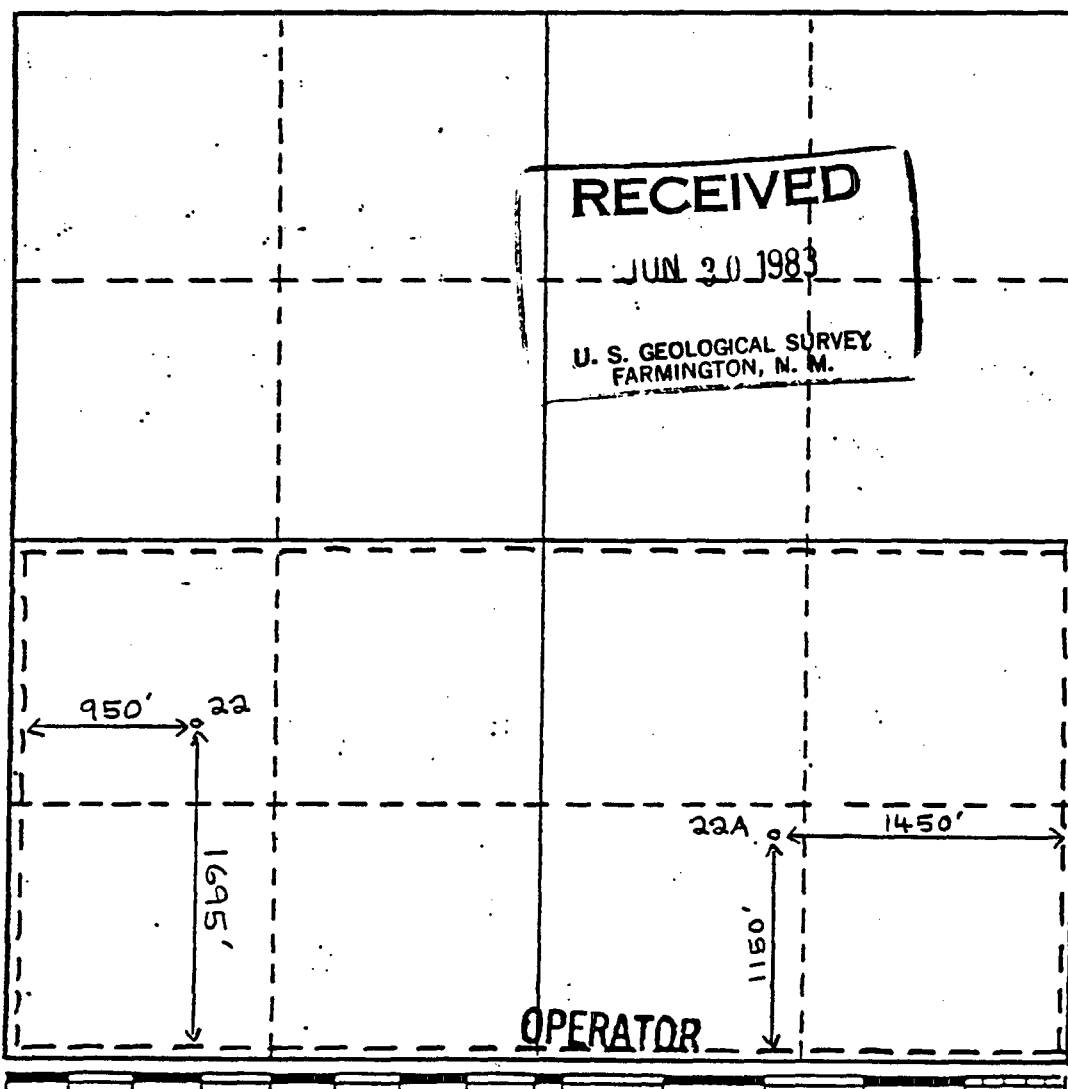

CERTIFICATION

I hereby certify that the information contained herein is true and complete to the best of my knowledge and belief.

Name *W. A. Hetherford*
Position Administrative Supervisor
Company CONOCO INC.
Date 6/28/83

I hereby certify that the well location shown on this plat was plotted from field notes of actual surveys made by me or under my supervision, and that the same is true and correct to the best of my knowledge and belief.

RECORDED FOR RECORD
Date Surveyed _____

Registered Professional Engineer and/or Land Surveyor
1985

Certificate No. _____

NEW MEXICO OIL CONSERVATION COMMISSION

WELL LOCATION AND ACERAGE DEDICATION PLAT

All distances must be from the outer boundaries of the Section

Operator: **CONTINENTAL OIL COMPANY** Lease: **JICARILLA "J"** Well No: **18 22**

Unit Letter: **L** Section: **6** Township: **25 NORTH** Range: **5 WEST** County: **RIO ARriba**

Actual Footage Location of Well: **1695** feet from **SOUTH** line of **950** feet from the **WEST** line

Ground Level Elev: **6524.0** Dedication/Acreage: **160 Acres**

1. Outline the acreage dedicated to the subject well by colored pencil or hatchure marks on the plat below.
 2. If more than one lease is dedicated to the well, outline each and identify the ownership thereof (both as to working interest and royalty).
 3. If more than one lease of different ownership is dedicated to the well, have the interests of all owners been consolidated by communization, unitization, force-pooling, etc?
- () Yes () No If answer is "yes," type of consolidation _____

If answer is "no" list the owners and tract descriptions which have actually consolidated (Use reverse side of this form if necessary.) _____

No allowable will be assigned to the well until all interests have been consolidated (by communization, unitization, forced-pooling, or otherwise) or until a non standard unit, eliminating such interests, has been approved by the Commission.

CERTIFICATION

I hereby certify that the information contained herein is true and complete to the best of my knowledge and belief.

Name _____

Position: **Administrative Supervisor**

Company: **Continental Oil Company**

Date: **November 15, 1971**

I hereby certify that the well location shown on this plat was plotted from field notes of actual surveys made by me or under my supervision, and that the same is true and correct to the best of my knowledge and belief.

18 August, 1971

James P. Hesch
 Registered Professional Engineer
JAMES P. HESCH

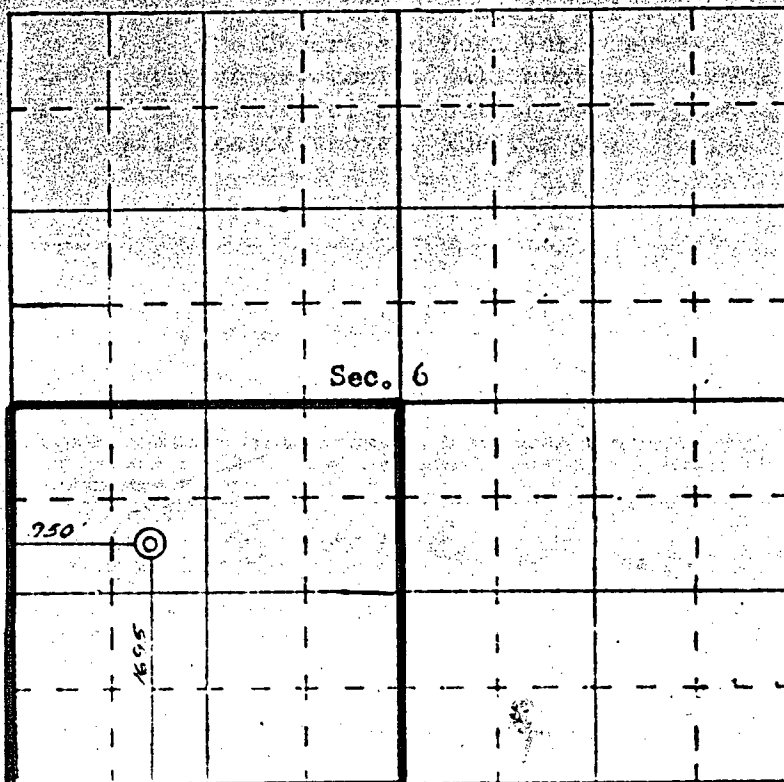

SCALE--4 INCHES EQUALS 1 MILE

Dwights

1000 Lease: AXI APACHE J 000022

Retrieval Code: 251,039,25N05W06L00C

1000

1000

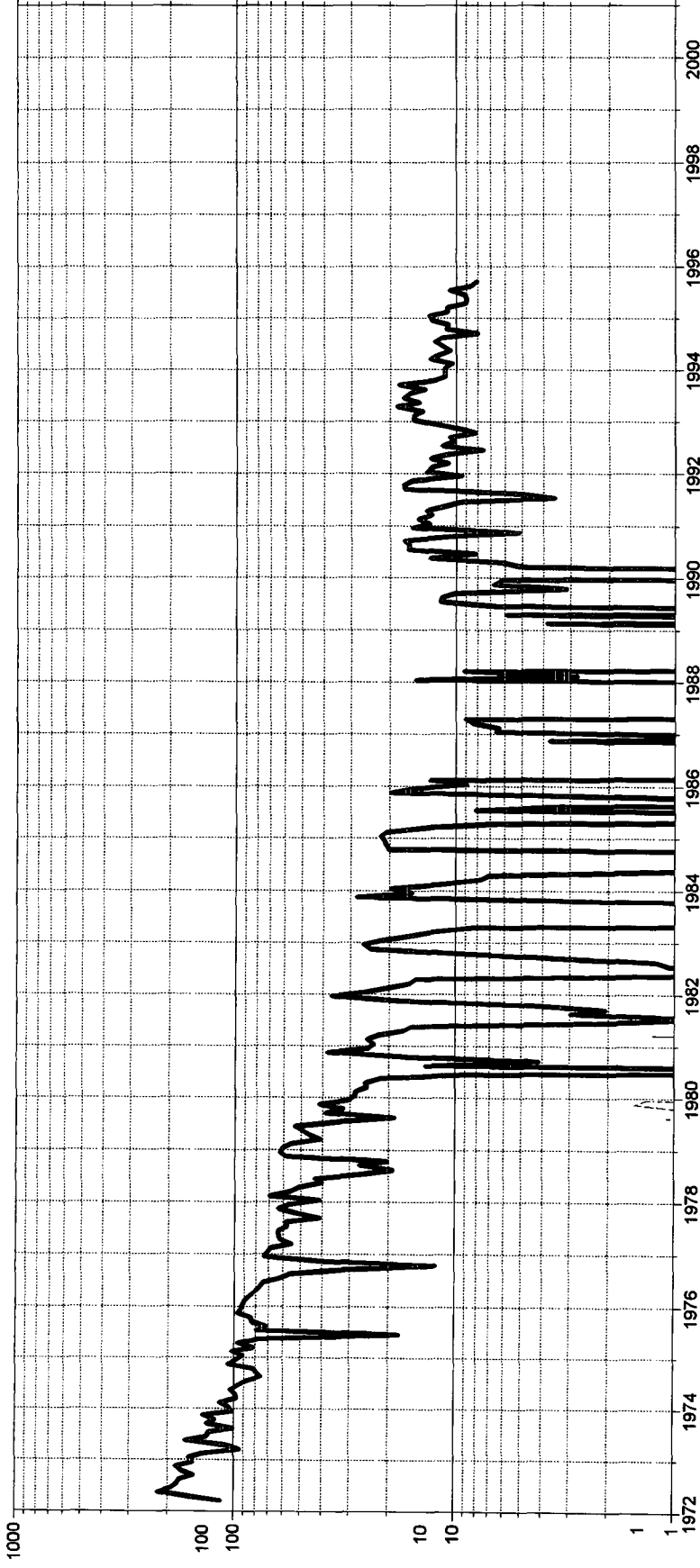

County: RIO ARRIBA

Field: OTERO (CHACRA) CK

Reservoir: CHACRA

Operator: CONOCO INC

State: NM

Oil Cum: 432 bbl

Gas Cum: 293530 mcf

Location: 6L 25N 5W

F.P. Date: 03/72

Date: 04/22/96

Water (bbl/day)

Well Count

Gas (mcf/day)

Oil (bbl/day)

Dwights

1000 Lease: AXI APACHE J 000022

Retrieval Code: 251,039,25N05W06L00M

1000

1000

100

100

10

10

1

1

1000

1000

100

100

10

10

1

1

1000

1000

100

100

10

10

1

1

1000

1000

100

100

10

10

1

1

1000

1000

100

100

10

10

1

1

1000

1000

100

100

10

10

1

1

1000

1000

100

100

10

10

1

1

1000

1000

100

100

10

10

1

1

1000

1000

100

100

10

10

1

1

1000

1000

100

100

10

10

1

1

1000

1000

100

100

10

10

1

1

1000

1000

100

100

10

10

1

1

1000

1000

100

100

10

10

1

1

1000

1000

100

100

10

10

1

1

1000

1000

100

100

10

10

1

1

1000

1000

100

100

10

10

1

1

1000

1000

100

100

10

10

1

1

1000

1000

100

100

10

10

1

1

1000

1000

100

100

10

10

1

1

1000

1000

100

100

10

10

1

1

1000

1000

100

100

10

10

1

1

1000

1000

100

100

10

10

1

1

1000

1000

100

100

10

10

1

1

1000

1000

100

100

10

10

1

1

1000

1000

100

100

10

10

1

1

1000

1000

100

100

10

10

1

1

1000

1000

100

100

10

10

1

1

1000

1000

100

100

10

10

1

1

1000

1000

100

100

10

10

1

1

1000

1000

100

100

10

10

1

1

1000

1000

100

100

10

10

1

1

1000

1000

100

100

10

10

1

1

1000

1000

100

100

10

10

1

1

1000

1000

100

100

10

10

1

1

1000

1000

100

100

10

10

1

1

1000

1000

100

100

10

10

1

1

1000

1000

100

100

10

10

1

1

1000

1000

100

100

10

10

1

1

1000

1000

100

100

10

10

1

1

1000

1000

100

100

10

10

1

1

1000

1000

100

100

10

10

1

1

1000

1000

100

100

10

10

1

1

1000

1000

100

100

10

10

1

1

1000

1000

100

100

10

10

1

1

1000

1000

100

100

10

10

1

1

1000

1000

100

100

10

AXI APACHE J # 22

OFFSET OPERATORS

