

District I
1625 N. French Dr., Hobbs, NM 88240
District II
811 S. First St., Artesia, NM 88210
District III
1000 Rio Brazos Road, Aztec, NM 87410
District IV
1220 S. St. Francis Dr., Santa Fe, NM 87505

State of New Mexico
Energy Minerals and Natural Resources
Oil Conservation Division
1220 South St. Francis Dr.
Santa Fe, NM 87505

Form C-141
Revised August 8, 2011

Submit 1 Copy to appropriate District Office in
accordance with 19.15.29 NMAC.

Release Notification and Corrective Action

RECEIVED

OPERATOR

☒ Initial Report ☐ Final Report

Name of Company Apache Corporation	Contact Natalie Gladden	
Address PO Box 1849, Eunice NM 88231	Telephone No. 575-390-4186	
Facility Name Lockhart B13 A SWD (nearest well #1)	Facility Type SWD	
Surface Owner BLM	Mineral Owner BLM/State	API No. 30-025-06555

LOCATION OF RELEASE

Unit Letter	Section	Township	Range	Feet from the	North/South Line	Feet from the	East/West Line	County
M	13	21S	37E	660	FSL	660	FWL	Lea

Latitude _____ Longitude _____

NATURE OF RELEASE

Type of Release Produced water	Volume of Release 18	Volume Recovered 15
Source of Release Ceramic plunger	Date and Hour of Occurrence 12/22/2012 1030am	Date and Hour of Discovery Same
Was Immediate Notice Given? <input type="checkbox"/> Yes <input checked="" type="checkbox"/> No <input type="checkbox"/> Not Required	If YES, To Whom? Geoffrey Leking/James Amos	
By Whom? Natalie Gladden	Date and Hour 12/27/12 615am	
Was a Watercourse Reached? <input type="checkbox"/> Yes <input checked="" type="checkbox"/> No	If YES, Volume Impacting the Watercourse.	

If a Watercourse was Impacted, Describe Fully.*



Describe Cause of Problem and Remedial Action Taken.*

The ceramic plunger broke on the triplex pump due to freezing weather. All fluid was released inside the containment area. Fluid was recovered by usage of vacuum truck. Initial samples have been taken to determine the remediation plan.

Describe Area Affected and Cleanup Action Taken.*

This facility does not have a liner. A remediation plan will be submitted to the NMOCD/BLM and all guidelines will be followed to closure.

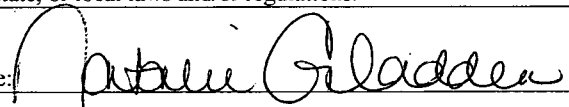
I hereby certify that the information given above is true and complete to the best of my knowledge and understand that pursuant to NMOCD rules and regulations all operators are required to report and/or file certain release notifications and perform corrective actions for releases which may endanger public health or the environment. The acceptance of a C-141 report by the NMOCD marked as "Final Report" does not relieve the operator of liability should their operations have failed to adequately investigate and remediate contamination that pose a threat to ground water, surface water, human health or the environment. In addition, NMOCD acceptance of a C-141 report does not relieve the operator of responsibility for compliance with any other federal, state, or local laws and/or regulations.

Signature: 	OIL CONSERVATION DIVISION 	
Printed Name: Natalie Gladden	Approved by Environmental Specialist: 	
Title: Sr. Environmental Tech	Approval Date: 01/13/13	Expiration Date: 03/13/13
E-mail Address: natalie.gladden@apachecorp.com	Conditions of Approval: SUBMIT FINAL C-141 BY 3/13/13	Attached <input type="checkbox"/> IRP-06-14-3076
Date: 12/27/2012 Phone: 575-390-4186		

* Attach Additional Sheets If Necessary

NSAD141775726



Internal Incident Report – Spill/Release

HOBBS OCD

DEC 27 2012

RECEIVED

Location: Lockhart B13 A SWD

Production Area: Eunice North

District: New Mexico

Production Foreman: James Pyle

Pumper: Johnny Lopez

Date: 12/22/2012

Time: 10:30am

One Line Summary: Ceramic plunger broke on triplex pump due to freezing weather.

Full summary: The ceramic plunger broke on the triplex pump. The pump is located between the tank and the disposal well. The release area is all within the containment walls of this SWD. This triplex pump starts and stops its own operation based on tank level set points. This triplex pump has three plungers which actuate the pump to transfer fluid out of the tanks. When the plunger broke, produced water began to release inside the containment area. The pump was found not to be operational at the time the leak was found. Approximately 18bbbls of produced water was released. Approximately 15bbbls of produced water was recovered.

Remediation Plan:

This facility does not have a surface liner therefore we will formulate a remediation plan and submit to the NMOCD for approval. The initial assessment will be completed on 12/26/2012 and a Risk Based Closure will be submitted on behalf of Apache Corporation, requesting that only 6" of contaminated soil be excavated at this time to ensure the integrity of the tanks and vessels, with the condition that when this facility is decommissioned that Apache Corporation will remediate to NMOCD Standards.

Root cause of incident:

- The plunger froze and broke due to freezing temperatures.

Corrective Actions:

- The plunger has been replaced and system has been tested to proper working order.

Reported by: Natalie Gladden (575-390-4186)

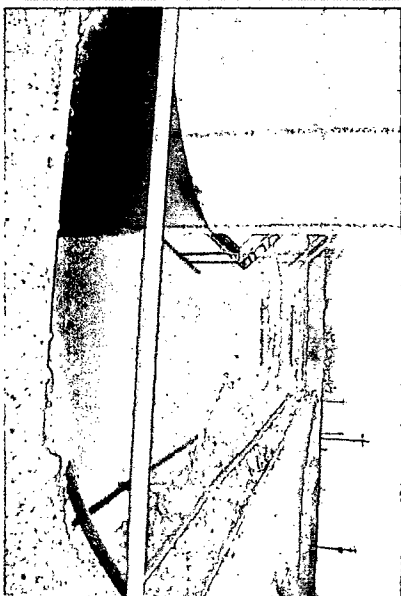
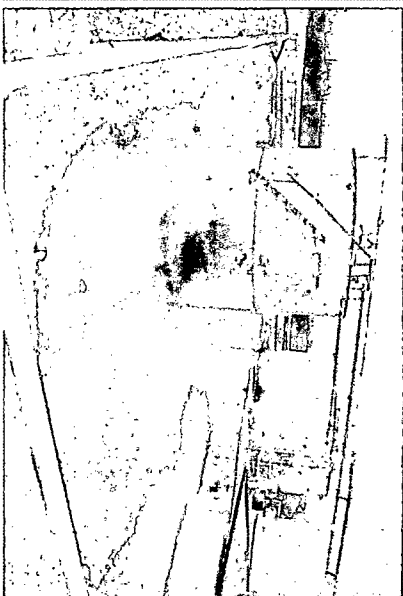
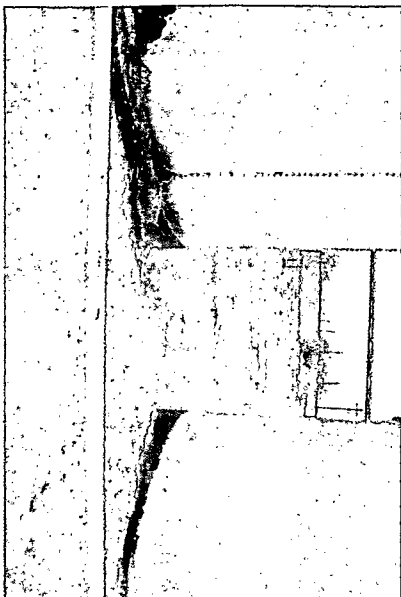
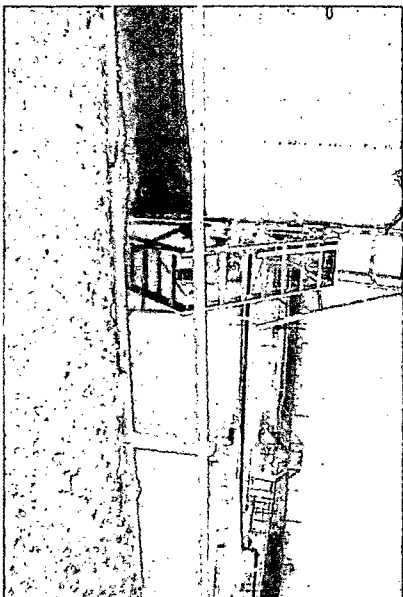

Proposed Hydro Vac Trench

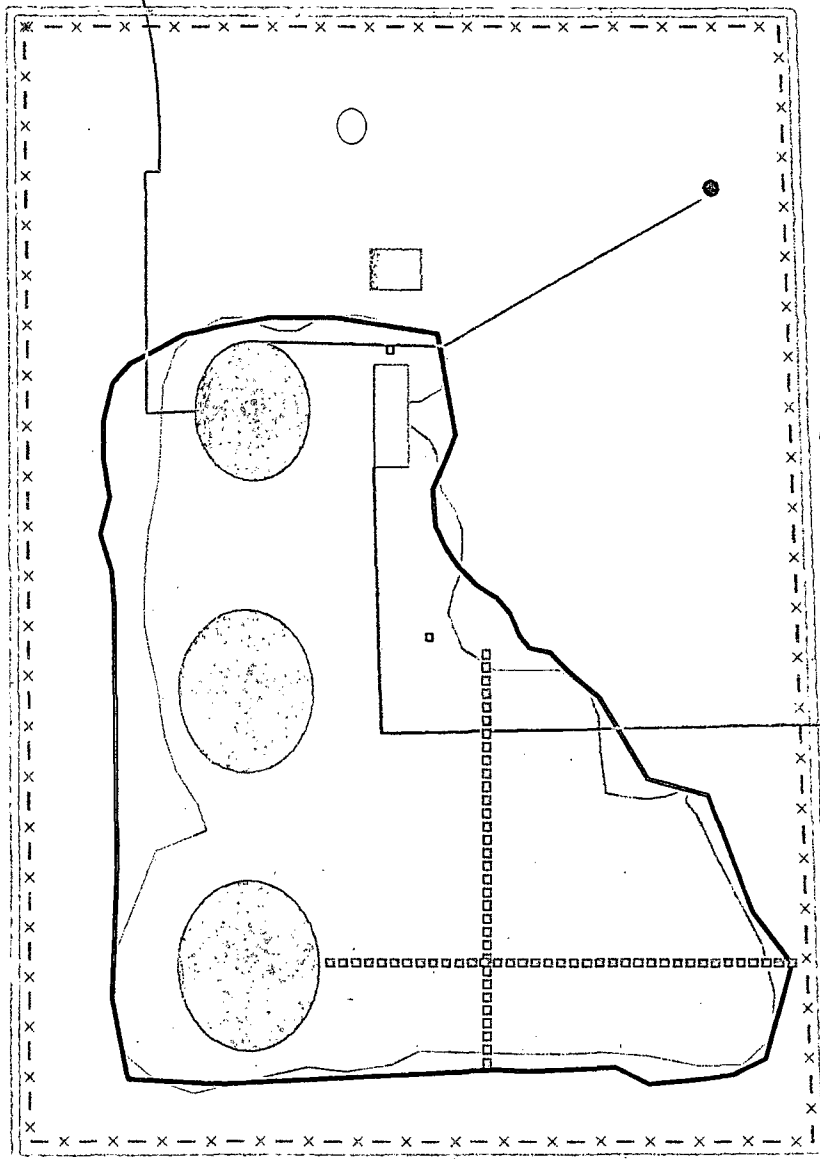

HOBBS OCD

SEP 09 2013

RECEIVED

Legend

- | | | | |
|-----------------------------|-----------------|-----------------|-----------------------|
| ● WELLHEAD | — SURFACE POLY | ■ CHEMICAL TANK | ⌂ FENCE |
| □ CONTROL BOX | — SURFACE STEEL | ■ TANK | □ PUMP |
| □ PROPOSED HYDRO VAC TRENCH | □ SCRAPE | □ BERM | □ SUMP |
| | | | □ STAIN (1,878 SQ FT) |

DGW = 53 ft.

Landowner = William O. Stephens



**APACHE
LOCKHART
B-13 A SWD**
UL K SECTION 13
T-21-S R-37-E
LEA COUNTY, NM



0 10 20
Feet

GPS date: 6/5/13 EC
Drawing date: 8/12/13
Drafted by: L. Weinheimer

Initial Field Data

Pt.4	CI-	PID
Surface	11390	7
6"	13487	6.3
1'	2478	40.3
1.5'	866	39.5
2'	963	8.6

Pt.3	CI-	PID
Surface	1095	2.2
6"	4232	9.1
1'	5335	3.2
1.5'	458	2.5

Pt.1	CI-	PID
Surface	4799	2.9
6"	4739	6.6
1'	5368	2.1
1.5'	509	2.5

Pt.2	CI-	PID
Surface	8525	2.2
6"	3965	4.4
1'	1180	3.3
1.5'	1502	3.4

Legend

- ▲ SAMPLE POINT
- WELLHEAD
- CONTROL BOX
- SURFACE POLY
- SURFACE STEEL
- CHIMNEY TANK
- TANK
- BERM
- FENCE
- PUMP
- SUMP
- STAIN (1,878 SQ FT)

DGW = 53 ft.

Landowner = William O. Stephens



**APACHE
LOCKHART
B-13 A SWD**
UL K SECTION 13
T-21-S R-37-E
LEA COUNTY, NM

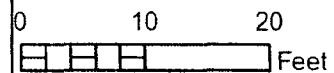

GPS date: 1/3/13 KN
Drawing date: 1/4/13
Drafted by: Tony Grieco, A.C. Ruth

Initial Sampling Data

Pt.4	CI-	PID	Lab	CI-	GRO	DRO
Surface	11390	7	14500	<10	<10	
6"	13487	6.3				
1'	2478	40				
1.5'	866	40				
2'	963	8.6				

Pt.3	CI-	PID	Lab	CI-	GRO	DRO
Surface	1095	2.2	1300	<10	<10	
6"	4232	9.1				
1'	5335	3.2				
1.5'	458	2.5				

Pt.1	CI-	PID	Lab	CI-	GRO	DRO
Surface	4799	2.9	16000	<10	16.7	
6"	4739	6.6				
1'	5368	2.1				
1.5'	509	2.5				

Pt.2	CI-	PID	Lab	CI-	GRO	DRO
Surface	8525	2.2	11600	<10	<10	
6"	3965	4.4				
1'	1180	3.3				
1.5'	1502	3.4				

Legend

- CONTROL BOX
- ▲ SAMPLE POINT
- WELLHEAD
- SURFACE POLY
- SURFACE STEEL
- CHEMICAL TANK
- TANK
- BERM
- ⌘ FENCE
- PUMP
- SUMP
- STAIN (1,878 SQ FT)

DGW = 53 ft.

Landowner = William O. Stephens



**APACHE
LOCKHART
B-13 A SWD**
UL K SECTION 13
T-21-S R-37-E
LEA COUNTY, NM

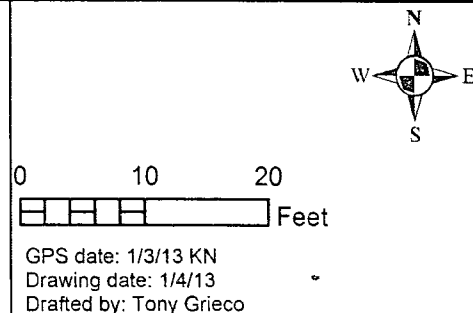

Initial Sampling Data





Pt.4 CI- PID GRO DRO
Surface 14500 7 <10 <10

Pt.3 CI- PID GRO DRO
Surface 1300 2.2 <10 <10

Pt.1 CI- PID GRO DRO
Surface 6000 2.9 <10 16.7

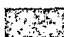
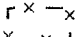
Pt.2 CI- PID GRO DRO
Surface 11600 2.2 <10 <10

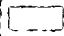
Legend

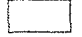
- | | | |
|-----------------|---|---|
| ▲ SAMPLE POINT |  CHEMICAL TANK |  FENCE |
| ● WELLHEAD |  TANK |  PUMP |
| ■ CONTROL BOX |  BERM |  SUMP |
| — SURFACE POLY | CI- Field Data |  STAIN (1,878 SQ FT) |
| — SURFACE STEEL | CI- Lab Data | |

DGW = 53 ft.

Landowner = William O. Stephens



**APACHE
LOCKHART
B-13 A SWD**
UL K SECTION 13
T-21-S R-37-E
LEA COUNTY, NM

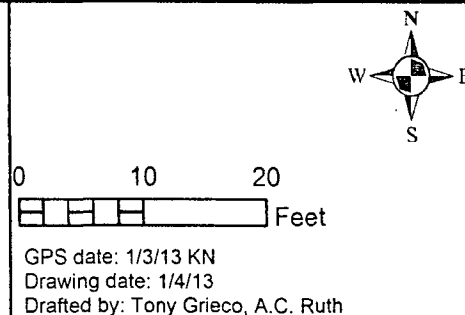

Lines

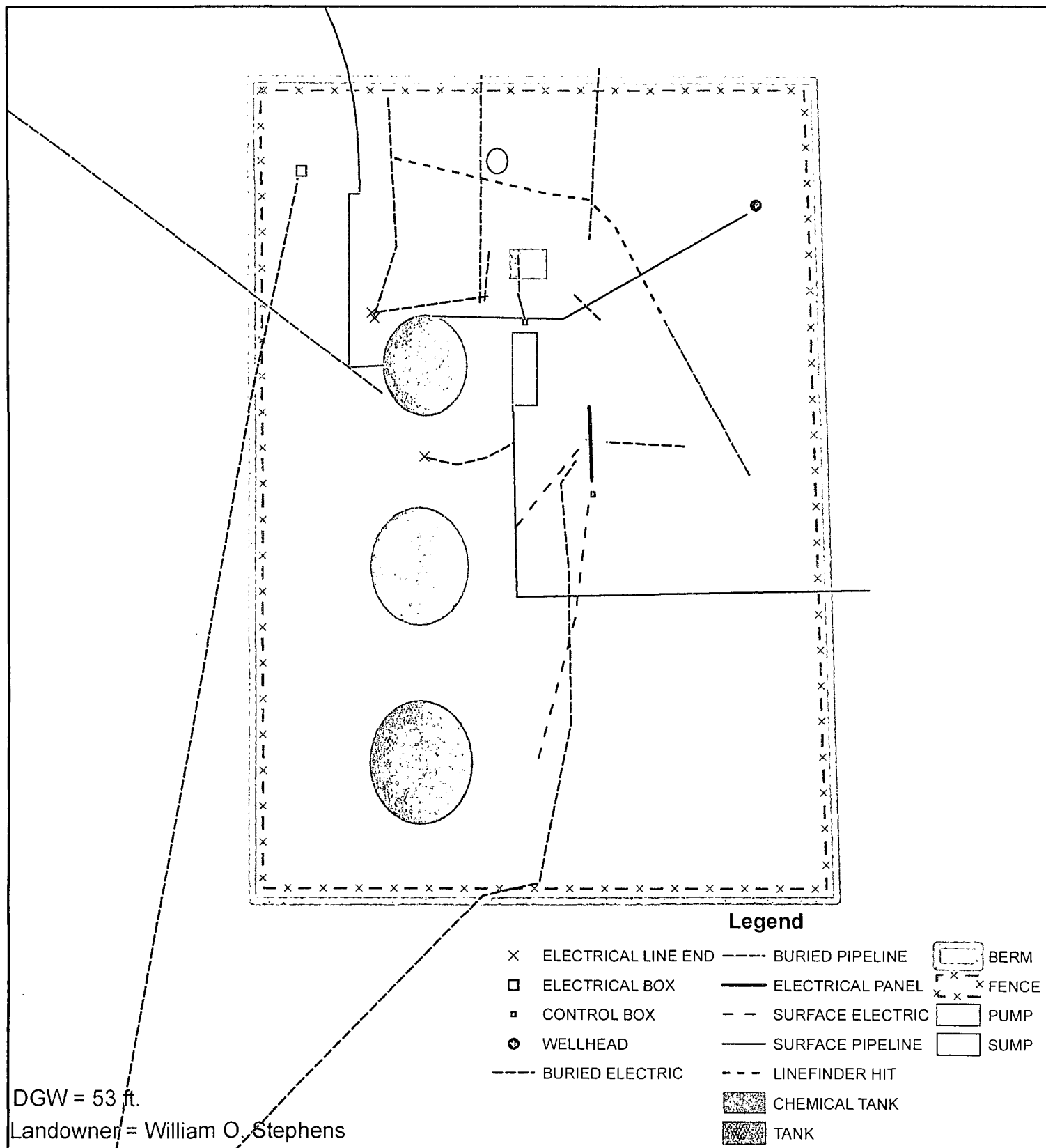

**APACHE
LOCKHART
B-13 A SWD**
UL K SECTION 13
T-21-S R-37-E
LEA COUNTY, NM

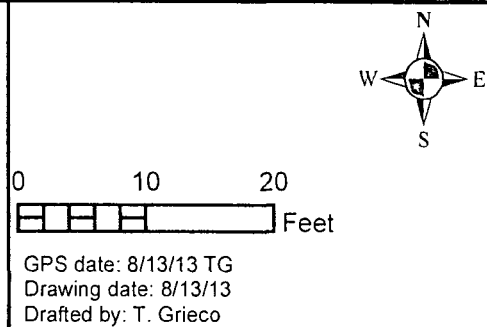

Vertical and Soil Bore Sampling Data

Vertical		
Depth	Cl-	PID
6"	2613	1
1'	1360	1.8
1.5'	1268	0.2
2'	581	0
2.5'	528	0
3'	651	0
3.5'	515	0
4'	738	0
4.5'	762	0
5'	795	0
5.5'	1016	0
6'	741	0.2
7'	1121	0
8'	918	0
9'	677	0.1
10'	1419	2.6
11'	1505	18.6
12'	1261	20.3
13'	1691	25.6

SB-1				
Depth	Cl-	PID	GRO	DRO
SS	6160	7.1	<10	256
3'	831	12.3		
6'	301	6.1		
9'	433	5.8		
12'	699	5		
15'	375	5.6		
18'	1200	6.4	<10	<10
21'	1073	6.1		
24'	810	6.1		
27'	545	7.2		
30'	888	5.6		
33'	980	4.5		
36'	704	5.3		
39'	420	9.2		
42'	476	9.1		
45'	421	15.9		
48'	240	12.1	<10	<10
51'	128	17.5	<10	<10
54'	240	7.1	<10	<10

SB-2 59.5'
TDD IN RED BED
NO WATER
COLLECTED

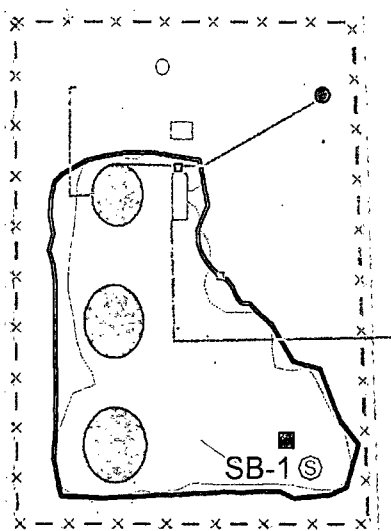

FIELD 288 48' 240 12.1 <10 <10
190 51' 128 17.5 <10 <10
263 54' 240 7.1 <10 <10

Legend

- ⊙ SOIL BORE
- ⊠ VERTICAL
- WELLHEAD
- CONTROL BOX
- SURFACE POLY
- SURFACE STEEL
- ▭ SCRAPE
- ▭ CHEMICAL TANK
- ▨ TANK
- ▨ BERM
- ⊠ FENCE
- ▭ PUMP
- ▭ SUMP
- ▭ STAIN (1,878 SQ FT)

DGW = None

Landowner = William O. Stephens



**APACHE
LOCKHART
B-13 A SWD**
UL K SECTION 13
T:21-S R:37-E
LEA COUNTY, NM

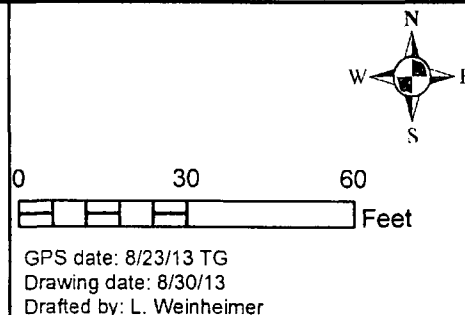

Arc Environmental

P. O. Box 1772
Lovington, New Mexico 88260
(575) 631-9310
Rozanne Johnson ~ rozanne@valornet.com

September 3, 2013

Mr. Hack Conder
RICE Environmental Consulting and Safety
112 West Taylor
Hobbs, New Mexico 88240

Re: Apache Lockhart B #13A SWD

Mr. Conder,

On Saturday August 31, 2013 soil bore #2 at the Apache Lockhart B #13A SWD, Lea County T21S, R37E, Sec 13 Unit Letter K was checked with a Solinst Water Level Meter for water accumulation within the borehole. The meter indicated no water accumulation within the borehole at the total depth of 59.4 feet.

Sincerely,
Arc Environmental

Rozanne Johnson
Rozanne Johnson

Electronic Copy: Hack Conder
Katie Jones
Lara Weinheimer

Augur Sampling Data

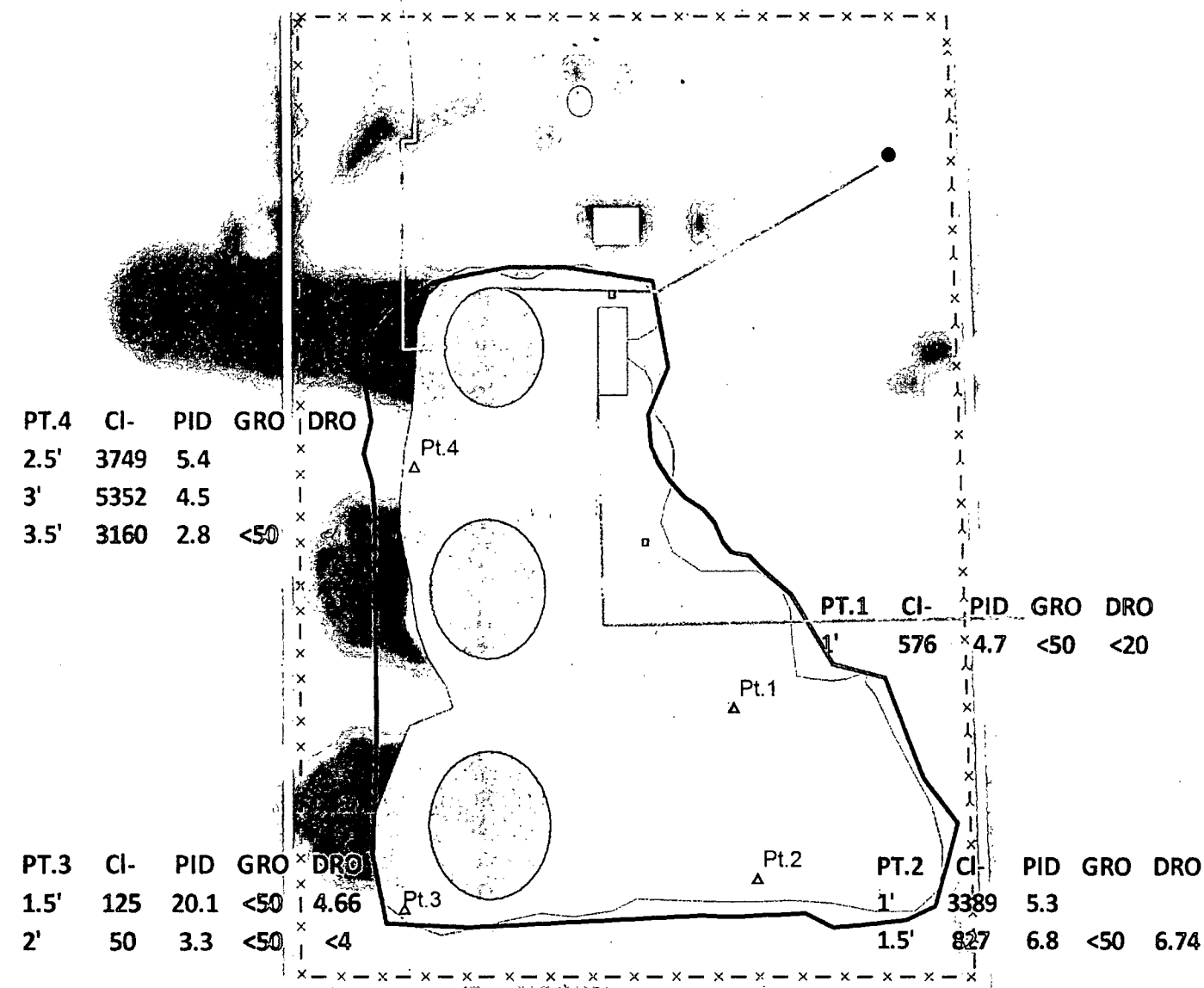

Legend

- ▲ SAMPLE POINT
- WELLHEAD
- CONTROL BOX
- SURFACE POLY
- SURFACE STEEL
- SCRAPE
- CHEMICAL TANK
- TANK
- BERM
- FENCE
- PUMP
- SUMP
- STAIN (1,878 SQ FT)

DGW = 53 ft.

Landowner = William O. Stephens

© 2013 Microsoft Corporation ImagePatch.com

being



**APACHE
LOCKHART
B-13 A SWD**
UL K SECTION 13
T-21-S R-37-E
LEA COUNTY, NM



0 10 20
Feet

GPS date: 6/5/13 EC
Drawing date: 6/6/13
Drafted by: L. Weinheimer

Final Sampling Data

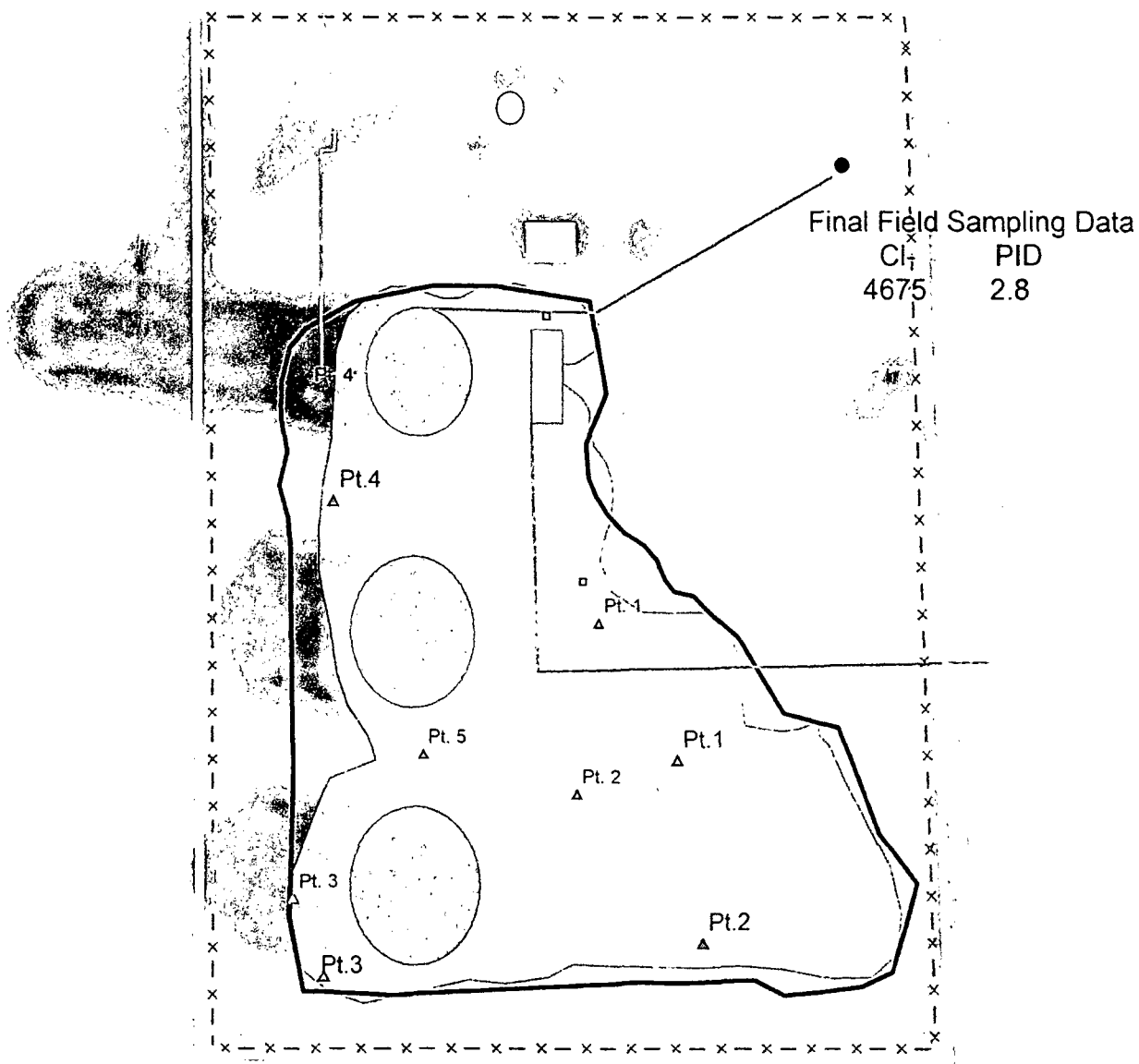

Legend

- | | | | |
|-----------------------|-----------------|-----------------|-----------------------|
| ▲ FINAL SAMPLE POINTS | — SURFACE POLY | ■ CHEMICAL TANK | ⌂ FENCE |
| ▲ SAMPLE POINT | — SURFACE STEEL | ■ TANK | □ PUMP |
| ● WELLHEAD | □ SCRAPE | □ BERM | □ SUMP |
| ■ CONTROL BOX | | | □ STAIN (1,878 SQ FT) |
- DGW = 53 ft.

Landowner = William O. Stephens

© 2013 Microsoft Corporation ImagePatch.com

ang



**APACHE
LOCKHART
B-13 A SWD**
UL K SECTION 13
T-21-S R-37-E
LEA COUNTY, NM



0 10 20
Feet

GPS date: 1/3/13 KN
Drawing date: 1/4/13
Drafted by: Tony Grieco, A.C. Ruth