

AHC

1334 8/1/96

## DISTRICT I

P.O. Box 1980, Hobbs, NM 88241-1980

## DISTRICT II

811 South First St., Artesia, NM 88210 2835

## DISTRICT III

1000 Rio Brezoz Rd, Aztec, NM 87410-1693

State of New Mexico  
Energy, Minerals and Natural Resources Department

## OIL CONSERVATION DIVISION

2040 S. Pacheco  
Santa Fe, New Mexico 87505-6429Form C-107-A  
New 3-12-96

## APPROVAL PROCESS:

☒ Administrative ☐ Hearing

## EXISTING WELLBORE

☒ YES ☐ NO

## APPLICATION FOR DOWNHOLE COMMINGLING

Operator Conoco Inc. Address 10 Desta Dr., Ste 100W, Midland TX 79705

Jicarilla A 13 E-13-26N-4W Rio Arriba

Lease Well No. Unit Ltr. - Sec - Twp - Rge County

OGRID NO. 005073 Property Code 18018 API NO. 30-039-20395 Spacing Unit Lease Types: (check 1 or more)  
Federal ☒ , State ☐ , (and/or) Fee ☐

The following facts are submitted in support of downhole commingling:	Upper Zone	Intermediate Zone	Lower Zone
1. Pool Name and Pool Code	Blanco Mesaverde 72319		Basin Dakota 71599
2. Top and Bottom of Pay Section (Perforations)	5648' - 5771'		7746' - 7941'
3. Type of production (Oil or Gas)	Gas		Gas
4. Method of Production (Flowing or Artificial Lift)	Flowing		Flowing
5. Bottomhole Pressure Oil Zones - Artificial Lift: Gas & Oil - Flowing: All Gas Zones: Estimated Current Measured Current Estimated Or Measured Original	a. (Current) 483 psia b. (Original) 1360 psia	a.  b.	a. 915 psia b. 2570 psia
6. Oil Gravity (°API) or Gas BTU Content	1273 BTU		1299 BTU
7. Producing or Shut-in?	Producing		Shut-in
Production Marginal? (yes or no)	Yes		Yes
* If Shut-In, give date and oil/gas/water rates of last production  Note: For new zones with no production history, applicant shall be required to attach production estimates and supporting data	Date: Rates:	Date: Rates:	Date: 8/94 Rates: rates proj. to mid-yr. 1996
* If Producing, give date and oil/gas/water rates of recent test (within 60 days)	Date: 1996 mid-yr Rates: 90 mcf/gpd .25 bopd, 0 bwpd	Date: Rates:	Date: 1996 mid-yr Rates: 48 mcf/gpd .89 bopd, 0 bwpd
8. Fixed Percentage Allocation Formula - % for each zone	Oil: 22 % Gas: 65 %	Oil: % Gas: %	Oil: 78 % Gas: 35 %

9. If allocation formula is based upon something other than current or past production, or is based upon some other method, submit attachments with supporting data and/or explaining method and providing rate projections or other required data.
10. Are all working, overriding, and royalty interests identical in all commingled zones? ☒ Yes ☐ No  
If not, have all working, overriding, and royalty interests been notified by certified mail? ☐ Yes ☐ No  
Have all offset operators been given written notice of the proposed downhole commingling? ☒ Yes ☐ No
11. Will cross-flow occur? ☒ Yes ☐ No If yes, are fluids compatible, will the formations not be damaged, will any cross-flowed production be recovered, and will the allocation formula be reliable. ☒ Yes ☐ No (If No, attach explanation)
12. Are all produced fluids from all commingled zones compatible with each other? ☒ Yes ☐ No
13. Will the value of production be decreased by commingling? ☐ Yes ☒ No (If Yes, attach explanation)
14. If this well is on, or communitized with, state or federal lands, either the Commissioner of Public Lands or the United States Bureau of Land Management has been notified in writing of this application. ☒ Yes ☐ No
15. NMOCD Reference Cases for Rule 303(D) Exceptions: ORDER NO(S). \_\_\_\_\_
16. ATTACHMENTS:
- \* C-102 for each zone to be commingled showing its spacing unit and acreage dedication.
  - \* Production curve for each zone for at least one year. (If not available, attach explanation.)
  - \* For zones with no production history, estimated production rates and supporting data.
  - \* Data to support allocation method or formula.
  - \* Notification list of all offset operators.
  - \* Notification list of working, overriding, and royalty interests for uncommon interest cases.
  - \* Any additional statements, data, or documents required to support commingling.

I hereby certify that the information above is true and complete to the best of my knowledge and belief.

SIGNATURE Jerry W. Hoover TITLE Sr. Conservation Coordinator DATE 6/28/96

TYPE OR PRINT NAME Jerry W. Hoover TELEPHONE NO. ( 915 ) 686-6549

District I  
PO Box 1980, Hobbs, NM 88241-1980  
District II  
PO Drawer DD, Artesia, NM 88211-0719  
District III  
1000 Rio Brazos Rd., Aztec, NM 87410  
District IV  
PO Box 2088, Santa Fe, NM 87504-2088

State of New Mexico  
Energy, Minerals & Natural Resources Department

OIL CONSERVATION DIVISION  
PO Box 2088  
Santa Fe, NM 87504-2088

Form C-1  
Revised February 10, 19  
Instructions on ba  
Submit to Appropriate District Offi  
State Lease - 4 Copi  
Fee Lease - 3 Copi

☐ AMENDED REPORT

WELL LOCATION AND ACREAGE DEDICATION PLAT

API Number 30-039-23002-20395		Pool Code 72319	Pool Name Blanco Mesa Verde
Property Code 013594	Property Name Jicarilla A		Well Number 13
OGRID No. 014591	Operator Name Merit Energy Company		Elevation 6878

<sup>10</sup> Surface Location

UL or lot no. E	Section 13	Township 26N	Range 4W	Lot Idn	Feet from the 1850	North/South line North	Feet from the 790	East/West line West	County Rio Arriba
--------------------	---------------	-----------------	-------------	---------	-----------------------	---------------------------	----------------------	------------------------	----------------------

<sup>11</sup> Bottom Hole Location If Different From Surface

UL or lot no.	Section	Township	Range	Lot Idn	Feet from the	North/South line	Feet from the	East/West line	County
---------------	---------	----------	-------	---------	---------------	------------------	---------------	----------------	--------

<sup>12</sup> Dedicated Acres 320	<sup>13</sup> Joint or Infill	<sup>14</sup> Consolidation Code	<sup>15</sup> Order No.
--------------------------------------	-------------------------------	----------------------------------	-------------------------

NO ALLOWABLE WILL BE ASSIGNED TO THIS COMPLETION UNTIL ALL INTERESTS HAVE BEEN CONSOLIDATED  
OR A NON-STANDARD UNIT HAS BEEN APPROVED BY THE DIVISION

<sup>16</sup> 1850 190				<sup>17</sup> OPERATOR CERTIFICATION I hereby certify that the information contained herein is true and complete to the best of my knowledge and belief.  Signature Sheryl J. Carruth Printed Name Regulatory Manager Title 10-12-94 Date
				<sup>18</sup> SURVEYOR CERTIFICATION I hereby certify that the well location shown on this plat was plotted from field notes of actual surveys made by me or under my supervision, and that the same is true and correct to the best of my belief.  Date of Survey Signature and Seal of Professional Surveyer:  Certificate Number

**NEW MEXICO OIL CONSERVATION COMMISSION  
WELL LOCATION AND ACERAGE DEDICATION PLAT**

All distances must be from the outer boundaries of the Section

Operator <b>SOUTHERN UNION PRODUCTION COMPANY</b>		Lease <b>JICARILLA "A"</b>		Well No. <b>13</b>
Unit Letter <b>E</b>	Section <b>13</b>	Township <b>26 NORTH</b>	Range <b>4 WEST</b>	County <b>RIO ARriba</b>
Actual Forage Location of Well. <div style="display: flex; justify-content: space-between;"> <span>1850 feet from the NORTH line</span> <span>790 feet from the WEST line</span> </div>				
Ground Level Elev. <b>6878.0</b>	Producing Formation <b>GALLUP PICTURED CLIFFS</b>		Dedicated Acreage <div style="display: flex; justify-content: space-between;"> <span><b>NW/4 160</b></span> <span><b>W/2 320</b></span> </div>	
		<b>UNDERSIGNED GALLUP BASIN DAKOTA</b>		

1. Outline the acreage dedicated to the subject well by colored pencil or hatchure marks on the plat below
2. If more than one lease is dedicated to the well, outline each and identify the ownership thereof (both as to working interest and royalty).
3. If more than one lease of different ownership is dedicated to the well, have the interests of all owners been consolidated by communization, unitization, force-pooling, etc?

( ) Yes ( ) No If answer is "yes," type of consolidation \_\_\_\_\_

If answer is "no" list the owners and tract descriptions which have actually consolidated. (Use reverse side of this form if necessary) \_\_\_\_\_

No allowable will be assigned to the well until all interests have been consolidated (by communization, unitization, forced-pooling, or otherwise) or until a non standard unit, eliminating such interests, has been approved by the Commission.

\_\_\_\_\_ **DEDICATED GALLUP ACERAGE**  
 \_\_\_\_\_ **DEDICATED DAKOTA ACERAGE**

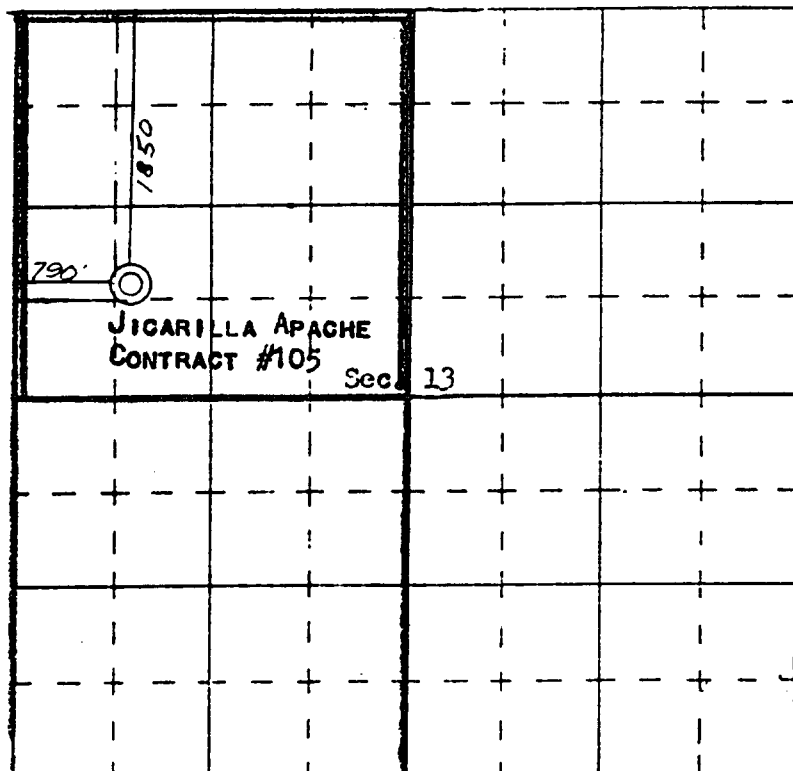

SCALE—4 INCHES EQUALS 1 MILE

SAN JUAN ENGINEERING COMPANY, FARMINGTON, N. M.

**CERTIFICATION**

I hereby certify that the information contained herein is true and complete to the best of my knowledge and belief.

Original signed by  
**GILBERT D. NOLAND, JR.**

Name  
**GILBERT D. NOLAND, JR.**  
 Position

**DRILLING SUPERINTENDENT**  
 Company

**SOUTHERN UNION PRODUCTION**  
 Date

**JUNE 28, 1971**

I hereby certify that the well location shown on this plat was plotted from field notes of actual surveys made by me or under my supervision, and that the same is true and correct to the best of my knowledge and belief.

**18 June, 1971**

Date Surveyed  
 Registered Professional Engineer  
 and/or Land Surveyor

**JAMES P. LEASE**

**11.63**

Certificate No. \_\_\_\_\_

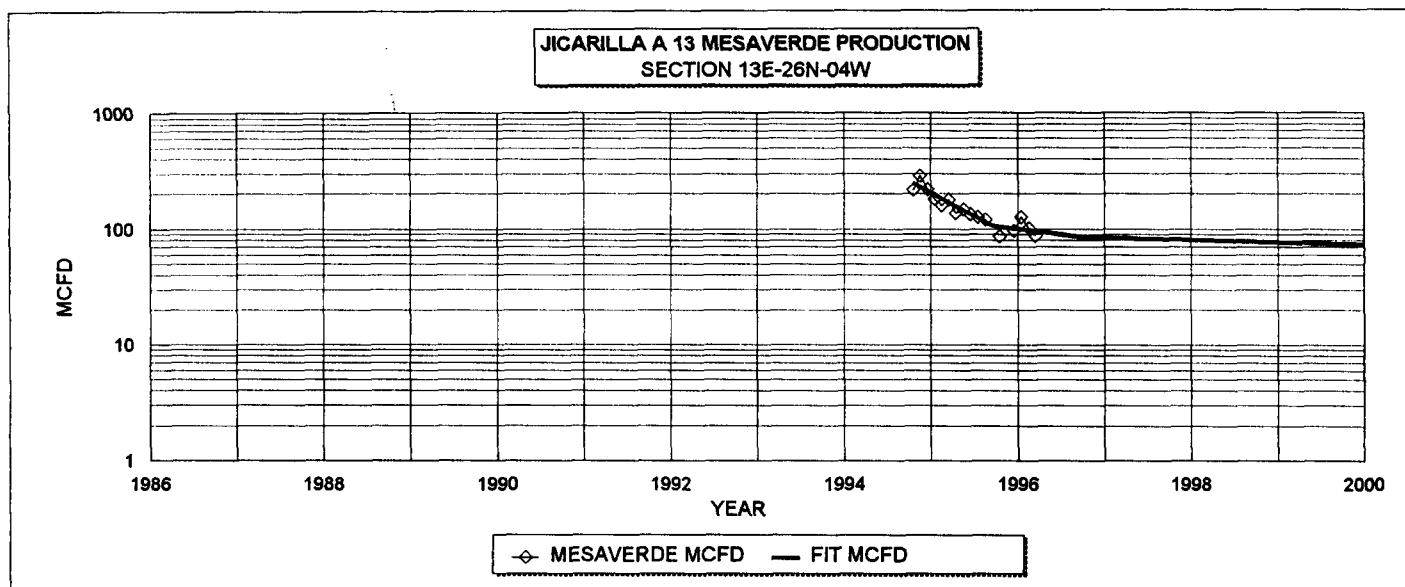

**MESAVERDE HISTORICAL DATA:** 1ST PROD: 10/80  
 OIL CUM: 0.17 MBO  
 GAS CUM: 60.7 MMCF  
 OIL YIELD: 0.0029 BBL/MCF

**MESAVERDE PROJECTED DATA**  
 7/1/96 Q1: 90 MCFD  
 DECLINE RATE: 20.0% THROUGH 10/96  
 4.5% FINAL DECLINE

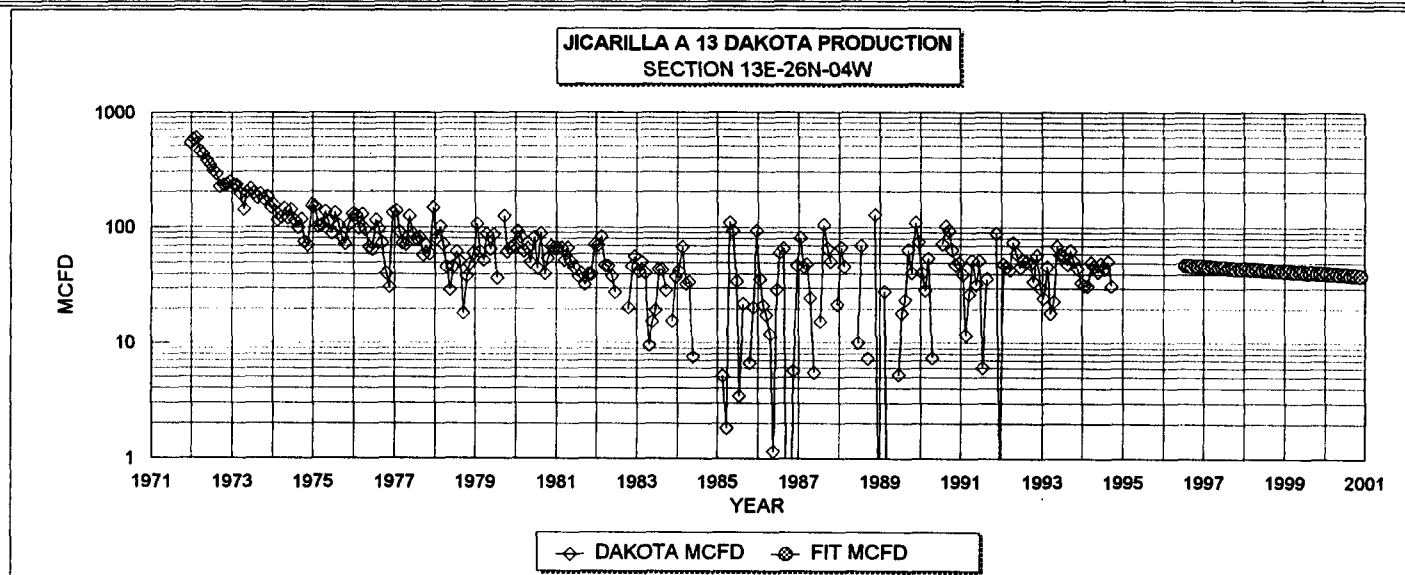

**DAKOTA HISTORICAL DATA** 1ST PROD: 12/71  
 OIL CUM: 11.7 MBO  
 GAS CUM: 614.2 MMCF  
 OIL YIELD: 0.0190 BBL/MCF

**DAKOTA PROJECTED DATA**  
 7/1/96 Q1: 48 MCFD  
 DECLINE RATE: 4.5% (EXPONENTIAL)

**FIXED COMMINGLE ALLOCATION FACTORS:**

	GAS	OIL
DAKOTA	35%	78%
MESAVERDE	65%	22%

GAS ALLOCATION BASED ON TABLE AT RIGHT  
 OIL ALLOCATION BASED ON WEIGHTED CUM OIL YEL

	YRLY AVG	YRLY AVG	%	%
YRLY AVG:	DK MCFD	MV MCFD	DAKOTA	MV
1996	47	87	35%	65%
1997	45	83	35%	65%
1998	43	80	35%	65%
1999	41	76	35%	65%
2000	39	73	35%	65%
2001	38	69	35%	65%

NOTE: ALL PRODUCTION DATA FROM DWIGHTS ENERGYDATA

# Dwights

Lease: JICARILLA A 000013

Retrieval Code: 251,039,26N04W13E00PC

05/20/96

10<sup>3</sup>  
10<sup>3</sup>  
10<sup>3</sup>

10<sup>2</sup>  
10<sup>2</sup>  
10<sup>2</sup>

10  
10

1  
1

Gas (mcf/day)

Oil (bbl/day)

Water (bbl/day)

Well Count

F.P. Date: 12/71

County: RIO ARRIBA, NM

Field: TAPACITO (PICTURED CLIFFS) P Oil Cum: 0 bbl

Reservoir: PICTURED CLIFFS Gas Cum: 724.1 mmcf

Operator: CONOCO INC Location: 13E 26N 4W

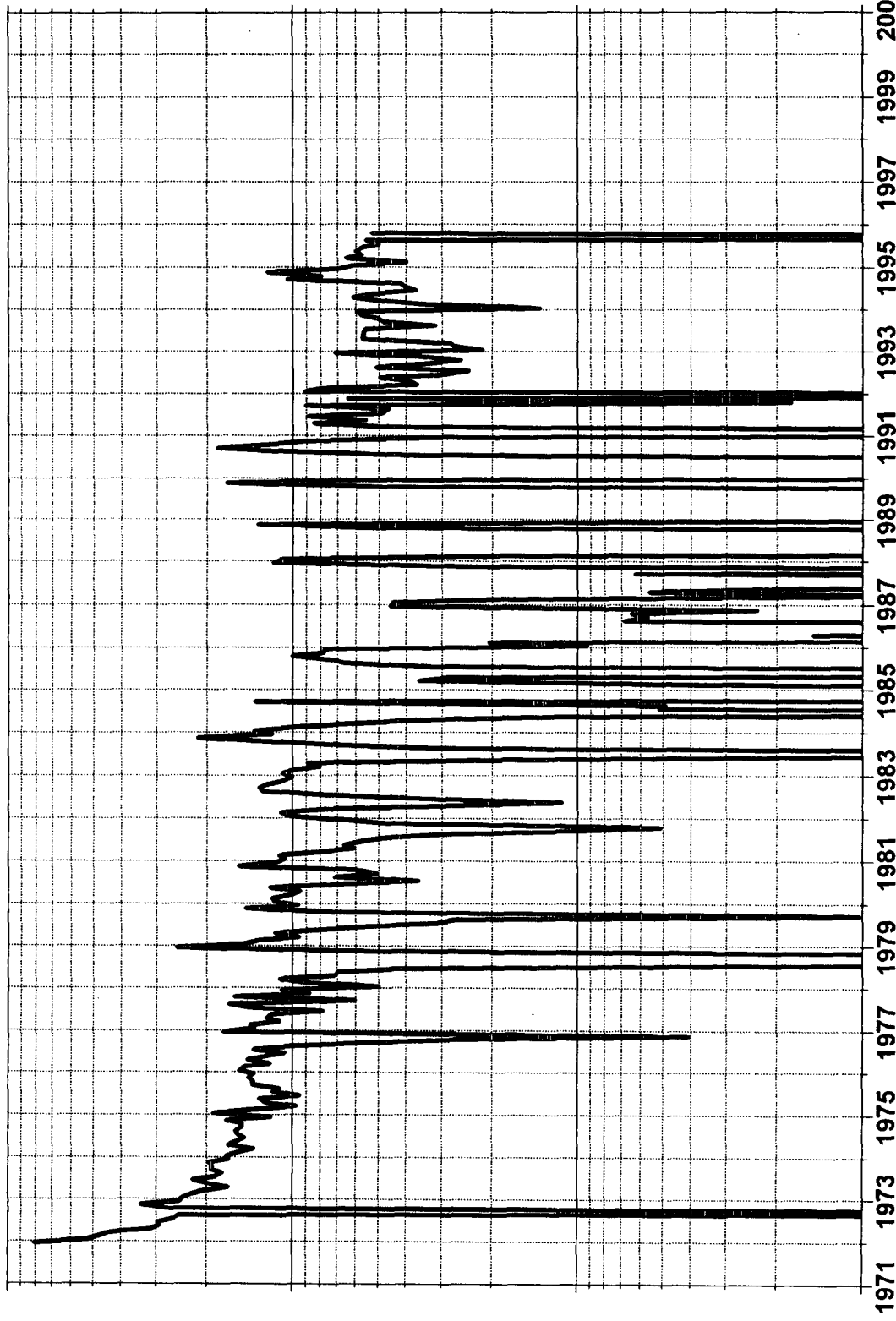

# Dwights

Lease: JICARILLA A 000013

Retrieval Code: 251,039,26N04W13E00DK

05/20/96

10<sup>3</sup>  
10<sup>3</sup>  
10<sup>3</sup>

10<sup>2</sup>  
10<sup>2</sup>  
10<sup>2</sup>

10  
10

1  
1

Gas (mcf/day)

Water (bbl/day)

Oil (bbl/day)

Well Count

F.P. Date: 12/71

County: RIO ARRIBA, NM

Field: BASIN (DAKOTA) DK

Oil Cum: 11.69 mbbl

Reservoir: DAKOTA

Gas Cum: 614.2 mmcf

Operator: CONOCO INC

Location: 13E 26N 4W

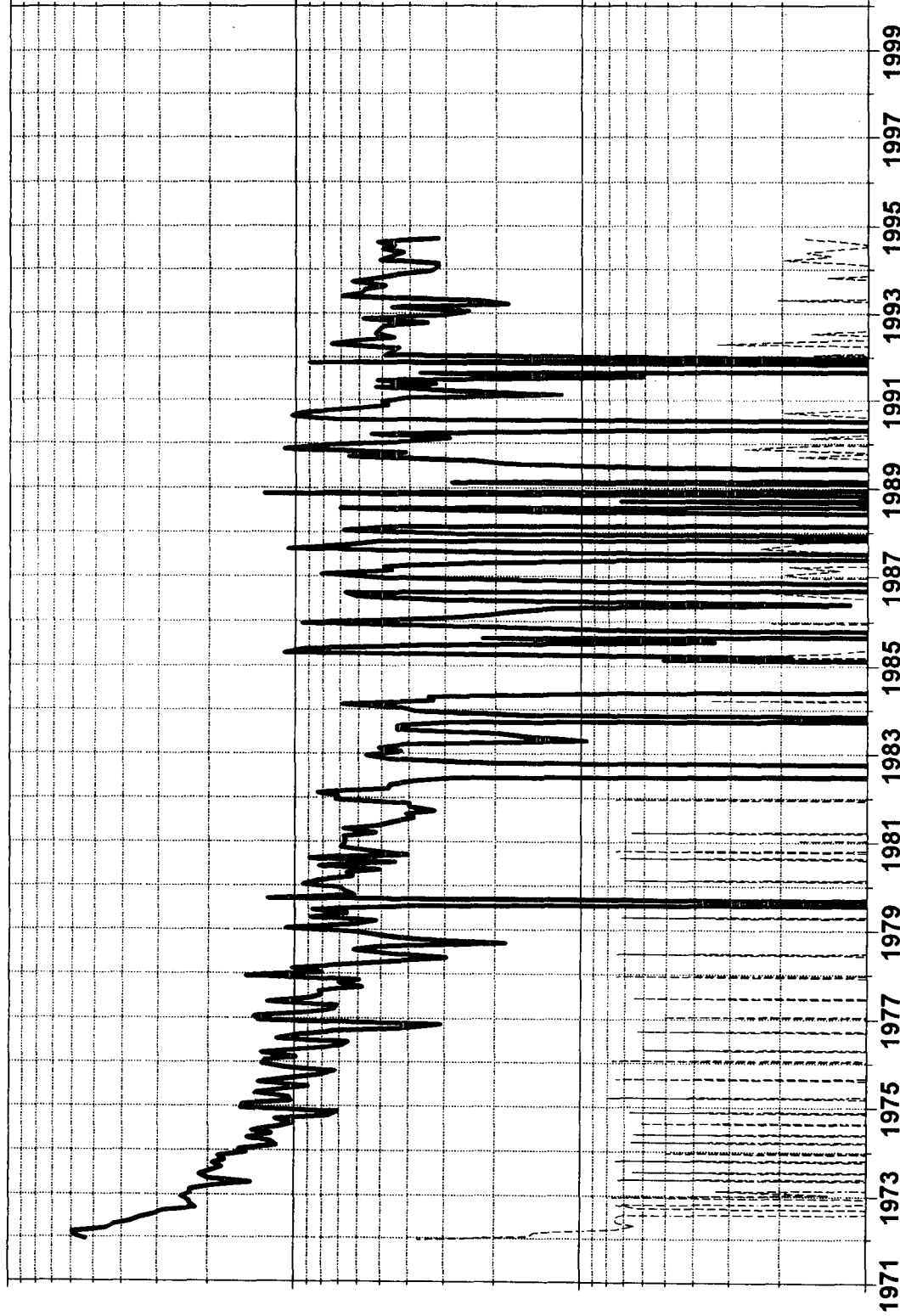

Dwights

Lease: JICARILLA A 013

05/20/96

Retrieval Code: 251,039,0392039572319

10<sup>3</sup>  
10<sup>3</sup>  
10<sup>3</sup>

10<sup>2</sup>  
10<sup>2</sup>  
10<sup>2</sup>

10  
10

1  
1

10<sup>2</sup>  
10<sup>2</sup>  
10<sup>2</sup>

10  
10

1  
1

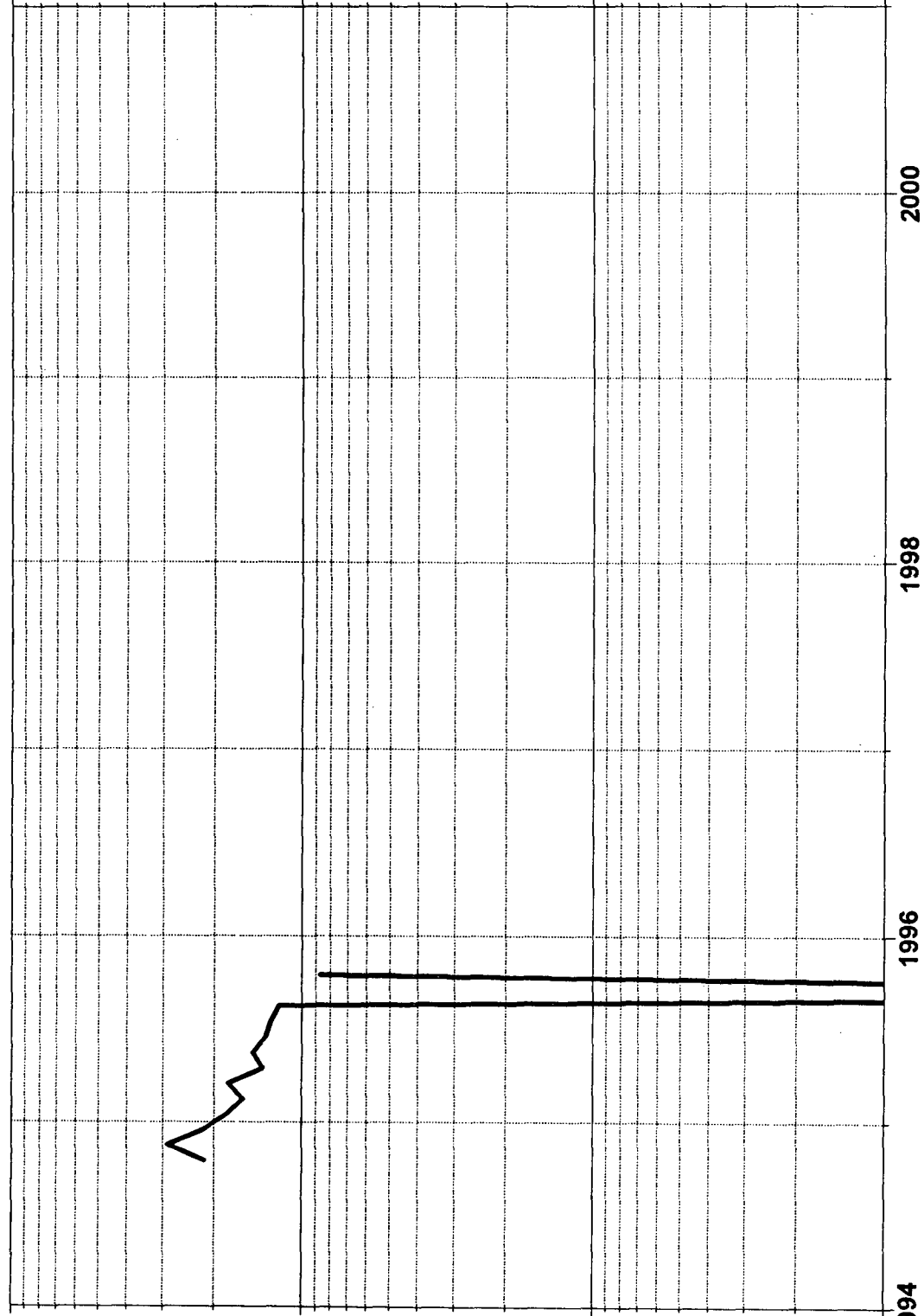

Gas (mcf/day)	County: RIO ARRIBA, NM	F.P. Date: 10/94	Oil (bbl/day)
Water (bbl/day)	Field: BLANCO (MESAVERDE) MV	Oil Cum: 174 bbl	Well Count
	Reservoir: MESAVERDE	Gas Cum: 60.68 mmcf	
	Operator: CONOCO INC	Location: 13E 26N 4W	

# JICARILLA "A" NO. 13

## OFFSET OPERATORS

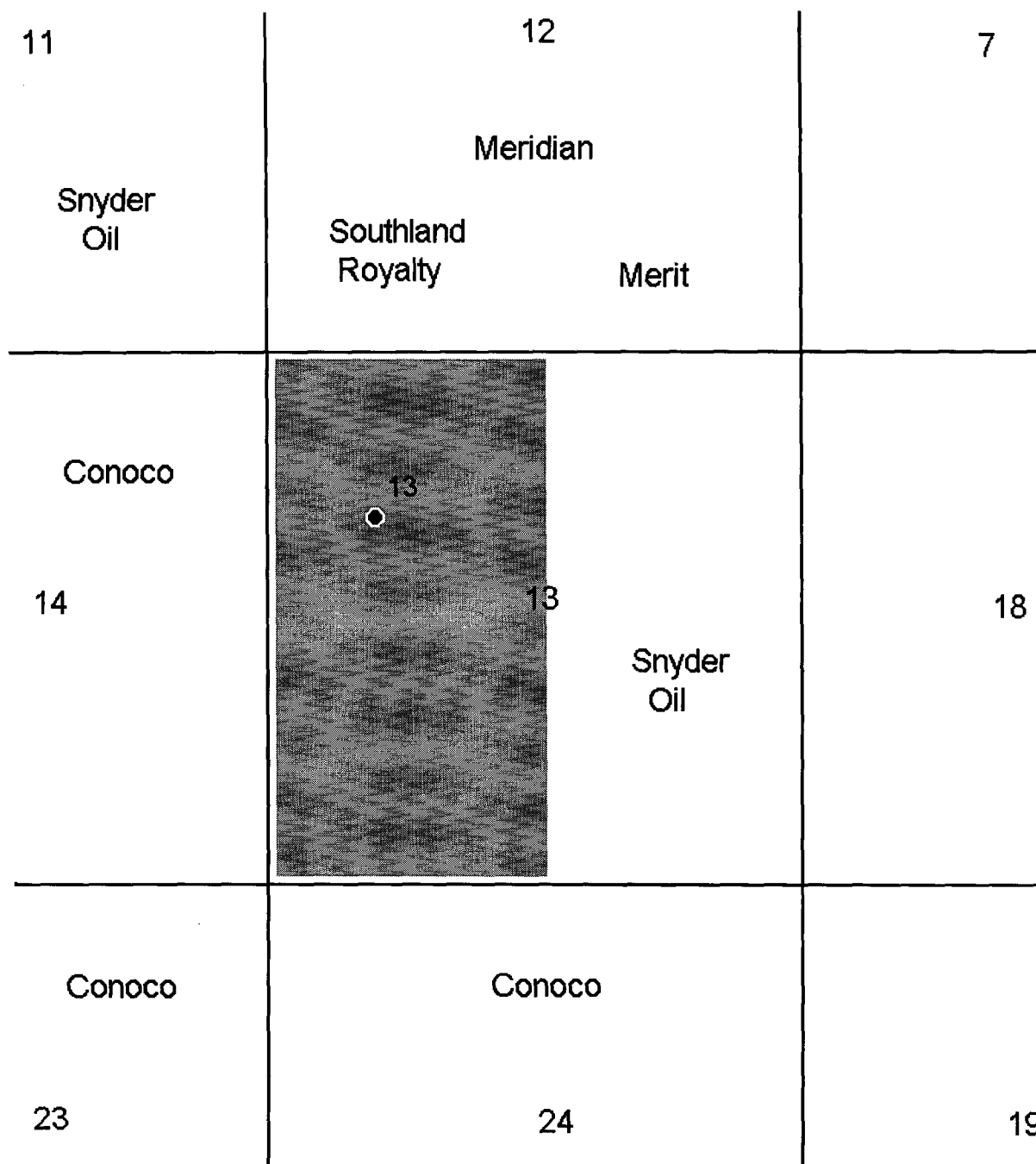

Township 26N --- Range 4W