

ABOVE THIS LINE FOR DIVISION USE ONLY

NEW MEXICO OIL CONSERVATION DIVISION
- Engineering Bureau -
1220 South St. Francis Drive, Santa Fe, NM 87505



ADMINISTRATIVE APPLICATION CHECKLIST

THIS CHECKLIST IS MANDATORY FOR ALL ADMINISTRATIVE APPLICATIONS FOR EXCEPTIONS TO DIVISION RULES AND REGULATIONS WHICH REQUIRE PROCESSING AT THE DIVISION LEVEL IN SANTA FE

Application Acronyms:

[NSL-Non-Standard Location] [NSP-Non-Standard Proration Unit] [SD-Simultaneous Dedication]
[DHC-Downhole Commingling] [CTB-Lease Commingling] [PLC-Pool/Lease Commingling]
[PC-Pool Commingling] [OLS - Off-Lease Storage] [OLM-Off-Lease Measurement]
[WFX-Waterflood Expansion] [PMX-Pressure Maintenance Expansion]
[SWD-Salt Water Disposal] [IPI-Injection Pressure Increase]
[EOR-Qualified Enhanced Oil Recovery Certification] [PPR-Positive Production Response]

[1] **TYPE OF APPLICATION** - Check Those Which Apply for [A]

[A] Location - Spacing Unit - Simultaneous Dedication
☐ NSL ☐ NSP ☐ SD

Check One Only for [B] or [C]

[B] Commingling - Storage - Measurement
☐ DHC ☒ CTB ☒ PLC ☐ PC ☐ OLS ☐ OLM

[C] Injection - Disposal - Pressure Increase - Enhanced Oil Recovery
☐ WFX ☐ PMX ☐ SWD ☐ IPI ☐ EOR ☐ PPR

[D] Other: Specify _____

[2] **NOTIFICATION REQUIRED TO:** - Check Those Which Apply, or Does Not Apply

[A] ☒ Working, Royalty or Overriding Royalty Interest Owners

[B] ☐ Offset Operators, Leaseholders or Surface Owner

[C] ☐ Application is One Which Requires Published Legal Notice

[D] ☒ Notification and/or Concurrent Approval by BLM or SLO
U.S. Bureau of Land Management - Commissioner of Public Lands, State Land Office

[E] ☐ For all of the above, Proof of Notification or Publication is Attached, and/or,

[F] ☐ Waivers are Attached

[3] **SUBMIT ACCURATE AND COMPLETE INFORMATION REQUIRED TO PROCESS THE TYPE OF APPLICATION INDICATED ABOVE.**

[4] **CERTIFICATION:** I hereby certify that the information submitted with this application for administrative approval is **accurate** and **complete** to the best of my knowledge. I also understand that **no action** will be taken on this application until the required information and notifications are submitted to the Division.

Note: Statement must be completed by an individual with managerial and/or supervisory capacity.

Jennifer Duarte
Print or Type Name

Signature: _____

Regulatory Specialist
Title

10/13/2014
Date

Jennifer_duarte@oxy.com
e-mail Address

-PLC 408
-Oxy USA, Inc
16696

2014 OCT 15 P 1:18

RECEIVED OOD

well
- Morgan Fee 14
30-015-39968
- Cedar Canyon
27 State Com 4H
30-015-42063

District I
1625 N. French Drive, Hobbs, NM 88240
District II
811 S. First St., Artesia, NM 88210
District III
1000 Rio Brazos Road, Aztec, NM 87410
District IV
1220 S. St Francis Dr, Santa Fe, NM
87505

State of New Mexico
Energy, Minerals and Natural Resources Department

Form C-107-B
Revised August 1, 2011

OIL CONSERVATION DIVISION

1220 S. St Francis Drive
Santa Fe, New Mexico 87505

Submit the original
application to the Santa Fe
office with one copy to the
appropriate District Office.

APPLICATION FOR SURFACE COMMINGLING (DIVERSE OWNERSHIP)

OPERATOR NAME: OXY USA Inc (16696)

OPERATOR ADDRESS: 5 Greenway Plaza, Ste. 110; Houston, TX 77046

APPLICATION TYPE:

☐ Pool Commingling ☐ Lease Commingling ☒ Pool and Lease Commingling ☐ Off-Lease Storage and Measurement (Only if not Surface Commingled)

LEASE TYPE: ☒ Fee ☒ State ☐ Federal

Is this an Amendment to existing Order? ☒ Yes ☐ No If "Yes", please include the appropriate Order No. PC-1261
Have the Bureau of Land Management (BLM) and State Land office (SLO) been notified in writing of the proposed commingling
☒ Yes ☐ No

(A) POOL COMMINGLING

Please attach sheets with the following information

(1) Pool Names and Codes	Gravities / BTU of Non-Commingled Production	Calculated Gravities / BTU of Commingled Production		Calculated Value of Commingled Production	Volumes
Please see attached spreadsheet					

- (2) Are any wells producing at top allowables? ☐ Yes ☒ No
(3) Has all interest owners been notified by certified mail of the proposed commingling? ☒ Yes ☐ No.
(4) Measurement type: ☒ Metering ☒ Other (Specify)
(5) Will commingling decrease the value of production? ☐ Yes ☒ No If "yes", describe why commingling should be approved

(B) LEASE COMMINGLING

Please attach sheets with the following information

- (1) Pool Name and Code.
(2) Is all production from same source of supply? ☒ Yes ☐ No
(3) Has all interest owners been notified by certified mail of the proposed commingling? ☒ Yes ☐ No
(4) Measurement type: ☒ Metering ☒ Other (Specify)

(C) POOL and LEASE COMMINGLING

Please attach sheets with the following information

- (1) Complete Sections A and E.

(D) OFF-LEASE STORAGE and MEASUREMENT

Please attached sheets with the following information

- (1) Is all production from same source of supply? ☐ Yes ☐ No
(2) Include proof of notice to all interest owners.

(E) ADDITIONAL INFORMATION (for all application types)

Please attach sheets with the following information

- (1) A schematic diagram of facility, including legal location.
(2) A plat with lease boundaries showing all well and facility locations. Include lease numbers if Federal or State lands are involved.
(3) Lease Names, Lease and Well Numbers, and API Numbers.

I hereby certify that the information above is true and complete to the best of my knowledge and belief.

SIGNATURE:  TITLE: REGULATORY SPECIALIST DATE: 10/13/2014

TYPE OR PRINT NAME: JENNIFER DUARTE TELEPHONE NO.: (713) 513-6640 / (832) 740-3716

E-MAIL ADDRESS: jennifer_duarte@oxy.com

**APPLICATION FOR CENTRAL TANK BATTERY, LEASE COMMINGLE,
OFF LEASE MEASUREMENT, SALES & STORAGE**

Commingling proposal for Limousine leases:

Proposal for Morgan Fee Com #1H & Cedar Canyon 27 State Com #4H

OXY USA INC is requesting approval for Central Tank Battery, Lease Commingle, Off Lease Measurement, Sales, & Storage from the following wells:

Fee Well

Pool: Corral Draw; Bone Spring (96238)

WELL NAME	API #	LOCATION	BOPD	OIL GRAVITY	MSCFD	BTU
MORGAN FEE COM #001H	30-015-39968	Sec21,T24S R29E	98	41.1	284	

State Lease: VO3983-0003

Pool: Pierce Crossing; Bone Spring (96473)

WELL NAME	API #	LOCATION	BOPD	OIL GRAVITY	MSCFD	BTU
CEDAR CANYON 27 STATE COM 4H	30-015-42063	Sec 27,T24S R29E	414	40	858	

A map is enclosed showing the leases and well locations in Section 21, T24S, R29E.

Oil & Gas metering:

Morgan Fee Com central tank battery is located in Township 24S, Range 29 E, Section 21 in Eddy County, New Mexico.

Oil, gas and water volumes from each well routed to Morgan Fee Com central tank battery will be routed to its dedicated test separator. The test separators at the battery will be utilized to process the incoming fluids while oil, water and gas measurement will be achieved by individual meters associated with the separator. Separate well tests would therefore not be required due to availability of dedicated test separators and meters at the facility.

The oil production from the wells listed in the list will be commingled, measured and sold on lease using a LACT Unit. Produced water will be measured through a turbine meter and trucked from the lease. The gas will be sold after it is measured by Oxy check meter located at the lease. The oil and gas meters will be calibrated on a regular basis per API, NMOCD and BLM specifications. The BLM and OCD will be notified of any future changes in the facility

Process and Flow Descriptions:

Please see attached block flow diagram for the Morgan Fee Com CTB. The flow route of produced fluids is shown in detail along with size of each vessel.

The commingling of production is in the interest of conservation and waste and will result in the most effective economic means of producing the reserves in place from the affected wells and will not result in reduced royalty or improper measurement of production. The proposed commingling will reduce operating expenses as well as reduce the surface facility footprint and overall emissions.

OXY USA INC understands the requested approval will not constitute the granting of any right-of-way or construction rights not granted by the lease instrument. These applications will be submitted separately for approval per NMOCD regulations.

Signed: 

Printed Name: Jennifer Duarte

Title: Regulatory Specialist

Date: 10-13-2014

DISTRICT I
1625 N. French Dr., Hobbs, NM 88240
Phone: (575) 393-6161 Fax: (575) 393-0720

DISTRICT II
811 S. First St., Artesia, NM 88210
Phone: (575) 748-1283 Fax: (575) 748-9720

DISTRICT III
1000 Rio Brazos Road, Aztec, NM 87410
Phone: (505) 334-6178 Fax: (505) 334-6170

DISTRICT IV
1220 S. St. Francis Dr., Santa Fe, NM 87505
Phone: (505) 476-3460 Fax: (505) 476-3462

State of New Mexico
Energy, Minerals & Natural Resources Department

OIL CONSERVATION DIVISION

1220 South St. Francis Dr.
Santa Fe, New Mexico 87505

RECEIVED

30 2012

NMOC D ARTESIA

Form C-102

Revised August 1, 2011

Submit one copy to appropriate
District Office

AMENDED REPORT
"As Drilled"

WELL LOCATION AND ACREAGE DEDICATION PLAT

API Number 30-015-39968	Pool Code 96235	Pool Name Cornal Draw Bone Spring
Property Code 39083	Property Name MORGAN FEE COM	Well Number 1H
OGRID No. 157984	Operator Name OCCIDENTAL PERMIAN, LTD.	Elevation 2923'

Surface Location

UL or lot No.	Section	Township	Range	Lot Idn	Feet from the	North/South line	Feet from the	East/West line	County
M	21	24-S	29-E		1035	SOUTH	455	WEST	EDDY

Bottom Hole Location If Different From Surface

UL or lot No.	Section	Township	Range	Lot Idn	Feet from the	North/South line	Feet from the	East/West line	County
P	21	24-S	29-E		600 651	SOUTH	330 349	EAST	EDDY
Dedicated Acres 160 AC	Joint or Infill N	Consolidation Code	Order No.						

NO ALLOWABLE WILL BE ASSIGNED TO THIS COMPLETION UNTIL ALL INTERESTS HAVE BEEN CONSOLIDATED OR A NON-STANDARD UNIT HAS BEEN APPROVED BY THE DIVISION

	<p>GEODETIC COORDINATES NAD 27 NME</p> <p>SURFACE LOCATION Y=436059.8 N X=604316.8 E</p> <p>LAT.=32.198396° N LONG.=103.996094° W</p> <p>BOTTOM HOLE LOCATION Y=435640.3 N X=608845.3 E</p> <p>LAT.=32.197203° N LONG.=103.981459° W</p> <p>CORNER COORDINATES TABLE</p> <p>Ⓐ - Y=436349.2 N, X=603862.6 E</p> <p>Ⓑ - Y=436372.2 N, X=609173.0 E</p> <p>Ⓒ - Y=435041.6 N, X=609177.0 E</p> <p>Ⓓ - Y=435023.4 N, X=603859.8 E</p>	<p>OPERATOR CERTIFICATION</p> <p>I hereby certify that the information herein is true and complete to the best of my knowledge and belief, and that this organization either owns a working interest or unleased mineral interest in the land including the proposed bottom hole location or has a right to drill this well at this location pursuant to a contract with an owner of such mineral or working interest, or to a voluntary pooling agreement or a compulsory pooling order heretofore entered by the division.</p> <p><i>David Stewart</i> 2/21/12 Signature Date</p> <p>David Stewart, Res. Adv. Printed Name</p> <p>David.stewart@oxy.com E-mail Address</p>
	<p>SURVEYOR CERTIFICATION</p> <p>I hereby certify that the well location shown on this plat was plotted from field notes of actual surveys made by me or under my supervision, and that the same is true and correct to the best of my belief.</p> <p>JANUARY 16, 2012</p> <p>Date of Survey</p> <p>Signature of Professional Surveyor:</p> <p>RONALD J. EIDSON NEW MEXICO 3239 REGISTERED SURVEYOR</p> <p>Certificate Number: 12641 Ronald J. Eidson 3239</p> <p>DSS Rev. 2/8/12 JWSC W.O.: 12.11.0102</p>	

DISTRICT I
1625 N. French Dr., Hobbs, NM 88240
Phone: (575) 393-6161 Fax: (575) 393-0720

DISTRICT II
811 S. First St., Artesia, NM 88210
Phone: (575) 748-1283 Fax: (575) 748-9720

DISTRICT III
1000 Rio Brazos Road, Aztec, NM 87410
Phone: (505) 334-6178 Fax: (505) 334-6170

DISTRICT IV
1220 S. St. Francis Dr., Santa Fe, NM 87505
Phone: (505) 476-3460 Fax: (505) 476-3462

State of New Mexico
Energy, Minerals & Natural Resources Department
OIL CONSERVATION DIVISION
1220 South St. Francis Dr.
Santa Fe, New Mexico 87505

Form C-102
Revised August 1, 2011
Submit one copy to appropriate
District Office

AMENDED REPORT

WELL LOCATION AND ACREAGE DEDICATION PLAT

API Number 30-015-42063	Pool Code 96473	Pool Name Pierce Crossing Bone Springs, East
Property Code 40389	Property Name CEDAR CANYON 27 STATE.COM	Well Number 4H
OGRID No. 16696	Operator Name OXY U.S.A. INC.	Elevation 2923'

Surface Location									
UL or lot No.	Section	Township	Range	Lot Idn	Feet from the	North/South line	Feet from the	East/West line	County
D	27	24-S	29-E		700	NORTH	173	WEST	EDDY

Bottom Hole Location If Different From Surface									
UL or lot No.	Section	Township	Range	Lot Idn	Feet from the	North/South line	Feet from the	East/West line	County
A	27	24-S	29-E		700	NORTH	350	EAST	EDDY

Penetration Point Location									
UL or lot No.	Section	Township	Range	Lot Idn	Feet from the	North/South line	Feet from the	East/West line	County
D	27	24-S	29-E		700	NORTH	873	WEST	EDDY

Dedicated Acres 160	Joint or Infill Y	Consolidation Code	Order No.
------------------------	----------------------	--------------------	-----------

NO ALLOWABLE WILL BE ASSIGNED TO THIS COMPLETION UNTIL ALL INTERESTS HAVE BEEN CONSOLIDATED OR A NON-STANDARD UNIT HAS BEEN APPROVED BY THE DIVISION

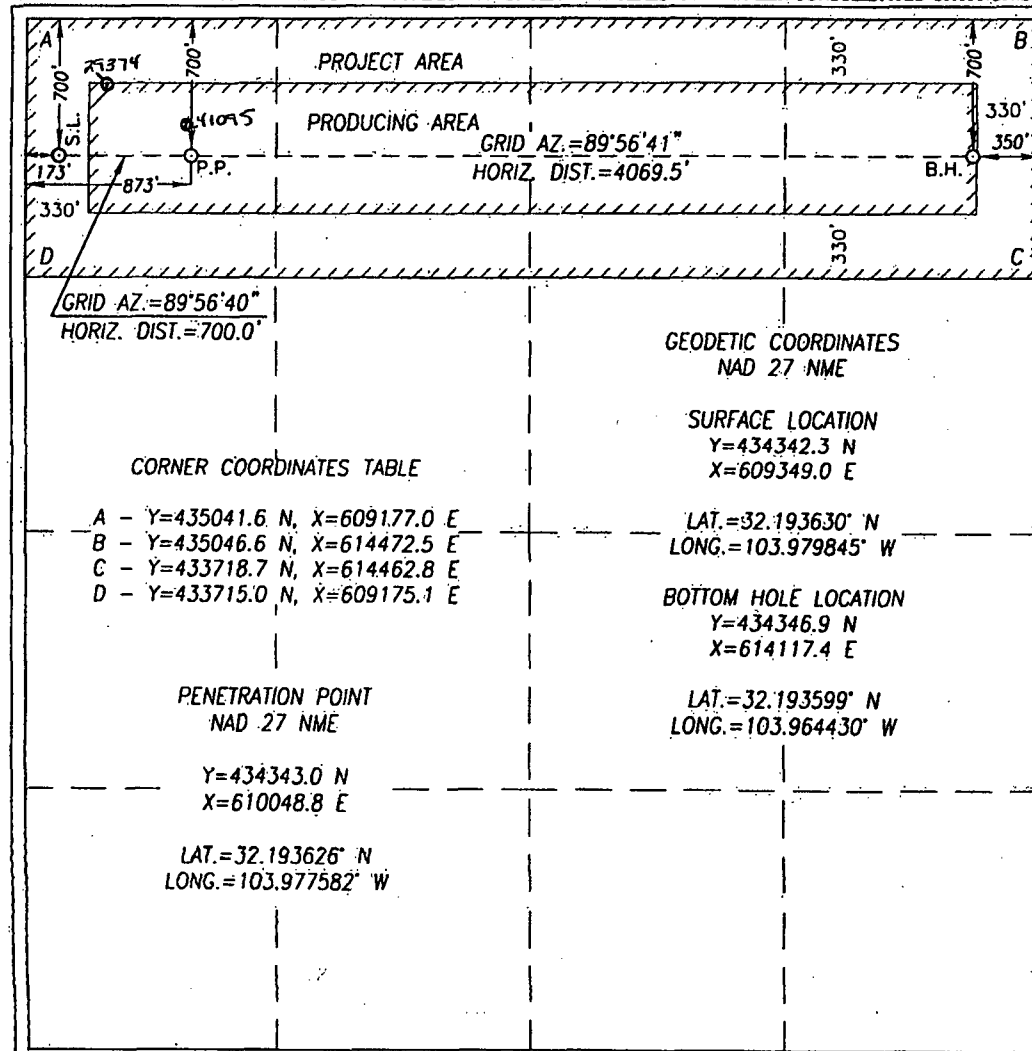

OPERATOR CERTIFICATION

I hereby certify that the information herein is true and complete to the best of my knowledge and belief, and that this organization either owns a working interest or unleased mineral interest in the land including the proposed bottom hole location or has a right to drill this well at this location pursuant to a contract with an owner of such mineral or working interest, or to a voluntary pooling agreement or a compulsory pooling order heretofore entered by the division.

Signature: David Stewart
Date: 2/11/14
Printed Name: David Stewart Sr. Reg. A.O.
E-mail Address: david_stewart@oxy.com

SURVEYOR CERTIFICATION

I hereby certify that the well location shown on this plat was plotted from field notes of actual surveys made by me or under my supervision, and that the same is true and correct to the best of my belief.

SEPTEMBER 18, 2013

Date of Survey
Signature of Professional Surveyor:



Certificate Number: Gary G. Eidson 12641
Professional Seal: Gary G. Eidson 3239
ACK REL. W. O. N. JWSC W.O. 14.13.0078

Pool	Lease Number	Well Name	Battery Name	Working Interest	API Gravities of Non-Commingled Production	Volumes	Calculated API Gravity of Commingled Production	Calculated Volume of Commingled Production	Oil, bpd	Gas, MSCFD	Water, bpd	API	Location	Operator
CORRAL DRAW; BONE SPRING (96238)	NMOC Property Code No. 39083	MORGAN FEE COM #001H	Morgan Fee Central Tank Battery	100%	41.1	OIL= 98 BPD GAS = 284 MSCFD WATER = 14 BPD	40.2 API GRAVITY	OIL= 512 BPD GAS = 1,142 MSCFD WATER = 469 BPD	98	284	14	30-015-39968	Sec 21, T24S R29E	OXY USA INC.
PIERCE CROSSING, BONE SPRING	VO3983-0003	CEDAR CANYON 27 STATE COM 4H	Morgan Fee Central Tank Battery	100%	40	OIL= 414 BPD GAS = 858 MSCFD WATER = 455 BPD			414	858	455	30-015-42063	Sec 27,T24S R29E	OXY USA INC.

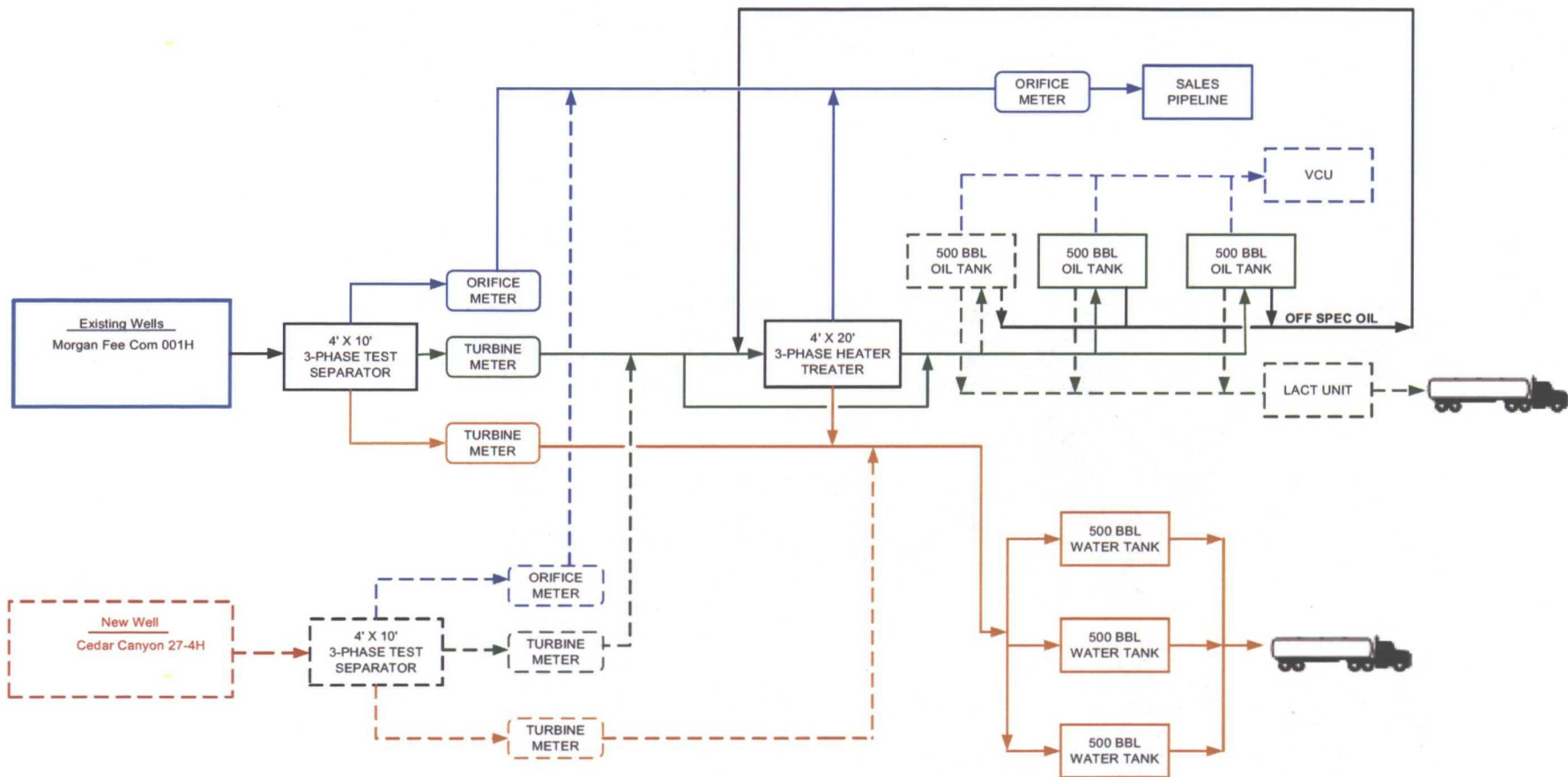



4" FP301 surface flowline will be routed from Cedar Canyon 27 State Com 4H well to Morgan fee battery. Length of flow line is estimate to be 6,500 ft. The flowline is laid on fee surface.

The Morgan fee CTB is built on the well pad of Morgan Fee Com 001H well. No flowline path is therefore shown for the Morgan Fee Com 001H well.



**OXY USA WTP Limited Partnership / OXY USA INC /
OCCIDENTIAL PERMIAN LP**
A subsidiary of Occidental Petroleum Corporation

5 Greenway Plaza, Suite 110, Houston, Texas 77046
P.O. Box 4294, Houston, Texas 77210-4294
Direct: 713.513.6640 Cell:: 832.740.3716
Jennifer_duarte@oxy.com

October 13, 2014

Interest Owners

Re: Request for a CTB & Pool/Lease Commingle
CTB Location: Section 21, T24S, R29E – Morgan Fee Com #1H CTB
Pool: Corral Draw; Bone Spring & Pierce Crossing; Bone Spring
Eddy County, New Mexico

To Whom It May Concern:

This is to advise you that OXY USA INC is filing an application with the New Mexico Oil Conservation Division ("NMOCD") seeking approval for a Central Tanks Battery & Pool/Lease commingle for the mentioned wells in the attached documents.

A copy of our application submitted to the Division is attached.

Any objection or requests that a hearing should be held regarding this application must be submitted to the New Mexico Oil Conservation Division Santa Fe Office within 21 Days from the date of this letter.

Please contact me should you have any questions or need anything further.

Thank you in advance for your time.

Very Truly Yours,

OXY USA WTP Limited Partnership / OXY USA INC / OCCIDENTIAL PERMIAN LP
Jennifer Duarte
Regulatory Specialist

Enclosure

JAMES M ALEXANDER
PO BOX 58
ABILENE, TX 79604
70141200000025723301

JERI A LOTT
9209 YORK PLACE
LUBBOCK, TX 79424
70141200000025723318

JOHN GUITAR ESTATE III
GEORGE D. JONES IND EXECUTORS
SALLY GUITAR IND. EXECUTORS
10 WOODHAVEN CIRCLE
ABILENE, TX 79605
70141200000025723325

WHITTEN GUITAR WITHERSPOON
7524 PEAR TREE LANE
FORT WORTH, TX 76133
70141200000025723332

WENDE WITHERSPOON MORGAN
1720 SOUTHWICKE
FLOWER MOUND, TX 75022
70141200000025723349

JOHN GUITAR WITHERSPOON JR
7404 LEMONWOOD LANE
FORT WORTH TX 76133
70141200000025723356

BRETT GUITAR WITHERSPOON
PO BOX 100635
FORT WORTH, TX 76185
70141200000025723363

PARDUE LIMITED COMPANY
PO BOX 2018
CARLSBAD, NM 88221
70141200000025723370

GUITAR LAND & CATTLE CO LP
PO BOX 2213
ABILENE, TX 79604
70141200000025723523

EARL B & MARGARET A GUITAR REV TR
MARGARET ANN GUITAR TRUSTEE
JOHN ALEXANDER GUITAR CO SUC TTEE
PHILLIP E GUITAR CO TRUSTEE
P O BOX 748
ABILENE, TX 79604
70141200000025723530

LAURA JEAN HOFER TRUST JOHN M HOFER & PAUL HOFER III CO-T 11248 SOUTH TURNER AVENUE ONTARIO, CA 91761	7014120000025723547
GAINES MINERAL MANAGEMENT TR REBECCA GAINES HOOKS TRUSTEE PO BOX 111 WARING, TX 78074	70141200000025723554
CAREN G LUCAS PO BOX 1485 SANTA ROSA BEACH, FL 32459	70141200000025723561
CATHERINE GALL PARKER 3721 PALLOS VERDAS DRIVE DALLAS, TX 75229	70141200000025723578
KELLY WOODS LEACH 312 GREATVIEW CIRCLE BIRMINGHAM, AL 35226-2320	70141200000025723585
JACK G WOODS JR PO BOX 341342 AUSTIN, TX 78734	70141200000025723592
GALL FAMILY TRUST CATHERINE GALL PARKER & CRAIG PARKER COTRUSTEES 3721 PALLOS VERDES DRIVE DALLAS, TX 75229	70141200000025723608
JACK SCOTT & SANDRA MCDONALD 1110 COLLEGE AVENUE SNYDER, TX 79549	70141200000025723615
BRITT P & CYDNEY MEDFORD 2111 PAISANO ROAD AUSTIN, TX 78746	70141200000025723622
CHARLOTTE ALBRIGHT SOLE AND SEPARATE PROPERTY 1705 BOYD DRIVE CARLSBAD, NM 88220-5404	70141200000025723639

BARBARA LEE BACKMAN INC
ATTN J. DOUGLAS HEISKELL
1516 W RIVERSIDE AVE
SPOKANE, WA 99201

70141200000025723738

JAN ALICE HERRSTROM
810 FOREST OAKS CIRCLE
WOODWAY, TX 76712

70141200000025723721

GEORGE SCOTT CRANFORD
2009 HUBBARD COURT
VILLA RICA, GA 30180

70141200000025723714

GUITAR GALUSHA LP
PO BOX 1438
ABILENE, TX 79604

70141200000025723707

GAYLE N NICOLAY REV TRUST
GAYLE N NICOLAY TRUSTEE
5528 TAHOE LANE
FAIRWAY, KS 66205

70141200000025723691

VIRGINIA NEVILL HOFF MGMT TRUST
VIRGINIA NEVILL HOFF TRUSTEE
2601 LAKEWOOD CIRCLE
TUSCALOOSA, AL 35405

70141200000025723684

JPH HOLDINGS LP
4400 ARCADY
DALLAS, TX 75205

70141200000025723677

TWIN OAKS PETROLEUM LLC
4010 LAZYBROOK DR
NOLANVILLE, TX 76559

70141200000025723660

HONEY'S HERITAGE LP
PO BOX 833206
RICHARDSON, TX 75083-3206

70141200000025723653

MURCHISON GUITAR FAMILY LP
PO BOX 712
RED BLUFF, CA 96080-0712

70141200000025723646

POLK LAND & MINERALS LP
1101 BUTTERNUT
ABILENE, TX 79602
70141200000025724209

JANE ALEXANDER RHODES REV TRUST
JERI ALEXANDER MANGUM TRUSTEE
FIRST FINANCIAL TR MGMT CO TTEE
PO BOX 701
ABILENE, TX 79604
70141200000025724193

WOODS DICKENS RANCH LP
C/O JACK G WOODS
36 SURRY SQUARE
ABILENE, TX 79606
70141200000025724186

MARY LYNN FOREHAND
403 SAN JUAN MANOR
CARLSBAD, NM 88220-6606
70141200000025724179

LESLIE DAVID GUITAR
PO BOX 2228
BROWNWOOD, TX 76804
70141200000025724162

PRESSLEY HUDSON GUITAR
PO BOX 5383
ABILENE, TX 79608
70141200000025724155

REPPS B GUITAR JR
PO BOX 7252
ABILENE, TX 79608
70141200000025724148

GUY P WITHERSPOON III
PO BOX 100403
FORT WORTH, TX 76185
70141200000025724131

JAMES M ALEXANDER
PO BOX 58
ABILENE, TX 79604
70141200000025724124

JERI A LOTT
9209 YORK PLACE
LUBBOCK, TX 79424
70141200000025724117

WHITTEN GUITAR WITHERSPOON
7524 PEAR TREE LANE
FORT WORTH, TX 76133
70141200000025724100

WENDE WITHERSPOON MORGAN
1720 SOUTHWICKE
FLOWER MOUND, TX 75022
70141200000025724094

JOHN GUITAR WITHERSPOON JR
7404 LEMONWOOD LANE
FORT WORTH, TX 76133
70141200000025724087

BRETT GUITAR WITHERSPOON
PO BOX 100635
FORT WORTH, TX 76185
70141200000025724070

PROSPECTOR LLC
PO BOX 429
ROSWELL, NM 88202
70141200000025724063

GUITAR LAND & CATTLE CO LP
PO BOX 2213
ABILENE, TX 79604
7014120025724056

EARL B & MARGARET A GUITAR REV/ TR
MARGARET ANN GUITAR TRUSTEE
JOHN ALEXANDER GUITAR CO SUC TTEE
PHILLIP E GUITAR CO TRUSTEE
PO BOX 748
ABILENE, TX 79604
70141200000025724049

LAURA JEAN HOFER TRUST
JOHN M HOFER & PAUL HOFER III CO-T
11248 SOUTH TURNER AVENUE
ONTARIO, CA 91761
70141200000025724032

CAREN G LUCAS
PO BOX 1485
SANTA ROSA BEACH, FL 32459
70141200000025724025

CATHERINE GALL PARKER
3721 PALLOS VERDAS DRIVE
DALLAS, TX 75229
70141200000025724018

KELLY WOODS LEACH 312 GREATVIEW CIRCLE BIRMINGHAM, AL 35226-2320	70141200000025724001
JACK G WOODS JR PO BOX 341342 AUSTIN, TX 78734	70141200000025723998
BARBARA LEE BACKMAN INC ATTN J. DOUGLAS HEISKELL 1516 W RIVERSIDE AVE SPOKANE, WA 99201	70141200000025723981
GUJAR GALUSHA LP P O BOX 1438 ABILENE, TX 79604	70141200000025723974
GAYLE N NICOLAY REV TRUST GAYLE N NICOLAY TRUSTEE 5528 TAHOE LANE FAIRWAY, KS 66205	70141200000025723967
VIRGINIA NEVILL HOFF MGMT TRUST VIRGINIA NEVILL HOFF TRUSTEE 2601 LAKEWOOD CIRCLE TUSCALOOSA, AL 35405	70141200000025723950
JPH HOLDINGS LP 4400 ARCADY DALLAS, TX 75205	70141200000025723943
HONEY'S HERITAGE LP PO BOX 833206 RICHARDSON, TX 75083-3206	70141200000025723936
MURCHISON GUITAR FAMILY LP PO BOX 712 RED BLUFF, CA 96080-0712	700141200000025723929
POLK LAND & MINERALS LP 1101 BUTTERNUT ABILENE, TX 79602	700141200000025723912

JANE ALEXANDER RHODES REV TRUST
JERI ALEXANDER MANGUM TRUSTEE
FIRST FINANCIAL TR MGMT CO TTEE
PO BOX 701
ABILENE, TX 79604

70141200000025723905

SALLY GUITAR
10 WOODHAVEN CIR
ABILENE, TX 79605

70141200000025723899

JUDY UHEY
PO BOX 632
ELIZABETHTOWN, KY 42702

700141200000025723882

SHARON ELLIS
PO BOX 105
SNOQUALMIE PASS, WA 98068

70141200000025723875

MELISSA MCGEE
PO BOX 334
BUFFALO GAP, TX 79508

70141200000025723868

WOODS DICKENS RANCH LP
C/O JACK G WOODS
36 SURRY SQUARE
ABILENE, TX 79606

70141200000025723851

ROSS DUNCAN PROPERTIES LLC
PO BOX 647
ARTESIA, NM 88211

70141200000025723844

XPLOR RESOURCES LLC
1104 N SHORE
CARLSBAD, NM 88220

70141200000025723837

GALL CREDIT SHELTER TRUST
CATHERINE GALL PARKER CO TTEE
CRAIG PARKER CO TRUSTEE
3721 PALLOS VERDAS
DALLAS, TX 75229

70141200000025723820

CATHERINE GALL PARKER EXEMPT TR
CATHERINE GALL PARKER TRUSTEE
CRAIG PARKER TRUSTEE
3721 PALLOS VERDAS
DALLAS, TX 75229

70141200000025723813

CAREN GALL LUCAS EXEMPT TRUST
CAREN GALL LUCAS TRUSTEE
PO BOX 1485
SANTA ROSA BEACH, FL 32459

70141200000025723806

LOST CREEK ROYALTIES LP
400 N MARIENFELD ST
SUITE 200
MIDLAND, TX 79701

70141200000025703790

LESLI GUITAR NICHOLS
PO BOX 327
BIG SPRING, TX 79721

70141200000025723783

JOHN GUITAR
PO BOX 1628
BIG SPRING, TX 79721

700141200000025723776

LESLIE DAVID GUITAR
PO BOX 2228
BROWNWOOD, TX 76804

70141200000025723769

PRESSLEY HUDSON GUITAR
PO BOX 5383
ABILENE, TX 79608

70141200000025723752

GUY P WITHERSPOON III
PO BOX 100403
FORT WORTH, TX 76185

70141200000025723745

NEW MEXICO STATE LAND OFFICE
Commingle PRE-Application ONLINE Version

Please provide the following requested information so that the SLO staff can determine whether or not you qualify to submit a commingle application package.

Name: JENNIFER DUARTE Company: OXY USA INC
Address: PO BOX 4294 City HOUSTON
Telephone: 713-513-6640 Fax: _____ State TX Zip 77210

The State Land Office rule that applies to commingling oil and gas production from New Mexico State Trust Lands is Rule 100.53. The rule is attached to the bottom of this form. If you have any questions, please contact the Oil, Gas, and Minerals Division at 505-827-5791.

1. Briefly describe what you propose to do. APPLICATION FOR POOL/LEASE COMMINGLE.

WELLS ARE DETAILED IN THE ATTACHED NMOCD APPLICATION AND CENTRAL TANK BATTERY
WILL BE LOCATED AT MORGAN FEE COM CTB; SEC 21 T24S R29E.

2. Fill in the following information for each well. *[Attach additional pages if needed.]*

Well name & number PLEASE SEE ATTACHED NMOCD PERMIT FOR INFO Lease # _____

Lessee of Record _____

Legal land description: Subdivisions _____

Sect _____ T _____ R _____ NMPM _____ County NM

Pool _____

Well name & number _____ Lease # _____

Lessee of Record _____

Legal land description: Subdivisions _____

Sect _____ T _____ R _____ NMPM _____ County NM

Pool _____

Well name & number _____ Lease # _____

Lessee of Record _____

Legal land description: Subdivisions _____

Sect _____ T _____ R _____ NMPM _____ County NM

Pool _____

Well_Name: MORGAN FEE COM # 1H API: 3001539968
Location: M-21-24.0S-29E 1035 FSL 455 FWL

Year: 2014

Pool Name: CORRAL DRAW;BONE SPRING

Month	Oil(BBLS)	Gas(MCF)	Water(BBLS)	Days Produced
January	3823	21224	3024	31
February	3263	16667	1876	28
March	3307	14821	610	30
April	3066	11730	474	30
May	2875	8808	533	31
June	2730	5168	441	30
July	2908	6041	864	31
August	2497	8139	0	0
September	0	0	0	0
October	0	0	0	0
November	0	0	0	0
December	0	0	0	0
CUM	143084	448005		