

9/15/2014 DATE IN	SUSPENSE	PRG ENGINEER	9/24/2014 LOGGED IN	SWD TYPE	PMAM1426958351 APP NO
----------------------	----------	-----------------	------------------------	-------------	--------------------------

ABOVE THIS LINE FOR DIVISION USE ONLY

NEW MEXICO OIL CONSERVATION DIVISION

- Engineering Bureau -

1220 South St. Francis Drive, Santa Fe, NM 87505



ADMINISTRATIVE APPLICATION CHECKLIST

THIS CHECKLIST IS MANDATORY FOR ALL ADMINISTRATIVE APPLICATIONS FOR EXCEPTIONS TO DIVISION RULES AND REGULATIONS WHICH REQUIRE PROCESSING AT THE DIVISION LEVEL IN SANTA FE

Application Acronyms:

[NSL-Non-Standard Location] [NSP-Non-Standard Proration Unit] [SD-Simultaneous Dedication]

[DHC-Downhole Commingling] [CTB-Lease Commingling] [PLC-Pool/Lease Commingling] - SWD

[PC-Pool Commingling] [OLS - Off-Lease Storage] [OLM-Off-Lease Measurement] - mclawson oil company

[WFX-Waterflood Expansion] [PMX-Pressure Maintenance Expansion]

[SWD-Salt Water Disposal] [IPI-Injection Pressure Increase]

[EOR-Qualified Enhanced Oil Recovery Certification] [PPR-Positive Production Response] 14744

[1] TYPE OF APPLICATION - Check Those Which Apply for [A]

[A] Location - Spacing Unit - Simultaneous Dedication

☐ NSL ☐ NSP ☐ SD

Check One Only for [B] or [C]

[B] Commingling - Storage - Measurement

☐ DHC ☐ CTB ☐ PLC ☐ PC ☐ OLS ☐ OLM

[C] Injection - Disposal - Pressure Increase - Enhanced Oil Recovery

☐ WFX ☐ PMX ☒ SWD ☐ IPI ☐ EOR ☐ PPR

[D] Other: Specify _____

[2] NOTIFICATION REQUIRED TO: - Check Those Which Apply, or Does Not Apply

[A] ☐ Working, Royalty or Overriding Royalty Interest Owners

[B] ☒ Offset Operators, Leaseholders or Surface Owner

[C] ☐ Application is One Which Requires Published Legal Notice

[D] ☐ Notification and/or Concurrent Approval by BLM or SLO
U.S. Bureau of Land Management - Commissioner of Public Lands, State Land Office

[E] ☒ For all of the above, Proof of Notification or Publication is Attached, and/or,

[F] ☐ Waivers are Attached

[3] SUBMIT ACCURATE AND COMPLETE INFORMATION REQUIRED TO PROCESS THE TYPE OF APPLICATION INDICATED ABOVE.

[4] **CERTIFICATION:** I hereby certify that the information submitted with this application for administrative approval is accurate and complete to the best of my knowledge. I also understand that no action will be taken on this application until the required information and notifications are submitted to the Division.

Note: Statement must be completed by an individual with managerial and/or supervisory capacity.

James Bruce

Print or Type Name

Signature

Attorney

Title

Date

jamesbruc@aol.com

e-mail Address

RECEIVED OOD
2014 SEP 15 P 3:22

Pool
- SWD; Devonian
96101

9/12/14

APPLICATION FOR AUTHORIZATION TO INJECT

- I. PURPOSE: Secondary Recovery Pressure Maintenance ☒ Disposal Storage
Application qualifies for administrative approval? X Yes No
- II. OPERATOR: **Mewbourne Oil Company**
ADDRESS: **500 W. Texas Suite 1020**
Midland, TX 79701
CONTACT PARTY: **Travis Cude** PHONE: **432-234-7724**
- III. WELL DATA: Complete the data required on the reverse side of this form for each well proposed for injection.
Additional sheets may be attached if necessary.
- IV. Is this an expansion of an existing project? Yes ☒ No
If yes, give the Division order number authorizing the project: _____
- V. Attach a map that identifies all wells and leases within two miles of any proposed injection well with a one-half mile radius circle drawn around each proposed injection well. This circle identifies the well's area of review.
- VI. Attach a tabulation of data on all wells of public record within the area of review which penetrate the proposed injection zone. Such data shall include a description of each well's type, construction, date drilled, location, depth, record of completion, and a schematic of any plugged well illustrating all plugging detail.
- VII. Attach data on the proposed operation, including:
1. Proposed average and maximum daily rate and volume of fluids to be injected;
 2. Whether the system is open or closed;
 3. Proposed average and maximum injection pressure;
 4. Sources and an appropriate analysis of injection fluid and compatibility with the receiving formation if other than reinjected produced water; and,
 5. If injection is for disposal purposes into a zone not productive of oil or gas at or within one mile of the proposed well, attach a chemical analysis of the disposal zone formation water (may be measured or inferred from existing literature, studies, nearby wells, etc.).
- *VIII. Attach appropriate geologic data on the injection zone including appropriate lithologic detail, geologic name, thickness, and depth. Give the geologic name, and depth to bottom of all underground sources of drinking water (aquifers containing waters with total dissolved solids concentrations of 10,000 mg/l or less) overlying the proposed injection zone as well as any such sources known to be immediately underlying the injection interval.
- IX. Describe the proposed stimulation program, if any.
- *X. Attach appropriate logging and test data on the well. (If well logs have been filed with the Division, they need not be resubmitted).
- *XI. Attach a chemical analysis of fresh water from two or more fresh water wells (if available and producing) within one mile of any injection or disposal well showing location of wells and dates samples were taken.
- XII. Applicants for disposal wells must make an affirmative statement that they have examined available geologic and engineering data and find no evidence of open faults or any other hydrologic connection between the disposal zone and any underground sources of drinking water.
- XIII. Applicants must complete the "Proof of Notice" section on the reverse side of this form.
- XIV. Certification: I hereby certify that the information submitted with this application is true and correct to the best of my knowledge and belief.

NAME: **Travis Cude**

TITLE: **Reservoir Engineer**

SIGNATURE: Travis Cude

DATE: 9/4/14

E-MAIL ADDRESS: **tcude@mewbourne.com**

- * If the information required under Sections VI, VIII, X, and XI above has been previously submitted, it need not be resubmitted. Please show the date and circumstances of the earlier submittal: _____

DISTRIBUTION: Original and one copy to Santa Fe with one copy to the appropriate District Office.

III. WELL DATA

- A. The following well data must be submitted for each injection well covered by this application. The data must be both in tabular and schematic form and shall include:

- (1) Lease name; Well No.; Location by Section, Township and Range; and footage location within the section.
- (2) Each casing string used with its size, setting depth, sacks of cement used, hole size, top of cement, and how such top was determined.
- (3) A description of the tubing to be used including its size, lining material, and setting depth.
- (4) The name, model, and setting depth of the packer used or a description of any other seal system or assembly used.

Division District Offices have supplies of Well Data Sheets which may be used or which may be used as models for this purpose. Applicants for several identical wells may submit a "typical data sheet" rather than submitting the data for each well.

- B. The following must be submitted for each injection well covered by this application. All items must be addressed for the initial well. Responses for additional wells need be shown only when different. Information shown on schematics need not be repeated.

- (1) The name of the injection formation and, if applicable, the field or pool name.
- (2) The injection interval and whether it is perforated or open-hole.
- (3) State if the well was drilled for injection or, if not, the original purpose of the well.
- (4) Give the depths of any other perforated intervals and detail on the sacks of cement or bridge plugs used to seal off such perforations.
- (5) Give the depth to and the name of the next higher and next lower oil or gas zone in the area of the well, if any.

XIV. PROOF OF NOTICE

All applicants must furnish proof that a copy of the application has been furnished, by certified or registered mail, to the owner of the surface of the land on which the well is to be located and to each leasehold operator within one-half mile of the well location.

Where an application is subject to administrative approval, a proof of publication must be submitted. Such proof shall consist of a copy of the legal advertisement which was published in the county in which the well is located. The contents of such advertisement must include:

- (1) The name, address, phone number, and contact party for the applicant;
- (2) The intended purpose of the injection well; with the exact location of single wells or the Section, Township, and Range location of multiple wells;
- (3) The formation name and depth with expected maximum injection rates and pressures; and,
- (4) A notation that interested parties must file objections or requests for hearing with the Oil Conservation Division, 1220 South St. Francis Dr., Santa Fe, New Mexico 87505, within 15 days.

NO ACTION WILL BE TAKEN ON THE APPLICATION UNTIL PROPER PROOF OF NOTICE HAS BEEN SUBMITTED.

NOTICE: Surface owners or offset operators must file any objections or requests for hearing of administrative applications within 15 days from the date this application was mailed to them.

Rio Bravo SWD #1 C-108
Additional Details

- VI.** There are no wells within the ½ mile area of review penetrating the Devonian on record.
- VII.** 1. Proposed average rate of 5000 bwpd and maximum rate of 20,000 bwpd.
2. Closed system.
3. Proposed average injection pressure is unknown and the maximum injection pressure is 2260 psig (0.2 psi/ft x 11,300 ft).
4. Injection fluid will be formation water from the Mewbourne Oil Company operated wells within the area producing from the Bone Spring. Mewbourne's closest producing well is located in 33-20S-28E. A water analysis from the Avalon Ridge 33 Fed Com 2H is attached.
5. We will be injecting into the Devonian. No water analysis is available for the Devonian.
- VIII.** 1. The proposed injection interval is within the Devonian carbonate formation which is a porous dolomite at +/- 11,280'
2. The underground fresh water aquifers (unnamed) are present at shallow depths down to about 300', shallower than the depth of the 9 5/8" csg. setting. There are no known fresh water intervals underlying the injecting formation.
- IX.** The proposed stimulation is an open-hole acid treatment of 20000 gallons of 15% HCL.
- X.** Well logs have been filed with the Division to a depth of 11,307'. New logs will be provided after the well has been deepened.
- XI.** There are two freshwater wells within 1 mile of the proposed SWD. They are located in units N and L in Section 11 T21S R25E. The well in unit N is not producing and attached is the water analysis for the well in unit L.
- XII.** (Mewbourne Oil Company has examined geologic and engineering data and has found that there is no evidence of faulting between the proposed disposal zone and any underground sources of drinking water.)
- XIII.** See attached Proof of Notice

INJECTION WELL DATA SHEET

OPERATOR: **Mewbourne Oil Company**

WELL NAME & NUMBER: **Rio Bravo SWD #1** (Originally: State Com #1) API 30-015-20221

WELL LOCATION: 1980' FNL & 1980' FEL G 15 21S 25E
FOOTAGE LOCATION UNIT LETTER SECTION TOWNSHIP RANGE

WELLBORE SCHEMATIC (See Attached)

WELL CONSTRUCTION DATA

Surface Casing

Hole Size: **20"** Casing Size: **16" @ 140'**

Cement with. **150 sx & 40 yds ready-mix** Top of Cement: **Surface (visual)**

Intermediate Casing

Hole Size: **13 3/4" (1000')** Casing Size: **9 5/8" @ 2706'**

12 1/4" (1000'-2706')
Cement with. **2150 sx & 47 1/2 yds read-mix** Top of Cement: **Surface (stg. to surface)**

Will run for injection after deepening hole:

Intermediate Casing

Hole Size: **8 3/4"** Casing Size: **7" @ 11300'**
DV TOOL @ 7100'

Cement with. **1600sx Class H (1.28 cuft/sx yield)** Top of Cement: **Surface**

Open Hole

Hole Size: **6 1/8"**

TD @ 12,800'

Injection Interval
11300' - 12800'

INJECTION WELL DATA SHEET

Tubing Size: **3 1/2" 9.3# L80**

Lining Material: **TK99 IPC**

Type of Packer: **Arrowset 1X (nickel plated) 3 1/2" x 7"**

Packer Setting Depth: **+/-11,250'**

Other Type of Tubing/Casing Seal (if applicable): **None**

Additional Data

1. Is this a new well drilled for injection? **No**

If no, for what purpose was the well originally drilled? **Devonian Test**

2. Name of the Injection Formation: **Devonian**

3. Name of Field or Pool (if applicable): **Wildcat Outpost**

4. Has the well ever been perforated in any other zone(s)? List all such perforated intervals and give plugging detail, i.e. sacks of cement or plug(s) used.

Perforations @ 1100'-1101' and 1878'-1880' for cementing intermediate casing.

Plugs @ 11207' (40 sx), 10100' (40 sx), 8400' (40 sx), 7000' (40 sx), 5150' (40 sx), 3450' (40 sx), 2650' (40 sx), 25' to surface (10 sx)

5. Give the name and depths of any oil or gas zones underlying or overlying the proposed injection zone in this area:

Overlying producing zone – **Morrow (roughly 1000' above injection interval)**

Underlying producing zone – **N/A**

Mewbourne Oil Company

Well Name: State Com #1

Updated by: T. Cude

Spud Date: 4/28/1969

Date Updated: 9/26/2013

Surface

20" x 16" 47.2#

Set @ 140'

150 sks @ 40 yds ready-mix

1st Intermediate

13 3/4" x 9 5/8" 32.3# H-40 (1000')

12 1/4" x 9 5/8" 36# H-40 (2706')

Perfs to stage cement job

2150 sx & 47.5 yds ready-mix

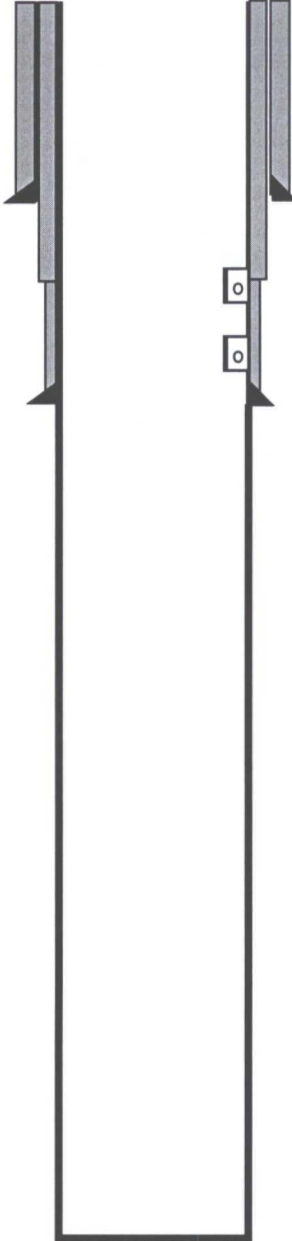

Perfs

1100' - 1101'

1878' - 1880'

2nd Intermediate

8 7/8" Open Hole, D&A

TD @ 11,307'

Mewbourne Oil Company

Well Name: Rio Bravo SWD #1

Proposed by: T. Cude

Spud Date: 4/28/1969

Date Updated: 9/26/2013

Surface

20" x 16" 47.2#

Set @ 140'

150 sks @ 40 yds ready-mix

1st Intermediate

13 3/4" x 9 5/8" 32.3# H-40 (1000')

12 1/4" x 9 5/8" 36# H-40 (2706')

Perfs to stage cement job 1969

2150 sx & 47.5 yds ready-mix

Multiple
Perf stages
(3)
+ Bradenheads
(4)

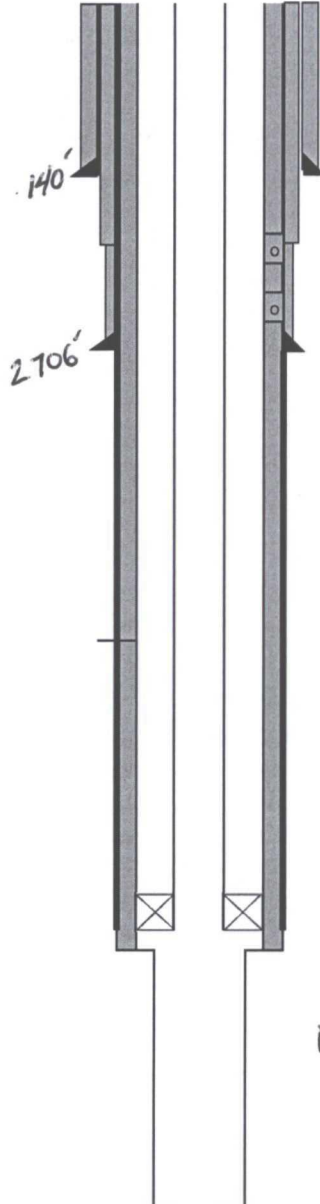

9 5/8" Perfs

1100' - 1101'

1878' - 1880'

DV Tool @ 7100' ✓

2nd Intermediate

8 3/4" x 7" 26# P110 LTC

Set @ 11300'

1600 sx of Class H (1.28 yield)

TOC Surface

Injection String

3 1/2" 9.3# L80 tbg IPC w/TK99

Pkr set @ 11250'

11300 to 12800

Injection Interval

6 1/8" Open Hole

TD @ 12800'

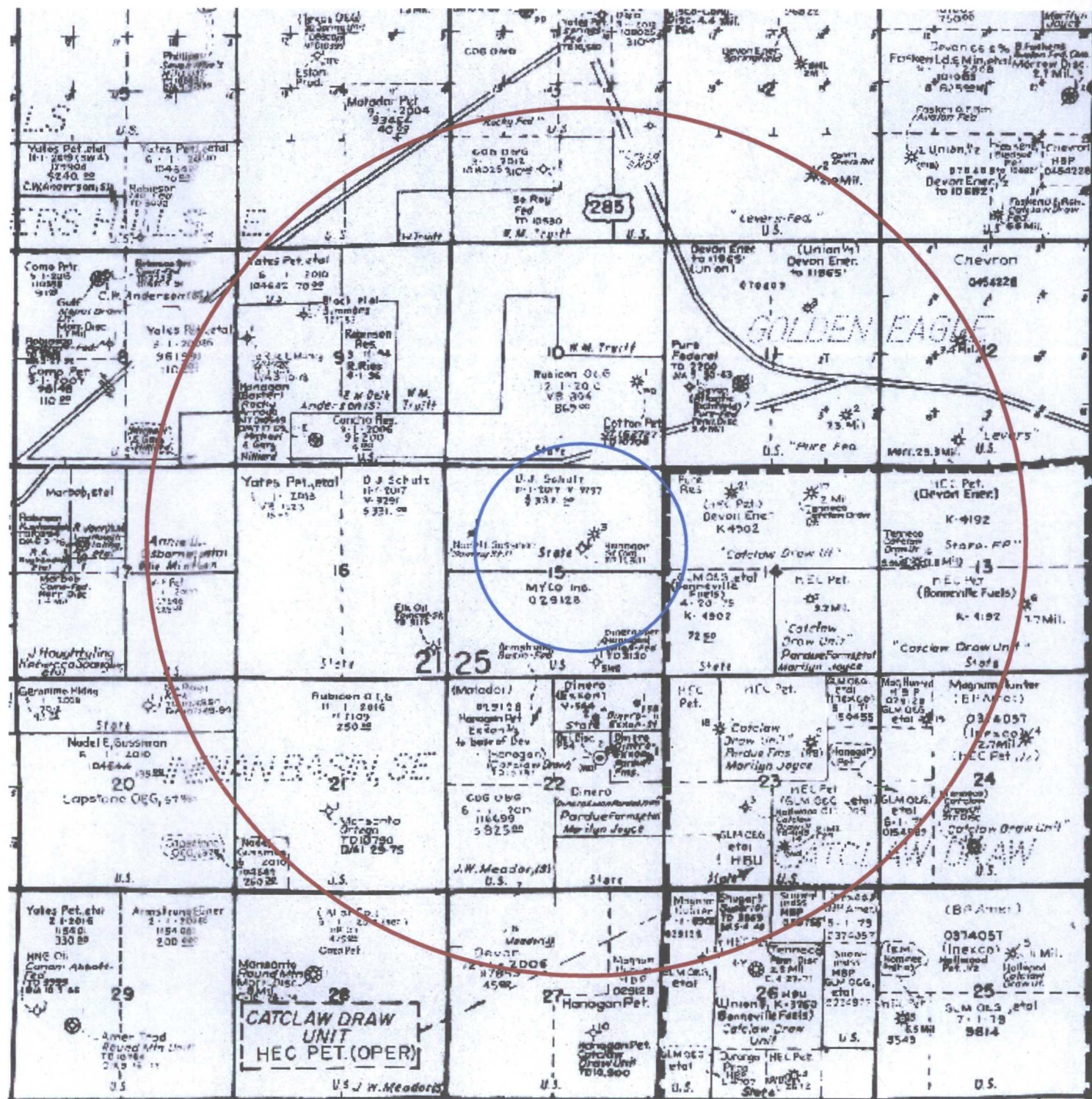
T
21
S

**Frac Water Analysis**

Date:

2708 West County Road, Hobbs NM 88240
Phone (575) 392-5556 Fax (575) 392-7307

Source Water

1

Analyzed For

Company	Well Name	County	State
Mewbourne	L-11-21S-25E	Lea	New Mexico

Specific Gravity	1.000	SG @ 60 °F	1.002
pH	7.84	Sulfides	Absent
Temperature (°F)	70	Reducing Agents	Absent

Cations

Sodium (Calc)	in Mg/L	12	in PPM	12
Calcium	in Mg/L	152	in PPM	152
Magnesium	in Mg/L	36	in PPM	36
Soluble Iron (FE2)	in Mg/L	0.0	in PPM	0

Anions

Chlorides	in Mg/L	240	in PPM	240
Sulfates	in Mg/L	105	in PPM	105
Bicarbonates	in Mg/L	132	in PPM	131

Total Hardness (as CaCO3)	in Mg/L	530	in PPM	529
Total Dissolved Solids (Calc)	in Mg/L	676	in PPM	675

Remarks Fresh Water

TYLER, TEXAS 75711

API No. 30-015-39415

JUN 15 2012

NOTICE LIST

Surface Owner

Oil, Gas and Minerals Division
Commissioner of Public Lands
P.O. Box 1148
Santa Fe, New Mexico 87504

Offset Operators

Crown Oil Partners V, LP	S/2S/2 Section 10
P.O. Box 50820	
Midland, Texas 79710	

Chevron Midcontinent, LP	W/2 Section 14
P.O. Box 2100	
Houston, Texas 77252	

Magnum Hunter Production, Inc.	S/2 Section 15
Suite 600	
600 North Marienfeld	
Midland, Texas 79701	

Manzano, LLC	S/2 Section 15
P.O. Box 2107	
Roswell, New Mexico 88202	

Mewbourne Oil Company	N/2 Section 15
-----------------------	----------------

JAMES BRUCE
ATTORNEY AT LAW

POST OFFICE BOX 1056
SANTA FE, NEW MEXICO 87504

369 MONTEZUMA, NO. 213
SANTA FE, NEW MEXICO 87501

(505) 982-2043 (Phone)
(505) 660-6612 (Cell)
(505) 982-2151 (Fax)

jamesbruc@aol.com

September 12, 2014

CERTIFIED MAIL – RETURN RECEIPT REQUESTED

To: Persons on Exhibit A

Ladies and gentlemen:

Mewbourne Oil Company has filed an application with the New Mexico Oil Conservation Division seeking approval of a salt water disposal well in the SW¼NE¼ of Section 15, Township 21 South, Range 25 East, N.M.P.M., Eddy County, New Mexico. A copy of the application is enclosed. If you object to the application, you must notify the Division in writing within 15 days (the Division's address is 1220 South St. Francis Drive, Santa Fe, New Mexico 87505). Failure to object will preclude you from contesting this matter at a later date.

Very truly yours,

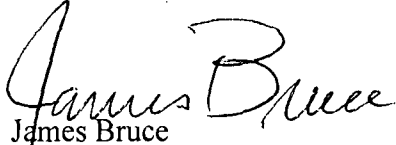
James Bruce

Attorney for Mewbourne Oil Company

Exhibit A

Surface Owner

Oil, Gas and Minerals Division
Commissioner of Public Lands
P.O. Box 1148
Santa Fe, New Mexico 87504

Offset Operators

Crown Oil Partners V, LP
P.O. Box 50820
Midland, Texas 79710

Chevron Midcontinent, LP
P.O. Box 2100
Houston, Texas 77252

Magnum Hunter Production, Inc.
Suite 600
600 North Marienfeld
Midland, Texas 79701

Manzano, LLC
P.O. Box 2107
Roswell, New Mexico 88202

NOTICE

Mewbourne Oil Company has filed an application with the New Mexico Oil Conservation Division seeking approval to re-enter and deepen the State Com. Well No. 1, to be re-named the Rio Bravo SWD Well No. 1, located 1980 feet from the north line and 1980 feet from the east line (the SW/4NE/4) of Section 15, Township 21 South, Range 25 East, NMPM, Eddy County, New Mexico, and dispose of produced water into the Devonian formation at depths of 11300-12800 feet subsurface. The expected maximum injection rate is 20000 BWPD, and the maximum injection pressure is 2260 psi. If you object to the application you must file a written objection or request for hearing with the Division within 15 days of the date this notice is published. The Division's address is 1220 South St. Francis Drive, Santa Fe, New Mexico 87505. Failure to object will preclude you from contesting this matter at a later date. The name and address of the contact party for applicant is Corey Mitchell, Mewbourne Oil Company, Suite 1020, 500 West Texas, Midland, Texas 79701, (432)-682-3715. The well is located approximately 10 miles south of Lakewood, New Mexico.

JAMES BRUCE
ATTORNEY AT LAW

POST OFFICE BOX 1056
SANTA FE, NEW MEXICO 87504

369 MONTEZUMA, NO. 213
SANTA FE, NEW MEXICO 87501

(505) 982-2043 (Phone)
(505) 660-6612 (Cell)
(505) 982-2151 (Fax)

jamesbruc@aol.com

RECEIVED OGD
2014 SEP 15 P 3:22

September 12, 2014

Phillip Goetze
Oil Conservation Division
1220 South St. Francis Drive
Santa Fe, New Mexico 87505

Dear Mr. Goetze:

Enclosed is an application for administrative approval of a salt water disposal well, filed on behalf of Mewbourne Oil Company. When I receive the certified green cards and the newspaper's affidavit of publication I will forward them to you.

Very truly yours,

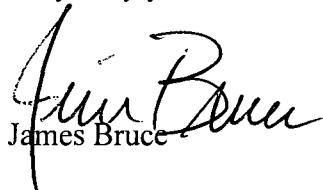
James Bruce

Attorney for Mewbourne Oil Company

**C-108 Review Checklist:**Received 09/24/14Add. Request: —Reply Date: —Suspended: —

[Ver 15]

ORDER TYPE: WFX / PMX / SWD Number: 1511Order Date: 12/05/2014Legacy Permits/Orders: NoneWell No. 1 Well Name(s): Rio Bravo SWD

[original: State Com. No. 1]

API: 30-0 15-20221Spud Date: 04/28/69New or Old: old (UIC Class II Primacy 03/07/1982)Footages 1980 FNL / 1980 FEL Lot — or Unit G Sec 15 Tsp 21S Rge 25E County EddyGeneral Location: 8 mi NW of Carlsbad / Azotea Mesa area Pool: SWD; Devonian Pool No.: 96101BLM 100K Map: Carlsbad Operator: Mawbome Oil Co. OGRID: 14744 Contact: J. BruceCOMPLIANCE RULE 5.9: Total Wells: 814 Inactive: 0 Fincl Assur: Yes Compl. Order? No IS 5.9 OK? Yes Date: 12/05/2014WELL FILE REVIEWED ☒ Current Status: P&A'd; two strings of casing - to 2706; open hole to 11307; plugsWELL DIAGRAMS: NEW: Proposed ☐ or RE-ENTER: Before Conv. ☐ After Conv. ☒ Logs in Imaging: acoustic GP - Induction set up to 11307Planned Rehab Work to Well: Drill out/plugs to 11300; set 7-inch & cmt; drill out open hole interval

Well Construction Details	Sizes (in) Borehole / Pipe	Setting Depths (ft)	Cement Size or Cr	Cement Top and Determination Method
Planned <input type="checkbox"/> or Existing <input checked="" type="checkbox"/> Surface	<u>20 / 16</u>	<u>0 to 140</u>	<u>140</u>	<u>Cir. to surface</u>
Planned <input type="checkbox"/> or Existing <input checked="" type="checkbox"/> Intern/Prod	<u>13 3/4 / 12 1/4</u>	<u>0 to 2706</u>	<u>None</u>	<u>2150 SX + 47.32 / Multiple TS - Confirm</u>
Planned <input checked="" type="checkbox"/> or Existing <input type="checkbox"/> Intern/Prod	<u>8 3/4 / 7</u>	<u>0 to 11300</u>	<u>DV @ 7100</u>	<u>1600 / Cir to surface C&L</u>
Planned <input type="checkbox"/> or Existing <input type="checkbox"/> Prod/Liner	<u>—</u>	<u>—</u>	<u>—</u>	<u>—</u>
Planned <input type="checkbox"/> or Existing <input type="checkbox"/> Liner	<u>—</u>	<u>—</u>	<u>—</u>	<u>—</u>
Planned <input checked="" type="checkbox"/> or Existing <input type="checkbox"/> (OH) PERF	<u>6 7/8</u>	<u>11300 to 12800</u>	<u>Inj Length 1500</u>	<u>—</u>

Injection Lithostratigraphic Units:	Depths (ft)	Injection or Confining Units	Tops	Completion/Operation Details:
Adjacent Unit: Litho. Struc. Por.		<u>Morrow</u>	<u>10004</u>	Drilled TD <u>11307</u> PBDT <u>2650 - last hole plug</u>
Confining Unit: Litho. <u>Struc.</u> Por.	<u>~ 16</u>	<u>Mississippian</u>	<u>11236</u>	NEW TD <u>12800</u> NEW PBDT <u>NA</u>
Proposed Inj Interval TOP:	<u>11300</u>	<u>Devonian</u>	<u>11284</u>	NEW Open Hole <input checked="" type="radio"/> or NEW Perfs <input type="radio"/>
Proposed Inj Interval BOTTOM:	<u>12800</u>			Tubing Size <u>3 1/2</u> in. Inter Coated? <u>Yes</u>
Confining Unit: Litho. Struc. Por.	<u>unknown</u>	<u>Fuselman Sil</u>	<u>(+ 12800)</u>	Proposed Packer Depth <u>11250</u> ft
Adjacent Unit: Litho. Struc. Por.		<u>Ordovician</u>		Min. Packer Depth <u>11200</u> (100-ft limit)
				Proposed Max. Surface Press. <u>2260</u> psi
				Admin. Inj. Press. <u>2260</u> (0.2 psi per ft)

AOR: Hydrologic and Geologic InformationPOTASH: R-111-P No Noticed? NA BLM Sec Ord 16 WIPP 16 Noticed? NA Salt/Salado T: — B: — NW: Cliff House fm NAFRESH WATER: Aquifer Shallow alluvial / Delaware Max Depth < 250' / Reef HYDRO AFFIRM STATEMENT By Qualified Person ☒NMOSE Basin: Capitan / Carlsbad CAPITAN REEF: thru ☒ adj ☐ NA ☐ No. Wells within 1-Mile Radius? 2 FW Analysis ☒Disposal Fluid: Formation Source(s) Mawbome's Bone Spring wells Analysis? Yes On Lease ☐ Operator Only ☒ or Commercial ☐Disposal Int: Inject Rate (Avg/Max BWPD): 10000 / 26000 Protectable Waters? UNK - low probability Source: UNK System: Closed ☒ or Open ☐HC Potential: Producing Interval? No Formerly Producing? No Method: Logs/DST/P&A/Other UNK 2-Mile Radius Pool Map NAAOR Wells: 1/2-M Radius Map? Yes Well List? NA Total No. Wells Penetrating Interval: 0 Horizontals? 0Penetrating Wells: No. Active Wells 0 Num Repairs? — on which well(s)? — Diagrams? NAPenetrating Wells: No. P&A Wells 0 Num Repairs? — on which well(s)? — Diagrams? NANOTICE: Newspaper Date 09/16/2014 Mineral Owner SLO Surface Owner SLO N. Date 09/17/14RULE 26.7(A): Identified Tracts? Yes Affected Persons: Crown Oil / Chevron Mid / Magnum Hunter / Manzanillo N. Date 09/16/17/14Order Conditions: Issues: 9 5/8" cementing history; Devonian untested below; formation picks; interval lengthsAdd Order Cond: Run RCBL on 9 5/8" casing before drilling out plugs; mud log & salinity; formationselection; injection survey (2 yrs)

30-015-20221

NO. OF COPIES RECEIVED	3
DISTRIBUTION	
SANTA FE	1
FILE	1
U.S.G.S.	
LAND OFFICE	
OPERATOR	1

RECEIVED
NEW MEXICO OIL CONSERVATION COMMISSION

JUN 2 1969

O. C. C.
ARTESIA, OFFICE

Form C-103
Supersedes Old
C-102 and C-103
Effective 1-1-65

5a. Indicate Type of Lease State <input checked="" type="checkbox"/> Fee <input type="checkbox"/>
5. State Oil & Gas Lease No. K-4333

SUNDRY NOTICES AND REPORTS ON WELLS
(DO NOT USE THIS FORM FOR PROPOSALS TO DRILL OR TO DEEPEN OR PLUG BACK TO A DIFFERENT RESERVOIR.
USE "APPLICATION FOR PERMIT -" (FORM C-101) FOR SUCH PROPOSALS.)

1. <input type="checkbox"/> OIL WELL <input checked="" type="checkbox"/> GAS WELL <input type="checkbox"/> OTHER-	7. Unit Agreement Name ---
2. Name of Operator Hanagan Petroleum Corporation	8. Farm or Lease Name State-Com
3. Address of Operator P. O. Box 1737, Roswell, New Mexico 88201	9. Well No. 1
4. Location of Well UNIT LETTER G , 1980 FEET FROM THE North LINE AND 1980 FEET FROM THE East LINE, SECTION 15 TOWNSHIP 21 South RANGE 25 East N.M.P.M.	10. Field and Pool, or Wildcat Golden Eagle Morrow
15. Elevation (Show whether DF, RT, GR, etc.) 3360' GR	12. County Eddy

16. Check Appropriate Box To Indicate Nature of Notice, Report or Other Data
NOTICE OF INTENTION TO: SUBSEQUENT REPORT OF:

PERFORM REMEDIAL WORK <input type="checkbox"/>	PLUG AND ABANDON <input type="checkbox"/>	REMEDIAL WORK <input type="checkbox"/>	ALTERING CASING <input type="checkbox"/>
TEMPORARILY ABANDON <input type="checkbox"/>	CHANGE PLANS <input type="checkbox"/>	COMMENCE DRILLING OPNS. <input type="checkbox"/>	PLUG AND ABANDONMENT <input type="checkbox"/>
PULL OR ALTER CASING <input type="checkbox"/>	OTHER <input type="checkbox"/>	CASING TEST AND CEMENT JOB <input checked="" type="checkbox"/>	OTHER <input type="checkbox"/>

17. Describe Proposed or Completed Operations (Clearly state all pertinent details, and give pertinent dates, including estimated date of starting any proposed work) SEE RULE 1703.

5/14/69: Ran 9-5/8" 36# J55 & 32.3# H40 casing to 2706', cement baskets @ 2200', 1700', 1200', & 700'. Cemented w/300 sx Class C-Pozmix A, 4% gelsolite, 1/4# Flocele & 8# salt/sk & 450 sx Class C-Pozmix A, 4% gel, 1/4# Flocele & 8# salt/sk Hole bridged, pressured to 2000 psi. Drilled out cement to 2660'. Top cement behind casing 2320' by Temp. Survey. Perforated 7 holes, 1878-1880', cemented w/ 40 sx Class C-Pozmix A, 4% gel, 1/4# Flocele, 2% CaCl, 8# salt/sk, & 110' sx Class C-Pozmix A, 2% CaCl, 8# salt/sk. T/cement 1540'. Temp. Survey. Perforated 5 holes, 1100-1101', cemented w/890 sx Class C-Pozmix A, 4% gel, 1/4# Flocele, 2% CaCl, T/cement 620' by Temp. Survey. Ran 1" IJ tubing, tagged cement at 674', staged cement as follows: 110 sx Class C, 4% CaCl, 75# Flocele, 674-470'; 80 sx Class C, 4% CaCl, 37# Flocele, 470-440'; 110 sx Class C, 4% CaCl, 75# Flocele, 440-374'; 60 sx Class C, 4% CaCl, 25# Flocele, no fill. Staging completed 8:00 P.M., 5/17/69. WOC 5 1/2 hrs. Filled annulus w/47 1/2 cu. yds. of Ready Mix concrete, 4% CaCl. Job complete 7:30 A.M., 5/18/69. WOC 26 1/2 hrs. Drilled plugs @ 974-1110' and 1829-1890'. Tested casing for 30 minutes @ 1500 psi, no pressure drop. Drilled plug 2660-2706' at 10:00 A.M., 5/19/69 with air.

18. I hereby certify that the information above is true and complete to the best of my knowledge and belief.

SIGNED <u>Hugh C. Hanagan</u>	TITLE <u>Vice President</u>	DATE <u>5/28/69</u>
APPROVED BY <u>R. F. Lamm</u>	TITLE <u>OIL AND GAS INSPECTOR</u>	DATE <u>JUN 2 1969</u>

CONDITIONS OF APPROVAL, IF ANY:

MEWBOURNE OIL COMPANY

500 W. TEXAS, SUITE 1020
MIDLAND, TEXAS 79701

(432) 682-3715
FAX (432) 685-4170

December 5, 2014

Engineering and Geological Services Bureau, Oil Conservation Division
1220 South St. Francis Drive
Santa Fe, NM 87505
Attn: Mr. Phillip Goetze

Re: Rio Bravo SWD #1

Mr. Goetze,

In accordance with item XII on Mewbourne Oil Company's C-108 filed for the captioned salt water disposal well, Mewbourne Oil Company has examined geologic and engineering data and has found that there is no evidence of faulting or any other hydrologic connection between the proposed disposal zone and any underground sources of drinking water.

Should you have any questions, please email me at tcude@mewbourne.com or call me at (432) 682-3715.

Sincerely yours,

MEWBOURNE OIL COMPANY



Travis Cude
Reservoir Engineer

JAMES BRUCE
ATTORNEY AT LAW

POST OFFICE BOX 1056
SANTA FE, NEW MEXICO 87504

369 MONTEZUMA, NO. 213
SANTA FE, NEW MEXICO 87501

(505) 982-2043 (Phone)
(505) 660-6612 (Cell)
(505) 982-2151 (Fax)

jamesbruce@aol.com

September 12, 2014

CERTIFIED MAIL – RETURN RECEIPT REQUESTED

To: Persons on Exhibit A

Ladies and gentlemen:

Mewbourne Oil Company has filed an application with the New Mexico Oil Conservation Division seeking approval of a salt water disposal well in the SW $\frac{1}{4}$ NE $\frac{1}{4}$ of Section 15, Township 21 South, Range 25 East, N.M.P.M., Eddy County, New Mexico. A copy of the application is enclosed. If you object to the application, you must notify the Division in writing within 15 days (the Division's address is 1220 South St. Francis Drive, Santa Fe, New Mexico 87505). Failure to object will preclude you from contesting this matter at a later date.

Very truly yours,

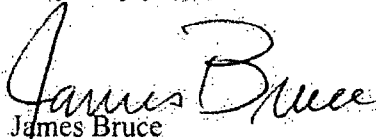
James Bruce

Attorney for Mewbourne Oil Company

Exhibit A

Surface Owner

Oil, Gas and Minerals Division
Commissioner of Public Lands
P.O. Box 1148
Santa Fe, New Mexico 87504

Offset Operators

Crown Oil Partners V, LP
P.O. Box 50820
Midland, Texas 79710

Chevron Midcontinent, LP
P.O. Box 2100
Houston, Texas 77252

Magnum Hunter Production, Inc.
Suite 600
600 North Marienfeld
Midland, Texas 79701

Manzano, LLC
P.O. Box 2107
Roswell, New Mexico 88202

SENDER: COMPLETE THIS SECTION		COMPLETE THIS SECTION ON DELIVERY	
<p>■ Complete items 1, 2, and 3. Also complete item 4 if Restricted Delivery is desired.</p> <p>■ Print your name and address on the reverse so that we can return the card to you.</p> <p>■ Attach this card to the back of the mailpiece, or on the front if space permits.</p>		<p>A. Signature <input checked="" type="checkbox"/> <i>R. Paul</i> <input type="checkbox"/> Agent <input type="checkbox"/> Addressee</p> <p>B. Received by (Printed Name) <i>R. Paul</i></p> <p>C. Date of Delivery <i>9/16/14</i></p> <p>D. Is delivery address different from item 1? <input type="checkbox"/> Yes If YES, enter delivery address below: <input type="checkbox"/> No</p>	
<p>1. Article Addressed to:</p> <p>Crown Oil Partners V, LP P.O. Box 50820 Midland, Texas 79710</p>		<p>3. Service Type</p> <p><input checked="" type="checkbox"/> Certified Mail® <input type="checkbox"/> Priority Mail Express™ <input type="checkbox"/> Registered <input type="checkbox"/> Return Receipt for Merchandise <input type="checkbox"/> Insured Mail <input type="checkbox"/> Collect on Delivery</p>	
<p>2. Article Number (Transfer from service label) 7013 3020 0000 4636 9695</p>		<p>4. Restricted Delivery? (Extra Fee) <input type="checkbox"/> Yes</p>	
<p>PS Form 3811, July 2013 Domestic Return Receipt <i>M. SCD</i></p>			

U.S. Postal Service™ CERTIFIED MAIL™ RECEIPT (Domestic Mail Only; No Insurance Coverage Provided)			
For delivery information visit our website at www.usps.com			
SANTA FE NM 87504			
Postage	\$ 1.61	0500	16 Postmark Here
Certified Fee	\$3.30		
Return Receipt Fee (Endorsement Required)	\$2.70		
Restricted Delivery Fee (Endorsement Required)	\$0.00		
Total Postage & Fees	\$ 7.61	09/12/2014	
<p>Sent To: Oil, Gas and Minerals Division Commissioner of Public Lands P.O. Box 1148 Santa Fe, New Mexico 87504</p>			
<p>PS Form 3800, August 2005 See Reverse for Instructions</p>			

U.S. Postal Service™ CERTIFIED MAIL™ RECEIPT (Domestic Mail Only; No Insurance Coverage Provided)			
For delivery information visit our website at www.usps.com			
MIDLAND TX 79710			
Postage	\$ 1.40	0500	16 Postmark Here
Certified Fee	\$3.30		
Return Receipt Fee (Endorsement Required)	\$2.70		
Restricted Delivery Fee (Endorsement Required)	\$0.00		
Total Postage & Fees	\$ 7.40	09/12/2014	
<p>Sent To: Crown Oil Partners V, LP P.O. Box 50820 Midland, Texas 79710</p>			
<p>PS Form 3800, August 2005 See Reverse for Instructions</p>			

SENDER: COMPLETE THIS SECTION		COMPLETE THIS SECTION ON DELIVERY	
<p>■ Complete items 1, 2, and 3. Also complete item 4 if Restricted Delivery is desired.</p> <p>■ Print your name and address on the reverse so that we can return the card to you.</p> <p>■ Attach this card to the back of the mailpiece, or on the front if space permits.</p>		<p>A. Signature <input checked="" type="checkbox"/> <i>Robert D...</i> <input type="checkbox"/> Agent <input type="checkbox"/> Addressee</p> <p>B. Received by (Printed Name) C. Date of Delivery</p> <p>D. Is delivery address different from item 1? <input type="checkbox"/> Yes If YES, enter delivery address below: <input type="checkbox"/> No</p>	
<p>1. Article Addressed to:</p> <p>Oil, Gas and Minerals Division Commissioner of Public Lands P.O. Box 1148 Santa Fe, New Mexico 87504</p>		<p>3. Service Type</p> <p><input checked="" type="checkbox"/> Certified Mail® <input type="checkbox"/> Priority Mail Express™ <input type="checkbox"/> Registered <input type="checkbox"/> Return Receipt for Merchandise <input type="checkbox"/> Insured Mail <input type="checkbox"/> Collect on Delivery</p>	
<p>2. Article Number (Transfer from service label) 7013 3020 0000 4635 9948</p>		<p>4. Restricted Delivery? (Extra Fee) <input type="checkbox"/> Yes</p>	
<p>PS Form 3811, July 2013 Domestic Return Receipt <i>M. SCD</i></p>			

SENDER: COMPLETE THIS SECTION		COMPLETE THIS SECTION ON DELIVERY	
<p>■ Complete items 1, 2, and 3. Also complete item 4 if Restricted Delivery is desired.</p> <p>■ Print your name and address on the reverse so that we can return the card to you.</p> <p>■ Attach this card to the back of the mailpiece, or on the front if space permits.</p>		<p>A. Signature <input checked="" type="checkbox"/> Agent <input type="checkbox"/> Addressee</p>	
<p>1. Article Addressed to:</p> <p>Magnum Hunter Production, Inc. Suite 600 600 North Maricfield Midland, Texas 79701</p>		<p>B. Received by (Printed Name) David Garcia</p> <p>C. Date of Delivery 9-16-14</p>	
<p>2. Article Number (Transfer from service label) 7013 3020 0000 4636 9688</p>		<p>D. Is delivery address different from item 1? <input type="checkbox"/> Yes If YES, enter delivery address below: <input type="checkbox"/> No</p>	
<p>PS Form 3811, July 2013 Domestic Return Receipt</p>		<p>3. Service Type <input checked="" type="checkbox"/> Certified Mail® <input type="checkbox"/> Priority Mail Express™ <input type="checkbox"/> Registered <input type="checkbox"/> Return Receipt for Merchandise <input type="checkbox"/> Insured Mail <input type="checkbox"/> Collect on Delivery</p>	
<p>4. Restricted Delivery? (Extra Fee) <input type="checkbox"/> Yes</p>			

U.S. Postal Service™ CERTIFIED MAIL® RECEIPT (Domestic Mail Only; No Insurance Coverage Provided)		
For delivery information visit our website at www.usps.com		
HOUSTON TX 77252		
Postage	\$ 1.61	0500
Certified Fee	\$3.30	16 Postmark Here
Return Receipt Fee (Endorsement Required)	\$2.70	
Restricted Delivery Fee (Endorsement Required)	\$0.00	
Total Postage & Fees	\$ 4.61	09/12/2014
<p>Sent To: Chevron Midcontinent, L.P. P.O. Box 2100 Houston, Texas 77252</p> <p>Street, Apt. No. or P.O. Box No. City, State, ZIP+4</p>		
PS Form 3810, August 2006 See Reverse for Instructions		

U.S. Postal Service™ CERTIFIED MAIL® RECEIPT (Domestic Mail Only; No Insurance Coverage Provided)		
For delivery information visit our website at www.usps.com		
MIDLAND TX 79701		
Postage	\$ 1.40	0500
Certified Fee	\$3.30	16 Postmark Here
Return Receipt Fee (Endorsement Required)	\$2.70	
Restricted Delivery Fee (Endorsement Required)	\$0.00	
Total Postage & Fees	\$ 7.40	09/12/2014
<p>Sent To: Magnum Hunter Production, Inc. Suite 600 600 North Maricfield Midland, Texas 79701</p> <p>Street, Apt. No. or P.O. Box No. City, State, ZIP+4</p>		
PS Form 3810, August 2006 See Reverse for Instructions		

SENDER: COMPLETE THIS SECTION		COMPLETE THIS SECTION ON DELIVERY	
<p>■ Complete items 1, 2, and 3. Also complete item 4 if Restricted Delivery is desired.</p> <p>■ Print your name and address on the reverse so that we can return the card to you.</p> <p>■ Attach this card to the back of the mailpiece, or on the front if space permits.</p>		<p>A. Signature <input checked="" type="checkbox"/> Agent <input type="checkbox"/> Addressee</p>	
<p>1. Article Addressed to:</p> <p>Chevron Midcontinent, L.P. P.O. Box 2100 Houston, Texas 77252</p>		<p>B. Received by (Printed Name) David Garcia</p> <p>C. Date of Delivery 9-17-14</p>	
<p>2. Article Number (Transfer from service label) 7013 3020 0000 4636 9701</p>		<p>D. Is delivery address different from item 1? <input type="checkbox"/> Yes If YES, enter delivery address below: <input type="checkbox"/> No</p>	
<p>PS Form 3811, July 2013 Domestic Return Receipt</p>		<p>3. Service Type <input checked="" type="checkbox"/> Certified Mail® <input type="checkbox"/> Priority Mail Express™ <input type="checkbox"/> Registered <input type="checkbox"/> Return Receipt for Merchandise <input type="checkbox"/> Insured Mail <input type="checkbox"/> Collect on Delivery</p>	
<p>4. Restricted Delivery? (Extra Fee) <input type="checkbox"/> Yes</p>			

7013 3020 0000 4636 9671

U.S. Postal Service™ CERTIFIED MAIL® RECEIPT (Domestic Mail Only; No Insurance Coverage Provided)		
For delivery information visit our website at www.usps.com		
ROSWELL NM 88202		
Postage	\$ 1.61	0500 16 Postmark Here 09/12/2014
Certified Fee	\$3.30	
Return Receipt Fee (Endorsement Required)	\$2.70	
Restricted Delivery Fee (Endorsement Required)	\$0.00	
Total Postage & Fees	\$ 7.61	
Sent To Street, Apt. No., or P.O. Box No. Manzano, LLC P.O. Box 2107 City, State, ZIP+4 Roswell, New Mexico 88202		
PS Form 3800, August 2006 See Reverse for Instructions		

SENDER: COMPLETE THIS SECTION		COMPLETE THIS SECTION ON DELIVERY	
■ Complete items 1, 2, and 3. Also complete item 4 if Restricted Delivery is desired. ■ Print your name and address on the reverse so that we can return the card to you. ■ Attach this card to the back of the mailpiece, or on the front if space permits.		A. Signature X <i>[Signature]</i> <input type="checkbox"/> Agent <input type="checkbox"/> Addressee	
1. Article Addressed to: Manzano, LLC P.O. Box 2107 Roswell, New Mexico 88202		B. Received by (Printed Name) <i>Debra J. Peters</i> C. Date of Delivery <i>9/16/14</i> D. Is delivery address different from item 1? <input type="checkbox"/> Yes If YES, enter delivery address below: <input type="checkbox"/> No	
2. Article Number (Transfer from service label)		3. Service Type <input checked="" type="checkbox"/> Certified Mail® <input type="checkbox"/> Priority Mail Express™ <input type="checkbox"/> Registered <input type="checkbox"/> Return Receipt for Merchandise <input type="checkbox"/> Insured Mail <input type="checkbox"/> Collect on Delivery	
PS Form 3811, July 2013		4. Restricted Delivery? (Extra Fee) <input type="checkbox"/> Yes	

7013 3020 0000 4636 9671

Domestic Return Receipt

AL SWD

Affidavit of Publication

State of New Mexico,
County of Eddy, ss.

Kathy McCarroll, being first duly
sworn, on oath says:

That she is the Classified Supervisor
of the Carlsbad Current-Argus, a
newspaper published daily at the
City of Carlsbad, in said county of
Eddy, state of New Mexico and of
general paid circulation in said
county; that the same is a duly
qualified newspaper under the laws
of the State wherein legal notices
and advertisements may be
published; that the printed notice
attached hereto was published in the
regular and entire edition of said
newspaper and not in supplement
thereof on the date as follows, to wit:

September 16 2014

That the cost of publication is **\$75.40**
and that payment thereof has been
made and will be assessed as court
costs.

Kathy McCarroll

Subscribed and sworn to before me
this 17 day of September
2014

Cynthia Arredondo

My commission Expires
2/13/17

Notary Public

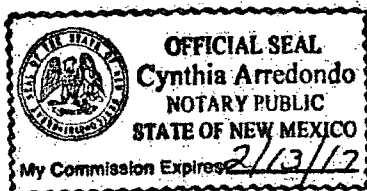

September 16, 2014

NOTICE

Mewbourne Oil Company has filed an application with the New Mexico Oil Conservation Division seeking approval to re-enter and deepen the State Com. Well No. 1, to be re-named the Rio Bravo SWD Well No. 1, located 1980 feet from the north line and 1980 feet from the east line (the SW/4NE/4) of Section 15, Township 21 South, Range 25 East, NMPM, Eddy County, New Mexico, and dispose of produced water into the Devonian formation at depths of 11300-12800 feet subsurface. The expected maximum injection rate is 20000 BWPD, and the maximum injection pressure is 2260 psi. If you object to the application you must file a written objection or request for hearing with the Division within 15 days of the date this notice is published. The Division's address is 1220 South St. Francis Drive, Santa Fe, New Mexico 87505. Failure to object will preclude you from contesting this matter at a later date. The name and address of the contact party for applicant is Corey Mitchell, Mewbourne Oil Company, Suite 1020, 500 West Texas, Midland, Texas 79701, (432) 682-3715. The well is located approximately 10 miles south of Lakewood, New Mexico.