

Excavation Data

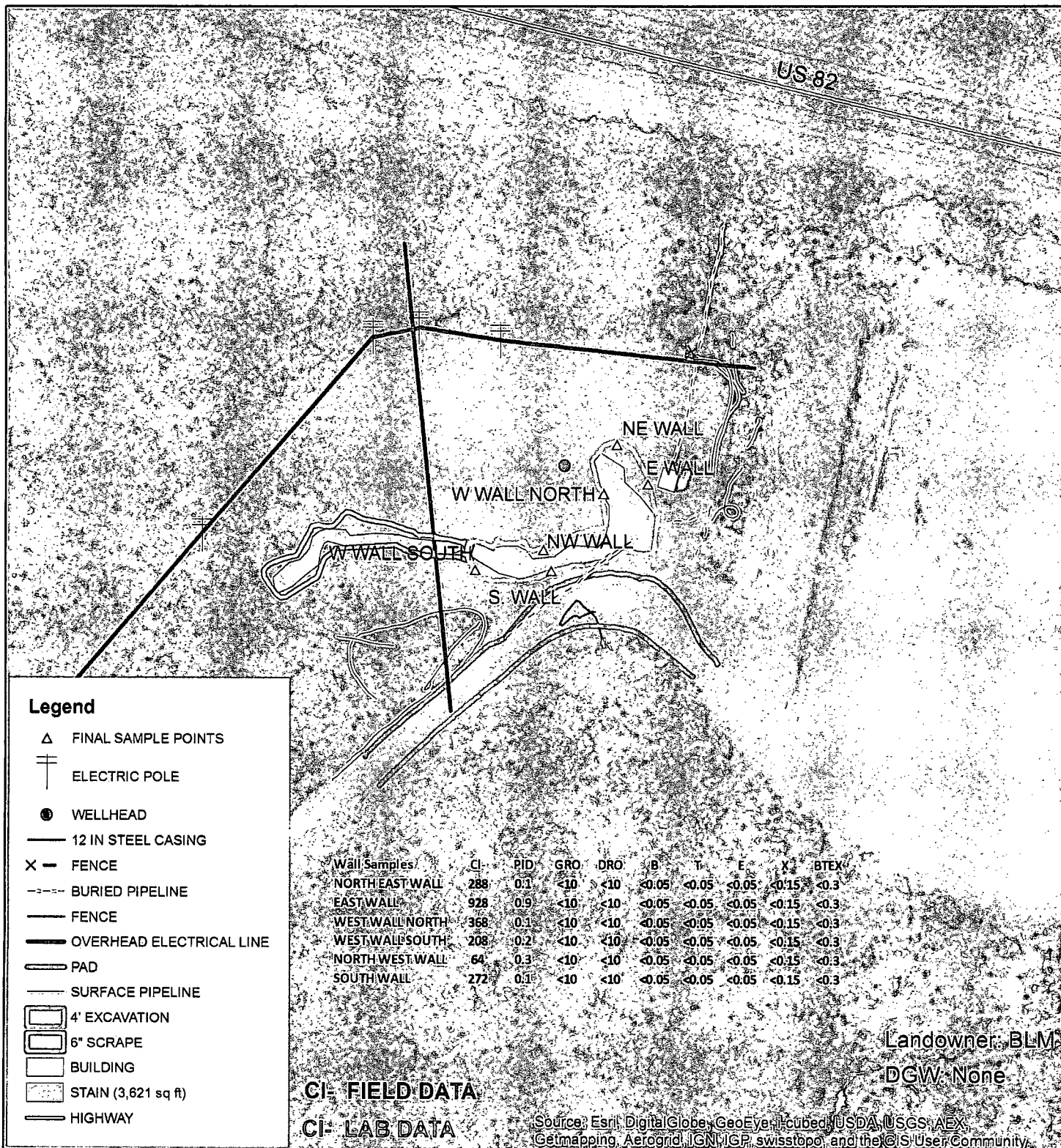

**LINN MAX FRIESS &
FREN SUPPLY LINE
(2RP-2033)**

**LEGALS: UL/L sec. 20
T-17-S R-31-E
EDDY COUNTY, NM**

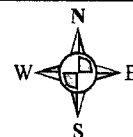

0 50 100
Feet

GPS date: 1/9/14, 1/10/14 JB
Drawing date: 1/14/14
Drafted by: T. Grieco