

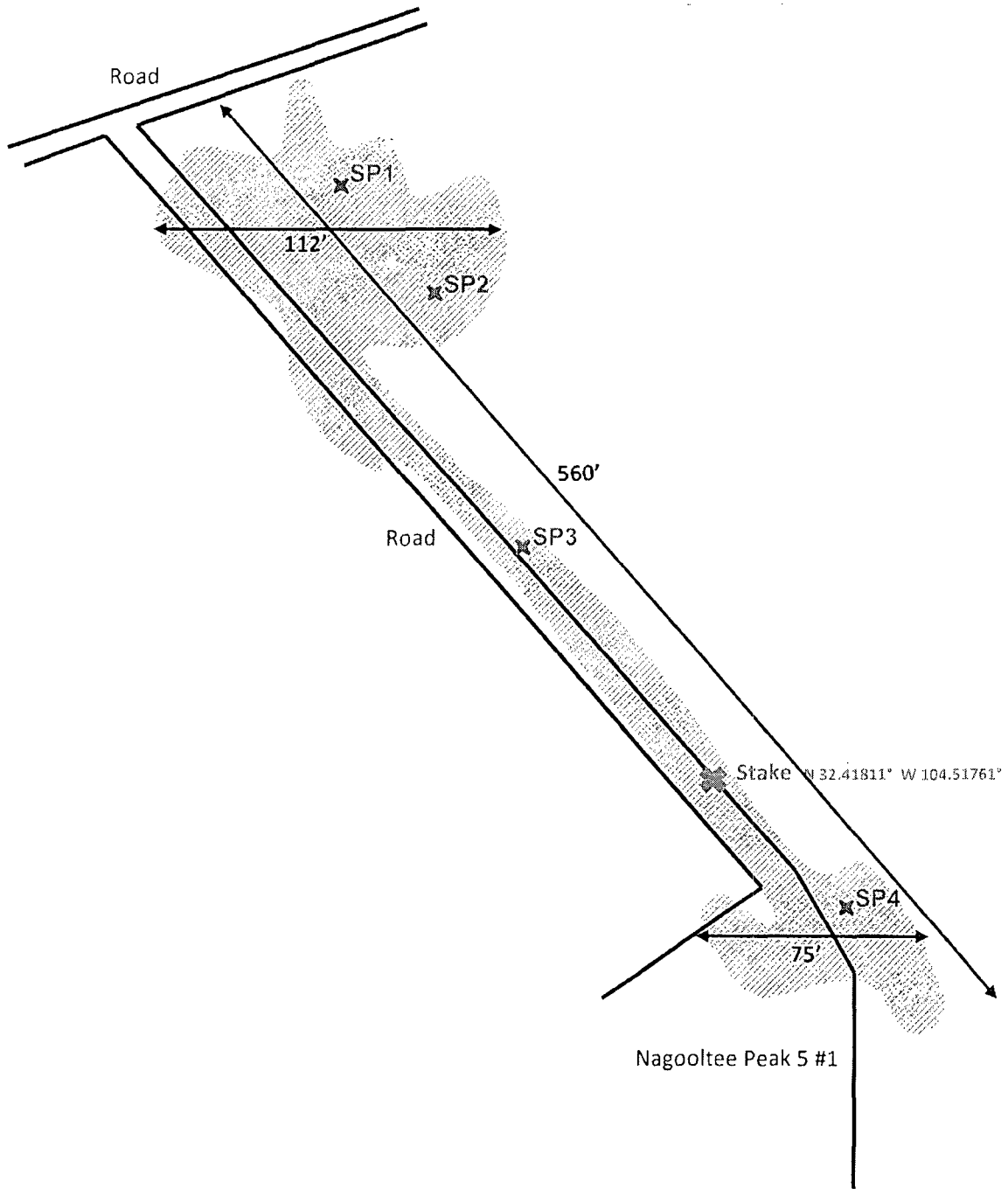

Oxy

Jones Canyon 4-4 (12/13/12)



U/L E, Section 4, T22S, R24E
2714' FNL and 217' FWL
Eddy County, NM

BBC International, Inc.

Oxy

Jones Canyon 4-4 (12/13/12)

Date: 01/18/13

DRWG by: K. Purvis

NOT TO SCALE

File: Oxy 2013

Groundwater Plot

Oxy Jones Canyon 4-4

County
Eddy

Unit Letter
E

Section
4

Township
22S

Range
24E

Trend Map 50'

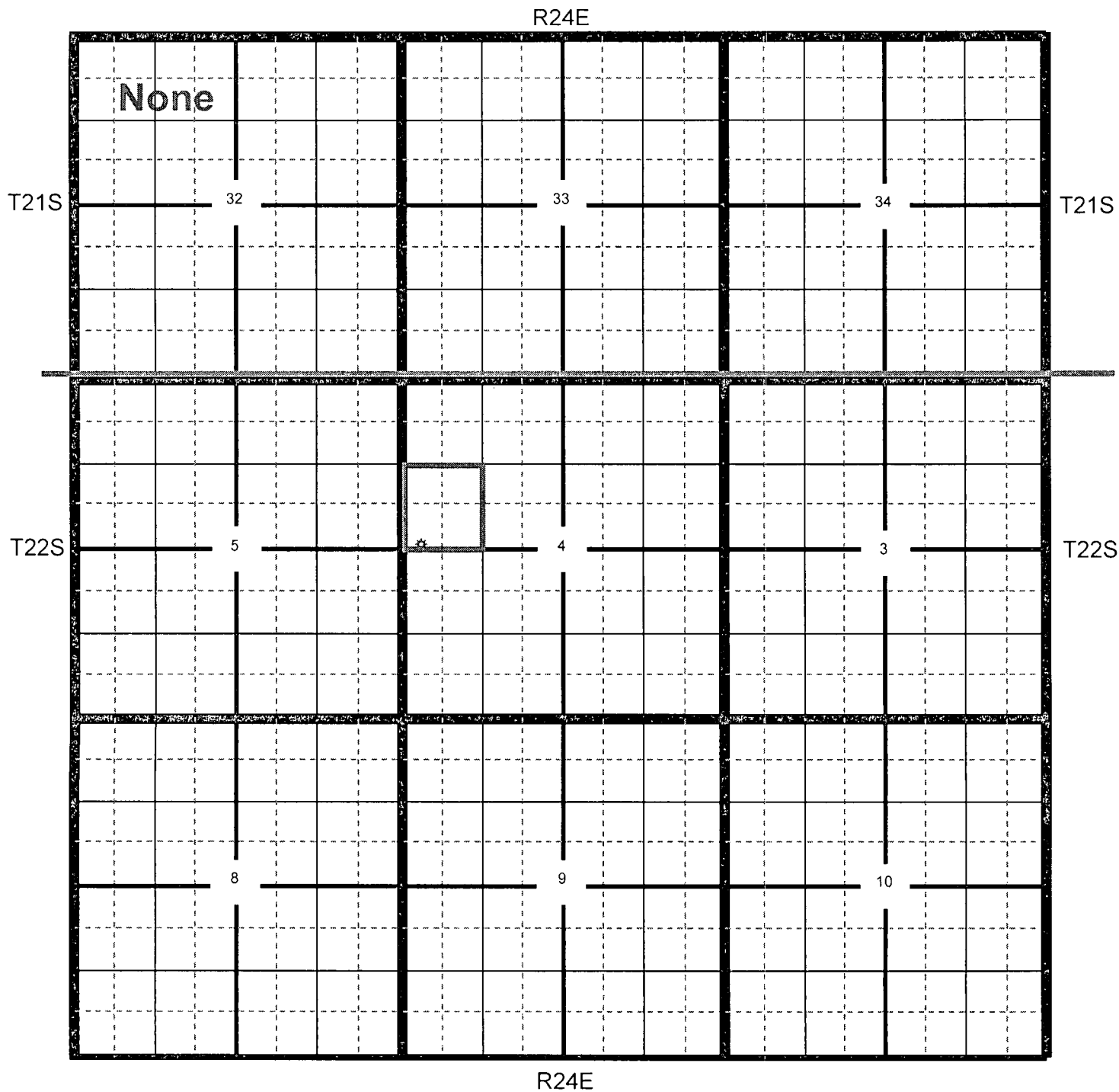

★ Location

● OCD

● USGS

● SEO

● All Databases

Section Quarters

Oxy Jones Canyon 4-4

County
Eddy

Unit Letter
E

Section
4

Township
22S

Range
24E

Trend Map 50'

1

2

NW/NW None	NE/NW	NW/NE	NE/NE
Unit Letter D	Unit Letter C	Unit Letter B	Unit Letter A
SW/NW 	SE/NW	SW/NE	SE/NE
Unit Letter F	Unit Letter F	Unit Letter G	Unit Letter H
NW/SW	NE/SW	NW/SE	NE/SE
Unit Letter L	Unit Letter K	Unit Letter J	Unit Letter I
SW/SW	SE/SW	SW/SE	SE/SE
Unit Letter M	Unit Letter N	Unit Letter O	Unit Letter P

3

4

 Location

 OCD

 USGS

 SEO

 All Databases

**Laboratory Analytical Results Summary
Jones Canyon 4 Fed #4**

		Sample	SP1 @ Surface	SP1 @ 6"
Analyte	Method	Date	2/7/13	2/7/13
			mg/Kg	mg/Kg
Chloride	SM4500CI-B		800	464

		Sample	SP2 @ Surface	SP2 @ 6"
Analyte	Method	Date	2/7/13	2/7/13
			mg/Kg	mg/Kg
Benzene	BTEX 8021B		n/a	<0.050
Toluene	BTEX 8021B		n/a	<0.050
Ethylbenzene	BTEX 8021B		n/a	<0.050
Total Xylenes	BTEX 8021B		n/a	<0.150
Total BTEX	BTEX 8021B		n/a	<0.300
Chloride	SM4500CI-B		2920	640
GRO	TPH 8015M		n/a	<10.0
DRO	TPH 8015M		n/a	<10.0

		Sample	SP3 @ Surface	SP3 @ 6"
Analyte	Method	Date	2/7/13	2/7/13
			mg/Kg	mg/Kg
Chloride	SM4500CI-B		800	480

		Sample	SP4 @ Surface	SP4 @ 6"
Analyte	Method	Date	2/7/13	2/7/13
			mg/Kg	mg/Kg
Benzene	BTEX 8021B		n/a	<0.050
Toluene	BTEX 8021B		n/a	<0.050
Ethylbenzene	BTEX 8021B		n/a	<0.050
Total Xylenes	BTEX 8021B		n/a	<0.150
Total BTEX	BTEX 8021B		n/a	<0.300
Chloride	SM4500CI-B		48	768
GRO	TPH 8015M		n/a	<10.0
DRO	TPH 8015M		n/a	<10.0



PHONE (575) 393-2326 ° 101 E. MARLAND ° HOBBS, NM 88240

February 15, 2013

Cliff Brunson

BBC International, Inc.

P.O. Box 805

Hobbs, NM 88241

RE: JONES CANYON 4-4

Enclosed are the results of analyses for samples received by the laboratory on 02/08/13 12:00.

Cardinal Laboratories is accredited through Texas NELAP under certificate number T104704398-11-3. Accreditation applies to drinking water, non-potable water and solid and chemical materials. All accredited analytes are denoted by an asterisk (*). For a complete list of accredited analytes and matrices visit the TCEQ website at www.tceq.texas.gov/field/qa/lab_accred_certif.html.

Cardinal Laboratories is accredited through the State of Colorado Department of Public Health and Environment for:

Method EPA 552.2	Haloacetic Acids (HAA-5)
Method EPA 524.2	Total Trihalomethanes (TTHM)
Method EPA 524.4	Regulated VOCs (V1, V2, V3)

Accreditation applies to public drinking water matrices.

This report meets NELAP requirements and is made up of a cover page, analytical results, and a copy of the original chain-of-custody. If you have any questions concerning this report, please feel free to contact me.

Sincerely,

A handwritten signature in black ink that reads "Coley D. Keene". The signature is written in a cursive, flowing style.

Celey D. Keene

Lab Director/Quality Manager

Analytical Results For:

 BBC International, Inc.
 Cliff Brunson
 P.O. Box 805
 Hobbs NM, 88241
 Fax To: (575) 397-0397

Received:	02/08/2013	Sampling Date:	02/07/2013
Reported:	02/15/2013	Sampling Type:	Soil
Project Name:	JONES CANYON 4-4	Sampling Condition:	Cool & Intact
Project Number:	NONE GIVEN	Sample Received By:	Jodi Henson
Project Location:	NOT GIVEN		

Sample ID: SP 1 @ SURFACE (H300367-01)

Chloride, SM4500CI-B		mg/kg		Analyzed By: DW					
Analyte	Result	Reporting Limit	Analyzed	Method Blank	BS	% Recovery	True Value QC	RPD	Qualifier
Chloride	800	16.0	02/13/2013	ND	432	108	400	3.77	

Sample ID: SP 1 @ 6" (H300367-02)

Chloride, SM4500CI-B		mg/kg		Analyzed By: DW					
Analyte	Result	Reporting Limit	Analyzed	Method Blank	BS	% Recovery	True Value QC	RPD	Qualifier
Chloride	464	16.0	02/13/2013	ND	432	108	400	3.77	

Sample ID: SP 2 @ SURFACE (H300367-03)

Chloride, SM4500CI-B		mg/kg		Analyzed By: DW					
Analyte	Result	Reporting Limit	Analyzed	Method Blank	BS	% Recovery	True Value QC	RPD	Qualifier
Chloride	2920	16.0	02/13/2013	ND	432	108	400	3.77	

Cardinal Laboratories

* = Accredited Analyte

PLEASE NOTE: Liability and Damages. Cardinal's liability and client's exclusive remedy for any claim arising, whether based in contract or tort, shall be limited to the amount paid by client for analyses. All claims, including those for negligence and any other cause whatsoever shall be deemed waived unless made in writing and received by Cardinal within thirty (30) days after completion of the applicable service. In no event shall Cardinal be liable for incidental or consequential damages, including, without limitation, business interruptions, loss of use, or loss of profits incurred by client, its subsidiaries, affiliates or successors arising out of or related to the performance of the services hereunder by Cardinal, regardless of whether such claim is based upon any of the above stated reasons or otherwise. Results relate only to the samples identified above. This report shall not be reproduced except in full with written approval of Cardinal Laboratories.



Celey D. Keene, Lab Director/Quality Manager

Analytical Results For:

BBC International, Inc.
Cliff Brunson
P.O. Box 805
Hobbs NM, 88241
Fax To: (575) 397-0397

Received:	02/08/2013	Sampling Date:	02/07/2013
Reported:	02/15/2013	Sampling Type:	Soil
Project Name:	JONES CANYON 4-4	Sampling Condition:	Cool & Intact
Project Number:	NONE GIVEN	Sample Received By:	Jodi Henson
Project Location:	NOT GIVEN		

Sample ID: SP 2 @ 6" (H300367-04)

BTEX 8021B		mg/kg		Analyzed By: AP					
Analyte	Result	Reporting Limit	Analyzed	Method Blank	BS	% Recovery	True Value QC	RPD	Qualifier
Benzene*	<0.050	0.050	02/13/2013	ND	2.46	123	2.00	8.61	
Toluene*	<0.050	0.050	02/13/2013	ND	2.42	121	2.00	9.04	
Ethylbenzene*	<0.050	0.050	02/13/2013	ND	2.39	119	2.00	8.61	
Total Xylenes*	<0.150	0.150	02/13/2013	ND	7.26	121	6.00	8.88	
Total BTEX	<0.300	0.300	02/13/2013	ND					

Surrogate: 4-Bromofluorobenzene (PIE) 107 % 89.4-126

Chloride, SM4500Cl-B		mg/kg		Analyzed By: DW					
Analyte	Result	Reporting Limit	Analyzed	Method Blank	BS	% Recovery	True Value QC	RPD	Qualifier
Chloride	640	16.0	02/13/2013	ND	432	108	400	3.77	
TPH 8015M		mg/kg		Analyzed By: MS					
Analyte	Result	Reporting Limit	Analyzed	Method Blank	BS	% Recovery	True Value QC	RPD	Qualifier
GRO C6-C10	<10.0	10.0	02/11/2013	ND	197	98.5	200	12.1	
DRO >C10-C28	<10.0	10.0	02/11/2013	ND	182	90.8	200	16.2	

Surrogate: 1-Chlorooctane 75.1 % 65.2-140

Surrogate: 1-Chlorooctadecane 93.9 % 63.6-154

Sample ID: SP 3 @ SURFACE (H300367-05)

Chloride, SM4500Cl-B		mg/kg		Analyzed By: DW					
Analyte	Result	Reporting Limit	Analyzed	Method Blank	BS	% Recovery	True Value QC	RPD	Qualifier
Chloride	800	16.0	02/13/2013	ND	432	108	400	3.77	

Cardinal Laboratories

*=Accredited Analyte

PLEASE NOTE: Liability and Damages. Cardinal's liability and client's exclusive remedy for any claim arising, whether based in contract or tort, shall be limited to the amount paid by client for analyses. All claims, including those for negligence and any other cause whatsoever shall be deemed waived unless made in writing and received by Cardinal within thirty (30) days after completion of the applicable service. In no event shall Cardinal be liable for incidental or consequential damages, including, without limitation, business interruptions, loss of use, or loss of profits incurred by client, its subsidiaries, affiliates or successors arising out of or related to the performance of the services hereunder by Cardinal, regardless of whether such claim is based upon any of the above stated reasons or otherwise. Results relate only to the samples identified above. This report shall not be reproduced except in full with written approval of Cardinal Laboratories.

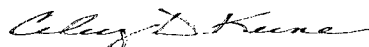

Celey D. Keene, Lab Director/Quality Manager

Analytical Results For:

BBC International, Inc.
Cliff Brunson
P.O. Box 805
Hobbs NM, 88241
Fax To: (575) 397-0397

Received: 02/08/2013
Reported: 02/15/2013
Project Name: JONES CANYON 4-4
Project Number: NONE GIVEN
Project Location: NOT GIVEN

Sampling Date: 02/07/2013
Sampling Type: Soil
Sampling Condition: Cool & Intact
Sample Received By: Jodi Henson

Sample ID: SP 3 @ 6" (H300367-06)

Chloride, SM4500CI-B		mg/kg		Analyzed By: DW					
Analyte	Result	Reporting Limit	Analyzed	Method Blank	BS	% Recovery	True Value QC	RPD	Qualifier
Chloride	480	16.0	02/13/2013	ND	432	108	400	3.77	

Sample ID: SP 4 @ SURFACE (H300367-07)

Chloride, SM4500CI-B		mg/kg		Analyzed By: DW					
Analyte	Result	Reporting Limit	Analyzed	Method Blank	BS	% Recovery	True Value QC	RPD	Qualifier
Chloride	48.0	16.0	02/13/2013	ND	432	108	400	3.77	

Cardinal Laboratories

*=Accredited Analyte

PLEASE NOTE: Liability and Damages. Cardinal's liability and client's exclusive remedy for any claim arising, whether based in contract or tort, shall be limited to the amount paid by client for analyses. All claims, including those for negligence and any other cause whatsoever shall be deemed waived unless made in writing and received by Cardinal within thirty (30) days after completion of the applicable service. In no event shall Cardinal be liable for incidental or consequential damages, including, without limitation, business interruptions, loss of use, or loss of profits incurred by client, its subsidiaries, affiliates or successors arising out of or related to the performance of the services hereunder by Cardinal, regardless of whether such claim is based upon any of the above stated reasons or otherwise. Results relate only to the samples identified above. This report shall not be reproduced except in full with written approval of Cardinal Laboratories.



Celey D. Keene, Lab Director/Quality Manager

Analytical Results For:

BBC International, Inc.
Cliff Brunson
P.O. Box 805
Hobbs NM, 88241
Fax To: (575) 397-0397

Received: 02/08/2013
Reported: 02/15/2013
Project Name: JONES CANYON 4-4
Project Number: NONE GIVEN
Project Location: NOT GIVEN

Sampling Date: 02/07/2013
Sampling Type: Soil
Sampling Condition: Cool & Intact
Sample Received By: Jodi Henson

Sample ID: SP 4 @ 6" (H300367-08)

BTEX 8021B		mg/kg		Analyzed By: AP					
Analyte	Result	Reporting Limit	Analyzed	Method Blank	BS	% Recovery	True Value QC	RPD	Qualifier
Benzene*	<0.050	0.050	02/13/2013	ND	2.46	123	2.00	8.61	
Toluene*	<0.050	0.050	02/13/2013	ND	2.42	121	2.00	9.04	
Ethylbenzene*	<0.050	0.050	02/13/2013	ND	2.39	119	2.00	8.61	
Total Xylenes*	<0.150	0.150	02/13/2013	ND	7.26	121	6.00	8.88	
Total BTEX	<0.300	0.300	02/13/2013	ND					

Surrogate: 4-Bromofluorobenzene (PIE) 107 % 89.4-126

Chloride, SM4500Cl-B		mg/kg		Analyzed By: DW					
Analyte	Result	Reporting Limit	Analyzed	Method Blank	BS	% Recovery	True Value QC	RPD	Qualifier
Chloride	768	16.0	02/13/2013	ND	432	108	400	3.77	

TPH 8015M		mg/kg		Analyzed By: MS					
Analyte	Result	Reporting Limit	Analyzed	Method Blank	BS	% Recovery	True Value QC	RPD	Qualifier
GRO C6-C10	<10.0	10.0	02/11/2013	ND	197	98.5	200	12.1	
DRO >C10-C28	<10.0	10.0	02/11/2013	ND	182	90.8	200	16.2	

Surrogate: 1-Chlorooctane 71.4 % 65.2-140

Surrogate: 1-Chlorooctadecane 88.7 % 63.6-154

Cardinal Laboratories

*=Accredited Analyte

PLEASE NOTE: Liability and Damages. Cardinal's liability and client's exclusive remedy for any claim arising, whether based in contract or tort, shall be limited to the amount paid by client for analyses. All claims, including those for negligence and any other cause whatsoever shall be deemed waived unless made in writing and received by Cardinal within thirty (30) days after completion of the applicable service. In no event shall Cardinal be liable for incidental or consequential damages, including, without limitation, business interruptions, loss of use, or loss of profits incurred by client, its subsidiaries, affiliates or successors arising out of or related to the performance of the services hereunder by Cardinal, regardless of whether such claim is based upon any of the above stated reasons or otherwise. Results relate only to the samples identified above. This report shall not be reproduced except in full with written approval of Cardinal Laboratories.



Celey D. Keene, Lab Director/Quality Manager

Notes and Definitions

ND	Analyte NOT DETECTED at or above the reporting limit
RPD	Relative Percent Difference
**	Samples not received at proper temperature of 6°C or below.
***	Insufficient time to reach temperature.
-	Chloride by SM4500Cl-B does not require samples be received at or below 6°C Samples reported on an as received basis (wet) unless otherwise noted on report

Cardinal Laboratories

*=Accredited Analyte

PLEASE NOTE: Liability and Damages. Cardinal's liability and client's exclusive remedy for any claim arising, whether based in contract or tort, shall be limited to the amount paid by client for analyses. All claims, including those for negligence and any other cause whatsoever shall be deemed waived unless made in writing and received by Cardinal within thirty (30) days after completion of the applicable service. In no event shall Cardinal be liable for incidental or consequential damages, including, without limitation, business interruptions, loss of use, or loss of profits incurred by client, its subsidiaries, affiliates or successors arising out of or related to the performance of the services hereunder by Cardinal, regardless of whether such claim is based upon any of the above stated reasons or otherwise. Results relate only to the samples identified above. This report shall not be reproduced except in full with written approval of Cardinal Laboratories.

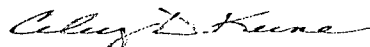

Celey D. Keene, Lab Director/Quality Manager



CARDINAL LABORATORIES

101 East Marland, Hobbs, NM 88240

(505) 393-2326 FAX (505) 393-2476

CHAIN-OF-CUSTODY AND ANALYSIS REQUEST

Company Name: BBC International, Inc.				BILL TO				ANALYSIS REQUEST																			
Project Manager: Cliff Brunson				P.O. #:																							
Address: P.O. Box 805				Company:																							
City: Hobbs State: NM Zip: 88241				Attn: <i>SAMIE</i>																							
Phone #: 575-397-6388 Fax #: 575-397-0397				Address:																							
Project #: Project Owner: <i>OK</i>				City:																							
Project Name: <i>JONES CAMPUS 4-4</i>				State: Zip:																							
Project Location:				Phone #:																							
Sampler Name: <i>FRANCIS LAMMEZ</i>				Fax #:																							
FOR LAB USE ONLY				MATRIX		PRESERV.		SAMPLING																			
Lab I.D.	Sample I.D.	(GRAB OR C)OMP.	# CONTAINERS	GROUNDWATER	WASTEWATER	SOIL	OIL	SLUDGE	OTHER	ACID/BASE	ICE / COOL	OTHER	DATE	TIME													
<i>H300367</i>																											
1	<i>SP 12 SURFACE</i>																										
2	<i>" " "</i>																										
3	<i>SP 20 SURFACE</i>																										
4	<i>" " "</i>																										
5	<i>SP 15 SURFACE</i>																										
6	<i>" " "</i>																										
7	<i>SP 10 SURFACE</i>																										
8	<i>" " "</i>																										

PLEASE NOTE: Liability and Damages: Cardinal's liability and client's exclusive remedy for any claim arising whether based in contract or tort, shall be limited to the amount paid by the client for the analyses. All claims, including those for negligence and any other cause whatsoever shall be deemed waived unless made in writing and received by Cardinal within 30 days after completion of the applicable service. In no event shall Cardinal be liable for incidental or consequential damages, including without limitation, business interruptions, loss of use or loss of profits incurred by client, its subsidiaries, affiliates or successors arising out of or related to the performance of services hereunder by Cardinal, regardless of whether such claim is based upon any of the above stated reasons or otherwise.

Relinquished By: <i>Francis Lamme</i>	Date: <i>11/13</i>	Received By: <i>Isaac Pence</i>	Phone Result: <input type="checkbox"/> Yes <input type="checkbox"/> No	Add'l Phone #:
	Time: <i>1:00</i>		Fax Result: <input type="checkbox"/> Yes <input type="checkbox"/> No	Add'l Fax #:
Relinquished By: <i>Isaac Pence</i>	Date: <i>11/13</i>	Received By: <i>Isaac Pence</i>	REMARKS:	
	Time: <i>1:00</i>			
Delivered By: (Circle One)	Sample Condition	CHECKED BY: (Initials)		
Sampler - UPS - Bus - Other:	Cool / Intact <input checked="" type="checkbox"/> Yes <input type="checkbox"/> No	<i>Isaac Pence</i>		

† Cardinal cannot accept verbal changes. Please fax written changes to 505-393-2476

26

District I
1625 N. French Dr., Hobbs, NM 88240
District II
1301 W. Grand Avenue, Artesia, NM 88210
District III
1000 Rio Brazos Road, Aztec, NM 87410
District IV
1220 S. St. Francis Dr., Santa Fe, NM 87505

State of New Mexico
Energy Minerals and Natural Resources

Oil Conservation Division
1220 South St. Francis Dr.
Santa Fe, NM 87505

Form C-141
Revised October 10, 2003

Submit 2 Copies to appropriate
District Office in accordance
with Rule 116 on back
side of form

Release Notification and Corrective Action

OPERATOR

☒ Initial Report ☐ Final Report

Name of Company	Oxy Permian Ltd.	Contact	Christopher Jones
Address	1502 W. Commerce Dr., Carlsbad, NM	Telephone No.	(575) 628-4121
Facility Name	Jones Canyon 4 Federal #4	Facility Type	
Surface Owner	Mineral Owner	Lease No.	API#30-015-30487

LOCATION OF RELEASE

Unit Letter	Section	Township	Range	Feet from the	North/South Line	Feet from the	East/West Line	County
E	4	22S	24E					Eddy County, NM

Latitude _____ Longitude _____

NATURE OF RELEASE

Type of Release	Produced water	Volume of Release	500 bbls	Volume Recovered	50 bbls
Source of Release	Failure in 2" steel production line	Date and Hour of Occurrence	12/13/2012	Date and Hour of Discovery	
Was Immediate Notice Given?	<input checked="" type="checkbox"/> Yes <input type="checkbox"/> No <input type="checkbox"/> Not Required	If YES, To Whom?	Mike Bratcher- OCD, James Amos-BLM, Terry Gregston-BLM		
By Whom?	Christopher Jones	Date and Hour	12/13/2012 @ 11:20am		
Was a Watercourse Reached?	<input type="checkbox"/> Yes <input checked="" type="checkbox"/> No	If YES, Volume Impacting the Watercourse.			
If a Watercourse was Impacted, Describe Fully.*					
Describe Cause of Problem and Remedial Action Taken.* Failure in a 2" steel production line caused 500 bbls of produced water to leak onto the ground. 50 bbls of produced water were recovered via vacuum truck.					
Describe Area Affected and Cleanup Action Taken.* Failure in a 2" steel production line caused 500 bbls of produced water to leak onto the ground. 50 bbls of produced water were recovered via vacuum truck. Remediation will be performed in accordance with an OCD-approved remediation plan.					
I hereby certify that the information given above is true and complete to the best of my knowledge and understand that pursuant to NMOC rules and regulations all operators are required to report and/or file certain release notifications and perform corrective actions for releases which may endanger public health or the environment. The acceptance of a C-141 report by the NMOC marked as "Final Report" does not relieve the operator of liability should their operations have failed to adequately investigate and remediate contamination that pose a threat to ground water, surface water, human health or the environment. In addition, NMOC acceptance of a C-141 report does not relieve the operator of responsibility for compliance with any other federal, state, or local laws and/or regulations.					
Signature: 		OIL CONSERVATION DIVISION			
Printed Name: Christopher Jones		Approved by District Supervisor:			
Title: HES Specialist		Approval Date:		Expiration Date:	
E-mail Address: Christopher.Jones@oxy.com		Conditions of Approval:		Attached <input type="checkbox"/>	
Date: 1-3-13		Phone: (575) 628-4121			

* Attach Additional Sheets If Necessary