

District I
1625 N. French Dr., Hobbs, NM 88240
District II
811 S. First St., Artesia, NM 88210
District III
1000 Rio Brazos Road, Aztec, NM 87410
District IV
1220 S. St. Francis Dr., Santa Fe, NM 87505

NM OIL CONSERVATION
State of New Mexico ARTESIA DISTRICT
Energy Minerals and Natural Resources
Oil Conservation Division
1220 South St. Francis Dr.
Santa Fe, NM 87505

MAY 04 2015

RECEIVED
Submit 1 Copy to appropriate District Office in accordance with 19.15.29 NMAC.

Form C-141
Revised August 8, 2011

FAB1512628769 Release Notification and Corrective Action

nAB1512628954

310025

OPERATOR

☒ Initial Report

☒ Final Report

Name of Company Western Refining Company, LLC.	Contact Matthew Krakow
Address 111 County RD 4990, Bloomfield, NM 87413	Telephone No. 505-632-8006
Facility Name T-Station	Facility Type Crude oil transmission station

Surface Owner BLM	Mineral Owner	API No.
-------------------	---------------	---------

LOCATION OF RELEASE

Unit Letter	Section 9	Township 26S	Range 30E	Feet from the	North/South Line	Feet from the	East/West Line	County Eddy
-------------	--------------	-----------------	--------------	---------------	------------------	---------------	----------------	----------------

Latitude 32.062707

Longitude -103.881937

NATURE OF RELEASE



Type of Release Crude oil	Volume of Release 50 barrels	Volume Recovered 15 barrels vacuum truck and 35 barrels by excavation
Source of Release Crude oil pipeline	Date and Hour of Occurrence 4/15/15 at approximately 5:00	Date and Hour of Discovery 4/15/15 at 6:08 am
Was Immediate Notice Given? <input checked="" type="checkbox"/> Yes <input type="checkbox"/> No <input type="checkbox"/> Not Required	If YES, To Whom? National Response Center and NMOCD (Mike Bratcher)	
By Whom? Dave Richards (NRC) Matthew Krakow (NMOCD)	Date and Hour 4/15/15 at 8:27am MT to NRC and 4/15/15 at 10:08 am MT to NMOCD	
Was a Watercourse Reached? <input type="checkbox"/> Yes <input checked="" type="checkbox"/> No	If YES, Volume Impacting the Watercourse.	

If a Watercourse was Impacted, Describe Fully.*

Describe Cause of Problem and Remedial Action Taken.* Crude oil overtopped a frac tank during a pipeline fill due to operator error. Once the spill was discovered the pipeline was shut down.

Describe Area Affected and Cleanup Action Taken.* The spill took place adjacent to the pipeline station. Pipeline personnel used shovels to build containment. A vacuum truck was mobilized and recovered 15 barrels of oil and a backhoe was used to excavate the crude impacted soil. Approximately 620 yard of dirt was removed from the site. Eight strategic samples were taken from eight different locations in the spill area. The analytical showed the area cleaned up to NMOCD and BLM standards.

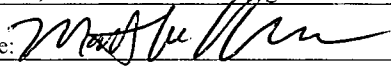
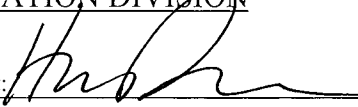
I hereby certify that the information given above is true and complete to the best of my knowledge and understand that pursuant to NMOCD rules and regulations all operators are required to report and/or file certain release notifications and perform corrective actions for releases which may endanger public health or the environment. The acceptance of a C-141 report by the NMOCD marked as "Final Report" does not relieve the operator of liability should their operations have failed to adequately investigate and remediate contamination that pose a threat to ground water, surface water, human health or the environment. In addition, NMOCD acceptance of a C-141 report does not relieve the operator of responsibility for compliance with any other federal, state, or local laws and/or regulations.

Signature: 	OIL CONSERVATION DIVISION	
Printed Name: Matthew Krakow	Approved by Environmental Specialist: 	
Title: Environmental Coordinator	Approval Date: 5/5/15	Expiration Date: N/A
E-mail Address: matt.krakow@wnr.com	Conditions of Approval: 	Attached <input type="checkbox"/>
Date: 4-29-15	Phone: 505-632-4169	

* Attach Additional Sheets If Necessary

iAB1512630107

2RP-2489

**SPILL CLEAN-UP CRITERIA
EVALUATION**



LT Environmental Inc.
2243 Main Avenue, Suite 3
Durango, Colorado 81301
T 970-385-1096

GENERAL INFORMATION

Facility Name:	T-Station
USPLSS:	SEC 9 TWN 26S RNG 30E
Lat/Long:	32.0633, -103.881792

Operator:	Western Refining
Date:	04/06/2015
Prepared by:	Daniel Newman

GENERAL INFORMATION

Geologic Formation: Quaternary Alluvium

Soil Type: Tonuco-Simona pajarito

GENERAL RANKING CRITERIA

Depth to groundwater: > 100 feet

Ranking Score: 0

The nearest water well (C 03483) is located 0.80 miles northwest of the site with a listed static water level of 200 feet below the ground surface.

Within 1,000 feet from a water source, or; <200 feet from private domestic water source: NO

Ranking Score: 0

The site is located approximately 1,790 southeast of the Brushy Draw

Distance to Surface Water Body: > 1000 feet

Ranking Score: 0

A stock pond is located 0.85 miles to the southwest

RECOMMENDED REMEDIATION ACTION LEVEL

Total Ranking Score: 0 to 9

Benzene (ppm): 10

BTEX (ppm): 50

TPH (ppm): 5,000

ADDITIONAL NOTES:

ATTACHED DOCUMENTS:

Figure 1: Topographic Map

Figure 2: Aerial Photograph and Nearby Water Wells
iWaters Data



New Mexico Office of the State Engineer

Wells with Well Log Information

(A CLW##### in the POD suffix indicates the POD has been replaced & no longer serves a water right file.)

(R=POD has been replaced,
O=orphaned,
C=the file is closed)

(quarters are 1=NW 2=NE 3=SW 4=SE)
(quarters are smallest to largest)

(NAD83 UTM in meters)

(in feet)

POD Number	Sub-Code	basin	County	Source	q	q	q	Sec	Tws	Rng	X	Y	Distance	Start Date	Finish Date	Log File Date	Depth Well	Depth Water	Driller	License Number
C 03483	CUB	ED	Shallow	4	4	4	05	26S	30E		604296	3548251	1280	06/03/2011	06/08/2011	07/14/2011	700	200	BEAUREGARD, RICHARD	1509
C 03581 POD1	CUB	ED	Shallow	4	4	4	05	26S	30E		604298	3548291	1287	11/01/2012	11/09/2012	11/13/2012	800	320	SIRMAN, JOHN (LD)	1654
C 01361		ED	Shallow	3	4	3	05	26S	30E		603240	3548157	2316	05/16/1952	06/01/1952	11/17/1953	775	184		95
C 01360	C	ED	Shallow	4	3	3	05	26S	30E		602997	3548152	2559	04/26/1952	05/15/1952	11/17/1953	770	173		95
C 02165	C	ED	Shallow				24	26S	30E		610036	3544121*	5927	05/02/1988	05/02/1988	05/05/1988	440	180	CORKY GLENN	421
C 01777	C	ED	Shallow				08	26S	31E		613245	3547409*	7715	09/09/1977	09/16/1977	09/28/1977	325	300	VAN NOY, W.L.	208
C 01379	C	ED		4	4	3	10	25S	30E		606571	3556355*	8418	01/22/1968	03/20/1968	04/26/1968	400		BARRON, EMMETT	30
C 02038	C	ED	Shallow	3	2	4	26	26S	29E		599204	3541992*	8739	09/01/1982	09/05/1982	09/16/1982	200		CORKY GLENN	421

Record Count: 8

UTMNAD83 Radius Search (in meters):

Easting (X): 605551.9

Northing (Y): 3547998.3

Radius: 10000

*UTM location was derived from PLSS - see Help

The data is furnished by the NMOSE/ISC and is accepted by the recipient with the expressed understanding that the OSE/ISC make no warranties, expressed or implied, concerning the accuracy, completeness, reliability, usability, or suitability for any particular purpose of the data.

4/6/15 4:07 PM

Page 1 of 1

WELLS WITH WELL LOG INFORMATION

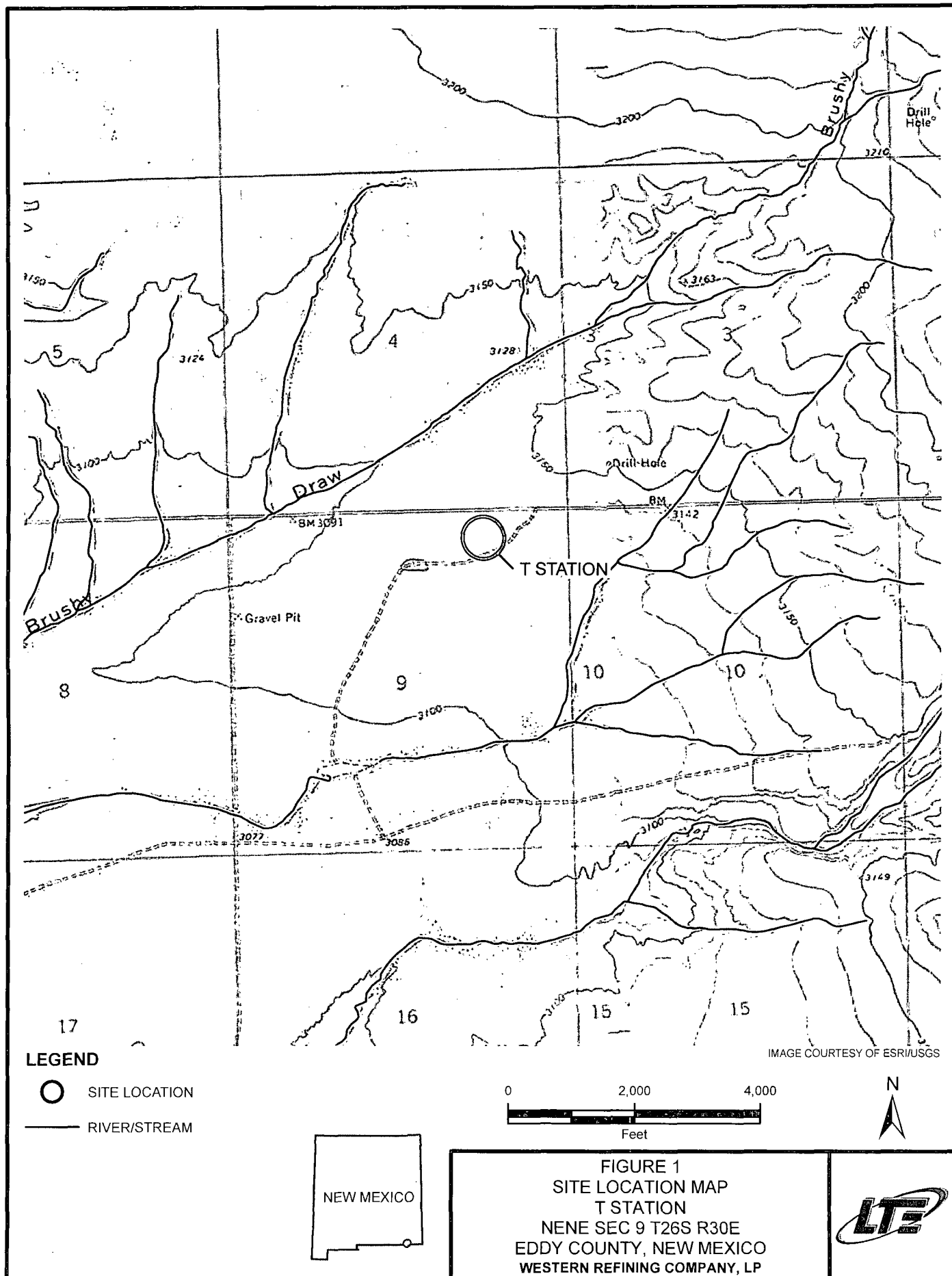

Table 1
Western Refining
T-Station Spill
Eddy County, New Mexico

Sample ID	Sample Date	Soil Status		TPH (mg/kg)			Benzene (mg/kg)	Toluene (mg/kg)	Ethlybenzene (mg/kg)	Xylene (mg/kg)	Total BTEX (mg/kg)
		In-Situ	Removed	GRO	DRO	Total					
Sample Point 1	4/17/2015	X		<10.0	<10.0	<10.0	<0.050	0.069	<0.050	<0.150	<0.300
Sample Point 2	4/17/2015	X		<10.0	<10.0	<10.0	<0.050	<0.050	<0.050	<0.150	<0.300
Sample Point 3	4/17/2015	X		<10.0	<10.0	<10.0	<0.050	<0.050	<0.050	<0.150	<0.300
Sample Point 4	4/17/2015	X		<10.0	<10.0	<10.0	<0.050	<0.050	<0.050	<0.150	<0.300
Sample Point 5	4/17/2015	X		<10.0	<10.0	<10.0	<0.050	<0.050	<0.050	<0.150	<0.300
Sample Point 6	4/17/2015	X		<10.0	<10.0	<10.0	<0.050	<0.050	<0.050	<0.150	<0.300
Sample Point 7	4/17/2015	X		<10.0	<10.0	<10.0	<0.050	<0.050	<0.050	<0.150	<0.300
Sample Point 8	4/17/2015	X		<10.0	<10.0	<10.0	<0.050	<0.050	<0.050	<0.150	<0.300