

DATE IN 4/13/2015	SUSPENSE	ENGINEER WAM	LOGGED IN 4/13/2015	TYPE NSL	APP NO. DMA151035201
----------------------	----------	-----------------	------------------------	-------------	-------------------------

ABOVE THIS LINE FOR DIVISION USE ONLY

NEW MEXICO OIL CONSERVATION DIVISION

- Engineering Bureau -

1220 South St. Francis Drive, Santa Fe, NM 87505



ADMINISTRATIVE APPLICATION CHECKLIST

THIS CHECKLIST IS MANDATORY FOR ALL ADMINISTRATIVE APPLICATIONS FOR EXCEPTIONS TO DIVISION RULES AND REGULATIONS WHICH REQUIRE PROCESSING AT THE DIVISION LEVEL IN SANTA FE

Application Acronyms:

[NSL-Non-Standard Location] **[NSP-Non-Standard Proration Unit]** **[SD-Simultaneous Dedication]**
[DHC-Downhole Commingling] **[CTB-Lease Commingling]** **[PLC-Pool/Lease Commingling]**
[PC-Pool Commingling] **[OLS - Off-Lease Storage]** **[OLM-Off-Lease Measurement]**
[WFX-Waterflood Expansion] **[PMX-Pressure Maintenance Expansion]**
[SWD-Salt Water Disposal] **[IPI-Injection Pressure Increase]**
[EOR-Qualified Enhanced Oil Recovery Certification] **[PPR-Positive Production Response]**

[1] TYPE OF APPLICATION - Check Those Which Apply for [A]

[A] Location - Spacing Unit - Simultaneous Dedication
 X NSL ☐ NSP ☐ SD

Check One Only for [B] or [C]

[B] Commingling - Storage - Measurement
☐ DHC ☐ CTB ☐ PLC ☐ PC ☐ OLS ☐ OLM

[C] Injection - Disposal - Pressure Increase - Enhanced Oil Recovery
☐ WFX ☐ PMX ☐ SWD ☐ IPI ☐ EOR ☐ PPR

[D] Other: Specify _____

[2] NOTIFICATION REQUIRED TO: - Check Those Which Apply, or Does Not Apply

[A] ☒ Working, Royalty or Overriding Royalty Interest Owners

[B] ☒ Offset Operators, Leaseholders or Surface Owner

[C] ☐ Application is One Which Requires Published Legal Notice

[D] ☒ Notification and/or Concurrent Approval by BLM or SLO
 U.S. Bureau of Land Management - Commissioner of Public Lands, State Land Office

[E] ☒ For all of the above, Proof of Notification or Publication is Attached, and/or,

[F] ☐ Waivers are Attached

[3] SUBMIT ACCURATE AND COMPLETE INFORMATION REQUIRED TO PROCESS THE TYPE OF APPLICATION INDICATED ABOVE.

[4] **CERTIFICATION:** I hereby certify that the information submitted with this application for administrative approval is **accurate** and **complete** to the best of my knowledge. I also understand that **no action** will be taken on this application until the required information and notifications are submitted to the Division.

Note: Statement must be completed by an individual with managerial and/or supervisory capacity.

Brian Wood

Print or Type Name

Signature

Consultant

Title

brian@permitswest.com

e-mail Address

4-13-15

Date

NSL 7271

Apache Corporation's 873
 Outlaw State 11
 30-015-42561

2015 APR 13 P 2:30

RECEIVED OGD

POW
 -Antesina Giloureta-yes
 96830

**REQUEST FOR ADMINISTRATIVE APPROVAL
APACHE CORPORATION'S
OUTLAW STATE 11
30-015-42561
2310' FSL & 1775' FEL
SECTION 29, T. 17 S., R. 28 E., EDDY COUNTY, NM**

I. This proposed oil well is on State surface and a State oil and gas lease in a smaller than standard section (below). The well is nonstandard (26' too far north) for the Artesia; Glorieta-Yeso Pool (96830) due to COG's State B Gas Com 1 (30-015-01611) well pad on the south (see EXHIBIT A). That Empire; Penn (Gas) well pad is 18' higher than the Outlaw State 11. Apache requests a nonstandard location due to land uses. A standard location would undercut another company's well pad. In addition, there are 4 rights-of-way (2 Frontier, 1 DCP (southeast of Apache's pad), & 1 LRE), 3 proposed Apache wells (all Artesia; Glorieta-Yeso), 2 roads, and COG's pipeline north of its well in the quarter-quarter.

A standard location must be $\geq 330'$ from the boundary of the quarter-quarter according to Order R-8539 et al. In this case, it is 304' from the north side of unit letter J. (The east side of Section 29 is shorter than normal. Length of the east side of Section 29 is 5,195.52'.)

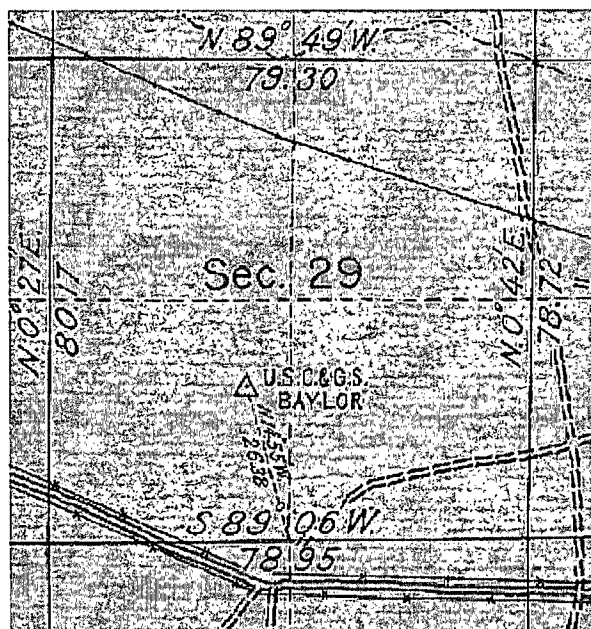

II. Form C-102 showing the well and 40-acre dedication is attached as Exhibit B. The well is 26' too far north.

III. Lease boundaries are shown on EXHIBIT C. The well encroaches to the north, northeast, and east. Artesia; Glorieta-Yeso dedications exist in unit letter J of Section 29 and 7 bordering or cornering quarter-quarters. Unit letter H of Section 29 does not have a Yeso well. See Exhibit D. This information is current and correct.

IV. Archaeology is not an issue.

V. Surface issues (COG well pad, COG pipeline, and DCP pipeline) and the need to prevent waste and recover additional reserves drive the need for this nonstandard location.

VI. Apache does not believe directional drilling to a standard location is cost effective for this well. It has already been moved once from an even more nonstandard location (2310 FSL & 1535 FEL).

VII. I hereby attest that I, on or before the date that the application was submitted to the division, sent notification to the affected persons (see EXHIBIT E) by certified mail, return receipt requested, advising them that if they have an objection it must be filed in writing within 20 days from the date the division receives the application. These affected persons have working or royalty interests in quarter-quarters that border the 40-acre spacing unit. Said notice was sent to:

Benton, Greg
BLM
Chisos Ltd.
Clayton WilliamsEnergy
Cunningham, Mickey
EGL Resources
Henen, Mark
Kennedy, John
Latham Family Trust
LRE Operating, LLC
NM State Land Office
Oxy Permian Ltd.
Pollard, Mike

Riggs, Melvin
Swerc, Matt
Thomas, Robert
Tisdale, Mark

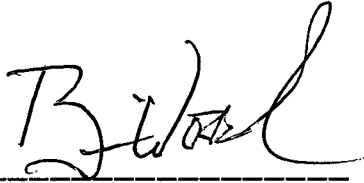

Brian Wood, Consultant

4-13-15

Date

STATE OF NEW MEXICO)
) SS:
COUNTY OF SANTA FE)

The foregoing instrument was acknowledged before me this 13th day of April, 2015 by Brian Wood. Witness my hand and official seal.



Notary Public

My Commission Expires: 8/7/2017

Business Address: 37 Verano Loop, Santa Fe NM 87508

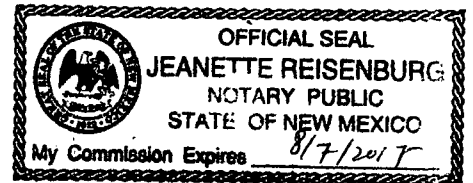

cc: Cooper



COG well

Looking southwest toward COG's State B Gas Com 1 well from Outlaw State 11 cellar.

EXHIBIT A

DISTRICT I

1625 N. French Dr., Hobbs, NM 88240
Phone (505) 593-5151 Fax: (505) 593-5720

DISTRICT II

811 S. First St., Artesia, NM 88210
Phone (505) 748-1283 Fax: (505) 748-9720

DISTRICT III

1000 Rio Brazos Rd., Aztec, NM 87410
Phone (505) 334-5176 Fax: (505) 334-5176

DISTRICT IV

1220 S. St. Francis Dr., Santa Fe, NM 87506
Phone (505) 476-3480 Fax: (505) 476-3482State of New Mexico
Energy, Minerals and Natural Resources Department

OIL CONSERVATION DIVISION

1220 South St. Francis Dr.
Santa Fe, New Mexico 87505

Form C-102

Revised August 1, 2011

Submit one copy to appropriate
District Office

WELL LOCATION AND ACREAGE DEDICATION PLAT

X AMENDED REPORT

API Number 30-015-42561	Pool Code 96830	Pool Name Artesia, Glorieta - Yeso
Property Code 313568	Property Name OUTLAW STATE	Well Number 11
GRID No. 873	Operator Name APACHE CORPORATION	Elevation 3683

Surface Location

UL or lot No.	Section	Township	Range	Lot Idn	Feet from the	SOUTH/South line	Feet from the	East/WEST LINE	County
J	29	17 S	28 E		2310	SOUTH	1775	EAST	EDDY

Bottom Hole Location If Different From Surface

UL or lot No.	Section	Township	Range	Lot Idn	Feet from the	SOUTH/South line	Feet from the	East/WEST LINE	County
Dedicated Acres 4.0	Joint or Infill	Consolidation Code	Order No.						

NO ALLOWABLE WILL BE ASSIGNED TO THIS COMPLETION UNTIL ALL INTERESTS HAVE BEEN CONSOLIDATED
OR A NON-STANDARD UNIT HAS BEEN APPROVED BY THE DIVISION

Lat - N 32.812407° Long - W 104.206286° NMSPC - N: 659309.7 E: 580389.4 (NAD83)	Lat - N 32.812382° Long - W 104.197769° NMSPC - N: 659304.1 E: 582986.2 (NAD83)	Lat - N 32.812355° Long - W 104.189253° NMSPC - N: 659297.4 E: 585602.3 (NAD83)	OPERATOR CERTIFICATION I hereby certify that the information contained herein is true and complete to the best of my knowledge and belief, and that this organization either owns a working interest or unleased mineral interest in the land including the proposed bottom hole location or has a right to drill this well at this location pursuant to a contract with an owner of such a mineral or working interest, or to a voluntary pooling agreement or a compulsory pooling order heretofore entered by the division. Signature <u>Michelle Cooper</u> Date <u>11-7-14</u> Printed Name <u>Michelle Cooper</u> Email Address <u>michelle.cooper@apachecorp.com</u>
Lat - N 32.812292° Long - W 104.205773° NMSPC - N: 659246.7 E: 538190.3 (NAD27)	Lat - N 32.812267° Long - W 104.197257° NMSPC - N: 659241.1 E: 541807.1 (NAD27)	Lat - N 32.812240° Long - W 104.186741° NMSPC - N: 659234.3 E: 544423.2 (NAD27)	
Lat - N 32.805133° Long - W 104.206381° NMSPC - N: 65663.4 E: 580349.5 (NAD83)	Lat - N 32.805018° Long - W 104.205848° NMSPC - N: 656600.4 E: 539179.4 (NAD27)	Lat - N 32.805220° Long - W 104.189361° NMSPC - N: 656701.8 E: 585572.7 (NAD83)	
SURFACE LOCATION Lat - N 32.804361° Long - W 104.195158° NMSPC - N: 656384.5 E: 583794.8 (NAD83)			SURVEYOR CERTIFICATION I hereby certify that the well location shown on this plat was plotted from field notes of actual surveys made by me or under my supervision and that the same is true and correct to the best of my belief. Date Surveyed <u>NOVEMBER 07, 2014</u> Signature & Seal of Professional Surveyor <u>[Signature]</u> Certificate No. <u>7977</u> Certified by Gary L. Jones 7977 BLSM SURVEY, INC.
Lat - N 32.804246° Long - W 104.194646° NMSPC - N: 656321.5 E: 542615.7 (NAD27)	Lat - N 32.805105° Long - W 104.188649° NMSPC - N: 656638.2 E: 544393.6 (NAD27)	Lat - N 32.797859° Long - W 104.208430° NMSPC - N: 654017.1 E: 580351.7 (NAD83)	
Lat - N 32.797744° Long - W 104.205918° NMSPC - N: 653954.1 E: 539152.5 (NAD27)	Lat - N 32.797855° Long - W 104.197424° NMSPC - N: 653997.8 E: 541782.5 (NAD27)	Lat - N 32.798079° Long - W 104.189456° NMSPC - N: 654103.8 E: 585547.1 (NAD83)	

EXHIBIT B

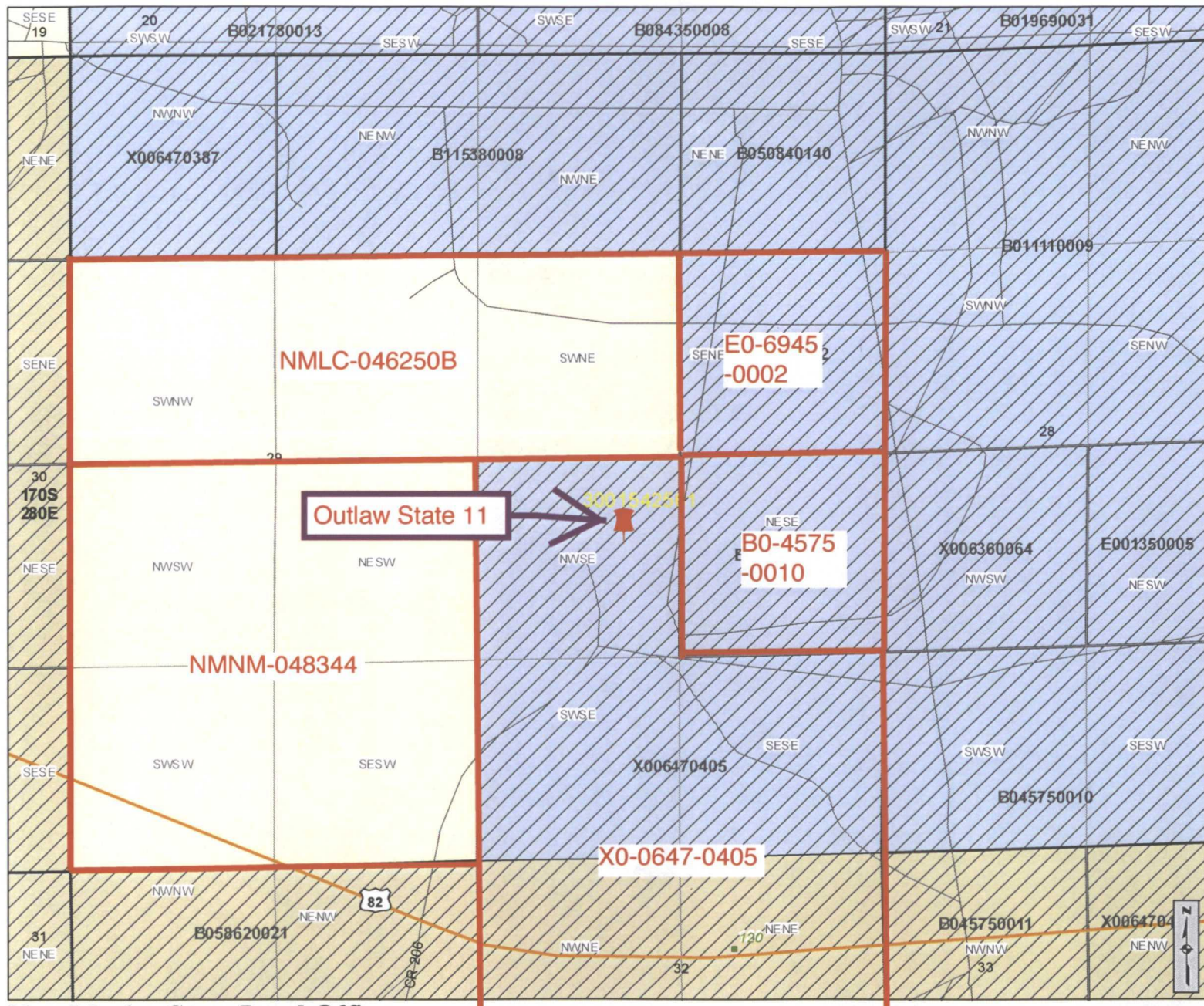

Cartographic Features

- County Boundaries
- County Seats
- City, Town or Village
- SLO District Offices
- SLO District Boundary
- Hwy Mileposts
- Interstate
- US Hwy
- NM Hwy
- Local Road
- Continental Divide

Federal Minerals Ownership

- All Minerals
- Coal Only
- Oil and Gas Only
- Oil, Gas and Coal Only
- Other Minerals

State Trust Lands

- Surface Estate
- Subsurface Estate
- Surface and Subsurface Estate

State Leases

- Oil and Gas Leases
- Agricultural Leases
- Commercial Leases
- Minerals Leases
- Not Available for Oil and Gas Leasing
- Oil and Gas Leasing Influenced by Restriction

Oil and Gas Related Features

- Oil and Gas Unit Boundary
- Participating Areas in Units
- Geologic Regions
- Volcanic Vents
- NMOCD Order R-111-P
- Potash Enclave Outline

NMOCD Oil and Gas Wells

- CO₂
- Gas
- Injection
- Miscellaneous
- Oil
- Salt Water Disposal
- Water
- DA or PA

New Mexico State Land Office Oil, Gas and Minerals

0 0.04 0.08 0.16 0.24 0.32 Miles
Universal Transverse Mercator Projection, Zone 13
1983 North American Datum

The New Mexico State Land Office assumes no responsibility or liability for, or in connection with, the accuracy, reliability or use of the information provided here, in State Land Office data layers or any other data layer.

Land Office Geographic Information Center
logic@slo.state.nm.us

Created On: 4/11/2015 9:39:09 AM

EXHIBIT C

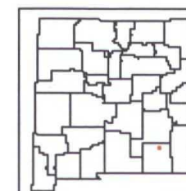

www.nmstatelands.org

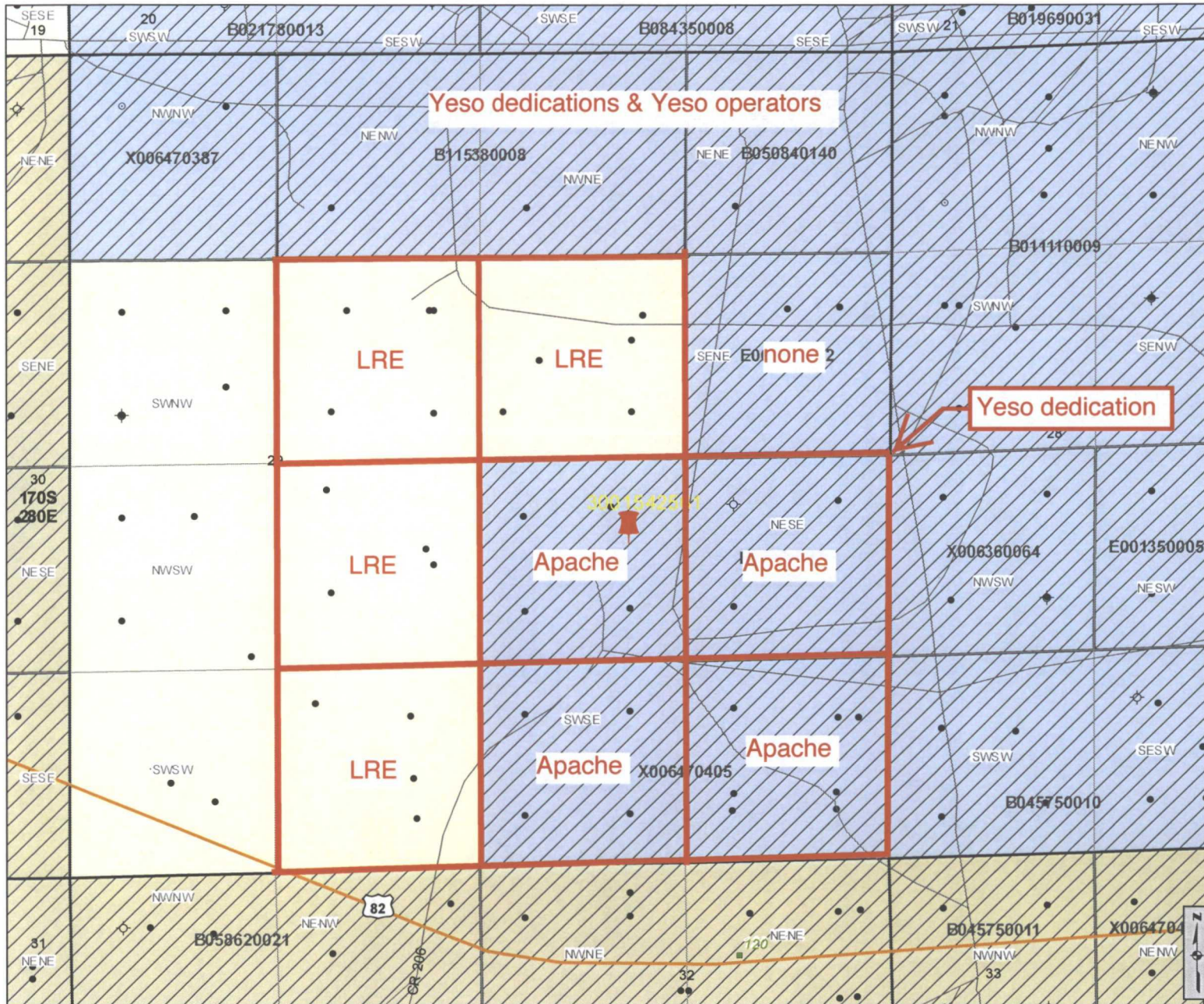

Cartographic Features

- County Boundaries
- County Seats
- City, Town or Village
- SLO District Offices
- SLO District Boundary
- Hwy Mileposts
- Interstate
- US Hwy
- NM Hwy
- Local Road
- Continental Divide

Federal Minerals Ownership

- All Minerals
- Coal Only
- Oil and Gas Only
- Oil, Gas and Coal Only
- Other Minerals

State Trust Lands

- Surface Estate
- Subsurface Estate
- Surface and Subsurface Estate

State Leases

- Oil and Gas Leases
- Agricultural Leases
- Commercial Leases
- Minerals Leases
- Not Available for Oil and Gas Leasing
- Oil and Gas Leasing Influenced by Restriction

Oil and Gas Related Features

- Oil and Gas Unit Boundary
- Participating Areas in Units
- Geologic Regions
- Volcanic Vents
- NMOCD Order R-111-P
- Potash Enclave Outline

NMOCD Oil and Gas Wells

- CO₂
- Injection
- Oil
- Water
- Gas
- Miscellaneous
- Salt Water Disposal
- DA or PA

New Mexico State Land Office

Oil, Gas and Minerals

0 0.04 0.08 0.16 0.24 0.32 Miles
 Universal Transverse Mercator Projection, Zone 13
 1983 North American Datum

The New Mexico State Land Office assumes no responsibility or liability for, or in connection with, the accuracy, reliability or use of the information provided here, in State Land Office data layers or any other data layer.

Land Office Geographic Information Center
 logic@slo.state.nm.us

Created On: 4/11/2015 10:41:48 AM

EXHIBIT D

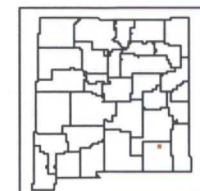

www.nmstatelands.org

PERMITS WEST, INC.
PROVIDING PERMITS for LAND USERS
37 Verano Loop, Santa Fe, New Mexico 87508 (505) 466-8120

April 13, 2015

Eric McClusky
LRE Operating, LLC
1111 Bagby St., Suite 4600
Houston, TX 77002

Dear Eric,

As required by New Mexico Oil Conservation Division Rules, I am notifying you of the following nonstandard location (NSL) for a well. This letter is a notice only. No action is needed unless you have questions or objections.

Apache Corporation is applying for NSL approval for its Outlaw State 11 oil well. Minimum state distance for such an oil well is 330' from a quarter-quarter line. The well is 26' further north than is standard (see attached application). Thus, it is a nonstandard location. The NSL is due to land uses (COG well pad and pipeline). Section 29 is smaller than a standard section.

Well Name: Outlaw State 11 ID: 5,300'

Proposed NSL Zone: Artesia; Glorieta-Yeso (O)

NSL Acreage Dedication: 40 acres (NWSE Section 29, T. 17 S., R. 28 E., Eddy County, NM) on NMSLO lease X0-0647-0405

Location: ~12 air mile west of Loco Hills, NM at 2310 FSL & 1775 FEL 29-17s-28e

Applicant Name: Apache Corporation (432) 818-1168

Applicant's Address: 303 Veterans Airpark Lane, Suite 300, Midland TX 79705

Submittal Information: Application for a nonstandard location will be filed with the NM Oil Conservation Division (NMOCD). If you have an objection, then it must be filed in writing within 20 days from the date the NMOCD receives the application. The New Mexico Oil Conservation Division address is 1220 South St. Francis Dr. Santa Fe, NM 87505. Their phone number is (505) 476-3440.

Please call me if you have any questions.

Sincerely,

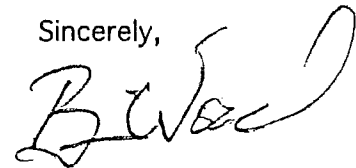

Brian Wood

U.S. Postal Service™ **APACHE OUTLAW STATE 11**
CERTIFIED MAIL™ RECEIPT
(Domestic Mail Only, No Insurance Coverage Provided)
For delivery information visit our website at www.usps.com

OFFICIAL USE

Postage \$
Certified Fee \$
Return Receipt Fee (Endorsement Required)
Restricted Delivery Fee (Endorsement Required)
Total Postage & Fees \$

APR 13 2015
87552

Sent To **ERIC MCCLUSKY / LRE**
Street, Apt. No.,
or PO Box No.
City, State, ZIP+4 **HOUSTON**

See Reverse for instructions

EXHIBIT E

April 13, 2015

BLM
 620 E. Greene
 Carlsbad NM 88220

As required by New Mexico Oil Conservation Division Rules, I am notifying you of the following nonstandard location (NSL) for a well. This letter is a notice only. No action is needed unless you have questions or objections.

Apache Corporation is applying for NSL approval for its Outlaw State 11 oil well. Minimum state distance for such an oil well is 330' from a quarter-quarter line. The well is 26' further north than is standard (see attached application). Thus, it is a nonstandard location. The NSL is due to land uses (COG well pad and pipeline). Section 29 is smaller than a standard section.

Well Name: Outlaw State 11 ID: 5,300'
Proposed NSL Zone: Artesia; Glorieta-Yeso (O)
NSL Acreage Dedication: 40 acres (NWSE Section 29, T. 17 S., R. 28 E., Eddy County, NM) on NMSLO lease X0-0647-0405
Location: ~12 air mile west of Loco Hills, NM at 2310 FSL & 1775 FEL 29-17s-28e
Applicant Name: Apache Corporation (432) 818-1168
Applicant's Address: 303 Veterans Airpark Lane, Suite 300, Midland TX 79705

Submittal Information: Application for a nonstandard location will be filed with the NM Oil Conservation Division (NMOCD). If you have an objection, then it must be filed in writing within 20 days from the date the NMOCD receives the application. The New Mexico Oil Conservation Division address is 1220 South St. Francis Dr. Santa Fe, NM 87505. Their phone number is (505) 476-3440.

Please call me if you have any questions.

Sincerely,

Brian Wood

EXHIBITE

April 13, 2015

NM State Land Office
 P. O. Box 1148
 Santa Fe NM 87504

As required by New Mexico Oil Conservation Division Rules, I am notifying you of the following nonstandard location (NSL) for a well. This letter is a notice only. No action is needed unless you have questions or objections.

Apache Corporation is applying for NSL approval for its Outlaw State 11 oil well. Minimum state distance for such an oil well is 330' from a quarter-quarter line. The well is 26' further north than is standard (see attached application). Thus, it is a nonstandard location. The NSL is due to land uses (COG well pad and pipeline). Section 29 is smaller than a standard section.

Well Name: Outlaw State 11 ID: 5,300'
Proposed NSL Zone: Artesia; Glorieta-Yeso (O)
NSL Acreage Dedication: 40 acres (NWSE Section 29, T. 17 S., R. 28 E., Eddy County, NM) on NMSLO lease X0-0647-0405
Location: ~12 air mile west of Loco Hills, NM at 2310 FSL & 1775 FEL 29-17s-28e
Applicant Name: Apache Corporation (432) 818-1168
Applicant's Address: 303 Veterans Airpark Lane, Suite 300, Midland TX 79705

Submittal Information: Application for a nonstandard location will be filed with the NM Oil Conservation Division (NMOCD). If you have an objection, then it must be filed in writing within 20 days from the date the NMOCD receives the application. The New Mexico Oil Conservation Division address is 1220 South St. Francis Dr. Santa Fe, NM 87505. Their phone number is (505) 476-3440.

Please call me if you have any questions.

Sincerely,

Brian Wood

U.S. Postal Service™ **APACHE OUTLAW**
CERTIFIED MAIL® RECEIPT STATE 17
 Domestic Mail Only

For delivery information, visit our website at www.usps.com

OFFICIAL USE

Postage \$ **APR 13 2015**
 Certified Fee **87552**
 Return Receipt Fee (Endorsement Required) _____
 Restricted Delivery Fee (Endorsement Required) _____
 Total Postage & Fees \$ _____

Sent To **BLM**
 Street & Apt. No., or PO Box No. _____
 City, State, ZIP+4 **CARLSBAD**

PS Form 3800, July 2014 See Reverse for Instructions

U.S. Postal Service™ **APACHE OUTLAW**
CERTIFIED MAIL® RECEIPT STATE 17
 Domestic Mail Only

For delivery information, visit our website at www.usps.com

OFFICIAL USE

Postage \$ **APR 13 2015**
 Certified Fee **87552**
 Return Receipt Fee (Endorsement Required) _____
 Restricted Delivery Fee (Endorsement Required) _____
 Total Postage & Fees \$ _____

Sent To **NM SLD**
 Street & Apt. No., or PO Box No. _____
 City, State, ZIP+4 **SANTA FE**

See Reverse for Instructions

April 13, 2015

Chisos LTD c/o Sue Ann Craddock
670 Dona Ana Road SW
Deming NM 88030

As required by New Mexico Oil Conservation Division Rules, I am notifying you of the following nonstandard location (NSL) for a well. This letter is a notice only. No action is needed unless you have questions or objections.

Apache Corporation is applying for NSL approval for its Outlaw State 11 oil well. Minimum state distance for such an oil well is 330' from a quarter-quarter line. The well is 26' further north than is standard (see attached application). Thus, it is a nonstandard location. The NSL is due to land uses (COG well pad and pipeline). Section 29 is smaller than a standard section.

Well Name: Outlaw State 11 ID: 5,300'

Proposed NSL Zone: Artesia; Glorieta-Yeso (O)

NSL Acreage Dedication: 40 acres (NWSE Section 29, T. 17 S., R. 28 E., Eddy County, NM) on NMSLO lease XO-0647-0405

Location: ~12 air mile west of Loco Hills, NM at 2310 FSL & 1775 FEL 29-17s-28e

Applicant Name: Apache Corporation (432) 818-1168

Applicant's Address: 303 Veterans Airpark Lane, Suite 300, Midland TX 79705

Submittal Information: Application for a nonstandard location will be filed with the NM Oil Conservation Division (NMOCD). If you have an objection, then it must be filed in writing within 20 days from the date the NMOCD receives the application. The New Mexico Oil Conservation Division address is 1220 South St. Francis Dr. Santa Fe, NM 87505. Their phone number is (505) 476-3440.

Please call me if you have any questions.

Sincerely,

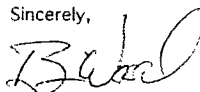

Brian Wood

EXHIBIT E

April 13, 2015

Teresa Jackson
Occidental Permian Ltd.
P. O. Box 4294
Houston TX 77210

Dear Teresa,

As required by New Mexico Oil Conservation Division Rules, I am notifying you of the following nonstandard location (NSL) for a well. This letter is a notice only. No action is needed unless you have questions or objections.

Apache Corporation is applying for NSL approval for its Outlaw State 11 oil well. Minimum state distance for such an oil well is 330' from a quarter-quarter line. The well is 26' further north than is standard (see attached application). Thus, it is a nonstandard location. The NSL is due to land uses (COG well pad and pipeline). Section 29 is smaller than a standard section.

Well Name: Outlaw State 11 ID: 5,300'

Proposed NSL Zone: Artesia; Glorieta-Yeso (O)

NSL Acreage Dedication: 40 acres (NWSE Section 29, T. 17 S., R. 28 E., Eddy County, NM) on NMSLO lease XO-0647-0405

Location: ~12 air mile west of Loco Hills, NM at 2310 FSL & 1775 FEL 29-17s-28e

Applicant Name: Apache Corporation (432) 818-1168

Applicant's Address: 303 Veterans Airpark Lane, Suite 300, Midland TX 79705

Submittal Information: Application for a nonstandard location will be filed with the NM Oil Conservation Division (NMOCD). If you have an objection, then it must be filed in writing within 20 days from the date the NMOCD receives the application. The New Mexico Oil Conservation Division address is 1220 South St. Francis Dr. Santa Fe, NM 87505. Their phone number is (505) 476-3440.

Please call me if you have any questions.

Sincerely,

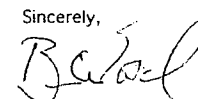

Brian Wood

7014 2670 0001 8951 2636

U.S. Postal Service™ APACHE OUTLAW
CERTIFIED MAIL® RECEIPT STATE
Domestic Mail Only

For delivery information, visit our website at www.usps.com

OFFICIAL USE

Postage	\$	
Certified Fee		
Return Receipt Fee (Endorsement Required)		
Restricted Delivery Fee (Endorsement Required)		
Total Postage & Fees	\$	87552

Postmark Here

Sent To
CHISOS LTD
Street & Apt. No., or PO Box No.
City, State, ZIP+4
DEMING

7012 1010 0000 4651 3951

U.S. Postal Service™ APACHE OUTLAW
CERTIFIED MAIL™ RECEIPT STATE
(Domestic Mail Only; No Insurance Coverage Provided)

For delivery information, visit our website at www.usps.com

OFFICIAL USE

Postage	\$	
Certified Fee		
Return Receipt Fee (Endorsement Required)		
Restricted Delivery Fee (Endorsement Required)		
Total Postage & Fees	\$	

APR 13 2015

87552

Sent To
T. JACKSON / OCCIDENTAL PERMIAN
Street, Apt. No., or PO Box No.
City, State, ZIP+4
HOUSTON

PS Form 3800, August 2006

April 13, 2015

The Latham Family Trust
Attn. Debra Denise Latham
954 River Forrest Dr.
New Braunfels TX 78132

As required by New Mexico Oil Conservation Division Rules, I am notifying you of the following nonstandard location (NSL) for a well. This letter is a notice only. No action is needed unless you have questions or objections.

Apache Corporation is applying for NSL approval for its Outlaw State 11 oil well. Minimum state distance for such an oil well is 330' from a quarter-quarter line. The well is 26' further north than is standard (see attached application). Thus, it is a nonstandard location. The NSL is due to land uses (COG well pad and pipeline). Section 29 is smaller than a standard section.

Well Name: Outlaw State 11 ID: 5,300'
Proposed NSL Zone: Artesia; Glorieta-Yeso (O)
NSL Acreage Dedication: 40 acres (NWSE Section 29, T. 17 S., R. 28 E., Eddy County, NM) on NMSLO lease X0-0647-0405
Location: ~12 air mile west of Loco Hills, NM at 2310 FSL & 1775 FEL 29-17s-28e
Applicant Name: Apache Corporation (432) 818-1168
Applicant's Address: 303 Veterans Airpark Lane, Suite 300, Midland TX 79705

Submittal Information: Application for a nonstandard location will be filed with the NM Oil Conservation Division (NMOCD). If you have an objection, then it must be filed in writing within 20 days from the date the NMOCD receives the application. The New Mexico Oil Conservation Division address is 1220 South St. Francis Dr. Santa Fe, NM 87505. Their phone number is (505) 476-3440.

Please call me if you have any questions.

Sincerely,

Brian Wood

Brian Wood

EXHIBIT E

April 13, 2015

E G L Resources Inc.
P. O. Box 10886
Midland TX 79702

As required by New Mexico Oil Conservation Division Rules, I am notifying you of the following nonstandard location (NSL) for a well. This letter is a notice only. No action is needed unless you have questions or objections.

Apache Corporation is applying for NSL approval for its Outlaw State 11 oil well. Minimum state distance for such an oil well is 330' from a quarter-quarter line. The well is 26' further north than is standard (see attached application). Thus, it is a nonstandard location. The NSL is due to land uses (COG well pad and pipeline). Section 29 is smaller than a standard section.

Well Name: Outlaw State 11 ID: 5,300'
Proposed NSL Zone: Artesia; Glorieta-Yeso (O)
NSL Acreage Dedication: 40 acres (NWSE Section 29, T. 17 S., R. 28 E., Eddy County, NM) on NMSLO lease X0-0647-0405
Location: ~12 air mile west of Loco Hills, NM at 2310 FSL & 1775 FEL 29-17s-28e
Applicant Name: Apache Corporation (432) 818-1168
Applicant's Address: 303 Veterans Airpark Lane, Suite 300, Midland TX 79705

Submittal Information: Application for a nonstandard location will be filed with the NM Oil Conservation Division (NMOCD). If you have an objection, then it must be filed in writing within 20 days from the date the NMOCD receives the application. The New Mexico Oil Conservation Division address is 1220 South St. Francis Dr. Santa Fe, NM 87505. Their phone number is (505) 476-3440.

Please call me if you have any questions.

Sincerely,

Brian Wood

Brian Wood



Postage	\$	87552
Certified Fee		
Return Receipt Fee (Endorsement Required)		
Restricted Delivery Fee (Endorsement Required)		
Total Postage & Fees	\$	87552

Postmark: APR 13 2015

Sent To: **LATHAM FAMILY TRUST**
Street, Apt. No., or PO Box No.:
City, State, ZIP+4: **NEW BRAUNFELS, TX**



Postage	\$	87552
Certified Fee		
Return Receipt Fee (Endorsement Required)		
Restricted Delivery Fee (Endorsement Required)		
Total Postage & Fees	\$	87552

Postmark: APR 13 2015

Sent To: **EGL**
Street, Apt. No., or PO Box No.:
City, State, ZIP+4: **MIDLAND**

4651 3937 1594 0000 0101 2102

2012 1010 0000 4651 3937

April 13, 2015

Mickey Cunningham
5313 Chesley Court
Midland TX 79707

As required by New Mexico Oil Conservation Division Rules, I am notifying you of the following nonstandard location (NSL) for a well. This letter is a notice only. No action is needed unless you have questions or objections.

Apache Corporation is applying for NSL approval for its Outlaw State 11 oil well. Minimum state distance for such an oil well is 330' from a quarter-quarter line. The well is 26' further north than is standard (see attached application). Thus, it is a nonstandard location. The NSL is due to land uses (COG well pad and pipeline). Section 29 is smaller than a standard section.

Well Name: Outlaw State 11 ID: 5,300'

Proposed NSL Zone: Artesia; Glorieta-Yeso (O)

NSL Acreage Dedication: 40 acres (NWSE Section 29, T. 17 S., R. 28 E., Eddy County, NM) on NMSLO lease X0-0647-0405

Location: ~12 air mile west of Loco Hills, NM at 2310 FSL & 1775 FEL 29-17s-28e

Applicant Name: Apache Corporation (432) 818-1168

Applicant's Address: 303 Veterans Airpark Lane, Suite 300, Midland TX 79705

Submission Information: Application for a nonstandard location will be filed with the NM Oil Conservation Division (NMOCD). If you have an objection, then it must be filed in writing within 20 days from the date the NMOCD receives the application. The New Mexico Oil Conservation Division address is 1220 South St. Francis Dr. Santa Fe, NM 87505. Their phone number is (505) 476-3440.

Please call me if you have any questions.

Sincerely,

Brian Wood

EXHIBIT E

April 13, 2015

Mark Tisdale
1600 Desta Dr., Suite 6500
Midland TX 79705

As required by New Mexico Oil Conservation Division Rules, I am notifying you of the following nonstandard location (NSL) for a well. This letter is a notice only. No action is needed unless you have questions or objections.

Apache Corporation is applying for NSL approval for its Outlaw State 11 oil well. Minimum state distance for such an oil well is 330' from a quarter-quarter line. The well is 26' further north than is standard (see attached application). Thus, it is a nonstandard location. The NSL is due to land uses (COG well pad and pipeline). Section 29 is smaller than a standard section.

Well Name: Outlaw State 11 ID: 5,300'

Proposed NSL Zone: Artesia; Glorieta-Yeso (O)

NSL Acreage Dedication: 40 acres (NWSE Section 29, T. 17 S., R. 28 E., Eddy County, NM) on NMSLO lease X0-0647-0405

Location: ~12 air mile west of Loco Hills, NM at 2310 FSL & 1775 FEL 29-17s-28e

Applicant Name: Apache Corporation (432) 818-1168

Applicant's Address: 303 Veterans Airpark Lane, Suite 300, Midland TX 79705

Submission Information: Application for a nonstandard location will be filed with the NM Oil Conservation Division (NMOCD). If you have an objection, then it must be filed in writing within 20 days from the date the NMOCD receives the application. The New Mexico Oil Conservation Division address is 1220 South St. Francis Dr. Santa Fe, NM 87505. Their phone number is (505) 476-3440.

Please call me if you have any questions.

Sincerely,

Brian Wood



April 13, 2015

Greg Benton
P. O. Box 51034
Midland TX 79705

As required by New Mexico Oil Conservation Division Rules, I am notifying you of the following nonstandard location (NSL) for a well. This letter is a notice only. No action is needed unless you have questions or objections.

Apache Corporation is applying for NSL approval for its Outlaw State 11 oil well. Minimum state distance for such an oil well is 330' from a quarter-quarter line. The well is 26' further north than is standard (see attached application). Thus, it is a nonstandard location. The NSL is due to land uses (COG well pad and pipeline). Section 29 is smaller than a standard section.

Well Name: Outlaw State 11 ID: 5,300'

Proposed NSL Zone: Artesia; Glorieta-Yeso (O)

NSL Acreage Dedication: 40 acres (NWSE Section 29, T. 17 S., R. 28 E., Eddy County, NM) on NMSLO lease XO-0647-0405

Location: ≈12 air mile west of Loco Hills, NM at 2310 FSL & 1775 FEL 29-17s-28e

Applicant Name: Apache Corporation (432) 818-1168

Applicant's Address: 303 Veterans Airpark Lane, Suite 300, Midland TX 79705

Submittal Information: Application for a nonstandard location will be filed with the NM Oil Conservation Division (NMOCD). If you have an objection, then it must be filed in writing within 20 days from the date the NMOCD receives the application. The New Mexico Oil Conservation Division address is 1220 South St. Francis Dr. Santa Fe, NM 87505. Their phone number is (505) 476-3440.

Please call me if you have any questions.

Sincerely,

Brian Wood

Brian Wood

EXHIBIT E



For delivery information visit our website at www.usps.com

Postage	\$
Certified Fee	\$
Return Receipt Fee (Endorsement Required)	\$
Restricted Delivery Fee (Endorsement Required)	\$
Total Postage & Fees	\$

Sent To GREG BENTON
Street, Apt. No., or PO Box No. _____
City, State, ZIP+4 MIDLAND

April 13, 2015

Clayton Williams Energy Inc.
6 Desta Dr., Suite 1100
Midland TX 79705

As required by New Mexico Oil Conservation Division Rules, I am notifying you of the following nonstandard location (NSL) for a well. This letter is a notice only. No action is needed unless you have questions or objections.

Apache Corporation is applying for NSL approval for its Outlaw State 11 oil well. Minimum state distance for such an oil well is 330' from a quarter-quarter line. The well is 26' further north than is standard (see attached application). Thus, it is a nonstandard location. The NSL is due to land uses (COG well pad and pipeline). Section 29 is smaller than a standard section.

Well Name: Outlaw State 11 ID: 5,300'

Proposed NSL Zone: Artesia; Glorieta-Yeso (O)

NSL Acreage Dedication: 40 acres (NWSE Section 29, T. 17 S., R. 28 E., Eddy County, NM) on NMSLO lease XO-0647-0405

Location: ≈12 air mile west of Loco Hills, NM at 2310 FSL & 1775 FEL 29-17s-28e

Applicant Name: Apache Corporation (432) 818-1168

Applicant's Address: 303 Veterans Airpark Lane, Suite 300, Midland TX 79705

Submittal Information: Application for a nonstandard location will be filed with the NM Oil Conservation Division (NMOCD). If you have an objection, then it must be filed in writing within 20 days from the date the NMOCD receives the application. The New Mexico Oil Conservation Division address is 1220 South St. Francis Dr. Santa Fe, NM 87505. Their phone number is (505) 476-3440.

Please call me if you

have any questions.

Sincerely,

Brian Wood

Brian Wood

U.S. Postal Service CERTIFIED MAIL RECEIPT (Domestic Mail Only; No Insurance Coverage Provided)

For delivery information visit our website at www.usps.com

OFFICIAL USE

Postage \$

Certified Fee \$

Return Receipt Fee (Endorsement Required) \$

Restricted Delivery Fee (Endorsement Required) \$

Total Postage & Fees \$

APR 13 2015

87552

Sent To CLAYTON WILLIAMS ENERGY
Street, Apt. No., or PO Box No. _____
City, State, ZIP+4 MIDLAND

PS Form 3800, August 2006

See Reverse for Instructions

April 13, 2015

Mike Pollard
6 Desta Dr., Suite 3000
Midland TX 79705

As required by New Mexico Oil Conservation Division Rules, I am notifying you of the following nonstandard location (NSL) for a well. This letter is a notice only. No action is needed unless you have questions or objections.

Apache Corporation is applying for NSL approval for its Outlaw State 11 oil well. Minimum state distance for such an oil well is 330' from a quarter-quarter line. The well is 26' further north than is standard (see attached application). Thus, it is a nonstandard location. The NSL is due to land uses (COG well pad and pipeline). Section 29 is smaller than a standard section.

Well Name: Outlaw State 11 ID: 5,300'

Proposed NSL Zone: Artesia; Glorieta-Yeso (O)

NSL Acreage Dedication: 40 acres (NWSE Section 29, T. 17 S., R. 28 E., Eddy County, NM) on NMSLO lease XO-0647-0405

Location: ~12 air mile west of Loco Hills, NM at 2310 FSL & 1775 FEL 29-17s-28e

Applicant Name: Apache Corporation (432) 818-1168

Applicant's Address: 303 Veterans Airpark Lane, Suite 300, Midland TX 79705

Submission Information: Application for a nonstandard location will be filed with the NM Oil Conservation Division (NMOCD). If you have an objection, then it must be filed in writing within 20 days from the date the NMOCD receives the application. The New Mexico Oil Conservation Division address is 1220 South St. Francis Dr. Santa Fe, NM 87505. Their phone number is (505) 476-3440.

Please call me if you have any questions.

Sincerely,

Brian Wood

EXHIBIT E

April 13, 2015

Matt Swerc
3000 Goddard Place
Midland TX 79705

As required by New Mexico Oil Conservation Division Rules, I am notifying you of the following nonstandard location (NSL) for a well. This letter is a notice only. No action is needed unless you have questions or objections.

Apache Corporation is applying for NSL approval for its Outlaw State 11 oil well. Minimum state distance for such an oil well is 330' from a quarter-quarter line. The well is 26' further north than is standard (see attached application). Thus, it is a nonstandard location. The NSL is due to land uses (COG well pad and pipeline). Section 29 is smaller than a standard section.

Well Name: Outlaw State 11 ID: 5,300'

Proposed NSL Zone: Artesia; Glorieta-Yeso (O)

NSL Acreage Dedication: 40 acres (NWSE Section 29, T. 17 S., R. 28 E., Eddy County, NM) on NMSLO lease XO-0647-0405

Location: ~12 air mile west of Loco Hills, NM at 2310 FSL & 1775 FEL 29-17s-28e

Applicant Name: Apache Corporation (432) 818-1168

Applicant's Address: 303 Veterans Airpark Lane, Suite 300, Midland TX 79705

Submission Information: Application for a nonstandard location will be filed with the NM Oil Conservation Division (NMOCD). If you have an objection, then it must be filed in writing within 20 days from the date the NMOCD receives the application. The New Mexico Oil Conservation Division address is 1220 South St. Francis Dr. Santa Fe, NM 87505. Their phone number is (505) 476-3440.

Please call me if you have any questions.

Sincerely,

Brian Wood



Postage	\$
Certified Fee	APR 13 2015
Return Receipt Fee (Endorsement Required)	Here
Restricted Delivery Fee (Endorsement Required)	87552
Total Postage & Fees	\$

Sent To	MIKE POLLARD
Street, Apt. No., or PO Box No.	
City, State, ZIP+4	MIDLAND

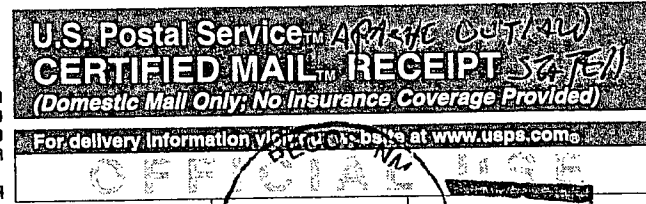

Postage	\$
Certified Fee	APR 13 2015
Return Receipt Fee (Endorsement Required)	Here
Restricted Delivery Fee (Endorsement Required)	87552
Total Postage & Fees	\$

Sent To	MATT SWERC
Street, Apt. No., or PO Box No.	
City, State, ZIP+4	MIDLAND

April 13, 2015

Mark B. Henen
 1221 S. Main, Suite 206
 Boerne TX 78006

As required by New Mexico Oil Conservation Division Rules, I am notifying you of the following nonstandard location (NSL) for a well. This letter is a notice only. No action is needed unless you have questions or objections.

Apache Corporation is applying for NSL approval for its Outlaw State 11 oil well. Minimum state distance for such an oil well is 330' from a quarter-quarter line. The well is 26' further north than is standard (see attached application). Thus, it is a nonstandard location. The NSL is due to land uses (COG well pad and pipeline). Section 29 is smaller than a standard section.

Well Name: Outlaw State 11 ID: S,300'
Proposed NSL Zone: Artesia; Glorieta-Yeso (O)
NSL Acreage Dedication: 40 acres (NWSE Section 29, T. 17 S., R. 28 E., Eddy County, NM) on NMSLO lease X0-0647-0405
Location: ≈12 air mile west of Loco Hills, NM at 2310 FSL & 1775 FEL 29-17s-28e
Applicant Name: Apache Corporation (432) 818-1168
Applicant's Address: 303 Veterans Airpark Lane, Suite 300, Midland TX 79705

Submittal Information: Application for a nonstandard location will be filed with the NM Oil Conservation Division (NMOCD). If you have an objection, then it must be filed in writing within 20 days from the date the NMOCD receives the application. The New Mexico Oil Conservation Division address is 1220 South St. Francis Dr. Santa Fe, NM 87505. Their phone number is (505) 476-3440.

Please call me if you have any questions.

Sincerely,

Brian Wood

EXHIBIT E

April 13, 2015

John Kennedy
 6 Desta Dr., Suite 3000
 Midland TX 79705

As required by New Mexico Oil Conservation Division Rules, I am notifying you of the following nonstandard location (NSL) for a well. This letter is a notice only. No action is needed unless you have questions or objections.

Apache Corporation is applying for NSL approval for its Outlaw State 11 oil well. Minimum state distance for such an oil well is 330' from a quarter-quarter line. The well is 26' further north than is standard (see attached application). Thus, it is a nonstandard location. The NSL is due to land uses (COG well pad and pipeline). Section 29 is smaller than a standard section.

Well Name: Outlaw State 11 ID: S,300'
Proposed NSL Zone: Artesia; Glorieta-Yeso (O)
NSL Acreage Dedication: 40 acres (NWSE Section 29, T. 17 S., R. 28 E., Eddy County, NM) on NMSLO lease X0-0647-0405
Location: ≈12 air mile west of Loco Hills, NM at 2310 FSL & 1775 FEL 29-17s-28e
Applicant Name: Apache Corporation (432) 818-1168
Applicant's Address: 303 Veterans Airpark Lane, Suite 300, Midland TX 79705

Submittal Information: Application for a nonstandard location will be filed with the NM Oil Conservation Division (NMOCD). If you have an objection, then it must be filed in writing within 20 days from the date the NMOCD receives the application. The New Mexico Oil Conservation Division address is 1220 South St. Francis Dr. Santa Fe, NM 87505. Their phone number is (505) 476-3440.

Please call me if you have any questions.

Sincerely,

Brian Wood

U.S. Postal Service™
CERTIFIED MAIL™ RECEIPT SYSTEM
 (Domestic Mail Only; No Insurance Coverage Provided)
 For delivery information visit our website at www.usps.com

OFFICIAL USE

Postage \$
 Certified Fee **APR 13 2015**
 Return Receipt Fee (Endorsement Required)
 Restricted Delivery Fee (Endorsement Required) **87552**
 Total Postage & Fees \$

Sent To **MARK B. HENEN**
 Street, Apt. No., or PO Box No.
 City, State, ZIP+4 **BOERNE, TX**

U.S. Postal Service™
CERTIFIED MAIL™ RECEIPT SYSTEM
 (Domestic Mail Only; No Insurance Coverage Provided)
 For delivery information visit our website at www.usps.com

OFFICIAL USE

Postage \$
 Certified Fee **APR 13 2015**
 Return Receipt Fee (Endorsement Required)
 Restricted Delivery Fee (Endorsement Required) **87552**
 Total Postage & Fees \$

Sent To **JOHN KENNEDY**
 Street, Apt. No., or PO Box No.
 City, State, ZIP+4 **MIDLAND**

See Reverse for Instructions

April 13, 2015

Melvin Riggs
4505 Island Dr.
Midland TX 79707

As required by New Mexico Oil Conservation Division Rules, I am notifying you of the following nonstandard location (NSL) for a well. This letter is a notice only. No action is needed unless you have questions or objections.

Apache Corporation is applying for NSL approval for its Outlaw State 11 oil well. Minimum state distance for such an oil well is 330' from a quarter-quarter line. The well is 26' further north than is standard (see attached application). Thus, it is a nonstandard location. The NSL is due to land uses (COG well pad and pipeline). Section 29 is smaller than a standard section.

Well Name: Outlaw State 11 ID: 5,300'

Proposed NSL Zone: Artesia; Glorieta-Yeso (O)

NSL Acreage Dedication: 40 acres (NWSE Section 29, T. 17 S., R. 28 E., Eddy County, NM) on NMSLO lease XO-0647-0405

Location: ≈12 air mile west of Loco Hills, NM at 2310 FSL & 1775 FEL 29-17s-28e

Applicant Name: Apache Corporation (432) 818-1168

Applicant's Address: 303 Veterans Airpark Lane, Suite 300, Midland TX 79705

Submittal Information: Application for a nonstandard location will be filed with the NM Oil Conservation Division (NMOCD). If you have an objection, then it must be filed in writing within 20 days from the date the NMOCD receives the application. The New Mexico Oil Conservation Division address is 1220 South St. Francis Dr. Santa Fe, NM 87505. Their phone number is (505) 476-3440.

Please call me if you have any questions.

Sincerely,

Brian Wood

EXHIBIT E

April 13, 2015

Robert Thomas
3808 Roadrunner Trail
Midland TX 79707

As required by New Mexico Oil Conservation Division Rules, I am notifying you of the following nonstandard location (NSL) for a well. This letter is a notice only. No action is needed unless you have questions or objections.

Apache Corporation is applying for NSL approval for its Outlaw State 11 oil well. Minimum state distance for such an oil well is 330' from a quarter-quarter line. The well is 26' further north than is standard (see attached application). Thus, it is a nonstandard location. The NSL is due to land uses (COG well pad and pipeline). Section 29 is smaller than a standard section.

Well Name: Outlaw State 11 ID: 5,300'

Proposed NSL Zone: Artesia; Glorieta-Yeso (O)

NSL Acreage Dedication: 40 acres (NWSE Section 29, T. 17 S., R. 28 E., Eddy County, NM) on NMSLO lease XO-0647-0405

Location: ≈12 air mile west of Loco Hills, NM at 2310 FSL & 1775 FEL 29-17s-28e

Applicant Name: Apache Corporation (432) 818-1168

Applicant's Address: 303 Veterans Airpark Lane, Suite 300, Midland TX 79705

Submittal Information: Application for a nonstandard location will be filed with the NM Oil Conservation Division (NMOCD). If you have an objection, then it must be filed in writing within 20 days from the date the NMOCD receives the application. The New Mexico Oil Conservation Division address is 1220 South St. Francis Dr. Santa Fe, NM 87505. Their phone number is (505) 476-3440.

Please call me if you have any questions.

Sincerely,

Brian Wood

U.S. Postal Service™ **CERTIFIED MAIL® RECEIPT**
Domestic Mail Only

For delivery information, visit our website at www.usps.com

OFFICIAL USE

Postage	\$ 1.70
Certified Fee	3.50
Return Receipt Fee (Endorsement Required)	2.70
Restricted Delivery Fee (Endorsement Required)	87552
Total Postage & Fees	\$ 6.70

APR 13 2015

87552

Sent To

MELVIN RIGGS

Street & Apt. No.,
or PO Box No.

CITY, STATE, ZIP+4

MIDLAND

PS Form 3800, August 2006

U.S. Postal Service™ **CERTIFIED MAIL® RECEIPT**
Domestic Mail Only; No Insurance Coverage Provided

For delivery information, visit our website at www.usps.com

OFFICIAL USE

Postage	\$
Certified Fee	APR 13 2015
Return Receipt Fee (Endorsement Required)	
Restricted Delivery Fee (Endorsement Required)	87552
Total Postage & Fees	\$

APR 13 2015

87552

Sent To

ROBERT THOMAS

Street, Apt. No.,
or PO Box No.

CITY, STATE, ZIP+4

MIDLAND

PS Form 3800, August 2006