

1409

**Southern**  
**Rockies**  
**Business**  
**Unit**

October 22, 1996

Mr. William J. LeMay, Director  
New Mexico Oil Conservation Division  
2040 S. Pacheco Street  
P. O. Box 6429  
Santa Fe, NM 87505

**Application for Exception to Rule 303-A- Downhole Commingling**  
**Storey LS #3 Well**  
**Unit M Section 26-T28N-R8W**  
**South Blanco Pictured Cliffs and Blanco Mesaverde Pools**  
**San Juan County, New Mexico**

Enclosed please find an administrative application form (C-107-A) and attachments for downhole commingling for the captioned well. By copy of this application by certified mail, return receipt requested, Amoco is notifying all offset operators in the formations captioned above as well as all affected interest owners if the ownership of those formations is not common. The Division Director may approve the proposed downhole commingling in the absence of a valid objection from any offset operator or any interest owner in those instances where ownership is not common in the zones to be commingled within 20 days after the receipt of the application if, in his opinion, waste will not result thereby, and correlative rights will not be violated.

Should there be questions concerning this matter, please contact me at (303) 830-5344.

Sincerely,

Pamela W. Staley

Enclosures

cc: Mark Rothenberg  
Pat Archuleta  
Wellfile  
Proration File  
Frank Chavez, Supervisor  
NMOCD District III  
1000 Rio Brazos Road  
Aztec, NM 87410

Duane Spencer  
Bureau of Land Management  
1235 La Plata Hwy.  
Farmington, NM 87401

OIL CONSERVATION DIVISION

APPROVAL PROCESS:

DISTRICT II  
811 South First St., Artesia, NM 88210-2835

2040 S. Pacheco  
Santa Fe, New Mexico 87505-6429

☒ Administrative ☐ Hearing

DISTRICT III  
1000 Rio Brazos Rd. Aztec, NM 87410-1893

APPLICATION FOR DOWNHOLE COMMINGLING

EXISTING WELLBORE  
☒ YES ☐ NO

Amoco Production Company

P.O. Box 800 Denver, CO 80201

Operator  
STOREY LS

3

Address  
M-26-28N-8W

San Juan

Lease

Well No.

Unit Ltr. - Sec Twp - Rge

County

Spacing Unit Lease Types: (check 1 or more)

OGRID NO. 000778 Property Code 0001133 API NO. 3004507094 Federal ☒ State ☐ (and/or) Fee ☐

The following facts are submitted in support of downhole commingling:	Upper Zone	Intermediate Zone	Lower Zone
1. Pool Name and Pool Code	SOUTH BLANCO PICTURED CLIFFS 72439		BLANCO MESAVERDE 72319
2. Top and Bottom of Pay Section (Perforations)	2510' - 2565'		4206' - 4878'
3. Type of production (Oil or Gas)	GAS		GAS
4. Method of Production (Flowing or Artificial Lift)	FLOWING		FLOWING
5. Bottomhole Pressure Oil Zones - Artificial Lift: Gas & Oil - Flowing: All Gas Zones: Estimated or Measured Original	(Current) a. 425 PSI (Original) b. 1000 PSI	a.  b.	a. 590 PSI  b. 1200 PSI
6. Oil Gravity (" API) or Gas BTU Content	1200 BTU		1209 BTU / 49 DEG API
7. Producing or Shut-In?	SHUT - IN		PRODUCING
Production Marginal? (yes or no) • If Shut-In, give data and oil/gas/water rates of last production Note: For new zones with no production history, applicant shall be required to attach production estimates and supporting data • If Producing, give date and oil/gas/water rates of recent test (within 60 days)	YES Date: 3/1/96 - 3/31/96 Rates: 17 MCFD 0 BCPD 0 BWPD Date: Rates:	Date: Rates:	YES Date: Rates: 8/1-31/96 127 MCFD 0.6 BCPD 0.6 BWPD
8. Fixed Percentage Allocation Formula -% for each zone	Oil: 0 % Gas 12 %	Oil: % Gas %	Oil: 100 % Gas 88 %

9. If allocation formula is based upon something other than current or past production, or is based upon some other method, submit attachments with supporting data and/or explaining method and providing rate projections or other required data.

10. Are all working, overriding, and royalty interests identical in all commingled zones? ☒ Yes ☐ No  
If not, have all working, overriding, and royalty interests been notified by certified mail? ☐ Yes ☐ No  
Have all offset operators been given written notice of the proposed downhole commingling? ☒ Yes ☐ No

11. Will cross-flow occur? ☐ Yes ☒ No If yes, are fluids compatible, will the formations not be damaged, will any cross-flowed production be recovered, and will the allocation formula be reliable. ☐ Yes ☐ No (If No, attach explanation)

12. Are all produced fluids from all commingled zones compatible with each other? ☒ Yes ☐ No

13. Will the value of production be decreased by commingling? ☐ Yes ☒ No (If Yes, attach explanation)

14. If this well is on, or communitized with, state or federal lands, either the Commissioner of Public Lands or the United States Bureau of Land Management has been notified in writing of this application. ☒ Yes ☐ No SF-078566

15. NMOCD Reference Cases for Rule 303(D) Exceptions: ORDER NO(S) \_\_\_\_\_

16. ATTACHMENTS:

- \* C-102 for each zone to be commingled showing its spacing unit and acreage dedication.
- \* Production curve for each zone for at least one year. (If not available, attach explanation.)
- \* For zones with no production history, estimated production rates and supporting data.
- \* Data to support allocation method or formula.
- \* Notification list of all offset operators.
- \* Notification list of working, overriding, and royalty interests for uncommon interest cases.
- \* Any additional statements, data, or documents required to support commingling.

I hereby certify that the information above is true and complete to the best of my knowledge and belief.

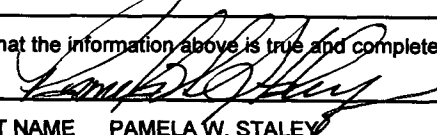
SIGNATURE  TITLE REGULATORY AFFAIRS ENGR DATE 10/22/96  
TYPE OR PRINT NAME PAMELA W. STALEY TELEPHONE NO. ( 303 ) 830-5344

NEW MEXICO  
OIL CONSERVATION COMMISSION

Form C-12B

WELL LOCATION AND/OR GAS PRODUCTION PLAT

DATE APRIL 30, 1957

OPERATOR EL PASO NATURAL GAS COMPANY LEASE STOREY SF 078566

WELL NO. 3 (PM) SECTION 26 TOWNSHIP 28 1/2 N RANGE 8-W NMPM

LOCATED 1050 FEET FROM SOUTH LINE 950 FEET FROM WEST LINE

SAN JUAN

COUNTY, NEW MEXICO

G.E. ELEVATION 6100

NAME OF PRODUCING FORMATION P.C. & M.V. SO. BLANCO P.C. Ext. 160 ACRES P.C.  
BLANCO M.V. 320 ACRES M.V.  
(1919 PLAT)

Note: All distances must be from outer boundaries of section.

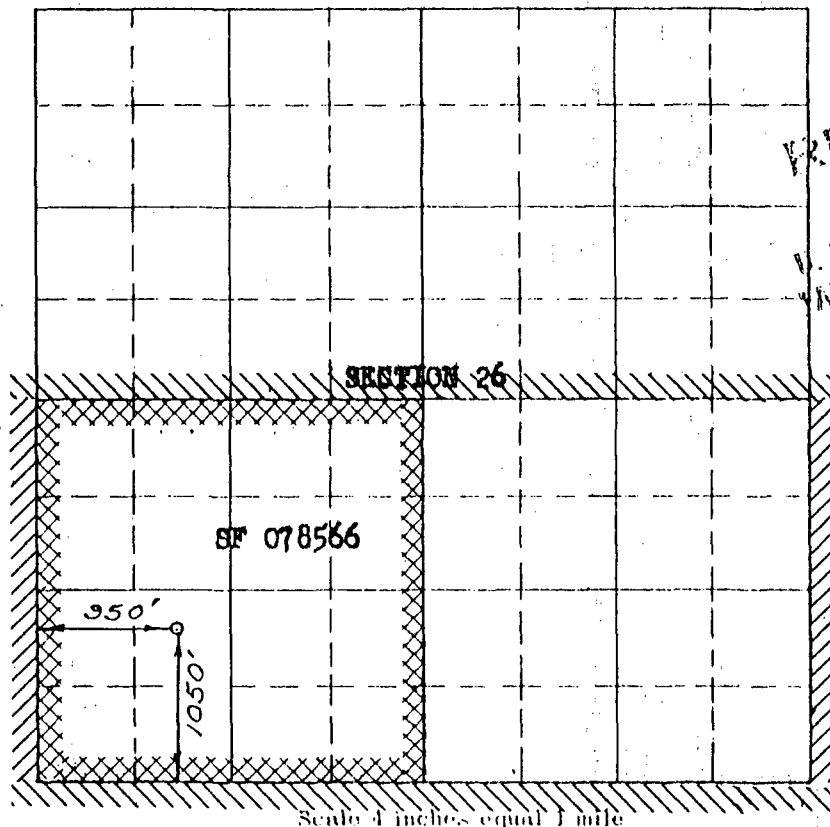

RECEIVED  
MAY 10 1957  
U. S. GEOLOGICAL SURVEY  
FARMINGTON, NEW MEXICO

NOTE

This section of  
form is to be used  
for gas wells only

This is to certify that the above plat was prepared from  
field notes of actual surveys made by me or under my  
supervision and that the same are true and correct to the  
best of my knowledge and belief.

Date Surveyed MARCH 19, 1957

E. O. Walker  
Registered Professional Engineer and/or Land Surveyor

(Seal)

1. Is this well a Dual Comp.

Yes X No

2. If the answer to Question 1

is yes, are there any other dually  
completed wells within the  
dedicated acreage.

Yes No X

Original Signed D. C. Johns

Position Petroleum Engineer

Representing El Paso Natural Gas

Address Box 997, Farmington, N.M.

User: zmdr16  
Owner: 2DMHF

# Single Well Gas3D

Description 1  
Mon Sep 23 08:09:52 1996

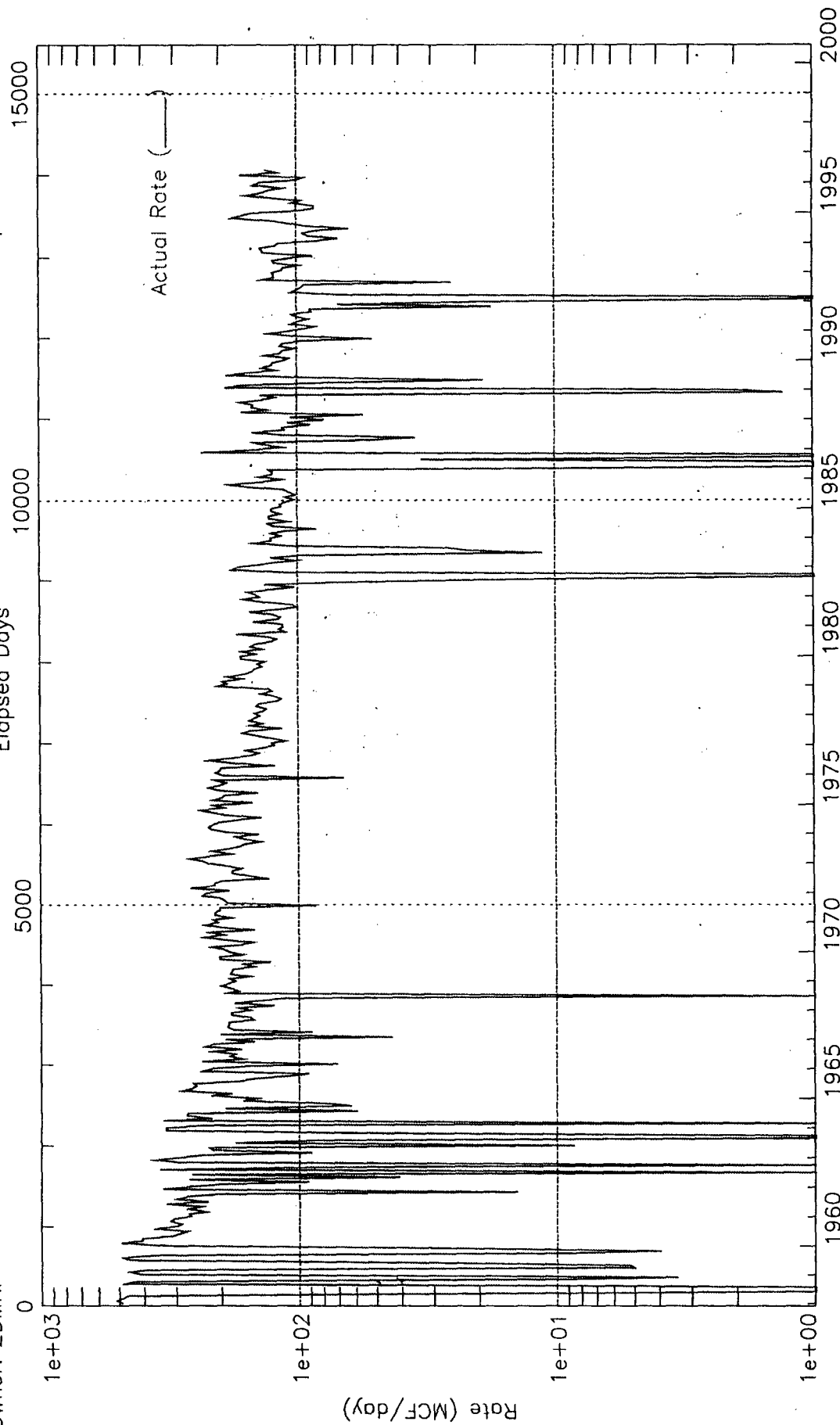

Cum Gas= 2189.40 MMCF

Date (Years)

Well ID: 300450709400 604MVRD  
Well Name: STOREY LS 1-4 /MV/ 003M26  
Operator: AMOCO PRODUCTION COMPANY

User: zmdr16  
Owner: 2DMHF

# Single Well Gas3D

Description 1  
Mon Sep 23 08:09:58 1996

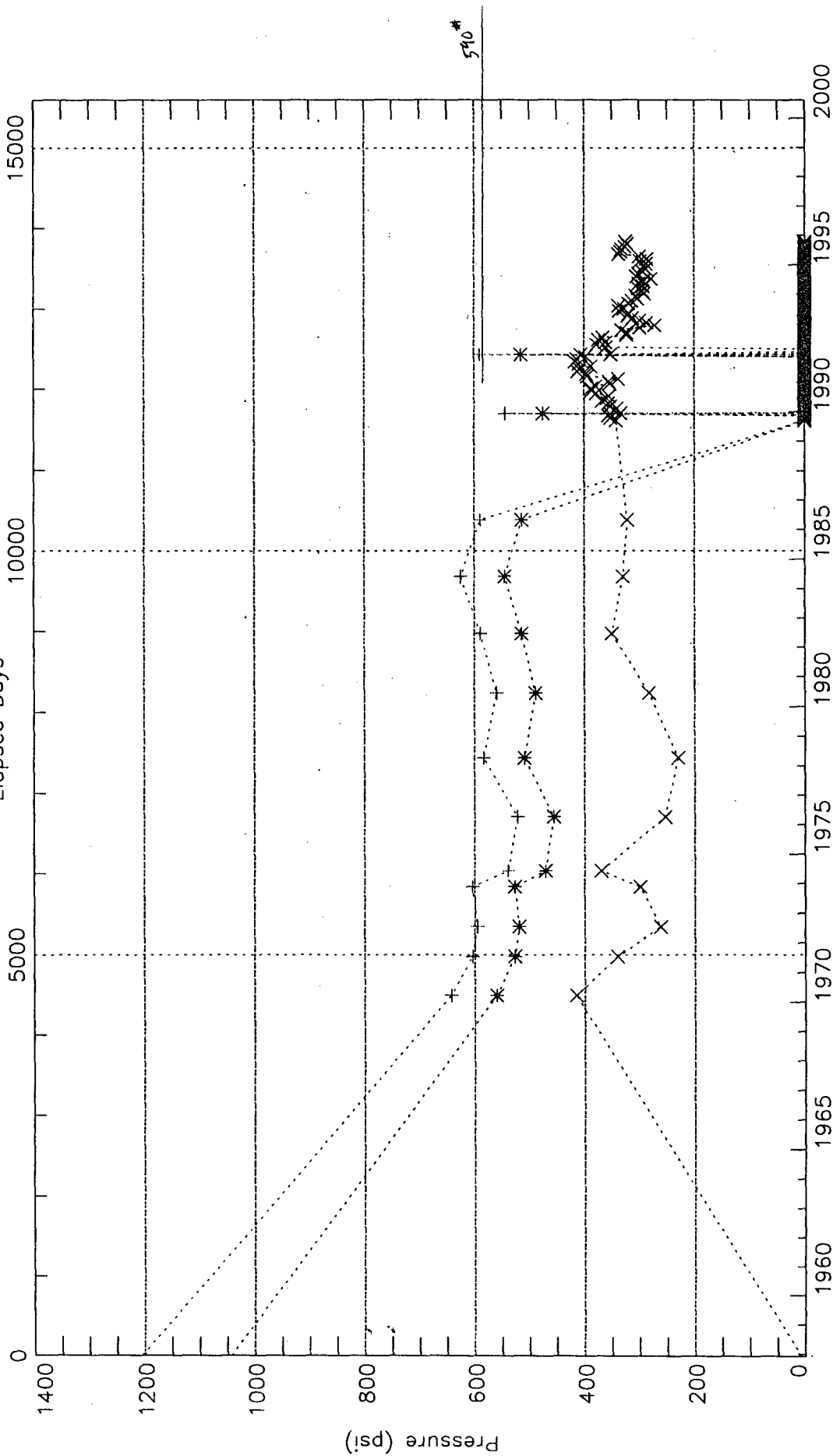

Date (Years)

WH\_SIP (\*)  
BHP (+)  
WH\_FTP (x)

Well ID: 300450709400 604MVRD  
Well Name: STOREY LS 1-4 /MV/ 003M26  
Operator: AMOCO PRODUCTION COMPANY

User: zmdr16  
Owner: 2DMHF

# Single Well Gas3D Elapsed Days

Description 1  
Mon Sep 23 08:10:18 1996

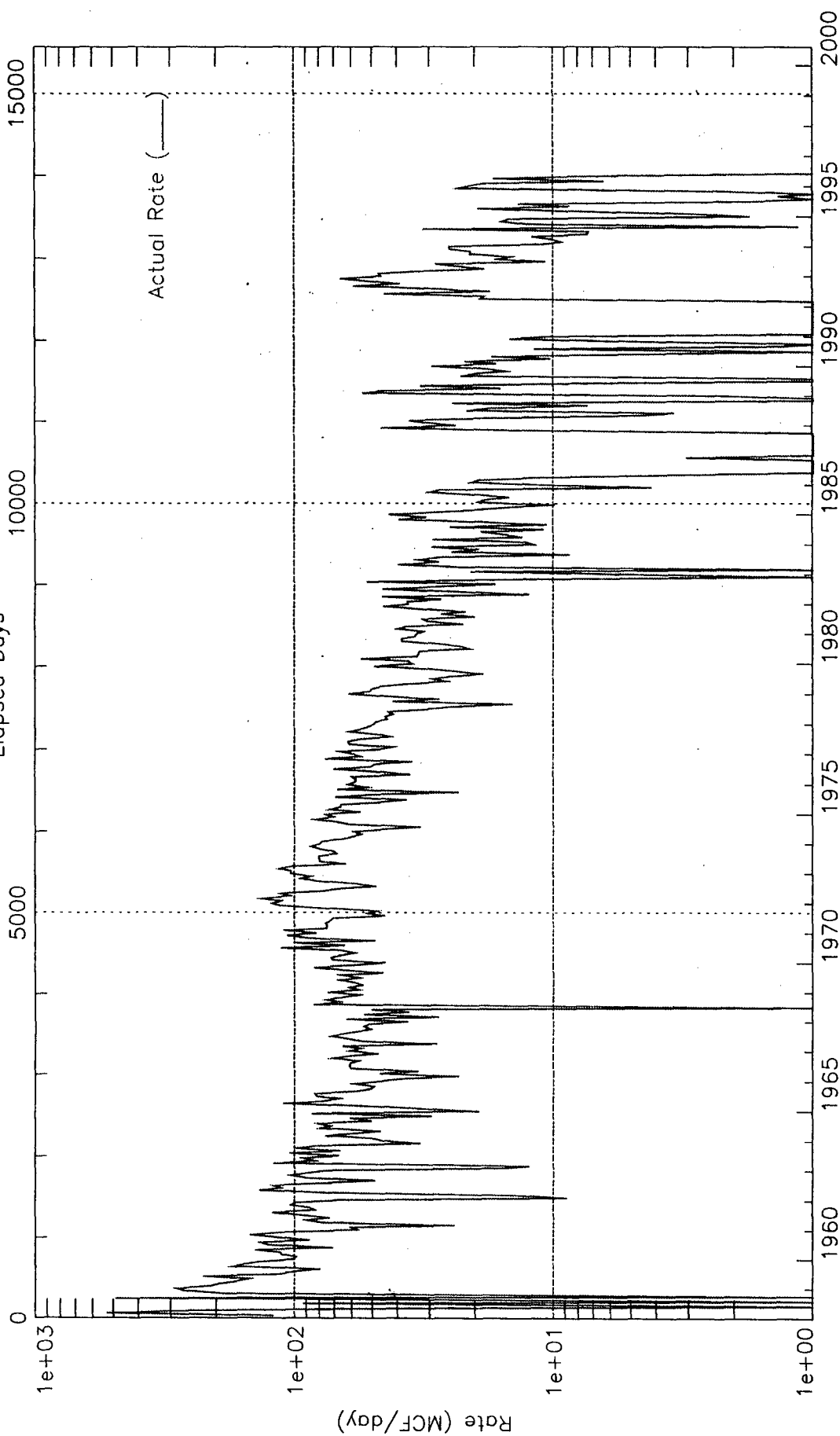

Date (Years)

Cum Gas= 708.50 MMCF

Well ID: 300450709400 604PCCF  
Well Name: STOREY LS 3-10 /PC/ 003M26  
Operator: AMOCO PRODUCTION COMPANY

User: zmdr16  
Owner: 2DMHF

# Single Well Gas3D

Description 1  
Mon Sep 23 08:10:23 1996

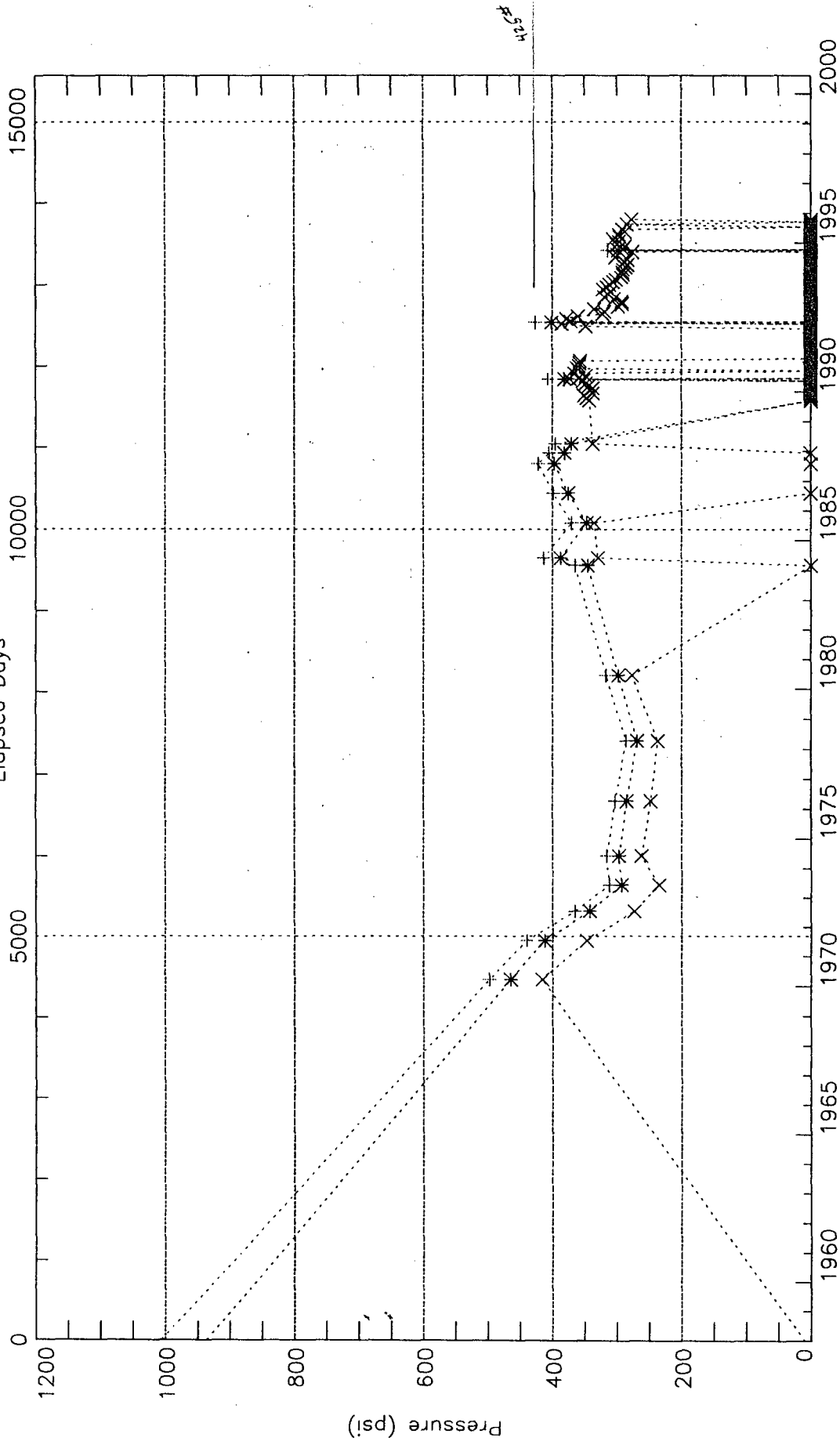

Date (Years)

Well ID: 300450709400 604PCCF  
Well Name: STOREY LS 3-10 /PC/ 003M26  
Operator: AMOCO PRODUCTION COMPANY

**OFFSET OPERATORS**  
**Storey LS #3**

Burlington Resources Oil and Gas Co.  
P.O. Box 4289  
Farmington, NM 87499