

DATE IN 2/25/97	SUSPENSE 3/17/97	ENGINEER BS	LOGGED KV	TYPE DHC
--------------------	---------------------	----------------	--------------	-------------

ABOVE THIS LINE FOR DIVISION USE ONLY

**NEW MEXICO OIL CONSERVATION DIVISION**  
- Engineering Bureau -

1505

**ADMINISTRATIVE APPLICATION COVERSHEET**

THIS COVERSHEET IS MANDATORY FOR ALL ADMINISTRATIVE APPLICATIONS FOR EXCEPTIONS TO DIVISION RULES AND REGULATIONS

**Application Acronyms:**

[NSP-Non-Standard Proration Unit] [NSL-Non-Standard Location]  
[DD-Directional Drilling] [SD-Simultaneous Dedication]  
[DHC-Downhole Commingling] [CTB-Lease Commingling] [PLC-Pool/Lease Commingling]  
[PC-Pool Commingling] [OLS - Off-Lease Storage] [OLM-Off-Lease Measurement]  
[WFX-Waterflood Expansion] [PMX-Pressure Maintenance Expansion]  
[SWD-Salt Water Disposal] [IPI-Injection Pressure Increase]  
[EOR-Qualified Enhanced Oil Recovery Certification] [PPR-Positive Production Response]

**[1] TYPE OF APPLICATION - Check Those Which Apply for [A]**

[A] Location - Spacing Unit - Directional Drilling  
☐ NSL ☐ NSP ☐ DD ☐ SD

Check One Only for [B] and [C]

[B] Commingling - Storage - Measurement  
☒ DHC ☐ CTB ☐ PLC ☐ PC ☐ OLS ☐ OLM

[C] Injection - Disposal - Pressure Increase - Enhanced Oil Recovery  
☐ WFX ☐ PMX ☐ SWD ☐ IPI ☐ EOR ☐ PPR

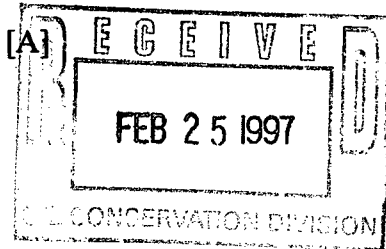

**[2] NOTIFICATION REQUIRED TO: - Check Those Which Apply, or ☐ Does Not Apply**

- [A] ☐ Working, Royalty or Overriding Royalty Interest Owners
- [B] ☐ Offset Operators, Leaseholders or Surface Owner
- [C] ☐ Application is One Which Requires Published Legal Notice
- [D] ☒ Notification and/or Concurrent Approval by BLM or SLO  
U.S. Bureau of Land Management - Commissioner of Public Lands, State Land Office
- [E] ☐ For all of the above, Proof of Notification or Publication is Attached, and/or,
- [F] ☐ Waivers are Attached

**[3] INFORMATION / DATA SUBMITTED IS COMPLETE - Statement of Understanding**

I hereby certify that I, or personnel under my supervision, have read and complied with all applicable Rules and Regulations of the Oil Conservation Division. Further, I assert that the attached application for administrative approval is accurate and complete to the best of my knowledge and where applicable, verify that all interest (WI, RI, ORRI) is common. I understand that any omission of data, information or notification is cause to have the application package returned with no action taken.

Note: Statement must be completed by an individual with supervisory capacity.

Peggy Bradfield

Regulatory/Compliance Administrator

Print or Type Name

Signature

Title

Date

2-24-97

# BURLINGTON RESOURCES

---

SAN JUAN DIVISION

February 24, 1997

SENT FEDERAL EXPRESS

Mr. William LeMay  
New Mexico Oil Conservation Division  
2040 South Pacheco Street  
Santa Fe, New Mexico 87505

Re: San Juan 28-5 Unit #84E  
790'FSL, 1450'FEL Section 16, T-28-N, R-05-W, Rio Arriba County, NM  
API #30-039-23836

Dear Mr. LeMay:

This is a request for administrative approval for downhole commingling the Blanco Mesa Verde and Basin Dakota pools in the subject well. This well was originally drilled as a Dakota; it is intended to add the Mesa Verde and commingle.

To comply with the New Mexico Oil Conservation Division rules, Burlington Resources Oil & Gas Company is submitting the following for your approval of this commingling:

1. Form C107A - Application for Downhole Commingling;
2. C-102 plat for each zone showing its spacing unit and acreage dedication;
3. Production curve for Dakota and expected production curve for the Mesa Verde;
4. Notification list of offset operators - Burlington is the operator of the unit;
5. Shut in wellhead pressure and calculated down hole pressure of surrounding wells;
6. Nine-section plats for the Mesa Verde and Dakota.

Notification of Mesa Verde and Dakota interest owners is covered under Order R-10695 dated November 12, 1996 attached.

We will consult with the Supervisor of the Aztec District Office of the New Mexico Oil Conservation Division to establish an allocation formula.

Please let me know if you require additional data.

Sincerely,



Peggy Bradfield  
Regulatory/Compliance Administrator

xc: Bureau of Land Management - hand delivered

DISTRICT I  
P.O. Box 1980, Hobbs, NM 88241-1980  
DISTRICT II  
811 South First St., Artesia, NM 88210-2835  
DISTRICT III  
1000 Rio Brazos Rd, Aztec, NM 87410-1693

State of New Mexico  
Energy, Minerals and Natural Resources Department  
OIL CONSERVATION DIVISION  
2040 S. Pacheco  
Santa Fe, New Mexico 87505-6429

Form C-107-A  
New 3-12-96

APPROVAL PROCESS :

☒ Administrative ☐ Hearing

EXISTING WELLBORE

☒ YES ☐ NO

APPLICATION FOR DOWNHOLE COMMINGLING

Burlington Resources Oil & Gas Company

PO Box 4289, Farmington, NM 87499

Operator Address  
San Juan 28-5 Unit 84E O 16-28-5 Rio Arriba  
Lease Well No. Unit Ltr. - Sec - Twp - Rge County  
Spacing Unit Lease Types: (check 1 or more)  
OGRID NO. 14538 Property Code 7460 API NO. 30-039-23836 Federal ☒ State (and/or) Fee

The following facts are submitted in support of downhole commingling:	Upper Zone	Intermediate Zone	Lower Zone
1. Pool Name and Pool Code	Blanco Mesaverde - 72319		Basin Dakota - 71599
2. Top and Bottom of Pay Section (Perforations)	will be supplied upon completion		will be supplied upon completion
3. Type of production (Oil or Gas)	gas		gas
4. Method of Production (Flowing or Artificial Lift)	flowing		flowing
5. Bottomhole Pressure Oil Zones - Artificial Lift: Estimated Current Gas & Oil - Flowing: Measured Current All Gas Zones: Estimated or Measured Original	(Current) a. 590 psi (see attachment) (Original) b. 1254 psi (see attachment)	a.  b.	a. 842 psi (see attachment)  b. 2329 psi (see attachment)
6. Oil Gravity (°API) or Gas BTU Content	BTU 1149		BTU 1118
7. Producing or Shut-In?	shut in		producing
Production Marginal? (yes or no)	no		yes
* If Shut-In and oil/gas/water rates of last production <small>Note: For new zones with no production history, applicant shall be required to attach production estimates and supporting data</small>	Date: n/a Rates:	Date: Rates:	Date: n/a Rates:
* If Producing, give data and oil/gas/water of recent test (within 60 days)	Date: n/a Rates:	Date: Rates:	Date: n/a Rates:
8. Fixed Percentage Allocation Formula -% for each zone (total of %'s to equal 100%)	Oil: % Gas: % will be supplied upon completion	Oil: % Gas: %	Oil: % Gas: % will be supplied upon completion

9. If allocation formula is based upon something other than current or past production, or is based upon some other method, submit attachments with supporting data and/or explaining method and providing rate projections or other required data.
10. Are all working, overriding, and royalty interests identical in all commingled zones? ☐ Yes ☒ No  
If not, have all working, overriding, and royalty interests been notified by certified mail? ☐ Yes ☒ No  
Have all offset operators been given written notice of the proposed downhole commingling? ☒ Yes ☐ No
11. Will cross-flow occur? ☒ Yes ☐ No If yes, are fluids compatible, will the formations not be damaged, will any cross-flowed production be recovered, and will the allocation formula be reliable. ☒ Yes ☐ No (If No, attach explanation)
12. Are all produced fluids from all commingled zones compatible with each other? ☒ Yes ☐ No
13. Will the value of production be decreased by commingling? ☐ Yes ☒ No (If Yes, attach explanation)
14. If this well is on, or communitized with, state or federal lands, either the Commissioner of Public Lands or the United States Bureau of Land Management has been notified in writing of this application. ☒ Yes ☐ No
15. NMOCD Reference Cases for Rule 303(D) Exceptions: ORDER NO(S). Reference Order R-10695 attached
16. ATTACHMENTS:  
\* C-102 for each zone to be commingled showing its spacing unit and acreage dedication.  
\* Production curve for each zone for at least one year. (If not available, attach explanation.)  
\* For zones with no production history, estimated production rates and supporting data.  
\* Data to support allocation method or formula.  
\* Notification list of all offset operators.  
\* Notification list of working, overriding, and royalty interests for uncommon interest cases.  
\* Any additional statements, data, or documents required to support commingling.

I hereby certify that the information above is true and complete to the best of my knowledge and belief.

SIGNATURE Sean Woolverton TITLE Production Engineer DATE 2/21/97

TYPE OR PRINT NAME Sean Woolverton TELEPHONE NO. ( 505 ) 326-9700

NEW MEXICO OIL CONSERVATION COMMISSION  
WELL LOCATION AND ACREAGE DEDICATION PLAT

Form C-102  
Supersedes C-128  
Effective 1-1-55

All distances must be from the outer boundaries of the Section.

Operator <b>EL PASO NATURAL GAS COMPANY</b>			Lease <b>SAN JUAN 28-5 UNIT (SF 080516)</b>		Well No. <b>81E</b>
Unit Letter <b>0</b>	Section <b>16</b>	Township <b>28 N</b>	Range <b>5 W</b>	County <b>Rio Arriba</b>	
Actual Footage Location of Well: <b>790</b> feet from the <b>South</b> line and <b>1450</b> feet from the <b>East</b> line					
Ground Level Elev. <b>6575</b>	Producing Formation <b>Dakota</b>		Pool <b>Basin</b>		Dedicated Acreage: <b>320</b> Acres

1. Outline the acreage dedicated to the subject well by colored pencil or hachure marks on the plat below.
2. If more than one lease is dedicated to the well, outline each and identify the ownership thereof (both as to working interest and royalty).
3. If more than one lease of different ownership is dedicated to the well, have the interests of all owners been consolidated by communitization, unitization, force-pooling, etc?

☒ Yes ☐ No If answer is "yes," type of consolidation Unitization

If answer is "no," list the owners and tract descriptions which have actually been consolidated. (Use reverse side of this form if necessary.)

No allowable will be assigned to the well until all interests have been consolidated (by communitization, unitization, forced-pooling, or otherwise) or until a non-standard unit, eliminating such interests, has been approved by the Commission.

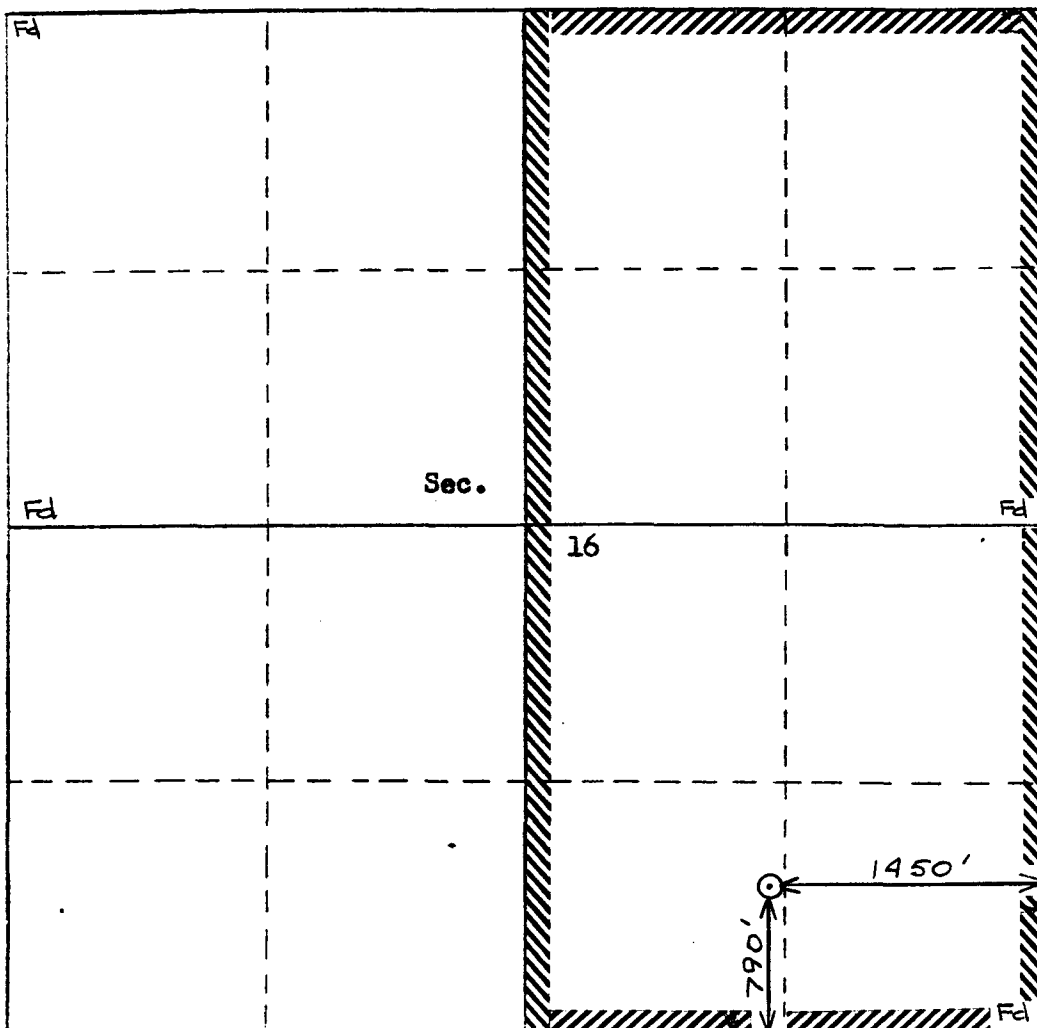

CERTIFICATION

I hereby certify that the information contained herein is true and complete to the best of my knowledge and belief.

Name  
**Drilling Clerk**  
Position  
**El Paso Natural Gas**  
Company

Date

I hereby certify that the well location shown on this plat was plotted from field notes of actual surveys made by me or under my supervision, and that the same is true and correct to the best of my knowledge and belief.

Date Surveyed **11-35**  
**WILLIAM E. MAHINKA**  
**NEW MEXICO**  
Registered Professional Engineer and Land Surveyor  
#8466  
Certificate

Expected Production Curve

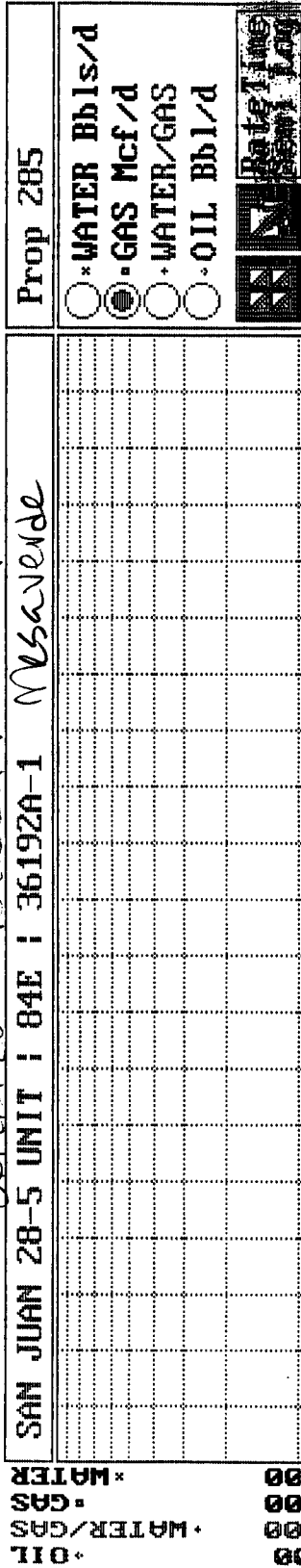

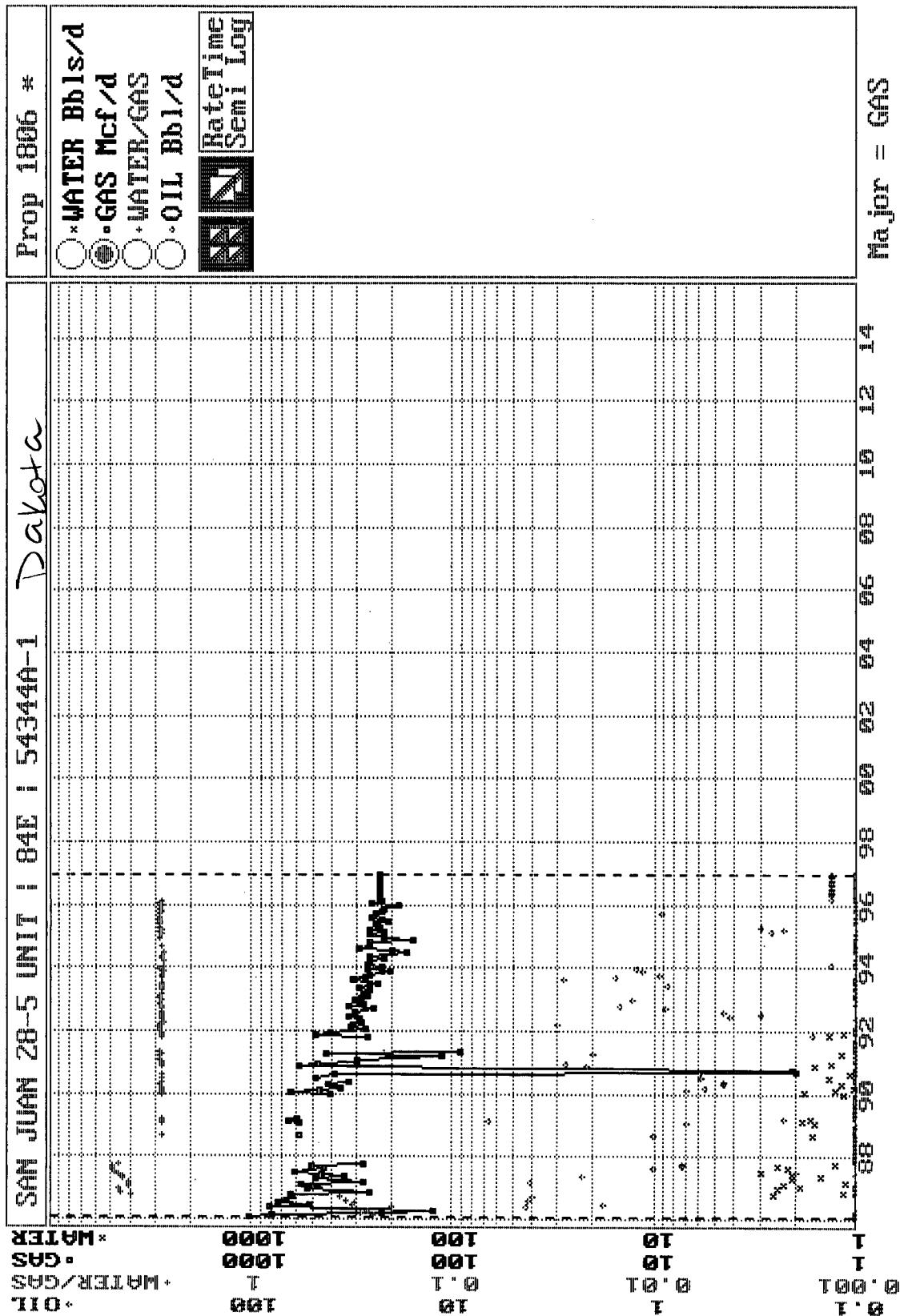

***BURLINGTON RESOURCES OIL AND GAS COMPANY***

**San Juan 28-5 Unit #84E  
OFFSET OPERATOR \ OWNER PLAT**

**Mesaverde (S/2)/Dakota (E/2) Formations Commingle Well**

**Township 28 North, Range 5 West**

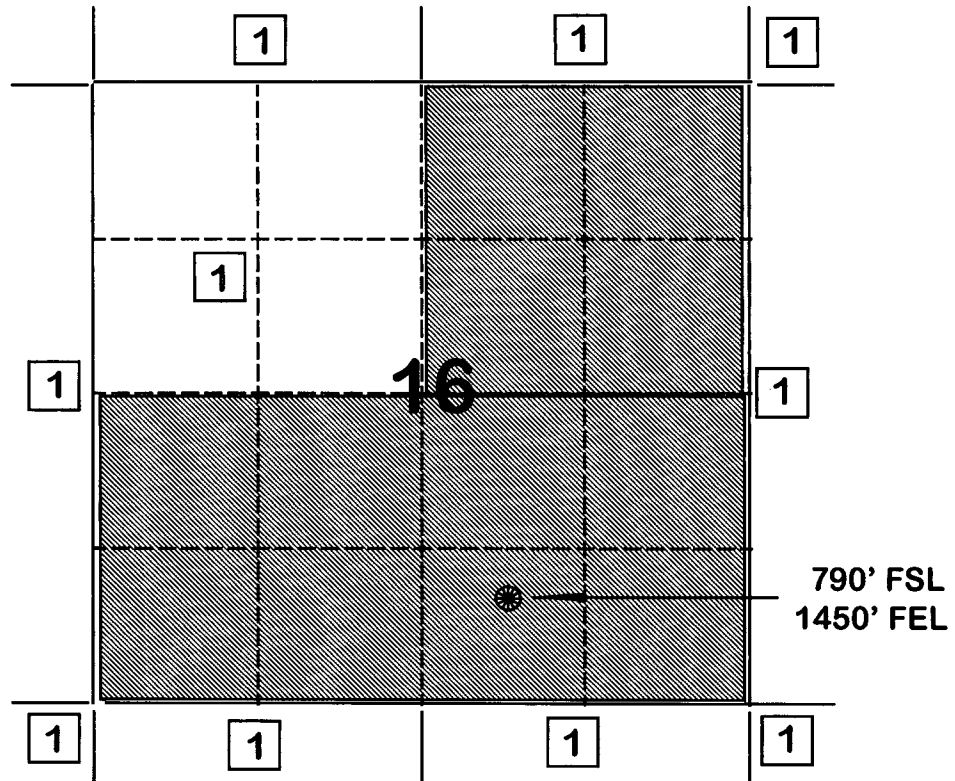

**1) Burlington Resources Oil and Gas Company Successor to Meridian Oil Inc.**

Page No.: 8  
 Print Time: Thu Jan 02 14:42:14 1997  
 Property ID: 1806  
 Property Name: SAN JUAN 28-5 UNIT | 84E | 54344A-1 45559  
 Table Name: K:\ARIES\RR97PDP\TEST.DBF

--DATE--	---CUM GAS--	M SIWHP
.....	.....Mcf.....	.....Psi.....
09/27/71	0	1902.0
05/15/72	0	1584.0
04/24/73	0	1573.0
04/15/75	0	1217.0
06/15/77	0	1147.0
06/05/79	0	1062.0
05/05/81	0	1027.0
11/02/83	0	1140.0
09/26/85	0	977.0
11/14/85	0	1660.0
03/11/86	62794	1228.0
11/03/87	348333	997.0
08/02/88	367649	1202.0
10/04/88	366139	1132.0
04/10/90	491892	1006.0
09/29/92	727889	805.0
01/31/94	847760	702.0



**FLOWING AND STATIC BHP  
CULLENDER AND SMITH METHOD**

VERSION 1.0 3/13/94

GAS GRAVITY	0.654
COND. OR MISC. (C/M)	C
%N2	0.82
%CO2	0.69
%H2S	0
DIAMETER (IN)	1.5
DEPTH (FT)	7905
SURFACE TEMPERATURE (DEG F)	60
BOTTOMHOLE TEMPERATURE (DEG F)	200
FLOWRATE (MCFPD)	0
SURFACE PRESSURE (PSIA)	1902
BOTTOMHOLE PRESSURE (PSIA)	2328.7

SAN JUAN 28-5 UNIT #84E DAKOTA - ORIGINAL

**FLOWING AND STATIC BHP  
CULLENDER AND SMITH METHOD**

VERSION 1.0 3/13/94

GAS GRAVITY	<b>0.654</b>
COND. OR MISC. (C/M)	<b>C</b>
%N2	<b>0.82</b>
%CO2	<b>0.69</b>
%H2S	<b>0</b>
DIAMETER (IN)	<b>1.5</b>
DEPTH (FT)	<b>7905</b>
SURFACE TEMPERATURE (DEG F)	<b>60</b>
BOTTOMHOLE TEMPERATURE (DEG F)	<b>200</b>
FLOWRATE (MCFPD)	<b>0</b>
SURFACE PRESSURE (PSIA)	<b>702</b>
BOTTOMHOLE PRESSURE (PSIA)	<b>841.9</b>

SAN JUAN 28-5 UNIT #84E DAKOTA - CURRENT

Page No.: 4  
 Print Time: Fri Jan 03 14:19:48 1997  
 Property ID: 8443  
 Property Name: SAN JUAN 28-5 UNIT | 6 | 49042A-1 28-5 #84E mv offset  
 Table Name: K:\ARIES\RR97PDP\TEST.DBF

--DATE--	---CUM GAS--	M SIWHP
-----	-----	-----
-----	-----	-----

12/20/54	0	1071.0
08/24/55	24000	929.0
08/31/56	66000	889.0
07/30/57	120000	782.0
11/06/58	180000	765.0
08/06/59	221000	761.0
06/14/60	270000	738.0
06/13/61	321000	713.0
07/31/62	369000	720.0
01/07/63	387000	741.0
01/02/64	421000	776.0
09/01/65	495000	699.0
08/19/66	541000	676.0
03/07/67	568000	676.0
03/01/68	612000	688.0
06/19/70	723257	622.0
04/27/71	755967	581.0
05/15/72	803440	452.0
05/02/74	896537	566.0
04/09/76	986275	632.0
05/15/78	1053519	564.0
09/19/86	1221910	689.0
06/17/91	1274723	770.0
07/16/91	1275209	782.0
03/13/94	1302733	803.0
05/31/94	1352401	511.0

**FLOWING AND STATIC BHP  
CULLENDER AND SMITH METHOD**

VERSION 1.0 3/13/94

GAS GRAVITY	0.681
COND. OR MISC. (C/M)	C
%N2	0.26
%CO2	1.09
%H2S	0
DIAMETER (IN)	2
DEPTH (FT)	5823
SURFACE TEMPERATURE (DEG F)	60
BOTTOMHOLE TEMPERATURE (DEG F)	150
FLOWRATE (MCFPD)	0
SURFACE PRESSURE (PSIA)	1071
BOTTOMHOLE PRESSURE (PSIA)	1253.7

SAN JUAN 28-5 UNIT #6 MESAVERDE - ORIGINAL

**FLOWING AND STATIC BHP  
CULLENDER AND SMITH METHOD**

VERSION 1.0 3/13/94

GAS GRAVITY	0.681
COND. OR MISC. (C/M)	C
%N2	0.26
%CO2	1.09
%H2S	0
DIAMETER (IN)	2
DEPTH (FT)	5823
SURFACE TEMPERATURE (DEG F)	60
BOTTOMHOLE TEMPERATURE (DEG F)	150
FLOWRATE (MCFPD)	0
SURFACE PRESSURE (PSIA)	511
BOTTOMHOLE PRESSURE (PSIA)	589.9

SAN JUAN 28-5 UNIT #6 MESAVERDE - CURRENT

# SAN JUAN 28-5 UNIT

<p>7 7A 7B 7C</p>	<p>8 8A 8B 8C</p>	<p>9 9A 9B 9C</p>	<p>10 10A 10B 10C</p>	<p>11 11A 11B 11C</p>	<p>12 12A 12B 12C</p>
<p>18 18A 18B 18C</p>	<p>17 17A 17B 17C</p>	<p>16 16A 16B 16C</p>	<p>15 15A 15B 15C</p>	<p>14 14A 14B 14C</p>	<p>13 13A 13B 13C</p>
<p>19 19A 19B 19C</p>	<p>20 20A 20B 20C</p>	<p>21 21A 21B 21C</p>	<p>22 22A 22B 22C</p>	<p>23 23A 23B 23C</p>	<p>24 24A 24B 24C</p>
<p>30 30A 30B 30C</p>	<p>29 29A 29B 29C</p>	<p>28 28A 28B 28C</p>	<p>27 27A 27B 27C</p>	<p>26 26A 26B 26C</p>	<p>25 25A 25B 25C</p>
<p>31 31A 31B 31C</p>	<p>32 32A 32B 32C</p>	<p>33 33A 33B 33C</p>	<p>34 34A 34B 34C</p>	<p>35 35A 35B 35C</p>	<p>36 36A 36B 36C</p>

**STATE OF NEW MEXICO  
ENERGY, MINERALS AND NATURAL RESOURCES DEPARTMENT  
OIL CONSERVATION DIVISION**

**IN THE MATTER OF THE HEARING CALLED  
BY THE OIL CONSERVATION DIVISION FOR  
THE PURPOSE OF CONSIDERING:**

**CASE NO. 11627  
ORDER NO. R-10695**

**APPLICATION OF BURLINGTON RESOURCES  
OIL & GAS COMPANY FOR THE ESTABLISHMENT  
OF A DOWNHOLE COMMINGLING "REFERENCE  
CASE" FOR ITS SAN JUAN 28-5 UNIT PURSUANT  
TO DIVISION RULE 303.E. AND THE ADOPTION  
OF SPECIAL ADMINISTRATIVE RULES THEREFOR,  
SAN JUAN COUNTY, NEW MEXICO.**

**ORDER OF THE DIVISION**

**BY THE DIVISION:**

This cause came on for hearing at 8:15 a.m. on October 17 and November 7, 1996, at Santa Fe, New Mexico, before Examiners David R. Catanach and Michael E. Stogner, respectively.

NOW, on this 12th day of November, 1996, the Division Director, having considered the testimony, the record and the recommendations of the Examiner, and being fully advised in the premises,

**FINDS THAT:**

(1) Due public notice having been given as required by law, the Division has jurisdiction of this cause and the subject matter thereof.

(2) The applicant, Burlington Resources Oil & Gas Company (Burlington), pursuant to the provisions of Division Rule 303.E., seeks to establish a downhole commingling "reference case" to provide exceptions for (a) marginal economic criteria, (b) pressure criteria, (c) allocation formulas and (d) modification of notification rules on a unit-wide basis for downhole commingling of Dakota, Mesaverde, Fruitland Coal and Pictured Cliffs gas production within existing or future drilled wells within the San Juan 28-5 Unit, San Juan County, New Mexico.

(3) Division Rule No. 303.E., amended by Order No. R-10470-A, currently states:

"If sufficient data exists on a lease, pool, formation, geographic area, etc., so as to render it unnecessary to repeatedly provide such data on Form C-107-A, an operator may except any of the various criteria required under Paragraph 303.D. of this rule by establishing a "reference case". The Division, upon its own motion, or by application from an operator, may establish "reference cases" either administratively or by hearing. Upon Division approval of such "reference cases" for specific criteria, subsequent applications to downhole commingle (Form C-107-A) will be required only to cite the Division order number which established such exceptions and shall not be required to submit data for those criteria."

(4) The applicant is the current operator of the San Juan 28-5 Unit which encompasses some 17,399 acres in Township 28 North, Range 5 West, NMPM, San Juan County, New Mexico.

(5) Within the San Juan 28-5 Unit, the applicant currently operates sixty-seven (67) Basin-Dakota Gas Pool wells, seventy-one (71) Blanco-Mesaverde Gas Pool wells, sixteen (16) Gobernador-Pictured Cliffs, Oso-Pictured Cliffs and Tapacito-Pictured Cliffs Gas Pool wells, and nineteen (19) Basin-Fruitland Coal Gas Pool wells.

(6) According to its evidence and testimony, Burlington seeks to:

- a) establish a "reference case" for marginal economic criteria in the Dakota and Pictured Cliffs formations whereby these formations and/or pools may be identified as "marginal" on Form C-107-A's subsequently filed for wells within the San Juan 28-5 Unit. The applicant further proposes that the data provided in the immediate case serve as supplemental data or confirmation that these formations and/or pools should be classified as "marginal";
- b) establish a "reference case" for pressure criteria in the Dakota and Pictured Cliffs formations whereby the Division may utilize data provided in the immediate case to verify the pressure data provided on Form C-107-A's subsequently filed for wells within the San Juan 28-5 Unit;



- c) establish a "reference case" whereby the Division utilizes the data presented in the immediate case to endorse or approve certain methods of allocating production whereby the applicant need not submit additional data or justification when proposing a certain method of allocating production on Form C-107-A's subsequently filed for wells within the San Juan 28-5 Unit; and,
- d) establish a "reference case" or an administrative procedure for authorizing the downhole commingling of existing or future drilled wells within the San Juan 28-5 Unit without additional notice to each affected interest owner as required by Division Rule No. 303.D.

(7) In support of its request to except marginal economic criteria, the applicant presented geologic and engineering evidence and testimony which indicates that within the San Juan 28-5 Unit:

- a) the structure and thickness of the Dakota and Pictured Cliffs formations are very consistent;
- b) the average recoverable Dakota and Pictured Cliffs gas reserves underlying an undeveloped drill block are approximately 1,258 MMCFG and 77 MMCFG, respectively;
- c) the average initial producing rate for a newly drilled or recompleted Dakota and Pictured Cliffs gas well is approximately 276 MCFGD and 136 MCFGD, respectively; and,
- d) the estimated ultimate gas recoveries and initial producing rates from the Dakota and Pictured Cliffs formations are insufficient to justify drilling stand alone wells and/or dually completed wells to recover such gas reserves.

(8) The evidence and testimony presented by the applicant indicates that the Dakota and Pictured Cliffs formations within the San Juan 28-5 Unit should be properly classified as "marginal".

(9) In support of its request to except pressure criteria within the Dakota and Pictured Cliffs formations within the San Juan 28-5 Unit, the applicant presented engineering evidence and testimony which indicates that:

- a) the average shut-in bottomhole pressure within the Dakota and Pictured Cliffs formations at the time of initial development were approximately 3,149 psi and 1,143 psi, respectively; and,
  - b) the average current shut-in bottomhole pressure within the Dakota and Pictured Cliffs formations are approximately 1,059 psi and 714 psi, respectively.
- (10) There is sufficient pressure data available within the San Juan 28-5 Unit so as to except pressure criteria as proposed by the applicant.
- (11) The applicant testified that various allocation methods will be utilized for downhole commingled wells within the San Juan 28-5 Unit depending on the circumstances. Some of the methods and circumstances are described as follows:
- a) the subtraction method will likely be utilized in those instances involving the Basin-Fruitland Coal Gas Pool and in those instances where a zone with a well established decline rate is commingled with a newly completed zone;
  - b) a fixed allocation formula will be utilized in those instances where production history for both zones is available, or in those instances where newly completed zones are tested and stabilized flow rates obtained.
- (12) The allocation methods proposed by the applicant are routinely utilized by industry and approved by the Division and therefore, the proposal to except allocation formulas should be approved.
- (13) In support of its request to establish a "reference case" or administrative procedure for providing notice within the San Juan 28-5 Unit the applicant presented evidence and testimony which indicates that:
- a) the interest ownership between two zones within a given wellbore in the San Juan 28-5 Unit is generally not common;
  - b) pursuant to Division Rule No. 303.D., applicant is currently required to notify all interest owners within the San Juan 28-5 Unit every time a Form C-107-A is submitted to the Division. There are a considerable number of such interest owners within the unit;

- c) providing notice to each interest owner within the San Juan 28-5 Unit of subsequent downhole comminglings is unnecessary and is an excessive burden on the applicant;
- d) the downhole commingling of wells within the San Juan 28-5 Unit Area will benefit working, royalty, and overriding royalty interest owners. In addition, the downhole commingling of wells within the San Juan 28-5 Unit should not violate the correlative rights of any interest owner;
- e) no interest owner appeared at the hearing in opposition to the establishment of a "reference case" or administrative procedure for notice.

(14) An administrative procedure should be established within the San Juan 28-5 Unit for obtaining approval for subsequent downhole commingled wells without notice to Unit interest owners, provided however that, all other provisions contained within Division Rule No. 303.C. are complied with.

(15) Approval of the proposed "reference cases" for marginal economic criteria, pressure criteria, allocation formulas and notice will lessen the burden on the applicant insofar as providing the data required pursuant to Division Rule No. 303.D. and Form C-107-A, will provide the applicant a streamlined method for obtaining downhole commingling approvals within the San Juan 28-5 Unit, and will not violate correlative rights.

**IT IS THEREFORE ORDERED THAT:**

(1) The application of Burlington Resources Oil & Gas Company to establish a "reference case" for (a) marginal economic criteria, (b) pressure criteria, (c) allocation formulas and (d) modification of notification rules on a unit-wide basis for downhole commingling of Dakota, Mesaverde, Fruitland Coal and Pictured Cliffs gas production within existing or future drilled wells within the San Juan 28-5 Unit, San Juan County, New Mexico, is hereby approved.

(2) Upon filing of Division Form No. C-107-A's for wells subsequently downhole commingled within the San Juan 28-5 Unit Area, the applicant shall not be required to submit supporting data to justify the classification of the Pictured Cliffs and Dakota formations as "marginal", supporting data to verify the Pictured Cliffs and Dakota pressure information provided, and support or justification for utilizing a given method or formula for allocation of production, provided however, in the event any of the data described above appearing on Form C-107-A appears to be beyond the data range provided in this case, the Division may require the submittal of additional supporting data.

(3) In order to obtain Division authorization to downhole commingle wells within the San Juan 28-5 Unit, the applicant shall file a Form C-107-A with the Santa Fe and Aztec Offices of the Division. Such application shall contain all the information required under Rule No. 303.C. of the Division Rules and Regulations, provided however that the applicant shall not be required to provide notice to all interest owners within the San Juan 28-5 Unit of such proposed commingling.

(4) Jurisdiction of this cause is retained for the entry of such further orders as the Division may deem necessary.

DONE at Santa Fe, New Mexico, on the day and year hereinabove designated.

STATE OF NEW MEXICO  
OIL CONSERVATION DIVISION

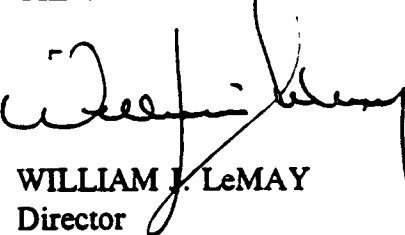

WILLIAM J. LeMAY  
Director

S E A L