

DATE IN 12-7-05	SUSPENSE 12/22/05	ENGINEER Catanach	LOGGED IN 12-7-05	TYPE PMX	APPROVAL P5em0534147548
--------------------	----------------------	----------------------	----------------------	-------------	----------------------------

ABOVE THIS LINE FOR DIVISION USE ONLY

## NEW MEXICO OIL CONSERVATION DIVISION

- Engineering Bureau -

1220 South St. Francis Drive, Santa Fe, NM 87505



242

### ADMINISTRATIVE APPLICATION CHECKLIST

THIS CHECKLIST IS MANDATORY FOR ALL ADMINISTRATIVE APPLICATIONS FOR EXCEPTIONS TO DIVISION RULES AND REGULATIONS WHICH REQUIRE PROCESSING AT THE DIVISION LEVEL IN SANTA FE

#### Application Acronyms:

**[NSL-Non-Standard Location]** **[NSP-Non-Standard Proration Unit]** **[SD-Simultaneous Dedication]**  
**[DHC-Downhole Commingling]** **[CTB-Lease Commingling]** **[PLC-Pool/Lease Commingling]**  
**[PC-Pool Commingling]** **[OLS - Off-Lease Storage]** **[OLM-Off-Lease Measurement]**  
**[WFX-Waterflood Expansion]** **[PMX-Pressure Maintenance Expansion]**  
**[SWD-Salt Water Disposal]** **[IPI-Injection Pressure Increase]**  
**[EOR-Qualified Enhanced Oil Recovery Certification]** **[PPR-Positive Production Response]**

#### [1] TYPE OF APPLICATION - Check Those Which Apply for [A]

[A] Location - Spacing Unit - Simultaneous Dedication  
☐ NSL ☐ NSP ☐ SD

Check One Only for [B] or [C]

[B] Commingling - Storage - Measurement  
☐ DHC ☐ CTB ☐ PLC ☐ PC ☐ OLS ☐ OLM

[C] Injection - Disposal - Pressure Increase - Enhanced Oil Recovery  
☐ WFX ☒ PMX ☐ SWD ☐ IPI ☐ EOR ☐ PPR

[D] Other: Specify \_\_\_\_\_

#### [2] NOTIFICATION REQUIRED TO: - Check Those Which Apply, or ☐ Does Not Apply

[A] ☐ Working, Royalty or Overriding Royalty Interest Owners

[B] ☒ Offset Operators, Leaseholders or Surface Owner

[C] ☒ Application is One Which Requires Published Legal Notice

[D] ☐ Notification and/or Concurrent Approval by BLM or SLO  
 U.S. Bureau of Land Management - Commissioner of Public Lands, State Land Office

[E] ☒ For all of the above, Proof of Notification or Publication is Attached, and/or,

[F] ☐ Waivers are Attached

#### [3] SUBMIT ACCURATE AND COMPLETE INFORMATION REQUIRED TO PROCESS THE TYPE OF APPLICATION INDICATED ABOVE.

[4] **CERTIFICATION:** I hereby certify that the information submitted with this application for administrative approval is **accurate** and **complete** to the best of my knowledge. I also understand that **no action** will be taken on this application until the required information and notifications are submitted to the Division.

Note: Statement must be completed by an individual with managerial and/or supervisory capacity.

Mark Stephens

Print or Type Name

Mark Stephen

Signature

Reg. Comp. Analyst

Title

11/28/05

Date

Mark\_Stephens@oxy.com

e-mail Address



**Occidental Permian Ltd.**

A subsidiary of Occidental Petroleum Corporation

5 Greenway Plaza, Suite 110, Houston, Texas 77046-0521  
P.O. Box 4294, Houston, Texas 77210-4294  
Phone 713.215.7000

December 5, 2005

State of New Mexico  
Energy, Minerals & Natural Resources Department  
Oil Conservation Division  
1220 S. St. Francis Dr.  
Santa Fe, NM 87505

RECEIVED

DEC 7 - 2005

OIL CONSERVATION  
DIVISION

RE: Expansion of Pressure Maintenance Project (R-6199-B, 10/22/01)  
North Hobbs (Grayburg/San Andres) Unit  
Hobbs; Grayburg – San Andres Pool  
Well No. 111 (30-025-05477)  
Letter D, Section 24, T-18-S, R-37-E  
Lea County, NM

Gentlemen:

Occidental Permian Limited Partnership respectfully requests administrative approval for expansion of the subject pressure maintenance project by converting North Hobbs (G/SA) Unit Well No. 111 from production to injection. As such, the following data is submitted in support of this request:

- Administrative Application Checklist
- Form C-108 with miscellaneous data attached
- An injection well data sheet
- A map reflecting the location of the proposed injection well (No. 111). The map identifies all wells located within a two-mile radius of the proposed injector and has a one-half mile radius circle drawn around the well which identifies the well's Area of Review
- Exhibit 1.0 – Area of Review Data
- Exhibit 2.0 – Showing nearby wells which have previously been approved for similar injectants/rates in accordance with Order No. R-6199-B



**Occidental Permian Ltd.**

A subsidiary of Occidental Petroleum Corporation

5 Greenway Plaza, Suite 110, Houston, Texas 77046-0521  
P.O. Box 4294, Houston, Texas 77210-4294  
Phone 713.215.7000

- A list of Offset Operators and Surface Owners (these parties have been notified of this application by certified mail)
- An Affidavit of Publication and copy of the legal advertisement that was published in the county in which the well is located

Your favorable consideration of our request will be appreciated. If you have any questions or need additional information, please call me at (713) 366-5158.

Very truly yours,

Mark Stephens  
Regulatory Compliance Analyst

CC: Oil Conservation Division  
Hobbs District Office  
1625 N. French Drive  
Hobbs, NM 88240

State of New Mexico  
Commissioner of Public Lands  
P.O. Box 1148  
Santa Fe, NM 87504-1148

Offset Operators (see attached list)

Surface Owners (see attached list)

**APPLICATION FOR AUTHORIZATION TO INJECT**

- I. PURPOSE: Secondary Recovery X Pressure Maintenance Disposal Storage  
Application qualifies for administrative approval? X Yes No
- II. OPERATOR: Occidental Permian Limited Partnership  
ADDRESS: P.O. Box 4294, Houston, TX 77210-4294  
CONTACT PARTY: Mark Stephens, Rm. 19.013, GRWY 5 PHONE: (713) 366-5158
- III. WELL DATA: Complete the data required on the reverse side of this form for each well proposed for injection.  
Additional sheets may be attached if necessary.
- IV. Is this an expansion of an existing project? X Yes No  
If yes, give the Division order number authorizing the project: R-6199-B (10/22/01)
- V. Attach a map that identifies all wells and leases within two miles of any proposed injection well with a one-half mile radius circle drawn around each proposed injection well. This circle identifies the well's area of review.
- VI. Attach a tabulation of data on all wells of public record within the area of review which penetrate the proposed injection zone. Such data shall include a description of each well's type, construction, date drilled, location, depth, record of completion, and a schematic of any plugged well illustrating all plugging detail.
- VII. Attach data on the proposed operation, including:
1. Proposed average and maximum daily rate and volume of fluids to be injected;
  2. Whether the system is open or closed;
  3. Proposed average and maximum injection pressure;
  4. Sources and an appropriate analysis of injection fluid and compatibility with the receiving formation if other than reinjected produced water; and,
  5. If injection is for disposal purposes into a zone not productive of oil or gas at or within one mile of the proposed well, attach a chemical analysis of the disposal zone formation water (may be measured or inferred from existing literature, studies, nearby wells, etc.).
- \*VIII. Attach appropriate geologic data on the injection zone including appropriate lithologic detail, geologic name, thickness, and depth. Give the geologic name, and depth to bottom of all underground sources of drinking water (aquifers containing waters with total dissolved solids concentrations of 10,000 mg/l or less) overlying the proposed injection zone as well as any such sources known to be immediately underlying the injection interval.
- IX. Describe the proposed stimulation program, if any.
- \*X. Attach appropriate logging and test data on the well. (If well logs have been filed with the Division, they need not be resubmitted).
- \*XI. Attach a chemical analysis of fresh water from two or more fresh water wells (if available and producing) within one mile of any injection or disposal well showing location of wells and dates samples were taken.
- XII. Applicants for disposal wells must make an affirmative statement that they have examined available geologic and engineering data and find no evidence of open faults or any other hydrologic connection between the disposal zone and any underground sources of drinking water.
- XIII. Applicants must complete the "Proof of Notice" section on the reverse side of this form.
- XIV. Certification: I hereby certify that the information submitted with this application is true and correct to the best of my knowledge and belief.
- NAME: Mark Stephens TITLE: Reg. Comp. Analyst  
SIGNATURE: Mark Stephens DATE: November 28, 2005  
E-MAIL ADDRESS: Mark\_Stephens@oxy.com
- \* If the information required under Sections VI, VIII, X, and XI above has been previously submitted, it need not be resubmitted. Please show the date and circumstances of the earlier submittal: Hearing September 6, 2001; Case No. 12722, Order No. 6199-B, effective October 22, 2001

DISTRIBUTION: Original and one copy to Santa Fe with one copy to the appropriate District Office

### III. WELL DATA

A. The following well data must be submitted for each injection well covered by this application. The data must be both in tabular and schematic form and shall include:

- (1) Lease name; Well No.; Location by Section, Township and Range; and footage location within the section.
- (2) Each casing string used with its size, setting depth, sacks of cement used, hole size, top of cement, and how such top was determined.
- (3) A description of the tubing to be used including its size, lining material, and setting depth.
- (4) The name, model, and setting depth of the packer used or a description of any other seal system or assembly used.

Division District Offices have supplies of Well Data Sheets which may be used or which may be used as models for this purpose. Applicants for several identical wells may submit a "typical data sheet" rather than submitting the data for each well.

B. The following must be submitted for each injection well covered by this application. All items must be addressed for the initial well. Responses for additional wells need be shown only when different. Information shown on schematics need not be repeated.

- (1) The name of the injection formation and, if applicable, the field or pool name.
- (2) The injection interval and whether it is perforated or open-hole.
- (3) State if the well was drilled for injection or, if not, the original purpose of the well.
- (4) Give the depths of any other perforated intervals and detail on the sacks of cement or bridge plugs used to seal off such perforations.
- (5) Give the depth to and the name of the next higher and next lower oil or gas zone in the area of the well, if any.

### XIV. PROOF OF NOTICE

All applicants must furnish proof that a copy of the application has been furnished, by certified or registered mail, to the owner of the surface of the land on which the well is to be located and to each leasehold operator within one-half mile of the well location.

Where an application is subject to administrative approval, a proof of publication must be submitted. Such proof shall consist of a copy of the legal advertisement which was published in the county in which the well is located. The contents of such advertisement must include:

- (1) The name, address, phone number, and contact party for the applicant;
- (2) The intended purpose of the injection well; with the exact location of single wells or the Section, Township, and Range location of multiple wells;
- (3) The formation name and depth with expected maximum injection rates and pressures; and,
- (4) A notation that interested parties must file objections or requests for hearing with the Oil Conservation Division, 1220 South St. Francis Dr., Santa Fe, New Mexico 87505, within 15 days.

NO ACTION WILL BE TAKEN ON THE APPLICATION UNTIL PROPER PROOF OF NOTICE HAS BEEN SUBMITTED.

---

NOTICE: Surface owners or offset operators must file any objections or requests for hearing of administrative applications within 15 days from the date this application was mailed to them.

Attachment To Form C-108  
Miscellaneous Data

North Hobbs (Grayburg/San Andres) Unit  
Well No. 111  
API No. 30-025-05477  
Letter D, Section 24, T-18-S, R-37-E  
Lea County, New Mexico

III. Well Data

- B.(5) Next higher oil zone -- Byers (Queen) @ +/- 3680'  
Next lower oil zone -- Glorieta @ +/- 5300'

VII. Proposed Operation

1. Average Injection Rate N/A  
Maximum Injection Rate 9000 BWPD/15,000 MCFGPD\*  
(\* In accordance with Order No. R-6199-B, effective 10/22/01)
2. Closed Injection System
3. Average Surface Injection Pressure N/A  
Maximum Surface Injection Pressures  

Produced Water	1100 PSI*
CO2	1250 PSI*
CO2 w/produced gas	1770 PSI*

<will not exceed 2400 psi bottomhole pressure>  
(\* In accordance with Order No. R-6199-B, effective 10/22/01)
4. Source Water -- San Andres Produced Water  
(Mitchell Analytical Laboratory analysis attached)

IX. Stimulation Program

Acid treatment of injection interval will be performed during conversion work  
(approx. 2000 gal. 15% HCL)

XI. Fresh Water Sample Analysis

No active fresh water sample points could be found in the area of review

- XII. Occidental Permian Limited Partnership affirms that available geologic and engineering data has been examined resulting in the finding of no evidence of open faults or any other hydrologic connection between the disposal zone and any underground source of drinking water.

# MITCHELL ANALYTICAL LABORATORY

2638 Faudree  
Odessa, Texas 79765-8538  
561-5579

Company: **Nalco Energy Services**

Well Number: WIB Pump Dis. #3  
Lease: OXY  
Location:  
Date Run: 1/25/2005  
Lab Ref #: 05-jan-n23830

Sample Temp: 70  
Date Sampled: 1/19/2005  
Sampled by: Mike Athey  
Employee #: 27-008  
Analyzed by: DOM

## Dissolved Gases

		Mg/L	Eq. Wt.	MEq/L
Hydrogen Sulfide (H <sub>2</sub> S)		137.00	16.00	8.56
Carbon Dioxide (CO <sub>2</sub> )	<b>NOT ANALYZED</b>			
Dissolved Oxygen (O <sub>2</sub> )	<b>NOT ANALYZED</b>			

## Cations

		Mg/L	Eq. Wt.	MEq/L
Calcium (Ca <sup>++</sup> )		1,125.60	20.10	56.00
Magnesium (Mg <sup>++</sup> )		341.60	12.20	28.00
Sodium (Na <sup>+</sup> )		3,524.02	23.00	153.22
Barium (Ba <sup>++</sup> )	<b>NOT ANALYZED</b>			
Manganese (Mn <sup>+</sup> )		.08	27.50	.00

## Anions

		Mg/L	Eq. Wt.	MEq/L
Hydroxyl (OH <sup>-</sup> )		.00	17.00	.00
Carbonate (CO <sub>3</sub> <sup>=</sup> )		.00	30.00	.00
BiCarbonate (HCO <sub>3</sub> <sup>-</sup> )		2,028.52	61.10	33.20
Sulfate (SO <sub>4</sub> <sup>=</sup> )		1,700.00	48.80	34.84
Chloride (Cl <sup>-</sup> )		6,006.60	35.50	169.20
Total Iron (Fe)		0.28	18.60	.02
Total Dissolved Solids		14,863.70		
Total Hardness as CaCO <sub>3</sub>		4,214.56		
Conductivity MICROMHOS/CM		26,250		

pH 6.350 Specific Gravity 60/60 F. 1.010

CaSO<sub>4</sub> Solubility @ 80 F. 39.63 MEq/L, CaSO<sub>4</sub> scale is unlikely

## CaCO<sub>3</sub> Scale Index

70.0	.221	100.0	.561	130.0	1.121
80.0	.341	110.0	.821	140.0	1.121
90.0	.561	120.0	.821	150.0	1.401

*Nalco Energy Services*

# INJECTION WELL DATA SHEET

Operator Occidental Permian Limited Partnership		Lease North Hobbs G/SA Unit		County Lea	
Well No. 111	Footage Location 330' FNL & 990' FWL	Section 24	Township 18-S	Range 37-E	Unit Letter D

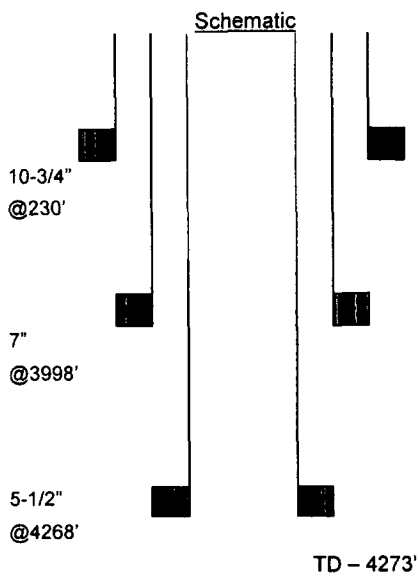

<u>Surface Casing</u>		<u>Tubular Data</u>	
Size	10-3/4"	Cemented with	250 sxs.
TOC	SURF	Determined by	NA
Hole size			
<u>Intermediate Casing</u>			
Size	7"	Cemented with	500 sxs.
TOC	NA	Determined by	NA
Hole size			
<u>Long string Casing *(See Note)</u>			
Size	5-1/2"	Cemented with	330 sx. sxs.
TOC	Surface	Determined by	Circulated
Hole size			
<u>Liner</u>			
Size		Cemented with	sxs.
TOC		Determined by	
Hole size			
<u>Total depth</u>	4273'		

Note: 5-1/2", 15# casing was set as a liner from 4268' to 3942' with 30 sx. (August, 1946). In September, 2004, a 5-1/2", 15.5#, FJ tie-back was run from 3942' to surface and cemented with 300 sx. and cemented to surface.

Injection interval  
4000' feet to TD feet

Completion type      Perforated Casing

Tubing size    2-7/8"      lined with    Duoline (Fiberglass liner)      set in a

Guiberson - Uni VI      packer at    Within 100    feet    Of the top perf.

(brand and model)

## Other Data

- Name of the injection formation      San Andres
- Name of field or Pool      Hobbs
- Is this a new well drilled for injection?      Yes      ☐ No  
If no, for what purpose was the well originally drilled?      Producer
- Has the well ever been perforated in any other zone(s)? List all such perforated intervals and give plugging detail (sacks of cement or bridge plug(s) used)      Grayburg: 4034' - 4054'
- Give the depth to and name of any overlying and/or underlying oil and gas zones (pools) in this area.  
Byers (Queen), +/- 3680'; Glorieta - 5300'



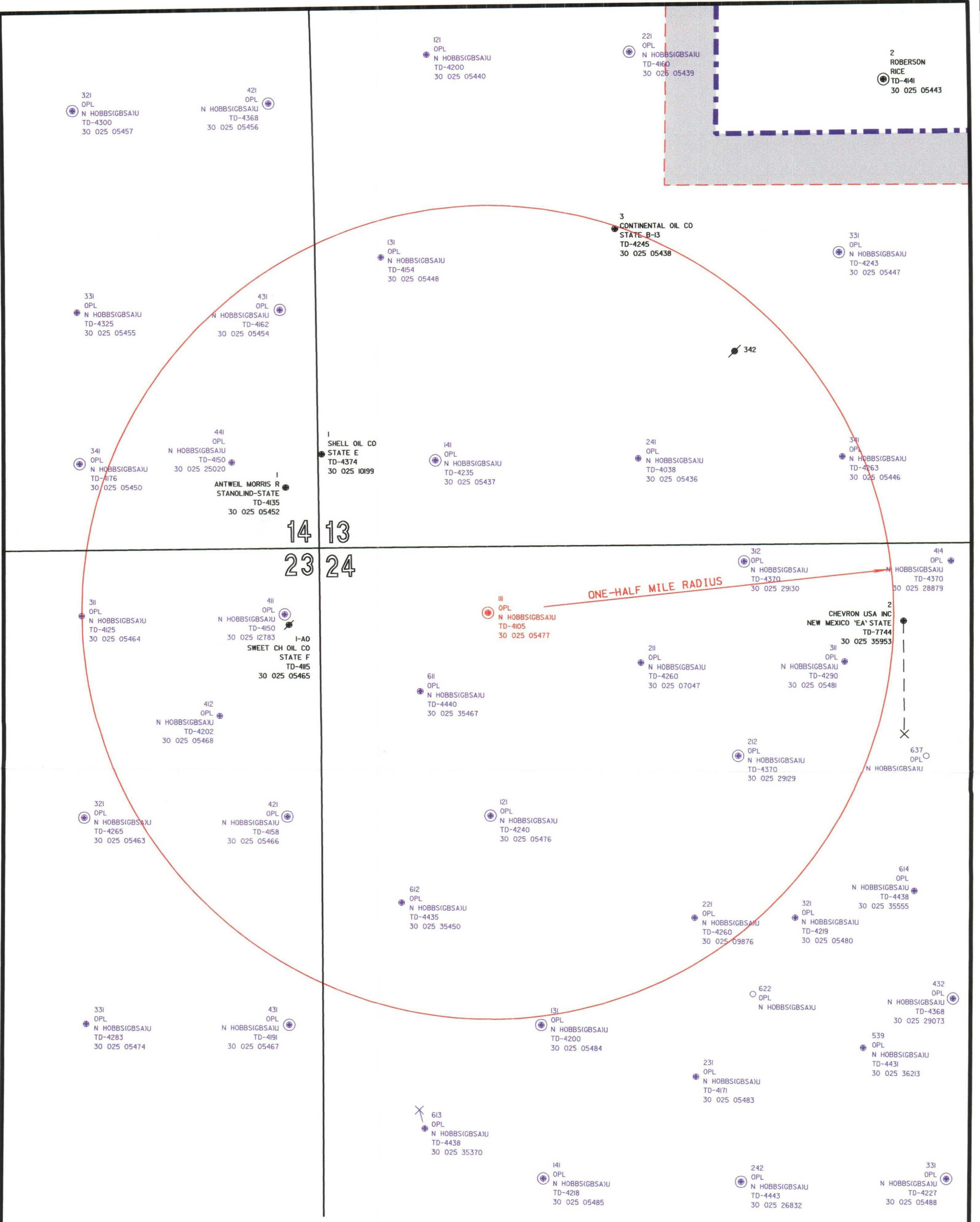

NOTE:  
WELL DATA DERIVED FROM THE PETROLEUM  
INFORMATION - DATA MANAGEMENT SYSTEM,  
WELL DATA SYSTEM PREPARED FOR  
OCCIDENTAL PERMIAN LTD.



Area of Review Plat

# NORTH HOBBS (GRAYBURG SAN ANDRES) UNIT

WELL NO. 24-111

T-18-S, R-37-E  
Lea County, New Mexico

Scale: 1" = 600' 10-20-2005 nm438\_2005.dgn  
Plat prepared by PJE Drafting, Inc.  
For Horizon Survey, Inc.

**Exhibit 1.0 – Area of Review Data**

North Hobbs G/SA Unit No. 111

A review of the subject well's AOR shows that two wells were drilled within the ½-mile radius since the previous review occurred (done as a part of Oxy's August, 2001 application to amend Order No. R-6199). These wells are:

**North Hobbs G/SA Unit No. 611** (30-025-35467)

**North Hobbs G/SA Unit No. 612** (30-025-35450)

The attached copies of sundry notices (2 ea. per well) and the completion reports for these two wells shows that cement was circulated to surface off all casing strings thus affording adequate protection of the injection interval (approx. 4000' to 4273') of Oxy's North Hobbs G/SA Unit Well No. 111.

**Area of Review Well Count**

Active Wells (includes SI and TxA'd wells) – 18

Plugged and Abandoned Wells – 4  
(Identified below)

**Sec. 13, T-18-S, R-37-E**

**State B-13 No. 3** (30-025-05438)

**Sec. 14, T-18-S, R-37-E**

**State "E" No. 1** (30-025-10199)

**Stanolind State No. 1** (30-025-05452)

**Sec. 23, T-18-S, R-37-E**

**State "F" No. 1** (30-025-05465)

**Exhibit 1.0 – Area of Review Data (con'd.)**

AOR NOTES:

North Hobbs G/SA Unit No. 342 (30-025-29255) in Section 13, T-18-S, R-37-E was permitted for drilling (5/9/85), but was never drilled (copies of Form C-103 and Form C-101 for this well are attached).

Mark Stephens 11/28/05

Mark Stephens  
Regulatory Compliance Analyst  
Occidental Permian Limited Partnership

Submit to Appropriate  
District Office  
State Lease - 6 copies  
Fee Lease - 5 copies  
**DISTRICT I**

P.O. Box 1980, Hobbs, NM 88240

**DISTRICT II**

P.O. Drawer DD, Artesia, NM 88210

**DISTRICT III**

1000 Rio Brazos Rd., Aztec, NM 87410

State of New Mexico  
Energy, Minerals and Natural Resources Department

Form C-105  
Revised 1-1-89

**OIL CONSERVATION DIVISION**

2040 Pacheco St.  
Santa Fe, NM 87505

WELL API NO.

30-025-35467

5. Indicate Type Of Lease

STATE ☒

FEE ☐

6. State Oil & Gas Lease No.

7. Lease Name or Unit Agreement Name

North Hobbs G/SA Unit

8. Well No.

611

9. Pool name or Wildcat

Hobbs; Grayburg - San Andres

**WELL COMPLETION OR RECOMPLETION REPORT AND LOG**

1a. Type of Well:

OIL WELL ☒

GAS WELL ☐

DRY ☐

OTHER

b. Type of Completion:

NEW WELL ☒

WORK OVER ☐

DEEPEN ☐

PLUG BACK ☐

DIFF RESVR ☐

OTHER

2. Name of Operator

Occidental Permian Limited Partnership

3. Address of Operator

P.O. Box 4294, Houston, TX 77210-4294

4. Well Location

Unit Letter D : 843 Feet From The North Line and 540 Feet From The West Line

Section 24 Township 18-S Range 37-E NMPM 1ea County

10. Date Spudded

4/9/01

11. Date T.D. Reached

4/15/01

12. Date Compl. (Ready to Prod.)

5/3/01

13. Elevations (DF & RKB, RT, GR, etc.)

3678' GL

14. Elev. Casinghead

15. Total Depth

4440'

16. Plug Back T.D.

4380'

17. If Multiple Compl. How Many Zones?

18. Intervals Drilled By

Rotary Tools

4440'

Cable Tools

19. Producing Interval(s), of this completion - Top, Bottom, Name

4138' - 4276'; Grayburg - San Andres

20. Was Directional Survey Made

No

21. Type Electric and Other Logs Run

NGR - TOLD CN/GR - AL Micro-CFL/GR

22. Was Well Cored

No

**23. CASING RECORD (Report all strings set in well)**

CASING SIZE	WEIGHT LB/FT.	DEPTH SET	HOLE SIZE	CEMENTING RECORD	AMOUNT PULLED
14	Conductor	40	18	50 str.	
8-5/8	24	1497	12-1/4	850 str.	
5-1/2	15.5	4440	7-7/8	850 str.	

**24. LINER RECORD**

SIZE	TOP	BOTTOM	SACKS CEMENT	SCREEN	SIZE	DEPTH SET	PACKER SET
					2-7/8	4100'	

**25. TUBING RECORD**

26. Perforation record (interval, size, and number)

4138' - 4276' (4 JSPP)

27. ACID, SHOT, FRACTURE, CEMENT, SOEEZE, ETC.

DEPTH INTERVAL	AMOUNT AND KIND MATERIAL USED
4138' - 4276'	3500 gal. 15% HCL

**28. PRODUCTION**

Date First Production	Production Method (Flowing, gas lift, pumping - Size and type pump)				Well Status (Prod. or Shut-in)	
5/7/01	Pumping, ESP - Reda				Producing	
Date of Test	Hours Tested	Choke Size	Prod'n For Test Period	Oil - Bbl.	Gas - MCF	Water - Bbl.
5/7/01	24	N/A		29	39	2359
Flow Tubing Press.	Casing Pressure	Calculated 24-Hour Rate	Oil - Bbl.	Gas - MCF	Water - Bbl.	Oil Gravity - API -(Corr.)
50	35		29	39	2359	35

29. Disposition of Gas (Sold, used for fuel, vented, etc.)

Sold

Test Witnessed By

T. Summers

30. List Attachments

Logs (3 ea.), Inclination Report

31. I hereby certify that the information shown on both sides of this form is true and complete to the best of my knowledge and belief

Signature Mark Stephens

Printed Name

Mark Stephens

Title Bus. Analyst (SG) Date 5/21/01

# INSTRUCTIONS

This form is to be filed with the appropriate District Office of the Division not later than 20 days after the completion of any newly-drilled or deepened well. It shall be accompanied by one copy of all electrical and radio-activity logs run on the well and a summary of all special tests conducted, including drill stem tests. All depths reported shall be measured depths. In the case of directionally drilled wells, true vertical depths shall also be reported. For multiple completions, Items 25 through 29 shall be reported for each zone. The form is to be filed in quintuplicate except on state land, where six copies are required. See Rule 1105.

## INDICATE FORMATION TOPS IN CONFORMANCE WITH GEOGRAPHICAL SECTION OF STATE

### Southeastern New Mexico

### Northeastern New Mexico

T. Anhy 1548  
T. Salt \_\_\_\_\_  
B. Salt \_\_\_\_\_  
T. Yates 2738  
T. 7 Rivers \_\_\_\_\_  
T. Queen 3507  
T. Grayburg 3858  
T. San Andres 4086  
T. Glorieta \_\_\_\_\_  
T. Paddock \_\_\_\_\_  
T. Blinbry \_\_\_\_\_  
T. Tubb \_\_\_\_\_  
T. Drinkard \_\_\_\_\_  
T. Abo \_\_\_\_\_  
T. Wolfcamp \_\_\_\_\_  
T. Penn \_\_\_\_\_  
T. Cisco (Bough C) \_\_\_\_\_

T. Canyon \_\_\_\_\_  
T. Strawn \_\_\_\_\_  
T. Atoka \_\_\_\_\_  
T. Miss \_\_\_\_\_  
T. Devonian \_\_\_\_\_  
T. Silurian \_\_\_\_\_  
T. Montoya \_\_\_\_\_  
T. Simpson \_\_\_\_\_  
T. McKee \_\_\_\_\_  
T. Ellenburger \_\_\_\_\_  
T. Gr. Wash \_\_\_\_\_  
T. Delaware Sand \_\_\_\_\_  
T. Bone Springs \_\_\_\_\_  
T. \_\_\_\_\_  
T. \_\_\_\_\_  
T. \_\_\_\_\_  
T. \_\_\_\_\_

T. Ojo Alamo \_\_\_\_\_  
T. Kirtland-Fruitland \_\_\_\_\_  
T. Pictured Cliffs \_\_\_\_\_  
T. Cliff House \_\_\_\_\_  
T. Menefee \_\_\_\_\_  
T. Point Lookout \_\_\_\_\_  
T. Mancos \_\_\_\_\_  
T. Gallup \_\_\_\_\_  
Base Greenhorn \_\_\_\_\_  
T. Dakota \_\_\_\_\_  
T. Morrison \_\_\_\_\_  
T. Todilto \_\_\_\_\_  
T. Entrada \_\_\_\_\_  
T. Wingate \_\_\_\_\_  
T. Chinle \_\_\_\_\_  
T. Permian \_\_\_\_\_  
T. Penn "A" \_\_\_\_\_

T. Penn. "B" \_\_\_\_\_  
T. Penn. "C" \_\_\_\_\_  
T. Penn. "D" \_\_\_\_\_  
T. Leadville \_\_\_\_\_  
T. Madison \_\_\_\_\_  
T. Elbert \_\_\_\_\_  
T. McCracken \_\_\_\_\_  
T. Ignacio Otzte \_\_\_\_\_  
T. Granite \_\_\_\_\_  
T. \_\_\_\_\_  
T. \_\_\_\_\_  
T. \_\_\_\_\_  
T. \_\_\_\_\_  
T. \_\_\_\_\_  
T. \_\_\_\_\_  
T. \_\_\_\_\_  
T. \_\_\_\_\_

### OIL OR GAS SANDS OR ZONES

No. 1, from 3920 to 4350 No. 3, from \_\_\_\_\_ to \_\_\_\_\_  
No. 2, from \_\_\_\_\_ to \_\_\_\_\_ No. 4, from \_\_\_\_\_ to \_\_\_\_\_

### IMPORTANT WATER SANDS

Include data on rate of water inflow and elevation to which water rose in hole.

No. 1, from \_\_\_\_\_ to \_\_\_\_\_ feet  
No. 2, from \_\_\_\_\_ to \_\_\_\_\_ feet  
No. 3, from \_\_\_\_\_ to \_\_\_\_\_ feet

### LITHOLOGY RECORD

( Attach additional sheet if necessary )

From	To	Thickness in Feet	Lithology	From	To	Thickness in Feet	Lithology
2738	3858	1120	Mixed anhydrite & silt with minor dolomite				
3858	3920	163	Mixed anhydrite, dolomite, & silt				
3920	4086	166	Mixed silt & dolomite with minor anhydrite				
4086	4440	354	Dolomite				

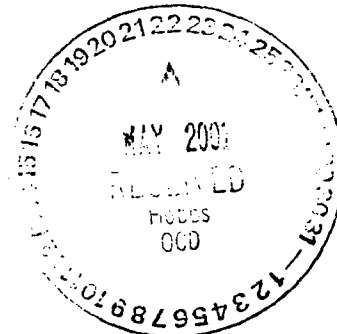

**OIL CONSERVATION DIVISION**

**DISTRICT I**

P.O. Box 1980, Hobbs NM 88241-1980

**DISTRICT II**

P.O. Drawer DD, Artesia, NM 88210

**DISTRICT III**

1000 Rio Brazos Rd., Aztec, NM 87410

2040 Pacheco St.  
Santa Fe, NM 87505

WELL API NO.
<b>30-025-35467</b>
5. Indicate Type of Lease STATE <input checked="" type="checkbox"/> FEE <input type="checkbox"/>
6. State Oil & Gas Lease No.

<b>SUNDRY NOTICES AND REPORTS ON WELLS</b> (DO NOT USE THIS FORM FOR PROPOSALS TO DRILL OR TO DEEPEN OR PLUG BACK TO A DIFFERENT RESERVOIR. USE "APPLICATION FOR PERMIT" (FORM C-101) FOR SUCH PROPOSALS.)	
1. Type of Well: OIL WELL <input checked="" type="checkbox"/> GAS WELL <input type="checkbox"/> OTHER <input type="checkbox"/>	7. Lease Name or Unit Agreement Name <b>North Hobbs G/SA Unit</b>
2. Name of Operator <b>Occidental Permian Limited Partnership</b>	8. Well No. <b>611</b>
3. Address of Operator <b>P.O. Box 4294, Houston, TX 77210-4294</b>	9. Pool name or Wildcat <b>Hobbs; Grayburg - San Andres</b>
4. Well Location Unit Letter <b>D</b> : <b>843</b> Feet From The <b>North</b> Line and <b>540</b> Feet From The <b>West</b> Line Section <b>24</b> Township <b>18-S</b> Range <b>37-E</b> NMPM <b>Lea</b> County	
10. Elevation (Show whether DF, RKB, RT, GR, etc.) <b>3678' GL</b>	

11.

Check Appropriate Box to Indicate Nature of Notice, Report, or Other Data

**NOTICE OF INTENTION TO:**

PERFORM REMEDIAL WORK ☐ PLUG AND ABANDON ☐  
TEMPORARILY ABANDON ☐ CHANGE PLANS ☐  
PULL OR ALTER CASING ☐  
OTHER: ☐

**SUBSEQUENT REPORT OF:**

REMEDIAL WORK ☐ ALTERING CASING ☐  
COMMENCE DRILLING OPNS. ☐ PLUG AND ABANDONMENT ☐  
CASING TEST AND CEMENT JOB ☐  
OTHER: **Rum 5-1/2" Casing** ☒

12. Describe Proposed or Completed Operations (Clearly state all pertinent details, and give pertinent dates, including estimated date of starting any proposed work) SEE RULE 1103.

4/15/01 -

4/16/01: Rum 110 jts. 5-1/2", 15.5#, J-55, I/T&C casing with 13 centralizers and set at 4440'.  
Cement first stage with 250 sx. Premium Plus, circulate 127 sx. Bump plug. Cement second stage with 500 sx. Interfill 'C' (lead) and 100 sx. Premium Plus (tail).  
Circulate 63 sx. to surface. Plug down. Nipple down x set slips x rig down.

Release drilling rig at 8:00 p.m., 4/16/01.

I hereby certify that the information above is true and complete to the best of my knowledge and belief.

SIGNATURE Mark Stephens TITLE Business Analyst (SG) DATE 4/17/01

TYPE OR PRINT NAME Mark Stephens TELEPHONE NO. 281/552-1158

(This space for State Use)

APPROVED BY \_\_\_\_\_ TITLE Paul Kautz DATE APR 26 2001  
Geologist

CONDITIONS OF APPROVAL, IF ANY:

**DISTRICT I**

P.O. Box 1980, Hobbs NM 88241-1980

**DISTRICT II**

P.O. Drawer DD, Artesia, NM 88210

**DISTRICT III**

1000 Rio Brazos Rd., Aztec, NM 87410

**OIL CONSERVATION DIVISION**

2040 Pacheco St.  
Santa Fe, NM 87505

WELL API NO. <b>30-025-35467</b>
5. Indicate Type of Lease STATE <input checked="" type="checkbox"/> FEE <input type="checkbox"/>
6. State Oil & Gas Lease No.
7. Lease Name or Unit Agreement Name <b>North Hobbs G/SA Unit</b>
8. Well No. <b>611</b>
9. Pool name or Wildcat <b>Hobbs; Grayburg - San Andres</b>
10. Elevation (Show whether DF, RKB, RT, GR, etc.) <b>3678' GL</b>

**SUNDRY NOTICES AND REPORTS ON WELLS**  
(DO NOT USE THIS FORM FOR PROPOSALS TO DRILL OR TO DEEPEN OR PLUG BACK TO A DIFFERENT RESERVOIR. USE "APPLICATION FOR PERMIT" (FORM C-101) FOR SUCH PROPOSALS.)

1. Type of Well: OIL WELL <input checked="" type="checkbox"/> GAS WELL <input type="checkbox"/> OTHER	2. Name of Operator <b>Occidental Permian Limited Partnership</b>
3. Address of Operator <b>P.O. Box 4294, Houston, TX 77210-4294</b>	4. Well Location Unit Letter <b>D</b> <b>843</b> Feet From The <b>North</b> Line and <b>540</b> Feet From The <b>West</b> Line Section <b>24</b> Township <b>18-S</b> Range <b>37-E</b> NMPM <b>Lea</b> County
11. Check Appropriate Box to Indicate Nature of Notice, Report, or Other Data	

**NOTICE OF INTENTION TO:**

PERFORM REMEDIAL WORK ☐ PLUG AND ABANDON ☐  
TEMPORARILY ABANDON ☐ CHANGE PLANS ☐  
PULL OR ALTER CASING ☐  
OTHER: ☐

**SUBSEQUENT REPORT OF:**

REMEDIAL WORK ☐ ALTERING CASING ☐  
COMMENCE DRILLING OPNS. ☐ PLUG AND ABANDONMENT ☐  
CASING TEST AND CEMENT JOB ☐  
OTHER: **Spud & Run Surface Casing** ☒

12. Describe Proposed or Completed Operations (Clearly state all pertinent details, and give pertinent dates, including estimated date of starting any proposed work) SEE RULE 1103.

4/9/01: MI x RU. Spud 12-1/4" hole at 2:00 a.m. (NMOC notified)

4/10/01 -

4/11/01: Run 38 jts. 8-5/8", 24#, J-55, ST&C casing with 10 centralizers and set at 1497'. Cement with 600 sx. PBCZ followed by 250 sx. Premium Plus. Plug down and circulate 104 sx. to surface. WOC. Nipple up and test blind rams and pipe rams to 1000 psi and drill out.

I hereby certify that the information above is true and complete to the best of my knowledge and belief.

SIGNATURE Mark Stephens TITLE Business Analyst (SG) DATE 4/12/01

TYPE OR PRINT NAME Mark Stephens TELEPHONE NO. 281/552-1158

(This space for State Use)

APPROVED BY \_\_\_\_\_ TITLE \_\_\_\_\_ DATE \_\_\_\_\_

CONDITIONS OF APPROVAL, IF ANY:

Orig. Signed by  
Paul Kautz  
Geologist

APR 23 2001

Submit to Appropriate  
District Office  
State Lease - 6 copies  
Fee Lease - 5 copies  
DISTRICT I

P.O. Box 1980, Hobbs, NM 88240

DISTRICT II

P.O. Drawer DD, Artesia, NM 88210

DISTRICT III

1000 Rio Brazos Rd., Aztec, NM 87410

State of New Mexico  
Energy, Minerals and Natural Resources Department

Form C-105  
Revised 1-1-89

OIL CONSERVATION DIVISION

2040 Pacheco St.  
Santa Fe, NM 87505

WELL API NO.

30-025-35450

5. Indicate Type Of Lease

STATE ☒

FEE ☐

6. State Oil & Gas Lease No.

7. Lease Name or Unit Agreement Name

North Hobbs G/SA Unit

8. Well No.

612

9. Pool name or Wildcat

Hobbs; Grayburg - San Andres

WELL COMPLETION OR RECOMPLETION REPORT AND LOG

1a. Type of Well:

OIL WELL ☒

GAS WELL ☐

DRY ☐

OTHER

b. Type of Completion:

NEW WELL ☒

WORK OVER ☐

DEEPEN ☐

PLUG BACK ☐

DIFF RESVR ☐

OTHER

2. Name of Operator

Occidental Permian Limited Partnership

3. Address of Operator

P.O. Box 4294, Houston, TX 77210-4294

4. Well Location

Unit Letter E : 2220 Feet From The North Line and 406 Feet From The West Line

Section 24 Township 18-S Range 37-E NMPM Lea County

10. Date Spudded  
12/3/01

11. Date T.D. Reached  
12/13/01

12. Date Compl. (Ready to Prod.)  
N/A

13. Elevations (DF & RKB, RT, GR, etc.)  
3676' GR

14. Elev. Casinghead

15. Total Depth  
4435'

16. Plug Back T.D.  
4390'

17. If Multiple Compl. How Many Zones?

18. Intervals Drilled By

Rotary Tools  
4435'

Cable Tools

19. Producing Interval(s), of this completion - Top, Bottom, Name

4216' - 4327'; Grayburg - San Andres

20. Was Directional Survey Made

No

21. Type Electric and Other Logs Run

AL Micro-CFL/GR; NGR; TD L-D CN/NGT

22. Was Well Cored

No

23. CASING RECORD (Report all strings set in well)

CASING SIZE	WEIGHT LB/FT.	DEPTH SET	HOLE SIZE	CEMENTING RECORD	AMOUNT PULLED
14	Conductor	40	18	50 SK.	
8-5/8	24	1507	12-1/4	850 SK.	
5-1/2	15.5	4435	7-7/8	900 SK.	

24. LINER RECORD

SIZE	TOP	BOTTOM	SACKS CEMENT	SCREEN	SIZE	DEPTH SET	PACKER SET
					2-7/8	4139	

25. TUBING RECORD

26. Perforation record (interval, size, and number)

4216' - 4327', 2 JSPP

27. ACID, SHOT, FRACTURE, CEMENT, SOEEZE, ETC.

DEPTH INTERVAL AMOUNT AND KIND MATERIAL USED

4216' - 4327'

500 gal. 15% HCL

28. PRODUCTION

Date First Production

Production Method (Flowing, gas lift, pumping - Size and type pump)

Well shut-in 1/20/02 with no test

Well Status (Prod. or Shut-in)

Shut-in

Date of Test

Hours Tested

Choke Size

Prod'n For Test Period

Oil - Bbl.

Gas - MCF

Water - Bbl.

Gas - Oil Ratio

Flow Tubing Press.

Casing Pressure

Calculated 24-Hour Rate

Oil - Bbl.

Gas - MCF

Water - Bbl.

Oil Gravity - API - (Corr.)

29. Disposition of Gas (Sold, used for fuel, vented, etc.)

Test Witnessed By

30. List Attachments

Logs (3 ea.), Inclination Report

31. I hereby certify that the information shown on both sides of this form is true and complete to the best of my knowledge and belief

Signature Mark Stephens

Printed Name

Mark Stephens

Title

Bus. Analyst (SG)

Date 3/21/02



Submit 3 Copies  
to Appropriate  
District Office

State of New Mexico  
Energy, Minerals and Natural Resources Department

Form C-103  
Revised 1-1-89

**DISTRICT I**  
P.O. Box 1980, Hobbs NM 88241-1980  
**DISTRICT II**  
P.O. Drawer DD, Artesia, NM 88210  
**DISTRICT III**  
1000 Rio Brazos Rd., Aztec, NM 87410

**OIL CONSERVATION DIVISION**  
2040 Pacheco St.  
Santa Fe, NM 87505

WELL API NO. <b>30-025-35450</b>
5. Indicate Type of Lease STATE <input checked="" type="checkbox"/> FEE <input type="checkbox"/>
6. State Oil & Gas Lease No.
7. Lease Name or Unit Agreement Name <b>North Hobbs G/SA Unit</b>
8. Well No. <b>612</b>
9. Pool name or Wildcat <b>Hobbs; Grayburg - San Andres</b>
10. Elevation (Show whether DF, RKB, RT, GR, etc.) <b>3676' GR</b>

<b>SUNDRY NOTICES AND REPORTS ON WELLS</b> (DO NOT USE THIS FORM FOR PROPOSALS TO DRILL OR TO DEEPEN OR PLUG BACK TO A DIFFERENT RESERVOIR. USE "APPLICATION FOR PERMIT" (FORM C-101) FOR SUCH PROPOSALS.)	
1. Type of Well: OIL WELL <input checked="" type="checkbox"/> GAS WELL <input type="checkbox"/> OTHER	
2. Name of Operator <b>Occidental Permian Limited Partnership</b>	
3. Address of Operator <b>P.O. Box 4294, Houston, TX 77210-4294</b>	
4. Well Location Unit Letter <b>E</b> : <b>2220</b> Feet From The <b>North</b> Line and <b>406</b> Feet From The <b>West</b> Line Section <b>24</b> Township <b>18-S</b> Range <b>37-E</b> NMPM <b>Lea</b> County	
10. Elevation (Show whether DF, RKB, RT, GR, etc.) <b>3676' GR</b>	

11. Check Appropriate Box to Indicate Nature of Notice, Report, or Other Data

**NOTICE OF INTENTION TO:**

PERFORM REMEDIAL WORK ☐ PLUG AND ABANDON ☐  
TEMPORARILY ABANDON ☐ CHANGE PLANS ☐  
PULL OR ALTER CASING ☐  
OTHER: ☐

**SUBSEQUENT REPORT OF:**

REMEDIAL WORK ☐ ALTERING CASING ☐  
COMMENCE DRILLING OPNS. ☐ PLUG AND ABANDONMENT ☐  
CASING TEST AND CEMENT JOB ☐  
OTHER: **Rm 5-1/2" Casing** ☒

12. Describe Proposed or Completed Operations (Clearly state all pertinent details, and give pertinent dates, including estimated date of starting any proposed work) SEE RULE 1103.

12/14/01: Rm 110 jts. 5-1/2", 15.5#, J-55, I/T&C casing with 12 centralizers and set at 4435'. Cement first stage with 300 sx. Premium Plus. Bump plug, drop bomb, and open DV tool. Circulate 84 xs. Cement second stage with 500 sx. Interfill 'C' and 100 sx. Premium Plus. Plug down and circulate 61 sx. Nipple down x set slips x rig down.

Release drilling rig at 11:00 p.m., 12/14/01.

I hereby certify that the information above is true and complete to the best of my knowledge and belief.

SIGNATURE Mark Stephens TITLE Business Analyst (SG) DATE 12/17/01  
TYPE OR PRINT NAME Mark Stephens TELEPHONE NO. 281/552-1158

(This space for State Use)

APPROVED BY \_\_\_\_\_ TITLE ORIGINAL SIGNED BY PAUL F. KAUTZ PETROLEUM ENGINEER DATE DEC 26 2001  
CONDITIONS OF APPROVAL, IF ANY:

Submit 3 Copies  
to Appropriate  
District Office

State of New Mexico  
Energy, Minerals and Natural Resources Department

Form C-103  
Revised 1-1-89

OIL CONSERVATION DIVISION

DISTRICT I

P.O. Box 1980, Hobbs NM 88241-1980

DISTRICT II

P.O. Drawer DD, Artesia, NM 88210

DISTRICT III

1000 Rio Brazos Rd., Aztec, NM 87410

2040 Pacheco St.  
Santa Fe, NM 87505

WELL API NO.

30-025-35450

5. Indicate Type of Lease

STATE ☒

FEE ☐

6. State Oil & Gas Lease No.

SUNDRY NOTICES AND REPORTS ON WELLS  
(DO NOT USE THIS FORM FOR PROPOSALS TO DRILL OR TO DEEPEN OR PLUG BACK TO A  
DIFFERENT RESERVOIR. USE "APPLICATION FOR PERMIT"  
(FORM C-101) FOR SUCH PROPOSALS.)

1. Type of Well:

OIL  
WELL ☒

GAS  
WELL ☐

OTHER

2. Name of Operator

Occidental Permian Limited Partnership

3. Address of Operator

P.O. Box 4294, Houston, TX 77210-4294

8. Well No.

612

9. Pool name or Wildcat

Hobbs; Grayburg - San Andres

4. Well Location

Unit Letter E : 2220 Feet From The North Line and 406 Feet From The West Line

Section 24 Township 18-S Range 37-E NMPM Lea County

10. Elevation (Show whether DF, RKB, RT, GR, etc.)

3676' GR

11.

Check Appropriate Box to Indicate Nature of Notice, Report, or Other Data

NOTICE OF INTENTION TO:

PERFORM REMEDIAL WORK ☐

PLUG AND ABANDON ☐

TEMPORARILY ABANDON ☐

CHANGE PLANS ☐

PULL OR ALTER CASING ☐

OTHER: ☐

SUBSEQUENT REPORT OF:

REMEDIAL WORK ☐

ALTERING CASING ☐

COMMENCE DRILLING OPNS. ☐

PLUG AND ABANDONMENT ☐

CASING TEST AND CEMENT JOB ☐

OTHER: Spud & Run Surface Casing

☒

12. Describe Proposed or Completed Operations (Clearly state all pertinent details, and give pertinent dates, including estimated date of starting any proposed work) SEE RULE 1103.

12/3/01: MI x RU. Spud 12-1/4" hole at 7:00 p.m. (NMOCD notified)

12/7/01 -

12/8/01: Run 38 jts. 8-5/8", 24#, J-55, ST&C casing with 10 centralizers and set at 1507'. Cement with 600 sx. PBCZ followed by 250 sx. Premium Plus. Plug down and circulate 88 sx. to surface. WOC. Nipple up and test BOP. Drill out cement and resume drilling operations.

I hereby certify that the information above is true and complete to the best of my knowledge and belief.

SIGNATURE

Mark Stephens

TITLE

Business Analyst (SG)

DATE

12/11/01

TYPE OR PRINT NAME

Mark Stephens

TELEPHONE NO.

281/552-1158

(This space for State Use)

APPROVED BY

TITLE

ORIGINAL SIGNED BY  
PAUL F. KAUTZ  
PETROLEUM ENGINEER

DATE

DEC 18 2001

CONDITIONS OF APPROVAL, IF ANY:

STATE OF NEW MEXICO  
ENERGY AND MINERALS DEPARTMENT

OIL CONSERVATION DIVISION

P. O. BOX 2088  
SANTA FE, NEW MEXICO 87501

Form C-103  
Revised 10-1-78

NO. OF COPIES RECEIVED	
DISTRIBUTION	
SANTA FE	
FILE	
U.S.G.S.	
LAND OFFICE	
OPERATOR	

API #30-025-29255

5a. Indicate Type of Lease  
State ☐ Fee ☒  
5. State Oil & Gas Lease No.

SUNDRY NOTICES AND REPORTS ON WELLS

(DO NOT USE THIS FORM FOR PROPOSALS TO DRILL OR TO DEEPEN OR PLUG BACK TO A DIFFERENT RESERVOIR. USE "APPLICATION FOR PERMIT -" (FORM C-101) FOR SUCH PROPOSALS.)

1. OIL WELL <input checked="" type="checkbox"/> GAS WELL <input type="checkbox"/> OTHER <input type="checkbox"/>	7. Unit Agreement Name N. HOBBS (G/SA) UNIT
2. Name of Operator SHELL WESTERN E&P INC.	8. Farm or Lease Name SECTION 13
3. Address of Operator P. O. BOX 576, HOUSTON, TEXAS 77001	9. Well No. 342
4. Location of Well UNIT LETTER 0, 1200 FEET FROM THE SOUTH LINE AND 2500 FEET FROM THE EAST LINE, SECTION 13, TOWNSHIP 18-S, RANGE 37-E, N.M.P.M.	10. Field and Pool, or Wildcat HOBBS (G/SA)
15. Elevation (Show whether DF, RT, GR, etc.) 3673.5' GL	12. County LEA

16. Check Appropriate Box To Indicate Nature of Notice, Report or Other Data.  
NOTICE OF INTENTION TO: SUBSEQUENT REPORT OF:

PERFORM REMEDIAL WORK <input type="checkbox"/>	PLUG AND ABANDON <input type="checkbox"/>	REMEDIAL WORK <input type="checkbox"/>	ALTERING CASING <input type="checkbox"/>
TEMPORARILY ABANDON <input type="checkbox"/>	CHANGE PLANS <input checked="" type="checkbox"/>	COMMENCE DRILLING OPER. <input type="checkbox"/>	PLUG AND ABANDONMENT <input type="checkbox"/>
PULL OR ALTER CASING <input type="checkbox"/>	OTHER <input type="checkbox"/>	CASING TEST AND CEMENT JOBS <input type="checkbox"/>	OTHER <input type="checkbox"/>

17. Describe Proposed or Completed Operations (Clearly state all pertinent details, and give pertinent dates, including estimated date of starting any proposed work) SEE RULE 1103.

SHELL WESTERN E&P INC. HEREBY REQUESTS THAT THE PERMIT TO DRILL (APPROVED MAY 9, 1985) BE NULLIFIED AS WE HAVE CANCELLED ALL PROPOSED DRILLING ACTIVITIES FOR THIS WELL. THE INABILITY TO SECURE A DRILLING CLEARANCE WITH THE SURFACE OWNER HAS NECESSITATED THIS REQUEST.

NOTE: NSL ORDER #R-7628.

18. I hereby certify that the information above is true and complete to the best of my knowledge and belief.

SIGNED <u>A. J. Fore</u>	A. J. FORE	TITLE SUPERVISOR REG. & PERMITTING	DATE AUGUST 7, 1985
APPROVED BY <u>EDDIE SEAY</u>	ORIGINAL SIGNED BY EDDIE SEAY	TITLE OIL & GAS INSPECTOR	DATE AUG 12 1985
CONDITIONS OF APPROVAL, IF ANY:			

30-025-29255

STATE OF NEW MEXICO  
ENERGY AND MINERALS DEPARTMENT

C.L. CONSERVATION DIVISION

P. O. BOX 2088

SANTA FE, NEW MEXICO 87501

Form C-101  
Revised 10-1-78

NO. OF COPIES RECEIVED	
DISTRIBUTION	
SANTA FE	
FILE	
U.S.G.S.	
LAND OFFICE	
OPERATOR	

5A. Indicate Type of Lease  
STATE ☐ FEE ☒  
5. State Oil & Gas Lease No.

APPLICATION FOR PERMIT TO DRILL, DEEPEN, OR PLUG BACK

1a. Type of Work  
b. Type of Well  
OIL WELL ☒ GAS WELL ☐ OTHER ☐  
DRILL ☒ DEEPEN ☐ PLUG BACK ☐  
SINGLE ZONE ☒ MULTIPLE ZONE ☐  
2. Name of Operator  
SHELL WESTERN E&P INC.  
3. Address of Operator  
P. O. BOX 991, HOUSTON, TEXAS 77001  
4. Location of Well  
UNIT LETTER 0 LOCATED 1200 FEET FROM THE SOUTH LINE  
AND 2500 FEET FROM THE EAST LINE OF SEC. 13 TWP. 18-S RSC. 37-E NMPM  
7. Unit Agreement Name  
N. HOBBS (G/SA) UNIT  
8. Farm or Lease Name  
SECTION 13  
9. Well No.  
342  
10. Field and Pool, or Wildcat  
HOBBS (G/SA)  
12. County  
LEA  
19. Proposed Depth  
4370'  
19A. Formation  
GRAYBURG/  
SAN ANDRES  
20. Rotary or C.T.  
ROTARY  
21. Elevations (Show whether D.F., K.T., etc.)  
3673.5' GL  
21A. Kind & Status Plug. Bond  
BLANKET  
21B. Drilling Contractor  
TRG DRILLING CO.  
22. Approx. Date Work will start  
JUNE 3, 1985

PROPOSED CASING AND CEMENT PROGRAM

SIZE OF HOLE	SIZE OF CASING	WEIGHT PER FOOT	SETTING DEPTH	SACKS OF CEMENT	EST. TOP
17-1/2"	13-3/8"	CONDUCTOR	40'	REDIMIX	SURFACE
12-1/4"	9-5/8"	36#	1500'	510	SURFACE
8-3/4"	7"	20#	4370'	580	SURFACE

BOP PROGRAM: 3000# ram preventer.  
NOTE: NSL Order # R-7628.

Permit Expires 6 Months From Approval  
Date Unless Drilling Underway.

ABOVE SPACE DESCRIBE PROPOSED PROGRAM: IF PROPOSAL IS TO DEEPEN OR PLUG BACK, GIVE DATA ON PRESENT PRODUCTIVE ZONE AND PROPOSED NEW PROD. ZONE. GIVE BLOWOUT PREVENTER PROGRAM, IF ANY.

I hereby certify that the information above is true and complete to the best of my knowledge and belief.

by A. J. Fore A. J. FORE Title SUPERVISOR REG. & PERMITTING Date MAY 3, 1985

(This space for State Use)  
Eddie W. Seay

PROVED BY Oil & Gas Inspector TITLE DATE MAY 9 1985

CONDITIONS OF APPROVAL, IF ANY:

NEW MEXICO OIL CONSERVATION COMMISSION  
WELL LOCATION AND ACREAGE DEDICATION PLAT

Form C-102  
Supersedes C-128  
Effective 1-1-65

All distances must be from the outer boundaries of the Section.

Operator SHELL WESTERN E. & P., INC.			Lease NORTH HOBBS UNIT SECTION 13		Well No. 342
Unit Letter 0	Section 13	Township 18S	Range 37E	County LEA	
Actual Footage Location of Well: 1200 feet from the SOUTH line and 2500 feet from the EAST line					
Ground Level Elev. 3673.5	Producing Formation GRAYBURG/SAN ANDRES		Pool HOBBS (GRAYBURG/SAN ANDRES)	Dedicated Acreage: 40 Acres	

1. Outline the acreage dedicated to the subject well by colored pencil or hachure marks on the plat below.
2. If more than one lease is dedicated to the well, outline each and identify the ownership thereof (both as to working interest and royalty).
3. If more than one lease of different ownership is dedicated to the well, have the interests of all owners been consolidated by communitization, unitization, force-pooling, etc?

☒ Yes ☐ No If answer is "yes," type of consolidation UNITIZATION

If answer is "no," list the owners and tract descriptions which have actually been consolidated. (Use reverse side of this form if necessary.)

No allowable will be assigned to the well until all interests have been consolidated (by communitization, unitization, forced-pooling, or otherwise) or until a non-standard unit, eliminating such interests, has been approved by the Commission.

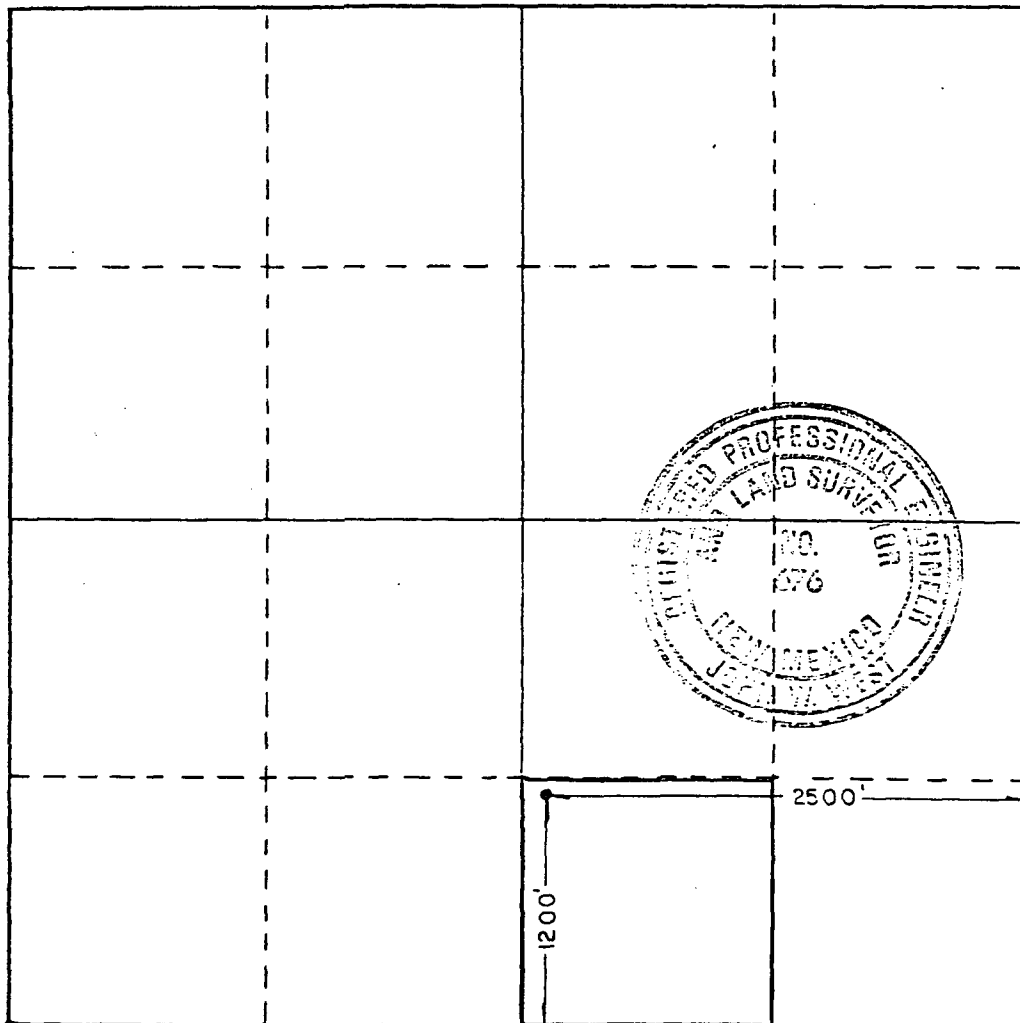

CERTIFICATION

I hereby certify that the information contained herein is true and complete to the best of my knowledge and belief.

Name  
*A. J. Fore* A. J. FORE  
Position  
SUPERVISOR REG. & PERMITTING  
Company  
SHELL WESTERN E&P INC.  
Date  
MAY 3, 1985

I hereby certify that the well location shown on this plat was plotted from field notes of actual surveys made by me or under my supervision, and that the same is true and correct to the best of my knowledge and belief.

Date Surveyed  
5/10/84  
Registered Professional Engineer  
and/or Land Surveyor  
*John W. West*

Certificate No. JOHN W. WEST, 676  
RONALD J. EIDSON, 3239

Exhibit 2.0 - Well No. 111 circled in red; wells approved for similar injectants/rates under Order R-6199-B circled in blue

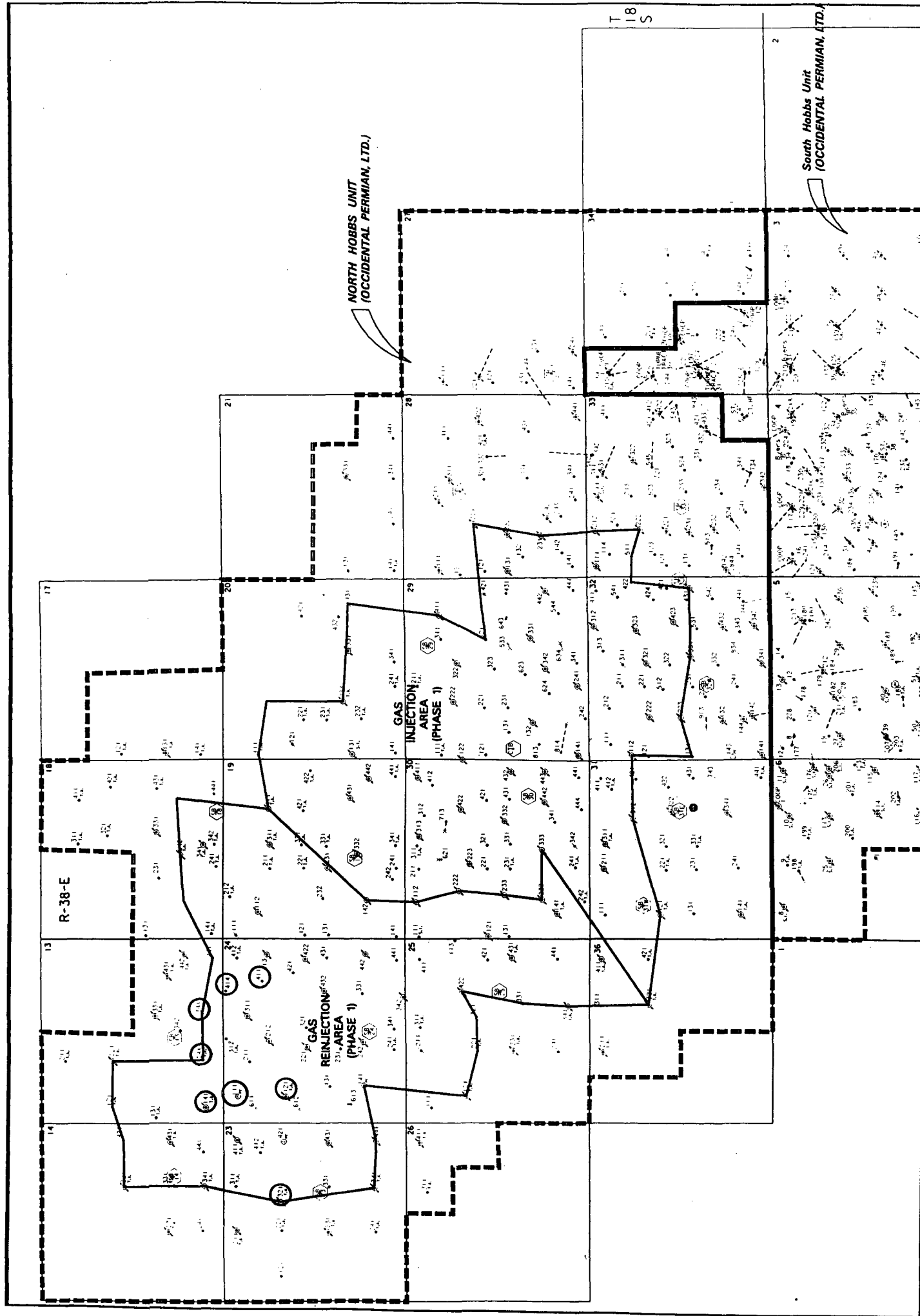

## LIST OF OFFSET OPERATORS & SURFACE OWNERS

---

North Hobbs (Grayburg/San Andres) Unit  
Well No. 111  
API No. 30-025-05477  
Letter D, Section 24, T-18-S, R-37-E  
Lea County, New Mexico

### **Offset Operators**

---

Occidental Permian Limited Partnership  
P.O. Box 4294  
Houston, TX 77210-4294

### **Surface Owners**

---

State of New Mexico  
Commissioner of Public Lands  
P.O. Box 1148  
Santa Fe, NM 87504-1148

**SENDER: COMPLETE THIS SECTION**

- Complete items 1, 2, and 3. Also complete item 4 if Restricted Delivery is desired.
- Print your name and address on the reverse so that we can return the card to you.
- Attach this card to the back of the mailpiece, or on the front if space permits.

1. Article Addressed to:

State of New Mexico  
Commissioner of Public Lands  
P.O. Box 1148  
Santa Fe, NM 87504-1148

2. Article Number (Copy from service label)

7000 0600 0025 0797 2234

PS Form 3811, July 1999

Domestic Return Receipt

102595-00-M-0952

**COMPLETE THIS SECTION ON DELIVERY**

A. Received by (Please Print Clearly) B. Date of Delivery

C. Signature

X

☐ Agent

☐ Addressee

D. Is delivery address different from item 1? ☐ Yes

If YES, enter delivery address below: ☐ No

3. Service Type

☒ Certified Mail

☐ Express Mail

☐ Registered

☒ Return Receipt for Merchandise

☐ Insured Mail

☐ C.O.D.

4. Restricted Delivery? (Extra Fee)

☐ Yes



AFFIDAVIT OF PUBLICATION

State of New Mexico,  
County of Lea.

I, KATHI BEARDEN

Publisher

of the Hobbs News-Sun, a  
newspaper published at  
Hobbs, New Mexico, do solemnly  
swear that the clipping attached  
hereto was published once a  
week in the regular and entire  
issue of said paper, and not a  
supplement thereof for a period.

of 1  
\_\_\_\_\_ weeks.

Beginning with the issue dated

October 22 2005  
and ending with the issue dated

October 22 2005

Kathi Bearden

Publisher

Sworn and subscribed to before

me this 24th day of

October 2005

Notary Public.

My Commission expires  
February 07, 2009  
(Seal)



OFFICIAL SEAL  
DORA MONTZ  
NOTARY PUBLIC  
STATE OF NEW MEXICO

My Commission Expires: \_\_\_\_\_

This newspaper is duly qualified  
to publish legal notices or adver-  
tisements within the meaning of  
Section 3, Chapter 167, Laws of  
1937, and payment of fees for  
said publication has been made.

LEGAL NOTICE  
October 22, 2005

Notice is hereby given of the application of Occidental Per-  
mian Limited Partnership, Attn: Mark Stephens, P.O. Box  
4294, Rm. 19.013 - GRWY 5, Houston, TX 77210-4294  
(713/366-5158), to the Oil Conservation Division, New Mex-  
ico Energy, Minerals and Natural Resources Department,  
for approval of the following injection wells for the purpose  
of tertiary recovery:

Pool Name: Hobbs; Grayburg - San Andres  
Lease/Unit Name: North Hobbs G/SA Unit  
Well No. 111  
Loc: 330' FNL & 990' FWL, Unit Letter D, Sec. 24, T-18-S,  
R-37-E, Lea Co., NM

Pool Name: Hobbs; Grayburg - San Andres  
Lease/Unit Name: North Hobbs G/SA Unit  
Well No. 312  
Loc: 10' FNL & 2630' FEL, Unit Letter B, Sec. 24, T-18-S,  
R-37-E, Lea Co., NM

The injection formation is the Hobbs; Grayburg - San An-  
dres Pool between the intervals of +/-3680' and +/-5300'  
below the surface of the ground. Expected maximum injec-  
tion rate is 9000 B/D (water)/15,000 MCF/D (CO2 & pro-  
duced gas), and the expected maximum injection pressure  
is approximately 1100 psi (water)/1250 psi (CO2)/1770 psi  
(CO2 & produced gas). Interested parties must file objec-  
tions or requests for hearing with the Oil Conservation Divi-  
sion, 1220 S. St. Francis Dr., Santa Fe, NM 87504 within fif-  
teen (15) days.

#21872

02101173000

67534023

OCCIDENTAL PERMIAN LIMITED  
P. O. BOX 4294  
HOUSTON, TX 77210-4294