

| | | | | |
|-----------------|------------------|-------------|-----------|----------|
| DATE IN 6/25/97 | SUSPENSE 7/15/97 | ENGINEER DC | LOGGED RN | TYPE DHC |
|-----------------|------------------|-------------|-----------|----------|

ABOVE THIS LINE FOR DIVISION USE ONLY

NEW MEXICO OIL CONSERVATION DIVISION

- Engineering Bureau -

ADMINISTRATIVE APPLICATION COVERSHEET

THIS COVERSHEET IS MANDATORY FOR ALL ADMINISTRATIVE APPLICATIONS FOR EXCEPTIONS TO DIVISION RULES AND REGULATIONS

Application Acronyms:

[NSP-Non-Standard Proration Unit] [NSL-Non-Standard Location]
 [DD-Directional Drilling] [SD-Simultaneous Dedication]
 [DHC-Downhole Commingling] [CTB-Lease Commingling] [PLC-Pool/Lease Commingling]
 [PC-Pool Commingling] [OLS - Off-Lease Storage] [OLM-Off-Lease Measurement]
 [WFX-Waterflood Expansion] [PMX-Pressure Maintenance Expansion]
 [SWD-Salt Water Disposal] [IPI-Injection Pressure Increase]
 [EOR-Qualified Enhanced Oil Recovery Certification] [PPR-Positive Production Response]

[1] TYPE OF APPLICATION - Check Those Which Apply for [A]

- [A] Location - Spacing Unit - Directional Drilling
☐ NSL ☐ NSP ☐ DD ☐ SD

Check One Only for [B] and [C]

- [B] Commingling - Storage - Measurement
☒ DHC ☐ CTB ☐ PLC ☐ PC ☐ OLS ☐ OLM

- [C] Injection - Disposal - Pressure Increase - Enhanced Oil Recovery
☐ WFX ☐ PMX ☐ SWD ☐ IPI ☐ EOR ☐ PPR

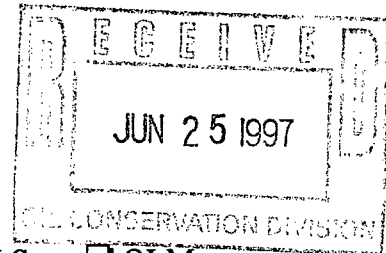

[2] NOTIFICATION REQUIRED TO: - Check Those Which Apply, or ☐ Does Not Apply

- [A] ☐ Working, Royalty or Overriding Royalty Interest Owners
 [B] ☒ Offset Operators, Leaseholders or Surface Owner
 [C] ☐ Application is One Which Requires Published Legal Notice
 [D] ☒ Notification and/or Concurrent Approval by BLM or SLO
 U.S. Bureau of Land Management - Commissioner of Public Lands, State Land Office
 [E] ☐ For all of the above, Proof of Notification or Publication is Attached, and/or,
 [F] ☐ Waivers are Attached

[3] INFORMATION / DATA SUBMITTED IS COMPLETE - Statement of Understanding

I hereby certify that I, or personnel under my supervision, have read and complied with all applicable Rules and Regulations of the Oil Conservation Division. Further, I assert that the attached application for administrative approval is accurate and complete to the best of my knowledge and where applicable, verify that all interest (WI, RI, ORRI) is common. I understand that any omission of data, information or notification is cause to have the application package returned with no action taken.

Note: Statement must be completed by an individual with supervisory capacity.

Peggy Bradfield

Print or Type Name

Signature

Regulatory/Compliance Administrator

Title

Date

6/24/97

BURLINGTON RESOURCES

SAN JUAN DIVISION

June 24, 1997

SENT FEDERAL EXPRESS

Mr. William LeMay
New Mexico Oil Conservation Division
2040 South Pacheco Street
Santa Fe, New Mexico 87505

Re: Cain #11E
810'FSL, 1825'FEL, Section 15, T-28-N, R-10-W
30-045-23972

Dear Mr. LeMay:

This is a request for administrative approval for downhole commingling the Chacra and Dakota in the subject well.

To comply with the New Mexico Oil Conservation Division rules, Burlington Resources Oil & Gas Company is submitting the following for your approval of this commingling:

1. Form C107A - Application for Downhole Commingling;
2. C-102 plat for each zone showing its spacing unit and acreage dedication;
3. Production curves for Chacra and Dakota;
4. Notification list of offset operators;
5. Shut in wellhead pressure and calculated down hole pressure of surrounding wells;
6. Nine-section plats for the Chacra and Dakota.

Working, overriding and royalty interests are identical in the commingled zones.

We will consult with the Supervisor of the Aztec District Office of the New Mexico Oil Conservation Division to establish an allocation formula.

Please let me know if you require additional data.

Sincerely,



Peggy Bradfield

Regulatory/Compliance Administrator

xc: Bureau of Land Management - hand delivered

DISTRICT I

P.O. Box 1980, Hobbs, NM 88241-1980

DISTRICT II

811 South First St., Artesia, NM 88210-2835

DISTRICT III

1000 Rio Brazos Rd, Aztec, NM 87410-1693

State of New Mexico
Energy, Minerals and Natural Resources Department

OIL CONSERVATION DIVISION

2040 S. Pacheco
Santa Fe, New Mexico 87505-6429Form C-107-A
New 3-12-96

APPROVAL PROCESS :

☒ Administrative ☐ Hearing

APPLICATION FOR DOWNHOLE COMMINGLING

EXISTING WELLBORE

☒ YES ☐ NO

BURLINGTON RESOURCES OIL & GAS COMPANY

PO Box 4289, Farmington, NM 87499

Operator

CAIN

Address

11E

O, Sec. 15, T28N, R10W

San Juan

Lease

Well No.

Unit Ltr. - Sec - Twp - Rge

County

Spacing Unit Lease Types: (check 1 or more)

OGRID NO. 14538 Property Code 18487 API NO. 30-045-23972 Federal ☒ , State (and/or) Fee

| The following facts are submitted in support of downhole commingling: | Upper Zone | Intermediate Zone | Lower Zone |
|---|--|-------------------|--|
| 1. Pool Name and Pool Code | Otero Chacra - 82329 | | Basin Dakota - 71599 |
| 2. Top and Bottom of Pay Section (Perforations) | 3032' - 3140' | | 6424'-6604' |
| 3. Type of production (Oil or Gas) | Gas | | Gas |
| 4. Method of Production (Flowing or Artificial Lift) | Flowing | | Flowing |
| 5. Bottomhole Pressure Oil Zones - Artificial Lift: Estimated Current Gas & Oil - Flowing: Measured Current All Gas Zones: Estimated or Measured Original | (Current) a. 470 Psia @ 3086' (Original) b. 1105 Psia | a. b. | a. 432 Psia @ 6514' b. 989 Psia |
| 6. Oil Gravity (°API) or Gas BTU Content | 1148 | | 1260 |
| 7. Producing or Shut-In? | Producing | | Producing |
| Production Marginal? (yes or no) | Yes | | Yes |
| * If Shut-In and oil/gas/water rates of last production Note: For new zones with no production history, applicant shall be required to attach production estimates and supporting data | Date: Rates: | Date: Rates: | Date: Rates: |
| * If Producing, give data and oil/gas/water water of recent test (within 60 days) | Date: 8/15/97 Rates: 71 MCFD | Date: Rates: | Date: 6/15/97 Rates: 135 MCFD |
| 8. Fixed Percentage Allocation Formula - % for each zone (total of %'s to equal 100%) | Oil: Gas: supplied upon completion | Oil: Gas: | Oil: Gas: supplies upon completion |

9. If allocation formula is based upon something other than current or past production, or is based upon some other method, submit attachments with supporting data and/or explaining method and providing rate projections or other required data.

10. Are all working, overriding, and royalty interests identical in all commingled zones? ☒ Yes ☐ No
If not, have all working, overriding, and royalty interests been notified by certified mail? ☐ Yes ☐ No
Have all offset operators been given written notice of the proposed downhole commingling? ☒ Yes ☐ No11. Will cross-flow occur? ☐ Yes ☒ No If yes, are fluids compatible, will the formations not be damaged, will any cross-flowed production be recovered, and will the allocation formula be reliable. ☐ Yes ☐ No (If No, attach explanation)12. Are all produced fluids from all commingled zones compatible with each other? ☒ Yes ☐ No13. Will the value of production be decreased by commingling? ☐ Yes ☒ No (If Yes, attach explanation)14. If this well is on, or communitized with, state or federal lands, either the Commissioner of Public Lands or the United States Bureau of Land Management has been notified in writing of this application. ☒ Yes ☐ No

15. NMOCD Reference Cases for Rule 303(D) Exceptions: ORDER NO(S).

16. ATTACHMENTS:

- * C-102 for each zone to be commingled showing its spacing unit and acreage dedication.
- * Production curve for each zone for at least one year. (If not available, attach explanation.)
- * For zones with no production history, estimated production rates and supporting data.
- * Data to support allocation method or formula.
- * Notification list of all offset operators.
- * Notification list of working, overriding, and royalty interests for uncommon interest cases.
- * Any additional statements, data, or documents required to support commingling.

I hereby certify that the information above is true and complete to the best of my knowledge and belief.

SIGNATURE Kevin L. Midkiff TITLE Operations Engineer DATE 06-23-97TYPE OR PRINT NAME Kevin L. Midkiff TELEPHONE NO. (505) 326-9700

All distances must be from the outer boundaries of the Section

| | | | | | |
|---|---|------------------------|-------------------------------------|---------------------------|--|
| Operator SOUTHLAND ROYALTY COMPANY | | | Lease Cain | | Well No. 11-E |
| Unit Letter 0 | Section 15 | Township 28N | Range 10W | County San Juan | |
| Actual Footage Location of Well: 810 feet from the South line and 1825 feet from the East line | | | | | |
| Ground Level Elev. 5935 | Producing Formation Dakota - Gallup | | Pool Basin - Undesignated | | Dedicated Acreage: 320 Acres |

1. Outline the acreage dedicated to the subject well by colored pencil or hatchure marks on the plat below.
2. If more than one lease is dedicated to the well, outline each and identify the ownership thereof (both as to working interest and royalty).
3. If more than one lease of different ownership is dedicated to the well, have the interests of all owners been consolidated by communitization, unitization, force-pooling, etc?

☐ Yes ☐ No If answer is "yes," type of consolidation _____

If answer is "no," list the owners and tract descriptions which have actually been consolidated. (Use reverse side of this form if necessary.) _____

No allowable will be assigned to the well until all interests have been consolidated (by communitization, unitization, forced-pooling, or otherwise) or until a non-standard unit, eliminating such interests, has been approved by the Commission.

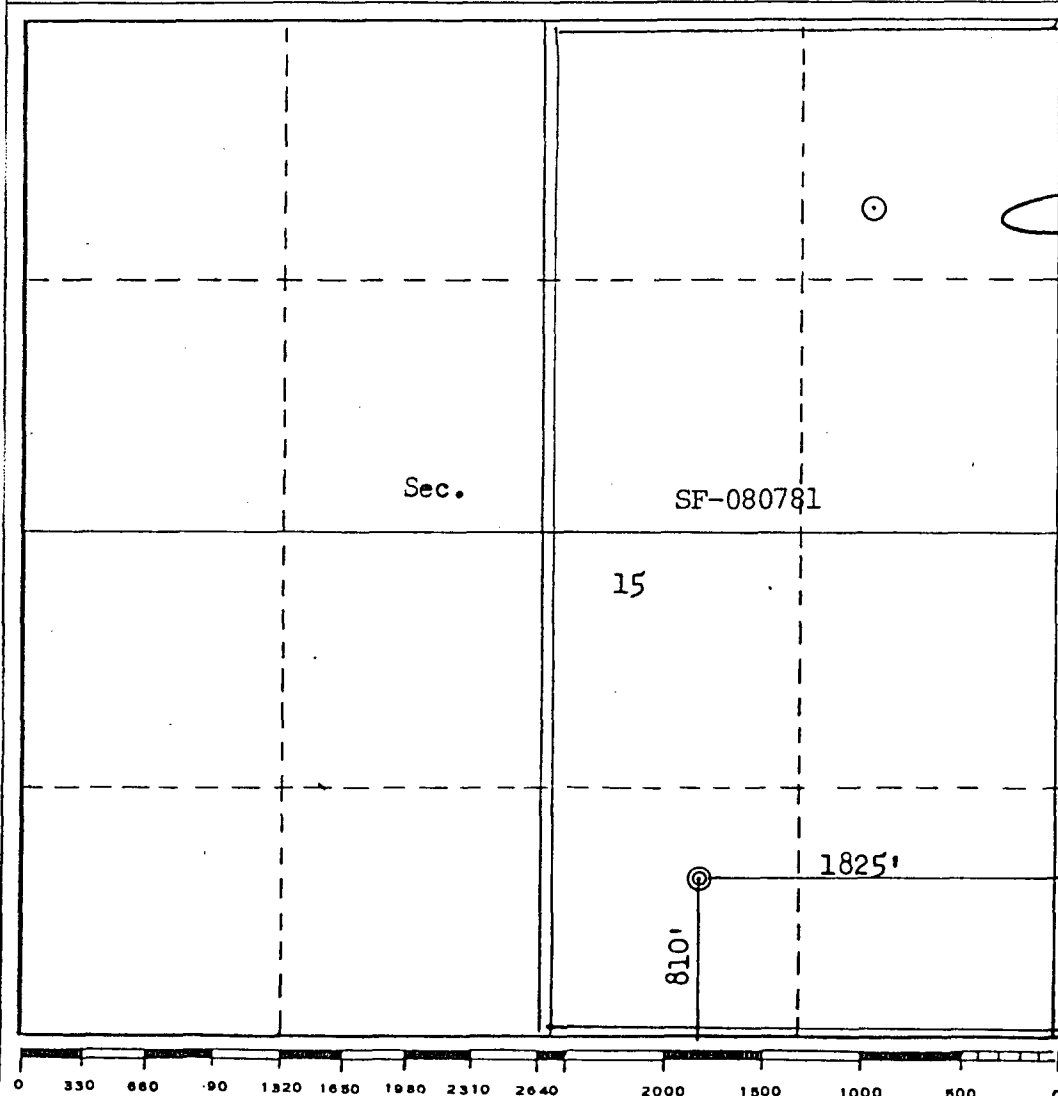

CERTIFICATION

I hereby certify that the information contained herein is true and complete to the best of my knowledge and belief.

Name
L. O. Van Ryan

Position
District Production Manager

Company
Southland Royalty Company

Date
November 6, 1979

I hereby certify that the well location shown on this plat was plotted from field notes of actual surveys made by me or under my supervision, and that the same is true and correct to the best of my knowledge and belief.

Date Surveyed

October 26, 1979

Registered Professional Engineer
and/or Land Surveyor No. **1250**

Fred B. Kerr Jr.

Certificate No. **3950**

WELL LOCATION AND ACREAGE DEDICATION PLAT

Effective 1-1-65

All distances must be from the outer boundaries of the Section.

| | | | | | |
|--|-------------------------------|-----------------|----------------------|---------------------------------|--|
| Operator Southland Royalty Company | | Lease Cain | | Well No. #11E | |
| Unit Letter O | Section 15 | Township 28N | Range 10W | County San Juan | |
| Actual Footage Location of Well: 810' feet from the South line and 1825 feet from the East line | | | | | |
| Ground Level Elev. 5935' | Producing Formation Chacra | | Pool Undesignated | Dedicated Acreage: 320 Acres | |

1. Outline the acreage dedicated to the subject well by colored pencil or hatchure marks on the plat below.
2. If more than one lease is dedicated to the well, outline each and identify the ownership thereof (both as to working interest and royalty).
3. If more than one lease of different ownership is dedicated to the well, have the interests of all owners been consolidated by communitization, unitization, force-pooling, etc?

☐ Yes ☐ No If answer is "yes," type of consolidation _____

If answer is "no," list the owners and tract descriptions which have actually been consolidated. (Use reverse side of this form if necessary.) _____

No allowable will be assigned to the well until all interests have been consolidated (by communitization, unitization, forced-pooling, or otherwise) or until a non-standard unit, eliminating such interests, has been approved by the Commission.

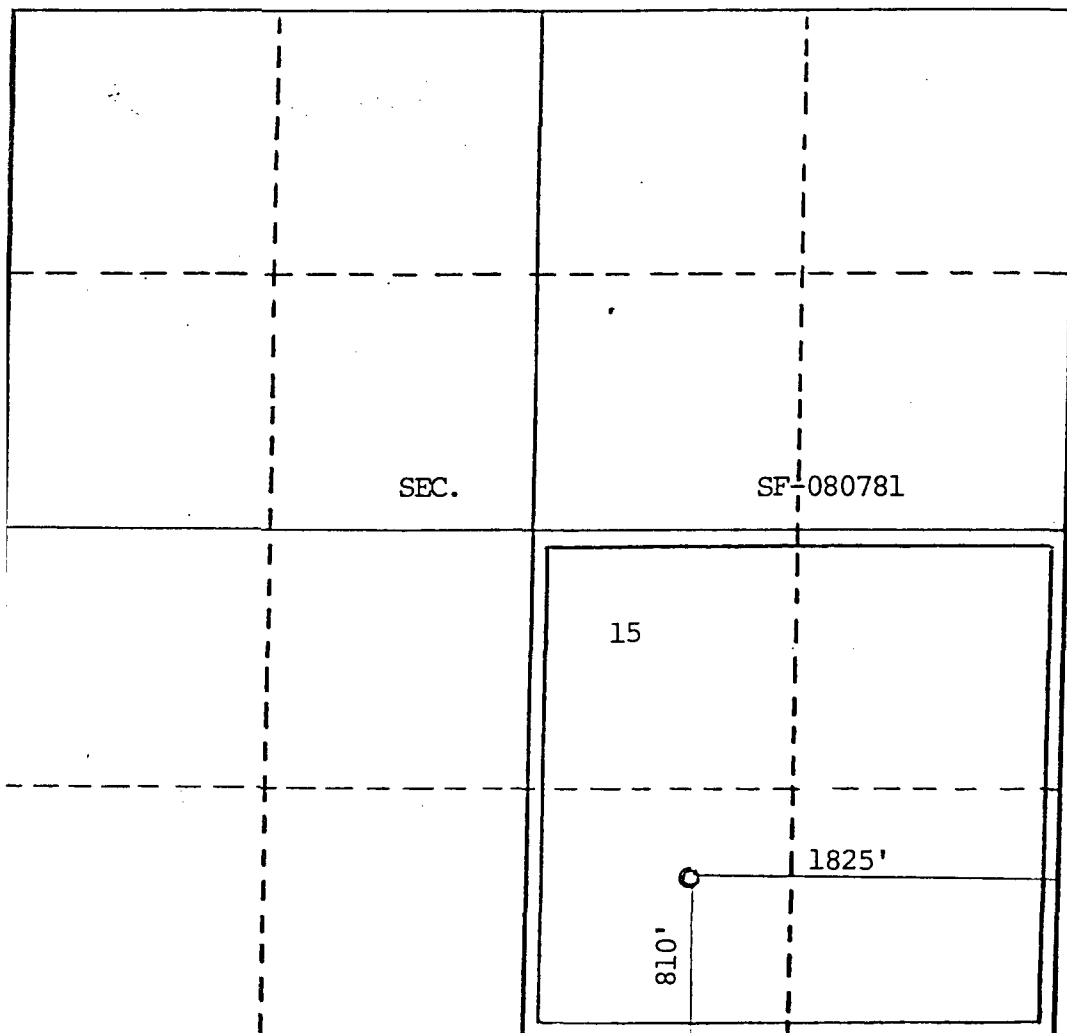

CERTIFICATION

I hereby certify that the information contained herein is true and complete to the best of my knowledge and belief.

Name
Curtis C. Parsons
Position
District Engineer
Company
Southland Royalty Company
Date
June 3, 1980

I hereby certify that the well location shown on this plat was plotted from field notes of actual surveys made by me or under my supervision, and that the same is true and correct to the best of my knowledge and belief.

Date Surveyed
October 16, 1979

Registered Professional Engineer
and/or Land Surveyor

Fred B. Kerr, Jr.

Certificate No.
3950

330 660 990 1320 1650 1980 2310 2640 2970 3300 3630 3960 4290 4620 4950 5280 5610 5940 6270 6600

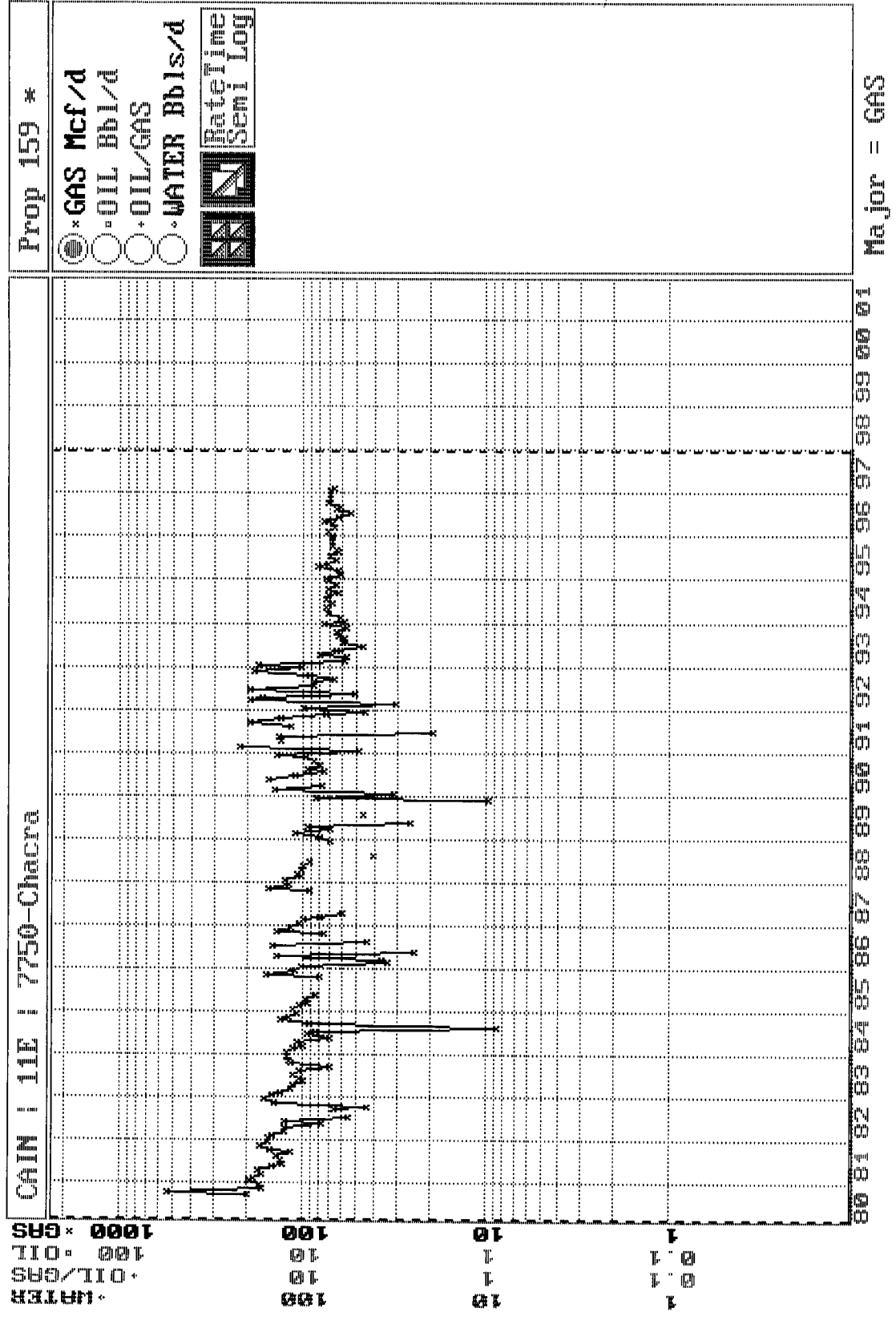

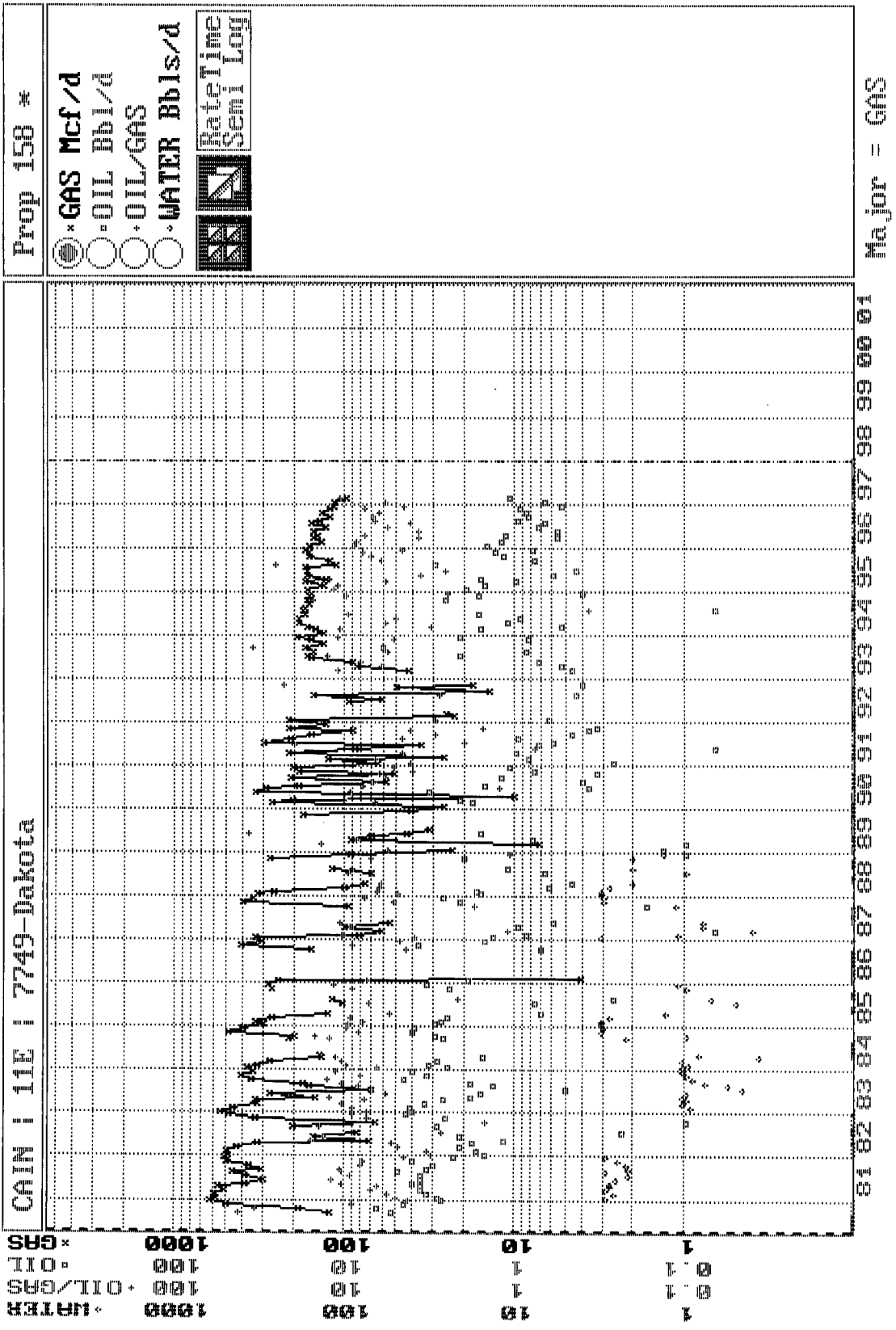

BURLINGTON RESOURCES OIL AND GAS COMPANY

**Cain #11E
OFFSET OPERATOR \ OWNER PLAT**

Chacra (SE/4)/Dakota (E/2) Formations Commingle Well

Township 28 North, Range 10 West

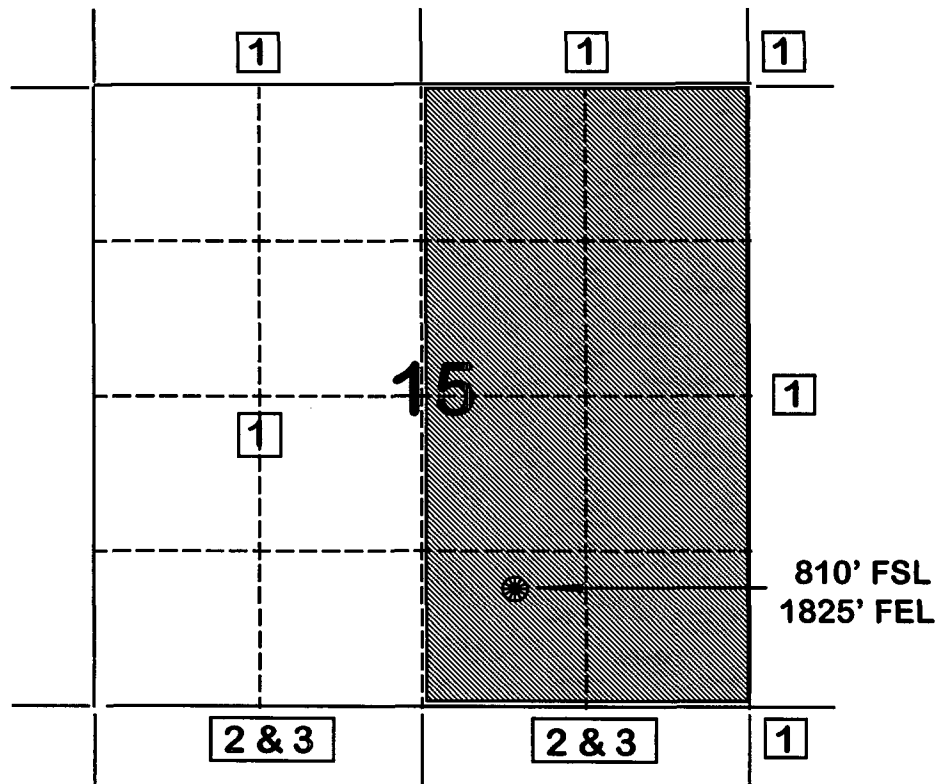

- 1) Burlington Resources Oil and Gas Company
- 2) Amoco Production Company
Attn: Bruce Zimney
P.O. Box 800
Denver, CO 80201
- 3) Universal Resources
1331 17th Street, Suite 300
Denver, CO 80202

Organize Data ScreenGraph Economics Report Plot Utility Quit
 Editing: CAIN | 11E | 7749-Dakota Property No.: 158
 Table(T): TEST/M,P,H,T,Z,C,A,O,D,1,2,3,B,U,S Rec: 1/9/1018
 Item: 2/3/33 Name: DATE Type: Date Len: 8/27/203

| --DATE-- | ---CUM GAS-- | M SIWHP |
|----------|--------------|---------|
| | Mcf | Psi |
| 05/07/80 | 0 | 836.0 |
| 11/08/80 | 24666 | 749.0 |
| 09/24/81 | 167806 | 574.0 |
| 05/25/82 | 265553 | 429.0 |
| 09/08/83 | 382438 | 577.0 |
| 12/05/85 | 549725 | 527.0 |
| 08/17/88 | 658285 | 397.0 |
| 10/02/90 | 734544 | 434.0 |
| 05/05/93 | 824889 | 370.0 |

F1=Help F3=PrvProp F5=PrvTbl F7=InsRcd F9=Utils Alt+TableLtr=Change Table
 F2=Jump F4=NxtProp F6=NxtTbl F8=DelRcd F10=Exit Shift+<- ->=Fast Tbl R & L

Organize Data ScreenGraph Economics Report Plot Utility Quit
 Editing: CAIN | 11E | 7750-Chacra Property No.: 159
 Table(T): TEST/M,P,H,T,Z,C,A,O,D,1,2,3,B,U,S Rec: 1/5/1018
 Item: 2/3/33 Name: DATE Type: Date Len: 8/27/203

| --DATE-- | ---CUM GAS-- | M SIWHP |
|----------|--------------|---------|
| | Mcf | Psi |
| 05/07/80 | 0 | 1013.0 |
| 09/24/81 | 74532 | 673.0 |
| 05/24/82 | 107954 | 660.0 |
| 09/08/83 | 152986 | 647.0 |
| 05/05/93 | 433872 | 435.0 |

F1=Help F3=PrvProp F5=PrvTbl F7=InsRcd F9=Utils Alt+TableLtr=Change Table
 F2=Jump F4=NxtProp F6=NxtTbl F8=DelRcd F10=Exit Shift+<- ->=Fast Tbl R & L

FDG055M4 S004
START OF DATA
DP NO: 7749_
CAIN

WELL PRODUCTION 8/8'S VOLUME

06/17/97 11:43:20

DAKOTA

DATE: 970615 (YYMMDD FORMAT)

11E SCROLL FORWARD BY DATE: _

| E | DATE | HOURS | -OIL PRODN- | -GAS PRODN- | -WATER PRODN- |
|---|----------|-------|-------------|-------------|---------------|
| L | PRODUCED | ON | (BOPD BOPM) | (MCFD MCFM) | (BWPD BWPM) |
| - | 06/15/97 | 24.0 | 1.20 18.00 | 135 2236 | 0.00 0.00 |
| - | 06/14/97 | 24.0 | 1.20 16.80 | 135 2101 | 0.00 0.00 |
| - | 06/13/97 | 24.0 | 1.20 15.60 | 142 1966 | 0.00 0.00 |
| - | 06/12/97 | 24.0 | 1.20 14.40 | 142 1824 | 0.00 0.00 |
| - | 06/11/97 | 24.0 | 1.20 13.20 | 142 1682 | 0.00 0.00 |
| - | 06/10/97 | 24.0 | 1.20 12.00 | 154 1540 | 0.00 0.00 |
| - | 06/09/97 | 24.0 | 1.20 10.80 | 154 1386 | 0.00 0.00 |
| - | 06/08/97 | 24.0 | 1.20 9.60 | 154 1232 | 0.00 0.00 |
| - | 06/07/97 | 24.0 | 1.20 8.40 | 154 1078 | 0.00 0.00 |
| - | 06/06/97 | 24.0 | 1.20 7.20 | 154 924 | 0.00 0.00 |
| - | 06/05/97 | 24.0 | 1.20 6.00 | 154 770 | 0.00 0.00 |

ENTER I UNDER SEL FOR MAINTENANCE

PF12=MAIN MENU PF6=NRI PF10=BROWSE MENU PF11=INQ/UPDATE MENU
B MY JOB ENTER=BACKWARDS PF24=HELP
LU #6

FDG055M4 S004
START OF DATA
DP NO: 7750_
CAIN

WELL PRODUCTION 8/8'S VOLUME

06/17/97 11:43:30

CHACRA

DATE: 970615 (YYMMDD FORMAT)

11E SCROLL FORWARD BY DATE: _

| E | DATE | HOURS | -OIL PRODN- | -GAS PRODN- | -WATER PRODN- |
|---|----------|-------|-------------|-------------|---------------|
| L | PRODUCED | ON | (BOPD BOPM) | (MCFD MCFM) | (BWPD BWPM) |
| - | 06/15/97 | 24.0 | 0.00 0.00 | 71 1123 | 0.00 0.00 |
| - | 06/14/97 | 24.0 | 0.00 0.00 | 71 1052 | 0.00 0.00 |
| - | 06/13/97 | 24.0 | 0.00 0.00 | 71 981 | 0.00 0.00 |
| - | 06/12/97 | 24.0 | 0.00 0.00 | 71 910 | 0.00 0.00 |
| - | 06/11/97 | 24.0 | 0.00 0.00 | 71 839 | 0.00 0.00 |
| - | 06/10/97 | 24.0 | 0.00 0.00 | 84 768 | 0.00 0.00 |
| - | 06/09/97 | 24.0 | 0.00 0.00 | 84 684 | 0.00 0.00 |
| - | 06/08/97 | 24.0 | 0.00 0.00 | 84 600 | 0.00 0.00 |
| - | 06/07/97 | 24.0 | 0.00 0.00 | 84 516 | 0.00 0.00 |
| - | 06/06/97 | 24.0 | 0.00 0.00 | 72 432 | 0.00 0.00 |
| - | 06/05/97 | 24.0 | 0.00 0.00 | 72 360 | 0.00 0.00 |

ENTER I UNDER SEL FOR MAINTENANCE

PF12=MAIN MENU PF6=NRI PF10=BROWSE MENU PF11=INQ/UPDATE MENU
B MY JOB ENTER=BACKWARDS PF24=HELP
LU #6

Organize Data ScreenGraph Economics Report Plot Utility Quit
 Editing: CAIN | 11E | 7749-1 *DAKOTA* Property No.: 158
 Table(T): TEST/M,P,H,T,Z,C,A,O,D,1,2,3,B,U,S Rec: 1/10/1032
 Item: 2/3/33 Name: DATE Type: Date Len: 8/27/203

| --DATE-- | ---CUM GAS-- | M SIWHP |
|----------|--------------|---------|
| | Mcf | Psi |
| 05/07/80 | 0 | 836.0 |
| 11/08/80 | 24666 | 749.0 |
| 09/24/81 | 167806 | 574.0 |
| 05/25/82 | 265553 | 429.0 |
| 09/08/83 | 382438 | 577.0 |
| 12/05/85 | 549725 | 527.0 |
| 08/17/88 | 658285 | 397.0 |
| 10/02/90 | 734544 | 434.0 |
| 05/05/93 | 824889 | 370.0 |

F1=Help F3=PrvProp F5=PrvTbl F7=InsRcd F9=Utils Alt+TableLtr=Change Table
 F2=Jump F4=NxtProp F6=NxtTbl F8=DelRcd F10=Exit Shift+<- ->=Fast Tbl R & L

Organize Data ScreenGraph Economics Report Plot Utility Quit
 Editing: CAIN | 11E | 7750-1 *CHACRA* Property No.: 159
 Table(T): TEST/M,P,H,T,Z,C,A,O,D,1,2,3,B,U,S Rec: 1/6/1032
 Item: 2/3/33 Name: DATE Type: Date Len: 8/27/203

| --DATE-- | ---CUM GAS-- | M SIWHP |
|----------|--------------|---------|
| | Mcf | Psi |
| 05/07/80 | 0 | 1013.0 |
| 09/24/81 | 74532 | 673.0 |
| 05/24/82 | 107954 | 660.0 |
| 09/08/83 | 152986 | 647.0 |
| 05/05/93 | 433872 | 435.0 |

F1=Help F3=PrvProp F5=PrvTbl F7=InsRcd F9=Utils Alt+TableLtr=Change Table
 F2=Jump F4=NxtProp F6=NxtTbl F8=DelRcd F10=Exit Shift+<- ->=Fast Tbl R & L

Cain #11E
Bottom Hole Pressures
Flowing and Static BHP
Cullender and Smith Method
Version 1.0 3/13/94

| Chacra | | Dakota | |
|--------------------------------|--------|--------------------------------|-------|
| <u>CH-Current</u> | | <u>DK-Current</u> | |
| GAS GRAVITY | 0.674 | GAS GRAVITY | 0.674 |
| COND. OR MISC. (C/M) | C | COND. OR MISC. (C/M) | C |
| %N2 | 0.83 | %N2 | 0.83 |
| %CO2 | 0.24 | %CO2 | 0.24 |
| %H2S | 0 | %H2S | 0 |
| DIAMETER (IN) | 5.5 | DIAMETER (IN) | 1.9 |
| DEPTH (FT) | 3086 | DEPTH (FT) | 6514 |
| SURFACE TEMPERATURE (DEG F) | 60 | SURFACE TEMPERATURE (DEG F) | 60 |
| BOTTOMHOLE TEMPERATURE (DEG F) | 102 | BOTTOMHOLE TEMPERATURE (DEG F) | 150 |
| FLOWRATE (MCFPD) | 0 | FLOWRATE (MCFPD) | 0 |
| SURFACE PRESSURE (PSIA) | 435 | SURFACE PRESSURE (PSIA) | 370 |
| BOTTOMHOLE PRESSURE (PSIA) | 470.3 | BOTTOMHOLE PRESSURE (PSIA) | 432.1 |
| <u>CH-Original</u> | | <u>DK-Original</u> | |
| GAS GRAVITY | 0.674 | GAS GRAVITY | 0.674 |
| COND. OR MISC. (C/M) | C | COND. OR MISC. (C/M) | C |
| %N2 | 0.83 | %N2 | 0.83 |
| %CO2 | 0.24 | %CO2 | 0.24 |
| %H2S | 0 | %H2S | 0 |
| DIAMETER (IN) | 5.5 | DIAMETER (IN) | 1.9 |
| DEPTH (FT) | 3086 | DEPTH (FT) | 6514 |
| SURFACE TEMPERATURE (DEG F) | 60 | SURFACE TEMPERATURE (DEG F) | 60 |
| BOTTOMHOLE TEMPERATURE (DEG F) | 102 | BOTTOMHOLE TEMPERATURE (DEG F) | 150 |
| FLOWRATE (MCFPD) | 0 | FLOWRATE (MCFPD) | 0 |
| SURFACE PRESSURE (PSIA) | 1013 | SURFACE PRESSURE (PSIA) | 836 |
| BOTTOMHOLE PRESSURE (PSIA) | 1105.2 | BOTTOMHOLE PRESSURE (PSIA) | 988.7 |

| | | | |
|--|--|---|--|
| CH-E SKELLY GAS COM CH-2 NEW MEXICO COMA CH-1 ZACHRY CH-20 ZACHRY CH-45 ZACHRY CH-47 ZACHRY | CH-1 ZACHRY CH-20 ZACHRY CH-45 ZACHRY CH-47 ZACHRY | CH-23 ZACHRY CH-49 ZACHRY CH-51 ZACHRY | CH-7 ZACHRY CH-17 ZACHRY |
| CH-A MEX NEW FEDERAL CH-1 MEXICO FEDERAL CH-16 | CH-42 ZACHRY CH-46 ZACHRY CH-39 ZACHRY CH-37 ZACHRY CH-18 ZACHRY CH-25 ZACHRY CH-55 ZACHRY CH-56 ZACHRY | CH-11 CAIN-D CH-15 CAIN CH-19-E MC CLANAHAN CH-22 MCCLANAHAN CH-19 MC CLANAHAN CH-22 MCCLANAHAN CH-19 MC CLANAHAN CH-22 MCCLANAHAN | CH-11 CAIN-D CH-15 CAIN CH-19-E MC CLANAHAN CH-22 MCCLANAHAN CH-19 MC CLANAHAN CH-22 MCCLANAHAN |
| CH-13 CAIN CH-19-E CAIN CH-16 CH-19 CAIN-D CH-14 CAIN CH-12-E CAIN CH-16 | CH-19 CAIN-D CH-23 CAIN CH-11 CAIN-D CH-15 CAIN CH-19-E MC CLANAHAN CH-22 MCCLANAHAN CH-19 MC CLANAHAN CH-22 MCCLANAHAN | CH-11 CAIN-D CH-15 CAIN CH-19-E MC CLANAHAN CH-22 MCCLANAHAN CH-19 MC CLANAHAN CH-22 MCCLANAHAN | CH-11 CAIN-D CH-15 CAIN CH-19-E MC CLANAHAN CH-22 MCCLANAHAN CH-19 MC CLANAHAN CH-22 MCCLANAHAN |
| CH-A DAVIDSON CH-2 MCLANE-KUTZ CH-21 | CH-E DAVIDSON GAS COM CH-1 KUTZ CH-1 G DAVIDSON CH-22 | CH-1 KUTZ CH-1 G DAVIDSON CH-22 | CH-1 KUTZ CH-1 G DAVIDSON CH-22 |
| CH-1 DAVIDSON CH-1 DAVIDSON CH-12-E DAVIDSON CH-12-21 KUTZ-FED | CH-1 KUTZ CH-1 G DAVIDSON CH-22 | CH-1 KUTZ CH-1 G DAVIDSON CH-22 | CH-1 KUTZ CH-1 G DAVIDSON CH-22 |
| CH-1 DAVIDSON CH-1 DAVIDSON CH-12-E DAVIDSON CH-12-21 KUTZ-FED | CH-1 KUTZ CH-1 G DAVIDSON CH-22 | CH-1 KUTZ CH-1 G DAVIDSON CH-22 | CH-1 KUTZ CH-1 G DAVIDSON CH-22 |

Cain 11E

Sec150 T28N R10W

Dakota/Chacra