

DATE IN 8/15/97	SUSPENSE 9/4/97	ENGINEER DC	LOGGED BY KV	TYPE DHC
-----------------	-----------------	-------------	--------------	----------

ABOVE THIS LINE FOR DIVISION USE ONLY

NEW MEXICO OIL CONSERVATION DIVISION

- Engineering Bureau -

ADMINISTRATIVE APPLICATION COVERSHEET

THIS COVERSHEET IS MANDATORY FOR ALL ADMINISTRATIVE APPLICATIONS FOR EXCEPTIONS TO DIVISION RULES AND REGULATIONS

Application Acronyms:

[NSP-Non-Standard Proration Unit] [NSL-Non-Standard Location]
 [DD-Directional Drilling] [SD-Simultaneous Dedication]
 [DHC-Downhole Commingling] [CTB-Lease Commingling] [PLC-Pool/Lease Commingling]
 [PC-Pool Commingling] [OLS - Off-Lease Storage] [OLM-Off-Lease Measurement]
 [WFX-Waterflood Expansion] [PMX-Pressure Maintenance Expansion]
 [SWD-Salt Water Disposal] [IPI-Injection Pressure Increase]
 [EOR-Qualified Enhanced Oil Recovery Certification] [PPR-Positive Production Response]

[1] TYPE OF APPLICATION - Check Those Which Apply for [A]

[A] Location - Spacing Unit - Directional Drilling

☐ NSL ☐ NSP ☐ DD ☐ SD

AUG 15 1997

Check One Only for [B] and [C]

[B] Commingling - Storage - Measurement

☒ DHC ☐ CTB ☐ PLC ☐ PC ☐ OLS ☐ OLM

[C] Injection - Disposal - Pressure Increase - Enhanced Oil Recovery

☐ WFX ☐ PMX ☐ SWD ☐ IPI ☐ EOR ☐ PPR

[2] NOTIFICATION REQUIRED TO: - Check Those Which Apply, or ☐ Does Not Apply

[A] ☐ Working, Royalty or Overriding Royalty Interest Owners

[B] ☒ Offset Operators, Leaseholders or Surface Owner

[C] ☐ Application is One Which Requires Published Legal Notice

[D] ☒ Notification and/or Concurrent Approval by BLM or SLO

U.S. Bureau of Land Management - Commissioner of Public Lands, State Land Office

[E] ☐ For all of the above, Proof of Notification or Publication is Attached, and/or,

[F] ☐ Waivers are Attached

[3] INFORMATION / DATA SUBMITTED IS COMPLETE - Statement of Understanding

I hereby certify that I, or personnel under my supervision, have read and complied with all applicable Rules and Regulations of the Oil Conservation Division. Further, I assert that the attached application for administrative approval is accurate and complete to the best of my knowledge and where applicable, verify that all interest (WI, RI, ORRI) is common. I understand that any omission of data, information or notification is cause to have the application package returned with no action taken.

Note: Statement must be completed by an individual with supervisory capacity.

Ann E. Ritchie
Print or Type Name

Signature

Regulatory Agent
Title

8-12-97
Date

DISTRICT I
P.O. Box 1980, Hobbs, NM 88241-1980

DISTRICT II
811 South First St., Artesia, NM 88210-2835

DISTRICT III
1000 Rio Brazos Rd., Aztec, NM 87410-1693

State of New Mexico
Energy, Minerals and Natural Resources Department

OIL CONSERVATION DIVISION

2040 S. Pacheco
Santa Fe, New Mexico 87505-6429

Form C-107-A
New 3-12-96

APPROVAL PROCESS:

☒ Administrative ☐ Hearing

EXISTING WELLBORE

☒ YES ☐ NO

APPLICATION FOR DOWNHOLE COMMINGLING

Conoco Inc.

10 Desta Dr., Ste 100W, Midland, TX 79705-4500

Operator

Address

Trieb Federal

2

O-33,T-30-N,R10-W

San Juan

Lease

Well No

Unit Ltr Sec Twp Rge

County

Spacing Unit Lease Types: (check 1 or more)

OGRID NO. 005073 Property Code 17979 API NO. 30 045 08947 Federal ☒ State ☐ (and/or) Fee ☐

The following facts are submitted in support of downhole commingling:	Upper Zone	intermediate Zone	Lower Zone
1. Pool Name and Pool Code	Mesa Verde 72319		Dakota 71599
2. TOP and Bottom of Pay Section (Perforations)	4424-4838'(Proposed)		6830-7004'
3. Type of production (Oil or Gas)	Gas		Gas
4. Method of Production (Flowing or Artificial Lift)	To Flow		Flowing
5. Bottom hole Pressure	a (Current)	a.	a.
Oil Zones - Artificial Lift: Estimated Current	568 PSIA		597 PSIA
Gas & Oil - Flowing: Measured Current	b (Original)	b.	b.
All Gas Zones: Estimated Or Measured Original	1080 PSIA		2383 PSIA
6. Oil Gravity (*API) or Gas BTU Content	1200 BTU Est.		1174 BTU
7. Producing or Shut-In?	new zone		Producing
Production Marginal? (yes or no)	YES		YES
• If Shut-In give date and oil/gas/water rates of last production	Date Rates new zone	Date Rates:	Date Rates:
Note: For new zones with no production history, applicant shall be required to attach production estimates and supporting data.			
• If Producing, give date and oil/gas/water rates of recent test (within 60 days)	Date Rates Incremental Production by subtraction	Date Rates:	Date Rates 6/15/97,92 mcf/d 0 bopd, 0 bwpd
8. Fixed Percentage Allocation Formula - % for each zone	oil: % Gas %	oil: % Gas %	oil: % Gas %

9. If allocation formula is based upon something other than current or past production, or is based upon some other method, submit attachments with supporting data and/or explaining method and providing rate projections or other required data.

10. Are all working, overriding, and royalty interests identical in all commingled zones? ☒ Yes ☐ No
If not, have all working, overriding, and royalty interests been notified by certified mail? ☒ Yes ☐ No
Have all offset operators been given written notice of the proposed downhole commingling? ☒ Yes ☐ No

11. Will cross-flow occur? ☒ Yes ☐ No If yes, are fluids compatible, will the formations not be damaged, will any cross-flowed production be recovered, and will the allocation formula be reliable. ☒ Yes ☐ No (If No, attach explanation)

12. Are all produced fluids from all commingled zones compatible with each others ☒ Yes ☐ No

13. Will the value of production be decreased by commingling? ☐ Yes ☒ No (If Yes, attach explanation)

14. If this well is on, or communitized with, state or federal lands, either the Commissioner of Public Lands or the United States Bureau of Land Management has been notified in writing of this application. ☒ Yes ☐ No

15. NMOCD Reference Cases for Rule 303(D) Exceptions: ORDER NO(S).

16. ATTACHMENTS

- * C-102 for each zone to be commingled showing its spacing unit and acreage dedication.
- * Production curve for each zone for at least one year. (If not available, attach explanation.)
- * For zones with no production history, estimated production rates and supporting data.
- * Data to support allocation method or formula.
- * Notification list of all offset operators.
- * Notification list of working, overriding and royalty interests for uncommon interest cases.
- * Any additional statements, data, or documents required to support commingling.

I hereby certify that the information above is true and complete to the best of my knowledge and belief.

SIGNATURE  TITLE Regulatory Agent DATE 8-11-97

TYPE OR PRINT NAME Ann E. Ritchie TELEPHONE NO. (915) 686-6548/684-6381

16	
<p>2 ○ ←</p>	

17	OPERATOR CERTIFICATION <i>I hereby certify that the information contained herein is true and complete to the best of my knowledge and belief.</i>
	 Signature _____ Printed Name <u>Jerry W. Hoover</u> Title <u>Sr. Conservation Coordinator</u> Date <u>4/20/94</u>
	18 SURVEYOR CERTIFICATION <i>I hereby certify that the well location shown on this plot was plotted from field notes of actual surveys made by me or under my supervision, and that the same is true and correct to the best of my belief.</i>
	Date of Survey _____ Signature and Seal of Professional Surveyer: _____ Certificate Number _____

NEW MEXICO OIL CONSERVATION COMMISSION

Well Location and Acreage Dedication Plat

Section A.

Date June 26, 1962

Operator PUBCO PETROLEUM CO. Lease TRIEB FEDERAL
 Well No. 2-33-0 Unit Letter 0 Section 33 Township 30 N Range 10 W NMPN
 Located 1190 Feet From south Line, 1550 Feet From east Line
 County San Juan G. L. Elevation 6019 Dedicated Acreage _____ Acres
 Name of Producing Formation Dakota Pool Basin Dakota

1. Is the Operator the only owner* in the dedicated acreage outlined on the plat below?
Yes ☒ No _____.
2. If the answer to question one is "no," have the interests of all the owners been consolidated by communitization agreement or otherwise? Yes ☒ No _____. If answer is "yes," Type of Consolidation Communitization agreement.
3. If the answer to question two is "no," list all the owners and their respective interests below:

OwnerPubco Petroleum CorporationLand DescriptionE/2 Sec. 33 T30N R10W

Section B

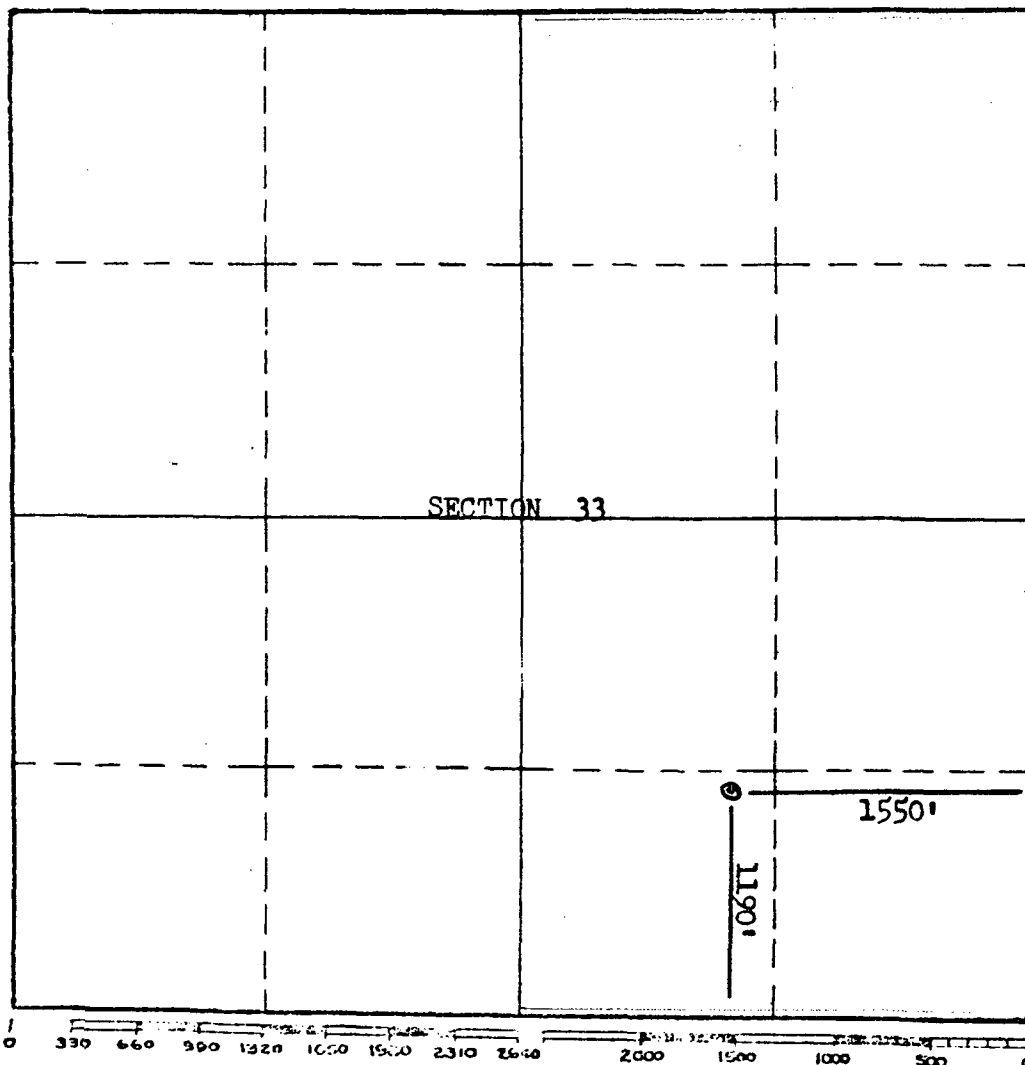

This is to certify that the information in Section A above is true and complete to the best of my knowledge and belief.

Pubco Petroleum Corporation

(Operator)

H. H. Maxwell, Jr.

(Representative)

Box 1419, Albuquerque, N.M.

Address

This is to certify that the well location shown on the plat in Section B was plotted from field notes of actual surveys made by me or under my supervision and that the same is true and correct to the best of my knowledge and belief.

Date Surveyed June 6, 1962Stephen H. Kinney
STEPHEN H. KINNEY, 503 LRegistered Professional
Engineer and/or Land SurveyorCertificate No. 803

**TRIEB #2 DAKOTA PRODUCTION
SECTION 330-30N-10W**

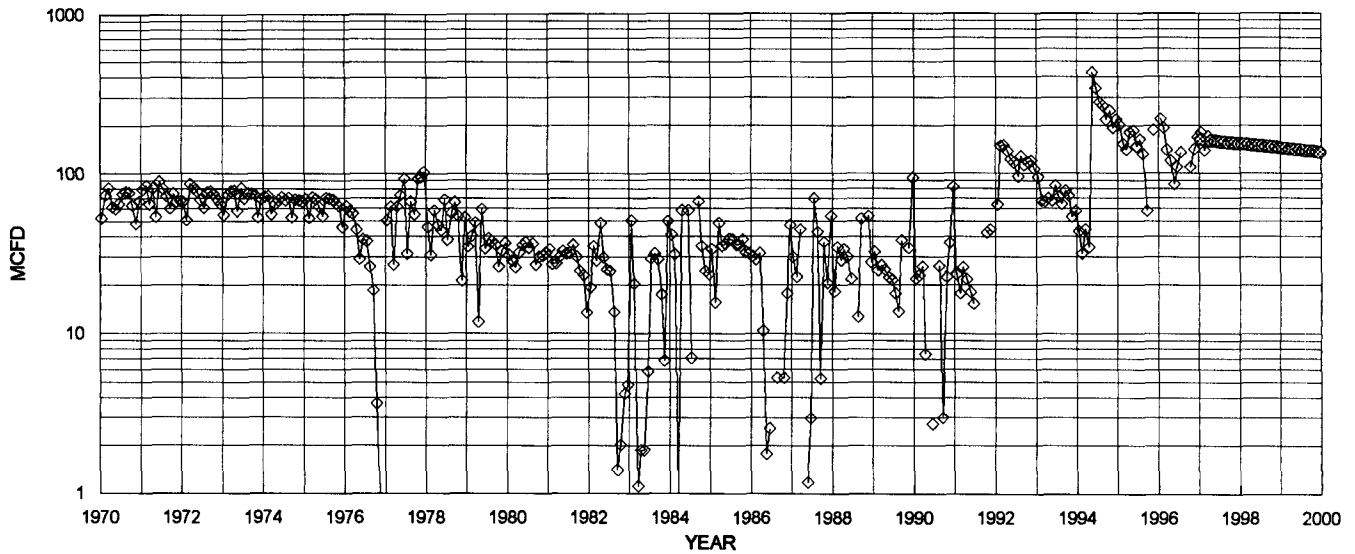

◇ DAKOTA MCFD — FIT MCFD

DAKOTA HISTORICAL DATA 1ST PROD: 11/82

OIL CUM: 1.8 MBO
GAS CUM: 849.6 MMCF
OIL YIELD: 0.0021 BBL/MCF

DAKOTA PROJECTED DATA

1/1/97 Q1: 183 MCFD
DECLINE RATE: 8.0% (EXPONENTIAL)
OIL YIELD: 0.0032 BBL/MCF, LAST 3 YEARS

PRODUCTION FORECAST FOR SUBTRACTION METHOD COMMINGLE ALLOCATION

YEAR	MID-YEAR AVG MCFD	MID-YEAR AVG BOPD
1997	158	0.5
1998	148	0.5
1999	139	0.4
2000	131	0.4
2001	123	0.4
2002	116	0.4
2003	109	0.3
2004	102	0.3
2005	96	0.3
2006	90	0.3
2007	85	0.3
2008	80	0.3
2009	75	0.2
2010	71	0.2
2011	68	0.2
2012	62	0.2
2013	59	0.2
2014	55	0.2
2015	52	0.2
2016	49	0.2
2017	46	0.1
2018	43	0.1
2019	40	0.1
2020	38	0.1
2021	36	0.1
2022	34	0.1
2023	32	0.1
2024	30	0.1
2025	28	0.1
2026	26	0.1

Conoco, Inc.
Trieb Federal, Well #2
San Juan County, New Mexico
Attachment to Form C-107-A

Offset Operators-other than Conoco:

Burlington O & G Resources Co.
P.O. Box 4289
Farmington, NM 87499

Amoco Production Co.
P.O. Box 800
Denver, CO 80201

Dugan Production Corp.
P.O. Box 420
Farmington, NM 87499-0420

Copies of C-107-A and attachments sent 8-12-97.

A handwritten signature in black ink, appearing to read "R. L. P. H.", is located at the bottom right of the page.