

TOWNSHIP 18 South RANGE 32 East NMPM

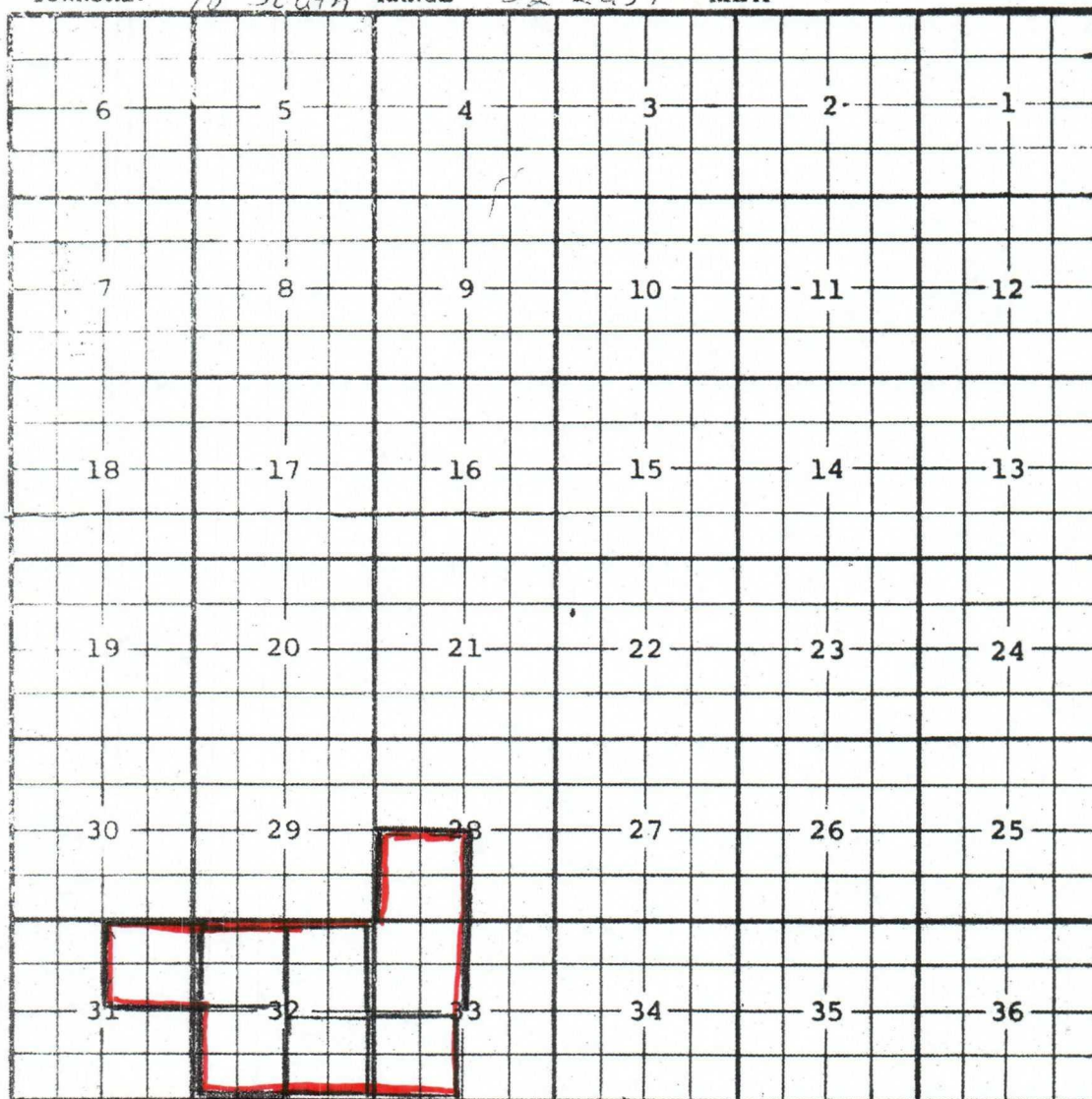

Ext: <sup>SE</sup>4 Sec. 32 (A-7667, 9-21-84) Ext: <sup>NE</sup>4 Sec. 32 (A-8356, 12-3-86).

EXT: SW/4 sec 33 (R-8826, 12-22-88) Ex+; <sup>NW</sup> 4 sec 32 (R-9937, 8-17-93)

Ext: <sup>SW</sup> 4 Sec. 32 (R-12317, 3-25-05) Ext: <sup>SW</sup> 4 Sec. 28, <sup>NE</sup> 4 Sec. 31, <sup>NW</sup> 4 Sec. 33 (R-12449, 10-22-05)

New Mexico Oil Conservation Division, District I  
1625 N. French Drive  
Hobbs, NM 88240

FORM APPROVED  
OMB No. 1004-0136  
Expires January 31, 2004

UNITED STATES  
DEPARTMENT OF THE INTERIOR  
BUREAU OF LAND MANAGEMENT

APPLICATION FOR PERMIT TO DRILL OR REENTER

1a. Type of Work: ☒ DRILL ☐ REENTER

5. Lease Serial No.

NM- 23006

6. If Indian, Allottee or Tribe Name

7. If Unit or CA Agreement, Name and No.

8. Lease Name and Well No.

LPC 31 Federal #1 35070

9. API Well No.

30-025-37440

10. Field and Pool, or Exploratory

Lusk, Bone Spring, North 41450

11. Sec. T, R, M, or Blk. and Survey or Area

Sec. 31, T18S, R-32E

12. County or Parish

Lea County

13. State

NM

2. Name of Operator

Marbob Energy Corporation

3a. Address

PO Box 227, Artesia, NM 88211-0227

3b. Phone No. (include area code)

505-748-3303

4. Location of Well (Report location clearly and in accordance with any State requirements. \*)

At surface 1980 FNL 1980 FEL

At proposed prod. zone

"G"

14. Distance in miles and direction from nearest town or post office\*

15. Distance from proposed\*  
location to nearest  
property or lease line, ft.  
(Also to nearest drig. unit line, if any)

16. No. of Acres in lease

18. Distance from proposed location\*  
to nearest well, drilling, completed,  
applied for, on this lease, ft.

19. Proposed Depth

10000'

17. Spacing Unit dedicated to this well

20. BLM/BIA Bond No. on file

585716

21. Elevations (Show whether DF, KDB, RT, GL, etc.)

3686'

22. Approximate date work will start\*

June 31, 2005

23. Estimated duration

21 days

24. Attachments

Carbon Controlled Water Basin

The following, completed in accordance with the requirements of Onshore Oil and Gas Order No. 1, shall be attached to this form:

1. Well plat certified by a registered surveyor.
2. A Drilling Plan.
3. A Surface Use Plan (if the location is on National Forest System Lands, the SUPO shall be filed with the appropriate Forest Service Office).

4. Bond to cover the operations unless covered by an existing bond on file (see Item 20 above).
5. Operator certification.
6. Such other site specific information and/or plans as may be required by the authorized officer.

25. Signature

*[Signature]*

Name (Printed/Typed)

Amy Reid

Date

5/30/2005

Title

Land Department

Approved by (Signature)

/s/ Joe G. Lara

Name (Printed/Typed)

/s/ Joe G. Lara

Date

SEP 02 2005

Title

FIELD MANAGER

Office

CARLSBAD FIELD OFFICE

Application approval does not warrant or certify that the applicant holds legal or equitable title to those rights in the subject lease which would entitle the applicant to conduct operations thereon.

Conditions of approval, if any, are attached.

APPROVAL FOR 1 YEAR

Title 18 U.S.C. Section 1001 and Title 43 U.S.C. Section 1212, make it a crime for any person knowingly and willfully to make to any department or agency of the United States any false, fictitious or fraudulent statements or representations as to any matter within its jurisdiction.

\*(Instructions on reverse)

APPROVAL SUBJECT TO  
GENERAL REQUIREMENTS AND  
SPECIAL STIPULATIONS  
ATTACHED

UNITED STATES  
DEPARTMENT OF THE INTERIOR  
BUREAU OF LAND MANAGEMENT

OCD-HOBBS

FORM APPROVED  
OMB No. 1004-0135  
Expires: January 31, 2004

**SUNDRY NOTICES AND REPORTS ON WELLS**  
**Do not use this form for proposals to drill or to re-enter an abandoned well. Use Form 3160-3 (APD) for such proposals.**

1003

**SUBMIT IN TRIPLICATE - Other instructions on reverse side**

1. Type of Well  
☒ Oil Well ☐ Gas Well ☐ Other

2. Name of Operator  
Marbob Energy Corporation 14049

3a. Address  
PO Box 227, Artesia, NM 88211-0227

3b. Phone No. (include area code)  
505-748-3303

4. Location of Well (Footage, Sec., T. R., M., or Survey Description)  
1980 FNL & 2280 FEL  
Section 31, T18S-R32E  
'G'

5. Lease Serial No.  
NM-23006

6. If Indian, Allottee or Tribe Name

7. If Unit or CA/Agreement, Name and/or No.

8. Well Name and No.  
LPC Federal #1 35070

9. API Well No.  
30-025-37440

10. Field and Pool, or Exploratory Area  
Lusk; Bone Spring, North

11. County or Parish, State  
Lea County, New Mexico

**12. CHECK APPROPRIATE BOX(ES) TO INDICATE NATURE OF NOTICE, REPORT, OR OTHER DATA**

TYPE OF SUBMISSION	TYPE OF ACTION			
<input checked="" type="checkbox"/> Notice of Intent	<input type="checkbox"/> Acidize	<input type="checkbox"/> Deepen	<input type="checkbox"/> Production (Start/Resume)	<input type="checkbox"/> Water Shut-Off
<input type="checkbox"/> Subsequent Report	<input type="checkbox"/> Alter Casing	<input type="checkbox"/> Fracture Treat	<input type="checkbox"/> Reclamation	<input type="checkbox"/> Well Integrity
<input type="checkbox"/> Final Abandonment Notice	<input type="checkbox"/> Casing Repair	<input type="checkbox"/> New Construction	<input type="checkbox"/> Recomplete	<input type="checkbox"/> Other Change footages on this well.
	<input type="checkbox"/> Change Plans	<input type="checkbox"/> Plug and Abandon	<input type="checkbox"/> Temporarily Abandon	
	<input type="checkbox"/> Convert to Injection	<input type="checkbox"/> Plug Back	<input type="checkbox"/> Water Disposal	

3. Describe Proposed or Completed Operation (clearly state all pertinent details, including estimated starting date of any proposed work and approximate duration thereof. If the proposal is to deepen directionally or recompleat horizontally, give subsurface locations and measured and true vertical depths of all pertinent markers and zones. Attach the Bond under which the work will be performed or provide the Bond No. on file with BLM/BIA. Required subsequent reports shall be filed within 30 days following completion of the involved operations. If the operation results in a multiple completion or recompleat in a new interval, a Form 3160-4 shall be filed once testing has been completed. Final Abandonment Notices shall be filed only after all requirements, including reclamation, have been completed, and the operator has determined that the site is ready for final inspection.)

Marbob Energy Corporation proposes to change the footages on this well from 1980 FNL & 1980 FEL to 1980 FNL & 2280 FEL.

14. I hereby certify that the foregoing is true and correct  
Name (Printed/Typed)

Amy Reid

Title Land Department

Signature

Date July 18, 2005

THIS SPACE FOR FEDERAL OR STATE OFFICE USE

Approved by (Signature)

/s/ Joe G. Lara

Name

(Printed/Typed) Joe G. Lara

Title

FIELD MANAGER

Conditions of approval, if any, are attached. Approval of this notice does not warrant or certify that the applicant holds legal or equitable title to those rights in the subject lease which would entitle the applicant to conduct operations thereon.

Office

APD

Date

SEP 02 2005

Title 18 U.S.C. Section 1001 and Title 43 U.S.C. Section 1212, make it a crime for any person knowingly and willfully to make to any department or agency of the United States any false, fictitious or fraudulent statements or representations as to any matter within its jurisdiction.

(Continued on next page)

## DISTRICT I

1625 N. FRENCH DR., BOBBS, NM 86240

## DISTRICT II

1301 W. GRAND AVENUE, ARTESIA, NM 86210

## DISTRICT III

1000 Rio Brazos Rd., Aztec, NM 87410

## DISTRICT IV

1220 S. ST. FRANCIS DR., SANTA FE, NM 87505

## State of New Mexico

Energy, Minerals and Natural Resources Department

OIL CONSERVATION DIVISION  
1220 SOUTH ST. FRANCIS DR.  
Santa Fe, New Mexico 87505

Form C-102

Revised JUNE 10, 2003

Submit to Appropriate District Office

State Lease - 4 Copies

Fee Lease - 3 Copies

## WELL LOCATION AND ACREAGE DEDICATION PLAT

☐ AMENDED REPORT

API Number <b>30.025.37440</b>	Pool Code <b>41450</b>	Pool Name <b>LUSK; BONE SPRING, NORTH</b>
Property Code	Property Name <b>LPC FEDERAL</b>	Well Number <b>1</b>
OGRID No. <b>14049</b>	Operator Name <b>MARBOB ENERGY CORPORATION</b>	Elevation <b>3683'</b>

## Surface Location

UL or lot No.	Section	Township	Range	Lot Idn	Feet from the	North/South line	Feet from the	East/West line	County
G	31	18-S	32-E		1980	NORTH	2280	EAST	LEA

## Bottom Hole Location If Different From Surface

UL or lot No.	Section	Township	Range	Lot Idn	Feet from the	North/South line	Feet from the	East/West line	County
Dedicated Acres <b>40</b>	Joint or Infill	Consolidation Code	Order No.						

NO ALLOWABLE WILL BE ASSIGNED TO THIS COMPLETION UNTIL ALL INTERESTS HAVE BEEN CONSOLIDATED  
OR A NON-STANDARD UNIT HAS BEEN APPROVED BY THE DIVISION

LOT 1									
41.18 AC LOT 2									
41.27 AC LOT 3									
41.35 AC LOT 4									
41.44 AC									

GEODETIC COORDINATES  
 NAD 27 NME  
 Y=620869.2 N  
 X=662829.3 E  
 LAT.=32°42'20.70" N  
 LONG.=103°48'14.32" W

1980'  
 3684.0' 3681.9'  
 600' 600'  
 3678.8' 3688.8'  
 2280'

**OPERATOR CERTIFICATION**

I hereby certify the the information contained herein is true and complete to the best of my knowledge and belief.

*[Signature]*  
 Signature  
**AMY REID**  
 Printed Name  
**LAND DEPARTMENT**  
 Title  
**JULY 20, 2005**  
 Date

**SURVEYOR CERTIFICATION**

I hereby certify that the well location shown on this plat was plotted from field notes of actual surveys made by me or under my supervision and that the same is true and correct to the best of my belief.

**JULY 6, 2005**

Date Surveyed  
 Signature & Seal of Professional Surveyor  
*[Signature]*  
 GARY EIDSON  
 05.11.1053  
 Certified No. GARY EIDSON 12641

**MARBOB ENERGY CORPORATION**  
**DRILLING AND OPERATIONS PROGRAM**

**LPC 31 Federal #1**  
**1980' FNL & 1980' FEL, Unit G**  
**Section 31, T18S, R32E**  
**Lea County, New Mexico**

In conjunction with Form 3160-3, Application for Permit to Drill subject well, Marbob Energy Corporation submits the following ten items of pertinent information in accordance with BLM requirements.

1. The geological surface formation is Permian.
2. The estimated tops of geologic markers are as follows:

Yates	2830'	Delaware	4560'
Seven Rivers	3060'	Bone Springs	6900'
Queen	3660'		

3. The estimated depths at which anticipated water, oil or gas formations are expected to be encountered:

Yates	2830'	Oil
Bone Springs	6900'	Oil

No other formations are expected to give up oil, gas, or fresh water in measurable quantities. The surface fresh water sands will be protected by setting 13 3/8" casing at 600' and circulating cement back to surface. Any shallower zones above TD which contain commercial quantities of oil and/or gas will have cement circulated across them by inserting a float shoe joint into the 5 1/2" production casing which will be run at TD to sufficiently cover all known oil and gas horizons 200' above.

4. Proposed Casing Program:

Hole Size	Interval	OD Casing	Wt	Grade
17 1/2"	0-600'	13 3/8"	48#	H-40 STC
12 1/4"	600-3200'	8 5/8"	32#	J-55 STC
7 7/8"	3200-13000'	5 1/2"	17#	S-95 P-110

**Proposed Cement Program:**

13 3/8" Surface Casing: Cement w/ 600 sx Class C. Circulate to surface.

8 5/8" Intermediate Casing: Cement w/ 750 sx Class C. Attempt to tie in to 13 3/8" csg.

5 1/2" Production Casing: Cement w/ 900 sx Class C. Attempt to tie in to 8 5/8" csg.

5. Pressure Control Equipment:

See Exhibit #1. Marbob proposes to nipple up on the 13 3/8" casing with a 2M system, testing it to 1000# with rig pumps, then nipple up on the 8 5/8" casing with a 5M system, tested to 5000# before drilling out.

6. Mud Program: The applicable depths and properties of this system are as follows:

Depth	Type	Weight (ppg)	Viscosity (sec)	Waterloss (cc)
0 - 600'	Fresh Wtr (spud)	8.5	28	N.C.
600 - 3200'	Brine	9.8-10.2	40-45	N.C.
3200 - 10000'	Cut Brine	8.6-9.4	28-36	N.C.

7. Auxiliary Equipment: Kelly Cock; Sub with full opening valve on floor; and drill pipe connections.

8. Testing, Logging and Coring Program:

No drillstem tests are anticipated.

The electric logging program will consist of Dual Laterolog Micro SFL, Spectral Density Dual Spaced Neutron Csng Log, and Depth Control Log.

No conventional coring is anticipated.

9. No abnormal pressures or temperatures are anticipated.

10. Anticipated starting date: As soon as possible after approval.

## STATEMENT ACCEPTING RESPONSIBILITY FOR OPERATIONS

The undersigned accepts all applicable terms, conditions, stipulations, and restrictions concerning operations conducted on the leased land or portion thereof, as described below:

Date: May 30, 2005

Lease #: NM-23006  
LPC 31 Federal #1

Legal Description: SWNE Sec. 31-T18S-R32E  
Eddy County, New Mexico

Formation(s): Permian

Bond Coverage: Statewide

BLM Bond File #: 585716

  
\_\_\_\_\_  
Melanie Parker  
Land Department

# LOCATION VERIFICATION MAP

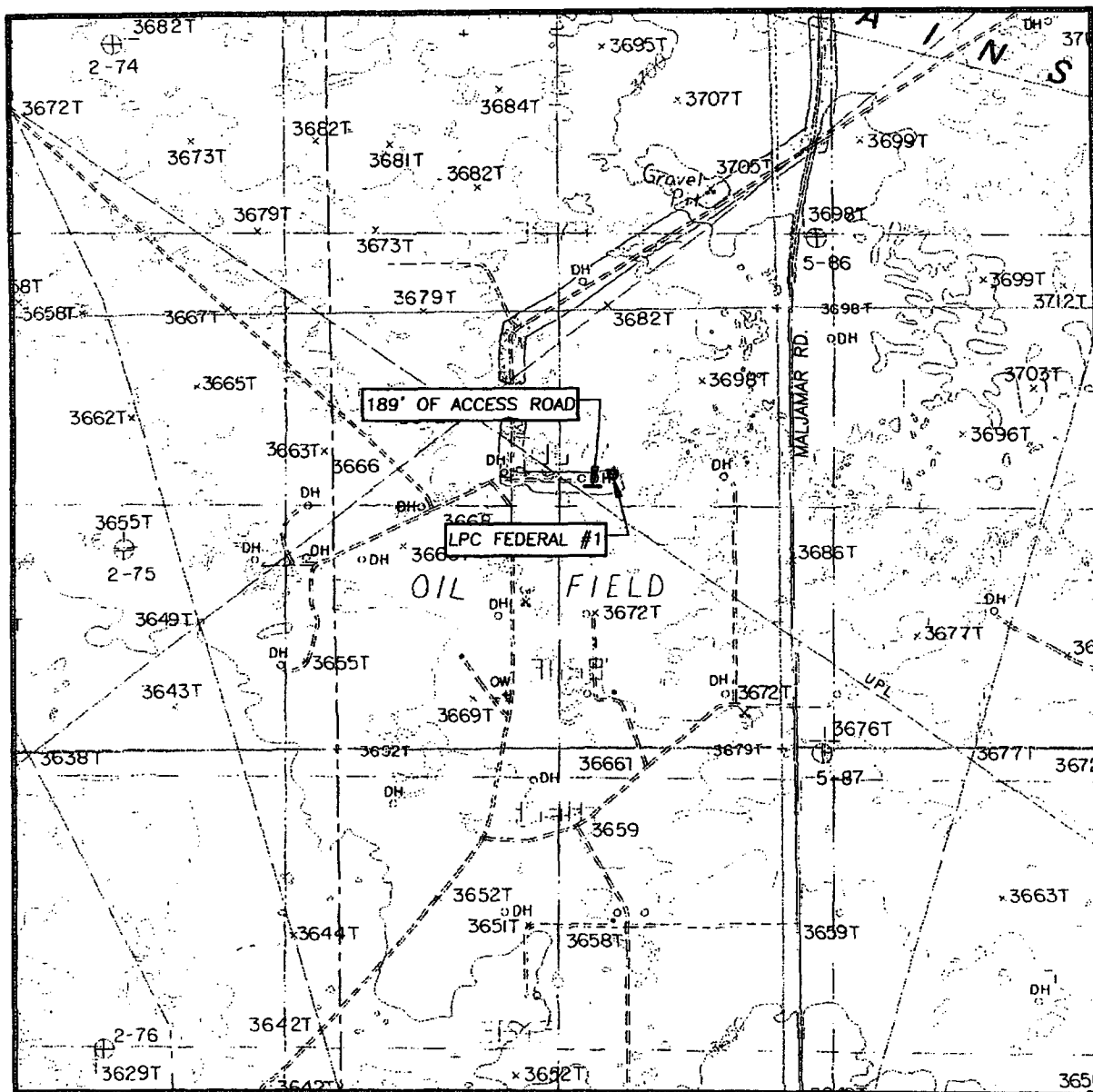

SCALE: 1" = 2000'

CONTOUR INTERVAL:  
GREENWOOD LAKE, N.M. - 10'

SEC. 31 TWP. 18-S RGE. 32-E

SURVEY N.M.P.M.

COUNTY LEA

DESCRIPTION 1980' FNL & 1980' FEL

ELEVATION 3686'

OPERATOR MARBOB ENERGY CORPORATION

LEASE LPC FEDERAL

U.S.G.S. TOPOGRAPHIC MAP  
GREENWOOD LAKE, N.M.

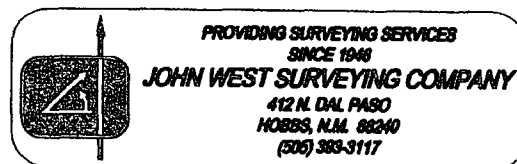

EXHIBIT TWO



UNITED STATES  
DEPARTMENT OF THE INTERIOR  
BUREAU OF LAND MANAGEMENTNew Mexico Oil Conservation Division, District I  
1625 N. French Drive  
Hobbs, NM 88240FORM APPROVED  
OMB No. 1004-0137  
Expires: March 31, 2007

## SUNDRY NOTICES AND REPORTS ON WELLS

Do not use this form for proposals to drill or to re-enter an abandoned well. Use Form 3160-3 (APD) for such proposals.

SUBMIT IN TRIPLICATE- Other instructions on reverse side.

1. Type of Well  
☒ Oil Well ☐ Gas Well ☐ Other

2. Name of Operator MARBOB ENERGY CORPORATION

3a. Address P O BOX 227  
ARTESIA NM 88211-02273b. Phone No. (include area code)  
505-748-33034. Location of Well (Footage, Sec., T., R., M., or Survey Description).  
SEC. 31-T18S-R32E, UNIT G  
1980 FNL 2280 FEL, SW/4NE/4

5. Lease Serial No.

NMNM23006

6. If Indian, Allottee or Tribe Name

7. If Unit or CA/Agreement, Name and/or No.

8. Well Name and No.

LPC 31 FEDERAL #1

9. API Well No.

30-025-37440

10. Field and Pool, or Exploratory Area

LUSK; BONE SPRING, NORTH

11. County or Parish, State

LEA COUNTY, NM

## 12. CHECK APPROPRIATE BOX(ES) TO INDICATE NATURE OF NOTICE, REPORT, OR OTHER DATA

TYPE OF SUBMISSION	TYPE OF ACTION			
<input checked="" type="checkbox"/> Notice of Intent	<input type="checkbox"/> Acidize	<input type="checkbox"/> Deepen	<input type="checkbox"/> Production (Start/Resume)	<input type="checkbox"/> Water Shut-Off
<input type="checkbox"/> Subsequent Report	<input type="checkbox"/> Alter Casing	<input type="checkbox"/> Fracture Treat	<input type="checkbox"/> Reclamation	<input type="checkbox"/> Well Integrity
<input type="checkbox"/> Final Abandonment Notice	<input type="checkbox"/> Casing Repair	<input type="checkbox"/> New Construction	<input type="checkbox"/> Recomplete	<input type="checkbox"/> Other
	<input checked="" type="checkbox"/> Change Plans	<input type="checkbox"/> Plug and Abandon	<input type="checkbox"/> Temporarily Abandon	
	<input type="checkbox"/> Convert to Injection	<input type="checkbox"/> Plug Back	<input type="checkbox"/> Water Disposal	

13. Describe Proposed or Completed Operation (clearly state all pertinent details, including estimated starting date of any proposed work and approximate duration thereof. If the proposal is to deepen directionally or recompleat horizontally, give subsurface locations and measured and true vertical depths of all pertinent markers and zones. Attach the Bond under which the work will be performed or provide the Bond No. on file with BLM/BIA. Required subsequent reports shall be filed within 30 days following completion of the involved operations. If the operation results in a multiple completion or recompleat in a new interval, a Form 3160-4 shall be filed once testing has been completed. Final Abandonment Notices shall be filed only after all requirements, including reclamation, have been completed, and the operator has determined that the site is ready for final inspection.)

MARBOB ENERGY CORPORATION REQUESTS APPROVAL TO CHANGE THE BOP EQUIPMENT

FROM: 5M SYSTEM ON 8 5/8"

TO: ~~3 1/2" M~~ SYSTEM ON 8 5/8" - To Drill To 10000'

THIS REQUEST IS MADE DUE TO THE FACT THAT WE WILL NOT BE PENETRATING THE WOLFCAMP.

14. I hereby certify that the foregoing is true and correct  
Name (Printed/Typed)

DEBORA L. WILBOURN

Title GEOTECH

Signature

*Deborah L. Wilbourn*

Date 09/09/05

## THIS SPACE FOR FEDERAL OR STATE OFFICE USE

Approved by **DAVID E. GLASS****PETROLEUM ENGINEER**

Date

SEP 14 2005

Conditions of approval, if any, are attached. Approval of this notice does not warrant or certify that the applicant holds legal or equitable title to those rights in the subject lease which would entitle the applicant to conduct operations thereon.

Office

*K*

Title 18 U.S.C. Section 1001 and Title 43 U.S.C. Section 1212, make it a crime for any person knowingly and willfully to make to any department or agency of the United States any false, fictitious or fraudulent statements or representations as to any matter within its jurisdiction.

(Instructions on page 2)

UNITED STATES  
DEPARTMENT OF THE INTERIOR  
BUREAU OF LAND MANAGEMENT

**SUNDRY NOTICES AND REPORTS ON WELLS**

*Do not use this form for proposals to drill or to re-enter an abandoned well. Use Form 3160-3 (APD) for such proposals.*

New Mexico Oil Conservation Division, District I  
1625 N. French Drive  
Bldg. 100, NM 88240

FORM APPROVED  
OM B No. 1004-0137  
Expires: March 31, 2007

**SUBMIT IN TRIPLICATE- Other instructions on reverse side.**

1. Type of Well ☐ Oil Well ☒ Gas Well ☐ Other

2. Name of Operator **MARBOB ENERGY CORPORATION**

3a. Address **P O BOX 227  
ARTESIA NM 88211-0227**

3b. Phone No. (include area code)  
**505-748-3303**

4. Location of Well (Footage, Sec., T., R., M., or Survey Description)

**SEC. 31-T18S-R32E, UNIT G  
1980 FNL 2280 FEL, SW/4NE/4**

5. Lease Serial No.

**NMNM23006**

6. If Indian, Allottee or Tribe Name

7. If Unit or CA/Agreement, Name and/or No.

8. Well Name and No.

**LPC 31 FEDERAL #1**

9. API Well No.

**30-025-37440**

10. Field and Pool, or Exploratory Area

**LUISK: BONE SPRING, NORTH**

11. County or Parish, State

**LEA COUNTY, NM**

**12. CHECK APPROPRIATE BOX(ES) TO INDICATE NATURE OF NOTICE, REPORT, OR OTHER DATA**

TYPE OF SUBMISSION	TYPE OF ACTION			
<input type="checkbox"/> Notice of Intent	<input type="checkbox"/> Acidize	<input type="checkbox"/> Deepen	<input type="checkbox"/> Production (Start/Resume)	<input type="checkbox"/> Water Shut-Off
<input checked="" type="checkbox"/> Subsequent Report	<input type="checkbox"/> Alter Casing	<input type="checkbox"/> Fracture Treat	<input type="checkbox"/> Reclamation	<input type="checkbox"/> Well Integrity
<input type="checkbox"/> Final Abandonment Notice	<input type="checkbox"/> Casing Repair	<input type="checkbox"/> New Construction	<input type="checkbox"/> Recomplete	<input checked="" type="checkbox"/> Other <b>SPUD CSG/CMT</b>
	<input type="checkbox"/> Change Plans	<input type="checkbox"/> Plug and Abandon	<input type="checkbox"/> Temporarily Abandon	
	<input type="checkbox"/> Convert to Injection	<input type="checkbox"/> Plug Back	<input type="checkbox"/> Water Disposal	

13. Describe Proposed or Completed Operation (clearly state all pertinent details, including estimated starting date of any proposed work and approximate duration thereof. If the proposal is to deepen directionally or recompleat horizontally, give subsurface locations and measured and true vertical depths of all pertinent markers and zones. Attach the Bond under which the work will be performed or provide the Bond No. on file with BLM/BIA. Required subsequent reports shall be filed within 30 days following completion of the involved operations. If the operation results in a multiple completion or recompleat in a new interval, a Form 3160-4 shall be filed once testing has been completed. Final Abandonment Notices shall be filed only after all requirements, including reclamation, have been completed, and the operator has determined that the site is ready for final inspection.)

**SPUD WELL @2:00 AM ON 10/11/05. DRLD 17 1/2" HOLE TO 614' @2:00 AM ON 10/12/05. RAN 14 JTS (614.92') 13 3/8" 48# H-50 CSG TO 606.95'. CMTD W/350 SX HLPP, TAILED IN W/200 SX P+, PD @10:52 AM ON 10/12/05, CIRC 116 SX TO PIT. WOC 18 HRS, TSTD CSG TO 600# F/30 MIN - HELD OK.**

ACCEPTED FOR RECORD

OCT 18 2005

GARY GOURLEY  
PETROLEUM ENGINEER

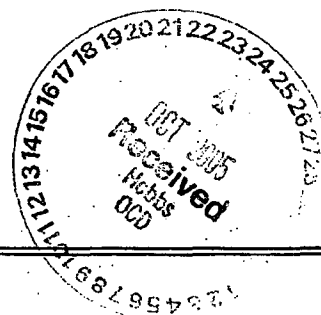

14. I hereby certify that the foregoing is true and correct

Name (Printed/Typed)

**DEBORA L. WILBOURN**

Title **GEOTECH**

Signature

*Debora L. Wilbourn*

Date **10/13/05**

**THIS SPACE FOR FEDERAL OR STATE OFFICE USE**

Approved by

Conditions of approval, if any, are attached. Approval of this notice does not warrant or certify that the applicant holds legal or equitable title to those rights in the subject lease which would entitle the applicant to conduct operations thereon.

Title

Date

Office

Title 18 U.S.C. Section 1001 and Title 43 U.S.C. Section 1212, make it a crime for any person knowingly and willfully to make to any department or agency of the United States any false, fictitious or fraudulent statements or representations as to any matter within its jurisdiction.

(Instructions on page 2)

*K*

UNITED STATES  
DEPARTMENT OF THE INTERIOR  
BUREAU OF LAND MANAGEMENT

1625 N. French Drive  
Hobbs, NM 88240

FORM APPROVED  
OM B No. 1004-0137  
Expires: March 31, 2007

**SUNDRY NOTICES AND REPORTS ON WELLS**

*Do not use this form for proposals to drill or to re-enter an abandoned well. Use Form 3160-3 (APD) for such proposals.*

**SUBMIT IN TRIPLICATE- Other instructions on reverse side.**

1. Type of Well  
☐ Oil Well ☒ Gas Well ☐ Other

2. Name of Operator **MARBOB ENERGY CORPORATION**

3a. Address **P O BOX 227  
ARTESIA NM 88211-0227**

3b. Phone No. (include area code)  
**505-748-3303**

4. Location of Well (Footage, Sec., T., R., M., or Survey Description)

**SEC. 31-T18S-R32E, UNIT G  
1980 FNL 2280 FEL, SW/4NE/4**

5. Lease Serial No.

**NMNM23006**

6. If Indian, Allottee or Tribe Name

7. If Unit or CA/Agreement, Name and/or No.

8. Well Name and No

**LPC 31 FEDERAL #1**

9. API Well No.  
**30-025-37440**

10. Field and Pool, or Exploratory Area  
**LUSH; BONE SPRING, NORTH**

11. County or Parish, State

**LEA COUNTY, NM**

**12. CHECK APPROPRIATE BOX(ES) TO INDICATE NATURE OF NOTICE, REPORT, OR OTHER DATA**

TYPE OF SUBMISSION	TYPE OF ACTION			
<input type="checkbox"/> Notice of Intent	<input type="checkbox"/> Acidize	<input type="checkbox"/> Deepen	<input type="checkbox"/> Production (Start/Resume)	<input type="checkbox"/> Water Shut-Off
<input checked="" type="checkbox"/> Subsequent Report	<input type="checkbox"/> Alter Casing	<input type="checkbox"/> Fracture Treat	<input type="checkbox"/> Reclamation	<input type="checkbox"/> Well Integrity
<input type="checkbox"/> Final Abandonment Notice	<input type="checkbox"/> Casing Repair	<input type="checkbox"/> New Construction	<input type="checkbox"/> Recomplete	<input checked="" type="checkbox"/> Other <b>INTMD CSG/CMT</b>
	<input type="checkbox"/> Change Plans	<input type="checkbox"/> Plug and Abandon	<input type="checkbox"/> Temporarily Abandon	
	<input type="checkbox"/> Convert to Injection	<input type="checkbox"/> Plug Back	<input type="checkbox"/> Water Disposal	

13. Describe Proposed or Completed Operation (clearly state all pertinent details, including estimated starting date of any proposed work and approximate duration thereof. If the proposal is to deepen directionally or recompleat horizontally, give subsurface locations and measured and true vertical depths of all pertinent markers and zones. Attach the Bond under which the work will be performed or provide the Bond No. on file with BLM/BIA. Required subsequent reports shall be filed within 30 days following completion of the involved operations. If the operation results in a multiple completion or recompleat in a new interval, a Form 3160-4 shall be filed once testing has been completed. Final Abandonment Notices shall be filed only after all requirements, including reclamation, have been completed, and the operator has determined that the site is ready for final inspection.)

**10/16/05 @9:15 AM, DRLD 12 1/4" HOLE TO 2729'. RAN 61 JTS (2730.92') 8 5/8" 32# J-55  
CSG TO 2727.35'. CMTD W/950 SX HLPP, TAILED IN W/200 SX P+, PD 06:00 PM 10/16/05.  
CIRC 150 SX TO PIT. WOC 18 HRS. TSTD CSG TO 1500# F/30 MIN - HELD ON**

OCT 19 2005

GARY GOURLEY  
PETROLEUM ENGINEER

14. I hereby certify that the foregoing is true and correct  
Name (Printed/Typed)

**DEBORA L. WILBOURN**

Title **GEOTECH**

Signature

*Debora L. Wilbourn*

Date **10/18/05**

**THIS SPACE FOR FEDERAL OR STATE OFFICE USE**

Approved by

Conditions of approval, if any, are attached. Approval of this notice does not warrant or certify that the applicant holds legal or equitable title to those rights in the subject lease which would entitle the applicant to conduct operations thereon.

Title

Date

Office

Title 18 U.S.C. Section 1001 and Title 43 U.S.C. Section 1212, make it a crime for any person knowingly and willfully to make to any department or agency of the United States any false, fictitious or fraudulent statements or representations as to any matter within its jurisdiction.

(Instructions on page 2)

**New Mexico Oil Conservation Division, District I**  
**1625 N. French Drive**  
**Albuquerque, NM 88240**  
 UNITED STATES  
 DEPARTMENT OF THE INTERIOR  
 BUREAU OF LAND MANAGEMENT

FORM APPROVED  
OM B No. 1004-0137  
Expires: March 31, 2007

**SUNDRY NOTICES AND REPORTS ON WELLS**

*Do not use this form for proposals to drill or to re-enter an abandoned well. Use Form 3160-3 (APD) for such proposals.*

**SUBMIT IN TRIPLICATE- Other instructions on reverse side.**

1. Type of Well ☐ Oil Well ☒ Gas Well ☐ Other

2. Name of Operator **MARBOB ENERGY CORPORATION**

3a. Address **P O BOX 227**  
**ARTESIA NM 88211-0227**

3b. Phone No. (include area code)  
**505-748-3303**

4. Location of Well (Footage, Sec., T., R., M., or Survey Description)

**SEC. 31-T18S-R32E, UNIT G**  
**1980 FNL 2280 FEL, SW/4NE/4**

**RECEIVED**

**NOV 16 2005**

**ODD-ARTESIA**

5. Lease Serial No.

**NMNM23006**

6. If Indian, Allottee or Tribe Name

7. If Unit or CA/Agreement, Name and/or No.

8. Well Name and No.

**LPC 31 FEDERAL #1**

9. API Well No.

**30-025-37440**

10. Field and Pool, or Exploratory Area

**LUSK; BONE SPRING, NORTH**

11. County or Parish, State

**LEA COUNTY, NM**

**12. CHECK APPROPRIATE BOX(ES) TO INDICATE NATURE OF NOTICE, REPORT, OR OTHER DATA**

TYPE OF SUBMISSION	TYPE OF ACTION			
<input type="checkbox"/> Notice of Intent	<input type="checkbox"/> Acidize	<input type="checkbox"/> Deepen	<input type="checkbox"/> Production (Start/Resume)	<input type="checkbox"/> Water Shut-Off
<input checked="" type="checkbox"/> Subsequent Report	<input type="checkbox"/> Alter Casing	<input type="checkbox"/> Fracture Treat	<input type="checkbox"/> Reclamation	<input type="checkbox"/> Well Integrity
<input type="checkbox"/> Final Abandonment Notice	<input type="checkbox"/> Casing Repair	<input type="checkbox"/> New Construction	<input type="checkbox"/> Recomplete	<input checked="" type="checkbox"/> Other <b>TD CSG/CMT</b>
	<input type="checkbox"/> Change Plans	<input type="checkbox"/> Plug and Abandon	<input type="checkbox"/> Temporarily Abandon	
	<input type="checkbox"/> Convert to Injection	<input type="checkbox"/> Plug Back	<input type="checkbox"/> Water Disposal	

13. Describe Proposed or Completed Operation (clearly state all pertinent details, including estimated starting date of any proposed work and approximate duration thereof. If the proposal is to deepen directionally or recompleat horizontally, give subsurface locations and measured and true vertical depths of all pertinent markers and zones. Attach the Bond under which the work will be performed or provide the Bond No. on file with BLM/BIA. Required subsequent reports shall be filed within 30 days following completion of the involved operations. If the operation results in a multiple completion or recompleat in a new interval, a Form 3160-4 shall be filed once testing has been completed. Final Abandonment Notices shall be filed only after all requirements, including reclamation, have been completed, and the operator has determined that the site is ready for final inspection.)

**TD WELL @10:00 PM ON 11/02/05. RUN 239 JTS (9980.25') 5 1/2" CSG (30 JTS N-80 17#, 207 JTS JE 17#, 2 JTS P-110 MRKRS), CMTD 1ST SG W/525 SX SUPER H, PD @1:10 AM ON 11/05/05, CIRC 110 SX TO PIT. CMTD 2ND STG W/500 SX INTERFIL C, TAILED IN W/350 SX PB SUPER H, PD @9:15 AM ON 11/05/05, DID NOT CIRC, RAN TEMP SURVEY - TOC @1410'. WOC 18 HRS, TSTD CSG TO 1500# F/30 MIN - HELD OK.**

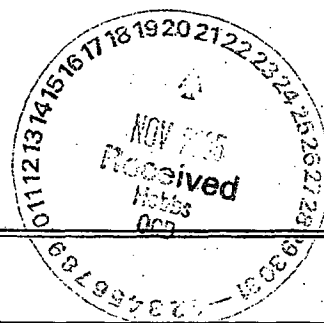

14. I hereby certify that the foregoing is true and correct

Name (Printed/Typed)

**DEBORA L. WILBOURN**

Title **GEOTECH**

Signature

*Deborah L. Wilbourn*

Date

**11/07/05**

**ACCEPTED FOR THIS SPACE FOR FEDERAL OR STATE OFFICE USE**

Approved by

**DAVID R. GLASS**

Title

Date

Conditions of approval, if any, are attached. Approval of this notice does not warrant or certify that the applicant holds legal or equitable title to those rights in the subject lease which would entitle the applicant to conduct operations thereon.

Office

Title 18 U.S.C. Section 1001 and Title 43 U.S.C. Section 1212, make it a crime for any person knowingly and willfully to make to any department or agency of the United States any false, fictitious or fraudulent statements or representations as to any matter within its jurisdiction.

(Instructions on page 2)