

ENERGY, MINERALS AND NATURAL RESOURCES DEPARTMENT

OIL CONSERVATION DIVISION

BRUCE KING
GOVERNORANITA LOCKWOOD
CABINET SECRETARY

January 31, 1994

POST OFFICE BOX 2088
STATE LAND OFFICE BUILDING
SANTA FE, NEW MEXICO 87504
(505) 827-5800

Santa Fe Energy Operating Partners, L.P.
c/o Hinkle, Cox, Eaton, Coffield & Hensley
Attention: James Bruce
P.O. Box 2068
Santa Fe, NM 87504-2068

Administrative Order NSL-3348

Dear Mr. Bruce:

Reference is made to your application dated January 26, 1994 on behalf of the operator, Santa Fe Energy Operating Partners, L.P., for a non-standard oil well location for the North Pure Gold "9" Federal Well No. 5 to be drilled 1140 feet from the North line and 990 feet from the West line (Unit ~~P~~) of Section 9, Township 23 South, Range 31 East, NMPM, to test the Los Medanos Pool, Eddy County, New Mexico. It is our understanding the proposed North Pure Gold "9" Federal Well No. 5 is within the Oil/Potash "R-111-P" area, and is therefore subject to all applicable restrictions and rules therein. Further, it is our understanding the original location proposed by Santa Fe Energy Operating Partners, L.P. for this well, which was to be at a standard oil well location 990 feet from the North and West lines of said Section 9, was unacceptable to the U.S. Bureau of Land Management since it:

"...would likely interfere with potash mining and result in undue waste of known enclave reserves. It could also prove hazardous to the health and safety of potash miners."

However, a move of merely 150 feet south would be acceptable, which presumably would not interfere with potash mining, would not result in undue waste of known enclave reserves and would not be a hazard to the health and safety of potash miners.

By the authority granted me under the provisions of General Rule 104.F.(1), the above-described unorthodox oil well location is hereby approved. The NW/4 NW/4 of said Section 9 shall be dedicated to said well forming a standard 40-acre oil spacing and proration unit for said pool.

Sincerely,

William J. LeMay
Director

WJL/MES/amg

cc: Oil Conservation Division - Artesia
US Bureau of Land Management - Carlsbad
US Bureau of Land Management - Santa Fe (William C. Caulkins)

District I
1625 N. French Dr., Hobbs, NM 88240
District II
1301 W. Grand Avenue, Artesia, NM 88210
District III
1000 Rio Brazos Road, Aztec, NM 87410
District IV
1220 S. St. Francis Dr., Santa Fe, NM 87505

State of New Mexico
Energy Minerals and Natural Resources

Form C-104A
March 1st, 2001

Oil Conservation Division
1220 South St. Francis Dr.
Santa Fe, NM 87505

Submit 1 copy of the final affected wells
list along with 1 copy of this form per
number of wells on that list to appropriate
District Office

Change of Operator

Previous Operator Information:

OGRID: 20305
Name: Devon SFS Operating, Inc.
Address: 20 North Broadway
Address: Ste 1500
City, State, Zip: Oklahoma City, OK 73102

New Operator Information:

Effective Date: November 1, 2002
New Ogrid: 6137
New Name: Devon Energy Production Company LP
Address: 20 North Broadway
Address: Ste 1500
City, State, Zip: Oklahoma City, OK 73102

I hereby certify that the rules of the Oil Conservation Division have been complied with and that the information on this form and the attached list of wells is true and complete to the best of my knowledge and belief.

New Operator

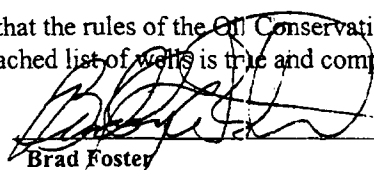
Signature: 

Brad Foster

Printed name: _____

Operations Manager

Title: _____

October 1, 2002

(405)552-7837

Date: _____

Phone: _____

RECEIVED
OCD - ARTESIA

Previous operator complete below:

Previous Operator: Devon SFS Operating, Inc.

Previous OGRID: 20305

Signature: 

Printed: Brad Foster

Name: Operations Manager

NMOCD Approval

Signature: 

Printed: _____

Name: District Supervisor

District: _____

Date: NOV 01 2002

District I
1625 N. French Dr., Hobbs, NM 88240
District II
811 South First, Artesia, NM 88210
District III
1000 Rio Brazos Rd., Aztec, NM 87410
District IV
2040 South Pacheco, Santa Fe, NM 87505

State of New Mexico
rgy, Minerals & Natural Resources

Form C-104
Revised March 25, 1999

OIL CONSERVATION DIVISION
2040 South Pacheco
Santa Fe, NM 87505

Submit to Appropriate District Office
5 Copies

☐ AMENDED REPORT

I. REQUEST FOR ALLOWABLE AND AUTHORIZATION TO TRANSPORT

¹ Operator name and Address Devon SFS Operating Inc 20 North Broadway, Suite 1500 Oklahoma City, OK 73102-8260		² OGRID Number 020305
		³ Reason for Filing Code CH (Effective 10/1/00)
⁴ API Number 30-0 15-27914	⁵ Pool Name Los Medanos (Delaware)	⁶ Pool Code 40297
⁷ Property Code 116658	⁸ Property Name North Pure Gold 9 Federal	⁹ Well Number 5

II. Surface Location

UL or lot no.	Section	Township	Range	Lot. Idn	Feet from the	North/South Line	Feet from the	East/West line	County
D	9	23S	31E		1140	North	990	West	Bddy

¹¹ Bottom Hole Location

UL or lot no.	Section	Township	Range	Lot. Idn	Feet from the	North/South Line	Feet from the	East/West line	County
¹² Lse Code F	¹³ Producing Method Code P	¹⁴ Gas Connection Date	¹⁵ C-129 Permit Number	¹⁶ C-129 Effective Date	¹⁷ C-129 Expiration Date				

III. Oil and Gas Transporters

¹⁸ Transporter OGRID	¹⁹ Transporter Name and Address	²⁰ POD	²¹ O/G	²² POD ULSTR Location and Description
13382	Llano Inc 921 W. Sanger Hobbs, NM 88240	2807532	G	(F) Sec 9, T 23S, R 31E
007440	BOIT Energy Corp P.O. Box 4666 Houston, TX 77210-4666	2807531	(F) Se	c. 9, T 23S, R 31E

IV. Produced Water

²³ POD 2807533	²⁴ POD ULSTR Location and Description (F) Sec. 9, T 23S, R 31E
-------------------------------------	---

V. Well Completion Data

²⁵ Spud Date	²⁶ Ready Date	²⁷ TD	²⁸ PBTD	²⁹ Perforations	³⁰ DHC, MC
³¹ Hole Size		³² Casing & Tubing Size	³³ Depth Set	³⁴ Sacks Cement	

VI. Well Test Data

³⁵ Date New Oil	³⁶ Gas Delivery Date	³⁷ Test Date	³⁸ Test Length	³⁹ Tbg. Pressure	⁴⁰ Csg. Pressure
⁴¹ Choke Size	⁴² Oil	⁴³ Water	⁴⁴ Gas	⁴⁵ AOF	⁴⁶ Test Method

⁴⁷ I hereby certify that the rules of the Oil Conservation Division have been complied with and that the information given above is true and complete to the best of my knowledge and belief.

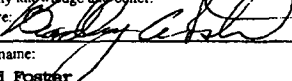
Signature: 
Printed name: **Brad Foster**
Title: **Div. Operations & Production Manager**
Date: _____

OIL CONSERVATION DIVISION
Approved by: **ORIGINAL SIGNED BY TIM W. GUM**
Title: **DISTRICT II SUPERVISOR**
Approval Date: **FEB 19 2001**
Phone: **405-552-7837**

⁴⁸ If this is a change of operator fill in the OGRID number and name of the previous operator

 **Bill Keathly** **Regulatory Specialist** **10/20/00**
Previous Operator Signature Printed Name Title Date

District I
PO Box 1980, Hobbs, NM 88241-1980
District II
PO Drawer DD, Artesia, NM 88211-0719
District III
1000 Rio Brazos Rd., Aztec, NM 87410
District IV
PO Box 2088, Santa Fe, NM 87504-2088

State of New Mexico
Geology, Minerals & Natural Resources Department

Form C-104
Revised February 10, 1994
Instructions on back
Submit to Appropriate District Office
5 Copies

OIL CONSERVATION DIVISION
P.O. Box 2088
Santa Fe, NM 87504-2088

☐ AMENDED REPORT

I. REQUEST FOR ALLOWABLE AND AUTHORIZATION TO TRANSPORT

1 Operator name and Address Santa Fe Energy Resources, Inc. 550 W. Texas, Suite 1330 Midland, TX 79701		2 OGRID Number 020305	
3 Reason for Filing Code CH		Effective 1-1-95	
4 API Number 30-015-27914	5 Pool Name Los Medanos (Delaware)	6 Pool Code 40297	
7 Property Code 16658	8 Property Name North Pure Gold 9 Federal	9 Well Number 5	

II. Surface Location

UL or lot no.	Section	Township	Range	Lot. Idn	Feet from the	North/South Line	Feet from the	East/West line	County
D	9	23S	31E		1140	North	990	West	Eddy

Bottom Hole Location

UL or lot no.	Section	Township	Range	Lot. Idn	Feet from the	North/South Line	Feet from the	East/West line	County
12 Lse Code F	13 Producing Method Code P	14 Gas Connection Date 1-1-91	15 C-129 Permit Number	16 C-129 Effective Date	17 C-129 Expiration Date				

III. Oil and Gas Transporters

18 Transporter OGRID 32109	19 Transporter Name and Address Llano, Inc. 921 W. Sanger Hobbs, NM 88240	20 POD 2807532	21 O/G G	22 POD ULSTR Location and Description (F), Sec. 9, T-23S, R-31E North Pure Gold 9 Fed #7 Btry
007440	EOTT Energy Corp. P. O. Box 4666 Houston, TX 77210-4666	2807531	0	(F), Sec. 9, T-23S, R-31E North Pure Gold 9 Fed #7 Btry
				RECEIVED FEB 22 1995

IV. Produced Water

23 POD 2807533	24 POD ULSTR Location and Description (F), Sec. 9, T-23S, R-31E
-------------------	--

OIL CON. DIV.
DIST. 2

V. Well Completion Data

25 Spud Date	26 Ready Date	27 TD	28 PSTD	29 Perforations
30 Hole Size		31 Casing & Tubing Size	32 Depth Set	33 Sacks Cement Post 10.3 3-3-95 CH OP

VI. Well Test Data

34 Date New Oil	35 Gas Delivery Date	36 Test Date	37 Test Length	38 Tbg. Pressure	39 Csg. Pressure
40 Choke Size	41 Oil	42 Water	43 Gas	44 AOF	45 Test Method

46 I hereby certify that the rules of the Oil Conservation Division have been complied with and that the information given above is true and complete to the best of my knowledge and belief.

Signature:

Printed name:

Terry McCullough

Title:

Sr. Production Clerk

Date:

2-14-95

Phone: 915/687-3551

OIL CONSERVATION DIVISION

Approved by:

SUPERVISOR, DIST. 2

Title:

Approval Date:

FEB 27 1995

47 If this is a change of operator fill in the OGRID number and name of the previous operator

Previous Operator Signature

Paul R. Baker

Printed Name

Atty-In-Fact

Title

Date

2/9/95

Santa Fe Energy Operating Partners, L.P. #020290

District I
PO Box 1988, Hobbs, NM 88241-1988
District II
PO Drawer DD, Artesia, NM 88211-0719
District III
1000 Rio Bravo Rd., Aztec, NM 87410
District IV
PO Box 2088, Santa Fe, NM 87504-2088

State of New Mexico
Energy, Minerals & Natural Resources Department

OIL CONSERVATION DIVISION
PO Box 2088
Santa Fe, NM 87504-2088

RECEIVED

JUL 19 '94

O. C. D.
ARTESIA, OFFICE

Form C-104
Revised February 10, 1994
Instructions on back
Submit to Appropriate District Office
5 Copies

☐ AMENDED REPORT

I. REQUEST FOR ALLOWABLE AND AUTHORIZATION TO TRANSPORT

Operator Name and Address Santa Fe Energy Operating Partners, L.P. 550 W. Texas, Suite 1330 Midland, Texas 79701		OGRID Number 020290
Reason for Filing Code NW		
API Number 30-015-27914	Pool Name Los Medanos (Delaware)	Pool Code 40297
Property Code 009984	Property Name North Pure Gold 9 Federal	Well Number 5

II. Surface Location

UL or lot no.	Section	Township	Range	Lot Idn	Feet from the	North/South Line	Feet from the	East/West Line	County
D	9	23S	31E		1140	North	990	West	Eddy

Bottom Hole Location

UL or lot no.	Section	Township	Range	Lot Idn	Feet from the	North/South Line	Feet from the	East/West Line	County
Law Code F	Producing Method Code F	Gas Connection Date 7-12-94	C-129 Permit Number	C-129 Effective Date	C-129 Expiration Date				

III. Oil and Gas Transporters

Transporter OGRID	Transporter Name and Address	POD	O/G	POD ULSTR Location and Description
007440	EOTT Energy Corp. P. O. Box 4666 Houston, Texas 77210-4666	2807531	O	(F), Sec 9, T-23S, R-31E North Pure Gold 9 Fed #7 Battery
003414	Llano, Inc. P. O. Box 1320 Hobbs, New Mexico 88240	2807532	G	(F), Sec. 9, T-23S, R-31E N. Pure Gold 9 Fed #7 Battery

Post ID: 2
8-19-94
L. J. M. & B. K.

IV. Produced Water

POD	POD ULSTR Location and Description
2807533	(F), Sec. 9, T-23S, R-31E (North Pure Gold 9 Fed #7 Battery)

V. Well Completion Data

Spud Date	Ready Date	TD	PBTD	Perforations
6-12-94	7-8-94	8150'	8080'	7918'-7958'
Hole Size	Casing & Tubing Size	Depth Set	Sacks Cement	
17-1/2"	13-3/8" 48#	429'	325 sx Lite & "C"	
11"	8-5/8" 32#	3983'	1150 sx Lite + C	
7-7/8"	5-1/2" 15.5 & 17	8150'	675 sx Lite + H	
	2-7/8"	8002'		

VI. Well Test Data

Date New Oil	Gas Delivery Date	Test Date	Test Length	Tbg. Pressure	Cog. Pressure
7-7-94	7-12-94	7-10-94	24	500	920
Choke Size	Oil	Water	Gas	AOF	Test Method
20/64"	406	183	408	N/A	F

"I hereby certify that the rules of the Oil Conservation Division have been compared with and that the information given above is true and complete to the best of my knowledge and belief.

Signature: *Terry McCullough*
Printed name: Terry McCullough

Title: Sr. Production Clerk

Date: 7-18-94 Phone: 915/687-3551

Approved by: SUPERVISOR, DISTRICT II

Title:

Approval Date: JUL 29 1994

"If this is a change of operator fill in the OGRID number and name of the previous operator

Previous Operator Signature

Printed Name

Title

Date

District I
PO Box 1986, Hobbs, NM 88241-1986
District II
PO Drawer OD, Artesia, NM 88211-8719
District III
1000 Rio Brava Rd., Artesia, NM 87410
District IV
PO Box 2088, Santa Fe, NM 87504-2088

State of New Mexico
Energy, Minerals & Natural Resources Department

Form C-104

Revised February 10, 1994

OIL CONSERVATION DIVISION

PO Box 2088
Santa Fe, NM 87504-2088

RECEIVED
Instructions on back
Submit to Appropriate District Office
5 Copies

JUL 20 10 55 AM '94 ☐ AMENDED REPORT

REQUEST FOR ALLOWABLE AND AUTHORIZATION TO TRANSPORT

Operator Name and Address Santa Fe Energy Operating Partners, L.P. 350 W. Texas, Suite 1330 Midland, Texas 79701		AREA AUG 16 1994 O. C. D.	LOGRID Number 020290 Reason for Filing Code NW
API Number 30-015-27914	Pool Name Los Medanos (Delaware)	ARTESIA, OFFICE	Pool Code 40297
Property Code 009984	Property Name North Pure Gold 9 Federal		Well Number 5

II. Surface Location

UL or lot no.	Section	Township	Range	Lot Idn	Feet from the	North/South Line	Feet from the	East/West Line	County
D	9	23S	31E		1140	North	990	West	Eddy

Bottom Hole Location

UL or lot no.	Section	Township	Range	Lot Idn	Feet from the	North/South Line	Feet from the	East/West Line	County
F	F		7-12-94						

" Loc Code	" Producing Method Code	" Gas Completion Date	" C-129 Permit Number	" C-129 Effective Date	" C-129 Expiration Date
F	F	7-12-94			

III. Oil and Gas Transporters

" Transporter OGRID	" Transporter Name and Address	" FOB	" O/G	" FOB ULSTR Location and Description
007440	EOTT Energy Corp. P. O. Box 4666 Houston, Texas 77210-4666	2807531	O	(F), Sec 9, T-23S, R-31E North Pure Gold 9 Fed #7 Battery
013414	Llano, Inc. P. O. Box 1320 Hobbs, New Mexico 88240	2807532	G	(F), Sec. 9, T-23S, R-31E N. Pure Gold 9 Fed #7 Battery

IV. Produced Water

" FOB	" FOB ULSTR Location and Description
2807533	(F), Sec. 9, T-23S, R-31E (North Pure Gold 9 Fed #7 Battery)

V. Well Completion Data

" Spud Date	" Ready Date	" TD	" FBTD	" Perforations
6-12-94	7-8-94	8150'	8080'	7918'-7958'
" Hole Size	" Casing & Tubing Size	" Depth Set	" Seals Cement	
17-1/2"	13-3/8" 48#	429'	325 sx Lite & "C"	
11"	8-5/8" 32#	3983'	1150 sx Lite + C	
7-7/8"	5-1/2" 15.5 & 17	8150'	675 sx Lite + H	
	2-7/8"	8002'		

VI. Well Test Data

" Date New Oil	" Gas Delivery Date	" Test Date	" Test Length	" Tbg. Pressure	" Csg. Pressure
7-7-94	7-12-94	7-10-94	24	500	920
" Choke Size	" Oil	" Water	" Gas	" AOF	" Test Method
20/64"	406	183	408	N/A	F

" I hereby certify that the rules of the Oil Conservation Division have been complied with and that the information given above is true and complete to the best of my knowledge and belief.

Signature: *Terry McCullough*

Printed name: Terry McCullough

Title: Sr. Production Clerk

Date: 7-18-94

Phone: 915/687-3551

OIL CONSERVATION DIVISION

Approved by:

Title:

Approval Date:

" If this is a change of operator fill in the OGRID number and name of the previous operator

Previous Operator Signature

Printed Name

Title

Date

OIL CONSERVATION DIVISION

DRAWER DD

ARTESIA NM

DISTRICT OFFICE II

July thru December 1994

NO. 2016 N

SUPPLEMENT TO THE OIL PRORATION SCHEDULE

DATE July 29, 1994

PURPOSE ALLOWABLE ASSIGNMENT - NEW OIL

Effective July 1, 1994 an allowable for a non-marginal (N187) well is hereby assigned to Santa Fe Energy Op. Partners lp, North Pure Gold 9 Federal #5-D-9-23-31 in the Los Medanos Delaware Pool.

L - F

MP - F

■

Santa Fe Energy

EOT

LI

OIL CONSERVATION DIVISION

DISTRICT SUPERVISOR

UNITED STATES
DEPARTMENT OF THE INTERIOR
BUREAU OF LAND MANAGEMENT

SUBMIT IN DUPLICATE

Form approved.
Budget Bureau No. 0137
BGNs August 31, 1985

NM OIL & GAS COMMISSION
Prater, DP
Artesia, NM 88210
NM-77046

WELL COMPLETION OR RECOMPLETION REPORT AND LOG *

1a. TYPE OF WELL: OIL WELL <input checked="" type="checkbox"/> GAS WELL <input type="checkbox"/> DRY <input type="checkbox"/> Other <input type="checkbox"/>		6. IF INDIAN, ALLOTTEE OR TRIBE NAME	
b. TYPE OF COMPLETION: NEW WELL <input checked="" type="checkbox"/> WORK OVER <input type="checkbox"/> DEEP EN <input type="checkbox"/> PLUG BACK <input type="checkbox"/> DIFF. REVER <input type="checkbox"/> Other <input type="checkbox"/>		7. UNIT AGREEMENT NAME	
2. NAME OF OPERATOR Santa Fe Energy Operating Partners, L.P.		8. FARM OR LEASE NAME North Pure Gold 9 Fed	
3. ADDRESS OF OPERATOR 350 W. Texas, Suite 1330, Midland, Texas 79701		9. WELL NO. 5	
4. LOCATION OF WELL (Report location clearly and in accordance with any State requirements) At surface (D), 1140' FNL and 990' FWL, Sec. 9, T-23S, R-31E At top prod. interval reported below At total depth		10. FIELD AND POOL, OR WILDCAT Los Medanos (Delaware)	
11. SEC. T. R. M. OR BLOCK AND SURVEY OR AREA Sec. 9, T-23S, R-31E		12. COUNTY OR PARISH Eddy	
13. STATE NM		14. PERMIT NO. 30-015-27914	
15. DATE SPUNDED 6-12-94		16. DATE T.D. REACHED 6-27-94	
17. DATE COMPL. (Ready to prod.) 7-8-94		18. ELEVATIONS (OF. RKB, RT. GR, ETC.) 3345' GR	
19. TOTAL DEPTH, MD & TVD 8150'		20. PLUG, BACK T.D., MD & TVD 8080'	
21. IF MULTIPLE COMPL. HOW MANY? N/A		22. INTERVALS DRILLED BY All	
23. ROTARY TOOLS N/A		24. CABLE TOOLS N/A	
25. PRODUCING INTERVAL(S) OF THIS COMPLETION—TOP, BOTTOM, NAME (MD AND TVD) 7918' - 7958' (Delaware)		26. WAS DIRECTIONAL SURVEY MADE NO	
27. TYPE ELECTRIC AND OTHER LOGS RUN DIT/LDT/CNL/GR		28. WAS WELL CORED Yes	
29. CASING RECORD (Report all strings set in well)			
CASING SIZE	WEIGHT, LB./FT.	DEPTH SET (MD)	HOLE SIZE
13-3/8"	48#	429'	17 1/2"
8-5/8"	32#	3983'	11"
5-1/2"	15.5 & 17.0	8150'	7-7/8"
CEMENTING RECORD		AMOUNT PULLED	
100 sx C Lite + 225 sx "C"		None	
950 sx Lite + 200 sx "C"		None	
125 bbls Nitrified Mud,		None	
500 gal Superflush, 375 sx "C" + 300 sx H			
30. LINER RECORD			
SIZE	TOP (MD)	BOTTOM (MD)	SACKS CEMENT*
N/A			
31. TUBING RECORD			
SIZE	DEPTH SET (MD)	PACKER SET (MD)	
2-7/8"	8002'	N/A	
32. PERFORATION RECORD (Interval, size and number)			
7918'-7958' (1 SPF - 40 holes) w/ 4" csg gun & 120° phasing			
33. ACID, SHOT, FRACTURE, CEMENT SQUEEZE, ETC.			
DEPTH INTERVAL (MD)		AMOUNT AND KIND OF MATERIAL USED	
7918'-7958'		66,700 gal gel w/ 152,000#	
		16/30 Ottawa sand & 15,000#	
		resin coated sand.	
34. PRODUCTION			
DATE FIRST PRODUCTION	PRODUCTION METHOD (Flowing, gas lift, pumping—size and type of pump)	WELL STATUS (Producing or shut-in)	
7-7-94	Flowing	Producing	
DATE OF TEST	HOURS TESTED	CHOKE SIZE	PROD'N. FOR TEST PERIOD
7-10-94	24	20/64"	406
FLOW. TUBING PRESS.	CASING PRESSURE	CALCULATED 24-HOUR RATE	OIL—BBL.
500	920	406	408
GAS—MCF.		WATER—BBL.	
183		1005	
OIL GRAVITY-API (CORR.)		40°	
35. DISPOSITION OF GAS (Sold, used for fuel, vented, etc.) Sold - Llano, Inc.			
36. LIST OF ATTACHMENTS C-104, Deviation Survey, Logs			
37. I hereby certify that the foregoing and attached information is complete and correct as determined from all available records			
SIGNED <i>Jerry McCullough</i>		TITLE Sr. Production Clerk	
DATE 7/18/94			

*(See Instructions and Spaces for Additional Data on Reverse Side)

37. SUMMARY OF POROUS ZONES: (Show all important zones of porosity and contents thereof; cored intervals; and all drill-stem, tests, including depth interval tested, cushion used, time tool open, flowing and shut-in pressures, and recoveries):

38. GEOLOGIC MARKERS

FORMATION	TOP	BOTTOM	DESCRIPTION, CONTENTS, ETC.	NAME	TOP	
					MEAS. DEPTH	TRUE VERT. DEPTH
Bell Canyon	4124'	5035'	Sandstone, Shale, Limestone			
Cherry Canyon	5035'	6382'	Sandstone, Shale, Limestone			
Brushy Canyon	6382'	8022'	Sandstone, Shale, Limestone			
Bone Spring	8022'	8150'	Limestone, Shale, Sandstone			
TD	8150'		Cored 7760'-7992' (232') Recovered 232' of core			

WELL NAME AND NUMBER North Pure Gold 9 Fed. #5

LOCATION _____
(Give Unit, Section, Township and Range)

OPERATOR Santa Fe Energy

DRILLING CONTRACTOR NABORS DRILLING USA, INC.

The Undersigned hereby certifies that he is an authorized representative of the drilling contractor who drilled the above-described well and that he has conducted deviation tests and obtained the following results:

<u>DEGREES @ DEPTH</u>	<u>DEGREES @ DEPTH</u>	<u>DEGREES @ DEPTH</u>	<u>DEGREES @ DEPTH</u>
<u>1 @ 429</u>	<u>1/2 @ 6380</u>	_____	_____
<u>3/4 @ 910</u>	<u>3/4 @ 6880</u>	_____	_____
<u>3/4 @ 1409</u>	<u>1 @ 7380</u>	_____	_____
<u>3/4 @ 1908</u>	<u>1 @ 7760</u>	_____	_____
<u>1/2 @ 2408</u>	<u>1 3/4 @ 8150</u>	_____	_____
<u>3/4 @ 2880</u>	_____	_____	_____
<u>1 @ 3319</u>	_____	_____	_____
<u>2 @ 3476</u>	_____	_____	_____
<u>1 3/4 @ 3660</u>	_____	_____	_____
<u>1 @ 3789</u>	_____	_____	_____
<u>1 1/2 @ 3983</u>	_____	_____	_____
<u>1/2 @ 4465</u>	_____	_____	_____
<u>1/2 @ 4925</u>	_____	_____	_____
<u>1/2 @ 5410</u>	_____	_____	_____
<u>3/4 @ 5909</u>	_____	_____	_____

Drilling Contractor Nabors Drilling USA, Inc.

By *L. Bohannon*
Larry Bohannon

Subscribed and sworn to before me this 6th day of July, 1994

Bernice K. Holder
Notary Public

My Commission Expires _____ MIDLAND County TEXAS

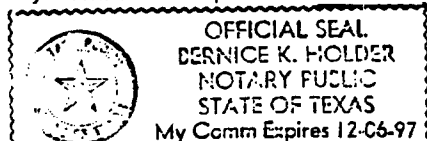

RECEIVED

Form 3160-5

June 1990

JUN 30 10 53 AM '94

GAS
ARE

UNITED STATES
DEPARTMENT OF THE INTERIOR
BUREAU OF LAND MANAGEMENT

NM OIL CONS COMMISSION
Drawer DD
Artesia, NM 88210

FORM APPROVED
Budget Bureau No. 1004-0135
Expires: March 31, 1993

5. Lease Designation and Serial No.

NM-77046

6. If Indian, Allottee or Tribe Name

SUNDRY NOTICES AND REPORTS ON WELLS

7. If Unit or CA, Agreement Designation

SUBMIT IN TRIPLICATE

Type of Well

☒ Oil Well ☐ Gas Well ☐ Other

8. Name of Operator

Santa Fe Energy Operating Partners, L.P.

9. Address and Telephone No.

550 W. Texas, Suite 1330, Midland, Texas 79701 JUL - 8 '94

10. Location of Well (Footage, Sec., T., R., M., or Survey Description)

(D), 1140' FNL and 990' FWL, Sec. 9, T-23S, R-31E C. D.
ARTESIA, OFFICE

8. Well Name and No.

North Pure Gold 9 Fed #5

9. API Well No.

30-015-27914

10. Field and Pool, or Exploratory Area

Los Medanos (Delaware)

11. County or Parish, State

Eddy Co., NM

CHECK APPROPRIATE BOX(s) TO INDICATE NATURE OF NOTICE, REPORT, OR OTHER DATA

TYPE OF SUBMISSION

☐ Notice of Intent☒ Subsequent Report☐ Final Abandonment Notice

TYPE OF ACTION

☐ Abandonment☐ Recompletion☐ Plugging Back☐ Casing Repair☐ Altering Casing☒ Other Ran casing & released rig☐ Change of Plans☐ New Construction☐ Non-Routine Fracturing☐ Water Shut-Off☐ Conversion to Injection☐ Dispose Water

(Note: Report results of multiple completion on Well Completion or Recompletion Report and Log (form.)

13. Describe Proposed or Completed Operations (Clearly state all pertinent details, and give pertinent dates, including estimated date of starting any proposed work. If well is directionally drilled, give subsurface locations and measured and true vertical depths for all markers and zones pertinent to this work.)

6/27/94: Depth 8150'. RU and ran 200 jts 5-1/2" 15.5 & 17.0# K-55 and J-55 casing and set at 8150'. FC @ 8106'. Cemented w/ 125 bbls Nitrified mud ahead 500 gals Superflush & 375 sx Cl "C" containing 3% Econolite + .25/10% Flocele. Tail w/ 300 sx Cl "H" containing .6% Halad 322, 8 pps Silica Fume, and 3% salt. Plug down at 2:00 p.m. Displ w/ 50 bbls 10% Acetic acid and tail w/ 140 bbls 2% KCl water. ND, set slips w/ 120,000#. NU tbg head. Released rig at 7:30 p.m. MST 6-27-94. WOCU.

14. I hereby certify that the foregoing is true and correct

Signed

Berry McCullough

Title

Sr. Production Clerk

Date

6/28/94

(This space for Federal or State office use)

Approved by

Conditions of approval, if any:

Title

Date

Title 18 U.S.C. Section 1001, makes it a crime for any person knowingly and willfully to make to any department or agency of the United States any false, fictitious or fraudulent statement or representations as to any matter within its jurisdiction.

*See instruction on Reverse Side

NM OIL COI. COMMISSION
Drawer DD
Artesia, NM 88210

C/SF

Form 3160-5
(June 1990)

UNITED STATES
DEPARTMENT OF THE INTERIOR
BUREAU OF LAND MANAGEMENT

FORM APPROVED
Budget Bureau No. 1004-0135
Expires: March 31, 1993

5. Lease Designation and Serial No.
NM-77046

6. If Indian, Allottee or Tribe Name

SUNDRY NOTICES AND REPORTS ON WELLS

Do not use this form for proposals to drill or to deepen or reentry to a different reservoir.
Use "APPLICATION FOR PERMIT—" for such proposals

SUBMIT IN TRIPLICATE

RECEIVED

1. Type of Well
☒ Oil Well ☐ Gas Well ☐ Other
2. Name of Operator
Santa Fe Energy Operating Partners, L.P.
3. Address and Telephone No.
550 W. Texas, Suite 1330, Midland, Texas 79701
4. Location of Well (Footage, Sec., T., R., M., or Survey Description)
(D), 1140' FNL and 990' FWL, Sec. 9, T-23S, R-31E

JUL - 8 '94

C. C. D.
ARTESIA, OFFICE

7. If Unit or CA, Agreement Designation

8. Well Name and No.
North Pure Gold 9 Fed #5

9. API Well No.
30-015-27914

10. Field and Pool, or Exploratory Area
Los Medanos (Delaware)
11. County or Parish, State
Eddy Co., NM

12. CHECK APPROPRIATE BOX(S) TO INDICATE NATURE OF NOTICE, REPORT, OR OTHER DATA

TYPE OF SUBMISSION

TYPE OF ACTION

☐ Notice of Intent
☒ Subsequent Report
☐ Final Abandonment Notice

☐ Abandonment
☐ Recompletion
☐ Plugging Back
☐ Casing Repair
☐ Altering Casing
☒ Other Ran casing string

☐ Change of Plans
☐ New Construction
☐ Non-Routine Fracturing
☐ Water Shut-Off
☐ Conversion to Injection
☐ Dispose Water

(Note: Report results of multiple completion on Well Completion or Recompletion Report and Log form.)

13. Describe Proposed or Completed Operations (Clearly state all pertinent details, and give pertinent dates, including estimated date of starting any proposed work. If well is directionally drilled, give subsurface locations and measured and true vertical depths for all markers and zones pertinent to this work.)*

6/17/94: Depth 3983'. RU and ran 91 jts 8-5/8" 32# K-55 ST&C casing and set at 3983'. Cemented w/ 950 sx "C" Lite 35:65:6 containing 9 pps salt. Tail w/ 200 sx Cl "C" + 2% CaCl₂. Plug down at 9:00 p.m. Circ'd 10 sx to pit. WOC.

6/18/94: WOC. Cut off and weld on head. Tested to 1000 psi, ok. NU BOP and choke manifold. Test same to 1500 psi, ok. PU BHA and TIH. Test casing and pipe rams to 1500 psi, ok. WOC total of 25 hours. Resume drilling operations.

J. Lora

14. I hereby certify that the foregoing is true and correct

Signed

(This space for Federal or State office use)

Title

Sr. Production Clerk

Date

6/22/94

Approved by

Conditions of approval, if any:

Title

Date

Title 18 U.S.C. Section 1001, makes it a crime for any person knowingly and willfully to make to any department or agency of the United States any false, fictitious or fraudulent statement or representations as to any matter within its jurisdiction.

*See Instruction on Reverse Side

Form 3160-5
(June 1990)

RECEIVED

JUN 17 10 46 AM '94

UNITED STATES
DEPARTMENT OF THE INTERIOR
BUREAU OF LAND MANAGEMENT

NM OIL CONS COMMISSION
Lawer DD
Artesia, NM 88210

FORM APPROVED
Budget Bureau No. 1004-0135
Expires: March 31, 1993

SUNDRY NOTICES AND REPORTS ON WELLS

Do not use this form for proposals to drill or to deepen or reentry to a different reservoir.
Use "APPLICATION FOR PERMIT—" for such proposals

SUBMIT IN TRIPLICATE

RECEIVED

Type of Well

☒ Oil Well ☐ Gas Well ☐ Other

2. Name of Operator

Santa Fe Energy Operating Partners, L.P.

3. Address and Telephone No.

550 W. Texas, Suite 1330, Midland, Texas 79701

4. Location of Well (Footage, Sec., T., R., M., or Survey Description)

(D), 1140' FNL and 990' FWL, Sec. 9, T-23S, R-31E

5. Lease Designation and Serial No.

NM-77046

6. If Indian, Allottee or Tribe Name

7. If Unit or CA, Agreement Designation

8. Well Name and No.

North Pure Gold 9 Fed #5

9. API Well No.

30-015-27914

10. Field and Pool, or Exploratory Area

Los Medanos (Delaware)

11. County or Parish, State

Eddy Co., NM

CHECK APPROPRIATE BOX(s) TO INDICATE NATURE OF NOTICE, REPORT, OR OTHER DATA

TYPE OF SUBMISSION

☐ Notice of Intent

☒ Subsequent Report

☐ Final Abandonment Notice

TYPE OF ACTION

☐ Abandonment

☐ Recompletion

☐ Plugging Back

☐ Casing Repair

☐ Altering Casing

☒ Other Spud and ran casing

☐ Change of Plans

☐ New Construction

☐ Non-Routine Fracturing

☐ Water Shut-Off

☐ Conversion to Injection

☐ Dispose Water

(Note: Report results of multiple completion on Well Completion or Recompletion Report and Log form.)

13. Describe Proposed or Completed Operations (Clearly state all pertinent details, and give pertinent dates, including estimated date of starting any proposed work. If well is directionally drilled, give subsurface locations and measured and true vertical depths for all markers and zones pertinent to this work.)

6/12/94: MIRU and mix spud mud. Spud well at 7:30 p.m. CST. Drlg.

6/13/94: Depth 429'. RU and ran 10 jts 13-3/8" 48# H-40 ST&C casing and set at 429'. Cemented w/ 100 sx C1 "C" containing 6% gel, 2% CaCl₂ and 1/4 pps Celloseal. Tail w/ 225 sx C1 "C" + 2% CaCl₂. Plug down at 5:30 a.m. Circ'd 75 sx to pit. WOC.

6/14/94: NU and test BOP to 600 psi, ok. WOC. Install rotating head. Test casing to 600 psi, ok. WOC total of 24 hours. Resume drilling operations.

14. I hereby certify that the foregoing is true and correct

Signed

Gregory McCullough

Title

Sr. Production Clerk

Date

6/15/94

(This space for Federal or State office use)

Approved by

Conditions of approval, if any:

Title

Date

Title 18 U.S.C. Section 1001, makes it a crime for any person knowingly and willfully to make to any department or agency of the United States any false, fictitious or fraudulent statement or representations as to any matter within its jurisdiction.

*See instruction on Reverse Side

Form 3160-5
(June 1990)

RECEIVED

JUN 8 11 07 AM '94

UNITED STATES
DEPARTMENT OF THE INTERIOR
BUREAU OF LAND MANAGEMENT

NM OIL CONS COMMISSION
Drawer DD
Artesia, NM 88210

FORM APPROVED
Budget Bureau No. 1004-0135
Expires: March 31, 1993

5. Lease Designation and Serial No.

NM-77046

6. If Indian, Allottee or Tribe Name

7. If Unit or CA, Agreement Designation

SUBMIT IN TRIPLICATE

RECEIVED

Type of Well

☒ Oil Well ☐ Gas Well ☐ Other

8. Name of Operator

Santa Fe Energy Operating Partners, L.P.

9. Address and Telephone No.

550 W. Texas, Suite 1330, Midland, Texas 79701

10. Location of Well (Footage, Sec., T., R., N., or Survey Description)

(D), 1140' FNL and 990' FWL, Sec. 9, T-23S, R-31E

8. Well Name and No.

North Pure Gold 9 Fed #5

9. API Well No.

30-015-27914

10. Field and Pool, or Exploratory Area

Los Medanos (Delaware)

11. County or Parish, State

Eddy Co., NM

CHECK APPROPRIATE BOX(s) TO INDICATE NATURE OF NOTICE, REPORT, OR OTHER DATA

TYPE OF SUBMISSION

TYPE OF ACTION

☒ Notice of Intent

☐ Subsequent Report

☐ Final Abandonment Notice

☐ Abandonment

☐ Recompletion

☐ Plugging Back

☐ Casing Repair

☐ Altering Casing

☐ Other

☒ Change of Plans

☐ New Construction

☐ Non-Routine Fracturing

☐ Water Shut-Off

☐ Conversion to Injection

☐ Dispose Water

Note: Report results of multiple completion on Well Completion or Recompletion Report and Log form.

13. Describe Proposed or Completed Operations (Clearly state all pertinent details, and give pertinent dates, including estimated date of starting any proposed work. If well is directionally drilled give subsurface locations and measured and true vertical depths for all markers and zones pertinent to this work.)

Santa Fe Energy Operating Partners, L.P. proposes to implement the following changes to drill the captioned well.

1. We propose to set 13-3/8" 48.0 ppf casing in a 17-1/2" hole at 400', utilizing 400 sx of cement to circulate.
2. We propose to drill an 11" hole to $\pm 4000'$ (instead of the stated 12-1/4" hole).
3. We propose to test the 3-M BOP stack and manifold to 1500 psi with a rig pump.

14. I hereby certify that the foregoing is true and correct.

Signed

This space for Federal or State office use:

Approved by (ORIG. SGD.) JOE G. LARA

Conditions of approval, if any:

Title

Sr. Production Clerk

Date

June 7, 1994

Title

PETROLEUM ENGINEER

Date

7/6/94

Title 18 U.S.C. Section 1001, makes it a crime for any person knowingly and willfully to make to any department or agency of the United States any false, fictitious or fraudulent statement or representations as to any matter within its jurisdiction.

*See instruction on Reverse Side

NM OIL CON' COMMISSION

DRAWN BY

ANTONIA, NM UNITED STATES

DEPARTMENT OF THE INTERIOR

BUREAU OF LAND MANAGEMENT

SUBMIT IN PLICATE*
(Other instructions on
reverse side)

30-015-27914
Form approved.
Budget Bureau No. 1004-0136
Expires August 31, 1985

APPLICATION FOR PERMIT TO DRILL, DEEPEN OR PLUG BACK

1A. TYPE OF WORK

DRILL ☒

DEEPEN ☐

PLUG BACK ☐

1B. TYPE OF WELL

OIL
WELL ☒

GAS
WELL ☐

OTHER ☐

2. NAME OF OPERATOR

Santa Fe Energy Operating Partners, L.P.

3. ADDRESS OF OPERATOR

550 W. Texas, Suite 1330, Midland, Texas 79701

4. LOCATION OF WELL (Report location clearly and in accordance with any State requirements.)*
At surface

(D), 1140' FNL and 990' FWL, Sec. 9, T-23S, R-31E

At proposed prod. zone

14. DISTANCE IN MILES AND DIRECTION FROM NEAREST TOWN OR POST OFFICE*

19 miles East of Loving, New Mexico

15. DISTANCE FROM PROPOSED*

LOCATION TO NEAREST
PROPERTY OR LEASE LINE, FT. 990'
(Also to nearest drlg. unit line, if any)

16. NO. OF ACRES IN LEASE

960

17. NO. OF ACRES ASSIGNED
TO THIS WELL

40

18. DISTANCE FROM PROPOSED LOCATION*
TO NEAREST WELL, DRILLING, COMPLETED,
OR APPLIED FOR, ON THIS LEASE, FT.

19. PROPOSED DEPTH

8100'

20. ROTARY OR CABLE TOOLS

Rotary

21. ELEVATIONS (Show whether DF, RT, GR, etc.)

3345' GR

22. APPROX. DATE WORK WILL START*

March 31, 1994

23.

PROPOSED CASING AND CEMENTING PROGRAM

111-P Potash

SIZE OF HOLE	SIZE OF CASING	WEIGHT PER FOOT	SETTING DEPTH	QUANTITY OF CEMENT
17-1/2"	13-3/8"	48.0	600'	600 sx to circulate
12-1/4"	8-5/8"	32.0	4200'	2000 sx to circulate
7-7/8"	5-1/2"	15.5 & 13.4	8100'	TOC 200' inside 8-5/8" casing

We propose to drill to a depth sufficient to test the Delaware formation for oil. If productive, 5-1/2" casing will be cemented to TD. If non-productive, the well will be plugged and abandoned in a manner consistent with Federal Regulations. Specific programs as per Onshore Oil and Gas Order No. 1 are outlined in the following attachments:

Drilling Program

Exhibit A - Operations Plan

Exhibit B - BOP and Choke

Exhibit C - Drilling Fluid Program

Exhibit D - Auxiliary Equipment

Exhibit E - Topo Map of Location

Exhibit F - Plat showing existing wells

Exhibit G - Well location & lease roads

Exhibit H - Well Site Layout

Multi-point Surface Use and Operations Plan

This APD is being resubmitted after being denied at a location 150' North of the proposed location, due to Potash reserves. The present location was suggested by Craig Cranston. It is unorthodox, but has been administratively approved by the NMOC.

IN ABOVE SPACE DESCRIBE PROPOSED PROGRAM: If proposal is to deepen or plug back, give data on present productive zone and proposed new productive zone. If proposal is to drill or deepen directionally, give pertinent data on subsurface locations and measured and true vertical depths. Give blowout preventer program, if any.

SIGNED

Daniel Polito

TITLE

Division Drilling Engineer

DATE Feb. 11, 1994

(This space for Federal or State office use)

PERMIT NO.

APPROVAL DATE

APPROVED BY

Mark J. Schnitzer

TITLE

Acting Assoc.

DATE

APR 5 1994

CONDITIONS OF APPROVAL, IF ANY:

APPROVAL SUBJECT TO
GENERAL REQUIREMENTS AND
SPECIAL STIPULATIONS

ATTACHED

*See Instructions On Reverse Side

Title 18 U.S.C. Section 1001, makes it a crime for any person knowingly and willfully to make to any department or agency of the United States any false, fictitious or fraudulent statements or representations or to any matter within its jurisdiction.

DISTRICT I

P. O. Box 1980
Hobbs, NM 88240

DISTRICT II

P. O. Drawer DD
Artesia, NM 88210

OIL CONSERVATION DIVISION

P. O. Box 2088
Santa Fe, New Mexico 87504-2088

DISTRICT III

1000 Rio Brazos Rd
Aztec, NM 87410

WELL LOCATION AND ACREAGE DEDICATION PLAT

All distances must be from the outer boundaries of the section.

Operator SANTA FE ENERGY OPER. PART, L.P.			Lease N. PURE GOLD '9' FED.		Well No. 5
Unit Letter D	Section 9	Township 23 SOUTH	Range 31 EAST, N.M.P.M.	County EDDY	
Actual Footage Location of Well 1140 feet from the NORTH line and 990 feet from the WEST line					
Ground Level Elev. 3345'	Producing Formation Delaware		Pool Los Medanos (Delaware)		40 Acres

- Outline the acreage dedicated to the subject well by colored pencil or hatchure marks on the plat below.
- If more than one lease is dedicated to the well, outline each and identify the ownership thereof (both as to working interest and royalty).
- If more than one lease of different ownership is dedicated to the well, have the interest of all the owners been consolidated by communitization, unitization, forced-pooling, etc.?
☐ Yes ☐ No If answer is "yes", type of consolidation _____
If the answer is "no", list the owners and tract descriptions which have actually been consolidated. (Use the reverse side of this form if necessary.) _____
No allowable will be assigned to the well until all interests have been consolidated (by communitization, unitization, forced-pooling, or otherwise) or until a non-standard unit, eliminating such interest, has been approved by the division.

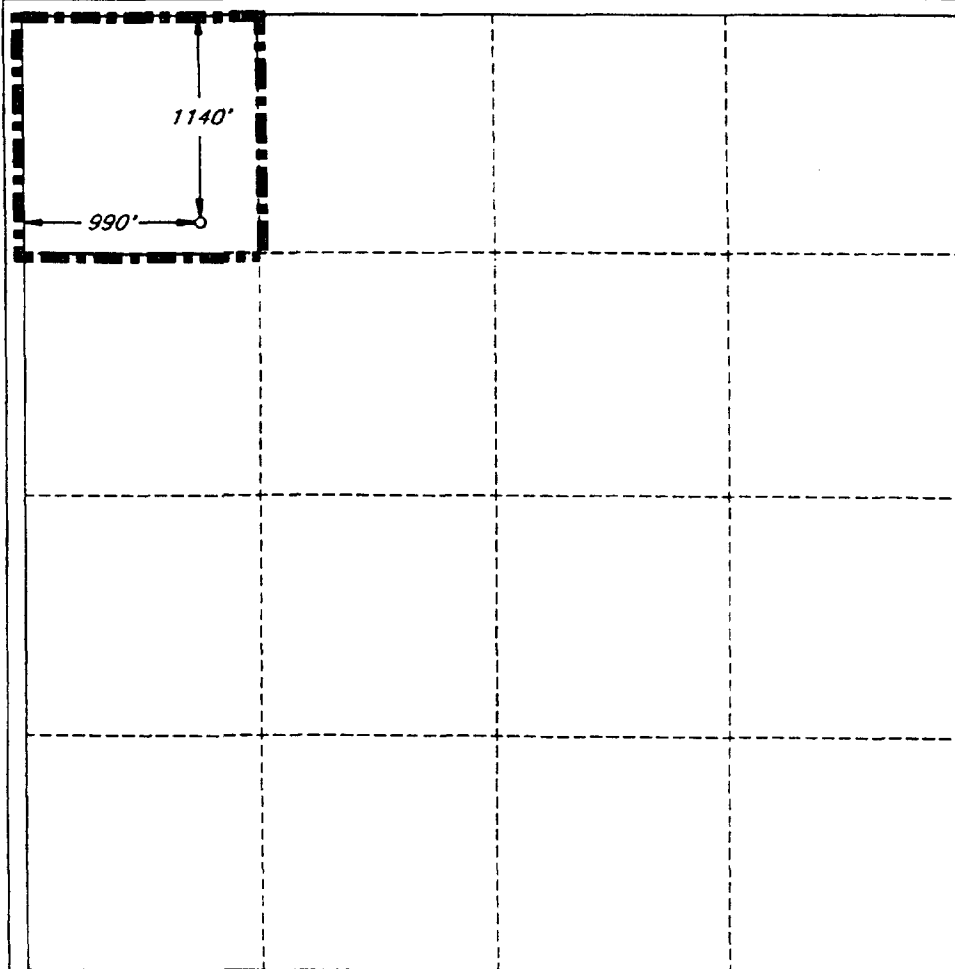

OPERATOR CERTIFICATION

I hereby certify that the information herein is true and complete to the best of my knowledge and belief.

Signature

Darrell Roberts

Printed Name

Darrell Roberts

Position

Division Drilling Engineer

Company Santa Fe Energy
Operating Partners, L.P.

Date

February 11, 1994

SURVEYOR CERTIFICATION

I hereby certify that the well location shown on this plat was plotted from field notes of actual surveys made by me or under my supervision, and that the same is true and correct to the best of my knowledge and belief.

Date Surveyed

JANUARY 20, 1994

Signature and Seal of
Professional Surveyor

V. LYNN

BEZNER

NO. 7920

Certification

V. L. BEZNER R.P.S. #7920

JOB #31254/48 SE cis

WRS COMPLETION REPORT

COMPLETIONS
PI# 30-T-0003 09/30/94 SEC 9 TWP 23S RGE 31E
30-015-27914-0000 PAGE 1

NMEX EDDY * 1140FNL 990FWL SEC NW NW
STATE COUNTY FOOTAGE SPOT
SANTA FE ENERGY OPRNG D DO
OPERATOR WELL CLASS INIT FIN
5 NORTH PURE GOLD "9" FEDERAL
WELL NO. LEASE NAME
3356KB 3345GR LOS MEDANOS
OPER ELEV FIELD/POOL AREA
API 30-015-27914-0000
LEASE NO. PERMIT OR WELL I.D. NO.
06/12/1994 07/10/1994 ROTARY VERT OIL
SPUD DATE COMP. DATE TYPE TOOL HOLE TYPE STATUS
8100 DELAWARE NABORS DRLG USA 347 RIG SUB 10
PROJ. DEPTH PROJ. FORM CONTRACTOR
DTD 8150 PB 8080 FM/TD BONE SPG
DRILLERS T.D. LOG T.D. PLUG BACK TD OLD T.D. FORM T.D.

LOCATION DESCRIPTION

18 MI E LOVING, NM

WELL IDENTIFICATION/CHANGES

PROJ DEPTH CHGD FROM 8200
FLD CHGD FROM EDDY CO UNDESIGNATED
FTG CHGD FROM 660 FNL, 660 FWL

CASING/LINER DATA

CSG 13 3/8 @ 429 W/ 325 SACKS
CSG 8 5/8 @ 3983 W/ 1150 SACKS
CSG 5 1/2 @ 8150 W/ 1300 SACKS

TUBING DATA

TBG 2 7/8 AT 8002

INITIAL POTENTIAL

IPP 406BOPD 408 MCFD 183BW 20/64CK 24HRS
DELAWARE PERF W/ 40/IT 7918- 7958
GTY 40.0 GOR 1005

TYPE	FORMATION	LTH	TOP DEPTH/SUB	BSE DEPTH/SUB
LOG	BELL CYN		4124 -768	
LOG	CHER CYN		5035 -1679	
LOG	BRSH CYN		6382 -3026	

CONTINUED IC# 300157010193

COPYRIGHT 1994



**Petroleum Information
Corporation**

PI-WRS-GET
Form No 187

COMPLETIONS SEC 9 TWP 23S RGE 31E
PI# 30-T-0003 09/30/94 30-015-27914-0000 PAGE 2

SANTA FE ENERGY OPRNG D DO
5 NORTH PURE GOLD "9" FEDERAL

TYPE FORMATION LTH TOP DEPTH/SUB BSE DEPTH/SUB
LOG BONE SPG 8022 -4666
SUBSEA MEASUREMENTS FROM KB

CORES

CORE 1	7760-7820	DELAWARE CONV	D
NO DESCRIPTION AVAILABLE			
CORE 2	7820-7880	DELAWARE CONV	D
NO DESCRIPTION AVAILABLE			
CORE 3	7880-7940	DELAWARE CONV	D
NO DESCRIPTION AVAILABLE			
CORE 4	7940-7992	DELAWARE CONV	D
NO DESCRIPTION AVAILABLE			

PRODUCTION TEST DATA

PTF 406BOPD 408 MCFD 183BW 20/64CK 24HRS
DELAWARE PERF W/ 40/IT 7918-7958
PERF 7918-7958
SWFR 7918-7958 66700GALS 167000LBS SAND
16/30 SD ADDTVGELA

LOGS AND SURVEYS /INTERVAL,TYPE/

LOGS	DI	LDT	CNL
LOGS	GR		

DRILLING PROGRESS DETAILS

	SANTA FE ENERGY OPRNG
	550 W TEXAS
	STE 1330
	MIDLAND, TX 79701
	915-687-3551
02/24	LOC/1993/
06/14	DRLG AHEAD
06/21	DRLG 5680

CONTINUED

COMPLETIONS SEC 9 TWP 23S RGE 31E
PI# 30-T-0003 09/30/94 30-015-27914-0000 PAGE 3

SANTA FE ENERGY OPRING
5 NORTH PURE GOLD "9" FEDERAL

D DO

DRILLING PROGRESS DETAILS

06/28 8150 TD, WOCT
07/08 8150 TD, PREP/TEST
08/30 8150 TD, PB 8080, WOSP
TD REACHED 06/27/94 RIG REL 06/27/94
09/26 8150 TD, PB 8080
COMP 7/10/94, IPP 406 BO, 408 MCFGPD,
183 BWP, 20/64 CK, GOR
1005, GTY 40
PROD ZONE - DELAWARE 7918-7958
FOUR CORES, NO TESTS RPTD

30-015-27914

NSL-3348
Approved 1-31-94

7-19-94
Camp Hunt
260-8111
PLH
3980-8138