

ABOVE THIS LINE FOR DIVISION USE ONLY

NEW MEXICO OIL CONSERVATION DIVISION

- Engineering Bureau -

1220 South St. Francis Drive, Santa Fe, NM 87505



R: 04/28/16

ADMINISTRATIVE APPLICATION CHECKLIST

THIS CHECKLIST IS MANDATORY FOR ALL ADMINISTRATIVE APPLICATIONS FOR EXCEPTIONS TO DIVISION RULES AND REGULATIONS WHICH REQUIRE PROCESSING AT THE DIVISION LEVEL IN SANTA FE

Application Acronyms:

[NSL-Non-Standard Location] [NSP-Non-Standard Proration Unit] [SD-Simultaneous Dedication]
 [DHC-Downhole Commingling] [CTB-Lease Commingling] [PLC-Pool/Lease Commingling]
 [PC-Pool Commingling] [OLS - Off-Lease Storage] [OLM-Off-Lease Measurement]
 [WFX-Waterflood Expansion] [PMX-Pressure Maintenance Expansion]
 [SWD-Salt Water Disposal] [IPI-Injection Pressure Increase]
 [EOR-Qualified Enhanced Oil Recovery Certification] [PPR-Positive Production Response]

[1] TYPE OF APPLICATION - Check Those Which Apply for [A]

- [A] Location - Spacing Unit - Simultaneous Dedication
☒ NSL ☐ NSP ☐ SD

Check One Only for [B] or [C]

- [B] Commingling - Storage - Measurement

☐ DHC ☐ CTB ☐ PLC ☐ PC ☐ OLS ☐ OLM

- [C] Injection - Disposal - Pressure Increase - Enhanced Oil Recovery

☐ WFX ☐ PMX ☐ SWD ☐ IPI ☐ EOR ☐ PPR

- [D] Other: Specify _____

NSL-7419

Matador Prod. Comp. (#228937)

WELL: B Banker 33-23S-28E

RB No. 226 H

Pool: Culebra Bluff;

*Wolfcamp, South
(gas) pool*

(# 75750)

[2] NOTIFICATION REQUIRED TO: - Check Those Which Apply, or ☐ Does Not Apply

- [A] ☐ Working, Royalty or Overriding Royalty Interest Owners

- [B] ☒ Offset Operators, Leaseholders or Surface Owner

- [C] ☐ Application is One Which Requires Published Legal Notice

- [D] ☐ Notification and/or Concurrent Approval by BLM or SLO
 U.S. Bureau of Land Management - Commissioner of Public Lands, State Land Office

- [E] ☐ For all of the above, Proof of Notification or Publication is Attached, and/or,

- [F] ☐ Waivers are Attached

API#30-015-

[3] SUBMIT ACCURATE AND COMPLETE INFORMATION REQUIRED TO PROCESS THE TYPE OF APPLICATION INDICATED ABOVE.

[4] **CERTIFICATION:** I hereby certify that the information submitted with this application for administrative approval is **accurate** and **complete** to the best of my knowledge. I also understand that **no action** will be taken on this application until the required information and notifications are submitted to the Division.

Note: Statement must be completed by an individual with managerial and/or supervisory capacity.

Zoe E. Lees

Print or Type Name

Signature

Attorney

Title

4/25/2016

Date

Zoe.lees@modrall.com

e-mail Address



MODRALL SPERLING

L A W Y E R S

April 25, 2016

Zoë E. Lees
505.848.1859
Fax: 505.848.9710
Zoe.lees@modrall.com

David Catanach
Oil Conservation Division
New Mexico Department of Energy,
Minerals and Natural Resources
1220 South Saint Francis Drive
Santa Fe, New Mexico 87505

Re: Application of Matador Production Company for administrative approval of unorthodox well location for its B Banker 33-23S-28E RB #226H well located in the N/2 of Section 33, Township 23 South, Range 28 East, N.M.P.M., Eddy County, New Mexico (the "Well").

Dear Mr. Catanach:

Matador Production Company (OGRID No. 228937) seeks administrative approval of an unorthodox well location ("NSL") for its B Banker 33-23S-28E RB #226H well (API No. forthcoming) to be completed within the Culebra Bluff; Wolfcamp, South (Gas) pool (Pool Code 75750) underlying the N/2 of Section 33, Township 23S, Range 28E, N.M.P.M., Eddy County, New Mexico. A C-102 for the Well is attached as **Exhibit A**. This is a horizontal Well that will be drilled as follows:

B Banker 33-23S-28E RB #226H

- Surface Hole Location: 1881 feet from the North line and 145 feet from the East line of Section 33, Township 23 South, Range 28 East;
- First Perforation Point: 2310 feet from the North line and 330 feet from the East line of Section 33, Township 23 South, Range 28 East;
- Last Perforation Point: 2310 feet from the North line and 330 feet from the West line of Section 33, Township 23 South, Range 28 East; and
- Bottom Hole Location: 2310 feet from the North line and 240 feet from the West line of Section 33, Township 23 South, Range 28 East.

Matador Production Company is requesting this NSL in order to efficiently produce its interests in Section 33. This Well will produce from the Culebra

Modrall Sperling
Roehl Harris & Sisk P.A.

Bank of America Centre
500 Fourth Street NW
Suite 1000
Albuquerque,
New Mexico 87102

PO Box 2168
Albuquerque,
New Mexico 87103-2168

Tel: 505.848.1800
www.modrall.com

Bluff, Wolfcamp, South (Gas) pool (Pool Code 75750). There are no special pool rules for this pool, and thus the setback requirements under Rule 19.15.15.10(B) of 660' apply. The completed interval for the proposed Well is closer than 660' from the boundary of the project area. The unorthodox location will encroach towards Section 32, the S/2 of Section 33 and Section 34. A list showing the surrounding ownership and the project area for the proposed Well in relation to adjoining spacing units is attached as **Exhibit B**.

A list of the parties affected by the encroachment is attached as **Exhibit C**. Each of these parties has been provided notice of this application by certified mail, return receipt requested, advising them that if they have an objection to the location of this Well, it must be filed with the New Mexico Oil Conservation Division within 20 days of the mailing of this notice. In addition, a copy of this application has also been provided to the New Mexico State Land Office.

Your attention to this matter is appreciated.

Sincerely,

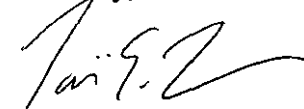
A handwritten signature in black ink, appearing to read 'Zoë E. Lees', written over a horizontal line.

Zoë E. Lees

*Attorney for Matador Production
Company*

c: New Mexico State Land Office
Post Office Box 1148
Santa Fe, New Mexico 87504

District I
1625 N. French Dr., Hobbs, NM 88240
Phone: (575) 393-6161 Fax: (575) 393-0720
District II
811 S. First St., Artesia, NM 88210
Phone: (575) 748-1283 Fax: (575) 748-9720
District III
1000 Rio Brazos Road, Aztec, NM 87410
Phone: (505) 334-6178 Fax: (505) 334-6170
District IV
1220 S. St. Francis Dr., Santa Fe, NM 87505
Phone: (505) 476-3460 Fax: (505) 476-3462

State of New Mexico
Energy, Minerals & Natural Resources
Department
OIL CONSERVATION DIVISION
1220 South St. Francis Dr.
Santa Fe, NM 87505

FORM C-102
Revised August 1, 2011
Submit one copy to appropriate
District Office
☐ AMENDED REPORT

WELL LOCATION AND ACREAGE DEDICATION PLAT

¹ API Number	² Pool Code	³ Pool Name
⁴ Property Code	⁵ Property Name B BANKER 33-23S-28E RB	⁶ Well Number #226H
⁷ OGRID No.	⁸ Operator Name MATADOR PRODUCTION COMPANY	⁹ Elevation 3058'

¹⁰Surface Location

UL or lot no.	Section	Township	Range	Lot Idn	Feet from the	North/South line	Feet from the	East/West line	County
H	33	23-S	28-E	-	1881'	NORTH	145'	EAST	EDDY

UL or lot no.	Section	Township	Range	Lot Idn	Feet from the	North/South line	Feet from the	East/West line	County
E	33	23-S	28-E	-	2310'	NORTH	240'	WEST	EDDY

¹² Dedicated Acres 320	¹³ Joint or Infill	¹⁴ Consolidation Code	¹⁵ Order No.
---	-------------------------------	----------------------------------	-------------------------

No allowable will be assigned to this completion until all interests have been consolidated or a non-standard unit has been approved by the division.

<p>17 OPERATOR CERTIFICATION</p> <p>I hereby certify that the information contained herein is true and complete to the best of my knowledge and belief, and that this organization either owns a working interest or released mineral interest in the land including the proposed bottom hole location or has a right to drill this well at this location pursuant to a contract with an owner of such a mineral or working interest, or to a voluntary pooling agreement or a compulsory pooling order heretofore entered by the division.</p> <p>Signature _____ Date _____</p> <p>Printed Name _____</p> <p>E-mail Address _____</p>		
<p>18 SURVEYOR CERTIFICATION</p> <p>I hereby certify that the well location shown on this plat was plotted from field notes of actual surveys made by me or under my supervision, and that the same is true to the best of my belief.</p> <p>12/17/2015</p> <p>Date of Survey</p> <p>Signature and Seal of Professional Surveyor</p> <p>MICHAEL B. BROWN NEW MEXICO 18329 PROFESSIONAL SURVEYOR</p> <p>Certificate Number _____</p>		

Exhibit A

BOTTOM HOLE LOCATION
NEW MEXICO EAST
NAD 1927
X=572222
Y=459218
LAT.: N 32.2622906
LONG.: W 104.0996894
NAD 1983
X=613405
Y=459277
LAT.: N 32.2624113
LONG.: W 104.1001840

LAST PERFORATION POINT
NEW MEXICO EAST
NAD 1927
X=572312
Y=459219
LAT.: N 32.2622919
LONG.: W 104.0993982
NAD 1983
X=613495
Y=459278
LAT.: N 32.2624127
LONG.: W 104.0998928

FIRST PERFORATION POINT
NEW MEXICO EAST
NAD 1927
X=576976
Y=459255
LAT.: N 32.2623624
LONG.: W 104.0843086
NAD 1983
X=618159
Y=459314
LAT.: N 32.2624834
LONG.: W 104.0848026

Midland Map

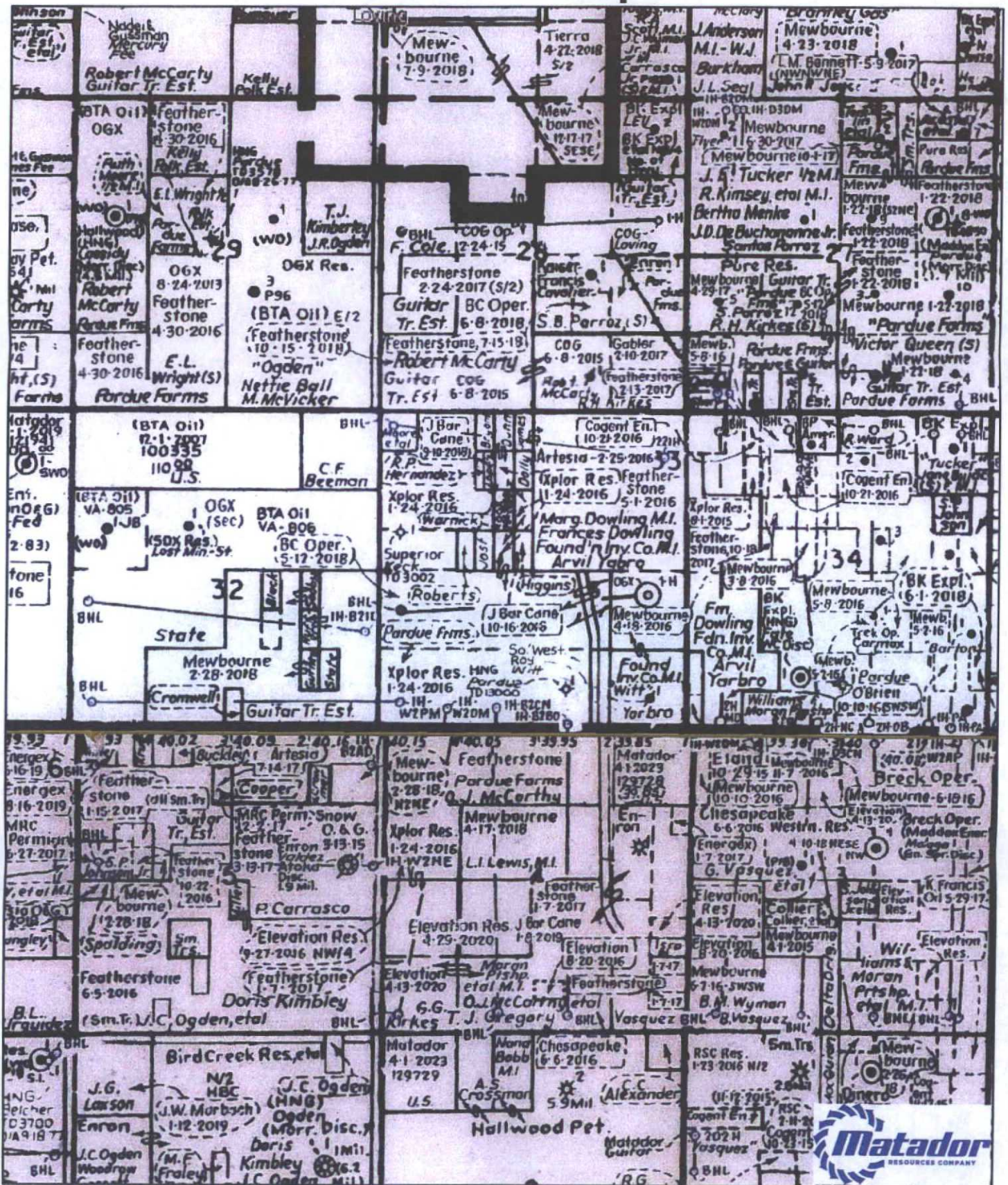

Author: Matador Production Company

Date: 4/21/2016

Exhibit B



RECEIVED OCD

2016 APR 28 P 2:48

April 25, 2016

VIA CERTIFIED MAIL
RETURN RECEIPT REQUESTED

Zoë E. Lees
505.848.1859
Fax: 505.848.9710
Zoe.lees@modrall.com

TO AFFECTED PARTIES

Re: Application of Matador Production Company for administrative approval of unorthodox well location for its B Banker 33-23S-28E RB #226H well located in the N/2 of Section 33, Township 23 South, Range 28 East, N.M.P.M., Eddy County, New Mexico.

Ladies and Gentlemen:

Enclosed in the notice is a copy of the above referenced application filed with the New Mexico Conservation Division on this date. Any objections that you have to this application must be filed in writing with the New Mexico Oil Conservation Division, 1220 South St. Francis Drive, Santa Fe, New Mexico 87505, within twenty (20) days from the date the Division receives the above referenced application may be administratively approved by the Division.

If you have any questions concerning this application, please contact:

Trey Goodwin, RPL
Matador Production Company
5400 LBJ Freeway, Suite 1500
Dallas, TX 75240
Phone: 972-371-5430

If you have no objection to this application, please sign the waiver as indicated below and return the original. Your assistance and cooperation in this matter are appreciated

Sincerely,

Zoë E. Lees

*Attorney for Matador Production
Company*

Modrall Sperling
Roehl Harris & Sisk P.A.

Bank of America Centre
500 Fourth Street NW
Suite 1000
Albuquerque,
New Mexico 87102

PO Box 2168
Albuquerque,
New Mexico 87103-2168

Tel: 505.848.1800
www.modrall.com

WAIVER

_____ hereby waives objection to the above referenced Application for an Unorthodox Location for the B Banker 33-23S-28E RB #226H well, underlying the N/2 of Section 33, Township 23 South, Range 28 East, Eddy County, New Mexico.

Dated: _____

Signature

EXHIBIT C:

List of Affected Persons for the Application of Matador Production Company for administrative approval of unorthodox well location for its B Banker 33-23S-28E RB #226H well located in the N/2 of Section 33, Township 23 South, Range 28 East, N.M.P.M., Eddy County, New Mexico.

Section 32

Mewbourne Oil Co.
3901 S Broadway Ave.
Tyler, TX 75701

BTA Oil Producers
104 S Pecos St.
Midland, TX 79701

Leslie D. Guitar
P.O. Box 1460
Stafford, TX 77477

Pressley Guitar
P.O. Box 2365
Big Springs, TX 79721

Guitar Galusha, LP
1202 Sylvan Avenue,
Abilene, TX 79605

John Guitar, III
P.O. Box 327
Big Spring, TX 79721

Leslie Guitar Nichols
P.O. Box 327
Big Spring, TX 79721

Gayle N. Nicolay Revocable Trust
5528 Tahoe Lane,
Fairway, Kansas 66205

Virginia N. Hoff Management Trust
2601 Lakewood Circle,
Tuscaloosa, Alabama 35405

Guy P. Witherspoon, III
4704 Birchman Ave.
Fort Worth, TX 76107

John Guitar Witherspoon, Jr.
3104 North Sixth Street,
McAllen, TX 78501

Sally Guitar
10 Woodhaven Circle
Abilene, TX 79605

Melissa McGee
P.O. Box 334
Buffalo Gap, TX 79508

Judy Guitar Uhey
P.O. Box 632
Elizabethtown, KY 42702

Sharon Guitar Ellis
P.O. Box 105
Snoqualmie Pass, WA 98068

Whitten Guitar Witherspoon
3824 Arroyo Road,
Fort Worth, TX 76109

Brett Witherspoon
4605 Cloudview Road,
Fort Worth, TX 76109

Wende Witherspoon Morgan
1004 West Eighth Street,
Westlaco, TX 78596

Catherine Gall Parker Exempt Trust
3721 Pallos Verdas
Dallas, TX 75229

Caren Gall Lucas Exempt Trust
P.O. Box 1485
Santa Rosa, Florida 32459

Gall Credit Shelter Trust
3721 Pallos Verdas
Dallas, TX 75229

Kelly Woods Leach
312 Greatview Circle
Birmingham, Alabama

Jack G. Woods, Jr.
312 Greatview Circle
Birmingham, Alabama

Caren G. Lucas
2100 Stone Creek Drive,
Plano, TX 75075

Catherine Gail Parker
3721 Paltos Verdas Drive,
Dallas, TX 75229

Woods Dickens Ranch, LP
36 Surrey Square,
Taylor County, TX 79606

JPH Holdings, L.P.
4400 Aready
Dallas, TX 75205

Honey's Heritage, L.P.
5615 Preston Fairways
Dallas, TX 75252-4954

Lost Creek Royalties, L.P.
400 N. Marienfeld St., Ste. 200
Midland, TX 79701

Polk Land & Minerals, L.P.
1101 Butternut
Abilene, TX 79602

James M. Alexander
P.O. Box 58
Abilene, TX 79604

Jeri Alexander Lott
5005 91st Street
Lubbock, TX 79424

Jane Alexander Rhodes Revocable Trust,
Jeri Alexander Mangum and First Financial
Trust and Asset Management Company,
N.A., Trustees
P.O. Box 701,
Abilene, Texas, 79604

Guitar Land & Cattle, LP
P.O. Box 2213
Abilene, TX 79604

Earl B. Guitar, Jr. and Margaret Ann Guitar
Revocable Trust
P.O. Box 2213
Abilene, Taylor County, TX 79604

James A. Brown
P.O. Box 928
Elk City, Oklahoma 73648

Margaret L. Mehl
702 Cambridge
Lees Summit, Missouri 64086

Ronald M. Rogers
19955 Indian Summer Lane
Monument, CO 80138

Mary E. Harris
531 E. Bungalow Street
Richmond, KS 6608

Kenneth W. Brown
7677 Jayhawk Drive
Riverside, California 92509

Sharon L. Fenton
3447 SE 35th Street
Topeka, KS 66605

Jesma Hopper
2926 Columbine Lane
Wichita, Kansas 67204

Mary Lee Lunblade
511 West Ness
Valley Center, KS 67147

Donna Ledford
9700 South 4055 Road
Talala, Oklahoma 74080

Norma Jeane Gupton
1902 Moody Ct.
Arlington, TX 76002

Joyce Ann Sassie
2500 Longview Dr.
Columbia, Missouri 65203

Charlotte E. Wells
10546 Rec Road 255E
Burkeville, Texas 75932

Ralph Wilson Peden
2704 Meadow Green
Bedford, TX 76201

Johnathon J. Peden
4681 Diane Avenue
San Diego, California 92117

Grant A. Swearingen
209 South Ashley Park
Wichita, Kansas 67209

Phil T. Brewer, Domiciliary Foreign
Personal Representative of the Estate of
Addie Swearingen
PO Box 298
Roswell, NM 88202

M.D. Vandaveer and Lois Vandaveer
12104 SE. 84th Terrace Rd.
Bellevue, Florida 34420

Loma Hopkins Weber Trustee of the Flora
Jane Hopkins Revocable Trust
24476 Chamalea
Mission Viejo, CA 92691

Terry A. White.
1302 W. 3rd St.
Chanute, KS 66720

The Barbara J. Swearingen Trust, Barbara J.
Swearingen and Kim A. Swearingen,
Trustees
2535 Stonepost Lane
Salina, Kansas 67401

CH4NET.COM, Ltd.
P.O. Box 1000
Roswell, New Mexico 88202

Dale M. Richardson
5093 East Highway 82
Gainesville, Texas 76240

David B. Brown
10769 Bay Ridge Dr.
Dardanelle, Arkansas 72834

Edna M. Watt Revocable Trust, Edna M.
Watt, Trustee
400 Holland Drive
West Sacramento, California 95605

Virginia H. Redford
1413 Warwick Street
Garland, Texas 75044

Estate of Evelyn Swearingen
1250 North 50th Road
Jamestown, Kansas 66948

George E. Richardson
4288 American Legion Rd.
Abbeville, GA 31001

Gregory Collier
5731 NW 19th, #4
Oklahoma City, Oklahoma 73127

Estate of Helen A. Marcotte
610 Elliott
Beloit KS 67420

Meredith Hardgrave
6012 East 114th Street
Tulsa, Oklahoma 74137

James Collier, III
1113 Shady Oaks Circle
McKinney, Texas 75070

John A. Brown
15626 Ash St.
Hesperia, CA 92345

Julie J. Martin
P.O. Box 10911
Southport, North Carolina 28461

Kenesaw Cemetery Association, by and
through its Treasurer, Dewayne Boesen
P.O. Box H
Kenesaw, Nebraska 68956

Liana Pearson
2535 Stonepost Lane
Salina, Kansas 67401

Section 34
Mewbourne Oil Co.
3901 S Broadway Ave.
Tyler, TX 75701

Section 33, S/2
Mewbourne Oil Co.
3901 S Broadway Ave.
Tyler, TX 75701

Lowe, Leonard, EMNRD

From: Lowe, Leonard, EMNRD
Sent: Wednesday, May 25, 2016 9:08 AM
To: 'Zoe Lees'
Cc: Bayliss, Randolph, EMNRD; Sharp, Karen, EMNRD; McMillan, Michael, EMNRD; Goetze, Phillip, EMNRD; Jones, William V, EMNRD; 'lisa@rwbyram.com'
Subject: NSL-7419 (B Banker 33 23S 28E RB Well No. 226H, Eddy County) APPROVED
Importance: High

Ms. Zoe E. Lees

The following permit has been issued and will soon be available on the Division's web site:
<http://ocdimage.emnrd.state.nm.us/imaging/WellFileCriteria.aspx>

NSL-7419

Matador Production Company

API: 30-015-PENDING

WELL: B Banker 33 23S 28E RB Well No. 226H, Eddy County

Leonard Lowe

Engineering Bureau

Oil Conservation Division

Energy Minerals and Natural Resources Department

1220 South St. Frances

Santa Fe, New Mexico 87004

Office: 505-476-3492

Fax: 505-476-3462

E-mail: leonard.lowe@state.nm.us

Website: <http://www.emnrd.state.nm.us/ocd/>