

DATE IN 12/1/2016	SUSPENSE	ENGINEER M/M	LOGGED IN 12/2/2016	TYPE C 73	APP NO. PMAM163373140Y
-------------------	----------	--------------	---------------------	-----------	------------------------

ABOVE THIS LINE FOR DIVISION USE ONLY

## NEW MEXICO OIL CONSERVATION DIVISION

- Engineering Bureau -

1220 South St. Francis Drive, Santa Fe, NM 87505



### ADMINISTRATIVE APPLICATION CHECKLIST

THIS CHECKLIST IS MANDATORY FOR ALL ADMINISTRATIVE APPLICATIONS FOR EXCEPTIONS TO DIVISION RULES AND REGULATIONS WHICH REQUIRE PROCESSING AT THE DIVISION LEVEL IN SANTA FE

#### Application Acronyms:

[NSL-Non-Standard Location] [NSP-Non-Standard Proration Unit] [SD-Simultaneous Dedication]  
 [DHC-Downhole Commingling] [CTB-Lease Commingling] [PLC-Pool/Lease Commingling]  
 [PC-Pool Commingling] [OLS - Off-Lease Storage] [OLM-Off-Lease Measurement]  
 [WFX-Waterflood Expansion] [PMX-Pressure Maintenance Expansion]  
 [SWD-Salt Water Disposal] [IPI-Injection Pressure Increase]  
 [EOR-Qualified Enhanced Oil Recovery Certification] [PPR-Positive Production Response]

#### [1] TYPE OF APPLICATION - Check Those Which Apply for [A]

[A] Location - Spacing Unit - Simultaneous Dedication  
☐ NSL ☐ NSP ☐ SD

Check One Only for [B] or [C]

[B] Commingling - Storage - Measurement  
☐ DHC ☒ CTB ☐ PLC ☐ PC ☐ OLS ☐ OLM

[C] Injection - Disposal - Pressure Increase - Enhanced Oil Recovery  
☐ WFX ☐ PMX ☐ SWD ☐ IPI ☐ EOR ☐ PPR

[D] Other: Specify \_\_\_\_\_

#### [2] NOTIFICATION REQUIRED TO: - Check Those Which Apply, or ☐ Does Not Apply

[A] ☐ Working, Royalty or Overriding Royalty Interest Owners

[B] ☐ Offset Operators, Leaseholders or Surface Owner

[C] ☐ Application is One Which Requires Published Legal Notice

[D] ☒ Notification and/or Concurrent Approval by BLM or SLO  
 U.S. Bureau of Land Management - Commissioner of Public Lands, State Land Office

[E] ☐ For all of the above, Proof of Notification or Publication is Attached, and/or,

[F] ☐ Waivers are Attached

#### [3] SUBMIT ACCURATE AND COMPLETE INFORMATION REQUIRED TO PROCESS THE TYPE OF APPLICATION INDICATED ABOVE.

[4] **CERTIFICATION:** I hereby certify that the information submitted with this application for administrative approval is **accurate** and **complete** to the best of my knowledge. I also understand that **no action** will be taken on this application until the required information and notifications are submitted to the Division.

Note: Statement must be completed by an individual with managerial and/or supervisory capacity.

Erin Workman  
 Print or Type Name

Signature

Regulatory Compliance Prof  
 Title

11.30.16  
 Date

Erin.Workman@dmv.com  
 E-mail Address

CTB-809  
 -Devon Energy Production  
 Company, LP  
 6137  
 WCH  
 -Cooter's State  
 #14  
 30-45-37625  
 + 8 wells  
 Pool  
 Willow Lake,  
 Bonaparte  
 Southeast  
 96217



Devon Energy Corporation  
333 West Sheridan Avenue  
Oklahoma City, OK 73102-5010

405 552-7970 Phone  
Erin.workman@dvn.com

RECEIVED

2016 DEC -1 A 10 02

November 30, 2016

Mr. Michael McMillian  
State of New Mexico  
Oil Conservation Division  
1220 S. St. Francis Drive  
Santa Fe, New Mexico 87505

**Re:** Central Tank Battery  
Cooter 16 State 1H, 2H, 3H, 4H, Cooter State Com 5H, 6H 7H, 8H, &  
Cottontail 16 State Com 1H  
Sec., T, R: Sec 16, T25S, R29E  
Lease: V-4902 & VB1065  
API: 30-015-37625, 30-015-37626, 30-015-37627, 30-015-37628, 30-015-37875,  
30-015-37876, 30-015-37877, 30-015-37878, & 30-015-42321  
Pool: Willow Lake; Bone Spring, Southeast  
County: Eddy Co., New Mexico

Dear Mr. McMillian:

Please find attached the OCD Form C-103 Notice of Intent for a Central Tank Battery for the  
aforementioned wells.

The working interest, royalty interest and overriding royalty interest owners are identical; no  
notification is necessary.

Subsequently drilled wells that produce from the subject pools within the project areas approved by  
this order may be added to this commingling authority by submittal of a Sundry Notice to the  
Engineering Bureau in Santa Fe.

Should you have any questions or need further assistance, please do not hesitate to contact me at (405)  
552-7970.

Sincerely,

Erin Workman  
Regulatory Compliance Professional

Enclosures

District I  
1625 N. French Drive, Hobbs, NM 88240  
District II  
1301 W. Grand Ave, Artesia, NM 88210  
District III  
1000 Rio Brazos Road, Aztec, NM 87410  
District IV  
1220 S. St Francis Dr, Santa Fe, NM  
87505

State of New Mexico  
Energy, Minerals and Natural Resources Department

Form C-107-B  
Revised June 10, 2003

**OIL CONSERVATION DIVISION**

1220 S. St Francis Drive  
Santa Fe, New Mexico 87505

Submit the original  
application to the Santa Fe  
office with one copy to the  
appropriate District Office.

**APPLICATION FOR SURFACE COMMINGLING (DIVERSE OWNERSHIP)**

OPERATOR NAME: Devon Energy Production Co., LP

OPERATOR ADDRESS: 333 W Sheridan Avenue, Oklahoma City, OK 73102

APPLICATION TYPE:

☒ Pool Commingling ☒ Lease Commingling ☐ Pool and Lease Commingling ☐ Off-Lease Storage and Measurement (Only if not Surface Commingling)

LEASE TYPE: ☐ Fee ☐ State ☒ Federal

Is this an Amendment to existing Order? ☐ Yes ☒ No If "Yes", please include the appropriate Order No. \_\_\_\_\_  
Have the Bureau of Land Management (BLM) and State Land office (SLO) been notified in writing of the proposed commingling  
☒ Yes ☐ No

**(A) POOL COMMINGLING**

Please attach sheets with the following information

(1) Pool Names and Codes	Gravities / BTU of Non-Commingled Production	Calculated Gravities / BTU of Commingled Production		Calculated Value of Commingled Production	Volumes

- (2) Are any wells producing at top allowables? ☐ Yes ☐ No  
(3) Has all interest owners been notified by certified mail of the proposed commingling? ☐ Yes ☐ No.  
(4) Measurement type: ☐ Metering ☐ Other (Coriolis Test Method)  
(5) Will commingling decrease the value of production? ☐ Yes ☐ No If "yes", describe why commingling should be approved

**(B) LEASE COMMINGLING**

Please attach sheets with the following information

- (1) Pool Name and Code.  
(2) Is all production from same source of supply? ☒ Yes ☐ No  
(3) Has all interest owners been notified by certified mail of the proposed commingling? ☒ Yes ☐ No  
(4) Measurement type: ☒ Metering ☒ Other (Coriolis Test )

**(C) POOL and LEASE COMMINGLING**

Please attach sheets with the following information

- (1) Complete Sections A and E.

**(D) OFF-LEASE STORAGE and MEASUREMENT**

Please attached sheets with the following information

- (1) Is all production from same source of supply? ☐ Yes ☐ No  
(2) Include proof of notice to all interest owners.

**(E) ADDITIONAL INFORMATION (for all application types)**

Please attach sheets with the following information

- (1) A schematic diagram of facility, including legal location.  
(2) A plat with lease boundaries showing all well and facility locations. Include lease numbers if Federal or State lands are involved.  
(3) Lease Names, Lease and Well Numbers, and API Numbers.

I hereby certify that the information above is true and complete to the best of my knowledge and belief.

SIGNATURE: Erin Workman TITLE: Regulatory Compliance Prof. DATE: 11.30.16

TYPE OR PRINT NAME: Erin Workman TELEPHONE NUMBER: 405-552-7970  
E-MAIL ADDRESS: Erin.workman@dmn.com

# APPLICATION FOR A CENTRAL TANK BATTERY

## Proposal for Cooter & Cottontail wells:

Devon Energy Production Company, LP is requesting approval for a Central Tank Battery for the following wells:

### State Lease V-4902 & VB1065

Well Name	Location	API #	Pool 96217	BOPD	MCFPD	Water
Cooter 16 State Com 5H	SWSE, Sec. 16, T25S, R29E	30-015-37875	Willowlake, BS, SE	4	160	15
Cooter 16 State Com 6H	SWSE, Sec. 16, T25S, R29E	30-015-37876	Willowlake, BS, SE	2	140	5
Cooter 16 State Com 7H	SESE, Sec. 16, T25S, R29E	30-015-37877	Willowlake, BS, SE	2	160	10
Cooter 16 State Com 8H	SESE, Sec. 16, T25S, R29E	30-015-37878	Willowlake, BS, SE	3	100	30

### State Lease V-4902 & VB1065

Well Name	Location	API#	Pool 96217	BOPD	MCFPD	Water
Cottontail 16 State Com 1H	SWSE, Sec. 16, T25S, R29E	30-015-42321	Willowlake, BS, SE	210	1170	700

### State Lease V-4902

Well Name	Location	API#	Pool 96217	BOPD	MCFPD	Water
Cooter 16 State 1H	SESW Sec. 16, T25S, R29E	30-015-37625	Willow Lake; BS, SE	0	110	0
Cooter 16 State 2H	SWSW Sec. 16, T25S, R29E	30-015-37626	Willow Lake; BS, SE	3	170	5
Cooter 16 State 3H	NWNW Sec. 16, T25S, R29E	30-015-37627	Willow Lake; BS, SE	3	160	5
Cooter 16 State 4H	SESW Sec. 16, T25S, R29E	30-015-37628	Willow Lake; BS, SE	3	170	3

Communization Agreements have been filed and approved for the Cooter 16 State Com 5H, 6H, 7H, & 8H wells and the Cottontail 16 State Com Well

## Oil & Gas metering:

There is one central tank battery located at the Cooter 16 State 5H Battery Sec. 16, SESE, T25S, R29E in Eddie County, New Mexico. The other Central Tank Battery is located at the Cooter 16 State 1H Battery in Sec. 16, SESW, T25S, R29E in Eddy County, NM. The production from the Cooter 16 State 5H, 6H, 7H, & 8H will come into a common production header with isolation lines to route each wells production. From this point, one will be on test and its production routed through the test equipment with a Micro Motion Coriolis Meter to meter the oil, flow meter to meter the water, and gas allocation meter to meter the gas. The Cottontail 16 State Com 1H will flow through its own three phase metered separator with a Micro Motion Coriolis Meter to meter the oil, flow meter to meter the water, and gas allocation meter to meter the gas. VRU will be allocated back to each well utilizing a percentage of each wells monthly oil production. The production from the Cooter 16 State 1H, 2H, 3H, & 4H will come into a common production header with isolation lines to route each wells production. From this point, one will be on test and its production routed through the test equipment. Gas will be measured utilizing a gas allocation meter, flow meter to meter the water, and tank gauging to measure the oil.

The Cooter 16 State 5H Battery will have 4 oil tanks on location and a Common DCD CDP #727858-00 located at the Cooter 16 1H Battery that all 5 wells will utilize. Oil, gas, and water volumes from the four Cooter wells producing to this battery will be determined by using a test separator/heater treater at the proposed facility. The Cottontail 16 State Com 1H well producing to this battery will be determined by using individual metered separator. Oil will be sold through a common Smith LACT Meter #1514E10017.

The production from the Cooter 16 State Com 5H, 6H, 7H, & 8H wells will come into a common production header with isolation lines to route each wells production. From this point, one well will be on test and its production flows through a two phase test separator. After separation, the gas will flow through the gas test meter #885-49-133, combines the gas from the VRU meter, Cottontail gas meter, and flows into the gas allocation meter #885-33-130, combines with the gas production from the wells at the Cooter 16 State 1H Battery, into the gas check meter #885-12-128 on location at the Cooter 16 State 1H Battery, and then to the DCP CDP #727858-00. The oil and water will flow into the Heater/treater. After separation, the water is then measured utilizing the turbine meter, combines with the water from the FWKO and the production heater/treater, and flows to one of the 500 bbl. produced water tanks. The oil is measured by the Micro Motion Coriolis Meter S\N14492980, then it will combine with the oil from the production heater, and flows to one of the 500 bbl. oil tanks.

The Cottontail 16 State Com 1H flows into its own three phase metering separator, where after separation gas is routed to the gas test meter #885-49-264, then combines with the gas from the VRU meter, Cooter Production Separator, and the Cooter Test Meter, is measured by the allocation meter #885-33-130, flows into the gas check meter and then to the DCP CDP #727858-00 at the Cooter 16 State 1H Battery. The oil is then metered with a Micro Motion Coriolis Meter S\N14492119, commingles with the oil from the FWKO, and the production separator, and flows into the production heater/treater, then into a common production line with the oil from the test side, which then flows to one of the 500 bbl. oil tanks. The water is metered using a turbine meter, flows to the FWKO, and then to one of the 500 bbl. water tanks, along with the water from the other wells.

The production from the Cooter 16 State 1H, 2H, 3H, & 4H wells come into a common production header with isolation lines to route each wells production. From this point, one well is on test and its production flows through a two phase test separator. After separation, the gas will flow through the gas test meter #885-33-130, combines the gas from the production separator and production from the Cooter 16 State 5H Battery, then flows into the gas allocation meter #885-12-128, and then into the DCP CDP #727858-00 on location. The oil and water will flow into the Heater/treater. After separation, the water is then measured utilizing the flow meter, it then combines with the water from the FWKO and the production heater/treater, and flows to one of the 500 bbl. produced water tanks. The oil flows into its designated 500 bbl. oil tank and is measured utilizing the tank gauging method.

The Cooter 16 State Com 5H, 6H, 7H, & 8H Wells will be based on the most recent well test utilizing the Micro Motion Coriolis Test. The Cottontail 16 State Com 5H oil production will be allocated on a daily basis based on the Micro Motion Coriolis Meter. The oil production from all of the Cooter 16 State 1H, 2H, 3H, & 4H oil production will be allocated on the most recent well test utilizing the tank gauge method. The gas production from all wells will be allocated based on the gas allocation meters. The gas from the VRU and from the gas allocation meters located at the Cooter 16 State Com 5H Battery will commingle, flow into the gas allocation meter #885-12-128, and then to the DCP CDP #727858-00. These meters will be calibrated on a regular basis per API, NMOCD specifications. The OCD will be notified of any future changes in the facilities.

#### **Process and Flow Descriptions:**

The flow of produced fluids is shown in detail on the enclosed Process Flow Diagram, along with a description of each vessel and map which shows the lease boundaries, location of wells, facility, and gas sales meter. Waste is not induced and no correlative rights are impaired. The proposed commingling will maximize the ultimate recovery of oil and/or gas from the state leases and will reduce environmental impacts by minimizing surface disturbance and emissions. The proposed commingling will reduce operating expenses, as well as, not adversely affect royalty income, production accountability, or the distribution of royalty.

Devon Energy Production Company, LP understands the requested approval will not constitute the granting of any right-of-way or construction rights not granted by the lease instrument.

Working, royalty, and overriding interest owners have been notified of this proposal via certified mail (see attached).

Signed:   
Printed Name: Erin workman  
Title: Regulatory Compliance Professional  
Date: 11.30.16



25S 29E

COOTER 16 STATE 2H

COOTER 16 STATE 3H

COOTER 16 STATE 1H

COOTER 16 STATE 4H

COOTER 16 STATE COM5H

COTTONTAIL 16 STATE COM 1H

COOTER 16 STATE COM5H

COOTER 16 STATE COM7H

COOTER 16 STATE COM8H

# COOTER/COTTONTAIL FED WELLS

Eddy Co, New Mexico



This map is for illustrative purposes only and is neither a legally recorded map nor a survey and is not intended to be used as one. Devon makes no warranty, representation, or guarantee of any kind regarding this map.

GCS North American 1927  
Datum: North American 1927; Units: Degree  
Created by: duncam2  
Map is current as of 9/14/2016



Feet  
0 215 430 860  
1 in. = 875 feet

- Surface Hole
- Tank Battery
- Central Delivery Point
- Flow Line
- Comm Agreement
- Project Area

## Drillable Leasehold

- ST OF NM V0- 4902
- ST OF NM VB 1065

DISTRICT I  
1625 N. French Dr., Hobbs, NM 88240

DISTRICT II  
1801 W. Grand Avenue, Artesia, NM 88210

DISTRICT III  
1000 Rio Bruece Rd., Aztec, NM 87410

DISTRICT IV  
1222 S. St. Francis Dr., Santa Fe, NM 87505

State of New Mexico  
Energy, Minerals and Natural Resources Department

Form C-102  
Revised October 15, 2009

Submit one copy to appropriate  
District Office

**OIL CONSERVATION DIVISION**  
1220 South St. Francis Dr.  
Santa Fe, New Mexico 87505

☐ AMENDED REPORT

**WELL LOCATION AND ACREAGE DEDICATION PLAT**

API Number <b>30-015-37625</b>	Pool Code <b>96217</b>	Pool Name <b>Willow Lake; Bone Spring, Southeast</b>
Property Code <b>38045</b>	Property Name <b>COOTER "16" STATE</b>	Well Number <b>1H</b>
OCRID No. <b>6137</b>	Operator Name <b>DEVON ENERGY PRODUCTION COMPANY, L.P.</b>	Elevation <b>3000'</b>

**Surface Location**

UL or lot No.	Section	Township	Range	Lot Idn	Feet from the	North/South line	Feet from the	East/West line	County
<b>N</b>	<b>16</b>	<b>25 S</b>	<b>29 E</b>		<b>330</b>	<b>SOUTH</b>	<b>1580</b>	<b>WEST</b>	<b>EDDY</b>

**Bottom Hole Location If Different From Surface**

UL or lot No.	Section	Township	Range	Lot Idn	Feet from the	North/South line	Feet from the	East/West line	County
<b>C</b>	<b>16</b>	<b>25 S</b>	<b>29 E</b>		<b>330</b>	<b>NORTH</b>	<b>1650</b>	<b>WEST</b>	<b>EDDY</b>
Dedicated Acres <b>160</b>	Joint or Infill	Consolidation Code	Order No.						

**NO ALLOWABLE WILL BE ASSIGNED TO THIS COMPLETION UNTIL ALL INTERESTS HAVE BEEN CONSOLIDATED  
OR A NON-STANDARD UNIT HAS BEEN APPROVED BY THE DIVISION**

<p>N: 413853.5730 E: 645110.5070 LAT: N032°08'14.35" LONG: W103°50'53.05"</p> <p>1650'</p> <p>330'</p> <p>4651.8'</p> <p>1580'</p> <p>330'</p> <p>N: 408543.4960 E: 645141.5510 LAT: N032°07'21.80" LONG: W103°50'52.88"</p>	<p><b>PROPOSED BOTTOM HOLE LOCATION</b> Lat - N 32°08'11.10" Long - W 103°50'33.85" NMSPCE- N 413530.575 E 646762.068 (NAD-83)</p> <p><b>SURFACE LOCATION</b> Lat - N 32°07'25.08" Long - W 103°50'34.52" NMSPCE- N 408679.982 E 646719.119 (NAD-83)</p>	<p>N: 413875.8720 E: 650420.8100 LAT: N032°08'14.47" LONG: W103°50'51.29"</p> <p>N: 411222.1980 E: 650437.5420 LAT: N032°07'48.14" LONG: W103°50'51.10"</p> <p>N: 408560.8730 E: 650434.7070 LAT: N032°07'21.80" LONG: W103°50'51.33"</p>	<p><b>OPERATOR CERTIFICATION</b></p> <p>I hereby certify that the information contained herein is true and complete to the best of my knowledge and belief, and that this organization either owns a working interest or unleased mineral interest in the land including the proposed bottom hole location or has a right to drill this well at this location pursuant to a contract with an owner of such a mineral or working interest, or to a voluntary pooling agreement or a compulsory pooling order heretofore entered by the division.</p> <p>11/28/2016</p> <p>Signature _____ Date _____</p> <p>Erin Workman, Regulatory Comp. Prof.</p> <p>Printed Name _____</p> <p><b>SURVEYOR CERTIFICATION</b></p> <p>I hereby certify that the well location shown on this plat was plotted from field notes of actual surveys made by me or under my supervision, and that the same is true and correct to the best of my belief.</p> <p>Date Surveyed _____</p> <p>Signature _____</p> <p>Professional Surveyor 7977</p> <p>Certificate No. Gary L. Jones 7977</p> <p><b>BASIN SURVEYS</b></p>
--	--	---	---



DISTRICT I  
1625 N. French Dr., Hobbs, NM 88240

DISTRICT II  
1301 W. Grand Avenue, Artesia, NM 88210

DISTRICT III  
1000 Rio Brazos Rd., Aztec, NM 87410

DISTRICT IV  
1220 S. St. Francis Dr., Santa Fe, NM 87505

State of New Mexico  
Energy, Minerals and Natural Resources Department

Form C-102  
Revised October 15, 2009

Submit one copy to appropriate  
District Office

OIL CONSERVATION DIVISION  
1220 South St. Francis Dr.  
Santa Fe, New Mexico 87505

WELL LOCATION AND ACREAGE DEDICATION PLAT

☐ AMENDED REPORT

API Number 30-015-37626	Pool Code 96217	Pool Name Willow Lake, Bone Spring, Sotheast
Property Code 38064	Property Name COOTER "16" STATE	Well Number 2H
GRID No. 6137	Operator Name DEVON ENERGY PRODUCTION COMPANY, L.P.	Elevation 2999'

Surface Location

UL or lot No.	Section	Township	Range	Lot Idn	Feet from the	North/South line	Feet from the	East/West line	County
M	16	25 S	29 E		480	SOUTH	330	WEST	EDDY

Bottom Hole Location If Different From Surface

UL or lot No.	Section	Township	Range	Lot Idn	Feet from the	North/South line	Feet from the	East/West line	County
D	16	25 S	29 E		330	NORTH	420	WEST	EDDY

Dedicated Acres 160	Joint or Infill	Consolidation Code	Order No.
------------------------	-----------------	--------------------	-----------

NO ALLOWABLE WILL BE ASSIGNED TO THIS COMPLETION UNTIL ALL INTERESTS HAVE BEEN CONSOLIDATED  
OR A NON-STANDARD UNIT HAS BEEN APPROVED BY THE DIVISION

<p><b>PROPOSED BOTTOM HOLE LOCATION</b> Lat - N 32°08'11.09" Long - W 103°59'48.20" NMSPC- N 413525.412 E 645528.485 (NAD-83)</p> <p><b>SURFACE LOCATION</b> Lat - N 32°07'26.55" Long - W 103°59'49.06" NMSPC- N 409024.853 E 645468.561 (NAD-83)</p> <p>Project Area Production Area</p>	<p><b>OPERATOR CERTIFICATION</b></p> <p>I hereby certify that the information contained herein is true and complete to the best of my knowledge and belief, and that this organization either owns a working interest or unleased mineral interest in the land including the proposed bottom hole location or has a right to drill this well at this location pursuant to a contract with an owner of such a mineral or working interest, or to a voluntary pooling agreement or a compulsory pooling order heretofore entered by the division.</p> <p><i>Erin Workman</i> 11/30/16 Signature Date</p> <p>Erin Workman, Regulatory Analyst Printed Name</p> <p><b>SURVEYOR CERTIFICATION</b></p> <p>I hereby certify that the well location shown on this plat was plotted from field notes of actual surveys made by me or under my supervision, and that the same is true and correct to the best of my belief.</p> <p><i>GARY L. JONES</i> Date Surveyed Signature &amp; Seal of Professional Surveyor</p> <p>Certificate No. Gary L. Jones 7977</p> <p><b>BASIN SURVEYS</b></p>
--	---



DISTRICT I  
1825 N. French Dr., Hobbs, NM 88240  
DISTRICT II  
1301 W. Grand Avenue, Artesia, NM 88210  
DISTRICT III  
1000 Rio Grande Rd., Aztec, NM 87410  
DISTRICT IV  
1820 S. St. Francis Dr., Santa Fe, NM 87505

State of New Mexico  
Energy, Minerals and Natural Resources Department

RECEIVED

AUG 28 2013

Form C-102  
Revised October 15, 2009

Submit one copy to appropriate  
District Office

OIL CONSERVATION DIVISION  
1220 South St. Francis Dr.  
Santa Fe, New Mexico 87505

WELL LOCATION AND ACREAGE DEDICATION PLAT

☐ AMENDED REPORT

API Number 30-015-37628	Pool Code 96217	Pool Name Willow Lake; Bone Spring, Southeast
Property Code 38U45	Property Name COOTER "16" STATE	Well Number 4H
GRID No. 6137	Operator Name DEVON ENERGY PRODUCTION COMPANY, L.P.	Elevation 2966'

Surface Location

UL or lot No.	Section	Township	Range	Lot Idn	Feet from the	North/South line	Feet from the	East/West line	County
N	16	25 S	29 E		330	SOUTH	2310	WEST	EDDY

Bottom Hole Location If Different From Surface

UL or lot No.	Section	Township	Range	Lot Idn	Feet from the	North/South line	Feet from the	East/West line	County
C	16	25 S	29 E		330	NORTH	2220	WEST	EDDY

Dedicated Acres 160	Joint or Infill	Consolidation Code	Order No.
------------------------	-----------------	--------------------	-----------

NO ALLOWABLE WILL BE ASSIGNED TO THIS COMPLETION UNTIL ALL INTERESTS HAVE BEEN CONSOLIDATED  
OR A NON-STANDARD UNIT HAS BEEN APPROVED BY THE DIVISION

<p>N 413853.5130 E 656110.5070 LAT: N03°07'14.33" LONG: W103°59'33.03"</p> <p>2220'</p> <p>330'</p>	<p><b>PROPOSED BOTTOM HOLE LOCATION</b> Lat - N 32°08'11.10" Long - W 103°59'27.22" NMSPCE - N 413532.968 E 647331.941 (NAD-83)</p>	<p>N 413853.5130 E 656110.5070 LAT: N03°07'14.33" LONG: W103°59'33.03"</p>
<p>N 413853.5130 E 656110.5070 LAT: N03°07'14.33" LONG: W103°59'33.03"</p>	<p><b>SURFACE LOCATION</b> Lat - N 32°07'25.08" Long - W 103°59'26.01" NMSPCE - N 408883.067 E 647450.910 (NAD-83)</p>	<p>N 413853.5130 E 656110.5070 LAT: N03°07'14.33" LONG: W103°59'33.03"</p>

**OPERATOR CERTIFICATION**

I hereby certify that the information contained herein is true and complete to the best of my knowledge and belief, and that this organization either owns a working interest or unleased mineral interest in the land including the proposed bottom hole location or has a right to drill this well at this location pursuant to a contract with an owner of such a mineral or working interest, or to a voluntary pooling agreement or a compulsory pooling order heretofore entered by the division.

*Erin L. Workman* 08/27/13  
Signature Date

Erin L. Workman  
Printed Name

**SURVEYOR CERTIFICATION**

I hereby certify that the well location shown on this plat was plotted from field notes of actual surveys made by me or under my supervision, and that the same is true and correct to the best of my belief.

JAN 10 2014  
Date Surveyed  
Signature of Professional Surveyor  
Professional Surveyor  
Certificate No. Gary L. Jones 7977

BASIN SURVEYS

DISTRICT I  
1625 N. French Dr., Hobbs, NM 88240

DISTRICT II  
1301 W. Grand Avenue, Artesia, NM 88210

DISTRICT III  
1000 Rio Brazos Rd., Astec, NM 87410

DISTRICT IV  
1220 S. St. Francis Dr., Santa Fe, NM 87505

State of New Mexico  
Energy, Minerals and Natural Resources Department

Form C-102  
Revised October 15, 2009

Submit one copy to appropriate  
District Office

OIL CONSERVATION DIVISION  
1220 South St. Francis Dr.  
Santa Fe, New Mexico 87505

WELL LOCATION AND ACREAGE DEDICATION PLAT

☐ AMENDED REPORT

API Number 30-015-37627	Pool Code 96217	Pool Name Willow Lake; Bone Spring, Southeast
Property Code 38045	Property Name COOTER "16" STATE	Well Number 3H
OGRID No. 6137	Operator Name DEVON ENERGY PRODUCTION COMPANY, L.P.	Elevation 3007'

Surface Location

UL or lot No.	Section	Township	Range	Lot Idn	Feet from the	North/South line	Feet from the	East/West line	County
D	16	25 S	29 E		330	NORTH	1190	WEST	EDDY

Bottom Hole Location If Different From Surface

UL or lot No.	Section	Township	Range	Lot Idn	Feet from the	North/South line	Feet from the	East/West line	County
M	16	25 S	29 E		330	SOUTH	990	WEST	EDDY

Dedicated Acres	Joint or Infill	Consolidation Code	Order No.
160			

NO ALLOWABLE WILL BE ASSIGNED TO THIS COMPLETION UNTIL ALL INTERESTS HAVE BEEN CONSOLIDATED  
OR A NON-STANDARD UNIT HAS BEEN APPROVED BY THE DIVISION

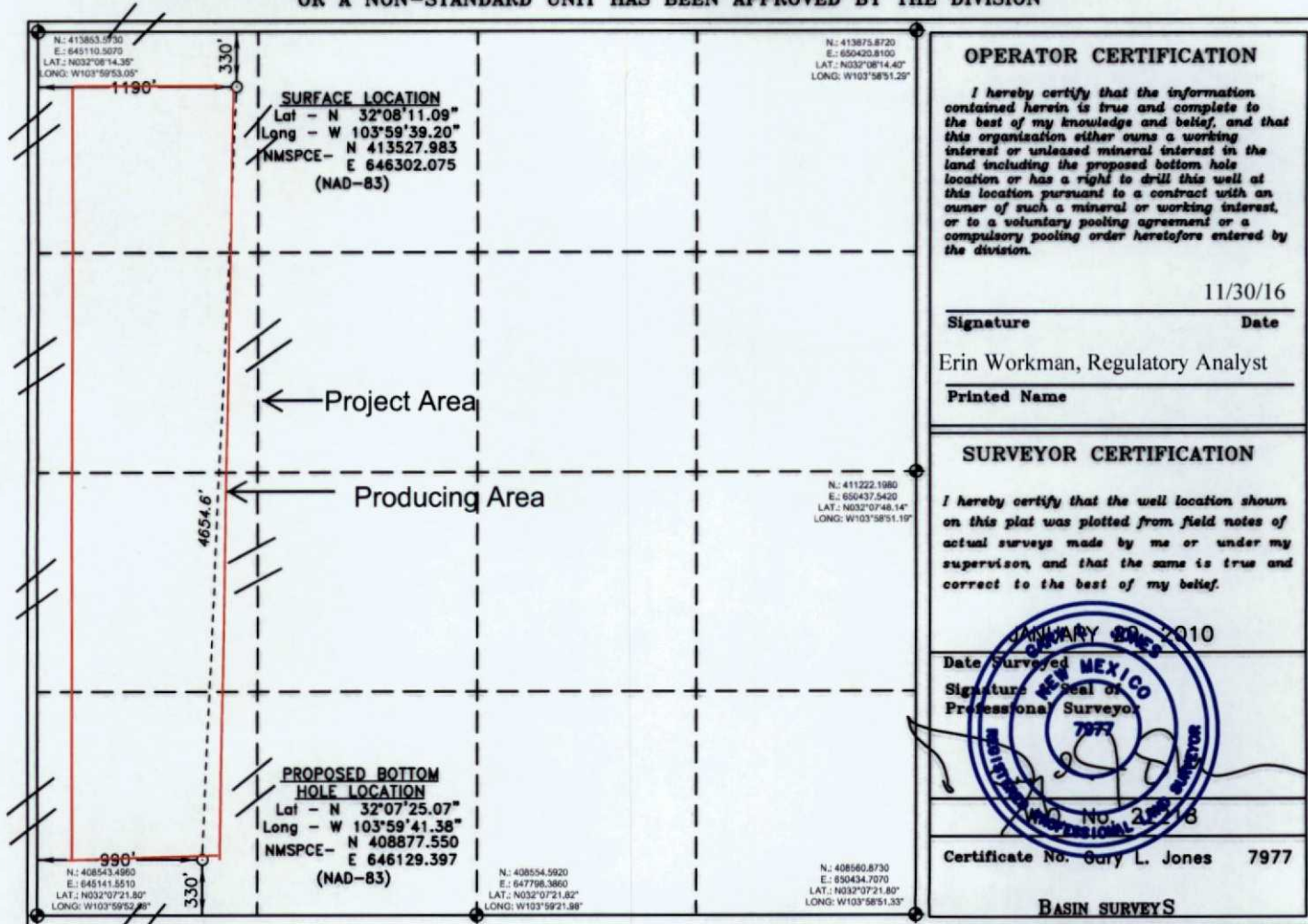



DISTRICT I  
1625 N. French Dr., Hobbs, NM 88240  
DISTRICT II  
1301 W. Grand Avenue, Artesia, NM 88210  
DISTRICT III  
1000 Rio Brazos Rd., Aztec, NM 87410  
DISTRICT IV  
1220 S. St. Francis Dr., Santa Fe, NM 87505

State of New Mexico  
Energy, Minerals and Natural Resources Department

Form C-102  
Revised October 15, 2009

Submit one copy to appropriate  
District Office

OIL CONSERVATION DIVISION  
1220 South St. Francis Dr.  
Santa Fe, New Mexico 87505

WELL LOCATION AND ACREAGE DEDICATION PLAT

☐ AMENDED REPORT

API Number 30-015-37875	Pool Code 96217	Pool Name Willow Lake, Bone Spring, Southeast
Property Code 38045	Property Name Cooter 16 State Com	Well Number 5H
OGRID No. 6137	Operator Name DEVON ENERGY PRODUCTION COMPANY, L.P.	Elevation 2998'

Surface Location

UL or lot No. O	Section 16	Township 25 S	Range 29 E	Lot Idn	Feet from the 330	North/South line SOUTH	Feet from the 2310	East/West line EAST	County EDDY
--------------------	---------------	------------------	---------------	---------	----------------------	---------------------------	-----------------------	------------------------	----------------

Bottom Hole Location If Different From Surface

UL or lot No. B	Section 16	Township 25 S	Range 29 E	Lot Idn	Feet from the 330	North/South line NORTH	Feet from the 2250	East/West line EAST	County EDDY
--------------------	---------------	------------------	---------------	---------	----------------------	---------------------------	-----------------------	------------------------	----------------

Dedicated Acres 320	Joint or Infill	Consolidation Code	Order No.
------------------------	-----------------	--------------------	-----------

NO ALLOWABLE WILL BE ASSIGNED TO THIS COMPLETION UNTIL ALL INTERESTS HAVE BEEN CONSOLIDATED  
OR A NON-STANDARD UNIT HAS BEEN APPROVED BY THE DIVISION

N: 413853.5730 E: 645110.5070 LAT: N032°08'14.35" LONG: W103°59'53.05"	<b>PROPOSED BOTTOM HOLE LOCATION</b> Lat - N 32°08'11.17" Long - W 103°59'17.52" NMSPCE- N 413541.851 E 648165.983 (NAD-83)	N: 413875.8720 E: 650420.8100 LAT: N032°08'14.40" LONG: W103°58'51.29"	<b>OPERATOR CERTIFICATION</b>  I hereby certify that the information contained herein is true and complete to the best of my knowledge and belief, and that this organization either owns a working interest or unleased mineral interest in the land including the proposed bottom hole location or has a right to drill this well at this location pursuant to a contract with an owner of such a mineral or working interest, or to a voluntary pooling agreement or a compulsory pooling order heretofore entered by the division.  02.27.15  Signature _____ Date _____ Erin Workman, Regulatory Comp Prof. Printed Name _____
N: 408543.4960 E: 645141.5510 LAT: N032°07'21.80" LONG: W103°59'52.88"	<b>SURFACE LOCATION</b> Lat - N 32°07'25.08" Long - W 103°59'18.17" NMSPCE- N 408885.048 E 648125.158 (NAD-83)	N: 411222.1980 E: 650437.5420 LAT: N032°07'48.14" LONG: W103°58'51.19"	<b>SURVEYOR CERTIFICATION</b>  I hereby certify that the well location shown on this plat was plotted from field notes of actual surveys made by me or under my supervision, and that the same is true and correct to the best of my belief.  JAMES L. JONES 2010 Date Surveyed _____ Signature & Seal of Professional Surveyor _____ Certificate No. Gary L. Jones 7977  BASIN SURVEYS

DISTRICT I  
1825 N. French Dr., Hobbs, NM 88240  
DISTRICT II  
1801 W. Grand Avenue, Artesia, NM 88210  
DISTRICT III  
1000 Rio Grande Blvd., Aztec, NM 87410  
DISTRICT IV  
1820 S. St. Francis Dr., Santa Fe, NM 87505

State of New Mexico  
Energy, Minerals and Natural Resources Department

Form C-102  
Revised October 15, 2009

Submit one copy to appropriate  
District Office

OIL CONSERVATION DIVISION  
1220 South St. Francis Dr.  
Santa Fe, New Mexico 87505

WELL LOCATION AND ACREAGE DEDICATION PLAT

☐ AMENDED REPORT

API Number 30-015-37876	Pool Code 96217	Pool Name Willowlake; Bone Spring, Southeast
Property Code 38045	Cooter 16 State Com	Well Number 6H
OGRID No. 6137	Operator Name DEVON ENERGY PRODUCTION COMPANY, L.P.	Elevation 2974'

Surface Location

UL or lot No.	Section	Township	Range	Lot Idn	Feet from the	North/South line	Feet from the	East/West line	County
0	16	25 S	29 E		330	SOUTH	1650	EAST	EDDY

Bottom Hole Location If Different From Surface

UL or lot No.	Section	Township	Range	Lot Idn	Feet from the	North/South line	Feet from the	East/West line	County
B	16	25 S	29 E		356	NORTH	1659	EAST	EDDY

Dedicated Acres 320	Joint or Infill	Consolidation Code	Order No.
------------------------	-----------------	--------------------	-----------

NO ALLOWABLE WILL BE ASSIGNED TO THIS COMPLETION UNTIL ALL INTERESTS HAVE BEEN CONSOLIDATED  
OR A NON-STANDARD UNIT HAS BEEN APPROVED BY THE DIVISION

<p>N: 413863.570 E: 645110.3070 LAT: N032°08'14.33" LONG: W103°58'51.00"</p> <p><b>PROPOSED BOTTOM HOLE LOCATION</b> Lat - N 32°08'11.12" Long - W 103°59'10.48" NMSPC- N 413539.944 E 648771.885 (NAD-83)</p>	<p>N: 413875.8720 E: 645040.8400 LAT: N032°08'14.40" LONG: W103°58'51.25"</p> <p><b>OPERATOR CERTIFICATION</b> I hereby certify that the information contained herein is true and complete to the best of my knowledge and belief, and that this organization either owns a working interest or unleased mineral interest in the land including the proposed bottom hole location or has a right to drill this well at this location pursuant to a contract with an owner of such a mineral or working interest, or to a voluntary pooling agreement or a compulsory pooling order heretofore entered by the Division.</p> <p><i>[Signature]</i> 02.27.15 Signature Date Erin Workman, Regulatory Comp. Prof. Printed Name</p>
<p>N: 408543.4860 E: 645141.3510 LAT: N032°07'21.80" LONG: W103°59'51.80"</p> <p><b>SURFACE LOCATION</b> Lat - N 32°07'25.08" Long - W 103°59'10.49" NMSPC- N 408888.926 E 648785.413 (NAD-83)</p>	<p>N: 411233.1860 E: 645037.5420 LAT: N032°07'48.14" LONG: W103°58'51.15"</p> <p><b>SURVEYOR CERTIFICATION</b> I hereby certify that the well location shown on this plat was plotted from field notes of actual surveys made by me or under my supervision, and that the same is true and correct to the best of my belief.</p> <p><i>[Signature]</i> 2010 Date Surveyed Signature of Professional Surveyor Certificate No. Gary L. Jones 7977 BASIN SURVEYS</p>

NM OIL CONSERVATION  
ARTESIA DISTRICT

FEB 27 2015

RECEIVED



DISTRICT I  
1825 N. French Dr., Hobbs, NM 88240

DISTRICT II  
1301 W. Grand Avenue, Artesia, NM 88210

DISTRICT III  
1000 Rio Braxos Rd., Aztec, NM 87410

DISTRICT IV  
1220 S. St. Francis Dr., Santa Fe, NM 87505

State of New Mexico  
Energy, Minerals and Natural Resources Department

Form C-102  
Revised October 15, 2009

Submit one copy to appropriate  
District Office

OIL CONSERVATION DIVISION  
1220 South St. Francis Dr.  
Santa Fe, New Mexico 87505

WELL LOCATION AND ACREAGE DEDICATION PLAT

☐ AMENDED REPORT

API Number 30-015-37877	Pool Code 96217	Pool Name WILLOW LAKE; BONE SPRING SOUTHEAST
Property Code 38045	Proprietary Name Cooter 16 State Com	Well Number 7H
UGRD No. 6137	Operator Name DEVON ENERGY PRODUCTION COMPANY, L.P.	Elevation 3020'

Surface Location

UL or lot No.	Section	Township	Range	Lot Idm	Feet from the	North/South line	Feet from the	East/West line	County
P	16	25 S	29 E		330	SOUTH	770	EAST	EDDY

Bottom Hole Location If Different From Surface

UL or lot No.	Section	Township	Range	Lot Idm	Feet from the	North/South line	Feet from the	East/West line	County
A	16	25 S	29 E		330	NORTH	1025	EAST	EDDY
Dedicated Acres 320	Joint or Infill	Consolidation Code	Order No.						

NO ALLOWABLE WILL BE ASSIGNED TO THIS COMPLETION UNTIL ALL INTERESTS HAVE BEEN CONSOLIDATED  
OR A NON-STANDARD UNIT HAS BEEN APPROVED BY THE DIVISION

**PROPOSED BOTTOM HOLE LOCATION**  
Lat - N 32°08'11.12"  
Long - W 103°59'02.80"  
NAD83 - N 413541.718  
E 649431.680  
(NAD-83)

**SURFACE LOCATION**  
Lat - N 32°07'25.06"  
Long - W 103°59'00.26"  
NAD83 - N 408887.894  
E 649665.761  
(NAD-83)

Project Area  
Production Area

PP: 261 FSL & 793 FEL

**OPERATOR CERTIFICATION**

I hereby certify that the information contained herein is true and complete to the best of my knowledge and belief, and that this organization either owns a working interest or unleased mineral interest in the land including the proposed bottom hole location or has a right to drill this well at this location pursuant to a contract with an owner of such a mineral or working interest, or to a voluntary pooling agreement or a compulsory pooling order heretofore entered by the Division.

Signature: *[Signature]* Date: 10/22/15  
Erin Workman, Reg. Analyst

**SURVEYOR CERTIFICATION**

I hereby certify that the well location shown on this plat was plotted from field notes of actual surveys made by me or under my supervision, and that the same is true and correct to the best of my belief.

Date Surveyed: 10/10/10  
Signature: *[Signature]*  
Professional Surveyor

Certificate No. Gory L. Jones 7977

**BASIN SURVEYS**

NM OIL CONSERVATION  
ARTESIA DISTRICT

FEB 27 2015

RECEIVED

District I  
1625 N. French Dr., Hobbs, NM 88240  
Phone: (575) 393-6161 Fax: (575) 393-0720  
District II  
311 S. First St., Artesia, NM 88210  
Phone: (575) 748-1283 Fax: (575) 748-9720  
District III  
1000 Rio Hondo Road, Aztec, NM 87414  
Phone: (505) 334-6178 Fax: (505) 334-6110  
District IV  
1220 S. St. Francis Dr., Santa Fe, NM 87505  
Phone: (505) 476-3460 Fax: (505) 476-3462

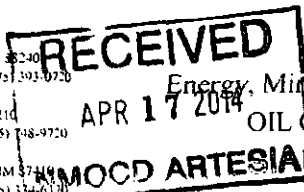

State of New Mexico  
Energy, Minerals & Natural Resources Department  
OIL CONSERVATION DIVISION  
1220 South St. Francis Dr.  
Santa Fe, NM 87505

Form C-102  
Revised August 1, 2011  
Submit one copy to appropriate  
District Office

☐ AMENDED REPORT

### WELL LOCATION AND ACREAGE DEDICATION PLAT

<sup>1</sup> API Number <b>30-015-42321</b>	<sup>2</sup> Pool Code 96217	<sup>3</sup> Pool Name Willowlake; Bone Spring SE
<sup>4</sup> Property Code <b>40505</b>	<sup>5</sup> Property Name <b>COTTONTAIL 16 STATE COM</b>	<sup>6</sup> Well Number <b>1H</b>
<sup>7</sup> OGRID No. <b>6137</b>	<sup>8</sup> Operator Name <b>DEVON ENERGY PRODUCTION COMPANY, L.P.</b>	<sup>9</sup> Elevation <b>2968.6</b>

#### <sup>10</sup> Surface Location

UL or lot no.	Section	Township	Range	Lot Ida	Feet from the	North/South line	Feet from the	East/West line	County
<b>O</b>	<b>16</b>	<b>25 S</b>	<b>29 E</b>		<b>150</b>	<b>SOUTH</b>	<b>1950</b>	<b>EAST</b>	<b>EDDY</b>

#### <sup>11</sup> Bottom Hole Location If Different From Surface

UL or lot no.	Section	Township	Range	Lot Idn	Feet from the	North/South line	Feet from the	East/West line	County
<b>B</b>	<b>16</b>	<b>25 S</b>	<b>29 E</b>		<b>330</b>	<b>NORTH</b>	<b>1980</b>	<b>EAST</b>	<b>EDDY</b>

<sup>12</sup> Dedicated Acres	<sup>13</sup> Joint or Infill	<sup>14</sup> Consolidation Code	<sup>15</sup> Order No.
<b>160</b>			

No allowable will be assigned to this completion until all interests have been consolidated or a non-standard unit has been approved by the division.

**NOTE:**  
LATITUDE AND LONGITUDE COORDINATES ARE SHOWN USING THE NORTH AMERICAN DATUM OF 1983 (NAD83). LISTED NEW MEXICO STATE PLANE EAST COORDINATES ARE GRID (NAD83) BASIS OF BEARING AND DISTANCES USED ARE NEW MEXICO STATE PLANE EAST COORDINATES MODIFIED TO THE SURFACE.

**PROJECT AREA**  
**PRODUCTION AREA**

**COTTONTAIL 16 STATE COM #1H**  
ELEV. = 2968.6'  
LAT. = 32.123444°N (NAD83)  
LONG. = 103.987162°W  
NMSP EAST (FT)  
N = 408708.1  
E = 648504.9

**BOTTOM OF HOLE**  
LAT. = 32.1364215°N  
LONG. = 103.9873041°W  
NMSP EAST (FT)  
N = 41357.89  
E = 648413.59

#### <sup>17</sup> OPERATOR CERTIFICATION

I hereby certify that the information contained herein is true and complete to the best of my knowledge and belief, and that this organization either owns a working interest or unleased mineral interest in the land including the proposed bottom hole location or has a right to drill this well at this location pursuant to a contract with an owner of such a mineral or working interest, or to a voluntary pooling agreement or a compulsory pooling order heretofore entered by the Division.

Signature: *Trina C. Couch* Date: *4/16/14*  
Trina C. Couch, Regulatory Analyst  
Printed Name: \_\_\_\_\_  
E-mail Address: *trina.couch@dmn.com*

#### <sup>18</sup> SURVEYOR CERTIFICATION

I hereby certify that the well location shown on this plat was plotted from field notes of actual surveys made by me or under my supervision, and that the same is true and correct to the best of my belief.

JUNE 1, 2013  
Date of Survey: \_\_\_\_\_  
Signature and Seal of Professional Surveyor: *[Signature]*  
Certificate Number: *112797*  
FILMON F. JARVIS, PLS 12797  
REGISTERED LAND SURVEYOR NO. 1862



Devon Energy Production Company  
333 W. Sheridan Avenue  
Oklahoma City, Oklahoma 73102  
Phone: (405)-552-7970  
Erin.Workman@devn.com

November 30, 2016

**CERTIFIED MAIL**  
**RETURN RECEIPT REQUESTED**

Interest Owners

Re: Central Tank Battery  
Cooter 16 State 1H, 2H, 3H, 4H, Cooter State Com 5H, 6H 7H, 8H, &  
Cottontail 16 State Com 1H  
Sec., T, R: Sec 16, T25S, R29E  
Lease: V-4902 & VB1065  
API: 30-015-37625, 30-015-37626, 30-015-37627, 30-015-37628, 30-015-37875,  
30-015-37876, 30-015-37877, 30-015-37878, & 30-015-42321  
Pool: Willow Lake; Bone Spring, Southeast  
County: Eddy Co., New Mexico

Gentlemen:

This is to advise you that Devon Energy Production Company, LP, is filing an application with the New Mexico Oil Conservation Division ("NMOCD") seeking approval for a Central Tank Battery for the above mentioned wells.

A copy of our application submitted to the Division is attached.

Any objections or requests that a hearing should be held regarding this application must be submitted to the New Mexico Oil Conservation Division Santa Fe office within 20 days from the date of this letter.

Subsequently drilled wells that produce from the subject pools within the project areas approved by this order may be added to this commingling authority by submittal of a Sundry Notice to the Engineering Bureau in Santa Fe.

Please contact the undersigned at (405) 552-7970 should you have any questions or need anything further.

Sincerely,

Devon Energy Production Company, L.P.

Erin Workman  
Regulatory Compliance Professional

Enclosure

# Cooter 16 State 5H - OLM

Name	Street	City	State	Postal Code	Tracking Number
KINGDOM INVESTMENTS LIMITED	2101 CEDAR SPRINGS RD STE 600	DALLAS	Texas	75201	9214 8901 5271 8100 1129 07
PENWELL EMPLOYEE ROYALTY POOL	310 W WALL STE 1001	MIDLAND	Texas	79701	9214 8901 5271 8100 1129 14
RAVE ENERGY INC	PO BOX 3087	HOUSTON	Texas	77253-3087	9214 8901 5271 8100 1129 21
TAURUS ROYALTY LLC % ROBERT B PAYNE JR	PO BOX 1477	LITTLE ELM	Texas	75068-1477	9214 8901 5271 8100 1129 38
VENDETTA ROYALTY PARTNERS LTD VENDETTA ROYALTY MGMT LLC GEN PART					
RECEIVER THOMAS L TAYLOR III	PO BOX 141638	AUSTIN	Texas	78714-1638	9214 8901 5271 8100 1129 45
GORDA SOUND ROYALTIES LP	PO BOX 671099	DALLAS	Texas	75367	9214 8901 5271 8100 1129 52
GEORGE G VAUGHT JR	PO BOX 13557	DENVER	Colorado	80201-3557	9214 8901 5271 8100 1129 69
JOHN LAWRENCE THOMA A SINGLE MAN	PO BOX 17656	GOLDEN	Colorado	80402	9214 8901 5271 8100 1129 76
SANDRA MARY THOMA A SINGLE WOMAN	8530 MILL RUN RD	ATHENS	Texas	75751	9214 8901 5271 8100 1129 83
PAUL R BARWIS % DUTTON HARRIS & CO	PO BOX 230	MIDLAND	Texas	79702	9214 8901 5271 8100 1129 90
JAREED PARTNERS LTD A TEXAS LIMITED PARTNERSHIP	PO BOX 51451	MIDLAND	Texas	79710-1451	9214 8901 5271 8100 1130 03
ROBRO ROYALTY PARTNERS LTD DBA RRP 2010 LTD BENNY D DUNCAN					
MANAGER OF TRUNK BAY LLC AGENT	PO BOX 671028	DALLAS	Texas	75367-1028	9214 8901 5271 8100 1130 10
BITTER END ROYALTIES LP	PO BOX 670988	DALLAS	Texas	75367-0988	9214 8901 5271 8100 1130 27
DEVON ENERGY PROD CO LP	333 W SHERIDAN AVE	OKLAHOMA CITY	Oklahoma	73102-5015	9214 8901 5271 8100 1130 34
ENERGY ROYALTIES LLC AC TEXAS COMMUNITY BANK NA	3100 RICHMOND AVE STE 100	HOUSTON	Texas	77098	9214 8901 5271 8100 1130 41
STATE OF NEW MEXICO COMMISSION OF PUBLIC LANDS	PO BOX 1148	SANTA FE	New Mexico	87504-1148	9214 8901 5271 8100 1130 58
DEVON ENERGY PROD CO LP	333 W SHERIDAN AVE	OKLAHOMA CITY	Oklahoma	73102-5015	
J RICHARD DOTY	803 UNIVERSITY AVE	OXFORD	Mississippi	38655-4337	9214 8901 5271 8100 1130 65
VANGUARD OPERATING LLC	PO BOX 46094	HOUSTON	Texas	77210-6094	9214 8901 5271 8100 1130 72





Devon Energy Production Company, L.P.  
333 West Sheridan Avenue  
Oklahoma City, OK 73102

405 235 3611 Phone  
[www.devonenergy.com](http://www.devonenergy.com)

Writer's direct dial 405 552 3365  
[zach.graham@devn.com](mailto:zach.graham@devn.com)

November 30, 2106

Mr. Michael McMillian  
New Mexico Oil Conservation Division  
1220 South Saint Francis Drive  
Santa Fe, NM 87504

Re: Cooter 16 State Com 5H, 6H, 7H, 8H  
Cottontail 16 State Com 1H  
Section 16-25S-29E Eddy County, NM

Mr. Ezeanyim:

Devon desires to surface commingle the wells listed below in the Willow Lake; Bone Spring, Southeast (Pool Code: 96217). Upon review of the title information and Devon's records, please be advised that all of the ownership is identical in these wells.

<u>Well Name</u>	<u>Location</u>	<u>API</u>	<u>Leases</u>	<u>Pool</u>
Cooter 16 State Com 5H	SW/4 SE/4 16-25S-29E	30-015-37875	V-4902/VB-1065	96217 Willow Lake; Bone Spring, Southeast
Cooter 16 State Com 6H	SW/4 SE/4 16-25S-29E	30-015-37876	V-4902/VB-1065	96217 Willow Lake; Bone Spring, Southeast
Cooter 16 State Com 7H	SE/4 SE/4 16-25S-29E	30-015-37877	V-4902/VB-1065	96217 Willow Lake; Bone Spring, Southeast
Cooter 16 State Com 8H	SE/4 SE/4 16-25S-29E	30-015-37878	V-4902/VB-1065	96217 Willow Lake; Bone Spring, Southeast
Cottontail 16 State Com 1H	SW/4 SE/4 16-25S-29E	30-015-42321	V-4902/VB-1065	96217 Willow Lake; Bone Spring, Southeast

If you have any questions please feel free to contact me at (405) 552-3365.

Sincerely,

DEVON ENERGY PRODUCTION COMPANY, L.P.



Zach Graham  
Landman



Devon Energy Production Company, L.P.  
333 West Sheridan Avenue  
Oklahoma City, OK 73102

405 235 3611 Phone  
[www.devonenergy.com](http://www.devonenergy.com)

Writer's direct dial 405 552 3365  
[zach.graham@dvn.com](mailto:zach.graham@dvn.com)

November 30, 2016

Mr. Mike McMillan  
New Mexico Oil Conservation Division  
1220 South Saint Francis Drive  
Santa Fe, NM 87504

Re: Cooter 16 State 1H, 2H, 3H, 4H  
Section 16-25S-29E Eddy County, NM

Mr. McMillan:

Devon desires to surface commingle the wells listed below in the Willow Lake; Bone Spring, Southeast (Pool Code: 96217). Upon review of the title information and Devon's records, please be advised that all of the ownership is identical in these wells.

<u>Well Name</u>	<u>Location</u>	<u>API</u>	<u>Lease</u>	<u>Pool</u>
Cooter 16 State 1H	SE/4 SW/4 16-25S-29E	30-015-37625	V-4902	96217 Willow Lake; Bone Spring, Southeast
Cooter 16 State 2H	SW/4 SW/4 16-25S-29E	30-015-37626	V-4902	96217 Willow Lake; Bone Spring, Southeast
Cooter 16 State 3H	NW/4 NW/4 16-25S-29E	30-015-37627	V-4902	96217 Willow Lake; Bone Spring, Southeast
Cooter 16 State 4H	SE/4 SW/4 16-25S-29E	30-015-37628	V-4902	96217 Willow Lake; Bone Spring, Southeast

If you have any questions please feel free to contact me at (405) 552-3365.

Sincerely,

DEVON ENERGY PRODUCTION COMPANY, L.P.

Zach Graham  
Landman

Cooter 16 State 1H  
Sec. 16, T25S, R29E  
API: 30-015-37626  
Eddy Co., NM  
V 4902

PROCESS FLOW DIAGRAM

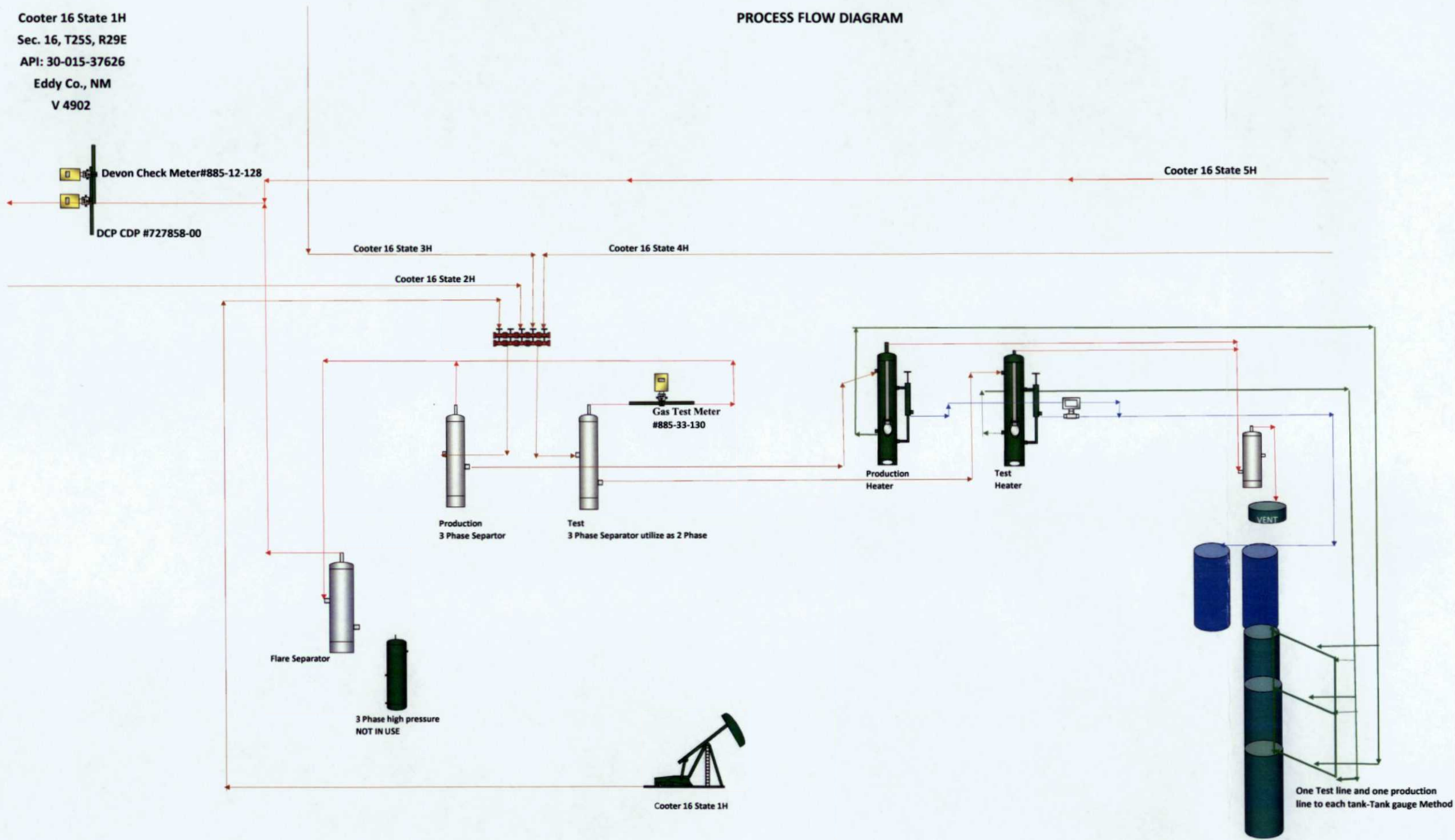

Cooter 16 St 5H Battery  
API 3001537875  
SL SEC-16 T25S R29E  
BHL SEC-16 T25S R29E

PROCESS FLOW DIAGRAM

Production System: Closed

Note:  
Devon Energy Site Security Plan  
located in the Artesia Main Office

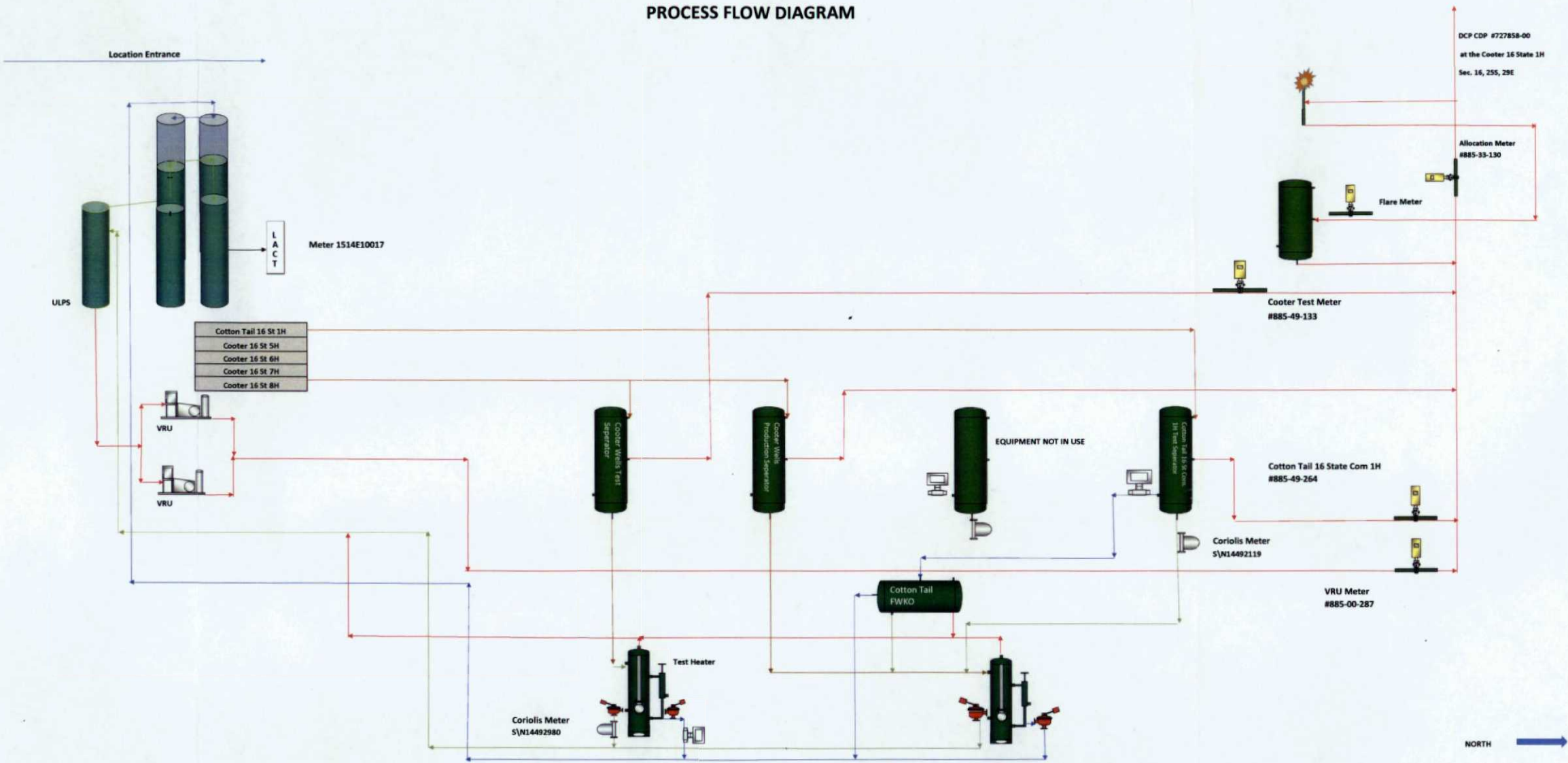



**McMillan, Michael, EMNRD**

---

**From:** Kautz, Paul, EMNRD  
**Sent:** Wednesday, December 14, 2016 11:29 AM  
**To:** Sharp, Karen, EMNRD; McMillan, Michael, EMNRD  
**Subject:** RE: [EXTERNAL] RE: COOTER 16 STATE COM #007H API 30-015-37877 dedicated acreage....Devon

After looking at the production GOR's it should remain as a Gas well on 320 acres.

Paul Kautz  
Hobbs District Geologist  
Energy Minerals Natural Resources Dept.  
Oil Conservation Division  
1625 N. French Dr.  
Hobbs, NM 88240  
575-393-6161 ext. 104

---

**From:** Sharp, Karen, EMNRD  
**Sent:** Wednesday, December 14, 2016 11:25 AM  
**To:** Kautz, Paul, EMNRD <paul.kautz@state.nm.us>; McMillan, Michael, EMNRD <Michael.McMillan@state.nm.us>  
**Subject:** FW: [EXTERNAL] RE: COOTER 16 STATE COM #007H API 30-015-37877 dedicated acreage....Devon

So this apparently is our call...do we want to go back to the 160 (oil) and have Devon amend the com agreement with State Land, or leave as 320 (gas) and all is good as is?

*Karen Sharp*

NMOCD  
Business Operations Specialist-Advanced  
(575) 748-1283 x 109  
Fax : 748-9720



---

**From:** Khalsa, Niranjan [mailto:nkhalsa@slo.state.nm.us]  
**Sent:** Wednesday, December 14, 2016 11:04 AM  
**To:** Sharp, Karen, EMNRD <Karen.Sharp@state.nm.us>  
**Cc:** Kautz, Paul, EMNRD <paul.kautz@state.nm.us>  
**Subject:** RE: [EXTERNAL] RE: COOTER 16 STATE COM #007H API 30-015-37877 dedicated acreage

# Devon Cooter State Surface commingle application

## Pending Cooter State Communitization Agreement

API #	Well Name	U-Sec	Twp	Rng	Ft N/S	Ft E/W	Project Area
30-015-37875	COOTER 16 STATE COM #5H	O-16	25S	29E	330S	2310E	W/2 E/2 Sec.16
30-015-37876	COOTER 16 STATE COM#6H	O- 16	25S	29E	330S	1650E	W/2 E/2 Sec.16
30-015-37877	COOTER 16 STATE COM#7H	P- 16	25S	29E	330S	770E	E/2 E/2 Sec.16
30-015-37878	COOTER 16 STATE COM#8H	P- 16	25S	29E	330S	420E	E/2 E/2 Sec.16

## Pending Cottontail State Communitization Agreement

API #	Well Name	U-Sec	Twp	Rng	Feet	Fi	Project Area
30-015-42321	COTTONTAIL 16 STATE COM#1H	O- 16	25S	29E	150S	1950E	E/2 Sec.16

## New Mexico State Lease VB-4902

API #	Well Name	U-Sec	Twp	Rng	Feet	Fi	Project Area
30-015-37625	COOTER 16 STATE#1H	N- 16	25S	29E	330S	1580W	E/2W/2 Sec.16
30-015-37626	COOTER 16 STATE#2H	M-16	25S	29E	480S	330W	W/2 W/2 Sec.16
30-015-37627	COOTER 16 STATE#3H	D- 16	25S	29E	330N	1190W	W/2 W/2 Sec.16
30-015-37628	COOTER 16 STATE#4H	N-16	25S	29E	330S	2310W	E/2 W/2 Sec.16

### Cooter 16 State Com 1H, 2H, 3H, & 4H Oil Production

WC Name	Month	Year	Oil DN Name	Prod
COOTER 16 ST 1H	5	2016	COOTER 16 STATE 1H OIL	0.00
COOTER 16 ST 2H	5	2016	COOTER 16 STATE 1H OIL	84.67
COOTER 16 ST 3H	5	2016	COOTER 16 STATE 1H OIL	150.21
COOTER 16 ST 4H	5	2016	COOTER 16 STATE 1H OIL	71.94
COOTER 16 ST 1H	6	2016	COOTER 16 STATE 1H OIL	0.00
COOTER 16 ST 2H	6	2016	COOTER 16 STATE 1H OIL	121.35
COOTER 16 ST 3H	6	2016	COOTER 16 STATE 1H OIL	121.34
COOTER 16 ST 4H	6	2016	COOTER 16 STATE 1H OIL	85.53
COOTER 16 ST 1H	7	2016	COOTER 16 STATE 1H OIL	0.00
COOTER 16 ST 2H	7	2016	COOTER 16 STATE 1H OIL	46.16
COOTER 16 ST 3H	7	2016	COOTER 16 STATE 1H OIL	96.32
COOTER 16 ST 4H	7	2016	COOTER 16 STATE 1H OIL	0.00
COOTER 16 ST 1H	8	2016	COOTER 16 STATE 1H OIL	0.00
COOTER 16 ST 2H	8	2016	COOTER 16 STATE 1H OIL	111.90
COOTER 16 ST 3H	8	2016	COOTER 16 STATE 1H OIL	62.88
COOTER 16 ST 4H	8	2016	COOTER 16 STATE 1H OIL	0.00
COOTER 16 ST 1H	9	2016	COOTER 16 STATE 1H OIL	0.00
COOTER 16 ST 2H	9	2016	COOTER 16 STATE 1H OIL	88.50
COOTER 16 ST 3H	9	2016	COOTER 16 STATE 1H OIL	90.69
COOTER 16 ST 4H	9	2016	COOTER 16 STATE 1H OIL	0.00
COOTER 16 ST 1H	10	2016	COOTER 16 STATE 1H OIL	0.00
COOTER 16 ST 2H	10	2016	COOTER 16 STATE 1H OIL	112.26
COOTER 16 ST 3H	10	2016	COOTER 16 STATE 1H OIL	105.23
COOTER 16 ST 4H	10	2016	COOTER 16 STATE 1H OIL	0.00



**Cooter 16 State Com 5H, 6H, 7H 8H, &  
Cottontail 16 State Com 1H Oil**

WC Name	Month	Year	Oil DN Name	Prod
COOTER 16 ST 5H	5	2016	COOTER 16 STATE 5H OIL	83.08
COOTER 16 ST 6H	5	2016	COOTER 16 STATE 5H OIL	63.20
COOTER 16 ST 7H	5	2016	COOTER 16 STATE 5H OIL	33.43
COOTER 16 ST 8H	5	2016	COOTER 16 STATE 5H OIL	87.32
<b>COTTONTAIL 16 STATE COM 1H</b>	<b>5</b>	<b>2016</b>	<b>COOTER 16 STATE 5H OIL</b>	<b>9,150.45</b>
COOTER 16 ST 5H	6	2016	COOTER 16 STATE 5H OIL	72.63
COOTER 16 ST 6H	6	2016	COOTER 16 STATE 5H OIL	93.61
COOTER 16 ST 7H	6	2016	COOTER 16 STATE 5H OIL	91.87
COOTER 16 ST 8H	6	2016	COOTER 16 STATE 5H OIL	75.99
<b>COTTONTAIL 16 STATE COM 1H</b>	<b>6</b>	<b>2016</b>	<b>COOTER 16 STATE 5H OIL</b>	<b>6,301.88</b>
COOTER 16 ST 5H	7	2016	COOTER 16 STATE 5H OIL	33.98
COOTER 16 ST 6H	7	2016	COOTER 16 STATE 5H OIL	70.25
COOTER 16 ST 7H	7	2016	COOTER 16 STATE 5H OIL	75.51
COOTER 16 ST 8H	7	2016	COOTER 16 STATE 5H OIL	39.97
<b>COTTONTAIL 16 STATE COM 1H</b>	<b>7</b>	<b>2016</b>	<b>COOTER 16 STATE 5H OIL</b>	<b>8,563.44</b>
COOTER 16 ST 5H	8	2016	COOTER 16 STATE 5H OIL	56.44
COOTER 16 ST 6H	8	2016	COOTER 16 STATE 5H OIL	43.30
COOTER 16 ST 7H	8	2016	COOTER 16 STATE 5H OIL	0.00
COOTER 16 ST 8H	8	2016	COOTER 16 STATE 5H OIL	85.37
<b>COTTONTAIL 16 STATE COM 1H</b>	<b>8</b>	<b>2016</b>	<b>COOTER 16 STATE 5H OIL</b>	<b>7,115.99</b>
COOTER 16 ST 5H	9	2016	COOTER 16 STATE 5H OIL	24.40
COOTER 16 ST 6H	9	2016	COOTER 16 STATE 5H OIL	48.31
COOTER 16 ST 7H	9	2016	COOTER 16 STATE 5H OIL	28.64
COOTER 16 ST 8H	9	2016	COOTER 16 STATE 5H OIL	76.99
<b>COTTONTAIL 16 STATE COM 1H</b>	<b>9</b>	<b>2016</b>	<b>COOTER 16 STATE 5H OIL</b>	<b>6,826.03</b>
COOTER 16 ST 5H	10	2016	COOTER 16 STATE 5H OIL	40.70
COOTER 16 ST 6H	10	2016	COOTER 16 STATE 5H OIL	47.24
COOTER 16 ST 7H	10	2016	COOTER 16 STATE 5H OIL	48.29
COOTER 16 ST 8H	10	2016	COOTER 16 STATE 5H OIL	102.79
<b>COTTONTAIL 16 STATE COM 1H</b>	<b>10</b>	<b>2016</b>	<b>COOTER 16 STATE 5H OIL</b>	<b>5,807.08</b>



**Cooter 16 State 1H, 2H, 3H, 4H, Cooter 16 State Com 5H, 6H, 7H, 8H, & Cottontail  
16 State Com 1H Gas Production**

WC Name	Month	Year	Gas DN Name	Flare	Prod
COOTER 16 ST 1H	5	2016	COOTER 16 STATE 1H GAS	649	3,322
COOTER 16 ST 2H	5	2016	COOTER 16 STATE 1H GAS	902	4,612
COOTER 16 ST 3H	5	2016	COOTER 16 STATE 1H GAS	1,067	5,459
COOTER 16 ST 4H	5	2016	COOTER 16 STATE 1H GAS	983	5,027
COOTER 16 ST 5H	5	2016	COOTER 16 STATE 1H GAS	819	4,458
COOTER 16 ST 6H	5	2016	COOTER 16 STATE 1H GAS	753	4,103
COOTER 16 ST 7H	5	2016	COOTER 16 STATE 1H GAS	669	3,639
COOTER 16 ST 8H	5	2016	COOTER 16 STATE 1H GAS	1,470	8,000
<b>COTTONTAIL 16 STATE COM 1H</b>	<b>5</b>	<b>2016</b>	<b>COOTER 16 STATE 1H GAS</b>	<b>9,034</b>	<b>46,214</b>
COOTER 16 ST 1H	6	2016	COOTER 16 STATE 1H GAS	65	2,634
COOTER 16 ST 2H	6	2016	COOTER 16 STATE 1H GAS	187	7,537
COOTER 16 ST 3H	6	2016	COOTER 16 STATE 1H GAS	217	8,760
COOTER 16 ST 4H	6	2016	COOTER 16 STATE 1H GAS	122	4,940
COOTER 16 ST 5H	6	2016	COOTER 16 STATE 1H GAS	149	6,121
COOTER 16 ST 6H	6	2016	COOTER 16 STATE 1H GAS	107	4,391
COOTER 16 ST 7H	6	2016	COOTER 16 STATE 1H GAS	140	5,712
COOTER 16 ST 8H	6	2016	COOTER 16 STATE 1H GAS	175	7,183
<b>COTTONTAIL 16 STATE COM 1H</b>	<b>6</b>	<b>2016</b>	<b>COOTER 16 STATE 1H GAS</b>	<b>834</b>	<b>33,672</b>
COOTER 16 ST 1H	7	2016	COOTER 16 STATE 1H GAS	186	1,162
COOTER 16 ST 2H	7	2016	COOTER 16 STATE 1H GAS	1,127	7,061
COOTER 16 ST 3H	7	2016	COOTER 16 STATE 1H GAS	1,080	6,768
COOTER 16 ST 4H	7	2016	COOTER 16 STATE 1H GAS	576	3,605
COOTER 16 ST 5H	7	2016	COOTER 16 STATE 1H GAS	394	2,583
COOTER 16 ST 6H	7	2016	COOTER 16 STATE 1H GAS	320	2,097
COOTER 16 ST 7H	7	2016	COOTER 16 STATE 1H GAS	677	4,433
COOTER 16 ST 8H	7	2016	COOTER 16 STATE 1H GAS	775	5,076
<b>COTTONTAIL 16 STATE COM 1H</b>	<b>7</b>	<b>2016</b>	<b>COOTER 16 STATE 1H GAS</b>	<b>7,176</b>	<b>44,945</b>
COOTER 16 ST 1H	8	2016	COOTER 16 STATE 1H GAS	256	2,764
COOTER 16 ST 2H	8	2016	COOTER 16 STATE 1H GAS	677	7,319
COOTER 16 ST 3H	8	2016	COOTER 16 STATE 1H GAS	738	7,976
COOTER 16 ST 4H	8	2016	COOTER 16 STATE 1H GAS	168	1,812
COOTER 16 ST 5H	8	2016	COOTER 16 STATE 1H GAS	363	1,961
COOTER 16 ST 6H	8	2016	COOTER 16 STATE 1H GAS	382	2,059
COOTER 16 ST 7H	8	2016	COOTER 16 STATE 1H GAS	1,730	9,336
COOTER 16 ST 8H	8	2016	COOTER 16 STATE 1H GAS	1,202	6,485
<b>COTTONTAIL 16 STATE COM 1H</b>	<b>8</b>	<b>2016</b>	<b>COOTER 16 STATE 1H GAS</b>	<b>3,482</b>	<b>37,650</b>
COOTER 16 ST 1H	9	2016	COOTER 16 STATE 1H GAS	75	3,574
COOTER 16 ST 2H	9	2016	COOTER 16 STATE 1H GAS	189	9,050
COOTER 16 ST 3H	9	2016	COOTER 16 STATE 1H GAS	144	6,859
COOTER 16 ST 4H	9	2016	COOTER 16 STATE 1H GAS	69	3,307
COOTER 16 ST 5H	9	2016	COOTER 16 STATE 1H GAS	1,305	3,192
COOTER 16 ST 6H	9	2016	COOTER 16 STATE 1H GAS	1,451	3,551
COOTER 16 ST 7H	9	2016	COOTER 16 STATE 1H GAS	3,734	9,141

WC Name	Month	Year	Gas DN Name	Flare	Prod
COOTER 16 ST 8H	9	2016	COOTER 16 STATE 1H GAS	2,355	5,765
COTTONTAIL 16 STATE COM 1H	9	2016	COOTER 16 STATE 1H GAS	817	39,005
COOTER 16 ST 1H	10	2016	COOTER 16 STATE 1H GAS	14	1,749
COOTER 16 ST 2H	10	2016	COOTER 16 STATE 1H GAS	89	11,001
COOTER 16 ST 3H	10	2016	COOTER 16 STATE 1H GAS	73	8,954
COOTER 16 ST 4H	10	2016	COOTER 16 STATE 1H GAS	29	3,551
COOTER 16 ST 5H	10	2016	COOTER 16 STATE 1H GAS	384	3,622
COOTER 16 ST 6H	10	2016	COOTER 16 STATE 1H GAS	410	3,866
COOTER 16 ST 7H	10	2016	COOTER 16 STATE 1H GAS	982	9,252
COOTER 16 ST 8H	10	2016	COOTER 16 STATE 1H GAS	769	7,261
COTTONTAIL 16 STATE COM 1H	10	2016	COOTER 16 STATE 1H GAS	281	34,626