

RECEIVED 6/02/2017	REVIEWER MAm	TYPE PLC	APP NO PLMAM1715257728
-----------------------	-----------------	-------------	---------------------------

ABOVE THIS TABLE FOR OCD DIVISION USE ONLY

NEW MEXICO OIL CONSERVATION DIVISION
 - Geological & Engineering Bureau -
 1220 South St Francis Drive, Santa Fe, NM 87505

**ADMINISTRATIVE APPLICATION CHECKLIST**

THIS CHECKLIST IS MANDATORY FOR ALL ADMINISTRATIVE APPLICATIONS FOR EXCEPTIONS TO DIVISION RULES AND REGULATIONS WHICH REQUIRE PROCESSING AT THE DIVISION LEVEL IN SANTA FE

Applicant: Merrion Oil & Gas Corporation

OGRID Number: 14634

Well Name: North Dufers CPD Logos 2508 20D #15

API: 30-045-35828

Pool: Duffers Point Gallup Dakota Escrito GallupPool Code: 14854 22619

SUBMIT ACCURATE AND COMPLETE INFORMATION REQUIRED TO PROCESS THE TYPE OF APPLICATION INDICATED BELOW

PLC 387A

1) **TYPE OF APPLICATION:** Check those which apply for [A]

A Location - Spacing Unit - Simultaneous Dedication

☐ NSL☐ NSP (PROJECT AREA)☐ NSP (PRORATION UNIT)☐ SD

B. Check one only for [I] or [II]

[I] Commingling - Storage - Measurement

☐ DHC☐ CTB☐ PLC☐ PC☐ OLS☒ OLM

[II] Injection - Disposal - Pressure Increase - Enhanced Oil Recovery

☐ WFX☐ PMX☐ SWD☐ IPI☐ EOR☐ PPR2) **NOTIFICATION REQUIRED TO:** Check those which applyA. ☐ Offset operators or lease holdersB. ☒ Royalty, overriding royalty owners, revenue ownersC. ☐ Application requires published noticeD. ☒ Notification and/or concurrent approval by SLOE. ☒ Notification and/or concurrent approval by BLMF. ☐ Surface ownerG. ☒ For all of the above, proof of notification or publication is attached, and/or,H. ☐ No notice required**FOR OCD ONLY**☐ Notice Complete
☐ Application
 Content
 Complete

3) **CERTIFICATION.** I hereby certify that the information submitted with this application for administrative approval is **accurate** and **complete** to the best of my knowledge. I also understand that **no action** will be taken on this application until the required information and notifications are submitted to the Division.

Note: Statement must be completed by an individual with managerial and/or supervisory capacity

Philana Thompson

Print or Type Name

Signature

5/31/2017

Date

505-486-1171

Phone Number

pthompson@merrion b/
 e-mail Address

Attachment A Merrion Oil and Gas Corporation Surface Commingle Application

API #	Well Name	UI Sec	Twp	Rng	Spacing	Pool	Pool Code	Comments
30-045-26536	FEDERAL A#2	P- 11	24N	8W	S/2 SE/4 Section 11	Escrito Gallup (Associated)	22619	
30-045-25580	JALAPENO#1	C-16	25N	8W	NW/4 Section 16	Dufers Point-Gallup Dakota	19859	
30-045-25579	ROADRUNNER#1	E- 2	24N	8W	NW/4 Section 2	Dufers Point-Gallup Dakota	19859	
30-045-26133	SHOOFLY#1	C-14	24N	8W	NW/4 Section 14	Dufers Point-Gallup Dakota	19859	/
30-045-22225	FEDERAL A#1	O-10	24N	8W	SE/4 Section 14	Dufers Point-Gallup Dakota	19859	
30-045-26322	SHOOFLY#2	A- 15	24N	8W	NE/4 Section 15	Dufers Point-Gallup Dakota	19859	
30-045-25931	STEPHENSON#2	I- 7	25N	8W	SE/4 Section 7	Dufers Point-Gallup Dakota	19859	
30-045-25985	STEPHENSON#3	K- 8	25N	8W	SW/4 Section 8	Dufers Point-Gallup Dakota	19859	
30-045-25986	STEPHENSON#4	O- 8	25N	8W	SE/4 Section 8	Dufers Point-Gallup Dakota	19859	
30-045-25912	WAGON TRAIN#1	I- 6	25N	8W	SE/4 Section 6	Dufers Point-Gallup Dakota	19859	
30-045-25376	WARITO#1	B- 7	25N	8W	NE/4 Section 7	Dufers Point-Gallup Dakota	19859	
30-045-26014	WILD HARE#1	D- 11	24N	8W	NW/4 Section 11	Dufers Point-Gallup Dakota	19859	
30-045-25927	SOB FEDERAL#1	E- 8	25N	8W	NW/4 Section 8	Dufers Point-Gallup Dakota	19859	
30-045-26310	HORSEFLY#1	M-11	24N	8W	SW/4 Section 20	Dufers Point-Gallup Dakota	19859	
30-045-26584	YUCCA COM#1	H- 2	25N	9W	NE/4 Section 2	Dufers Point-Gallup Dakota	19859	
30-045-05299	KEELING FEDERAL#1	B-20	25N	8W	NE/4 Section 20	Dufers Point-Gallup Dakota	19859	
30-045-35828	LOGOS 2508 20D#15	D-20	25N	8W	NW/4 Section 20	Dufers Point-Gallup Dakota	19859	LOGOS OPERATING, LLC



May 26th, 2017

05/26/17

2017-05-26 12:22

RE: Notice to working and royalty interest owners
Proposed addition of the Logos 2508 20D #15 to the North Dufers Point CPD #97133

Dear Interest Owner:

According to our records, you have a working interest or royalty interest in one or more wells that is either currently connected or proposed to be connected to the North Dufers Point CPD #97133. The NMOCD requires that all working and royalty interest owners be notified of the plans to surface commingle when ownership is different between wells.

Merrion Oil & Gas Corporation is applying to the New Mexico Oil Conservation Division (NMOCD) and Bureau of Land Management for approval to add the Logos 2508 20D #15 (Operated by Logos Operating, LLC) to the North Dufers Point CPD which currently has 17 wells approved for the system. The Logos 2508 20D #15 will add the Dufers Point Gallup Dakota pool; this will require surface commingling of gas production, plus the sale of gas at an off-lease central delivery system.

Logos 2508 20D #15 interest owners will pay the cost required to install, operate and maintain the addition to the existing gathering system and all associated costs for the tie-in of the Logos 2508 20D #15 to the North Dufers CPD. As an interest owner in any of the remaining well(s), your only cost will be the existing fee charged for gathering and compression. You will not be billed for any costs associated with the tie-in of the Logos 2508 20D #15

We plan to produce the commingled gas through a shared compressor. Produced liquids will not be surfaced commingled. A copy of our application to surface commingle is attached for your reference. This proposal will not affect your interest in these wells and should allow for optimum operations on all wells. This method of operations will help to keep our operating expenses low as possible, keep wellhead operating pressures as low as possible. This will allow all interest owners to recover more of the gas reserves from each well. If you need additional information or have any questions, I may be contacted at 505-486-1171

If you have any objections to our application, you must notify in writing Merrion Oil & Gas and the NMOCD Santa Fe office at 1220 South St Francis Drive, Santa Fe, NM 87505 within 20 days. The application was mailed to the NMOCD on the date of this letter.

Sincerely,

A handwritten signature in black ink, appearing to read "Philana Thompson", is written over the typed name.

Philana Thompson
Regulatory Compliance Specialist
505-486-1171
pthompson@merrion.biz

cc: Logos Operating, LLC
New Mexico OCD
Farmington BLM

610 Reilly Avenue
Farmington, NM 87401
main 505.324.5300
fax 505.324.5350

#4



Data use subject to license.

© DeLorme. XMap® 6.

www.delorme.com



Scale 1 : 50,000

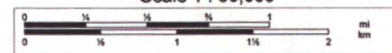

1" = 4,166.7 ft Data Zoom 12-0

#4

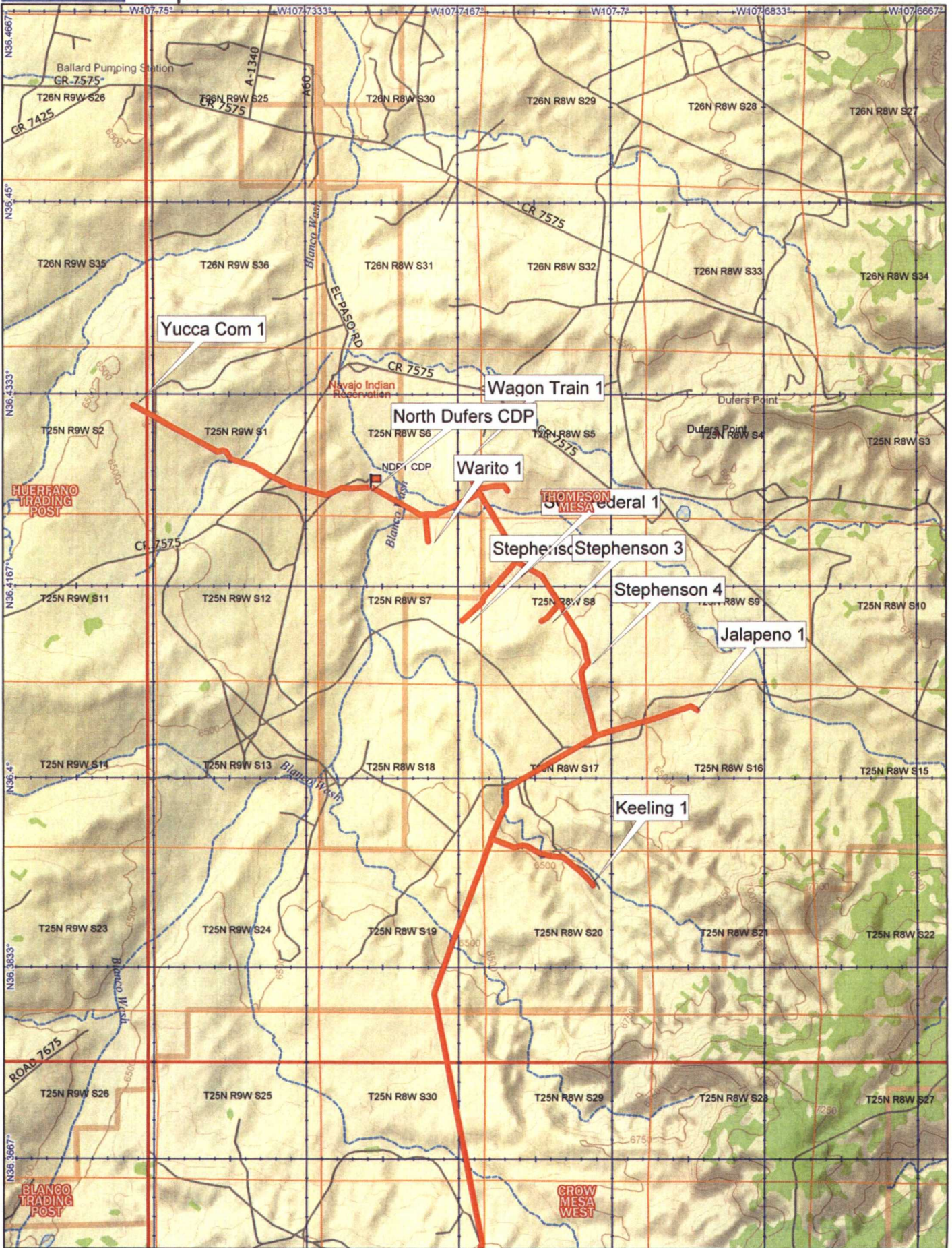

Data use subject to license.

© DeLorme. XMap® 6.

www.delorme.com



Scale 1 : 50,000

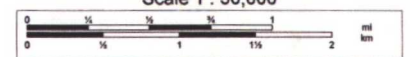

1" = 4,166.7 ft

Data Zoom 12-0

Merrion Oil & Gas
CPD -North Dufers Point # 97133

#5 Schematic Diagram -

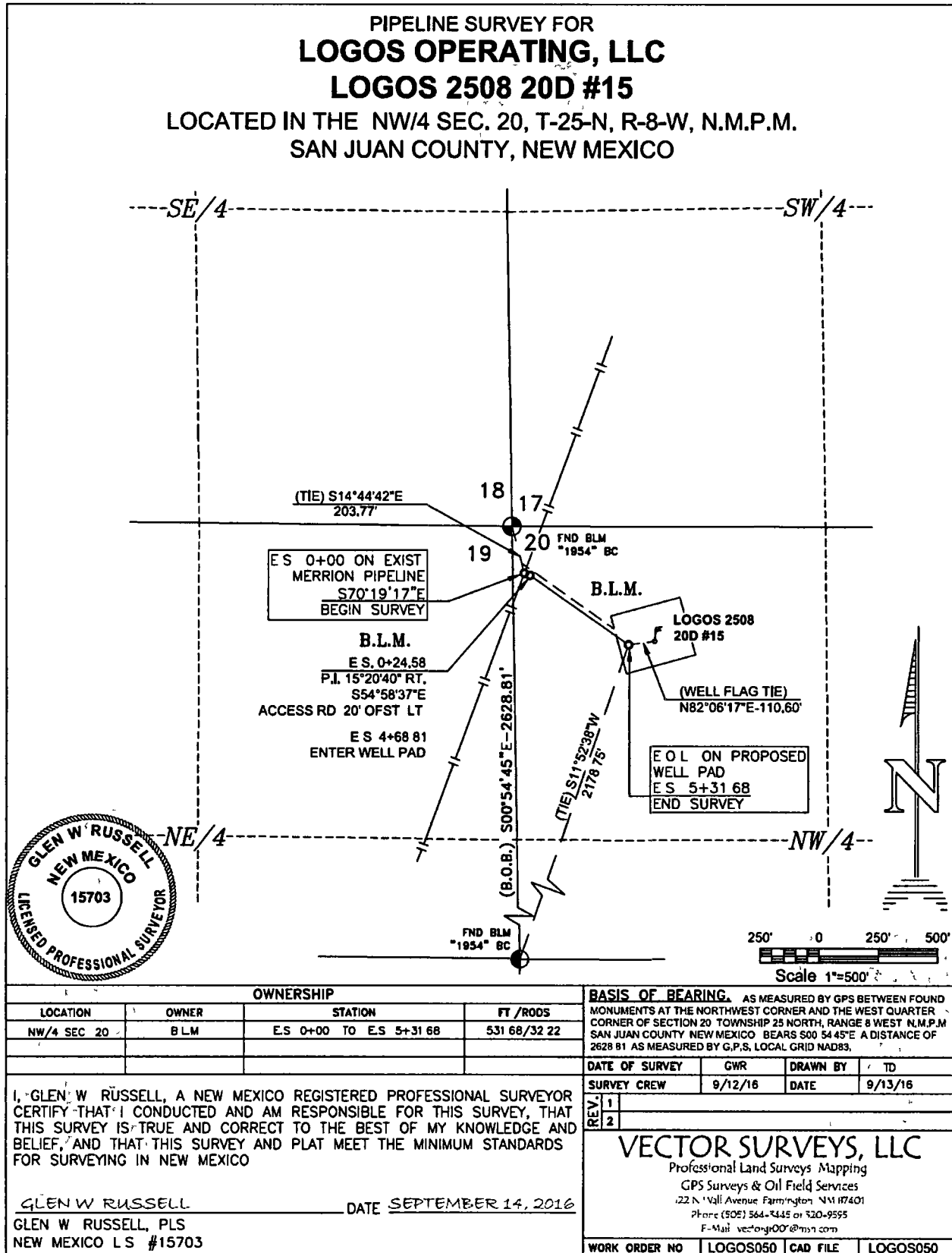

Merrion Oil & Gas
CPD -North Dufers Point # 97133

6 Estimated Monthly Production - Sample Month

June				
Well	API	Lease	Gas Sales Volume MCF @ 14.073	BTU
CPD Sales Meter			8540	1321
✓ Federal A2	30-045-26536	NMNM14580A	611	
Federal A3	30-045-26525	NMNM14580A	343	
Federal A1	30-045-22225	NMNM14580A	467	
✓ Jalapeno 1	30-045-25580	State	303	
✓ Roadrunner 1	30-045-25579	State	266	
✓ Shoofly 1	30-045-26133	NMNM16589	490	
✓ Shoofly 2	30-045-26322	NMNM16589	439	
✓ Stephenson 2	30-045-25931	NMSF078475	239	
✓ Stephenson 3	30-045-25985	NMSF078475	0	
✓ Stephenson 4	30-045-25986	NMSF078475	862	
✓ Wagon Train 1	30-045-25912	NMNM54982	1730	
✓ Wanto 1	30-045-25376	NOOC14205008	663	
Wild Hare 1	30-045-26014	NMNM47167	0	
✓ SOB Federal 1	30-045-25927	NMNM47169	1172	
✓ Horsefly 1	30-045-26310	NMNM014580	536	
✓ Yucca Com 1	30-045-26584	State	1314	
Keeling #1 (test meter)	30-045-05299	NMSF-078474	1405	

Merrion Oil & Gas
CPD -North Dufers Point # 97133

#7 Summary Report

610 REILLY AVENUE, FARMINGTON, NM 87401
NEW MEXICO OPERATOR'S MONTHLY REPORT (FORM C-115)

DECEMBER, 2016



POOL NAME WELL NAME AND NO.	WELL STATUS	Injection	PRODUCTION				DISPOSITION OF GAS				DISPOSITION OF OIL						DTU C 15.825	DTU C 14.75
		Value	BOIL OIL/COND PROD	BOIL WTR PROD	GAS PROD (MCF) C 15.825	DAYS PROD	SOID (MCF) C 15.825	TRANS- POR- TER	O T O N D E	C O D E	OIL OR HARD AT DEC OF MONTH	BARRELS TO TRANS- PORTER	TRANS- POR- TER	O T O N D E	C O D E	OIL OR HARD AT END OF MONTH		
DUFERS POINT-GALLUP DAKOTA																		
Federal A 1	P		104	10	414	26	258	EFS	156	U	379	0	WR	0		483	1307	1282
Federal A 2	S		0	0	0	0	0	EFS	0	U	171	0	WR	0		171	0	0
Horsefly 1	S		0	0	0	0	0	EFS	0	U	314	0	WR	0		314	0	0
Jalapeno 1	P		0	0	276	31	102	EFS	174	U	224	0	WR	0		224	1307	1282
Keeling Federal 1	P		30	50	842	31	695	EFS	147	U	145	0	WR	0		175	1307	1282
Roadrunner 1	P		0	0	211	27	65	EFS	146	U	99	0	WR	0		99	1307	1282
Shoofly 1	P		0	0	105	16	22	EFS	83	U	245	0	WR	0		245	1307	1282
Shoofly 2	S		0	0	0	0	0	EFS	0	U	244	0	WR	0		244	0	0
SOB Federal 1	S		0	0	0	0	0	EFS	0	U	299	0	WR	0		299	0	0
Stephenson Federal 2	S		0	0	0	0	0	EFS	0									
Stephenson Federal 3	S		0	0	0	0	0	EFS	0									
Stephenson Federal 4 (Revised 2/1/17)	P		6	20	454	30	254	EFS	200									
Wagon Train 1	F		5	10	1283	31	1009	EFS	274	U	357	191	WR	2	S	169	1307	1282
Warito 1	P		0	0	199	30	43	EFS	156	U	311	0	WR	0		311	1307	1282
Wild Hare 1	S		0	0	0	0	0	EFS	0	U	89	0	WR	0		89	0	0
Yucca Com 1	S		0	0	0	0	0	EFS	0	U	150	0	WR	0		150	0	0
FIELD TOTALS			145	90	3784	222	2448		1336		3027	191				2973		

Merrion Oil & Gas
CPD -North Dufers Point # 97133

NOVEMBER, 2016

		POOL NAME WELL NAME AND NO.	Injection			PRODUCTION		DAYS PROD	DISPOSITION OF			DISPOSITION OF OIL						BTU @ 15.025	BTU @ 14.73	
			WELL STATU S	Volu me	BBLS OIL/C OND PROD	BBLS WTR PROD	GAS PROD (MCF) @15.02 5		SOLD (MCF) @ 15.025	TRA NS- PO R- TER	O T H E R	OIL ON HAND AT BEG OF MONTH	BARRE LS TO TRANS- PORTE R	TRANS- POR- TER	O T H E R	C O D E	OIL ON HAND AT END OF MONT H			
30-045-25580	State	Jalapeno 1	P		0	0	283	30	120	EFS	163	U	224	0	WR	0		224	1308	1282
30-045-05299	NMSF078474	Keeling Federal 1	P		28	30	990	30	872	EFS	118	U	117	0	WR	0		145	1308	1282
30-045-25579	State	Roadrunner 1	S		0	0	0	0	0	EFS	0	U	99	0	WR	0		99	0	0
30-045-25579	NMNM16589	Shoofly 1	S		0	0	0	0	0	EFS	0	U	245	0	WR	0		245	0	0
30-045-26133	NMNM16589	Shoofly 2	P		66	0	274	30	112	EFS	162	U	178	0	WR	0		244	1308	1282
30-045-25927	NMNM47169	SOB Federal 1	S		0	0	0	0	0	EFS	0	U	299	0	WR	0		299	0	0
30-045-25931	NMSF078475	Stephenson Federal 2	P		0	0	213	30	58		155									
30-045-25985	NMSF078475	Stephenson Federal 3	S		0	0	0	0	0		0									
30-045-25986	NMSF078475	Stephenson Federal 4	P		46	20	434	30	253		181									
30-045-25912	NMNM54982	Wagon Train 1	F		13	13	1558	30	1321	EFS	237	U	344	0	WR	0		357	1308	1282
30-045-25376	NOOC14205008	Warito 1	P		0	0	229	30	72	EFS	157	U	311	0	WR	0		311	1308	1282
30-045-26014	NMNM47167	Wild Hare 1	S		0	0	0	0	0	EFS	0	U	89	0	WR	0		89	0	0
30-045-26584	State	Yucca Com 1	P		19	0	716	30	501	EFS	215	U	131	0	WR	0		150	1308	1282
30-045-26536	NMNM14580A	Federal A 2	S		0	0	0	0	0	EFS	0	U	171	0	WR	0		171	0	0
30-045-22225	NMNM14580A	Federal A 1	S		0	0	0	0	0	EFS	0	U	379	0	WR	0		379	0	0
		FIELD TOTALS			172	63	4697	240	3309		1388		2587	0		0		2713		

ENTERPRISE EMPLOYEE 
PRINTED NAME ERNIE JACQUEZ

ENTERPRISE FIELD SERVICES LLC (SAN JUAN)										Accounting/Production Period 12/2016										MERRION OIL & GAS CORP																			
Preparer Code 135476534																				Recipient Code 014510408																			
Statement Title Measurement Monthly Summary Statement																				Location Code NA										DRN									
MEAS Contact JENNIFER KENNEDY (505)599-3205										BTU Basis Dry										Report Date/Time 01/11/2017 10 43																			
STMT Contact MARCUS WARE (713)381-7816										Reporting Basis MCF @ 14 730										Statement Type Original																			
																				</																			

MERRION OIL & GAS CORP
 Recipient Code 014510408
 Location Code NA
 Report Date/Time 01/11/2017 10 43
 Statement Type Original

[illegible]

Energy Resources Analytical BTU Report

(505)486-2599

Sample Information

Sample Information	
Sample Name	North Duffers CPD
Company Name	Merrion
Well	North Duffers CPD
Flowing temp	79.4
Flowing Press	274.3
Diff Pressure	13.3
Method Name	GSA 3C
Operator	Reyes Marin
Injection Date	10/3/2010 12:00:01 PM
Report Date	10/03/2010 12:04:46 PM
BTU Configuration File	GPA 2145-03 ERAnalytical.cfg
Data Source	Cerity data system connection
Instrument	G2801AGC - CN10929001
Data Saved To	North Duffers CPD-20101003-120446.btu

Component Results

Component Name	Ret Time	Peak Area	Normalized Mole%	Heating Value (Btu / cu. ft.)	Molar Mass Ratio (G)	GPM (Gal / 1000 cu. ft.)
Nitrogen	0.217	10663	0.628	0.000	0.0061	0.0691
Methane	0.226	563860	74.797	757.194	0.4144	12.6773
Carbon Dioxide	0.308	10005	0.834	0.000	0.0127	0.1414
Ethane	0.375	149602	11.726	207.988	0.1217	3.1338
Hydrogen Sulfide	0.000	0	0.000	0.000	0.0000	0.0000
Propane	1.165	118000	7.560	190.667	0.1151	2.0815
i-Butane	0.416	50385	0.857	27.934	0.0172	0.2803
n-Butane	0.440	129695	2.171	71.000	0.0436	0.6845
i-Pentane	0.519	32380	0.498	19.959	0.0124	0.1821
n-Pentane	0.551	30931	0.464	18.639	0.0116	0.1680
Hexanes Plus	1.174	34320	0.466	23.957	0.0150	0.2022
Total			100.000	1317.340	0.7697	19.6202

Results Summary

Result	Dry	Sat
Total Unnormalized Mole%	105.618	
Pressure Base (psia)	14.730	
Water Mole%	-	1.740
Gross Heating Value (Btu / Ideal cu. ft.)	1317.340	1294.413
Gross Heating Value (Btu / Real cu. ft.)	1322.757	1300.290
Real Relative Density	0.77255	0.77030
Gas Compressibility (Z) Factor	0.99590	0.99548

Merrion Oil & Gas
CPD - North Dufers Point # 97133

#8 Measurement and Allocation Methods and Formulas

Date: 5/31/2017

MERRION OIL & GAS CORPORATION - - NORTH DUFERS POINT CPD - - #97133

June, 2013

Well Name		Chart Volume MCF @ 14.73	Prod. Days	Chart Days	A/P Well	Lease, Unit or CA ID #	Wellhead Mfr Inlet* MCF	Volume Ratio	Allocated MCF Sold @ 14.74 psf	Wellhead BTU/lb	Wellhead Measured MMBTU	MMBTU Ratio	Allocated Sales MMBTU	System Usage (MCF)	Allocated Production (MCF)	Allocated Average MMBTU/lb	Allocated MCF Sold @ 15.025	
Federal A1	ON	531	30	30	30-045-22225	NM-014580-A	531	0.052	375	1424	756	0.056	526	0	375	1.400	368	
Federal A2	ON	429	30	30	30-045-25535	NM-014580-A	429	0.042	303	1349	579	0.042	402	0	303	1.326	297	
Federal A3	ON	30	1	1	30-045-25525	NM-014580-A	30	0.003	21	1424	43	0.003	30	0	21	1.400	21	
Horsefly 1	ON	360	30	30	30-045-25310	NM-014580	360	0.036	255	1362	490	0.036	341	0	255	1.339	250	
Roadrunner 1	ON	110	30	30	30-045-25570	LG-1915	110	0.011	78	1361	150	0.011	104	0	78	1.338	76	
Shoofly 1	ON	317	30	30	30-045-25133	NM-15559	317	0.031	224	1378	437	0.032	304	0	224	1.355	220	
Shoofly 2	ON	270	30	30	30-045-25322	NM-15559	270	0.027	191	1390	375	0.028	261	0	191	1.367	187	
Wildhare 1	ON	95	30	30	30-045-25014	NM-47157	95	0.009	67	1353	129	0.009	89	0	67	1.330	66	
		3,045	30	30				3,045	0.301	2153	1339	4077	0.299	2,834	0	2153	1.317	2,111
Jalapeno 1	ON	145	30	30	30-045-25580	LG-1255	145	0.014	103	1339	194	0.014	135	0	103	1.317	101	
SOB Federal 1	ON	948	30	30	30-045-25527	NM-47159	948	0.094	670	1493	1415	0.104	994	0	670	1.468	657	
Stephenson 2	ON	85	30	30	30-045-25531	SF-4175475	85	0.008	60	1240	105	0.008	73	0	60	1.219	59	
Stephenson 3	ON	6	1	1	30-045-25585	SF-4175475	6	0.001	4	1354	8	0.001	6	0	4	1.331	4	
Stephenson 4	ON	661	30	30	30-045-25585	SF-4175475	661	0.065	467	1273	841	0.062	585	0	467	1.252	458	
Wagon Train 1	ON	1,545	30	30	30-045-25012	NM-54552	1,545	0.152	1,092	1287	1988	0.146	1,382	0	1,092	1.265	1,071	
Warrio Com 1	ON	477	30	30	30-045-25378	NOD-C-5003	477	0.047	337	1314	627	0.046	436	0	337	1.292	331	
Yucca Com 1	ON	1,079	30	30	30-045-25554	LG-3495	1,079	0.106	763	1301	1404	0.103	976	0	763	1.279	748	
Total		10,133						10,133		9,317	13619		12301	0	9317		9,134	

(Check)

(Check) (Check) (Check)

CPD METER TOTAL N DUFERS POINT @ 14.73	7,164	@ 15.025
MMBTU SOLD FROM CPD	9,467	7023
CPD, BTU/SCF	1321.000	
CPD Gas Usage:	0	

COMPRESSOR AND DRIP LIQUID ALLOCATION

MINIMUM BTU =
PRODUCT BTU/Lb =
MONTHLY PROD =
MONTHLY SALES =

1,050
100,000
10
0.00

BTU/SCF
BTU/Lb
BBLs
BBLs

MONTH: June, 2013

TOTAL DOLLARS R/O, (\$)

\$0.00

\$0.00

\$0.00

PROPERTY	BEGINNING INVENTORY BBLs	PROD INVENTORY BBLs	THEORETICAL PROD BBLs	ALLOC PROD BBLs BASED ON THEOR	ALLOC SALES	ENDING INVENTORY BBLs	ALLOC SALES (\$) BASED ON INVENTORY	ALLOC SALES (\$) BASED ON INVENTORY	ALLOC SALES (\$) BASED ON INVENTORY
Federal A1	ON	338	338	33	1	0	338	\$0.00	\$0.00
Federal A2	ON			21	1	0	1	\$0.00	\$0.00
Federal A3	ON			2	0	0	0	\$0.00	\$0.00
Horsefly 1	ON			19	1	0	1	\$0.00	\$0.00
Roadrunner 1	ON			6	0	0	0	\$0.00	\$0.00
Shoofly 1	ON			17	0	0	0	\$0.00	\$0.00
Shoofly 2	ON			15	0	0	0	\$0.00	\$0.00
Wildhare 1	ON			5	0	0	0	\$0.00	\$0.00
Jalapeno 1	ON			7	0	0	0	\$0.00	\$0.00
SOB Federal 1	ON			70	2	0	2	\$0.00	\$0.00
Stephenson 2	ON			3	0	0	0	\$0.00	\$0.00
Stephenson 3	ON			0	0	0	0	\$0.00	\$0.00
Stephenson 4	ON			24	1	0	1	\$0.00	\$0.00
Wagon Train 1	ON			61	2	0	2	\$0.00	\$0.00
Warrio Com 1	ON			21	1	0	1	\$0.00	\$0.00
Yucca Com 1	ON			45	1	0	1	\$0.00	\$0.00
TOTAL		338	338	347	10	0	346	\$0.00	\$0.00

#REF:

Merrion Oil & Gas
CPD -North Dufers Point # 97133

8a

Beneficial Fuel Usage Calculations

Fuel for equipment is calculated based on the equipment in use at each well. These wells will have a combined cold separator that uses no fuel and a pumping unit. The fuel use for the equipment is calculated as follows:

Pumping Units:

$$\begin{aligned} &12 \text{ hp} * 10 \text{ SCF/hphr} * 24 \text{ hrs/day} && \text{(based on 1,100 BTU/SCF per} \\ &&& \text{Practical Petroleum Engineer's} \\ &&& \text{Handbook by Zaba \& Doherty)} \\ &= 2,880 \text{ SCFD} \\ &\text{Approximately 3 MCFD} && (90 \text{ MCFM}) \end{aligned}$$

Separators:

$$\begin{aligned} &\frac{500,000 \text{ BTU/hr} * 25\% \text{ on line} * 24 \text{ hrs}}{1000 \text{ BTU/SCF} * 70\% \text{ eff.}} \\ &= 2,143 \text{ SCF} \\ &\text{Approximately 2 MCFD} && (60 \text{ MCFM}) \end{aligned}$$

Fuel for the central compression equipment is calculated based of the horsepower rating of the engine.

Compressor:

$$\begin{aligned} &\frac{125 \text{ BHP} * 8,500 \text{ BTU/BHP} * 24 \text{ hr}}{1,253 \text{ BTU/SCF}} \\ &= 20,351 \text{ SCF} \\ &20,351 \text{ MCFD} * 30.4 \text{ days/month} \\ &\underline{619 \text{ MCFM}} \end{aligned}$$

Merrion Oil & Gas
CPD -North Dufers Point # 97133

8b Estimated Vented Volumes for Gas Wells - not normal operating conditions,
gas vented in upset conditions only.

Example only - not actual data

Example only - not actual data

FILE: VENTDATA
MONTH: EXAMPLE ONLY
NOT ACTUAL DATA

ESTIMATED VENTED VOLUMES
FOR GAS WELLS

Wagon Train #1

WELL
TYPE VENTING
CYCLES/DAY
VENT TIME/CYCLE (HR)
TUBING VOLUME VENTED
SIZE
DEPTH
CAPACITY (FT³/FT)
TBG VOL (FT³)
INITIAL PRESS
INITIAL Bg(MCF/FT³)
INITIAL VOL (MCF)
FINAL PRESS
FINAL Bg(MCF/FT³)
FINAL VOL (MCF)
VENTED VOL (MCF)
TOTAL VOLUME VENTED
VOL/CYCLE (MCF)
VOL/DAY (MCF)

UPSET

1

0.25

2 3/8"

1478

0.02171

32.1

50

0.0033

0.1

12

0.0008

0

0.1

0.1

0.1

Merrion Oil & Gas
CPD -North Duffers Point # 97133

#9

Evidence of Proper Allocation

Merrion Oil & Gas (MOG) will allocate production from the North Duffers Point CPD on a monthly basis. An example of the monthly allocation sheet is shown on attachment 8

The figures are reconciled based on the spreadsheet example in the latest allocation method approved by the MMS.

Royalties are paid to the Minerals Management Service through the MOG accounting department after the production allocation is determined. Royalty payments are calculated on an individual well basis, thus the accounting is accurate as long as the correct production allocation and royalty rates are entered into the system.

Merrion Oil & Gas
CPD -North Dufers Point # 97133

10

Economic Evaluation:

The wells are marginal and therefore central compression is needed to keep well head pressures low. It would be cost prohibitive to have individual wellhead compression on each well.

Merrion Oil & Gas
CPD -North Dufers Point # 97133

11

SIGNATURE PAGE

We request approval to add the Logos 2508 20D # 15 to the existing CPD.

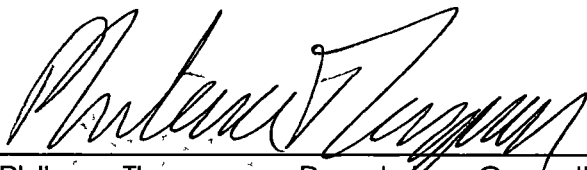

Philana Thompson, Regulatory Compliance Spec.

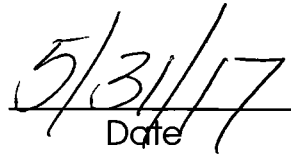
Date

Mike C Abraham P O Box 25123 Albuquerque, NM 87125	Pennies From Heaven LLC Bank Of America, N A PO Box 840738 Dallas, TX 75284-0738	RHB Enterprises, LLC C/O Reynolds, Hix & Co, PA 6729 Academy Road NE, Suite D Albuquerque, NM 87109
The Greg & Nancy Vance Family Limited Partnership 8080 N Central Exprsway, Ste1090 Dallas, TX 75206	WCB Investments, LLC C/O Reynolds, Hix & Co, PA 6729 Academy Road NE, Suite D Albuquerque, NM 87109	BP America Production P O Box 277897 Atlanta, GA 30384-7897
Ceefam LLC Little Oil & Gas, Agent P O Box 1258 Farmington, NM 87499	Energen Resources Corp Attn Cindy Russo 605 Richard Arrington Jr Blvd North Birmingham, AL 35203-2707	Harold Yaffee PO Box 4511 Sioux City, IA 51104
Mike C Abraham P O Box 25123 Albuquerque, NM 87125	Pennies From Heaven LLC Bank Of America, N A PO Box 840738 Dallas, TX 75284-0738	Potenziani Family Partnership Frank A Potenziani P O Box 676370 Rancho Santa Fe, CA 92067-6370
R B Nielsen Trust 1200 Danbury Drive Mansfield, TX 76063	RHB Enterprises, LLC C/O Reynolds, Hix & Co, PA 6729 Academy Road NE, Suite D Albuquerque, NM 87109	Robert Umbach Cancer Foundation Zia Data Search Corporation, Agent P O Box 2188 Roswell, NM 88202-2188
Tedde Birkhead 1732 Larry Hinson El Paso, TX 79936	WWR Enterprises C/O Petroleum Asset Management P O Box 745 Hobbs, NM 88241	WCB Investments, LLC C/O Reynolds, Hix & Co, PA 6729 Academy Road NE, Suite D Albuquerque, NM 87109
BP America Production P O Box 277897 Atlanta, GA 30384	Energen Resources Corp 605 Richard Arrington Jr Blvd North Birmingham, AL 35203-2707	Marcia L Berger Educational Foundation C/O Petroleum Asset Management LLC Agent P O Box 745 Hobbs, NM 88241
Potenziani Family Partnership Frank A Potenziani P O Box 676370 Rancho Santa Fe, CA 92067-6370	R B Nielsen Trust 1200 Danbury Drive Mansfield, TX 76063	Robert Umbach Cancer Foundation Zia Data Search Corporation, Agent P O Box 2188 Roswell, NM 88202-2188
WWR Enterprises C/O Petroleum Asset Management P O Box 745 Hobbs, NM 88241	Elliott A Riggs P O Box 711 Farmington, NM 87499	Adelante Oil & Gas LLC PO Box 2471 Durango, CO 81302
Columbine II Limited Partnership P O Box 22854 Denver, CO 80222	Dennis R Reimers & Teresa M Reimers 1594 Cactus Drive Bayfield, CO 81122	Dr Charles A McAdams, MD 1912 Cindy Lane Denton, TX 76201



United States Department of the Interior

BUREAU OF LAND MANAGEMENT

Farmington Field Office
1235 La Plata Highway, Suite A
Farmington, New Mexico 87401

IN REPLY REFER TO
3162 7-3
North Dufers Point CDP

Merrion Oil and Gas
Attn: Connie Dinning
610 Reilly Avenue
Farmington, New Mexico 87401

SEP - 9 1999

Dear Ms. Dinning

Reference is made to your application for surface commingling and off-lease measurement and sales of gas and associated liquid hydrocarbons from the North Dufers Point/Crow Mesa Central Delivery Point (CDP). You propose to measure production at the El Paso Field Services meter No. 97133 at the following location:

SWSW section 6, T. 25N., R. 8W., Rio Arriba County, New Mexico.

Your application indicates that measurement at a central delivery point is necessary to effectively and economically operate these wells and extend the economic life of the properties. We have reviewed your application and the supplemental information you supplied and concur with these findings. As such, you are hereby authorized to measure natural gas and associated liquid hydrocarbons in accordance with the procedures outlined in your application. The following are conditions of this approval:

- Allocation methodology must be made on an MMBTU basis. By January 1, 2000, file a report of wellhead versus allocated volumes and MMBTUs for each well under this approval. This report must include the previous three months of production for our review.
- Measurement of gas and associated liquid hydrocarbons at the CDP must be conducted in accordance with the requirements outlined in Onshore Order No. 3, Site Security, Onshore Order No. 4, Oil Measurement, and Onshore Order No. 5, Gas Measurement.
- In order to prevent waste and conserve natural gas, periodic review of each well's venting procedures must be conducted in accordance with the requirements outlined in NTL-ADO-93-1.
- No other wells can be added to this system of measurement without the prior approval of this office.
- Contact this office in the event of any lost hydrocarbons between the wells and the central delivery point.

Failure to operate this facility in accordance with the conditions outlined above may subject this approval to revocation. In addition, this office reserves the right to rescind this approval should future evaluation of this method of measurement indicate that federal royalties would be reduced.

Attached is a list of the wells recognized as contributing to the North Dufers Point/Crow Mesa CDP. If you have any questions regarding the above, contact Jim Lovato at (505) 599-6367.

Sincerely,

Errol Becher
Acting Team Leader, Petroleum Management Team

Attachment (List of Contributing wells)

cc FIMO

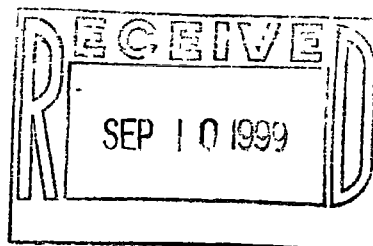

Merrion Oil & Gas
CPD -North Dufers Point # 97133

REQUEST FOR APPROVAL TO ADD:
Logos 2508 20D #15 operated by Logos
TO THE EXISTING COMBINED
OFF LEASE PRODUCTION

1

Merrion Oil & Gas Corporation hereby requests approval to add the Logos 2508 20D # 15 to the existing North Dufers CPD # 97133 approved 9/9/1999, in San Juan County, New Mexico.

A description of the existing system, including the mechanical components, flowline routing and allocation methods is enclosed.

List of attachments:

1. Formal Request to add the Logos 2508 20D # 15
2. List of all wells and connection date to CPD
3. Description of Current Operations, including pipe specs and meter calibration information.
4. Area Map - Individual well locations and compressor station location.
5. Schematic Diagram
6. Estimated monthly production
7. Summary report (Table B)
 - a. Gas Analysis Reports for sample months
 - b. Meter Inspection Reports
 - c. Chart Integration Reports
 - d. The individual well integration statements on the Federal A tank Battery are not available as products are allocated based on test information from the meter located at the Battery.
8. Measurement and Allocation methods and formulas
 - a. Beneficial Fuel Usage Calculations
 - b. Estimated Vented Volumes for Gas Wells
9. Evidence of Proper Allocation
10. Economic Evaluations
11. Signature Page for Participating Operators.

Merrion Oil & Gas
CPD –North Dufers Point # 97133

#2 List of All Wells and Connection Date to the CPD

Well	API	Lease	Lline N/S	Lline E/W	Sec	TNSP	RNG	Lat	Long	Meter #	Connected to CPD
CPD Meter										97-133	
Federal A2	30-045-26536	NMNM14580A	940S	790E	11	24-N	8-W	N36°19.432'	W107°38.733'	Chart	1/1/1992
Federal A3	30-045-26525	NMNM14580A	2270N	790E	10	24-N	8-W	N36.329242	W107.663444	Chart	1/1/1992
Federal A1	30-045-22225	NMNM14580A	970S	1700E	10	24-N	8-W	N36°19.444'	W107°39.955'	Chart	1/1/1992
Jalapeno 1	30-045-25580	State	790N	1650W	16	25-N	8-W	N36°24.358'	W107°41.439'	Chart	1/1/1992
Roadrunner 1	30-045-25579	State	2310N	330W	2	24-N	8-W	N36°20.628'	W107°39.593'	Chart	1/1/1992
Shoofly 1	30-045-26133	NMNM16589	790N	1650W	14	24-N	8-W	N36°19.141'	W107°39.291'	Chart	1/1/1992
Shoofly 2	30-045-26322	NMNM16589	970N	790E	15	24-N	8-W	N36°19.115'	W107°39.790'	Chart	1/1/1992
Stephenson 2	30-045-25931	NMSF078475	1960S	660E	7	25-N	8-W	N36°24.814'	W107°42.985'	Chart	1/1/1992
Stephenson 3	30-045-25985	NMSF078475	1980S	1980W	8	25-N	8-W	N36°24.816'	W107°42.442'	Chart	1/1/1992
Stephenson 4	30-045-25986	NMSF078475	1660S	1980E	8	25-N	8-W	N36°24.600'	W107°42.173'	Chart	1/1/1992
Wagon Train 1	30-045-25912	NMNM54982	1750S	820E	6	25-N	8-W	N36°25.637'	W107°42.996'	Chart	1/1/1992
Warito 1	30-045-25376	NOOC14205008	790N	1810E	7	25-N	8-W	N36°25.233'	W107°43.216'	Chart	1/1/1992
Wild Hare 1	30-045-26014	NMNM47167	970N	970W	11	24-N	8-W	N36°19.973'	W107°39.461'	Chart	1/1/1992
SOB Federal 1	30-045-25927	NMNM47169	1850N	990W	8	25-N	8-W	N36°25.056'	W107°42.649'	Chart	1/1/1992
Horsefly 1	30-045-26310	NMNM014580	790S	790W	11	24-N	8-W	N36°19.400'	W107.39.471'	Chart	1/1/1992
Yucca Com 1	30-045-26584	State	1850N	790E	2	25-N	9-W	N36°25.942'	W107°45.157'	Chart	1/1/1992
Keeling #1	30-045-05299	NMSF078474	990N	1750E	20	25-N	8-W	N36.390934	w-107.7019274	Chart	

Red indicates Crow Mesa Area (T24N R8W), all others (T25N R8/9W) are North Dufers Point Area

Merrion Oil & Gas
CPD -North Dufers Point # 97133

3 DESCRIPTION OF CURRENT OPERATIONS

The North Dufers Point, Crow Mesa compressor station began operation in early 1992. All of the wells that are currently behind the CPD were connected to the compressor at that time. A list of the wells that are currently connected to the CPD are attached. There are currently 17 wells which produce to this CPD, and they are all in the Dufers Point Gallup/Dakota pool except for the Federal A2, which is in the Escrito Gallup pool. The wells on the north end of the line (T25N R8/9W) are designated as the North Dufers Point area. The wells on the southern end of the line (T24N R8W) are in the Crow Mesa Area.

The gathering system for all the lines consists of several different piping configurations and sizes. The specifics are listed in attachment # 5. The routing of the flowlines is shown on the attached topographic and survey maps in attachments # 5.

The compressor takes suction from the gathering system at 60-70 psig. There is an NGL scrubber on the compressor skid. Liquid from the scrubber flows to a 400 bbl storage tank. Any water in the NGL stream is drained off the tank to a fiberglass pit. The gas is compressed by a Serico Industries Model 496 single stage compressor with a GM 496 engine rated at 125 BHP at 1500 RPM. The compressed gas is cooled, then metered by Enterprise Field Services.

Each well has a separator and an oil tank. Purging of liquids from the line is not necessary because liquids are removed at the individual well sites.

There is one well on an automatic vent system. If any well is vented due to an upset condition, this is reported by field personnel. The time of venting is recorded and volumes are calculated based on attachment # 8b. Beneficial usage calculations are shown on attachment # 8a.

The compression facility is located in the southeast corner of S1, T25N, R9W as shown on attachment # 4a Topo's, Surveys, Area Maps & Drawings. The schematic showing the equipment at the central compressor is also in # 4a.

Merrion Oil & Gas
CPD -North Dufers Point # 97133

Pipe Specifications and Mechanical Integrity Testing

The right of way for the gathering system was approved by the BLM on January 25th 1990. The main line connecting the Crow Mesa and North Dufers point wells is a buried steel line, 6 5/8" OD, 0.156" wall thickness with welded connections. There was some x-ray work performed, but the files do not show a percentage of wells x-rayed. The line was pressure tested to 900 psig overnight at the time of construction.

The North Dufers Point wells connect the main line via a 4" line that was originally constructed by El Paso Natural Gas Company. The Jalapeno was connected at a later date by a 3" steel surface line, pressure tested to 300 psi. The Yucca Com # 1 was also connected via a 3" buried steel line pressure tested to 500 psi. This portion of the line operates at about 60 psi.

The new pipe is SDR11-HDS800, rated at 160 psi for natural gas service. It will be tested with natural gas to 150 psi. **The line will operate at 100 psi or less.** The MAOP will be 150 psig.

Meter Calibration and Gas Analysis Schedule

The sales meter is calibrated quarterly in February, May, August and November. Gas samples are collected from the metering point in February and August. Gas production from individual wells is analyzed quarterly by AWC, Gas Analysis. Wellsite check meters, property of Merrion Oil & Gas, are calibrated on a quarterly basis.

Merrion Oil & Gas
CPD -North Dufers Point # 97133

4 AREA MAP

The area is shown on the topo locator maps for wells and flowline to the CPD.

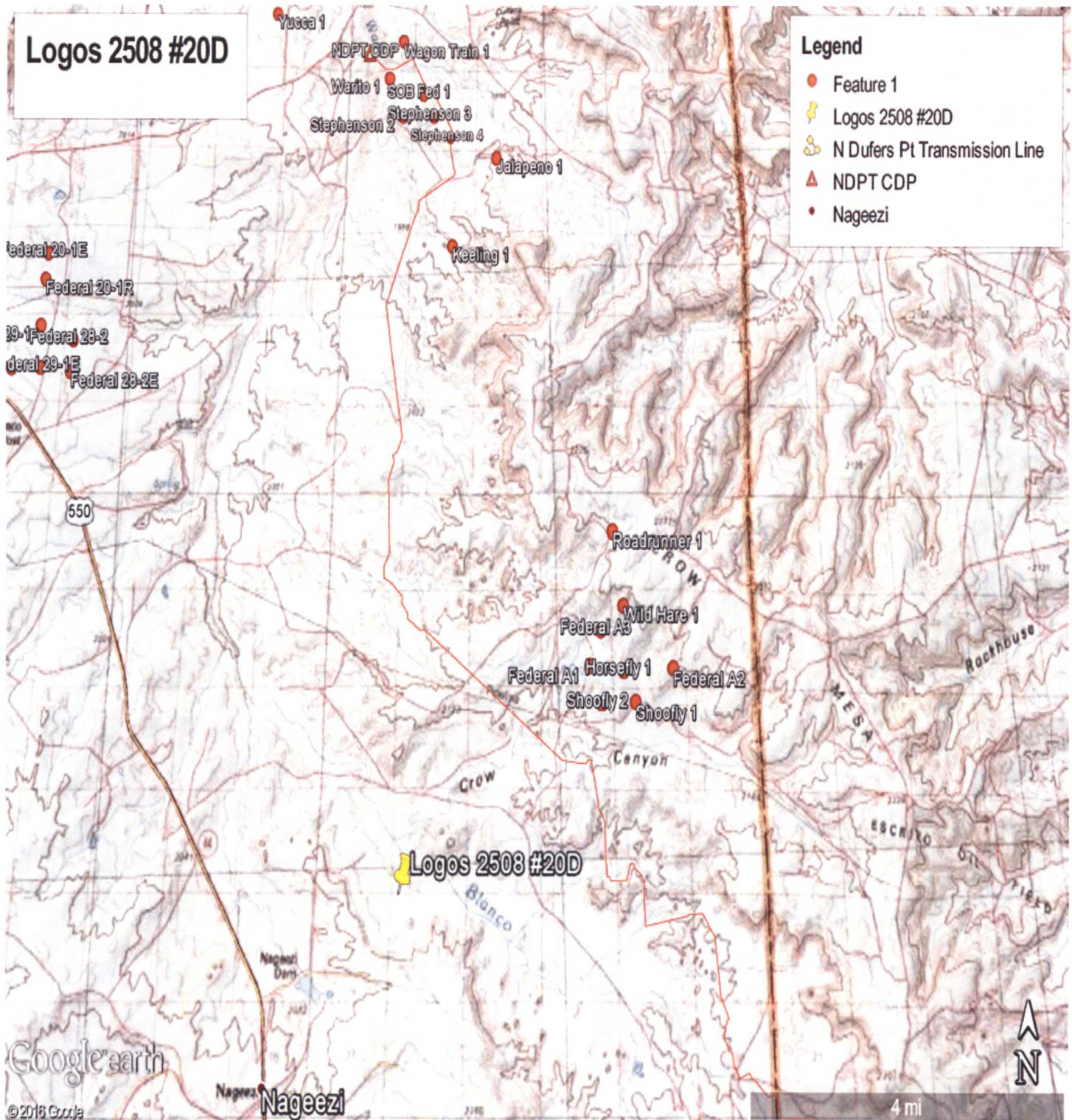



www.delorme.com

$$1'' = 1.78 \text{ mi}$$

Data Zoom 11-0

NEW MEXICO OIL CONSERVATION COMMISSION
WELL LOCATION AND ACREAGE DEDICATION PLAT

Form C-102
Supersedes C-128
Effective 1-1-65

All distances must be from the center boundaries of the Section.

Owner Merrion Oil & Gas Corporation			Lease FEDERAL "A"		Well No. 1
Section 0	Section 10	Township 24 NORTH	Range 8 WEST	County San Juan	
Actual Footage Location of Well					
970 feet from the SOUTH line and		1700 feet from the EAST line			
Surface Level Elev. 5842.6987	Producing Formation GALLUP	Pool Dufers Point Gallup-Dakota		Dedicated Acreage 160	Acres

1. Outline the acreage dedicated to the subject well by colored pencil or hatchure marks on the plat below.
2. If more than one lease is dedicated to the well, outline each and identify the ownership thereof (both as to working interest and royalty).
3. If more than one lease of different ownership is dedicated to the well, have the interests of all owners been consolidated by communitization, unitization, force-pooling, etc?

☐ Yes ☐ No If answer is "yes," type of consolidation _____

If answer is "no," list the owners and tract descriptions which have actually been consolidated. (Use reverse side of this form if necessary.) _____

No allowable will be assigned to the well until all interests have been consolidated (by communitization, unitization, forced-pooling, or otherwise) or until a non-standard unit, eliminating such interests, has been approved by the Commission.

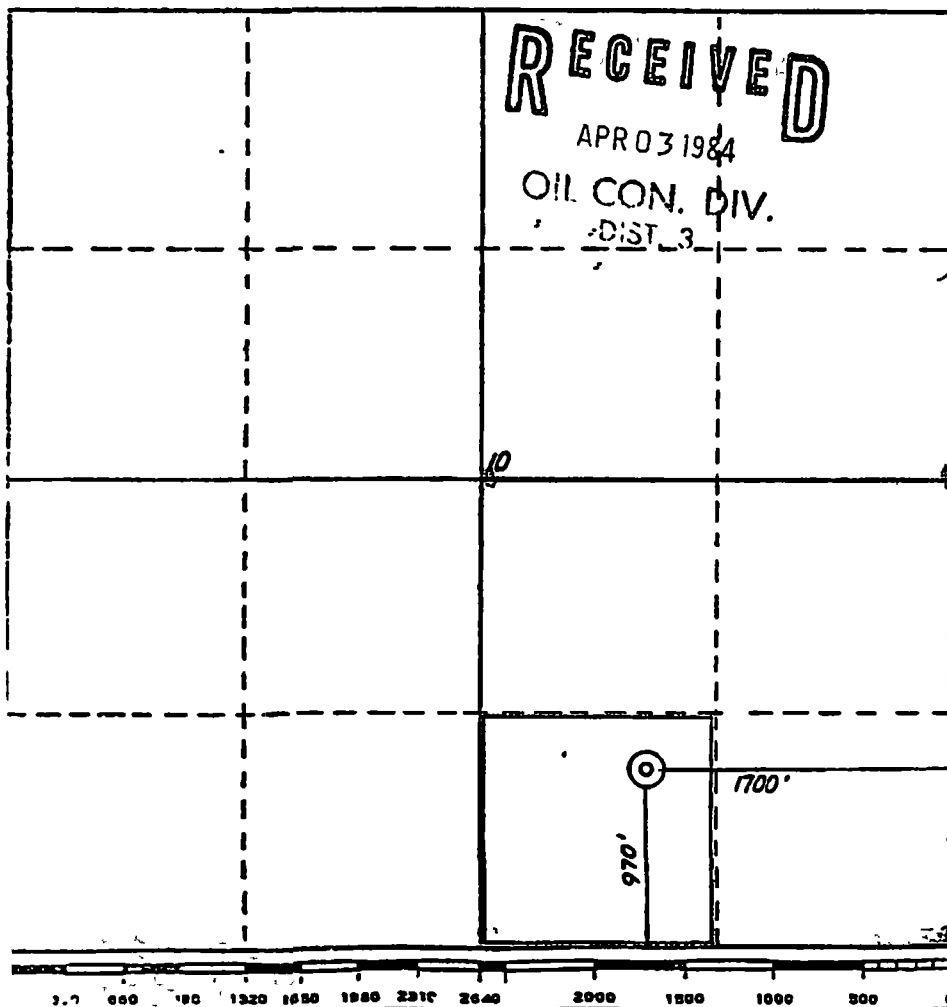

CERTIFICATION

I hereby certify that the information contained herein is true and complete to the best of my knowledge and belief.

Name

Steve S. Dunn

Position

Operations Manager

Company

Merrion Oil & Gas Corp.

Date

3/8/84

I hereby certify that the well location shown on this plat was plotted from field notes of actual surveys made by me or under my supervision, and that the same is true and correct to the best of my knowledge and belief.

10-12-1976

Date Surveyed

James P. Lease

Registered Professional Engineer and/or Land Surveyor

Certificate No.

1463

All distances must be from the outer boundaries of the Section.

Operator MERRION OIL & GAS CORPORATION			Lease JALAPENO		Well No. 1
Unit Letter C	Section 16	Township 25N	Range 8W	County San Juan	
Actual Footage Location of Wells: 790 feet from the North line and 1650 feet from the West line					
Ground Level Elev. 6589	Producing Formation Dakota		Pool Dufers Point Gallup Dakota		Dedicated Acreage 160 Acres

1. Outline the acreage dedicated to the subject well by colored pencil or hatchure marks on the plat below.
2. If more than one lease is dedicated to the well, outline each and identify the ownership thereof (both as to working interest and royalty).
3. If more than one lease of different ownership is dedicated to the well, have the interests of all owners been consolidated by communitization, unitization, force-pooling, etc?

☐ Yes ☒ No If answer is "yes," type of consolidation _____

If answer is "no," list the owners and tract descriptions which have actually been consolidated. (Use reverse side of this form if necessary.) _____

No allowable will be assigned to the well until all interests have been consolidated (by communitization, unitization, forced-pooling, or otherwise) or until a non-standard unit, eliminating such interests, has been approved by the Commission.

	<p>RECEIVED MAR 29 1984 OIL CON. DIV. DIST. 3</p>
	<p>State Sec.</p>
<p>16</p> <p>RECEIVED FEB 14 1983 OIL CON. DIV. DIST. 3</p>	

CERTIFICATION

I hereby certify that the information contained herein is true and complete to the best of my knowledge and belief.

Steve S. Dunn
Name

Steve S. Dunn

Position

Operations Manager

Company

Merrion Oil & Gas Corporation

Date

3/8/84

I hereby certify that the well location shown on this plat was plotted from field notes of actual surveys made by me or under my supervision, and that the same is true and correct to the best of my knowledge and belief.

Fred B. Kerr Jr.
Date Surveyed

December 13, 1982

Registered Professional Engineer
and Land Surveyor

Fred B. Kerr Jr.
Fred B. Kerr Jr.

Certificate No. **1111**

All distances must be from the outer boundaries of the Section.

Operator MERRION OIL & GAS CORPORATION		Lease SHOO FLY		Well No. 2
Well Letter A	Section 15	Township 24N	Range 8W	County San Juan
Actual Footage Location of Wells				
970	feet from the	North	line and	790
				feet from the
				East
				line
Ground Level Elev 6954	Producing Formation Gallup		Pool Dufers Point Gallup Dakota	Dedicated Acreage 160
				Acre

1. Outline the acreage dedicated to the subject well by colored pencil or hatchure marks on the plat below.
2. If more than one lease is dedicated to the well, outline each and identify the ownership thereof (both as to working interest and royalty).
3. If more than one lease of different ownership is dedicated to the well, have the interests of all owners been consolidated by communitization, unitization, force-pooling, etc?

☐ Yes ☐ No If answer is "yes," type of consolidation _____

If answer is "no," list the owners and tract descriptions which have actually been consolidated. (Use reverse side of this form if necessary.) _____

No allowable will be assigned to the well until all interests have been consolidated (by communitization, unitization, forced-pooling, or otherwise) or until a non-standard unit, eliminating such interests, has been approved by the Commission.

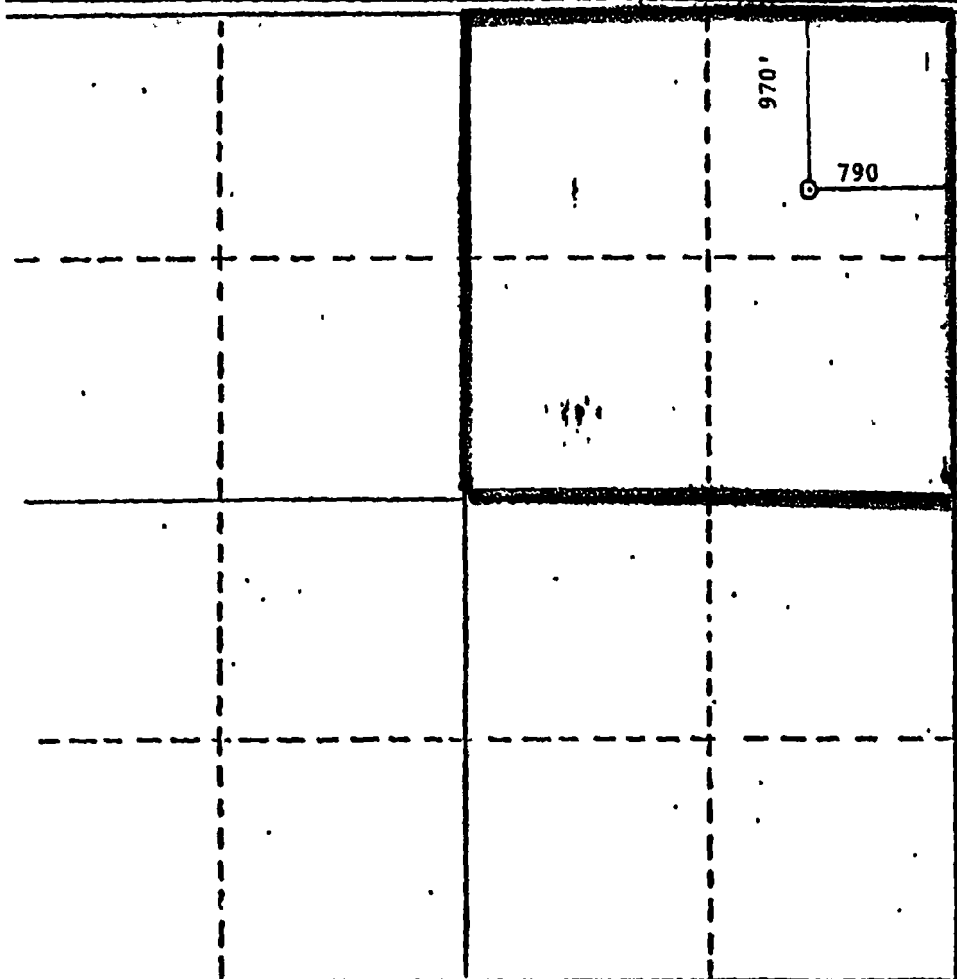

CERTIFICATION

I hereby certify that the information contained herein is true and complete to the best of my knowledge and belief.

Steve S. Dunn

Steve S. Dunn

Position

Operations Manager

Company

Merrion Oil & Gas Corporation

Date

6/24/85

I hereby certify that the well location shown on this plat was plotted from field notes of actual surveys made by me or under my supervision, and that the same is true and correct to the best of my knowledge and belief.

Date Surveyed

Mar 1985

Registered Professional Engineer

and

Filed

6/24/85

Certified by

All distances must be from the outer boundaries of the Section

Operator MERRION OIL & GAS CORPORATION			Lease STEVENSON		Well No. 2
Unit Letter I	Section 7	Township 25N	Range 8W	County San Juan	
Actual Footage Location of Well: 1060 feet from the South line and 660 feet from the East line					
Ground Level Elev. 6420	Producing Formation Gallup/Dakota		Pool Dufers Point Gallup Dakota		Dedicated Acreage: 160 Acres

1. Outline the acreage dedicated to the subject well by colored pencil or hatchure marks on the plat below.
2. If more than one lease is dedicated to the well, outline each and identify the ownership thereof (both as to working interest and royalty).
3. If more than one lease of different ownership is dedicated to the well, have the interests of all owners been consolidated by communitization, unitization, force-pooling, etc?

☐ Yes ☐ No If answer is "yes," type of consolidation _____

If answer is "no," list the owners and tract descriptions which have actually been consolidated. (Use reverse side of this form if necessary.) _____

No allowable will be assigned to the well until all interests have been consolidated (by communitization, unitization, forced-pooling, or otherwise) or until a non-standard unit, eliminating such interests, has been approved by the Commission.

Sec.	RECEIVED MAY 21 1984 BUREAU OF LAND MANAGEMENT FARMINGTON RESOURCE AREA
	7 660' 1060' SF 078475

Scale: 1"=1000'

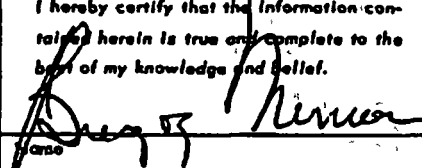
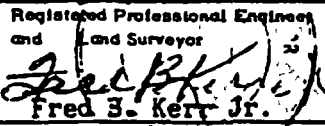
CERTIFICATION	
I hereby certify that the information contained herein is true and complete to the best of my knowledge and belief.	
	
J. Gregory Merrion	
Position President	
Company Merrion Oil & Gas Corp.	
Date 5/16/84	
I hereby certify that the well location shown on this plat was plotted from field notes of actual surveys made by me or under my supervision, and that the same is true and correct to the best of my knowledge and belief.	
Date Surveyed May 2, 1984	
Registered Professional Engineer and Land Surveyor  Fred B. Kerr Jr.	
Certificate No. 3950	

OIL CONSERVATION DIVISION

STATE OF NEW MEXICO
ENERGY AND MINERALS DEPARTMENT

P. O. BOX 2068
SANTA FE, NEW MEXICO 87501

Form C-102
Revised 10-1-78

All distances must be from the corner boundaries of the Section.

Operator MERRION OIL & GAS CORPORATION			Lease STEPHENSON		Well No. 3
Unit Letter K	Section 8	Township 25N	Range 8W	County San Juan	
Actual Footage Location of Well:					
1980 feet from the South		line and 1980 feet from the West		line	
Ground Level Elev. 6501	Producing Formation Gallup/Dakota		Pool Dufers Point Gallup Dakota		Dedicated Acreage: 160 Acres

1. Outline the acreage dedicated to the subject well by colored pencil or hatchure marks on the plat below.
2. If more than one lease is dedicated to the well, outline each and identify the ownership thereof (both as to working interest and royalty).
3. If more than one lease of different ownership is dedicated to the well, have the interests of all owners been consolidated by communitization, unitization, force-pooling, etc?

☐ Yes ☐ No If answer is "yes," type of consolidation _____

If answer is "no," list the owners and tract descriptions which have actually been consolidated. (Use reverse side of this form if necessary.) _____

No allowable will be assigned to the well until all interests have been consolidated (by communitization, unitization, forced-pooling, or otherwise) or until a non-standard unit, eliminating such interests, has been approved by the Commission.

RECEIVED

JUN 01 1984

OIL CON. DIV.

DIST. 3

8

1980'

1980'

Sec.

SF 078475

Scale: 1"=1000'

CERTIFICATION

I hereby certify that the information contained herein is true and complete to the best of my knowledge and belief.

Steve S. Dunn

Name
Steve S. Dunn

Position
Operations Manager

Company
Merrion Oil & Gas Corporation

Date
4/24/84

I hereby certify that the well location shown on this plat was plotted from field notes of actual surveys made by me or under my supervision, and that the same is true and correct to the best of my knowledge and belief.

Date Surveyed
April 4, 1984

Registered Professional Engineer and Land Surveyor

Fred B. Kerr Jr.

Certificate No. **3950**

All distances must be from the outer boundaries of the Section.

Operator MERRION OIL & GAS CORPORATION			Lease STEPHENSON		Well No. 1
Unit Letter 0	Section 8	Township 25N	Range 8W	County San Juan	
Actual Footage Location of Wells: 660 feet from the South line and 1980 feet from the East line					
Ground Level Elev. 6517	Producing Formation Gallup/Dakota		Pool Dufers Point Gallup Dakota		Dedicated Acreage 160 Acres

1. Outline the acreage dedicated to the subject well by colored pencil or hatchure marks on the plat below.
2. If more than one lease is dedicated to the well, outline each and identify the ownership thereof (both as to working interest and royalty).
3. If more than one lease of different ownership is dedicated to the well, have the interests of all owners been consolidated by communitization, unitization, force-pooling, etc?

☐ Yes ☐ No If answer is "yes," type of consolidation _____

If answer is "no," list the owners and tract descriptions which have actually been consolidated. (Use reverse side of this form if necessary.) _____

No allowable will be assigned to the well until all interests have been consolidated (by communitization, unitization, forced-pooling, or otherwise) or until a non-standard unit, eliminating such interests, has been approved by the Commission.

		<p>RECEIVED JUN 01 1984 OIL CON. DIV. DIST. 3</p>	
<p>Sec.</p>		<p>8</p>	
		<p>SF 07B475</p>	
		<p>1980'</p>	
		<p>660'</p>	

Scale: 1"=1000'

CERTIFICATION	
I hereby certify that the information contained herein is true and complete to the best of my knowledge and belief.	
<p><i>Steve S. Dunn</i></p> <p>Name Steve S. Dunn</p> <p>Position Operations Manager</p> <p>Company Merrion Oil & Gas Corp.</p> <p>Date 5/1/84</p>	
I hereby certify that the well location shown on this plat was plotted from field notes of actual surveys made by me or under my supervision, and that the same is true and correct to the best of my knowledge and belief.	
<p>Date Surveyed April 1, 1984</p> <p>Registered Professional Engineer and Land Surveyor <i>Fred B. Kerr Jr.</i> Fred B. Kerr Jr.</p> <p>Certificate No. 3950</p>	

All distances must be from the outer boundaries of the Section.

Operator MERRION OIL & GAS CORPORATION			Lease WAGON TRAIN		Well No. 1
Unit Letter I	Section 6	Township 25N	Range 8W	County San Juan	
Actual Footage Location of Well: 1750 feet from the South line and 820 feet from the East line					
Ground Level Elev. 6386	Producing Formation Gallup/Dakota		Pool Dufers Point Gallup Dakota		Dedicated Acreage 160 Acres

1. Outline the acreage dedicated to the subject well by colored pencil or hatchure marks on the plat below.
2. If more than one lease is dedicated to the well, outline each and identify the ownership thereof (both as to working interest and royalty).
3. If more than one lease of different ownership is dedicated to the well, have the interests of all owners been consolidated by communitization, unitization, force-pooling, etc?

☐ Yes ☐ No If answer is "yes," type of consolidation _____

If answer is "no," list the owners and tract descriptions which have actually been consolidated. (Use reverse side of this form if necessary.) _____

No allowable will be assigned to the well until all interests have been consolidated (by communitization, unitization, forced-pooling, or otherwise) or until a non-standard unit, eliminating such interests, has been approved by the Commission.

<p>RECEIVED MAR 09 1984 OIL CON. DIV. DIST. 3</p>		<p>RECEIVED OIL CON. DIV. DIST. 3</p>	
		<p>Sec.</p>	
<p>6</p>		<p>820'</p>	
		<p>NM 54982</p>	
<p>1750'</p>		<p>1750'</p>	

Scale: 1"=1000'

<p>CERTIFICATION</p>	
<p>I hereby certify that the information contained herein is true and complete to the best of my knowledge and belief.</p>	
<p><i>Steve S. Dunn</i></p>	
<p>Name Steve S. Dunn</p>	
<p>Position Operations Manager</p>	
<p>Company Merrion Oil & Gas Corporation</p>	
<p>Date 12/21/83</p>	
<p>I hereby certify that the well location shown on this plat was plotted from field notes of actual surveys made by me or under my supervision, and that the same is true and correct to the best of my knowledge and belief.</p>	
<p>Date Surveyed December 13, 1983</p>	
<p>Registered Professional Engineer and Land Surveyor <i>Fred E. Kerr Jr.</i> Fred E. Kerr Jr.</p>	
<p>Certificate No. 3950</p>	

Distances must be from the corner boundaries of the section

Operator MERRION OIL & GAS INCORPORATED			Lease Warito		Well No. No. 1
Unit Letter 3	Section 7	Township 25N	Range 8W	County San Juan	
Actual Footage Location of Well:					
790 feet from the North line and		1810 feet from the East line			
Ground Level Elev. 6341	Producing Formation Dakota/Gallup		Pool Dufers Point Gallup Dakota		Dedicated Acreage 160

1. Outline the acreage dedicated to the subject well by colored pencil or hatchure marks on the plat below.
2. If more than one lease is dedicated to the well, outline each and identify the ownership thereof (both as to well interest and royalty).
3. If more than one lease of different ownership is dedicated to the well, have the interests of all owners been consolidated by communitization, unitization, force-pooling, etc?

☐ Yes ☐ No If answer is "yes," type of consolidation _____

If answer is "no," list the owners and tract descriptions which have actually been consolidated. (Use reverse side of this form if necessary.) _____

No allowable will be assigned to the well until all interests have been consolidated (by communitization, unitization, force-pooling, or otherwise) or until a non-standard unit, eliminating such interests, has been approved by the Commission.

RECEIVED
APR 02 1984
OIL CON. DIV.
DIST. 3

NCO-C-5007	Sec.	NCO-C-5008	7
------------	------	------------	---

CERTIFICATION

I hereby certify that the information contained herein is true and complete to the best of my knowledge and belief.

Steve S. Dunn
Name

Steve S. Dunn

Position

Operations Manager

Company

Merrion Oil & Gas Corp

Date

3/28/84

I hereby certify that the well is shown on this plat was plotted from notes of actual surveys made by me under my supervision, and that this is true and correct to the best of my knowledge and belief.

Date Surveyed

March 1984

Registered Professional Engineer and/or Land Surveyor

Fred E. Kerr Jr.
Fred E. Kerr Jr.

Certificate No.

All distances must be from the outer boundaries of the Section.

Operator MERRION OIL & GAS COMPANY			Lease ROADRUNNER		Well No. 1
Unit Letter E	Section 2	Township 24N	Range 8W	County San Juan	
Actual Footage Location of Well: 2310 feet from the North line and 330 feet from the West line					
Ground Level Elev. 7183	Producing Formation Dakota		Pool Dufers Point Gallup Dakota		Dedicated Acreage 160 Acres

1. Outline the acreage dedicated to the subject well by colored pencil or hatchure marks on the plat below.
2. If more than one lease is dedicated to the well, outline each and identify the ownership thereof (both as to working interest and royalty).
3. If more than one lease of different ownership is dedicated to the well, have the interests of all owners been consolidated by communitization, unitization, force-pooling, etc?

☐ Yes ☐ No If answer is "yes," type of consolidation _____

If answer is "no," list the owners and tract descriptions which have actually been consolidated. (Use reverse side of this form if necessary.) _____

No allowable will be assigned to the well until all interests have been consolidated (by communitization, unitization, forced-pooling, or otherwise) or until a non-standard unit, eliminating such interests, has been approved by the Commission.

Scale: 1"=1000'

CERTIFICATION	
I hereby certify that the information contained herein is true and complete to the best of my knowledge and belief.	
Name	Steve S. Dunn
Position	Operations Manager
Company	Merrion Oil & Gas Corp.
Date	3/7/84
I hereby certify that the well location shown on this plat was plotted from field notes of actual surveys made by me or under my supervision, and that the same is true and correct to the best of my knowledge and belief.	
Date Surveyed	March 1, 1984
Registered Professional Engineer and Land Surveyor	Fred E. Kerr Jr.
Certificate No.	3950

NO. OF COPIES RECEIVED	
DISTRIBUTION	
SANTA FE	
FILE	
U.S.G.S.	
LAND OFFICE	
OPERATOR	

NEW MEXICO OIL CONSERVATION COMMISSION

Form C-101
Revised 1-1-83 30-043-25579

RECEIVED
FEB 8 1983

APPLICATION FOR PERMIT TO DRILL, DEEPEN OR PLUG BACK

1a. Type of Work b. Type of Well OIL WELL <input checked="" type="checkbox"/> GAS WELL <input type="checkbox"/> OTHER <input type="checkbox"/> DEEPEN <input type="checkbox"/> PLUG BACK <input type="checkbox"/> SINGLE ZONE <input checked="" type="checkbox"/> MULTIPLE ZONE <input type="checkbox"/>		5a. Indicate Type of Lease STATE <input checked="" type="checkbox"/> FEDERAL <input type="checkbox"/> 5. State Oil & Gas Lease No. LG 1916
2. Name of Operator Merrion Oil & Gas Corporation		7. Unit Agreement Name
3. Address of Operator P. O. Box 1017, Farmington, New Mexico 87499		8. Farm or Lease Name Roadrunner
4. Location of Well UNIT LETTER F LOCATED 1850 FEET FROM THE North LINE AND 1660 FEET FROM THE West LINE OF SEC. 2 TWP. 24N REG. 8W NMPM		9. Well No. 1
10. Field and Pool, or Wildcat Dufos Point Gal-Dak		11. County San Juan
19. Proposed Depth 7200'		19A. Formation Dakota
20. Rotary or C.T. Rotary		21. Elevations (Show whether DF, RT, etc.) 7241 GL
21A. Kind & Status Plug. Bond		21B. Drilling Contractor Undesignated
22. Approx. Date Work will start 2nd Quarter, 1983		

23.

PROPOSED CASING AND CEMENT PROGRAM

SIZE OF HOLE	SIZE OF CASING	WEIGHT PER FOOT	SETTING DEPTH	SACKS OF CEMENT	EST. TOP
12-1/4"	8-5/8"	24 #/ft.	200'	175 sx	Surface
7-7/8"	4-1/2"	11.6 #/ft.	7150'	795 sx.	Above Ojo Alamo

Propose to drill 12-1/4" hole to 200' and set 200' of 8-5/8", 24 #/ft, surface casing with 175 sx. Will drill 7-7/8" hole to TD, and run open hole logs. If appears productive, will run 4-1/2", 11.6 #/ft casing to 7200' and cement 1st Stage with 450 sx Class H 2% Gel to cover Gallup and Dakota. Second Stage with tool @ 5100' with 165 sx Class B, 2% D-79 followed by 50 sx Class H 2% gel to cover Mesa Verde. Third Stage tool @ 2650' with 70 sx Class B 2% D-79 followed by 50 sx Class H 2% gel to cover Pictured Cliffs, Fruitland, Kirtland and Ojo Alamo. Will perforate and stimulate as necessary. 10" 900 series double ram preventers will be used in drilling.

ESTIMATED TOPS

Ojo Alamo	1800'	Cliffhouse	3570'	Greenhorn	6730'
Kirtland	1925'	Menefee	3600'	Graneros	6910'
Fruitland	2340'	Pt. Lookout	4880'	Dakota	7010'
Pictured Cliffs	2550'	Mancos	5100'	TD	7200'
Lewis	2645'	Gallup	5945'		

IN ABOVE SPACE DESCRIBE PROPOSED PROGRAM; IF PROPOSAL IS TO DEEPEN OR PLUG BACK, GIVE DATA ON PRESENT PRODUCTIVE ZONE AND PROPOSED NEW PRODUCTIVE ZONE. GIVE BLOWOUT PREVENTER PROGRAM, IF ANY.

I hereby certify that the information above is true and complete to the best of my knowledge and belief.

Signed Alan Kelly Title Operations Manager Date 2/7/83

(This space for State Use)

SUPERVISOR DISTRICT # 3

FEB 13 1983

APPROVED BY Frank J. Day TITLE _____

CONDITIONS OF APPROVAL, IF ANY:

APPROVAL EXPIRES August 15, 1983
UNLESS DRILLING IS COMMENCED.
SFUD ACT CEASE MUST BE SUBMITTED
WITHIN 10 DAYS.

OPERATOR

OIL CONSERVATION DIVISION

P. O. BOX 2088

SANTA FE, NEW MEXICO 87501

Form C-107
Revised 10-1

All distances must be from the outer boundaries of the Section.

Operator MERRION OIL & GAS CORPORATION			Lease SHOO FLY		Well No. 1
Unit Letter C	Section 14	Township 24N	Range 8W	County San Juan	
Actual Footage Location of Well: 330 feet from the North line and 2170 feet from the West line					
Ground Level Elev: 6960	Producing Formation Gallup		Pool Escrito Gallup		Dedicated Acreage 80 Acres

1. Outline the acreage dedicated to the subject well by colored pencil or hatchure marks on the plat below.
2. If more than one lease is dedicated to the well, outline each and identify the ownership thereof (both as to working interest and royalty).
3. If more than one lease of different ownership is dedicated to the well, have the interests of all owners been consolidated by communitization, unitization, force-pooling, etc?

☐ Yes ☐ No If answer is "yes," type of consolidation _____

If answer is "no," list the owners and tract descriptions which have actually been consolidated. (Use reverse side of this form if necessary.) _____

No allowable will be assigned to the well until all interests have been consolidated (by communitization, unitization, forced-pooling, or otherwise) or until a non-standard unit, eliminating such interests, has been approved by the Commission.

2170'	330'	RECEIVED SEP 21 1984 BUREAU OF LAND MANAGEMENT FARMINGTON RESOURCE AREA
	Sec.	
NM 16589		

CERTIFICATION

I hereby certify that the information contained herein is true and complete to the best of my knowledge and belief.

Name Steve S. Dunn
Position Operations Manager
Company Merrion Oil & Gas Corporation
Date 9/11/84

I hereby certify that the well location shown on this plat was plotted from field notes of actual surveys made by me or under my supervision, and that the same is true and correct to the best of my knowledge and belief.

Date Surveyed September 5, 1984
Registered Professional Engineer and Land Surveyor
Fred E. Hunt Jr.
Commission No. 37

All distances must be from the outer boundaries of the Section.

Operator MERRION OIL & GAS CORPORATION			Lease WILD HARE		Well No. 1
Unit or Lot 2	Section 11	Township 24N	Range 8W	County San Juan	
Actual Footage Location of Well					
970 feet from the North line and		970 feet from the West line			
Ground Level Elev 7176	Producing Formation Gallup/Dakota	Pool Dufers Point Gallup Dakota		Dedicated Acreage 160	Acres

1. Outline the acreage dedicated to the subject well by colored pencil or hatchure marks on the plat below.
2. If more than one lease is dedicated to the well, outline each and identify the ownership thereof (both as to working interest and royalty).
3. If more than one lease of different ownership is dedicated to the well, have the interests of all owners been consolidated by communitization, unitization, force-pooling, etc?

☐ Yes ☐ No If answer is "yes," type of consolidation _____

If answer is "no," list the owners and tract descriptions which have actually been consolidated. (Use reverse side of this form if necessary.) _____

No allowable will be assigned to the well until all interests have been consolidated (by communitization, unitization, forced-pooling, or otherwise) or until a non-standard unit, eliminating such interests, has been approved by the Commission.

970'	970'	
NM 47167	Sec.	
	11	
RECEIVED		
JUL 29 1984		
M. C. DIV.		
1984		

CERTIFICATION

I hereby certify that the information contained herein is true and complete to the best of my knowledge and belief.

Steve S. Dunn

Name
Steve S. Dunn
Position
Operations Manager
Company
Merrion Oil & Gas Corporation

Date
6/13/84

I hereby certify that the well location shown on this plat was plotted from field notes of actual surveys made by me or under my supervision, and that the same is true and correct to the best of my knowledge and belief.

Date Surveyed
June 14, 1984
Registered Professional Engineer and Land Surveyor
Frank E. Kett
Cert. No. 1004

Scale: 1"=1000'

STATE OF NEW MEXICO
ENERGY AND MINERALS DEPARTMENT

U.S. CONSERVATION DIVISION
P.O. BOX 7088
SANTA FE, NEW MEXICO 87501

Form (1-10)
Revised 10-1-7

A. Distances must be from the exterior boundaries of the section.

Operator Merrion Oil & Gas Corp.			Lease SOB Fed Gas		Well No. 1
Unit Letter E	Section 8	Township 25N	Range 8W	County San Juan	
Actual Footage Location of Well: 1850 feet from the North line and 990 feet from the West line					
Ground Level Elev. 6441	Producing Formation Dakota		Pool Dufers Point Gallup Dakota		Dedicated Acreage: 40 Acres

1. Outline the acreage dedicated to the subject well by colored pencil or hatchure marks on the plat below.
2. If more than one lease is dedicated to the well, outline each and identify the ownership thereof (both as to working interest and royalty).
3. If more than one lease of different ownership is dedicated to the well, have the interests of all owners been consolidated by communitization, unitization, force-pooling, etc?

☒ Yes ☐ No If answer is "yes," type of consolidation will be communitized

If answer is "no," list the owners and tract descriptions which have actually been consolidated. (Use reverse side of this form if necessary.)

No allowable will be assigned to the well until all interests have been consolidated (by communitization, unitization, forced-pooling, or otherwise) or until a non-standard unit, eliminating such interests, has been approved by the Commission.

CERTIFICATION

I hereby certify that the information contained herein is true and complete to the best of my knowledge and belief.

Name

Steve S. Dunn

Position

Operations Manager

Company

Merrion Oil & Gas Corp.

Date

4/6/83

I hereby certify that the well location shown on this plat was plotted from field notes of actual surveys made by me or under my supervision, and that the same is true and correct to the best of my knowledge and belief.

Date Surveyed

March 9

Registered Professional Engineer and/or Land Surveyor

Fred E. Kerr Jr.

Certificate No.

3950

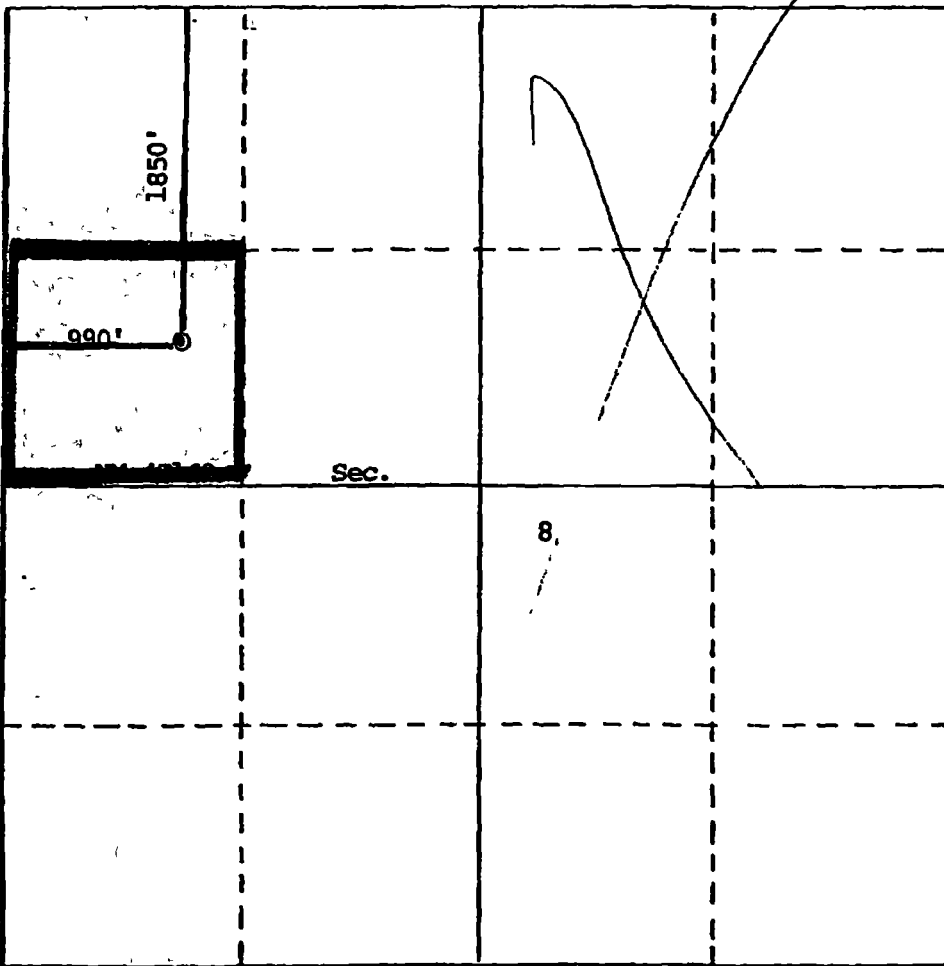

0 330 660 990 1320 1650 1980 2310 2640 2970 3300 3630 3960 4290 4620 4950 5280 5610 5940 6270 6600

OIL CONSERVATION DIVISION

STATE OF NEW MEXICO
NATURAL GAS AND MINERALS DEPARTMENT

F. O. BOX 2088

SANTA FE, NEW MEXICO 87501

Form C-107
Revised 11-

All distances must be from the outer boundaries of the Section.

Operator MERRION OIL & GAS CORPORATION			Lease Horsefly		Well No. 1
Unit Letter M	Section 11	Township 24N	Range 8W	County San Juan	
Actual Footage Location of Well: 790 feet from the South line and 790 feet from the West line					
Ground Level Elev. 7032	Producing Formation Gallup		Pool Duff's Point Escrito Gallup Gallup & Dakota		Dedicated Acreage: 80 166 Acres

1. Outline the acreage dedicated to the subject well by colored pencil or hachure marks on the plat below.
2. If more than one lease is dedicated to the well, outline each and identify the ownership thereof (both as to working interest and royalty).
3. If more than one lease of different ownership is dedicated to the well, have the interests of all owners been consolidated by communitization, unitization, force-pooling, etc?

☐ Yes ☐ No If answer is "yes," type of consolidation _____

If answer is "no," list the owners and tract descriptions which have actually been consolidated. (Use reverse side of this form if necessary.) _____

No allowable will be assigned to the well until all interests have been consolidated (by communitization, unitization, forced-pooling, or otherwise) or until a non-standard unit, eliminating such interests, has been approved by the Commission.

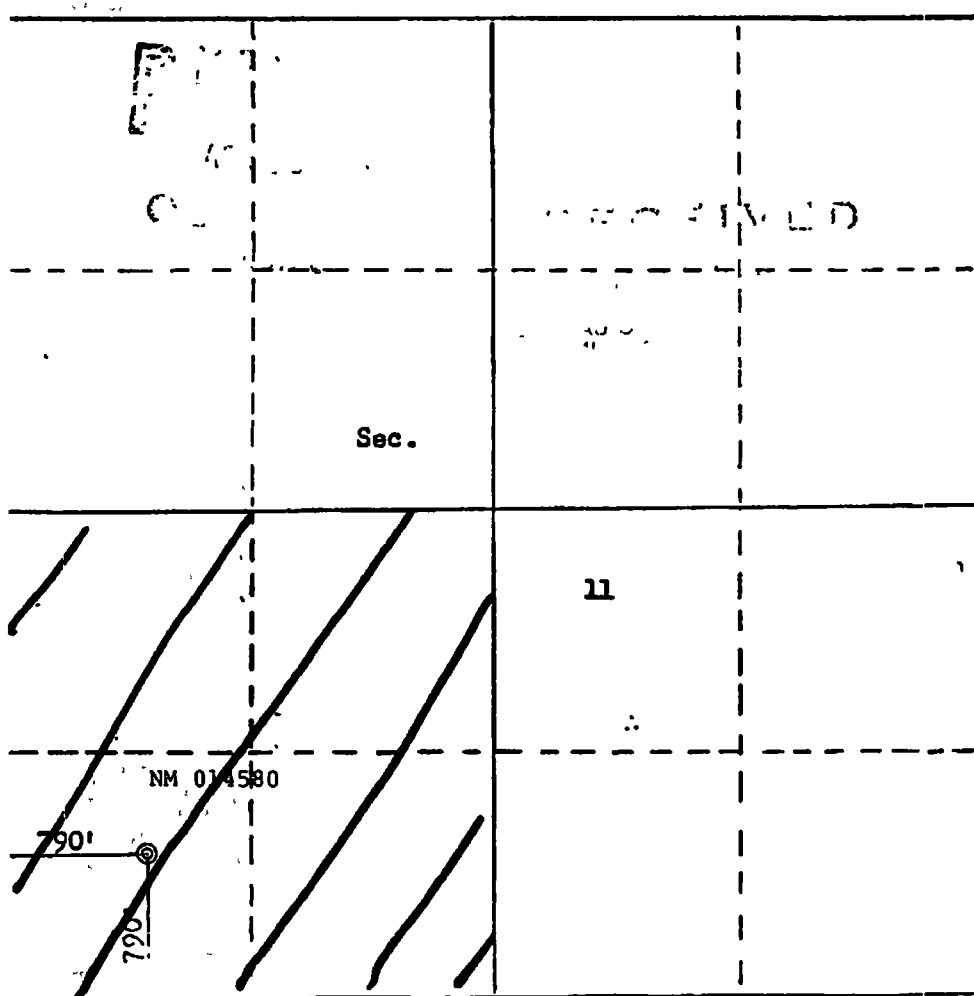

CERTIFICATION

I hereby certify that the information contained herein is true and complete to the best of my knowledge and belief.

Name

Steve S. Dunn

Position

Operations Manager

Company

Merrion Oil & Gas Corporation

Date

2/8/85

I hereby certify that the well location shown on this plat was plotted from field notes of actual surveys made by me or under my supervision, and that the same is true and correct to the best of my knowledge and belief.

Date Surveyed

February 7, 1985

Registered Professional Engineer

and Land Surveyor

Fred B. J. Jr.

New Mexico

NEW MEXICO OIL CONSERVATION COMMISSION
WELL LOCATION AND ACREAGE DEDICATION PLAT

Form C-102
Supersedes C-128
Effective 1-1-65

All distances must be from the outer boundaries of the Section

Operator MERRION OIL & GAS CORPORATION			Lease Yucca Com		Well No. 1
Unit Letter H	Section 2	Township 25N	Range 9W	County San Juan	
Actual Footage Location of Well 1850 feet from the North line and 790 feet from the East line					
Ground Level Elev 6481	Producing Formation Gallup/Dakota		Pool EXX Dufers Point Gallup Dakota		Dedicated Acreage 160.29 Acres

1. Outline the acreage dedicated to the subject well by colored pencil or hatchure marks on the plat below.
2. If more than one lease is dedicated to the well, outline each and identify the ownership thereof (both as to working interest and royalty)
3. If more than one lease of different ownership is dedicated to the well, have the interests of all owners been consolidated by communitization, unitization, force-pooling, etc?

☒ Yes ☐ No If answer is "yes," type of consolidation Communitization

If answer is "no," list the owners and tract descriptions which have actually been consolidated. (Use reverse side of this form if necessary)

No allowable will be assigned to the well until all interests have been consolidated (by communitization, unitization, forced-pooling, or otherwise) or until a non-standard unit, eliminating such interests, has been approved by the Commission.

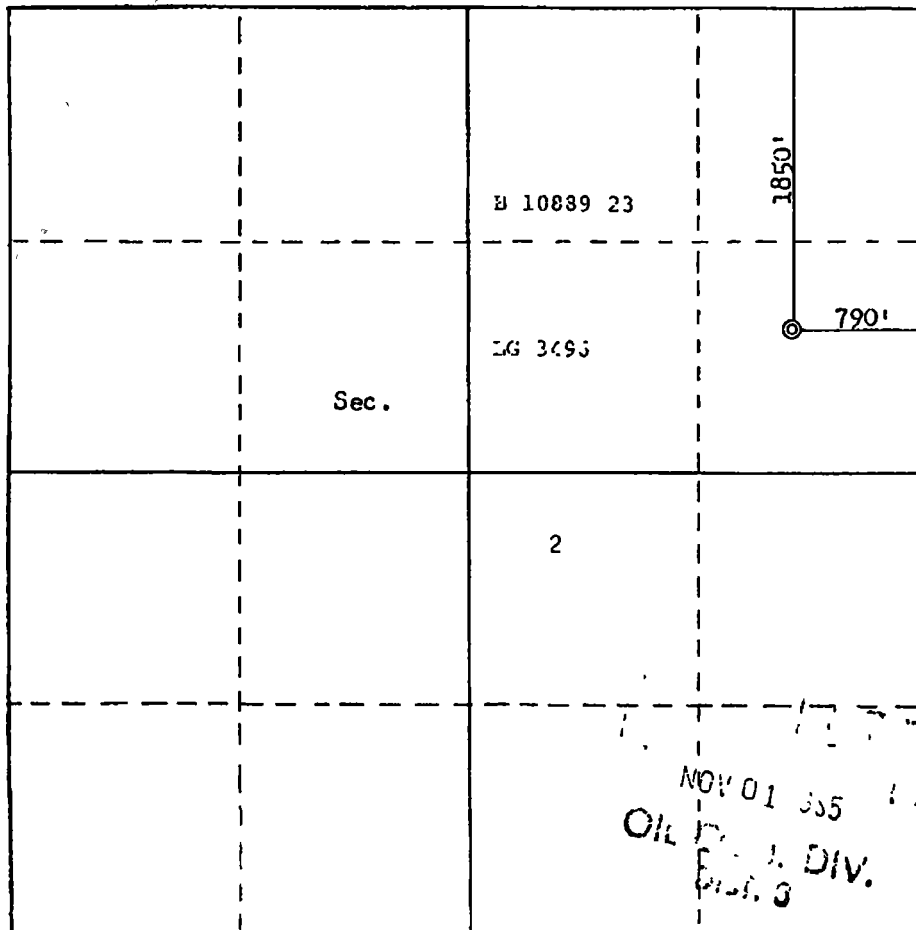

Scale: 1"=1000'

CERTIFICATION	
I hereby certify that the information contained herein is true and complete to the best of my knowledge and belief.	
<i>[Signature]</i>	
Name	Steve S. Dunn
Position	Operations Manager
Company	Merrion Oil & Gas Corporation
Date	10/30/85
I hereby certify that the well location shown on this plat was plotted from field notes of actual surveys made by me or under my supervision, and that the same is true and correct to the best of my knowledge and belief.	
Date Surveyed	October 17, 1985
Registered Professional Engineer and Land Surveyor	
<i>[Signature]</i>	
Fred R. Kerr Jr.	
3/50	

Section A

September 28, 1959

Operator **Western Natural Gas Co. et al**

C. A. Keeling Federal SF 078474

Well No. **1** Unit Letter **B** **S** **20****25N** **8W**Located **990** Feet From **North****1750** **East**County **San Juan** **6515****40**Name of Producing Formation **Dakota****Dakota Wildcat**1. Is the Operator the owner of the well?
Yes ☒ No ☐2. If the answer to question one is "No", the well is owned by:
Name of owner **Western Natural Gas Co.**3. If the answer to question two is "No", the well is owned by:
Name of owner

Section B

N. A. Ad

This is to certify that the information
in Section A above is true and correct
to the best of my knowledge and belief.

Western Natural Gas Co.
Operator
Calvin M. Raynes
Representative
211 1/2 W. Main
Address
Farmington, New Mexico

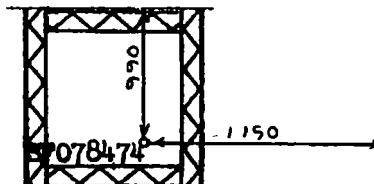

Section 20

This is to certify that the information
in Section A above is true and correct
to the best of my knowledge and belief.

(Seal)

September 28, 1959

Farmington, New Mexico

C. O. Walker
Operator

NI MEXICO OIL CONSERVATION COMMISS I
WELL LOCATION AND ACREAGE DEDICATION PLAT

Form C-102
Supersedes C-128
Effective 1-1-85

All distances must be from the outer boundaries of the Section

Operator MERRION OIL & GAS CORPORATION		Lease FEDERAL "A"		Well No. 2
Unit Letter P	Section 11	Township 24N	Range 8W	County San Juan
Actual Footage Location of Well: 940 feet from the South line and 790 feet from the East line				
Ground Level Elev: 7178	Producing Formation Gallup	Pool Escrito Gallup	Dedicated Acreage: 80 Acres	

1. Outline the acreage dedicated to the subject well by colored pencil or hatchure marks on the plat below.
2. If more than one lease is dedicated to the well, outline each and identify the ownership thereof (both as to working interest and royalty).
3. If more than one lease of different ownership is dedicated to the well, have the interests of all owners been consolidated by communitization, unitization, force-pooling, etc?

☐ Yes ☐ No If answer is "yes," type of consolidation _____

If answer is "no," list the owners and tract descriptions which have actually been consolidated. (Use reverse side of this form if necessary.) _____

No allowable will be assigned to the well until all interests have been consolidated (by communitization, unitization, forced-pooling, or otherwise) or until a non-standard unit, eliminating such interests, has been approved by the Commission.

		<p>RECEIVED AUG 09 1985</p>
Sec.		11
		NM 014580A

Scale: 1"=1000'

CERTIFICATION

I hereby certify that the information contained herein is true and complete to the best of my knowledge and belief.

Steve S. Dunn

Name
Steve S. Dunn

Position
Operations Manager

Company
Merrion Oil & Gas Corporation

Date
7/31/85

I hereby certify that the well location shown on this plat was plotted from field notes of actual surveys made by me or under my supervision, and that the same is true and correct to the best of my knowledge and belief.

Date Surveyed
July 25, 1985

Registered Professional Engineer and Land Surveyor

Fred B. Kerry Jr.
Fred B. Kerry Jr.

Certificate No.
3950

DISTRICT I
1625 N. French Dr., Hobbs, N.M. 88240
Phone: (575) 393-8181 Fax: (575) 393-0720

DISTRICT II
811 S. First St., Artesia, N.M. 88210
Phone: (575) 748-1283 Fax: (575) 748-9720

DISTRICT III
1000 Rio Bravo Rd., Aztec, N.M. 87410
Phone: (505) 334-8178 Fax: (505) 334-8170

DISTRICT IV
1220 S. St. Francis Dr. Santa Fe, NM 87508
Phone: (505) 476-3480 Fax: (505) 476-3482

State of New Mexico
Energy, Minerals & Natural Resources Department

OIL CONSERVATION DIVISION

1220 South St Francis Dr
Santa Fe, NM 87505

Form C-102
Revised August 1, 2011
Submit one copy to appropriate
District Office

☐ AMENDED REPORT

WELL LOCATION AND ACREAGE DEDICATION PLAT

*API Number 30-045-35828		*Pool Code 19859	*Pool Name DUFFERS POINT-GALLUP DAKOTA
*Property Code 317770	*Property Name LOGOS 2508 20D		*Well Number 15
*OGRD No 289408	*Operator Name LOGOS OPERATING, LLC		*Elevation 6544

¹⁰ Surface Location

UL or lot no	Section	Township	Range	Lot Idn	Feet from the	North/South line	Feet from the	East/West line	County
D	20	25-N	8-W		480	NORTH	592	WEST	SAN JUAN

¹¹ Bottom Hole Location If Different From Surface

UL or lot no	Section	Township	Range	Lot Idn	Feet from the	North/South line	Feet from the	East/West line	County
*Dedicated Acres G-DK 160.00 ACRES NW/4			*Joint or Infill		*Consolidation Code		*Order No		

NO ALLOWABLE WILL BE ASSIGNED TO THIS COMPLETION UNTIL ALL INTERESTS HAVE BEEN CONSOLIDATED
OR A NON-STANDARD UNIT HAS BEEN APPROVED BY THE DIVISION

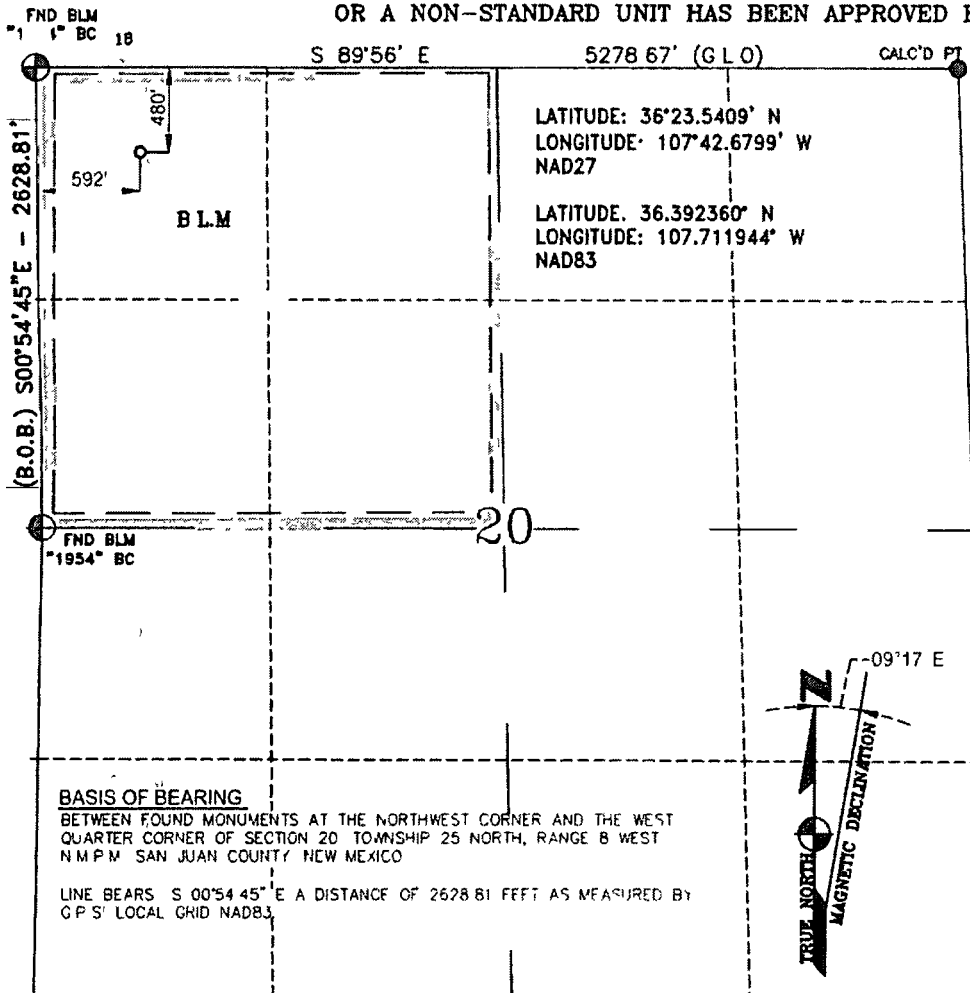

17 OPERATOR CERTIFICATION

I hereby certify that the information contained herein is true and complete to the best of my knowledge and belief, and that this organization either owns a working interest or, unless mineral interest in the land including the proposed bottom hole location or has a right to drill this well at this location pursuant to a contract with an owner of such a mineral or a working interest, or to a voluntary pooling agreement or a compulsory pooling order heretofore entered by the division.

Signature

Date

Tamra Sessions

Printed Name

tsessions@logosresourcesllc.com

E-mail Address

18 SURVEYOR CERTIFICATION

I hereby certify that the well location shown on this plat was plotted from field notes of actual surveys made by me or under my supervision, and that the same is true and correct to the best of my belief.

SEPTEMBER 27, 2011

Date of Survey

Signature and Seal

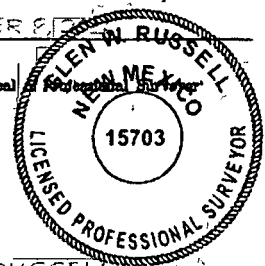

GLEN W. RUSSELL

Certificate Number

15703

McMillan, Michael, EMNRD

From: Tamra Sessions <tsessions@logosresourcesllc.com>
Sent: Thursday, June 1, 2017 3:44 PM
To: Philana Thompson
Cc: McMillan, Michael, EMNRD
Subject: RE: North Dufers CDP OLM application to add LOGOS well

We have received the below mentioned OLM application from Merrion. Attachment was named '2017-5-31 CPD app to NMOCD' and is for adding LOGOS 2508 20D 15 well to Merrion's North Dufers CPD.

Sincerely,

Tamra Sessions
Regulatory Specialist
Office 505-324-4145
tsessions@logosresourcesllc.com



From: Philana Thompson [mailto:pthompson@merrion.bz]
Sent: Thursday, June 01, 2017 3:38 PM
To: Tamra Sessions <tsessions@logosresourcesllc.com>
Cc: McMillan, Michael, EMNRD <Michael.McMillan@state.nm.us>
Subject: North Dufers CDP OLM application to add LOGOS well

Tamra,
I sent a letter and a hard copy, I also sent you an email with the CDP application attached. Please reply-all to this email that you received the copy of the application for NMOCDs records.

Mr. McMillan with the NMOCD in Santa Fe is CC'd on this correspondence.

Thanks Philana

--

Philana Thompson
Regulatory Compliance
Merrion Oil & Gas Corp
cell 505-486-1171
fax 505-324-5300

State of New Mexico
Energy, Minerals and Natural Resources Department

Susana Martinez
Governor

David Martin
Cabinet Secretary-Designate

Brett F. Woods, Ph D
Deputy Cabinet Secretary

Jamí Bailey, Division Director
Oil Conservation Division



November 27, 2013

ADMINISTRATIVE POOL/LEASE COMMINGLING ORDER

Administrative Order PLC-387
Administrative Application Reference No pPRG1328952265

Merrion Oil & Gas Corp
Attn: Mr. Ryan Davis

Pursuant to your application received on October 15, 2013, Merrion Oil & Gas Corp (OGRID 14634) is hereby authorized to surface commingle gas production only from the following pools located in Eddy County, New Mexico

Dufers Point; Gallup-Dakota (Oil) 19859
Escrito; Gallup (Associated) 22619

and from the following diversely owned wells located in said county

See Exhibit A attached hereto.

The commingled gas production shall be measured and sold at the North Dufers Central Delivery Point in Township 25 North, Range 8W, San Juan County. Production from each of the wells shall be separately metered. Meters shall be calibrated in accordance with Rule 19.15.12.10.C(2)(b).

The operator shall notify the transporter of this commingling authority

The operator shall notify the Aztec district office of the Division upon commencement of commingling operations.

November 27, 2013

Page 2

This approval is subject to like approval from the United States Bureau of Land Management and the New Mexico State Land Office before commencement of the commingling operations

Sincerely,

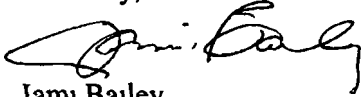
A handwritten signature in black ink, appearing to read "Jami Bailey". The signature is fluid and cursive, with the first name "Jami" and last name "Bailey" clearly distinguishable.

Jami Bailey
Division Director

JB/db

cc: Oil Conservation Division District Office – Aztec
New Mexico State Land Office
United States Bureau of Land Management.

**Merion Oil & Gas
CPD-North Dufers Point #97133**

#2 List of All Wells and Connection Date to the CPD

Well	API	Lease	Line N/S	Line E/W	Sec	TNSP	RNG	Lat	Long	Meter #	Connected to CPD
CPD Meter										97-133	
Federal A2	30-045-26536	NMNM14580A	940S	790E	11	24-N	8-W	N36°19'43"	W107°38'73"	Chart	1/1/1992
Federal A3	30-045-26525	NMNM14580A	2270N	790E	10	24-N	8-W	N36°32'24"	W107°36'34"	Chart	1/1/1992
Federal A1	30-045-22225	NMNM14580A	970S	1700E	10	24-N	8-W	N36°19'44"	W107°39'55"	Chart	1/1/1992
Jalapeno 1	30-045-25580	State	790N	1850W	18	25-N	8-W	N36°24'35"	W107°41'43"	Chart	1/1/1992
Roadrunner 1	30-045-25579	State	2310N	330W	2	24-N	8-W	N36°20'62"	W107°39'53"	Chart	1/1/1992
Shoofly 1	30-045-26133	NMNM16589	780N	1650W	14	24-N	8-W	N36°19'14"	W107°39'29"	Chart	1/1/1992
Shoofly 2	30-045-26322	NMNM16589	970N	790E	15	24-N	8-W	N36°19'11"	W107°39'79"	Chart	1/1/1992
Stephenson 2	30-045-25931	NMSF078475	1880S	860E	7	25-N	8-W	N36°24'81"	W107°42'88"	Chart	1/1/1992
Stephenson 3	30-045-25985	NMSF078475	1880S	1880W	8	25-N	8-W	N36°24'81"	W107°42'44"	Chart	1/1/1992
Stephenson 4	30-045-25988	NMSF078475	1880S	1880E	8	25-N	8-W	N36°24'80"	W107°42'17"	Chart	1/1/1992
Wagon Train 1	30-045-25812	NMNM54982	1750S	820E	6	25-N	8-W	N36°25'63"	W107°42'99"	Chart	1/1/1992
Warito 1	30-045-25376	NOOC14205008	790N	1810E	7	25-N	8-W	N36°25'23"	W107°43'21"	Chart	1/1/1992
Wild Hare 1	30-045-26014	NMNM47167	970N	970W	11	24-N	8-W	N36°19'97"	W107°39'46"	Chart	1/1/1992
SOB Federal 1	30-045-25827	NMNM47169	1850N	980W	8	25-N	8-W	N36°25'05"	W107°42'64"	Chart	1/1/1992
Horsety 1	30-045-26310	NMNM014580	790S	790W	11	24-N	8-W	N36°19'40"	W107°39'47"	Chart	1/1/1992
Yuca Com 1	30-045-26584	State	1850N	790E	2	25-N	8-W	N36°25'94"	W107°45'15"	Chart	1/1/1992

Keeling #1 30-045-05299 SF-078474 990N 1750E 20 25N 8W N36.390934 W-107.7019274 Chart Waiting on line

Red Indicates Crow Mesa Area (T24N R8W), all others (T25N R8/9W) are North Dufers Point Area

Exhibit A to Order PLE-387

#15

COMPRESSOR FACILITY LAYOUT

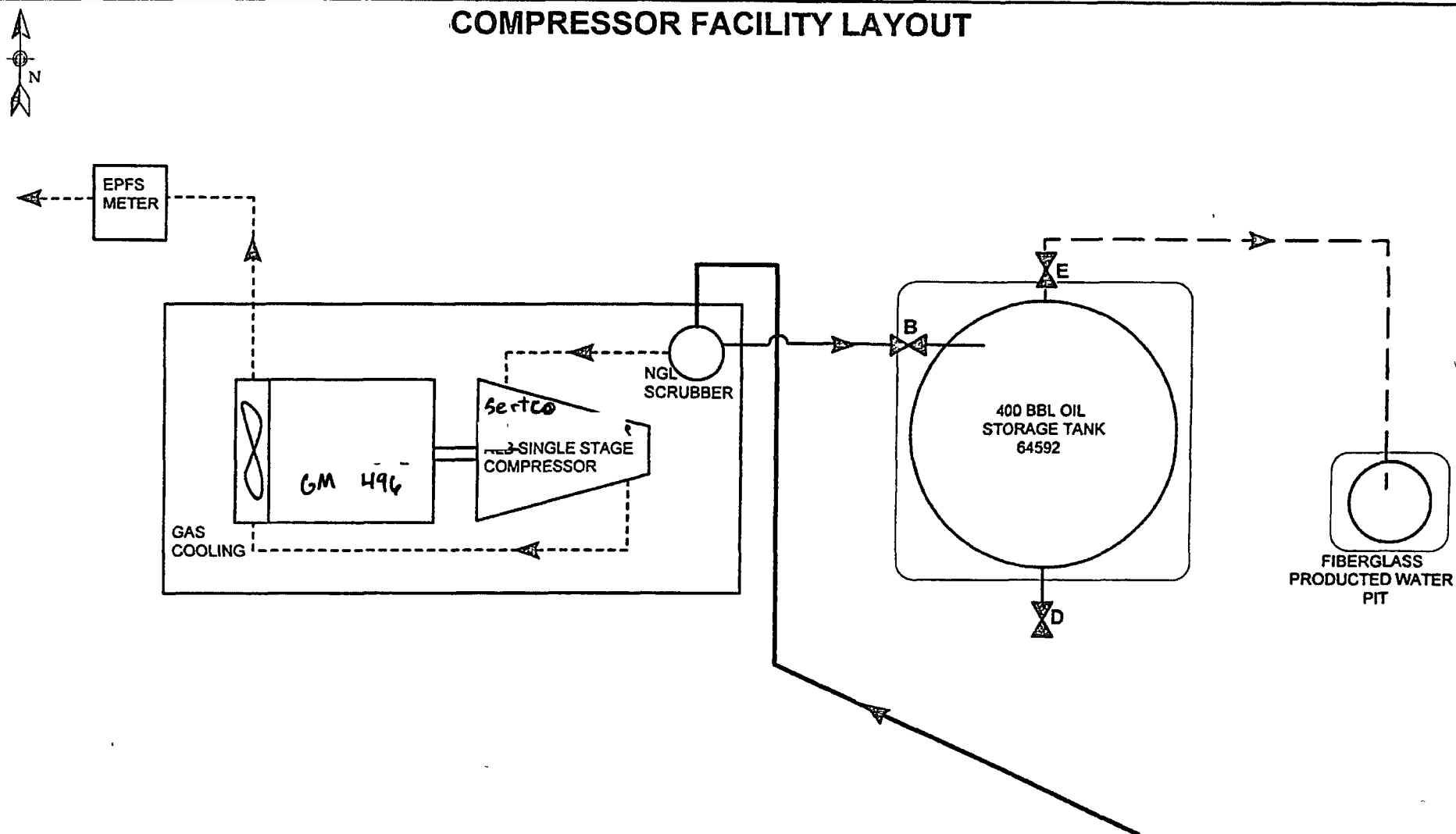

FLUID FLOW LEGEND

- Total Production
- Oil
- Water
- Gas
- Diesel

VALVE SEAL LEGEND

- A - Sealed Closed at All Times.
- B - Sealed Open for Production, Sealed Closed for Sales
- C - Sealed Closed for Sale at Either Tank
- D - Sealed Closed for Production, Open for Sales.
- E - Normally Sealed Closed Except to Haul Water

Merron Oil & Gas Corp.
 North Dufer's Point
 Central Compression Facility, CPD
 Section 1, T25N, R9W
 Rio Arriba County
 (Not to Scale)

Drawn by Connie Dinning, 7/3/96

McMillan, Michael, EMNRD

From: Philana Thompson <pthompson@merrion bz>
Sent: Monday, June 5, 2017 3 24 PM
To: McMillan, Michael, EMNRD
Subject: Re North Dufer CPD application

NMSLO certified letter tracking #70160910000123657776

On Mon, Jun 5, 2017 at 3 18 PM, Philana Thompson <pthompson@merrion bz> wrote
I did not make a copy of the envelope, can I send a copy of the signed green card when I receive it or is the email correspondence enough?

On Mon, Jun 5, 2017 at 3 12 PM, McMillan, Michael, EMNRD <Michael McMillan@state.nm.us> wrote

Proof of mailing only, not return receipts

mike

From: Philana Thompson [mailto:pthompson@merrion bz]
Sent: Monday, June 5, 2017 2 59 PM

To: McMillan, Michael, EMNRD <Michael McMillan@state.nm.us>
Subject: Re North Dufer CPD application

I thought you wanted the returned registered mail card (which we have not got back from them yet) I can forward the email communication I have going with them

On Mon, Jun 5, 2017 at 2 56 PM, McMillan, Michael, EMNRD <Michael McMillan@state.nm.us> wrote

Where is the NMSLO proof of mailing?

Mike

From: McMillan, Michael, EMNRD
Sent: Friday, June 2, 2017 10 56 AM

To: 'Philana Thompson' <pthompson@merrion bz>
Subject: RE: North Dufer CPD application

McMillan, Michael, EMNRD

From: Philana Thompson <pthompson@merrion bz>
Sent: Monday, June 5, 2017 3 00 PM
To: McMillan, Michael, EMNRD
Subject: Fwd Notice to working and royalty interest owners
Attachments: image001.png

----- Forwarded message -----

From: **Gruebel, Marilyn** <mgruebel@slo state nm us>
Date: Fri, Jun 2, 2017 at 9 42 AM
Subject: RE Notice to working and royalty interest owners
To: "pthompson@merrion bz" <pthompson@merrion bz>

Good morning, Philana –

Thanks for giving us a “heads up” on the commingling application. Because there is production from New Mexico State Trust acreage involved in the commingling, you are correct in sending an application to us.

In addition to the information you have included, we require an application letter addressed to the New Mexico Commissioner of Public Lands stating the type of permission desired and the reasons, accompanied by an application fee of \$150.

Please ensure that you have all necessary business leases and rights-of-way from the New Mexico State Land Office if surface facilities or flow lines involve State Trust acreage.

If you have any questions or if we may be of further assistance, my contact information is attached to this email.

Best regards,

Marilyn



Marilyn Gruebel

Units/Commingle Manager

Oil, Gas & Minerals Division

505 827 5791

505 827.4739 Fax

New Mexico State Land Office

310 Old Santa Fe Trail

P O Box 1148

Santa Fe, NM 87504-1148

mgruebel@slo.state.nm.us

www.slo.state.nm.us

.. .. .

CONFIDENTIALITY NOTICE This e-mail, including all attachments is for the sole use of the intended recipient[s] and may contain confidential and/or privileged information. Any unauthorized review, use, copying, disclosure or distribution is prohibited, unless specifically provided under the New Mexico Inspection of Public Records Act. If you are not the intended recipient, please contact the sender at once and destroy all copies of this message.

From: Philana Thompson [mailto:pthompson@merrion.bz]

Sent: Thursday, June 01, 2017 4:26 PM

To: Martinez, Danny - Royalty <DMartinez@slo.state.nm.us>, Warnell, Terry <twarnell@slo.state.nm.us>

Subject: Notice to working and royalty interest owners

Please see the attached proposal to add a well to our North Dufers CPD

PROCESS FLOW DIAGRAM

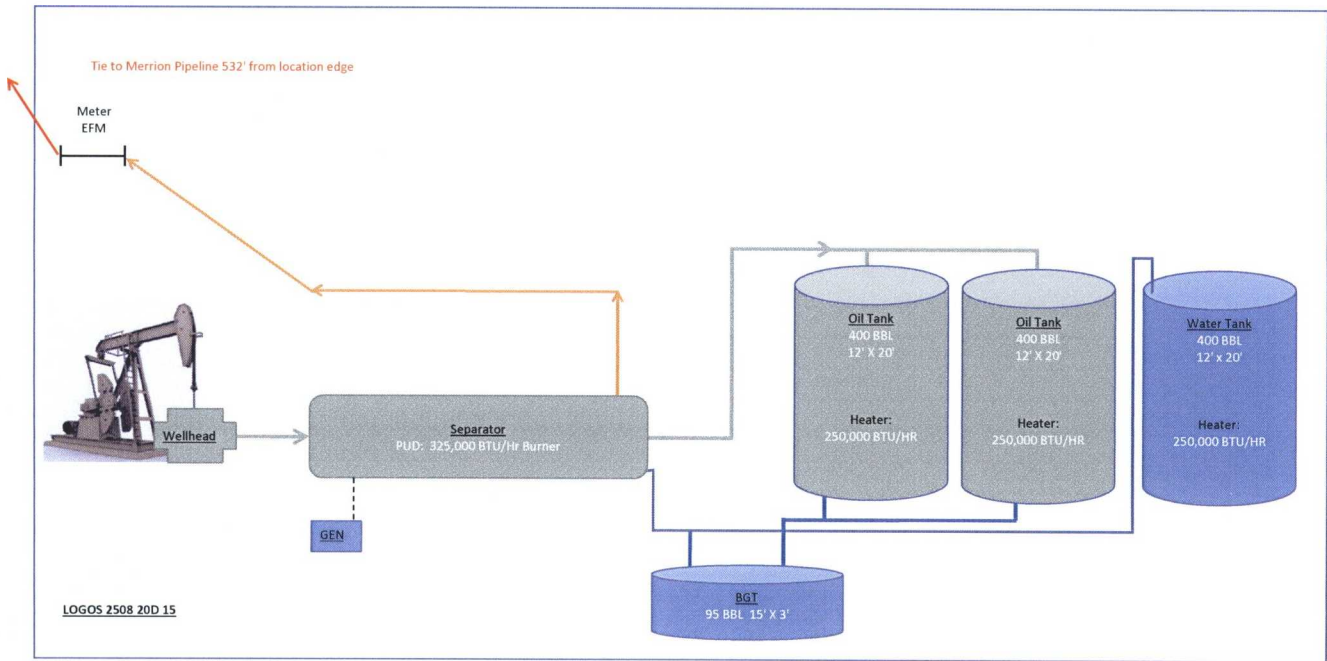

Merrion Oil & Gas
CPD -North Dufers Point # 97133

4 AREA MAP

The area is shown on the topo locator maps for wells and flowline to the CPD.

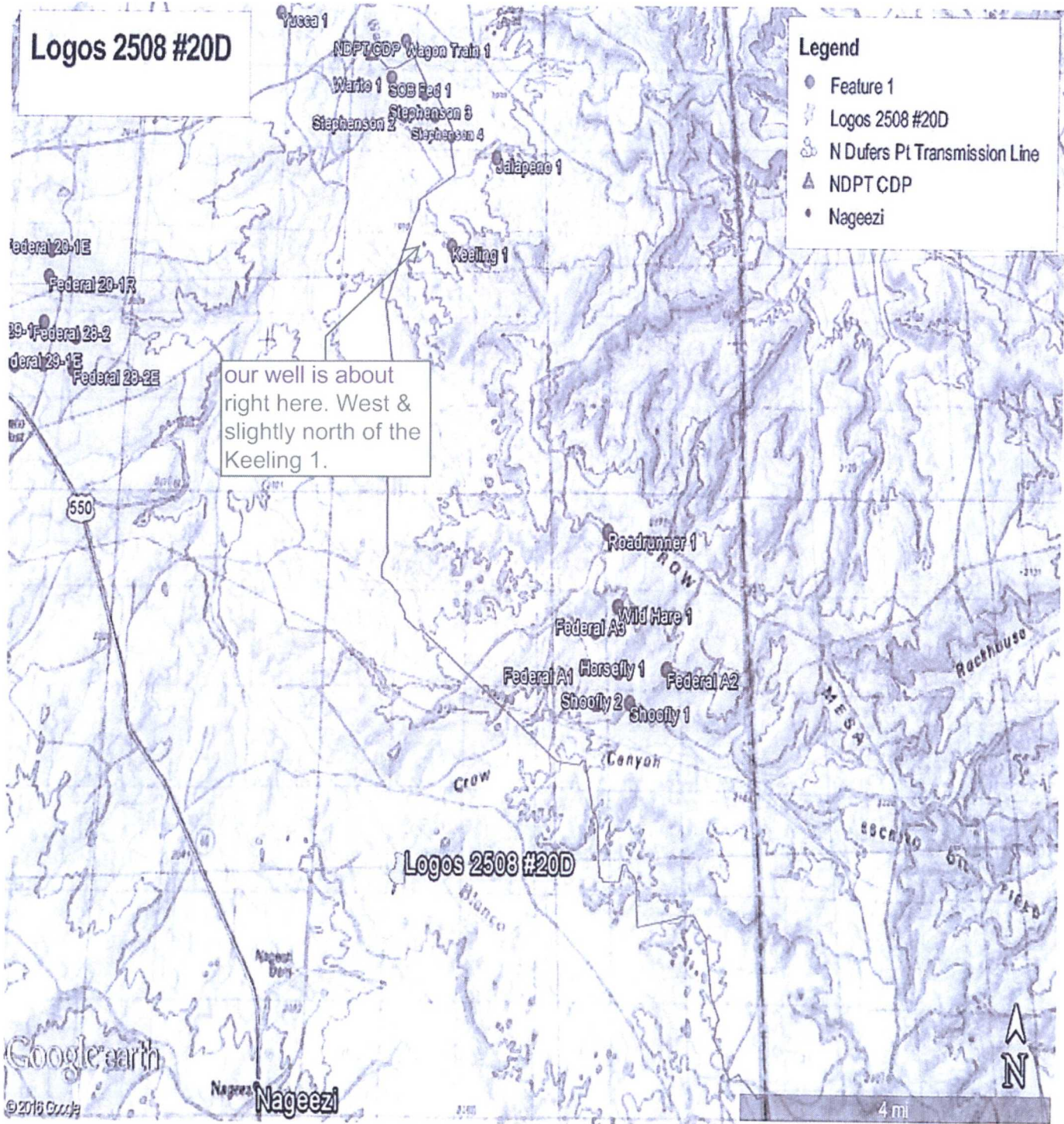



Prod Alloc - Delivery System to Well-State Volumes

December 2016

Code	Name	State	State Begin Inv	State Oil Prod	State Oil Sales	State Other Disp	State End Inv	State Gas Prod	State Gas Sales	State Gas MMBtu	State Gas O D	State Gas Inj	State Water Prod	State Water Injected	Days Up
Code	CPDNPPDS1	North Dufers Point CPD													
0258 01	Federal A1 GL	NM	379	104	0	0	483	414	258	344	156	0	10	0	26
0259 01	Federal A2 GL	NM	171	0	0	0	171	0	0	0	0	0	0	0	0
0344 01	Horsefly 1 GL	NM	314	0	0	0	314	0	0	0	0	0	0	0	0
0363 01	Jalapeno 1 GL	NM	224	0	0	0	224	276	102	136	174	0	0	0	31
0383 01	Keeling 1 GL	NM	145	30	0	0	175	842	695	926	147	0	50	0	31
0505 01	Roadrunner 1 GL	NM	99	0	0	0	99	211	65	86	146	0	0	0	27
0525 01	Shoofly 1 GL	NM	245	0	0	0	245	105	22	29	83	0	0	0	16
0526 01	Shoofly 2 GL	NM	244	0	0	0	244	0	0	0	0	0	0	0	0
0538 01	SOB Federal 1 GL	NM	299	0	0	0	299	0	0	0	0	0	0	0	0
0562 01	Stephenson 2 GL	NM	39	0	0	0	39	0	0	0	0	0	0	0	0
0563 01	Stephenson 3 GL	NM	203	0	0	0	203	0	0	0	0	0	0	0	0
0564 01	Stephenson 4 GL	NM	315	6	0	0	321	454	254	277	200	0	20	0	30
0598 01	Wagon Train 1 GL	NM	357	5	191	2	169	1 283	1 009	1 345	274	0	10	0	31
0597 01	Wanto 1 GL	NM	311	0	0	0	311	199	43	58	156	0	0	0	30
0615 01	Wild Hare 1 GL	NM	89	0	0	0	89	0	0	0	0	0	0	0	0
0621 01	Yucca Com 1 GL	NM	150	0	0	0	150	0	0	0	0	0	0	0	0
Alloc Totals for North Dufers Point CP			3,584	145	191	2	3,536	3 784	2 448	3,201	1,336	0	90	0	
Report Totals			3,584	145	191	2	3,536	3 784	2,448	3,201	1,336	0	90	0	

Printed 6/21/2017 9 25 27 AM

Page 1

ElsRpt0000001591



Prod Alloc - Delivery System to Well-State Volumes

January 2017

Code	Name	State	State Begin Inv	State Oil Prod	State Oil Sales	State Other Disp	State End Inv	State Gas Prod	State Gas Sales	State Gas MMBtu	State Gas O D	State Gas Inj	State Water Prod	State Water Injected	Days Up
Code	CPDNPPDS1	North Dufers Point CPD													
0258 01	Federal A1 GL	NM	483	0	0	0	483	0	0	0	0	0	0	0	0
0259 01	Federal A2 GL	NM	171	0	0	0	171	0	0	0	0	0	0	0	0
0344 01	Horsefly 1 GL	NM	314	21	184	0	151	174	96	128	78	0	5	0	13
0363 01	Jalapeno 1 GL	NM	224	0	0	0	224	319	146	195	173	0	0	0	31
0383 01	Keeling 1 GL	NM	175	29	0	0	204	702	614	821	88	0	35	0	31
0505 01	Roadrunner 1 GL	NM	99	0	0	0	99	0	0	0	0	0	0	0	0
0525 01	Shoofly 1 GL	NM	245	0	0	0	245	0	0	0	0	0	0	0	0
0526 01	Shoofly 2 GL	NM	244	62	0	0	306	353	176	236	177	0	5	0	31
0538 01	SOB Federal 1 GL	NM	299	0	0	0	299	0	0	0	0	0	0	0	0
0562 01	Stephenson 2 GL	NM	39	0	0	0	39	152	0	0	152	0	0	0	31
0563 01	Stephenson 3 GL	NM	203	0	0	0	203	0	0	0	0	0	0	0	0
0564 01	Stephenson 4 GL	NM	321	43	189	0	175	641	428	468	213	0	30	0	31
0596 01	Wagon Train 1 GL	NM	169	21	0	0	190	1 352	1 137	1 519	215	0	20	0	27
0597 01	Wanto 1 GL	NM	311	44	0	0	355	291	130	174	161	0	25	0	31
0615 01	Wild Hare 1 GL	NM	89	0	0	0	89	0	0	0	0	0	0	0	0
0621 01	Yucca Com 1 GL	NM	150	28	0	0	178	1 166	887	1 185	279	0	30	0	31
Alloc Totals for North Dufers Point CP			3,536	248	373	0	3,411	5 150	3,614	4,725	1,536	0	150	0	
Report Totals			3,536	248	373	0	3,411	5 150	3,614	4,725	1,536	0	150	0	

Printed 6/21/2017 9 28 17 AM

Page 1

ElsRpt0000001591



Prod Alloc - Delivery System to Well-State Volumes

February 2017

Code	Name	State	State Begin Inv	State Oil Prod	State Oil Sales	State Other Disp	State End Inv	State Gas Prod	State Gas Sales	State Gas MMBtu	State Gas O D	State Gas Inj	State Water Prod	State Water Injected	Days Up
Code	CPDNPDSD1	North Dufers Point CPD													
0258 01	Federal A1 GL	NM	483	0	0	0	483	308	173	227	135	0	0	0	28
0259 01	Federal A2 GL	NM	171	0	0	0	171	0	0	0	0	0	0	0	0
0344 01	Horsefly 1 GL	NM	151	0	0	0	151	0	0	0	0	0	0	0	0
0363 01	Jalapeno 1 GL	NM	224	0	0	0	224	246	95	124	151	0	0	0	28
0383 01	Keeling 1 GL	NM	204	25	0	0	229	913	796	1 042	117	0	40	0	28
0505 01	Roadrunner 1 GL	NM	99	0	0	0	99	0	0	0	0	0	0	0	0
0525 01	Shoofly 1 GL	NM	245	0	0	0	245	183	65	85	128	0	0	0	24
0526 01	Shoofly 2 GL	NM	306	3	0	0	309	190	51	67	139	0	0	0	27
0538 01	SOB Federal 1 GL	NM	299	41	0	0	340	476	316	414	160	0	40	0	23
0562 01	Stephenson 2 GL	NM	39	0	0	0	39	0	0	0	0	0	0	0	0
0563 01	Stephenson 3 GL	NM	203	0	0	0	203	0	0	0	0	0	0	0	0
0564 01	Stephenson 4 GL	NM	175	39	0	0	214	408	236	256	172	0	35	0	28
0596 01	Wagon Train 1 GL	NM	190	13	0	0	203	1 283	1 072	1 403	211	0	10	0	27
0597 01	Wanto 1 GL	NM	355	3	0	0	358	269	115	151	154	0	0	0	28
0615 01	Wild Hare 1 GL	NM	89	0	0	0	89	0	0	0	0	0	0	0	0
0621 01	Yucca Corn 1 GL	NM	178	7	0	0	185	417	248	325	169	0	0	0	27
Alloc Totals for North Dufers Point CP			3 411	131	0	0	3,542	4,703	3,167	4,092	1,536	0	125	0	
Report Totals			3,411	131	0	0	3,542	4 703	3,167	4,092	1,536	0	125	0	

Printed 6/21/2017 9 28 17 AM

Page 1

EisRpt0000001591



Prod Alloc - Delivery System to Well-State Volumes

March 2017

Code	Name	State	State Begin Inv	State Oil Prod	State Oil Sales	State Other Disp	State End Inv	State Gas Prod	State Gas Sales	State Gas MMBtu	State Gas O D	State Gas Inj	State Water Prod	State Water Injected	Days Up
Code	CPDNPDSD1	North Dufers Point CPD													
0258 01	Federal A1 GL	NM	483	0	0	0	483	96	18	23	78	0	0	0	19
0259 01	Federal A2 GL	NM	171	0	0	0	171	155	67	88	88	0	0	0	16
0344 01	Horsefly 1 GL	NM	151	44	0	0	195	288	118	155	170	0	5	0	31
0363 01	Jalapeno 1 GL	NM	224	0	0	0	224	350	172	225	178	0	0	0	31
0383 01	Keeling 1 GL	NM	229	20	0	0	249	528	458	599	70	0	30	0	31
0505 01	Roadrunner 1 GL	NM	99	0	0	0	99	0	0	0	0	0	0	0	0
0525 01	Shoofly 1 GL	NM	245	0	0	0	245	170	41	54	129	0	0	0	25
0526 01	Shoofly 2 GL	NM	309	157	178	0	288	338	160	209	176	0	5	0	31
0538 01	SOB Federal 1 GL	NM	340	0	0	0	340	0	0	0	0	0	0	0	0
0562 01	Stephenson 2 GL	NM	39	0	0	0	39	166	63	82	103	0	0	0	19
0563 01	Stephenson 3 GL	NM	203	0	0	0	203	91	11	15	80	0	0	0	16
0564 01	Stephenson 4 GL	NM	214	48	0	0	262	438	248	269	190	0	30	0	31
0596 01	Wagon Train 1 GL	NM	203	14	0	0	217	1 815	1 523	1 993	292	0	20	0	31
0597 01	Wanto 1 GL	NM	358	0	0	0	358	281	112	147	169	0	0	0	31
0615 01	Wild Hare 1 GL	NM	89	0	0	0	89	113	38	49	75	0	0	0	14
0621 01	Yucca Corn 1 GL	NM	185	39	0	0	224	578	370	484	208	0	20	0	31
Alloc Totals for North Dufers Point CP			3 542	322	178	0	3 686	5 405	3 399	4,393	2,006	0	110	0	
Report Totals			3,542	322	178	0	3,686	5,405	3 399	4,393	2,006	0	110	0	

Printed 6/21/2017 9 30 25 AM

Page 1

EisRpt0000001591



Prod Alloc - Delivery System to Well-State Volumes

April 2017

Code	Name	State	State Begin Inv	State Oil Prod	State Oil Sales	State Other Disp	State End Inv	State Gas Prod	State Gas Sales	State Gas MMBtu	State Gas O D	State Gas Inj	State Water Prod	State Water Injected	Days Up
Code	CPDNPDOS1	North Dufers Point CPD													
0258 01	Federal A1 GL	NM	483	113	191	0	405	436	279	366	157	0	0	0	30
0259 01	Federal A2 GL	NM	171	0	0	0	171	0	0	0	0	0	0	0	0
0344 01	Horsefly 1 GL	NM	195	9	0	0	204	5	0	0	5	0	10	0	1
0363 01	Jalapeno 1 GL	NM	224	0	0	0	224	282	119	156	163	0	0	0	30
0383 01	Keeling 1 GL	NM	249	40	0	0	289	74	65	85	9	0	0	0	30
0505 01	Roadrunner 1 GL	NM	99	0	0	0	99	0	0	0	0	0	0	0	0
0525 01	Shoofly 1 GL	NM	245	225	190	0	280	369	195	255	174	0	0	0	30
0526 01	Shoofly 2 GL	NM	288	5	0	0	293	246	87	113	159	0	0	0	30
0538 01	SOB Federal 1 GL	NM	340	0	189	0	151	1 021	767	1 005	254	0	80	0	30
0562 01	Stephenson 2 GL	NM	39	0	0	0	39	278	115	150	163	0	0	0	30
0563 01	Stephenson 3 GL	NM	203	0	0	0	203	0	0	0	0	0	0	0	0
0564 01	Stephenson 4 GL	NM	262	53	0	0	315	457	272	285	185	0	15	0	30
0596 01	Wagon Train 1 GL	NM	217	10	0	0	227	1 561	1 322	1 731	239	0	15	0	28
0597 01	Wanto 1 GL	NM	358	37	183	0	212	316	148	194	168	0	0	0	30
0615 01	Wild Hare 1 GL	NM	89	0	0	0	89	0	0	0	0	0	0	0	0
0621 01	Yucca Corn 1 GL	NM	224	0	0	0	224	402	224	293	178	0	0	0	30
Alloc Totals for North Dufers Point CP			3 686	492	753	0	3 425	5,447	3,593	4 644	1,854	0	120	0	
Report Totals			3,686	492	753	0	3 425	5 447	3 593	4,644	1,854	0	120	0	

Printed 6/21/2017 9:33:04 AM

Page 1

EisRpt0000001591



Prod Alloc - Delivery System to Well-State Volumes

May 2017

Code	Name	State	State Begin Inv	State Oil Prod	State Oil Sales	State Other Disp	State End Inv	State Gas Prod	State Gas Sales	State Gas MMBtu	State Gas O D	State Gas Inj	State Water Prod	State Water Injected	Days Up
Code	CPDNPDOS1	North Dufers Point CPD													
0258 01	Federal A1 GL	NM	405	37	11	0	431	122	0	0	122	0	0	0	31
0259 01	Federal A2 GL	NM	171	0	0	0	171	0	0	0	0	0	0	0	0
0344 01	Horsefly 1 GL	NM	204	158	203	0	159	819	603	788	216	0	0	0	29
0363 01	Jalapeno 1 GL	NM	224	7	7	0	224	317	147	192	170	0	0	0	31
0383 01	Keeling 1 GL	NM	289	52	210	65	66	559	498	651	61	0	35	0	31
0505 01	Roadrunner 1 GL	NM	99	0	0	0	99	0	0	0	0	0	0	0	0
0525 01	Shoofly 1 GL	NM	280	6	4	0	282	298	130	171	168	0	0	0	31
0526 01	Shoofly 2 GL	NM	293	146	187	0	252	325	154	201	171	0	2	0	31
0538 01	SOB Federal 1 GL	NM	151	46	0	0	197	5	0	0	5	0	0	0	1
0562 01	Stephenson 2 GL	NM	39	6	5	0	40	143	123	161	20	0	0	0	1
0563 01	Stephenson 3 GL	NM	203	0	0	0	203	0	0	0	0	0	0	0	0
0564 01	Stephenson 4 GL	NM	315	54	17	0	352	478	291	315	187	0	15	0	31
0596 01	Wagon Train 1 GL	NM	227	76	79	0	224	1 648	1 414	1 850	234	0	10	0	31
0597 01	Wanto 1 GL	NM	212	8	8	0	212	321	151	197	170	0	0	0	31
0615 01	Wild Hare 1 GL	NM	89	0	0	0	89	0	0	0	0	0	0	0	0
0621 01	Yucca Corn 1 GL	NM	224	66	21	0	269	960	720	942	240	0	25	0	31
Alloc Totals for North Dufers Point CP			3 425	662	752	65	3 270	5 995	4 231	5 468	1 764	0	87	0	
Report Totals			3,425	662	752	65	3,270	5,995	4,231	5 468	1,764	0	87	0	

Printed 6/21/2017 9:37:11 AM

Page 1

EisRpt0000001591

State of New Mexico
Energy, Minerals and Natural Resources Department

Susana Martinez
Governor

David Martin
Cabinet Secretary-Designate

Brett F. Woods, Ph D
Deputy Cabinet Secretary

Jami Bailey, Division Director
Oil Conservation Division

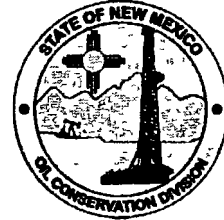

November 27, 2013

ADMINISTRATIVE POOL/LEASE COMMINGLING ORDER

Administrative Order PLC-387
Administrative Application Reference No. pPRG1328952265

Merrion Oil & Gas Corp
Attn: Mr. Ryan Davis

Pursuant to your application received on October 15, 2013, Merrion Oil & Gas Corp (OGRID 14634) is hereby authorized to surface commingle **gas production only** from the following pools located in Eddy County, New Mexico.

Dufers Point; Gallup-Dakota (Oil) 19859
Escrito; Gallup (Associated) 22619

and from the following diversely owned wells located in said county:

See Exhibit A attached hereto.

The commingled gas production shall be measured and sold at the North Dufers Central Delivery Point in Township 25 North, Range 8W, San Juan County. **Production from each of the wells shall be separately metered.** Meters shall be calibrated in accordance with Rule 19.15.12.10.C(2)(b).

The operator shall notify the transporter of this commingling authority.

The operator shall notify the Aztec district office of the Division upon commencement of commingling operations.

November 27, 2013

Page 2

This approval is subject to like approval from the United States Bureau of Land Management and the New Mexico State Land Office before commencement of the commingling operations

Sincerely,

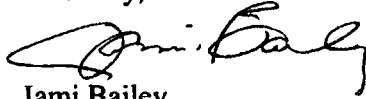
A handwritten signature in black ink, appearing to read "Jami Bailey", written in a cursive style.

Jami Bailey
Division Director

JB/db

cc: Oil Conservation Division District Office – Aztec
New Mexico State Land Office
United States Bureau of Land Management.

**Merrion Oil & Gas
CPD - North Dufers Point #97133**

#2 List of All Wells and Connection Date to the CPD

Well	API	Lease	Line N/S	Line E/W	Sec	TNSP	RNG	Lat	Long	Meter #	Connected to CPD
CPD Meter										97-133	
Federal A2	30-045-26538	NMNM14580A	940S	790E	11	24-N	8-W	N36°19.432'	W107°38.733'	Chart	1/1/1992
Federal A3	30-045-26525	NMNM14580A	2270N	790E	10	24-N	8-W	N36°328242	W107°583444	Chart	1/1/1992
Federal A1	30-045-22225	NMNM14580A	970S	1700E	10	24-N	8-W	N36°19.444'	W107°39.955'	Chart	1/1/1992
Jalepeno 1	30-045-26580	State	790N	1650W	16	25-N	8-W	N36°24.358'	W107°41.439'	Chart	1/1/1992
Roadrunner 1	30-045-26579	State	2310N	330W	2	24-N	8-W	N36°20.828'	W107°39.693'	Chart	1/1/1992
Shoofly 1	30-045-26133	NMNM16589	790N	1650W	14	24-N	8-W	N36°19.141'	W107°39.291'	Chart	1/1/1992
Shoofly 2	30-045-26122	NMNM16589	970N	790E	15	24-N	8-W	N36°19.115'	W107°39.780'	Chart	1/1/1992
Stephenson 2	30-045-25931	NMSF078475	1980S	880E	7	25-N	8-W	N36°24.814'	W107°42.985'	Chart	1/1/1992
Stephenson 3	30-045-25985	NMSF078475	1980S	1980W	8	25-N	8-W	N36°24.815'	W107°42.442'	Chart	1/1/1992
Stephenson 4	30-045-25986	NMSF078475	1980S	1980E	8	25-N	8-W	N36°24.600'	W107°42.173'	Chart	1/1/1992
Wagon Train 1	30-045-25912	NMNM54982	1750S	820E	6	25-N	8-W	N36°25.637'	W107°42.996'	Chart	1/1/1992
Warito 1	30-045-25376	NOOC14205008	790N	1810E	7	25-N	8-W	N36°25.233'	W107°43.216'	Chart	1/1/1992
Wild Hare 1	30-045-26014	NMNM47187	970N	970W	11	24-N	8-W	N36°19.973'	W107°39.481'	Chart	1/1/1992
SOB Federal 1	30-045-25927	NMNM47169	1850N	990W	8	25-N	8-W	N36°25.058'	W107°42.649'	Chart	1/1/1992
Horsefly 1	30-045-26310	NMNM014580	790S	790W	11	24-N	8-W	N36°19.400'	W107°39.471'	Chart	1/1/1992
Yucca Corn 1	30-045-26584	State	1850N	790E	2	25-N	8-W	N36°25.942'	W107°45.157'	Chart	1/1/1992

Keeling #1 30-045-05299 SF-078474 990N 1750E 20 25N 8W N36.390934 W-107.7019274 Chart Waiting on line

Red indicates Crow Mesa Area (T24N R8W), all others (T25N R8/9W) are North Dufers Point Area

Exhibit A to Order P2C-387