

DATE IN 8/23/17	SUSPENSE	ENGINEER LRL	LOGGED IN 8/25/17	TYPE NSL	APP NO. PKSC1723738612
-----------------	----------	--------------	-------------------	----------	------------------------

ABOVE THIS LINE FOR DIVISION USE ONLY

NEW MEXICO OIL CONSERVATION DIVISION

- Engineering Bureau -

1220 South St. Francis Drive, Santa Fe, NM 87505



NSL-7583

HOLLAND 10 N #1 30-015-44373

ADMINISTRATIVE APPLICATION CHECKLIST

THIS CHECKLIST IS MANDATORY FOR ALL ADMINISTRATIVE APPLICATIONS FOR EXCEPTIONS TO DIVISION RULES AND REGULATIONS WHICH REQUIRE PROCESSING AT THE DIVISION LEVEL IN SANTA FE

Application Acronyms:

[NSL-Non-Standard Location] [NSP-Non-Standard Proration Unit] [SD-Simultaneous Dedication]
 [DHC-Downhole Commingling] [CTB-Lease Commingling] [PLC-Pool/Lease Commingling]
 [PC-Pool Commingling] [OLS - Off-Lease Storage] [OLM-Off-Lease Measurement]
 [WFX-Waterflood Expansion] [PMX-Pressure Maintenance Expansion]
 [SWD-Salt Water Disposal] [IPI-Injection Pressure Increase]
 [EOR-Qualified Enhanced Oil Recovery Certification] [PPR-Positive Production Response]

[1] TYPE OF APPLICATION - Check Those Which Apply for [A] *Lime Rock Resources II-A, L.P.*

[A] Location - Spacing Unit - Simultaneous Dedication
☒ NSL ☐ NSP ☐ SD *277558*
Holland 10 N #1
30-015-44373

Check One Only for [B] or [C]

[B] Commingling - Storage - Measurement
☐ DHC ☐ CTB ☐ PLC ☐ PC ☐ OLS ☐ OLM

[C] Injection - Disposal - Pressure Increase - Enhanced Oil Recovery
☐ WFX ☐ PMX ☐ SWD ☐ IPI ☐ EOR ☐ PPR

[D] Other: Specify _____

[2] NOTIFICATION REQUIRED TO: - Check Those Which Apply, or ☐ Does Not Apply

[A] ☐ Working, Royalty or Overriding Royalty Interest Owners *Atoka, San Andres*
 [B] ☒ Offset Operators, Leaseholders or Surface Owner *3618*
Atoka, Glorieta Yaso
3250
 [C] ☐ Application is One Which Requires Published Legal Notice
 [D] ☐ Notification and/or Concurrent Approval by BLM or SLO
 U.S. Bureau of Land Management - Commissioner of Public Lands, State Land Office
 [E] ☐ For all of the above, Proof of Notification or Publication is Attached, and/or,
 [F] ☐ Waivers are Attached

[3] SUBMIT ACCURATE AND COMPLETE INFORMATION REQUIRED TO PROCESS THE TYPE OF APPLICATION INDICATED ABOVE.

[4] **CERTIFICATION:** I hereby certify that the information submitted with this application for administrative approval is **accurate** and **complete** to the best of my knowledge. I also understand that **no action** will be taken on this application until the required information and notifications are submitted to the Division.

Note: Statement must be completed by an individual with managerial and/or supervisory capacity.

Mike Pippin	<i>Mike Pippin</i>	Petroleum Engineer	August 22, 2017
Print or Type Name	Signature	Title	Date

mike@pippinllc.com
 e-mail Address

LIME ROCK RESOURCES II-A, L.P.

c/o Mike Pippin
3104 N. Sullivan Avenue
Farmington, NM 87401
505-327-4573 (phone) 505-564-8656 (fax)
Email: mike@pippinllc.com

August 22, 2017

Engineering Bureau
Phil Goetze
New Mexico Oil Conservation Division
1220 S. Saint Francis Drive
Santa Fe, New Mexico 87504

RE: **Application for Administrative Approval for a Non-standard Location**
HOLLAND 10 N #1 - 30-015-44373
135' FSL & 2300' FWL (N). Sec. 10 T18S R26E, Eddy County, NM
Atoka, Glorieta-Yeso (3250) and Atoka, San Andres (3610)

Dear Mr. Goetze:

Lime Rock Resources hereby requests administrative approval for a non-standard location for the above referenced well. Attached for your reference are the following exhibits:

1. C-102 for the State Pools
2. Copy of letter to offset operators
3. List of Offset Operators
4. Operator/Well maps
5. Location Map and Vicinity Map

The APD for the referenced well was approved on 8/17/17. The surface land owner, Mr. & Mrs. William C. Netherlin whose address is 103 E. Four Dinkus Road, Artesia, NM 88210, has requested that Lime Rock not drill the well in the middle of his cotton field. However, in order to accommodate Mr. Netherlin, the well must be non-standard. The State rule is that a well must be at least 330' from a spacing unit line. We are submitting this NSL application in an effort to both produce the natural resource and accommodate Mr. Netherlin.

By certified mail, a copy of this application has been sent to all of the Atoka, Glorieta-Yeso (3250) and Atoka, San Andres (3610) offset operators on the attached list. Lime Rock Resources requests your Administrative Approval for the non-standard location based on the above information. Should you need any additional information please feel free to contact me at (505) 327-4573.

Best Regards,



Mike Pippin
Petroleum Engineer

Enclosures

cc: Artesia District Office

Marathon Oil Permian LLC
5555 San Felipe ST
Houston, TX 77056-2723

10T18R26-L

No Wells

100% SA Rights ASAU
100% All Yeso Rights

10T18R26-K

Lime Rock Resources II-A, L.P.
1111 Bagby ST, STE 4600
Houston, TX 77002

100% SA Rights ASAU
0% Yeso Rights (ORRI Only)

10T18R26-J

10T18R26-H

ATOKA SAN ANDRES UNIT117

No Wells

100% SA Rights ASAU
100% All Yeso Rights

10T18R26-M

No Wells

100% SA Rights ASAU
100% All Yeso Rights

10T18R26-N

HOLLAND 10 N #1

138' FSL 2300' FWL Sec. 10
T18S R26E

Section 10



No Wells

100% SA Rights ASAU
0% Yeso Rights (ORRI Only)

10T18R26-O

10T18R26-P

No Wells

100% SA Rights ASAU
100% Yeso Rights Down to 4,000' Partial Tubb

15T18R26-D

Section 15

No Wells

100% SA Rights ASAU
100% Yeso Rights Down to 4,000' Partial Tubb

15T18R26-C

SIMPSON 15 B4

SIMPSON 15 B5
SIMPSON 15 B134

15T18R26-B

15T18R26-A

100% SA Rights ASAU
100% Yeso Rights Down to 4,000' Partial Tubb

Lime Rock Resources II-A, L.P.
1111 Bagby ST, STE 4600
Houston, TX 77002



LIME ROCK
RESOURCES

Holland 10N #1 NSL

• Wells SHL

— Offset Operator Boundary

Author: Michael Buenvenida

Date Saved: 8/11/2017 12:39:05 PM

15T18R26-F

15T18R26-G

15T18R26-H

District I
1625 N. French Dr., Hobbs, NM 88240
Phone: (575) 393-6161 Fax: (575) 393-0720
District II
811 S. First St., Artesia, NM 88210
Phone: (575) 748-1283 Fax: (575) 748-9720
District III
1000 Rio Brazos Road, Aztec, NM 87410
Phone: (505) 334-6178 Fax: (505) 334-6170
District IV
1220 S. St. Francis Dr., Santa Fe, NM 87505
Phone: (505) 476-3460 Fax: (505) 476-3462

State of New Mexico
Energy, Minerals & Natural Resources Department
OIL CONSERVATION DIVISION
1220 South St. Francis Dr.
Santa Fe, NM 87505

Form C-102
Revised August 1, 2011
Submit one copy to appropriate
District Office
☐ AMENDED REPORT

WELL LOCATION AND ACREAGE DEDICATION PLAT

¹ API Number 30-015-44373		² Pool Code 3610		³ Pool Name ATOKA, SAN ANDRES	
⁴ Property Code 319280		⁵ Property Name HOLLAND 10N			⁶ Well Number 1
⁷ OGRID No. 277558		⁸ Operator Name LIME ROCK RESOURCES II-A, L.P.			⁹ Elevation 3339.4

" Surface Location

UL or lot no.	Section	Township	Range	Lot Idn	Feet from the	North/South line	Feet from the	East/West line	County
N	10	18 S	26 E		135	SOUTH	2300	WEST	EDDY

" Bottom Hole Location If Different From Surface

UL or lot no.	Section	Township	Range	Lot Idn	Feet from the	North/South line	Feet from the	East/West line	County

¹⁰ Dedicated Acres	¹¹ Joint or Infill	¹² Consolidation Code	¹³ Order No.

No allowable will be assigned to this completion until all interests have been consolidated or a non-standard unit has been approved by the division.

<p>N89°54'04"E 2650.68 FT</p> <p>NW CORNER SEC. 10 LAT. = 32.7697629°N LONG. = 104.3782885°W</p> <p>NMSP EAST (FT) N = 643774.73 E = 527519.63</p>		<p>N89°52'46"E 2642.07 FT</p> <p>N Q CORNER SEC. 10 LAT. = 32.7697783°N LONG. = 104.3696669°W</p> <p>NMSP EAST (FT) N = 643779.31 E = 530169.65</p>		<p>NE CORNER SEC. 10 LAT. = 32.7697958°N LONG. = 104.3610733°W</p> <p>NMSP EAST (FT) N = 643784.86 E = 532811.07</p>	
<p>NOTE: LATITUDE AND LONGITUDE COORDINATES ARE SHOWN USING THE NORTH AMERICAN DATUM OF 1983 (NAD83). LISTED NEW MEXICO STATE PLANE EAST COORDINATES ARE GRID (NAD83). BASIS OF BEARING AND DISTANCES USED ARE NEW MEXICO STATE PLANE, EAST COORDINATES MODIFIED TO THE SURFACE. VERTICAL DATUM, NAVD83.</p>					
<p>W Q CORNER SEC. 10 LAT. = 32.7624931°N LONG. = 104.3783083°W</p> <p>NMSP EAST (FT) N = 641129.88 E = 527512.41</p>		<p>HOLLAND 10N 1 ELEV. = 3339.4' LAT. = 32.7556136°N (NAD83) LONG. = 104.3708466°W</p> <p>NMSP EAST (FT) N = 638826.13 E = 529805.21</p>		<p>E Q CORNER SEC. 10 LAT. = 32.7624930°N LONG. = 104.3610992°W</p> <p>NMSP EAST (FT) N = 641128.03 E = 532802.40</p>	
<p>SW CORNER SEC. 10 LAT. = 32.7552460°N LONG. = 104.3783275°W</p> <p>NMSP EAST (FT) N = 638493.30 E = 527505.39</p>		<p>SURFACE LOCATION</p> <p>DNF</p>		<p>SE CORNER SEC. 10 LAT. = 32.7552375°N LONG. = 104.3611235°W</p> <p>NMSP EAST (FT) N = 638488.37 E = 532794.24</p>	
N89°56'48"W 2645.08 FT				N89°56'48"W 2645.08 FT	

17 OPERATOR CERTIFICATION

I hereby certify that the information contained herein is true and complete to the best of my knowledge and belief, and that this organization either owns a working interest or unleased mineral interest in the land including the proposed bottom hole location or has a right to drill this well at this location pursuant to a contract with an owner of such a mineral or working interest, or to a voluntary pooling agreement or a compulsory pooling order heretofore entered by the division.

Eric McCluskey 8/7/17
Signature Date

Eric McCluskey
Printed Name

emccluskey@limerockresources.com
E-mail Address

18 SURVEYOR CERTIFICATION

I hereby certify that the well location shown on this plat was plotted from field notes of actual surveys made by me or under my supervision, and that the same is true and correct to the best of my belief.

JULY 24, 2017
Date of Survey

Elimon F. Jaramillo
Signature and Seal of Professional Surveyor

Certificate Number: ELIMON F. JARAMILLO, PLS 12797
SURVEY NO. 5345

District I
 1425 N. French Dr., Hobbs, NM 88240
 Phone: (505) 493-6161 Fax: (505) 493-0700
 District II
 411 S. First St., Artesia, NM 88210
 Phone: (505) 748-1283 Fax: (505) 748-0720
 District III
 1000 Rio Brazos Road, Aztec, NM 87411
 Phone: (505) 434-6175 Fax: (505) 434-6179
 District IV
 1220 S. St. Francis Dr., Santa Fe, NM 87503
 Phone: (505) 476-3450 Fax: (505) 476-3462

State of New Mexico
NEW MEXICO OIL CONSERVATION
 Energy, Minerals & Natural Resources Department
OIL CONSERVATION DIVISION
 1220 South St. Francis Dr.
 Santa Fe, NM 87505

Form C-102
 Revised August 1, 2011
 Submit one copy to appropriate
 District Office
☐ AMENDED REPORT

Aug 09 2017

RECEIVED

WELL LOCATION AND ACREAGE DEDICATION PLAT

¹ API Number 30-015-44373	² Pool Code 3250	³ Pool Name ATOKA, GLORIETA-YESO
⁴ Property Code 314280	⁵ Property Name HOLLAND 10N	
⁶ OGRID No. 277558	⁷ Operator Name LIME ROCK RESOURCES II-A, L.P.	⁸ Well Number 1
		⁹ Elevation 3339.4

" Surface Location

UL or lot no.	Section	Township	Range	Lot Idn	Feet from the	North/South line	Feet from the	East/West line	County
N	10	18 S	26 E		135	SOUTH	2300	WEST	EDDY

" Bottom Hole Location If Different From Surface

UL or lot no.	Section	Township	Range	Lot Idn	Feet from the	North/South line	Feet from the	East/West line	County

¹⁰ Dedicated Acres	¹¹ Joint or Infill	¹² Consolidation Code	¹³ Order No.

No allowable will be assigned to this completion until all interests have been consolidated or a non-standard unit has been approved by the division.

NW CORNER SEC. 10 LAT. = 32.7697629°N LONG. = 104.3782885°W NMSP EAST (FT) N = 643774.73 E = 527519.63		N Q CORNER SEC. 10 LAT. = 32.7697629°N LONG. = 104.3696657°W NMSP EAST (FT) N = 643779.37 E = 530159.61		NE CORNER SEC. 10 LAT. = 32.7697658°N LONG. = 104.3619732°W NMSP EAST (FT) N = 643784.86 E = 532811.07	
W Q CORNER SEC. 10 LAT. = 32.7624931°N LONG. = 104.3785085°W NMSP EAST (FT) N = 641129.88 E = 527512.41		E Q CORNER SEC. 10 LAT. = 32.7624930°N LONG. = 104.3610990°W NMSP EAST (FT) N = 641128.03 E = 532811.40			
NOTE: 1. ALL SURVEYS USED THE NORTH 2. ALL SURVEYS USED THE NORTH 3. ALL SURVEYS USED THE NORTH 4. ALL SURVEYS USED THE NORTH 5. ALL SURVEYS USED THE NORTH 6. ALL SURVEYS USED THE NORTH 7. ALL SURVEYS USED THE NORTH 8. ALL SURVEYS USED THE NORTH 9. ALL SURVEYS USED THE NORTH 10. ALL SURVEYS USED THE NORTH 11. ALL SURVEYS USED THE NORTH 12. ALL SURVEYS USED THE NORTH 13. ALL SURVEYS USED THE NORTH 14. ALL SURVEYS USED THE NORTH 15. ALL SURVEYS USED THE NORTH 16. ALL SURVEYS USED THE NORTH 17. ALL SURVEYS USED THE NORTH 18. ALL SURVEYS USED THE NORTH 19. ALL SURVEYS USED THE NORTH 20. ALL SURVEYS USED THE NORTH 21. ALL SURVEYS USED THE NORTH 22. ALL SURVEYS USED THE NORTH 23. ALL SURVEYS USED THE NORTH 24. ALL SURVEYS USED THE NORTH 25. ALL SURVEYS USED THE NORTH 26. ALL SURVEYS USED THE NORTH 27. ALL SURVEYS USED THE NORTH 28. ALL SURVEYS USED THE NORTH 29. ALL SURVEYS USED THE NORTH 30. ALL SURVEYS USED THE NORTH 31. ALL SURVEYS USED THE NORTH 32. ALL SURVEYS USED THE NORTH 33. ALL SURVEYS USED THE NORTH 34. ALL SURVEYS USED THE NORTH 35. ALL SURVEYS USED THE NORTH 36. ALL SURVEYS USED THE NORTH 37. ALL SURVEYS USED THE NORTH 38. ALL SURVEYS USED THE NORTH 39. ALL SURVEYS USED THE NORTH 40. ALL SURVEYS USED THE NORTH 41. ALL SURVEYS USED THE NORTH 42. ALL SURVEYS USED THE NORTH 43. ALL SURVEYS USED THE NORTH 44. ALL SURVEYS USED THE NORTH 45. ALL SURVEYS USED THE NORTH 46. ALL SURVEYS USED THE NORTH 47. ALL SURVEYS USED THE NORTH 48. ALL SURVEYS USED THE NORTH 49. ALL SURVEYS USED THE NORTH 50. ALL SURVEYS USED THE NORTH 51. ALL SURVEYS USED THE NORTH 52. ALL SURVEYS USED THE NORTH 53. ALL SURVEYS USED THE NORTH 54. ALL SURVEYS USED THE NORTH 55. ALL SURVEYS USED THE NORTH 56. ALL SURVEYS USED THE NORTH 57. ALL SURVEYS USED THE NORTH 58. ALL SURVEYS USED THE NORTH 59. ALL SURVEYS USED THE NORTH 60. ALL SURVEYS USED THE NORTH 61. ALL SURVEYS USED THE NORTH 62. ALL SURVEYS USED THE NORTH 63. ALL SURVEYS USED THE NORTH 64. ALL SURVEYS USED THE NORTH 65. ALL SURVEYS USED THE NORTH 66. ALL SURVEYS USED THE NORTH 67. ALL SURVEYS USED THE NORTH 68. ALL SURVEYS USED THE NORTH 69. ALL SURVEYS USED THE NORTH 70. ALL SURVEYS USED THE NORTH 71. ALL SURVEYS USED THE NORTH 72. ALL SURVEYS USED THE NORTH 73. ALL SURVEYS USED THE NORTH 74. ALL SURVEYS USED THE NORTH 75. ALL SURVEYS USED THE NORTH 76. ALL SURVEYS USED THE NORTH 77. ALL SURVEYS USED THE NORTH 78. ALL SURVEYS USED THE NORTH 79. ALL SURVEYS USED THE NORTH 80. ALL SURVEYS USED THE NORTH 81. ALL SURVEYS USED THE NORTH 82. ALL SURVEYS USED THE NORTH 83. ALL SURVEYS USED THE NORTH 84. ALL SURVEYS USED THE NORTH 85. ALL SURVEYS USED THE NORTH 86. ALL SURVEYS USED THE NORTH 87. ALL SURVEYS USED THE NORTH 88. ALL SURVEYS USED THE NORTH 89. ALL SURVEYS USED THE NORTH 90. ALL SURVEYS USED THE NORTH 91. ALL SURVEYS USED THE NORTH 92. ALL SURVEYS USED THE NORTH 93. ALL SURVEYS USED THE NORTH 94. ALL SURVEYS USED THE NORTH 95. ALL SURVEYS USED THE NORTH 96. ALL SURVEYS USED THE NORTH 97. ALL SURVEYS USED THE NORTH 98. ALL SURVEYS USED THE NORTH 99. ALL SURVEYS USED THE NORTH 100. ALL SURVEYS USED THE NORTH					
SW CORNER SEC. 10 LAT. = 32.7624931°N LONG. = 104.3785085°W NMSP EAST (FT) N = 641129.88 E = 527512.41					
HOLLAND 10N ELEV. = 3339.4 LAT. = 32.7556130°N (NAD83) LONG. = 104.3768407°W NMSP EAST (FT) N = 638626.17 E = 524805.21					
SURFACE LOCATION 2300'					
SE CORNER SEC. 10 LAT. = 32.7612370°N LONG. = 104.3611235°W NMSP EAST (FT) N = 638498.37 E = 532794.24					

" OPERATOR CERTIFICATION

I hereby certify that the information contained herein is true and complete to the best of my knowledge and belief, and that this organization either owns a working interest or a mineral interest in the land including the proposed bottom hole location or has a right to drill this well at this location pursuant to a contract with the owner of such a mineral or working interest, or to a voluntary pooling agreement or a compulsory pooling order heretofore entered in the division.

Signature: *Eric McCluskey* Date: *8/7/17*

Printed Name: *Eric McCluskey*

E-mail Address: *emccluskey@limerockresources.com*

" SURVEYOR CERTIFICATION

I hereby certify that the well location shown on this plat was plotted from field notes of actual surveys made by me or under my supervision, and that the same is true and correct to the best of my belief.

Date of Survey: *July 24, 2017*

Signature: *[Signature]*

Printed Name: *[Name]*

Survey Number: *1* EDDY COUNTY, NEW MEXICO
 SURVEY NO. 0345

LIME ROCK RESOURCES II-A, L.P.
c/o Mike Pippin PE
3104 N. Sullivan Avenue
Farmington, NM 87401
505-327-4573 (phone) - 505-564-8656 (fax)
Email: mike@pippinllc.com

August 22, 2017

VIA CERTIFIED MAIL:
To all Offset Operators or Interest Owners

RE: **Application for Administrative Approval for a Non-standard Location**
HOLLAND 10 N #1 API#: 30-015-44373
135' FSL & 2300' FWL (N). Sec. 10 T18S R26E, Eddy County, NM
Atoka, Glorieta-Yeso (3250) & Atoka, San Andres (3610)

Dear Sir or Madam:

Enclosed please find a copy of the above captioned application that has been sent to the NMOCD for administrative approval. Should you not agree with the request, please notify the NMOCD within 20 days of the date of this application.

The APD for the referenced well was approved by the State on 8/17/17. The surface land owner, has requested that Lime Rock not drill the well in the middle of his cotton field. However, in order to accommodate the surface land owner, the well must be non-standard. The State rule is that a well must be at least 330' from a spacing unit line. We are submitting this NSL application in an effort to both produce the natural resource and accommodate the surface land owner.

Any questions you may have concerning the operations, please feel free to contact me at (505) 327-4573.

Best Regards,

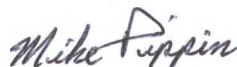

Mike Pippin
Petroleum Engineer

Enclosures

OFFSET OPERATORS
Non-Standard Location Application
HOLLAND 10 N #1

OPERATORS:

Lime Rock Resources II-A, L.P.
1111 Bagby Street, Suite 4600
Houston, TX 77002

Marathon Oil Permian LLC
5555 San Felipe St.
Houston, TX 77056-2723

37.

SURFACE LAND OWNERS

William C. & Patricia A. Netherlin
103 E. Four Dinkus Road,
Artesia, NM 88210

7016 0910 0001 2366 5085

U.S. Postal ServiceTM
CERTIFIED MAIL[®] RECEIPT
Domestic Mail Only

For delivery information, visit our website at www.usps.com[®]

HOUSTON, TX 77056

Certified Mail Fee \$3.35
\$2.75
Extra Services & Fees (check box, add fee as appropriate)
☐ Return Receipt (hardcopy) \$0.00
☐ Return Receipt (electronic) \$0.00
☐ Certified Mail Restricted Delivery \$0.00
☐ Adult Signature Required \$0.00
☐ Adult Signature Restricted Delivery \$0.00

Postage \$0.70
\$
Total Postage and Fees \$6.80

Sent To *Marathon Oil Permian LLC*
Street and Apt. No., or PO Box No. *5555 San Felipe St*
City, State, ZIP+4[®] *Houston TX 77056-2723*

PS Form 3800, April 2015 PSN 7530-02-000-9047

See Reverse for Instructions



SECTION 10, TOWNSHIP 18 SOUTH, RANGE 26 EAST, N.M.P.M.
 EDDY COUNTY, STATE OF NEW MEXICO
 LOCATION VERIFICATION MAP

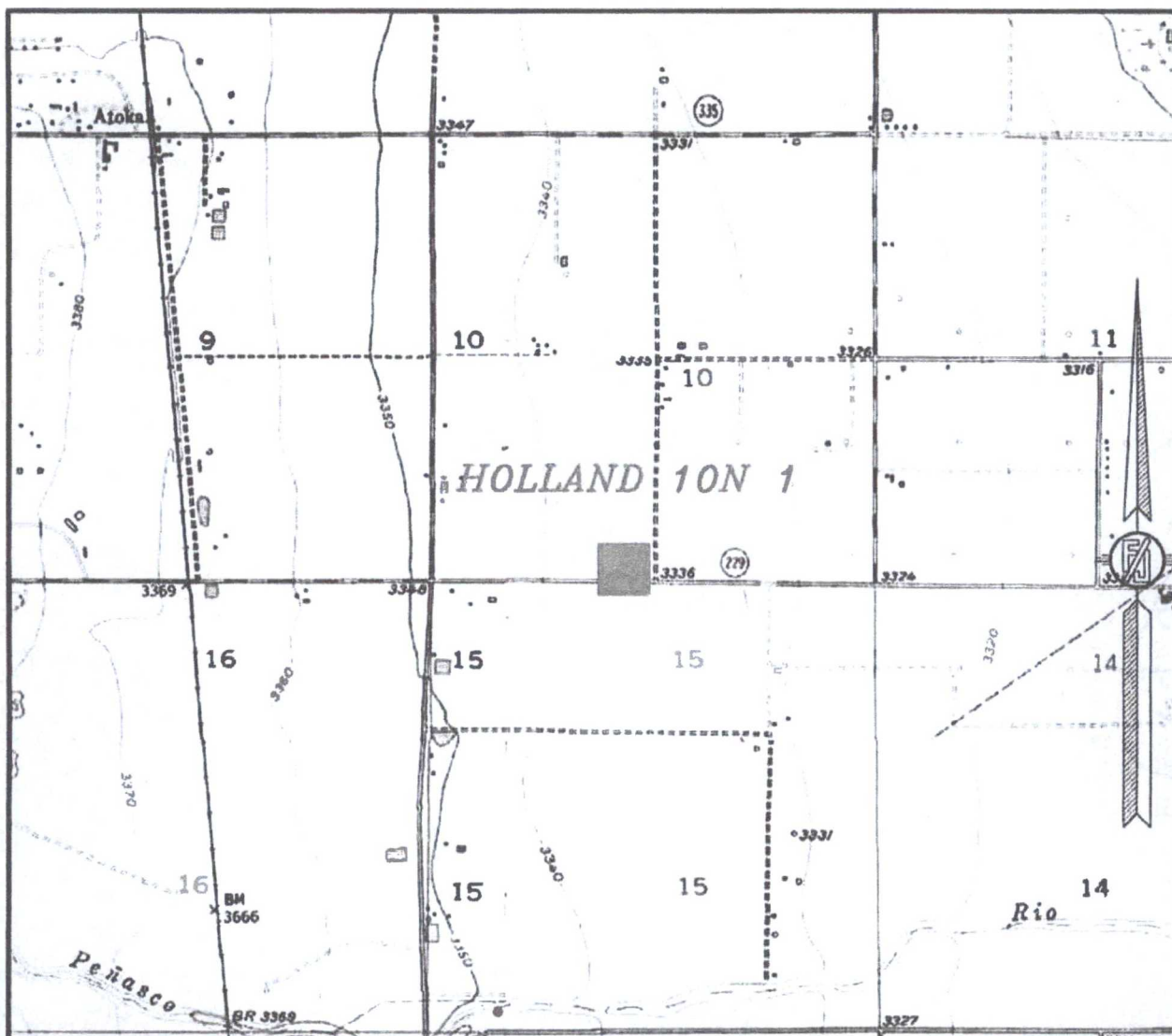

USGS QUAD MAP:
 SPRING LAKE

NOT TO SCALE

LIME ROCK RESOURCES II-A, L.P.
 HOLLAND 10N 1

LOCATED 135 FT. FROM THE SOUTH LINE
 AND 2300 FT. FROM THE WEST LINE OF
 SECTION 10, TOWNSHIP 18 SOUTH,
 RANGE 26 EAST, N.M.P.M.
 EDDY COUNTY, STATE OF NEW MEXICO

JULY 24, 2017

SURVEY NO. 5345

MADRON SURVEYING, INC. 301 SOUTH CANAL (575) 234-3341 CARLSBAD, NEW MEXICO

SECTION 10, TOWNSHIP 18 SOUTH, RANGE 26 EAST, N.M.P.M.
EDDY COUNTY, STATE OF NEW MEXICO
VICINITY MAP

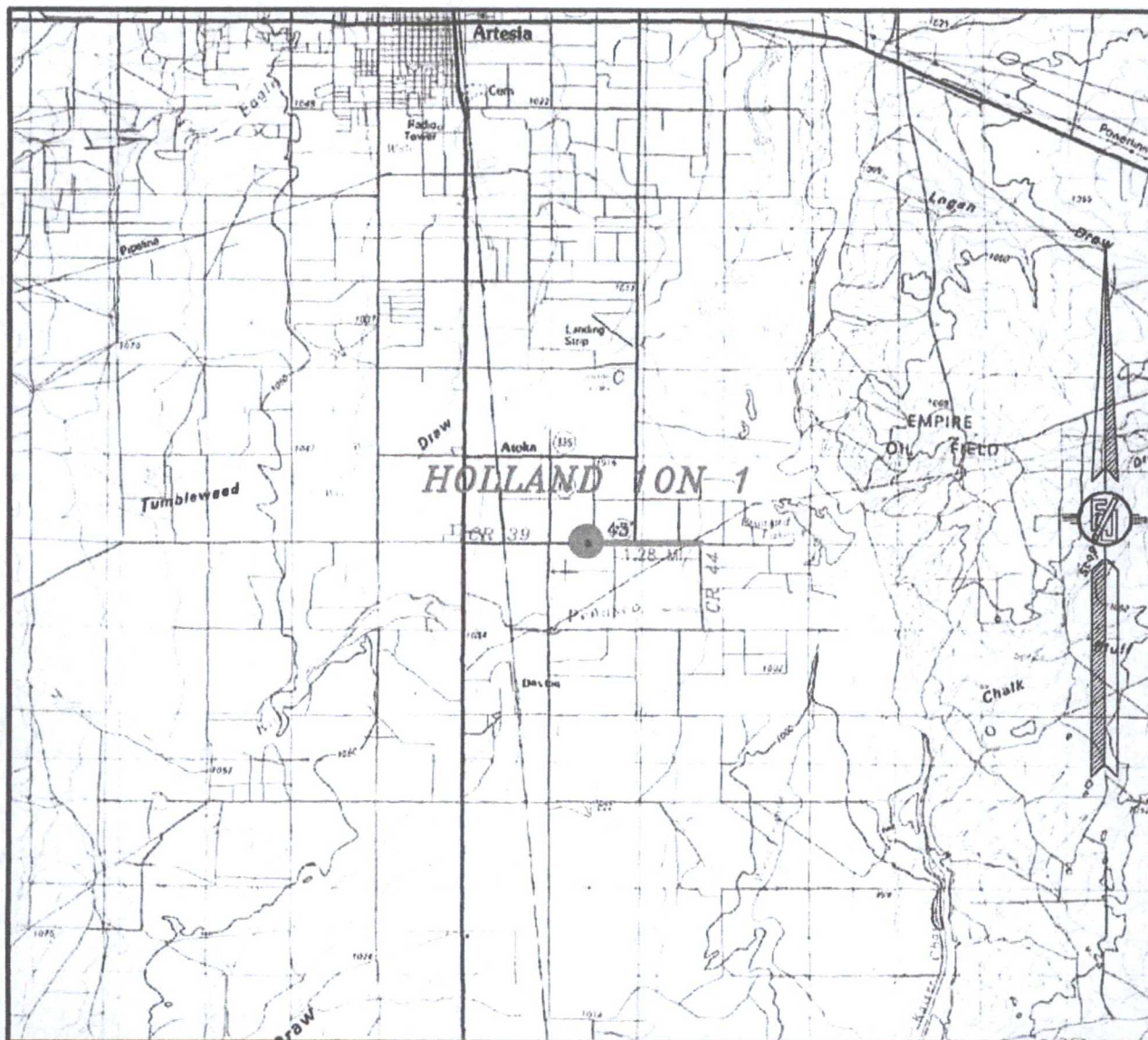

DISTANCES IN MILES

NOT TO SCALE

DIRECTIONS TO LOCATION
FROM CR 39 (FOUR DINKUS) AND CR 44 (FANNING) GO WEST ON CR 39 1.28 MILES, TURN RIGHT GO NORTH 43' TO THE SOUTHEAST PAD CORNER FOR THIS LOCATION.

LIME ROCK RESOURCES II-A, L.P.
HOLLAND 10N 1
LOCATED 135 FT. FROM THE SOUTH LINE
AND 2300 FT. FROM THE WEST LINE OF
SECTION 10, TOWNSHIP 18 SOUTH,
RANGE 26 EAST, N.M.P.M.
EDDY COUNTY, STATE OF NEW MEXICO

JULY 24, 2017

MADRON SURVEYING, INC. 301 SOUTH CANAL (575) 234-3341 CARLSBAD, NEW MEXICO

SURVEY NO. 5345

Lowe, Leonard, EMNRD

From: Lowe, Leonard, EMNRD
Sent: Wednesday, September 13, 2017 8:30 AM
To: 'mike@pippinllc.com'
Cc: Sharp, Karen, EMNRD; Podany, Raymond, EMNRD; 'lisa@rwbyram.com'; Jones, William V, EMNRD; Goetze, Phillip, EMNRD; McMillan, Michael, EMNRD
Subject: APPROVED: NSL-7582 (SEC 12 18S 26E) & NSL-7583 (SEC 10 18S 26E)_LIME ROCK RESOURCES II-A, L.P.

Importance: High

Mr. Mike Pippin,

The following administrative orders have been issued and will soon be available on the Division's web site:

<http://ocdimage.emnrd.state.nm.us/Imaging/Default.aspx>

NSL – 7582

Lime Rock Resources II-A, L.P.

WELL: API #: 30-015-44412

NAME: Brainard 12M Well No. 2

NSL – 7583

Lime Rock Resources II-A, L.P.

WELL: API #: 30-015-44373

NAME: Holland 10 N Well No. 1

Leonard Lowe

Engineering Bureau

Oil Conservation Division

Energy Minerals and Natural Resources Department

1220 South St. Frances

Santa Fe, New Mexico 87004

Office: 505-476-3492

Cell: 505-930-6717

Fax: 505-476-3462

E-mail: leonard.lowe@state.nm.us

Website: <http://www.emnrd.state.nm.us/ocd/>