

**OIL CONSERVATION COMMISSION**

P. O. BOX 871

SANTA FE, NEW MEXICO

August 3, 1965

**Sinclair Oil & Gas Company  
P. O. Box 1920  
Hobbs, New Mexico**

**Attention: Mr. W. F. Burns, Superintendent**

**Re: State 157 "G" Well No. 3, Unit A, Section 5,  
Township 22 South, Range 36 East, Jalmat Gas  
Pool, Lea County, New Mexico**

**Gentlemen:**

We have your letter of July 27, 1965, requesting authority to dedicate the 160-acre non-standard gas proration unit approved by Administrative Order NSP-183 to the above well.

We do not feel that formal approval is necessary in order to rededicate this unit to the above well. Your letter of July 27, 1965, and the Form C-102 attached thereto will be sufficient to rededicate the acreage. A copy of your letter of July 27, the Form C-102 attached thereto, and this letter will be placed in the Commission's NSP-183 file, in the State 157 "G" Well No. 1 well file, in the State 157 "G" Well No. 3 well file, and forwarded to our Proration Department and Hobbs District Office.

Very truly yours,

**J. M. DURRETT, Jr.  
Attorney**

**JMD/esr**

**cc: Oil Conservation Commission - Hobbs  
Proration Department, OCC - Santa Fe  
State Land Office - Santa Fe**

C  
O  
P  
Y



SINCLAIR OIL & GAS COMPANY

P.O. Box 1920  
Hobbs, New Mexico

July 27, 1965

New Mexico Oil Conservation Commission  
P.O. Box 2088  
Santa Fe, New Mexico

Attention: Mr. A.L. Porter, Jr.

Re: Acreage dedication to  
State 157 "G" Well No. 3  
Jalmat Gas Pool

Dear Sir:

We have recently completed our State 157 "G" Well No. 3 located 990 feet from the North and East lines of Section 5, T-22S, R-36E, Lea County, New Mexico, in the Jalmat Gas Pool and it is requested that administrative approval of a non-standard proration unit consisting of the 160 acres located in the Northwest Quarter of Section 5-22S-36E be approved for this well.

This 160 acres non-standard unit requested for our Well No. 3 is presently dedicated to our State 157 "G" Well No. 1 in the Jalmat Gas Pool and was approved by the Oil Conservation Commission's Order NSP-183 dated September 2, 1955. Our State 157 "G" Well No. 1 is dead and has been shut in.

Yours truly,

W.F. Burns  
Superintendent

MAIN OFFICE OCC

'65 JUL 30 PM 1 03

**NEW MEXICO OIL CONSERVATION COMMISSION  
WELL LOCATION AND ACREAGE DEDICATION PLAT**

Form C-102  
Supersedes C-128  
Effective 1-1-65

All distances must be from the outer boundaries of the Section.

Operator <b>Sinclair Oil &amp; Gas Company</b>			Lease <b>State 157 "G"</b>		Well No. <b>3</b>
Unit Letter <b>A</b>	Section <b>5</b>	Township <b>22S</b>	Range <b>36E</b>	County <b>Lea</b>	
Actual Footage Location of Well: <div style="display: flex; justify-content: space-between; align-items: center;"> <span><b>990</b> feet from the <b>North</b> line and</span> <span><b>990</b> feet from the <b>East</b> line</span> </div>					
Ground Level Elev:	Producing Formation <b>Yates</b>	Pool <b>Jalmat (Gas)</b>	Dedicated Acreage: <b>160</b> Acres		

1. Outline the acreage dedicated to the subject well by colored pencil or hachure marks on the plat below.
2. If more than one lease is dedicated to the well, outline each and identify the ownership thereof (both as to working interest and royalty).
3. If more than one lease of different ownership is dedicated to the well, have the interests of all owners been consolidated by communitization, unitization, force-pooling, etc?

☐ Yes    ☐ No    If answer is "yes," type of consolidation \_\_\_\_\_

If answer is "no," list the owners and tract descriptions which have actually been consolidated. (Use reverse side of this form if necessary.) \_\_\_\_\_

No allowable will be assigned to the well until all interests have been consolidated (by communitization, unitization, forced-pooling, or otherwise) or until a non-standard unit, eliminating such interests, has been approved by the Commission.

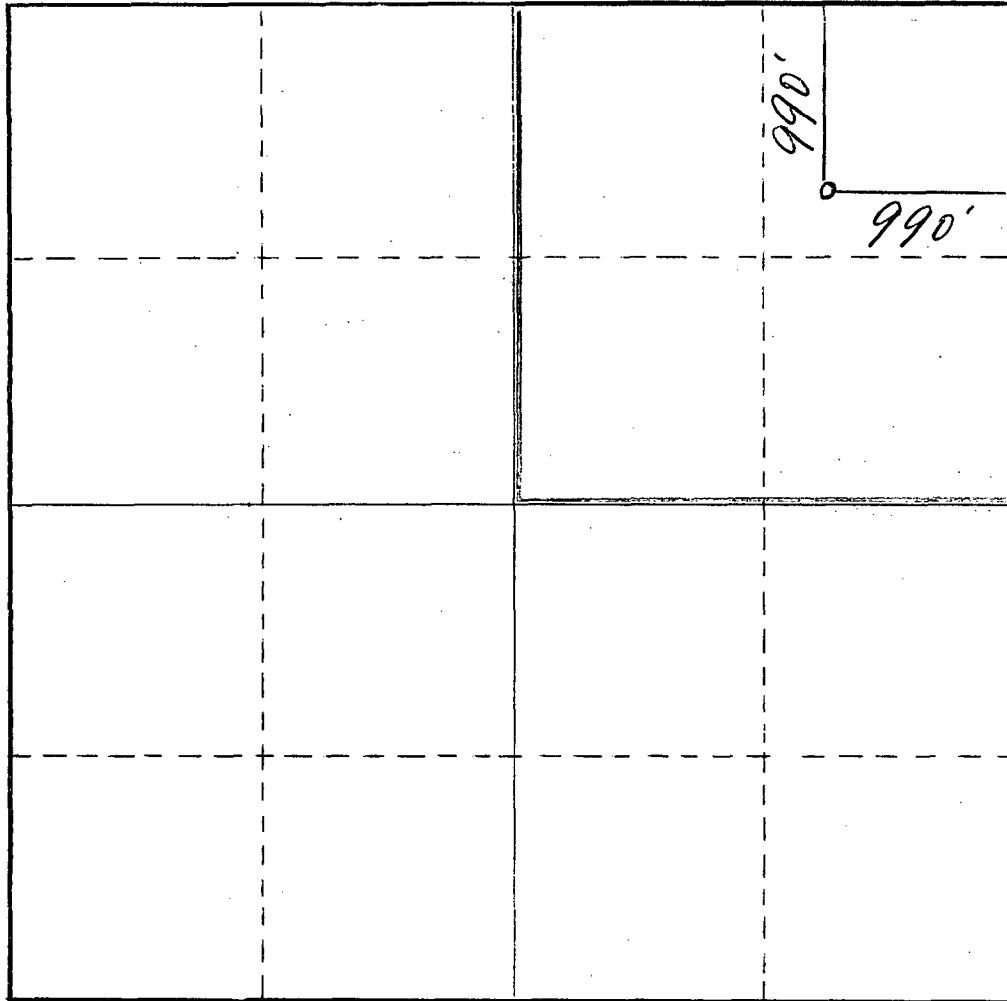

**CERTIFICATION**

*I hereby certify that the information contained herein is true and complete to the best of my knowledge and belief.*

Name \_\_\_\_\_

Position \_\_\_\_\_

Company \_\_\_\_\_

Date \_\_\_\_\_

*I hereby certify that the well location shown on this plat was plotted from field notes of actual surveys made by me or under my supervision, and that the same is true and correct to the best of my knowledge and belief.*

Date Surveyed \_\_\_\_\_

Registered Professional Engineer  
and/or Land Surveyor

Certificate No. \_\_\_\_\_

