

RECEIVED: 9/22/2017	REVIEWER: MAM	TYPE: PLC	APP NO: PLMAM172653977
------------------------	------------------	--------------	---------------------------

ABOVE THIS TABLE FOR OCD DIVISION USE ONLY

NEW MEXICO OIL CONSERVATION DIVISION
 - Geological & Engineering Bureau -
 1220 South St. Francis Drive, Santa Fe, NM 87505

**ADMINISTRATIVE APPLICATION CHECKLIST**

THIS CHECKLIST IS MANDATORY FOR ALL ADMINISTRATIVE APPLICATIONS FOR EXCEPTIONS TO DIVISION RULES AND
 REGULATIONS WHICH REQUIRE PROCESSING AT THE DIVISION LEVEL IN SANTA FE

Applicant: <u>OXY USA WTP LP</u>	OGRID Number: <u>192463</u>
Well Name: <u>STATE CV COM #2H</u>	API: <u>30-015-41857</u>
Pool: <u>OLD MILLMAN RANCH;BS (ASSOC)</u>	Pool Code: <u>48035</u>

**SUBMIT ACCURATE AND COMPLETE INFORMATION REQUIRED TO PROCESS THE TYPE OF APPLICATION
 INDICATED BELOW**

- 1) **TYPE OF APPLICATION:** Check those which apply for (A)
- A. Location - Spacing Unit - Simultaneous Dedication
- ☐ NSL ☐ NSP (PROJECT AREA) ☐ NSP (PRORATION UNIT) ☐ SD

B. Check one only for (I) or (II)

(I) Commingling - Storage - Measurement

☐ DHC ☐ CTB ☒ PLC ☐ PC ☐ OLS ☐ OLM

(II) Injection - Disposal - Pressure Increase - Enhanced Oil Recovery

☐ WFX ☐ PMX ☐ SWD ☐ IPI ☐ EOR ☐ PPR

2) **NOTIFICATION REQUIRED TO:** Check those which apply.

- A. ☐ Offset operators or lease holders
- B. ☒ Royalty, overriding royalty owners, revenue owners
- C. ☐ Application requires published notice
- D. ☒ Notification and/or concurrent approval by SLO
- E. ☐ Notification and/or concurrent approval by BLM
- F. ☐ Surface owner
- G. ☒ For all of the above, proof of notification or publication is attached, and/or,
- H. ☐ No notice required

FOR OCD ONLY

☐ Notice Complete

☐ Application Content Complete

- 3) **CERTIFICATION:** I hereby certify that the information submitted with this application for administrative approval is **accurate** and **complete** to the best of my knowledge. I also understand that **no action** will be taken on this application until the required information and notifications are submitted to the Division.

Note: Statement must be completed by an individual with managerial and/or supervisory capacity.

Taylor Stillman
 Print or Type Name

Taylor Stillman
 Signature

09/22/2017
 Date

(713) 366-5945
 Phone Number

Taylor-Stillman@oxy.com
 e-mail Address

District I
1625 N. French Drive, Hobbs, NM 88240
District II
811 S. First St., Artesia, NM 88210
District III
1000 Rio Brazos Road, Aztec, NM 87410
District IV
1220 S. St Francis Dr, Santa Fe, NM
87505

State of New Mexico
Energy, Minerals and Natural Resources Department

Form C-107-B
Revised August 1, 2011

OIL CONSERVATION DIVISION
1220 S. St Francis Drive
Santa Fe, New Mexico 87505

Submit the original
application to the Santa Fe
office with one copy to the
appropriate District Office.

APPLICATION FOR SURFACE COMMINGLING (DIVERSE OWNERSHIP)

OPERATOR NAME: OXY USA WTP LP
OPERATOR ADDRESS: 5 GREENWAY PLAZA SUITE 110 HOUSTON, TX 77046
APPLICATION TYPE:

☐ Pool Commingling ☐ Lease Commingling ☒ Pool and Lease Commingling ☐ Off-Lease Storage and Measurement (Only if not Surface Commingling)

LEASE TYPE: ☐ Fee ☒ State ☐ Federal

Is this an Amendment to existing Order? ☐ Yes ☒ No If "Yes", please include the appropriate Order No. _____
Have the Bureau of Land Management (BLM) and State Land office (SLO) been notified in writing of the proposed commingling
☒ Yes ☐ No

(A) POOL COMMINGLING
Please attach sheets with the following information

(1) Pool Names and Codes	Gravities / BTU of Non-Commingled Production	Calculated Gravities / BTU of Commingled Production		Calculated Value of Commingled Production	Volumes
SEE ATTACHED					

- (2) Are any wells producing at top allowances? ☐ Yes ☒ No
(3) Has all interest owners been notified by certified mail of the proposed commingling? ☒ Yes ☐ No.
(4) Measurement type: ☒ Metering ☐ Other (Specify)
(5) Will commingling decrease the value of production? ☐ Yes ☒ No If "yes", describe why commingling should be approved

(B) LEASE COMMINGLING
Please attach sheets with the following information

- (1) Pool Name and Code.
(2) Is all production from same source of supply? ☐ Yes ☐ No
(3) Has all interest owners been notified by certified mail of the proposed commingling? ☐ Yes ☐ No
(4) Measurement type: ☐ Metering ☐ Other (Specify)

(C) POOL and LEASE COMMINGLING
Please attach sheets with the following information

- (1) Complete Sections A and E.

(D) OFF-LEASE STORAGE and MEASUREMENT
Please attached sheets with the following information

- (1) Is all production from same source of supply? ☐ Yes ☐ No
(2) Include proof of notice to all interest owners.

(E) ADDITIONAL INFORMATION (for all application types)
Please attach sheets with the following information

- (1) A schematic diagram of facility, including legal location.
(2) A plat with lease boundaries showing all well and facility locations. Include lease numbers if Federal or State lands are involved.
(3) Lease Names, Lease and Well Numbers, and API Numbers.

I hereby certify that the information above is true and complete to the best of my knowledge and belief.

SIGNATURE: Taylor Stillman TITLE: Regulatory Engineer DATE: 09/22/17
TYPE OR PRINT NAME Taylor Stillman TELEPHONE NO.: (713) 366-5945
E-MAIL ADDRESS: Taylor.Stillman@oxy.com

APPLICATION FOR POOL LEASE COMMINGLE

OXY USA WTP LP respectfully requests Pool Lease Commingling approval to commingle production from the following wells:

Well Name	State Lease Number	Pool	API	Location	BOPD	Oil Gravity	MCFPD	BTU/CF	Water (BWPD)
State CV Com 1	K065991	Burton Flat Wolfcamp, North (73520) & Saladar Strawn (84412)	30-015-21927	E-16-20S-28E	82	42	750	1000	216
State CV Com 2H	LG7943	OLD MILLMAN RANCH;BS (ASSOC) (48035)	30-015-41857	H-16-20S-28E	46	42	117	1000	156
Oxy Bulldog State 1	LG7943	Burton Flat Wolfcamp, North (73520) & Saladar Strawn (84412)	30-015-29234	H-16-20S-28E	82	42	750	1000	216

Oil production at the State CV 2H battery will be separated and measured using three 4' X 10' permanent three-phase separators. Oil production will then flow through tanks, before being sold through a LACT unit, located at the battery. Each well will be continuously measured through one of the aforementioned separators. Each vessel will be equipped with an oil turbine meters, gas orifice meter and water turbine meter.

Gas from the separators will be sent to DCP gas sales meter S/N 713245.

Produced water will be sent to the Government AB 9 SWD.

Additional Application Components:

The flow of production is shown in detail on the enclosed facility diagram. Also enclosed is a map detailing the lease boundaries, well and battery locations.

The working interest, royalty interest and overriding royalty interest owners have been notified of this proposal by certified mail (see attached).

Pursuant to Statewide rule 19.15.12.10(C)(4)(g) OXY USA INC requests the option to include additional pools or leases within the defined parameters set forth in the order for future additions.

Commingling this production is the most effective means of producing the reserves. OXY USA INC understands the requested approval will not constitute the granting of any right-of-way or construction rights not granted by the lease instrument.

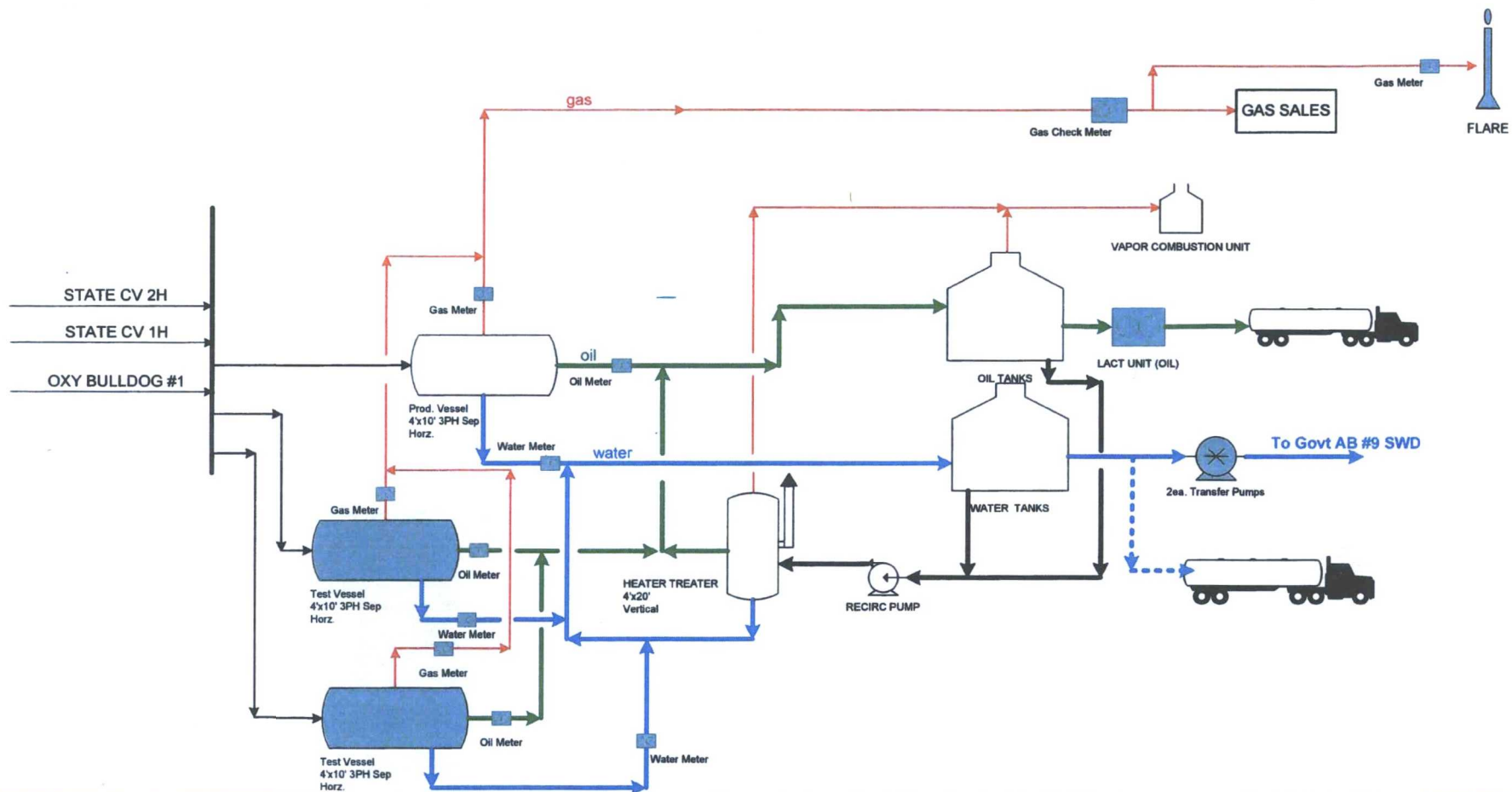

REVISION BLOCK

NO.	DATE	DESCRIPTION	BY	CHK	APP
1	9/6/17		LDS		

ENGINEERING RECORD

BY	DATE
DRN:	
DES:	
CHK:	
APP:	
AFE:	

PROCESS FLOW DIAGRAM
STATE CV- 2H CTB
BURTON FLATS
EDDY COUNTY, NEW MEXICO

RECEIVED

DEC 12 2013

NM OIL CONSERVATION

ARTESIA DISTRICT

SEP 11 2014

Office 1
103 N. French Dr., Hobbs, NM 88240
Phone: (505) 393-6181 Fax: (505) 393-6720
Office 2
811 S. First St., Artesia, NM 88210
Phone: (505) 748-1281 Fax: (505) 748-9720
Office 3
1000 Rio Rancho Road, Acoma, NM 87410
Phone: (505) 334-4179 Fax: (505) 334-8170
Office 4
1230 S. St. Francis Dr., Santa Fe, NM 87505
Phone: (505) 476-3480 Fax: (505) 476-3462

NM OIL CONSERVATION

State of New Mexico
Minerals & Natural Resources Department
OIL CONSERVATION DIVISION
1220 South St. Francis Dr.
Santa Fe, NM 87505

Form C-102
Revised August 1, 2011
RECEIVED
Submit one copy to appropriate
District Office

AMENDED REPORT

WELL LOCATION AND ACREAGE DEDICATION PLAT

As-Drilled

API Number 32-015-41857	Pool Code 48035	Pool Name Old Millman Ranch Bone Springs
Property Code 302161	Property Name STATE C.V. COM.	Well Number 2H
OGRID No. 192463	Operator Name OXY USA LTP LP	Elevation 3274.7'

Surface Location

UL or lot no.	Section	Township	Range	Lot 1st	Feet from the	North/South line	Feet from the	East/West line	County
H	16	20 SOUTH	28 EAST, N.M.P.M.		1700'	NORTH	300'	EAST	EDDY

Bottom Hole Location If Different From Surface

UL or lot no.	Section	Township	Range	Lot 1st	Feet from the	North/South line	Feet from the	East/West line	County
E	16	20 SOUTH	28 EAST, N.M.P.M.		1791'	NORTH	189'	WEST	EDDY

Dedicated Acres	Joint or Infill	Consolidation Code	Order No.
40	16.0 ac.		

No allowable will be assigned to this completion until all interests have been consolidated or a non-standard unit has been approved by the division.

Top Perf = 1701' FUL 393' FEL Bottom Perf = 1724' FUL 315' FEL

<p>1791'</p> <p>189'</p> <p>GRID A2 = 269°38'48" 4709.79' IN. ALL</p> <p>PRODUCING AREA</p> <p>PROJECT AREA</p> <p>330'</p> <p>1700'</p> <p>330'</p>			<p>OPERATOR CERTIFICATION</p> <p>I hereby certify that the information contained herein is true and complete to the best of my knowledge and belief, and that this organization either owns a working interest or mineral interest in the land including the proposed bottom hole location or has a right to drill this well at this location pursuant to a contract with an owner of such a mineral or working interest, or to a voluntary pooling agreement or a compulsory pooling order heretofore entered by the division.</p> <p><i>Jennifer Drake</i> 12/11/13 Signature jennifer.drake@oxy.com Print Name jennifer.drake@oxy.com E-mail Address</p>
<p>BOTTOM HOLE LOCATION NEW MEXICO EAST NAD 1927 Y=573304.8 X=344233.0 LAT.: N 32.5760395° LONG.: W 104.1897388°</p>	<p>PENETRATION POINT NEW MEXICO EAST NAD 1927 Y=573333.7 X=348912.7 LAT.: N 32.5781005° LONG.: W 104.1745468°</p>	<p>SURFACE LOCATION NEW MEXICO EAST NAD 1927 Y=573333.8 X=348942.7 LAT.: N 32.5781005° LONG.: W 104.1744495°</p>	
<p>SURVEYOR CERTIFICATION</p> <p>I hereby certify that the well proposed shown on this plat was plotted from field notes of actual surveys made by me or under my supervision, and that the same is true and correct to the best of my belief.</p> <p>SEPTEMBER 22, 2013 Date of Survey</p> <p><i>Jeffrey J. Drake</i> Signature and Seal Professional Surveyor</p> <p>Certificate Number 15079</p> <p>WD# 130922WL (RA)</p>			

DISTRICT I
P.O. Box 1980, Hobbs, NM 88240

DISTRICT II
P.O. Drawer DD, Artesia, NM 88210

DISTRICT III
1000 Rio Brazos Rd., Aztec, NM 87410

State of New Mexico
Energy, Minerals and Natural Resources Department

Form C-102
Revised February 10, 1994
Instruction on back
Submit to Appropriate District Office
State Lease - 4 Copies
Fee Lease - 5 Copies

OIL CONSERVATION DIVISION

P.O. Box 2088
Santa Fe, New Mexico 87504-2088

☐ AMENDED REPORT

WELL LOCATION AND ACREAGE DEDICATION PLAT

API Number 30-015-29234	Pool Code 73280	Pool Name Burton Flat-Morrow PRO GAS
Property Code	Property Name Oxy Bulldog State	Well Number 1
OGRI No. 16696	Operator Name Oxy USA Inc.	Elevation 3265'

Surface Location

UL or lot No. H	Section 16	Township 20 S	Range 28 E	Lot Idn	Feet from the 1980	North/South line North	Feet from the 660	East/West line East	County Eddy
--------------------	---------------	------------------	---------------	---------	-----------------------	---------------------------	----------------------	------------------------	----------------

Bottom Hole Location If Different From Surface

UL or lot No.	Section	Township	Range	Lot Idn	Feet from the	North/South line	Feet from the	East/West line	County
Dedicated Acres 320	Joint or Infill N	Consolidation Code	Order No.						

NO ALLOWABLE WILL BE ASSIGNED TO THIS COMPLETION UNTIL ALL INTERESTS HAVE BEEN CONSOLIDATED
OR A NON-STANDARD UNIT HAS BEEN APPROVED BY THE DIVISION

	OPERATOR CERTIFICATION I hereby certify the the information contained herein is true and complete to the best of my knowledge and belief. Signature David Stewart Printed Name Regulatory Analyst Title 10/18/96 Date	
	SURVEYOR CERTIFICATION I hereby certify that the well location shown on this plat was plotted from field notes of actual surveys made by me or under my supervision, and that the same is true and correct to the best of my belief. September 27, 1996 Date Surveyed Signature & Seal of Professional Surveyor W.O. No. 6412a Certificate No. Gary L. Jones 7977 BASIN SURVEYS	

District I
1625 N. French Dr., Hobbs, NM 88240
Phone (575) 393-6161 Fax (575) 393-0720
District II
811 S. First St., Artesia, NM 88210
Phone (575) 748-1243 Fax (575) 748-9720
District III
1960 Rio Brazos Road, Aztec, NM 87410
Phone (505) 334-6174 Fax (505) 334-6170
District IV
1220 S. St. Francis Dr., Santa Fe, NM 87505
Phone (505) 476-3460 Fax (505) 476-3462

State of New Mexico
Energy, Minerals & Natural Resources Department
OIL CONSERVATION DIVISION
1220 South St. Francis Dr.
Santa Fe, NM 87505

NM OIL CONSERVATION
ARTESIA DISTRICT

Form C-102

SEP 18 2017

Revised August 1, 2011

Submit one copy to appropriate

District Office

RECEIVED

☒ AMENDED REPORT

WELL LOCATION AND ACREAGE DEDICATION PLAT

¹ API Number 30-015-29234	² Pool Code 73520	³ Pool Name Bunton Flat Wolfcamp, North
⁴ Property Code	⁵ Property Name OXY Bulldog State	⁶ Well Number 1
⁷ OGRID No. 192463	⁸ Operator Name OXY USA WTP LP	⁹ Elevation 3265

¹⁰ Surface Location

UL or lot no.	Section	Township	Range	Lot Idn	Feet from the	North/South line	Feet from the	East/West line	County
H	16	20S	28E		1980	North	660	east	Eddy

¹¹ Bottom Hole Location If Different From Surface

UL or lot no.	Section	Township	Range	Lot Idn	Feet from the	North/South line	Feet from the	East/West line	County

¹² Dedicated Acres 320	¹³ Joint or Infill N	¹⁴ Consolidation Code	¹⁵ Order No.
--------------------------------------	------------------------------------	----------------------------------	-------------------------

No allowable will be assigned to this completion until all interests have been consolidated or a non-standard unit has been approved by the division.

	<p>¹⁷ OPERATOR CERTIFICATION</p> <p>I hereby certify that the information contained herein is true and complete to the best of my knowledge and belief, and that this organization either owns a working interest or unleased mineral interest in the land including the proposed bottom hole location or has a right to drill this well at this location pursuant to a contract with an owner of such a mineral or working interest, or to a voluntary pooling agreement or a compulsory pooling order heretofore entered by the division.</p> <p><i>David Stewart</i> 9/14/17 Signature Date</p> <p>David Stewart Sr. Res. Adm. Printed Name</p> <p>david_stewart@oxy.com E-mail Address</p>
	<p>¹⁸ SURVEYOR CERTIFICATION</p> <p>I hereby certify that the well location shown on this plat was plotted from field notes of actual surveys made by me or under my supervision, and that the same is true and correct to the best of my belief.</p>
	<p>Date of Survey</p> <p>Signature and Seal of Professional Surveyor:</p>
	<p>Certificate Number</p>

OXY USA WTP LP - Current
OXY Bulldog State #1
API No. 30-015-29234

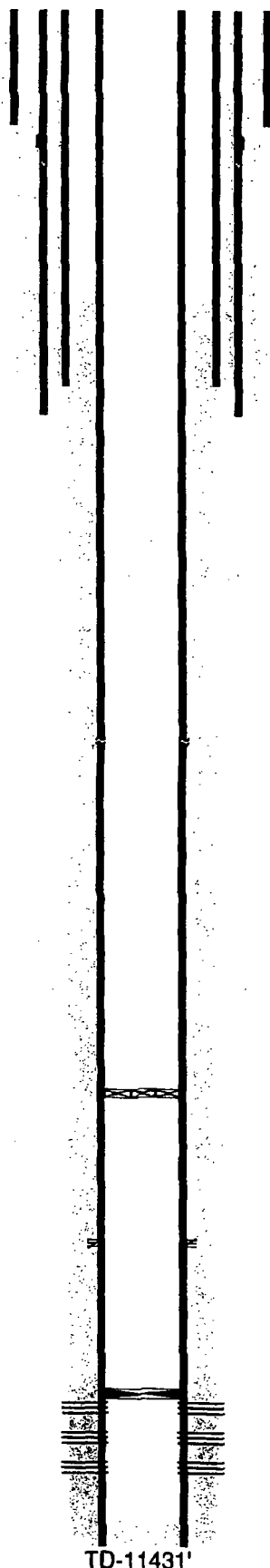

4/12-CIBP @ 10582'

OXY USA WTP LP - Proposed
OXY Bulldog State #1
API No. 30-015-29234

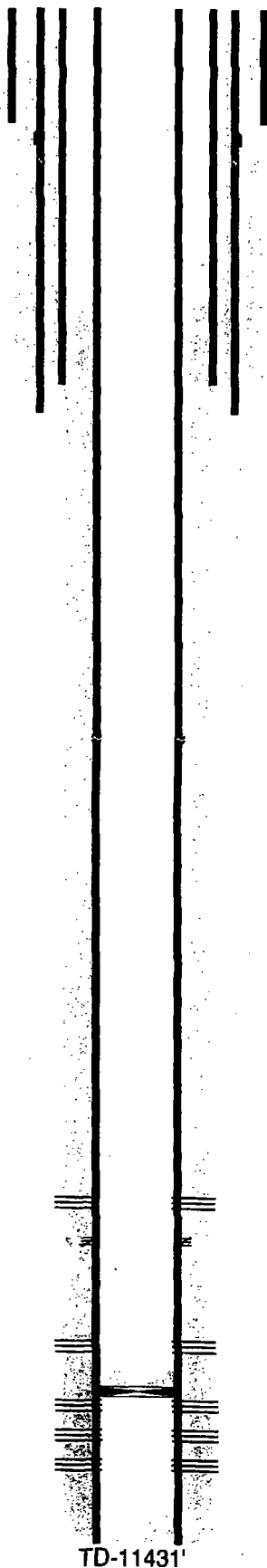

17-1/2" hole @ 416'
13-3/8" csg @ 416'
w/ 420sx-TOC-Surf-Circ

Csg part @ 1272' & 1432', sqz w/ 500sx cmt

7" csg @ 2902'
w/ 250sx-TOC-Surf-Circ

11" hole @ 3050'
8-5/8" csg @ 3046'
DVT @ 1210'
w/ 1975sx-TOC-Surf-Circ

4/12-csg lk @ 5810-5842'
sqz w/ 490sx cmt-TOC-2540'-Calc

Perfs @ 9080-9217'
4/12-Perf @ 9500', sqz w/415sx cmt TOC-5852'-TS
6-1/4" hole @ 11431'
4-1/2" csg @ 11431'
w/ 125sx-TOC-9566'-CBL

Perfs @ 10319-10328'

Perfs @ 10630-11154'

15sx @ 10582-10417' WOC-Tag
4/12-CIBP @ 10582'

PB-11385'

TD-11431'

District I
1625 N. French Dr., Hobbs, NM 88240
Phone (575) 393-6161 Fax (575) 393-0720

District II
811 S. First St., Artesia, NM 88210
Phone (575) 748-1283 Fax (575) 748-9720

District III
1000 Rio Brazos Road, Aztec, NM 87410
Phone (505) 334-6178 Fax (505) 334-6170

District IV
1220 S. St. Francis Dr., Santa Fe, NM 87505
Phone (505) 476-3460 Fax (505) 476-3462

State of New Mexico
Energy Minerals and Natural Resources
Oil Conservation Division
1220 South St. Francis Dr.
Santa Fe, NM 87505

NM OIL CONSERVATION
ARTESIA DISTRICT
SEP 18 2017
AMENDED REPORT
RECEIVED

APPLICATION FOR PERMIT TO DRILL, RE-ENTER, DEEPEN, PLUGBACK, OR ADD A ZONE

Operator Name and Address OXY USA WTP LP P.O. Box 50250 Midland, TX 79710		OGRID Number 192463
Property Code		API Number 30-015-21927
Property Name State CV Com		Well No.

Surface Location

UL - Lot	Section	Township	Range	Lot Idn	Feet from	N/S Line	Feet From	E/W Line	County
E	16	20S	20E		1980	North	760	West	Eddy

Proposed Bottom Hole Location

UL - Lot	Section	Township	Range	Lot Idn	Feet from	N/S Line	Feet From	E/W Line	County

Pool Information

Pool Name Benton Flat Wolfcamp, North - 73520	Pool Code Saladar Strawn - 84412
--	-------------------------------------

Additional Well Information

Work Type PB	Well Type G	Cable/Rotary N/A	Lease Type S	Ground Level Elevation 3276
Multiple Y - DHC	Proposed Depth 10305'	Formation Wolfcamp-Strawn	Contractor N/A	Spud Date After Permit + Approval
Depth to Ground water		Distance from nearest fresh water well		Distance to nearest surface water

☒ We will be using a closed-loop system in lieu of lined pits

Proposed Casing and Cement Program

Type	Hole Size	Casing Size	Casing Weight/ft	Setting Depth	Sacks of Cement	Estimated TOC
Surf	17 1/2"	13 3/8"	48	615'	895	Surf-Cinc
Int	12 1/4"	8 5/8"	24-32	3000'	2125	" "
Prod	7 7/8"	5 1/2"	17-20 11.35	11360' 10953'	725 200	8530' 1612'-CBL

Casing/Cement Program: Additional Comments

See Attached for proposed procedure & WBD	DHC to be filed
---	-----------------

Proposed Blowout Prevention Program

Type	Working Pressure	Test Pressure	Manufacturer
Annular	5000	5000	

23. I hereby certify that the information given above is true and complete to the best of my knowledge and belief.
I further certify that I have complied with 19.15.14.9 (A) NMAC ☒ and/or 19.15.14.9 (B) NMAC ☒ if applicable.
Signature: *David Stewart*

Printed name: David Stewart
Title: Sr. Regulatory Advisor
E-mail Address: david_stewart@oxy.com
Date: 9/14/17 Phone: 432-665577

OIL CONSERVATION DIVISION

Approved By: *Raymond W. Rodang*
Title: Geologist
Approved Date: 9-18-17 Expiration Date: 9-18-19
Conditions of Approval Attached

Attachment C-101

OXY USA WTP LP

State CV Com #1 - 30-015-21927

- 1 Rig Up Well service Unit
- 2 Check for pressures in the well
- 3 Nipple down wellhead and nipple up BOP
- 4 Unset Packer and POOH Tubing
- 5 Move in work string , offload and tally
- 6 Pick up work string and RIH to 11000'
- 7 M&P 10# MLF
- 8 M&P 30sx CL H cmt @ 11000-10750'.
- 9 Pull from the plug and WOC,
- 10 Pick up 3 13/16" bit and rotative scraper . RIH to 10,600 '.
- 11 Circulate 10# kill fluid
- 12 RIH and tag cement plug
- 13 POOH
- 14 Run Casing log
- 15 RIH with CIBP and set at 10700'. M&P 20sx CL H cmt to 10500', WOC & Tag.
- 16 Test Casing and plug 500 psi. Review pressure after casing log.
- 17 POOH
- 18 MIRU Wireline Unit and Lubricator
- 19 RIH guns with (SPF,Phase deg TBD), correlate depth and perforate Strawn @ 10279-10305'
- 20 Pull up and perforate WC D @ 9337-9346' with (SPF,Phase Deg TBD).
- 21 Pull up and perforate WC D @ 9124-9132' with (SPF,Phase Deg TBD).
- 22 Pull and perforate WC C @ 9012-9047' with (SPF, Phase Deg TBD).
- 23 Pull out wireline. RDMO Wire Line Truck
- 24 Pick up Plug and Packer and RIH
- 25 Set plug and packer (isolates strawn perfs)
- 26 MIRU acid truck and acidize Strawn Perfs
- 27 Release plug and packer and move up hole (Isolate WC D perfs)
- 28 Acidize WC D Perf
- 29 Release plug and packer and move up hole (Isolate seconf section of WC D perfs)
- 30 Acidize WC D Perf
- 31 Release plug and packer and move up hole (Isolate WC C perfs)
- 32 Acidize WC C Perf
- 33 RDMO Acid Trucks
- 34 Pull out plug and packer laying down work string
- 35 Pick up BHA and RIH with production packer
- 36 Nipple down BOP, Set TAC , Nipple Up Well Head
- 37 Pick Up new pump and RIH with rod string
- 38 Hang well on and Rig Down well service unit

OXY USA WTP LP - Current
State CV #1
API No. 30-015-21927

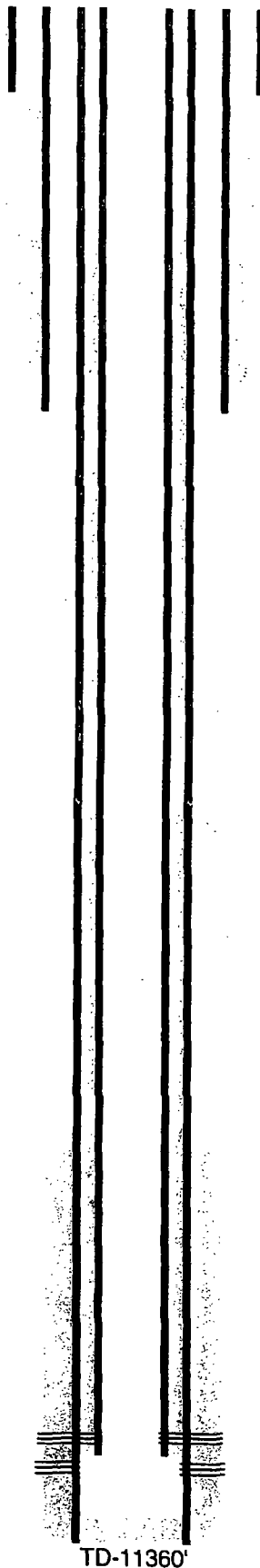

17-1/2" hole @ 615'
13-3/8" csg @ 615'
w/ 895sx-TOC-Surf-Circ

12-1/4" hole @ 3000'
8-5/8" csg @ 3000'
w/ 2125sx-TOC-Surf-Circ

12/01-Csg Lk @ 6074-6106'-cmt @ 6070-6300'

3/02-4-1/2" liner @ 10953'
w/ 200sx-TOC-1612'-CBL

7-7/8" hole @ 11360'
5-1/2" csg @ 11360'
w/ 725sx-TOC-8530'

3/02-Perfs @ 10813-10825'
Perfs @ 11014-11068'

OXY USA WTP LP - Proposed
State CV #1
API No. 30-015-21927

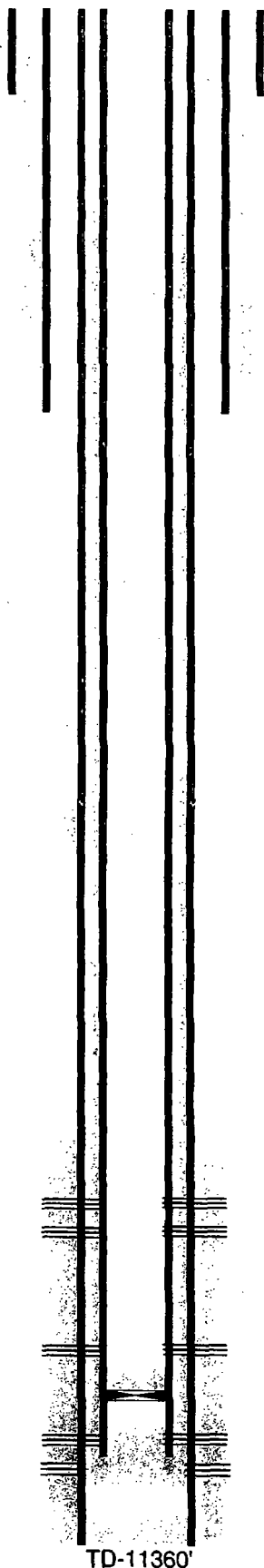

17-1/2" hole @ 615'
13-3/8" csg @ 615'
w/ 895sx-TOC-Surf-Circ

12-1/4" hole @ 3000'
8-5/8" csg @ 3000'
w/ 2125sx-TOC-Surf-Circ

12/01-Csg Lk @ 6074-6106'-cmt @ 6070-6300'

3/02-4-1/2" liner @ 10953'
w/ 200sx-TOC-1612'-CBL

Perfs @ 9012-9346'

7-7/8" hole @ 11360'
5-1/2" csg @ 11360'
w/ 725sx-TOC-8530'

Perfs @ 10279-10305'

3/02-Perfs @ 10813-10825'
Perfs @ 11014-11068'

CIBP @ 10700' w/ 20sx to 10500'

30sx @ 11000-10750' WOC-Tag

PB-11300'

TD-11360'

Attachment C-101

OXY USA WTP LP

OXY Bulldog State #1 - 30-015-29234

- Rig Up Well service Unit
- Check for pressures in the well
- Nipple down wellhead and nipple up BOP
- Move in work string , offload and tally
- Pick up 3 13/16" bit and scraper . RIH to 9378 ' . Drill cement retainer @ ~ 8381' and excess of squeeze 9500'
- RIH & tag CIBP @ 10582', M&P 15sx CI H cmt to new PBTD @ ~ 10417'.
- Circulate kill fluid 10 ppg and retest casing 500 psi .Check pressure test value before start operations with PE.
- Pull out of the hole BHA.
- MIRU Wireline Unit and Lubricator
- RIH guns with (SPF,Phase deg TBD), correlate depth and perforate Strawn @ 10,319-10328'. Check well
- Pull up and perforate WC D @ 9204-9217' with (SPF,Phase Deg TBD). Check Well
- Pull and perforate WC C @ 9079-9103' with (SPF, Phase Deg TBD). Check well
- Pull out wireline. RDMO Wire Line Truck
- Pick up Plug and Packer and RIH
- Set plug and packer (isolates strwn perfs)
- MIRU acid truck and acidize Strawn Perfs
- Release plug and packer and move up hole (Isolate WC D perfs)
- Acidize WC D Perf
- Release plug and packer and move up hole (Isolate WC C perfs)
- Acidize WC C Perf
- RDMO Acid Trucks
- Pull out plug and packer laying down work string
- Pick Up and run in to the hole with 2-3/8" tubing , packers and valves for Gas Lift Installation
- Set packer 9050', hang well on.
- Nipple down BOP and Nipple up Wellhead
- Rig Down and mobilize well service uit
- RTP

District I
 1625 N. French Dr., Hobbs, NM 88240
 Phone (575) 393-6161 Fax (575) 393-0720
 District II
 811 S. First St., Artesia, NM 88211
 Phone (575) 748-1283 Fax (575) 744-9726
 District III
 1000 Rio Brazos Road, Aztec, NM 87410
 Phone (505) 334-6175 Fax (505) 334-6176
 District IV
 1220 S. St. Francis Dr., Santa Fe, NM 87503
 Phone (505) 476-3460 Fax (505) 476-4462

State of New Mexico
 Energy, Minerals & Natural Resources Department
 OIL CONSERVATION DIVISION
 1220 South St. Francis Dr.
 Santa Fe, NM 87505

NM OIL CONSERVATION
 ARTESIA DISTRICT
 SEP 18 2017
 Form C-102
 Revised August 1, 2011
 Submit one copy to appropriate District Office
RECEIVED ☒ AMENDED REPORT

WELL LOCATION AND ACREAGE DEDICATION PLAT

¹ API Number 30-015-29234	² Pool Code B4412	³ Pool Name Salader Strawn
⁴ Property Code	⁵ Property Name OKY Bulldog State	⁶ Well Number 1
⁷ OGRID No. 192463	⁸ Operator Name OKY USA WTP LP	⁹ Elevation 3265

¹⁰ Surface Location									
UL or lot no.	Section	Township	Range	Lot Idn	Feet from the	North/South line	Feet from the	East/West line	County
H	16	20S	28E		1980	North	660	East	Eddy

¹¹ Bottom Hole Location If Different From Surface									
UL or lot no.	Section	Township	Range	Lot Idn	Feet from the	North/South line	Feet from the	East/West line	County

¹² Dedicated Acres 320	¹³ Joint or Infill N	¹⁴ Consolidation Code	¹⁵ Order No.
--------------------------------------	------------------------------------	----------------------------------	-------------------------

No allowable will be assigned to this completion until all interests have been consolidated or a non-standard unit has been approved by the division.

	¹⁷ OPERATOR CERTIFICATION I hereby certify that the information contained herein is true and complete to the best of my knowledge and belief, and that this organization either owns a working interest or unleased mineral interest in the land including the proposed bottom hole location or has a right to drill this well at this location pursuant to a contract with an owner of such a mineral or working interest, or to a voluntary pooling agreement or a compulsory pooling order heretofore entered by the division.	
	Signature 	Date 9/14/17
	Printed Name David Stewart	
	E-mail Address david_stewart@oky.com	
	¹⁸ SURVEYOR CERTIFICATION I hereby certify that the well location shown on this plat was plotted from field notes of actual surveys made by me or under my supervision, and that the same is true and correct to the best of my belief.	
	Date of Survey	
	Signature and Seal of Professional Surveyor:	
	Certificate Number	

Oxy State CV 2H Facility T20S R28E

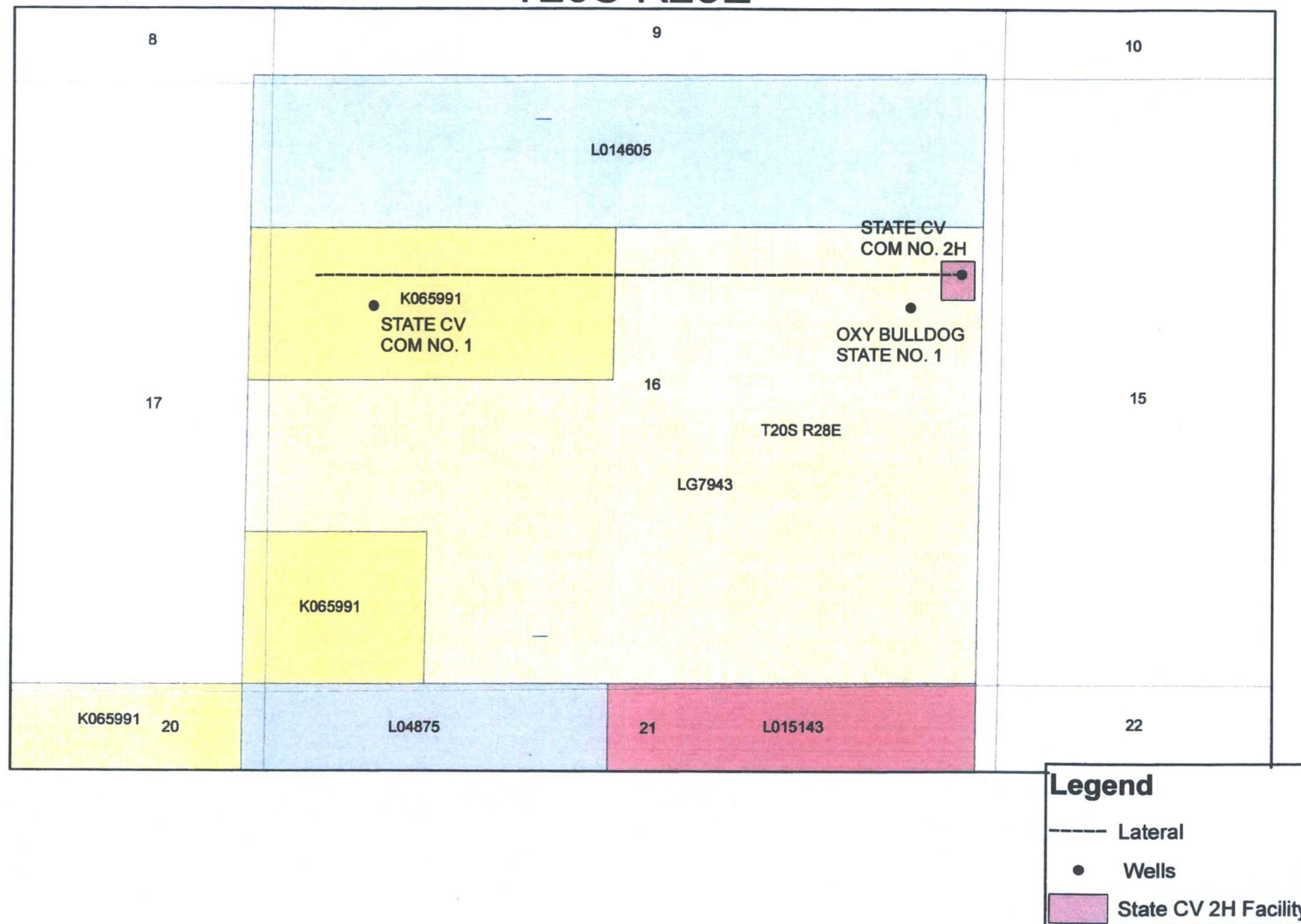



**OXY USA WTP Limited Partnership / OXY
USA INC / OCCIDENTAL PERMIAN LTD**
A subsidiary of Occidental Petroleum Corporation

5 Greenway Plaza, Suite 110, Houston, Texas 77046
P.O. Box 4294, Houston, Texas 77210-4294
Direct: 713.366.5249
Justin_Morris@oxy.com

September 22, 2017

CERTIFIED MAIL
RETURN RECEIPT REQUESTED

Re: Application for Pool Lease Commingling for the State CV 2H CTB

To Whom It May Concern:

This is to advise you that OXY USA WTP LP is filing an application for surface commingling at the State CV 2H CTB. A copy of the application submitted to the Division is attached.

Any objections or requests for a hearing regarding this application must be submitted to the New Mexico Oil Conservation Division Santa Fe Office within 20 Days from the date of this letter.

Pursuant to Statewide rule 19.15.12.10(C)(4)(g) OXY USA WTP LP requests the option to include additional pools or leases within the defined parameters set forth in the order for future additions.

For questions regarding this application, please contact Taylor Stillman at (713) 366-5945.

Respectfully,

OXY USA WTP LP
Taylor Stillman
Regulatory Engineer
Taylor_Stillman@oxy.com

Interest Owner Notification - Tracking Numbers

OWNER NAME	CERTIFIED TRACKING NO
STATE OF NEW MEXICO	7014 1820 0000 0732 2094
DEVON ENERGY PRODUCTION CO LP	7014 1820 0000 0732 7822
COG OPERATING LLC	7014 1820 0000 0732 7839
DIAMOND HEAD PROPERTIES L P	7014 1820 0000 0732 7846
DUGAN PRODUCTION CORP	7014 1820 0000 0732 7853

State CV CTB Production Data

OXY BULLDOG STATE #001 (30-015-29234)

Month	Oil (bbls)	Average Daily Volume (bbls)	Gas (MCF)	Water (bbls)
Jan	0	0	0	0
Feb	0	0	0	0
Mar	0	0	0	0
Apr	0	0	0	0
May	0	0	0	0
Jun	0	0	0	0

STATE CV COM #001 (30-015-21927)

Month	Oil (bbls)	Average Daily Volume (bbls)	Gas (MCF)	Water (bbls)
Jan	0	0	170	0
Feb	0	0	191	0
Mar	0	0	0	0
Apr	0	0	86	0
May	0	0	179	0
Jun	0	0	43	0

STATE CV COM #002H (30-015-41857)

Month	Oil (bbls)	Average Daily Volume (bbls)	Gas (MCF)	Water (bbls)
Jan	905	32	5378	4115
Feb	762	28	5298	4115
Mar	446	30	2649	1872
Apr	950	38	5260	4299
May	4	4	140	268
Jun	0	0	1	0

District I
 1625 N. French Dr., Hobbs, NM 88240
 Phone (575) 393-6161 Fax (575) 393-0720
 District II
 811 S. First St., Artesia, NM 88210
 Phone (575) 748-1262 Fax (575) 748-9720
 District III
 1000 Rio Blanco Road, Aztec, NM 87410
 Phone (505) 334-6175 Fax (505) 334-6170
 District IV
 1220 S. St. Francis Dr., Santa Fe, NM 87505
 Phone (505) 476-3460 Fax (505) 476-3462

State of New Mexico
 Energy, Minerals & Natural Resources Department
 OIL CONSERVATION DIVISION
 1220 South St. Francis Dr.
 Santa Fe, NM 87505

NM OIL CONSERVATION

Form C-102

ARTESIA DISTRICT Revised August 1, 2011

SEP 18 2017
 it one copy to appropriate District Office

RECEIVED ☒ AMENDED REPORT

WELL LOCATION AND ACREAGE DEDICATION PLAT

¹ API Number 30-015-21927	² Pool Code 73520	³ Pool Name Bunton Flat Wolfcamp, North
⁴ Property Code	⁵ Property Name State CV Com	⁶ Well Number 1
⁷ OGRID No. 192463	⁸ Operator Name OXY USA WTP LP	⁹ Elevation 3276'

¹⁰ Surface Location

UL or lot no.	Section	Township	Range	Lot Idn	Feet from the	North/South line	Feet from the	East/West line	County
E	16	20S	28E		1980	North	760	West	Eddy

¹¹ Bottom Hole Location If Different From Surface

UL or lot no.	Section	Township	Range	Lot Idn	Feet from the	North/South line	Feet from the	East/West line	County

¹² Dedicated Acres 320	¹³ Joint or Infill N	¹⁴ Consolidation Code	¹⁵ Order No.
--------------------------------------	------------------------------------	----------------------------------	-------------------------

No allowable will be assigned to this completion until all interests have been consolidated or a non-standard unit has been approved by the division.

			<p>¹⁷ OPERATOR CERTIFICATION</p> <p>I hereby certify that the information contained herein is true and complete to the best of my knowledge and belief, and that this organization either owns a working interest or unleased mineral interest in the land including the proposed bottom hole location or has a right to drill this well at this location pursuant to a contract with an owner of such a mineral or working interest, or to a voluntary pooling agreement or a compulsory pooling order heretofore entered by the division.</p> <p><i>David Stewart</i> 9/14/17 Signature Date</p> <p>David Stewart SR Res. Adm. Printed Name</p> <p>david_stewart@oxy.com E-mail Address</p>
			<p>¹⁸ SURVEYOR CERTIFICATION</p> <p>I hereby certify that the well location shown on this plat was plotted from field notes of actual surveys made by me or under my supervision, and that the same is true and correct to the best of my belief.</p>
			<p>Date of Survey</p> <p>Signature and Seal of Professional Surveyor:</p>
			<p>Certificate Number</p>

District I
1625 N. French Dr., Hobbs, NM 88240
Phone: (575) 393-6161 Fax: (575) 393-0720
District II
811 S. First St., Artesia, NM 88210
Phone: (575) 748-1263 Fax: (575) 748-9720
District III
1000 Rio Bravo Road, Aztec, NM 87410
Phone: (505) 334-6175 Fax: (505) 334-6170
District IV
1220 S. St. Francis Dr., Santa Fe, NM 87505
Phone: (505) 476-3460 Fax: (505) 476-3462

State of New Mexico
Energy, Minerals & Natural Resources Department
OIL CONSERVATION DIVISION
1220 South St. Francis Dr.
Santa Fe, NM 87505

NM OIL CONSERVATION
ARTESIA DISTRICT

Form C-102

Revised August 1, 2011

SEP 18 2017

Submit one copy to appropriate
District Office

RECEIVED

☒ AMENDED REPORT

WELL LOCATION AND ACREAGE DEDICATION PLAT

¹ API Number 30-015-21927	² Pool Code 84412	³ Pool Name Saladan Strawn
⁴ Property Code	⁵ Property Name State CV Com	⁶ Well Number 1
⁷ OGRID No. 192463	⁸ Operator Name OKY USA WTP LP	⁹ Elevation 3276'

¹⁰ Surface Location

UL or lot no.	Section	Township	Range	Lot Idn	Feet from the	North/South line	Feet from the	East/West line	County
E	16	20S	28E		1980	North	760	West	Eddy

¹¹ Bottom Hole Location If Different From Surface

UL or lot no.	Section	Township	Range	Lot Idn	Feet from the	North/South line	Feet from the	East/West line	County

¹² Dedicated Acres 320	¹³ Joint or Infill N	¹⁴ Consolidation Code	¹⁵ Order No.
--------------------------------------	------------------------------------	----------------------------------	-------------------------

No allowable will be assigned to this completion until all interests have been consolidated or a non-standard unit has been approved by the division.

	<p>¹⁷ OPERATOR CERTIFICATION I hereby certify that the information contained herein is true and complete to the best of my knowledge and belief, and that this organization either owns a working interest or unleased mineral interest in the land including the proposed bottom hole location or has a right to drill this well at this location pursuant to a contract with an owner of such a mineral or working interest, or to a voluntary pooling agreement or a compulsory pooling order heretofore entered by the division.</p> <p>Signature: <i>David Stewart</i> Date: 9/14/17</p> <p>Printed Name: David Stewart SR. Reg. Adm.</p> <p>E-mail Address: david_stewart@oky.com</p>	
	<p>¹⁸ SURVEYOR CERTIFICATION I hereby certify that the well location shown on this plat was plotted from field notes of actual surveys made by me or under my supervision, and that the same is true and correct to the best of my belief.</p> <p>Date of Survey:</p> <p>Signature and Seal of Professional Surveyor:</p>	
	<p>Certificate Number</p>	

NEW MEXICO OIL CONSERVATION COMMISSION
WELL LOCATION AND ACREAGE DEDICATION PLAT

Form 17-102
 Superseded C-128
 Effective 1-1-65

All distances must be from the outer boundaries of the Section

Operator CITIES SERVICE OIL COMPANY			Lease State C. V.		Well No. 1
Unit Letter E	Section 16	Township 20 South	Range 28 East	County Bddy	
Actual Fringe Location of Well: 1980 feet from the north line and 760 feet from the west line					
Ground Level Elev. 3275.7'	Producing Formation Morrow	Pool Undesignated Morrow	Dedicated Acreage: 320 Acres		

1. Outline the acreage dedicated to the subject well by colored pencil or hatchure marks on the plat below.
2. If more than one lease is dedicated to the well, outline each and identify the ownership thereof (both as to working interest and royalty).
3. If more than one lease of different ownership is dedicated to the well, have the interests of all owners been consolidated by communitization, unitization, force-pooling, etc?

☒ Yes ☐ No If answer is "yes" type of consolidation ***Communitization**
 *As of this date all interest owners have not been signed up but by the time this well is spudded they will be.
 If answer is "no," list the owners and tract descriptions which have actually been consolidated. (Use reverse side of this form if necessary.)

No allowable will be assigned to the well until all interests have been consolidated (by communitization, unitization, forced-pooling, or otherwise) or until a non-standard unit, eliminating such interests, has been approved by the Commission.

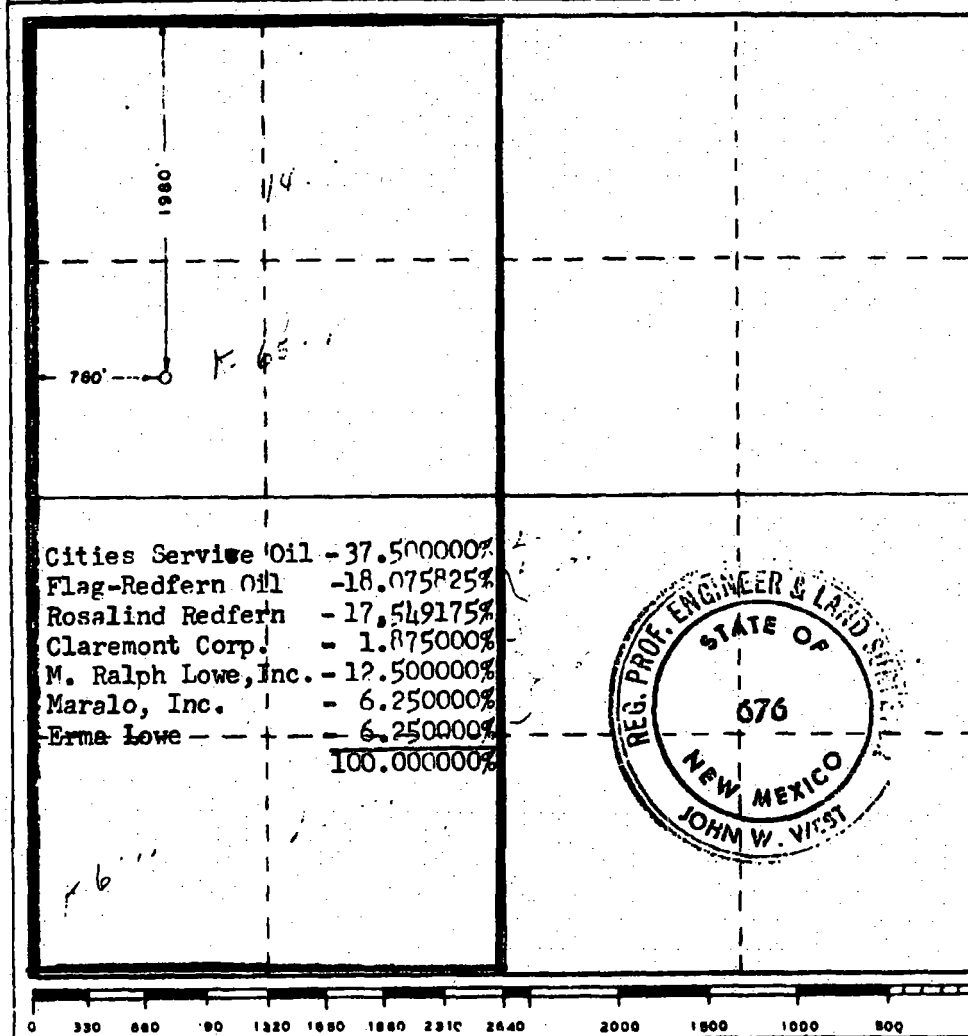

CERTIFICATION

I hereby certify that the information contained herein is true and complete to the best of my knowledge and belief

Name *E. Sprullen*
 Position **Region Operation Manager**
 Company **Cities Service Oil Company**
 Date **September 27, 1976**

I hereby certify that the well location shown on this plat was plotted from field notes of actual surveys made by me or under my supervision, and that the same is true and correct to the best of my knowledge and belief.

Date Surveyed
Sept. 24, 1976
 Registered Professional Engineer
 and/or Land Surveyor

John W. Virst
 Certificate No. **676**

District I
1625 N French Dr. Hobbs NM 88240
Phone (575) 393-6161 Fax (575) 393-0720

District II
811 S First St., Artesia, NM 88210
Phone (575) 748-1283 Fax (575) 748-9720

District III
1000 Rio Brazos Road, Aztec, NM 87410
Phone (505) 334-6178 Fax (505) 334-6170

District IV
1220 S St. Francis Dr., Santa Fe, NM 87505
Phone (505) 476-3460 Fax (505) 476-3462

State of New Mexico
Energy Minerals and Natural Resources
Oil Conservation Division
1220 South St. Francis Dr.
Santa Fe, NM 87505

NM OIL CONSERVATION
ARTESIA DISTRICT
Form C-101
Revised July 18, 2013
SEP 18 2017
☐ AMENDED REPORT
RECEIVED

APPLICATION FOR PERMIT TO DRILL, RE-ENTER, DEEPEN, PLUGBACK, OR ADD A ZONE

¹ Operator Name and Address OXY USA WTPLP P.O. Box 50250 Midland, TX 79710		² OGRID Number 192463	
³ Property Code		⁴ API Number 30015-29234	
⁵ Property Name OXY Bulldog State		⁶ Well No	

7. Surface Location									
U/L - Lot	Section	Township	Range	Lot Idn	Feet from	N/S Line	Feet From	E/W Line	County
H	16	20S	20E		1980	North	660	East	Eddy

8. Proposed Bottom Hole Location									
U/L - Lot	Section	Township	Range	Lot Idn	Feet from	N/S Line	Feet From	E/W Line	County

9. Pool Information	
⁹ Pool Name Bunton Flat Wolfcamp, North - 73520 Saladar Strawn - 84412	¹⁰ Pool Code

Additional Well Information				
¹¹ Work Type PB	¹² Well Type G	¹³ Cable/Rotary N/A	¹⁴ Lease Type S	¹⁵ Ground Level Elevation 3265'
¹⁶ Multiple Y - DHC	¹⁷ Proposed Depth 10320'	¹⁸ Formation Wolfcamp-Strawn	¹⁹ Contractor N/A	²⁰ Spud Date After Perm. + Approval
²¹ Depth to Ground water		²² Distance from nearest fresh water well		²³ Distance to nearest surface water

☒ We will be using a closed-loop system in lieu of lined pits

21. Proposed Casing and Cement Program						
Type	Hole Size	Casing Size	Casing Weigh/ft	Setting Depth	Sacks of Cement	Estimated TOC
Surf	17 1/2"	13 3/8"	40	416'	420	Surf-Linc
Int	11"	8 5/8"	24-32# 23#	3046' 2902'	1975 250	" "
Prod	6 1/4"	4 1/2"	11.6#	11431'	1030	2540' calc

Casing/Cement Program: Additional Comments
See Attached for proposed procedure & WBD DHC to be filed

22. Proposed Blowout Prevention Program			
Type	Working Pressure	Test Pressure	Manufacturer
Annular	5000	5000	

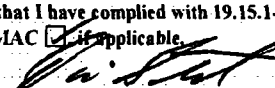
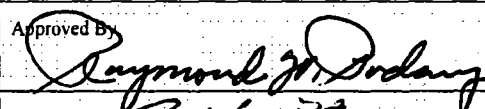
²³ I hereby certify that the information given above is true and complete to the best of my knowledge and belief. I further certify that I have complied with 19.15.14.9 (A) NMAC <input checked="" type="checkbox"/> and/or 19.15.14.9 (B) NMAC <input checked="" type="checkbox"/> if applicable. Signature:  Printed name: David Stewart Title: Sr. Regulatory Advisor E-mail Address: david.stewart@oxy.com Date: 9/14/17 Phone: 432-6955717		OIL CONSERVATION DIVISION Approved By:  Title: Geologist Approved Date: 9-18-17 Expiration Date: 9-18-19 Conditions of Approval Attached	
--	--	---	--