

MWJ PRODUCING COMPANY

★ PETROLEUM PRODUCERS ★

400 WEST ILLINOIS SUITE 1100
MIDLAND, TEXAS 79701
TELEPHONE (915) 682-5216

May 2, 1989

RECEIVED

MAY - 5 1989

OIL CONSERVATION DIV.
SANTA FE

Oil Conservation Division
P. O. Box 2088
Santa Fe, New Mexico 87504

Attn: Michael Stogner

RE: Administrative Order DD-25

Dear Mr. Stogner:

MWJ received approval under the captioned order to directionally drill its Baum State #2 to a bottom hole location in the Baum Upper Pennsylvanian Pool at a standard location in the SE/4 SW/4 (Unit N) of Section 5, Township 14S, Range 33E, Lea County, New Mexico.

The Baum State #2 was drilled to a total measured depth of 10,377' and a multishot directional survey was run, a copy of which is enclosed. The survey shows the bottom hole location to be 1791.49' FWL and 646.00' FSL of Section 5. A plat has been enclosed for your convenience.

The bottom hole location of the Baum State #2 is not within the limits, pursuant to the Special Pool Rules, of the standard oil well location. MWJ therefore requests approval of the unorthodox location for the Baum State #2 well. A copy of the form C-103 is also enclosed.

We appreciate your consideration of our request, and if you require anything further, please do not hesitate to contact us.

Very truly yours,

MWJ PRODUCING COMPANY



Stan Venable

SV/pd
Enclosures

cc: Oil Conservation Division - Hobbs

100-440000-100000

100-440000-100000

100-440000-100000

100-440000-100000

100-440000-100000

100-440000-100000

100-440000-100000

Submit 3 Copies
to Appropriate
District Office

State of New Mexico
Energy, Minerals and Natural Resources Department

Form C-103
Revised 1-1-89

DISTRICT I
P.O. Box 1980, Hobbs, NM 88240

DISTRICT II
P.O. Drawer DD, Artesia, NM 88210

DISTRICT III
1000 Rio Brazos Rd., Aztec, NM 87410

OIL CONSERVATION DIVISION
P.O. Box 2088
Santa Fe, New Mexico 87504-2088

WELL API NO.
5. Indicate Type of Lease STATE <input checked="" type="checkbox"/> FEE <input type="checkbox"/>
6. State Oil & Gas Lease No. NM-3138
7. Lease Name or Unit Agreement Name Baum State
8. Well No. 2
9. Pool name or Wildcat Baum Upper Penn
10. Elevation (Show whether DF, RKB, RT, GR, etc.) 4266' GL

SUNDRY NOTICES AND REPORTS ON WELLS
(DO NOT USE THIS FORM FOR PROPOSALS TO DRILL OR TO DEEPEN OR PLUG BACK TO A
DIFFERENT RESERVOIR. USE "APPLICATION FOR PERMIT"
(FORM C-101) FOR SUCH PROPOSALS.)

1. Type of Well:
OIL WELL ☒ GAS WELL ☐ OTHER ☐

2. Name of Operator
MWJ PRODUCING COMPANY

3. Address of Operator
400 W Illinois Suite 1100 Midland, Texas 79701

4. Well Location
Unit Letter N : 990 Feet From The West Line and 2310 Feet From The South Line
Section 5 Township 14S Range 33E NMPM Lea County

10. Elevation (Show whether DF, RKB, RT, GR, etc.)
4266' GL

11. Check Appropriate Box to Indicate Nature of Notice, Report, or Other Data	
NOTICE OF INTENTION TO:	SUBSEQUENT REPORT OF:
PERFORM REMEDIAL WORK <input type="checkbox"/>	REMEDIAL WORK <input type="checkbox"/>
PLUG AND ABANDON <input type="checkbox"/>	ALTERING CASING <input type="checkbox"/>
TEMPORARILY ABANDON <input type="checkbox"/>	COMMENCE DRILLING OPNS. <input checked="" type="checkbox"/>
CHANGE PLANS <input type="checkbox"/>	PLUG AND ABANDONMENT <input type="checkbox"/>
PULL OR ALTER CASING <input type="checkbox"/>	CASING TEST AND CEMENT JOB <input type="checkbox"/>
OTHER: <input type="checkbox"/>	OTHER: <input type="checkbox"/>

12. Describe Proposed or Completed Operations (Clearly state all pertinent details, and give pertinent dates, including estimated date of starting any proposed work) SEE RULE 1103.

3/31/89: RU Norton Drilling. Set Whipstock Plug from 4700-4100' w/150 sx cmt.
4/1/89: Ran Multishot.
4/2-4/26: Drilling.
4/27/89: TD 10377' Ran Multishot, ran 5-1/2" casing & set @ 10377'. Halliburton cemented w/500 sx 50/50 Prem Pozmix w/.6% Halide 22 & 5# KCL/sk. Displaced w/fresh wtr. PD @ 9: PM.
4/28/89: Ran temp survey, top of cmt @ 7650'. WOCU.

RECEIVED

MAY - 5 1989

OIL CONSERVATION DIV.
SANTA FE

I hereby certify that the information above is true and complete to the best of my knowledge and belief.

SIGNATURE

Pat Drexler

TITLE

Pat Drexler-Agent

DATE

5/2/89

TYPE OR PRINT NAME

TELEPHONE NO.

(This space for State Use)

APPROVED BY

TITLE

DATE

CONDITIONS OF APPROVAL, IF ANY:

DATA DRIL

REPORT of WELL COMPLETION SURVEY

M.W.J. PRODUCING CO.
BAUM STATE #F-2
LEA COUNTY, NEW MEXICO
SW 1/4 OF SEC. 5, 14S, 33E

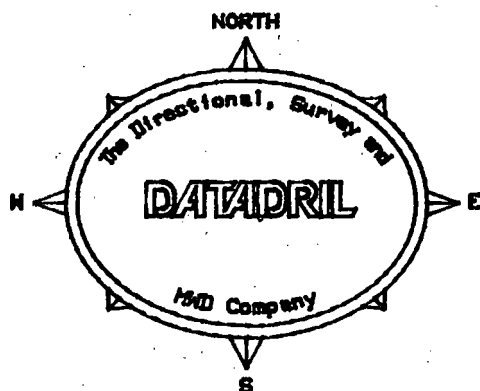

DATADRIL

M.W.J. PRODUCING CO.
BAUM STATE #F-2
LEA COUNTY, NEW MEXICO
SW 1/4 OF SEC. 5, 14S, 33E
DATE OF REPORT: 04-27-89

GYRO & MAGNETIC MULTISHOTS
DECLINATION= 10 DEGREES EASTERLY
NORTON #8
JOHN WILLY- GYRO
GARRY HENDRIX- MAGNETIC

File Name: 116689005A

***** RECORD OF SURVEY *****

Calculated by DATADRIL's CADDs System

Radius of Curvature Method

All Angles are Decimal

Vertical Section Plane: S 30.96 E

TYPE OF SURVEY	MEASURED DEPTH (FT)	INCL ANGLE (DEG)	D R I F T DIRECTION (DEG)	COURSE LENGTH (FT)	TOTAL VERTICAL DEPTH	T O T A L RECTANGULAR COORDINATES (FT)		VERTICAL SECTION (FT)	DOGLEG SEVERITY (DEG/100')
GMS	0.00	0.00	N 0.00 E	0.00	0.00	0.00 N	0.00 E	0.00	0.00
GMS	100.00	.25	S 30.00 W	100.00	100.00	.19 S	.11 W	.11	.25
GMS	200.00	.25	S 19.00 W	100.00	200.00	.59 S	.29 W	.35	.05
GMS	300.00	.25	S 34.00 W	100.00	300.00	.97 S	.48 W	.59	.07
GMS	400.00	.25	N 73.00 E	100.00	400.00	1.24 S	.29 W	.92	.47
GMS	500.00	.25	N 68.00 E	100.00	500.00	1.10 S	.13 E	1.01	.02
GMS	600.00	.50	S 24.00 E	100.00	599.99	1.32 S	.68 E	1.48	.55
GMS	700.00	.50	N 88.00 E	100.00	699.99	1.76 S	1.37 E	2.21	.56
GMS	800.00	.50	S 79.00 E	100.00	799.99	1.82 S	2.24 E	2.72	.11
GMS	900.00	.50	S 84.00 E	100.00	899.98	1.95 S	3.10 E	3.27	.04
GMS	1000.00	.50	S 23.00 E	100.00	999.98	2.45 S	3.77 E	4.04	.51
GMS	1100.00	.50	S 65.00 E	100.00	1099.97	3.06 S	4.36 E	4.87	.36
GMS	1200.00	1.25	N 84.00 E	100.00	1199.96	3.31 S	5.85 E	5.85	.86
GMS	1300.00	1.00	N 67.00 E	100.00	1299.94	2.82 S	7.75 E	6.40	.41
GMS	1400.00	1.00	N 80.00 E	100.00	1399.93	2.33 S	9.42 E	6.84	.23
GMS	1500.00	1.00	N 67.00 E	100.00	1499.91	1.83 S	11.09 E	7.27	.23
GMS	1600.00	1.00	N 64.00 E	100.00	1599.90	1.11 S	12.67 E	7.47	.05
GMS	1700.00	1.00	N 82.00 E	100.00	1699.88	.60 S	14.34 E	7.89	.31
GMS	1800.00	.75	N 62.00 E	100.00	1799.87	.13 S	15.78 E	8.23	.39
GMS	1900.00	1.00	N 78.00 E	100.00	1899.86	.39 N	17.21 E	8.52	.35
GMS	2000.00	.75	N 74.00 E	100.00	1999.85	.76 N	18.69 E	8.96	.26

DATADRIL

 M.W.J. PRODUCING CO.
 BAUM STATE #F-2

 LEA COUNTY, NEW MEXICO
 SW 1/4 OF SEC. 5, 14S, 33E

TYPE OF SURVEY	MEASURED DEPTH (FT)	INCL ANGLE (DEG)	D R I F T DIRECTION (DEG)	COURSE LENGTH (FT)	TOTAL VERTICAL DEPTH	T O T A L RECTANGULAR COORDINATES (FT)		VERTICAL SECTION (FT)	DOGLEG SEVERITY (DEG/100')
GMS	2100.00	.75	N 83.00 E	100.00	2099.84	1.02 N	19.97 E	9.40	.12
GMS	2200.00	.75	S 87.00 E	100.00	2199.83	1.07 N	21.28 E	10.03	.13
GMS	2300.00	.75	N 76.00 E	100.00	2299.82	1.19 N	22.58 E	10.59	.22
GMS	2400.00	.75	S 64.00 E	100.00	2399.81	1.06 N	23.85 E	11.37	.51
GMS	2500.00	1.00	N 86.00 E	100.00	2499.80	.77 N	25.34 E	12.37	.51
GMS	2600.00	1.00	S 73.00 E	100.00	2599.79	.57 N	27.06 E	13.43	.36
GMS	2700.00	.75	S 68.00 E	100.00	2699.77	.06 N	28.50 E	14.61	.26
GMS	2800.00	.50	S 79.00 E	100.00	2799.77	.25 S	29.54 E	15.41	.28
GMS	2900.00	.50	S 79.00 E	100.00	2899.76	.41 S	30.40 E	15.99	0.00
GMS	3000.00	.75	N 66.00 E	100.00	2999.76	.29 S	31.47 E	16.44	.45
GMS	3100.00	.25	S 37.00 E	100.00	3099.75	.49 S	32.25 E	17.01	.74
GMS	3200.00	.25	N 80.00 E	100.00	3199.75	.65 S	32.64 E	17.34	.26
GMS	3300.00	.50	N 86.00 E	100.00	3299.75	.57 S	33.29 E	17.61	.25
GMS	3400.00	.50	S 84.00 E	100.00	3399.75	.58 S	34.16 E	18.07	.09
GMS	3500.00	.50	N 66.00 E	100.00	3499.74	.45 S	35.01 E	18.39	.26
GMS	3600.00	.50	N 76.00 E	100.00	3599.74	.16 S	35.83 E	18.57	.09
GMS	3700.00	.25	S 61.00 E	100.00	3699.74	.25 S	36.47 E	18.97	.36
GMS	3800.00	.25	N 81.00 E	100.00	3799.74	.32 S	36.89 E	19.25	.16
GMS	3900.00	.25	N 51.00 E	100.00	3899.74	.14 S	37.28 E	19.30	.13
GMS	4000.00	.25	N 66.00 E	100.00	3999.73	.08 N	37.65 E	19.30	.07
GMS	4100.00	.25	S 27.00 E	100.00	4099.73	.05 S	38.03 E	19.60	.34
GMS	4200.00	.25	S 65.00 E	100.00	4199.73	.35 S	38.33 E	20.02	.16
GMS	4300.00	.50	S 63.00 E	100.00	4299.73	.63 S	38.92 E	20.57	.25

MAGNETIC MULTISHOT TO FOLLOW SII GYRO

MMS	4320.00	.75	S 48.00 E	20.00	4319.73	.76 S	39.10 E	20.77	1.48
MMS	4414.00	1.00	S 32.00 E	94.00	4413.72	1.85 S	40.02 E	22.18	.37
MMS	4508.00	2.00	S 26.00 E	94.00	4507.68	4.00 S	41.21 E	24.64	1.08
MMS	4602.00	5.25	S 25.00 E	94.00	4601.48	9.37 S	43.77 E	30.55	3.46
MMS	4696.00	6.00	S 27.00 E	94.00	4695.03	17.65 S	47.81 E	39.73	.82
MMS	4790.00	7.00	S 32.00 E	94.00	4788.42	26.91 S	53.05 E	50.36	1.22
MMS	4884.00	8.25	S 34.00 E	94.00	4881.59	37.37 S	59.84 E	62.83	1.36

DATADRIL

M.W.J. PRODUCING CO.
BAUM STATE #F-2

LEA COUNTY, NEW MEXICO
SW 1/4 OF SEC. 5, 14S, 33E

TYPE OF SURVEY	MEASURED DEPTH (FT)	INCL ANGLE (DEG)	D R I F T DIRECTION (DEG)	COURSE LENGTH (FT)	TOTAL VERTICAL DEPTH	T O T A L RECTANGULAR COORDINATES (FT)		VERTICAL SECTION (FT)	DOGLEG SEVERITY (DEG/100')
MMS	4978.00	8.50	S 35.00 E	94.00	4974.59	48.65 S	67.60 E	76.49	.31
MMS	5072.00	10.00	S 37.00 E	94.00	5067.36	60.87 S	76.48 E	91.54	1.63
MMS	5166.00	11.00	S 40.00 E	94.00	5159.79	74.28 S	87.14 E	108.52	1.21
MMS	5260.00	11.50	S 40.00 E	94.00	5251.98	88.33 S	98.93 E	126.63	.53
MMS	5354.00	11.50	S 43.00 E	94.00	5344.10	102.36 S	111.34 E	145.06	.64
MMS	5448.00	11.00	S 35.00 E	94.00	5436.29	116.60 S	122.88 E	163.20	1.74
MMS	5542.00	11.00	S 23.00 E	94.00	5528.56	132.26 S	131.56 E	181.09	2.43
MMS	5636.00	12.75	S 18.00 E	94.00	5620.55	150.37 S	138.33 E	200.11	2.16
MMS	5730.00	14.00	S 18.00 E	94.00	5712.00	171.05 S	145.05 E	221.30	1.33
MMS	5824.00	14.50	S 19.00 E	94.00	5803.10	192.99 S	152.39 E	243.89	.59
MMS	5918.00	15.50	S 21.00 E	94.00	5893.90	215.85 S	160.71 E	267.77	1.20
MMS	6012.00	16.50	S 21.00 E	94.00	5984.26	240.04 S	169.99 E	293.29	1.06
MMS	6106.00	17.50	S 23.00 E	94.00	6074.15	265.52 S	180.29 E	320.44	1.23
MMS	6200.00	18.00	S 24.00 E	94.00	6163.67	291.80 S	191.72 E	348.85	.62
MMS	6294.00	18.50	S 26.00 E	94.00	6252.94	318.48 S	204.16 E	378.13	.85
MMS	6388.00	19.50	S 28.00 E	94.00	6341.82	345.75 S	218.05 E	408.66	1.27
MMS	6482.00	21.00	S 29.00 E	94.00	6430.01	374.34 S	233.57 E	441.16	1.64
MMS	6576.00	21.00	S 30.00 E	94.00	6517.77	403.66 S	250.16 E	474.84	.38
MMS	6670.00	20.25	S 30.00 E	94.00	6605.74	432.33 S	266.72 E	507.94	.80
MMS	6764.00	20.00	S 30.00 E	94.00	6694.00	460.34 S	282.89 E	540.28	.27
MMS	6858.00	20.00	S 30.00 E	94.00	6782.33	488.18 S	298.96 E	572.43	0.00
MMS	6952.00	19.50	S 29.00 E	94.00	6870.80	515.83 S	314.60 E	604.18	.64
MMS	7046.00	18.50	S 28.00 E	94.00	6959.68	542.72 S	329.21 E	634.76	1.12
MMS	7140.00	18.00	S 27.00 E	94.00	7048.95	568.83 S	342.80 E	664.14	.63
MMS	7234.00	18.00	S 25.00 E	94.00	7138.35	594.94 S	355.53 E	693.08	.66
MMS	7328.00	18.25	S 25.00 E	94.00	7227.69	621.44 S	367.89 E	722.16	.27
MMS	7422.00	18.75	S 25.00 E	94.00	7316.83	648.47 S	380.49 E	751.83	.53
MMS	7516.00	19.50	S 25.00 E	94.00	7405.64	676.39 S	393.51 E	782.46	.80
MMS	7610.00	20.00	S 25.00 E	94.00	7494.11	705.17 S	406.93 E	814.05	.53
MMS	7704.00	21.00	S 26.00 E	94.00	7582.16	734.89 S	421.11 E	846.82	1.13
MMS	7798.00	21.25	S 26.00 E	94.00	7669.84	765.34 S	435.96 E	880.57	.27
MMS	7892.00	20.75	S 26.00 E	94.00	7757.60	795.61 S	450.72 E	914.13	.53
MMS	7986.00	21.00	S 25.00 E	94.00	7845.42	825.84 S	465.14 E	947.47	.46

DATADRIL

 M.W.J. PRODUCING CO.
BAUM STATE #F-2

 LEA COUNTY, NEW MEXICO
SW 1/4 OF SEC. 5, 14S, 33E

TYPE OF SURVEY	MEASURED DEPTH (FT)	INCL ANGLE (DEG)	D R I F T DIRECTION (DEG)	COURSE LENGTH (FT)	TOTAL VERTICAL DEPTH	T O T A L RECTANGULAR COORDINATES (FT)		VERTICAL SECTION (FT)	DOGLEG SEVERITY (DEG/100')
MMS	8080.00	21.00	S 25.00 E	94.00	7933.18	856.37 S	479.38 E	980.98	0.00
MMS	8174.00	21.50	S 24.00 E	94.00	8020.79	887.38 S	493.51 E	1014.83	.66
MMS	8268.00	21.75	S 23.00 E	94.00	8108.17	919.14 S	507.32 E	1049.18	.47
MMS	8362.00	22.50	S 24.00 E	94.00	8195.25	951.61 S	521.44 E	1084.28	.89
MMS	8456.00	23.00	S 24.00 E	94.00	8281.94	984.82 S	536.22 E	1120.36	.53
MMS	8550.00	23.75	S 24.00 E	94.00	8368.22	1018.89 S	551.39 E	1157.38	.80
MMS	8644.00	25.00	S 24.00 E	94.00	8453.84	1054.33 S	567.17 E	1195.89	1.33
MMS	8738.00	25.25	S 24.00 E	94.00	8538.95	1090.79 S	583.40 E	1235.51	.27
MMS	8832.00	25.00	S 24.00 E	94.00	8624.05	1127.25 S	599.64 E	1275.12	.27
MMS	8926.00	25.00	S 24.00 E	94.00	8709.25	1163.54 S	615.80 E	1314.56	0.00
MMS	9020.00	25.00	S 24.00 E	94.00	8794.44	1199.83 S	631.95 E	1353.99	0.00
MMS	9114.00	25.25	S 23.00 E	94.00	8879.55	1236.43 S	647.87 E	1393.57	.52
MMS	9208.00	25.00	S 23.00 E	94.00	8964.65	1273.17 S	663.46 E	1433.09	.27
MMS	9302.00	22.50	S 22.00 E	94.00	9050.68	1308.15 S	677.95 E	1470.54	2.69
MMS	9396.00	20.50	S 21.00 E	94.00	9138.14	1340.20 S	690.58 E	1504.52	2.16
MMS	9490.00	19.00	S 19.00 E	94.00	9226.61	1370.04 S	701.44 E	1535.70	1.75
MMS	9584.00	19.50	S 19.00 E	94.00	9315.35	1399.35 S	711.53 E	1566.02	.53
MMS	9674.00	19.50	S 18.00 E	90.00	9400.19	1427.84 S	721.06 E	1595.35	.37
MMS	9772.00	20.25	S 20.00 E	98.00	9492.35	1459.34 S	731.91 E	1627.94	1.03
MMS	9866.00	20.25	S 21.00 E	94.00	9580.54	1489.81 S	743.30 E	1659.94	.37
MMS	9960.00	21.50	S 20.00 E	94.00	9668.37	1521.18 S	755.03 E	1692.87	1.38
MMS	10054.00	21.25	S 19.00 E	94.00	9755.90	1553.48 S	766.47 E	1726.45	.47
MMS	10148.00	21.00	S 18.00 E	94.00	9843.59	1585.61 S	777.22 E	1759.53	.47
MMS	10242.00	21.00	S 17.00 E	94.00	9931.34	1617.73 S	787.35 E	1792.29	.38

THE FOLLOWING SURVEY IS A PROJECTION

PROJ	10377.00	21.00	S 17.00 E	135.00	10057.38	1664.00 S	801.49 E	1839.24	0.00
------	----------	-------	-----------	--------	----------	-----------	----------	---------	------

BOTTOM HOLE CLOSURE: 1846.96 Feet at S 25.72 Degrees E

M.W.J. PRODUCING CO.
 BAUM STATE #F-2
 LEA COUNTY, NEW MEXICO
 SW 1/4 OF SEC. 5, 14S, 33E

1 MAY 1989 @ 10:56

DATA DRILL

HORIZONTAL PLOT



SCALE: 300 FEET/INCH

BHL: 1847 FEET
 @ S 25.72 E
 TVD: 10057 FEET
 MD: 10377 FEET

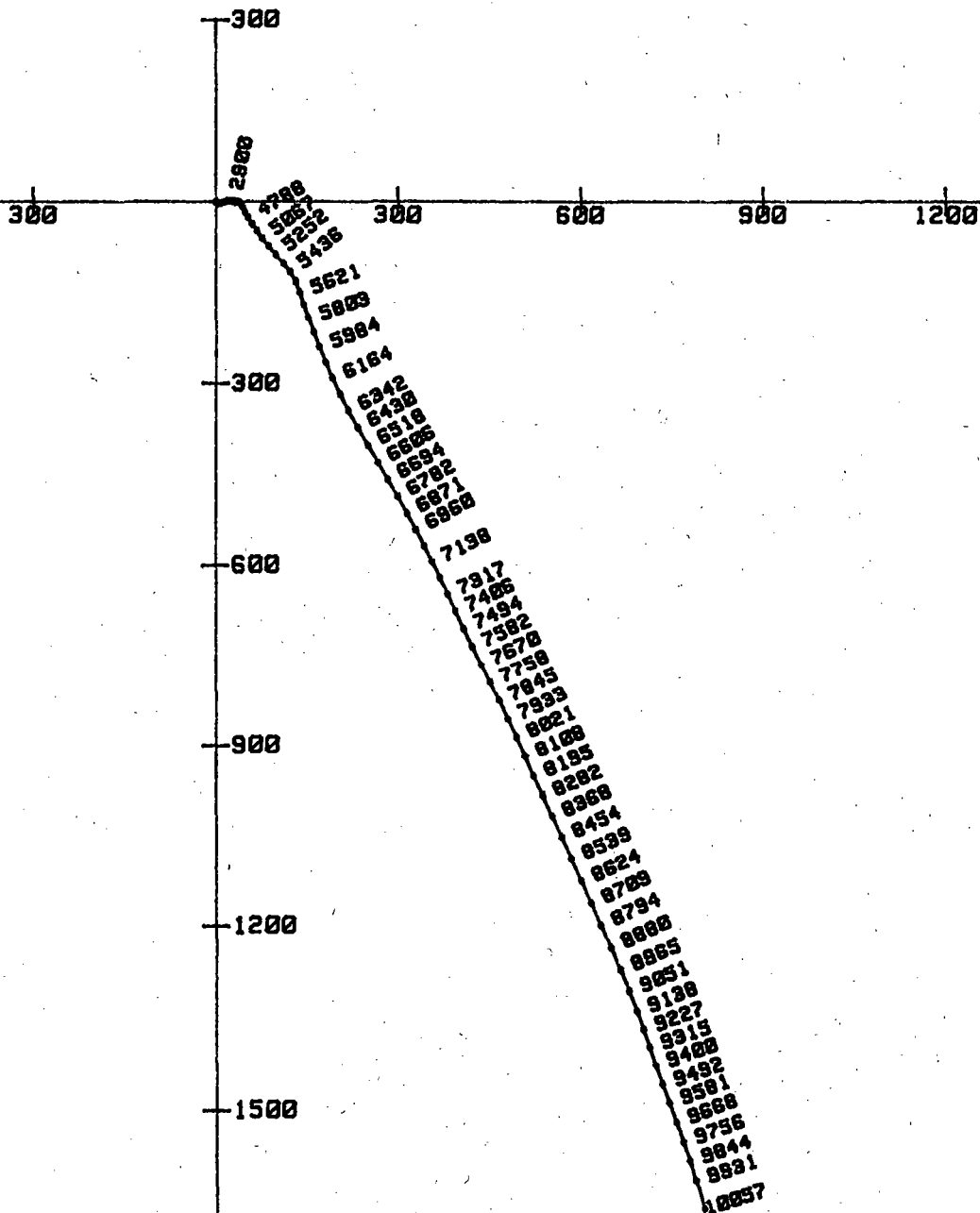

M.W.J. PRODUCING CO.
 BAUM STATE #F-2
 LEA COUNTY, NEW MEXICO
 SW 1/4 OF SEC. 5, 14S, 33E

DATA DRILL

VERTICAL PLOT

SCALE: 1500 FEET/INCH

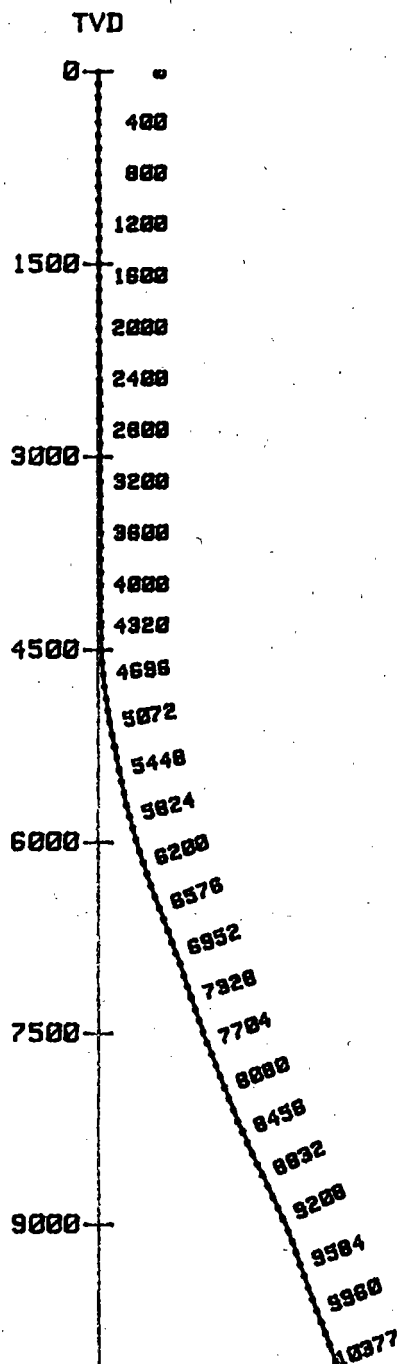

VERTICAL SECTION
 SECTION PLANE: S 30.96 E

BHL: 1047 FEET
 @ S 25.72 E
 TVD: 10057 FEET
 MD: 10377 FEET

1 MAY 1989 @ 12:07

M.W.J. PRODUCING
BAUM "F" #1
LEA COUNTY, NEW MEXICO
SW 1/4 OF SEC. 5 14S, 33E

DATA DRILL

VERTICAL PLANE
SCALE: 500 FEET/DIVISION

HORIZONTAL PLANE
SCALE: 500 FEET/DIVISION

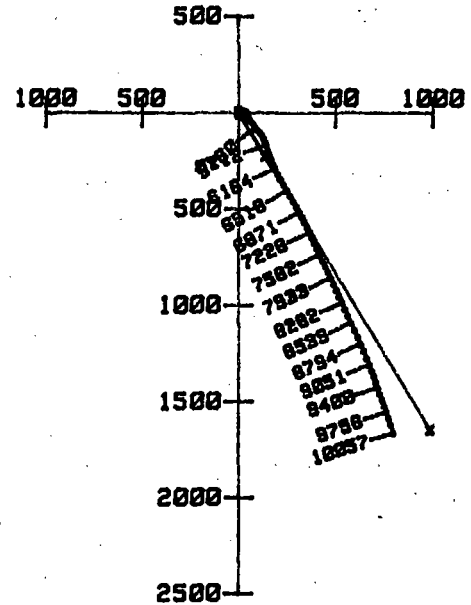
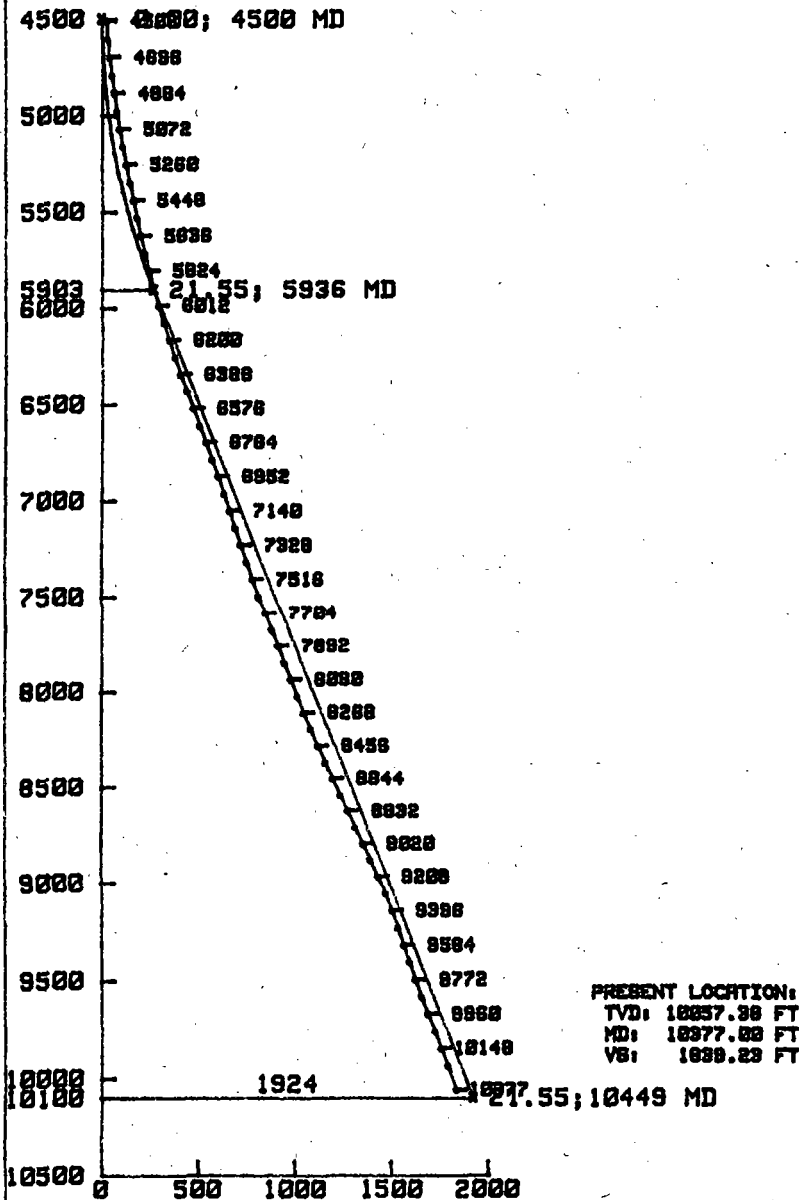

VERTICAL SECTION PLANE: S 30.96 E

SMITH
INTERNATIONAL
Smith International, Inc.

SURVEY CERTIFICATION

COMPANY MWJ PRODUCING COMPANY WELL NAME & NO. BAUM STATE # F-2
DATE of CERTIFICATION 03-31-89 LOCATION LEA COUNTY, NEW MEXICO
TYPE of SURVEY GYROSCOPIC MULTISHOT FROM SURFACE TO 4300'
JOB NUMBER 1166890005 TICKET NUMBER 27070

THE ABOVE SURVEY WAS PERFORMED BY ME ON 03-31- 19 89
THE RESULTS OBTAINED FROM ACTUAL FIELD DATA CONFORM TO ESTABLISHED STANDARDS AND ARE
TRUE AND ACCURATE TO THE BEST OF MY KNOWLEDGE.

JOHN WILLY / John Willy
GARRY HENDRIX / Garry Hendrix
SURVEYOR / DIRECTIONAL DRILLER

FILM TRANSFER RECEIPT

I HEREBY ACKNOWLEDGE RECEIPT OF ORIGINAL FILM OBTAINED ON THE ABOVE SURVEY.

DATE RECEIVED 19

COMPANY REPRESENTATIVE

SURVEY CONFIRMATION

I HAVE EXAMINED THE ABOVE SURVEY AND FOUND THE DATA AND RESULTS ACCEPTABLE ACCORDING
TO CURRENT SMITH DRILLING SYSTEMS STANDARDS.

THOMAS WRIGHT /

Thomas Wright
SII - REPRESENTATIVE

**MEXICO OIL CONSERVATION COMMISSION
WELL LOCATION AND ACREAGE DEDICATION PLAT**

Form C-102
Supersedes C-128
Effective 1-1-65

All distances must be from the outer boundaries of the Section.

Operator MWJ PRODUCING COMPANY			Lease BAUM STATE		Well No. 2
Unit Letter L	Section 5	Township 14 South	Range 33 East	County Lea	
Actual Footage Location of Well: 1980 feet from the West line and 660 feet from the South line					
Ground Level Elev. 4266.3'	Producing Formation Upper Penn		Pool Baum Upper Penn	Dedicated Acreage: 160 Acres	

1. Outline the acreage dedicated to the subject well by colored pencil or hatchure marks on the plat below.
2. If more than one lease is dedicated to the well, outline each and identify the ownership thereof (both as to working interest and royalty).
3. If more than one lease of different ownership is dedicated to the well, have the interests of all owners been consolidated by communitization, unitization, force-pooling, etc?

☐ Yes ☐ No If answer is "yes," type of consolidation _____

If answer is "no," list the owners and tract descriptions which have actually been consolidated. (Use reverse side of this form if necessary.) _____

No allowable will be assigned to the well until all interests have been consolidated (by communitization, unitization, forced-pooling, or otherwise) or until a non-standard unit, eliminating such interests, has been approved by the Commission.

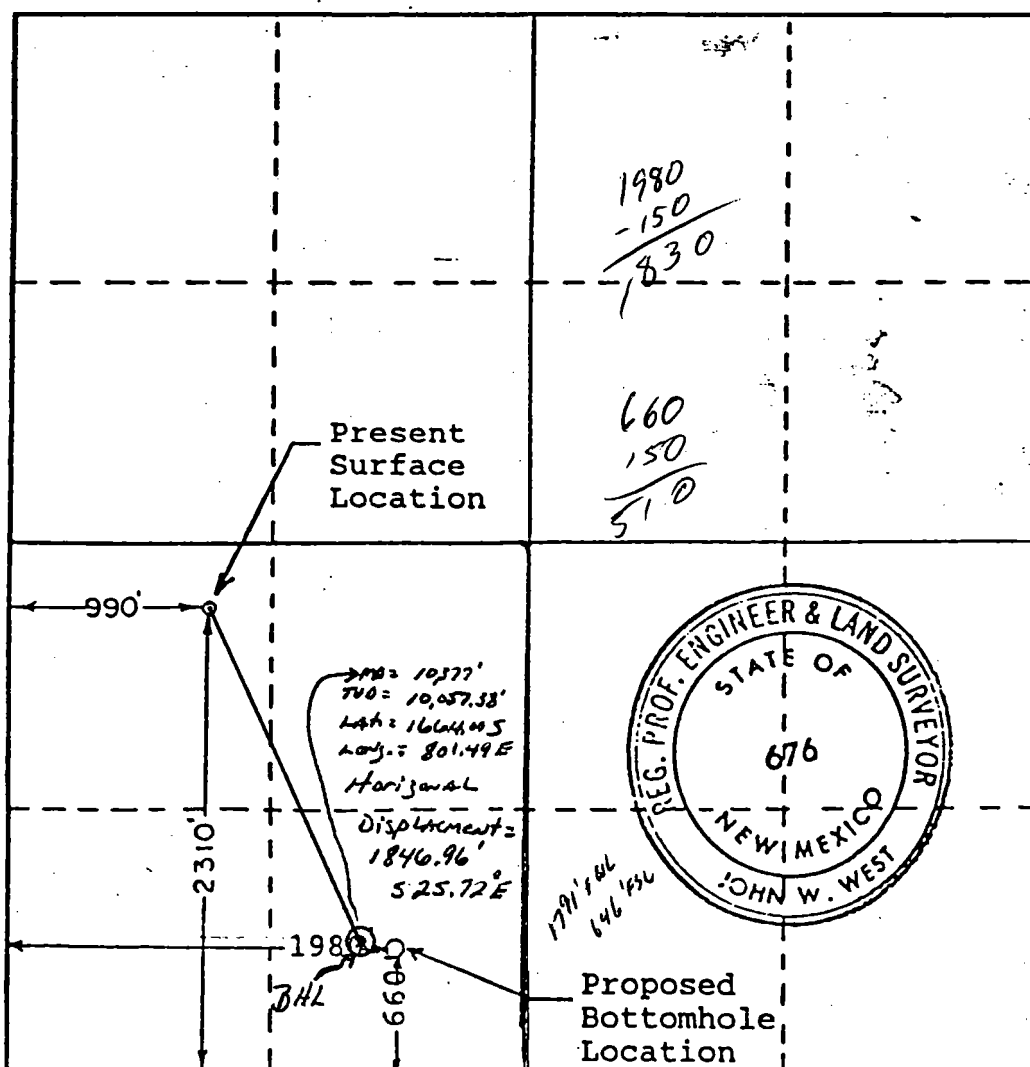

CERTIFICATION

I hereby certify that the information contained herein is true and complete to the best of my knowledge and belief.

Name
Pat Drexler

Position
Agent

Company
MWJ PRODUCING COMPANY

Date
3/15/89

I hereby certify that the well location shown on this plat was plotted from field notes of actual surveys made by me or under my supervision, and that the same is true and correct to the best of my knowledge and belief.

Date Surveyed
OCTOBER 24, 1970

Registered Professional Engineer and/or Land Surveyor

John W. West
 Certificate No. **676**

BAUM-UPPER PENNSYLVANIAN POOL
(Formerly Baum-Wolfcamp Pool)
Lea County, New Mexico

Order No. R-3368-A, Redesignating and Adopting Operating Rules for the Baum-Upper Pennsylvanian Pool, Lea County, New Mexico, June 1, 1968.

Order No. R-3368-A supersedes Order No. R-3368, adopting temporary operating rules for the Baum-Wolfcamp Pool, January 22, 1968.

Application of Coastal States Gas Producing Company for an Amendment to Order No. R-3368, Lea County, New Mexico.

CASE NO. 3701
Order No. R-3368-A

ORDER OF THE COMMISSION

BY THE COMMISSION: This cause came on for hearing at 8 a.m. on May 22, 1968, at Santa Fe, New Mexico, before Examiner Daniel S. Nutter.

NOW, on this 29th day of May, 1968, the Commission, a quorum being present, having considered the testimony, the record, and the recommendations of the Examiner, and being fully advised in the premises,

FINDS:

(1) That due public notice having been given as required by law, the Commission has jurisdiction of this cause and the subject matter thereof.

(2) That by Order No. R-3368, dated January 22, 1968, temporary Special Rules and Regulations were promulgated for the Baum-Wolfcamp Pool, Lea County, New Mexico, providing for 80-acre spacing units, limited well locations, and an 80-acre proportional factor of 4.77 for allowable purposes, and providing that said temporary rules be reconsidered at an examiner hearing in January, 1969.

(3) That the applicant, Coastal States Gas Producing Company, seeks amendment of the temporary Special Rules and Regulations promulgated by Order No. R-3368 to provide for 160-acre spacing units with the assignment of 80-acre allowables.

(4) That the applicant also seeks to have said rules and regulations, as proposed, made permanent.

(5) That a number of wells have been completed in the subject pool subsequent to the issuance of Order No. R-3368.

(6) That the additional evidence concerning the characteristics of the subject reservoir gained as a result of said completions establishes that one well in the pool can efficiently and economically drain and develop 160 acres.

(7) That the additional evidence presented indicates that the establishment of 160-acre spacing units and an 80-acre proportional factor of 4.77 for allowable purposes is warranted.

(8) That the Special Rules and Regulations promulgated by Order No. R-3368, as amended by this order, will afford to the owner of each property in the pool the opportunity to produce his just and equitable share of the oil in the pool.

(9) That in order to prevent the economic loss caused by the drilling of unnecessary wells, to avoid the augmentation of risk arising from the drilling of an excessive number of wells, to prevent reduced recovery which might result from the drilling of too few wells, and to otherwise prevent waste and protect correlative rights, the Special Rules and Regulations promulgated by Order No. R-3368, as amended by this order, should be continued in full force and effect until further order of the Commission.

(10) That the aforementioned additional evidence also establishes that the subject pool is producing from the Upper Pennsylvanian formation rather than the Wolfcamp formation.

(11) That the subject pool should be redesignated the Baum-Upper Pennsylvanian Pool.

IT IS THEREFORE ORDERED:

(1) That, effective June 1, 1968, Order (a) of Order No. R-875-A, Order (a) of Order No. R-914, Order (e) of Order No. R-3367, and Order (a) of Order No. R-3389 are hereby amended by deleting therefrom the word "Wolfcamp" wherever it appears and substituting in lieu thereof the words "Upper Pennsylvanian."

(2) That the Special Rules and Regulations governing the Baum-Wolfcamp Pool, Lea County, New Mexico, promulgated by Order No. R-3368, are hereby amended to read in their entirety as follows, effective June 1, 1968:

**SPECIAL RULES AND REGULATIONS
FOR THE
BAUM-UPPER PENNSYLVANIAN POOL**

RULE 1. Each well completed or recompleted in the Baum-Upper Pennsylvanian Pool or in the Upper Pennsylvanian formation within one mile thereof, and not nearer to or within the limits of another designated Upper Pennsylvanian oil pool, shall be spaced, drilled, operated, and produced in accordance with the Special Rules and Regulations hereinafter set forth.

RULE 2. Each well shall be located on a standard unit containing 160 acres, more or less, substantially in the form of a square, which is a quarter section being a legal subdivision of the United States Public Land Surveys.

RULE 3. The Secretary-Director of the Commission may grant an exception to the requirements of Rule 2 without notice

(BAUM-UPPER PENNSYLVANIAN POOL - Cont'd.)

and hearing when an application has been filed for a non-standard unit consisting of less than 160 acres or the unorthodox size or shape of the tract is due to a variation in the legal subdivision of the United States Public Land Surveys. All operators offsetting the proposed non-standard unit shall be notified of the application by registered or certified mail, and the application shall state that such notice has been furnished. The Secretary-Director may approve the application upon receipt of written waivers from all offset operators or if no offset operator has entered an objection to the formation of the non-standard unit within 30 days after the Secretary-Director has received the application.

RULE 4. Each well shall be located within 150 feet of the center of a governmental quarter-quarter section or lot.

RULE 5. The Secretary-Director may grant an exception to the requirements of Rule 4 without notice and hearing when an application has been filed for an unorthodox location necessitated by topographical conditions or the recompletion of a well previously drilled to another horizon. All operators offsetting the proposed location shall be notified of the application by registered or certified mail, and the application shall state that such notice has been furnished. The Secretary-Director may approve the application upon receipt of written waivers from all operators offsetting the proposed location or if no objection to the unorthodox location has been entered within 20 days after the Secretary-Director has received the application.

RULE 6. A standard proration unit (158 through 162 acres) shall be assigned an 80-acre proportional factor of 4.77 for allowable purposes, and in the event there is more than one well on a 160-acre proration unit, the operator may produce the allowable assigned to the unit from the wells on the unit in any proportion.

The allowable assigned to a non-standard proration unit shall bear the same ratio to a standard allowable as the acreage in such non-standard unit bears to 160 acres.

IT IS FURTHER ORDERED:

(1) That the locations of all wells presently drilling to or completed in the Baum-Upper Pennsylvanian Pool or in the Upper Pennsylvanian formation within one mile thereof are hereby approved; that the operator of any well having an unorthodox location shall notify the Hobbs District Office of the Commission in writing of the name and location of the well on or before June 1, 1968.

(2) That each well presently drilling to or completed in the Baum-Upper Pennsylvanian Pool or in the Upper Pennsylvanian formation within one mile thereof shall, after June 1, 1968, receive an allowable in the same proportion to a standard 160-acre allowable for the pool as the acreage presently dedicated to the well bears to 160 acres, until Form C-102 dedicating 160 acres to the well has been filed with the Commission, or until a non-standard unit containing less than 160 acres has been approved.

(3) That Order No. R-3368 entered by the Commission on January 22, 1968, is hereby superseded.

(4) That jurisdiction of this cause is retained for the entry of such further orders as the Commission may deem necessary.

DONE at Santa Fe, New Mexico, on the day and year hereinabove designated.

NORTH SHIPROCK-DAKOTA POOL
San Juan County, New Mexico

Order No. R-3408, Adopting Operating Rules for the North Shiprock-Dakota Pool, San Juan County, New Mexico, April 29, 1968.

Application of Dugan Production Corporation for the Creation of an Oil Pool and for Special Pool Rules, San Juan County, New Mexico.

CASE NO. 3755
Order No. R-3408

ORDER OF THE COMMISSION

BY THE COMMISSION: This cause came on for hearing at 9 a.m. on April 24, 1968, at Santa Fe, New Mexico, before Examiner Daniel S. Nutter.

NOW, on this 29th day of April, 1968, the Commission, a quorum being present, having considered the testimony, the record, and the recommendations of the Examiner, and being fully advised in the premises,

FINDS:

(1) That due public notice having been given as required by law, the Commission has jurisdiction of this cause and the subject matter thereof.

(2) That the applicant, Dugan Production Corporation, seeks the creation of a new oil pool for Dakota production in San Juan County, New Mexico, and the establishment of special pool rules therefor providing for development on 2-1/2-acre spacing with a provision that each 40-acre tract be subject to a single Northwest New Mexico normal unit allowable.

(3) That the Thomas A. Dugan Shiprock Well No. 1, located in Unit B of Section 14, Township 30 North, Range 18 West, NMPM, San Juan County, New Mexico, has discovered a separate common source of supply which should be designated the North Shiprock-Dakota Oil Pool; that the vertical limits of said pool should be Dakota formation, and that the horizontal limits of said pool should be the NE/4 of said Section 14.



STATE OF NEW MEXICO
ENERGY AND MINERALS DEPARTMENT
OIL CONSERVATION DIVISION
HOBBS DISTRICT OFFICE

GARREY CARRUTHERS
GOVERNOR

5-3-89

POST OFFICE BOX 1980
HOBBS, NEW MEXICO 88241-1980
(505) 393-6161

OIL CONSERVATION DIVISION
P. O. BOX 2088
SANTA FE, NEW MEXICO 87501

RE: Proposed:

MC	_____
DHC	_____
NSL	<u>X</u>
NSP	_____
SWD	_____
WFX	_____
PMX	_____

Gentlemen:

I have examined the application for the:

mwj Prod-Co. Baum St #2-2 5-14-33
Operator Lease & Well No. Unit S-T-R

and my recommendations are as follows:

OK

Yours very truly,

Jerry Sexton
Jerry Sexton
Supervisor, District 1

/ed

RECEIVED

MAY - 8 1989

OIL CONSERVATION DIV.
SANTA FE

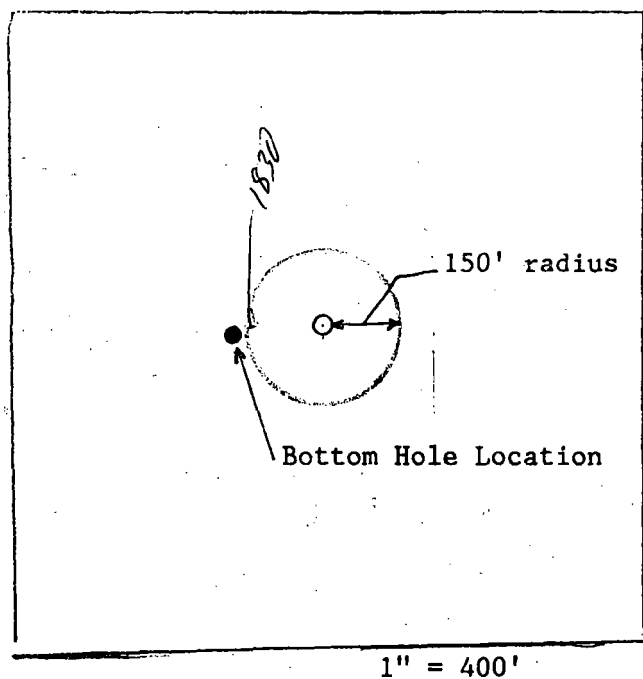
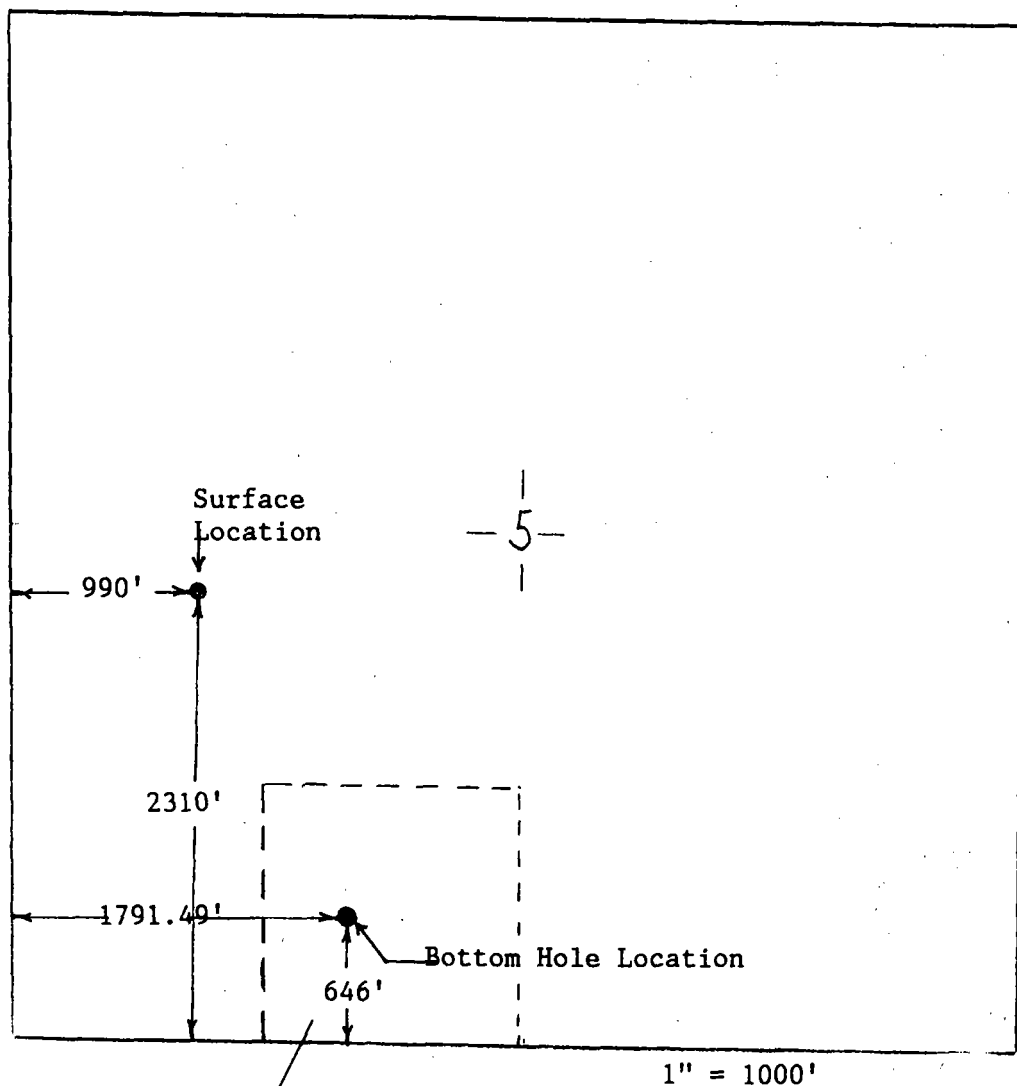

1980
- 150
1830

MWJ PRODUCING COMPANY
BAUM STATE #2
Sec 5, T-14S, R-33E
Lea County, New Mexico
K-3138

DD25

5/2/89

MWJ PRODUCING COMPANY

★ PETROLEUM PRODUCERS ★

400 WEST ILLINOIS SUITE 1100
MIDLAND, TEXAS 79701
TELEPHONE (915) 682-5218

June 6, 1989

RECEIVED

SEP 22 1989

Oil Conservation Division
P. O. Box 2088
Santa Fe, New Mexico 87504

OIL CONSERVATION DIV.
SANTA FE

Attn: Mike Stogner

RE: Administrative Order
Number DD-25

Dear Mike:

As per your request, enclosed please find a copy of the letter that was sent to Union Pacific Resources and Coastal Oil & Gas, the two offset operators of the Baum State #2.

If any additional information is needed, please contact either Stan or myself.

Very truly yours,

MWJ PRODUCING COMPANY

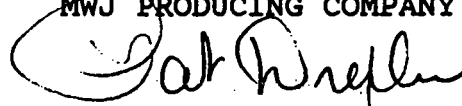

Pat Drexler

/pd

Encl.

MWJ PRODUCING COMPANY

★ PETROLEUM PRODUCERS ★

400 WEST ILLINOIS SUITE 1100
MIDLAND, TEXAS 79701
TELEPHONE (915) 682-5216

June 5, 1989

TO: Offset Operators

RE: MWJ-Baum State #2
Administrative Order No. DD-25
SW/4 Sec 5, T-14S, R-33E
Lea County, New Mexico

Gentlemen:

MWJ proposed to plug back and directionally drill the captioned well to a new bottomhole location of 1980' FWL & 660' FSL of Section 5. The surface location was 990' FWL & 2310' FSL. The whipstock was applied for and approved by the New Mexico Oil Conservation Division with no objections from offset operators.

The well was directionally drilled to a measured depth of 10,377', with a bottomhole location of 1791.49' FWL and 646.0' FSL, or roughly 200' west of our proposed bottomhole location. This letter will serve as notification to all offset operators of the bottomhole location of the Baum State #2. Approval as an unorthodox location by the New Mexico OCD is pending.

If you should have any questions concerning this matter, please contact me.

Very truly yours,

MWJ PRODUCING COMPANY



Stan Venable

SV/pd

MWJ PRODUCING COMPANY

★ PETROLEUM PRODUCERS ★

400 WEST ILLINOIS SUITE 1100
MIDLAND, TEXAS 79701
TELEPHONE (915) 682-5216

March 30, 1989

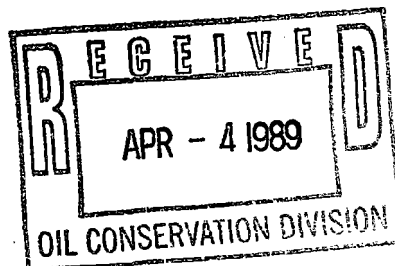

Oil Conservation Division
P. O. Box 2088
Santa Fe, New Mexico 87504

Attn: Mike Stogner

RE: MWJ-Baum State #2 (K-3138)
Administrative Order DD-25
Sec 5, T-14S, R-33E
Lea County, New Mexico

Gentlemen:

Enclosed please find the original waiver letters for the above captioned. I am also enclosing a copy of the amended C-101 that shows the correct well name.

I do appreciate the prompt attention that was given in issuing this permit.

Very truly yours,

MWJ PRODUCING COMPANY

A handwritten signature in cursive script, appearing to read "Pat Drexler".

Pat Drexler

pd
Enclosures

cc: Oil Conservation Division
Hobbs, New Mexico

MWJ PRODUCING COMPANY

★ PETROLEUM PRODUCERS ★

400 WEST ILLINOIS SUITE 1100
MIDLAND, TEXAS 79701
TELEPHONE (915) 682-5216

March 15, 1989

Coastal Oil & Gas Corporation
~~P. O. Box 235~~
~~Midland, Texas 79702~~
211 N. Robinson, Ste 1700
OKla. City, OKla. 73102

RE: MWJ-Baum "F" State #1
990' FWL & 2310' FSL
Sec 5, T-14S, R-33E
Lea County, New Mexico
Baum Upper Penn Field

Gentlemen:

MWJ proposes the sidetrack drilling of the above captioned well to a new bottom hole location of 1980' FWL and 660' FSL, Sec 5, T-14S, R-33E, Lea County, New Mexico.

If you have no objection to our proposal, please execute in the space provided below and return three copies of this letter to our office. We appreciate your prompt attention.

Very truly yours,

MWJ PRODUCING COMPANY

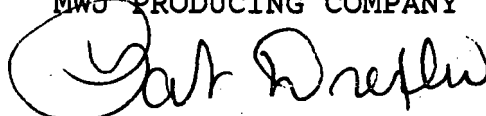

Pat Drexler

pd

COASTAL OIL & GAS CORPORATION has no objection to the sidetrack drilling of the proposed well.

By

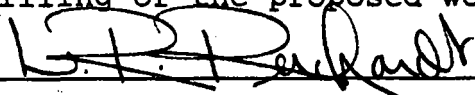

Title District Exploration Mgr.

Date 21 March '89

MWJ PRODUCING COMPANY

* PETROLEUM PRODUCERS *

400 WEST ILLINOIS SUITE 1100
MIDLAND, TEXAS 79701
TELEPHONE (818) 682-6216

March 15, 1989

Union Pacific Resources Company
P. O. Box 7 MS3306
Fort Worth, Texas 76101-0007

RE: MWJ-Baum "F" State #1
990' FWL & 2310' FSL
Sec 5, T-14S, R-33E
Lea County, New Mexico
Baum Upper Penn Field

Gentlemen:

MWJ proposes the sidetrack drilling of the above captioned well to a new bottom hole location of 1980' FWL and 660' FSL, Sec 5, T-14S, R-33E, Lea County, New Mexico.

If you have no objection to our proposal, please execute in the space provided below and return three copies of this letter to our office. We appreciate your prompt attention.

Very truly yours,

MWJ PRODUCING COMPANY

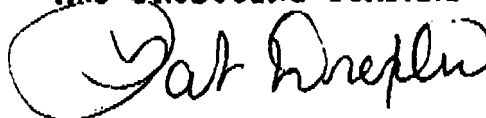

Pat Drexler

pd

UNION PACIFIC RESOURCES COMPANY has no objection to the sidetrack drilling of the proposed well.

By 

Title Regulatory Manager

Date March 15, 1989

BEFORE THE OIL CONSERVATION COMMISSION
OF THE STATE OF NEW MEXICO

IN THE MATTER OF THE HEARING
CALLED BY THE OIL CONSERVATION
COMMISSION OF NEW MEXICO FOR
THE PURPOSE OF CONSIDERING:

CASE No. 4432

Order No. R-4038

APPLICATION OF MWJ PRODUCING COMPANY
FOR AN UNORTHODOX OIL WELL LOCATION,
LEA COUNTY, NEW MEXICO.

ORDER OF THE COMMISSION

IT IS THEREFORE ORDERED:

BY THE COMMISSION:

That the applicant, MWJ Producing Company, is hereby
advised that this cause came on for hearing at 9 a.m. on September 30, 1970,
at Santa Fe, New Mexico, before Examiner Daniel S. Nutter.
Now, on this 6th day of October, 1970, the Commission, a
quorum being present, having considered the testimony, the record,
and the recommendations of the Examiner, and being fully advised
in the premises,
It is the order of the Commission that the jurisdiction of this cause is hereby
extended to the 6th day of October, 1970.

(1) That due public notice having been given as required by
law, the Commission has jurisdiction of this cause and the subject
matter thereof.

(2) That the applicant, MWJ Producing Company, seeks an
exception to Rule 4 of the Special Rules and Regulations govern-
ing the Baum-Upper Pennsylvanian Pool, as promulgated by Order
No. R-3368-A, to permit the drilling of an oil well at an unortho-
dox location 2310 feet from the South line and 990 feet from the
West line of Section 5, Township 14 South, Range 33 East, NMPM,
Lea County, New Mexico.

(3) That the SW/4 of said Section 5 would be dedicated to
the subject well.

(4) That mechanical problems caused the abandonment of a
producing oil well at a standard location in the NW/4 SW/4 of
said Section 5.

(5) That a well drilled at the proposed non-standard loca-
tion in the NW/4 SW/4 of said Section 5 will avoid the damaged

CASE No. 4432

Order No. R-4038

hole of the previously drilled well and is more likely to encounter more of the Baum-Upper Pennsylvanian producing section above 100% water saturation than a well drilled at a standard location in another quarter of said quarter section and should, therefore, result in greater ultimate recovery of oil from the pool.

(6) That approval of the proposed unorthodox location will not violate correlative rights and will afford the applicant the opportunity to produce its just and equitable share of the oil from the subject pool, will prevent the economic loss caused by the drilling of unnecessary wells, avoid the augmentation of risk arising from the drilling of an excessive number of wells, and otherwise prevent waste.

IT IS THEREFORE ORDERED:

(1) That the applicant, MWJ Producing Company, is hereby granted an exception to the well location requirements of the Baum-Upper Pennsylvanian Pool, as promulgated by Order No. R-3368-A, and is hereby authorized to drill an oil well at an unorthodox location 2310 feet from the South line and 990 feet from the West line of Section 5, Township 14 South, Range 33 East, NMPM, Lea County, New Mexico.

(2) That jurisdiction of this cause is retained for the entry of such further orders as the Commission may deem necessary.

DONE at Santa Fe, New Mexico, on the day and year hereinabove designated.

STATE OF NEW MEXICO

OIL CONSERVATION COMMISSION

DAVID F. CARGO, Chairman

ALEX. J. ARMIJO, Member

A. L. PORTER, Jr., Member & Secretary

SEAL

esr/



STATE OF NEW MEXICO
ENERGY AND MINERALS DEPARTMENT
OIL CONSERVATION DIVISION
HOBBS DISTRICT OFFICE

GARREY CARRUTHERS
GOVERNOR

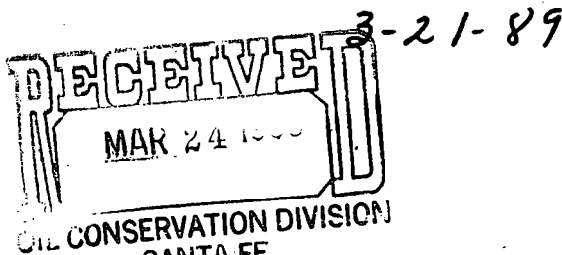

POST OFFICE BOX 1980
HOBBS, NEW MEXICO 88241-1980
(505) 393-6161

OIL CONSERVATION DIVISION
P. O. BOX 2088
SANTA FE, NEW MEXICO 87501

RE: Proposed:

MC _____
DHC _____
NSL _____
NSP _____
SWD _____
WFX _____
PMX _____

D.D. X

Gentlemen:

I have examined the application for the:

mwj Prod. Co. Baum State #2-2 5-14-33
Operator Lease & Well No. Unit S-T-R

and my recommendations are as follows:

OK JJ

Note: This well was drilled as the Baum F St #1
but was changed to the Baum St #2 in 1971.
Yours very truly, Letter will be forthcoming from mwj showing
Correct lease Name & well No. Evelyn

Jerry Sexton
Supervisor, District 1

/ed

MWJ PRODUCING COMPANY

★ PETROLEUM PRODUCERS ★

400 WEST ILLINOIS SUITE 1100
MIDLAND, TEXAS 79701
TELEPHONE (915) 682-5216

June 6, 1989

RECEIVED

JUN 12 1989

OIL CONSERVATION DIV.
SANTA FE

Oil Conservation Division
P. O. Box 2088
Santa Fe, New Mexico 87504

Attn: Mike Stogner

RE: Administrative Order
Number DD-25

Dear Mike:

As per your request, enclosed please find a copy of the letter that was sent to Union Pacific Resources and Coastal Oil & Gas, the two offset operators of the Baum State #2.

If any additional information is needed, please contact either Stan or myself.

Very truly yours,

MWJ PRODUCING COMPANY

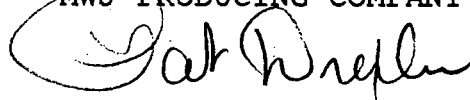

Pat Drexler

/pd

Encl.

RECEIVED - ENVIRONMENTAL

1987 JUL 10 10 11 AM

RECEIVED - ENVIRONMENTAL

1987 JUL 10 10 11 AM

ENVIRONMENTAL DIV
SANTA FE

MWJ PRODUCING COMPANY

★ PETROLEUM PRODUCERS ★

400 WEST ILLINOIS SUITE 1100
MIDLAND, TEXAS 79701
TELEPHONE (915) 682-5216

June 5, 1989

TO: Offset Operators

RE: MWJ-Baum State #2
Administrative Order No. DD-25
SW/4 Sec 5, T-14S, R-33E
Lea County, New Mexico

Gentlemen:

MWJ proposed to plug back and directionally drill the captioned well to a new bottomhole location of 1980' FWL & 660' FSL of Section 5. The surface location was 990' FWL & 2310' FSL. The whipstock was applied for and approved by the New Mexico Oil Conservation Division with no objections from offset operators.

The well was directionally drilled to a measured depth of 10,377', with a bottomhole location of 1791.49' FWL and 646.0' FSL, or roughly 200' west of our proposed bottomhole location. This letter will serve as notification to all offset operators of the bottomhole location of the Baum State #2. Approval as an unorthodox location by the New Mexico OCD is pending.

If you should have any questions concerning this matter, please contact me.

Very truly yours,

MWJ PRODUCING COMPANY



Stan Venable

SV/pd

NO. OF COPIES REQUESTED	
DISTRIBUTION	
SANTA FE	
FILE	
U.S.G.S.	
LAND OFFICE	
TRANSPORTER	OIL
	GAS
OPERATOR	
PRODUCTION OFFICE	

NEW MEXICO OIL CONSERVATION COMMISSION
REQUEST FOR ALLOWABLE
AND
AUTHORIZATION TO TRANSPORT OIL AND NATURAL GAS

Form C-104
Supersedes Old C-285 and C-286
Effective 1-1-83

MWJ PRODUCING COMPANY

413 FIRST NATIONAL BANK BUILDING, MIDLAND, TEXAS 79701

Reason(s) for filing (check proper box) ☐ Change in Transporter ☐ Other (Please explain)
To change Baum "F" State Well No. 2 to

STATE OF NEW MEXICO

ENERGY, MINERALS AND NATURAL RESOURCES DEPARTMENT

OIL CONSERVATION DIVISION

GARREY CARRUTHERS
GOVERNOR

POST OFFICE BOX 2088
STATE LAND OFFICE BUILDING
SANTA FE, NEW MEXICO 87504
(505) 827-5800

October 27, 1989

MWJ Producing Company
400 West Illinois
Suite 1100
Midland, TX 79701

Attention: Stan Venable

Amended Administrative Order DD-25(NSL)

Dear Mr. Venable:

Reference is made to your application dated May 2, 1989 requesting an amendment to Administrative Order DD-25, dated March 27, 1989, to properly reflect the actual bottomhole location for the Baum "F" State Well No. 2 in the Baum Upper Pennsylvanian Pool.

It is our understanding that the subject well was drilled to a total depth of 10,377 and a multi-shot directional survey was run, which indicates that the actual bottomhole location is 646 feet from the South line and 1791.5 feet from the West line (Unit N) of Section 5, Township 14 South, Range 33 East, NMPM, Lea County, New Mexico. This bottomhole location exceeds the limits prescribed by the original order DD-25 and is also an unorthodox oil well location for said pool.

The Division at this time finds that the applicant has made proper notification to all offset operators pursuant to General Rule 111(e) and 104.(F)IV and Rule 5 of the Special Rules and Regulations for the Baum-Upper Pennsylvanian Pool, as promulgated by Division Order No. R-3368-A, and no objections from any offsets were received.

Therefore, Division Administrative Order DD-25 is hereby amended to properly reflect the actual bottomhole location for the applicant's Baum "F" State Well No. 2, being an unorthodox oil well location for the Baum-Upper Pennsylvanian Pool, be 646 feet from the South line and 1791.5 feet from the West line (Unit N) of said Section 5.

All other provisions of said original order DD-25 shall remain in full force and effect until further notice.

NO. OF COPIES RECEIVED	
DISTRIBUTION	
SANTA FE	
FILE	
U.S.G.S.	
LAND OFFICE	
OPERATOR	

NEW MEXICO OIL CONSERVATION COMMISSION WELL COMPLETION OR RECOMPLETION REPORT AND LOG

Indicate State <input checked="" type="checkbox"/> New Mexico <input type="checkbox"/> Other	Indicate Lease No. <input type="checkbox"/>
State Oil & Gas Lease No.	
K-3138	

1. TYPE OF WELL	2. TYPE OF COMPLETION	3. Name of Operator	4. Field or Lease Name
OIL WELL <input checked="" type="checkbox"/> GAS WELL <input type="checkbox"/> HOT <input type="checkbox"/> OTHER <input type="checkbox"/>	NEW WELL <input checked="" type="checkbox"/> WORK OVER <input type="checkbox"/> REPAIR <input type="checkbox"/> PLUG BACK <input type="checkbox"/> DIFF. REPAIR <input type="checkbox"/> OTHER <input type="checkbox"/>	MWJ PRODUCING COMPANY	BAUM "F"

5. Address of Operator	6. Well No.
413 FIRST NATIONAL BANK BUILDING, MIDLAND, TEXAS 79701	1

7. Location of Well	8. Field and Pool, or Wildcat
UNIT LETTER <u>L</u> LOCATED <u>2310</u> FEET FROM THE <u>SOUTH</u> LINE AND <u>990</u> FEET FROM <u>LEA</u>	BAUM, UPPER PENN

9. Date Drilled	10. Date T.D. Reached	11. Date Cased	12. Elevation of PINKHART	13. Flow Combination
11-2-70	11-24-70	12-3-70	KB 4277	4266

14. Total Depth	15. Plug Back T.D.	16. If Multiple Compl. How Many	17. Interval Rotary Tools Drilled By	18. Cable Tools
10,060	10,021		0-10,060	

19. Producing Interval(s), of this completion - Top, Bottom, None	20. Was Geophysical Survey Made
9909-14, 9917-19, 9930-37, 9939-42 (UPPER PENN)	NO

21. Type Electric and Other Logs Run	22. Was Well Cased
SNP	NO

CASINO RECORD (Report all strings set in well)					
CASING SIZE	WEIGHT LB./FT.	DEPTH SET	MOLE SIZE	CEMENTING RECORD	AMOUNT PULLED
13 3/8	48	362	17 1/2	400 SX	None
8 5/8	32 & 24	4074	11	300 SX	None
5 1/2	17	10057	7 7/8	200 SX	None

LINER RECORD				TUBING RECORD		
SIZE	TOP	BOTTOM	BACKS CEMENT	SCREEN	SIZE	DEPTH SET
					2 3/8	9885
						9885

23. Perforation Record (Interval, size and number)	24. ACID, SHOT, FRACTURE, CEMENT SQUEEZE, ETC.
9909 - 42 (15 - 1/2" holes)	DEPTH INTERVAL
	AMOUNT AND KIND MATERIAL USED
	9909-42 2000 gal. 28% Hcl

PRODUCTION							
Date First Production	Production Method (Flowing, gas lift, pumping - Size and type pump)	Well Status (Prod. or Shut-in)					
12-1-70	Swab and Flow	Producing					
Date of Test	Hours Tested	Choke Size	Prod'n. For Test Period	Oil - Bbl.	Gas - MCF	Water - Bbl.	Gas - Oil Ratio
12-2-70	24	12/64		336	300	144	893:1
Flow Tubing Pkgs.	Quoting Pressure	Calculated 24-Hour Rate	Oil - Bbl.	Gas - MCF	Water - Bbl.	Oil Gravity - API (Conv.)	
50-100	Pkr.		336	300	144	42.1	

25. Disposition of Gas (Sold, used for fuel, vented, etc.)	Test Witnessed By
Vented	

26. List of Attachments
Electric Log

27. I hereby certify that the information shown on both sides of this form is true and complete to the best of my knowledge and belief.
SIGNED <u>B. G. G. G.</u> TITLE <u>AGENT</u> DATE <u>DECEMBER 3, 1970</u>

NO. OF COPIES RECEIVED	
DISTRIBUTION	
SANTA FE	
FILE	
U.S.G.S.	
LAND OFFICE	
TRANSPORTER	OIL GAS

**NEW MEXICO OIL CONSERVATION COMMISSION
REQUEST FOR ALLOWABLE
AND
AUTHORIZATION TO TRANSPORT OIL AND NATURAL GAS**

Form C-104
Supersedes Old C-104 and C-110
Effective 1-1-65

76 DEC 33

INSTRUCTIONS

This form is to be filed with the appropriate District Office of the Commission not later than 20 days after the completion of any newly-drilled or deepened well. It shall be accompanied by one copy of all electrical and radio-activity logs run on the well and a summary of all special tests conducted, including drill stem tests. All depths reported shall be measured depths. In the case of directionally drilled wells, true vertical depths shall also be reported. For multiple completions, Items 30 through 34 shall be reported for each zone. The form is to be filed in quintuplicate except on state land, where six copies are required. See Rule 1105.

INDICATE FORMATION TOPS IN CONFORMANCE WITH GEOGRAPHICAL SECTION OF STATE

Southeastern New Mexico

Northwestern New Mexico

T. Anhy <u>1690</u>	T. Canyon _____	T. Ojo Alamo _____	T. Penn. "B" _____
T. Salt _____	T. Strawn _____	T. Kirtland-Fruitland _____	T. Penn. "C" _____
B. Salt _____	T. Atoka _____	T. Pictured Cliffs _____	T. Penn. "D" _____
T. Yates <u>2570</u>	T. Miss _____	T. Cliff House _____	T. Leadville _____
T. 7 Rivers _____	T. Devonian _____	T. Menefee _____	T. Madison _____
T. Queen <u>3496</u>	T. Silurian _____	T. Point Lookout _____	T. Elbert _____
T. Grayburg <u>3725</u>	T. Montoya _____	T. Mancos _____	T. McCracken _____
T. San Andres <u>4034</u>	T. Simpson _____	T. Gallup _____	T. Ignacio Quito _____
T. Glorieta <u>5475</u>	T. McKee _____	T. Base Greenhorn _____	T. Granite _____
T. Paddock _____	T. Ellenburger _____	T. Dakota _____	T. _____
T. Elmore _____	T. Gr. Wash _____	T. Morrison _____	T. _____
T. Tubb <u>6887</u>	T. Granite _____	T. Todillo _____	T. _____
T. Drinkard _____	T. Delaware Sand _____	T. Entrada _____	T. _____
T. Abo <u>7575</u>	T. Lone Springs _____	T. Wingate _____	T. _____
T. Wolfcamp _____	T. _____	T. Chinle _____	T. _____
T. Penn. <u>9756</u>	T. _____	T. Permian _____	T. _____
T. Cisco (Bough C) <u>9906</u>	T. _____	T. Penn. "A" _____	T. _____

FORMATION RECORD (Attach additional sheets if necessary)

From	To	Thickness in Feet	Formation	From	To	Thickness in Feet	Formation
Surface	1690	1690	Cretaceous				
1690	2570	880	Anhyd & Salt				
2570	4034	1464	Whitehorse Group				
4034	6887	2853	San Andres-Clearfork				
6887	7575	688	Tubb				
7575	9756	2181	Lower Wolfcamp				
9756	TD	304	Penn				

RECEIVED
DEC 7 1970
OIL CONSERVATION COM. **COM.**
HOOVER, ALA.

UNITED STATES DEPARTMENT OF JUSTICE
FEDERAL BUREAU OF INVESTIGATION
WASHINGTON, D. C. 20535

REPORT OF INVESTIGATION
DATE: 10/15/68
BY: [illegible]
TITLE: [illegible]

TO: DIRECTOR, FBI
FROM: SAC, [illegible]
SUBJECT: [illegible]

1. [illegible]

2. [illegible]

3. [illegible]

4. [illegible]

5. [illegible]

6. [illegible]

7. [illegible]

8. [illegible]

9. [illegible]

10. [illegible]

11. [illegible]

12. [illegible]

13. [illegible]

14. [illegible]

15. [illegible]

16. [illegible]

17. [illegible]

18. [illegible]

19. [illegible]

20. [illegible]

WELL NAME AND NUMBER Baum "F" State #1

LOCATION 2310/S 990/W Section 5, T14S, R33E, Lea County, New Mexico
(New Mexico give U.S. T&R: TEXAS GIVE S, BLK, SURV. & TWR)

OPERATOR MWJ Producing Company

DRILLING CONTRACTOR Moran Oil Producing & Drilling Corp.

The undersigned hereby certifies that he is an authorized representative of the drilling contractor who drilled the above-described well and that he has conducted deviation tests and obtained the following results:

Degrees @ Depth	Degrees @ Depth	Degrees @ Depth	Degrees @ Depth
1/4 180	1/2 5660		
1/2 365	3/4 6165		
1/4 860	3/4 6345		
3/4 1360	1/2 6810		
1 1800	1/2 7160		
1 1/4 2400	1/4 7675		
1 1/4 2840	3/4 8100		
3/4 3078	1 8600		
1/2 3290	1 9115		
1 3645	1 9150		
1/4 4070	1 1/4 9610		
1/2 4630	1 10,060		
1/2 5140			

Drilling Contractor MORAN OIL PRODUCING & DRILLING CORP.

By

K. D. McPeters, Vice President

Subscribed and sworn to before me this 3rd day of Decmeber, 19 70

My Commission expires:
April 1, 1974

Sammy Swinney
Notary Public
Lea County, New Mexico

NO. OF COPIES RECEIVED	
DISTRIBUTION	
SANTA FE	
FILE	
U.S.G.S.	
LAND OFFICE	
OPERATOR	

NEW MEXICO OIL CONSERVATION COMMISSION

70 DEC 10 2 11 33

Form C-103
Supersedes Old
C-102 and C-103
Effective 1-1-65

5a. Indicate Type of Lease	
State <input checked="" type="checkbox"/> Fed <input type="checkbox"/>	
5. State Oil & Gas Lease No.	
K-3138	

SUNDRY NOTICES AND REPORTS ON WELLS

(DO NOT USE THIS FORM FOR PROPOSALS TO DRILL OR TO DEESEN OR PLUG BACK TO A DIFFERENT RESERVOIR. USE "APPLICATION FOR PERMIT" (FORM C-101) FOR SUCH PROPOSALS.)

1. OIL WELL <input checked="" type="checkbox"/> GAS WELL <input type="checkbox"/> OTHER <input type="checkbox"/>	7. Unit Agreement Name
2. Name of Operator MWJ PRODUCING COMPANY	8. Farm or Lease Name BAUM "P"
3. Address of Operator 413 FIRST NATIONAL BANK BUILDING, MIDLAND, TX 79701	9. Well No. 1
4. Location of Well UNIT LETTER L, 2310 FEET FROM THE SOUTH LINE AND 990 FEET FROM THE WEST LINE, SECTION 5, TOWNSHIP 14 SOUTH, RANGE 33 EAST, NMPM	10. Field and Pool, or Wildcat BAUM, UPPER PENN
15. Elevation (Show whether DF, RT, GR, etc.) 4277 KB	12. County LEA

Check Appropriate Box To Indicate Nature of Notice, Report or Other Data
NOTICE OF INTENTION TO: SUBSEQUENT REPORT OF:

PERFORM REMEDIAL WORK <input type="checkbox"/>	PLUG AND ABANDON <input type="checkbox"/>	REMEDIAL WORK <input type="checkbox"/>	ALTERING CASING <input type="checkbox"/>
TEMPORARILY ABANDON <input type="checkbox"/>	CHANGE PLANS <input type="checkbox"/>	COMMENCE DRILLING OPER. <input type="checkbox"/>	PLUG AND ABANDONMENT <input type="checkbox"/>
PULL OR ALTER CASING <input type="checkbox"/>	OTHER <input type="checkbox"/>	CASING TEST AND CEILING JOBS <input checked="" type="checkbox"/>	OTHER <input type="checkbox"/>

17. Describe Proposed or Completed Operations (Clearly state all pertinent details, and give pertinent dates, including estimated date of starting any proposed work) SEE RULE 1709.

Drilled 7 7/8" hole to 10,060'. Ran 5 1/2", 17 lb., N-80 & K-55 and set @ 10057' w/200 sx 50/50 pozmix, Type "C", 2% gel, 9 lb. salt/sk, 0.5% CFR-2. Plug down @ 7:45 A.M. (MST) 11-25-70. WOC 24 hours. Test casing to 3000 psi for 30 minutes. Test OK.

18. I hereby certify that the information above is true and complete to the best of my knowledge and belief.

SIGNED Bob Goldfarb TITLE AGENT DATE DECEMBER 3, 1970

APPROVED BY John R. Remy TITLE Geologist DATE DEC 7 1970

CONDITION OF APPROVAL, IF ANY:

NO. OF COPIES RECEIVED	
DISTRIBUTION	
SANTA FE	
FILE	
U.S.G.S.	
LAND OFFICE	
OPERATOR	

NEW MEXICO OIL CONSERVATION COMMISSION

Form C-103
Supersedes Oil
C-102 and C-103
Effective 1-1-65

70 NOV 19 11:13

SUNDRY NOTICES AND REPORTS ON WELLS (DO NOT USE THIS FORM FOR PROPOSALS TO DRILL OR TO REPER OR PLUG BACK TO A DIFFERENT RESERVOIR. USE APPLICATION FOR PERMIT - (FORM C-101) FOR SUCH PROPOSALS.)

1. OIL WELL <input checked="" type="checkbox"/> GAS WELL <input type="checkbox"/> OTHER <input type="checkbox"/>	5a. Indicate Type of Lease State <input checked="" type="checkbox"/> Fee <input type="checkbox"/>
2. Name of Operator MWJ PRODUCING COMPANY	5. State Oil & Gas Lease No. K-3138
3. Address of Operator 413 FIRST NATIONAL BANK BUILDING, MIDLAND, TX 79701	7. Unit Agreement Name
4. Location of Well UNIT LETTER L 2310 FEET FROM THE SOUTH LINE AND 990 FEET FROM THE WEST LINE, SECTION 5 TOWNSHIP 14 SOUTH RANGE 33 EAST NMPM.	8. Farm or Lease Name BAUM "P"
11. Elevation (Show whether DF, RT, GR, etc.) 4277 KB	9. Well No. 1
	10. Field and Pool, or Wildcat BAUM, UPPER PENN
	12. County LEA

16. Check Appropriate Box To Indicate Nature of Notice, Report or Other Data			
NOTICE OF INTENTION TO:		SUBSEQUENT REPORT OF:	
PERFORM REMEDIAL WORK <input type="checkbox"/>	PLUG AND ABANDON <input type="checkbox"/>	REMEDIAL WORK <input type="checkbox"/>	ALTERING CASING <input type="checkbox"/>
TEMPORARILY ABANDON <input type="checkbox"/>	CHANGE PLANS <input type="checkbox"/>	COMMENCE DRILLING OPS. <input checked="" type="checkbox"/>	PLUG AND ABANDONMENT <input type="checkbox"/>
PULL OR ALTER CASING <input type="checkbox"/>	OTHER <input type="checkbox"/>	CASING TEST AND CEMENT JOBS <input checked="" type="checkbox"/>	OTHER <input type="checkbox"/>

17. Describe Proposed or Completed Operations (Clearly state all pertinent details, and give pertinent dates, including estimated date of starting any proposed work) SEE RULE 100B.

Drilled 11" hole to 4075'. Set 8 5/8", 32 and 24 lb., N-80 & K-55, ST&C casing @ 4074'. Cemented w/200 ex Class "H", 4% gel and 100 sr Class "H", 2% CaCl₂. Plug down @ 11:30 a.m. 11-8-70 (MST) WOC 18 hrs. Tested casing to 200 psi for 30 minutes. Test OK.
Ran Temperature survey. Top of cement @ 3440'.

18. I hereby certify that the information above is true and complete to the best of my knowledge and belief.

SIGNED Bob Klepfer TITLE ENGINEER DATE NOVEMBER 10, 1970
APPROVED BY [Signature] TITLE SUPERVISOR DISTRICT 1 DATE NOV 16 1970
CONDITIONS OF APPROVAL, IF ANY:

NO. OF COPIES RECEIVED	
DISTRIBUTION	
SANTA FE	
FILE	
U.S.G.S.	
LAND OFFICE	
OPERATOR	

NEW MEXICO OIL CONSERVATION COMMISSION

Form C-103
Supersedes Old
C-102 and C-103
Effective 1-4-65

970 NOV 9 AM 11 33

5a. Indicate Type of Lease State <input checked="" type="checkbox"/> Fee <input type="checkbox"/>
5. State Oil & Gas Lease No. K-3138
7. Unit Agreement Name
8. Farm or Lease Name BAUM "P"
9. Well No. 1
10. Field and Pool, or Wildcat BAUM, UPPER PENN
12. County LEA

SUNDY NOTICES AND REPORTS ON WELLS

(DO NOT USE THIS FORM FOR PROPOSALS TO DRILL OR TO DEEPEN OR PLUG BACK TO A DIFFERENT RESERVOIR.
USE APPLICATION FOR PERMIT - (FORM C-101) FOR SUCH PROPOSALS.)

1. OIL WELL <input checked="" type="checkbox"/> GAS WELL <input type="checkbox"/> OTHER <input type="checkbox"/>
2. Name of Operator MWJ PRODUCING COMPANY
3. Address of Operator 413 FIRST NATIONAL BANK BUILDING, MIDLAND, TX 79701
4. Location of Well UNIT LETTER <u>L</u> <u>2310</u> FEET FROM THE <u>SOUTH</u> LINE AND <u>990</u> FEET FROM THE <u>WEST</u> LINE, SECTION <u>5</u> TOWNSHIP <u>14</u> SOUTH RANGE <u>33</u> EAST
11. Elevation (Show whether DF, RT, GR, etc.) 4277 KB

Check Appropriate Box To Indicate Nature of Notice, Report or Other Data
NOTICE OF INTENTION TO: SUBSEQUENT REPORT OF:

PERFORM REMEDIAL WORK <input type="checkbox"/>	PLUG AND ABANDON <input type="checkbox"/>	REMEDIAL WORK <input type="checkbox"/>	ALTERING CASING <input type="checkbox"/>
TEMPORARILY ABANDON <input type="checkbox"/>	CHARGE PLANS <input type="checkbox"/>	COMMENCE DRILLING OPER. <input checked="" type="checkbox"/>	PLUG AND ABANDONMENT <input type="checkbox"/>
PULL OR ALTER CASING <input type="checkbox"/>	OTHER <input type="checkbox"/>	CASING TEST AND CEMENT JOB <input checked="" type="checkbox"/>	OTHER <input type="checkbox"/>

17. Describe Proposed or Completed Operations (Clearly state all pertinent details and give pertinent dates, including estimated date of starting any proposed work) SEE RULE 1708.

Spudded 17 1/2" hole @ 6:00 a.m. 11-2-70. Drilled to 365'. Set 13 3/8", 48 lb., H-40, ST&C casing @ 362' and cemented w/400 sx regular neat, 2% CaCl. Cement circulated. Plug down 5:30 a.m. 11-3-70. WOC 18 hrs. Tested casing to 1000 psi for 30 minutes. Test OK.

Location Exception: Case No. 4432
Order No. R-4038
Dated October 6, 1970

18. I hereby certify that the information above is true and complete to the best of my knowledge and belief.

SIGNED Ed. Alfaro TITLE ENGINEER DATE NOVEMBER 3, 1970
APPROVED BY J. D. [Signature] TITLE SUPERVISOR DISTRICT DATE NOV - 6 1970
CONDITIONS OF APPROVAL, IF ANY:

NO. OF COPIES RECEIVED	
DISTRIBUTION	
SANTA FE	
FILE	
U.S.G.S.	
LAND OFFICE	
OPERATOR	

NEW MEXICO OIL CONSERVATION COMMISSION

Form C-101
Revised 1-4-65

70 Nov 9 AM 5 33

5A. Indicate Type of Lease	STATE <input checked="" type="checkbox"/> PER <input type="checkbox"/>
5. State Oil & Gas Lease No.	K-3138

APPLICATION FOR PERMIT TO DRILL, DEEPEN, OR PLUG BACK

1a. Type of Work	DRILL <input type="checkbox"/> DEEPEN <input type="checkbox"/> PLUG BACK <input type="checkbox"/>	7. Unit Agreement Name	
b. Type of Well	OIL WELL <input checked="" type="checkbox"/> GAS WELL <input type="checkbox"/> OTHER <input type="checkbox"/>	8. Farm or Lease Name	BAUM "F"
2. Name of Operator	MWJ PRODUCING COMPANY	9. Well No.	1
3. Address of Operator	413 FIRST NATIONAL BANK BUILDING	10. Field and Pool, or Wildcat	BAUM, UPPER PENN
4. Location of Well	UNIT LETTER L LOCATED 2310 FEET FROM THE SOUTH LINE AND 990 FEET FROM THE WEST LINE OF SEC. 5 TWP. 14 RSE. 33 NMPM	12. County	LEA
19. Proposed Depth	10,100	19A. Formation	UPPER PENN
20. Rotary or C.T.	ROTARY	21. Elevations (Show whether D.P., R.T., etc.)	4277 KB
21A. Kind & Status Plug. Bond	BLANKET	21B. Drilling Contractor	MORAN OIL PRODUCING & DRILLING CORPORATION
22. Approx. Date Work will start	November 10, 1970		

SIZE OF HOLE	SIZE OF CASING	WEIGHT PER FOOT	SETTING DEPTH	SACKS OF CEMENT	EST. TOP
17 1/4	13 3/8	48	340	400	Circ.
11	8 5/8	24 & 32	4000	300	2500
7 7/8	5 1/2	17	10100	200	9000

Location Exception: Case No. 4432
Order No. R-4038
Date: October 6, 1970

THE COMMISSION MUST BE NOTIFIED
24 HOURS PRIOR TO RUNNING CASING.

APPROVAL VOID
UNLESS
SIGNED AND
DATED
Feb. 1, 1971

IN ABOVE SPACE DESCRIBE PROPOSED PROGRAM: IF PROPOSAL IS TO DEEPEN OR PLUG BACK, GIVE DATA ON PRESENT PRODUCTIVE ZONE AND PROPOSED NEW PRODUCTIVE ZONE. GIVE BLOWOUT PREVENTER PROGRAM, IF ANY.

I hereby certify that the information above is true and complete to the best of my knowledge and belief.

Signed John W. Rungtner Title ENGINEER Date OCTOBER 28, 1970

(This space for State Use)

APPROVED BY John W. Rungtner TITLE Geologist DATE NOV - 5 1970

CONDITIONS OF APPROVAL, IF ANY:

**NEW MEXICO OIL CONSERVATION COMMISSION
WELL LOCATION AND ACREAGE DEDICATION PLAT**

Form C-293
Supersede C-128
Effective 1-1-69

All distances must be from the outer boundaries of the Section.

Operator M W J PRODUCING CO.				Lease BAUM "F"		Well No. 5 1
Unit Letter L	Section 5	Township 14 SOUTH	Range 33 EAST	County LEA		
Actual Footings Location of Well: 2310 feet from the SOUTH line and 990 feet from the WEST line						
Ground Level Elev. 3256.3	Producing Formation UPPER PENN		Pool BAUM, UPPER PENN		Dedicated Acreage 160 Acres	

1. Outline the acreage dedicated to the subject well by colored pencil or hatchure marks on the plat below.
2. If more than one lease is dedicated to the well, outline each and identify the ownership thereof (both as to working interest and royalty).
3. If more than one lease of different ownership is dedicated to the well, have the interests of all owners been consolidated by communitization, unitization, force-pooling, etc?

☐ Yes ☐ No If answer is "yes," type of consolidation _____

If answer is "no," list the owners and tract descriptions which have actually been consolidated. (Use reverse side of this form if necessary.) _____

No allowable will be assigned to the well until all interests have been consolidated (by communitization, unitization, forced-pooling, or otherwise) or until a non-standard unit, eliminating such interests, has been approved by the Commission.

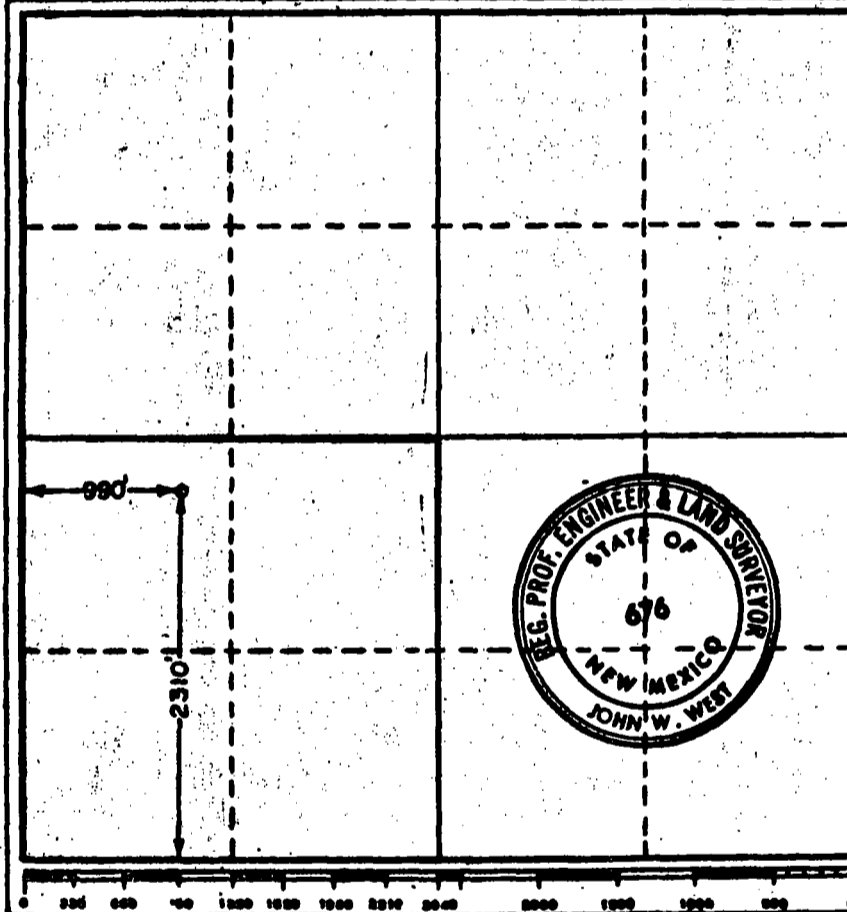

CERTIFICATION

I hereby certify that the information contained herein is true and complete to the best of my knowledge and belief.

Bob Alexander
Name

BOB ALEXANDER

Position
ENGINEER

Company
MWJ PRODUCING COMPANY

Date
OCTOBER 28, 1970

I hereby certify that the well location shown on this plat was plotted from field notes of actual surveys made by me or under my supervision, and that the same is true and correct to the best of my knowledge and belief.

Date Surveyed
OCTOBER 24, 1970

Registered Professional Engineer and/or Land Surveyor

John W. West
Signature

State No. **676**

COUNTY LEA FIELD BAUM STATEMENT 30-025-23619

OPR MWI PRODUCING CO. MAP

1 BAUM "F"

Sec 5, T-14-S, R-33-E CO-ORD

2310' FSL, 990' FHL of Sec

Spd 11-2-70

Comp 12-1-70

CLASS EL

FORMATION DATUM FORMATION DATUM

CGO & EX. TUBING

13 3/8" at 362' w/400 ex

8 5/8" at 4074' w/300 ex

5 1/2" at 10,060' w/200 ex.

LOGS EL. OF RA. INR HC. A

TD 10,060'; PBD 10,021'

IP (Upper Pennsylvanian) Perfs 9902-42' F 336 BOPD + 144 BW.

Pot based on 24 hr test thru 12/64" chk. GOR 893; Grav 42.1;

CP Pkr; TP 50-100#.

Distribution limited and publication prohibited by subscribers' agreement.
Reproduction rights reserved by Williams & Lee Drilling Service, Inc.

CONT. Moran PROP DEPTH 10,100' TYPE RT

DATE

F.R. 11-10-70; Opr's Elev. 4277' RKB
PD 10,100' RT (Upper Pennsylvanian)
Contractor - Moran
11-10-70 Drlg. 4530' 1m
11-16-70 Drlg. 7520'
11-23-70 Drlg. 9855' 1m
11-30-70 TD 10,060'; PBD 10,021'; SI Storage
Perf @ 9909', 9912', 9913', 9914', 9917',
9918', 9919', 9930', 9931', 9932', 9936',
9937', 9938', 9939', 9940', 9941', 9942'
Acid (9909-42') 2000 gals
12-7-70 TD 10,060'; PBD 10,021'; COMPLETE
LOG TOPS: Anhydrite 1690', Yates 2570',
San Andres 4034', Tubb 6887', Abo 7575',
Bough "C" 9906'
12-10-70 COMPLETION REPORTED

Proposed Side track

03-15-89

MWJ Producing Company
Baum F State #1
990' FWL + 2310' FSL
5-145-33E
Lea County, New Mexico

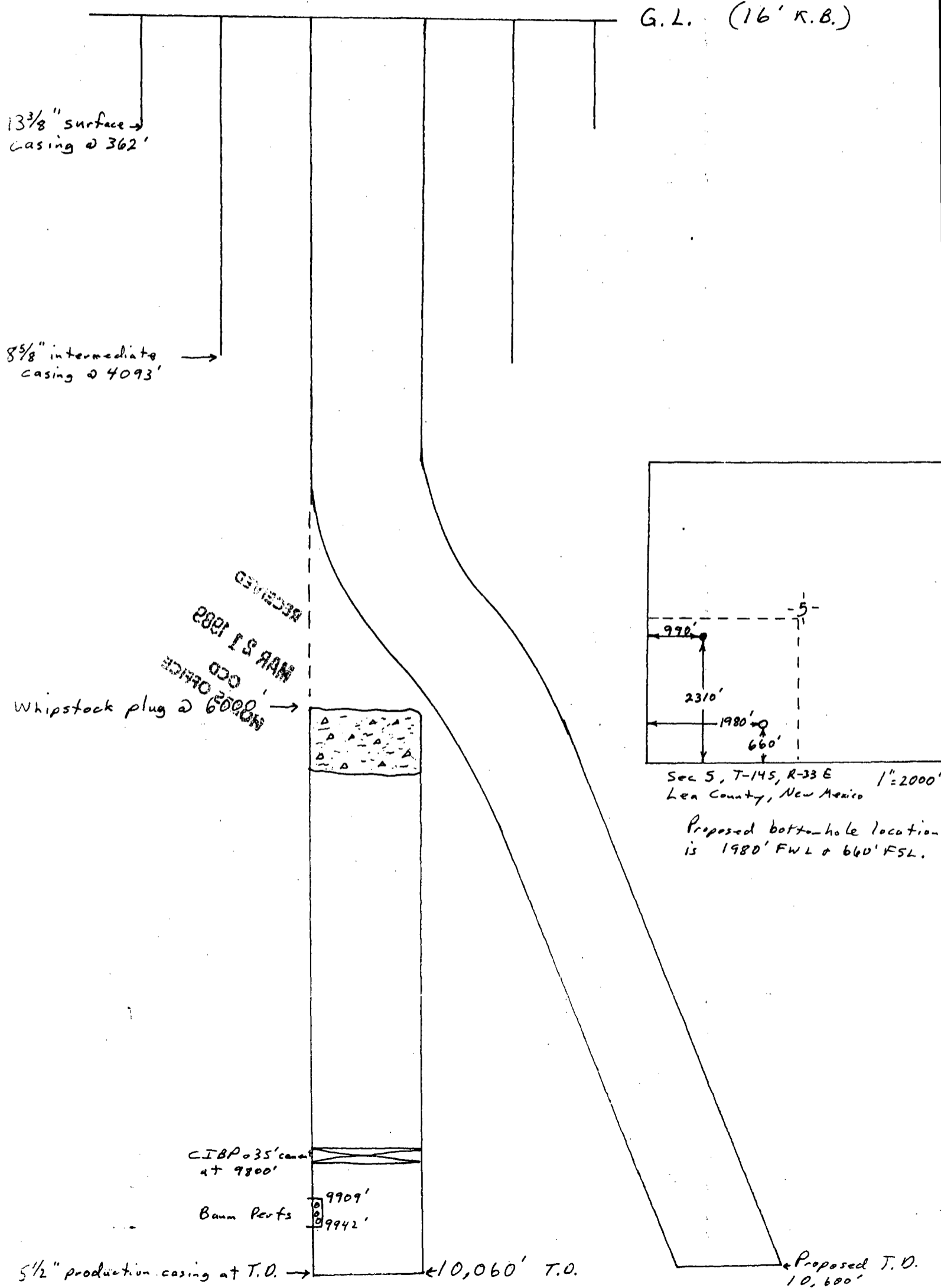

RECEIVED
MAR 21 1989
OCD
HOBBS OFFICE

MWJ PRODUCING COMPANY

★ PETROLEUM PRODUCERS ★

400 WEST ILLINOIS SUITE 1100
MIDLAND, TEXAS 79701
TELEPHONE (915) 682-5216

March 15, 1989

Union Pacific Resources Company
P. O. Box 7 MS3306
Fort Worth, Texas 76101-0007

RE: MWJ-Baum "F" State #1
990' FWL & 2310' FSL
Sec 5, T-14S, R-33E
Lea County, New Mexico
Baum Upper Penn Field

Gentlemen:

MWJ proposes the sidetrack drilling of the above captioned well to a new bottom hole location of 1980' FWL and 660' FSL, Sec 5, T-14S, R-33E, Lea County, New Mexico.

If you have no objection to our proposal, please execute in the space provided below and return three copies of this letter to our office. We appreciate your prompt attention.

Very truly yours,

MWJ PRODUCING COMPANY

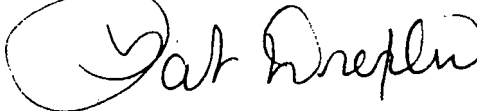

Pat Drexler

pd

UNION PACIFIC RESOURCES COMPANY has no objection to the sidetrack drilling of the proposed well.

By _____

Title _____

Date _____

RECEIVED
MAR 21 1989
HOBBS OFFICE
OCD

MWJ PRODUCING COMPANY

★ PETROLEUM PRODUCERS ★

400 WEST ILLINOIS SUITE 1100
MIDLAND, TEXAS 79701
TELEPHONE (915) 682-5216

March 15, 1989

Coastal Oil & Gas Corporation
P. O. Box 235
Midland, Texas 79702

RE: MWJ-Baum "F" State #1
990' FWL & 2310' FSL
Sec 5, T-14S, R-33E
Lea County, New Mexico
Baum Upper Penn Field

Gentlemen:

MWJ proposes the sidetrack drilling of the above captioned well to a new bottom hole location of 1980' FWL and 660' FSL, Sec 5, T-14S, R-33E, Lea County, New Mexico.

If you have no objection to our proposal, please execute in the space provided below and return three copies of this letter to our office. We appreciate your prompt attention.

Very truly yours,

MWJ PRODUCING COMPANY

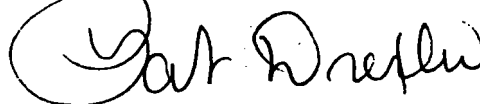

Pat Drexler

pd

COASTAL OIL & GAS CORPORATION has no objection to the sidetrack drilling of the proposed well.

By _____

Title _____

Date _____

HOSTS OFFICE
CCO
MAR 2 1989
RECEIVED

MWJ PRODUCING COMPANY

BAUM "F" State #1

OFFSET OPERATORS

Union Pacific Resources Company
P. O. Box 7 MS3306
Fort Worth, Texas 76101-0007

Coastal Oil & Gas Corporation
P. O. Box 235
Midland, Texas 79702

09/07/00
0001 P & HAM
000
20110 2000M

RECEIVED
MAR 21 1989
HQBBSO OFFICE
OCD

FACSIMILE TRANSMITTAL

MESSAGE TO Mike Stogner
COMPANY Oil Conservation Div
NUMBER OF PAGES INCLUDING COVER SHEET 3
MESSAGE FROM Pat H. Reilly
MWJ PRODUCING COMPANY
DATE 3/23/89 TIME 12:05
COMMENT _____

SHARP FO-500
FACSIMILE
(915) 682-5275

Any Problems Receiving
Message, please call (915) 682-5216

03-11-89

11:17

171355425-0

002

MAR 13 1989 17:04 MWJ PRODUCING CO

P. 02

MWJ PRODUCING COMPANY

* PETROLEUM PRODUCERS *

400 WEST ILLINOIS SUITE 1100
MIDLAND, TEXAS 79701
TELEPHONE (817) 681-6610

March 15, 1989

Union Pacific Resources Company
P. O. Box 7 M33306
Fort Worth, Texas 76101-0007RE: MWJ-Baum "F" Stato #1
990' FWL & 2310' FSL
Sec 5, T-14S, R-33E
Lea County, New Mexico
Bates Upper Penn Field

Gentlemen:

MWJ proposes the sidetrack drilling of the above captioned well to a new bottom hole location of 1980' FWL and 660' FSL, Sec 5, T-14S, R-33E, Lea County, New Mexico.

If you have no objection to our proposal, please execute in the space provided below and return three copies of this letter to our office. We appreciate your prompt attention.

Very truly yours,

MWJ PRODUCING COMPANY

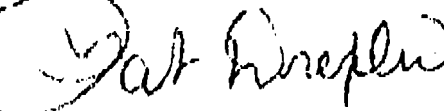

Pat Drexler

pd

UNION PACIFIC RESOURCES COMPANY has no objection to the sidetrack drilling of the proposed well.

BY

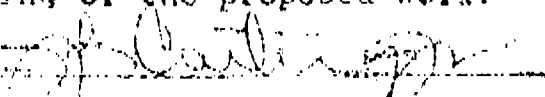

Title Regulatory Authority

Date March 15, 1989

MWJ PRODUCING COMPANY

★ PETROLEUM PRODUCERS ★

400 WEST ILLINOIS SUITE 1100
MIDLAND, TEXAS 79701
TELEPHONE (817) 883-8318

March 15, 1989

Coastal Oil & Gas Corporation

~~P. O. Box 235~~~~Midland, Texas 79702~~

211 N. Robinson, Ste 1700

OKla. City, OKla. 73102

RE: MWJ-Baum "F" State #1
990' FWL & 2310' FSL
Sec 5, T-14S, R-33E
Lea County, New Mexico
Baum Upper Penn Field

Gentlemen:

MWJ proposes the sidetrack drilling of the above captioned well to a new bottom hole location of 1980' FWL and 660' FSL, Sec 5, T-14S, R-33E, Lea County, New Mexico.

If you have no objection to our proposal, please execute in the space provided below and return three copies of this letter to our office. We appreciate your prompt attention.

Very truly yours,

MWJ PRODUCING COMPANY

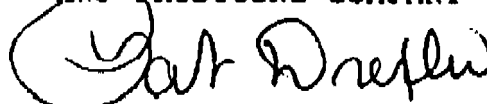

Pat Drexler

pd

COASTAL OIL & GAS CORPORATION has no objection to the sidetrack drilling of the proposed well.

By Title District Exploration Mgr.Date 21 March '89

MWJ PRODUCING COMPANY

★ PETROLEUM PRODUCERS ★

400 WEST ILLINOIS SUITE 1100
MIDLAND, TEXAS 79701

TELEPHONE (915) 682-5216

March 15, 1989

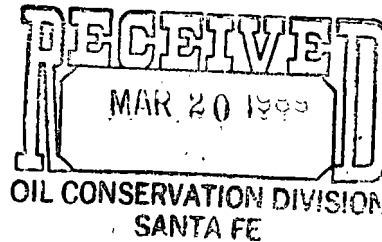

John Shazel

Oil Conservation Commission
P. O. Box 1980
Hobbs, New Mexico 88240

Attn: Jerry Sexton

RE: MWJ-Baum "F" State #1 (F-3138)
990' FWL & 2310' FSL
Sec 5, T-14S, R-33E
Lea County, New Mexico
Baum (Upper Penn) Field

Gentlemen:

Enclosed please find Form C-101, C-102, map, schematic and waiver letters that have been sent to offset operators. We plan to side-track drill the well to a new bottom hole location of 1980' FWL and 660' FSL, Sec 5, T-14S, R-33E, Lea County, New Mexico. The proposed total depth is 10,600'.

Upon receiving approval from the offset operators, we would like to ask that the Commission approve the drilling of this well.

Very truly yours,

MWJ PRODUCING COMPANY

Pat Drexler
Pat Drexler

pd
Enclosures

cc: Oil Conservation Commission
Santa Fe, New Mexico

RECEIVED

MAR 21 1989

OCD
HOBBS OFFICE

NO. OF COPIES RECEIVED	
DISTRIBUTION	
SANTA FE	
FILE	
U.S.G.S.	
LAND OFFICE	
OPERATOR	

NEW MEXICO OIL CONSERVATION COMMISSION

Form C-101
Revised 1-1-85

5A. Indicate Type of Lease	
STATE <input checked="" type="checkbox"/>	FEE <input type="checkbox"/>
5. State Oil & Gas Lease No.	
K-3138	

APPLICATION FOR PERMIT TO DRILL, DEEPEN, OR PLUG BACK

1a. Type of Work		X Directional Drill	
b. Type of Well		DEEPEN <input type="checkbox"/> PLUG BACK <input checked="" type="checkbox"/>	
OIL WELL <input checked="" type="checkbox"/> GAS WELL <input type="checkbox"/> OTHER <input type="checkbox"/>		SINGLE ZONE <input type="checkbox"/> MULTIPLE ZONE <input type="checkbox"/>	
2. Name of Operator			
MWJ PRODUCING COMPANY			
3. Address of Operator			
400 W. Illinois - Suite 1100 Midland, Texas 79701			
4. Location of Well			
UNIT LETTER L LOCATED 990 FEET FROM THE west LINE			
AND 2310 FEET FROM THE South LINE OF SEC. 5 TWP. 14S RGE. 33E NMPM			
7. Unit Agreement Name			
8. Farm or Lease Name			
Baum "F" State			
9. Well No.			
1			
10. Field and Pool, or Wildcat			
Baum Upper Penn			
12. County			
Lea			
19. Proposed Depth		19A. Formation	
10,600'		Penn	
20. Rotary or C.T.		Rotary	
21. Elevations (Show whether DF, RT, etc.)		21A. Kind & Status Plug. Bond	
4266' GL		Blanket/current	
21B. Drilling Contractor		22. Approx. Date Work will start	
Unknown		4/1/89	

23.

PROPOSED CASING AND CEMENT PROGRAM

SIZE OF HOLE	SIZE OF CASING	WEIGHT PER FOOT	SETTING DEPTH	SACKS OF CEMENT	EST. TOP
* 17-1/4"	13-3/8"	48#	340'	400	surface
* 11"	8-5/8"	24# & 32#	4000'	300	2500'
7-7/8"	5-1/2"	17#	10600'	450	9500'

The Baum "F" State #1 has become noncommercial with respect to production from the Baum Upper Penn at this location.

PROPOSED PROCEDURE:

1. Set CIBP @ 9800' with 35' cement on top. (Perforations 9909-9942')
2. Cut off and pull approximately 5000' of 5-1/2" casing.
3. Set a cement plug at the 5-1/2" cutoff sufficient to serve as the Whipstock plug.
4. Whipstock the Baum "F" State #1 and drill new production hole to a point located 1980' FWL, 660' FSL Sec 5, T-14S, R-33E, Lea County, NM.
5. Run, set and cement 5-1/2" casing at TD.
6. Smith International will do Directional Surveys.

*Original casing set in Baum "F" State #1

IN ABOVE SPACE DESCRIBE PROPOSED PROGRAM; IF PROPOSAL IS TO DEEPEN OR PLUG BACK, GIVE DATA ON PRESENT PRODUCTIVE ZONE AND PROPOSED NEW PRODUCTIVE ZONE. GIVE BLOWOUT PREVENTER PROGRAM, IF ANY.

I hereby certify that the information above is true and complete to the best of my knowledge and belief.

Signed Pat Drexler Title Pat Drexler-Agent Date 3/15/89

(This space for State Use)

APPROVED BY _____ TITLE _____ DATE _____

CONDITIONS OF APPROVAL, IF ANY:

RECEIVED

MAR 21 1989

OCD
HOBBS OFFICE

NEW MEXICO OIL CONSERVATION COMMISSION
WELL LOCATION AND ACREAGE DEDICATION PLAT

Form C-102
Supersedes C-128
Effective 1-1-65

All distances must be from the outer boundaries of the Section.

Operator MWJ PRODUCING COMPANY			Lease BAUM "F" STATE		Well No. 1
Unit Letter L	Section 5	Township 14 South	Range 33 East	County Lea	
Actual Footage Location of Well: 1980 feet from the West line and 660 feet from the South line					
Ground Level Elev. 4266.3'	Producing Formation Upper Penn		Pool Baum Upper Penn		Dedicated Acreage: 160 Acres

1. Outline the acreage dedicated to the subject well by colored pencil or hatchure marks on the plat below.
2. If more than one lease is dedicated to the well, outline each and identify the ownership thereof (both as to working interest and royalty).
3. If more than one lease of different ownership is dedicated to the well, have the interests of all owners been consolidated by communitization, unitization, force-pooling, etc?

☐ Yes ☐ No If answer is "yes," type of consolidation _____

If answer is "no," list the owners and tract descriptions which have actually been consolidated. (Use reverse side of this form if necessary.) _____

No allowable will be assigned to the well until all interests have been consolidated (by communitization, unitization, forced-pooling, or otherwise) or until a non-standard unit, eliminating such interests, has been approved by the Commission.

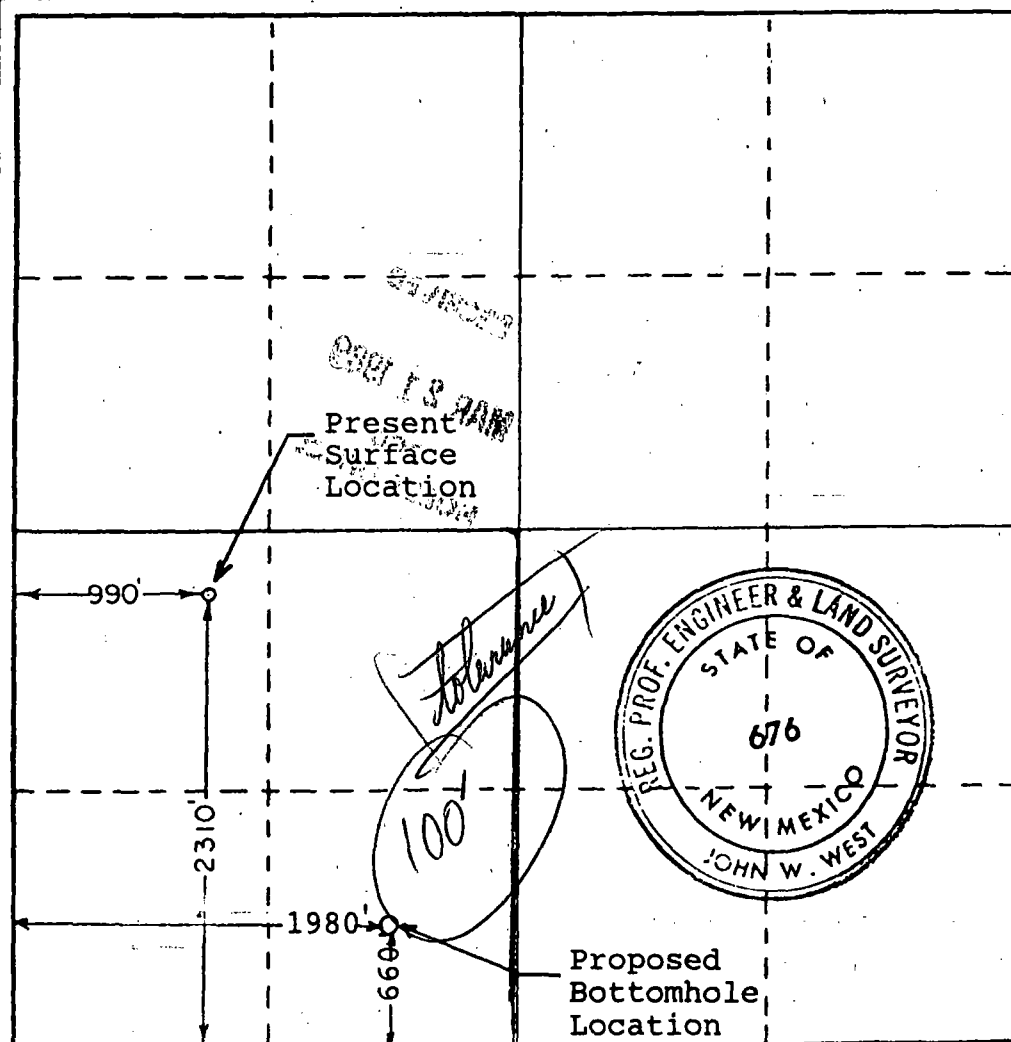

CERTIFICATION

I hereby certify that the information contained herein is true and complete to the best of my knowledge and belief.

Name
Pat Drexler

Position
Agent

Company
MWJ PRODUCING COMPANY

Date
3/15/89

I hereby certify that the well location shown on this plat was plotted from field notes of actual surveys made by me or under my supervision, and that the same is true and correct to the best of my knowledge and belief.

Date Surveyed
OCTOBER 24, 1970

Registered Professional Engineer and/or Land Surveyor

John W. West
Certificate No. **676**

HOBBBS OFFICE
OCD
MAR 2 1 1989
RECEIVED

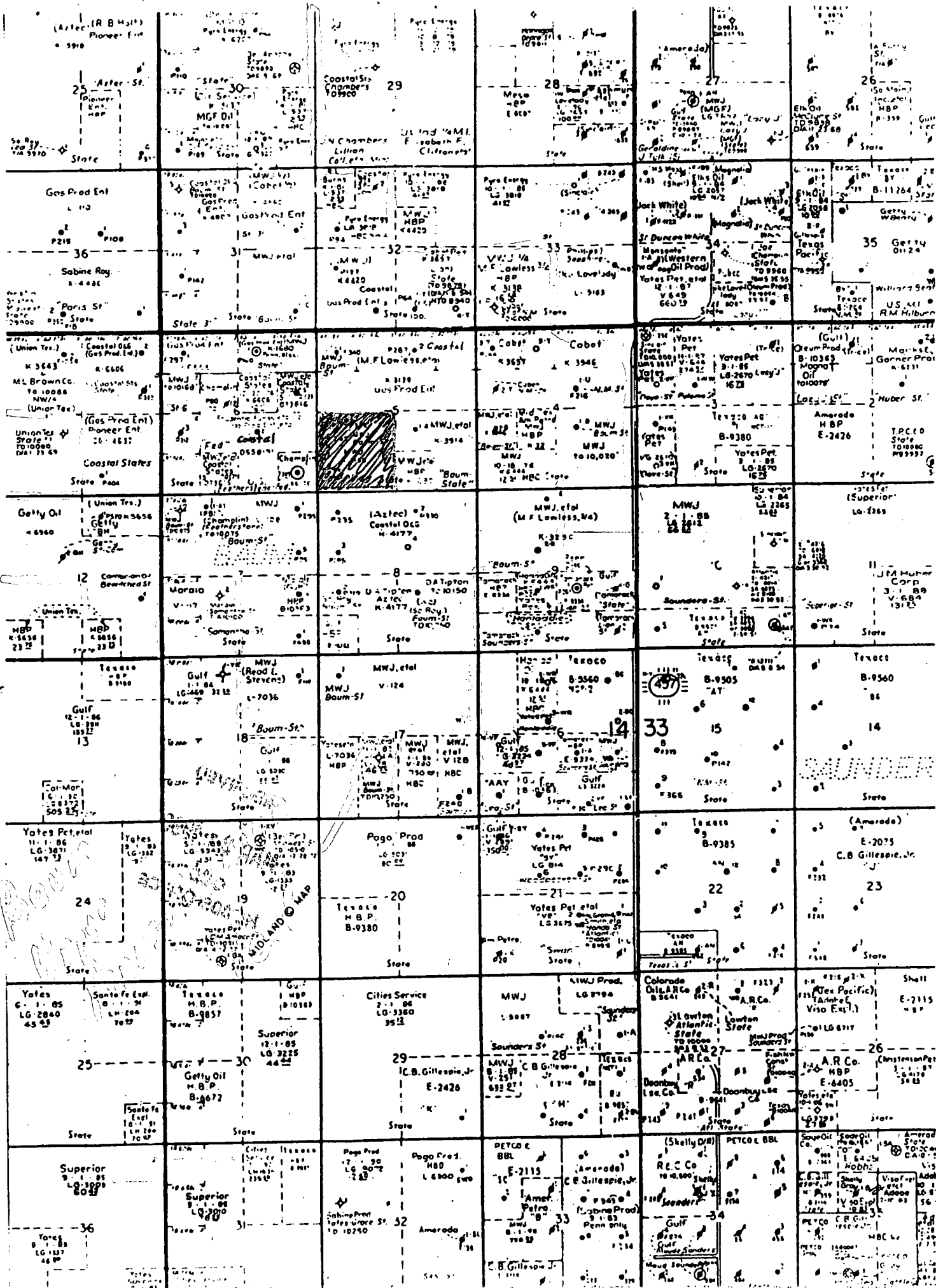

RECEIVED
MAR 21 1981
HOBBS OFFICE
OCCD