

INFILL DRILLING FINDINGS AND WELL-SPACING WAIVER  
MADE PURSUANT TO SECTION 271.305(b) OF THE  
FEDERAL ENERGY REGULATORY COMMISSION REGULATIONS,  
NATURAL GAS POLICY ACT OF 1978 AND OIL CONSERVATION DIVISION  
ORDER NO. R-6013

I.

Operator Millard Deck Oil Co. Well Name and No. Shell State Well No. 3  
Location: Unit B Sec. 36 Twp. 24S Rng. 36E Cty. Lea

II.

THE DIVISION FINDS:

- (1) That Section 271.305(b) of the Federal Energy Regulatory Commission Interim Regulations promulgated pursuant to the Natural Gas Policy Act of 1978 provides that, in order for an infill well to qualify as a new onshore production well under Section 103 of said Act, the Division must find, prior to the commencement of drilling, that the well is necessary to effectively and efficiently drain a portion of the reservoir covered by the proration unit which cannot be so drained by any existing well within that unit, ~~and must grant a waiver of existing well-spacing requirements.~~
- (2) That by Order No. R-6013, dated June 7, 1979, the Division established an administrative procedure whereby the Division Director and the Division Examiners are empowered to act for the Division and find that an infill well is necessary.
- (3) That the well for which a finding is sought is to be completed in the Jalmat Gas Pool, and the standard spacing unit in said pool is 640 acres.
- (4) That a 160-acre proration unit comprising the NW/4 NE/4, E/2 NW/4 & NE/4 SW/4 of Sec. 36, Twp. 24S, Rng. 36E, is currently dedicated to the Shell State Well No. 2 located in Unit F of said section.
- (5) That this proration unit is ( ) standard (X) nonstandard; if nonstandard, said unit was previously approved by Order No. NSP-808.
- (6) That said proration unit is not being effectively and efficiently drained by the existing well(s) on the unit.
- (7) That the drilling and completion of the well for which a finding is sought should result in the production of an additional 406,000 MCF of gas from the proration unit which would not otherwise be recovered.
- (8) That all the requirements of Order No. R-6013 have been complied with, and that the well for which a finding is sought is necessary to effectively and efficiently drain a portion of the reservoir covered by said proration unit which cannot be so drained by any existing well within the unit.
- (9) That in order to permit effective and efficient drainage of said proration unit, the subject application should be approved ~~as an exception to the standard well-spacing requirements for the pool.~~

IT IS THEREFORE ORDERED:

- (1) That the applicant is hereby authorized to drill the well described in Section I above as an infill well on the existing proration unit described in Section II(4) above. The authorization for infill drilling granted by this order ~~is an exception to applicable well-spacing requirements~~ and is necessary to permit the drainage of a portion of the reservoir covered by said proration unit which cannot be effectively and efficiently drained by any existing well thereon.
- (2) That jurisdiction of this cause is retained for the entry of such further orders as the Division may deem necessary.

DONE at Santa Fe, New Mexico, on this 9th day of November, 19 79.

  
DIVISION DIRECTOR X EXAMINER —

INFILL DRILLING FINDINGS AND WELL-SPACING WAIVER  
MADE PURSUANT TO SECTION 271.305(b) OF THE  
FEDERAL ENERGY REGULATORY COMMISSION REGULATIONS,  
NATURAL GAS POLICY ACT OF 1978 AND OIL CONSERVATION DIVISION  
ORDER NO. R-6013

I.

Operator Millard Deck Oil Co Well Name and No. Shell State Well No 3  
Location: Unit B Sec. 36 Twp. 24S Rng. 36E Cty. Lea

II.

THE DIVISION FINDS:

(1) That Section 271.305(b) of the Federal Energy Regulatory Commission Interim Regulations promulgated pursuant to the Natural Gas Policy Act of 1978 provides that, in order for an infill well to qualify as a new onshore production well under Section 103 of said Act, the Division must find, prior to the commencement of drilling, that the well is necessary to effectively and efficiently drain a portion of the reservoir covered by the proration unit which cannot be so drained by any existing well within that unit, ~~and must grant a waiver of existing well-spacing requirements.~~

(2) That by Order No. R-6013, dated June 7, 1979, the Division established an administrative procedure whereby the Division Director and the Division Examiners are empowered to act for the Division and find that an infill well is necessary.

(3) That the well for which a finding is sought is to be completed in the Talman Gas Pool, and the standard spacing unit in said pool is 640 acres.

(4) That a 160-acre proration unit comprising the NW1/4 NE1/4, E1/2 NW1/4 & NE1/4 SW1/4 of Sec. 36, Twp. 24, Rng. 36, is currently dedicated to the Shell State Well No 2 located in Unit F of said section.

(5) That this proration unit is ( ) standard (X) nonstandard; if nonstandard, said unit was previously approved by Order No. NSP808.

(6) That said proration unit is not being effectively and efficiently drained by the existing well(s) on the unit.

(7) That the drilling and completion of the well for which a finding is sought should result in the production of an additional 406,000 MCF of gas from the proration unit which would not otherwise be recovered.

(8) That all the requirements of Order No. R-6013 have been complied with, and that the well for which a finding is sought is necessary to effectively and efficiently drain a portion of the reservoir covered by said proration unit which cannot be so drained by any existing well within the unit.

(9) That in order to permit effective and efficient drainage of said proration unit, the subject application should be approved, ~~as an exception to the standard well-spacing requirements for the pool.~~

IT IS THEREFORE ORDERED:

(1) That the applicant is hereby authorized to drill the well described in Section I above as an infill well on the existing proration unit described in Section II(4) above. The authorization for infill drilling granted by this order ~~is an exception to applicable well-spacing requirements~~ and is necessary to permit the drainage of a portion of the reservoir covered by said proration unit which cannot be effectively and efficiently drained by any existing well thereon.

(2) That jurisdiction of this cause is retained for the entry of such further orders as the Division may deem necessary.

DONE at Santa Fe, New Mexico, on this \_\_\_\_\_ day of \_\_\_\_\_, 19\_\_\_\_.

DIVISION DIRECTOR \_\_\_\_\_ EXAMINER \_\_\_\_\_

## MILLARD DECK OIL COMPANY

P. O. Box 1047

Phone (505) 394-2249

EUNICE, NEW MEXICO 88231

October 16, 1979

New Mexico Department of Energy & Minerals  
Oil Conservation Division  
P. O. Box 2088  
Santa Fe, New Mexico 87501

Re: Supplement to Application  
for Administrative Approval  
for NGPA Infill Finding  
According to 271.304 and  
271.305 for Shell State  
No. 3 - Jalmat Tansill Yates  
Seven Rivers Gas Pool -  
660' FNL & 2310" FEL, Sec. 36,  
T24S, R36E, Lea County,  
New Mexico.

Gentlemen:

Several questions were raised concerning the original application, dated October 16, 1979, for the Shell State No. 3 application. One question concerned measures taken to control water. A second question concerned how the bottom hole pressure was determined. The third question concerned the calculation for the estimated recoverable gas reserves. A question was raised concerning the relative structural position of Nos. 2 and 3.

First, during the initial completion attempt, this well was perforated from 3299' to 3378'. After treating with 1000 gallons of acid, it swabbed 100% water. A bridge plug was set and a second attempt was made. It was perforated from 3048' to 3065' and treated with 200 gallons of acid. Again it produced 100% water. A bridge plug was again set. The casing was perforated from 2701' to 2771'. After treating with 1000 gallons of acid, the well swabbed dry. It was then fracture treated using 10,000 gallons of gelled brine. Following the fracture treatment the well potentialled for 1½BO and 105 BWPD with 1,150 MCF of gas. Over the next few weeks water production increased. Within 3 months it was producing too much water to economically continue production. It was decided from this performance that the initial cement job on the 4½" casing had resulted in channels so that all zones below 3000' were initially communicated. Following the fracture treatment we felt that a channel had been created downward into the Seven Rivers. Due to the extensive channelling, which we were convinced existed, it was our opinion that numerous squeeze jobs would be required to remedy the poor cement job and that the chances for success would be slim considering the long interval involved. The decision was made to make no further attempt to remedy or complete the well.

Page 2 October 16, 1979  
Millard Deck Oil Company  
to  
New Mexico Department of Energy & Minerals

The bottom hole pressure estimate of 450 psi was made based on three items of information. From the enclosed C-105 it will be noted that the well exhibited a casing pressure of 540 psi on a flowing potential test. In September, 1969 El Paso Natural Gas Company reported a 72 hr shut-in pressure of 448 psi. Currently, the well has 1200' of fluid in the hole as indicated by a fluid level shot. This calculates to be in excess of 450 psi.

Enclosed is a copy of a Gamma Ray-Neutron log from the Shell State No. 2. This log has been marked to show the zones of porosity in the Yates that can reasonably be expected to produce gas. There are 80' exhibiting a weighted average of 13% porosity. Using the following assumptions a recalculation of recoverable reserves was made: BHP-450 psi, BH temp. 90°, gas gravity of .7, 80 acre unit, 30% water saturation, 50% of reserves are recoverable. The pore volume containing recoverable gas is calculated to be  $(43560 \text{ ft}^2/\text{ac}) (80 \text{ ac}) (.13 \text{ porosity}) (.7 \text{ gas}) (.5 \text{ recoverable}) = 12,685,000 \text{ ft}^3$ . Then calculating the volume of gas at standard conditions of 14.7 psi and 60° F contained in one ft<sup>3</sup> at reservoir conditions of 450 psi and 90° and using a gas deviation factor of .9, it is found that 32 SCF/ft<sup>3</sup> is contained in the reservoir. Then  $(12,685,000) (32) = 408,920,000 \text{ SCF}$  or 405,920 MCF.

A question was also raised concerning the relative structural position of Shell State Nos. 2 and 3. According to the structure map presented, the No. 2 is higher structurally than No. 3, which generally would mean that No. 3 was more likely to be water productive. However in this case the wells along the east side of Section 36 have produced lower volumes of water than wells along the west boundary. Permeability may be a factor in this difference. It is our opinion that the poor quality cement job in the Seven Rivers and Yates sections of No. 2 is the single most important reason for the high water production from No. 2 instead of structural position.

Finally, current plans for No. 2 are to plug and abandon the well as soon as the approval is obtained and equipment is available.

Yours very truly,



Millard Deck

MD/sjb  
Enclosures

# MILLARD DECK OIL COMPANY

P. O. Box 1047 Phone (505) 394-2249

EUNICE, NEW MEXICO 88231

October 16, 1979

New Mexico Department of Energy & Minerals  
Oil Conservation Division  
P. O. Box 2088  
Santa Fe, New Mexico 87501

Re: Supplement to Application  
for Administrative Approval  
for NGPA Infill Finding  
According to 271.304 and  
271.305 for Shell State  
No. 3 - Jalmat Tansill Yates  
Seven Rivers Gas Pool -  
660' FNL & 2310" FEL, Sec. 36,  
T24S, R36E, Lea County,  
New Mexico.

Gentlemen:

Several questions were raised concerning the original application, dated October 16, 1979, for the Shell State No. 3 application. One question concerned measures taken to control water. A second question concerned how the bottom hole pressure was determined. The third question concerned the calculation for the estimated recoverable gas reserves. A question was raised concerning the relative structural position of Nos. 2 and 3.

First, during the initial completion attempt, this well was perforated from 3299' to 3378'. After treating with 1000 gallons of acid, it swabbed 100% water. A bridge plug was set and a second attempt was made. It was perforated from 3048' to 3065' and treated with 200 gallons of acid. Again it produced 100% water. A bridge plug was again set. The casing was perforated from 2701' to 2771'. After treating with 1000 gallons of acid, the well swabbed dry. It was then fracture treated using 10,000 gallons of gelled brine. Following the fracture treatment the well potentialled for 1½BO and 105 BWPD with 1,150 MCF of gas. Over the next few weeks water production increased. Within 3 months it was producing too much water to economically continue production. It was decided from this performance that the initial cement job on the 4½" casing had resulted in channels so that all zones below 3000' were initially communicated. Following the fracture treatment we felt that a channel had been created downward into the Seven Rivers. Due to the extensive channelling, which we were convinced existed, it was our opinion that numerous squeeze jobs would be required to remedy the poor cement job and that the chances for success would be slim considering the long interval involved. The decision was made to make no further attempt to remedy or complete the well.

100-20-100

## MILLARD DECK OIL COMPANY

P. O. Box 1047 Phone (505) 394-2249

EUNICE, NEW MEXICO 88231

October 16, 1979

New Mexico Department of Energy & Minerals  
Oil Conservation Division  
P. O. Box 2088  
Santa Fe, New Mexico 87501

Re: Supplement to Application  
for Administrative Approval  
for NGPA Infill Finding  
According to 271.304 and  
271.305 for Shell State  
No. 3 - Jalmat Tansill Yates  
Seven Rivers Gas Pool -  
660' FNL & 2310" FEL, Sec. 36,  
T24S, R36E, Lea County,  
New Mexico.

Gentlemen:

Several questions were raised concerning the original application, dated October 16, 1979, for the Shell State No. 3 application. One question concerned measures taken to control water. A second question concerned how the bottom hole pressure was determined. The third question concerned the calculation for the estimated recoverable gas reserves. A question was raised concerning the relative structural position of Nos. 2 and 3.

First, during the initial completion attempt, this well was perforated from 3299' to 3378'. After treating with 1000 gallons of acid, it swabbed 100% water. A bridge plug was set and a second attempt was made. It was perforated from 3048' to 3065' and treated with 200 gallons of acid. Again it produced 100% water. A bridge plug was again set. The casing was perforated from 2701' to 2771'. After treating with 1000 gallons of acid, the well swabbed dry. It was then fracture treated using 10,000 gallons of gelled brine. Following the fracture treatment the well potentialled for 1½BO and 105 BWPD with 1,150 MCF of gas. Over the next few weeks water production increased. Within 3 months it was producing too much water to economically continue production. It was decided from this performance that the initial cement job on the 4½" casing had resulted in channels so that all zones below 3000' were initially communicated. Following the fracture treatment we felt that a channel had been created downward into the Seven Rivers. Due to the extensive channelling, which we were convinced existed, it was our opinion that numerous squeeze jobs would be required to remedy the poor cement job and that the chances for success would be slim considering the long interval involved. The decision was made to make no further attempt to remedy or complete the well.

Page 2 October 16, 1979  
Millard Deck Oil Company  
to  
New Mexico Department of Energy & Minerals

The bottom hole pressure estimate of 450 psi was made based on three items of information. From the enclosed C-105 it will be noted that the well exhibited a casing pressure of 540 psi on a flowing potential test. In September, 1969 El Paso Natural Gas Company reported a 72 hr shut-in pressure of 448 psi. Currently, the well has 1200' of fluid in the hole as indicated by a fluid level shot. This calculates to be in excess of 450 psi.

Enclosed is a copy of a Gamma Ray-Neutron log from the Shell State No. 2. This log has been marked to show the zones of porosity in the Yates that can reasonably be expected to produce gas. There are 80' exhibiting a weighted average of 13% porosity. Using the following assumptions a recalculation of recoverable reserves was made: BHP-450 psi, BH temp. 90°, gas gravity of .7, 80 acre unit, 30% water saturation, 50% of reserves are recoverable. The pore volume containing recoverable gas is calculated to be  $(43560 \text{ ft}^2/\text{ac}) (80 \text{ ac}) (80 \text{ ft with porosity}) (.13 \text{ porosity}) (.7 \text{ gas}) (.5 \text{ recoverable}) = 12,685,000 \text{ ft}^3$ . Then calculating the volume of gas at standard conditions of 14.7 psi and 60° F contained in one  $\text{ft}^3$  at reservoir conditions of 450 psi and 90° and using a gas deviation factor of .9, it is found that 32 SCF/ $\text{ft}^3$  is contained in the reservoir. Then  $(12,685,000) (32) = 408,920,000 \text{ SCF}$  or 405,920 MCF.

A question was also raised concerning the relative structural position of Shell State Nos. 2 and 3. According to the structure map presented, the No. 2 is higher structurally than No. 3, which generally would mean that No. 3 was more likely to be water productive. However in this case the wells along the east side of Section 36 have produced lower volumes of water than wells along the west boundary. Permeability may be a factor in this difference. It is our opinion that the poor quality cement job in the Seven Rivers and Yates sections of No. 2 is the single most important reason for the high water production from No. 2 instead of structural position.

Finally, current plans for No. 2 are to plug and abandon the well as soon as the approval is obtained and equipment is available.

Yours very truly,

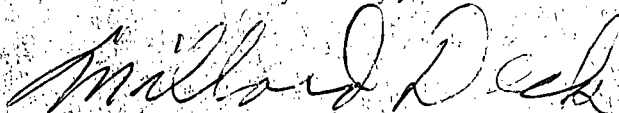

Millard Deck

MD/sjb  
Enclosures



1892

MILLARD DECK OIL COMPANY

P. O. Box 1047

Phone (505) 394-2249

EUNICE, NEW MEXICO 88231

October 16, 1979

Doyle Hartman  
508 C & K Petroleum Building  
Midland, Texas 79701

Re: Enclosed Applications For  
Administrative Approval For  
Natural Gas Policy Act  
Infill Finding For Shell  
State No. 3.

Gentlemen:

Enclosed you will find copies of our applications to the Oil  
Conservation Division for the finding required by NGPA 271.304  
and 271.305 in accordance with Division Order No. R-6013.

In order to expedite the approval by the OCD, you are requested  
to execute the Waiver of Objection below and to return one copy  
for use with the OCD.

Thank you for your cooperation in securing these approvals.

Yours very truly,



Millard Deck

WAIVER OF OBJECTION

Doyle Hartman hereby waives any objection to the drilling of the  
Millard Deck Shell State No. 3.

By

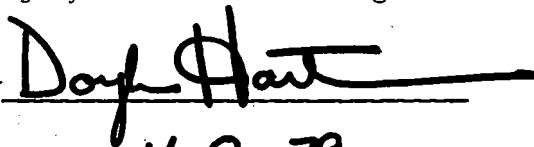

Date

11-8-79

MILLARD DECK OIL COMPANY

P. O. Box 1047

Phone (505) 394-2249

EUNICE, NEW MEXICO 88231

October 16, 1979

Doyle Hartman  
508 C & K Petroleum Building  
Midland, Texas 79701

Re: Enclosed Applications For  
Administrative Approval For  
Natural Gas Policy Act  
Infill Finding For Shell  
State No. 3.

Gentlemen:

Enclosed you will find copies of our applications to the Oil  
Conservation Division for the finding required by NGPA 271.304  
and 271.305 in accordance with Division Order No. R-6013.

In order to expedite the approval by the OCD, you are requested  
to execute the Waiver of Objection below and to return one copy  
for use with the OCD.

Thank you for your cooperation in securing these approvals.

Yours very truly

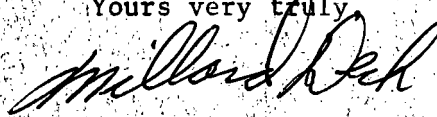

Millard Deck

WAIVER OF OBJECTION

Doyle Hartman hereby waives any objection to the drilling of the  
Millard Deck Shell State No. 3.

By

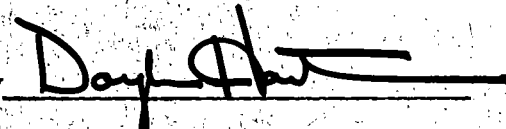

Date

11-8-79

MILLARD DECK OIL COMPANY

P. O. Box 1047 Phone (505) 394-2249

EUNICE, NEW MEXICO 88231

October 16, 1979

Doyle Hartman  
508 C & K Petroleum Building  
Midland, Texas 79701

Re: Enclosed Applications For  
Administrative Approval For  
Natural Gas Policy Act  
Infill Finding For Shell  
State No. 3.

Gentlemen:

Enclosed you will find copies of our applications to the Oil  
Conservation Division for the finding required by NGPA 271.304  
and 271.305 in accordance with Division Order No. R-6013.

In order to expedite the approval by the OCD, you are requested  
to execute the Waiver of Objection below and to return one copy  
for use with the OCD.

Thank you for your cooperation in securing these approvals.

Yours very truly,

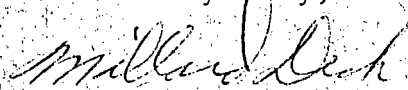

Millard Deck

WAIVER OF OBJECTION

Doyle Hartman hereby waives any objection to the drilling of the  
Millard Deck Shell State No. 3.

By

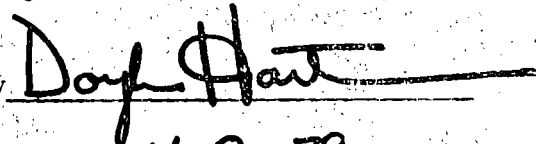

Date

11-8-79

NEW MEXICO OIL CONSERVATION COMMISSION  
GAS WELL SHUT-IN PRESSURE REPORT

Form C-125  
Revised 1-1-65

Operator MILLARD DECK	Address BOX 409 - EUNICE, NEW MEXICO	Post JALMAT	County LEA COUNTY, NEW MEXICO
--------------------------	---	----------------	----------------------------------

LEASE	WELL NO.	LOCATION				DATE PRESS. RUN	TIME S.I. HRS./MIN.	S.I. PRESSURE PSIG (DWT)	S.I. PRESSURE PSIA	PREV. TEST DATE
		UNIT	SEC.	TWP.	RGE.					
Shell State	2	F	26	24	36	9-17-69	72	435	448.2	New Well

EL PASO NATURAL GAS COMPANY

I hereby certify that the above information is true and complete to the best of my knowledge and belief. SEE RULE 402

Signature [Signature] Title JAL, NEW MEXICO 88252 Date JAN 27 1970

NEW MEXICO OIL CONSERVATION COMMISSION  
GAS WELL SHUT-IN PRESSURE REPORT

Form C-125  
Revised 1-1-65

Operator MILLARD DECK	Address BOX 409 - EUNICE, NEW MEXICO	Pool JALMAT	County LEA COUNTY, NEW MEXICO
--------------------------	---	----------------	----------------------------------

LEASE	WELL NO.	LOCATION				DATE PRESS. RUN	TIME S.I. HRS./MIN.	S.I. PRESSURE PSIG (DWT)	S.I. PRESSURE PSIA	PREV. TEST DATE
		UNIT	SEC.	TWP.	RGE.					
Shell State	2	F	26	24	36	9-17-69	72	435	448.2	New Well

EL PASO NATURAL GAS COMPANY

hereby certify that the above information is true and complete to the best of my knowledge and belief. SEE RULE 402

Signature [Signature] Title JAL, NEW MEXICO 88252 Date JAN 27 1970

NO. OF COPIES RECEIVED	
DISTRIBUTION	
SANTA FE	
FILE	
U.S.G.S.	
LAND OFFICE	
OPERATOR	

**NEW MEXICO OIL CONSERVATION COMMISSION  
WELL COMPLETION OR RECOMPLETION REPORT AND LOG**

Form C-105  
Revised 1-1-65

5a. Indicate Type of Lease	
State <input checked="" type="checkbox"/>	Fee <input type="checkbox"/>
5. State Oil & Gas Lease No.	
<b>B-1167-12</b>	

1a. TYPE OF WELL	
OIL WELL <input type="checkbox"/>	GAS WELL <input checked="" type="checkbox"/> DRY <input type="checkbox"/> OTHER <input type="checkbox"/>
b. TYPE OF COMPLETION	
NEW WELL <input checked="" type="checkbox"/> WORK OVER <input type="checkbox"/>	DEEPEN <input type="checkbox"/> PLUG BACK <input type="checkbox"/> DIFF. RESVH. <input type="checkbox"/> OTHER <input type="checkbox"/>

7. Unit Agreement Name
8. Farm or Lease Name
<b>Shell State</b>
9. Well No.
<b>2</b>
10. Field and Pool, or Wildcat
<b>Jalmat Yates 7R (Gas)</b>

2. Name of Operator
<b>Millard Deck</b>
3. Address of Operator
<b>P. O. Box 409, Eunice, New Mexico 88231</b>

4. Location of Well	
UNIT LETTER <b>F</b>	LOCATED <b>2310</b> FEET FROM THE <b>North</b> LINE AND <b>1980</b> FEET FROM
THE <b>West</b> LINE OF SEC. <b>36</b> TWP. <b>24S</b> RGE. <b>36E</b> ANMPM	

12. County
<b>Lea</b>

15. Date Spudded	16. Date T.D. Reached	17. Date Compl. (Ready to Prod.)	18. Elevations (DF, RKB, RT, GR, etc.)	19. Elev. Casinghead
<b>1/3/69</b>	<b>1/11/69</b>	<b>1/13/69</b>	<b>3267' GR</b>	<b>3267'</b>
20. Total Depth	21. Plug Back T.D.	22. If Multiple Compl., How Many	23. Intervals Drilled By	Rotary Tools
<b>3430'</b>	<b>3404'</b>		<b>X</b>	Cable Tools
24. Producing Interval(s), of this completion - Top, Bottom, Name				25. Was Directional Survey Made
<b>2701' - 2721' Jalmat (Gas)</b>				<b>No</b>
26. Type Electric and Other Logs Run				27. Was Well Cored
<b>Gamma Ray - Neutron, Sonic, Laterlog</b>				<b>No</b>

28. CASING RECORD (Report all strings set in well)					
CASING SIZE	WEIGHT LB./FT.	DEPTH SET	HOLE SIZE	CEMENTING RECORD	AMOUNT PULLED
<b>8-5/8"</b>	<b>24#</b>	<b>305'</b>	<b>12-1/4"</b>	<b>230 sacks-circulated</b>	<b>None</b>
<b>4-1/2"</b>	<b>10.50#</b>	<b>3430'</b>	<b>7-7/8"</b>	<b>355 sacks</b>	<b>None</b>

29. LINER RECORD					30. TUBING RECORD		
SIZE	TOP	BOTTOM	SACKS CEMENT	SCREEN	SIZE	DEPTH SET	PACKER SET
					<b>2-3/8"</b>	<b>2700'</b>	<b>None</b>

31. Perforation Record (Interval, size and number)	32. ACID, SHOT, FRACTURE, CEMENT SQUEEZE, ETC.						
<b>2701', 2707', 2709', 2721' with four 1/2" holes.</b>	<table border="1"> <tr> <th>DEPTH INTERVAL</th> <th>AMOUNT AND KIND MATERIAL USED</th> </tr> <tr> <td><b>3701' - 3721'</b></td> <td><b>10,000 gals. gelled brine with 10,000# 20-40 sand</b></td> </tr> <tr> <td><b>2701' - 2721'</b></td> <td></td> </tr> </table>	DEPTH INTERVAL	AMOUNT AND KIND MATERIAL USED	<b>3701' - 3721'</b>	<b>10,000 gals. gelled brine with 10,000# 20-40 sand</b>	<b>2701' - 2721'</b>	
DEPTH INTERVAL	AMOUNT AND KIND MATERIAL USED						
<b>3701' - 3721'</b>	<b>10,000 gals. gelled brine with 10,000# 20-40 sand</b>						
<b>2701' - 2721'</b>							

33. PRODUCTION							
Date First Production		Production Method (Flowing, gas lift, pumping - Size and type pump)				Well Status (Prod. or Shut-in)	
<b>1/13/69</b>		<b>Flow</b>				<b>Prod.</b>	
Date of Test	Hours Tested	Choke Size	Prod'n. For Test Period	Oil - Bbl.	Gas - MCF	Water - Bbl.	Gas - Oil Ratio
<b>1/17/69</b>	<b>24</b>	<b>48/64"</b>	<b>1.26</b>	<b>1,150</b>	<b>105</b>	<b>912,000</b>	
Flow Tubing Press.	Casing Pressure	Calculated 24-Hour Rate	Oil - Bbl.	Gas - MCF	Water - Bbl.	Oil Gravity - API (Corr.)	
<b>175#</b>	<b>540#</b>	<b>1.26</b>	<b>1,150</b>	<b>105</b>	<b>38.3</b>		

34. Disposition of Gas (Sold, used for fuel, vented, etc.)	Test Witnessed By
<b>Sold</b>	<b>Royce Crowell</b>

35. List of Attachments
<b>Gamma Ray - Neutron, Sonic, Laterlog inclination survey</b>

36. I hereby certify that the information shown on both sides of this form is true and complete to the best of my knowledge and belief.		
SIGNED <b>Millard Deck</b>	TITLE <b>Owner-Operator</b>	DATE <b>1/29/69</b>

# INSTRUCTIONS

This form is to be filed with the appropriate District Office of the Commission not later than 20 days after the completion of any newly-drilled or deepened well. It shall be accompanied by one copy of all electrical and radio-activity logs run on the well and a summary of all special tests conducted, including drill stem tests. All depths reported shall be measured depths. In the case of directionally drilled wells, true vertical depths shall also be reported. For multiple completions, Items 30 through 34 shall be reported for each zone. The form is to be filed in quintuplicate except on state land, where six copies are required. See Rule 1105.

## INDICATE FORMATION TOPS IN CONFORMANCE WITH GEOGRAPHICAL SECTION OF STATE

### Southeastern New Mexico

T. Anhy 1121'  
T. Salt 1313'  
B. Salt 2590'  
T. Yates 2760'  
T. 7 Rivers 2989'  
T. Queen 3374'  
T. Grayburg \_\_\_\_\_  
T. San Andres \_\_\_\_\_  
T. Glorieta \_\_\_\_\_  
T. Paddock \_\_\_\_\_  
T. Blinbry \_\_\_\_\_  
T. Tubb \_\_\_\_\_  
T. Drinkard \_\_\_\_\_  
T. Abo \_\_\_\_\_  
T. Wolfcamp \_\_\_\_\_  
T. Penn. \_\_\_\_\_  
T. Cisco (Bough C) \_\_\_\_\_

T. Canyon \_\_\_\_\_  
T. Strawn \_\_\_\_\_  
T. Atoka \_\_\_\_\_  
T. Miss \_\_\_\_\_  
T. Devonian \_\_\_\_\_  
T. Silurian \_\_\_\_\_  
T. Montoya \_\_\_\_\_  
T. Simpson \_\_\_\_\_  
T. McKee \_\_\_\_\_  
T. Ellenburger \_\_\_\_\_  
T. Gr. Wash \_\_\_\_\_  
T. Granite \_\_\_\_\_  
T. Delaware Sand \_\_\_\_\_  
T. Bone Springs \_\_\_\_\_  
T. \_\_\_\_\_  
T. \_\_\_\_\_

### Northwestern New Mexico

T. Ojo Alamo \_\_\_\_\_  
T. Kirtland-Fruitland \_\_\_\_\_  
T. Pictured Cliffs \_\_\_\_\_  
T. Cliff House \_\_\_\_\_  
T. Menefee \_\_\_\_\_  
T. Point Lookout \_\_\_\_\_  
T. Mancos \_\_\_\_\_  
T. Gallup \_\_\_\_\_  
Base Greenhorn \_\_\_\_\_  
T. Dakota \_\_\_\_\_  
T. Morrison \_\_\_\_\_  
T. Todilto \_\_\_\_\_  
T. Entrada \_\_\_\_\_  
T. Wingate \_\_\_\_\_  
T. Chinle \_\_\_\_\_  
T. Permian \_\_\_\_\_  
T. Penn. "A" \_\_\_\_\_  
T. Penn. "B" \_\_\_\_\_  
T. Penn. "C" \_\_\_\_\_  
T. Penn. "D" \_\_\_\_\_  
T. Leadville \_\_\_\_\_  
T. Madison \_\_\_\_\_  
T. Elbert \_\_\_\_\_  
T. McCracken \_\_\_\_\_  
T. Ignacio Qizte \_\_\_\_\_  
T. Granite \_\_\_\_\_  
T. \_\_\_\_\_  
T. \_\_\_\_\_  
T. \_\_\_\_\_  
T. \_\_\_\_\_  
T. \_\_\_\_\_  
T. \_\_\_\_\_  
T. \_\_\_\_\_

## FORMATION RECORD (Attach additional sheets if necessary)

From	To	Thickness in Feet	Formation	From	To	Thickness in Feet	Formation
0	35	35'	Surface & caliche				
35	345	310	Red beds & sand stringers				
310	601	291	Red beds & Anhydrite				
601	1121	520	Red beds, sand & Anhydrite				
1121	1288	167	Anhydrite				
1288	2599	1311	Salt & Anhydrite				
2599	2740	141	Anhydrite				
2740	2935	195	Anhydrite & lime				
2935	3430	495	Lime, sand & dolomite				



NO. OF COPIES RECEIVED	
DISTRIBUTION	
SANTA FE	
FILE	
U.S.G.S.	
LAND OFFICE	
OPERATOR	

**NEW MEXICO OIL CONSERVATION COMMISSION  
WELL COMPLETION OR RECOMPLETION REPORT AND LOG**

Form C-105  
Revised 1-1-65

5a. Indicate Type of Lease State <input checked="" type="checkbox"/> Fee <input type="checkbox"/>
5. State Oil & Gas Lease No. <b>B-1167-12</b>

1a. TYPE OF WELL OIL WELL <input type="checkbox"/> GAS WELL <input checked="" type="checkbox"/> DRY <input type="checkbox"/> OTHER <input type="checkbox"/>		7. Unit Agreement Name	
b. TYPE OF COMPLETION NEW WELL <input checked="" type="checkbox"/> WORK OVER <input type="checkbox"/> DEEPEN <input type="checkbox"/> PLUG BACK <input type="checkbox"/> DIFF. RESVRL. <input type="checkbox"/> OTHER <input type="checkbox"/>		8. Farm or Lease Name <b>Shell State</b>	
2. Name of Operator <b>Millard Deck</b>		9. Well No. <b>2</b>	
3. Address of Operator <b>P. O. Box 409, Eunice, New Mexico 88231</b>		10. Field and Pool, or Wildcat <b>Jalmat Yates 7R (Gas)</b>	
4. Location of Well UNIT LETTER <b>F</b> LOCATED <b>2310</b> FEET FROM THE <b>North</b> LINE AND <b>1980</b> FEET FROM <b>West</b>		12. County <b>Lea</b>	
15. Date Spudded <b>1/3/69</b>		16. Date T.D. Reached <b>1/11/69</b>	
17. Date Compl. (Ready to Prod.) <b>1/13/69</b>		18. Elevations (DF, RKB, RT, GR, etc.) <b>3267' GR</b>	
19. Elev. Casinghead <b>3267'</b>		20. Total Depth <b>3430'</b>	
21. Plug Back T.D. <b>3404'</b>		22. If Multiple Completions, How Many	
23. Intervals Drilled By <b>X</b>		24. Producing Interval(s), of this completion - Top, Bottom, Name <b>2701' - 2721' Jalmat (Gas)</b>	
25. Was Directional Survey Made <b>No</b>		26. Type Electric and Other Logs Run <b>Gamma Ray - Neutron, Sonic, Laterlog</b>	
27. Was Well Cored <b>No</b>		28. CASING RECORD (Report all strings set in well)	
CASING SIZE	WEIGHT LB./FT.	DEPTH SET	HOLE SIZE
<b>8-5/8"</b>	<b>24#</b>	<b>305'</b>	<b>12-1/4"</b>
<b>4-1/2"</b>	<b>10.50#</b>	<b>3430'</b>	<b>7-7/8"</b>
CEMENTING RECORD		AMOUNT PULLED	
<b>230 sacks-circulated</b>		<b>None</b>	
<b>355 sacks</b>		<b>None</b>	
29. LINER RECORD		30. TUBING RECORD	
SIZE	TOP	BOTTOM	SACKS CEMENT
<b>2-3/8"</b>	<b>2700'</b>	<b>None</b>	
31. Perforation Record (Interval, size and number)		32. ACID, SHOT, FRACTURE, CEMENT SQUEEZE, ETC.	
<b>2701', 2707', 2709', 2721' with four 1/2" holes.</b>		DEPTH INTERVAL <b>3701'-3721'</b> <b>2701' - 2721'</b>	
		AMOUNT AND KIND MATERIAL USED <b>10,000 gals. gelled brine with 10,000# 20-40 sand</b>	
33. PRODUCTION			
Date First Production <b>1/13/69</b>	Production Method (Flowing, gas lift, pumping - Size and type pump) <b>Flow</b>		Well Status (Prod. or Shut-in) <b>Prod.</b>
Date of Test <b>1/17/69</b>	Hours Tested <b>24</b>	Choke Size <b>48/64"</b>	Prod'n. For Test Period <b>1.26</b>
Flow Tubing Press. <b>175#</b>	Casing Pressure <b>540#</b>	Calculated 24-Hour Rate <b>1.26</b>	Oil - Bbl. <b>1,150</b>
			Gas - MCF <b>105</b>
			Water - Bbl. <b>912,000</b>
			Gas - Oil Ratio <b>33.3</b>
34. Disposition of Gas (Sold, used for fuel, vented, etc.) <b>Sold</b>			Test Witnessed By <b>Royce Crowell</b>
35. List of Attachments <b>Gamma Ray - Neutron, Sonic, Laterlog inclination survey</b>			
36. I hereby certify that the information shown on both sides of this form is true and complete to the best of my knowledge and belief.			
SIGNED <b>Millard Deck</b>		TITLE <b>Owner-Operator</b> DATE <b>1/29/69</b>	

# INSTRUCTIONS

This form is to be filed with the appropriate District Office of the Commission not later than 20 days after the completion of any newly-drilled or deepened well. It shall be accompanied by one copy of all electrical and radio-activity logs run on the well and a summary of all special tests conducted, including drill stem tests. All depths reported shall be measured depths. In the case of directionally drilled wells, true vertical depths shall also be reported. For multiple completions, items 30 through 34 shall be reported for each zone. The form is to be filed in quintuplicate except on state land, where six copies are required. See Rule 1105.

## INDICATE FORMATION TOPS IN CONFORMANCE WITH GEOGRAPHICAL SECTION OF STATE

### Southeastern New Mexico

### Northwestern New Mexico

T. Anhy <u>1121'</u>	T. Canyon _____	T. Ojo Alamo _____	T. Penn. "B" _____
T. Salt <u>1313'</u>	T. Strawn _____	T. Kirtland-Fruitland _____	T. Penn. "C" _____
B. Salt <u>2590'</u>	T. Atoka _____	T. Pictured Cliffs _____	T. Penn. "D" _____
T. Yates <u>2760'</u>	T. Miss _____	T. Cliff House _____	T. Leadville _____
T. 7 Rivers <u>2989'</u>	T. Devonian _____	T. Menefee _____	T. Madison _____
T. Queen <u>3374'</u>	T. Silurian _____	T. Point Lookout _____	T. Elbert _____
T. Grayburg _____	T. Montoya _____	T. Mancos _____	T. McCracken _____
T. San Andres _____	T. Simpson _____	T. Gallup _____	T. Ignacio Qtzite _____
T. Glorieta _____	T. McKee _____	Base Greenhorn _____	T. Granite _____
T. Paddock _____	T. Ellenburger _____	T. Dakota _____	T. _____
T. Blinbry _____	T. Gr. Wash _____	T. Morrison _____	T. _____
T. Tubb _____	T. Granite _____	T. Todilto _____	T. _____
T. Drinkard _____	T. Delaware Sand _____	T. Entrada _____	T. _____
T. Abo _____	T. Bone Springs _____	T. Wingate _____	T. _____
T. Wolfcamp _____	T. _____	T. Chinle _____	T. _____
T. Penn. _____	T. _____	T. Permian _____	T. _____
T. Cisco (Bough C) _____	T. _____	T. Penn. "A" _____	T. _____

## FORMATION RECORD (Attach additional sheets if necessary)

From	To	Thickness in Feet	Formation	From	To	Thickness in Feet	Formation
0	35	35'	Surface & caliche				
35	345	310	Red beds & sand stringers				
310	601	291	Red beds & Anhydrite				
601	1121	520	Red beds, sand & Anhydrite				
1121	1288	167	Anhydrite				
1288	2599	1311	Salt & Anhydrite				
2599	2740	141	Anhydrite				
2740	2935	195	Anhydrite & lime				
2935	3430	495	Lime, sand & dolomite				

# MILLARD DECK OIL COMPANY

P. O. Box 1047

Phone (505) 394-2249

EUNICE, NEW MEXICO 88231

October 16, 1979

New Mexico Department of Energy & Minerals  
Oil Conservation Division  
P. O. Box 2088  
Santa Fe, NM 87501

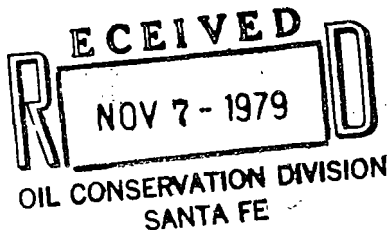

Re: Application for Administrative  
Approval for Natural Gas Policy  
Act Infill Finding According to  
271.304 and 271.305 for Shell  
State No. 3 - Jalmat Tansil Yates  
Seven Rivers Gas Pool - 660' FNL  
& 2310' FEL, Sec. 36, T24S, R36E,  
Lea County, New Mexico

Gentlemen:

Millard Deck respectfully requests your finding, as per requirement in NGPA 271.305, that there is a need for a second well on the previously approved 160 acre proration unit to effectively and efficiently drain Jalmat Pool gas reserves. Your approval is requested in accordance with special rules and regulations set forth under Division Order No. R-6013. The following information is submitted to support our request:

1. Copies of Form C-101 and C-102.
2. A completion attempt will be made in the Jalmat Gas Pool which has a standard proration unit of 640 acres.
3. Division Order NSP-808 established a 160 acre proration unit consisting of the NE/4 SW/4, the E/2 NW/4 and the NW/4 NE/4 Sec. 36-24S-36E. The Shell State No. 3 will be located on the NW/4 NE/4 with the proration unit consisting of the NE/4 NW/4 and the NW/4 NE/4.
4. The Shell State No. 3 has not been spudded. The well will be spudded as soon as practical following your approval of this request.
5. One well has previously been drilled on the 160 acre proration unit and completed in the same reservoir as the proposed well. It is the Shell State No. 2, located 2310' FNL and 1980' FWL, 36-24-36. It was spudded 1/4/69 and completed 1/13/69 through perforations from 2701' to 2777'. This well has been shut in

*New well pending*

October 16, 1979

Re: Shell State No. 3

- for several years due to excessive water production. The proposed replacement well for the Shell State No. 2 will be moved toward an area which has historically had lower water production.
6. A structure map of the area has been prepared with contours on the top of the Yates formation. The proposed well is indicated on the map along with other wells in the area.
  7. The proposed well will be moved northeastward from the Shell State No. 2 toward an area that has indicated lower water production. Perforations will also be made on a much more selective basis than No. 2. Volumetric calculations and production history from Jalmat gas wells in the area, indicate an additional 350 MMCF of gas will be recovered from this proposed well. These calculations are based on a drainage area of 80 acres, 25' of net pay with 16% average porosity. Reservoir bottom hole pressure is estimated to 450 psi, based on the Shell State No. 2 and other wells in the area.
  8. Offset operators are listed below along with their addresses. Each operator has been notified of this application and has been requested to execute a Waiver of Objection. Copies of their signed Waiver of Objection are included with this application.

Operator

Address

Phillips Petroleum Co.

P. O. Box 2130  
Hobbs, NM 88240

Texas Pacific Oil Co.

P. O. Box 4067  
Midland, TX 79701

Doyle Hartman

508 C&K Petroleum Bldg.  
Midland, TX 79701

Petroleum Corporation of Texas

P. O. Box 1842  
Midland, TX 79702

Shell Oil Company

P. O. Box 1509  
Midland, TX 79701

Burleson & Huff

P. O. Box 2479  
Midland, TX 79701

Yours very truly,

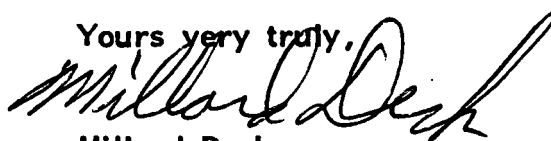

Millard Deck

Enclosures

NO. OF COPIES RECEIVED	
DISTRIBUTION	
SANTA FE	
FILE	
U.S.G.S.	
LAND OFFICE	
OPERATOR	

# NEW MEXICO OIL CONSERVATION COMMISSION

30-025-26536

Form C-101  
Revised 1-1-65

5A. Indicate Type of Lease	
STATE <input checked="" type="checkbox"/>	FEE <input type="checkbox"/>
5. State Oil & Gas Lease No.	

## APPLICATION FOR PERMIT TO DRILL, DEEPEN, OR PLUG BACK

1a. Type of Work		7. Unit Agreement Name	
b. Type of Well DRILL <input checked="" type="checkbox"/> DEEPEN <input type="checkbox"/> PLUG BACK <input type="checkbox"/> OIL WELL <input type="checkbox"/> GAS WELL <input checked="" type="checkbox"/> OTHER <input type="checkbox"/> SINGLE ZONE <input checked="" type="checkbox"/> MULTIPLE ZONE <input type="checkbox"/>		8. Farm or Lease Name Shell State	
c. Name of Operator Millard Deck		9. Well No. 3	
1. Address of Operator P. O. Box 1047, Eunice, NM 88231		10. Field and Pool, or Wildcat Jalmat Gas	
4. Location of Well UNIT LETTER B LOCATED 660 FEET FROM THE North LINE 2310 FEET FROM THE East LINE OF SEC. 36 TWP. 24 S RGE. 36 E NMDM		12. County Lea	
18. Proposed Depth 3500'		19A. Formation Yates Seven Rivers	
21A. Kind & Status Plug. Bond Blanket on file		20. Rotary or C.T. Rotary	
21B. Drilling Contractor Cactus Drlg. Co.		22. Approx. Date Work will start 11/10/79	
21. Previous Production (whether DF, RI, etc.) 3272' GR			

## PROPOSED CASING AND CEMENT PROGRAM

SIZE OF HOLE	SIZE OF CASING	WEIGHT PER FOOT	SETTING DEPTH	SACKS OF CEMENT	EST. TOP
12 1/4"	8 5/8"	24#	350'	300	circulate
7 7/8"	5 1/2"	15.5#	3500'	1200	circulate

- Surface casing will be set at 350' and the cement will be circulated to the surface.
- 5 1/2" casing will be set at approximately 3500' with a two-stage cementing tool near the top of the salt at approximately 2550'. Bottom stage will be 400 sacks of Class "C" 50-50 Poz and second stage will be 700 sacks of Halliburton Lite, tailed in by 100 sacks of Class "C" neat.

IN ABOVE SPACE DESCRIBE PROPOSED PROGRAM: IF PROPOSAL IS TO DEEPEN OR PLUG BACK, GIVE DATA ON PRESENT PRODUCTIVE ZONE AND PROPOSED NEW PRODUCTIVE ZONE. GIVE BLOWOUT PREVENTER PROGRAM, IF ANY.

I hereby certify that the information above is true and complete to the best of my knowledge and belief.

Signed Millard Deck Title Owner Date 10/23/79

(This space for State Use)

APPROVED BY John W. Kenyon TITLE Commissioner DATE NOV 5 1979

CONDITIONS OF APPROVAL, IF ANY:

Production from this well will not be authorized until approval is obtained for the non-standard perforation unit.

**NEW MEXICO OIL CONSERVATION COMMISSION  
WELL LOCATION AND ACREAGE DEDICATION PLAT**

Form C-102  
Supersedes C-128  
Effective 1-1-65

All distances must be from the outer boundaries of the Section.

Operator <b>MILLARD DECK</b>			Lease <b>SHELL STATE</b>		Well No. <b>3</b>
Unit Letter <b>B</b>	Section <b>36</b>	Township <b>24 South</b>	Range <b>36 East</b>	County <b>Lea</b>	
Actual Footage Location of Well: <b>660</b> feet from the <b>North</b> line and <b>2310</b> feet from the <b>East</b> line					
Ground Level Elev. <b>3271.8</b>	Producing Formation <b>Yates Seven Rivers</b>		Pool <b>Jalmat Gas</b>		Dedicated Acreage: <b>80</b> Acres

1. Outline the acreage dedicated to the subject well by colored pencil or hachure marks on the plat below.
2. If more than one lease is dedicated to the well, outline each and identify the ownership thereof (both as to working interest and royalty).
3. If more than one lease of different ownership is dedicated to the well, have the interests of all owners been consolidated by communitization, unitization, force-pooling, etc?

☐ Yes ☐ No If answer is "yes," type of consolidation \_\_\_\_\_

If answer is "no," list the owners and tract descriptions which have actually been consolidated. (Use reverse side of this form if necessary.) \_\_\_\_\_

No allowable will be assigned to the well until all interests have been consolidated (by communitization, unitization, forced-pooling, or otherwise) or until a non-standard unit, eliminating such interests, has been approved by the Commission.

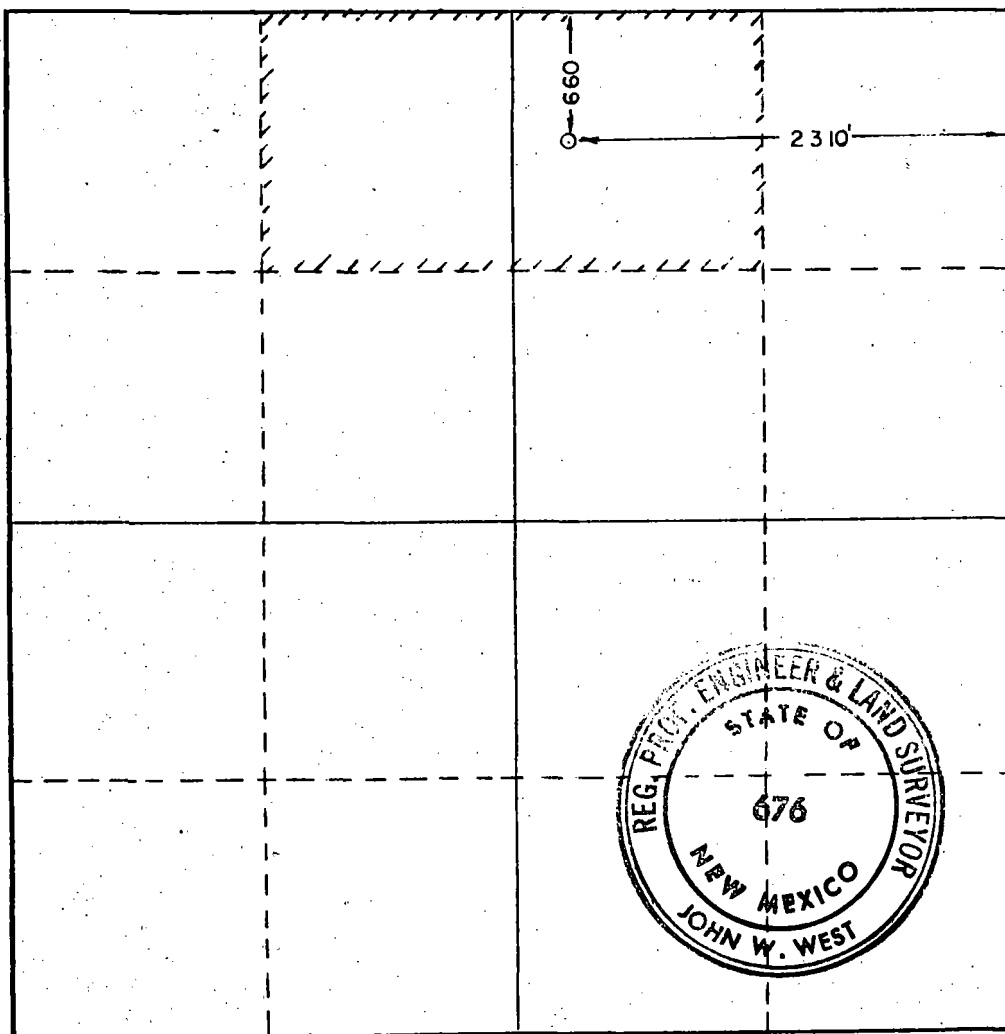

**CERTIFICATION**

I hereby certify that the information contained herein is true and complete to the best of my knowledge and belief.

*Millard Deck*  
Name \_\_\_\_\_

Position \_\_\_\_\_

**Owner**

Company \_\_\_\_\_

**Millard Deck**

Date \_\_\_\_\_

**October 18, 1979**

I hereby certify that the well location shown on this plat was plotted from field notes of actual surveys made by me or under my supervision, and that the same is true and correct to the best of my knowledge and belief.

Date Surveyed \_\_\_\_\_

**October 17, 1979**

Registered Professional Engineer and/or Land Surveyor

*John W. West*  
Certificate No. **676**



MAILGRAM SERVICE CENTER  
MIDDLETOWN, VA. 22645

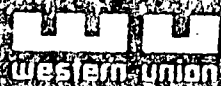

Mailgram



4-061918S306003 11/02/79 ICS IPMBNGZ CSP MIDB  
2 9156844011 MGM TDBN MIDLAND TX 11-02 0523P EST

MILLARD DECK  
PO BOX 1047  
EUNICE NM 88231

THIS IS A CONFIRMATION COPY OF A PREVIOUSLY PHONE-DELIVERED TELEGRAM

SIGNED WAIVER FOR YOUR WELL IN THE NORTHWEST QUARTER NORTHEAST  
QUARTER SECTION 36 T24S R36E WILL BE DELIVERED TO YOU ONLY WHEN YOU  
DELIVER TO ME SIGNED FARMOUT LETTER PER PREVIOUSLY AGREED TO TERMS OF  
A 65 PERCENT NET REVENUE INTEREST TO ME COVERING SOUTHEAST QUARTER  
NORTHWEST QUARTER SECTION 36 T24S R36E REPLY IMMEDIATELY SINCE YOU  
WANT TO START YOUR WELL IN THE NORTHWEST QUARTER NORTHEAST QUARTER  
SECTION 36 MONDAY NOVEMBER 5-1979  
DOYLE HARTMAN

1727 EST

MGMCOMP MGM

MILLARD DECK OIL COMPANY

P. O. Box 4047

Phone (505) 394 2249

MURKIN, NEW MEXICO 88231

October 16, 1979

Texas Pacific Oil Company

P. O. Box 4067

Midland, Texas 79701

Re: Enclosed Applications For  
Administrative Approval  
For Natural Gas Policy Act  
Infill Finding For Shell  
State No. 3.

Gentlemen:

Enclosed you will find copies of our applications to the Oil  
Conservation Division for the finding required by NPGA 271.304  
and 271.305 in accordance with Division Order No. R-6013.

In order to expedite the approval by the OCD, you are requested  
to execute the Waiver of Objection below and to return one copy  
for use with the OCD.

Thank you for your cooperation in securing these approvals.

Yours very truly,

Millard Deck

Waiver of Objection

Texas Pacific Oil Company hereby waives any objection to the  
drilling of the Millard Deck Shell State No. 3.

By

*R. J. Womack*  
R. J. Womack - Regional Manager

Date

10/19/79



MILLARD DECK OIL COMPANY

P. O. Box 1047

Phone (505) 394 2249

TUBUL, NEW MEXICO 88231

October 16, 1979

Texas Pacific Oil Company  
P. O. Box 4067  
Midland, Texas 79701

Re: Enclosed Applications For  
Administrative Approval  
For Natural Gas Policy Act  
Infill Finding For Shell  
State No. 3.

Gentlemen:

Enclosed you will find copies of our applications to the Oil  
Conservation Division for the finding required by NCPA 271.304  
and 271.305 in accordance with Division Order No. R-6013.

In order to expedite the approval by the OCD, you are requested  
to execute the Waiver of Objection below and to return one copy  
for use with the OCD.

Thank you for your cooperation in securing these approvals.

Yours very truly,

Millard Deck

Waiver of Objection.

Texas Pacific Oil Company hereby waives any objection to the  
drilling of the Millard Deck Shell State No. 3.

By

*R. J. Womack*  
R. J. Womack - Regional Manager

Date

10/19/79

MILLARD DECK OIL COMPANY

P. O. Box 1047

Phone (505) 394-2249

EUNICE, NEW MEXICO 88231

October 16, 1979

Shell Oil Company  
P. O. Box 1509  
Midland, Texas 79701

RE: Enclosed Applications For  
Administrative Approval  
For Natural Gas Policy Act  
Infill Finding for Shell  
State No. 3.

Gentlemen:

Enclosed you will find copies of our applications to the Oil  
Conservation Division for the finding required by NGPA 271.304  
and 271.305 in accordance with Division Order No. R-6013.

In order to expedite the approval by the OCD, you are requested  
to execute the Waiver of Objection below and to return one copy  
for use with the OCD.

Thank you for your cooperation in securing these approvals.

Yours very truly,

*Millard Deck*

Millard Deck

Waiver of Objection

Shell Oil Company waives any objection to the drilling of the  
Millard Deck Shell State No. 3.

By

*A. F. Osborne*

DATE

10-26-79

MILLARD DECK OIL COMPANY

P. O. Box 1047

Phone (505) 394-2249

EUNICE, NEW MEXICO 88231

October 16, 1979

Burleson & Huff  
P. O. Box 2479  
Midland, Texas 79701

Re: Enclosed Applications For  
Administrative Approval  
For Natural Gas Policy Act  
Infill Finding For Shell  
State No. 3.

Gentlemen:

Enclosed you will find copies of our applications to the Oil  
Conservation Division for the finding required by NGPA 271.304  
and 271.305 in accordance with Division Order No. R-6013,

In order to expedite the approval by the OCD, you are requested  
to execute the Waiver of Objection below and to return one copy  
for use with the OCD.

Thank you for your cooperation in securing these approvals.

Yours very truly,

*Millard Deck*

Millard Deck

Waiver of Objection

Burleson & Huff hereby waives any objection to the drilling of  
the Millard Deck Shell State No. 3.

By

*J. B. Burleson*  
*J. B. Burleson & Huff*

Date

*Oct. 22, 1979*

In order to be returned by the OGD, you are requested to return the copy of the

information to the OGD.

Very truly,

William H. Deak

Waiver of Objection

Petroleum Corporation of Texas  
Millard Deak Shell State No. 31

BT

100

**MILLARD DECK OIL COMPANY**

P. O. Box 1047

Phone (505) 394-2249

EUNICE, NEW MEXICO 88231

October 16, 1979

**Petroleum Corporation of Texas**  
P. O. Box 1842  
Midland, TX 79701

Re: **Enclosed Applications For  
Administrative Approval  
For Natural Gas Policy Act  
Infill Finding For Shell State  
No. 3**

Gentlemen:

Enclosed you will find copies of our applications to the Oil Conservation Division for the finding required by NGPA 271.304 and 271.305 in accordance with Division Order No. R-6013.

In order to expedite the approval by the OCD, you are requested to execute the Waiver of Objection below and to return one copy for use with the OCD.

Thank you for your cooperation in securing these approvals.

Yours very truly,

Millard Deck

**Waiver of Objection**

**Petroleum Corporation of Texas hereby waives any objection to the drilling of the Millard Deck Shell State No. 3.**

PETROLEUM CORPORATION OF TEXAS

By

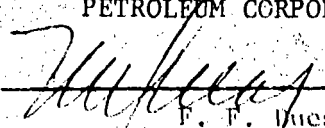
  
F. F. Dueser

Date

11-2-79

# MILLARD DECK OIL COMPANY

P. O. Box 1047

Phone (505) 394-2249

EUNICE, NEW MEXICO 88231

October 16, 1979

Phillips Petroleum Company  
P. O. Box 2130  
Hobbs, New Mexico 88240

Re: Enclosed Applications For  
Administrative Approval  
For Natural Gas Policy Act  
Infill Finding For Shell  
State No. 3.

Gentlemen:

Enclosed you will find copies of our applications to the Oil  
Conservation Division for the find required by NGPA 271.304  
and 271.305 in accordance with Division Order No. R-6013.

In order to expedite the approval by the OCD, you are requested  
to execute the Waiver of Objection below and to return one copy  
for use with the OCD.

Thank you for your cooperation in securing these approvals.

Yours very truly,

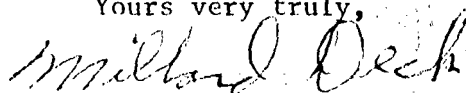

Millard Deck

## Waiver of Objection

Phillips Petroleum Company hereby waives any objection to the  
drilling of the Millard Deck Shell State No. 3.

By



Director, Reservoir Engineering

Date

10/24/79

Odessa Area, Southeastern Region

# MILLARD DECK OIL COMPANY

P. O. Box 1047

Phone (505) 394-2249

EUNICE, NEW MEXICO 88231

October 16, 1979

New Mexico Department of Energy & Minerals  
Oil Conservation Division  
P. O. Box 2088  
Santa Fe, NM 87501

Re: Application for Administrative  
Approval for Natural Gas Policy  
Act Infill Finding According to  
271.304 and 271.305 for Shell  
State No. 3 - Jalmat Tansil Yates  
Seven Rivers Gas Pool - 660' FNL  
& 2310' FEL, Sec. 36, T24S, R36E,  
Lea County, New Mexico

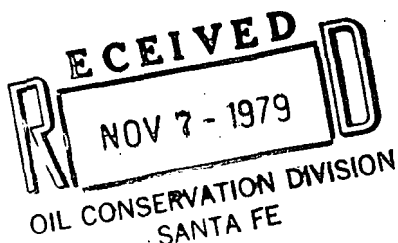

Gentlemen:

Millard Deck respectfully requests your finding, as per requirement in NGPA 271.305, that there is a need for a second well on the previously approved 160 acre proration unit to effectively and efficiently drain Jalmat Pool gas reserves. Your approval is requested in accordance with special rules and regulations set forth under Division Order No. R-6013. The following information is submitted to support our request:

1. Copies of Form C-101 and C-102.
2. A completion attempt will be made in the Jalmat Gas Pool which has a standard proration unit of 640 acres.
3. Division Order NSP-808 established a 160 acre proration unit consisting of the NE/4 SW/4, the E/2 NW/4 and the NW/4 NE/4 Sec. 36-24S-36E. The Shell State No. 3 will be located on the NW/4 NE/4 with the proration unit consisting of the NE/4 NW/4 and the NW/4 NE/4.
4. The Shell State No. 3 has not been spudded. The well will be spudded as soon as practical following your approval of this request.
5. One well has previously been drilled on the 160 acre proration unit and completed in the same reservoir as the proposed well. It is the Shell State No. 2, located 2310' FNL and 1980' FWL, 36-24-36. It was spudded 1/4/69 and completed 1/13/69 through perforations from 2701' to 2777'. This well has been shut in

October 16, 1979

Re: Shell State No. 3

- for several years due to excessive water production. The proposed replacement well for the Shell State No. 2 will be moved toward an area which has historically had lower water production.
6. A structure map of the area has been prepared with contours on the top of the Yates formation. The proposed well is indicated on the map along with other wells in the area.
  7. The proposed well will be moved northeastward from the Shell State No. 2 toward an area that has indicated lower water production. Perforations will also be made on a much more selective basis than No. 2. Volumetric calculations and production history from Jalmat gas wells in the area, indicate an additional 350 MMCF of gas will be recovered from this proposed well. These calculations are based on a drainage area of 80 acres, 25' of net pay with 16% average porosity. Reservoir bottom hole pressure is estimated to 450 psi, based on the Shell State No. 2 and other wells in the area.
  8. Offset operators are listed below along with their addresses. Each operator has been notified of this application and has been requested to execute a Waiver of Objection. Copies of their signed Waiver of Objection are included with this application.

<u>Operator</u>	<u>Address</u>
Phillips Petroleum Co.	P. O. Box 2130 Hobbs, NM 88240
Texas Pacific Oil Co.	P. O. Box 4067 Midland, TX 79701
Doyle Hartman	508 C&K Petroleum Bldg. Midland, TX 79701
Petroleum Corporation of Texas	P. O. Box 1842 Midland, TX 79702
Shell Oil Company	P. O. Box 1509 Midland, TX 79701
Burleson & Huff	P. O. Box 2479 Midland, TX 79701

Yours very truly,

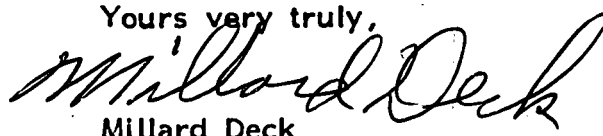
  
Millard Deck

Enclosures



359

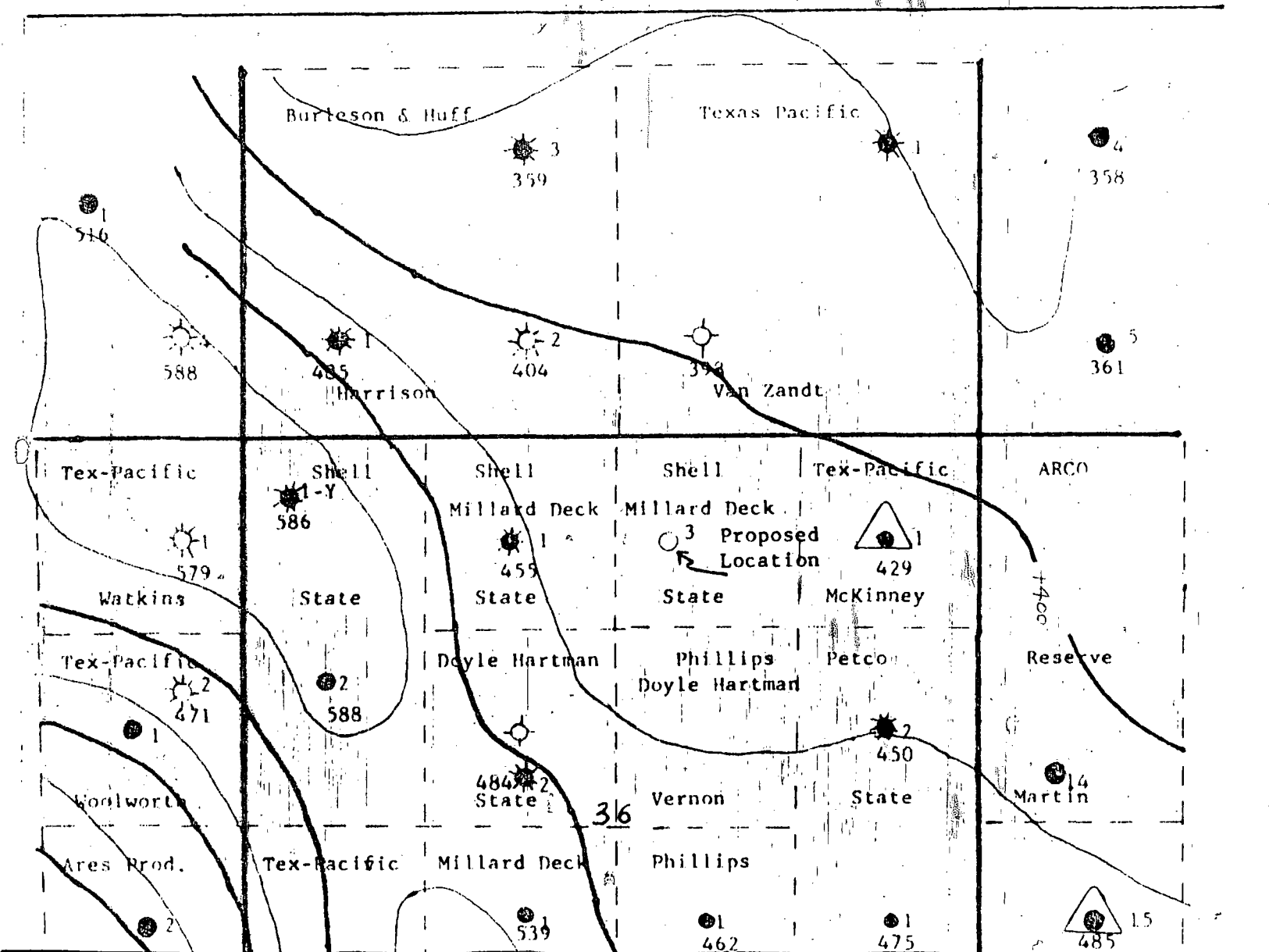

NO. OF COPIES RECEIVED	
DISTRIBUTION	
SANTA FE	
FILE	
U.S.G.S.	
LAND OFFICE	
OPERATOR	

# NEW MEXICO OIL CONSERVATION COMMISSION

30-025-26536

Form C-101  
Revised 1-1-65

5A. Indicate Type of Lease	
STATE <input checked="" type="checkbox"/>	FEE <input type="checkbox"/>
5. State Oil & Gas Lease No.	

## APPLICATION FOR PERMIT TO DRILL, DEEPEN, OR PLUG BACK

1a. Type of Work		7. Unit Agreement Name	
b. Type of Well OIL WELL <input type="checkbox"/> GAS WELL <input checked="" type="checkbox"/> OTHER <input type="checkbox"/>		8. Farm or Lease Name Shell State	
c. Name of Operator Millard Deck		9. Well No. 3	
1. Address of Operator P. O. Box 1047, Eunice, NM 88231		10. Field and Pool, or Wildcat Jalmat Gas	
4. Location of Well UNIT LETTER B LOCATED 660 FEET FROM THE North LINE AND 2310 FEET FROM THE East LINE OF SEC. 36 TWP. 24 S RGL. 36 E NADPH		12. County Lea	
11. Proposed Depth 3500'		19A. Formation Yates Seven Rivers	
21A. Kind & Status Plug. Bond Blanket on file		20. Rotary or C.T. Rotary	
21B. Drilling Contractor Cactus Drlg. Co.		22. Approx. Date Work will start 11/10/79	
23. (Indicate whether DE, RT, etc.) 3272' GR			

## PROPOSED CASING AND CEMENT PROGRAM

SIZE OF HOLE	SIZE OF CASING	WEIGHT PER FOOT	SETTING DEPTH	SACKS OF CEMENT	EST. TOP
12 1/4"	8 5/8"	24#	350'	300	circulate
7 7/8"	5 1/2"	15.5#	3500'	1200	circulate

1. Surface casing will be set at 350' and the cement will be circulated to the surface.
2. 5 1/2" casing will be set at approximately 3500' with a two-stage cementing tool near the top of the salt at approximately 2550'. Bottom stage will be 400 sacks of Class "C" 50-50 Poz and second stage will be 700 sacks of Halliburton Lite, tailed in by 100 sacks of Class "C" neat.

IN ABOVE SPACE DESCRIBE PROPOSED PROGRAM: IF PROPOSAL IS TO DEEPEN OR PLUG BACK, GIVE DATA ON PRESENT PRODUCTIVE ZONE AND PROPOSED NEW PRODUCTIVE ZONE. GIVE BEGOUT PREVENTER PROGRAM, IF ANY.

I hereby certify that the information above is true and complete to the best of my knowledge and belief.

Signed Millard Deck Title Owner Date 10/23/79

(This space for State Use)

APPROVED BY John W. Kuyper TITLE Commissioner DATE NOV 5 1979

CONDITIONS OF APPROVAL, IF ANY:

Production from this well will not be authorized until approval is obtained for the non-standard proration unit.

**NEW MEXICO OIL CONSERVATION COMMISSION  
WELL LOCATION AND ACREAGE DEDICATION PLAT**

Form C-102  
Supersedes C-128  
Effective 1-1-65

All distances must be from the outer boundaries of the Section.

Operator <b>MILLARD DECK</b>			Lease <b>SHELL STATE</b>		Well No. <b>3</b>
Unit Letter <b>B</b>	Section <b>36</b>	Township <b>24 South</b>	Range <b>36 East</b>	County <b>Lea</b>	
Actual Footage Location of Well: <b>660</b> feet from the <b>North</b> line and <b>2310</b> feet from the <b>East</b> line					
Ground Level Elev. <b>3271.8</b>	Producing Formation <b>Yates Seven Rivers</b>		Pool <b>Jalmat Gas</b>		Dedicated Acreage: <b>80</b> Acres

1. Outline the acreage dedicated to the subject well by colored pencil or hachure marks on the plat below.
2. If more than one lease is dedicated to the well, outline each and identify the ownership thereof (both as to working interest and royalty).
3. If more than one lease of different ownership is dedicated to the well, have the interests of all owners been consolidated by communitization, unitization, force-pooling, etc?

☐ Yes    ☐ No    If answer is "yes," type of consolidation \_\_\_\_\_

If answer is "no," list the owners and tract descriptions which have actually been consolidated. (Use reverse side of this form if necessary.) \_\_\_\_\_

No allowable will be assigned to the well until all interests have been consolidated (by communitization, unitization, forced-pooling, or otherwise) or until a non-standard unit, eliminating such interests, has been approved by the Commission.

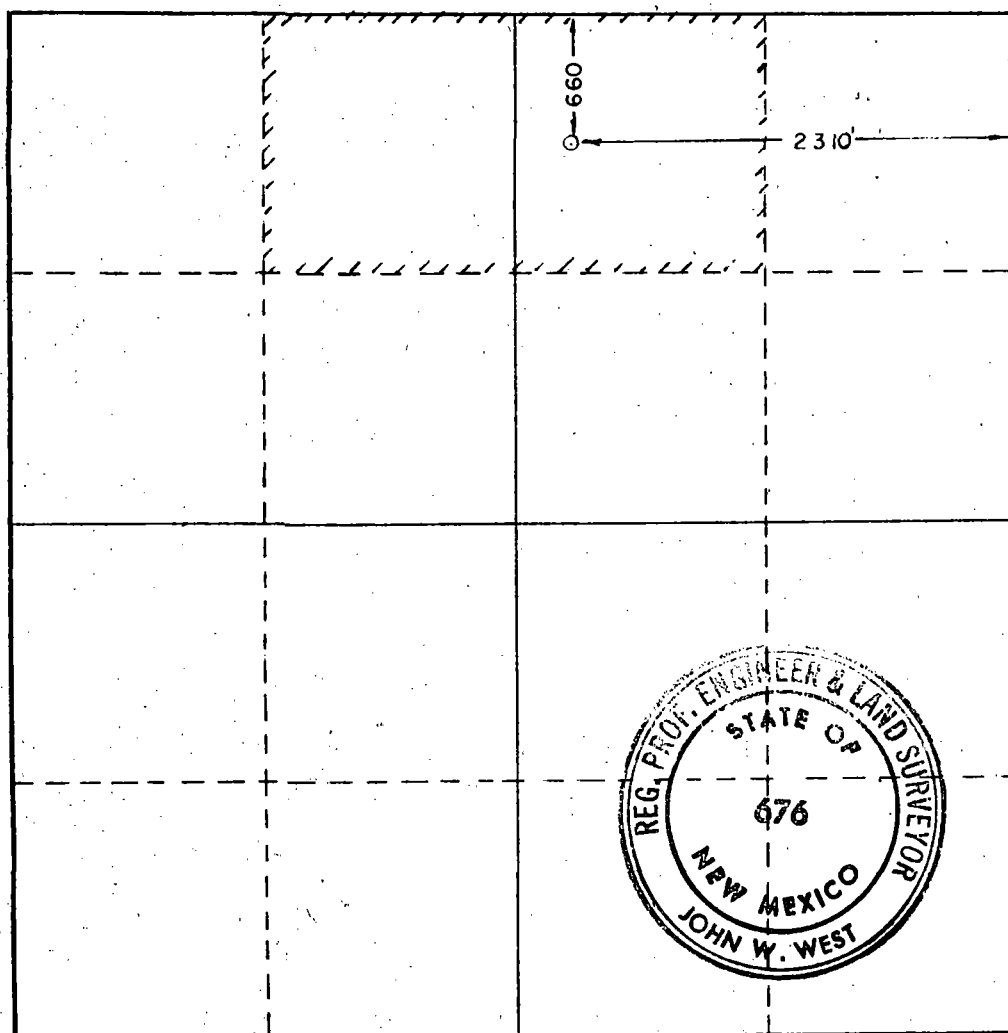

**CERTIFICATION**

I hereby certify that the information contained herein is true and complete to the best of my knowledge and belief.

*Millard Deck*

Name

Position

**Owner**

Company

**Millard Deck**

Date

**October 18, 1979**

I hereby certify that the well location shown on this plat was plotted from field notes of actual surveys made by me or under my supervision, and that the same is true and correct to the best of my knowledge and belief.

Date Surveyed

**October 17, 1979**

Registered Professional Engineer and/or Land Surveyor

*John W. West*

Certificate No. **676**

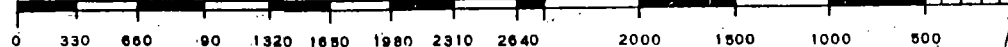

MAILGRAM SERVICE CENTER  
MIDDLETOWN, VA. 22645



**Mailgram**



4-061918S306003 11/02/79 ICS IPMBNGZ CSP MIDB  
2 9156844011 MGM TDBN MIDLAND TX 11-02 0523P EST

MILLARD DECK  
PO BOX 1047  
EUNICE NM 88231

THIS IS A CONFIRMATION COPY OF A PREVIOUSLY PHONE-DELIVERED TELEGRAM

SIGNED WAIVER FOR YOUR WELL IN THE NORTHWEST QUARTER NORTHEAST  
QUARTER SECTION 36 T24S R36E WILL BE DELIVERED TO YOU ONLY WHEN YOU  
DELIVER TO ME SIGNED FARMOUT LETTER PER PREVIOUSLY AGREED TO TERMS OF  
A 65 PERCENT NET REVENUE INTEREST TO ME COVERING SOUTHEAST QUARTER  
NORTHWEST QUARTER SECTION 36 T24S R36E REPLY IMMEDIATELY SINCE YOU  
WANT TO START YOUR WELL IN THE NORTHWEST QUARTER NORTHEAST QUARTER  
SECTION 36 MONDAY NOVEMBER 5 1979

DOYLE HARTMAN

1727 EST

MGMCOMP MGM

MILLARD DECK OIL COMPANY

P. O. Box 1047

Phone (505) 394 2249

MIDLAND, NEW MEXICO 88231

October 16, 1979

Texas Pacific Oil Company  
P. O. Box 4067  
Midland, Texas 79701

Re: Enclosed Applications For  
Administrative Approval  
For Natural Gas Policy Act  
Infill Finding For Shell  
State No. 3.

Gentlemen:

Enclosed you will find copies of our applications to the Oil  
Conservation Division for the finding required by NCPA 271.304  
and 271.305 in accordance with Division Order No. R-6012.

In order to expedite the approval by the OCD, you are requested  
to execute the Waiver of Objection below and to return one copy  
for use with the OCD.

Thank you for your cooperation in securing these approvals.

Yours very truly,

Millard Deck

Waiver of Objection

Texas Pacific Oil Company hereby waives any objection to the  
drilling of the Millard Deck Shell State No. 3.

By

*R. J. Womack*  
R. J. Womack - Regional Manager

Date

10/19/79

MILLARD DECK OIL COMPANY

P. O. Box 1047

Phone (505) 394-2249

EUNICE, NEW MEXICO 88231

October 16, 1979

Shell Oil Company  
P. O. Box 1509  
Midland, Texas 79701

RE: Enclosed Applications For  
Administrative Approval  
For Natural Gas Policy Act  
Infill Finding for Shell  
State No. 3.

Gentlemen:

Enclosed you will find copies of our applications to the Oil  
Conservation Division for the finding required by NGPA 271.304  
and 271.305 in accordance with Division Order No. R-6013.

In order to expedite the approval by the OCD, you are requested  
to execute the Waiver of Objection below and to return one copy  
for use with the OCD.

Thank you for your cooperation in securing these approvals.

Yours very truly,

*Millard Deck*

Millard Deck

Waiver of Objection

Shell Oil Company waives any objection to the drilling of the  
Millard Deck Shell State No. 3.

By

*A. F. Osborne*

DATE

10-26-79

MILLARD DECK OIL COMPANY

P. O. Box 1047

Phone (505) 394-2249

EUNICE, NEW MEXICO 88231

October 16, 1979

Burleson & Huff  
P. O. Box 2479  
Midland, Texas 79701

Re: Enclosed Applications For  
Administrative Approval  
For Natural Gas Policy Act  
Infill Finding For Shell  
State No. 3.

Gentlemen:

Enclosed you will find copies of our applications to the Oil  
Conservation Division for the finding required by NCPA 271.304  
and 271.305 in accordance with Division Order No. R-6013,

In order to expedite the approval by the OCD, you are requested  
to execute the Waiver of Objection below and to return one copy  
for use with the OCD.

Thank you for your cooperation in securing these approvals.

Yours very truly,

*Millard Deck*

Millard Deck

Waiver of Objection

Burleson & Huff hereby waives any objection to the drilling of  
the Millard Deck Shell State No. 3.

By

*[Signature]* *Joe B. Burleson*

Date

*Oct. 22, 1979*

**MILLARD DECK OIL COMPANY**

P. O. Box 1047

Phone (505) 394-2249

EUNICE, NEW MEXICO 88231

October 16, 1979

Petroleum Corporation of Texas  
P. O. Box 1842  
Midland, TX 79701

Re: Enclosed Applications For  
Administrative Approval  
For Natural Gas Policy Act  
Infill Finding For Shell State  
No. 3

Gentlemen:

Enclosed you will find copies of our applications to the Oil Conservation Division for the finding required by NCPA 271.304 and 271.305 in accordance with Division Order No. R-6013.

In order to expedite the approval by the OCD, you are requested to execute the Waiver of Objection below and to return one copy for use with the OCD.

Thank you for your cooperation in securing these approvals.

Yours very truly,

Millard Deck

**Waiver of Objection**

Petroleum Corporation of Texas hereby waives any objection to the drilling of the Millard Deck Shell State No. 3.

PETROLEUM CORPORATION OF TEXAS

By

*F. F. Dueser*  
F. F. Dueser

Date

11-2-79



MILLARD DECK OIL COMPANY

P. O. Box 1047

Phone (505) 394-2249

EUNICE, NEW MEXICO 88231

October 16, 1979

Phillips Petroleum Company  
P. O. Box 2130  
Hobbs, New Mexico 88240

Re: Enclosed Applications For  
Administrative Approval  
For Natural Gas Policy Act  
Infill Finding For Shell  
State No. 3.

Gentlemen:

Enclosed you will find copies of our applications to the Oil  
Conservation Division for the find required by NGPA 271.304  
and 271.305 in accordance with Division Order No. R-6013.

In order to expedite the approval by the OCD, you are requested  
to execute the Waiver of Objection below and to return one copy  
for use with the OCD.

Thank you for your cooperation in securing these approvals.

Yours very truly,

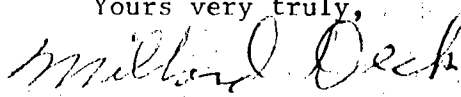

Millard Deck

Waiver of Objection

Phillips Petroleum Company hereby waives any objection to the  
drilling of the Millard Deck Shell State No. 3.

By 

Director, Reservoir Engineering

Date 10/24/79

Odessa Area, Southeastern Region

