



STATE OF NEW MEXICO  
ENERGY, MINERALS AND NATURAL RESOURCES DEPARTMENT

OIL CONSERVATION DIVISION  
2040 S. PACHECO  
SANTA FE, NEW MEXICO 87505  
(505) 827-7131

July 14, 1997

Phillips Petroleum Company  
5525 Highway 64 - NBU 3004  
Farmington, New Mexico 87401  
Attention: Patrick H. Noah

*Administrative Order DD-182(NSBHL)*

Dear Mr. Noah:

Reference is made to your application dated November 1, 1996 authorizing Phillips Petroleum Company's ("Phillips") recent recompletion of its San Juan "32-8" Unit Well No. 5 (API No. 30-045-10850) by side tracking off of the existing vertical wellbore and directionally drilling to a pre-determined unorthodox bottomhole gas well location in order to further develop the Blanco-Mesaverde Pool underlying the existing standard 320-acre gas spacing and proration unit ("GPU") comprising the W/2 of Section 10, Township 31 North, Range 8 West, NMPM, San Juan County, New Mexico.

**The Division Director Finds That:**

- (1) By Order No. R-8170, as amended, the Division promulgated the "*General Rules For The Prorated Gas Pools of New Mexico/Special Rules and Regulations For The Blanco-Mesaverde Pool*", which includes provisions for 320-acre gas spacing and proration units ("GPU") and well location requirements whereby the initial well drilled on a GPU shall be located be no closer than 790 feet to the outer boundary of the quarter section on which the well is located and not closer than 130 feet to any quarter-quarter section line or subdivision inner boundary and the infill well drilled on an existing GPU shall be in the quarter section not containing a Mesaverde gas well and shall be located with respect to the restrictions as previously described;
- (2) The San Juan "32-8" Unit Well No. 5, located at a standard surface gas well location 1160 feet from the South line and 1700 feet from the West line (Unit N) of said Section 10, was originally drilled by Phillips in 1953;
- (3) In 1957 said well was finally completed in the Blanco-Mesaverde Pool;
- (4) This application has been duly filed under the applicable provisions of said special pool rules and Rules 111.D and E of the General Rules and Regulations of the New Mexico Oil Conservation Division ("Division"), revised by Division Order No. R-10388, issued by the New Mexico Oil Conservation Commission in Case 11,274 on June 13, 1995;
- (5) As indicated by the directional survey, dated October 14, 1996, on file with the Division,

the actual bottomhole location for this well within the Blanco-Mesaverde is now 1298 feet from the South line and 1529 feet from the West line (Unit N) of said Section 10; and,

- (6) It appearing the applicant has satisfied all of the appropriate requirements prescribed in said Rule 111.D and E and Rule 2(d) of said special pool rules, the subject application should be approved.

**IT IS THEREFORE ORDERED THAT:**

(1) The recompletion by Phillips Petroleum Company of its San Juan "32-8" Unit Well No. 5 (API No. 30-045-10850), located at a standard surface gas well location 1160 feet from the South line and 1700 feet from the West line (Unit N) of Section 10, Township 31 North, Range 8 West, NMPM, San Juan County, New Mexico, by side tracking off of the existing vertical wellbore and directionally drilling to its present unorthodox bottomhole gas well location within the Blanco-Mesaverde Pool 1298 feet from the South line and 1529 feet from the West line (Unit N) of said Section 10, is hereby approved.

(2) The existing 320-acre standard gas spacing and proration unit ("GPU") comprising the W/2 of said Section 10 shall be dedicated to said well.

(3) Jurisdiction of this cause is retained for the entry of such further orders as the Division may deem necessary.

DONE at Santa Fe, New Mexico, on the day and year hereinabove designated.

STATE OF NEW MEXICO  
OIL CONSERVATION DIVISION

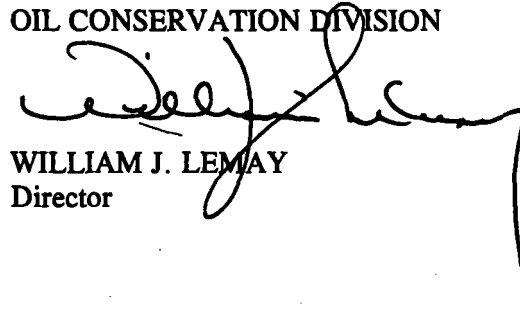

WILLIAM J. LEMAY  
Director

SEAL

WJL/MES/kv

cc: Oil Conservation Division - Aztec  
U. S. Bureau of Land Management - Farmington

Rec: 11-5-96  
Susp: 11-25-96  
Released: 7-14-97

Phillips. 3

July 14, 1997

Phillips Petroleum Company  
5525 Highway 64 - NBU 3004  
Farmington, New Mexico 87401

Attention: Patrick H. Noah

Administrative Order DD-182-\*\*\*\*(NSBHL)

Dear Mr. Noah:

Reference is made to your application dated November 1, 1996 authorizing Phillips Petroleum Company's ("Phillips") recent recompletion of its San Juan "32-8" Unit Well No. 5 (API No. 30-045-10850) by side tracking off of the existing vertical wellbore and directionally drilling to a pre-determined unorthodox bottomhole gas well location in order to further develop the Blanco-Mesaverde Pool underlying the existing standard 320-acre gas spacing and proration unit ("GPU") comprising the W/2 of Section 10, Township 31 North, Range 8 West, NMPM, San Juan County, New Mexico.

**The Division Director Finds That:**

- (1) By Order No. R-8170, as amended, the Division promulgated the "*General Rules For The Prorated Gas Pools of New Mexico/Special Rules and Regulations For The Blanco-Mesaverde Pool*", which includes provisions for 320-acre gas spacing and proration units ("GPU") and well location requirements whereby the initial well drilled on a GPU shall be located be no closer than 790 feet to the outer boundary of the quarter section on which the well is located and not closer than 130 feet to any quarter-quarter section line or subdivision inner boundary and the infill well drilled on an existing GPU shall be in the quarter section not containing a Mesaverde gas well and shall be located with respect to the restrictions as previously described;
- (2) The San Juan "32-8" Unit Well No. 5, located at a standard surface gas well location 1160 feet from the South line and 1700 feet from the West line (Unit N) of said Section 10, was originally drilled by Phillips in 1953;
- (3) In 1957 said well was finally completed in the Blanco-Mesaverde Pool;
- (4) This application has been duly filed under the applicable provisions of said special pool rules and **Rules 111.D and E** of the General Rules and Regulations of the

New Mexico Oil Conservation Division ("Division"), revised by Division Order No. R-10388, issued by the New Mexico Oil Conservation Commission in Case 11,274 on June 13, 1995;

- (5) As indicated by the directional survey, dated October 14, 1996, on file with the Division, the actual bottomhole location for this well within the Blanco-Mesaverde is now 1298 feet from the South line and 1529 feet from the West line (Unit N) of said Section 10; and,
- (6) It appearing the applicant has satisfied all of the appropriate requirements prescribed in said Rule 111.D and E and Rule 2(d) of said special pool rules, the subject application should be approved.

**IT IS THEREFORE ORDERED THAT:**

(1) The recompletion by Phillips Petroleum Company of its San Juan "32-8" Unit Well No. 5 (API No. 30-045-10850), located at a standard surface gas well location 1160 feet from the South line and 1700 feet from the West line (Unit N) of Section 10, Township 31 North, Range 8 West, NMPM, San Juan County, New Mexico, by side tracking off of the existing vertical wellbore and directionally drilling to its present unorthodox bottomhole gas well location within the Blanco-Mesaverde Pool 1298 feet from the South line and 1529 feet from the West line (Unit N) of said Section 10, is hereby approved.

(2) The existing 320-acre standard gas spacing and proration unit ("GPU") comprising the W/2 of said Section 10 shall be dedicated to said well.

(3) Jurisdiction of this cause is retained for the entry of such further orders as the Division may deem necessary.

DONE at Santa Fe, New Mexico, on the day and year hereinabove designated.

STATE OF NEW MEXICO  
OIL CONSERVATION DIVISION

WILLIAM J. LEMAY  
Director

S E A L

WJL/MES/kv

cc: Oil Conservation Division - Aztec  
U. S. Bureau of Land Management - Farmington



**PHILLIPS PETROLEUM COMPANY**

FARMINGTON, NEW MEXICO 87401  
5525 HWY. 64 NBU 3004

NSK  
DD  
11/25/96  
OIL CONSERVATION DIVISION  
RECEIVED

NOV 5 AM 8 52

November 1, 1996

State of New Mexico  
Oil Conservation Division  
204 South Pacheco  
Santa Fe, New Mexico 87505

ATTN: MR. WILLIAM J. LEMAY

**RE: EXCEPTION FOR UNORTHODOX LOCATION AND FIELD RULES AND  
ADMINISTRATIVE APPROVAL OF INTENTIONAL WELL DEVIATION  
SAN JUAN 32-8 UNIT #5 WELL  
SW/4 SECTION 10-T31N-R8W,  
SAN JUAN COUNTY, NEW MEXICO  
PHILLIPS' G.F.-5465, LCN 650117**

Gentlemen:

Phillips Petroleum Company ("Phillips"), as Operator of the San Juan 32-8 Unit, requests administrative approval of the unorthodox location of the above-described #5 Well due to intentional deviation of the well.

The San Juan 32-8 Unit #5 Well was originally drilled in 1953 and completed as a Blanco Mesaverde Pool well. Enclosed is a copy of the original plats for this well which indicate the original location of 1160' FSL and 1700' FWL.

Phillips has abandoned the existing Blanco Mesaverde interval in this well, sidetracked and completed in the Blanco Mesaverde at a bottom-hole location of 1298' FSL and 1529' FWL Section 10-T31N-R8W. Enclosed are three copies of a new well location and acreage dedication plat and sub-surface directional survey confirming the well's bottom-hole location.

No offset notification of this request is required, as all offset Blanco Mesaverde spacing units are within the boundaries of the San Juan 32-8 Unit.

Please advise if additional information is required.

Very truly yours,

*Patrick H. Noah*

Patrick H. Noah  
Senior Land Specialist  
San Juan Basin  
(505) 599-3410

cc: J.L. Mathis (r) G.F. 5465  
Ernie Busch-OCD, Aztec

NEW MEXICO  
OIL CONSERVATION COMMISSION

Gas Well Plat *file*

Date March 23, 1956  
PACIFIC NORTHWEST PIPELINE CORP. 32-8 Mesa 5-10  
Operator Lease Well No.

Name of Producing Formation Mesa Verde Pool Blanco

No. Acres Dedicated to the Well 320

SECTION 10 TOWNSHIP 31N RANGE 8W

USDI	10	USDI	
PACIFIC NORTHWEST PIPELINE CORP.			
	X		

I hereby certify that the information given above is true and complete to the best of my knowledge.

Name Original signed by T. A. Dugan  
Position District Engineer  
Representing PACIFIC NORTHWEST PIPELINE CORP.  
Address 4132W, Main, Farmington, New Mexico

(over)

U.S.G.S -4  
B'ville -1  
Region -1  
File -1

Company.....Phillips Petroleum Company.....

Lease.....Well No.....

Sec. 10, T. 31 N., R. 8 W., N.M.P.M.

Location.....1160' from the South line and 1700' from  
the West line.

Elevation 6643 Ungraded ground.

San Juan County

New Mexico

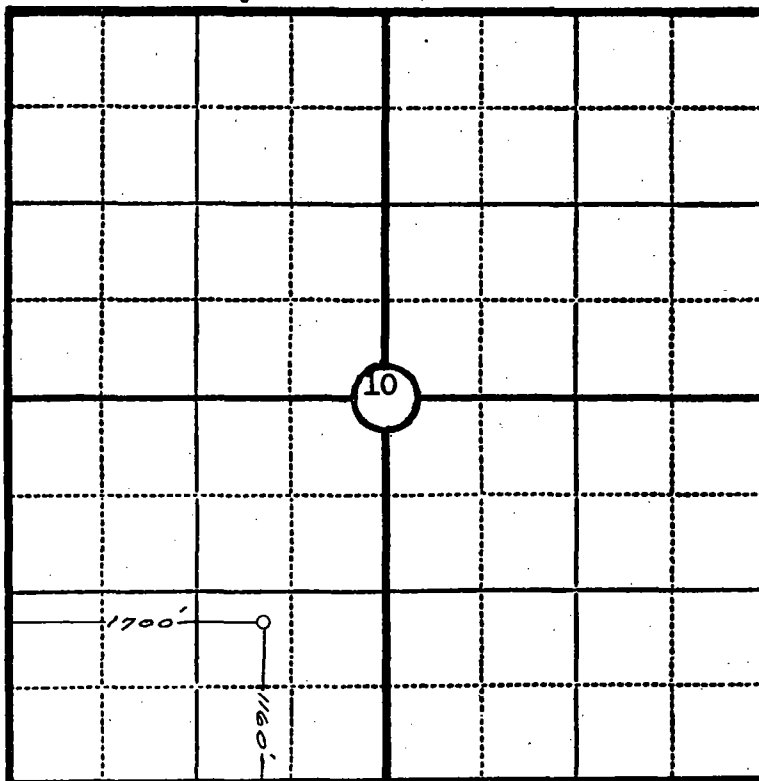

REF  
SEP 1, 1953  
U.S. GEOLOGICAL SURVEY  
FARMINGTON, N. M.

Scale—4 inches equal 1 mile.

This is to certify that the above plat was prepared from field notes of actual surveys made by me or under my supervision and that the same are true and correct to the best of my knowledge and belief.

Seal:

Registered Professional  
Engineer and Land Surveyor.

Ernest V. Echohawk  
N. Mex. Reg. No. 1545

Surveyed September 10, 1953



District I  
PO Box 1980, Hobbs, NM 88241-1980  
District II  
811 South First, Artesia, NM 88210  
District III  
1000 Rio Brazos Rd., Aztec, NM 87410  
District IV  
2040 South Pacheco, Santa Fe, NM 87505

State of New Mexico  
Energy, Minerals & Natural Resources Department

OIL CONSERVATION DIVISION  
2040 South Pacheco  
Santa Fe, NM 87505

Form C-102  
Revised October 18, 1994  
Instructions on back  
Submit to Appropriate District Office  
State Lease - 4 Copies  
Fee Lease - 3 Copies

☐ AMENDED REPORT

WELL LOCATION AND ACREAGE DEDICATION PLAT

<sup>1</sup> API Number 30-045-1-850	<sup>2</sup> Pool Code 72319	<sup>3</sup> Pool Name Blanco Mesaverde
<sup>4</sup> Property Code 009261	<sup>5</sup> Property Name San Juan 32-8 Unit	<sup>6</sup> Well Number #5
<sup>7</sup> OGRID No. 017654	<sup>8</sup> Operator Name Phillips Petroleum Company	<sup>9</sup> Elevation 6643' GL

<sup>10</sup> Surface Location

UL or lot no.	Section	Township	Range	Lot Idn	Feet from the	North/South line	Feet from the	East/West line	County
N	10	31N	8W		1160	South	1700	West	San Juan

<sup>11</sup> Bottom Hole Location If Different From Surface

UL or lot no.	Section	Township	Range	Lot Idn	Feet from the	North/South line	Feet from the	East/West line	County
N	10	31N	8W		1298.5	South	1529	West	San Juan

<sup>12</sup> Dedicated Acres 320 acrs.	<sup>13</sup> Joint or Infill N	<sup>14</sup> Consolidation Code U	<sup>15</sup> Order No.
--	------------------------------------	---------------------------------------	-------------------------

NO ALLOWABLE WILL BE ASSIGNED TO THIS COMPLETION UNTIL ALL INTERESTS HAVE BEEN CONSOLIDATED  
OR A NON-STANDARD UNIT HAS BEEN APPROVED BY THE DIVISION

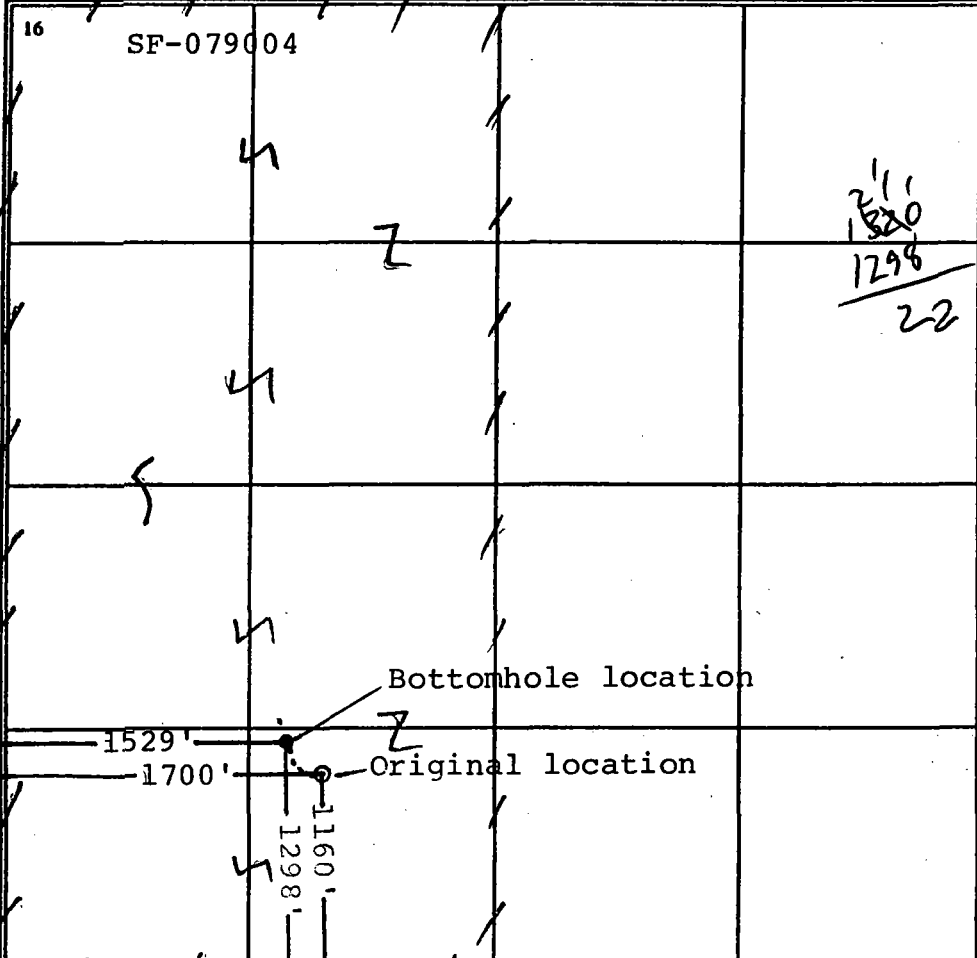
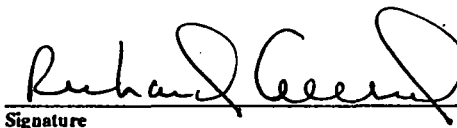
<div><p><sup>16</sup> SF-079004</p></div>	<div><p><sup>17</sup> OPERATOR CERTIFICATION</p><p>I hereby certify that the information contained herein is true and complete to the best of my knowledge and belief</p><p></p><p>Signature Richard Allred Printed Name Prod. Superintendent Title 11-4-96 Date</p></div> <div><p><sup>18</sup> SURVEYOR CERTIFICATION</p><p>I hereby certify that the well location shown on this plat was plotted from field notes of actual surveys made by me or under my supervision, and that the same is true and correct to the best of my belief.</p><p>October 13, 1996 Date of Survey Signature and Seal of Professional Surveyer: Certificate Number</p></div>
--	--

**New Mexico Oil Conservation Division  
C-102 Instructions**

**IF THIS IS AN AMENDED REPORT, CHECK THE BOX LABELED "AMENDED REPORT" AT THE TOP OF THIS DOCUMENT.**

Surveyors shall use the latest United States government survey or dependent resurvey. Well locations will be in reference to the New Mexico Principal Meridian. If the land is not surveyed contact the appropriate OCD district office. Independent subdivision surveys will not be acceptable.

(Note: A legal location is determined from the perpendicular distance to the edge of the tract.) If this is a high angle or horizontal hole show that portion of the well bore that is open within this pool.

Show all lots, lot numbers, and their respective acreage.

If more than one lease has been dedicated to this completion, outline each one and identify the ownership as to both working interest and royalty.

17. The signature, printed name, and title of the person authorized to make this report, and the date this document was signed.

18. The registered surveyors certification. This section does not have to be completed if this form has been previously accepted by the OCD and is being filed for a change of pool or dedicated acreage.

1. The OCD assigned API number for this well
2. The pool code for this (proposed) completion
3. The pool name for this (proposed) completion
4. The property code for this (proposed) completion
5. The property name (well name) for this (proposed) completion
6. The well number for this (proposed) completion
7. Operator's OGRID number
8. The operator's name
9. The ground level elevation of this well
10. The surveyed surface location of this well measured from the section lines NOTE: If the United States government survey designates a Lot Number for this location use that number in the "UL or lot no." box. Otherwise use the OCD unit letter.
11. Proposed bottom hole location. If this is a horizontal hole indicate the location of the end of the hole.
12. The calculated acreage dedicated to this completion to the nearest hundredth of an acre
13. Put a Y if more than one completion will be sharing this same acreage or N if this is the only completion on this acreage
14. If more than one lease of different ownership has been dedicated to the well show the consolidation code from the following table:

C	Communitization
U	Unitization
F	Forced pooling
O	Other
P	Consolidation pending

**NO ALLOWABLE WILL BE ASSIGNED TO THIS COMPLETION UNTIL ALL INTERESTS HAVE BEEN CONSOLIDATED OR A NON-STANDARD UNIT HAS BEEN APPROVED BY THE DIVISION!**

15. Write in the OCD order(s) approving a non-standard location, non-standard spacing, or directional or horizontal drilling
16. This grid represents a standard section. You may superimpose a non-standard section over this grid. Outline the dedicated acreage and the separate leases within that dedicated acreage. Show the well surface location and bottom hole location, if it is directionally drilled, with the dimensions from the section lines in the cardinal directions.



1700 Broadway Suite 1450 Denver Colorado 80290  
(303) 860-0509 Fax (303) 830-2546

# REPORT OF SUB-SURFACE DIRECTIONAL SURVEY

Phillips Petroleum  
COMPANY

San Juan Unit 32-8 #5  
WELL NAME

San Juan County, New Mexico  
LOCATION

JOB NUMBER  
410-80548

TYPE OF SURVEY  
MSS

DATE  
October 13, 1996

SURVEYED BY  
Max Lund

OFFICE  
DENVER



1700 Broadway Suite 1450 Denver Colorado 80290  
(303) 860-0509 Fax (303) 830-2546

## SURVEY CERTIFICATION SHEET

Phillips Petroleum

Company

Sec-10-T32N-R8W

Lease

410-80548

Job #

San Juan Unit 32-8 #5

Well #

October 13, 1996

Date

San Juan County, New Mexico

County and State

Surveyed from a depth of 4,003 feet to 4,359 feet MD

Type of Survey MSS

Directional Supervisor/Surveyor Max Lund

The data and calculations for this survey have been checked by me and conform to the standards and procedures set forth by Baker Hughes INTEQ. This report represents a true and correct Directional Survey of this well based on the original data obtained at the well site. Wellbore Coordinates are calculated using minimum curvature.

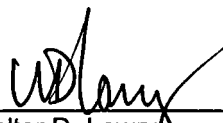
  
\_\_\_\_\_  
Walter D. Lowry  
Sr. Drilling Engineer

This document has been subscribed and affirmed, or sworn to before me in the county of Denver, state of Colorado, this 22nd day of October, 1996.

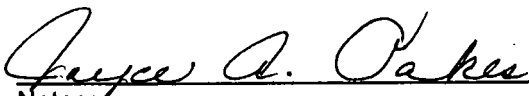
  
\_\_\_\_\_  
Notary My commission expires August 4, 2000

Certification Number: 431  
Certification Date: October 22, 1996

# PHILLIPS PETROLEUM

Structure : SEC.10-T32N-R8W Well : SAN JUAN UNIT 32-8 #5

Field : SAN JUAN COUNTY

Location : NEW MEXICO

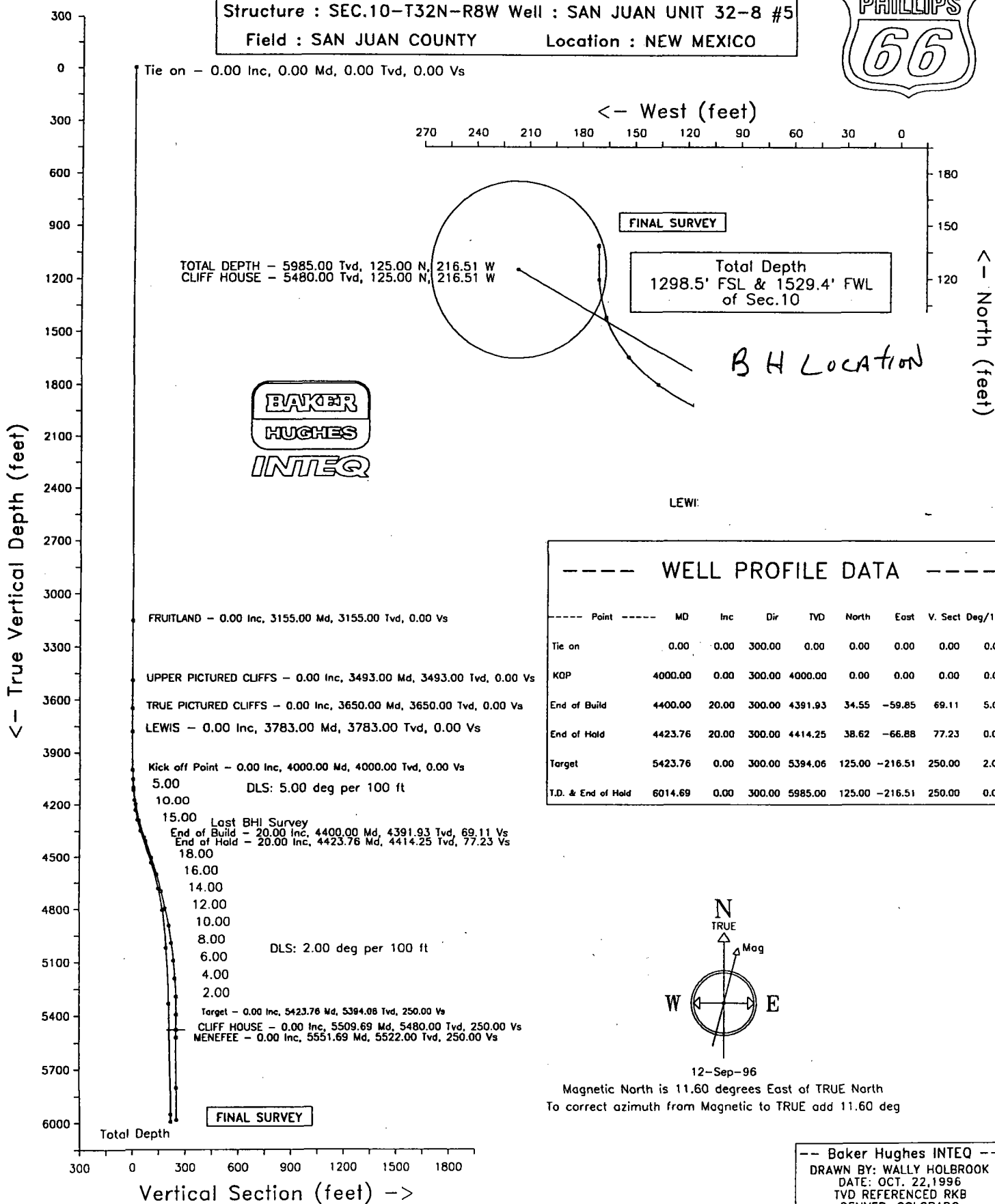

FINAL SURVEY

TOTAL DEPTH - 5985.00 Tvd, 125.00 N, 216.51 W  
CLIFF HOUSE - 5480.00 Tvd, 125.00 N, 216.51 W

Total Depth  
1298.5' FSL & 1529.4' FWL  
of Sec.10



LEWIS

## WELL PROFILE DATA

Point	MD	Inc	Dir	TVD	North	East	V. Sect	Deg/100
Tie on	0.00	0.00	300.00	0.00	0.00	0.00	0.00	0.00
KOP	4000.00	0.00	300.00	4000.00	0.00	0.00	0.00	0.00
End of Build	4400.00	20.00	300.00	4391.93	34.55	-59.85	69.11	5.00
End of Hold	4423.76	20.00	300.00	4414.25	38.62	-66.88	77.23	0.00
Target	5423.76	0.00	300.00	5394.06	125.00	-216.51	250.00	2.00
T.D. & End of Hold	6014.69	0.00	300.00	5985.00	125.00	-216.51	250.00	0.00

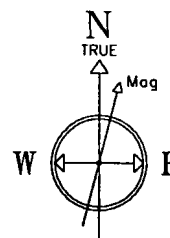

12-Sep-96

Magnetic North is 11.60 degrees East of TRUE North  
To correct azimuth from Magnetic to TRUE add 11.60 deg

-- Baker Hughes INTEQ --  
DRAWN BY: WALLY HOLBROOK  
DATE: OCT. 22, 1996  
TVD REFERENCED RKB  
DENVER, COLORADO  
PHONE: (303) 860-0509

Vertical Section (feet) -->  
Azimuth 300.00 with reference 0.00 N, 0.00 E from SLOT #1

PHILLIPS PETROLEUM  
SEC.10-T32N-R8W

SAN JUAN UNIT 32-8 #5  
SLOT #1  
SAN JUAN COUNTY  
NEW MEXICO

S U R V E Y L I S T I N G

by  
Baker Hughes INTEQ

Your ref : Single Shot Survey  
Our ref : svy3753  
License :

Date printed : 22-Oct-96  
Date created : 14-Oct-96  
Last revised : 22-Oct-96

Field is centred on n36 50 0.000,w107 30 0  
Structure is centred on n36 58 22.005,w107 39 54.002

Slot location is n36 58 33.474,w107 39 33.053  
Slot Grid coordinates are N 2174566.023, E 550871.083  
Slot local coordinates are 1160.00 N 1700.00 E

Projection type: mercator - New Mexico West (3003), Spheroid: Clarke - 1866

Reference North is True North

PHILLIPS PETROLEUM  
SEC.10-T32N-R8W,SAN JUAN UNIT 32-8 #5  
SAN JUAN COUNTY,NEW MEXICO

SURVEY LISTING Page 1  
Your ref : Single Shot Survey  
Last revised : 22-Oct-96

Measured Depth	Inclin. Degrees	Azimuth Degrees	True Vert Depth	R E C T A N G U L A R C O O R D I N A T E S		Dogleg Deg/100ft	Vert Sect	
0.00	0.00	0.00	0.00	0.00 N	0.00 E	0.00	0.00	
4000.00	0.00	0.00	4000.00	0.00 N	0.00 E	0.00	0.00	
4052.00	1.21	269.30	4052.00	0.01 S	0.55 W	2.33	0.47	
4114.00	3.74	305.10	4113.94	1.15 N	2.86 W	4.59	3.05	
4173.00	7.00	304.60	4172.67	4.30 N	7.39 W	5.53	8.55	
4235.00	10.50	282.60	4233.95	7.68 N	16.02 W	7.71	17.71	
4297.00	14.75	286.60	4294.44	11.17 N	29.10 W	6.99	30.79	
4359.00	19.00	291.60	4353.76	17.14 N	46.06 W	7.24	48.46	Last BHI Survey
4553.00	17.50	293.60	4538.00	40.44 N	102.16 W	0.84	108.69	
4708.00	12.50	307.60	4687.72	60.03 N	136.83 W	3.96	148.52	
4832.00	8.75	321.60	4809.59	75.61 N	153.33 W	3.65	170.60	
5047.00	5.25	343.60	5022.99	97.88 N	166.27 W	2.02	192.94	
5359.00	2.75	359.40	5334.22	119.06 N	170.38 W	0.87	207.09	
5979.00	0.75	359.40	5953.90	137.99 N	170.58 W	0.32	216.72	Total Depth is
6020.00	0.75	359.40	5994.89	138.53 N	170.59 W	0.00	217.00	1298.5' FSL & 1529.4' FWL

All data is in feet unless otherwise stated.  
Coordinates from SLOT #1 and TVD from RKB (6650.00 Ft above mean sea level).  
Bottom hole distance is 219.75 on azimuth 309.08 degrees from wellhead.  
Vertical section is from wellhead on azimuth 300.00 degrees.  
Calculation uses the minimum curvature method.  
Presented by Baker Hughes INTEQ

PHILLIPS PETROLEUM  
 SEC.10-T32N-R8W,SAN JUAN UNIT 32-8 #5  
 SAN JUAN COUNTY,NEW MEXICO

SURVEY LISTING Page 2  
 Your ref : Single Shot Survey  
 Last revised : 22-Oct-96

				Comments in wellpath =====
MD	TVD	Rectangular Coords.		Comment
4359.00	4353.76	17.14 N	46.06 W	Last BHI Survey
5979.00	5953.90	137.99 N	170.58 W	Total Depth is
6020.00	5994.89	138.53 N	170.59 W	1298.5' FSL & 1529.4' FWL

Targets associated with this wellpath =====				
Target name	Geographic Location	T.V.D.	Rectangular Coordinates	Revised
CLIFF HOUSE 32-8 #5		5480.00	125.00N 216.51W	16-Aug-96



## **Mike Stogner**

---

**From:** Ernie Busch  
**To:** Mike Stogner  
**Subject:** PHILLIPS PETROLEUM CO SAN JUAN 32-8 UNIT #5 (NSBHL)  
**Date:** Friday, November 22, 1996 10:59AM  
**Priority:** High

SAN JUAN 32-8 UNIT #5  
1299' FSL;1529' FWL  
N-10-31N-08W  
RECOMMEND: APPROVAL

CMD :  
OG5SECT

ONGARD  
INQUIRE LAND BY SECTION

07/12/97 11:26:30  
OGOMES -EMGB  
PAGE NO: 1

Sec : 10 Twp : 31N Rng : 08W Section Type : NORMAL

D 40.00 <del>Federal owned U</del>	C 40.00 <del>Federal owned U</del>	B 40.00 Federal owned U A A	A 40.00 Federal owned U
E 40.00 <del>Federal owned U</del>	F 40.00 <del>Federal owned U</del>	G 40.00 Federal owned U	H 40.00 Federal owned U

PF01 HELP      PF02      PF03 EXIT      PF04 GoTo      PF05      PF06  
PF07 BKWD      PF08 FWD      PF09 PRINT      PF10 SDIV      PF11      PF12

CMD :  
OG5SECT

ONGARD  
INQUIRE LAND BY SECTION

07/12/97 11:26:34  
OGOMES -EMGB  
PAGE NO: 2

Sec : 10 Twp : 31N Rng : 08W Section Type : NORMAL

L 40.00 <del>Federal owned U</del>	K 40.00 <del>Federal owned U</del>	J 40.00 Federal owned U	I 40.00 Federal owned U
M 40.00 <del>Federal owned U</del>	N 40.00 <del>Federal owned U A A</del>	O 40.00 Federal owned U	P 40.00 Federal owned U

PF01 HELP      PF02      PF03 EXIT      PF04 GoTo      PF05      PF06  
PF07 BKWD      PF08 FWD      PF09 PRINT      PF10 SDIV      PF11      PF12



**PHILLIPS PETROLEUM COMPANY**

FARMINGTON, NEW MEXICO 87401  
5525 HWY. 64 NBU 3004

November 1, 1996

State of New Mexico  
Oil Conservation Division  
204 South Pacheco  
Santa Fe, New Mexico 87505

ATTN: MR. WILLIAM J. LEMAY

**RE: EXCEPTION FOR UNORTHODOX LOCATION AND FIELD RULES AND  
ADMINISTRATIVE APPROVAL OF INTENTIONAL WELL DEVIATION  
SAN JUAN 32-8 UNIT #5 WELL  
SW/4 SECTION 10-T31N-R8W,  
SAN JUAN COUNTY, NEW MEXICO  
PHILLIPS' G.F.-5465, LCN 650117**

Gentlemen:

Phillips Petroleum Company ("Phillips"), as Operator of the San Juan 32-8 Unit, requests administrative approval of the unorthodox location of the above-described #5 Well due to intentional deviation of the well.

The San Juan 32-8 Unit #5 Well was originally drilled in 1953 and completed as a Blanco Mesaverde Pool well. Enclosed is a copy of the original plats for this well which indicate the original location of 1160' FSL and 1700' FWL.

Phillips has abandoned the existing Blanco Mesaverde interval in this well, sidetracked and completed in the Blanco Mesaverde at a bottom-hole location of 1298' FSL and 1529' FWL Section 10-T31N-R8W. Enclosed are three copies of a new well location and acreage dedication plat and sub-surface directional survey confirming the well's bottom-hole location.

No offset notification of this request is required, as all offset Blanco Mesaverde spacing units are within the boundaries of the San Juan 32-8 Unit.

Please advise if additional information is required.

Very truly yours,

Patrick H. Noah  
Senior Land Specialist  
San Juan Basin  
(505) 599-3410

cc: J.L. Mathis (r) G.F. 5465  
Ernie Busch-OCD, Aztec

NEW MEXICO  
OIL CONSERVATION COMMISSION

Gas Well Plat

*file*

Date March 23, 1956

PACIFIC NORTHWEST PIPELINE CORP. 32-8 Mesa 5-10  
Operator Lease Well No.

Name of Producing Formation Mesa Verde Pool Blanco

No. Acres Dedicated to the Well 320

SECTION 10 TOWNSHIP 31N RANGE 8W

USDI	10	USDI	
PACIFIC NORTHWEST PIPELINE CORP.			
	X		

I hereby certify that the information given above is true and complete to the best of my knowledge.

Name Original signed by T. A. Dugan  
Position District Engineer  
Representing PACIFIC NORTHWEST PIPELINE CORP.  
Address 4132<sup>nd</sup>, Main, Farmington, New Mexico

(over)

U. S. G. S. -4  
B'ville -1  
Region -1  
File -1

Company Phillips Petroleum Company

Lease..... Well No.....

Sec. 10, T. 31 N., R. 8 W., N.M.P.M.

Location 1160' from the South line and 1700' from  
the West line.

Elevation 6643 Ungraded ground.

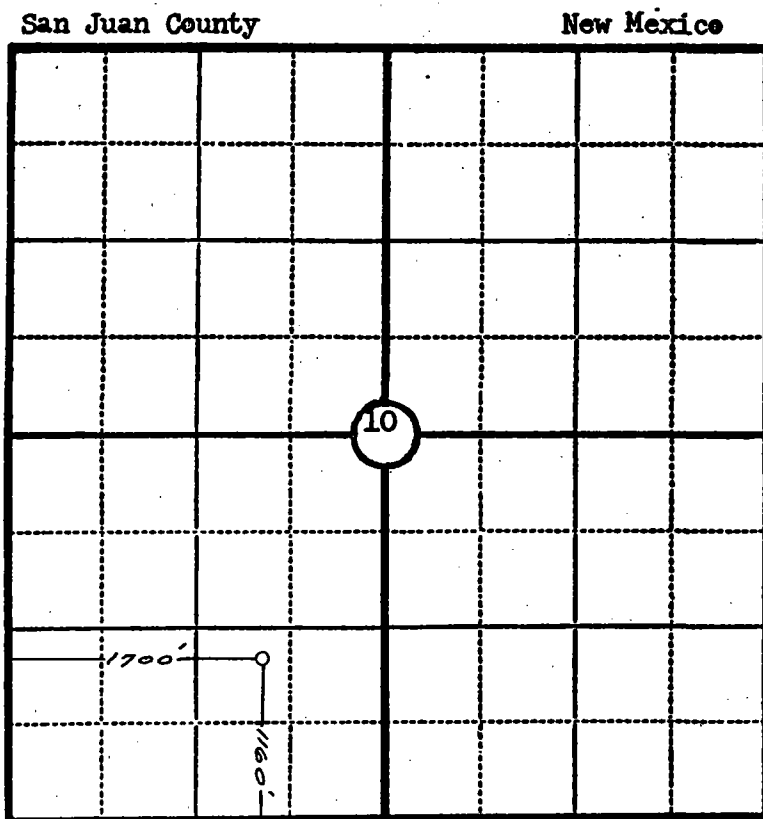

RE

SEP 1, 1953  
U. S. SURVEY  
FARMERS, N. M.

N

Scale—4 inches equal 1 mile.

This is to certify that the above plat was prepared from field notes of actual surveys made by me or under my supervision and that the same are true and correct to the best of my knowledge and belief.

Seal:

Registered Professional  
Engineer and Land Surveyor.

Ernest V. Echohawk  
N. Mex. Reg. No. 1545

Surveyed September 10, 1953

District I  
PO Box 1980, Hobbs, NM 88241-1980  
District II  
811 South First, Artesia, NM 88210  
District III  
1000 Rio Brazos Rd., Aztec, NM 87410  
District IV  
2040 South Pacheco, Santa Fe, NM 87505

State of New Mexico  
Energy, Minerals & Natural Resources Department

OIL CONSERVATION DIVISION  
2040 South Pacheco  
Santa Fe, NM 87505

Form C-102  
Revised October 18, 1994  
Instructions on back  
Submit to Appropriate District Office  
State Lease - 4 Copies  
Fee Lease - 3 Copies

☐ AMENDED REPORT

WELL LOCATION AND ACREAGE DEDICATION PLAT

1 API Number 30-045-1-850		2 Pool Code 72319		3 Pool Name Blanco Mesaverde	
4 Property Code 009261		5 Property Name San Juan 32-8 Unit			6 Well Number #5
7 OGRID No. 017654		8 Operator Name Phillips Petroleum Company			9 Elevation 6643' GL

10 Surface Location

UL or lot no.	Section	Township	Range	Lot Idn	Feet from the	North/South line	Feet from the	East/West line	County
N	10	31N	8W		1160	South	1700	West	San Juan

11 Bottom Hole Location If Different From Surface

UL or lot no.	Section	Township	Range	Lot Idn	Feet from the	North/South line	Feet from the	East/West line	County
N	10	31N	8W		1298.5	South	1529	West	San Juan

12 Dedicated Acres	13 Joint or Infill	14 Consolidation Code	15 Order No.
320 acrs.	N	U	

NO ALLOWABLE WILL BE ASSIGNED TO THIS COMPLETION UNTIL ALL INTERESTS HAVE BEEN CONSOLIDATED  
OR A NON-STANDARD UNIT HAS BEEN APPROVED BY THE DIVISION

<p>16</p>	<p>17 OPERATOR CERTIFICATION</p> <p>I hereby certify that the information contained herein is true and complete to the best of my knowledge and belief</p> <p><i>Richard Allred</i></p> <p>Signature Richard Allred Printed Name Prod. Superintendent Title 11-4-96 Date</p>
	<p>18 SURVEYOR CERTIFICATION</p> <p>I hereby certify that the well location shown on this plat was plotted from field notes of actual surveys made by me or under my supervision, and that the same is true and correct to the best of my belief.</p> <p>October 13, 1996 Date of Survey Signature and Seal of Professional Surveyer:  Certificate Number</p>



1700 Broadway Suite 1450 Denver Colorado 80290  
(303) 860-0509 Fax (303) 830-2546

# REPORT OF SUB-SURFACE DIRECTIONAL SURVEY

Phillips Petroleum  
COMPANY

San Juan Unit 32-8 #5  
WELL NAME

San Juan County, New Mexico  
LOCATION

JOB NUMBER  
410-80548

TYPE OF SURVEY  
MSS

DATE  
October 13, 1996

SURVEYED BY  
Max Lund

OFFICE  
DENVER



1700 Broadway Suite 1450 Denver Colorado 80290  
(303) 860-0509 Fax (303) 830-2546

## SURVEY CERTIFICATION SHEET

Phillips Petroleum

Company

Sec-10-T32N-R8W

Lease

410-80548

Job #

San Juan Unit 32-8 #5

Well #

October 13, 1996

Date

San Juan County, New Mexico

County and State

Surveyed from a depth of 4,003 feet to 4,359 feet MD

Type of Survey MSS

Directional Supervisor/Surveyor Max Lund

The data and calculations for this survey have been checked by me and conform to the standards and procedures set forth by Baker Hughes INTEQ. This report represents a true and correct Directional Survey of this well based on the original data obtained at the well site. Wellbore Coordinates are calculated using minimum curvature.

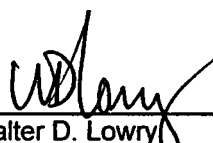
  
\_\_\_\_\_  
Walter D. Lowry  
Sr. Drilling Engineer

This document has been subscribed and affirmed, or sworn to before me in the county of Denver, state of Colorado, this 22nd day of October, 1996.

  
\_\_\_\_\_  
Notary My commission expires August 4, 2000

Certification Number: 431  
Certification Date: October 22, 1996



# PHILLIPS PETROLEUM

Structure : SEC.10-T32N-R8W Well : SAN JUAN UNIT 32-8 #5

Field : SAN JUAN COUNTY

Location : NEW MEXICO

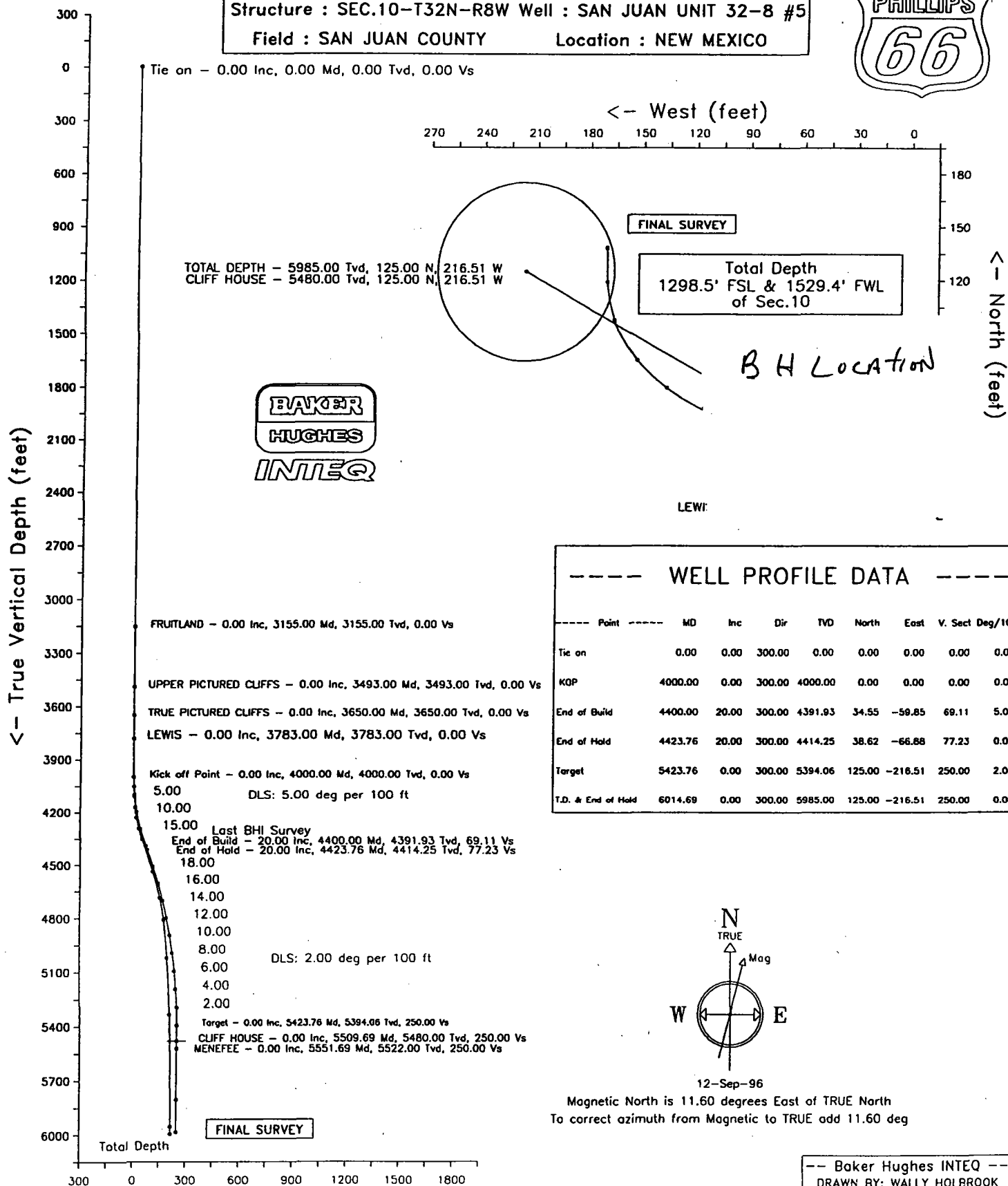

## WELL PROFILE DATA

Point	MD	Inc	Dir	TVD	North	East	V. Sect	Deg/100
Tie on	0.00	0.00	300.00	0.00	0.00	0.00	0.00	0.00
KOP	4000.00	0.00	300.00	4000.00	0.00	0.00	0.00	0.00
End of Build	4400.00	20.00	300.00	4391.93	34.55	-59.85	69.11	5.00
End of Hold	4423.76	20.00	300.00	4414.25	38.62	-66.88	77.23	0.00
Target	5423.76	0.00	300.00	5394.06	125.00	-216.51	250.00	2.00
T.D. & End of Hold	6014.69	0.00	300.00	5985.00	125.00	-216.51	250.00	0.00

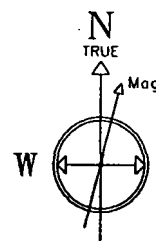

12-Sep-96

Magnetic North is 11.60 degrees East of TRUE North  
To correct azimuth from Magnetic to TRUE add 11.60 deg

-- Baker Hughes INTEQ --  
DRAWN BY: WALLY HOLBROOK  
DATE: OCT. 22, 1996  
TVD REFERENCED RKB  
DENVER, COLORADO  
PHONE: (303) 860-0509

PHILLIPS PETROLEUM  
SEC.10-T32N-R8W

SAN JUAN UNIT 32-8 #5  
SLOT #1  
SAN JUAN COUNTY  
NEW MEXICO

S U R V E Y L I S T I N G

by  
Baker Hughes INTEQ

Your ref : Single Shot Survey  
Our ref : svy3753  
License :

Date printed : 22-Oct-96  
Date created : 14-Oct-96  
Last revised : 22-Oct-96

Field is centred on n36 50 0.000,w107 30 0  
Structure is centred on n36 58 22.005,w107 39 54.002

Slot location is n36 58 33.474,w107 39 33.053  
Slot Grid coordinates are N 2174566.023, E 550871.083  
Slot local coordinates are 1160.00 N 1700.00 E

Projection type: mercator - New Mexico West (3003), Spheroid: Clarke - 1866

Reference North is True North

PHILLIPS PETROLEUM  
SEC.10-T32N-R8W,SAN JUAN UNIT 32-8 #5  
SAN JUAN COUNTY,NEW MEXICO

SURVEY LISTING Page 1  
Your ref : Single Shot Survey  
Last revised : 22-Oct-96

Measured Depth	Inclin. Degrees	Azimuth Degrees	True Vert Depth	R E C T A N G U L A R C O O R D I N A T E S		Dogleg Deg/100ft	Vert Sect	
0.00	0.00	0.00	0.00	0.00 N	0.00 E	0.00	0.00	
4000.00	0.00	0.00	4000.00	0.00 N	0.00 E	0.00	0.00	
4052.00	1.21	269.30	4052.00	0.01 S	0.55 W	2.33	0.47	
4114.00	3.74	305.10	4113.94	1.15 N	2.86 W	4.59	3.05	
4173.00	7.00	304.60	4172.67	4.30 N	7.39 W	5.53	8.55	
4235.00	10.50	282.60	4233.95	7.68 N	16.02 W	7.71	17.71	
4297.00	14.75	286.60	4294.44	11.17 N	29.10 W	6.99	30.79	
4359.00	19.00	291.60	4353.76	17.14 N	46.06 W	7.24	48.46	Last BHI Survey
4553.00	17.50	293.60	4538.00	40.44 N	102.16 W	0.84	108.69	
4708.00	12.50	307.60	4687.72	60.03 N	136.83 W	3.96	148.52	
4832.00	8.75	321.60	4809.59	75.61 N	153.33 W	3.65	170.60	
5047.00	5.25	343.60	5022.99	97.88 N	166.27 W	2.02	192.94	
5359.00	2.75	359.40	5334.22	119.06 N	170.38 W	0.87	207.09	
5979.00	0.75	359.40	5953.90	137.99 N	170.58 W	0.32	216.72	Total Depth is
6020.00	0.75	359.40	5994.89	138.53 N	170.59 W	0.00	217.00	1298.5' FSL & 1529.4' FWL

All data is in feet unless otherwise stated.  
Coordinates from SLOT #1 and TVD from RKB (6650.00 Ft above mean sea level).  
Bottom hole distance is 219.75 on azimuth 309.08 degrees from wellhead.  
Vertical section is from wellhead on azimuth 300.00 degrees.  
Calculation uses the minimum curvature method.  
Presented by Baker Hughes INTEQ

PHILLIPS PETROLEUM  
 SEC.10-T32N-R8W,SAN JUAN UNIT 32-8 #5  
 SAN JUAN COUNTY,NEW MEXICO

SURVEY LISTING Page 2  
 Your ref : Single Shot Survey  
 Last revised : 22-Oct-96

				Comments in wellpath
				=====
MD	TVD	Rectangular Coords.		Comment
-----				
4359.00	4353.76	17.14 N	46.06 W	Last BHI Survey
5979.00	5953.90	137.99 N	170.58 W	Total Depth is
6020.00	5994.89	138.53 N	170.59 W	1298.5' FSL & 1529.4' FWL

Targets associated with this wellpath				
=====				
Target name	Geographic Location	T.V.D.	Rectangular Coordinates	Revised
-----				
CLIFF HOUSE 32-8 #5		5480.00	125.00N 216.51W	16-Aug-96



**PHILLIPS PETROLEUM COMPANY**

FARMINGTON, NEW MEXICO 87401  
5525 HWY. 64 NBU 3004

November 1, 1996

State of New Mexico  
Oil Conservation Division  
204 South Pacheco  
Santa Fe, New Mexico 87505

ATTN: MR. WILLIAM J. LEMAY

**RE: EXCEPTION FOR UNORTHODOX LOCATION AND FIELD RULES AND  
ADMINISTRATIVE APPROVAL OF INTENTIONAL WELL DEVIATION  
SAN JUAN 32-8 UNIT #5 WELL  
SW/4 SECTION 10-T31N-R8W,  
SAN JUAN COUNTY, NEW MEXICO  
PHILLIPS' G.F.-5465, LCN 650117**

Gentlemen:

Phillips Petroleum Company ("Phillips"), as Operator of the San Juan 32-8 Unit, requests administrative approval of the unorthodox location of the above-described #5 Well due to intentional deviation of the well.

The San Juan 32-8 Unit #5 Well was originally drilled in 1953 and completed as a Blanco Mesaverde Pool well. Enclosed is a copy of the original plats for this well which indicate the original location of 1160' FSL and 1700' FWL.

Phillips has abandoned the existing Blanco Mesaverde interval in this well, sidetracked and completed in the Blanco Mesaverde at a bottom-hole location of 1298' FSL and 1529' FWL Section 10-T31N-R8W. Enclosed are three copies of a new well location and acreage dedication plat and sub-surface directional survey confirming the well's bottom-hole location.

No offset notification of this request is required, as all offset Blanco Mesaverde spacing units are within the boundaries of the San Juan 32-8 Unit.

Please advise if additional information is required.

Very truly yours,

Patrick H. Noah  
Senior Land Specialist  
San Juan Basin  
(505) 599-3410

cc: J.L. Mathis (r) G.F. 5465  
Ernie Busch-OCD, Aztec

NEW MEXICO  
OIL CONSERVATION COMMISSION

*file*  
Gas Well Plat

Date March 23, 1956

PACIFIC NORTHWEST PIPELINE CORP. 32-8 Mesa 5-10  
Operator Lease Well No.

Name of Producing Formation Mesa Verde Pool Blanco

No. Acres Dedicated to the Well 320

SECTION 10 TOWNSHIP 31N RANGE 8W

USDI	10	USDI	
PACIFIC NORTHWEST PIPELINE CORP.			
	X		

I hereby certify that the information given above is true and complete to the best of my knowledge.

Name Original signed by T. A. Dugan  
Position District Engineer  
Representing PACIFIC NORTHWEST PIPELINE CORP.  
Address 4132w, Main, Farmington, New Mexico

(over)

Surveyed September 10, 1953

District I  
PO Box 1980, Hobbs, NM 88241-1980  
District II  
811 South First, Artesia, NM 88210  
District III  
1000 Rio Brazos Rd., Aztec, NM 87410  
District IV  
2040 South Pacheco, Santa Fe, NM 87505

State of New Mexico  
Energy, Minerals & Natural Resources Department

OIL CONSERVATION DIVISION  
2040 South Pacheco  
Santa Fe, NM 87505

Form C-102  
Revised October 18, 1994  
Instructions on back  
Submit to Appropriate District Office  
State Lease - 4 Copies  
Fee Lease - 3 Copies

☐ AMENDED REPORT

WELL LOCATION AND ACREAGE DEDICATION PLAT

1 API Number 30-045-1-850		2 Pool Code 72319		3 Pool Name Blanco Mesaverde		
4 Property Code 009261		5 Property Name San Juan 32-8 Unit			6 Well Number #5	
7 OGRID No. 017654		8 Operator Name Phillips Petroleum Company			9 Elevation 6643' GL	

10 Surface Location

UL or lot no.	Section	Township	Range	Lot Idn	Feet from the	North/South line	Feet from the	East/West line	County
N	10	31N	8W		1160	South	1700	West	San Juan

11 Bottom Hole Location If Different From Surface

UL or lot no.	Section	Township	Range	Lot Idn	Feet from the	North/South line	Feet from the	East/West line	County
N	10	31N	8W		1298.5	South	1529	West	San Juan

12 Dedicated Acres 320 acrs.	13 Joint or Infill N	14 Consolidation Code U	15 Order No.
---------------------------------	-------------------------	----------------------------	--------------

NO ALLOWABLE WILL BE ASSIGNED TO THIS COMPLETION UNTIL ALL INTERESTS HAVE BEEN CONSOLIDATED  
OR A NON-STANDARD UNIT HAS BEEN APPROVED BY THE DIVISION

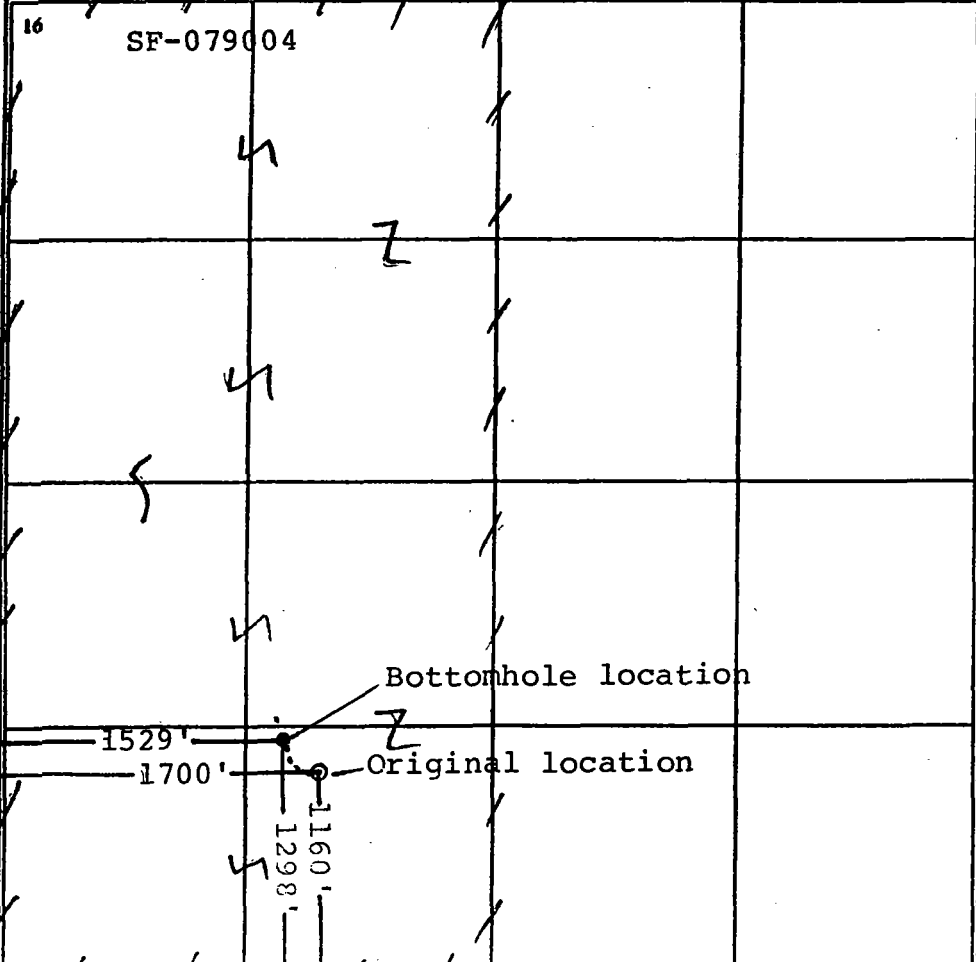
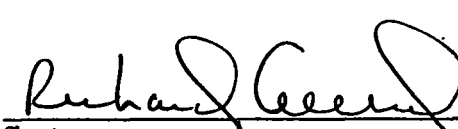
	<p>17 OPERATOR CERTIFICATION</p> <p>I hereby certify that the information contained herein is true and complete to the best of my knowledge and belief</p> <p></p> <p>Signature Richard Allred Printed Name Prod. Superintendent Title 11-4-96 Date</p>
	<p>18 SURVEYOR CERTIFICATION</p> <p>I hereby certify that the well location shown on this plat was plotted from field notes of actual surveys made by me or under my supervision, and that the same is true and correct to the best of my belief.</p> <p>October 13, 1996 Date of Survey Signature and Seal of Professional Surveyer:  Certificate Number</p>





1700 Broadway Suite 1450 Denver Colorado 80290  
(303) 860-0509 Fax (303) 830-2546

# REPORT OF SUB-SURFACE DIRECTIONAL SURVEY

Phillips Petroleum  
COMPANY

San Juan Unit 32-8 #5  
WELL NAME

San Juan County, New Mexico  
LOCATION

JOB NUMBER  
410-80548

TYPE OF SURVEY  
MSS

DATE  
October 13, 1996

SURVEYED BY  
Max Lund

OFFICE  
DENVER



1700 Broadway Suite 1450 Denver Colorado 80290  
(303) 860-0509 Fax (303) 830-2546

## SURVEY CERTIFICATION SHEET

Phillips Petroleum

Company

Sec-10-T32N-R8W

Lease

410-80548

Job #

San Juan Unit 32-8 #5

Well #

October 13, 1996

Date

San Juan County, New Mexico

County and State

Surveyed from a depth of 4,003 feet to 4,359 feet MD

Type of Survey MSS

Directional Supervisor/Surveyor Max Lund

The data and calculations for this survey have been checked by me and conform to the standards and procedures set forth by Baker Hughes INTEQ. This report represents a true and correct Directional Survey of this well based on the original data obtained at the well site. Wellbore Coordinates are calculated using minimum curvature.

Walter D. Lowry  
Sr. Drilling Engineer

This document has been subscribed and affirmed, or sworn to before me in the county of Denver, state of Colorado, this 22nd day of October, 1996.

Notary

My commission expires August 4, 2000

Certification Number: 431  
Certification Date: October 22, 1996

# PHILLIPS PETROLEUM

Structure : SEC.10-T32N-R8W Well : SAN JUAN UNIT 32-8 #5

Field : SAN JUAN COUNTY

Location : NEW MEXICO

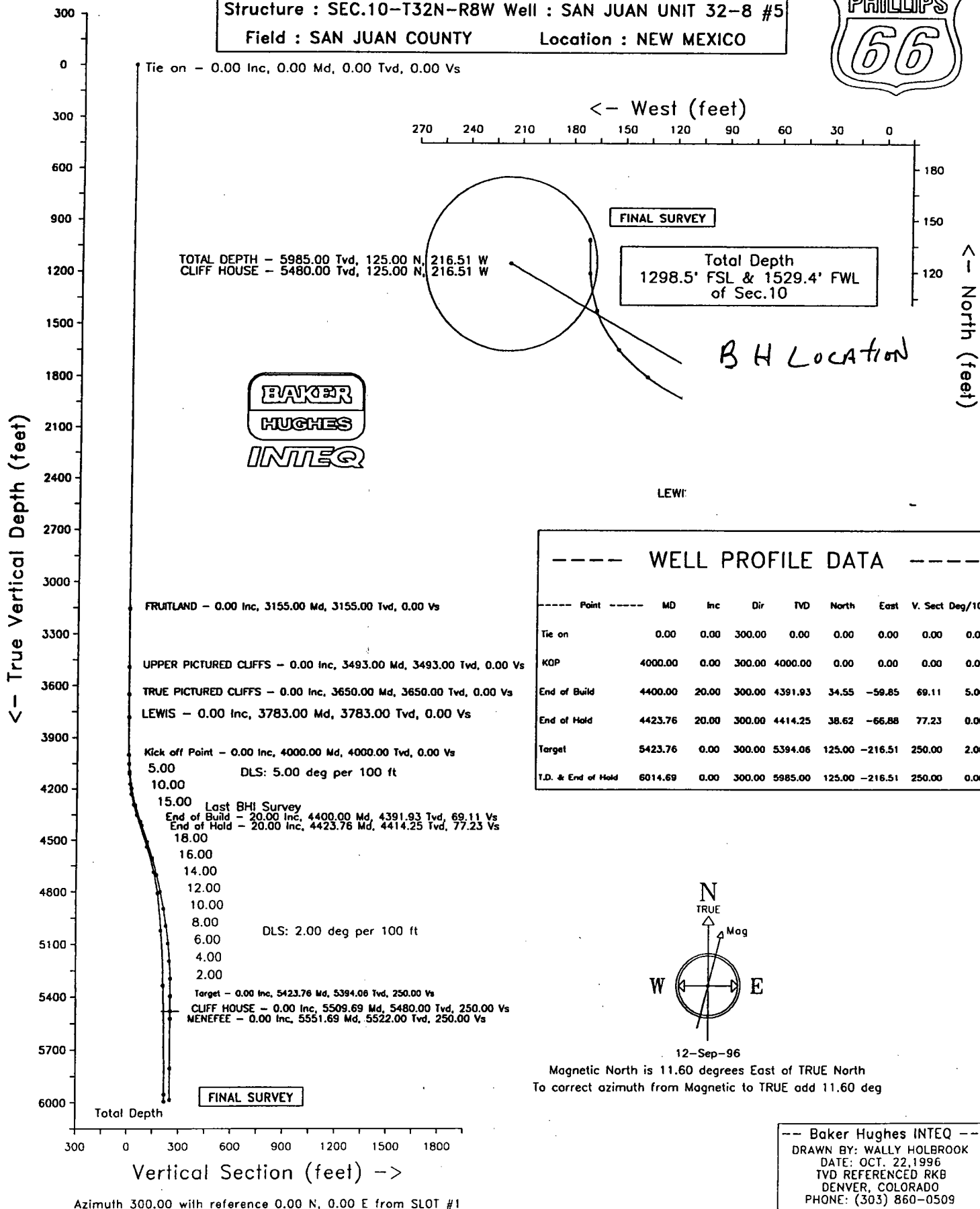

PHILLIPS PETROLEUM  
SEC.10-T32N-R8W

SAN JUAN UNIT 32-8 #5  
SLOT #1  
SAN JUAN COUNTY  
NEW MEXICO

S U R V E Y   L I S T I N G

by  
Baker Hughes INTEQ

Your ref : Single Shot Survey  
Our ref : svy3753  
License :

Date printed : 22-Oct-96  
Date created : 14-Oct-96  
Last revised : 22-Oct-96

Field is centred on n36 50 0.000,w107 30 0  
Structure is centred on n36 58 22.005,w107 39 54.002

Slot location is n36 58 33.474,w107 39 33.053  
Slot Grid coordinates are N 2174566.023, E 550871.083  
Slot local coordinates are 1160.00 N 1700.00 E

Projection type: mercator - New Mexico West (3003), Spheroid: Clarke - 1866

Reference North is True North

PHILLIPS PETROLEUM  
SEC.10-T32N-R8W,SAN JUAN UNIT 32-8 #5  
SAN JUAN COUNTY,NEW MEXICO

SURVEY LISTING Page 1  
Your ref : Single Shot Survey  
Last revised : 22-Oct-96

Measured Depth	Inclin. Degrees	Azimuth Degrees	True Vert Depth	R E C T A N G U L A R C O O R D I N A T E S		Dogleg Deg/100ft	Vert Sect
0.00	0.00	0.00	0.00	0.00 N	0.00 E	0.00	0.00
4000.00	0.00	0.00	4000.00	0.00 N	0.00 E	0.00	0.00
4052.00	1.21	269.30	4052.00	0.01 S	0.55 W	2.33	0.47
4114.00	3.74	305.10	4113.94	1.15 N	2.86 W	4.59	3.05
4173.00	7.00	304.60	4172.67	4.30 N	7.39 W	5.53	8.55
4235.00	10.50	282.60	4233.95	7.68 N	16.02 W	7.71	17.71
4297.00	14.75	286.60	4294.44	11.17 N	29.10 W	6.99	30.79
4359.00	19.00	291.60	4353.76	17.14 N	46.06 W	7.24	48.46
4553.00	17.50	293.60	4538.00	40.44 N	102.16 W	0.84	108.69
4708.00	12.50	307.60	4687.72	60.03 N	136.83 W	3.96	148.52
4832.00	8.75	321.60	4809.59	75.61 N	153.33 W	3.65	170.60
5047.00	5.25	343.60	5022.99	97.88 N	166.27 W	2.02	192.94
5359.00	2.75	359.40	5334.22	119.06 N	170.38 W	0.87	207.09
5979.00	0.75	359.40	5953.90	137.99 N	170.58 W	0.32	216.72
6020.00	0.75	359.40	5994.89	138.53 N	170.59 W	0.00	217.00

Last BHI Survey

Total Depth is 1298.5' FSL & 1529.4' FWL

All data is in feet unless otherwise stated.  
Coordinates from SLOT #1 and TVD from RKB (6650.00 Ft above mean sea level).  
Bottom hole distance is 219.75 on azimuth 309.08 degrees from wellhead.  
Vertical section is from wellhead on azimuth 300.00 degrees.  
Calculation uses the minimum curvature method.  
Presented by Baker Hughes INTEQ



PHILLIPS PETROLEUM  
SEC.10-T32N-R8W,SAN JUAN UNIT 32-8 #5  
SAN JUAN COUNTY,NEW MEXICO

SURVEY LISTING Page 2  
Your ref : Single Shot Survey  
Last revised : 22-Oct-96

				Comments in wellpath
				=====
MD	TVD	Rectangular Coords.		Comment
-----				
4359.00	4353.76	17.14 N	46.06 W	Last BHI Survey
5979.00	5953.90	137.99 N	170.58 W	Total Depth is
6020.00	5994.89	138.53 N	170.59 W	1298.5' FSL & 1529.4' FWL

Targets associated with this wellpath				
=====				
Target name	Geographic Location	T.V.D.	Rectangular Coordinates	Revised
-----				
CLIFF HOUSE 32-8 #5		5480.00	125.00N 216.51W	16-Aug-96