

4/28/99	5/18/99	DC	MV	DHC
---------	---------	----	----	-----

ABOVE THIS LINE FOR DIVISION USE ONLY

NEW MEXICO OIL CONSERVATION DIVISION  
- Engineering Bureau -

2342

ADMINISTRATIVE APPLICATION COVERSHEET

THIS COVERSHEET IS MANDATORY FOR ALL ADMINISTRATIVE APPLICATIONS FOR EXCEPTIONS TO DIVISION RULES AND REGULATIONS

Application Acronyms:

[NSP-Non-Standard Proration Unit] [NSL-Non-Standard Location]  
[DD-Directional Drilling] [SD-Simultaneous Dedication]  
[DHC-Downhole Commingling] [CTB-Lease Commingling] [PLC-Pool/Lease Commingling]  
[PC-Pool Commingling] [OLS - Off-Lease Storage] [OLM-Off-Lease Measurement]  
[WFX-Waterflood Expansion] [PMX-Pressure Maintenance Expansion]  
[SWD-Salt Water Disposal] [IPI-Injection Pressure Increase]  
[EOR-Qualified Enhanced Oil Recovery Certification] [PPR-Positive Production Response]

[1] TYPE OF APPLICATION - Check Those Which Apply for [A]

[A] Location - Spacing Unit - Directional Drilling  
☐ NSL ☐ NSP ☐ DD ☐ SD

Check One Only for [B] or [C]

[B] Commingling - Storage - Measurement  
☒ DHC ☐ CTB ☐ PLC ☐ PC ☐ OLS ☐ OLM

[C] Injection - Disposal - Pressure Increase - Enhanced Oil Recovery  
☐ WFX ☐ PMX ☐ SWD ☐ IPI ☐ EOR ☐ PPR

APR 28 1999

[2] NOTIFICATION REQUIRED TO: - Check Those Which Apply, or ☐ Does Not Apply

[A] ☐ Working, Royalty or Overriding Royalty Interest Owners

[B] ☐ Offset Operators, Leaseholders or Surface Owner

[C] ☐ Application is One Which Requires Published Legal Notice

[D] ☐ Notification and/or Concurrent Approval by BLM or SLO  
U.S. Bureau of Land Management - Commissioner of Public Lands, State Land Office

[E] ☐ For all of the above, Proof of Notification or Publication is Attached, and/or,

[F] ☐ Waivers are Attached

[3] INFORMATION / DATA SUBMITTED IS COMPLETE - Statement of Understanding

I hereby certify that I, or personnel under my supervision, have read and complied with all applicable Rules and Regulations of the Oil Conservation Division. Further, I assert that the attached application for administrative approval is accurate and complete to the best of my knowledge and where applicable, verify that all interest (WI, RI, ORRI) is common. I further verify that all applicable API Numbers are included. I understand that any omission of data, information or notification is cause to have the application package returned with no action taken.

Note: Statement must be completed by an individual with supervisory capacity.

J. DENISE LEAKE

J. Denise Leake 4-26-99

Print or Type Name



Texaco E & P

205 E. Bender Blvd.  
Hobbs NM 88240  
505 393 7191

April 23, 1999

GOV-STATE AND LOCAL GOVERNMENTS  
EXCEPTION TO NMOCD RULE 303(A)

Application to DHC

Teague Tubb North Assoc. and Teague Drinkard-Abo North Assoc.

B.F. Harrison "B" #17

Unit Letter D, Sec. 9, T23S, R37E, 990' FNL, and 910' FWL

API #: 30-025-32497

Lea County, NM

State of New Mexico  
Energy and Minerals Department  
Oil Conservation Commission  
2040 South Pacheco  
Santa Fe, NM 87505

Attention: Mr. Ben Stone

(96313)

(96315) Texaco Exploration and Production Inc., respectfully requests approval to downhole commingle the North Teague Tubb (Assoc.) and the North Teague Drinkard-Abo North (~~Assoc.~~) pool within the subject wellbore. A copy of this application has notified offset operators. The royalty is common in all zones.

The proposed downhole commingling will provide a more economical means of production. It will allow complete development of the productive capacity on the subject lease by allowing both intervals to be artificially lifted simultaneously. This will extend the productive life of both completions, thereby preventing waste.

The subject well meets all of the requirements as set forth by rule 303(C). In addition, it should be noted that all produced fluids have entered a common production facility with no fluid compatibility problems.

It is requested that the allocation of production for each zone be based on well tests obtained from the Teague Tubb Pool and Drinkard/Abo Pool before DHC.

If you have any questions concerning this application, please contact Denise Leake at (505)397-0405, or Denise Wann at (505)397-0425.

Yours Truly,  
*Denise Wann*  
Denise Wann  
Production Engineer  
Eunice FMT

**EXHIBIT "B" - CASE NO. 11353, ORDER NO. R-10470-A**

P.O. Box 1980, Hobbs, NM 88240

B11 South First St., Azusa, NM 88210

1000 Rio Grande Rd. Altos, NM 87410

OIL CONSERVATION DIVISION

**2040 S. Pacheco  
Santa Fe, New Mexico 87505-8429**

Form C-107-A  
New 3-12-96

**APPROVAL PROCESS:**

X Administrative Hearing

### EXISTING WELLBORE

X      YES      NO

# APPLICATION FOR DOWNHOLE COMMINGLING

Texaco Exploration & Producing Inc.	205 East Bender	Hobbs, New Mexico 88240
Operator	Address	

B.F. Harrison "B" 17 D Sec 9, T23S, R37E Lea  
Lease Well No. Unit Ltr. - Sec - Tws - Rge County  
OGRID NO. 022351 Property Code 10960 API NO. 3002532497 Federal \_\_\_\_\_, State \_\_\_\_\_, (and/or) Fee XX  
Spacing Unit Lease Types: (check 1 or more)

The following facts are submitted in support of downhole commingling:	Lower Zone	Intermediate Zone	Upper Zone
1. Pool Name and Pool Code	North Teague Drinkard-Abo ( <del>AssoC.</del> )		North Teague Tubb (AssoC.)
2. Top And Bottom of Pay Section (Perforations)	6336'-7036'		6074'-6198'
3. Type of production (Oil or Gas)	Oil		Oil
4. Method of Production (Flowing or Artificial Lift)	Flowing (Current)		Flowing w/PL
5. Bottomhole Pressure Oil Zones - Artificial Lift: Estimated Current	415#	a.	410#
Gas & Oil - Flowing: Measured Current	(Original) b.	b.	b.
All Gas Zones: Estimated Or Measured Original			
6. Oil Gravity (* API) or Gas BTU Content			
7. Producing or Shut-In? Production Marginal? (yes or no)	Producing		Producing
* If Shut-In, give date and oil/gas/ water rates of last production Note: For new zones with no production history, applicant shall be required to attach production estimates and supporting data	Date: Rates:		
* If Producing, give date and oil/gas/ water rates of recent test (within 60 days)	Date: 3/18/99 Rates: 11 Oil, 0 Wtr, 571 Gas		3/13/99 3 Oil, 0 Wtr, 184 Gas
8. Fixed Percentage Allocation Formula -% for each zone	Oil: % 79 Gas: % 76	Oil: % Gas: %	Oil: % 21 Gas: % 24

9. If allocation Formula is based upon something other than current or past production, or is based upon some other method, submit attachments with supporting data and/or explaining method and providing rate projections or other required data.
10. Are all working, overriding, and royalty interests identical in all commingled zones? Yes XX No  
If not, have all working, overriding, and royalty interests been notified by certified mail?      Yes      No  
Have all offset operators been given written notice of the proposed downhole commingling? XX Yes      No
11. Will cross-flow occur?      Yes XX No If yes, are fluids compatible, will the Formations not be damaged, will any cross-flowed production be recovered, and will the allocation formula be reliable.      Yes      No (If No, attach explanation)
12. Are all produced fluids from all commingled zones compatible with other? XX Yes      No
13. Will the value of production be decreased by commingling?      Yes XX No (If Yes, attach explanation)
14. If this well is on, or communitized with, state or federal lands, either the Commissioner of Public Land or the United States Bureau of Land Management has been notified in writing of this application. XX Yes      No
15. NMOCD Reference Cases for Rule 303(C) Exceptions: ORDER NO(S). \_\_\_\_\_
16. ATTACHMENTS:

- \* C-102 for each zone to be commingled showing its spacing unit and acreage dedication.
- \* Production curve for each zone for at least one year. (If not available, attach explanation.)
- \* For zones with no production history, estimated production rates and supporting data.
- \* Notification list of all offset operators.
- \* Notification list of working, overriding, and royalty interests for uncommon interest cases.
- \* Any additional statements, data or documents required to support commingling.

I hereby certify that the information above is true and complete to the best of my knowledge and belief

SIGNATURE Denise Wann TITLE Pet. Engr. DATE 4/26/99  
TYPE OR PRINT NAME Denise Wann TELEPHONE NO. (505) 397-0425

## DISTRICT I

P.O. Box 1980, Hobbs, NM 88241-1980

## DISTRICT II

P.O. Box Drawer DD, Artesia, NM 88211-0719

## DISTRICT III

1000 Rio Brazos Rd., Aztec, NM 87410

## DISTRICT IV

P.O. Box 2088, Santa Fe, NM 87504-2088

State of New Mexico

Energy, Minerals and Natural Resources Department

## OIL CONSERVATION DIVISION

P.O. Box 2088

Santa Fe, New Mexico 87504-2088

Form C-102

Revised February 10, 1994

Instructions on back

Submit to Appropriate District Office

State Lease - 4 Copies

Fee Lease - 3 Copies

☐ AMENDED REPORT

## WELL LOCATION AND ACREAGE DEDICATION PLAT

<sup>1</sup> API Number 30 025 32497	<sup>2</sup> Pool Code 96313	<sup>3</sup> Pool Name N. Teague Drinkard - Abo
<sup>4</sup> Property Code 10960	<sup>5</sup> Property Name HARRISON, B. F. 'B'	<sup>6</sup> Well No. 17
<sup>7</sup> OGRID Number 022351	<sup>8</sup> Operator Name TEXACO EXPLORATION & PRODUCTION INC.	<sup>9</sup> Elevation 3318'

<sup>10</sup> Surface Location

UI or lot no.	Section	Township	Range	Lot.Idn	Feet From The	North/South Line	Feet From The	East/West Line	County
D	9	23-S	37-E		990	NORTH	910	WEST	LEA

<sup>11</sup> Bottom Hole Location If Different From Surface

UI or lot no.	Section	Township	Range	Lot.Idn	Feet From The	North/South Line	Feet From The	East/West Line	County

<sup>12</sup> Dedicated Acres 40	<sup>13</sup> Joint or Infill No	<sup>14</sup> Consolidation Code	<sup>15</sup> Order No.
-------------------------------------	-------------------------------------	----------------------------------	-------------------------

NO ALLOWABLE WILL BE ASSIGNED TO THIS COMPLETION UNTIL ALL INTERESTS HAVE BEEN CONSOLIDATED  
OR A NON-STANDARD UNIT HAS BEEN APPROVED BY THE DIVISION

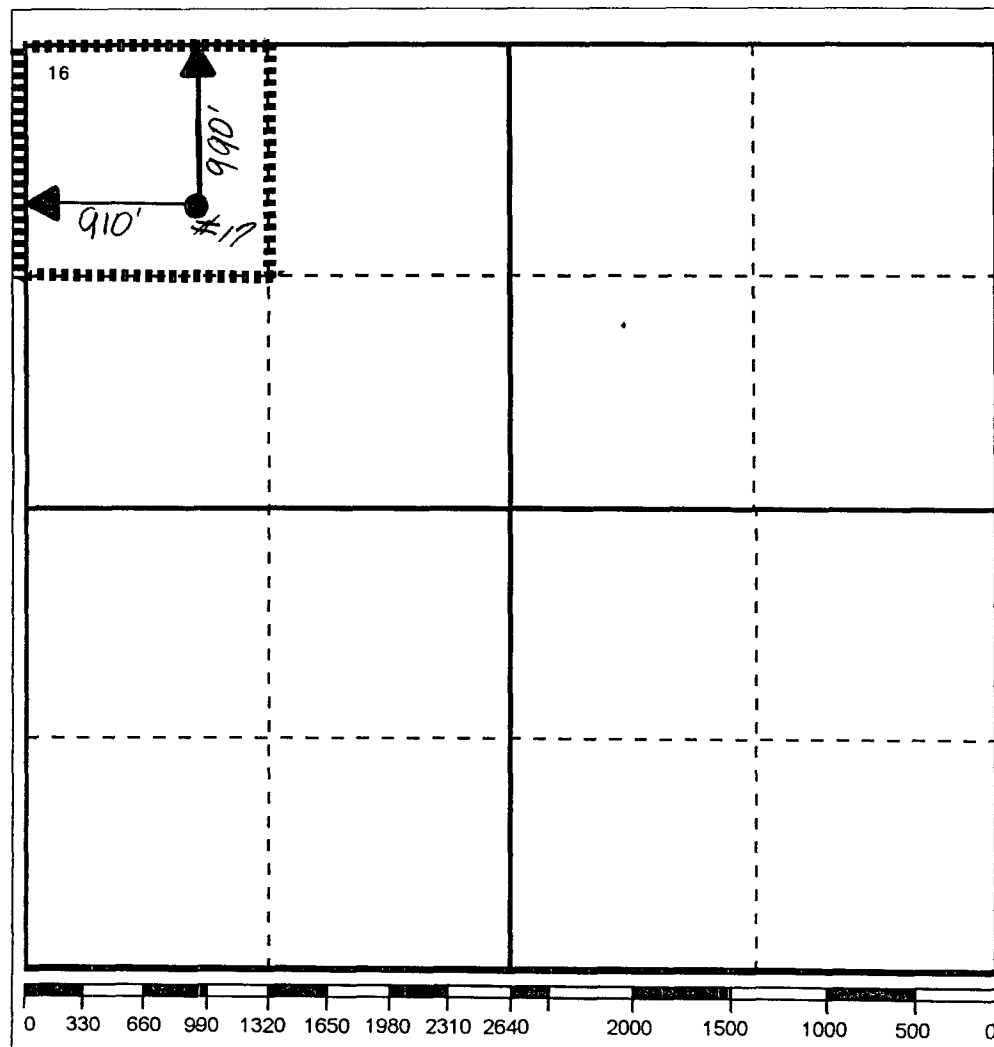

## 17 OPERATOR CERTIFICATION

I hereby certify that the information contained herein is true and complete to the best of my knowledge and belief

Signature

Printed Name

J. Denise Leake

Position

Engineering Assistant

Date

4/23/99

## 18 SURVEYOR CERTIFICATION

I hereby certify that the well location shown on this plat was plotted from field notes of actual surveys made by me or under my supervision, and that the same is true and correct to the best of my knowledge and belief.

Date Surveyed

Signature & Seal of  
Professional Surveyor

Certificate No.

## DISTRICT I

P.O. Box 1980, Hobbs, NM 88241-1980

## DISTRICT II

P.O. Box Drawer DD, Artesia, NM 88211-0719

## DISTRICT III

1000 Rio Brazos Rd., Aztec, NM 87410

## DISTRICT IV

P.O. Box 2088, Santa Fe, NM 87504-2088

State of New Mexico

Energy, Minerals and Natural Resources Department

Form C-102

Revised February 10, 1994

Instructions on back

Submit to Appropriate District Office

State Lease - 4 Copies

Fee Lease - 3 Copies

☐ AMENDED REPORT

## OIL CONSERVATION DIVISION

P.O. Box 2088

Santa Fe, New Mexico 87504-2088

## WELL LOCATION AND ACREAGE DEDICATION PLAT

<sup>1</sup> API Number 30 025 32497	<sup>2</sup> Pool Code 96315	<sup>3</sup> Pool Name Teague; Tubb, North (Assoc.)
<sup>4</sup> Property Code 10960	<sup>5</sup> Property Name HARRISON, B. F. 'B'	<sup>6</sup> Well No. 17
<sup>7</sup> OGRID Number 022351	<sup>8</sup> Operator Name TEXACO EXPLORATION & PRODUCTION INC.	<sup>9</sup> Elevation 3318'

<sup>10</sup> Surface Location

UI or lot no.	Section	Township	Range	Lot.Idn	Feet From The	North/South Line	Feet From The	East/West Line	County
D	9	23-S	37-E		990	NORTH	910	WEST	LEA

<sup>11</sup> Bottom Hole Location If Different From Surface

UI or lot no.	Section	Township	Range	Lot.Idn	Feet From The	North/South Line	Feet From The	East/West Line	County

<sup>12</sup> Dedicated Acres 40	<sup>13</sup> Joint or Infill No	<sup>14</sup> Consolidation Code	<sup>15</sup> Order No.
-------------------------------------	-------------------------------------	----------------------------------	-------------------------

NO ALLOWABLE WILL BE ASSIGNED TO THIS COMPLETION UNTIL ALL INTERESTS HAVE BEEN CONSOLIDATED  
OR A NON-STANDARD UNIT HAS BEEN APPROVED BY THE DIVISION

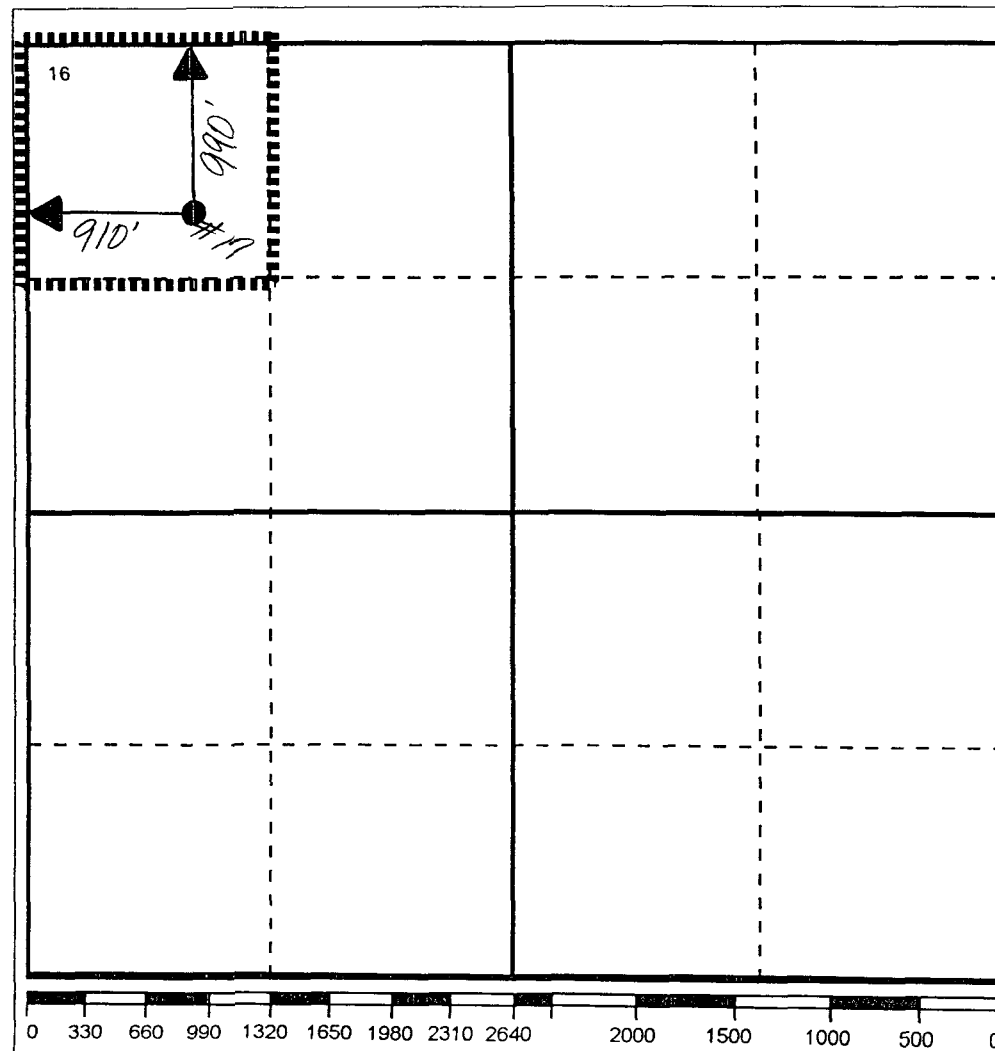

## 17 OPERATOR CERTIFICATION

I hereby certify that the information  
contained herein is true and complete to the  
best of my knowledge and belief

Signature

Printed Name

J. Denise Leake

Position

Engineering Assistant

Date

4/23/99

## 18 SURVEYOR CERTIFICATION

I hereby certify that the well location shown  
on this plat was plotted from field notes of  
actual surveys made by me or under my  
supervision, and that the same is true and  
correct to the best of my knowledge and  
belief.

Date Surveyed

Signature & Seal of  
Professional Surveyor

Certificate No.

LEASE NAME: HARRISON, B. F. -B-  
TEX WEL NO: 17  
CURR\_LSE\_NO: 010960

RSVR: REG\_FLD: 96313

**Drinkard / Abo**

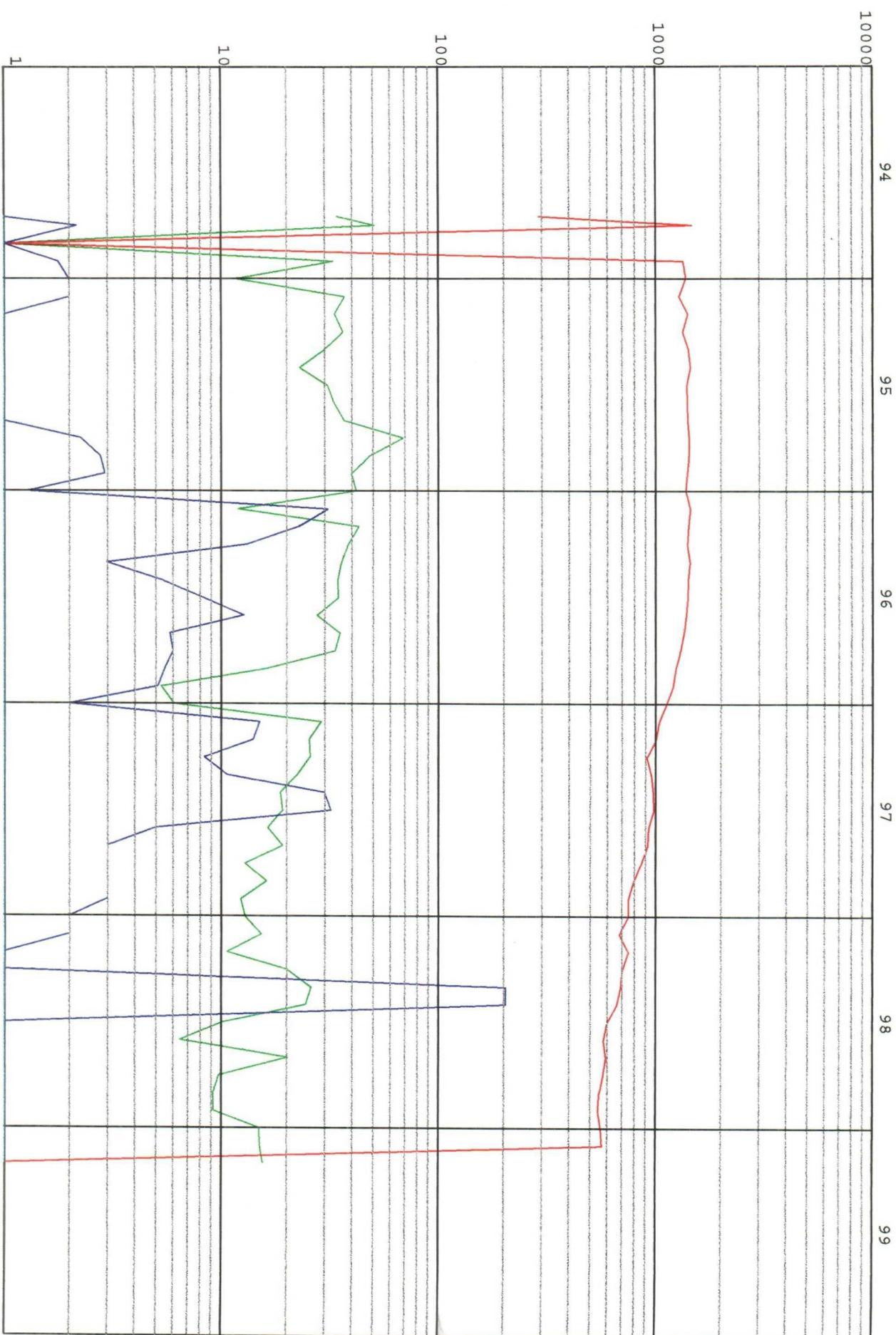

D  
A  
I  
L  
Y  
R  
A  
T  
E

--- BOPD --- MCPD --- BWPD --- BWPD --- AVG INJ PRES / 1  
CURRENT CUMS: OIL: 40,922 bbl GAS: 1,711,872 mcf WTR: 20,670 bbl WINJ: 0 bbl



LEASE NAME: HARRISON, B. F. -B-  
TEX\_WELL\_NO: 17  
CURR\_LSE\_NO: 010960

RSVR:   
REG\_FLD: 96315

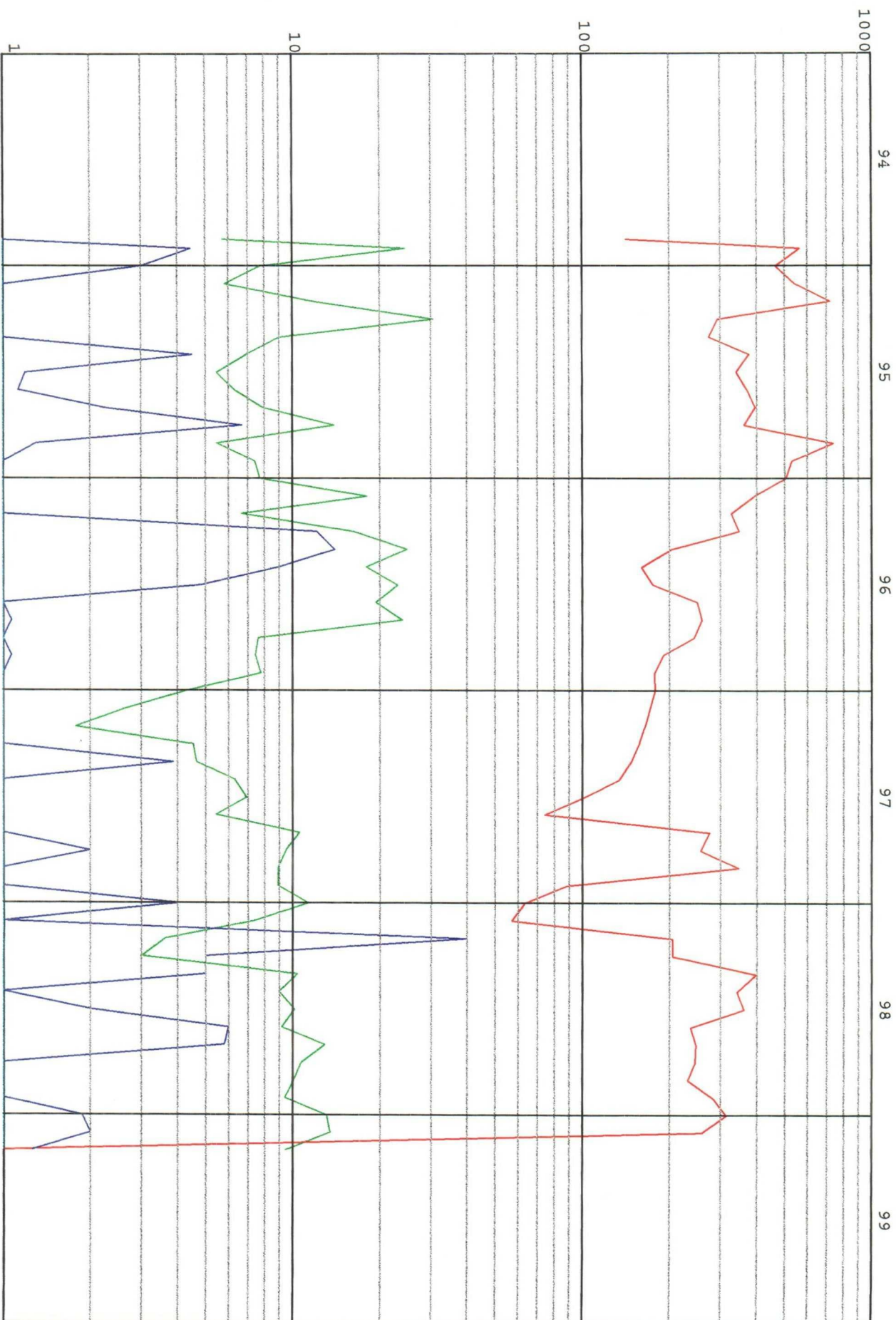

CURRENT CUMS: OIL: 16,595 bbl GAS: 453,126 mcf WTR: 4,750 bbl WIND: 0 bbl

D  
A  
I  
L  
Y  
R  
A  
T  
E

Offset Operators and all Lessees of Record

B. F. Harrison B #17

SE/4 NW/4 of Section 9, T-23-S, R-37-E

*Teague Tubb North Assoc. +*  
Teague Drinkard-Abo North Assoc.

Lea County, New Mexico

April 24, 1999

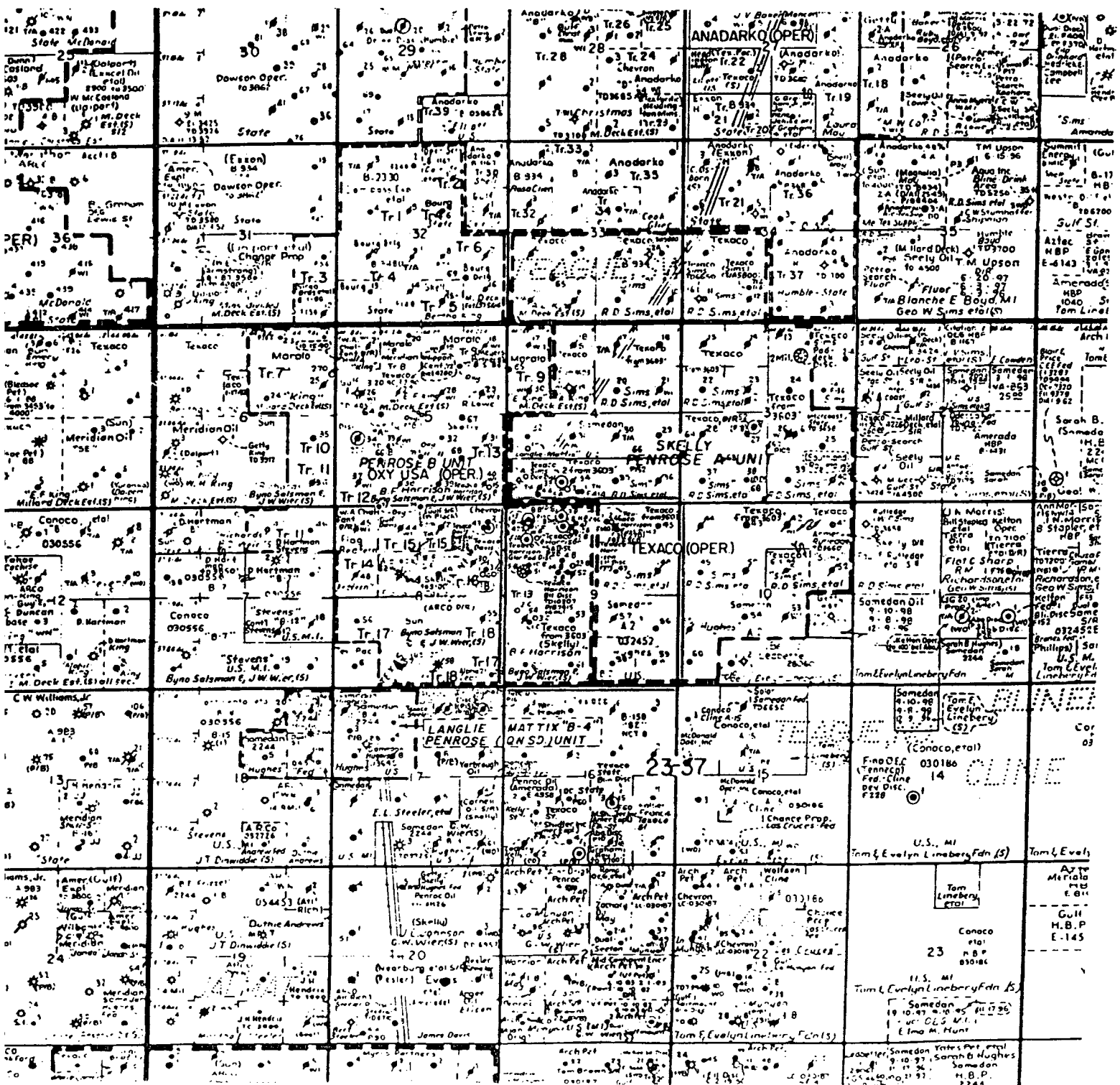



Offset Operators and all Lessees of Record

B. F. Harrison B #17

SE/4 NW/4 of Section 9, T-23-S, R-37-E

Teague Tubbs NORTH ASSOC. +  
Teague Drinkard-Abo North Assoc.

Lea County, New Mexico

April 26, 1999

36	31	32	33	34	35	36	31
1	6	5	4	3	2	1	6
12	7	8	1 1 1 1 1 1 1 1 1 1 2 2 1 1 2 2	9	10	11	12
13	18	17	16	15	14	13	18
24	19	20	21	22	23	24	19
25	30	29	28	27	26	25	30
36	31	32	33	34	35	36	31
1	6	5	4	3	2	1	6

Offset Operators and all Lessees of Record  
B. F. Harrison B # 17  
SE/4 NW/4 of Section 9, T-23-S, R-37-E  
*Teague Tubb NORTH ASSOC. ✓*  
Teague Drinkard-Abo North Assoc.  
Lea County, New Mexico  
April 26, 1999

Number 1

---

Texaco Exploration and Production Inc.  
P. O. Box 3109  
Midland, Texas 79702

Number 2

---

Samedan Oil Corporation  
12600 Northborough, Suite 250  
Houston, Texas 77067



Texaco E & P

205 E. Bender Blvd.  
Hobbs NM 88240  
505 393 7191

April 23, 1999

Texaco Exploration and Production Inc.  
205 East Bender  
Hobbs, New Mexico 88240

Samedan Oil Corporation  
12600 Northborough, Suite 250  
Houston, Texas 77067

Gentlemen:

Please find attached an application which has been filed with the New Mexico Oil Conservation Division in Santa Fe, New Mexico for administrative approval for downhole commingling of the B. F. Harrison "B" #17.

Sincerely,

J. Denise Leake  
Engineering Assistant  
Texaco E&P  
Hobbs Operating Unit



STATE OF NEW MEXICO  
ENERGY, MINERALS AND NATURAL RESOURCES DEPARTMENT  
OIL CONSERVATION DIVISION  
HOBBS DISTRICT OFFICE

GOVERNOR

5/3/99

POST OFFICE BOX 1980  
HOBBS, NEW MEXICO 88241-1980  
(505) 393-6161

OIL CONSERVATION DIVISION  
P. O. BOX 2088  
SANTA FE, NEW MEXICO 87501

RE: Proposed:

MC	_____
DHC	_____X_____
NSL	_____
NSP	_____
SWD	_____
WFX	_____
PMX	_____

Gentlemen:

I have examined the application for the:

Texaco E&P Inc      B F Harrison B      # 17-D, 9-23s-37e  
Operator      Lease & Well No.      Unit      S-T-R

and my recommendations are as follows:

OK

Yours very truly,

Chris Williams  
Chris Williams  
Supervisor, District 1

/ed