

DATE IN 3/29/00	SUSPENSE 4/18/00	ENGINEER DC	LOGGED KW	TYPE DHC
-----------------	------------------	-------------	-----------	----------

ABOVE THIS LINE FOR DIVISION USE ONLY

**NEW MEXICO OIL CONSERVATION DIVISION**  
- Engineering Bureau -

2714

**ADMINISTRATIVE APPLICATION COVERSHEET**

THIS COVERSHEET IS MANDATORY FOR ALL ADMINISTRATIVE APPLICATIONS FOR EXCEPTIONS TO DIVISION RULES AND REGULATIONS

**Application Acronyms:**

[NSP-Non-Standard Proration Unit] [NSL-Non-Standard Location]  
[DD-Directional Drilling] [SD-Simultaneous Dedication]  
[DHC-Downhole Commingling] [CTB-Lease Commingling] [PLC-Pool/Lease Commingling]  
[PC-Pool Commingling] [OLS - Off-Lease Storage] [OLM-Off-Lease Measurement]  
[WFX-Waterflood Expansion] [PMX-Pressure Maintenance Expansion]  
[SWD-Salt Water Disposal] [IPI-Injection Pressure Increase]  
[EOR-Qualified Enhanced Oil Recovery Certification] [PPR-Positive Production Response]

**[1] TYPE OF APPLICATION - Check Those Which Apply for [A]**

[A] Location - Spacing Unit - Directional Drilling  
NSL NSP DD SD

Check One Only for [B] and [C]

[B] Commingling - Storage - Measurement  
X DHC CTB PLC PC OLS OLM

[C] Injection - Disposal - Pressure Increase - Enhanced Oil Recovery  
WFX PMX SWD IPI EOR PPR

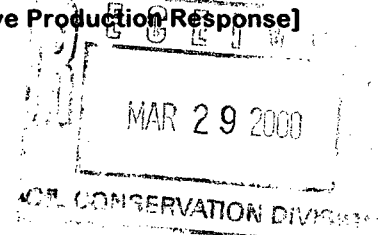

**[2] NOTIFICATION REQUIRED TO: - Check Those Which Apply, or Does Not Apply**

- [A] X Working, Royalty or Overriding Royalty Interest Owners
- [B] Offset Operators, Leaseholders or Surface Owner
- [C] Application is One Which Requires Published Legal Notice
- [D] X Notification and/or Concurrent Approval by BLM or SLO  
U.S. Bureau of Land Management - Commissioner of Public Lands, State Land Office
- [E] For all of the above, Proof of Notification or Publication is Attached, and/or,
- [F] Waivers are Attached

**[3] INFORMATION / DATA SUBMITTED IS COMPLETE - Statement of Understanding**

I hereby certify that I, or personnel under my supervision, have read and complied with all applicable Rules and Regulations of the Oil Conservation Division. Further, I assert that the attached application for administrative approval is accurate and complete to the best of my knowledge and where applicable, verify that all interest (WI, RI, ORRI) is common. I understand that any omission of data, information or notification is cause to have the application package returned with no action taken.

Note: Statement must be completed by an individual with supervisory capacity.

Peggy Cole

*Peggy Cole*

Regulatory/Compliance Administrator

Print or Type Name

Signature

Title

Date

DISTRICT I  
1625 N. French Dr., Hobbs, NM 88240  
DISTRICT II  
811 South First St., Artesia, NM 88210  
DISTRICT III  
1000 Rio Brazos Rd, Aztec, NM 87410  
DISTRICT IV  
2040 S. Pacheco, Santa Fe, NM 87505

State of New Mexico  
Energy, Minerals and Natural Resources Department  
**OIL CONSERVATION DIVISION**

2040 S. Pacheco  
Santa Fe, New Mexico 87505-6429

Form C-107-A  
Revised August 1999

APPROVAL PROCESS:

☒ Administrative ☐ Hearing

EXISTING WELLBORE

☒ YES ☐ NO

APPLICATION FOR DOWNHOLE COMMINGLING

**Burlington Resources Oil and Gas**

Operator **Moore** Address **H-35-32N-12W** County **San Juan**

Lease Well No. Unit Ltr. - Sec - Twp - Rge

Spacing Unit Lease Types: (check 1 or more)

OGRID NO. 14538 Property Code 18587 API NO. 30-045-13214 Federal ☒ , State ☐ , (and/or) Fee ☒

The following facts are submitted in support of downhole commingling:	Upper Zone	Intermediate Zone	Lower Zone
1. Pool Name and Pool Code	Blanco Mesaverde - 72319		Basin Dakota - 71599
2. Top and Bottom of Pay Section (Perforations)	5287-5422		7038-7132
3. Type of production (Oil or Gas)	Gas		Gas
4. Method of Production (Flowing or Artificial Lift)	Flowing		Flowing
5. Bottomhole Pressure Oil Zones - Artificial Lift: Gas & Oil - Flowing: All Gas Zones: Estimated Current Measured Current Estimated Or Measured Original	a. (Current) 587 psi (see attachment)	a.	a. 1141 psi (see attachment)
	b. (Original) 1373 psi (see attachment)	b.	b. 2831 psi (see attachment)
6. Oil Gravity (EAPI) or Gas BTU Content	BTU 1209		BTU 1066
7. Producing or Shut-In?	Producing		Producing
Production Marginal? (yes or no)  * If Shut-In, give date and oil/gas/ water rates of last production  Note: For new zones with no production history, applicant shall be required to attach production estimates and supporting data  * If Producing, give date and oil/gas/ water rates of recent test (within 60 days)	Yes		Yes
	Date: Rates:	Date: Rates:	Date: Rates:
	Date: 1/31/00 Rates: 22 mcf/d	Date: Rates:	Date: 1/31/00 Rates: 40 mcf/d
8. Fixed Percentage Allocation Formula - % for each zone (total of %'s to equal 100%)	Will be supplied upon completion.		Will be supplied upon completion.

9. If allocation formula is based upon something other than current or past production, or is based upon some other method, submit attachments with supporting data and/or explaining method and providing rate projections or other required data.

10. Are all working, overriding, and royalty interests identical in all commingled zones? Yes ☒ No ☐  
If not, have all working, overriding, and royalty interests been notified by certified mail? ☒ Yes ☐ No

11. Will cross-flow occur? ☒ Yes ☐ No If yes, are fluids compatible, will the formations not be damaged, will any cross-flowed production be recovered, and will the allocation formula be reliable. ☒ Yes ☐ No (If No, attach explanation)

12. Are all produced fluids from all commingled zones compatible with each other? ☒ Yes ☐ No

13. Will the value of production be decreased by commingling? ☐ Yes ☒ No (If Yes, attach explanation)

14. If this well is on, or communitized with, state or federal lands, either the Commissioner of Public Lands or the United States Bureau of Land Management has been notified in writing of this application. ☒ Yes ☐ No

15. NMOCD Reference Cases for Rule 303(D) Exceptions: ORDER NO(S) \_\_\_\_\_

16. ATTACHMENTS:

- \* C-102 for each zone to be commingled showing its spacing unit and acreage dedication.
- \* Production curve for each zone for at least one year. (If not available, attach explanation.)
- \* For zones with no production history, estimated production rates and supporting data.
- \* Data to support allocation method or formula.
- \* Notification list of working, overriding, and royalty interests for uncommon interest cases.
- \* Any additional statements, data, or documents required to support commingling.

I hereby certify that the information above is true and complete to the best of my knowledge and belief.

SIGNATURE Jennifer Dobson TITLE PRODUCTION ENGINEER DATE 3/21/00

TYPE OR PRINT NAME Jennifer Dobson TELEPHONE NO. (505) 326-9700

**NEW MEXICO  
OIL CONSERVATION COMMISSION**

**Gas Well Plat**

Date March 11, 1954

Southern Union Gas Co.

Moore

1

Operator

Lease

Well No.

Name of Producing Formation Mogaverta

Pool Mance

No. Acres Dedicated to the Well 320

Indicate land status and show ownership.

SECTION 35 TOWNSHIP 32-N RANGE 12-W

		S. U. C. Patented 4	
		Horton SP 07811.6 Federal 4	
		S. U. C. Patented 2 4 2	

I hereby certify that the information given above is true and complete to the best of my knowledge.

Original Signed By  
A. M. WIEDERKEHR

Name \_\_\_\_\_

Position Engineer

Representing Southern Union Gas Co.

Address Fort Bldg., Dallas

(over)

**NEW MEXICO OIL CONSERVATION COMMISSION  
WELL LOCATION AND ACREAGE DEDICATION PLAT**

Form C-102  
Supersedes C-128  
Effective 1-1-65

All distances must be from the outer boundaries of the Section.

Operator <b>Aztec Oil and Gas</b>			Lease <b>Moore</b>		Well No. <b>1</b>
Unit Letter <b>H</b>	Section <b>35</b>	Township <b>32N</b>	Range <b>12W</b>	County <b>San Juan</b>	
Actual Footage Location of Well: <b>1650</b> feet from the <b>North</b> line and <b>990</b> feet from the <b>East</b> line					
Ground Level Elev:	Producing Formation <b>Dakota</b>		Pool <b>Basin Dakota</b>		Dedicated Acreage: <b>320</b> Acres

1. Outline the acreage dedicated to the subject well by colored pencil or hachure marks on the plat below.
2. If more than one lease is dedicated to the well, outline each and identify the ownership thereof (both as to working interest and royalty).
3. If more than one lease of different ownership is dedicated to the well, have the interests of all owners been consolidated by communitization, unitization, force-pooling, etc?

☒ Yes    ☐ No    If answer is "yes," type of consolidation Communitization

If answer is "no," list the owners and tract descriptions which have actually been consolidated. (Use reverse side of this form if necessary.) \_\_\_\_\_

No allowable will be assigned to the well until all interests have been consolidated (by communitization, unitization, forced-pooling, or otherwise) or until a non-standard unit, eliminating such interests, has been approved by the Commission.

**RECEIVED**  
**FEB 5 1969**  
**OIL CON COM.**  
**DIST. 3**

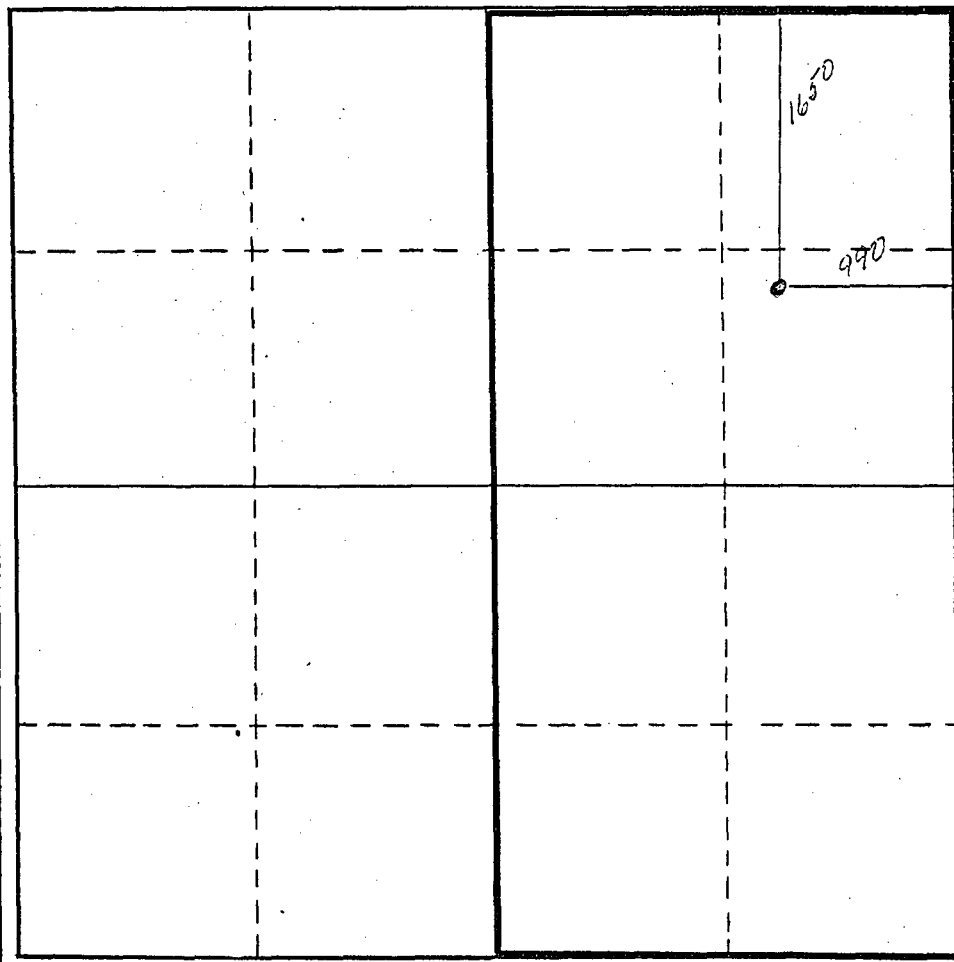

**CERTIFICATION**

I hereby certify that the information contained herein is true and complete to the best of my knowledge and belief.

*Joe C. Salmon*  
Name

**Joe C. Salmon**

Position

**District Superintendent**

Company

**Aztec Oil and Gas**

Date

**February 4, 1969**

I hereby certify that the well location shown on this plat was plotted from field notes of actual surveys made by me or under my supervision, and that the same is true and correct to the best of my knowledge and belief.

Date Surveyed

Registered Professional Engineer and/or Land Surveyor

Certificate No.

0 330 660 990 1320 1650 1980 2310 2640 2970 3300 3630 0

**Moore #1**  
**Bottom Hole Pressures**  
**Flowing and Static BHP**  
**Cullender and Smith Method**  
Version 1.0 1/14/98

<b>Mesaverde</b>		<b>Dakota</b>	
<b><u>MV-Current</u></b>		<b><u>DK-Current</u></b>	
GAS GRAVITY	<u>0.7</u>	GAS GRAVITY	<u>0.628</u>
COND. OR MISC. (C/M)	<u>M</u>	COND. OR MISC. (C/M)	<u>M</u>
%N2	<u>0.26</u>	%N2	<u>0.25</u>
%CO2	<u>1.12</u>	%CO2	<u>2.34</u>
%H2S	<u>0</u>	%H2S	<u>0</u>
DIAMETER (IN)	<u>4.5</u>	DIAMETER (IN)	<u>2.375</u>
DEPTH (FT)	<u>5355</u>	DEPTH (FT)	<u>7543</u>
SURFACE TEMPERATURE (DEG F)	<u>60</u>	SURFACE TEMPERATURE (DEG F)	<u>60</u>
BOTTOMHOLE TEMPERATURE (DEG F)	<u>156</u>	BOTTOMHOLE TEMPERATURE (DEG F)	<u>196</u>
FLOWRATE (MCFPD)	<u>0</u>	FLOWRATE (MCFPD)	<u>0</u>
SURFACE PRESSURE (PSIA)	<u>512</u>	SURFACE PRESSURE (PSIA)	<u>962</u>
BOTTOMHOLE PRESSURE (PSIA)	<u>586.5</u>	BOTTOMHOLE PRESSURE (PSIA)	<u>1140.9</u>
<b><u>MV-Original</u></b>		<b><u>DK-Original</u></b>	
GAS GRAVITY	<u>0.7</u>	GAS GRAVITY	<u>0.628</u>
COND. OR MISC. (C/M)	<u>M</u>	COND. OR MISC. (C/M)	<u>M</u>
%N2	<u>0.26</u>	%N2	<u>0.25</u>
%CO2	<u>1.12</u>	%CO2	<u>2.34</u>
%H2S	<u>0</u>	%H2S	<u>0</u>
DIAMETER (IN)	<u>4.5</u>	DIAMETER (IN)	<u>2.375</u>
DEPTH (FT)	<u>5355</u>	DEPTH (FT)	<u>7543</u>
SURFACE TEMPERATURE (DEG F)	<u>60</u>	SURFACE TEMPERATURE (DEG F)	<u>60</u>
BOTTOMHOLE TEMPERATURE (DEG F)	<u>156</u>	BOTTOMHOLE TEMPERATURE (DEG F)	<u>196</u>
FLOWRATE (MCFPD)	<u>0</u>	FLOWRATE (MCFPD)	<u>0</u>
SURFACE PRESSURE (PSIA)	<u>1179</u>	SURFACE PRESSURE (PSIA)	<u>2360</u>
BOTTOMHOLE PRESSURE (PSIA)	<u>1373.2</u>	BOTTOMHOLE PRESSURE (PSIA)	<u>2830.7</u>



MOORE 1 4831602 (270640334354.895) Data: Jan. 1953-Jan. 2000

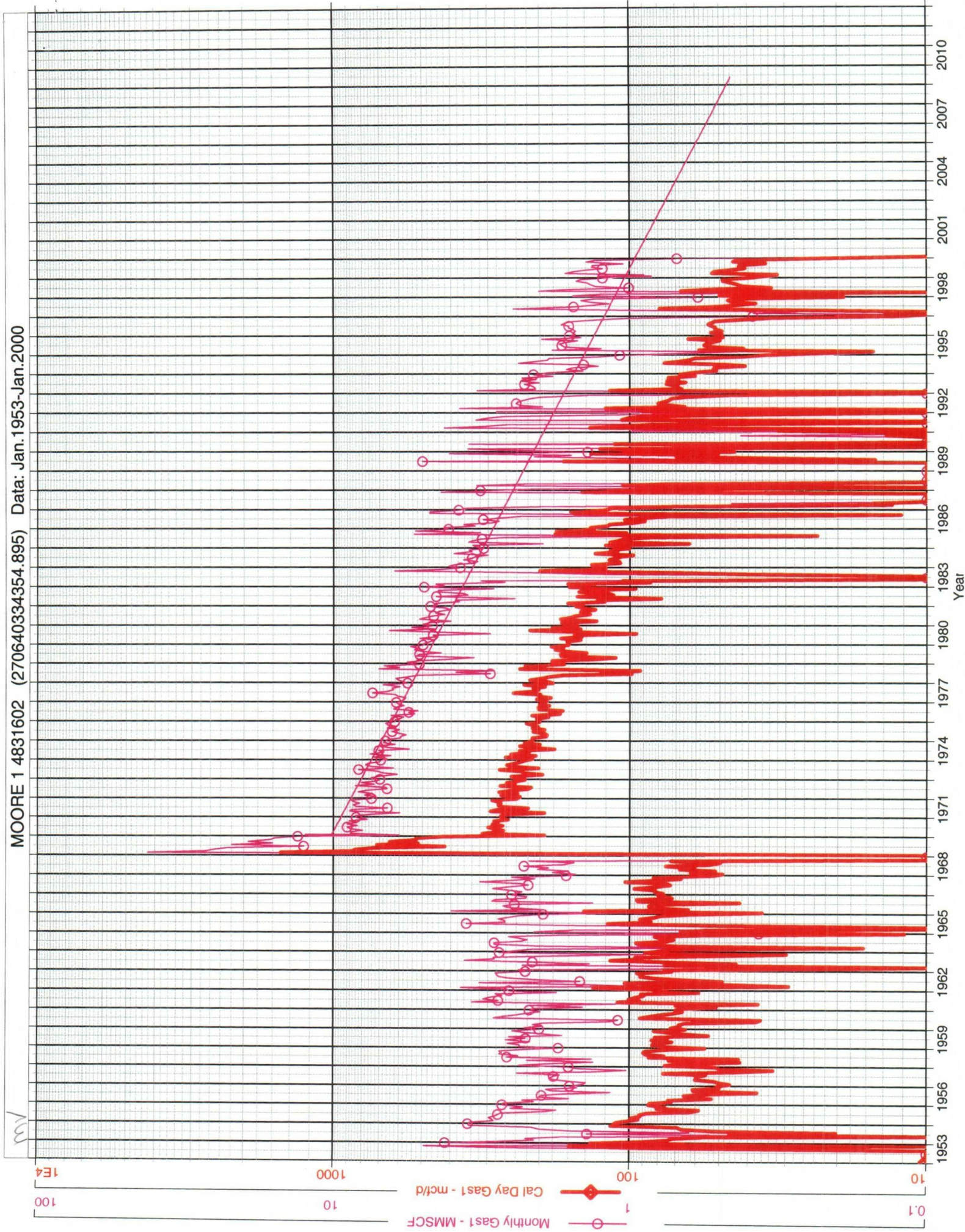



MOORE 1 4831601 (254767827759.945) Data: Nov. 1968-Jan. 2000

DK

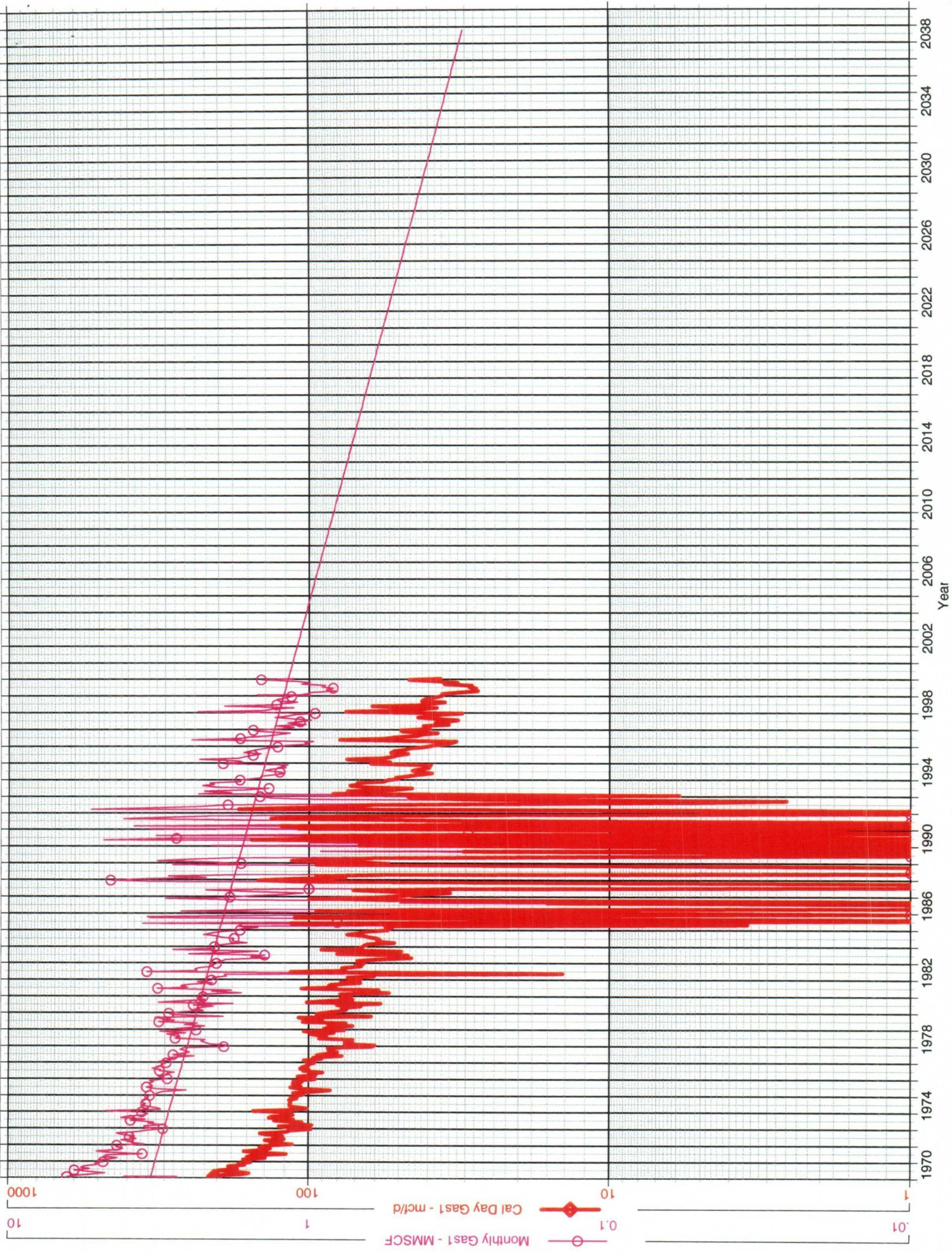



mv

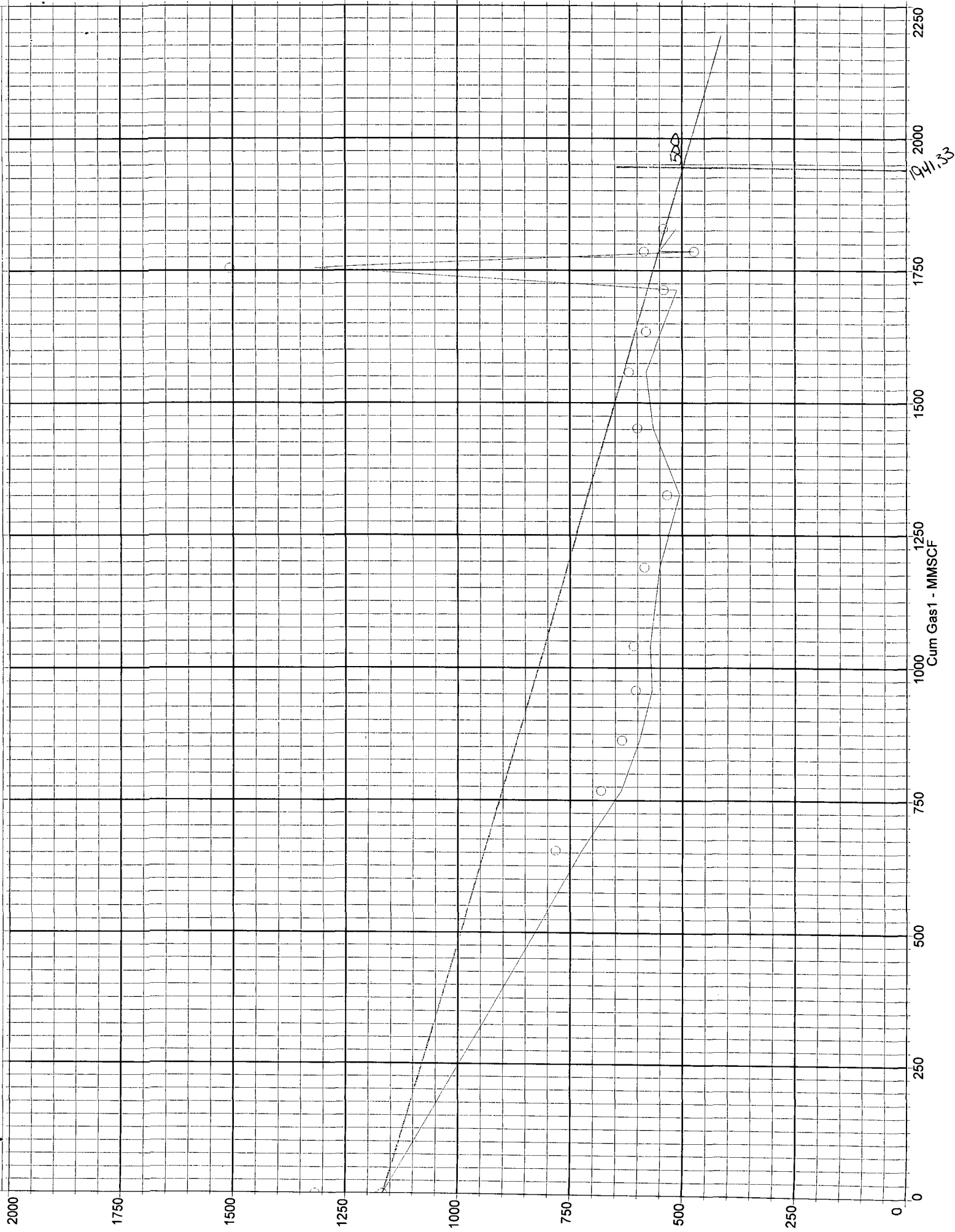



DK

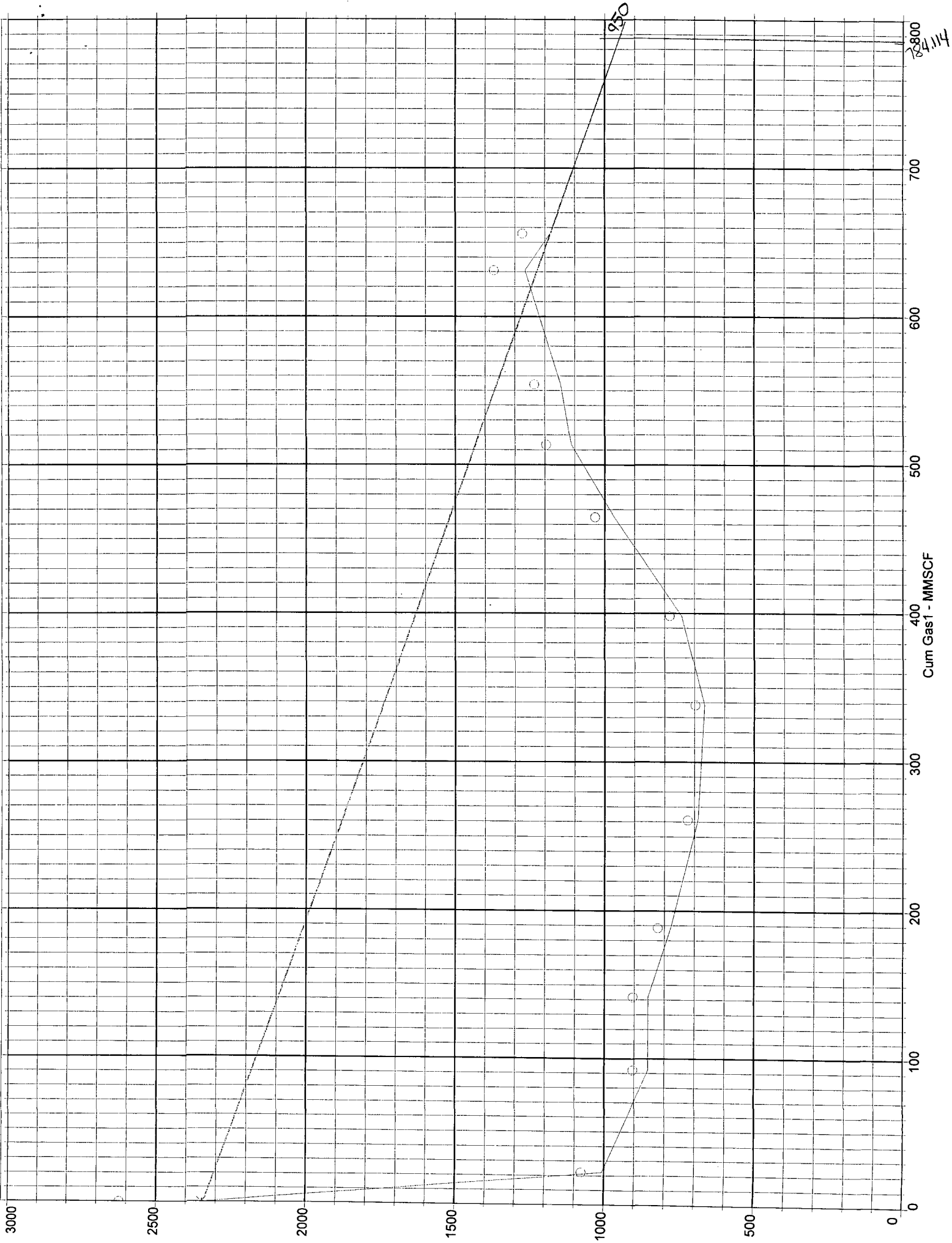

DPNO	METERNA	WELLNAME	WELLNO	FRM	Cum MCF	Year	Month	Day	WH Psi			
4831601	34318	MOORE	1	DK		1968	11	14	2,348	original		
						1970	4	17	1,008			
						1971	6	18	854			
						1972	6	18	854			
						1973	7	18	779			
						1975	4	18	688			
						1977	5	17	666			
						1979	5	2	743			
						1981	8	31	968			
						1983	8	23	1,112			
						1985	6	11	1,147			
						1990	9	4	1,267			
						1992	3	29	1,183			
					784	2000	3	1	950	current estimated from P/Z data		
4831602	34142	MOORE	1	MV		1953	6	18	1,167	original		
						1970	4	17	724			
						1971	6	18	636			
						1972	6	18	596			
						1973	7	18	568			
						1974	7	18	572			
						1976	7	3	551			
						1978	6	2	506			
						1980	8	24	565			
						1982	8	23	581			
						1984	8	21	547			
						1986	8	19	512			
						1989	7	8	1,319			
						1991	5	14	473			
						1991	5	28	551			
						1993	5	4	513			
					1,941	2000	3	1	500	current estimated from P/Z data		

DPNO	METERNA	WELLNAME	WELLNO	FRM	DISP_MO	GRS GAS PROD	3monavg
4831601	34318	MOORE	1	DK	31-Jan-99	1110.75	
4831601	34318	MOORE	1	DK	28-Feb-99	1008.8	
4831601	34318	MOORE	1	DK	31-Mar-99	996.05	
4831601	34318	MOORE	1	DK	30-Apr-99	820.57	
4831601	34318	MOORE	1	DK	31-May-99	876.45	
4831601	34318	MOORE	1	DK	30-Jun-99	833.31	
4831601	34318	MOORE	1	DK	31-Jul-99	907.82	
4831601	34318	MOORE	1	DK	31-Aug-99	886.25	
4831601	34318	MOORE	1	DK	30-Sep-99	1061.74	
4831601	34318	MOORE	1	DK	31-Oct-99	992.13	
4831601	34318	MOORE	1	DK	30-Nov-99	1098.99	
4831601	34318	MOORE	1	DK	31-Dec-99	1441.14	
4831601	34318	MOORE	1	DK	31-Jan-00	1129.38	40
4831602	34142	MOORE	1	MV	31-Jan-99	1093.11	
4831602	34142	MOORE	1	MV	28-Feb-99	895.07	
4831602	34142	MOORE	1	MV	31-Mar-99	1643.09	
4831602	34142	MOORE	1	MV	30-Apr-99	1558.78	
4831602	34142	MOORE	1	MV	31-May-99	1422.51	
4831602	34142	MOORE	1	MV	30-Jun-99	1230.36	
4831602	34142	MOORE	1	MV	31-Jul-99	1337.22	
4831602	34142	MOORE	1	MV	31-Aug-99	1328.4	
4831602	34142	MOORE	1	MV	30-Sep-99	1049.97	
4831602	34142	MOORE	1	MV	31-Oct-99	1396.04	
4831602	34142	MOORE	1	MV	30-Nov-99	1309.77	
4831602	34142	MOORE	1	MV	31-Dec-99	694.1	
4831602	34142	MOORE	1	MV	31-Jan-00	14.71	22



## Moore 1

BARBARA MOSELEY  
BETSY H BRYANT  
CLAUDIA MARCIA LUNDELL GILMER  
CONOCO INC  
EVELYN SMITH  
GARY W HARVEY INDEP EXEC  
GLADYS WATFORD TRUSTEE  
HARRIET M BUCHENAU TRUSTEE  
J BURTON VETETO  
JERALD T MARCOTTE  
JIM L SHARP  
JULIE ANN ANTWEIL TRUST  
LINDA JEANNE LUNDELL LINDSEY  
MARQUITA MOSELEY MAYTAG  
MITZI ANN HENDERSON EASLEY  
MORTIMER A KLINE JR SOLE TRUSTEE  
PATTIE ANN BEAMON LUNDELL EST  
PAUL B HORTON AND  
PHILLIPS PETROLEUM COMPANY  
POLLY MOSELEY ROYCE  
REESE L MILNER II TRUSTEE  
ROBERT E BEAMON III  
ROBERT M WILLIAMS  
ROBERT R DIAL LIFE ESTATE  
ROBERT WALTER LUNDELL  
SANDRA CHAPMAN MOSELY TRUST  
SINGER BROS  
SUSAN H RITTER  
UNION OIL CO OF CALIF  
UNITED PIPE SUPPLY CO  
WALTER E DIAL LIFE TENANT  
WILLIAM L MADSEN OR SARAH S  
BLM OF FARMINGTON