

DATE IN 9/15/06	SUSPENSE	D. Brooks ENGINEER	LOGGED IN 9/15/06	TYPE NSL	APP NO. PTDSD-25856940
------------------------	----------	------------------------------	--------------------------	-----------------	-------------------------------

ABOVE THIS LINE FOR DIVISION USE ONLY

NEW MEXICO OIL CONSERVATION DIVISION
- Engineering Bureau -
1220 South St. Francis Drive, Santa Fe, NM 87505



ADMINISTRATIVE APPLICATION CHECKLIST

THIS CHECKLIST IS MANDATORY FOR ALL ADMINISTRATIVE APPLICATIONS FOR EXCEPTIONS TO DIVISION RULES AND REGULATIONS WHICH REQUIRE PROCESSING AT THE DIVISION LEVEL IN SANTA FE

Application Acronyms:

[NSL-Non-Standard Location] [NSP-Non-Standard Proration Unit] [SD-Simultaneous Dedication]
[DHC-Downhole Commingling] [CTB-Lease Commingling] [PLC-Pool/Lease Commingling]
[PC-Pool Commingling] [OLS - Off-Lease Storage] [OLM-Off-Lease Measurement]
[WFX-Waterflood Expansion] [PMX-Pressure Maintenance Expansion]
[SWD-Salt Water Disposal] [IPI-Injection Pressure Increase]
[EOR-Qualified Enhanced Oil Recovery Certification] [PPR-Positive Production Response]

[1] **TYPE OF APPLICATION** - Check Those Which Apply for [A]

[A] Location - Spacing Unit - Simultaneous Dedication
☒ NSL ☐ NSP ☐ SD

Check One Only for [B] or [C]

[B] Commingling - Storage - Measurement
☐ DHC ☐ CTB ☐ PLC ☐ PC ☐ OLS ☐ OLM

[C] Injection - Disposal - Pressure Increase - Enhanced Oil Recovery
☐ WFX ☐ PMX ☐ SWD ☐ IPI ☐ EOR ☐ PPR

[D] Other: Specify _____

[2] **NOTIFICATION REQUIRED TO:** - Check Those Which Apply, or Does Not Apply

[A] ☐ Working, Royalty or Overriding Royalty Interest Owners

[B] ☐ Offset Operators, Leaseholders or Surface Owner

[C] ☐ Application is One Which Requires Published Legal Notice

[D] ☐ Notification and/or Concurrent Approval by BLM or SLO
U.S. Bureau of Land Management - Commissioner of Public Lands, State Land Office

[E] ☐ For all of the above, Proof of Notification or Publication is Attached, and/or,

[F] ☐ Waivers are Attached

[3] **SUBMIT ACCURATE AND COMPLETE INFORMATION REQUIRED TO PROCESS THE TYPE OF APPLICATION INDICATED ABOVE.**

[4] **CERTIFICATION:** I hereby certify that the information submitted with this application for administrative approval is **accurate** and **complete** to the best of my knowledge. I also understand that **no action** will be taken on this application until the required information and notifications are submitted to the Division.

JAMES BRUCE
P.O. BOX 1056
SANTA FE, NM 87504
Print or Type Name

Note: Statement must be completed by an individual with managerial and/or supervisory capacity.

Signature

Title

Date

e-mail Address

2006 SEP 14 PM 4 16

JAMES BRUCE
ATTORNEY AT LAW

POST OFFICE BOX 1056
SANTA FE, NEW MEXICO 87504

369 MONTEZUMA, NO. 213
SANTA FE, NEW MEXICO 87501

(505) 982-2043 (Phone)
(505) 660-6612 (Cell)
(505) 982-2151 (Fax)

jamesbruc@aol.com

September 14, 2006

Hand delivered

Michael E. Fesmire
Oil Conservation Division
1220 South St. Francis Drive
Santa Fe, New Mexico 87505

Dear Mr. Fesmire:

Pursuant to Division Rule 104.F(2), Samson Resources Company applies for approval of an unorthodox oil well location for the following well:

<u>Well:</u>	Lea Federal Unit Well No. 27
<u>Location:</u>	1150 feet FSL & 700 feet FEL
<u>Well Units:</u>	E $\frac{1}{2}$ SE $\frac{1}{4}$ of Section 11, Township 20 South, Range 34 East, N.M.P.M., Lea County, New Mexico

The well will be drilled to a depth sufficient to test the Bone Spring formation (Lea-Bone Spring Pool). Under Division Order No. R-1827, the pool is spaced on 80 acres, with wells to be within 150 feet of the center of a quarter-quarter section. A Form C-102 for the well is attached as Exhibit A.

The well's location is based upon topographic reasons. Attached as Exhibit B is a plat showing that pipelines in the area prevent a well from being located at a standard location; the well must be moved either north or south. Also, applicant is proposing to drill a separate well in the NE $\frac{1}{4}$ SE $\frac{1}{4}$ of Section 11, and thus cannot move the proposed well to that quarter-quarter section.

Attached as Exhibit C is a land plat of the area. The well unit is committed to the Lea Federal Unit, operated by Brothers Production Co. Applicant has a farmout from the Unit Operator permitting it to drill the well. Because the well location is internal to the well unit, and because the well is within a unit area, there is no adversely affected interest owner, and notice of this application has not been given to anyone.

Due to continuous development obligations in applicant's agreement with Brothers Production Co., applicant requests expedited approval of the unorthodox location.

Please contact me if you need any further information on this application.

Very truly yours,

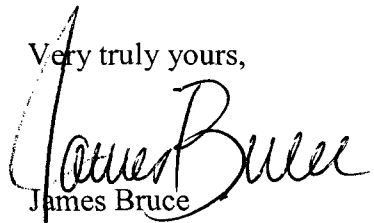
A handwritten signature in cursive script, appearing to read "James Bruce". The signature is written in black ink and is positioned above the printed name "James Bruce".

James Bruce

Attorney for Samson Resources Company

DISTRICT I

1625 N. FRENCH DR., BOBBS, NM 86240

DISTRICT II

1301 W. GRAND AVENUE, ARTESIA, NM 86210

DISTRICT III

1000 Rio Brazos Rd., Artec, NM 87410

DISTRICT IV

1220 S. ST. FRANCIS DR., SANTA FE, NM 87505

State of New Mexico

Energy, Minerals and Natural Resources Department

OIL CONSERVATION DIVISION

1220 SOUTH ST. FRANCIS DR.
Santa Fe, New Mexico 87505

Form C-102

Revised October 12, 2005

Submit to Appropriate District Office

State Lease - 4 Copies

Fee Lease - 3 Copies

WELL LOCATION AND ACREAGE DEDICATION PLAT

☐ AMENDED REPORT

API Number	Pool Code	Pool Name
Property Code	Property Name LEA FEDERAL UNIT	Well Number 27
OGRID No.	Operator Name SAMSON RESOURCES	Elevation 3652'

Surface Location

UL or lot No.	Section	Township	Range	Lot Idn	Feet from the	North/South line	Feet from the	East/West line	County
P	11	20-S	34-E		1150	SOUTH	700	EAST	LEA

Bottom Hole Location If Different From Surface

UL or lot No.	Section	Township	Range	Lot Idn	Feet from the	North/South line	Feet from the	East/West line	County
Dedicated Acres	Joint or Infill	Consolidation Code	Order No.						

NO ALLOWABLE WILL BE ASSIGNED TO THIS COMPLETION UNTIL ALL INTERESTS HAVE BEEN CONSOLIDATED
OR A NON-STANDARD UNIT HAS BEEN APPROVED BY THE DIVISION

<p>GEODETIC COORDINATES NAD 27 NME</p> <p>Y=576900.4 N X=749257.1 E</p> <p>LAT.=32°35'00.24" N LONG.=103°31'26.80" W</p> <p>LAT.=32.583399" N LONG.=103.524110" W</p>		<p>OPERATOR CERTIFICATION</p> <p>I hereby certify that the information herein is true and complete to the best of my knowledge and belief, and that this organization either owns a working interest or unleased mineral interest in the land including the proposed bottom hole location or has a right to drill this well at this location pursuant to a contract with an owner of such mineral or working interest, or to a voluntary pooling agreement or a compulsory pooling order heretofore entered by the division.</p> <p>Signature _____ Date _____</p> <p>Printed Name _____</p>
		<p>SURVEYOR CERTIFICATION</p> <p>I hereby certify that the well location shown on this plat was plotted from field notes of actual surveys made by me or under my supervision, and that the same is true and correct to the best of my belief.</p> <p>JUNE 12, 2006</p> <p>Date Surveyed _____ LA</p> <p>Signature & Seal of Professional Surveyor</p> <p><i>Gary A. Eidson 6/16/06</i> 06.11.0995</p> <p>Certificate No. GARY EIDSON 12641</p>

Exhibit A

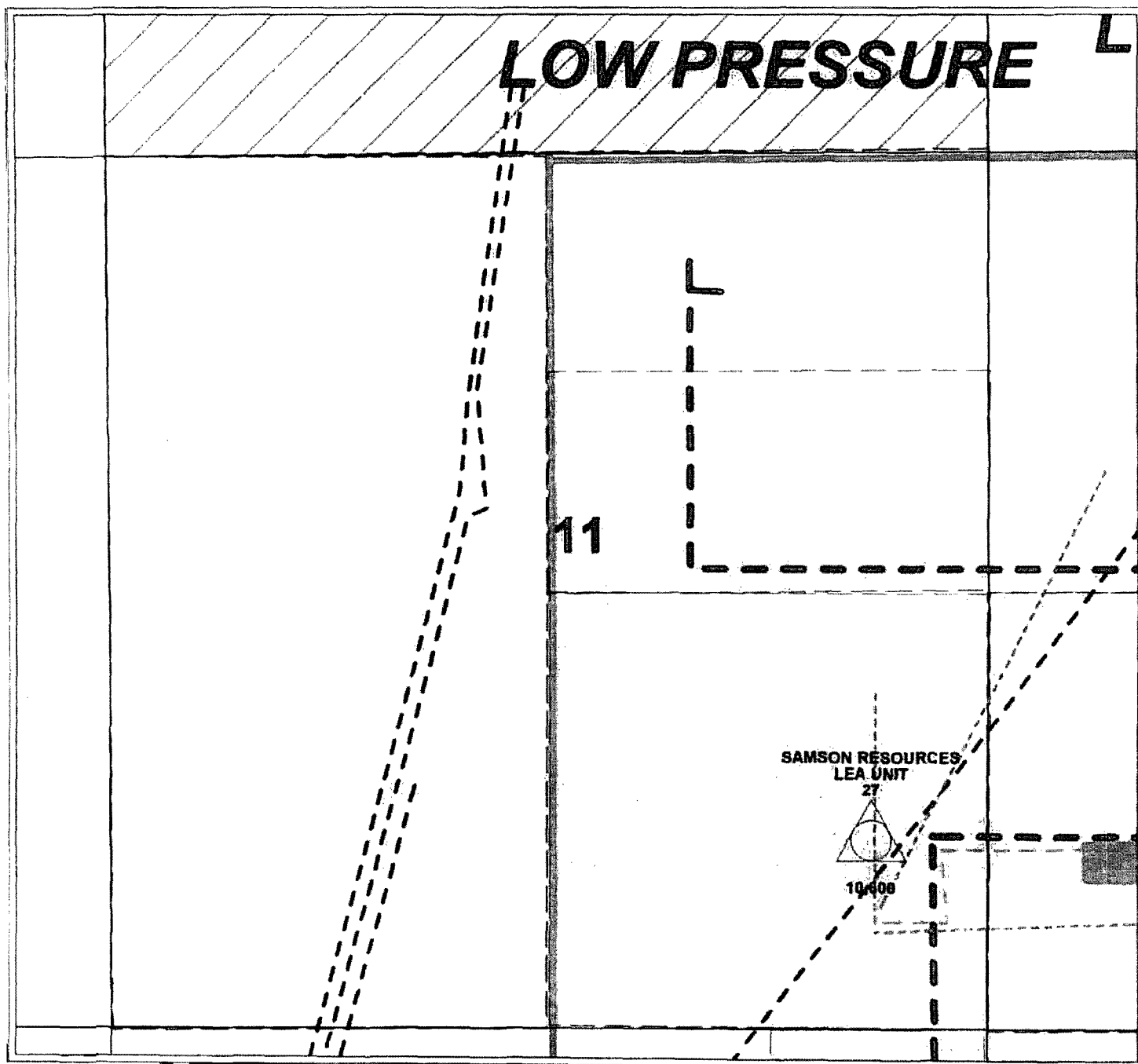

PETRA 01/16/2006 10:25:08 AM

Exhibit B

Lea Federal Unit # 27
 1150' FSL, 700' FEL
 Section 11, T-20-S, R-34-E
 Lea County, New Mexico

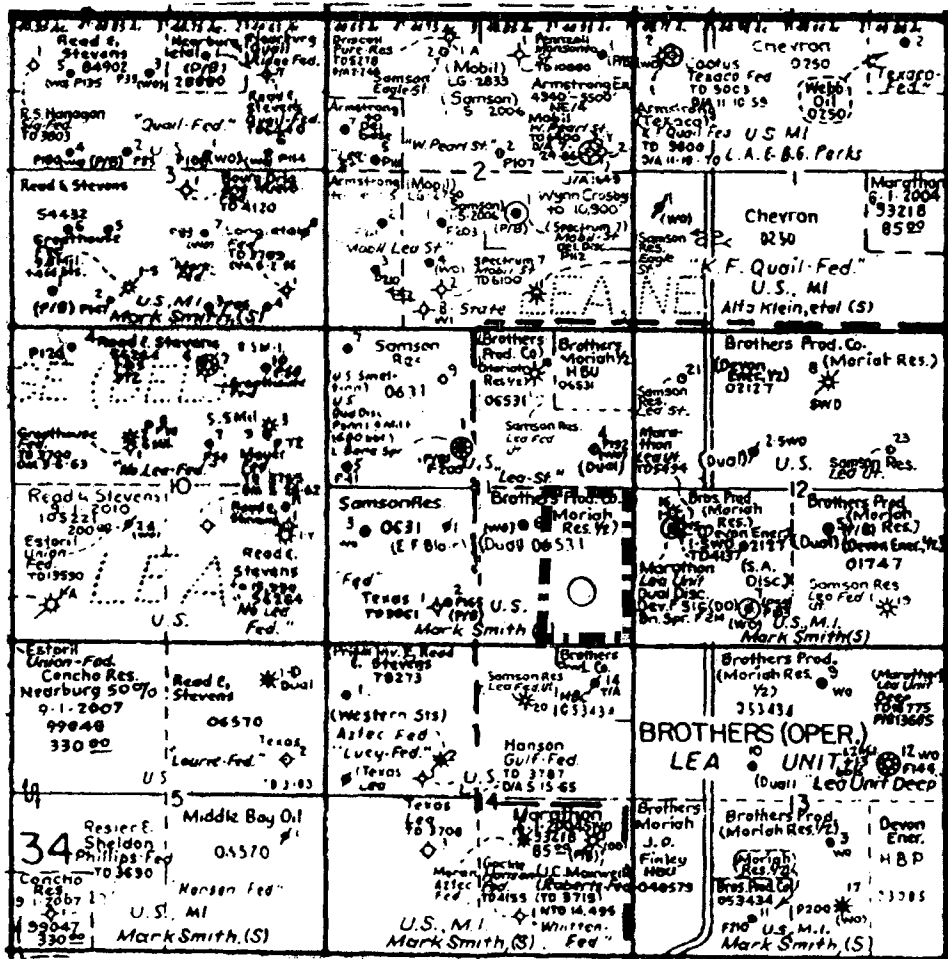

Exhibit C