

**FAX COVER SHEET**

Date:

1/24

Number of pages including cover sheet:

25

NMOC
Attn: Michael Stogner

Phone: (505) 476-3440
Fax phone: (505) 476-3462

From:

Cy Cowan105 South Fourth StreetArtesia, NM 88210

Phone:

505-748-4372

Fax phone:

505-748-4572

REMARKS:

☐ Urgent☒ For your review☐ Reply ASAP☐ Please comment

Request for Yates Drilling Company's
Parrot Federal Com #2 Administration
Approval.
Thank You!
Cy Cowan

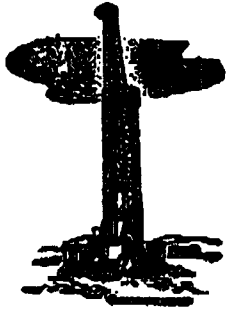
**YATES DRILLING COMPANY**

105 SOUTH FOURTH STREET • ARTESIA, NEW MEXICO 88210

(505) 748-8440 • FAX (505) 748-8470

EMAIL: ydcl@qwest.net

PEYTON YATES
PRESIDENTS. P. YATES
VICE PRESIDENTRANDY G. PATTERSON
SECRETARYDENNIS G. KINSEY
TREASURER

January 24, 2006

Mr. Michael Stogner
New Mexico Oil Conservation Division
1220 South Saint Francis Drive
Santa Fe, New Mexico 87505

Via Facsimile
Certified Mail
Return Receipt Request

RE: Application for Unorthodox Location
Parrott Federal Com. #2
1600' FSL and 660' FEL
Section 29, T19S-R27E
Eddy County, New Mexico

30-015-33345

Dear Mr. Stogner

Yates Drilling Company respectfully requests administrative approval for the captioned Wolfcamp oil well. The well located on Federal Lease LC-049945.

The Parrot Federal #2 was originally drilled as a wildcat Chestur gas well on a 320 acre dedication orthodox location. It was later decided to plug back the well to attempt to obtain production from other formations. This well was plugged back to the wolfcamp formation in the Lake McMillan Wolfcamp Oil Pool and the proration unit was decreased to a 40 acre proration unit. By doing this the captioned footages are unorthodox to the south approximately 54 feet. Please note attached exhibits.

Yates Drilling Company (Yates Petroleum Corporation) is the offset operator to the south since Lease NM-049945 covers the S/2SE/4 and the SE/SW/4 of this section. Therefore Yates Drilling Company requests administrative approval for this plugged back unorthodox location at your earliest convenience. We also wish this approval to cover the following formations Seven Rivers, Queen, San Andres, and the Bone Springs.

Enclosed please find Yates Drillings' Administrative Application Checklist and supporting information for your review. However should you need anything further please advise.

Thank you,

Very truly yours,

YATES PETROLEUM CORPORATION

Cy Cowan
Regulatory Agent
/cyc

DATE <u>1/24/06</u>	SUSPENSE <u>2/13/06</u>	ENGINEER <u>MIKE</u>	LOGGED IN <u>2/2/06</u>	TYPE <u>NSL</u>	APP NO. <u>PTDS 0603339149</u>
---------------------	-------------------------	----------------------	-------------------------	-----------------	--------------------------------

ABOVE THIS LINE FOR DIVISION USE ONLY

NEW MEXICO OIL CONSERVATION DIVISION

- Engineering Bureau -

1220 South St. Francis Drive, Santa Fe, NM 87505



ADMINISTRATIVE APPLICATION CHECKLIST

THIS CHECKLIST IS MANDATORY FOR ALL ADMINISTRATIVE APPLICATIONS FOR EXCEPTIONS TO DIVISION RULES AND REGULATIONS WHICH REQUIRE PROCESSING AT THE DIVISION LEVEL IN SANTA FE

Application Acronyms:

[NSL-Non-Standard Location] [NSP-Non-Standard Proration Unit] [SD-Simultaneous Dedication]
 [DHC-Downhole Commingling] [CTB-Lease Commingling] [PLC-Pool/Lease Commingling]
 [PC-Pool Commingling] [OLS - Off-Lease Storage] [OLM-Off-Lease Measurement]
 [WFX-Waterflood Expansion] [PMX-Pressure Maintenance Expansion]
 [SWD-Salt Water Disposal] [IPI-Injection Pressure Increase]
 [EOR-Qualified Enhanced Oil Recovery Certification] [PPR-Positive Production Response]

[1] TYPE OF APPLICATION - Check Those Which Apply for [A]

[A] Location - Spacing Unit - Simultaneous Dedication

☒ NSL ☐ NSP ☐ SD

Check One Only for [B] or [C]

[B] Commingling - Storage - Measurement

☐ DHC ☐ CTB ☐ PLC ☐ PC ☐ OLS ☐ OLM

[C] Injection - Disposal - Pressure Increase - Enhanced Oil Recovery

☐ WFX ☐ PMX ☐ SWD ☐ IPI ☐ EOR ☐ PPR

[D] Other: Specify _____

[2] NOTIFICATION REQUIRED TO: - Check Those Which Apply, or Does Not Apply

[A] ☐ Working, Royalty or Overriding Royalty Interest Owners[B] ☐ Offset Operators, Leaseholders or Surface Owner[C] ☐ Application is One Which Requires Published Legal Notice
 [D] ☐ Notification and/or Concurrent Approval by BLM or SLO
 U.S. Bureau of Land Management - Commissioner of Public Lands, State Land Office
[E] ☐ For all of the above, Proof of Notification or Publication is Attached, and/or,[F] ☐ Waivers are Attached

[3] SUBMIT ACCURATE AND COMPLETE INFORMATION REQUIRED TO PROCESS THE TYPE OF APPLICATION INDICATED ABOVE.

[4] CERTIFICATION: I hereby certify that the information submitted with this application for administrative approval is accurate and complete to the best of my knowledge. I also understand that no action will be taken on this application until the required information and notifications are submitted to the Division.

Note: Statement must be completed by an individual with managerial and/or supervisory capacity.

 Cy Cowan
 Print or Type Name

Signature

 Regulatory Agent
 Title

 1/20/06
 Date

e-mail Address

NEW MEXICO OIL CONSERVATION DIVISION**SUBMITTAL GUIDELINES FOR ADMINISTRATIVE APPROVAL
OF NON-STANDARD LOCATION APPLICATIONS**

- I.** If the well is located on Federal or Indian Lands, the Federal Surface Management Agency must be notified and an on-site inspection conducted prior to filing the application. If an Application for Permit to drill or a Notice of Staking has been prepared, a copy must be submitted.
- Note I, Ia, + Ib.*
- II.** Completed C-162 showing the well location, proration unit, leases within the unit and other required information.
- III.** Land plat showing offset operators and working interest owners and any offsetting wells producing from the same pool or formation.
- A.** This information may be shown on the topo map if it does not impair the readability of the map.
- B.** The operator should certify that the information is current and correct. *THIS INFORMATION IS CURRENT AND CORRECT.*
- IV.** Original or clear copy of topographic map, preferably 7.5 minute quad, showing contours and other mapped features impacting the location, with the following information marked thereon (In order to be able to adequately show all of the necessary surface conditions it may be necessary to enlarge the relevant portion of the topo map to provide room for detail):
- A.** The proposed well location and proration unit;
- B.** An outline of the orthodox drilling windows as provided in the applicable rules for the subject application;
- C.** The location of any wells to any formation within the area of the proration unit and a statement as to whether an existing pad can be used to drill the proposed well: *Two wells share this pad.*
- V.** An enlargement of the topo map showing the subject area with the applicable additional information:
- N/A*
- A.** Terrain features not shown on the map which make an orthodox location unusable;
- B.** Proposed access roads and pipelines if they affect the location selection;
- C.** The location of any surface uses which prevent use of a legal location;

N/A

D. The location of any archeological sites identified in the archeological survey;

E. The location and nature of any other surface conditions which prevent the use of an orthodox location.

N/A

VI. If archeological sites are a reason for the unorthodox location request, a copy of the archeological survey, or a summary, identifying sites which cannot be disturbed or which must have any disturbance mitigated. In addition, the location of such areas should be marked on the enlarged topo so they can be clearly identified.

N/A

VII. A narrative report of any on-site inspection of the potential locations. If such on-site has resulted in elimination of legal locations due to surface conditions, such information should also be noted on the enlarged topo.

VIII.

A statement of why directional drilling to reach a legal bottom-hole location is not feasible. *THIS WELL WAS ORIGINALLY DRILLED TO THE CHESTER (ORTHODOX) THEN PLUGGED BACK TO THE WOLF CAMP (UNORTHODOX)*

IX.

An affidavit that notice has been sent to all parties entitled thereto, under the Divisions Rules and Regulations with return receipt cards showing date of receipt of notice.

The plug back formation is toward a portion of Yates Drilling Company lease in the SE/SE/4.

Thank you!

OPERATOR'S COPY

WF



Form 3160-3
(August 1999)UNITED STATES
DEPARTMENT OF THE INTERIOR
BUREAU OF LAND MANAGEMENT

APPLICATION FOR PERMIT TO DRILL OR REENTER

1a. Type of Work: <input checked="" type="checkbox"/> DRILL <input type="checkbox"/> REENTER		5. Lease Serial No. LC-049945-B	
b. Type of Well: <input type="checkbox"/> Oil Well <input checked="" type="checkbox"/> Gas Well <input type="checkbox"/> Other <input type="checkbox"/> Single Zone <input type="checkbox"/> Multiple Zone		6. If Indian, Allottee or Tribe Name	
2. Name of Operator Yates Drilling Company		7. If Unit or CA Agreement, Name and No.	
3A. Address 105 South Fourth Street Artesia, New Mexico 88210		8. Lease Name and Well No. Parrot Federal Com. #2	
3b. Phone No. (include area code) (505) 748-1471		9. API Well No.	
4. Location of Well (Report location clearly and in accordance with any State requirements. *) At surface 1600' FSL and 660' FEL At proposed prod. Zone Same		10. Field and Pool, or Exploratory Wildcat Chester	
14. Distance in miles and direction from nearest town or post office* Approximately 14 miles southeast of Artesia, New Mexico.		11. Sec., T., R., M., or Blk. and Survey or Area Section 29, T19S-R27E	
15. Distance from proposed location to nearest property or lease line, ft. (Also to nearest drg. unit line, if any.) 660'	16. No. of Acres in lease 320	17. Spacing Unit dedicated to this well E/2	
18. Distance from proposed location to nearest well, drilling, completed, applied for, on this lease, ft. 1/2 mile	19. Proposed Depth 10725'	20. BLM/BIA Bond No. on file 586000	
21. Elevations (Show whether DF, KDB, RT, GL, etc.)	22. Approximate date work will start* ASAP	23. Estimated duration 45 days	
24. Attachments ROSWELL CONTROLLED WATER BASIN			

The following, completed in accordance with the requirements of Onshore Oil and Gas Order No. 1, shall be attached to this form:

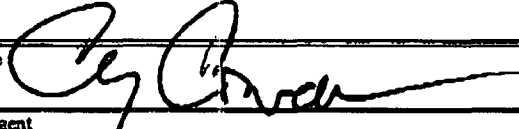
- | | |
|---|---|
| 1. Well plat certified by a registered surveyor. | 4. Bond to cover the operations unless covered by an existing bond on file (see Item 20 above). |
| 2. A Drilling Plan. | 5. Operator certification. |
| 3. A Surface Use Plan (if the location is on National Forest System Lands, the SUPO shall be filed with the appropriate Forest Service Office). | 6. Such other site specific information and/or plans as may be required by the authorized office. |

25. Signature 	Name (Printed/Typed) Cy Cowan	Date 2/10/04
Regulatory Agent		
Regulatory Agent		
Approved by (Signature) 	Name (Printed/Typed) Joe G. Lara	Date 2/24/04
Title Acting FIELD MANAGER	Office CARLSBAD FIELD OFFICE	

Application approval does not warrant or certify that the applicant holds legal or equitable title to those rights in the subject lease which would entitle the applicant to conduct operations thereon.

Conditions of approval, if any, are attached.

APPROVAL FOR 1 YEAR

Title 18 U.S.C. Section 1001 and Title 43 U.S.C. Section 1212, make it a crime for any person knowingly and willfully to make to any department or agency of the United States any false, fictitious or fraudulent statements or representations as to any matter within its jurisdiction.

*(Instructions on reverse)

APPROVAL SUBJECT TO
GENERAL REQUIREMENTS
AND SPECIAL STIPULATIONS
ATTACHEDWitness Surface and
Intermediate Casing

JMS N. French Dr., Hobbs, NM 88240

State of New Mexico

Form O-100

DISTRICT II

661 South First, Artesia, NM 88210

Energy, Minerals and Natural Resources Department

Revised March 17, 1989

Instruction on back

Submit to appropriate District Office

State Lease - 4 Copies

Fee Lease - 3 Copies

DISTRICT III

1000 N. Brown Rd., Aztec, NM 87410

OIL CONSERVATION DIVISION

P.O. Box 2088

Santa Fe, New Mexico 87504-2088

DISTRICT IV

800 South Pacheco, Santa Fe, NM 87505

☐ AMENDED REPORT

WELL LOCATION AND ACREAGE DEDICATION PLAT

API Number	Pool Code	Pool Name Wildcat Chester
Property Code	Property Name PARROT FEDERAL COM.	Well Number 2
OGND No. 025575	Operator Name YATES DRILLING COMPANY	Elevation 3413



Surface Location

UL or lot No.	Section	Township	Range	Lot Idn	Feet from the	North/South line	Feet from the	East/West line	County
1	29	19S	27E		1600	SOUTH	660	EAST	EDDY

Bottom Hole Location If Different From Surface

UL or lot No.	Section	Township	Range	Lot Idn	Feet from the	North/South line	Feet from the	East/West line	County
Dedicated Acres 320		Joint or Unit		Consolidation Code		Order No.			

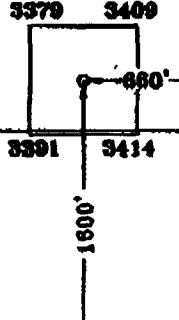
NO ALLOWABLE WILL BE ASSIGNED TO THIS COMPLETION UNTIL ALL INTERESTS HAVE BEEN CONSOLIDATED
OR A NON-STANDARD UNIT HAS BEEN APPROVED BY THE DIVISION

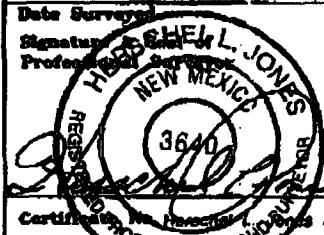
		NM-049945 B	NM-049945 C	OPERATOR CERTIFICATION I hereby certify the information contained herein is true and complete to the best of my knowledge and belief.  Signature Cy Cowan Printed Name Regulatory Agent Title February 6, 2004 Date
			N.32°37'43.8" W.104°17'40.4" 3379 3409  3391 3414 1600'	SURVEYOR CERTIFICATION I hereby certify that the well location shown on this plat was plotted from field notes of actual surveys made by me or under my supervision, and that the same is true and correct to the best of my belief. Date Surveyed 1/21/2004 Signature  Professional Surveyor  Certificate No. 3640 PROFESSIONAL LAND SURVEYOR GENERAL SURVEYING COMPANY

0 330' 660' 990' 1650' 1980' 2310' 2640' 2970' 3300' 3630' 3960' 4290' 4620' 4950' 5280' 5610' 5940' 6270' 6600'

YATES DRILLING COMPANY
Parrot Federal Com. #2
 1600' FSL and 660' FEL
 Section 29, T19S-R27E
 Eddy County, New Mexico

1. The estimated tops of geologic markers are as follows:

Queen	876'	Atoka	9645'
Grayburg	1184'	Morrow	9964'
San Andres	1771'	Morrow Clastics	10104'
Bone Spring Lime	2719'	Lower Morrow	10236'
1 st Bone Spring Lime	5417'	Barnett	10376'
3 rd Bone Springs Lime	7399'	Chester	10654'
Wolfcamp	7836'	TD	10725'
Cisco Canyon	8277'		
Strawn	9076'		

2. The estimated depths at which anticipated water, oil or gas formations are expected to be encountered:

Water: 200' - 300'
 Oil or Gas: All potential zones

3. Pressure Control Equipment: BOPE will be installed on the 9 5/8" casing and rated for 5000 BOP systems will be consistent with API RP 53. Pressure tests will be conducted before drilling out from under all casing strings which are set and cemented in place. Blowout Preventor controls will be installed prior to drilling the surface plug and will remain in use until the well is completed or abandoned. Preventors will be inspected and operated at least daily to ensure good mechanical working order, and this inspection recorded on the daily drilling report. See Exhibit B.

Auxiliary Equipment:

A. Auxiliary Equipment: Kelly cock, pit level indicators, flow sensor equipment and a sub with full opening valve to fit the drill pipe and collars will be available on the rig floor in the open position at all times for use when kelly is not in use.

4. THE PROPOSED CASING AND CEMENTING PROGRAM:

A. Casing Program: (All New)

<u>Hole Size</u>	<u>Casing Size</u>	<u>Wt./Ft</u>	<u>Grade</u>	<u>Thread</u>	<u>Interval</u>	<u>Length</u>	WITNESS
17 1/2"	13 3/8"	48#	H-40	ST&C	0-400'	400'	WITNESS
12 1/4"	9 5/8"	36#	J-55	ST&C	0-2800'	2800'	
8 3/4"	5 1/2"	17#	L-80	LT&C	0-1100'	1100'	
8 3/4"	5 1/2"	17#	J-55	LT&C	1100'-2200'	1100'	
8 3/4"	5 1/2"	15.5#	J-55	LT&C	2200'-6200'	4000'	
8 3/4"	5 1/2"	17#	J-55	LT&C	6200'-8000'	1800'	
8 3/4"	5 1/2"	17#	L-80	LT&C	8000'-9400'	1400'	
8 3/4"	5 1/2"	17#	HCP-110	LT&C	9400'-10725'	3425'	

A deep string of 7" casing will be set if problems are encountered.

Minimum Casing Design Factors: Collapse 1.125, Burst 1.0, Tensile Strength 1.8

Parrot Federal Com. #2**Page 2****B. CEMENTING PROGRAM:**

Surface casing: 500 sx Class 'C' + 2% CaCl₂ (YLD 1.32 WT 14.8).

Intermediate casing: Lead with 700 sx Lite (YLD 2.0 WT 12.5) Tail in w/200 sx Class C + 2% CaCl₂ (YLD 1.32 WT 14.8).

Production Casing: TOC 7300', Lead w/750 sx Super 'C' (YLD 1.63 WT 13.0)

5. Mud Program and Auxiliary Equipment:

<u>Interval</u>	<u>Type</u>	<u>Weight</u>	<u>Viscosity</u>	<u>Fluid Loss</u>
Spud to 400'	FW Gel/Paper	8.4-8.8	32-40	N/C
400'-2800'	Fresh Water	8.4	28	N/C
2800'-9600'	Cut Brine	8.6-9.6	28	N/C
9600'-10725'	S Gel/KCL/Starch/Drispac	9.6-10.0	32-38	<12cc

Sufficient mud material(s) to maintain mud properties, control lost circulation and contain a blow out will be available at the well site during drilling operations. Mud will be checked hourly by rig personnel.

6. EVALUATION PROGRAM:

Samples: 10' out from under intermediate casing to TD.

Logging: Platform Express CNL/LDT TD-surface casing; DLL MSFL TD-surface casing; BHC Sonic TD-surface casing; CNL/GR TD-surface; FMI TD-top of Wolfcamp.

Coring: None anticipated.

DST's: Possible Wolfcamp thorough Strawn.

7. Abnormal Conditions, Bottom hole pressure and potential hazards:**Anticipated BHP:**

From: 0	TO 400'	Anticipated Max. BHP: 175	PSI
From: 400'	TO 2800'	Anticipated Max. BHP: 1225	PSI
From: 2800'	TO 10600'	Anticipated Max. BHP: 5600	PSI

Abnormal Pressures Anticipated: None

Lost Circulation Zones Anticipated: None

H₂S Zones Anticipated: None

Maximum Bottom Hole Temperature: 189° F

8. ANTICIPATED STARTING DATE:

Plans are to drill this well as soon as possible after receiving approval. It should take approximately 30 days to drill the well with completion taking another 15 days.

MULTI-POINT SURFACE USE AND OPERATIONS PLAN

Yates Drilling Company
Parrot Federal Com. #2
1600' FSL and 660' FEL
Section 29, T19S-R27E
Eddy County, New Mexico

This plan is submitted with Form 3160-3, Application for Permit to Drill, covering the above described well. The purpose of this plan is to describe the location of the proposed well, the proposed construction activities and operations plan, the magnitude of the surface disturbance involved and the procedures to be followed in rehabilitating the surface after completion of the operations, so that a complete appraisal can be made of the environmental effect associated with the operations.

1. EXISTING ROADS:

Exhibit A is a portion of the BLM map showing the well and roads in the vicinity of the proposed location. The proposed wellsite is located approximately 14 miles southeast of Artesia, New Mexico and the access route to the location is indicated in red and green on Exhibit A.

DIRECTIONS:

Go south of Artesia on Highway 285 for approx. 24.5 miles to intersection of Capitan Reef Road and Hwy 285. Turn left on Capitan Reef Road and go approx. 5.9 miles to the intersection of Lake Road and Capitan Reef Road. Turn left on Lake Road (CR-34) and go approx. 0.2 of a mile. Turn right here on Netherland Road (CR-236) and go approx. 3.9 miles. The new road will start here going west.

2. PLANNED ACCESS ROAD:

- A. The new access road will be approximately .4 of a mile from the point of origin to the southeast corner of the well location.
- B. The new road will be 14 feet in width (driving surface) and will be adequately drained to control runoff and soil erosion.
- C. The new road will be bladed with drainage on one side. Traffic turnouts will not be built.
- D. The route of the road is visible.
- E. Existing roads will be maintained in the same or better condition.

3. LOCATION OF EXISTING WELL

- A. There is drilling activity within a one-mile radius of the wellsite.
- B. Exhibit D shows existing wells within a one-mile radius of the proposed wellsite.

4. LOCATION OF EXISTING AND/OR PROPOSED FACILITIES

- A. There are no production facilities on this lease at the present time.
- B. In the event that the well is productive, the necessary production facilities will be installed on the drilling pad. If the well is productive oil, a gas or diesel self-contained unit will be used to provide the necessary power. No power will be required if the well is productive of gas.

Parrot Federal Com. #2
Page 2

5. LOCATION AND TYPE OF WATER SUPPLY:

- A. It is planned to drill the proposed well with a fresh water system. The water will be obtained from commercial sources and will be hauled to the location by truck over the existing and proposed roads shown in Exhibit A.

6. SOURCE OF CONSTRUCTION MATERIALS:

The dirt contractor will acquire any materials from the closest source at the time of construction of the well pad.

7. METHODS OF HANDLING WASTE DISPOSAL:

- A. Drill cuttings will be disposed of in the reserve pits.
B. Drilling fluids will be allowed to evaporate in the reserve pits until the pits are dry.
C. Water produced during operations will be collected in tanks until hauled to an approved disposal system, or separate disposal application will be submitted.
D. Oil produced during operations will be stored in tanks until sold.
E. Current laws and regulations pertaining to the disposal of human waste will be complied with.
F. All trash, junk, and other waste materials will be contained in trash cages or bins to prevent scattering and will be removed and deposited in an approved sanitary landfill. Burial on site is not approved.

8. ANCILLARY FACILITIES: None

9. WELLSITE LAYOUT:

- A. Exhibit C shows the relative location and dimensions of the well pad, the reserve pits, the location of the drilling equipment, rig orientation and access road approach.
B. The reserve pits will be plastic lined.
C. A 600' x 600' area has been staked and flagged.

10. PLANS FOR RESTORATION

- A. After finishing drilling and/or completion operations, all equipment and other material not needed for further operations will be removed. The location will be cleaned of all trash and junk to leave the wellsite in as aesthetically pleasing a condition as possible.
B. Unguarded pits, if any, containing fluids will be fenced until they have dried and been leveled.
C. If the proposed well is non-productive, all rehabilitation and/or vegetation requirements of the Bureau of Land Management will be complied with and will be accomplished as expeditiously as possible. All pits will be filled level within 90 days after abandonment.

11. SURFACE OWNERSHIP: Bureau of Reclamation Albuquerque, New Mexico.

12. OTHER INFORMATION:

- A. Topography: Refer to the existing archaeological report for a description of the topography, flora, fauna, soil characteristics, dwellings, historical and cultural sites.
B. The primary surface use is for grazing.

Parrot Federal Com. #2**Page 3****13. OPERATOR'S REPRESENTATIVE****A. Through A.P.D. Approval:**

Cy Cowan, Regulatory Agent
Yates Petroleum Corporation
105 South Fourth Street
Artesia, New Mexico 88210
Phone (505) 748-1471

**B. Through Drilling Operations,
Completions and Production:**

Toby Rhodes, Operations Manager
Yates Drilling Company
105 South Fourth Street
Artesia, New Mexico 88210
Phone (505) 748-1471

14. CERTIFICATION:

I hereby certify that I, or persons under my direct supervision, have inspected the proposed drill site and access route, that I am familiar with the conditions which presently exist; that the statements made in this plan are to the best of my knowledge, true and correct; and, that the work associated with the operations proposed herein will be performed by Yates Petroleum Corporation and its contractors and subcontractors in conformity with this plan and the terms and conditions under which it is approved. This statement is subject to the provisions of 18 U.S.C. 1001 for the filing of a false statement.

2/10/2004

Regulatory Agent

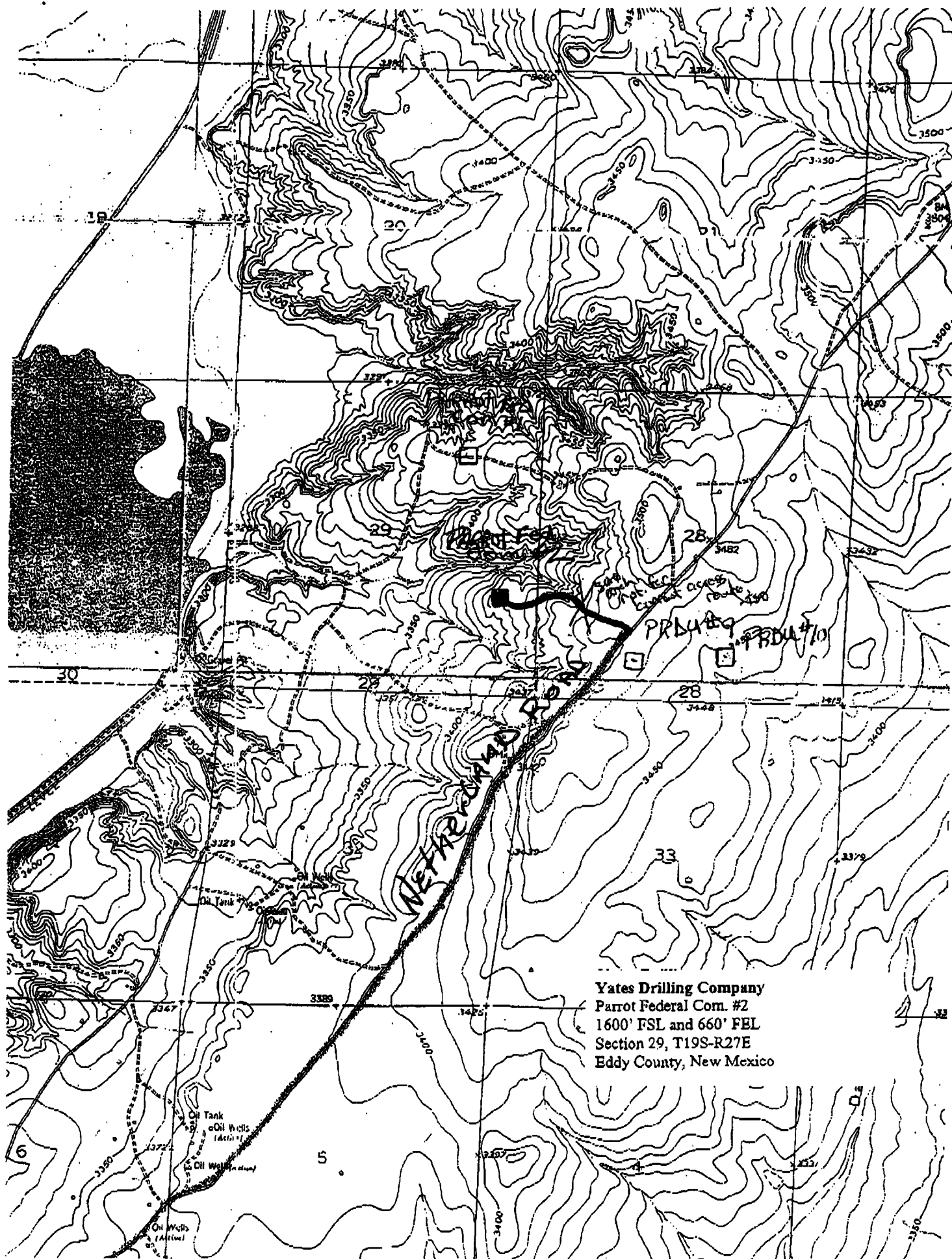

Yates Drilling Company
Parrot Federal Corn. #2
1600' FSL and 660' FEL
Section 29, T19S-R27E
Eddy County, New Mexico

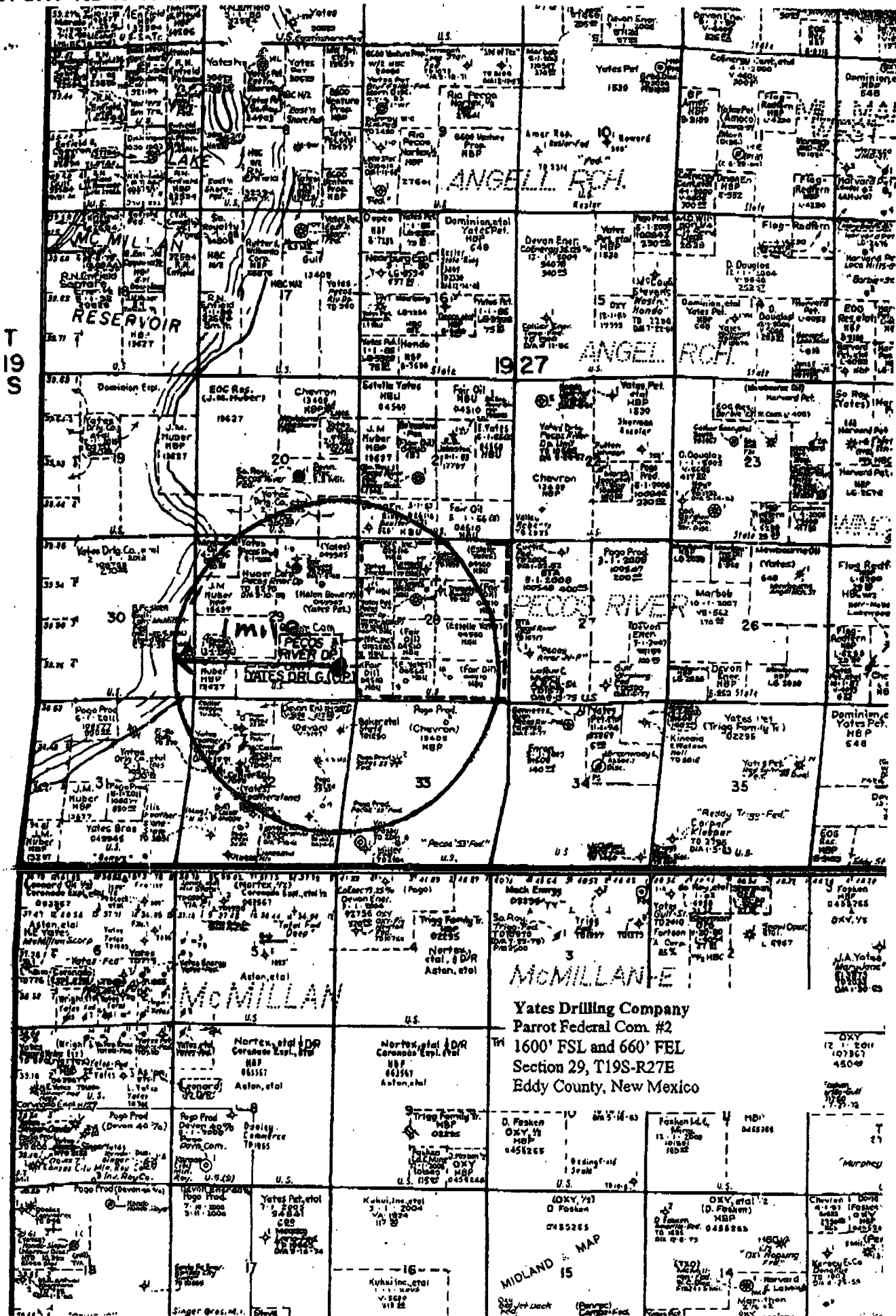

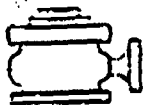

YATES DRILLING COMPANY

BOP-4

Typical 5,000 psi Pressure System Schematic Annular with Double Ram Preventer Stack

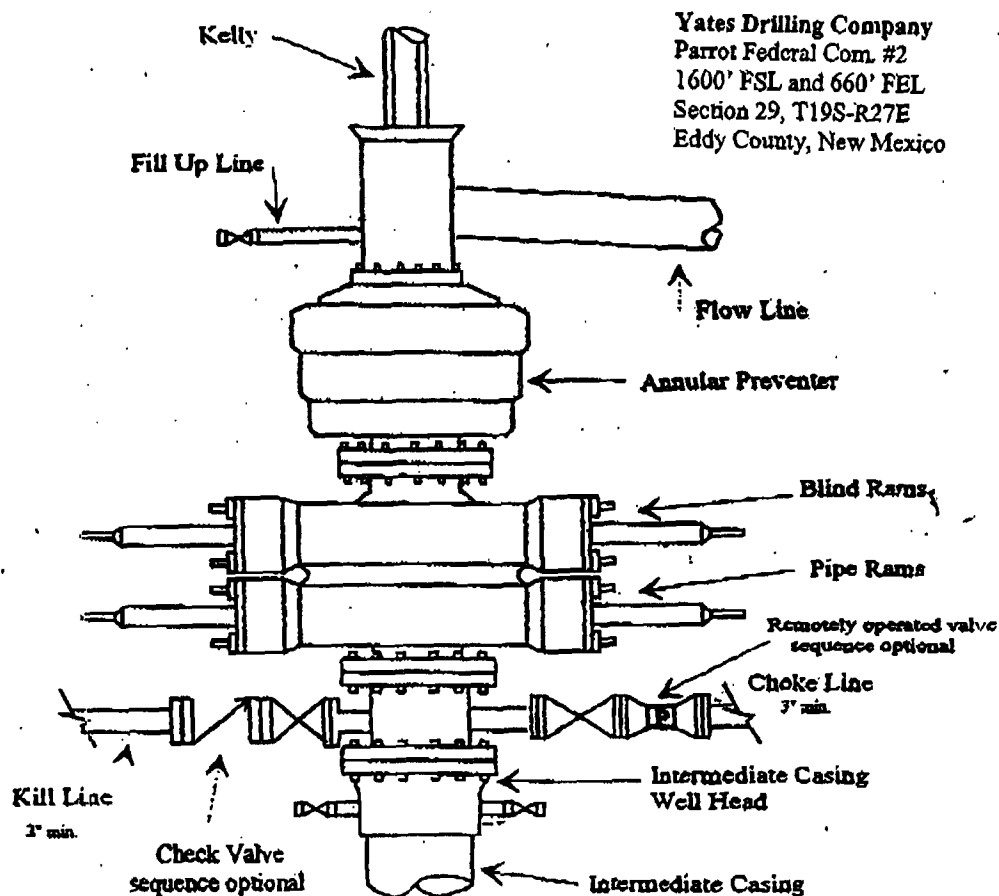

Typical 5,000 psi choke manifold assembly with at least these minimum features

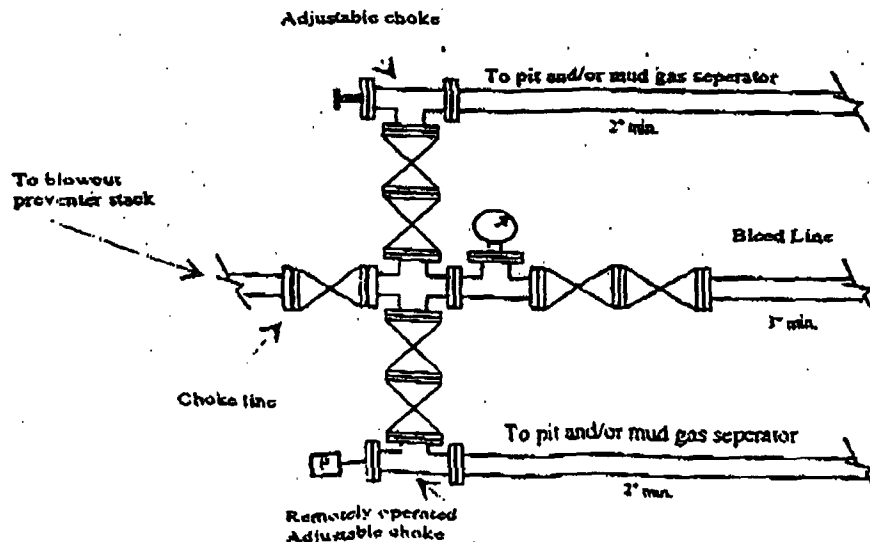

Yates Drilling Company

Location Layout for Permian Basin

Up to 12,000'

Yates Drilling Company
Parrot Federal Com. #2
1600' FSL and 660' FEL
Section 29, T19S-R27E
Eddy County, New Mexico

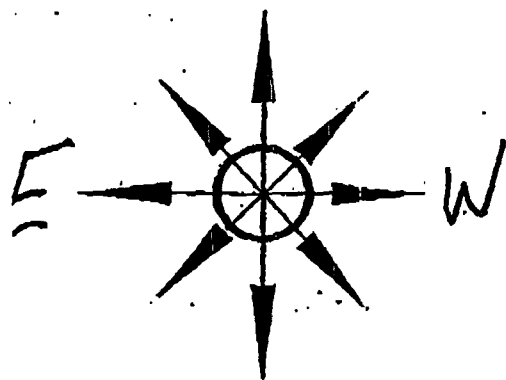

PITS EAST

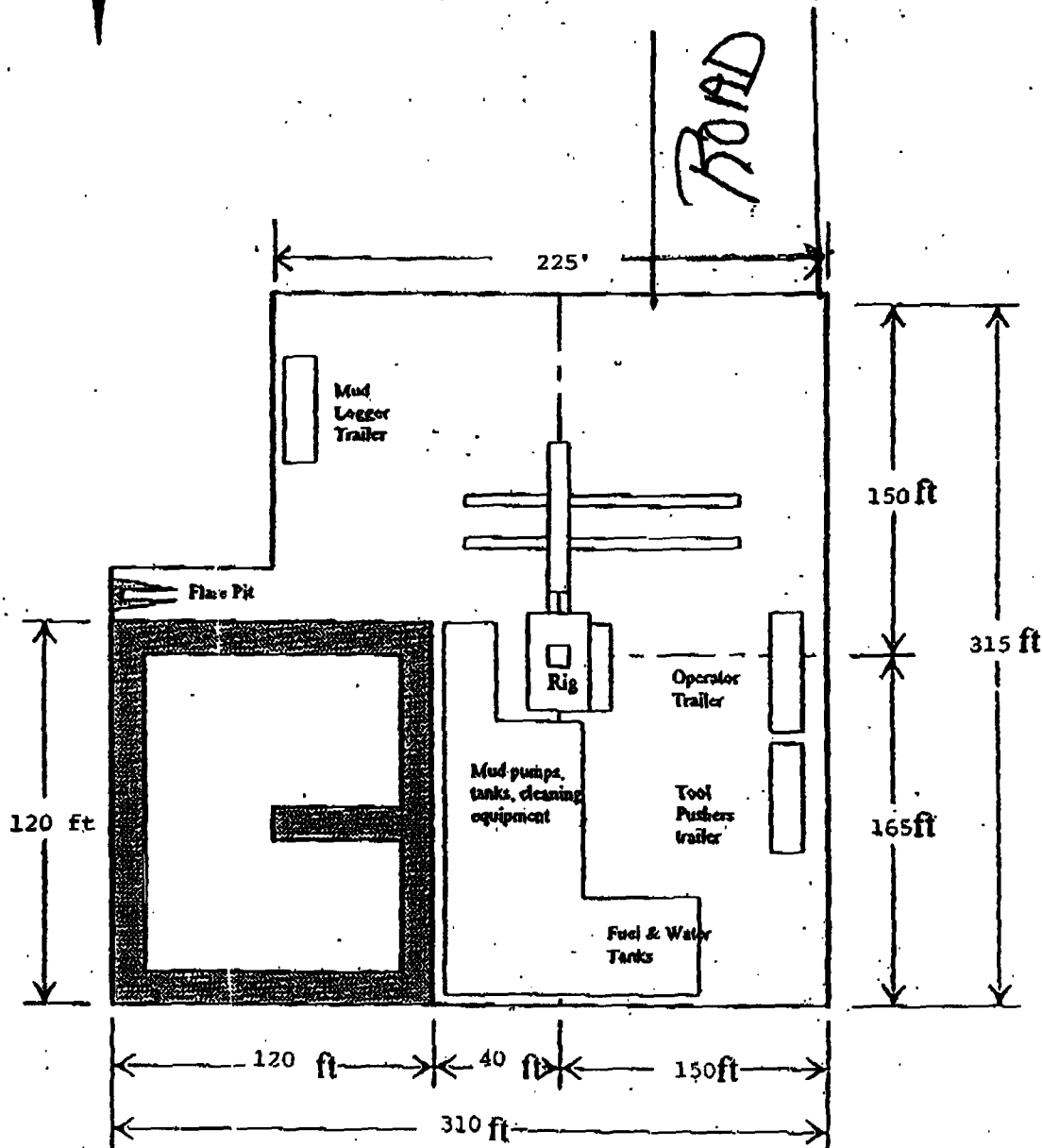

Distance from Well Head to Reserve Pit will vary between rigs

The above dimension should be a maximum

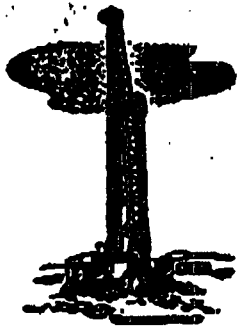
**YATES DRILLING COMPANY**

105 SOUTH FOURTH STREET - (505) 746-1471

FAX (505) 746-2268

ARTESIA, NEW MEXICO 88210

PEYTON YATES
PRESIDENT**S. P. YATES**
VICE PRESIDENT**RANDY G. PATTERSON**
SECRETARY**DENNIS G. KINSEY**
TREASURER**STATEMENT ACCEPTING RESPONSIBILITY FOR OPERATIONS**

The undersigned accepts all applicable terms, conditions, stipulations, and restrictions concerning operations conducted on the leased land or portion thereof, as described below:

Lease Number: LC-049945-B

Bond Coverage: Individually Bonded

Parrot Federal Com. #2
Legal Description of Land:

BLM Bond File Number: NM 0344

E/2 Section 29, T19S-R27E

Formations(s) (if applicable): N/A

Date: 2/13/04**YATES DRILLING COMPANY**
Cy Cowan, Regulatory Agent

Form 3160-3
(September 2001)UNITED STATES
DEPARTMENT OF THE INTERIOR
BUREAU OF LAND MANAGEMENT

OPERATOR'S COPY

FORM APPROVED
OMB No. 1004-0135
Expires January 31, 2004

SUNDRY NOTICES AND REPORTS ON WELLS

Do not use this form for proposals to drill or to enter an
abandoned well. Use Form 3160-3 (APD) for such proposals.

SUBMIT IN TRIPLICATE - Other instructions on reverse side

1. Type of Well

☐

Oil Well

☒

Gas Well

☐

Other

2. Name of Operator

Yates Drilling Company

3a. Address

105 S. 4th Str., Artesia, NM 88210

3b. Phone No. (include area code)

505-748-8463

4. Location of Well (Footage, Sec., T., R., M., OR Survey Description)

1600' FSL and 660' FEL Section 29-19S-27E

5. Lease Serial No.

LC-049945-B

6. If Indian, Allottee or Tribe Name

7. If Unit or CA/Agreement, Name and/or No.

8. Well Name and No.

Parrot Federal Com #2

9. API Well No.

30-015-33345

10. Field and Pool, or Exploratory Area

Wildcat Chester

11. County or Parish, State

Eddy, NM

12. CHECK APPROPRIATE BOX(ES) TO INDICATE NATURE OF NOTICE, REPORT, OR OTHER DATA

TYPE OF SUBMISSION

☐

Notice of Intent

☒

Subsequent Report

☐

Final Abandonment Notice

TYPE OF ACTION

☐

Acidize

☐

Alter Casing

☐

Casing Repair

☐

Change Plans

☐

Convert to Injection

☐

Deepen

☐

Fracture Treat

☐

New Construction

☐

Plug and Abandon

☒

Plug Back

☐

Production (Start/Resume)

☐

Reclamation

☐

Recomplete

☐

Temporarily Abandon

☐

Water Disposal

☐

Water Shut-Off

☐

Well Integrity

☒

Other

13. Describe Proposed or Completed Operation (clearly state all pertinent details, including estimated starting date of any proposed work and approximate duration thereof. If the proposal is to deepen directionally or recompletions horizontally, give subsurface locations and measured and true vertical depths of all pertinent markers and zones. Attach the Bond under which the work will be performed or provide the Bond No. on file with BLM/BIA. Required subsequent reports shall be filed within 30 days following completion of the involved operations. If the operation results in a multiple completion or recompletion in a new interval, a Form 3160-4 shall be filed once testing has been completed. Final Abandonment Notices shall be filed only after all requirements, including reclamation, have been completed, and the operator has determined that the site is ready for final disposition.)

9/21/2004 RIH and dumped 10' cement on top of existing plug at 8975'. Total cement on top of plug 35'. RIH with CIBP and set at 8360'. Tested casing to 1500 psi, held good. RIH and dumped 35' cement on top of CIBP. New PBTD 8325'.

9/24/2004 Perforated 8074'-8158', 467 shots, 4 SPF, .48" hole. Flowed well back.

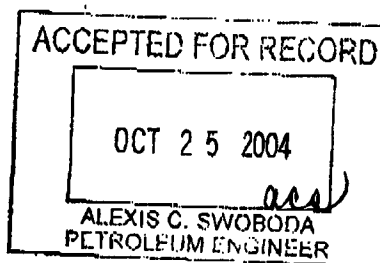

RECEIVED
2004 OCT 22 AM 9:13
BUREAU OF LAND MANAGEMENT
ROOM 1000

14. I hereby certify that the foregoing is true and correct

Name (Printed/Typed)

Karen J. Leishman

Title

Engineering Technician

Signature

Karen J. Leishman

Date

20-Oct-04

THIS SPACE FOR FEDERAL OR STATE OFFICE USE

Approved by

Title

Date

Conditions of approval, if any, are attached. Approval of this notice does not warrant or certify that the applicant holds legal or equitable title to those rights in the subject lease which would entitle the applicant to conduct operations thereon.

Office

Title 18 U.S.C. Section 1001 and Title 43 U.S.C. Section 1212, make it a crime for any person knowingly and willfully to make to any department or agency of the United

Form 3160-4
(September 2001)UNITED STATES
DEPARTMENT OF THE INTERIOR
BUREAU OF LAND MANAGEMENTFORM APPROVED
OMB NO. 1004-0137
Expires: January 31, 2004

WELL COMPLETION OR RECOMPLETION REPORT AND LOG

1a. Type of Well ☒ Oil Well ☒ Gas Well ☐ Dry ☐ Other

b. Type of Completion: ☒ Flow Well ☐ Work Over ☐ Deepen ☐ Plug Back ☐ Diff. Recovery ☐ Other

2. Name of Operator
Yates Drilling Company

3. Address
105 S. 4th Str., Artesia, NM 88210

3a. Phone No. (include area code)
505-748-8463

4. Location of Well (Report location clearly and in accordance with Federal requirements)*
At Surface 1600' FSL & 660' FEL
At top prod. interval reported below
At total depth

5. Lease Serial No.
LC-049345-B

6. If Indian, Allottee or Tribe Name

7. Unit or CA Agreement Name and No.

8. Lease Name and Well No.
Parrot Federal Com #2

9. API Well No.
30-015-33345 S1

10. Field and Pool, or Exploratory
Wildcat Chester Wolfcamp

11. Sec., T., R., M., on Block and Survey or Area
29-19S-27E

12. County or Parish **13. State**
Eddy NM

14. Date Spudded 5/29/2004 **15. Date T.D. Reached** 7/12/2004 **16. Date Completed** 10/5/2004
☐ D & A ☒ Ready to Prod.

17. Elevations (DF, RKB, F.T., GL)*
3413' GL

18. Total Depth: MD 10677' **19. Plug Back T.D.:** MD 8325' **20. Depth Bridge Plug Set:** MD 8360'
TVD TVD TVD

21. Type Electric & Other Mechanical Logs Run (Submit copy of each)
CSNG/DSN/SDL DLL/MGRD, SSS/RSCT

22. Was Well cased? ☒ No ☐ Yes (Submit analysis)
Was DST run? ☐ No ☒ Yes (Submit report)
Directional Survey? ☒ No ☐ Yes (Submit copy)

23. Casing and Liner Record (Report all strings set in well)

Hole Size	Size/Grade	Wt. (#/ft.)	Top (MD)	Bottom (MD)	State Cementer Depth	No. of Sks & Type of Cement	Slurry Vol. (BBL)	Cement Top*	Amount Pulled
17 1/2"	13 3/8"	54.5	surf	430'		475 "C"	183	circ	none
12 1/4"	9 5/8"	35#	surf	2820'		900 "C"	521	circ	none
8 3/4"	7"	26 & 23#	surf	8205'		800 "C"	581	circ	none
6 1/8"	4 1/2"	11.6#	7983'	10677'		275 "C"	73	7983'	none

24. Tubing Record

Size	Depth Set (MD)	Packer Depth (MD)	Size	Depth Set (MD)	Packer Depth (MD)	Size	Depth Set (MD)	Packer Depth (MD)
2 3/8"	7920'	7920'						

25. Producing Intervals

Formation	Top	Bottom	Perforated Interval	Size	No. Holes	Perf. Status
A) Wolfcamp	8074'	8222'	10186'-10222'	.43"	72	plugged
B)			10094'-10126'	.43"	128	plugged
C)			8382'-8398'	.43"	84	plugged
D)			8074'-8158'	.48"	467	producing

26. Perforation Record

27. Acid, Fracture, Treatment, Cement Squeeze, Etc.

Depth Interval	Amount and Type of Material
10186'-10222' (plugged)	Acidized w/ 2000 gals 7 1/2" NEFE acid w/ N2 Frac'd w/ 40,980# 20/40 Interprop w/4838 SCF N2, 90 tons CO2
10094'-10126' (plugged)	Acidized w/ 3500 gals 7 1/2% HCL w/ 700 gals methanol
8382'-8398' (plugged)	Acidized 4000 gals 20% HCL

28. Production - Interval A

Date First Produced	Test Date	Hours Tested	Test Production	Oil BBL	Gas MCF	Water BBL	Oil Gravity Corr. API	Gas Gravity	Production Method
10/6/2004	10/18/2004	24	↔	183.39	970	0			Flowing
Choke Size	Tbg. Press. Flwg.	Csg. Press.	24 Hr. Rate	Oil BBL	Gas MCF	Water BBL	Gas: Oil Ratio	Well Status	
12/64	2100		↔	183.39	970	0	528/1	flowing	

28a. Production-Interval B

Date First Produced	Test Date	Hours Tested	Test Production	Oil BBL	Gas MCF	Water BBL	Oil Gravity Corr. API	Gas Gravity	Production Method
			↔						
Choke Size	Tbg. Press. Flwg.	Csg. Press.	24 Hr. Rate	Oil BBL	Gas MCF	Water BBL	Gas: Oil Ratio	Well Status	
SI			↔						

ACCEPTED FOR RECORD
OCT 25 2004
ALEXIS C. SWINODA
PETROLEUM ENGINEER

28b. Production - Interval C

Date First Produced	Test Date	Hours Tested	Test Production ⇒	Oil BBL	Gas MCF	Water BBL	Oil Gravity Corr. API	Gas Gravity	Production Method
Choke Size	Tbg. Press. Flwg. SI	Csg. Press.	24 Hr. Rate ⇒	Oil BBL	Gas MCF	Water BBL	Gas: Oil Ratio	Well Status	

28c. Production - Interval D

Date First Produced	Test Date	Hours Tested	Test Production ⇒	Oil BBL	Gas MCF	Water BBL	Oil Gravity Corr. API	Gas Gravity	Production Method
Choke Size	Tbg. Press. Flwg. SI	Csg. Press.	24 Hr. Rate ⇒	Oil BBL	Gas MCF	Water BBL	Gas: Oil Ratio	Well Status	

29. Disposition of Gas (Sold, used for fuel, vented, etc.)

Sold

30. Summary of Porous Zones (Include Aquifers):

Show all important zones of porosity and contents thereof: Cored intervals and all drill-stem tests, including depth interval tested, cushion used, time tool open, flowing and shut-in pressures and recoveries.

31. Formation (Log) Markers

Formation	Top	Bottom	Description, Contents, etc.	Name	Top Meas Depth
				Queen	828'
				Grayburg	1124'
				San Andres	1682'
				Bone Spring Lime	2724'
				1st Bone Spring	5352'
				3rd Bone Spring	7364'
				Wolfcamp	7764'
				Cisco Canyon	8348'
				Strawn	9024'
				Atoka	9592'
				Morrow	9886'
				Morrow Clastics	10034'
				Lower Morrow	10182'

32. Additional remarks (include plugging procedure):

#31: Additional Formation Markers

Barnett/Austin Cycle 10342'
 Chester 10534'
 TD 10725'

33. Circle enclosed attachments:

1. Electrical/Mechanical Log. (1 full set req'd.) 2. Geologic Report 3. DST Report 4. Directional Survey
 5. Sundry Notice for plugging and cement verification 6. Core Analysis 7. Other:

34. I hereby certify that the foregoing and attached information is complete and correct as determined from all available records (see attached instructions)*

Name (please print) Karen J. Leishman

Title Engineering Tech

Signature

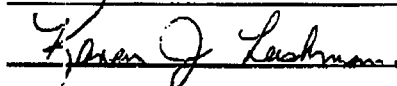

Date 10/20/2004

Title 18 U.S.C. Section 1001 and Title 43 U.S.C. Section 1212, make it a crime for any person knowingly and willfully to make to any department or agency of the United States any false, fictitious or fraudulent statements or representations as to any matter within its jurisdiction.

OPERATOR: YATES DRILLING
 WELL/LEASE: PARROT FED COM #2
 COUNTY: EDDY, NM

512-5062

STATE OF NEW MEXICO
 DEVIATION REPORT

186	1/2	5,873	3/4
401	1 1/4	6,124	1
647	1 1/2	6,378	3/4
894	1 1/2	6,631	2 1/4
1,116	1 1/2	6,758	1 1/2
1,401	1 1/2	6,886	1 1/2
1,655	3/4	7,012	1 1/2
1,908	3/4	7,139	2 1/4
2,163	3/4	7,266	3
2,416	1/2	7,329	2 3/4
3,050	1	7,392	2 1/4
3,273	1	7,518	2 3/4
3,525	1	7,652	2 3/4
3,775	1 1/4	7,778	2 1/4
4,033	2 1/4	7,906	2 1/2
4,128	2 1/4	8,033	2 1/4
4,223	2 3/4	8,162	2 1/2
4,325	2 1/4	8,254	2 3/4
4,413	2 3/4	8,388	3 1/4
4,509	2 3/4	8,513	1
4,603	2 3/4	8,640	1 1/2
4,699	2 1/2	8,768	1
4,795	2 1/2	8,891	1 1/2
4,891	1 3/4	9,145	1 1/2
4,986	1 3/4	9,385	1 3/4
5,113	2	9,642	1 1/2
5,240	1 3/4	9,903	1 1/2
5,365	1 3/4	10,188	3/4
5,492	1 3/4	10,430	1
5,619	2	10,688	1
5,746	1 1/2		

By

STATE OF TEXAS
 COUNTY OF MIDLAND

The foregoing instrument was acknowledged before me on this 14th day of July, 2004, by
 Steve Moore on behalf of Patterson-UTI Drilling Company LP, LLLP.

J. Robertson
 Notary Public for Midland County, Texas

My Commission Expires: 8/23/2007

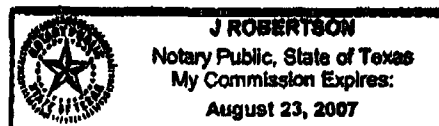

DISTRICT I

1600 E. French St., Hobbs, NM 88240

DISTRICT II

611 South First, Artesia, NM 88210

DISTRICT III

1600 E. Franco St., Aztec, NM 87413

DISTRICT IV

2400 South Penasco, Santa Fe, NM 87505

State of New Mexico

Energy, Minerals and Natural Resources Department

OIL CONSERVATION DIVISION

P.O. Box 2088

Santa Fe, New Mexico 87504-2088

Form C-102

Revised March 17, 1999

Instruction on back

Submit to Appropriate District Office

State Lease - 4 Copies

Per Lease - 2 Copies

☐ AMENDED REPORT**WELL LOCATION AND ACREAGE DEDICATION PLAT**

API Number	Pool Code 97400	Pool Name Lake McMillan Wolfcamp Oil
Property Code	Property Name Parrot Federal Com.	Well Number 2
OCED No. 025515	Operator Name YATES DRILLING COMPANY	Elevation 3413'

Surface Location

UL or lot No.	Section	Township	Range	Lot No.	Feet from the	North/South Line	Feet from the	East/West Line	County
I	29	19S	27E		1600'	South	660'	East	Eddy

Bottom Hole Location If Different From Surface

UL or lot No.	Section	Township	Range	Lot No.	Feet from the	North/South Line	Feet from the	East/West Line	County

Dedicated Acres 40	Joint or Infill	Consolidation Code	Order No.
-----------------------	-----------------	--------------------	-----------

NO ALLOWABLE WILL BE ASSIGNED TO THIS COMPLETION UNTIL ALL INTERESTS HAVE BEEN CONSOLIDATED
OR A NON-STANDARD UNIT HAS BEEN APPROVED BY THE DIVISION

NM-049945

660

1600'

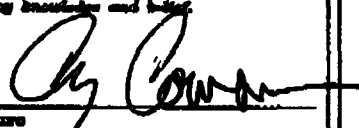
OPERATOR CERTIFICATION
 I hereby certify that the information contained herein is true and complete to the best of my knowledge and belief.

 Signature
 Cy Cowan
 Printed Name
 Regulatory Agent
 Title
 January 20, 2006
 Date

SURVEYOR CERTIFICATION
 I hereby certify that the well location shown on this plat was plotted from field notes of actual surveys made by me or under my supervision, and that the same is true and correct to the best of my belief.
 REFER TO ORIGINAL PLAT.
 Date Surveyed
 Signature & Seal of Professional Surveyor

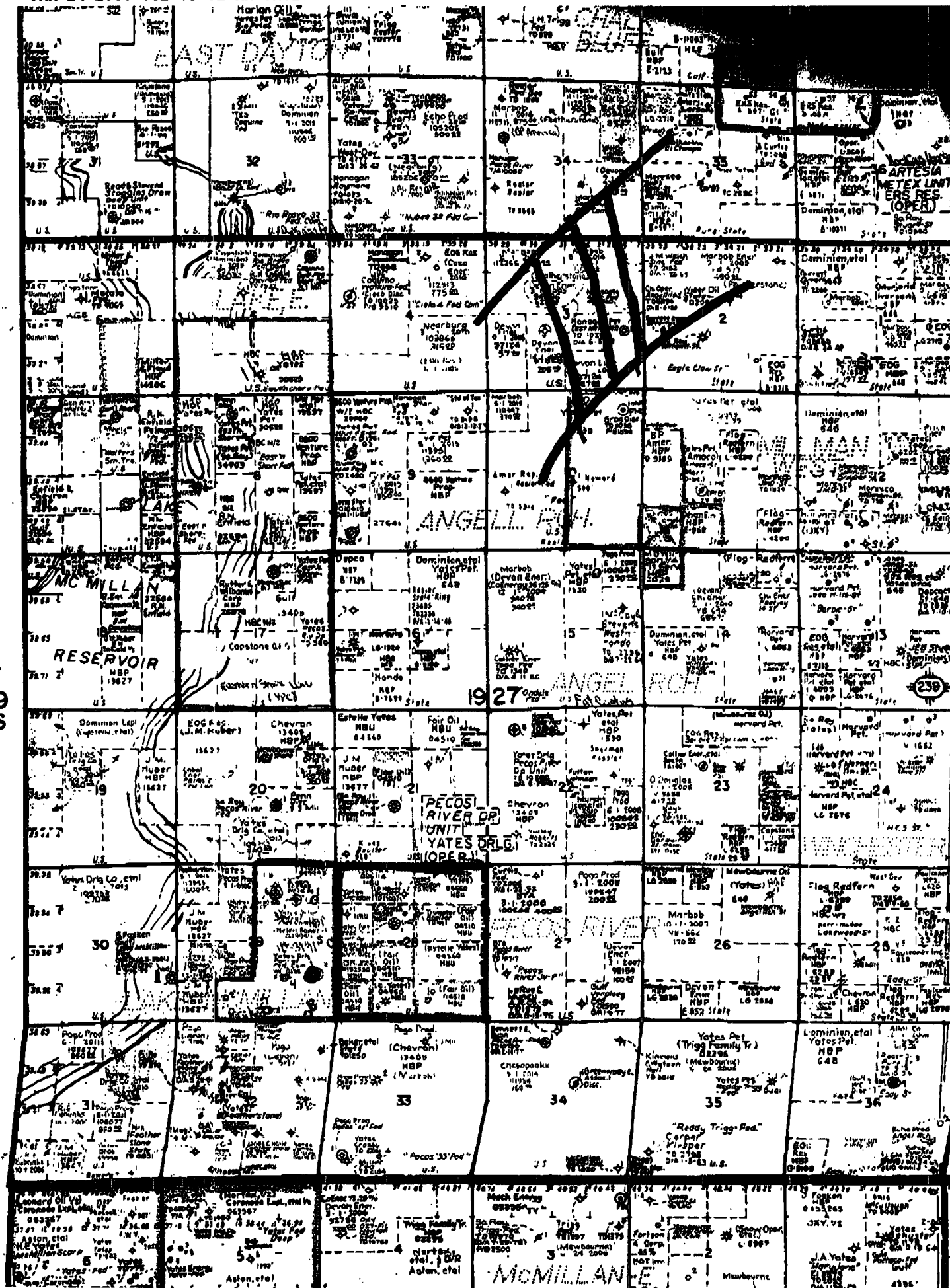
Certificate No. Horsthol L. Jones RLS 3840
 GENERAL SURVEYING COMPANY



Topographic map of the Parrot Federal Complex area. The map features contour lines, a grid, and two rectangular areas marked with boxes. Handwritten annotations include:

- Orthodox** (handwritten text above the lower box)
- Bristle** (handwritten text above the lower box)
- Window** (handwritten text above the lower box)
- PARROT FEDERAL COM. #1** (printed text below the upper box)
- PARROT FEDERAL COM. #2** (printed text below the lower box)
- B. O. R.** (handwritten text at the bottom center)
- 51** (handwritten text at the bottom right)

The map also shows contour lines with elevations such as 3350, 3300, 3250, 3200, 3150, 3100, 3050, 3000, 2950, 2900, 2850, 2800, 2750, 2700, 2650, 2600, 2550, 2500, 2450, 2400, 2350, 2300, 2250, 2200, 2150, 2100, 2050, 2000, 1950, 1900, 1850, 1800, 1750, 1700, 1650, 1600, 1550, 1500, 1450, 1400, 1350, 1300, 1250, 1200, 1150, 1100, 1050, 1000, 950, 900, 850, 800, 750, 700, 650, 600, 550, 500, 450, 400, 350, 300, 250, 200, 150, 100, 50, 0. A dashed line runs diagonally across the map.

1,053.0 FEET = 100.1818 ROODS, 0.3131 MILES OR 1.1394 ACRES, MORE OR LESS.

IV A+B

1999' 0 1999' 2000'

Scale 1" = 1000'

THE COMPARISON OF THE
WORK OF A GROUP WITH
INDIVIDUALS IN THE
PERFORMANCE OF THE SAME
TASKS IS THE MAIN
PURPOSE OF THE STUDY
CONDUCTED BY THE
RESEARCHERS OF THE
UNIVERSITY OF CALIFORNIA
AT BERKELEY. THE
RESULTS OF THE STUDY
WILL BE PUBLISHED IN
THE JOURNAL OF APPLIED
PSYCHOLOGY.

YATES DRILLING COMPANY

LINE WENT TO ADDRESS THE VARIOUS BUILDING COMPANY
FURNISH FURNITURE, ETC. IN AND IS NOW LOCATED IN
SECTION 26, TOWNSHIP 19 NORTH, RANGE 27 EAST, T8P4A,
SAND COUNTY, MINN. STATE.

GENERAL SURVEYING COMPANY P.O. BOX 1828
LOUISIANA NEW MEXICO 88100

Form No. 1-21-62	Page 1 of 1
Form No. 1-21-62	Page 1 of 1
Form No. 1-21-62	Page 1 of 1

SECTION 29, TOWNSHIP 1 SOUTH, RANGE 27 EAST, NMPM, OXY COUNTY, NEW MEXICO.

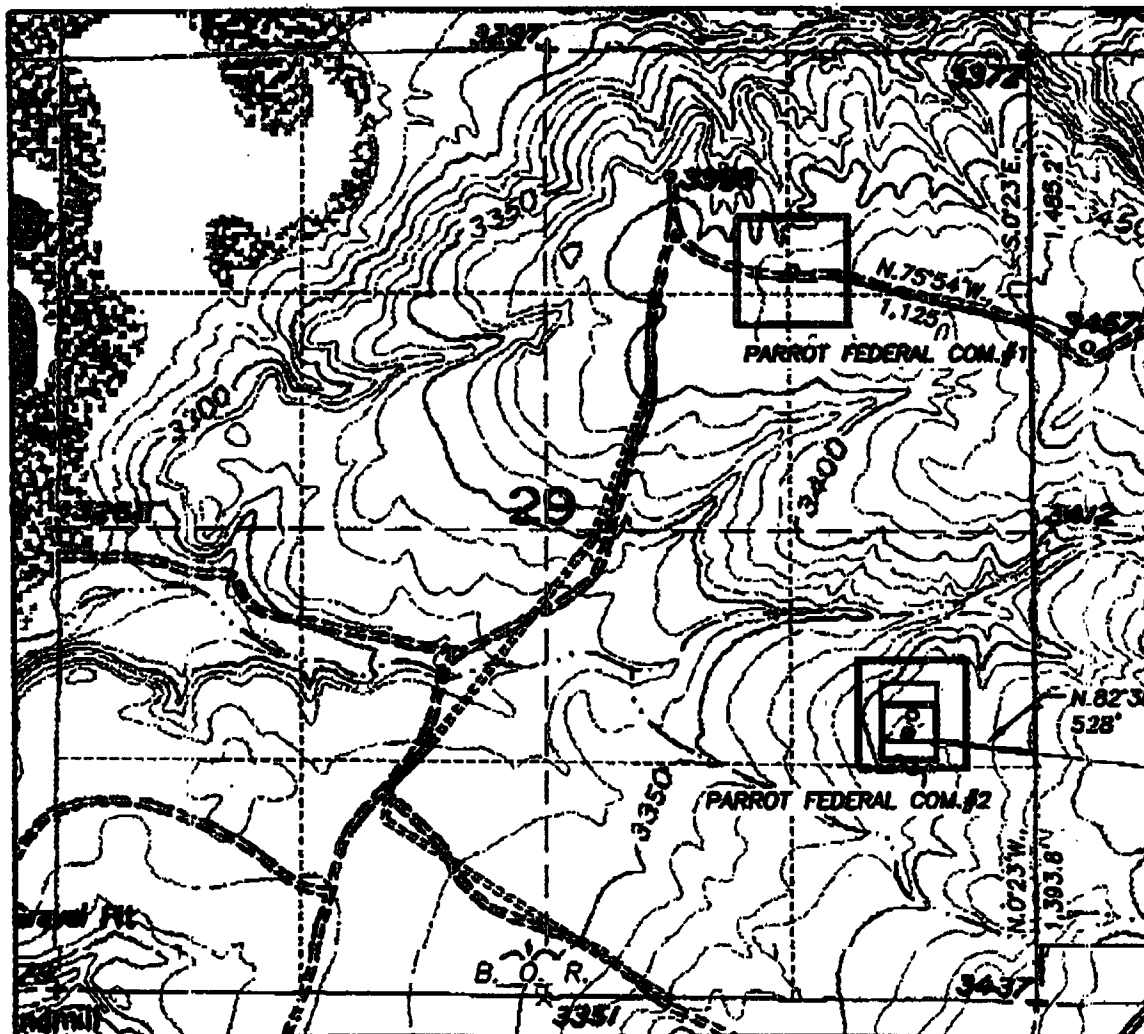

DESCRIPTION:

LEASE ROAD RIGHT OF WAYS 30 FEET WIDE AND 1,853.0 FEET IN LENGTH, BEING 15 FEET TO THE LEFT AND RIGHT OF THE SURVEY LINES AS SHOWN ON THIS PLAT.

1,853.0 FEET = 100.1818 RODS, 0.3131 MILES OR 1.1384 ACRES, MORE OR LESS.

IV-C

□ = 'S PARAKEET FED "29" #1

□ = 'S Parrot Fed Com #2

These two wells share this location.

1000' 0 1000' 2000'
Scale 1" = 1000'

THE PREPARATION OF THIS MAP, THE PERFORMANCE OF THE SURVEY UPON WHICH IT IS BASED, AND THE ACCURACY OF THE PLAT ACCURACIOUSLY DEPENDS UPON THE SURVEYOR'S SKILL AND MEET THE REQUIREMENTS OF THE SURVEYING ACTS AND LAWS OF NEW MEXICO AS ADOPTED BY THE NEW MEXICO STATE BOARD OF SURVEYORS FOR PROFESSIONAL SURVEYORS AND LAND SURVEYORS.



GENERAL SURVEYING COMPANY P.O. BOX 1928
LOVINGTON, NEW MEXICO 88260

YATES DRILLING COMPANY

LEASE ROAD TO ACCESS THE YATES DRILLING COMPANY
PARROT FEDERAL COM. #1 AND #2 WELLS, LOCATED IN
SECTION 29, TOWNSHIP 1 SOUTH, RANGE 27 EAST, NMPM,
OXY COUNTY, NEW MEXICO.

Survey Date: 1/21/2004	Sheet 1 of 1	Scale
Drawn By: Ed Blodgett	S.D. Number	
Date: 1/24/04	Scale 1" = 1000' PARROT 1&2	

TRANSACTION REPORT

P. 01

JAN-24-2006 TUE 08:21 AM

FOR:

RECEIVE

DATE	START	SENDER	RX TIME	PAGES	TYPE	NOTE	M#	DP
JAN-24	08:16 AM	5057484572	4' 31"	25	RECEIVE	OK		