

6/27/00	7/17/00	DC	KV	DHC
---------	---------	----	----	-----

ABOVE THIS LINE FOR DIVISION USE ONLY

NEW MEXICO OIL CONSERVATION DIVISION

- Engineering Bureau -

ADMINISTRATIVE APPLICATION COVERSHEET

THIS COVERSHEET IS MANDATORY FOR ALL ADMINISTRATIVE APPLICATIONS FOR EXCEPTIONS TO DIVISION RULES AND REGULATIONS

Application Acronyms:

[NSP-Non-Standard Proration Unit] [NSL-Non-Standard Location]
 [DD-Directional Drilling] [SD-Simultaneous Dedication]
 [DHC-Downhole Commingling] [CTB-Lease Commingling] [PLC-Pool/Lease Commingling]
 [PC-Pool Commingling] [OLS - Off-Lease Storage] [OLM-Off-Lease Measurement]
 [WFX-Waterflood Expansion] [PMX-Pressure Maintenance Expansion]
 [SWD-Salt Water Disposal] [IPI-Injection Pressure Increase]
 [EOR-Qualified Enhanced Oil Recovery Certification] [PPR-Positive Production Response]

[1] TYPE OF APPLICATION - Check Those Which Apply for [A]

[A] Location - Spacing Unit - Directional Drilling

☐ NSL ☐ NSP ☐ DD ☐ SD

Check One Only for [B] or [C]

[B] Commingling - Storage - Measurement

☒ DHC ☐ CTB ☐ PLC ☐ PC ☐ OLS ☐ OLM

[C] Injection - Disposal - Pressure Increase - Enhanced Oil Recovery

☐ WFX ☐ PMX ☐ SWD ☐ IPI ☐ EOR ☐ PPR

[2] NOTIFICATION REQUIRED TO: - Check Those Which Apply, or ☐ Does Not Apply

[A] ☒ Working, Royalty or Overriding Royalty Interest Owners

[B] ☐ Offset Operators, Leaseholders or Surface Owner

[C] ☐ Application is One Which Requires Published Legal Notice

[D] ☒ Notification and/or Concurrent Approval by BLM or SLO

U.S. Bureau of Land Management - Commissioner of Public Lands, State Land Office

[E] ☒ For all of the above, Proof of Notification or Publication is Attached, and/or,

[F] ☐ Waivers are Attached

[3] INFORMATION / DATA SUBMITTED IS COMPLETE - Statement of Understanding

I hereby certify that I, or personnel under my supervision, have read and complied with all applicable Rules and Regulations of the Oil Conservation Division. Further, I assert that the attached application for administrative approval is accurate and complete to the best of my knowledge and where applicable, verify that all interest (WI, RI, ORRI) is common. I further verify that all applicable API Numbers are included. I understand that any omission of data, information or notification is cause to have the application package returned with no action taken.

Note: Statement must be completed by an individual with supervisory capacity.

Walter M. Frank

Print or Type Name

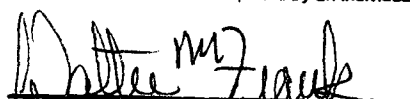
 Signature

Senior Operations
 Engineer

Title

06-16-2000

Date



ENERGY PRODUCTION COMPANY, L.P.

20 North Broadway, Suite 1500
Oklahoma City, Oklahoma 73102-8260

Telephone 405/235-3611
FAX 405/552-4667

Candace R. Graham
Telephone 405/552-4520
FAX 405/552-7813

June 15, 2000

Certified Mail No. Z 068 589 118

STATE OF NEW MEXICO
Energy, Minerals and Natural Resources Dept.
Oil Conservation Division
2040 South Pacheco
Santa Fe, NM 87505

RE: Application for Downhole Commingling
API 30-015-30584
State "BW" Com. #4
Section O-27-T18S-R28 E
Eddy County, New Mexico

Gentlemen:

Concerning the referenced, Devon Energy Production Company, L.P. requests administrative approval for an exception to Rule 303-A to permit the downhole commingling of production from Travis (Upper Penn) and Travis (Wolfcamp) pools. As per Rule 303-D, enclosed please find Form C-107-A, Application for Downhole Commingling, with attachments.

Please direct inquiries concerning this matter to Wally Frank, Senior Operations Engineer, in our Oklahoma City office at (405) 235-3611, X4595.

Yours truly,

DEVON ENERGY PRODUCTION COMPANY, L.P.

Candace R. Graham
Engineering Tech.

Attachments

/cg (Q:\Prod\Common\Frank\Aweldata\Gasprod\Statebw#4\6-2000 commingle - OCD.doc)

copy: NMOCD in Artesia, NM (**Certified Mail No. Z 068 589 119**)
Commissioner of Public Lands in Santa Fe (**Certified Mail No. Z 068 589 120**)
file, engineer, foreman, area interest owners

District I
1625 N. French Drive, Hobbs, NM 88240
District II
811 South First Street, Artesia, NM 88210
District III
1000 Rio Brazos Road, Aztec, NM 87410
District IV
2040 South Pacheco, Santa Fe, NM 87505

State of New Mexico
Energy, Minerals and Natural Resources Department

Form C-107A
Revised May 15, 2000

OIL CONSERVATION DIVISION
2040 South Pacheco
Santa Fe, New Mexico 87505
APPLICATION FOR DOWNHOLE COMMINGLING

APPLICATION TYPE
Single Well
Establish Pre-Approved Pools
EXISTING WELLBORE
Yes No

DEVON ENERGY PRODUCTION COMPANY, L.P. 20 N. BROADWAY, SUITE 1500, OKC, OK 73102-8260
Operator Address

State "BW" Com. 4 O-27-18S-28E Eddy, NM
Lease Well No. Unit Letter-Section-Township-Range County

OGRID No. 6137 Property Code 3502 API No. 30-015-30584 Lease Type: Federal X State Fee

DATA ELEMENT	UPPER ZONE	INTERMEDIATE ZONE	LOWER ZONE
Pool Name	Undesignated Travis (Wolfcamp)		Travis (Upper Penn)
Pool Code	96833		59860
Top and Bottom of Pay Section (Perforated or Open-Hole Interval)	8834-8854' proposed perfs		9673-9863'
Method of Production (Flowing or Artificial Lift)	Artificial lift		Artificial lift
Bottomhole Pressure (Note: Pressure data will not be required if the bottom perforation in the lower zone is within 150% of the depth of the top perforation in the upper zone)	Estimated 2000 psi		1800 psi
Oil Gravity or Gas BTU (Degree API or Gas BTU)	42°		46.4°
Producing, Shut-In or New Zone	Proposed – oil		Producing - oil
Date and Oil/Gas/Water Rates of Last Production. (Note: For new zones with no production history, applicant shall be required to attach production estimates and supporting data.)	Date: (see attached production estimate) Rates:	Date: Rates:	Date: 05-26-2000 Rates: 11 50 10 BO MCF BW
Fixed Allocation Percentage (Note: If allocation is based upon something other than current or past production, supporting data or explanation will be required.)	Oil Gas 79 % 82 %	Oil Gas % %	Oil Gas 21 % 18 %

ADDITIONAL DATA

Are all working, royalty and overriding royalty interests identical in all commingled zones? Yes X No
If not, have all working, royalty and overriding royalty interest owners been notified by certified mail? Yes No
Are all produced fluids from all commingled zones compatible with each other? Yes X No
Will commingling decrease the value of production? Yes No X
If this well is on, or communitized with, state or federal lands, has either the Commissioner of Public Lands or the United States Bureau of Land Management been notified in writing of this application? Yes X No

NMOCD Reference Case No. applicable to this well:

Attachments:
C-102 for each zone to be commingled showing its spacing unit and acreage dedication.
Production curve for each zone for at least one year. (If not available, attach explanation.)
For zones with no production history, estimated production rates and supporting data.
Data to support allocation method or formula.
Notification list of working, royalty and overriding royalty interests for uncommon interest cases.
Any additional statements, data or documents required to support commingling.

PRE-APPROVED POOLS

If application is to establish Pre-Approved Pools, the following additional information will be required:

List of other orders approving downhole commingling within the proposed Pre-Approved Pools
List of all operators within the proposed Pre-Approved Pools
Proof that all operators within the proposed Pre-Approved Pools were provided notice of this application.
Bottomhole pressure data.

I hereby certify that the information above is true and complete to the best of my knowledge and belief.

SIGNATURE Candace R. Graham TITLE Engineering Tech. DATE June 15, 2000
TYPE OR PRINT NAME Candace R. Graham X4520 TELEPHONE NO. (405) 235-3611

Devon Energy Production Company, L.P.
 State "BW" Com. #4
 Eddy County, New Mexico
 Downhole commingle Wolfcamp and Upper Penn

Production Allocation

Pool	BOPD	MCFGD	BWPD	Test Method
Travis (Wolfcamp)	40	220	9	ESTIMATE
Travis (Upper Penn)	<u>11</u>	<u>50</u>	<u>10</u>	PUMP TEST
Total	51	270	19	

Allocated Percentages (Post workover utilizing above production)

(NOTE: Refigure below. Also list on the form C107A)

Pool	Oil%	Gas%	Water%
Travis (Wolfcamp)	79	82	48
Travis (Upper Penn)	<u>21</u>	<u>18</u>	<u>52</u>
Total	100	100	100

DISTRICT I
P. O. Box 1980
Hobbs, NM 88241-1980

State of New Mexico
Energy, Minerals, and Natural Resources

Devon Energy
State "BW" Com. #4
Eddy County, New Mexico
Downhole commingle WC and UP
6/2000 Attachment

Form C-102
Revised 02-10-94
Instructions on back
to the Appropriate
Office
Lease - 4 copies
base - 3 copies

DISTRICT II
P. O. Drawer DD
Artesia, NM 88211-0719

OIL CONSERVATION
P. O. Box 1

Santa Fe, New Mexico 87504-2088

☐ AMENDED REPORT

DISTRICT III
1000 Rio Brazos Rd.
Aztec, NM 87410

DISTRICT IV
P. O. Box 2088
Santa Fe, NM 87507-2088

WELL LOCATION AND ACREAGE DEDICATION PLAT

1 API Number		2 Pool Code		3 Pool Name TRAVIS (UPPER PENN)	
4 Property Code		5 Property Name STATE BW COM			6 Well Number 4
7 OGRID No. 6137		8 Operator Name DEVON ENERGY CORPORATION (NEVADA)			9 Elevation 3564'

10 SURFACE LOCATION

UL or lot no.	Section	Township	Range	Lot Ida	Feet from the	North/South line	Feet from the	East/West line	County
0	27	18 SOUTH	28 EAST, N.M.P.M.		740'	SOUTH	2264'	EAST	EDDY

11 BOTTOM HOLE LOCATION IF DIFFERENT FROM SURFACE

UL or lot no.	Section	Township	Range	Lot Ida	Feet from the	North/South line	Feet from the	East/West line	County

12 Dedicated Acres 80	13 Joint or Infill	14 Consolidation Code	15 Order No.
--------------------------	--------------------	-----------------------	--------------

NO ALLOWABLE WELL BE ASSIGNED TO THIS COMPLETION UNTIL ALL INTERESTS HAVE BEEN CONSOLIDATED OR A NON-STANDARD UNIT HAS BEEN APPROVED BY THE DIVISION

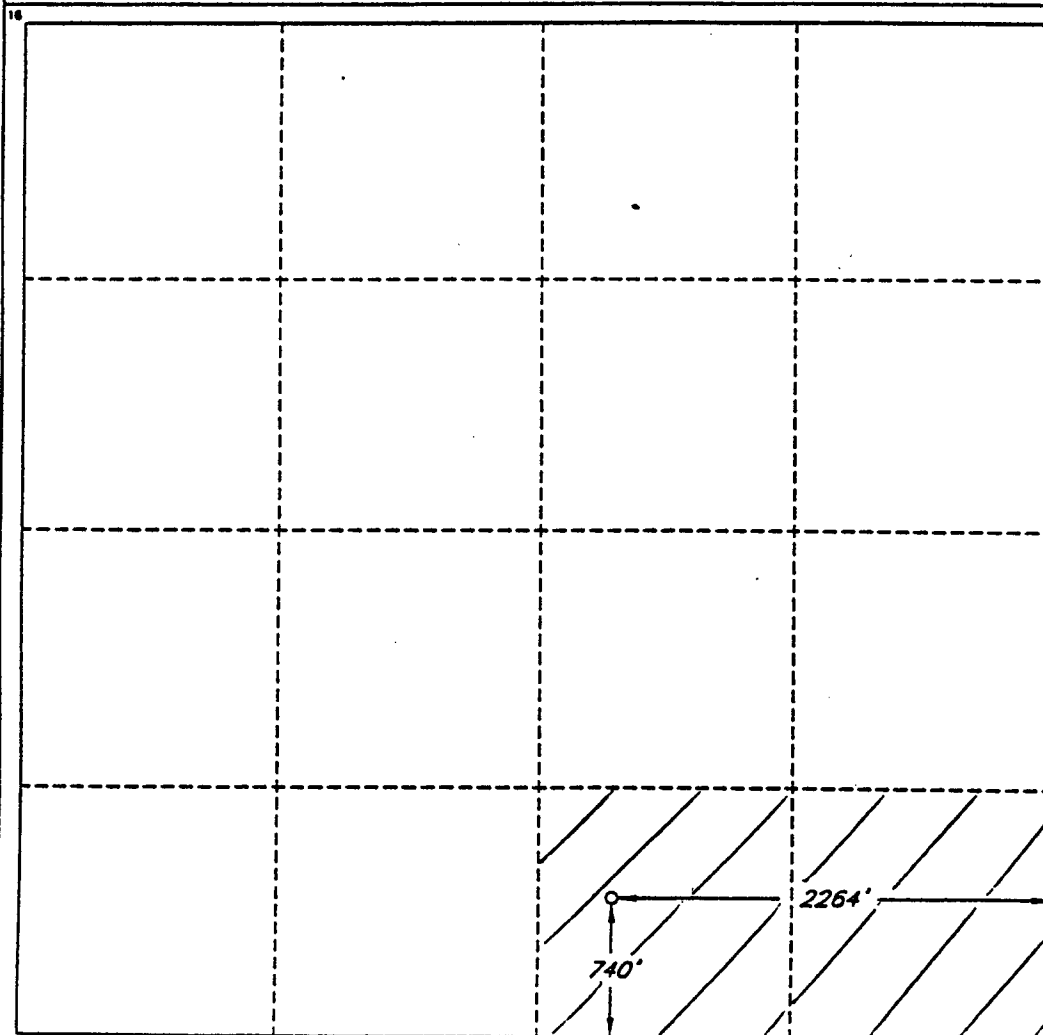

OPERATOR CERTIFICATION

I hereby certify that the information contained herein is true and complete to the best of my knowledge and belief.

Signature

Candace R. Graham

Printed Name

Candace R. Graham

Title

Engineering Tech.

Date

February 26, 1999

SURVEYOR CERTIFICATION

I hereby certify that the well location shown on this plat was plotted from field notes of actual surveys made by me or under my supervision, and that the same is true and correct to the best of my belief.

Date of Survey

FEBRUARY 26, 1999

Signature and Seal of Professional Surveyor

ROGER M. ROBBINS
REGISTERED PROFESSIONAL SURVEYOR
NEW MEXICO
12128

Certificate No. 12128

JOB #62558 / 99 SE / V.H.B.

DISTRICT I
P. O. Box 1980
Hobbs, NM 88241-1980

State of New Mexico
Energy, Minerals, and Natural Resources

Devon Energy
State "BW" Com. #4
Eddy County, New Mexico
Downhole commingle WC and UP
6/2000 Attachment

Form C-102
Revised 02-10-94
Instructions on back
to the Appropriate
Office
- 4 copies
- 3 copies

DISTRICT II
P. O. Drawer DD
Artesia, NM 88211-0719

OIL CONSERVATION

P. O. Box 2088
Santa Fe, New Mexico 87504-2088

☐ AMENDED REPORT

DISTRICT III
1000 Rio Brazos Rd.
Aztec, NM 87410

DISTRICT IV
P. O. Box 2088
Santa Fe, NM 87507-2088

WELL LOCATION AND ACREAGE DEDICATION PLAT

1 API Number		2 Pool Code		3 Pool Name TRAVIS (UPPER PENN) WILDCAT (WOLFCAMP)					
4 Property Code		5 Property Name STATE BW COM				6 Well Number 4			
7 OGRID No. 6137		8 Operator Name DEVON ENERGY CORPORATION (NEVADA)				9 Elevation 3564'			
10 SURFACE LOCATION									
UL or lot no. 0	Section 27	Township 18 SOUTH	Range 28 EAST, N.M.P.M.	Lot Ida	Feet from the 740'	North/South line SOUTH	Feet from the 2264'	East/West line EAST	County EDDY
11 BOTTOM HOLE LOCATION IF DIFFERENT FROM SURFACE									
UL or lot no.	Section	Township	Range	Lot Ida	Feet from the	North/South line	Feet from the	East/West line	County
12 Dedicated Acres 40		13 Joint or Infill		14 Consolidation Code		15 Order No.			

NO ALLOWABLE WELL BE ASSIGNED TO THIS COMPLETION UNTIL ALL INTERESTS HAVE BEEN CONSOLIDATED OR A NON-STANDARD UNIT HAS BEEN APPROVED BY THE DIVISION

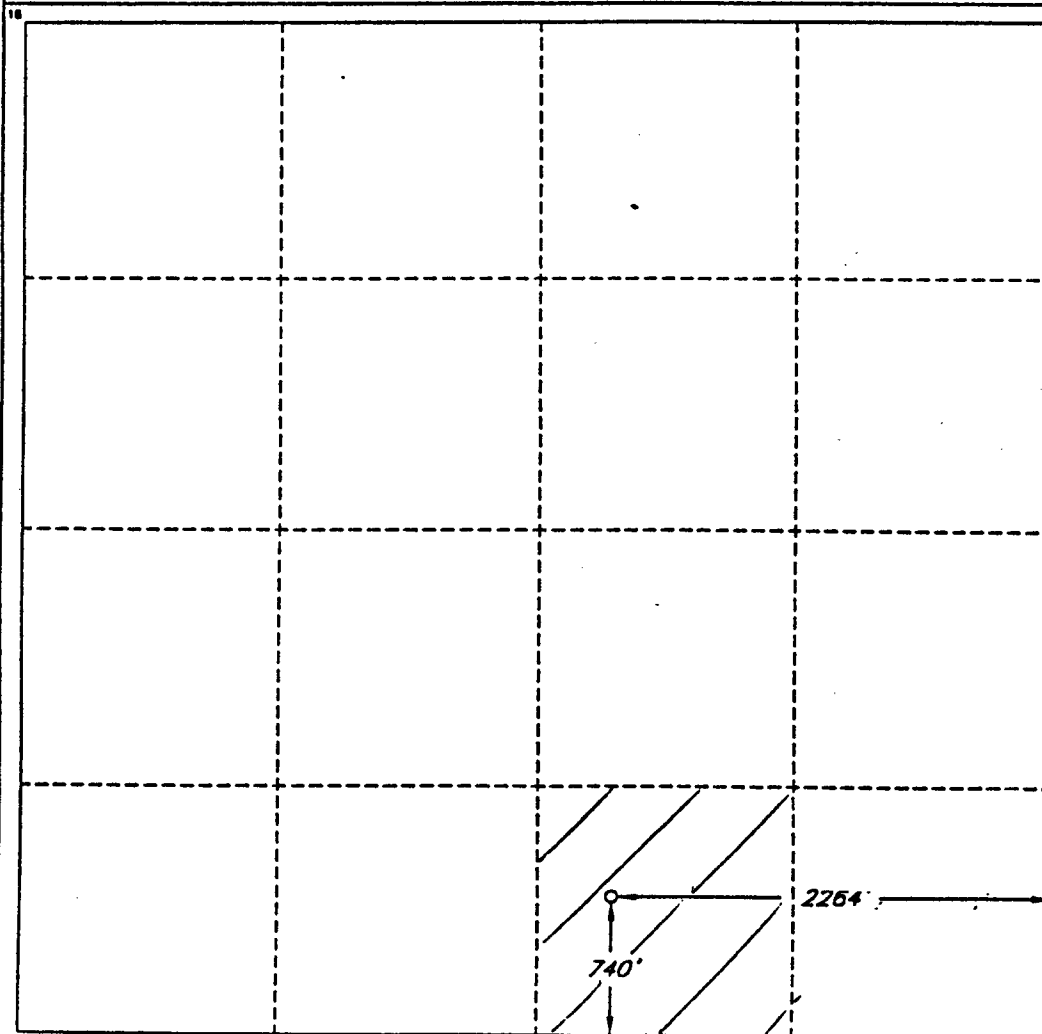

OPERATOR CERTIFICATION

I hereby certify that the information contained herein is true and complete to the best of my knowledge and belief.

Signature

Candace R. Graham

Printed Name

Candace R. Graham

Title

Engineering Tech.

Date

February 26, 1999

SURVEYOR CERTIFICATION

I hereby certify that the well location shown on this plat was plotted from field notes of actual surveys made by me or under my supervision, and that the same is true and correct to the best of my belief.

Date of Survey

FEBRUARY 26, 1999

Signature and Seal of Professional Surveyor

ROGER M. ROBBINS
12128
REGISTERED PROFESSIONAL SURVEYOR
NEW MEXICO

Certificate No. 12128
ROGER M. ROBBINS

JOB #62558 / 99 SE / V.H.B.

revised 7/1999 /cg

Devon Energy Production Company, L.P.
State "BW" Com. #4
Eddy County, New Mexico
Downhole commingle Wolfcamp and Upper Penn

Attach production curves for each zone for at least one year. (If not available, attach explanation.)

Devon plans to allocate production by assuming any incremental production gain, realized after the commingling the Upper Penn and Wolfcamp, would come from the Wolfcamp.

Attached is the Upper Penn production curve for the State "BW" Com. #4, which had initial production on 5/7/1999. This well produces into a common battery for the State "BW" Com. Upper Penn Lease. There are three wells currently producing into this common Upper Penn battery. Each well will have at least two different monthly production tests through the test facilities located at the common battery. The Upper Penn production graph illustrates that the decline of the Upper Penn formation is very consistent. Devon plans to allocate production by assuming any incremental production gain realized after the commingle of the Upper Penn and Wolfcamp would come from the Wolfcamp.

For zones with no production history, estimated production rates and supporting data.

Devon's estimated production history for the Wolfcamp is based upon the production history of Marathon's Samuel Burns 34 #2. The 34 #2 is located $\pm 3600'$ to the southwest of the State "BW" Com. #4. Both the Wolfcamp and Upper Penn, currently being downhole commingled in the Burns 34 #2, are geologically correlative to the intervals being proposed for downhole commingle in the State "BW" Com. #4.

Because the State "BW" Com. #4 is updip of the Burns 34 #2, Devon believes that the Wolfcamp will decline at significantly less rate than the Burns 34 #2 (see attached production curve). Devon believes that the initial production rate of 220 Mcfd, 40 Bopd, and 9 Bwpd will decline at a rate of 90% for the next four months, slow to a rate of 50% for four months, and then drop to a rate of 10% thereafter. Please see the attached estimated production curve and tabular spreadsheet.

Data to support allocation method or formula.

The attached spreadsheet, of the production from the State "BW" Com. #4, provides a good history of the Upper Penn production. This data indicates a consistent decline. Once commingled, the incremental production of the well will be allocated to the Wolfcamp with the remaining production being allocated to the Upper Penn.

Devon Energy Production Company, L.P.
State "BW" Com. #4
Eddy County, New Mexico

Daily average production rates from the Upper Penn

LEASE NAME	#	DATE	BOPD	MCFGD	BWPD
State BW	4	May-99	24	515	10
State BW	4	Jun-99	68	214	2
State BW	4	Jul-99	44	178	21
State BW	4	Aug-99	42	169	21
State BW	4	Sep-99	45	116	24
State BW	4	Oct-99	39	115	28
State BW	4	Nov-99	44	107	10
State BW	4	Dec-99	21	102	0
State BW	4	Jan-00	29	91	0
State BW	4	Feb-00	18	43	0
State BW	4	Mar-00	17	39	0
State BW	4	Apr-00	14	38	0

Devon Energy
State "BW" Com. #4
Eddy County, New Mexico
Downhole commingle WC and UP
6/2000 Attachment

**State BW #4 (Upper Penn)
Daily production average**

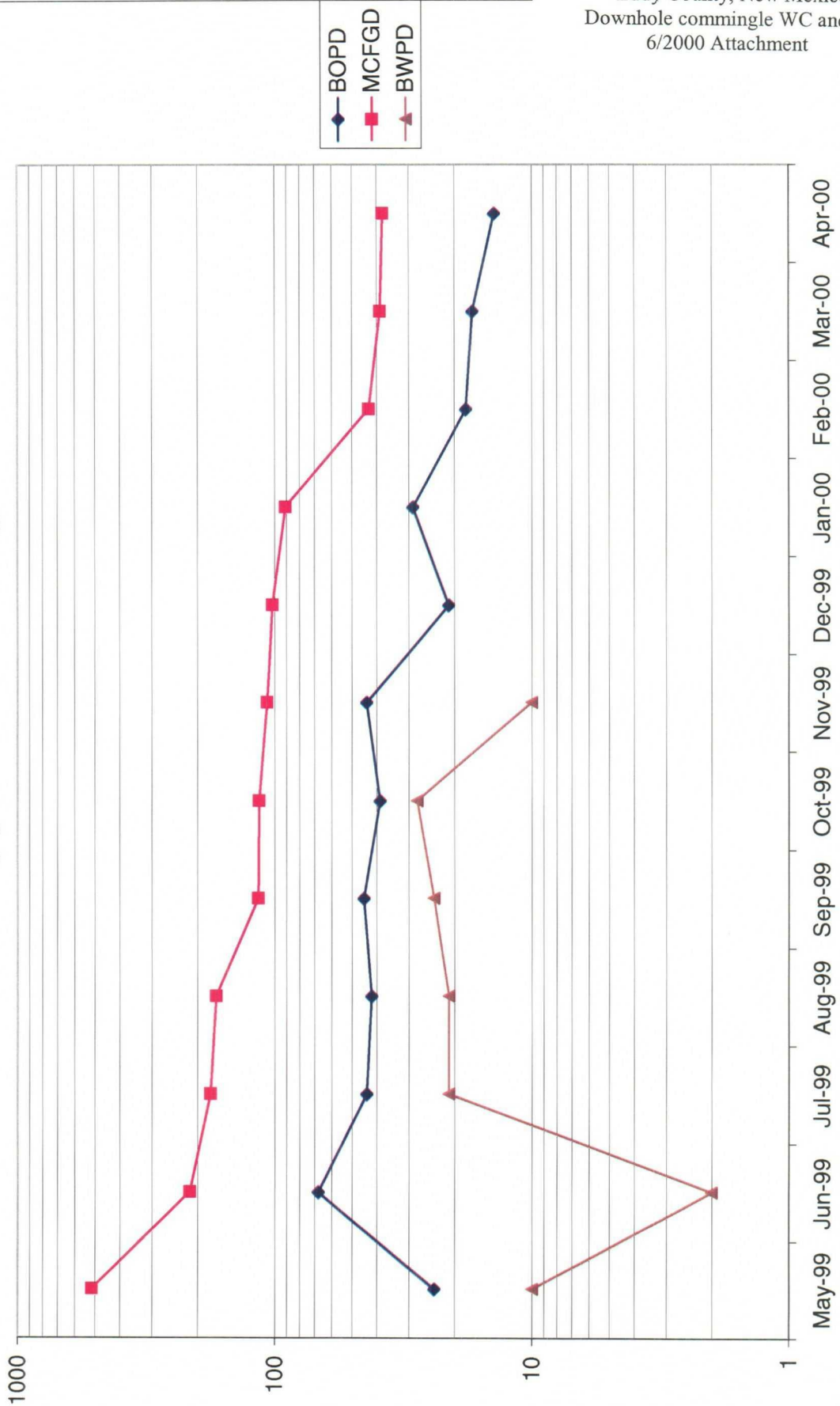

Estimated Wolfcamp Production
State BW Com. #4
(05-26-2000)

Month	Mcfd	Bopd	Bwpd
1	220	40	9
2	214	39	9
3	201	37	8
4	184	33	8
5	163	30	7
6	141	26	6
7	118	21	5
8	96	17	4
9	75	14	3
10	58	10	2
11	43	8	2
12	31	6	1
13	29	5	1
14	28	5	1
15	26	5	1
16	25	4	1
17	23	4	1
18	21	4	1
19	20	4	1
20	18	3	1
21	17	3	1
22	15	3	1
23	14	3	1
24	13	2	1

Devon Energy
State "BW" Com. #4
Eddy County, New Mexico
Downhole commingle WC and UP
6/2000 Attachment

Estimated Wolfcamp Production Decline

State BW Com. #4

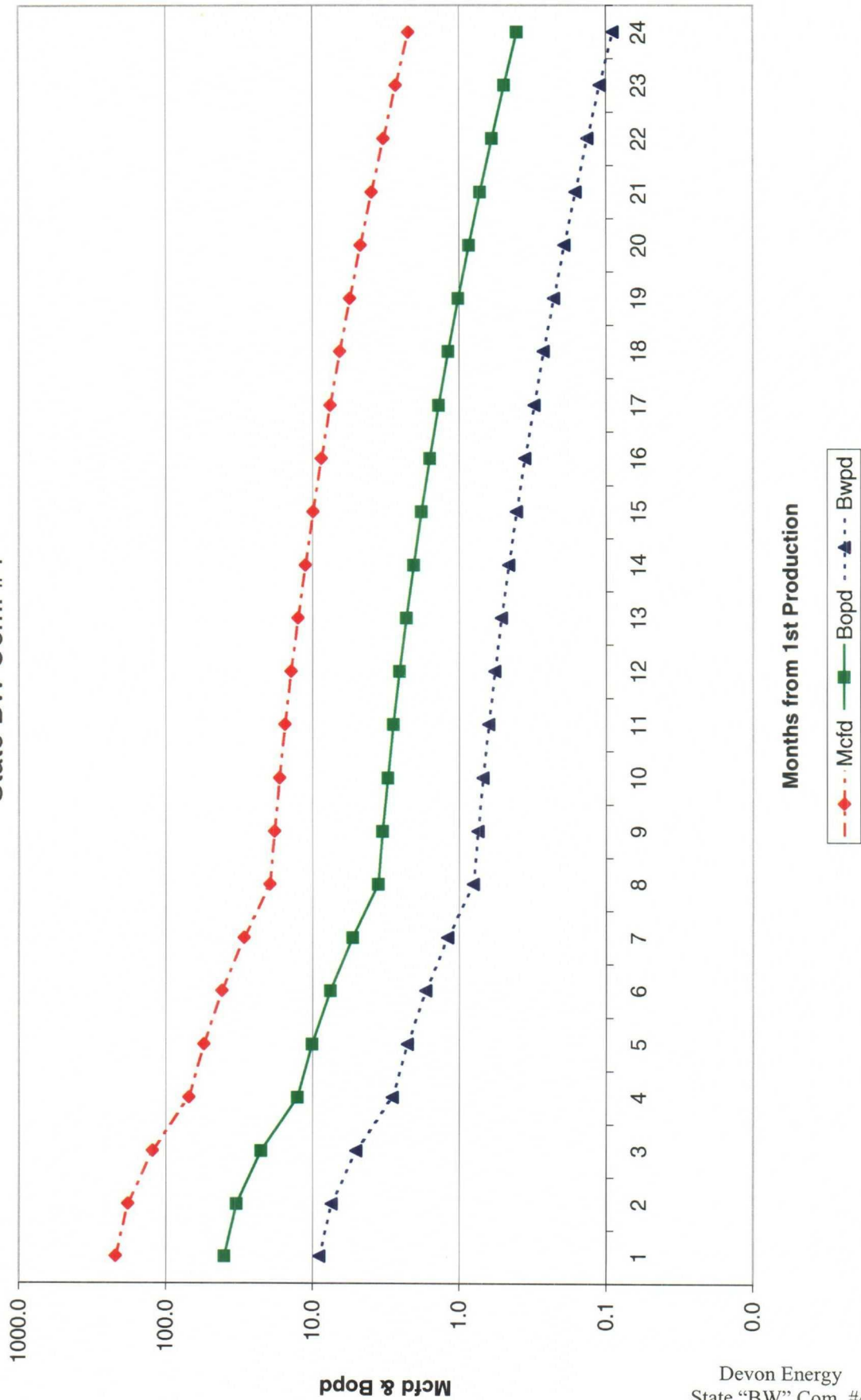

Devon Energy
 State "BW" Com. #4
 Eddy County, New Mexico
 Downhole commingle WC and UP
 6/2000 Attachment

Devon Energy
State "BW" Com. #4
Eddy County, New Mexico
Downhole commingle WC and UP
6/2000 Attachment



TRAVIS - UPPER PENN
WOLFCAMP/UPPER PENN(Canyon)
COMPLETIONS (shown in triangles)

George Davis	1" = 2000'	7/29/99
PB-Turkey Tract	4: Travis Upper Penn	BW4WOLJ.gpf

**NEW MEXICO ENERGY, MINERALS
& NATURAL RESOURCES DEPARTMENT**

Devon Energy
State "BW" Com. #4
Eddy County, New Mexico
Downhole commingle WC and UP
6/2000 Attachment

ADMINISTRATIVE ORDER DHC-2207

Marathon Oil Company
P.O. Box 2490
Hobbs, New Mexico 88240

Attn: Mr. Andrew J. Schwandt

*Samuel Burns "34" State No. 2
API No. 30-015-30315
Unit E, Section 34, Township 18 South, Range 28 East, NMPM,
Eddy County, New Mexico.
Travis-Wolfcamp (Oil-96833), and
Travis-Upper Penn (Oil-59860) Pools*

Dear Mr. Schwandt:

Reference is made to your recent application for an exception to Rule 303.A. of the Division Rules and Regulations to permit the above described well to commingle production from the subject pools in the wellbore.

It appearing that the subject well qualifies for approval for such exception pursuant to the provisions of Rule 303.C., and that reservoir damage or waste will not result from such downhole commingling, and correlative rights will not be violated thereby, you are hereby authorized to commingle the production as described above and any Division Order which authorized the dual completion and required separation of the zones is hereby placed in abeyance.

In accordance with the provisions of Rule 303.C., the daily allowable producing rates from the subject well are hereby established as follows:

Oil 230 B/D Gas 460 MCF/D Water 460 B/D

Assignment of allowable to the well and allocation of production from the well shall be on the following basis:

Travis-Wolfcamp Pool	Oil-36%	Gas-55%
Travis-Upper Penn Pool	Oil-64%	Gas-45%

REMARKS: The operator shall notify the Artesia District Office of the Division upon implementation of the commingling process.

Pursuant to Rule 303 H., the commingling authority granted herein may be rescinded by the Division Director if conservation is not being best served by such commingling.

Approved at Santa Fe, New Mexico on this 24th day of February, 1999.

STATE OF NEW MEXICO
OIL CONSERVATION DIVISION

LORI WROTENBERY
Director

SEAL

LW/DRC

cc: Oil Conservation Division - Artesia
State Land Office-Oil & Gas Division

3
10
3
10

Lease: SAMUEL BURNS 34 STATE (2)

Dwights

06/12/00

Devon Energy
State "BW" Com. #4
Eddy County, New Mexico
Downhole commingle WC and UP
6/2000 Attachment

3
10

2
10
2
10

2
10

10
10

10
10

1
1

1
1

1998

2000

Oil (bbl/day)

Water (bbl/day)

County: EDDY, NM

Field: TRAVIS (WOLFCAMP)

Reservoir: WOLFCAMP

Operator: MARATHON OIL CO

F.P. Date: 08/98

Oil Cum: 3767 bbl

Gas Cum: 27.57 mmcf

Location: 34E 18S 28E

Gas (mcf/day)

$A = .702$

$D = 99\%$

$$99 + 81 = 180 / 2 = 90$$

$A = .139$

$D = 81\%$



ENERGY PRODUCTION COMPANY, L.P.

20 North Broadway, Suite 1500
Oklahoma City, Oklahoma 73102-8260

Telephone 405/235-3611
FAX 405/552-4667

Candace R. Graham
Telephone 405/552-4520
FAX 405/552-7813

June 15, 2000

To Whom It May Concern:

RE: Downhole commingle Wolfcamp and Upper Penn
State "BW" Com. #4
Section O-27-T18S-R28E
Eddy County, New Mexico

Gentlemen:

Concerning the referenced, enclosed please find a copy of our submittal to the NMOCD in Santa Fe, New Mexico, of form C-107-A for Upper Penn and Wolfcamp downhole commingling.

Please direct inquiries concerning this matter to Wally Frank, Senior Operations Engineer, in our Oklahoma City office at (405) 235-3611, X4595.

Sincerely,

DEVON ENERGY PRODUCTION COMPANY, L.P.

Candace R. Graham
Engineering Tech.

Attachments

/cg (Q:\Prod\Common\Frank\Aweldata\Gasprod\Statebw#4\6-2000 commingle - OCD.doc)

copy: NMOCD in Santa Fe and in Artesia
Commissioner of Public Lands in Santa Fe
file, engineer, foreman, area interest owners

Devon Energy
State "BW" Com. #4
Eddy County, New Mexico
Downhole commingle WC and UP
6/2000 Attachment

DEVON ENERGY PRODUCTION COMPANY, L.P.
Downhole commingle Wolfcamp and Upper Penn
State "BW" Com. #4
Eddy County, New Mexico
June 15, 2000
Page 2

Area Interest Owners Address List

	Certified Mail No.
LOUIS DREYFUS NAT GAS CORP ATTN LIZ SMITH 14000 QUAIL SPRINGS PKWY SUITE 600 OKC OK 73134	Z 068 589 121
YATES PETROLEUM CORP ATTN LISA RAYOS 105 SOUTH 4 TH STREET ARTESIA NM 88210	Z 068 589 122
YATES PETROLEUM CORP ATTN LEE SHIPMAN 105 SOUTH 4 TH STREET ARTESIA NM 88210	Z 068 589 123
MARATHON OIL COMPANY ATTN JOE MADRON PO BOX 552 MIDLAND TX 79702	Z 068 589 124

Devon Energy
State "BW" Com. #4
Eddy County, New Mexico
Downhole commingle WC and UP
6/2000 Attachment

State BW 4 (6-16-2000) C107A

SENDER: ■ Complete items 1 and/or 2 for additional services. ■ Complete items 3, 4a, and 4b. ■ Print your name and address on the reverse of this form so that we can return this card to you. ■ Attach this form to the front of the mailpiece, or on the back if space does not permit. ■ Write "Return Receipt Requested" on the mailpiece below the article number. ■ The Return Receipt will show to whom the article was delivered and the date delivered.		I also wish to receive the following services (for an extra fee): 1. <input type="checkbox"/> Addressee's Address 2. <input type="checkbox"/> Restricted Delivery Consult postmaster for fee.
3. Article Addressed to: STATE OF NEW MEXICO ENERGY, MINERALS, NATURAL RES OIL CONSERVATION DIVISION 2040 SOUTH PACHECO SANTA FE, NM 87505	4a. Article Number Z 068 589 118	Thank you for using Return Receipt Service.
	4b. Service Type <input type="checkbox"/> Registered <input checked="" type="checkbox"/> Certified <input type="checkbox"/> Express Mail <input type="checkbox"/> Insured <input checked="" type="checkbox"/> Return Receipt for Merchandise <input type="checkbox"/> COD	
	7. Date of Delivery	
5. Received By: (Print Name)	8. Addressee's Address (Only if requested and fee is paid)	
6. Signature: (Addressee or Agent) X		
PS Form 3811, December 1994 102595-98-B-0229 Domestic Return Receipt		

State BW 4 (6-16-2000) C107A

SENDER: ■ Complete items 1 and/or 2 for additional services. ■ Complete items 3, 4a, and 4b. ■ Print your name and address on the reverse of this form so that we can return this card to you. ■ Attach this form to the front of the mailpiece, or on the back if space does not permit. ■ Write "Return Receipt Requested" on the mailpiece below the article number. ■ The Return Receipt will show to whom the article was delivered and the date delivered.		I also wish to receive the following services (for an extra fee): 1. <input type="checkbox"/> Addressee's Address 2. <input type="checkbox"/> Restricted Delivery Consult postmaster for fee.
3. Article Addressed to: NM OIL CONSERVATION DIV DISTRICT II 811 SOUTH FIRST ARTESIA NM 88210-2834	4a. Article Number Z 068 589 119	Thank you for using Return Receipt Service.
	4b. Service Type <input type="checkbox"/> Registered <input checked="" type="checkbox"/> Certified <input type="checkbox"/> Express Mail <input type="checkbox"/> Insured <input checked="" type="checkbox"/> Return Receipt for Merchandise <input type="checkbox"/> COD	
	7. Date of Delivery	
5. Received By: (Print Name)	8. Addressee's Address (Only if requested and fee is paid)	
6. Signature: (Addressee or Agent) X		
PS Form 3811, December 1994 102595-98-B-0229 Domestic Return Receipt		

State BW 4 (6-16-2000) C107A

SENDER: ■ Complete items 1 and/or 2 for additional services. ■ Complete items 3, 4a, and 4b. ■ Print your name and address on the reverse of this form so that we can return this card to you. ■ Attach this form to the front of the mailpiece, or on the back if space does not permit. ■ Write "Return Receipt Requested" on the mailpiece below the article number. ■ The Return Receipt will show to whom the article was delivered and the date delivered.		I also wish to receive the following services (for an extra fee): 1. <input type="checkbox"/> Addressee's Address 2. <input type="checkbox"/> Restricted Delivery Consult postmaster for fee.
3. Article Addressed to: NEW MEXICO STATE LAND OFF COMMISSIONER OF PUBLIC LANDS POB 1148 SANTA FE NM 87501	4a. Article Number Z 068-589 120	Thank you for using Return Receipt Service.
	4b. Service Type <input type="checkbox"/> Registered <input checked="" type="checkbox"/> Certified <input type="checkbox"/> Express Mail <input type="checkbox"/> Insured <input checked="" type="checkbox"/> Return Receipt for Merchandise <input type="checkbox"/> COD	
	7. Date of Delivery	
5. Received By: (Print Name)	8. Addressee's Address (Only if requested and fee is paid)	
6. Signature: (Addressee or Agent) X		
PS Form 3811, December 1994 102595-98-B-0229 Domestic Return Receipt		

Devon Energy
 State "BW" Com. #4
 Eddy County, New Mexico
 Downhole commingle WC and UP
 6/2000 Attachment

State BW 4 (6-16-2000) C107A

SENDER: ■ Complete items 1 and/or 2 for additional services. ■ Complete items 3, 4a, and 4b. ■ Print your name and address on the reverse of this form so that we can return this card to you. ■ Attach this form to the front of the mailpiece, or on the back if space does not permit. ■ Write "Return Receipt Requested" on the mailpiece below the article number. ■ The Return Receipt will show to whom the article was delivered and the date delivered.		I also wish to receive the following services (for an extra fee): 1. <input type="checkbox"/> Addressee's Address 2. <input type="checkbox"/> Restricted Delivery Consult postmaster for fee.	
3. Article Addressed to: LOUIS DREYFUS NAT GAS CORP ATTN LIZ SMITH 14000 QUAIL SPRINGS PKWY SUITE 600 OKC OK 73134		4a. Article Number Z068 589 121 4b. Service Type <input type="checkbox"/> Registered <input checked="" type="checkbox"/> Certified <input type="checkbox"/> Express Mail <input type="checkbox"/> Insured <input checked="" type="checkbox"/> Return Receipt for Merchandise <input type="checkbox"/> COD 7. Date of Delivery	
5. Received By: (Print Name)		8. Addressee's Address (Only if requested and fee is paid)	
6. Signature: (Addressee or Agent) X			

Is your RETURN ADDRESS completed on the reverse side? PS Form 3811, December 1994 102595-98-B-0229 Domestic Return Receipt

Thank you for using Return Receipt Service.

State BW 4 (6-16-2000) C107A

SENDER: ■ Complete items 1 and/or 2 for additional services. ■ Complete items 3, 4a, and 4b. ■ Print your name and address on the reverse of this form so that we can return this card to you. ■ Attach this form to the front of the mailpiece, or on the back if space does not permit. ■ Write "Return Receipt Requested" on the mailpiece below the article number. ■ The Return Receipt will show to whom the article was delivered and the date delivered.		I also wish to receive the following services (for an extra fee): 1. <input type="checkbox"/> Addressee's Address 2. <input type="checkbox"/> Restricted Delivery Consult postmaster for fee.	
3. Article Addressed to: YATES PETROLEUM CORP ATTN LISA RAYOS 105 SOUTH 4TH STREET ARTESIA NM 88210		4a. Article Number Z 068 589 122 4b. Service Type <input type="checkbox"/> Registered <input checked="" type="checkbox"/> Certified <input type="checkbox"/> Express Mail <input type="checkbox"/> Insured <input checked="" type="checkbox"/> Return Receipt for Merchandise <input type="checkbox"/> COD 7. Date of Delivery	
5. Received By: (Print Name)		8. Addressee's Address (Only if requested and fee is paid)	
6. Signature: (Addressee or Agent) X			

Is your RETURN ADDRESS completed on the reverse side? PS Form 3811, December 1994 102595-98-B-0229 Domestic Return Receipt

Thank you for using Return Receipt Service.

State BW 4 (6-16-2000) C107A

SENDER: ■ Complete items 1 and/or 2 for additional services. ■ Complete items 3, 4a, and 4b. ■ Print your name and address on the reverse of this form so that we can return this card to you. ■ Attach this form to the front of the mailpiece, or on the back if space does not permit. ■ Write "Return Receipt Requested" on the mailpiece below the article number. ■ The Return Receipt will show to whom the article was delivered and the date delivered.		I also wish to receive the following services (for an extra fee): 1. <input type="checkbox"/> Addressee's Address 2. <input type="checkbox"/> Restricted Delivery Consult postmaster for fee.	
3. Article Addressed to: YATES PETROLEUM CORP ATTN LEE SHIPMAN 105 SOUTH 4TH STREET ARTESIA NM 88210		4a. Article Number Z 068 589 123 4b. Service Type <input type="checkbox"/> Registered <input checked="" type="checkbox"/> Certified <input type="checkbox"/> Express Mail <input type="checkbox"/> Insured <input checked="" type="checkbox"/> Return Receipt for Merchandise <input type="checkbox"/> COD 7. Date of Delivery	
5. Received By: (Print Name)		8. Addressee's Address (Only if requested and fee is paid)	
6. Signature: (Addressee or Agent) X			

Is your RETURN ADDRESS completed on the reverse side? PS Form 3811, December 1994 102595-98-B-0229 Domestic Return Receipt

Thank you for using Return Receipt Service.

State BW 4 (6-16-2000) C107A

SENDER: ■ Complete items 1 and/or 2 for additional services. ■ Complete items 3, 4a, and 4b. ■ Print your name and address on the reverse of this form so that we can return this card to you. ■ Attach this form to the front of the mailpiece, or on the back if space does not permit. ■ Write "Return Receipt Requested" on the mailpiece below the article number. ■ The Return Receipt will show to whom the article was delivered and the date delivered.		I also wish to receive the following services (for an extra fee): 1. <input type="checkbox"/> Addressee's Address 2. <input type="checkbox"/> Restricted Delivery Consult postmaster for fee.	
3. Article Addressed to: MARATHON OIL COMPANY ATTN JOE MADRON PO BOX 552 MIDLAND TX 79702		4a. Article Number Z 068 589 124 4b. Service Type <input type="checkbox"/> Registered <input checked="" type="checkbox"/> Certified <input type="checkbox"/> Express Mail <input type="checkbox"/> Insured <input checked="" type="checkbox"/> Return Receipt for Merchandise <input type="checkbox"/> COD 7. Date of Delivery	
5. Received By: (Print Name)		8. Addressee's Address (Only if requested and fee is paid)	
6. Signature: (Addressee or Agent) X			

Is your RETURN ADDRESS completed on the reverse side? PS Form 3811, December 1994 102595-98-B-0229 Domestic Return Receipt

Thank you for using Return Receipt Service.

Devon Energy
 State "BW" Com. #4
 Eddy County, New Mexico
 Downhole commingle WC and UP
 6/2000 Attachment