



Highlander Environmental Corp.

Midland, Texas

June 21, 2006

Mr. Larry Johnson
Environmental Engineer Specialist
Oil Conservation Division- District I
1625 N. French Drive
Hobbs, New Mexico 88240

RPT# 1000

RE: Assessment and Closure Report for a Spill at the Pogo Producing Company, Cotton Draw Unit Tank Battery #2, Located in Unit Letter K, Section 15, Township 25 South, Range 32 East, Lea County, New Mexico.

Dear Mr. Johnson:

Highlander Environmental Corp. (Highlander) was contacted by Pogo Producing Company (Pogo) to assess a spill on the Cotton Draw Unit Tank Battery #2, located in Unit Letter K, Section 15, Township 25 South, Range 32 East, Lea County, New Mexico (Site). The site coordinates are N 32° 07' 06.1", W 103° 41' 03.2". The State of New Mexico C-141 (Initial) is included in Appendix C. The Site is shown on Figure 1.

Background

According to the State of New Mexico C-141 report, the spill occurred on February 18, 2006, when a valve plugged up and ran a tank over. The spill released 35 barrels of produced water and 5 barrels of oil, with 18 barrels of water and ½ barrel of oil recovered. The spill ran off the pad in two directions, north and west. The spill location is shown on Figure 2. The spill area to the north extended off the pad approximately 60' north and turned west for an additional 170'. The spill area to the west extended off the pad 65' and split into two spill areas approximately 185' long. The spill then joined back up for an additional 140' west and turned south for an additional 720' onto a pipeline right-of-way operated by Duke. Both the north and the west spills were approximately 2'-3' wide.

Groundwater and Regulatory

Neither the New Mexico State Engineer Office's database nor USGS database show wells in Section 15, however, one well in Section 32 had reported a depth of 290' below ground surface. In the surrounding Townships and Ranges, most of the wells showed depths to groundwater greater than 200' below surface. The New Mexico State Engineer and USGS well reports are shown in Appendix B. A risk-based evaluation was performed for the Site in accordance with the New Mexico Oil Conservation Division (NMOCD) Guidelines for Remediation of Leaks, Spills and Releases, dated August 13, 1993. The guidelines require a

risk-based evaluation of the site to determine recommended remedial action levels (RRAL) for benzene, toluene, ethylbenzene and xylene (collectively referred to as BTEX) and total petroleum hydrocarbons (TPH) in soil. The proposed RRAL for benzene was determined to be 10 parts per million (ppm) or milligrams per kilogram (mg/kg) and 50 ppm for total BTEX (sum of benzene, toluene, ethylbenzene and xylene). Based upon the depth to groundwater, the proposed RRAL for TPH is 5,000 mg/kg.

Assessment and Corrective Action

On February 21, 2006, Highlander personnel inspected the facility. A total of fifteen (15) auger holes were installed in the spill areas to depths ranging from 1.5' to 5.5' below ground surface (bgs). The sample locations are shown on Figure 2. Twelve (12) auger holes (AH-1 through AH-11, and AH-15) were placed in the west spill area, and three (3) auger holes (AH-12 through AH-14) were placed in the north spill area. Additional confirmation and delineation samples for chlorides were taken on March 3 and March 9, 2006 with a hand auger at AH-4 and AH-5, and backhoe trenches at AH-1 (T-1) and AH-12 (T-2). Soil samples were collected for analysis of TPH by EPA method 8015 modified, BTEX by EPA method 8021B and chloride by EPA method 300.0. The laboratory report and chain of custody are included in Appendix B. The results of the sampling are shown in Table 1.

Referring to Table 1, there were no BTEX concentrations exceeding the RRAL. Soil samples from 0-1' did exceed the RRAL for TPH in AH-2, AH-4, AH-5, AH-6, AH-8, AH-9 and AH-15. The deepest hydrocarbon impact was in AH-2, AH-4, AH-5 and AH-15, however, TPH concentrations declined below the RRAL at 2.0' to 3.0' below surface in these areas. The remaining auger holes AH-6, AH-8 and AH-9 were defined at 1.0' below surface.

The chloride impact at the Site was vertically defined in all of the auger holes. The majority of the auger holes showed a shallow impact at a depth of 1.0 to 2.0' below surface, with the deepest chloride impact observed in AH-2, AH-12 and AH-15 ranging from 3.0' to 5.0'. Auger holes AH-5, AH-6, AH-8, AH-10, and AH-14 did not exhibit elevated chloride concentrations in the 0-1' samples.

From February 28 and March 6, 2006, Highlander supervised the excavation of the spill areas by hand or backhoe. All soils which exceeded the RRAL for TPH were excavated, with depths ranging from 1.5' to 3.0'. This excavation also removed a significant amount of the highest chloride impacted soils. The area of AH-2 was excavated to a depth of 3.0' below surface. The areas of AH-1, AH-12 and AH-13 were also excavated to a depth of 2.0' to 2.5' below surface to remove elevated chloride concentrations. The spill and excavated areas are shown on Figure 2. The excavated soils were transported to Sundance Services, Inc. for disposal.

Conclusions and Closure Request

Chloride impact to subsurface soils was defined, and is limited to a depth of 5.0' or less below ground surface. All TPH impacted soils above the RRAL have been excavated and hauled to disposal. This excavation also removed a significant amount of the highest chloride impacted soils. A search of available groundwater in the vicinity of this site revealed depths to groundwater in excess of 200' below the surface. As such, the residual chloride impact does not appear to be an imminent threat to groundwater. Considering the limited areal extent and depth of impact, the depth to groundwater and the remediation performed at this facility, Pogo requests



closure of this site. The State of New Mexico Form C-141 (Final) is included in Appendix C.

If you require any additional information or have any questions or comments concerning the assessment report, please call at (432) 682-4559.

Respectfully submitted,
Highlander Environmental Corp.

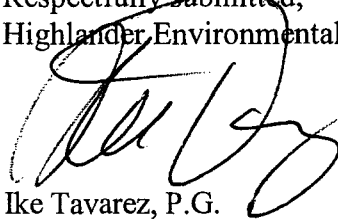

Ike Tavarez, P.G.
Project Manager/Senior Geologist

cc: Don Riggs - Pogo
Pat Ellis - Pogo



Lea County, NM

[illegible]

[illegible]

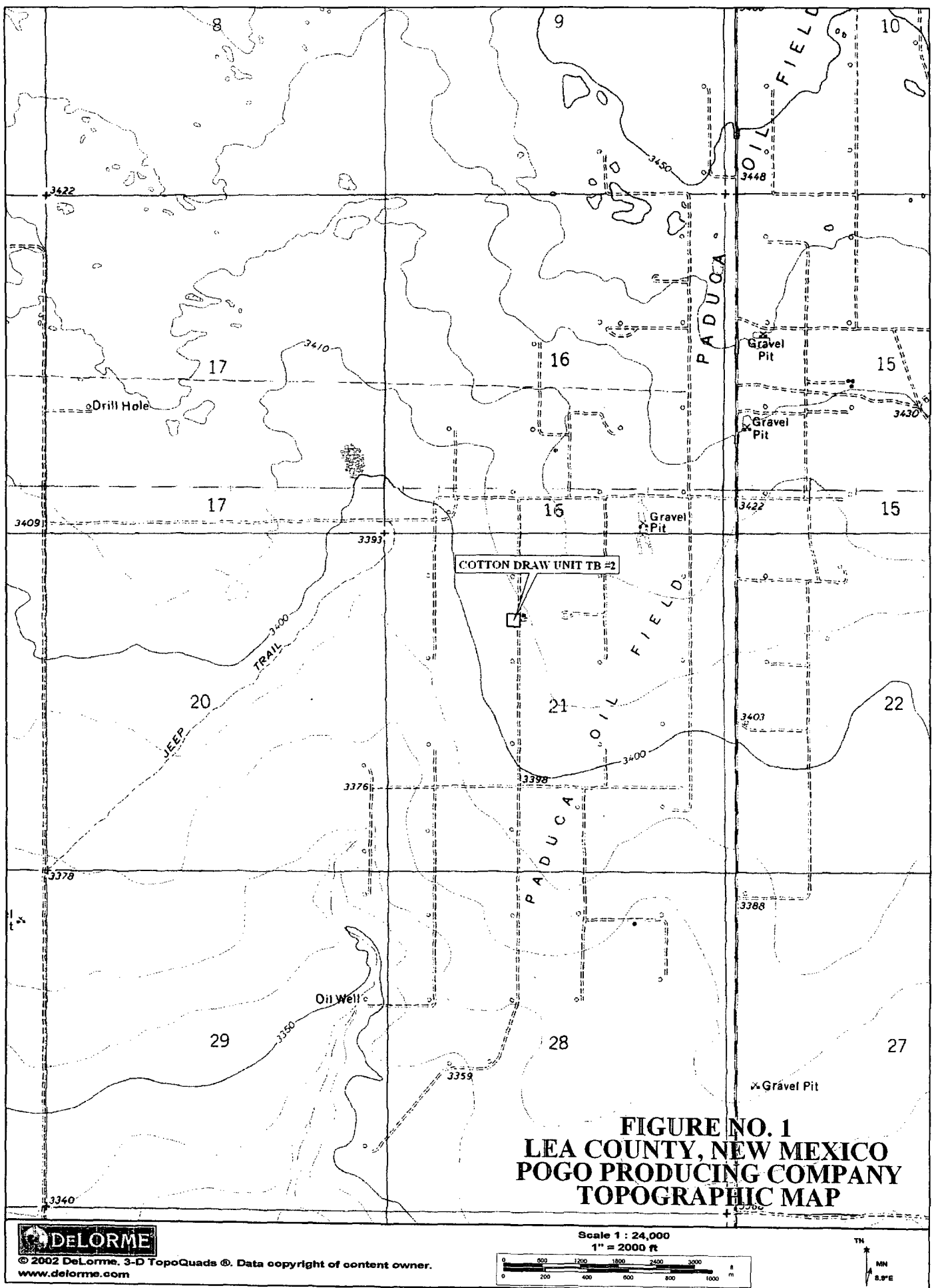

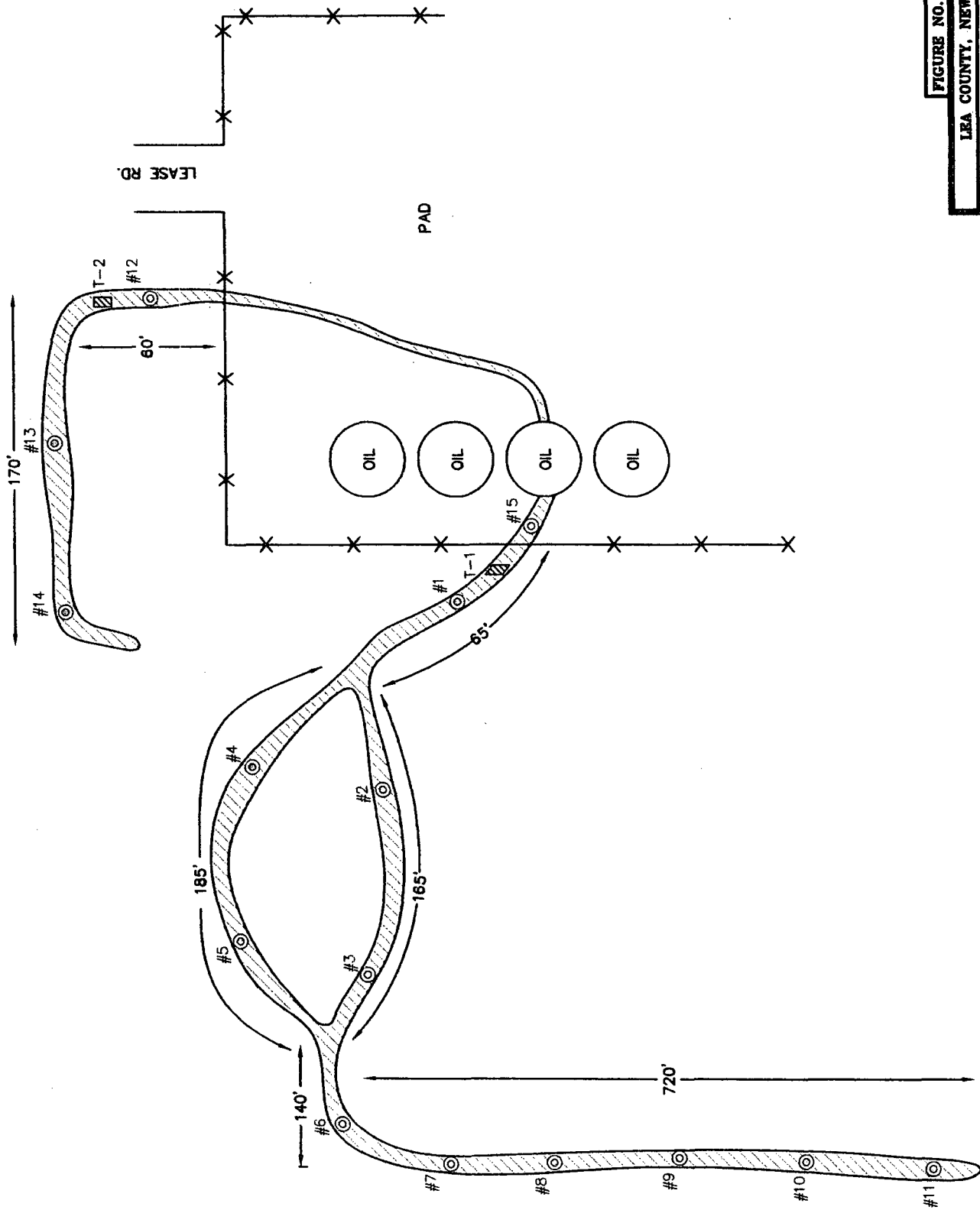
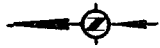

FIGURE NO. 2

LEA COUNTY, NEW MEXICO

POGO PRODUCING COMPANY
COTTON DRAW TB #2

HIGHLANDER ENVIRONMENTAL CORP.
MIDLAND, TEXAS

DATE:	6/2/06
DRAWN BY:	JJ
FILE:	ENVIRONMENTAL
COTTON DRAW	

NOT TO SCALE

APPENDIX A

Average Depth of Water Report

New Mexico Office of the State Engineer
POD Reports and Downloads

Township: 25S Range: 32E Sections:

NAD27 X: Y: Zone: Search Radius:

County: Basin: Number: Suffix:

Owner Name: (First) (Last) ☐ Non-Domestic ☐ Domestic
☒ All

POD / Surface Data Report Avg. Depth to Water Report
Water Column Report

Clear Form iWATERS Menu Help

AVERAGE DEPTH OF WATER REPORT 06/15/2006

Bsn	Tws	Rng	Sec	Zone	X	Y	Wells	(Depth Water in Feet)		
								Min	Max	Avg
L	25S	32E	32				1	290	290	290

Record Count: 1

APPENDIX B

Analytical Reports

[illegible]

Analytical Report

3/7/2006

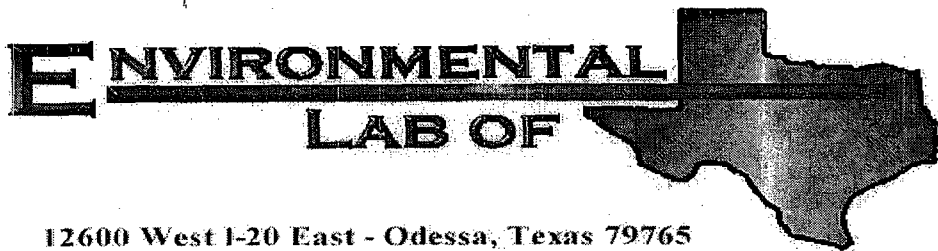

Analytical Report

Prepared for:

Ike Tavarez

Highlander Environmental Corp.

1910 N. Big Spring St.

Midland, TX 79705

Project: Pogo/ Cotton Draw TB #2

Project Number: 2589

Location: Lea County, NM

Lab Order Number: 6B23027

Report Date: 03/07/06

Highlander Environmental Corp.
1910 N. Big Spring St.
Midland TX, 79705

Project: Pogo/ Cotton Draw TB #2
Project Number: 2589
Project Manager: Ike Tavaréz

Fax: (432) 682-3946

Reported:
03/07/06 13:24

ANALYTICAL REPORT FOR SAMPLES

Sample ID	Laboratory ID	Matrix	Date Sampled	Date Received
AH-1 0.-1.0'	6B23027-01	Soil	02/21/06 00:00	02/23/06 15:40
AH-1 1.0-1.5'	6B23027-02	Soil	02/21/06 00:00	02/23/06 15:40
AH-2 0-1.0'	6B23027-03	Soil	02/21/06 00:00	02/23/06 15:40
AH-2 1.0-1.5'	6B23027-04	Soil	02/21/06 00:00	02/23/06 15:40
AH-2 2.0-2.5'	6B23027-05	Soil	02/21/06 00:00	02/23/06 15:40
AH-2 3.0-3.5'	6B23027-06	Soil	02/21/06 00:00	02/23/06 15:40
AH-2 4.0-4.5'	6B23027-07	Soil	02/21/06 00:00	02/23/06 15:40
AH-2 5.0-5.5'	6B23027-08	Soil	02/21/06 00:00	02/23/06 15:40
AH-3 0-1.0'	6B23027-09	Soil	02/21/06 00:00	02/23/06 15:40
AH-3 1.0-1.5'	6B23027-10	Soil	02/21/06 00:00	02/23/06 15:40
AH-4 0-1.0'	6B23027-12	Soil	02/21/06 00:00	02/23/06 15:40
AH-4 1.0-1.5'	6B23027-13	Soil	02/21/06 00:00	02/23/06 15:40
AH-5 0.-1.0'	6B23027-14	Soil	02/21/06 00:00	02/23/06 15:40
AH-5 1.0-1.5'	6B23027-15	Soil	02/21/06 00:00	02/23/06 15:40
AH-6 0-1.0'	6B23027-17	Soil	02/21/06 00:00	02/23/06 15:40
AH-6 1.0-1.5'	6B23027-18	Soil	02/21/06 00:00	02/23/06 15:40
AH-7 0-1.0'	6B23027-20	Soil	02/21/06 00:00	02/23/06 15:40
AH-7 1.0-1.5'	6B23027-21	Soil	02/21/06 00:00	02/23/06 15:40
AH-7 2.0-2.5'	6B23027-22	Soil	02/21/06 00:00	02/23/06 15:40
AH-8 0-1.0'	6B23027-23	Soil	02/21/06 00:00	02/23/06 15:40
AH-8 1.0-1.5'	6B23027-24	Soil	02/21/06 00:00	02/23/06 15:40
AH-9 0-1.0'	6B23027-25	Soil	02/21/06 00:00	02/23/06 15:40
AH-9 1.0-1.5'	6B23027-26	Soil	02/21/06 00:00	02/23/06 15:40
AH-10 0-1.0'	6B23027-28	Soil	02/21/06 00:00	02/23/06 15:40
AH-10 1.0-1.5'	6B23027-29	Soil	02/21/06 00:00	02/23/06 15:40
AH-11 0-1.0'	6B23027-30	Soil	02/21/06 00:00	02/23/06 15:40
AH-11 1.0-1.5'	6B23027-31	Soil	02/21/06 00:00	02/23/06 15:40
AH-12 0-1.0'	6B23027-32	Soil	02/21/06 00:00	02/23/06 15:40
AH-13 0-1.0'	6B23027-33	Soil	02/21/06 00:00	02/23/06 15:40
AH-13 1.0-1.5'	6B23027-34	Soil	02/21/06 00:00	02/23/06 15:40
AH-14 0-1.0'	6B23027-36	Soil	02/21/06 00:00	02/23/06 15:40
AH-14 1.0-1.5'	6B23027-37	Soil	02/21/06 00:00	02/23/06 15:40
AH-15 0-1.0'	6B23027-39	Soil	02/21/06 00:00	02/23/06 15:40
AH-15 1.0-1.5'	6B23027-40	Soil	02/21/06 00:00	02/23/06 15:40

Highlander Environmental Corp.
1910 N. Big Spring St.
Midland TX, 79705

Project: Pogo/ Cotton Draw TB #2
Project Number: 2589
Project Manager: Ike Tavarez

Fax: (432) 682-3946

Reported:
03/07/06 13:24

ANALYTICAL REPORT FOR SAMPLES

Sample ID	Laboratory ID	Matrix	Date Sampled	Date Received
AH-15 2.0-2.5'	6B23027-41	Soil	02/21/06 00:00	02/23/06 15:40
AH-15 3.0-3.5'	6B23027-42	Soil	02/21/06 00:00	02/23/06 15:40

Highlander Environmental Corp.
1910 N. Big Spring St.
Midland TX, 79705

Project: Pogo/ Cotton Draw TB #2
Project Number: 2589
Project Manager: Ike Tavaréz

Fax: (432) 682-3946

Reported:
03/07/06 13:24

Organics by GC
Environmental Lab of Texas

Analyte	Result	Reporting Limit	Units	Dilution	Batch	Prepared	Analyzed	Method	Notes
AH-1 0-1.0' (6B23027-01) Soil									
Carbon Ranges C6-C12	ND	10.0	mg/kg dry	1	EB62414	02/24/06	03/01/06	EPA 8015M	
Carbon Ranges C12-C28	102	10.0	"	"	"	"	"	"	
Carbon Ranges C28-C35	82.9	10.0	"	"	"	"	"	"	
Total Hydrocarbon C6-C35	185	10.0	"	"	"	"	"	"	
Surrogate: 1-Chlorooctane		104 %	70-130		"	"	"	"	
Surrogate: 1-Chlorooctadecane		104 %	70-130		"	"	"	"	
AH-2 0-1.0' (6B23027-03) Soil									
Carbon Ranges C6-C12	10100	20.0	mg/kg dry	2	EB62414	02/24/06	03/01/06	EPA 8015M	
Carbon Ranges C12-C28	20800	20.0	"	"	"	"	"	"	
Carbon Ranges C28-C35	1570	20.0	"	"	"	"	"	"	
Total Hydrocarbon C6-C35	32500	20.0	"	"	"	"	"	"	
Surrogate: 1-Chlorooctane		87.8 %	70-130		"	"	"	"	S-04
Surrogate: 1-Chlorooctadecane		49.6 %	70-130		"	"	"	"	S-06
AH-2 2.0-2.5' (6B23027-05) Soil									
Benzene	0.403	0.0250	mg/kg dry	25	EC60604	03/06/06	03/06/06	EPA 8021B	
Toluene	1.39	0.0250	"	"	"	"	"	"	
Ethylbenzene	1.19	0.0250	"	"	"	"	"	"	
Xylene (p/m)	4.93	0.0250	"	"	"	"	"	"	
Xylene (o)	1.29	0.0250	"	"	"	"	"	"	
Surrogate: a,a,a-Trifluorotoluene		113 %	80-120		"	"	"	"	
Surrogate: 4-Bromofluorobenzene		272 %	80-120		"	"	"	"	S-04
Carbon Ranges C6-C12	2420	10.0	mg/kg dry	1	EC60311	03/06/06	03/06/06	EPA 8015M	
Carbon Ranges C12-C28	7580	10.0	"	"	"	"	"	"	
Carbon Ranges C28-C35	756	10.0	"	"	"	"	"	"	
Total Hydrocarbon C6-C35	10800	10.0	"	"	"	"	"	"	
Surrogate: 1-Chlorooctane		123 %	70-130		"	"	"	"	
Surrogate: 1-Chlorooctadecane		113 %	70-130		"	"	"	"	

Environmental Lab of Texas

The results in this report apply to the samples analyzed in accordance with the samples received in the laboratory. This analytical report must be reproduced in its entirety, with written approval of Environmental Lab of Texas.

Page 3 of 23

Highlander Environmental Corp.
1910 N. Big Spring St.
Midland TX, 79705

Project: Pogo/ Cotton Draw TB #2
Project Number: 2589
Project Manager: Ike Tavaréz

Fax: (432) 682-3946

Reported:
03/07/06 13:24

Organics by GC
Environmental Lab of Texas

Analyte	Result	Reporting Limit	Units	Dilution	Batch	Prepared	Analyzed	Method	Notes
AH-2 3.0-3.5' (6B23027-06) Soil									
Benzene	0.294	0.0250	mg/kg dry	25	EC60604	03/06/06	03/06/06	EPA 8021B	
Toluene	1.04	0.0250	"	"	"	"	"	"	
Ethylbenzene	0.605	0.0250	"	"	"	"	"	"	
Xylene (p/m)	0.978	0.0250	"	"	"	"	"	"	
Xylene (o)	0.543	0.0250	"	"	"	"	"	"	
Surrogate: a,a,a-Trifluorotoluene		250 %	80-120		"	"	"	"	S-04
Surrogate: 4-Bromofluorobenzene		176 %	80-120		"	"	"	"	S-04
Carbon Ranges C6-C12	810	10.0	mg/kg dry	1	EC60311	03/06/06	03/06/06	EPA 8015M	
Carbon Ranges C12-C28	1700	10.0	"	"	"	"	"	"	
Carbon Ranges C28-C35	317	10.0	"	"	"	"	"	"	
Total Hydrocarbon C6-C35	2830	10.0	"	"	"	"	"	"	
Surrogate: 1-Chlorooctane		109 %	70-130		"	"	"	"	
Surrogate: 1-Chlorooctadecane		114 %	70-130		"	"	"	"	
AH-2 5.0-5.5' (6B23027-08) Soil									
Benzene	0.303	0.0250	mg/kg dry	25	EC60604	03/06/06	03/06/06	EPA 8021B	
Toluene	1.56	0.0250	"	"	"	"	"	"	
Ethylbenzene	1.18	0.0250	"	"	"	"	"	"	
Xylene (p/m)	5.28	0.0250	"	"	"	"	"	"	
Xylene (o)	0.955	0.0250	"	"	"	"	"	"	
Surrogate: a,a,a-Trifluorotoluene		290 %	80-120		"	"	"	"	S-04
Surrogate: 4-Bromofluorobenzene		247 %	80-120		"	"	"	"	S-04
Carbon Ranges C6-C12	941	10.0	mg/kg dry	1	EC60311	03/06/06	03/06/06	EPA 8015M	
Carbon Ranges C12-C28	1880	10.0	"	"	"	"	"	"	
Carbon Ranges C28-C35	345	10.0	"	"	"	"	"	"	
Total Hydrocarbon C6-C35	3170	10.0	"	"	"	"	"	"	
Surrogate: 1-Chlorooctane		129 %	70-130		"	"	"	"	
Surrogate: 1-Chlorooctadecane		137 %	70-130		"	"	"	"	S-04

Environmental Lab of Texas

The results in this report apply to the samples analyzed in accordance with the samples received in the laboratory. This analytical report must be reproduced in its entirety, with written approval of Environmental Lab of Texas.

Page 4 of 23

Highlander Environmental Corp.
1910 N. Big Spring St.
Midland TX, 79705

Project: Pogo/ Cotton Draw TB #2
Project Number: 2589
Project Manager: Ike Tavaréz

Fax: (432) 682-3946

Reported:
03/07/06 13:24

Organics by GC
Environmental Lab of Texas

Analyte	Result	Reporting Limit	Units	Dilution	Batch	Prepared	Analyzed	Method	Notes
AH-3 0-1.0' (6B23027-09) Soil									
Carbon Ranges C6-C12	1950	10.0	mg/kg dry	1	EB62414	02/24/06	03/01/06	EPA 8015M	
Carbon Ranges C12-C28	4190	10.0	"	"	"	"	"	"	
Carbon Ranges C28-C35	643	10.0	"	"	"	"	"	"	
Total Hydrocarbon C6-C35	6780	10.0	"	"	"	"	"	"	
Surrogate: 1-Chlorooctane		108 %	70-130		"	"	"	"	
Surrogate: 1-Chlorooctadecane		104 %	70-130		"	"	"	"	
AH-3 1.0-1.5' (6B23027-10) Soil									
Benzene	ND	0.0250	mg/kg dry	25	EC60604	03/06/06	03/06/06	EPA 8021B	
Toluene	ND	0.0250	"	"	"	"	"	"	
Ethylbenzene	ND	0.0250	"	"	"	"	"	"	
Xylene (p/m)	ND	0.0250	"	"	"	"	"	"	
Xylene (o)	ND	0.0250	"	"	"	"	"	"	
Surrogate: a,a,a-Trifluorotoluene		91.0 %	80-120		"	"	"	"	
Surrogate: 4-Bromofluorobenzene		104 %	80-120		"	"	"	"	
Carbon Ranges C6-C12	12.1	10.0	mg/kg dry	1	EC60311	03/06/06	03/06/06	EPA 8015M	
Carbon Ranges C12-C28	186	10.0	"	"	"	"	"	"	
Carbon Ranges C28-C35	117	10.0	"	"	"	"	"	"	
Total Hydrocarbon C6-C35	315	10.0	"	"	"	"	"	"	
Surrogate: 1-Chlorooctane		128 %	70-130		"	"	"	"	
Surrogate: 1-Chlorooctadecane		126 %	70-130		"	"	"	"	
AH-4 0-1.0' (6B23027-12) Soil									
Carbon Ranges C6-C12	5940	20.0	mg/kg dry	2	EB62414	02/24/06	03/01/06	EPA 8015M	
Carbon Ranges C12-C28	22500	20.0	"	"	"	"	"	"	
Carbon Ranges C28-C35	1450	20.0	"	"	"	"	"	"	
Total Hydrocarbon C6-C35	29900	20.0	"	"	"	"	"	"	
Surrogate: 1-Chlorooctane		63.2 %	70-130		"	"	"	"	S-06
Surrogate: 1-Chlorooctadecane		58.0 %	70-130		"	"	"	"	S-06

Environmental Lab of Texas

The results in this report apply to the samples analyzed in accordance with the samples received in the laboratory. This analytical report must be reproduced in its entirety, with written approval of Environmental Lab of Texas.

Page 5 of 23

Highlander Environmental Corp.
1910 N. Big Spring St.
Midland TX, 79705

Project: Pogo/ Cotton Draw TB #2
Project Number: 2589
Project Manager: Ike Tavarez

Fax: (432) 682-3946

Reported:
03/07/06 13:24

Organics by GC
Environmental Lab of Texas

Analyte	Result	Reporting Limit	Units	Dilution	Batch	Prepared	Analyzed	Method	Notes
AH-4 1.0-1.5' (6B23027-13) Soil									
Benzene	ND	0.0250	mg/kg dry	25	EC60604	03/06/06	03/06/06	EPA 8021B	
Toluene	ND	0.0250	"	"	"	"	"	"	
Ethylbenzene	ND	0.0250	"	"	"	"	"	"	
Xylene (p/m)	0.165	0.0250	"	"	"	"	"	"	
Xylene (o)	0.119	0.0250	"	"	"	"	"	"	
Surrogate: a,a,a-Trifluorotoluene		84.8 %	80-120		"	"	"	"	
Surrogate: 4-Bromofluorobenzene		97.8 %	80-120		"	"	"	"	
Carbon Ranges C6-C12	540	10.0	mg/kg dry	1	EC60311	03/06/06	03/06/06	EPA 8015M	
Carbon Ranges C12-C28	9590	10.0	"	"	"	"	"	"	
Carbon Ranges C28-C35	760	10.0	"	"	"	"	"	"	
Total Hydrocarbon C6-C35	10900	10.0	"	"	"	"	"	"	
Surrogate: 1-Chlorooctane		114 %	70-130		"	"	"	"	
Surrogate: 1-Chlorooctadecane		127 %	70-130		"	"	"	"	
AH-5 0.-1.0' (6B23027-14) Soil									
Carbon Ranges C6-C12	87.2	20.0	mg/kg dry	2	EB62414	02/24/06	03/01/06	EPA 8015M	
Carbon Ranges C12-C28	5880	20.0	"	"	"	"	"	"	
Carbon Ranges C28-C35	1520	20.0	"	"	"	"	"	"	
Total Hydrocarbon C6-C35	7490	20.0	"	"	"	"	"	"	
Surrogate: 1-Chlorooctane		56.2 %	70-130		"	"	"	"	S-06
Surrogate: 1-Chlorooctadecane		64.6 %	70-130		"	"	"	"	S-06
AH-5 1.0-1.5' (6B23027-15) Soil									
Benzene	ND	0.0250	mg/kg dry	25	EC60604	03/06/06	03/06/06	EPA 8021B	
Toluene	ND	0.0250	"	"	"	"	"	"	
Ethylbenzene	ND	0.0250	"	"	"	"	"	"	
Xylene (p/m)	ND	0.0250	"	"	"	"	"	"	
Xylene (o)	ND	0.0250	"	"	"	"	"	"	
Surrogate: a,a,a-Trifluorotoluene		89.5 %	80-120		"	"	"	"	
Surrogate: 4-Bromofluorobenzene		84.0 %	80-120		"	"	"	"	
Carbon Ranges C6-C12	24.0	10.0	mg/kg dry	1	EC60311	03/06/06	03/06/06	EPA 8015M	
Carbon Ranges C12-C28	4660	10.0	"	"	"	"	"	"	
Carbon Ranges C28-C35	808	10.0	"	"	"	"	"	"	
Total Hydrocarbon C6-C35	5490	10.0	"	"	"	"	"	"	
Surrogate: 1-Chlorooctane		112 %	70-130		"	"	"	"	
Surrogate: 1-Chlorooctadecane		141 %	70-130		"	"	"	"	S-04

Environmental Lab of Texas

The results in this report apply to the samples analyzed in accordance with the samples received in the laboratory. This analytical report must be reproduced in its entirety, with written approval of Environmental Lab of Texas.

Page 6 of 23

Highlander Environmental Corp.
1910 N. Big Spring St.
Midland TX, 79705

Project: Pogo/ Cotton Draw TB #2
Project Number: 2589
Project Manager: Ike Tavarez

Fax: (432) 682-3946

Reported:
03/07/06 13:24

Organics by GC
Environmental Lab of Texas

Analyte	Result	Reporting Limit	Units	Dilution	Batch	Prepared	Analyzed	Method	Notes
AH-6 0-1.0' (6B23027-17) Soil									
Carbon Ranges C6-C12	1060	10.0	mg/kg dry	1	EB62414	02/24/06	03/01/06	EPA 8015M	
Carbon Ranges C12-C28	8630	10.0	"	"	"	"	"	"	
Carbon Ranges C28-C35	807	10.0	"	"	"	"	"	"	
Total Hydrocarbon C6-C35	10500	10.0	"	"	"	"	"	"	
Surrogate: 1-Chlorooctane		110 %	70-130		"	"	"	"	
Surrogate: 1-Chlorooctadecane		121 %	70-130		"	"	"	"	

AH-6 1.0-1.5' (6B23027-18) Soil

Benzene	ND	0.0250	mg/kg dry	25	EC60604	03/06/06	03/06/06	EPA 8021B	
Toluene	ND	0.0250	"	"	"	"	"	"	
Ethylbenzene	ND	0.0250	"	"	"	"	"	"	
Xylene (p/m)	ND	0.0250	"	"	"	"	"	"	
Xylene (o)	ND	0.0250	"	"	"	"	"	"	
Surrogate: a,a,a-Trifluorotoluene		90.5 %	80-120		"	"	"	"	
Surrogate: 4-Bromofluorobenzene		100 %	80-120		"	"	"	"	
Carbon Ranges C6-C12	ND	10.0	mg/kg dry	1	EC60311	03/06/06	03/06/06	EPA 8015M	
Carbon Ranges C12-C28	74.4	10.0	"	"	"	"	"	"	
Carbon Ranges C28-C35	59.3	10.0	"	"	"	"	"	"	
Total Hydrocarbon C6-C35	134	10.0	"	"	"	"	"	"	
Surrogate: 1-Chlorooctane		111 %	70-130		"	"	"	"	
Surrogate: 1-Chlorooctadecane		113 %	70-130		"	"	"	"	

AH-7 0-1.0' (6B23027-20) Soil

Carbon Ranges C6-C12	143	10.0	mg/kg dry	1	EB62414	02/24/06	03/02/06	EPA 8015M	
Carbon Ranges C12-C28	570	10.0	"	"	"	"	"	"	
Carbon Ranges C28-C35	220	10.0	"	"	"	"	"	"	
Total Hydrocarbon C6-C35	933	10.0	"	"	"	"	"	"	
Surrogate: 1-Chlorooctane		106 %	70-130		"	"	"	"	
Surrogate: 1-Chlorooctadecane		114 %	70-130		"	"	"	"	

Environmental Lab of Texas

The results in this report apply to the samples analyzed in accordance with the samples received in the laboratory. This analytical report must be reproduced in its entirety, with written approval of Environmental Lab of Texas.

Page 7 of 23

Highlander Environmental Corp.
1910 N. Big Spring St.
Midland TX, 79705

Project: Pogo/ Cotton Draw TB #2
Project Number: 2589
Project Manager: Ike Tavaréz

Fax: (432) 682-3946

Reported:
03/07/06 13:24

Organics by GC
Environmental Lab of Texas

Analyte	Result	Reporting Limit	Units	Dilution	Batch	Prepared	Analyzed	Method	Notes
AH-8 0-1.0' (6B23027-23) Soil									
Carbon Ranges C6-C12	184	10.0	mg/kg dry	1	EB62414	02/24/06	03/02/06	EPA 8015M	
Carbon Ranges C12-C28	3870	10.0	"	"	"	"	"	"	
Carbon Ranges C28-C35	772	10.0	"	"	"	"	"	"	
Total Hydrocarbon C6-C35	4830	10.0	"	"	"	"	"	"	
Surrogate: 1-Chlorooctane		127 %		70-130	"	"	"	"	
Surrogate: 1-Chlorooctadecane		152 %		70-130	"	"	"	"	S-04
AH-9 0-1.0' (6B23027-25) Soil									
Carbon Ranges C6-C12	2980	10.0	mg/kg dry	1	EB62414	02/24/06	03/02/06	EPA 8015M	
Carbon Ranges C12-C28	7410	10.0	"	"	"	"	"	"	
Carbon Ranges C28-C35	779	10.0	"	"	"	"	"	"	
Total Hydrocarbon C6-C35	11200	10.0	"	"	"	"	"	"	
Surrogate: 1-Chlorooctane		113 %		70-130	"	"	"	"	
Surrogate: 1-Chlorooctadecane		108 %		70-130	"	"	"	"	
AH-9 1.0-1.5' (6B23027-26) Soil									
Benzene	ND	0.0250	mg/kg dry	25	EC60604	03/06/06	03/06/06	EPA 8021B	
Toluene	ND	0.0250	"	"	"	"	"	"	
Ethylbenzene	ND	0.0250	"	"	"	"	"	"	
Xylene (p/m)	ND	0.0250	"	"	"	"	"	"	
Xylene (o)	ND	0.0250	"	"	"	"	"	"	
Surrogate: a,a,a-Trifluorotoluene		92.5 %		80-120	"	"	"	"	
Surrogate: 4-Bromofluorobenzene		111 %		80-120	"	"	"	"	
Carbon Ranges C6-C12	ND	10.0	mg/kg dry	1	EC60311	03/06/06	03/06/06	EPA 8015M	
Carbon Ranges C12-C28	137	10.0	"	"	"	"	"	"	
Carbon Ranges C28-C35	142	10.0	"	"	"	"	"	"	
Total Hydrocarbon C6-C35	279	10.0	"	"	"	"	"	"	
Surrogate: 1-Chlorooctane		110 %		70-130	"	"	"	"	
Surrogate: 1-Chlorooctadecane		112 %		70-130	"	"	"	"	

Environmental Lab of Texas

The results in this report apply to the samples analyzed in accordance with the samples received in the laboratory. This analytical report must be reproduced in its entirety, with written approval of Environmental Lab of Texas.

Page 8 of 23

Highlander Environmental Corp.
1910 N. Big Spring St.
Midland TX, 79705

Project: Pogo/ Cotton Draw TB #2
Project Number: 2589
Project Manager: Ike Tavarez

Fax: (432) 682-3946

Reported:
03/07/06 13:24

Organics by GC
Environmental Lab of Texas

Analyte	Result	Reporting Limit	Units	Dilution	Batch	Prepared	Analyzed	Method	Notes
AH-10 0-1.0' (6B23027-28) Soil									
Carbon Ranges C6-C12	66.2	10.0	mg/kg dry	1	EB62414	02/24/06	03/02/06	EPA 8015M	
Carbon Ranges C12-C28	896	10.0	"	"	"	"	"	"	
Carbon Ranges C28-C35	330	10.0	"	"	"	"	"	"	
Total Hydrocarbon C6-C35	1290	10.0	"	"	"	"	"	"	
Surrogate: 1-Chlorooctane		105 %	70-130		"	"	"	"	
Surrogate: 1-Chlorooctadecane		121 %	70-130		"	"	"	"	
AH-11 0-1.0' (6B23027-30) Soil									
Carbon Ranges C6-C12	ND	10.0	mg/kg dry	1	EB62414	02/24/06	03/02/06	EPA 8015M	
Carbon Ranges C12-C28	100	10.0	"	"	"	"	"	"	
Carbon Ranges C28-C35	91.8	10.0	"	"	"	"	"	"	
Total Hydrocarbon C6-C35	192	10.0	"	"	"	"	"	"	
Surrogate: 1-Chlorooctane		118 %	70-130		"	"	"	"	
Surrogate: 1-Chlorooctadecane		123 %	70-130		"	"	"	"	
AH-12 0-1.0' (6B23027-32) Soil									
Carbon Ranges C6-C12	76.4	10.0	mg/kg dry	1	EB62414	02/24/06	03/02/06	EPA 8015M	
Carbon Ranges C12-C28	665	10.0	"	"	"	"	"	"	
Carbon Ranges C28-C35	218	10.0	"	"	"	"	"	"	
Total Hydrocarbon C6-C35	959	10.0	"	"	"	"	"	"	
Surrogate: 1-Chlorooctane		95.2 %	70-130		"	"	"	"	
Surrogate: 1-Chlorooctadecane		101 %	70-130		"	"	"	"	
AH-13 0-1.0' (6B23027-33) Soil									
Carbon Ranges C6-C12	ND	10.0	mg/kg dry	1	EB62414	02/24/06	03/02/06	EPA 8015M	
Carbon Ranges C12-C28	43.3	10.0	"	"	"	"	"	"	
Carbon Ranges C28-C35	26.9	10.0	"	"	"	"	"	"	
Total Hydrocarbon C6-C35	70.2	10.0	"	"	"	"	"	"	
Surrogate: 1-Chlorooctane		106 %	70-130		"	"	"	"	
Surrogate: 1-Chlorooctadecane		106 %	70-130		"	"	"	"	

Highlander Environmental Corp.
1910 N. Big Spring St.
Midland TX, 79705

Project: Pogo/ Cotton Draw TB #2
Project Number: 2589
Project Manager: Ike Tavarez

Fax: (432) 682-3946

Reported:
03/07/06 13:24

Organics by GC
Environmental Lab of Texas

Analyte	Result	Reporting Limit	Units	Dilution	Batch	Prepared	Analyzed	Method	Notes
AH-14 0-1.0' (6B23027-36) Soil									
Carbon Ranges C6-C12	95.1	10.0	mg/kg dry	1	EB62414	02/24/06	03/02/06	EPA 8015M	
Carbon Ranges C12-C28	4040	10.0	"	"	"	"	"	"	
Carbon Ranges C28-C35	743	10.0	"	"	"	"	"	"	
Total Hydrocarbon C6-C35	4880	10.0	"	"	"	"	"	"	
Surrogate: 1-Chlorooctane		93.0 %	70-130		"	"	"	"	
Surrogate: 1-Chlorooctadecane		107 %	70-130		"	"	"	"	
AH-15 0-1.0' (6B23027-39) Soil									
Carbon Ranges C6-C12	1390	10.0	mg/kg dry	1	EB62414	02/24/06	03/02/06	EPA 8015M	
Carbon Ranges C12-C28	8960	10.0	"	"	"	"	"	"	
Carbon Ranges C28-C35	841	10.0	"	"	"	"	"	"	
Total Hydrocarbon C6-C35	11200	10.0	"	"	"	"	"	"	
Surrogate: 1-Chlorooctane		86.6 %	70-130		"	"	"	"	
Surrogate: 1-Chlorooctadecane		85.6 %	70-130		"	"	"	"	
AH-15 1.0-1.5' (6B23027-40) Soil									
Benzene	ND	0.0250	mg/kg dry	25	EC60604	03/06/06	03/06/06	EPA 8021B	
Toluene	ND	0.0250	"	"	"	"	"	"	
Ethylbenzene	0.218	0.0250	"	"	"	"	"	"	
Xylene (p/m)	0.513	0.0250	"	"	"	"	"	"	
Xylene (o)	0.289	0.0250	"	"	"	"	"	"	
Surrogate: a,a,a-Trifluorotoluene		94.5 %	80-120		"	"	"	"	
Surrogate: 4-Bromofluorobenzene		152 %	80-120		"	"	"	"	S-04
Carbon Ranges C6-C12	612	10.0	mg/kg dry	1	EC60311	03/06/06	03/06/06	EPA 8015M	
Carbon Ranges C12-C28	6060	10.0	"	"	"	"	"	"	
Carbon Ranges C28-C35	814	10.0	"	"	"	"	"	"	
Total Hydrocarbon C6-C35	7490	10.0	"	"	"	"	"	"	
Surrogate: 1-Chlorooctane		122 %	70-130		"	"	"	"	
Surrogate: 1-Chlorooctadecane		133 %	70-130		"	"	"	"	S-04

Environmental Lab of Texas

The results in this report apply to the samples analyzed in accordance with the samples received in the laboratory. This analytical report must be reproduced in its entirety, with written approval of Environmental Lab of Texas.

Page 10 of 23

Highlander Environmental Corp.
1910 N. Big Spring St.
Midland TX, 79705

Project: Pogo/ Cotton Draw TB #2
Project Number: 2589
Project Manager: Ike Tavaréz

Fax: (432) 682-3946

Reported:
03/07/06 13:24

Organics by GC
Environmental Lab of Texas

Analyte	Result	Reporting Limit	Units	Dilution	Batch	Prepared	Analyzed	Method	Notes
AH-15 2.0-2.5' (6B23027-41) Soil									
Benzene	ND	0.0250	mg/kg dry	25	EC60604	03/06/06	03/06/06	EPA 8021B	
Toluene	ND	0.0250	"	"	"	"	"	"	
Ethylbenzene	ND	0.0250	"	"	"	"	"	"	
Xylene (p/m)	ND	0.0250	"	"	"	"	"	"	
Xylene (o)	ND	0.0250	"	"	"	"	"	"	
Surrogate: a,a,a-Trifluorotoluene		89.8 %	80-120		"	"	"	"	
Surrogate: 4-Bromofluorobenzene		86.0 %	80-120		"	"	"	"	
Carbon Ranges C6-C12	ND	10.0	mg/kg dry	1	EC60311	03/06/06	03/06/06	EPA 8015M	
Carbon Ranges C12-C28	75.6	10.0	"	"	"	"	"	"	
Carbon Ranges C28-C35	80.6	10.0	"	"	"	"	"	"	
Total Hydrocarbon C6-C35	156	10.0	"	"	"	"	"	"	
Surrogate: 1-Chlorooctane		116 %	70-130		"	"	"	"	
Surrogate: 1-Chlorooctadecane		118 %	70-130		"	"	"	"	

AH-15 3.0-3.5' (6B23027-42) Soil

Benzene	ND	0.0250	mg/kg dry	25	EC60604	03/06/06	03/06/06	EPA 8021B	
Toluene	ND	0.0250	"	"	"	"	"	"	
Ethylbenzene	ND	0.0250	"	"	"	"	"	"	
Xylene (p/m)	ND	0.0250	"	"	"	"	"	"	
Xylene (o)	ND	0.0250	"	"	"	"	"	"	
Surrogate: a,a,a-Trifluorotoluene		91.0 %	80-120		"	"	"	"	
Surrogate: 4-Bromofluorobenzene		102 %	80-120		"	"	"	"	
Carbon Ranges C6-C12	ND	10.0	mg/kg dry	1	EC60311	03/06/06	03/06/06	EPA 8015M	
Carbon Ranges C12-C28	32.9	10.0	"	"	"	"	"	"	
Carbon Ranges C28-C35	40.6	10.0	"	"	"	"	"	"	
Total Hydrocarbon C6-C35	73.5	10.0	"	"	"	"	"	"	
Surrogate: 1-Chlorooctane		92.6 %	70-130		"	"	"	"	
Surrogate: 1-Chlorooctadecane		94.2 %	70-130		"	"	"	"	

Highlander Environmental Corp.
1910 N. Big Spring St.
Midland TX, 79705

Project: Pogo/ Cotton Draw TB #2
Project Number: 2589
Project Manager: Ike Tavarez

Fax: (432) 682-3946

Reported:
03/07/06 13:24

General Chemistry Parameters by EPA / Standard Methods
Environmental Lab of Texas

Analyte	Result	Reporting Limit	Units	Dilution	Batch	Prepared	Analyzed	Method	Notes
AH-1 0.-1.0' (6B23027-01) Soil									
Chloride	7060	100	mg/kg	200	EB62812	02/24/06	02/28/06	EPA 300.0	
% Moisture	5.6	0.1	%	1	EB62703	02/24/06	02/27/06	% calculation	
AH-1 1.0-1.5' (6B23027-02) Soil									
Chloride	9360	100	mg/kg	200	EB62812	02/24/06	02/28/06	EPA 300.0	
AH-2 0-1.0' (6B23027-03) Soil									
Chloride	7540	100	mg/kg	200	EB62812	02/24/06	02/28/06	EPA 300.0	
% Moisture	7.1	0.1	%	1	EB62703	02/24/06	02/27/06	% calculation	
AH-2 1.0-1.5' (6B23027-04) Soil									
Chloride	8630	200	mg/kg	400	EB62812	02/24/06	02/28/06	EPA 300.0	
AH-2 2.0-2.5' (6B23027-05) Soil									
Chloride	13400	200	mg/kg	400	EB62812	02/24/06	02/28/06	EPA 300.0	
% Moisture	12.7	0.1	%	1	EC60601	03/03/06	03/06/06	% calculation	
AH-2 3.0-3.5' (6B23027-06) Soil									
Chloride	3800	50.0	mg/kg	100	EB62812	02/24/06	02/28/06	EPA 300.0	
% Moisture	12.7	0.1	%	1	EC60601	03/03/06	03/06/06	% calculation	
AH-2 4.0-4.5' (6B23027-07) Soil									
Chloride	395	10.0	mg/kg	20	EB62812	02/24/06	02/28/06	EPA 300.0	
AH-2 5.0-5.5' (6B23027-08) Soil									
Chloride	70.2	5.00	mg/kg	10	EB62812	02/24/06	02/28/06	EPA 300.0	
% Moisture	12.0	0.1	%	1	EC60601	03/03/06	03/06/06	% calculation	
AH-3 0-1.0' (6B23027-09) Soil									
Chloride	2290	50.0	mg/kg	100	EB62812	02/24/06	02/28/06	EPA 300.0	
% Moisture	3.0	0.1	%	1	EB62703	02/24/06	02/27/06	% calculation	

Environmental Lab of Texas

The results in this report apply to the samples analyzed in accordance with the samples received in the laboratory. This analytical report must be reproduced in its entirety, with written approval of Environmental Lab of Texas.

Page 12 of 23

Highlander Environmental Corp.
1910 N. Big Spring St.
Midland TX, 79705

Project: Pogo/ Cotton Draw TB #2
Project Number: 2589
Project Manager: Ike Tavarez

Fax: (432) 682-3946

Reported:
03/07/06 13:24

General Chemistry Parameters by EPA / Standard Methods
Environmental Lab of Texas

Analyte	Result	Reporting Limit	Units	Dilution	Batch	Prepared	Analyzed	Method	Notes
AH-3 1.0-1.5' (6B23027-10) Soil									
Chloride	122	5.00	mg/kg	10	EB62812	02/24/06	02/28/06	EPA 300.0	
% Moisture	1.5	0.1	%	1	EC60601	03/03/06	03/06/06	% calculation	
AH-4 0-1.0' (6B23027-12) Soil									
Chloride	3480	50.0	mg/kg	100	EB62812	02/24/06	02/28/06	EPA 300.0	
% Moisture	5.1	0.1	%	1	EB62703	02/24/06	02/27/06	% calculation	
AH-4 1.0-1.5' (6B23027-13) Soil									
Chloride	83.2	5.00	mg/kg	10	EB62812	02/24/06	02/28/06	EPA 300.0	
% Moisture	7.1	0.1	%	1	EC60601	03/03/06	03/06/06	% calculation	
AH-5 0-1.0' (6B23027-14) Soil									
Chloride	75.1	5.00	mg/kg	10	EB62812	02/24/06	02/28/06	EPA 300.0	
% Moisture	3.7	0.1	%	1	EB62703	02/24/06	02/27/06	% calculation	
AH-5 1.0-1.5' (6B23027-15) Soil									
Chloride	56.1	5.00	mg/kg	10	EB62812	02/24/06	02/28/06	EPA 300.0	
% Moisture	3.3	0.1	%	1	EC60601	03/03/06	03/06/06	% calculation	
AH-6 0-1.0' (6B23027-17) Soil									
Chloride	211	10.0	mg/kg	20	EB62812	02/24/06	02/28/06	EPA 300.0	
% Moisture	6.1	0.1	%	1	EB62703	02/24/06	02/27/06	% calculation	
AH-6 1.0-1.5' (6B23027-18) Soil									
Chloride	152	5.00	mg/kg	10	EB62812	02/24/06	02/28/06	EPA 300.0	
% Moisture	6.7	0.1	%	1	EC60601	03/03/06	03/06/06	% calculation	
AH-7 0-1.0' (6B23027-20) Soil									
Chloride	3040	50.0	mg/kg	100	EB62812	02/24/06	02/28/06	EPA 300.0	
% Moisture	4.8	0.1	%	1	EB62703	02/24/06	02/27/06	% calculation	

Environmental Lab of Texas

The results in this report apply to the samples analyzed in accordance with the samples received in the laboratory. This analytical report must be reproduced in its entirety, with written approval of Environmental Lab of Texas.

Page 13 of 23

Highlander Environmental Corp.
1910 N. Big Spring St.
Midland TX, 79705

Project: Pogo/ Cotton Draw TB #2
Project Number: 2589
Project Manager: Ike Tavarez

Fax: (432) 682-3946

Reported:
03/07/06 13:24

General Chemistry Parameters by EPA / Standard Methods
Environmental Lab of Texas

Analyte	Result	Reporting Limit	Units	Dilution	Batch	Prepared	Analyzed	Method	Notes
AH-7 1.0-1.5' (6B23027-21) Soil									
Chloride	2860	50.0	mg/kg	100	EB62812	02/24/06	02/28/06	EPA 300.0	
AH-7 2.0-2.5' (6B23027-22) Soil									
Chloride	31.2	5.00	mg/kg	10	EB62812	02/24/06	02/28/06	EPA 300.0	
AH-8 0-1.0' (6B23027-23) Soil									
Chloride	91.7	5.00	mg/kg	10	EB62812	02/24/06	02/28/06	EPA 300.0	
% Moisture	2.4	0.1	%	1	EB62703	02/24/06	02/27/06	% calculation	
AH-8 1.0-1.5' (6B23027-24) Soil									
Chloride	6.30	5.00	mg/kg	10	EB62813	02/24/06	02/28/06	EPA 300.0	
AH-9 0-1.0' (6B23027-25) Soil									
Chloride	4360	50.0	mg/kg	100	EB62813	02/24/06	02/28/06	EPA 300.0	
% Moisture	4.0	0.1	%	1	EB62703	02/24/06	02/27/06	% calculation	
AH-9 1.0-1.5' (6B23027-26) Soil									
Chloride	66.5	5.00	mg/kg	10	EB62813	02/24/06	02/28/06	EPA 300.0	
% Moisture	3.1	0.1	%	1	EC60601	03/03/06	03/06/06	% calculation	
AH-10 0-1.0' (6B23027-28) Soil									
Chloride	11.3	5.00	mg/kg	10	EB62813	02/24/06	02/28/06	EPA 300.0	
% Moisture	1.6	0.1	%	1	EB62703	02/24/06	02/27/06	% calculation	
AH-10 1.0-1.5' (6B23027-29) Soil									
Chloride	7.12	5.00	mg/kg	10	EB62813	02/24/06	02/28/06	EPA 300.0	
AH-11 0-1.0' (6B23027-30) Soil									
Chloride	1890	25.0	mg/kg	50	EB62813	02/24/06	02/28/06	EPA 300.0	
% Moisture	2.5	0.1	%	1	EB62703	02/24/06	02/27/06	% calculation	

Environmental Lab of Texas

The results in this report apply to the samples analyzed in accordance with the samples received in the laboratory. This analytical report must be reproduced in its entirety, with written approval of Environmental Lab of Texas.

Page 14 of 23

Highlander Environmental Corp.
1910 N. Big Spring St.
Midland TX, 79705

Project: Pogo/ Cotton Draw TB #2
Project Number: 2589
Project Manager: Ike Tavaraz

Fax: (432) 682-3946

Reported:
03/07/06 13:24

General Chemistry Parameters by EPA / Standard Methods
Environmental Lab of Texas

Analyte	Result	Reporting Limit	Units	Dilution	Batch	Prepared	Analyzed	Method	Notes
AH-11 1.0-1.5' (6B23027-31) Soil									
Chloride	19.7	5.00	mg/kg	10	EB62813	02/24/06	02/28/06	EPA 300.0	
AH-12 0-1.0' (6B23027-32) Soil									
Chloride	14600	200	mg/kg	400	EB62813	02/24/06	02/28/06	EPA 300.0	
% Moisture	10.7	0.1	%	1	EB62703	02/24/06	02/27/06	% calculation	
AH-13 0-1.0' (6B23027-33) Soil									
Chloride	9300	200	mg/kg	400	EB62813	02/24/06	02/28/06	EPA 300.0	
% Moisture	8.3	0.1	%	1	EB62703	02/24/06	02/27/06	% calculation	
AH-13 1.0-1.5' (6B23027-34) Soil									
Chloride	1400	25.0	mg/kg	50	EB62813	02/24/06	02/28/06	EPA 300.0	
AH-14 0-1.0' (6B23027-36) Soil									
Chloride	272	10.0	mg/kg	20	EB62813	02/24/06	02/28/06	EPA 300.0	
% Moisture	4.9	0.1	%	1	EB62703	02/24/06	02/27/06	% calculation	
AH-14 1.0-1.5' (6B23027-37) Soil									
Chloride	53.7	5.00	mg/kg	10	EB62813	02/24/06	02/28/06	EPA 300.0	
AH-15 0-1.0' (6B23027-39) Soil									
Chloride	6930	100	mg/kg	200	EB62813	02/24/06	02/28/06	EPA 300.0	
% Moisture	10.9	0.1	%	1	EB62703	02/24/06	02/27/06	% calculation	
AH-15 1.0-1.5' (6B23027-40) Soil									
Chloride	4120	50.0	mg/kg	100	EB62813	02/24/06	02/28/06	EPA 300.0	
% Moisture	5.7	0.1	%	1	EC60601	03/03/06	03/06/06	% calculation	
AH-15 2.0-2.5' (6B23027-41) Soil									
Chloride	2360	50.0	mg/kg	100	EB62813	02/24/06	02/28/06	EPA 300.0	
% Moisture	4.1	0.1	%	1	EC60601	03/03/06	03/06/06	% calculation	

Environmental Lab of Texas

The results in this report apply to the samples analyzed in accordance with the samples received in the laboratory. This analytical report must be reproduced in its entirety, with written approval of Environmental Lab of Texas.

Page 15 of 23

Highlander Environmental Corp.
1910 N. Big Spring St.
Midland TX, 79705

Project: Pogo/ Cotton Draw TB #2
Project Number: 2589
Project Manager: Ike Tavaréz

Fax: (432) 682-3946

Reported:
03/07/06 13:24

General Chemistry Parameters by EPA / Standard Methods
Environmental Lab of Texas

Analyte	Result	Reporting Limit	Units	Dilution	Batch	Prepared	Analyzed	Method	Notes
AH-15 3.0-3.5' (6B23027-42) Soil									
Chloride	598	10.0	mg/kg	20	EB62813	02/24/06	02/28/06	EPA 300.0	
% Moisture	2.0	0.1	%	1	EC60601	03/03/06	03/06/06	% calculation	

Highlander Environmental Corp.
1910 N. Big Spring St.
Midland TX, 79705

Project: Pogo/ Cotton Draw TB #2
Project Number: 2589
Project Manager: Ike Tavaraz

Fax: (432) 682-3946

Reported:
03/07/06 13:24

Organics by GC - Quality Control
Environmental Lab of Texas

Analyte	Result	Reporting Limit	Units	Spike Level	Source Result	%REC	%REC Limits	RPD	RPD Limit	Notes
---------	--------	--------------------	-------	----------------	------------------	------	----------------	-----	--------------	-------

Batch EB62414 - Solvent Extraction (GC)

Blank (EB62414-BLK1)

Prepared: 02/24/06 Analyzed: 03/01/06

Carbon Ranges C6-C12	ND	10.0	mg/kg wet							
Carbon Ranges C12-C28	ND	10.0	"							
Carbon Ranges C28-C35	ND	10.0	"							
Total Hydrocarbon C6-C35	ND	10.0	"							
Surrogate: 1-Chlorooctane	47.6		mg/kg	50.0		95.2	70-130			
Surrogate: 1-Chlorooctadecane	45.9		"	50.0		91.8	70-130			

LCS (EB62414-BS1)

Prepared: 02/24/06 Analyzed: 03/01/06

Carbon Ranges C6-C12	514	10.0	mg/kg wet	500		103	75-125			
Carbon Ranges C12-C28	496	10.0	"	500		99.2	75-125			
Carbon Ranges C28-C35	ND	10.0	"	0.00			75-125			
Surrogate: 1-Chlorooctane	59.7		mg/kg	50.0		119	70-130			
Surrogate: 1-Chlorooctadecane	56.5		"	50.0		113	70-130			

Calibration Check (EB62414-CCV1)

Prepared: 02/24/06 Analyzed: 03/02/06

Carbon Ranges C6-C12	233		mg/kg	250		93.2	80-120			
Carbon Ranges C12-C28	265		"	250		106	80-120			
Total Hydrocarbon C6-C35	498		"	500		99.6	80-120			
Surrogate: 1-Chlorooctane	53.6		"	50.0		107	70-130			
Surrogate: 1-Chlorooctadecane	54.2		"	50.0		108	70-130			

Matrix Spike (EB62414-MS1)

Source: 6B23027-01

Prepared: 02/24/06 Analyzed: 03/02/06

Carbon Ranges C6-C12	594	10.0	mg/kg dry	530	ND	112	75-125			
Carbon Ranges C12-C28	636	10.0	"	530	102	101	75-125			
Carbon Ranges C28-C35	38.6	10.0	"	0.00	82.9		75-125			
Total Hydrocarbon C6-C35	1270	10.0	"	1060	185	102	75-125			
Surrogate: 1-Chlorooctane	60.7		mg/kg	50.0		121	70-130			
Surrogate: 1-Chlorooctadecane	59.0		"	50.0		118	70-130			

Environmental Lab of Texas

The results in this report apply to the samples analyzed in accordance with the samples received in the laboratory. This analytical report must be reproduced in its entirety, with written approval of Environmental Lab of Texas.

Page 17 of 23

Highlander Environmental Corp.
1910 N. Big Spring St.
Midland TX, 79705

Project: Pogo/ Cotton Draw TB #2
Project Number: 2589
Project Manager: Ike Tavarez

Fax: (432) 682-3946

Reported:
03/07/06 13:24

Organics by GC - Quality Control
Environmental Lab of Texas

Analyte	Result	Reporting Limit	Units	Spike Level	Source Result	%REC	%REC Limits	RPD	RPD Limit	Notes
---------	--------	--------------------	-------	----------------	------------------	------	----------------	-----	--------------	-------

Batch EB62414 - Solvent Extraction (GC)

Matrix Spike Dup (EB62414-MSD1)

Source: 6B23027-01

Prepared: 02/24/06 Analyzed: 03/02/06

Carbon Ranges C6-C12	591	10.0	mg/kg dry	530	ND	112	75-125	0.506	20	
Carbon Ranges C12-C28	628	10.0	"	530	102	99.2	75-125	1.27	20	
Carbon Ranges C28-C35	44.8	10.0	"	0.00	82.9		75-125	14.9	20	
Total Hydrocarbon C6-C35	1260	10.0	"	1060	185	101	75-125	0.791	20	
Surrogate: 1-Chlorooctane	60.6		mg/kg	50.0		121	70-130			
Surrogate: 1-Chlorooctadecane	58.0		"	50.0		116	70-130			

Batch EC60311 - Solvent Extraction (GC)

Blank (EC60311-BLK1)

Prepared: 03/03/06 Analyzed: 03/06/06

Carbon Ranges C6-C12	ND	10.0	mg/kg wet							
Carbon Ranges C12-C28	ND	10.0	"							
Carbon Ranges C28-C35	ND	10.0	"							
Total Hydrocarbon C6-C35	ND	10.0	"							
Surrogate: 1-Chlorooctane	52.2		mg/kg	50.0		104	70-130			
Surrogate: 1-Chlorooctadecane	44.5		"	50.0		89.0	70-130			

LCS (EC60311-BS1)

Prepared: 03/03/06 Analyzed: 03/06/06

Carbon Ranges C6-C12	543	10.0	mg/kg wet	500		109	75-125			
Carbon Ranges C12-C28	509	10.0	"	500		102	75-125			
Total Hydrocarbon C6-C35	1050	10.0	"	1000		105	75-125			
Surrogate: 1-Chlorooctane	63.7		mg/kg	50.0		127	70-130			
Surrogate: 1-Chlorooctadecane	48.9		"	50.0		97.8	70-130			

Calibration Check (EC60311-CCV1)

Prepared: 03/03/06 Analyzed: 03/06/06

Carbon Ranges C6-C12	262		mg/kg	250		105	80-120			
Carbon Ranges C12-C28	298		"	250		119	80-120			
Total Hydrocarbon C6-C35	560		"	500		112	80-120			
Surrogate: 1-Chlorooctane	61.7		"	50.0		123	70-130			
Surrogate: 1-Chlorooctadecane	57.3		"	50.0		115	70-130			

Environmental Lab of Texas

The results in this report apply to the samples analyzed in accordance with the samples received in the laboratory. This analytical report must be reproduced in its entirety, with written approval of Environmental Lab of Texas.

Page 18 of 23

Highlander Environmental Corp.
1910 N. Big Spring St.
Midland TX, 79705

Project: Pogo/ Cotton Draw TB #2
Project Number: 2589
Project Manager: Ike Tavaraz

Fax: (432) 682-3946

Reported:
03/07/06 13:24

Organics by GC - Quality Control
Environmental Lab of Texas

Analyte	Result	Reporting Limit	Units	Spike Level	Source Result	%REC Limits	RPD	RPD Limit	Notes
---------	--------	--------------------	-------	----------------	------------------	----------------	-----	--------------	-------

Batch EC60311 - Solvent Extraction (GC)

Matrix Spike (EC60311-MS1) Source: 6C03004-01 Prepared: 03/03/06 Analyzed: 03/06/06

Carbon Ranges C6-C12	682	10.0	mg/kg dry	621	ND	110	75-125		
Carbon Ranges C12-C28	631	10.0	"	621	60.9	91.8	75-125		
Total Hydrocarbon C6-C35	1310	10.0	"	1240	89.0	98.5	75-125		
Surrogate: 1-Chlorooctane	38.1		mg/kg	50.0		76.2	70-130		
Surrogate: 1-Chlorooctadecane	35.3		"	50.0		70.6	70-130		

Matrix Spike Dup (EC60311-MSD1) Source: 6C03004-01 Prepared: 03/03/06 Analyzed: 03/06/06

Carbon Ranges C6-C12	684	10.0	mg/kg dry	621	ND	110	75-125	0.293	20
Carbon Ranges C12-C28	640	10.0	"	621	60.9	93.3	75-125	1.42	20
Total Hydrocarbon C6-C35	1320	10.0	"	1240	89.0	99.3	75-125	0.760	20
Surrogate: 1-Chlorooctane	38.2		mg/kg	50.0		76.4	70-130		
Surrogate: 1-Chlorooctadecane	35.2		"	50.0		70.4	70-130		

Batch EC60604 - EPA 5030C (GC)

Blank (EC60604-BLK1) Prepared & Analyzed: 03/06/06

Benzene	ND	0.0250	mg/kg wet						
Toluene	ND	0.0250	"						
Ethylbenzene	ND	0.0250	"						
Xylene (p/m)	ND	0.0250	"						
Xylene (o)	ND	0.0250	"						
Surrogate: a,a,a-Trifluorotoluene	32.1		ug/kg	40.0		80.2	80-120		
Surrogate: 4-Bromofluorobenzene	41.0		"	40.0		102	80-120		

LCS (EC60604-BS1) Prepared & Analyzed: 03/06/06

Benzene	0.0405	0.00100	mg/kg wet	0.0500		81.0	80-120		
Toluene	0.0464	0.00100	"	0.0500		92.8	80-120		
Ethylbenzene	0.0555	0.00100	"	0.0500		111	80-120		
Xylene (p/m)	0.117	0.00100	"	0.100		117	80-120		
Xylene (o)	0.0579	0.00100	"	0.0500		116	80-120		
Surrogate: a,a,a-Trifluorotoluene	37.7		ug/kg	40.0		94.2	80-120		
Surrogate: 4-Bromofluorobenzene	42.9		"	40.0		107	80-120		

Environmental Lab of Texas

The results in this report apply to the samples analyzed in accordance with the samples received in the laboratory. This analytical report must be reproduced in its entirety, with written approval of Environmental Lab of Texas.

Page 19 of 23

Highlander Environmental Corp.
1910 N. Big Spring St.
Midland TX, 79705

Project: Pogo/ Cotton Draw TB #2
Project Number: 2589
Project Manager: Ike Tavarez

Fax: (432) 682-3946

Reported:
03/07/06 13:24

Organics by GC - Quality Control
Environmental Lab of Texas

Analyte	Result	Reporting Limit	Units	Spike Level	Source Result	%REC	%REC Limits	RPD	RPD Limit	Notes
---------	--------	--------------------	-------	----------------	------------------	------	----------------	-----	--------------	-------

Batch EC60604 - EPA 5030C (GC)

Calibration Check (EC60604-CCV1)

Prepared & Analyzed: 03/06/06

Benzene	40.3		ug/kg	50.0		80.6	80-120			
Toluene	42.0		"	50.0		84.0	80-120			
Ethylbenzene	47.3		"	50.0		94.6	80-120			
Xylene (p/m)	99.5		"	100		99.5	80-120			
Xylene (o)	50.2		"	50.0		100	80-120			
Surrogate: a,a,a-Trifluorotoluene	33.6		"	40.0		84.0	80-120			
Surrogate: 4-Bromofluorobenzene	33.3		"	40.0		83.2	80-120			

Matrix Spike (EC60604-MS1)

Source: 6C03004-01

Prepared & Analyzed: 03/06/06

Benzene	1.25	0.0250	mg/kg dry	1.55	ND	80.6	80-120			
Toluene	1.40	0.0250	"	1.55	ND	90.3	80-120			
Ethylbenzene	1.73	0.0250	"	1.55	ND	112	80-120			
Xylene (p/m)	3.64	0.0250	"	3.11	ND	117	80-120			
Xylene (o)	1.82	0.0250	"	1.55	ND	117	80-120			
Surrogate: a,a,a-Trifluorotoluene	34.0		ug/kg	40.0		85.0	80-120			
Surrogate: 4-Bromofluorobenzene	47.1		"	40.0		118	80-120			

Matrix Spike Dup (EC60604-MSD1)

Source: 6C03004-01

Prepared & Analyzed: 03/06/06

Benzene	1.26	0.0250	mg/kg dry	1.55	ND	81.3	80-120	0.865	20	
Toluene	1.40	0.0250	"	1.55	ND	90.3	80-120	0.00	20	
Ethylbenzene	1.69	0.0250	"	1.55	ND	109	80-120	2.71	20	
Xylene (p/m)	3.58	0.0250	"	3.11	ND	115	80-120	1.72	20	
Xylene (o)	1.79	0.0250	"	1.55	ND	115	80-120	1.72	20	
Surrogate: a,a,a-Trifluorotoluene	34.1		ug/kg	40.0		85.2	80-120			
Surrogate: 4-Bromofluorobenzene	44.3		"	40.0		111	80-120			

Environmental Lab of Texas

The results in this report apply to the samples analyzed in accordance with the samples received in the laboratory. This analytical report must be reproduced in its entirety, with written approval of Environmental Lab of Texas.

Page 20 of 23

Highlander Environmental Corp.
1910 N. Big Spring St.
Midland TX, 79705

Project: Pogo/ Cotton Draw TB #2
Project Number: 2589
Project Manager: Ike Tavarez

Fax: (432) 682-3946

Reported:
03/07/06 13:24

General Chemistry Parameters by EPA / Standard Methods - Quality Control
Environmental Lab of Texas

Analyte	Result	Reporting Limit	Units	Spike Level	Source Result	%REC	%REC Limits	RPD	RPD Limit	Notes
---------	--------	--------------------	-------	----------------	------------------	------	----------------	-----	--------------	-------

Batch EB62703 - General Preparation (Prep)

Blank (EB62703-BLK1) Prepared: 02/24/06 Analyzed: 02/27/06

% Solids 100 %

Duplicate (EB62703-DUP1) Source: 6B23028-01 Prepared: 02/24/06 Analyzed: 02/27/06

% Solids 98.4 % 98.4 0.00 20

Duplicate (EB62703-DUP2) Source: 6B23027-20 Prepared: 02/24/06 Analyzed: 02/27/06

% Solids 95.2 % 95.2 0.00 20

Duplicate (EB62703-DUP3) Source: 6B24003-01 Prepared: 02/24/06 Analyzed: 02/27/06

% Solids 89.0 % 89.3 0.337 20

Duplicate (EB62703-DUP4) Source: 6B24009-15 Prepared: 02/24/06 Analyzed: 02/27/06

% Solids 93.4 % 93.0 0.429 20

Duplicate (EB62703-DUP5) Source: 6B24010-14 Prepared: 02/24/06 Analyzed: 02/27/06

% Solids 93.2 % 93.6 0.428 20

Batch EB62812 - Water Extraction

Blank (EB62812-BLK1) Prepared: 02/24/06 Analyzed: 02/28/06

Chloride ND 0.500 mg/kg

LCS (EB62812-BS1) Prepared: 02/24/06 Analyzed: 02/28/06

Chloride 9.67 0.500 mg/kg 10.0 96.7 80-120

Calibration Check (EB62812-CCV1) Prepared: 02/24/06 Analyzed: 02/28/06

Chloride 9.44 mg/L 10.0 94.4 80-120

Environmental Lab of Texas

The results in this report apply to the samples analyzed in accordance with the samples received in the laboratory. This analytical report must be reproduced in its entirety, with written approval of Environmental Lab of Texas.

Page 21 of 23

Highlander Environmental Corp.
1910 N. Big Spring St.
Midland TX, 79705

Project: Pogo/ Cotton Draw TB #2
Project Number: 2589
Project Manager: Ike Tavaréz

Fax: (432) 682-3946

Reported:
03/07/06 13:24

General Chemistry Parameters by EPA / Standard Methods - Quality Control
Environmental Lab of Texas

Analyte	Result	Reporting Limit	Units	Spike Level	Source Result	%REC	%REC Limits	RPD	RPD Limit	Notes
---------	--------	--------------------	-------	----------------	------------------	------	----------------	-----	--------------	-------

Batch EB62812 - Water Extraction

Duplicate (EB62812-DUP1) Source: 6B23027-01 Prepared: 02/24/06 Analyzed: 02/28/06

Chloride	7120	0.500	mg/kg		7060			0.846	20	
----------	------	-------	-------	--	------	--	--	-------	----	--

Batch EB62813 - Water Extraction

Blank (EB62813-BLK1) Prepared: 02/24/06 Analyzed: 02/28/06

Chloride	ND	0.500	mg/kg							
----------	----	-------	-------	--	--	--	--	--	--	--

LCS (EB62813-BS1) Prepared: 02/24/06 Analyzed: 02/28/06

Chloride	9.39	0.500	mg/kg	10.0		93.9	80-120			
----------	------	-------	-------	------	--	------	--------	--	--	--

Calibration Check (EB62813-CCV1) Prepared: 02/24/06 Analyzed: 02/28/06

Chloride	9.19		mg/L	10.0		91.9	80-120			
----------	------	--	------	------	--	------	--------	--	--	--

Duplicate (EB62813-DUP1) Source: 6B23027-25 Prepared: 02/24/06 Analyzed: 02/28/06

Chloride	4390	50.0	mg/kg		4360			0.686	20	
----------	------	------	-------	--	------	--	--	-------	----	--

Batch EC60601 - General Preparation (Prep)

Blank (EC60601-BLK1) Prepared: 03/03/06 Analyzed: 03/06/06

% Solids	100		%							
----------	-----	--	---	--	--	--	--	--	--	--

Duplicate (EC60601-DUP1) Source: 6C03001-01 Prepared: 03/03/06 Analyzed: 03/06/06

% Solids	96.0		%		96.7			0.727	20	
----------	------	--	---	--	------	--	--	-------	----	--

Duplicate (EC60601-DUP2) Source: 6B23027-26 Prepared: 03/03/06 Analyzed: 03/06/06

% Solids	97.0		%		96.9			0.103	20	
----------	------	--	---	--	------	--	--	-------	----	--

Highlander Environmental Corp.
1910 N. Big Spring St.
Midland TX, 79705

Project: Pogo/ Cotton Draw TB #2
Project Number: 2589
Project Manager: Ike Tavarez

Fax: (432) 682-3946

Reported:
03/07/06 13:24

Notes and Definitions

S-06 The recovery of this surrogate is outside control limits due to sample dilution required from high analyte concentration and/or matrix interference's.

S-04 The surrogate recovery for this sample is outside of established control limits due to a sample matrix effect.

DET Analyte DETECTED

ND Analyte NOT DETECTED at or above the reporting limit

NR Not Reported

dry Sample results reported on a dry weight basis

RPD Relative Percent Difference

LCS Laboratory Control Spike

MS Matrix Spike

Dup Duplicate

Report Approved By:

Raland K. Tuttle

Date:

3-07-06

Raland K. Tuttle, Lab Manager
Celey D. Keene, Lab Director, Org. Tech Director
Peggy Allen, QA Officer

Jeanne Mc Murrey, Inorg. Tech Director
LaTasha Cornish, Chemist
Sandra Sanchez, Lab Tech.

This material is intended only for the use of the individual (s) or entity to whom it is addressed, and may contain information that is privileged and confidential.

If you have received this material in error, please notify us immediately at 432-563-1800.

Environmental Lab of Texas

The results in this report apply to the samples analyzed in accordance with the samples received in the laboratory. This analytical report must be reproduced in its entirety, with written approval of Environmental Lab of Texas.

Page 23 of 23

Environmental Lab of Texas

Variance / Corrective Action Report – Sample Log-In

Client: Highlander

Date/Time: 2/23/06 3:40

Order #: WB23027

Initials: CK

Sample Receipt Checklist

Temperature of container/cooler?	Yes	No	30 C
Shipping container/cooler in good condition?	<input checked="" type="checkbox"/>	No	
Custody Seals intact on shipping container/cooler?	Yes	No	Not present
Custody Seals intact on sample bottles?	Yes	No	Not present
Chain of custody present?	<input checked="" type="checkbox"/>	No	
Sample Instructions complete on Chain of Custody?	<input checked="" type="checkbox"/>	No	
Chain of Custody signed when relinquished and received?	<input checked="" type="checkbox"/>	No	
Chain of custody agrees with sample label(s)	Yes	No	ID on 1103
Container labels legible and intact?	Yes	No	n/a
Sample Matrix and properties same as on chain of custody?	<input checked="" type="checkbox"/>	No	
Samples in proper container/bottle?	<input checked="" type="checkbox"/>	No	
Samples properly preserved?	<input checked="" type="checkbox"/>	No	
Sample bottles intact?	<input checked="" type="checkbox"/>	No	
Preservations documented on Chain of Custody?	<input checked="" type="checkbox"/>	No	
Containers documented on Chain of Custody?	<input checked="" type="checkbox"/>	No	
Sufficient sample amount for indicated test?	<input checked="" type="checkbox"/>	No	
All samples received within sufficient hold time?	<input checked="" type="checkbox"/>	No	
VOC samples have zero headspace?	<input checked="" type="checkbox"/>	No	Not Applicable

Other observations:

Variance Documentation:

Contact Person: - _____ Date/Time: _____ Contacted by: _____
Regarding: _____

Corrective Action Taken:

Jeanne McMurrey

From: "Ike T" <itavarez@hec-enviro.com>
To: "Jeanne - Enviro Lab" <jeanne@elabtexas.com>
Sent: Friday, March 03, 2006 1:18 PM
Subject: Pogo Producing - Additional Analysis for the Cotton Draw Project

Pogo Producing Company – Cotton Draw Tank Battery #2, Lea County, New Mexico
Lab Order # 6B23027
Project #2589

Jeanne, please additional analysis on samples below. Call me if you have any questions, thanks.

AH-2 (2-2.5) – TPH, BTEX
AH-2 (3-3.5) - TPH, BTEX
AH-2 (5-5.5) – TPH, BTEX

AH-3 (1-1.5') – TPH, BTEX

AH-4 (1-1.5) - TPH, BTEX

AH-5 (1-1.5) – TPH, BTEX

AH-6 (1-1.5) – TPH, BTEX

AH-9 (1-1.5) – TPH, BTEX

AH-15 (1-1.5) – TPH, BTEX
 (2-2.5) – TPH, BTEX
 (3-3.5) – TPH, BTEX

--

This message has been scanned for viruses and dangerous content by BasinBroadband, and is believed to be clean.

PAGE: 1 **OF:** 3

ANALYSIS REQUEST
(Circle or Specify Method No.)

Fax (432) 682-3946

(432) 682-4559

SITE MANAGER: The Trust for

PROJECT NAME: Pogo/Cotton Draw TB #2

County, NM

SAMPLE IDENTIFICATION

SAMPLE IDENTIFICATION

100

(0-1-0)

12

15.1-0.7

10-101

$$\begin{array}{r} 100 \\ 111111 \\ \hline \end{array}$$
$$(5.1 - 0.1)$$

12021

157-077

(30'-35')

11-11-11

(4.0-4.5)

1700

155-05

$$(0 - 1.0')$$

0.1 - 1

15.1-0.7

RECEIVED BY: 23106

40	PERCENTAGE PV.
----	----------------

RECEIVED DI:

RECEIVED BY: _____

RECEIVED BY

DATE: 2/2

PD: **W-Water** **A-Air**

8-901 SL-500

Now copy -- Return original

Abstract omitted

HIGHLANDER ENVIRONMENTAL CORP.

(432) 682-4559

Fax (432) 682-3946

SITE MANAGER: *The Tavares*

PROJECT NAME:
P060 / cotton Draw TB #2

COUNTY, N.M.

STATION NUMBER	DATE	MATTY	COM1	GRAVE	NUMBER	FLUTE	HCL	HNO ₃	ICE	NONN	BTX	MTBE	TPH	PAH	RCRA	TCLP	TCLP	TCLP	RCI	GC.MS	GC.MS	PCB's	Pest.	BOD ₅	Germ	Alphab	PLM
7201	2/2/96	S	X	AH-3 (2.0'-2.5')	1				X																		
72		S	X	AH-4 (0-1.0')	1				X			X											X				
73		S	X	AH-4 (1.0'-1.5')	1				X		X												X				
74		S	X	AH-5 (0-1.0')	1				X			X											X				
75		S	X	AH-5 (1.0'-1.5')	1				X		X												X				
76		S	X	AH-5 (2.0'-2.5')	1				X																		
77		S	X	AH-6 (0-1.0')	1				X				X										X				
78		S	X	AH-6 (1.0'-1.5')	1				X		X		X										X				
79		S	X	AH-6 (2.0'-2.5')	1				X																		
80	↓	S	X	AH-7 (0-1.0')	1				X			X											X				

RELINQUISHED BY: (Signature) <i>[Signature]</i>	Date: <u>2/23/06</u> Time: <u>3:46</u>	RECEIVED BY: (Signature) _____	Date: _____ Time: _____	SAMPLED BY: (Print & Sign) <i>for glass Ike Tavariz</i>	Date: <u>2/23/06</u> Time: <u>1:30</u>
RELINQUISHED BY: (Signature) _____	Date: _____ Time: _____	RECEIVED BY: (Signature) _____	Date: _____ Time: _____	SAMPLE SHIPPED BY: (Circle) FEDEX <input checked="" type="checkbox"/> BUS <input type="checkbox"/> UPS <input type="checkbox"/>	AIRBILL # _____ OTHER: _____
RELINQUISHED BY: (Signature) _____	Date: _____ Time: _____	RECEIVED BY: (Signature) _____	Date: _____ Time: _____	STANDARD DELIVERY	Results by: RUSH Charges _____ Authorized: Yes _____ No _____
RECEIVING LABORATORY: <u>FLT</u>	_____	RECEIVED BY: (Signature) <i>[Signature]</i>	_____	HIGHLANDER CONTACT PERSON: <i>Ike Tavariz</i>	_____
ADDRESS: _____	_____	DATE: <u>2/23/06</u>	TIME: <u>3:40</u>	REMARKS: <i>for glass 30 ^{oz} label / no seals</i>	_____
CITY: <u>Orleans</u>	STATE: <u>TX</u>	ZIP: _____	_____	_____	_____
CONTACT: _____	PHONE: _____	_____	_____	_____	_____
SAMPLE CONDITION WHEN RECEIVED:		MAYBE:		_____	
_____		W-Tetar (S-Sell) _____ A-Air _____ SD-Solid _____		_____	
_____		SL-Sludge _____ O-Other _____		_____	

Analytical Report

3/13/2006

ENVIRONMENTAL LAB OF

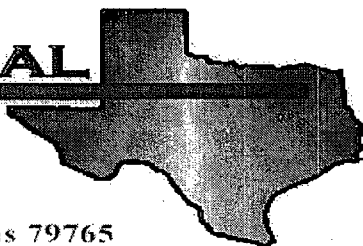

12600 West I-20 East - Odessa, Texas 79765

Analytical Report

Prepared for:

Ike Tavaréz

Highlander Environmental Corp.

1910 N. Big Spring St.

Midland, TX 79705

Project: Pogo/ Cotton Draw TB #2

Project Number: 2589

Location: Lea County, NM

Lab Order Number: 6C07003

Report Date: 03/13/06

Highlander Environmental Corp.
1910 N. Big Spring St.
Midland TX, 79705

Project: Pogo/ Cotton Draw TB #2
Project Number: 2589
Project Manager: Ike Tavaréz

Fax: (432) 682-3946

Reported:
03/13/06 09:04

ANALYTICAL REPORT FOR SAMPLES

Sample ID	Laboratory ID	Matrix	Date Sampled	Date Received
AH-1 T-1 2.0' BEB	6C07003-01	Soil	03/03/06 00:00	03/07/06 14:00
AH-12 T-2 2.0'	6C07003-03	Soil	03/03/06 00:00	03/07/06 14:00
AH-12 T-2 3.5'	6C07003-04	Soil	03/03/06 00:00	03/07/06 14:00
AH-12 T-2 5.0'	6C07003-05	Soil	03/03/06 00:00	03/07/06 14:00

Highlander Environmental Corp.
1910 N. Big Spring St.
Midland TX, 79705

Project: Pogo/ Cotton Draw TB #2
Project Number: 2589
Project Manager: Ike Tavarez

Fax: (432) 682-3946

Reported:
03/13/06 09:04

General Chemistry Parameters by EPA / Standard Methods
Environmental Lab of Texas

Analyte	Result	Reporting Limit	Units	Dilution	Batch	Prepared	Analyzed	Method	Notes
AH-1 T-1 2.0' BEB (6C07003-01) Soil									
Chloride	232	10.0	mg/kg	20	EC60910	03/09/06	03/09/06	EPA 300.0	
AH-12 T-2 2.0' (6C07003-03) Soil									
Chloride	16600	200	mg/kg	400	EC60910	03/09/06	03/09/06	EPA 300.0	
AH-12 T-2 3.5' (6C07003-04) Soil									
Chloride	17700	200	mg/kg	400	EC60910	03/09/06	03/09/06	EPA 300.0	
AH-12 T-2 5.0' (6C07003-05) Soil									
Chloride	112	5.00	mg/kg	10	EC60910	03/09/06	03/09/06	EPA 300.0	

Highlander Environmental Corp.
1910 N. Big Spring St.
Midland TX, 79705

Project: Pogo/ Cotton Draw TB #2
Project Number: 2589
Project Manager: Ike Tavarez

Fax: (432) 682-3946

Reported:
03/13/06 09:04

General Chemistry Parameters by EPA / Standard Methods - Quality Control
Environmental Lab of Texas

Analyte	Result	Reporting Limit	Units	Spike Level	Source Result	%REC Limits	RPD	RPD Limit	Notes
Batch EC60910 - Water Extraction									
Blank (EC60910-BLK1)				Prepared & Analyzed: 03/09/06					
Chloride	ND	0.500	mg/kg						
LCS (EC60910-BS1)				Prepared & Analyzed: 03/09/06					
Chloride	9.17		mg/L	10.0		91.7	80-120		
Calibration Check (EC60910-CCV1)				Prepared & Analyzed: 03/09/06					
Chloride	9.39		mg/L	10.0		93.9	80-120		
Duplicate (EC60910-DUP1)				Source: 6C08016-01 Prepared & Analyzed: 03/09/06					
Chloride	1770	50.0	mg/kg		1760		0.567	20	

Highlander Environmental Corp.
1910 N. Big Spring St.
Midland TX, 79705

Project: Pogo/ Cotton Draw TB #2
Project Number: 2589
Project Manager: Ike Tavaréz

Fax: (432) 682-3946

Reported:
03/13/06 09:04

Notes and Definitions

DET Analyte DETECTED
ND Analyte NOT DETECTED at or above the reporting limit
NR Not Reported
dry Sample results reported on a dry weight basis
RPD Relative Percent Difference
LCS Laboratory Control Spike
MS Matrix Spike
Dup Duplicate

Report Approved By:

Raland K. Tuttle

Date:

3-13-06

Raland K. Tuttle, Lab Manager
Celey D. Keene, Lab Director, Org. Tech Director
Peggy Allen, QA Officer

Jeanne Mc Murrey, Inorg. Tech Director
LaTasha Cornish, Chemist
Sandra Sanchez, Lab Tech.

This material is intended only for the use of the individual (s) or entity to whom it is addressed, and may contain information that is privileged and confidential.

If you have received this material in error, please notify us immediately at 432-563-1800.

Environmental Lab of Texas

Variance / Corrective Action Report – Sample Log-In

Client: Higlander

Date/Time: 3/7/06 2:00

Order #: 6107003

Initials: CK

Sample Receipt Checklist

Temperature of container/cooler?	Yes	No	600 C
Shipping container/cooler in good condition?	<input checked="" type="checkbox"/>	No	
Custody Seals intact on shipping container/cooler?	Yes	No	Not present
Custody Seals intact on sample bottles?	Yes	No	Not present
Chain of custody present?	<input checked="" type="checkbox"/>	No	
Sample Instructions complete on Chain of Custody?	<input checked="" type="checkbox"/>	No	
Chain of Custody signed when relinquished and received?	<input checked="" type="checkbox"/>	No	
Chain of custody agrees with sample label(s)	<input checked="" type="checkbox"/>	No	
Container labels legible and intact?	<input checked="" type="checkbox"/>	No	
Sample Matrix and properties same as on chain of custody?	<input checked="" type="checkbox"/>	No	
Samples in proper container/bottle?	<input checked="" type="checkbox"/>	No	
Samples properly preserved?	<input checked="" type="checkbox"/>	No	
Sample bottles intact?	<input checked="" type="checkbox"/>	No	
Preservations documented on Chain of Custody?	<input checked="" type="checkbox"/>	No	
Containers documented on Chain of Custody?	<input checked="" type="checkbox"/>	No	
Sufficient sample amount for indicated test?	<input checked="" type="checkbox"/>	No	
All samples received within sufficient hold time?	<input checked="" type="checkbox"/>	No	
VOC samples have zero headspace?	<input checked="" type="checkbox"/>	No	Not Applicable

Other observations:

Variance Documentation:

Contact Person: _____ Date/Time: _____ Contacted by: _____
Regarding: _____

Corrective Action Taken:

Analysis Request and Chain of Custody Record

HIGHLANDER ENVIRONMENTAL CORP.

1910 N. Big Spring St.
Midland, Texas 79705

(432) 682-4559

Fax (432) 682-3946

CLIENT NAME:	PROJECT NAME:	SITE MANAGER:
P060	P060 / Cotton draw TB#2	Ike Taurer
PROJECT NO.: 2589	SAMPLE IDENTIFICATION	
	Lea County - NM	

LAB I.D. NUMBER	DATE	TIME	MATRIX	COMP.	GRAB	NUMBER OF CONTAINERS	FILTERED (Y/N)	HCL	HNO3	ICE	NONE	PRESERVATIVE METHOD
01	3/3/06				X	1	1			X		
02	3/3/06				X	1	1			X		
03	3/6/06				X	1	1			X		
04	3/6/06				X	1	1			X		
05	3/6/06				X	1	1			X		

RELINQUISHED BY: (Signature)	Date: 3/3/06	Time: 5:00	RECEIVED BY: (Signature)	Date: 3/3/06	Time: 5:00
RELINQUISHED BY: (Signature)	Date: _____	Time: _____	RECEIVED BY: (Signature)	Date: _____	Time: _____
RELINQUISHED BY: (Signature)	Date: _____	Time: _____	RECEIVED BY: (Signature)	Date: _____	Time: _____
RECEIVING LABORATORY: EIT			RECEIVED BY: (Signature)	Date: 3/3/06	Time: 2:00

ADDRESS: 00000
CITY: 00000
STATE: TX
ZIP: 00000
PHONE: 000-0000000

SAMPLE CONDITION WHEN RECEIVED: _____

MATRIX: W-Water A-Air SL-Sludge SD-Solid O-Other

REMARKS: 402 glass vials labeled

CLIENT NAME: P060 PROJECT NAME: P060 / Cotton draw TB#2 SITE MANAGER: Ike Taurer

PROJECT NO.: 2589

LAB I.D. NUMBER: 01 DATE: 3/3/06 TIME: 5:00 MATRIX: COMP.: GRAB: X

LAB I.D. NUMBER: 02 DATE: 3/3/06 TIME: 5:00 MATRIX: COMP.: GRAB: X

LAB I.D. NUMBER: 03 DATE: 3/6/06 TIME: 5:00 MATRIX: COMP.: GRAB: X

LAB I.D. NUMBER: 04 DATE: 3/6/06 TIME: 5:00 MATRIX: COMP.: GRAB: X

LAB I.D. NUMBER: 05 DATE: 3/6/06 TIME: 5:00 MATRIX: COMP.: GRAB: X

PAGE: 1 OF: 1

ANALYSIS REQUEST (Circle or Specify Method No.)

GC/MS Vol. B240/B260/B24

GC/MS Semi. Vol. B270/B25

PCB's B080/B08

Pest. B08/B08

BOD, TSS, pH, TDS, Chloride

Gamma Spec.

Alpha Beta (Air)

PLM (Asbestos)

SAMPLED BY: (Print & Sign) Date: 3/3/06 Time: 11:30

SAMPLE SHIPPED BY: (Circle) Date: 3/3/06 Time: 11:30

FEDX AIRBILL #

HAND DELIVERED OTHER:

HIGHLANDER CONTACT PERSON: Ike Taurer

RUSH CHARGES AUTHORIZED: Yes No

Analytical Report

3/13/2006

ENVIRONMENTAL LAB OF

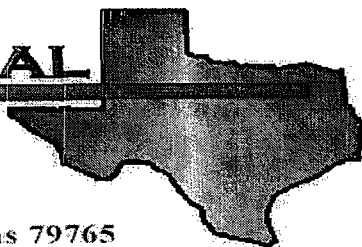

12600 West I-20 East - Odessa, Texas 79765

Analytical Report

Prepared for:

Ike Tavaréz

Highlander Environmental Corp.

1910 N. Big Spring St.

Midland, TX 79705

Project: Pogo/ Cotton Draw TB #2

Project Number: 2589

Location: Lea County, NM

Lab Order Number: 6C09012

Report Date: 03/13/06

Highlander Environmental Corp.
1910 N. Big Spring St.
Midland TX, 79705

Project: Pogo/ Cotton Draw TB #2
Project Number: 2589
Project Manager: Ike Tavarez

Fax: (432) 682-3946

Reported:
03/13/06 10:49

ANALYTICAL REPORT FOR SAMPLES

Sample ID	Laboratory ID	Matrix	Date Sampled	Date Received
AH-13 (2.0'-2.5')	6C09012-01	Soil	02/21/06 00:00	02/23/06 15:40

Highlander Environmental Corp.
1910 N. Big Spring St.
Midland TX, 79705

Project: Pogo/ Cotton Draw TB #2
Project Number: 2589
Project Manager: Ike Tavaréz

Fax: (432) 682-3946

Reported:
03/13/06 10:49

General Chemistry Parameters by EPA / Standard Methods
Environmental Lab of Texas

Analyte	Result	Reporting Limit	Units	Dilution	Batch	Prepared	Analyzed	Method	Notes
AH-13 (2.0'-2.5') (6C09012-01) Soil									
Chloride	39.1	5.00	mg/kg	10	EC61305	03/10/06	03/13/06	EPA 300.0	

Highlander Environmental Corp.
1910 N. Big Spring St.
Midland TX, 79705

Project: Pogo/ Cotton Draw TB #2
Project Number: 2589
Project Manager: Ike Tavarez

Fax: (432) 682-3946

Reported:
03/13/06 10:49

General Chemistry Parameters by EPA / Standard Methods - Quality Control
Environmental Lab of Texas

Analyte	Result	Reporting Limit	Units	Spike Level	Source Result	%REC	%REC Limits	RPD	RPD Limit	Notes
---------	--------	--------------------	-------	----------------	------------------	------	----------------	-----	--------------	-------

Batch EC61305 - Water Extraction

Blank (EC61305-BLK1)

Prepared: 03/10/06 Analyzed: 03/13/06

Chloride	ND	0.500	mg/kg							
----------	----	-------	-------	--	--	--	--	--	--	--

LCS (EC61305-BS1)

Prepared: 03/10/06 Analyzed: 03/13/06

Chloride	8.69		mg/L	10.0		86.9	80-120			
----------	------	--	------	------	--	------	--------	--	--	--

Calibration Check (EC61305-CCV1)

Prepared: 03/10/06 Analyzed: 03/13/06

Chloride	8.99		mg/L	10.0		89.9	80-120			
----------	------	--	------	------	--	------	--------	--	--	--

Duplicate (EC61305-DUP1)

Source: 6C09004-02

Prepared: 03/10/06 Analyzed: 03/13/06

Chloride	516	10.0	mg/kg		509			1.37	20	
----------	-----	------	-------	--	-----	--	--	------	----	--

Environmental Lab of Texas

The results in this report apply to the samples analyzed in accordance with the samples received in the laboratory. This analytical report must be reproduced in its entirety, with written approval of Environmental Lab of Texas.

Page 3 of 4

Highlander Environmental Corp.
1910 N. Big Spring St.
Midland TX, 79705

Project: Pogo/ Cotton Draw TB #2
Project Number: 2589
Project Manager: Ike Tavarez

Fax: (432) 682-3946

Reported:
03/13/06 10:49

Notes and Definitions

DET Analyte DETECTED
ND Analyte NOT DETECTED at or above the reporting limit
NR Not Reported
dry Sample results reported on a dry weight basis
RPD Relative Percent Difference
LCS Laboratory Control Spike
MS Matrix Spike
Dup Duplicate

Report Approved By:

Raland K Tuttle

Date:

03-13-06

Raland K. Tuttle, Lab Manager
Celey D. Keene, Lab Director, Org. Tech Director
Peggy Allen, QA Officer

Jeanne Mc Murrey, Inorg. Tech Director
LaTasha Cornish, Chemist
Sandra Sanchez, Lab Tech.

This material is intended only for the use of the individual (s) or entity to whom it is addressed, and may contain information that is privileged and confidential.

If you have received this material in error, please notify us immediately at 432-563-1800.

Environmental Lab of Texas

The results in this report apply to the samples analyzed in accordance with the samples received in the laboratory. This analytical report must be reproduced in its entirety, with written approval of Environmental Lab of Texas.

Page 4 of 4

Environmental Lab of Texas

Variance / Corrective Action Report – Sample Log-In

Client: Highlander

Date/Time: 2/23/06 3:40

Order #: 6B23027 / resubmit # 6C09012

Initials: CK

COPY

Sample Receipt Checklist

Temperature of container/cooler?	Yes	No	3.0	C
Shipping container/cooler in good condition?	<input checked="" type="checkbox"/> Yes	No		
Custody Seals intact on shipping container/cooler?	Yes	No	Not present	
Custody Seals intact on sample bottles?	Yes	No	Not present	
Chain of custody present?	<input checked="" type="checkbox"/> Yes	No		
Sample Instructions complete on Chain of Custody?	<input checked="" type="checkbox"/> Yes	No		
Chain of Custody signed when relinquished and received?	<input checked="" type="checkbox"/> Yes	No		
Chain of custody agrees with sample label(s)	Yes	No	ED on 1105	
Container labels legible and intact?	Yes	No	N/A	
Sample Matrix and properties same as on chain of custody?	<input checked="" type="checkbox"/> Yes	No		
Samples in proper container/bottle?	<input checked="" type="checkbox"/> Yes	No		
Samples properly preserved?	<input checked="" type="checkbox"/> Yes	No		
Sample bottles intact?	<input checked="" type="checkbox"/> Yes	No		
Preservations documented on Chain of Custody?	<input checked="" type="checkbox"/> Yes	No		
Containers documented on Chain of Custody?	<input checked="" type="checkbox"/> Yes	No		
Sufficient sample amount for indicated test?	<input checked="" type="checkbox"/> Yes	No		
All samples received within sufficient hold time?	<input checked="" type="checkbox"/> Yes	No		
VOC samples have zero headspace?	<input checked="" type="checkbox"/> Yes	No	Not Applicable	

Other observations:

Variance Documentation:

Contact Person: - _____ Date/Time: _____ Contacted by: _____

Regarding: _____

Corrective Action Taken:

Jeanne McMurrey

From: "Ike T" <itavarez@hec-enviro.com>
To: "Jeanne - Enviro Lab" <jeanne@elabtxas.com>
Sent: Thursday, March 09, 2006 1:45 PM
Subject: FW: Pogo Producing - Additional Analysis for the Cotton Draw Project

Pogo Producing Company – Cotton Draw Tank Battery #2, Lea County, New Mexico
Lab Order # 6B23027
Project #2589

Jeanne, please run additional analysis on the sample below. Call me if you have any questions, thanks.

AH-13 (2-2.5') - Chloride

-----Original Message-----

From: Jeanne McMurrey [mailto:jeanne@elabtxas.com]
Sent: Friday, March 03, 2006 2:30 PM
To: Ike T
Subject: Re: Pogo Producing - Additional Analysis for the Cotton Draw Project

Thanks Ike. I will add your analysis request.
~Jeanne

Jeanne McMurrey
Environmental Lab of Texas I, Ltd.
12600 West I-20 East
Odessa, Texas 79765
432-563-1800

----- Original Message -----

From: Ike T
To: Jeanne - Enviro Lab
Sent: Friday, March 03, 2006 1:18 PM
Subject: Pogo Producing - Additional Analysis for the Cotton Draw Project

Pogo Producing Company – Cotton Draw Tank Battery #2, Lea County, New Mexico
Lab Order # 6B23027
Project #2589

Jeanne, please additional analysis on samples below. Call me if you have any questions, thanks.

AH-2 (2-2.5) – TPH, BTEX
AH-2 (3-3.5) - TPH, BTEX
AH-2 (5-5.5) – TPH, BTEX

AH-3 (1-1.5') – TPH, BTEX

AH-4 (1-1.5) - TPH, BTEX

AH-5 (1-1.5) – TPH, BTEX

AH-6 (1-1.5) – TPH, BTEX

AH-9 (1-1.5) – TPH, BTEX

AH-15 (1-1.5) – TPH, BTEX
(2-2.5) – TPH, BTEX
(3-3.5) – TPH, BTEX

--

This message has been scanned for viruses and dangerous content by BasinBroadband, and is believed to be clean.

--

This message has been scanned for viruses and dangerous content by BasinBroadband, and is believed to be clean.

--

This message has been scanned for viruses and dangerous content by BasinBroadband, and is believed to be clean.

Analytical Report

3/17/2006

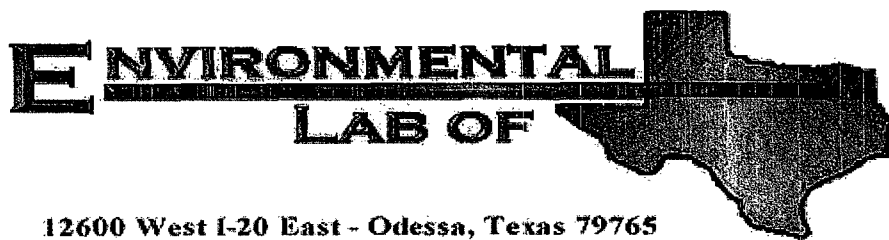

12600 West I-20 East - Odessa, Texas 79765

Analytical Report

Prepared for:

Ike Tavarez

Highlander Environmental Corp.

1910 N. Big Spring St.

Midland, TX 79705

Project: Pogo/ Cotton Draw TB #2

Project Number: 2589

Location: Lea County, NM

Lab Order Number: 6C13019

Report Date: 03/17/06

Highlander Environmental Corp.
1910 N. Big Spring St.
Midland TX, 79705

Project: Pogo/ Cotton Draw TB #2
Project Number: 2589
Project Manager: Ike Tavaréz

Fax: (432) 682-3946
Reported:
03/17/06 10:28

ANALYTICAL REPORT FOR SAMPLES

Sample ID	Laboratory ID	Matrix	Date Sampled	Date Received
AH-4 (0-1.0') BEB	6C13019-01	Soil	03/09/06 00:00	03/13/06 16:00
AH-5 (0-1.0') BEB	6C13019-02	Soil	03/09/06 00:00	03/13/06 16:00

Highlander Environmental Corp.
1910 N. Big Spring St.
Midland TX, 79705

Project: Pogo/ Cotton Draw TB #2
Project Number: 2589
Project Manager: Ike Tavaréz

Fax: (432) 682-3946

Reported:
03/17/06 10:28

Organics by GC
Environmental Lab of Texas

Analyte	Result	Reporting Limit	Units	Dilution	Batch	Prepared	Analyzed	Method	Notes
AH-4 (0-1.0') BEB (6C13019-01) Soil									
Carbon Ranges C6-C12	ND	10.0	mg/kg dry	1	EC61406	03/14/06	03/15/06	EPA 8015M	
Carbon Ranges C12-C28	ND	10.0	"	"	"	"	"	"	
Carbon Ranges C28-C35	ND	10.0	"	"	"	"	"	"	
Total Hydrocarbon C6-C35	ND	10.0	"	"	"	"	"	"	
Surrogate: 1-Chlorooctane		105 %	70-130		"	"	"	"	
Surrogate: 1-Chlorooctadecane		103 %	70-130		"	"	"	"	
AH-5 (0-1.0') BEB (6C13019-02) Soil									
Carbon Ranges C6-C12	ND	10.0	mg/kg dry	1	EC61406	03/14/06	03/15/06	EPA 8015M	
Carbon Ranges C12-C28	ND	10.0	"	"	"	"	"	"	
Carbon Ranges C28-C35	ND	10.0	"	"	"	"	"	"	
Total Hydrocarbon C6-C35	ND	10.0	"	"	"	"	"	"	
Surrogate: 1-Chlorooctane		111 %	70-130		"	"	"	"	
Surrogate: 1-Chlorooctadecane		110 %	70-130		"	"	"	"	

Environmental Lab of Texas

The results in this report apply to the samples analyzed in accordance with the samples received in the laboratory. This analytical report must be reproduced in its entirety, with written approval of Environmental Lab of Texas.

Page 2 of 7

Highlander Environmental Corp.
1910 N. Big Spring St.
Midland TX, 79705

Project: Pogo/ Cotton Draw TB #2
Project Number: 2589
Project Manager: Ike Tavarez

Fax: (432) 682-3946
Reported:
03/17/06 10:28

General Chemistry Parameters by EPA / Standard Methods
Environmental Lab of Texas

Analyte	Result	Reporting Limit	Units	Dilution	Batch	Prepared	Analyzed	Method	Notes
AH-4 (0-1.0') BEB (6C13019-01) Soil									
% Moisture	5.4	0.1	%	1	EC61506	03/14/06	03/15/06	% calculation	
AH-5 (0-1.0') BEB (6C13019-02) Soil									
% Moisture	3.3	0.1	%	1	EC61506	03/14/06	03/15/06	% calculation	

Environmental Lab of Texas

The results in this report apply to the samples analyzed in accordance with the samples received in the laboratory. This analytical report must be reproduced in its entirety, with written approval of Environmental Lab of Texas.

Page 3 of 7

Highlander Environmental Corp.
1910 N. Big Spring St.
Midland TX, 79705

Project: Pogo/ Cotton Draw TB #2
Project Number: 2589
Project Manager: Ike Tavaréz

Fax: (432) 682-3946

Reported:
03/17/06 10:28

Organics by GC - Quality Control
Environmental Lab of Texas

Analyte	Result	Reporting Limit	Units	Spike Level	Source Result	%REC	%REC Limits	RPD	RPD Limit	Notes
---------	--------	--------------------	-------	----------------	------------------	------	----------------	-----	--------------	-------

Batch EC61406 - Solvent Extraction (GC)

Blank (EC61406-BLK1)

Prepared & Analyzed: 03/14/06

Carbon Ranges C6-C12	ND	10.0	mg/kg wet							
Carbon Ranges C12-C28	ND	10.0	"							
Carbon Ranges C28-C35	ND	10.0	"							
Total Hydrocarbon C6-C35	ND	10.0	"							
Surrogate: 1-Chlorooctane	50.2		mg/kg	50.0		100	70-130			
Surrogate: 1-Chlorooctadecane	42.2		"	50.0		84.4	70-130			

LCS (EC61406-BS1)

Prepared & Analyzed: 03/14/06

Carbon Ranges C6-C12	494	10.0	mg/kg wet	500		98.8	75-125			
Carbon Ranges C12-C28	434	10.0	"	500		86.8	75-125			
Total Hydrocarbon C6-C35	928	10.0	"	1000		92.8	75-125			
Surrogate: 1-Chlorooctane	53.4		mg/kg	50.0		107	70-130			
Surrogate: 1-Chlorooctadecane	44.3		"	50.0		88.6	70-130			

Calibration Check (EC61406-CCV1)

Prepared: 03/14/06 Analyzed: 03/15/06

Carbon Ranges C6-C12	231		mg/kg	250		92.4	80-120			
Carbon Ranges C12-C28	258		"	250		103	80-120			
Total Hydrocarbon C6-C35	489		"	500		97.8	80-120			
Surrogate: 1-Chlorooctane	50.5		"	50.0		101	70-130			
Surrogate: 1-Chlorooctadecane	52.8		"	50.0		106	70-130			

Matrix Spike (EC61406-MS1)

Source: 6C13017-17

Prepared & Analyzed: 03/14/06

Carbon Ranges C6-C12	569	10.0	mg/kg dry	534	ND	107	75-125			
Carbon Ranges C12-C28	511	10.0	"	534	8.14	94.2	75-125			
Total Hydrocarbon C6-C35	1080	10.0	"	1070	ND	101	75-125			
Surrogate: 1-Chlorooctane	59.1		mg/kg	50.0		118	70-130			
Surrogate: 1-Chlorooctadecane	50.0		"	50.0		100	70-130			

Environmental Lab of Texas

The results in this report apply to the samples analyzed in accordance with the samples received in the laboratory. This analytical report must be reproduced in its entirety, with written approval of Environmental Lab of Texas.

Page 4 of 7

Highlander Environmental Corp.
1910 N. Big Spring St.
Midland TX, 79705

Project: Pogo/ Cotton Draw TB #2
Project Number: 2589
Project Manager: Ike Tavaréz

Fax: (432) 682-3946

Reported:
03/17/06 10:28

Organics by GC - Quality Control

Environmental Lab of Texas

Analyte	Result	Reporting Limit	Units	Spike Level	Source Result	%REC	%REC Limits	RPD	RPD Limit	Notes
---------	--------	--------------------	-------	----------------	------------------	------	----------------	-----	--------------	-------

Batch EC61406 - Solvent Extraction (GC)

Matrix Spike Dup (EC61406-MSD1)

Source: 6C13017-17

Prepared & Analyzed: 03/14/06

Carbon Ranges C6-C12	565	10.0	mg/kg dry	534	ND	106	75-125	0.705	20	
Carbon Ranges C12-C28	506	10.0	"	534	8.14	93.2	75-125	0.983	20	
Total Hydrocarbon C6-C35	1070	10.0	"	1070	ND	100	75-125	0.930	20	
Surrogate: 1-Chlorooctane	58.6		mg/kg	50.0		117	70-130			
Surrogate: 1-Chlorooctadecane	49.7		"	50.0		99.4	70-130			

Environmental Lab of Texas

The results in this report apply to the samples analyzed in accordance with the samples received in the laboratory. This analytical report must be reproduced in its entirety, with written approval of Environmental Lab of Texas.

Page 5 of 7

Highlander Environmental Corp.
1910 N. Big Spring St.
Midland TX, 79705

Project: Pogo/ Cotton Draw TB #2
Project Number: 2589
Project Manager: Ike Tavarez

Fax: (432) 682-3946
Reported:
03/17/06 10:28

General Chemistry Parameters by EPA / Standard Methods - Quality Control
Environmental Lab of Texas

Analyte	Result	Reporting Limit	Units	Spike Level	Source Result	%REC Limits	RPD	RPD Limit	Notes
Batch EC61506 - General Preparation (Prep)									
Blank (EC61506-BLK1)		Prepared: 03/14/06 Analyzed: 03/15/06							
% Solids	100		%						
Duplicate (EC61506-DUP1)		Source: 6C13017-01		Prepared: 03/14/06 Analyzed: 03/15/06					
% Solids	93.5		%		93.6		0.107	20	
Duplicate (EC61506-DUP2)		Source: 6C13016-02		Prepared: 03/14/06 Analyzed: 03/15/06					
% Solids	95.9		%		97.2		1.35	20	
Duplicate (EC61506-DUP3)		Source: 6C13016-22		Prepared: 03/14/06 Analyzed: 03/15/06					
% Solids	83.1		%		83.6		0.600	20	
Duplicate (EC61506-DUP4)		Source: 6C13016-42		Prepared: 03/14/06 Analyzed: 03/15/06					
% Solids	95.4		%		95.7		0.314	20	
Duplicate (EC61506-DUP5)		Source: 6C13016-62		Prepared: 03/14/06 Analyzed: 03/15/06					
% Solids	81.3		%		80.2		1.36	20	
Duplicate (EC61506-DUP6)		Source: 6C13016-82		Prepared: 03/14/06 Analyzed: 03/15/06					
% Solids	85.6		%		86.7		1.28	20	
Duplicate (EC61506-DUP7)		Source: 6C14004-03		Prepared: 03/14/06 Analyzed: 03/15/06					
% Solids	98.8		%		99.0		0.202	20	

Environmental Lab of Texas

The results in this report apply to the samples analyzed in accordance with the samples received in the laboratory. This analytical report must be reproduced in its entirety, with written approval of Environmental Lab of Texas.

Page 6 of 7

Highlander Environmental Corp.
1910 N. Big Spring St.
Midland TX, 79705

Project: Pogo/ Cotton Draw TB #2
Project Number: 2589
Project Manager: Ike Tavaraz

Fax: (432) 682-3946
Reported:
03/17/06 10:28

Notes and Definitions

DET Analyte DETECTED
ND Analyte NOT DETECTED at or above the reporting limit
NR Not Reported
dry Sample results reported on a dry weight basis
RPD Relative Percent Difference
LCS Laboratory Control Spike
MS Matrix Spike
Dup Duplicate

Report Approved By:



Date: 3/17/2006

Raland K. Tuttle, Lab Manager
Celey D. Keene, Lab Director, Org. Tech Director
Peggy Allen, QA Officer

Jeanne Mc Murrey, Inorg. Tech Director
LaTasha Cornish, Chemist
Sandra Sanchez, Lab Tech.

This material is intended only for the use of the individual (s) or entity to whom it is addressed, and may contain information that is privileged and confidential.

If you have received this material in error, please notify us immediately at 432-563-1800.

Environmental Lab of Texas

The results in this report apply to the samples analyzed in accordance with the samples received in the laboratory. This analytical report must be reproduced in its entirety, with written approval of Environmental Lab of Texas.

Page 7 of 7

PAGE: / OF:

HIGHLANDER ENVIRONMENTAL CORP.

1910 N. Big Spring St.
Midland, Texas 79705

(432) 682-4559

Fax (432) 682-3946

CLIENT NAME: Donna

STTG MANAGER:

Ike Tavaraz

PROJECT NO.: 7-201

PROJECT NAME: 0000 Cotton draw TB #2

Leg County, NM

LAB I.D. NUMBER	DATE	TIME	MATRIX	COMP.	GRAB
13019					

S	X AH-4 (0-1.0') BEB
---	---------------------

S	X	AM-5	(0-1.0')	BEB
---	---	------	----------	-----

REDAKCIJA: (Signature)

Date: 5/17/06
Time: 4:50

RECEIVED BY: (Signature)

Date: _____
Time: _____

14
DECLASSIFIED BY: (Signature)

Date: _____
Time: _____

RECEIVED BY: (Signature)

Date: _____
Time: _____

(Signature) : J.R. DEMSIOBATSE

Date: _____
Time: _____

RECEIVED BY: XE DEATHS (BOMBARDIER)

Date: _____
Time: _____

RECEIVING LABORATORY: _____

RECEIVED BY: Signature

CONTACT: 633-2770

 ZIP: _____

DATE: 3/3/00

4:20

SAMPLE CONDITION WHEN RECEIVED

MATRIX:

Run	Sample	SD-5	0-01
1	A-Air	0.00	0.00
2	B-Sludge	0.00	0.00
3	C-Sludge	0.00	0.00
4	D-Sludge	0.00	0.00
5	E-Sludge	0.00	0.00
6	F-Sludge	0.00	0.00
7	G-Sludge	0.00	0.00
8	H-Sludge	0.00	0.00
9	I-Sludge	0.00	0.00
10	J-Sludge	0.00	0.00
11	K-Sludge	0.00	0.00
12	L-Sludge	0.00	0.00
13	M-Sludge	0.00	0.00
14	N-Sludge	0.00	0.00
15	O-Sludge	0.00	0.00
16	P-Sludge	0.00	0.00
17	Q-Sludge	0.00	0.00
18	R-Sludge	0.00	0.00
19	S-Sludge	0.00	0.00
20	T-Sludge	0.00	0.00
21	U-Sludge	0.00	0.00
22	V-Sludge	0.00	0.00
23	W-Sludge	0.00	0.00
24	X-Sludge	0.00	0.00
25	Y-Sludge	0.00	0.00
26	Z-Sludge	0.00	0.00

REMARKS: 109-102

Please fill out all copies - Laboratory retains yellow copy - Return original copy to Highlander Environmental Corp. - Project Manager retains pink copy - Accounting receives Gold copy.

Environmental Lab of Texas Variance / Corrective Action Report – Sample Log-In

Client: Highlander
 Date/Time: 3/13/04 4:00
 Order #: 6513019
 Initials: CK

Sample Receipt Checklist

Temperature of container/cooler?	Yes	No	4.0 C
Shipping container/cooler in good condition?	<input checked="" type="checkbox"/>	No	
Custody Seals intact on shipping container/cooler?	Yes	No	Not present
Custody Seals intact on sample bottles?	Yes	No	Not present
Chain of custody present?	<input checked="" type="checkbox"/>	No	
Sample Instructions complete on Chain of Custody?	<input checked="" type="checkbox"/>	No	
Chain of Custody signed when relinquished and received?	<input checked="" type="checkbox"/>	No	
Chain of custody agrees with sample label(s)	<input checked="" type="checkbox"/>	No	
Container labels legible and intact?	<input checked="" type="checkbox"/>	No	
Sample Matrix and properties same as on chain of custody?	<input checked="" type="checkbox"/>	No	
Samples in proper container/bottle?	<input checked="" type="checkbox"/>	No	
Samples properly preserved?	<input checked="" type="checkbox"/>	No	
Sample bottles intact?	<input checked="" type="checkbox"/>	No	
Preservations documented on Chain of Custody?	<input checked="" type="checkbox"/>	No	
Containers documented on Chain of Custody?	<input checked="" type="checkbox"/>	No	
Sufficient sample amount for indicated test?	<input checked="" type="checkbox"/>	No	
All samples received within sufficient hold time?	<input checked="" type="checkbox"/>	No	
VOC samples have zero headspace?	<input checked="" type="checkbox"/>	No	Not Applicable

Other observations:

Variance Documentation:

Contact Person: _____ Date/Time: _____ Contacted by: _____
 Regarding: _____

Corrective Action Taken:

APPENDIX C

State of New Mexico Oil Conservation Division

C-141 Forms

District I - (505) 393-6161
 P. O. Box 1980
 Hobbs, NM 88241-1980
 District II - (505) 748-1283
 811 South First
 Artesia, NM 88210
 District III - (505) 334-6178
 1000 Rio Brazos Road
 Aztec, NM 87410
 District IV - (505) 827-7131

Pat Ellis
State of New Mexico
Energy Minerals and Natural Resources Department
Oil Conservation Division
 2040 South Pacheco Street
 Santa Fe, New Mexico 87505
 (505) 827-7131

Form C-141
 Originated 2/13/97

Submit 2 copies to
 Appropriate District
 Office in accordance
 with Rule 116 on
 back side of form

Release Notification and Corrective Action

OPERATOR

☐ Initial Report ☐ Final Report

Name <i>Pogo Producing Company</i>	Contact <i>Pat Ellis</i>
Address <i>P.O. Box 10340 Midland TX 79702</i>	Telephone No. <i>432-685-8100</i>
Facility Name <i>Cotton Draw Unit Tank Battery #2</i>	Facility Type <i>TANK BATTERY #2</i>
Surface Owner <i>BLM</i>	Mineral Owner <i>BLM</i>
Lease No. <i>91-005247</i>	

LOCATION OF RELEASE

Unit Letter	Section	Township	Range	Feet from the	North/South Line	Feet from the	East/West Line	County
	<i>15</i>	<i>25S</i>	<i>32E</i>					<i>LEA</i>

NE 1/4 of SW 1/4

NATURE OF RELEASE

Type of Release <i>Water & Oil</i>	Volume of Release <i>35 Water 5 oil</i>	Volume Recovered <i>18 Water 1/2 oil</i>
Source of Release <i>TANK</i>	Date and Hour of Occurrence <i>2/18/06 2:00 PM</i>	Date and Hour of Discovery <i>2/18/06 2:00 PM</i>
Was Immediate Notice Given? <input checked="" type="checkbox"/> Yes <input type="checkbox"/> No <input type="checkbox"/> Not Required	If YES, To Whom? <i>ON CALL PERSON</i>	
By Whom? <i>CLAY OSBORN</i>	Date and Hour <i>2/18/06 2:40 PM</i>	
Was a Watercourse Reached? <input type="checkbox"/> Yes <input checked="" type="checkbox"/> No	If YES, Volume Impacting the Watercourse	

If a Watercourse was Impacted, Describe Fully (Attach Additional Sheets If Necessary)

Describe Cause of Problem and Remedial Action Taken (Attach Additional Sheets If Necessary)

VAIVE Plug & set up. RAN TANK OVER. Pump & Valve Replaced.
Called BLM-Kathy Houston @ 2:40 PM.

Describe Area Affected and Cleanup Action Taken (Attach Additional Sheets If Necessary)

ONE TRUCK PICK UP FREE FLUID. CLEAN UP IS ON GOING.

I hereby certify that the information given above is true and complete to the best of my knowledge and understand that pursuant to NMOC rules and regulations all operators are required to report and/or file certain release notifications and perform corrective actions for releases which may endanger public health or the environment. The acceptance of a C-141 report by the NMOC marked as "Final Report" does not relieve the operator of liability should their operations have failed to adequately investigate and remediate contamination that pose a threat to ground water, surface water, human health or the environment. In addition, NMOC acceptance of a C-141 report does not relieve the operator of responsibility for compliance with any other federal, state, or local laws and/or regulations.

Signature <i>Clay Osborn</i>	OIL CONSERVATION DIVISION		
Printed Name <i>CLAY OSBORN</i>	Approved by District Supervisor:		
Title <i>FIELD FOREMAN</i>	Approval Date:	Expiration Date:	
Date: <i>2/18/06</i>	Phone: <i>505-671-0129</i>	Conditions of Approval:	Attached <input type="checkbox"/>

SITE INFORMATION

ASSESSMENT & CLOSURE REPORT

General Site Information:

Site:	Cotton Draw Unit Tank Battery #2
Company:	Pogo Producing Company
Section, Township and Range	Section 15, Township 25S, Range 32E
Unit Letter:	K
Lease Number:	91-005247
County:	Lea
GPS:	32-07-06.1 N / 103-41-03.2 W
Surface Owner:	BLM
Mineral Owner:	BLM
Directions:	From Jal, take Highway 128 west for 30 miles. Turn left on CR1 and travel south for 6.2 miles. Turn right and travel west for 0.6 miles. Turn left and travel south 0.3 miles to facility.

Release Data:

Date Released:	2/18/2006
Type Release:	Oil & Water
Source of Contamination:	Valve plugged up, and tank ran over
Fluid Released:	5 barrels oil / 35 barrels water
Fluids Recovered:	1/2 barrel oil / 18 barrels water

Official Communication:

Name:	Pat Ellis	Don Riggs	Ike Tavarez
Company:	Pogo Producing Company	Pogo Producing Company	Highlander Environmental Corp.
Address:	300 N. Marienfeld St.	5 Greenway Plaza, Suite 2700	1910 N. Big Spring
P.O. Box	Box 10340		
City:	Midland Texas, 79701-7340	Houston, Texas 77046	Midland, Texas
Phone number:	(432) 685-8100	(713) 297-5045	(432) 682- 4559
Email:	EllisP@pogoproducing.com	riggsd@pogoproducing.com	itavarez@hec-enviro.com

Ranking Criteria

Depth to Groundwater:	Ranking Score	Site Data
<50 ft	20	
50-99 ft	10	
>100 ft.	0	0
WellHead Protection:	Ranking Score	Site Data
Water Source <1,000 ft., Private <200 ft.	20	
Water Source >1,000 ft., Private >200 ft.	0	0
Surface Body of Water:	Ranking Score	Site Data
<200 ft.	20	
200 ft - 1,000 ft.	10	
>1,000 ft.	0	0
Total Ranking Score:	0	

Acceptable Soil RRAL (mg/kg)

Benzene	Total BTEX	TPH
10	50	5,000

District I
1625 N. French Dr., Hobbs, NM 88240
District II
1301 W. Grand Avenue, Artesia, NM 88210
District III
1000 Rio Brazos Road, Aztec, NM 87410
District IV
1220 S. St. Francis Dr., Santa Fe, NM 87505

State of New Mexico
Energy Minerals and Natural Resources
Oil Conservation Division
1220 South St. Francis Dr.
Santa Fe, NM 87505

Form C-141
Revised June 10, 2003

Submit 2 Copies to appropriate
District Office in accordance
with Rule 116 on back
side of form

Release Notification and Corrective Action

OPERATOR

☐ Initial Report ☒ Final Report

Name of Company: Pogo Producing Company	Contact: Pat Ellis	
Address: 300 North Marienfeld, Suite 600, Midland TX 79701	Telephone No. (432) 685-8100	
Facility Name: Cotton Draw Unit Tank Battery #2	Facility Type: Tank Battery	
Surface Owner BLM	Mineral Owner BLM	Lease No. 91-005247

LOCATION OF RELEASE

Unit Letter K	Section 15	Township 25S	Range 32E	Feet from the	North Line	Feet from the	East Line	County Lea
------------------	---------------	-----------------	--------------	---------------	------------	---------------	-----------	---------------

300'

NATURE OF RELEASE

Type of Release Oil and produced water	Volume of Release 5 bbl oil, 35 bbl water	Volume Recovered 1/2 BO, 18 BW
Source of Release: Valve plugged up and tank ran over.	Date and Hour of Occurrence 2:00 pm, 2/18/06	Date and Hour of Discovery 2:00 pm, 2/18/06
Was Immediate Notice Given? <input checked="" type="checkbox"/> Yes <input type="checkbox"/> No <input type="checkbox"/> Not Required	If YES, To Whom? On call pager	
By Whom? Clay Osborn	Date and Hour 2:40 pm, 2/18/06	
Was a Watercourse Reached? <input type="checkbox"/> Yes <input checked="" type="checkbox"/> No	If YES, Volume Impacting the Watercourse. N/A	
If a Watercourse was Impacted, Describe Fully.* N/A		
Describe Cause of Problem and Remedial Action Taken.* A valve plugged up causing a tank to overflow. A vacuum truck was called in to pick up fluids. The valve and pump were replaced.		
Describe Area Affected and Cleanup Action Taken.* A vacuum truck picked up the fluids, and the valve and pump were replaced. The site was assessed by Highlander Environmental Corp. Impacted soils were removed by hand digging and with a backhoe. Excavated soils were hauled to Sundance Services for disposal. Grab-type confirmation samples were collected.		
I hereby certify that the information given above is true and complete to the best of my knowledge and understand that pursuant to NMOCD rules and regulations all operators are required to report and/or file certain release notifications and perform corrective actions for releases which may endanger public health or the environment. The acceptance of a C-141 report by the NMOCD marked as "Final Report" does not relieve the operator of liability should their operations have failed to adequately investigate and remediate contamination that pose a threat to ground water, surface water, human health or the environment. In addition, NMOCD acceptance of a C-141 report does not relieve the operator of responsibility for compliance with any other federal, state, or local laws and/or regulations.		

OIL CONSERVATION DIVISION

Signature: <i>Pat Ellis</i>	Approved by District Supervisor:	
Printed Name: Pat Ellis	Approval Date:	Expiration Date:
Title: Division Environmental Safety & Health Supervisor	Conditions of Approval:	
E-mail Address: EllisP@pogoproducing.com	Attached <input type="checkbox"/>	
Date: 6-15-06 Phone: (432) 685-8100		

* Attach Additional Sheets If Necessary

facility - FPAC062834694
incident - nPAC062834780
application - pPAC062837018

1RP-1000