

BLACKWOOD & NICHOLS COMPANY
Box 1237
DURANGO, COLORADO

MAIN OFFICE CO
1956 APR 12 AM 8:21

April 10, 1956

NSL-28

Encl 4/12/56

Well No. 31-6

Mr. W. B. Macey
Secretary-Director
Oil Conservation Commission
P. O. Box 871
Santa Fe, New Mexico

Dear Mr. Macey:

As Operator of the Northeast Blanco Unit, we request permission to drill an unorthodox well, to be located 420' from the North line and 1900' from the East line of Section 6-30N-7W, San Juan County, New Mexico.

The proposed Navajo Dam Project prevents a normal well location for this well and it is, therefore, necessary to select a more suitable location for a drilling site.

Section 6-30N-7W is a part of the Northeast Blanco Unit and the new location, as requested, will present no drainage problem to offset operators.

We enclose a location plat for the requested new location.

Very truly yours,

BLACKWOOD & NICHOLS COMPANY

De Lasso Loos
DeLasso Loos
Field Superintendent

DL:fw

Encl

NEW MEXICO
OIL CONSERVATION COMMISSION

Form C-128

Well Location and/or Gas Proration Plat

Date _____

Operator Blackwood and Nichols Company Lease _____

Well No. _____ Section 6 Township 30 North Range 7 West NMPM

Located 420 Feet From North Line, 1900 Feet From East Line,

San Juan County, New Mexico. G. L. Elevation 6265

Name of Producing Formation _____ Pool _____ Dedicated Acreage _____

(Note: All distances must be from outer boundaries of Section)

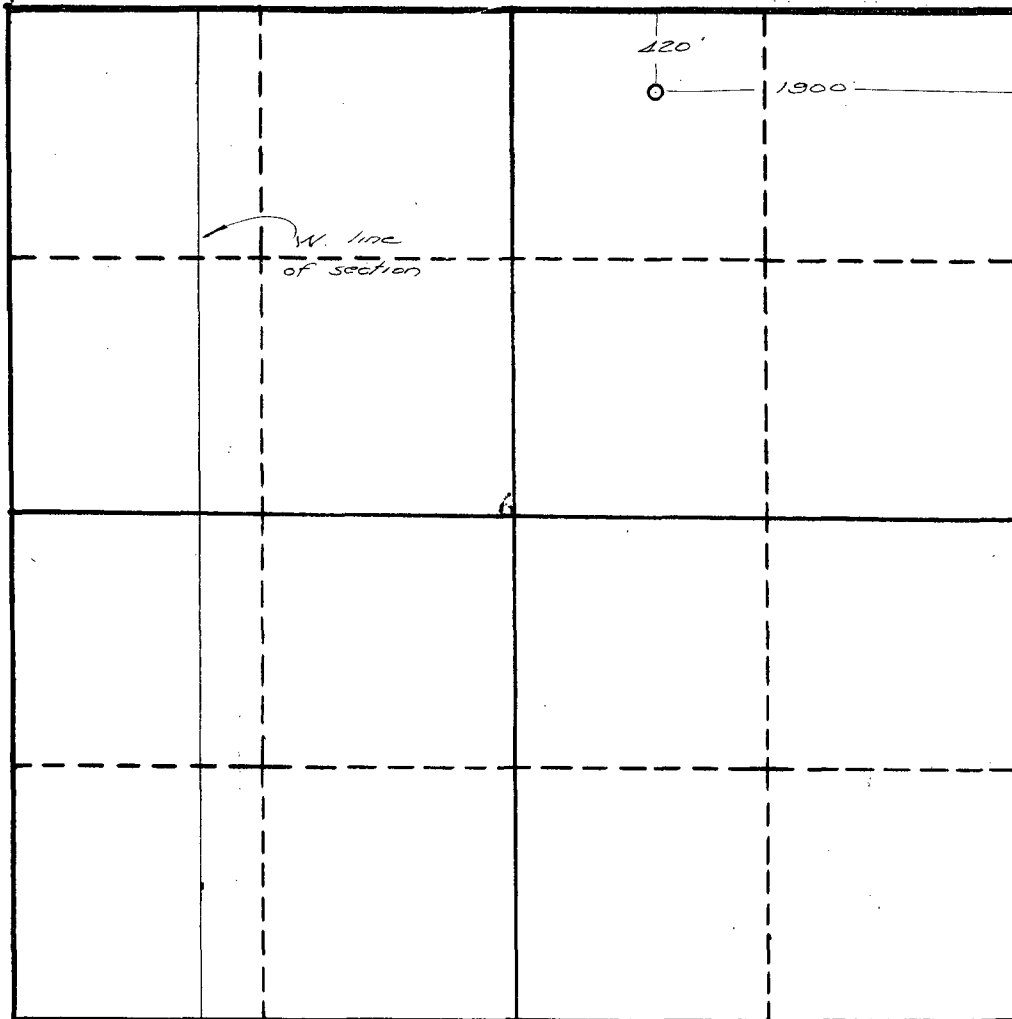

NOTE

This section of
form is to be
used for gas
wells only.



SCALE: 1"=1000'

1. Is this Well a Dual Comp. ? Yes ___ No ___.
2. If the answer to Question 1 is yes, are there any other dually completed wells within the dedicated acreage ? Yes ___ No ___.

Name _____
Position _____
Representing _____
Address _____

This is to certify that the above plat was prepared from field notes of actual surveys made by me or under my supervision and that the same are true and correct to the best of my knowledge and belief.

Date Surveyed February 28, 1956
Ernest J. Gschawek
Registered Professional Engineer and/or
Land Surveyor