

EL PASO NATURAL GAS PRODUCTS COMPANY

POST OFFICE BOX 1161, EL PASO, TEXAS

February 7, 1958

Mr. A. L. Porter  
Secretary and Director  
Oil Conservation Commission  
Post Office Box 871  
Santa Fe, New Mexico

Dear Mr. Porter:

This is a request for Administrative Approval of an Unorthodox Location in the Horseshoe Canyon Gallup Pool. This location, our Horseshoe Canyon No. 7, is located 1673' from the South Line and 1628' from the West Line of Section 3, Township 30-N, Range 16-W, NMPM, San Juan County, New Mexico. The NE SW of Section 3 is dedicated to this well. This well is to be drilled through the Gallup Formation and then all possible producing zones will be perforated and sandoil fractured. This location is on a rock ledge on the steep slope of the side of a canyon. It would be extremely hard and expensive to make an Orthodox Location and your approval of this request would be greatly appreciated.

Mr. Tom Bolack owns the lease in the NW SW of Section 3 and he has been notified by Registered Letter of our intention to build this Unorthodox Location.

Attached you will find two copies each of the Intention to Drill, Well Location and Acreage Plat, and Plat showing Offset Operators.

Very truly yours,

ENW:EW  
cc: Tom Bolack

*Ewell N. Walsh*  
Ewell N. Walsh  
Division Petroleum Engineer

NSR No. 133  
on waiting  
approved

3/2/58  
waiver  
from Bolack  
attached  
up

ADDRESS REPLY TO:  
POST OFFICE BOX 1565  
ARMINGTON, NEW MEXICO

Topograph

Truck

*Federal  
self*

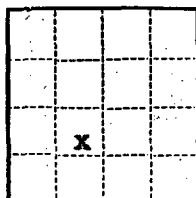

(SUBMIT IN TRIPLICATE)

UNITED STATES  
DEPARTMENT OF THE INTERIOR  
GEOLOGICAL SURVEY

Land Office **SF**  
Lease No. **081226**  
Unit **Horseshoe Canyon**

**SUNDRY NOTICES AND REPORTS ON WELLS**

NOTICE OF INTENTION TO DRILL	<input checked="" type="checkbox"/>	SUBSEQUENT REPORT OF WATER SHUT-OFF	
NOTICE OF INTENTION TO CHANGE PLANS		SUBSEQUENT REPORT OF SHOOTING OR ACIDIZING	
NOTICE OF INTENTION TO TEST WATER SHUT-OFF		SUBSEQUENT REPORT OF ALTERING CASING	
NOTICE OF INTENTION TO RE-DRILL OR REPAIR WELL		SUBSEQUENT REPORT OF RE-DRILLING OR REPAIR	
NOTICE OF INTENTION TO SHOOT OR ACIDIZE		SUBSEQUENT REPORT OF ABANDONMENT	
NOTICE OF INTENTION TO PULL OR ALTER CASING		SUPPLEMENTARY WELL HISTORY	
NOTICE OF INTENTION TO ABANDON WELL			

(INDICATE ABOVE BY CHECK MARK NATURE OF REPORT, NOTICE, OR OTHER DATA)

January 31, 1958

Well No. 7 is located 1673 ft. from N line and 1628 ft. from Ex line of sec. 3  
NE SW/4 Sec. 3 30-N 16-W NMPM  
(1/4 Sec. and Sec. No.) (Twp.) (Range) (Meridian)  
Horseshoe-Gallup San Juan New Mexico  
(Field) (County or Subdivision) (State or Territory)

The elevation of the derrick floor above sea level is 5643 ft.

**DETAILS OF WORK**

(State names of and expected depths to objective sands; show sizes, weights, and lengths of proposed casings; indicate mudding jobs, cementing points, and all other important proposed work)

It is intended to drill a well using rotary tools and mud circulation through the Gallup formation. Production casing will be set and possible productive intervals will be perforated and fractured.

Estimated Total Depth 1670'.

**Casing Program:**

8-5/8" at 100' with 125 sacks cement circulated to surface.

5-1/2" at 1670' with 100 sacks cement.

The NE SW/4 of Section 3 is dedicated to this well.

NE SW/4 Section 3 SF-081226

I understand that this plan of work must receive approval in writing by the Geological Survey before operations may be commenced.

Company El Paso Natural Gas Products Company

Address Post Office Box 1565  
Farmington, New Mexico

ORIGINAL SIGNED BY: JOSEPH E. KREGER

By \_\_\_\_\_  
 Title Petroleum Engineer

NEW MEXICO OIL CONSERVATION COMMISSION

Well Location and Acreage Dedication Plat

Section A.

Date February 3, 1958

Operator El Paso Natural Gas Products Company Lease Horseshoe Canyon SF-081226  
Well No. 7 Unit Letter K Section 3 Township 30 North Range 16 West NMPM  
Located 1673 Feet From South Line, 1628 Feet From West Line  
County San Juan G. L. Elevation 5633 Dedicated Acreage 40 Acres  
Name of Producing Formation Gallup Pool Horseshoe-Gallup

1. Is the Operator the only owner\* in the dedicated acreage outlined on the plat below?  
Yes X No       .
2. If the answer to question one is "no," have the interests of all the owners been consolidated by communitization agreement or otherwise? Yes        No       . If answer is "yes,"  
Type of Consolidation
3. If the answer to question two is "no," list all the owners and their respective interests below:

Owner

Land Description

Section. B

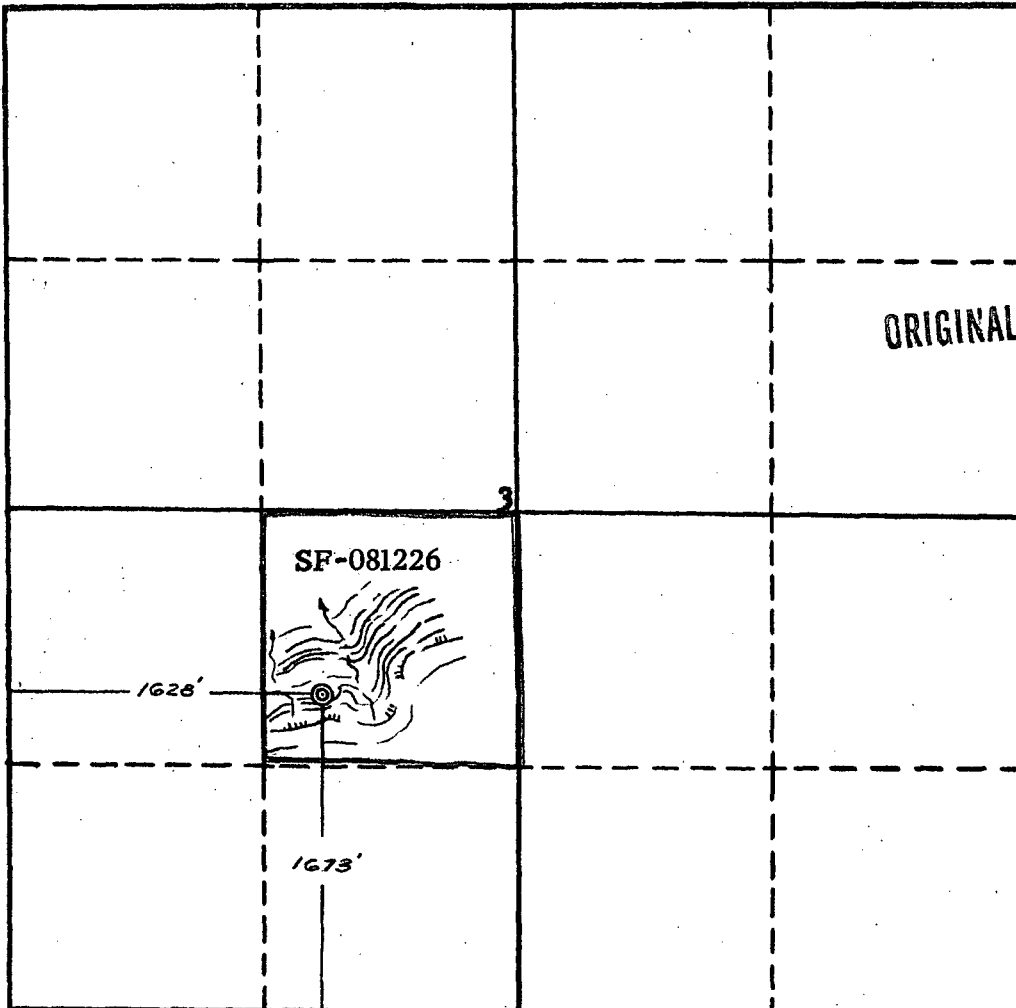

This is to certify that the information in Section A above is true and complete to the best of my knowledge and belief.

El Paso Natural Gas Products Co.

ORIGINAL SIGNED BY: JOSEPH E. KREGER

(Representative)

Box 1565, Farmington, New Mexico

Address

This is to certify that the well location shown on the plat in Section B was plotted from field notes or actual surveys made by me or under my supervision and that the same is true and correct to the best of my knowledge and belief.

Date Surveyed Jan. 28, 1958

Ernest V. Echolaw  
Ernest V. Echolaw  
Registered Land Surveyor.

Certificate No. 1545



PLAT SHOWING UNORTHODOX LOCATION OF THE  
EL PASO NATURAL GAS PRODUCTS COMPANY  
HORSESHOE CANYON WELL NO. 7  
NESW SECTION 3  
TOWNSHIP 30 NORTH, RANGE 16 WEST

R 16 W

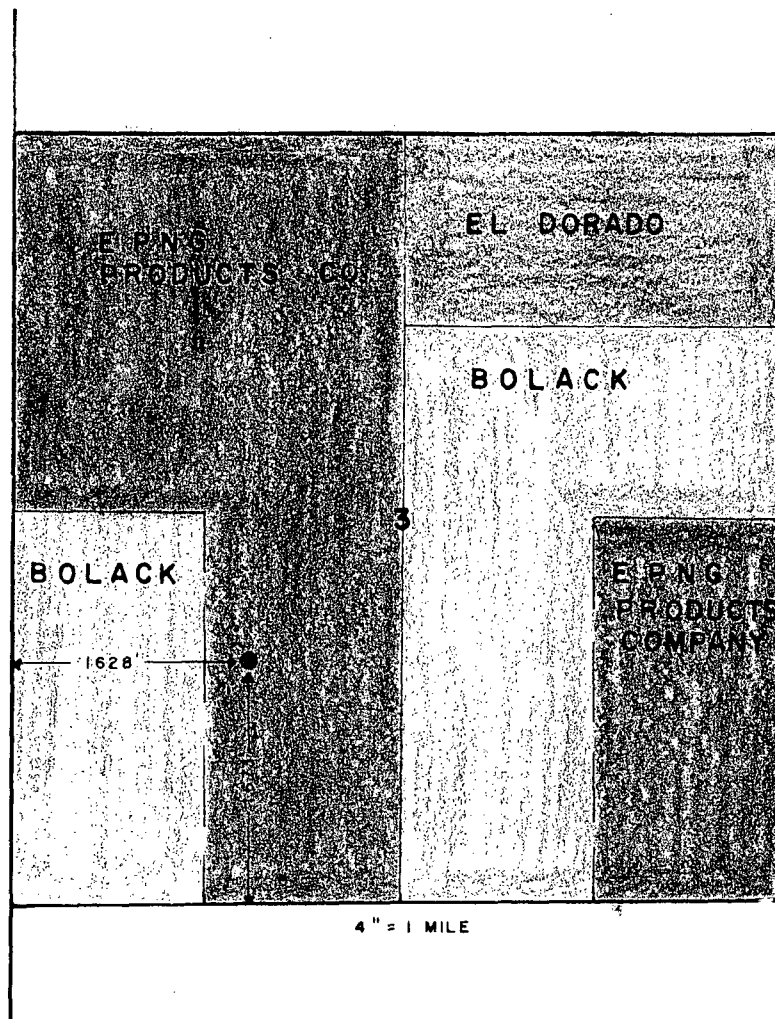

T  
30  
N