

*NS 6-365
20 days + vinf of topo
from Emery*

El Paso Natural Gas Company

El Paso, Texas

November 12, 1965

ADDRESS REPLY TO:
POST OFFICE BOX 990
FARMINGTON, NEW MEXICO

Mr. A. L. Porter, Secretary and Director
New Mexico Oil Conservation Commission
Box 2088
Santa Fe, New Mexico - 87501

Dear Sir:

This is a request for administrative approval for an unorthodox gas well location in the Aztec Pictured Cliffs Pool.

It is intended to locate the well, El Paso Natural Gas Co. Green Com No. 1, 1935' from the north line and 825' from the west line of Section 36, Township 29 North, Range 9 West, N.M.P.M., San Juan County, New Mexico. The NW/4 of Section 36 is dedicated to this well.

As shown on the plat, the NW/4 consists of Largo Wash. The only feasible land for a well in the NW/4 is that which makes the location unorthodox. It is, therefore, planned to make the location unorthodox in order that the extremely high cost of maintaining an orthodox location be avoided.

El Paso Natural Gas Co. has the verbal consent to said location from the offset operator.

I am enclosing two copies of the certified well location plat, and two copies of the notice of intention to drill.

Yours very truly,

E. S. Oberly
E. S. Oberly,
Area Petroleum Engineer

ESO:dgb

cc: Sam Smith
Emery Arnold
~~P. T. McGrath~~
File

NO. OF COPIES RECEIVED		
DISTRIBUTION		
SANTA FE		
FILE		
U.S.G.S.		
LAND OFFICE		
OPERATOR		

NEW MEXICO OIL CONSERVATION COMMISSION

Form C-101
Revised 1-1-65

5A. Indicate Type of Lease	
STATE <input checked="" type="checkbox"/>	FEE <input type="checkbox"/>
5. State Oil & Gas Lease No. B-10889-18	

APPLICATION FOR PERMIT TO DRILL, DEEPEN, OR PLUG BACK

1a. Type of Work		7. Unit Agreement Name	
b. Type of Well DRILL <input checked="" type="checkbox"/> DEEPEN <input type="checkbox"/> PLUG BACK <input type="checkbox"/> OIL WELL <input type="checkbox"/> GAS WELL <input checked="" type="checkbox"/> OTHER <input type="checkbox"/> SINGLE ZONE <input checked="" type="checkbox"/> MULTIPLE ZONE <input type="checkbox"/>		8. Farm or Lease Name Green Com	
2. Name of Operator El Paso Natural Gas Company		9. Well No. 1	
3. Address of Operator Box 990, Farmington, New Mexico		10. Field and Pool, or Wildcat Aztec Pictured Cliffs	
4. Location of Well UNIT LETTER <u>E</u> LOCATED <u>1935</u> FEET FROM THE <u>North</u> LINE AND <u>825</u> FEET FROM THE <u>West</u> LINE OF SEC. <u>36</u> TWP. <u>29N</u> RGE. <u>9W</u> NMPM		12. County San Juan	
19. Proposed Depth 2200'		19A. Formation Pictured Cliffs	
20. Rotary or C.T. Rotary		21. Elevations (Show whether DF, RT, etc.) 5661' GL	
21A. Kind & Status Plug. Bond Nationwide		21B. Drilling Contractor Carmack	
22. Approx. Date Work will start 11-13-65		23.	

PROPOSED CASING AND CEMENT PROGRAM

SIZE OF HOLE	SIZE OF CASING	WEIGHT PER FOOT	SETTING DEPTH	SACKS OF CEMENT	EST. TOP
12 1/4"	8 5/8"	20#	300'	200 Sks.	Surface
6 3/4"	2 7/8"	6.4#	2200'	400 cu. ft.	

Selective zones in the Pictured Cliffs formation will be perforated and fractured.

The NE/4 of Section 36 is dedicated to this well.

IN ABOVE SPACE DESCRIBE PROPOSED PROGRAM: IF PROPOSAL IS TO DEEPEN OR PLUG BACK, GIVE DATA ON PRESENT PRODUCTIVE ZONE AND PROPOSED NEW PRODUCTIVE ZONE. GIVE BLOWOUT PREVENTER PROGRAM, IF ANY.

I hereby certify that the information above is true and complete to the best of my knowledge and belief.

Signed ORIGINAL SIGNED E. S. OBERLY Title Petroleum Engineer Date November 12, 1965

(This space for State Use)

APPROVED BY _____ TITLE _____ DATE _____
CONDITIONS OF APPROVAL, IF ANY:

**NEW MEXICO OIL CONSERVATION COMMISSION
WELL LOCATION AND ACREAGE DEDICATION PLAT**

Form C-102
Supersedes C-128
Effective 1-1-65

All distances must be from the outer boundaries of the Section.

Operator El Paso Natural Gas Company			Lease Green Com. B-10889-18		Well No. 1
Unit Letter E	Section 36	Township 29 north	Range 9 West	County San Juan	
Actual Footage Location of Well: 1935 feet from the North line and 825 feet from the West line					
Ground Level Elev. 5661	Producing Formation Pictured Cliffs		Pool Aztec Pictured Cliffs	Dedicated Acreage: 155.4 Acres	

1. Outline the acreage dedicated to the subject well by colored pencil or hachure marks on the plat below.
2. If more than one lease is dedicated to the well, outline each and identify the ownership thereof (both as to working interest and royalty).
3. If more than one lease of different ownership is dedicated to the well, have the interests of all owners been consolidated by communitization, unitization, force-pooling, etc?

☒ Yes ☐ No If answer is "yes," type of consolidation **Communitization**

If answer is "no," list the owners and tract descriptions which have actually been consolidated. (Use reverse side of this form if necessary.) _____

No allowable will be assigned to the well until all interests have been consolidated (by communitization, unitization, forced-pooling, or otherwise) or until a non-standard unit, eliminating such interests, has been approved by the Commission.

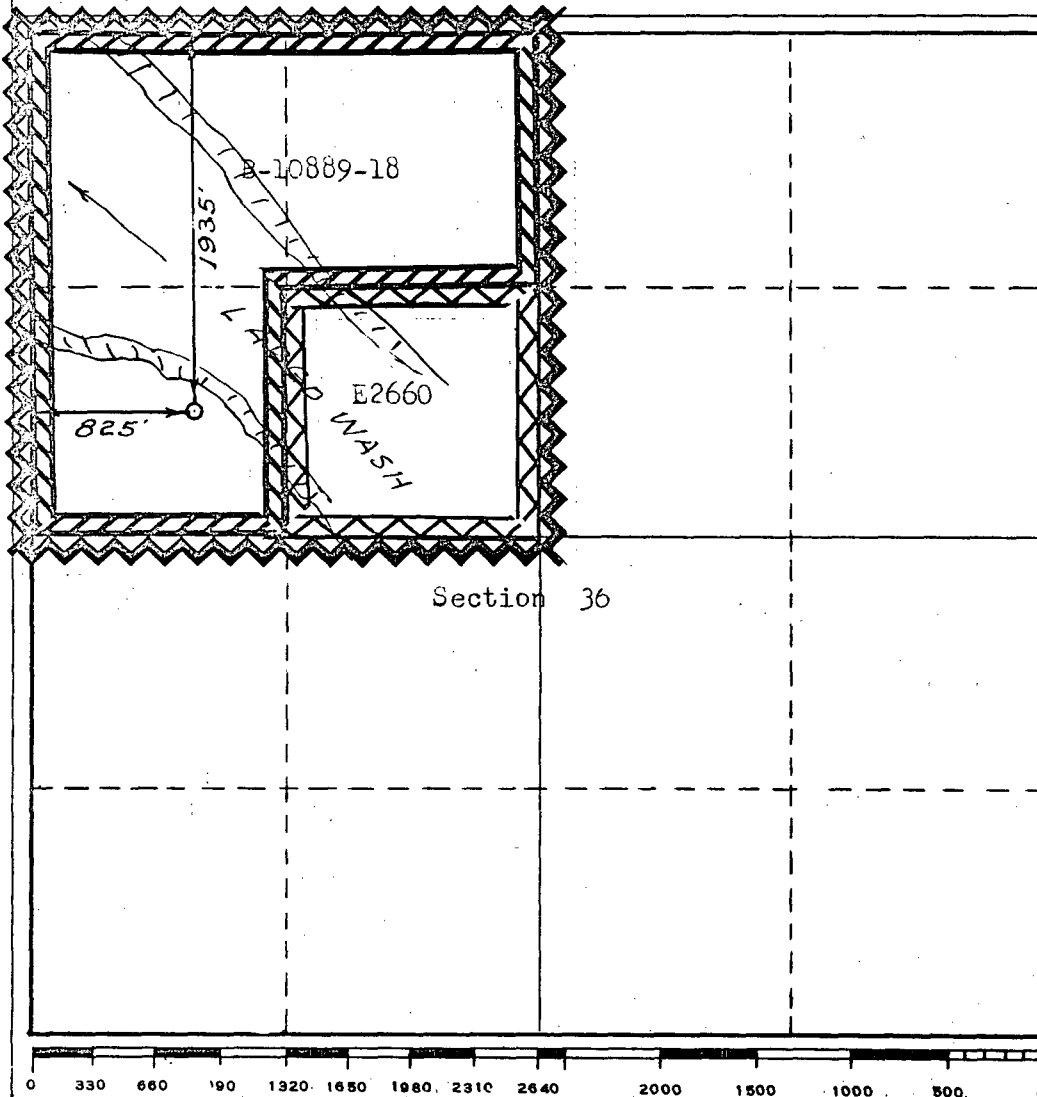

CERTIFICATION

I hereby certify that the information contained herein is true and complete to the best of my knowledge and belief.

ORIGINAL SIGNED E. S. OBERLY

Name
Petroleum Engineer

Position
El Paso Natural Gas Co.

Company
November 12, 1965

Date

I hereby certify that the well location shown on this plat was plotted from field notes of actual surveys made by me or under my supervision, and that the same is true and correct to the best of my knowledge and belief.

11-11-65
Date Surveyed

[Signature]
Registered Professional Engineer
and/or Land Surveyor

Certificate No.

OIL CONSERVATION COMMISSION
3-23 DISTRICT

DATE 11-18-65

OIL CONSERVATION COMMISSION
BOX 871
SANTA FE, NEW MEXICO

Re: Proposed NSP _____

Proposed NWU _____

Proposed NSL ✓

Proposed NFO _____

Proposed DC ✓

Gentlemen:

I have examined the application dated 11-12-65

for the EPNG CO Green Com # 1 1935/N
Operator Lease and Well No. 825/W 36-29-9
S-T-R

and my recommendations are as follows:

Cerritos - Location has been inspected

Yours very truly,

Ernest C. Smith

El Paso Natural Gas Company

El Paso, Texas

November 12, 1965

ADDRESS REPLY TO:
POST OFFICE BOX 990
FARMINGTON, NEW MEXICO

Mr. A. L. Porter, Secretary and Director
New Mexico Oil Conservation Commission
Box 2088
Santa Fe, New Mexico - 87501

Dear Sir:

This is a request for administrative approval for an unorthodox gas well location in the Aztec Pictured Cliffs Pool.

It is intended to locate the well, El Paso Natural Gas Co. Green Com No. 1, 1935' from the north line and 825' from the west line of Section 36, Township 29 North, Range 9 West, N.M.P.M., San Juan County, New Mexico. The NW/4 of Section 36 is dedicated to this well.

As shown on the plat, the NW/4 consists of Largo Wash. The only feasible land for a well in the NW/4 is that which makes the location unorthodox. It is, therefore, planned to make the location unorthodox in order that the extremely high cost of maintaining an orthodox location be avoided.

El Paso Natural Gas Co. has the verbal consent to said location from the offset operator.

I am enclosing two copies of the certified well location plat, and two copies of the notice of intention to drill.

Yours very truly,

ORIGINAL SIGNED E. S. OBERLY

E. S. Oberly,
Area Petroleum Engineer

ESO:dgb

cc: Sam Smith

Emory Arnold

~~P. T. McGrath~~

File

COPY

PAN AMERICAN PETROLEUM CORPORATION

P. O. Box 480, Farmington, New Mexico
November 11, 1965

File: E-623-986.510.1

Subject: Waiver For Unorthodox Well Location
El Paso Natural Gas Company
Operated Green No. 1
Aztec Pictured Cliffs Field
San Juan County, New Mexico

MAIN OFFICE

NOV 18 1965

*Santa Fe
Jim Durrell
NSH
[Signature]*

Mr. E. C. Arnold
New Mexico Oil Conservation Commission
1000 Rio Brazos Road
Aztec, New Mexico

Dear Sir:

This is to advise that Pan American Petroleum Corporation, as operator of the State Gas Com "V" No. 1 located in the SW/4 of Section 36, T-29-N, R-9-W, has no objection to the drilling of El Paso Natural Gas Company's Green No. 1 as an Aztec Pictured Cliffs Field well at an unorthodox location in the NW/4 of the same Section 36, with said location being 1955 feet from the North line and 825 feet from the West line, as we understand it is necessary to drill this well at an unorthodox location due to the proximity of the Largo Wash.

Yours very truly,

PAN AMERICAN PETROLEUM CORPORATION

L. O. Speer, Jr.
L. O. Speer, Jr.
Area Superintendent

FHH:en

cc: Mr. Ed Oberly
El Paso Natural Gas Company
P. O. Box 990
Farmington, New Mexico

