



TENNECO OIL COMPANY • P. O. BOX 1714 • 835 SECOND AVENUE • DURANGO, COLORADO 81302

January 3, 1966

Secretary Director
New Mexico Oil Conservation Comm.
P. O. Box 2088
Santa Fe, New Mexico

Dear Sir:

Re: Unorthodox Location
Schwerdtfeger "A" #4
1190' FSL, 660' FEL
Section 31, T-28-N, R-8-W
San Juan County, New Mexico

Application is hereby made under NMOCC Rule 3A, Well Location,
for unorthodox location in the Dakota formation on the above well
because of topography. (See attached plat.)

A copy of this letter will be forwarded to the offset operators:
El Paso Natural Gas Company, P. O. Box 990, Farmington, New Mexico;
Pan American Petroleum Corporation, P. O. Box 480, Farmington; and
Skelly Oil Company, P. O. Box 38, Hobbs, New Mexico.

Very truly yours,

TENNECO OIL COMPANY

R. E. Siverson
District Production Superintendent

HCN:nw

Attach.

CC: New Mexico Oil Conservation Comm. - Aztec
J. D. Moon - Tenneco - Midland
El Paso Natural Gas Company - Farmington
Pan American Petroleum Corp. - Farmington
Skelly Oil Company - Hobbs

NSK-369
20 days &
perf of topo
Done 1-24

NEW MEXICO OIL CONSERVATION COMMISSION
WELL LOCATION AND ACREAGE DEDICATION PLAT

Form O-112
Supersedes O-128
Effective 1-1-65

All distances must be from the outer boundaries of the Section

TENNECO OIL COMPANY			Lease SCHWERTFEDER "A"		Well No. 4
Tract Letter P	Section 31	Range 28 North	Range 8 West	County San Juan	
Actual Location of Well: 1190 feet from the South line and 660 feet from the East line					
Ground Level Elev. 6703' ungraded	Producing Formation Basin Dakota	Pool Basin Dakota	Dedicated Acreage: E/2 320 Acres		

1. Outline the acreage dedicated to the subject well by colored pencil or hatchure marks on the plat below.
2. If more than one lease is dedicated to the well, outline each and identify the ownership thereof (both as to working interest and royalty).
3. If more than one lease of different ownership is dedicated to the well, have the interests of all owners been consolidated by communitization, unitization, force-pooling, etc?

☐ Yes ☐ No If answer is "yes," type of consolidation _____

If answer is "no," list the owners and tract descriptions which have actually been consolidated. (Use reverse side of this form if necessary.) _____

No allowable will be assigned to the well until all interests have been consolidated (by communitization, unitization, forced-pooling, or otherwise) or until a non-standard unit, eliminating such interests, has been approved by the Commission.

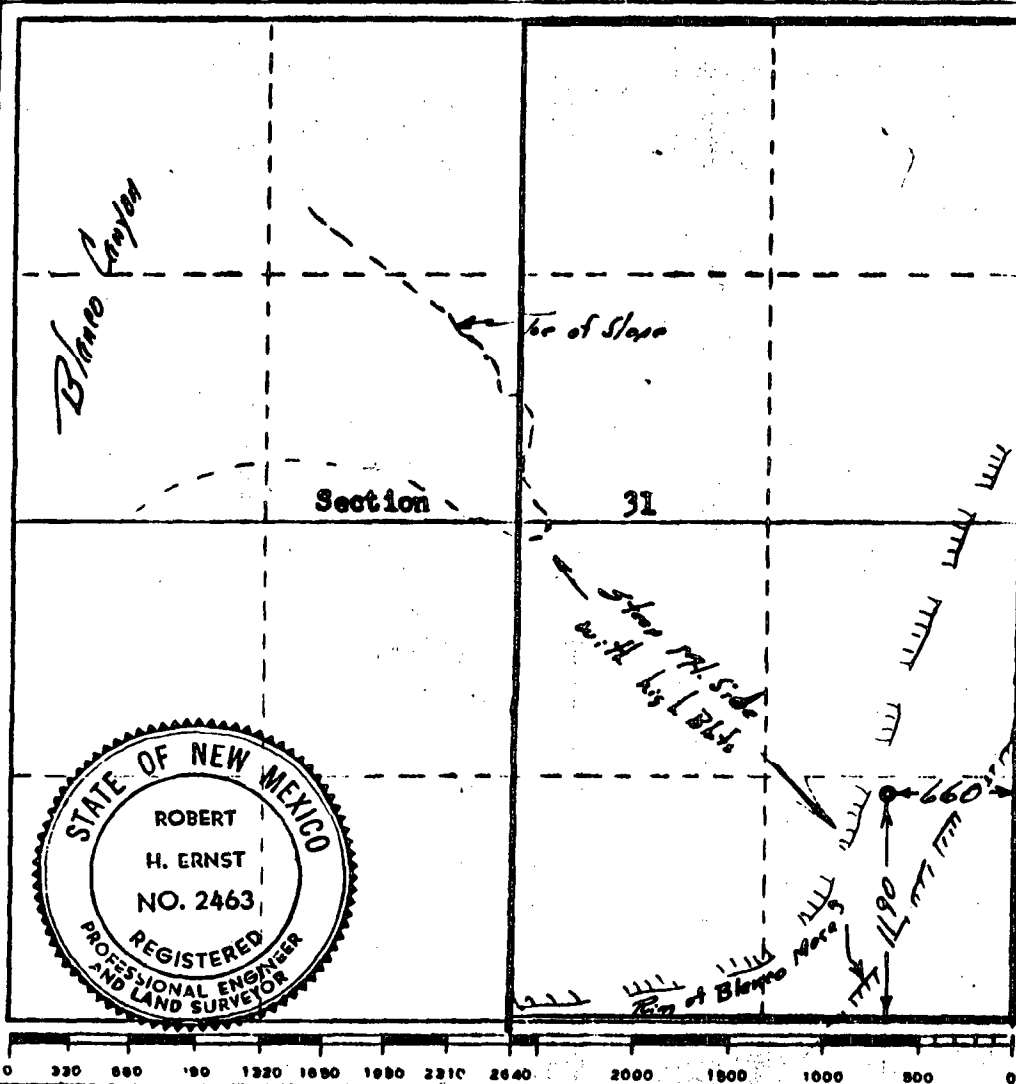

CERTIFICATION

I hereby certify that the information contained herein is true and complete to the best of my knowledge and belief.

Harold C. Nichols
Name **Harold C. Nichols**
Position **Sr. Production Clerk**
Company **Tenneco Oil Company**
Date **December 7, 1965**

I hereby certify that the well location shown on this plat was plotted from field notes of actual surveys made by me or under my supervision, and that the same is true and correct to the best of my knowledge and belief.

Date Surveyed
3 December 1965
Registered Professional Engineer and/or Land Surveyor
Robert H. Ernst
Certificate No.
R. Mex. PE & LS 2463

OIL CONSERVATION COMMISSION

3 DISTRICT

OIL CONSERVATION COMMISSION
BOX 871
SANTA FE, NEW MEXICO

DATE 1-7-68

Re: Proposed NSP _____

Proposed NWU _____

Proposed NSL ✓ _____

Proposed NFO _____

Proposed DC _____

Gentlemen:

I have examined the application dated _____

for the Teneco O. Co. Schwerdtfeger D #4 SE 31-28N-8W
Operator Lease and Well No. S-T-R

and my recommendations are as follows:

Topography Verified approve

Yours very truly,

Ernest C. [Signature]