

PETROLEUM ENGINEERING
RESERVOIR STUDIES
EVALUATIONS
GEOLOGICAL STUDIES

WALSH
ENGINEERING & PRODUCTION
CORPORATION

PETROLEUM CLUB PLAZA BUILDING
P. O. BOX 254
FARMINGTON, NEW MEXICO 87401

LEASE MANAGEMENT
CONTRACT PUMPING
DRILLING SUPERVISION
WORKOVER SUPERVISION

EWELL N. WALSH, P.E.
President

EWELL N. WALSH

May 13, 1969

MAY 14 1969

TELEPHONE 325-8203

Mr. A. L. Porter, Jr.
Secretary-Director
New Mexico Oil Conservation Commission
P. O. Box 2088
Santa Fe, New Mexico 87501

Ref: Colonial Production Company
Jicarilla #10, Unit C Sec. 15,
T23N, R4W, Rio Arriba County,
N. M., Ballard Picture Cliff
Pool.

Dear Mr. Porter:

On behalf of Colonial Production Company, I am requesting the approval of the New Mexico Oil and Gas Conservation Commission of the above-referred-to well due to the fact that it is an unorthodox location by being located 690' from the North line and 1850' from the West line of Section 15, Township 23 North, Range 4 West, Rio Arriba County, New Mexico.

The reason for the unorthodox location is due to rock ledges on the small bluff which prevent locating the well the standard 790' from the North line of Section 15 without a considerable expense in building the road and location.

Enclosed you will find the following:

- (1) Original copy of letter from John E. Schalk, the Operator of Section 10, Township 23 North, Range 4 West, who has given his approval to the unorthodox location.
- (2) Copy of Intention to Drill submitted to the USGS, Durango, Colorado.
- (3) Copy of Well Location and Acreage Dedication plat which indicates the topography in the immediate area of the well and has been submitted with the Intention to Drill to the USGS.

Mr. A. L. Porter, Jr.

-2-

May 13, 1969

Your immediate approval of this location would be appreciated due to the fact that the location should be prepared for drilling in the very near future.

If you have any questions concerning this matter, please do not hesitate to contact me.

Very truly yours,

A handwritten signature in dark ink, appearing to read "Ewell N. Walsh", is written over a horizontal line.

Ewell N. Walsh, P. E.
President

ENW:lt

Enclosures

cc:Colonial Production Co. w/encl.
NMOCC/Aztec, N.M. w/encl.
USGS/Durango, Colorado

OIL CONSERVATION COMMISSION

P. O. BOX 2088

SANTA FE, NEW MEXICO 87501

May 15, 1969

Mr. Ewell N. Walsh, President
Walsh Engineering & Production Corporation
P. O. Box 254
Farmington, New Mexico 87401

Re: Colonial Production Company
Jicarilla #10, Unit C, Sec. 15,
Township 23 North, Range 4 West,
Rio Arriba County, New Mexico,
Ballard-Pictured Cliffs Pool

Dear Mr. Walsh:

If you will furnish the Commission a written statement that all operators of leases directly and diagonally offsetting the subject quarter section have been furnished a copy of the subject application by registered mail, the Secretary-Director of the Commission can approve the application upon receipt of waivers from all such parties or upon the expiration of 20 days in the absence of objection.

Very truly yours,

GEORGE M. HATCH
Attorney

GMH/esr

C
O
P
Y

John E. Schalk
915 Midland Savings Building
444 - 17th Street
Denver, Colorado 80202

May 8, 1969

Walsh Engineering & Production Corporation
Post Office Box 254
Farmington, New Mexico 87401

Attention: Mr. Ewell N. Walsh, P.E.
President

Re: Colonial Production Company
Jicarilla #10, Unit C. Sec. 15,
Township 23 North, Range 4 West
Rio Arriba County, New Mexico

Gentlemen:

You may use this letter as authority of my approval for the location of the above captioned well to be drilled in the Ballard Picture Cliff Pool located 690 feet from the North Line and 1850' from the West Line of Section 15.

Yours very truly,

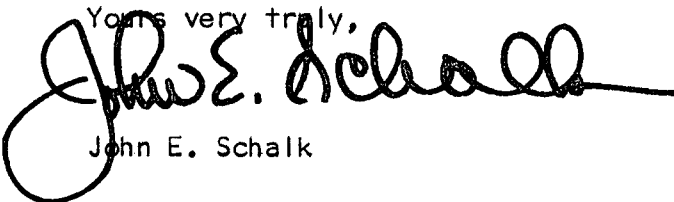

John E. Schalk

JES:fr

UNITED STATES
DEPARTMENT OF THE INTERIOR
GEOLOGICAL SURVEY

APPLICATION FOR PERMIT TO DRILL, DEEPEN, OR PLUG BACK

1a. TYPE OF WORK

DRILL ☒DEEPEN ☐PLUG BACK ☐

b. TYPE OF WELL

OIL
WELL ☐GAS
WELL ☒

OTHER

SINGLE
ZONE ☐MULTIPLE
ZONE ☐

2. NAME OF OPERATOR

Colonial Production Company

3. ADDRESS OF OPERATOR

1434 Westwood Blvd., Los Angeles, California 90024

4. LOCATION OF WELL (Report location clearly and in accordance with any State requirements.*)

At surface

690' from North Line, 1850' from West Line

At proposed prod. zone

Same

14. DISTANCE IN MILES AND DIRECTION FROM NEAREST TOWN OR POST OFFICE*

60 miles

10. DISTANCE FROM PROPOSED*

LOCATION TO NEAREST
PROPERTY OR LEASE LINE, FT.
(Also to nearest drilg. unit line, if any)

690'

16. NO. OF ACRES IN LEASE

1280

17. NO. OF ACRES ASSIGNED
TO THIS WELL

160

18. DISTANCE FROM PROPOSED LOCATION*
TO NEAREST WELL, DRILLING, COMPLETED,
OR APPLIED FOR, ON THIS LEASE, FT.

2640'

19. PROPOSED DEPTH

3050

20. ROTARY OR CABLE TOOLS

Rotary

21. ELEVATIONS (Show whether DF, RT, GR, etc.)

7282 G. R.

22. APPROX. DATE WORK WILL START*

May 23, 1969

23:

PROPOSED CASING AND CEMENTING PROGRAM

SIZE OF HOLE	SIZE OF CASING	WEIGHT PER FOOT	SETTING DEPTH	QUANTITY OF CEMENT
9-7/8"	7-5/8	26.40	100'	100
6-3/4"	4-1/2	9.50	3050	100

It is proposed to drill this well with rotary tools and mud as a circulation medium through and complete in the Pictured Cliffs Formation and to stimulate well by a sandwater fracture treatment.

The NW/4 Section 15 is dedicated to this well.

IN ABOVE SPACE DESCRIBE PROPOSED PROGRAM: If proposal is to deepen or plug back, give data on present productive zone and proposed new productive zone. If proposal is to drill or deepen directionally, give pertinent data on subsurface locations and measured and true vertical depths. Give blowout preventer program, if any.

24. For: COLONIAL PRODUCTION COMPANY President, Walsh Engineering & Production Corporation

5-13-69

SIGNED

TITLE

DATE

(This space for Federal or State office use)

PERMIT NO.

APPROVAL DATE

APPROVED BY

TITLE

DATE

CONDITIONS OF APPROVAL, IF ANY:

**NEW MEXICO OIL CONSERVATION COMMISSION
WELL LOCATION AND ACERAGE DEDICATION PLAT**

All distances must be from the outer boundaries of the Section

Operator COLONIAL PRODUCTION COMPANY			Lease Jicarilla		Well No. 10
Unit Letter C	Section 15	Township 23 NORTH	Range 4 WEST	County RIO ARriba	
Actual Footage Location of Well: 690 feet from the NORTH line and 1850 feet from the WEST line					
Ground Level Elev. 7282.0	Producing Formation Pictured Cliffs	Pool Ballard P. C.	Dedicated Acreage: 160		Acres

1. Outline the acreage dedicated to the subject well by colored pencil or hatchure marks on the plat below.
2. If more than one lease is dedicated to the well, outline each and identify the ownership thereof (both as to working interest and royalty).
3. If more than one lease of different ownership is dedicated to the well, have the interests of all owners been consolidated by communitization, unitization, force-pooling, etc?

() Yes () No If answer is "yes," type of consolidation

If answer is "no," list the owners and tract descriptions which have actually consolidated. (Use reverse side of this form if necessary.)

No allowable will be assigned to the well until all interests have been consolidated (by communitization, unitization, forced-pooling, or otherwise) or until a non standard unit, eliminating such interests, has been approved by the Commission.

**Jicarilla Tribal
Contract No. 398**

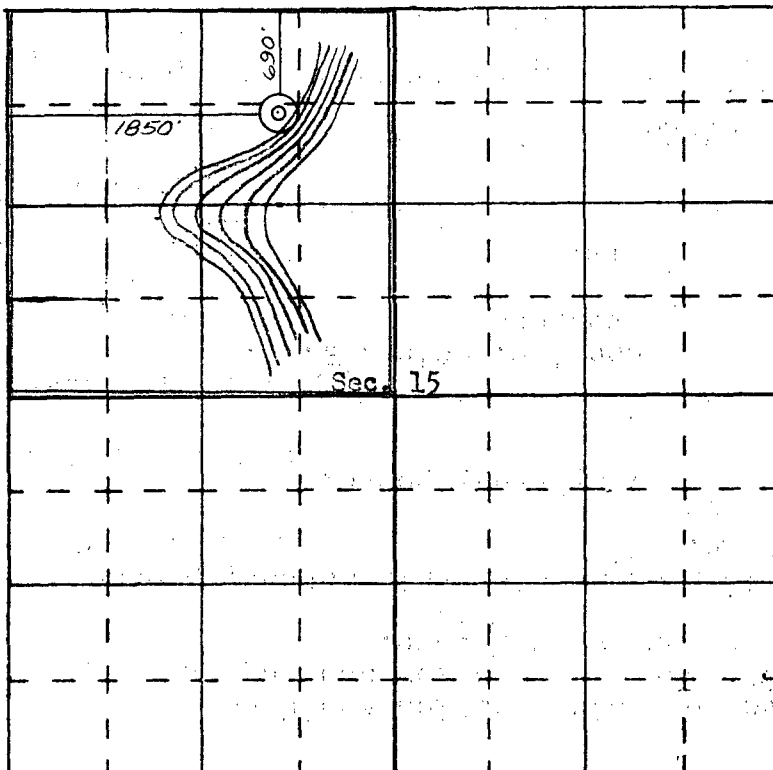

SCALE—4 INCHES, EQUALS 1 MILE

SAN JUAN ENGINEERING COMPANY, FARMINGTON, N. M.

CERTIFICATION

I hereby certify that the information contained herein is true and complete to the best of my knowledge and belief.

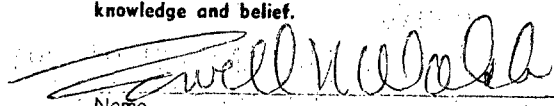
 Name **Ewell N. Walsh**
 Position **President**
 Company **Walsh Engineering & Production Corporation**
 Date **May 13, 1969**

I hereby certify that the well location shown on this plat was plotted from field notes of actual surveys made by me or under my supervision, and that the same is true and correct to the best of my knowledge and belief.

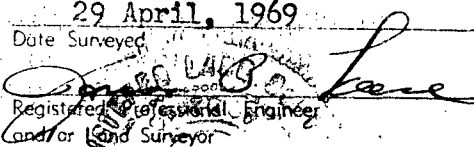
29 April, 1969
 Date Surveyed

 Registered Professional Engineer
 and/or Land Surveyor
JAMES P. LEESE
1463
 Certificate No.

PETROLEUM ENGINEERING
RESERVOIR STUDIES
EVALUATIONS
GEOLOGICAL STUDIES

WALSH
ENGINEERING & PRODUCTION
CORPORATION

PETROLEUM CLUB PLAZA BUILDING
P. O. BOX 254
FARMINGTON, NEW MEXICO 87401

LEASE MANAGEMENT
CONTRACT PUMPING
DRILLING SUPERVISION
WORKOVER SUPERVISION

EWELL N. WALSH, P.E.
President

TELEPHONE 325-8203

May 16, 1969

Handwritten:
NSL 435
issue 5-19-69

Mr. George M. Hatch, Attorney
Oil Conservation Commission
State of New Mexico
P. O. Box 2088
Santa Fe, New Mexico 87501

Ref: Colonial Production Company
Jicarilla #10, Unit C, Sec. 15,
Township 23 North, Range 4 West,
Rio Arriba County, New Mexico,
Ballard-Pictured Cliffs Pool

Dear Mr. Hatch:

This is to inform you that the Operator of the lease directly and diagonally offsetting the subject quartersection has been notified of the Application for approval of the unorthodox location. You are in receipt of the letter from John E. Schalk, Operator of the offset lease, giving approval of the unorthodox location.

For your information John E. Schalk is the Operator of Section 9, diagonally offsetting the subject quartersection, and Section 10, directly offsetting the subject quartersection, and Colonial Production is the Operator of Sections 15 and 16, all located in Township 23 North, Range 4 West, Rio Arriba County, New Mexico.

Therefore, it was only necessary to contact Mr. Schalk for approval of the unorthodox location.

Very truly yours,



Ewell N. Walsh, P. E.
President

ENW:lt

TOWNSHIP PLAT

(Scale: 1 in. = 1 mi.)

TOWNSHIP 23 N RANGE 4 W COUNTY Rio Arriba STATE New Mexico

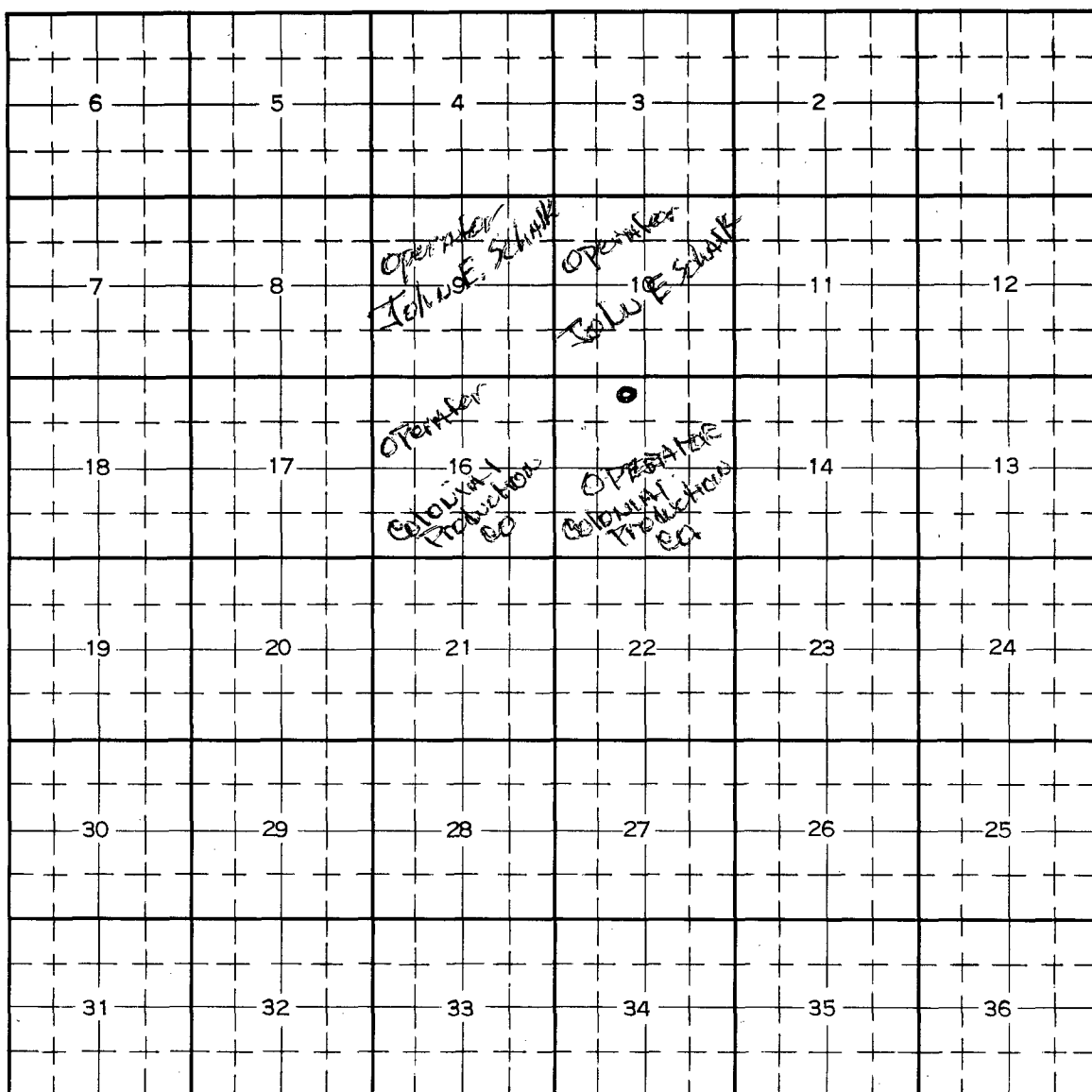

OIL CONSERVATION COMMISSION
1000 Rio Brazos Rd.
Aztec, New Mexico

MAILED
JUN 10 1969
AM 8 27

OIL CONSERVATION COMMISSION
BOX 871
SANTA FE, NEW MEXICO

DATE 5-15-69

RE: Proposed NSP _____

Proposed NSL ✓

Proposed NFO _____

Proposed DC _____

Gentlemen:

I have examined the application dated 5-13-69
for the Colonial Prod. Co. Jicarilla #10 C-15-23N-4W
Operator Lease and Well No. S-T-R

and my recommendations are as follows:

Topography Ver. Filed - approve

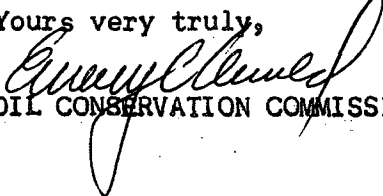
Yours very truly,

OIL CONSERVATION COMMISSION