



L. P. Thompson
Division Manager
Production Department
Hobbs Division

Western Hemisphere Petroleum Division
Continental Oil Company
P. O. 460
1001 North Turner
Hobbs, New Mexico 88240
(505) 393-4141

71 JUL 28 AM 10 09

NSL-512

July 27, 1971

New Mexico Oil Conservation Commission
P. O. Box 2088
Santa Fe, New Mexico 87501

Attention Mr. A. L. Porter, Jr., Secretary-Director

Gentlemen:

Application for Approval of Unorthodox Location for our MCA Unit No. 282

On March 15, 1971, we asked for an unorthodox location approval for the MCA Unit No. 282, located 25' FNL and 1295' FEL of Section 28, Unit Letter "A", T-17S, R-32E, Lea County, New Mexico. We received approval for this unorthodox location by Administrative Order No. NSL-493, dated March 16, 1971. It is necessary that we move this location to 1295' FNL & 2615' FWL of Section 27, Unit Letter "C", T-17S, R-32E, Lea County, New Mexico. It is respectfully requested that immediate approval of this revised location be given.

Yours very truly,

SW

CC:
NMOCC-Hobbs
USGS-Hobbs (2)
RLA: JJB: JWK

Supplied
NSL-493

**NEW MEXICO OIL CONSERVATION COMMISSION
WELL LOCATION AND ACREAGE DEDICATION PLAT**

Form O-102
Supersedes O-128
Effective 1-1-65

All distances must be from the outer boundaries of the Section

Operator CONTINENTAL OIL COMPANY			Lease MCA UNIT		Well No. 282
Unit Letter C	Section 27	Township 17 SOUTH	Range 32 EAST	County LEA	
Actual Footage Location of Well: <div style="display: flex; justify-content: space-between;"> 1295 feet from the NORTH line and 2615 feet from the WEST line </div>					
Ground Level Elev.	Producing Formation	Pool	Estimated Acreage		

1. Outline the acreage dedicated to the subject well by colored pencil or hatchure marks on the plat below.
2. If more than one lease is dedicated to the well, outline each and identify the ownership thereof (both as to working interest and royalty).
3. If more than one lease of different ownership is dedicated to the well, have the interests of all owners been consolidated by communitization, unitization, force-pooling, etc?

☐ Yes ☐ No If answer is "yes," type of consolidation _____

If answer is "no," list the owners and tract descriptions which have actually been consolidated. (Use reverse side of this form if necessary.) _____

No allowable will be assigned to the well until all interests have been consolidated (by communitization, unitization, forced-pooling, or otherwise) or until a non-standard unit, eliminating such interests, has been approved by the Commission.

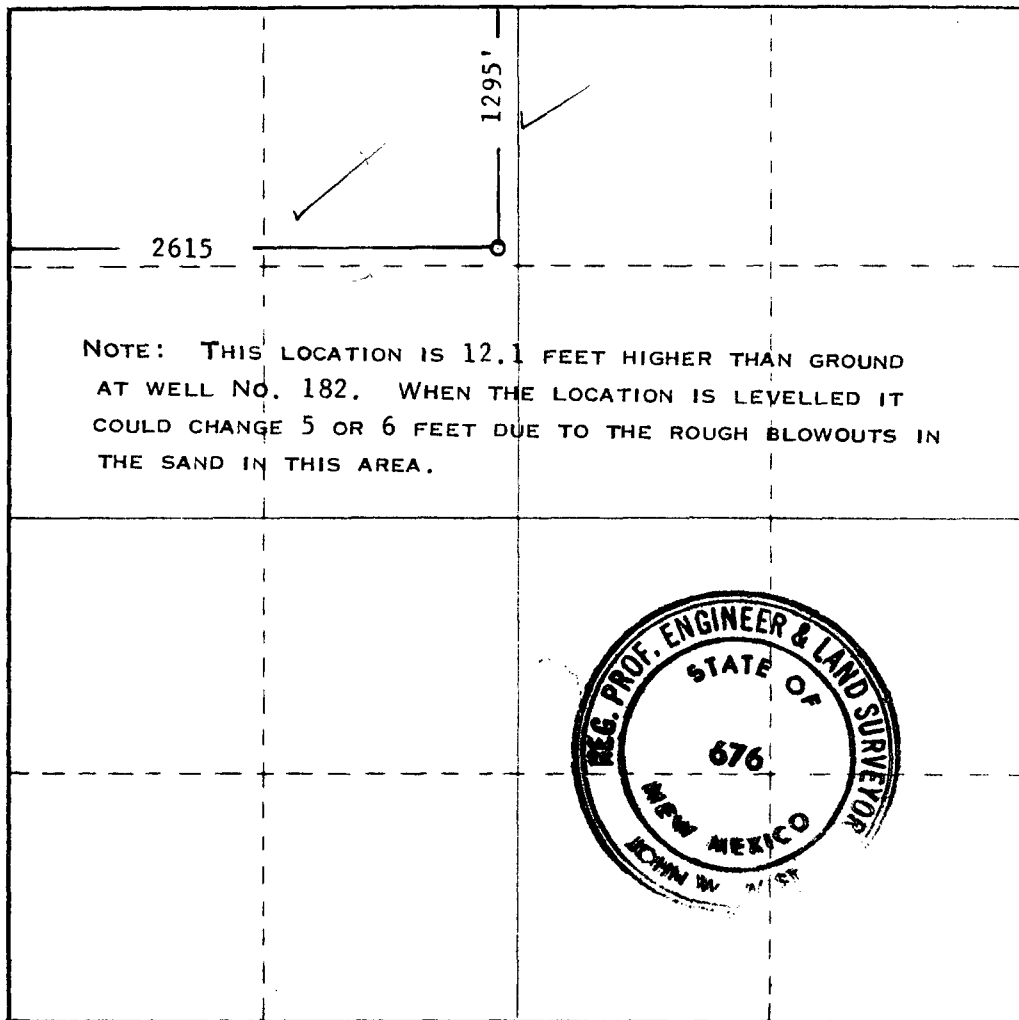

CERTIFICATION

I hereby certify that the information contained herein is true and complete to the best of my knowledge and belief.

Date

Signature

Capacity

Title

I hereby certify that the well location shown on this plat was plotted from field notes of actual surveys made by me or under my supervision, and that the same is true and correct to the best of my knowledge and belief.

Date Surveyed

7-29-1971

Registered Professional Engineer and/or Land Surveyor

John W. West
676

Aug 2 4 48 30

GOVERNOR
BRUCE KING
CHAIRMAN
LAND COMMISSIONER
ALEX J. ARMIJO
MEMBER
STATE GEOLOGIST
A. L. PORTER, JR.
SECRETARY - DIRECTOR

RECEIVED HOBBS DIVISION		
JUL 20 71		
	DATE	INITIALS
Div. Manager		
Asst. Div. Mgr.		
Div. Engr.		
Div. Off. Mgr.		
Contract. Sec'y		
HAI		
GOM		

Attention: Mr. T. B. Thompson

Re: Application for approval
of Unorthodox Location
for your MCA Unit No. 282

Gentlemen:

Please furnish us with a plat showing the location of the well and the nearest boundary lines of the MCA Unit Well.

Thank you.

Yours very truly,

George M. Hatch
GEORGE M. HATCH
Attorney

GMH/dr