

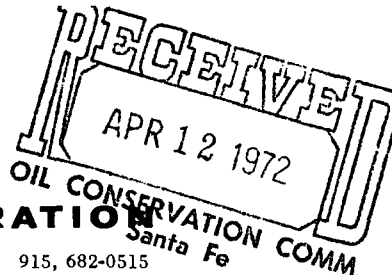

Union Texas Petroleum Division

**ALLIED CHEMICAL CORPORATION**

1300 WILCO BUILDING • MIDLAND, TEXAS 79701



*Am  
NSL - 549  
issue 5-2-72  
104 F*

April 7, 1972

Mr. A.L. Porter, Jr.  
New Mexico Conservation Commission  
State Land Office Building  
Santa Fe, New Mexico - 87501

RE: Crosby Deep No. 1  
Wildcat (Fusselman)  
Lea County, New Mexico

Dear Sir:

The subject well was drilled as a prospective Ellenburger Oil Well in Unit N, 330' FSL and 1980' FWL, Sec. 28, T-25-S, R-37-E, NMPM. The well was found to be non-productive in the Ellenburger Zone and was ultimately completed as a gas well in the Fusselman Zone.

It may be noted from the attached plat that this well location does not comply with Rule 104, A, I, (a) regarding the distance to the nearest side boundary, but does comply in other respects.

Giving consideration to the fact that the location was selected for an oil well, it is respectfully requested that exception to the portion of Rule 104, A, I, (a) violated, be granted administratively.

We are advising all offset operators of this request by copies of this letter.

Very truly yours,

UNION TEXAS PETROLEUM CORP.

*Howard Perdue*  
Howard Perdue  
District Petroleum Engineer

HP:hr  
Attachment

cc: El Paso, Texas Pacific, Atlantic-Richfield, Gulf, Pan American  
Continental, Terra Resources

**NEW MEXICO OIL CONSERVATION COMMISSION  
WELL LOCATION AND ACREAGE DEDICATION PLAT**

All distances must be from the outer boundaries of the Section.

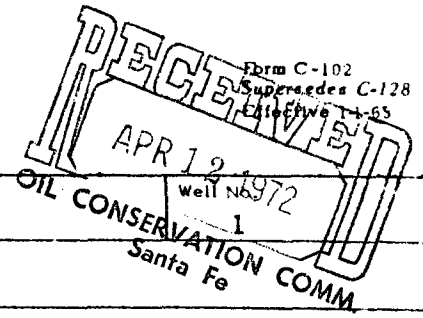

Operator <b>UNION TEXAS PETROLEUM CORP.</b>			Lease <b>CROSBY DEEP</b>		
Unit Letter <b>N</b>	Section <b>28</b>	Township <b>25 SOUTH</b>	Range <b>37 EAST</b>	County <b>LEA</b>	
Actual Footage Location of Well: <b>330</b> feet from the <b>SOUTH</b> line and <b>1980</b> feet from the <b>WEST</b> line					
Ground Level Elev. <b>3010' (Est.)</b>	Producing Formation <b>Fusselman</b>		Pool <b>Wildcat</b>	Dedicated Acreage: <b>320</b> Acres	

1. Outline the acreage dedicated to the subject well by colored pencil or hachure marks on the plat below.
2. If more than one lease is dedicated to the well, outline each and identify the ownership thereof (both as to working interest and royalty).
3. If more than one lease of different ownership is dedicated to the well, have the interests of all owners been consolidated by communitization, unitization, force-pooling, etc?

☒ Yes    ☐ No    If answer is "yes," type of consolidation Unitization

If answer is "no," list the owners and tract descriptions which have actually been consolidated. (Use reverse side of this form if necessary.) \_\_\_\_\_

No allowable will be assigned to the well until all interests have been consolidated (by communitization, unitization, forced-pooling, or otherwise) or until a non-standard unit, eliminating such interests, has been approved by the Commission.

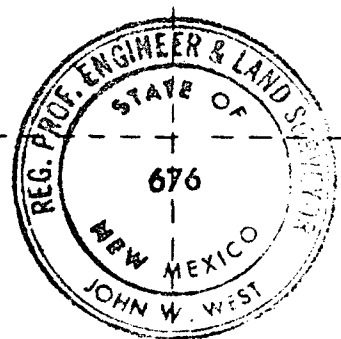
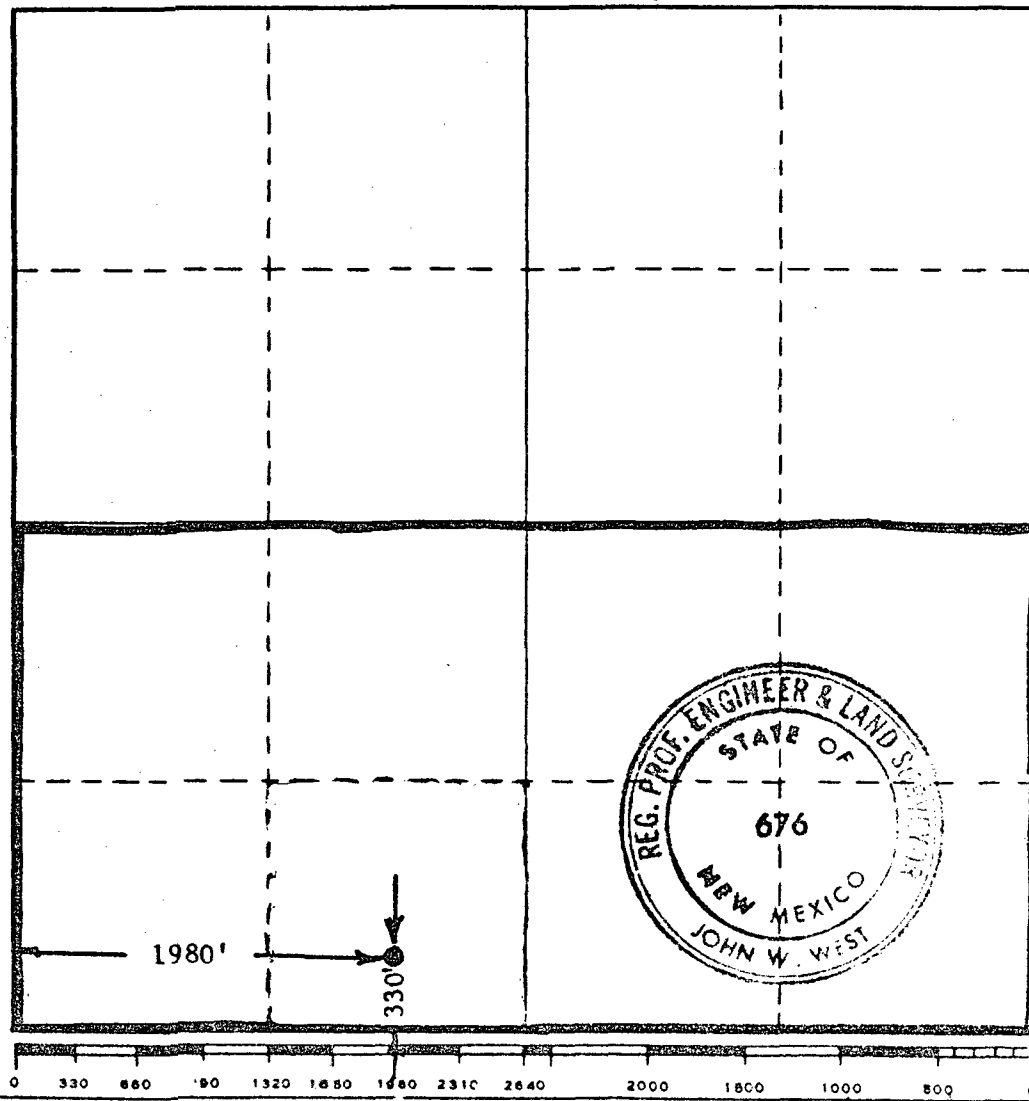

**CERTIFICATION**

I hereby certify that the information contained herein is true and complete to the best of my knowledge and belief.

Name R. W. Manry  
 Position Operations Supt. Western  
 Company UNION TEXAS PETROLEUM CORP.  
 Date April 4, 1972

I hereby certify that the well location shown on this plat was plotted from field notes of actual surveys made by me or under my supervision, and that the same is true and correct to the best of my knowledge and belief.

Date Surveyed SEPTEMBER 20, 1971  
 Registered Professional Engineer and/or Land Surveyor

John W. West  
 Certificate No. **676**