

11-6-72
104F
if OK from Dist office

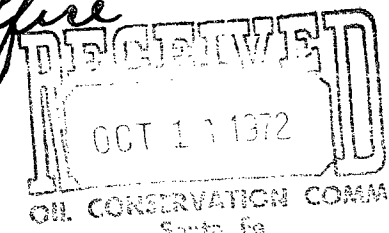

SKELLY OIL COMPANY

EXPLORATION & PRODUCTION DEPARTMENT
WEST CENTRAL DISTRICT

October 13, 1972

ADDRESS REPLY TO:
P. O. BOX 1351
MIDLAND, TEXAS 79701

A. B. CARY, EXPLORATION & PRODUCTION MANAGER
V. E. BARTLETT, EXPLORATION MANAGER
P. L. NUNLEY, PRODUCTION MANAGER
J. R. AVENT, ADMINISTRATIVE COORDINATOR

File: Cedar Canyon-10 Well No. 1
SE/4 NW/4 Section 10, T24S-R29E
Eddy County, New Mexico

Re: Application For Unorthodox Gas Well Location

State of New Mexico
Oil Conservation Commission
P. O. Box 2088
Santa Fe, New Mexico 87501

Attention: A. L. Porter, Jr., Secretary-Director

Gentlemen:

Skelly Oil Company respectfully requests administrative approval to drill a wildcat well to be located 2180' FNL and 1980' FWL of Section 10, T24S, R29E, Eddy County, New Mexico. Said well to be drilled through the Morrow Formation at approximately 13,000-13,500', from which gas production is anticipated.

Skelly is the owner of a lease in the North half (N/2) of Sec. 10-24S-29E, Eddy County; and the Statewide rules, and more particularly Rule 104-B-1(a), provide for Formation of Pennsylvanian age or older shall be located on a drilling tract consisting of 320 surface contiguous acres comprising any two contiguous quarter sections of a single governmental section, with minimum spacing of 660' to the nearest side boundary of the unit nor closer than 1,980' to the nearest end boundary.

The original planned location was to be 1980' FNL and 1980' FWL of Section 10, however, it has become necessary to move to location 200' south in order to avoid the extreme problems of topography.

Attached is a Well Location and Acreage Dedication Plat, along with a Land Plat indicating offset operators and a topography plat for Section 10.

October 13, 1972

Also attached is a waiver from Superior Oil Company, one offset operator to the above property, indicating that they have no objection to this unorthodox location. The other offset operators have been sent identical waivers which will be forwarded to you as soon as they are received or will be sent to you direct.

Respectfully submitted,

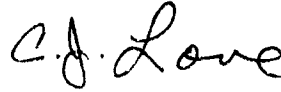

C. J. Love

MLF/gm
attachs.

cc: New Mexico Oil Conservation Commission, Artesia
U. S. Geological Survey, Artesia
Mr. D. R. Parkhurst

NEW MEXICO OIL CONSERVATION COMMISSION
WELL LOCATION AND ACREAGE DEDICATION PLAT

Form C-102
Supersedes C-128
Effective 1-1-65

All distances must be from the outer boundaries of the Section.

AMENDED PLAT

Lessee Skelly Oil Company		Lease Cedar Canyon 10.		Well No.	
Tract Letter H F	Section 10	Township 24 S	Range 29 E	County Eddy	
Actual Footage Location of Well:					
2180 feet from the North line and		1980 feet from the West line			
Ground Level Elev. Unknown	Producing Formation Morrow	Pool Undesignated		Dedicated Acreage: 320 Acres	

- Outline the acreage dedicated to the subject well by colored pencil or hachure marks on the plat below.
- If more than one lease is dedicated to the well, outline each and identify the ownership thereof (both as to working interest and royalty).
- If more than one lease of different ownership is dedicated to the well, have the interests of all owners been consolidated by communitization, unitization, force-pooling, etc?

☐ Yes ☐ No If answer is "yes," type of consolidation _____

If answer is "no," list the owners and tract descriptions which have actually been consolidated. (Use reverse side of this form if necessary.) _____

No allowable will be assigned to the well until all interests have been consolidated (by communitization, unitization, forced-pooling, or otherwise) or until a non-standard unit, eliminating such interests, has been approved by the Commission.

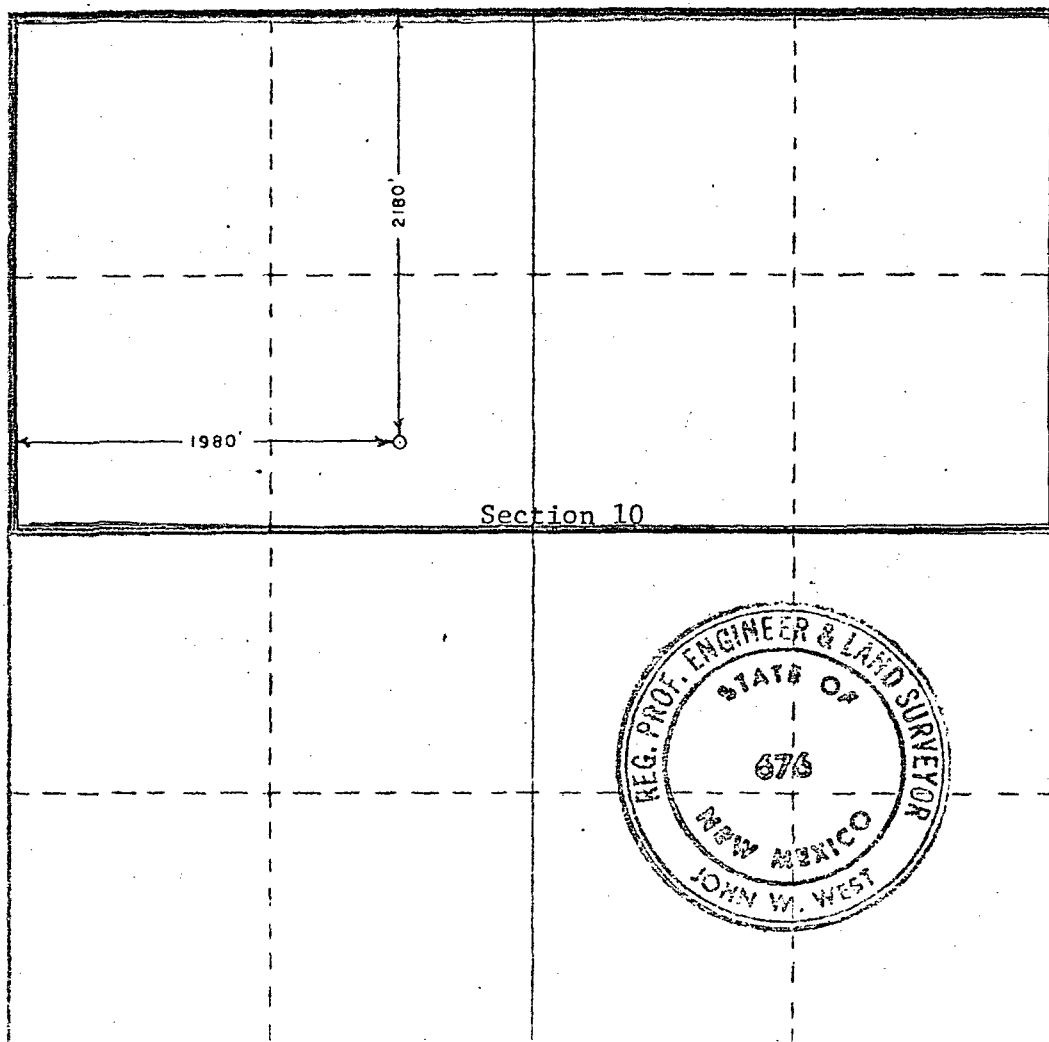

CERTIFICATION

I hereby certify that the information contained herein is true and complete to the best of my knowledge and belief.

Name C. J. Love C. J. Love
Position District Production Manager
Company Skelly Oil Company
Date October 10, 1972

I hereby certify that the well location shown on this plat was plotted from field notes of actual surveys made by me or under my supervision, and that the same is true and correct to the best of my knowledge and belief.

Sept. 20, 1972

Date Surveyed

Registered Professional Engineer and/or Land Surveyor

John W. West
676

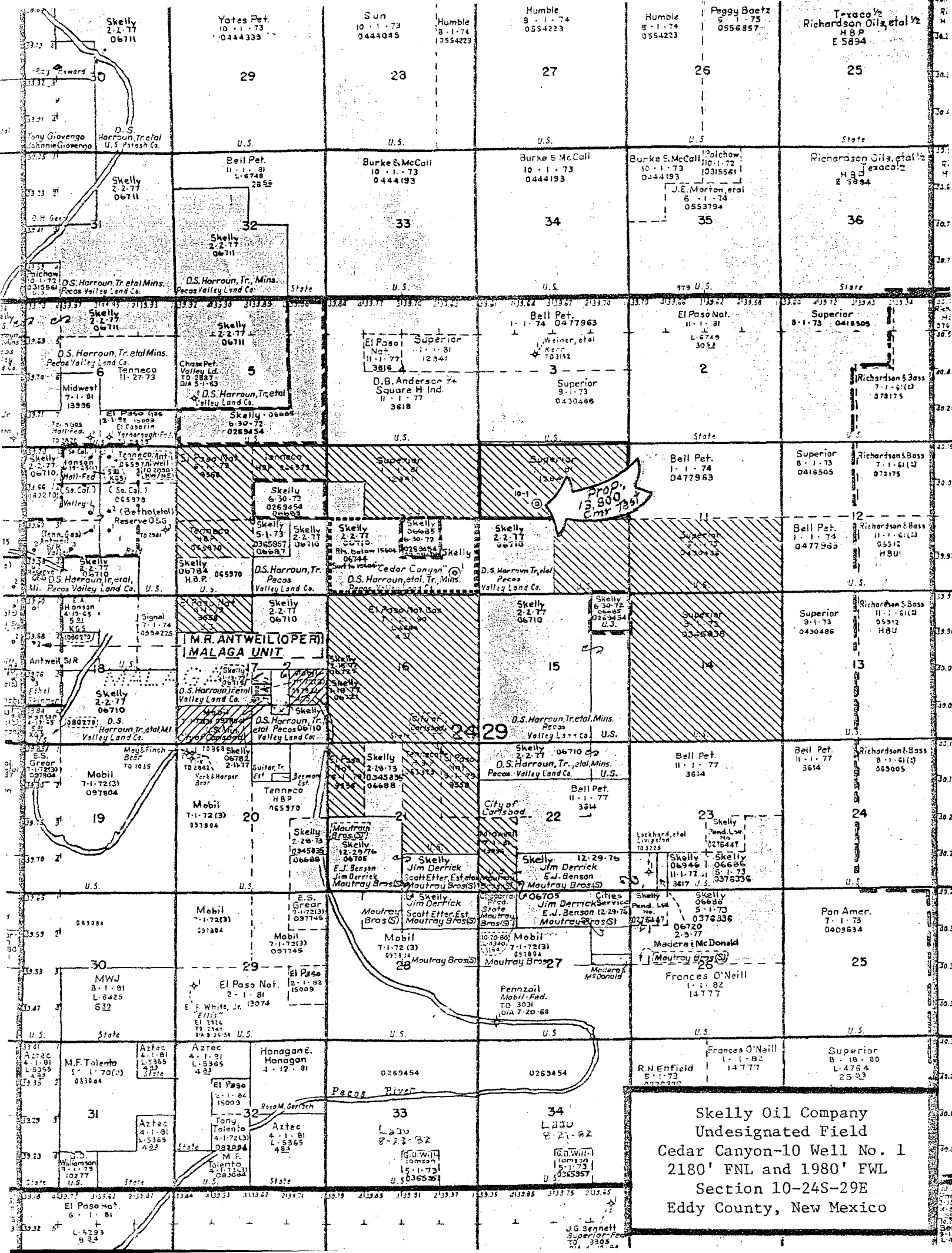

Skelly Oil Company
Undesignated Field
Cedar Canyon-10 Well No. 1
2180' FNL and 1980' FWL
Section 10-24S-29E
Eddy County, New Mexico

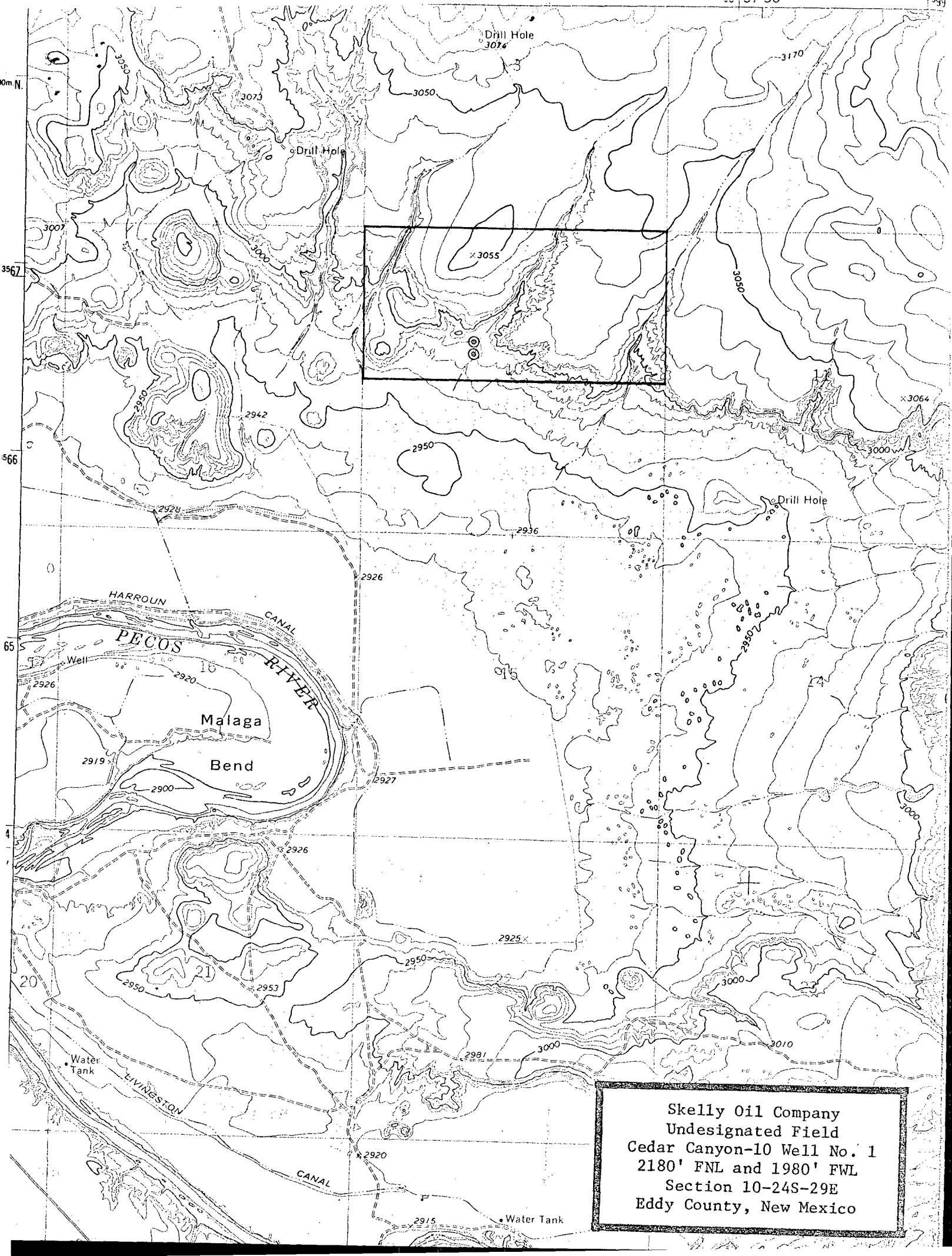

Skelly Oil Company
Undesignated Field
Cedar Canyon-10 Well No. 1
2180' FNL and 1980' FWL
Section 10-24S-29E
Eddy County, New Mexico

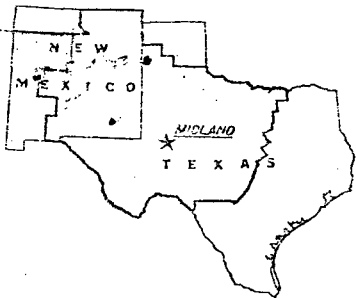

SKELLY OIL COMPANY
EXPL & PROD. DEPT.

OCT 16 1972

WEST CENTRAL DISTRICT

SKELLY OIL COMPANY

EXPLORATION & PRODUCTION DEPARTMENT
WEST CENTRAL DISTRICT

October 10, 1972

V. E. BARTLETT, EXPLORATION MANAGER
J. R. GISBURNE, DISTRICT EXPLORATION GEOLOGIST
M. E. ROBINSON, DISTRICT LANDMAN
E. E. RODGERS, DISTRICT PROJECTS GEOLOGIST
T. O. SCHMIDT, DISTRICT GEOPHYSICIST

ADDRESS-REPLY TO
P. O. BOX 1351
MIDLAND, TEXAS 79701

Re: N/2 Section 10, 24S-29E
Eddy County, New Mexico

The Superior Oil Company
Box 1900
Midland, Texas 79701
Attention: D. H. Collins, Jr.

Mr. D. B. Anderson
P. O. Box 1000
Roswell, New Mexico 88201

El Paso Natural Gas Company
600 Building of the Southwest
Midland, Texas 79701
Attention: A. J. Mason

Dr. W. J. Langley
Garland Road
Dallas, Texas 75221

Bell Petroleum Company
16633 Ventura Blvd.
Suite 700
Encino, Calif. 91316
Attention: Mr. R. J. Tingle

Gentlemen:

Skelly, as operator, proposes to drill a test at a location 2180' FNL plus 1980' FNL Section 10-24S-29E, Eddy County, New Mexico, which is 200' south of a standard location.

If you, as the owner of an offset tract, have no objection to the proposed non-standard location, please so indicate by signing in the space provided on the second page hereof.

Very truly yours,

Wm. B. Crownover

WBC:wt
Attachment

We have no objection to the non-standard location 2180' FNL plus
1980' FWL Sec. 10 24S-29E, Eddy County, New Mexico as proposed by
Skelly Oil Company.

THE SUPERIOR OIL COMPANY

By: _____

Date: _____

DR. W. J. LANGLEY

By: _____

Date: _____

BELL PETROLEUM COMPANY

By: _____

Date: _____

D. B. ANDERSON

By: *Fred D. Anderson*

Date: 10-13-72

EL PASO NATURAL GAS COMPANY

By: _____

Date: _____

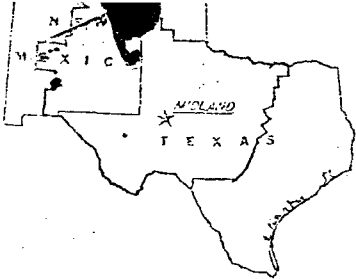

SKELLY OIL COMPANY
EXPL. & PROD. DEPT.
OCT 16 1972
WEST CENTRAL DISTRICT

SKELLY OIL COMPANY

EXPLORATION & PRODUCTION DEPARTMENT
WEST CENTRAL DISTRICT

October 10, 1972

ADDRESS REPLY TO:
P. O. BOX 1351
MIDLAND, TEXAS 79701

V. E. BARTLETT, EXPLORATION MANAGER
J. R. GIBBURNE, DISTRICT EXPLORATION GEOLOGIST
M. E. ROBINSON, DISTRICT LANDMAN
E. E. RODGERS, DISTRICT PROJECTS GEOLOGIST
T. O. SCHMIDT, DISTRICT GEOPHYSICIST

Re: N/2 Section 10, 24S-29E
Eddy County, New Mexico

The Superior Oil Company
Box 1900
Midland, Texas 79701
Attention: D. H. Collins, Jr.

Mr. D. B. Anderson
P. O. Box 1000
Roswell, New Mexico 88201

El Paso Natural Gas Company
600 Building of the Southwest
Midland, Texas 79701
Attention: A. J. Mason

Dr. W. J. Langley
Garland Road
Dallas, Texas 75221

Bell Petroleum Company
16633 Ventura Blvd.
Suite 700
Encino, Calif. 91316
Attention: Mr. R. J. Tingle

Gentlemen:

Skelly, as operator, proposes to drill a test at a location 2180' FNL plus 1980' FNL Section 10-24S-29E, Eddy County, New Mexico, which is 200' south of a standard location.

If you, as the owner of an offset tract, have no objection to the proposed non-standard location, please so indicate by signing in the space provided on the second page hereof.

Very truly yours,

Wm. B. Crowder

WBC:wt
Attachment

We have no objection to the non-standard location 2180' FNL plus
1980' FWL Sec. 10 24S-29E, Eddy County, New Mexico as proposed by
Skelly Oil Company.

THE SUPERIOR OIL COMPANY

By: _____

Date: _____

DR. W. J. LANGLEY

BY: _____

Date: _____

BELL PETROLEUM COMPANY

By: *[Signature]*

Date: 10-12-72

D. B. ANDERSON

By: _____

Date: _____

EL PASO NATURAL GAS COMPANY

By: _____

Date: _____

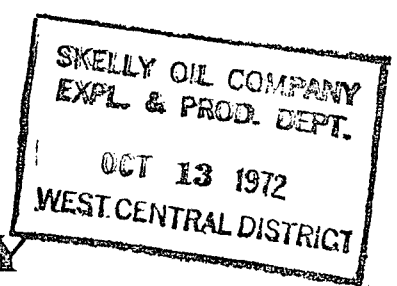
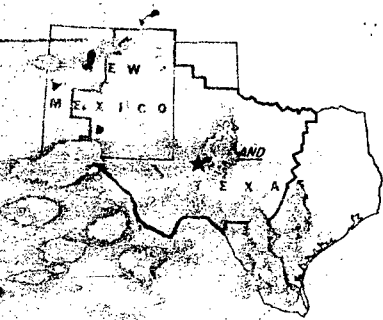

SKELLY OIL COMPANY

EXPLORATION & PRODUCTION DEPARTMENT
WEST CENTRAL DISTRICT

October 10, 1972

ADDRESS REPLY TO:
P. O. BOX 1351
MIDLAND, TEXAS 79701

V. E. BARTLETT, EXPLORATION MANAGER
J. R. GIBBURNE, DISTRICT EXPLORATION GEOLOGIST
M. E. ROBINSON, DISTRICT LANDMAN
E. E. RODGERS, DISTRICT PROJECTS GEOLOGIST
T. O. SCHMIDT, DISTRICT GEOPHYSICIST

Re: N/2 Section 10, 24S-29E
Eddy County, New Mexico

The Superior Oil Company
Box 1900
Midland, Texas 79701
Attention: D. H. Collins, Jr.

attached

Mr. D. B. Anderson
P. O. Box 1000
Roswell, New Mexico 88201

in the mail

El Paso Natural Gas Company
600 Building of the Southwest
Midland, Texas 79701
Attention: A. J. Mason

✓

Dr. W. J. Langley
Garland Road
Dallas, Texas 75221

in the mail

Bell Petroleum Company
16633 Ventura Blvd.
Suite 700
Encino, Calif. 91316
Attention: Mr. R. J. Tingle

in mail

Gentlemen:

Skelly, as operator, proposes to drill a test at a location 2180' FNL plus 1980' FWL Section 10-24S-29E, Eddy County, New Mexico, which is 200' south of a standard location.

If you, as the owner of an offset tract, have no objection to the proposed non-standard location, please so indicate by signing in the space provided on the second page hereof.

Very truly yours,

W.B. Crownover
Wm. B. Crownover

WBC:wt
Attachment

as offset operator

We have no objection to the non-standard location 2180' FNL plus
1980' FWL Sec. 10 24S-29E, Eddy County, New Mexico as proposed by
Skelly Oil Company.

THE SUPERIOR OIL COMPANY

By: *D. H. Collins Jr.*

Date: 10-12-72

DR. W. J. LANGLEY

By: _____

Date: _____

BELL PETROLEUM COMPANY

By: _____

Date: _____

D. B. ANDERSON

By: _____

Date: _____

EL PASO NATURAL GAS COMPANY

By: _____

Date: _____

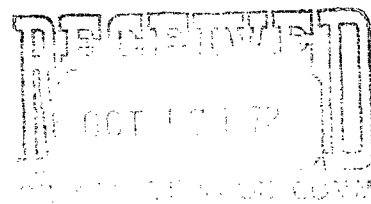
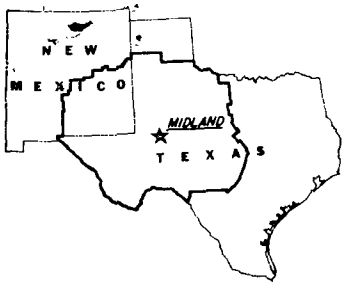

SKELLY OIL COMPANY

EXPLORATION & PRODUCTION DEPARTMENT
WEST CENTRAL DISTRICT

October 16, 1972

ADDRESS REPLY TO:
P. O. BOX 1351
MIDLAND, TEXAS 79701

A. B. CARY, EXPLORATION & PRODUCTION MANAGER
V. E. BARTLETT, EXPLORATION MANAGER
P. L. NUNLEY, PRODUCTION MANAGER
J. R. AVENT, ADMINISTRATIVE COORDINATOR

File: Cedar Canyon-10 Well No. 1
SE/4 NW/4 Section 10, T24S, R29E
Eddy County, New Mexico

Re: Application for Unorthodox Gas Well Location

State of New Mexico
Oil Conservation Commission
P. O. Box 2088
Santa Fe, New Mexico 87501

Attention: Mr. A. L. Porter, Jr., Secretary-Director

Gentlemen:

Regarding our letter to you of October 13, 1972, enclosed are waivers from the offset operators listed below indicating that they have no objection to the unorthodox location of our proposed Cedar Canyon-10 Well No. 1:

Dr. W. J. Langley
Bell Petroleum Company
D. B. Anderson

El Paso Natural Gas Company's waiver will be sent to you by telegraph.

Respectfully submitted,

C. J. Love
C. J. Love

MLF/gm
attachs. (3)

cc: New Mexico Oil Conservation Commission, Artesia
U. S. Geological Survey, Artesia
Mr. D. R. Parkhurst

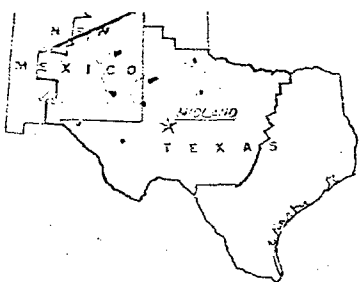

SKELLY OIL COMPANY
EXPL & PROD. DEPT.

OCT 16 1972
WEST CENTRAL DISTRICT

SKELLY OIL COMPANY

EXPLORATION & PRODUCTION DEPARTMENT
WEST CENTRAL DISTRICT

October 10, 1972

ADDRESS REPLY TO:
P. O. BOX 1351
MIDLAND, TEXAS 79701

V. E. BARTLETT, EXPLORATION MANAGER
J. R. GIBBURN, DISTRICT EXPLORATION GEOLOGIST
M. E. ROBINSON, DISTRICT LANDMAN
E. E. RODGERS, DISTRICT PROJECTS GEOLOGIST
T. O. SCHMIDT, DISTRICT GEOPHYSICIST

Re: N/2 Section 10, 24S-29E
Eddy County, New Mexico

The Superior Oil Company
Box 1900
Midland, Texas 79701
Attention: D. H. Collins, Jr.

Mr. D. B. Anderson
P. O. Box 1000
Roswell, New Mexico 88201

El Paso Natural Gas Company
600 Building of the Southwest
Midland, Texas 79701
Attention: A. J. Mason

Dr. W. J. Langley
Garland Road
Dallas, Texas 75221

Bell Petroleum Company
16633 Ventura Blvd.
Suite 700
Encino, Calif. 91316
Attention: Mr. R. J. Tingle

Gentlemen:

Skelly, as operator, proposes to drill a test at a location 2180' FNL plus 1980' FWL Section 10-24S-29E, Eddy County, New Mexico, which is 200' south of a standard location.

If you, as the owner of an offset tract, have no objection to the proposed non-standard location, please so indicate by signing in the space provided on the second page hereof.

Very truly yours,

Wm. B. Crownover

WBC:wt
Attachment

We have no objection to the non-standard location 2180' FNL plus
1980' FWL Sec. 10 24S-29E, Eddy County, New Mexico as proposed by
Skelly Oil Company.

THE SUPERIOR OIL COMPANY

By: _____

Date: _____

DR. W. J. LANCIEY

BY:  _____

Date: 10-13-72

BELL PETROLEUM COMPANY

By: _____

Date: _____

D. B. ANDERSON

By: _____

Date: _____

EL PASO NATURAL GAS COMPANY

By: _____

Date: _____

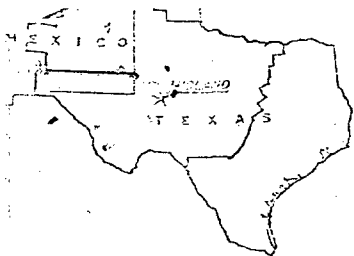

EXPL & PROD. DEPT.

OCT 16 1972

WEST CENTRAL DISTRICT

SKELLY OIL COMPANY

EXPLORATION & PRODUCTION DEPARTMENT
WEST CENTRAL DISTRICT

October 10, 1972

ADDRESS REPLY TO:
P. O. BOX 1331
MIDLAND, TEXAS 79701

V. E. BARTLETT, EXPLORATION MANAGER
J. R. GIBBURN, DISTRICT EXPLORATION GEOLOGIST
M. E. ROBINSON, DISTRICT LANDMAN
E. E. RODGERS, DISTRICT PROJECTS GEOLOGIST
T. O. SCHMIDT, DISTRICT GEOPHYSICIST

Re: N/2 Section 10, 24S-29E
Eddy County, New Mexico

The Superior Oil Company
Box 1900
Midland, Texas 79701
Attention: D. H. Collins, Jr.

Mr. D. B. Anderson
P. O. Box 1000
Roswell, New Mexico 88201

El Paso Natural Gas Company
600 Building of the Southwest
Midland, Texas 79701
Attention: A. J. Mason

Dr. W. J. Langley
Garland Road
Dallas, Texas 75221

Bell Petroleum Company
16633 Ventura Blvd.
Suite 700
Encino, Calif. 91316
Attention: Mr. R. J. Tingle

Gentlemen:

Skelly, as operator, proposes to drill a test at a location 2180' FWL plus 1980' FWL Section 10-24S-29E, Eddy County, New Mexico, which is 200' south of a standard location.

If you, as the owner of an offset tract, have no objection to the proposed non-standard location, please so indicate by signing in the space provided on the second page hereof.

Very truly yours,

Wm. B. Crowder

WBC:wlt
Attachment

We have no objection to the non-standard location 2180' FNL plus
1930' FNL Sec. 10 24S-29E, Eddy County, New Mexico as proposed by
Skelly Oil Company.

THE SUPERIOR OIL COMPANY

By: _____

Date: _____

DR. W. J. LANCIEY

By: *[Signature]*

Date: 10-13-72

BELL PETROLEUM COMPANY

By: _____

Date: _____

D. B. ANDERSON

By: _____

Date: _____

EL PASO NATURAL GAS COMPANY

By: _____

Date: _____

75L-584

NEW MEXICO
OIL CONSERVATION COMMISSION

FIELD TRIP REPORT

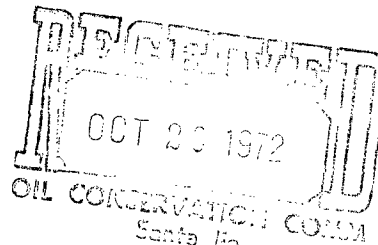

DATE 10-17-72

Name of Employee W. A. Gressett

Time of Departure 10:30 A. M. Time of Return 2:30 P. M.

Miles Travelled 132

In the space below please indicate purpose of trip and duties performed, listing wells or leases visited.

Field Inspection - Non Standard Location

Skelly Oil Company Cedar Canyon 10 #1-2180/N-1980/W
Sec. 10-24-29 (W/ the N/2 dedicated)

A location 1980 N & W would fall on the edge of a shallow arroyo coming from NE to SW and the reserve pits would be right up against or on the side of a hill. Without objection from offset operators, I would recommend approval.

I noticed some new pipeline activity in the vicinity of the Grace Carlsbad #1-I-36-22-26 and on up to the Gopogo #2-G-24-22-26. I assume that they will be connected before long.

W. A. Gressett
Employee's Signature
District #1 I



Telegram

KA015 K KCE218(1304)

(1-018473A290)PD 10/16/72 1302 =TWX EPNG ELP ^{1972 OCT 16 PM 1 17}

=ZCZC 05701 PD EL PASO TEX =

=PMS OIL CONSERVATION COMMISSION

=STATE OF NEW MEXICO =SANTA FE NEW MEXICO =

=EL PASO NATURAL GAS COMPANY HAS NO OBJECTION TO THE
PROPOSAL BY =SKELLY OIL COMPANY FOR A NON-STANDARD WELL
LOCATION 2180 FEET FNL =AND 1980 FEET FWL OF SECTION 10,
T-24-S, R-29-E, EDDY COUNTY, =NEW MEXICO =

=D N CANFIELD =MANAGER LAND DEPARTMENT =
EL PASO NATURAL GAS COMPANY =EL PASO, TEXAS =