

# El Paso Natural Gas Company

El Paso, Texas 79978

June 19, 1973

ADDRESS REPLY TO  
POST OFFICE BOX 990  
FARMINGTON, NEW MEXICO 87401

Mr. A. L. Porter, Secretary & Director  
New Mexico Oil Conservation Commission  
Post Office Box 2088  
Santa Fe, New Mexico 87501

ok  
NSL-609  
104  
New July 11

Dear Mr. Porter:

This is a request for administrative approval for an unorthodox gas well location in the Basin Dakota pool.

It is intended to locate the El Paso Natural Gas Company San Juan 28-4 Unit #36 700' from the South line and 1470' from the West line of Section 29 T-28-N, R-4-W, NMPM, Rio Arriba County, New Mexico. The West half of Section 29 is dedicated to this well.

The Southwest quarter of Section 29 is crossed by Munoz Canyon. The sides of this canyon are very steep, making an orthodox location extremely expensive to build.

All of the offsetting proration units are included in the San Juan 28-4 Unit of which El Paso Natural Gas Company is the operator.

Plats showing the proposed well location with terrain features and ownership of offset leases are attached.

Yours truly,

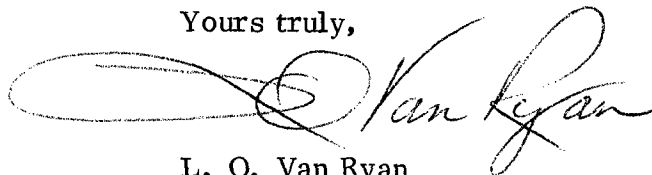

L. O. Van Ryan  
Senior Petroleum Engineer

LOVR:pb

cc: Emery Arnold w/attachments  
J. Permenter w/attachments  
P. T. McGrath w/attachments

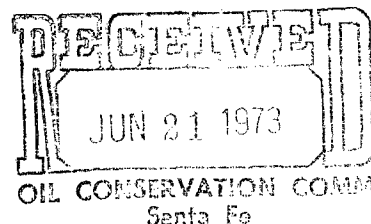

UNITED STATES  
DEPARTMENT OF THE INTERIOR  
GEOLOGICAL SURVEY

## APPLICATION FOR PERMIT TO DRILL, DEEPEN, OR PLUG BACK

## 1a. TYPE OF WORK

DRILL ☒DEEPEN ☐PLUG BACK ☐

## b. TYPE OF WELL

OIL  
WELL ☐GAS  
WELL ☒

OTHER

SINGLE  
ZONE ☒MULTIPLE  
ZONE ☐

## 2. NAME OF OPERATOR

El Paso Natural Gas Company

## 3. ADDRESS OF OPERATOR

PO Box 990, Farmington, NM 87401

## 4. LOCATION OF WELL (Report location clearly and in accordance with any State requirements.)\*

At surface

700'S, 1470'W

At proposed prod. zone

## 14. DISTANCE IN MILES AND DIRECTION FROM NEAREST TOWN OR POST OFFICE\*

## 15. DISTANCE FROM PROPOSED\*

LOCATION TO NEAREST  
PROPERTY OR LEASE LINE, FT.  
(Also to nearest drig. unit line, if any)

## 16. NO. OF ACRES IN LEASE

17. NO. OF ACRES ASSIGNED  
TO THIS WELL

320.00

18. DISTANCE FROM PROPOSED LOCATION\*  
TO NEAREST WELL, DRILLING, COMPLETED,  
OR APPLIED FOR, ON THIS LEASE, FT.

## 19. PROPOSED DEPTH

8715'

## 20. ROTARY OR CABLE TOOLS

Rotary

## 21. ELEVATIONS (Show whether DF, RT, GR, etc.)

7305'GR

## 22. APPROX. DATE WORK WILL START\*

## 23.

## PROPOSED CASING AND CEMENTING PROGRAM

SIZE OF HOLE	SIZE OF CASING	WEIGHT PER FOOT	SETTING DEPTH	QUANTITY OF CEMENT
13 3/4"	9 5/8"	32.3#	200'	220 cu. ft. to circulate
8 3/4"	7"	20#	4578'	200 cu. ft. to cover Ojo Alamo
6 1/4"	4 1/2"	10.5#&11.6#	8715'	635 cu. ft. to fill to intermediate casing

Selectively perforate and sandwater fracture the Dakota formation.

The W/2 of Section 29 is dedicated to this well.

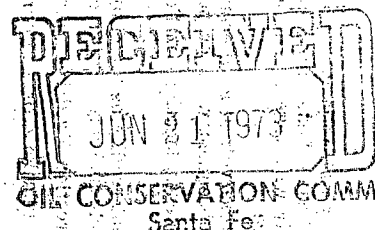

IN ABOVE SPACE DESCRIBE PROPOSED PROGRAM: If proposal is to deepen or plug back, give data on present productive zone and proposed new productive zone. If proposal is to drill or deepen directionally, give pertinent data on subsurface locations and measured and true vertical depths. Give blowout preventer program, if any.

## 24.

SIGNED

*D. G. Ennes*

TITLE

Drilling Clerk

DATE

June 20, 1973

(This space for Federal or State office use)

PERMIT NO.

APPROVAL DATE

APPROVED BY

TITLE

DATE

CONDITIONS OF APPROVAL, IF ANY:

R 4 W

El Paso Natural Gas

El Paso Natural Gas

El Paso Natural Gas

El Paso Natural Gas

El Paso Natural Gas

El Paso Natural Gas

29

T  
28  
N

990 HV  
0 490  
1470' 36(Kd)  
700'

Amoco

Amoco

Amoco

\* 30(Kd)

\* 32(Kd)

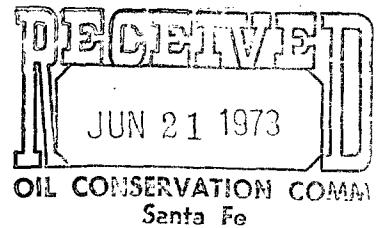

DAKOTA OWNERSHIP

Offsetting E.P.N.G. San Juan 28-4 Unit No.36 - 29-28N.-4W.  
Rio Arriba Co., New Mexico

SCALE: 3"=1 Mile

DATE: 6/18/73

DRAWN BY: J.L.H.

OIL CONSERVATION COMMISSION  
AZTEC DISTRICT

OIL CONSERVATION COMMISSION  
BOX 2088  
SANTA FE, NEW MEXICO

DATE June 25, 1973

Re: Proposed NSP \_\_\_\_\_

Proposed NWI \_\_\_\_\_

Proposed NSL XXXX

Proposed NFO \_\_\_\_\_

Proposed MC \_\_\_\_\_

Gentlemen:

I have examined the application dated June 19, 1973

for the El Paso Natural Gas Co. San Juan 28-4 Unit #36 N-29-28N-4W  
Operator Lease and Well No. S-T-R

and my recommendations are as follows:

Approve

Yours very truly,

*AR Kendrick*

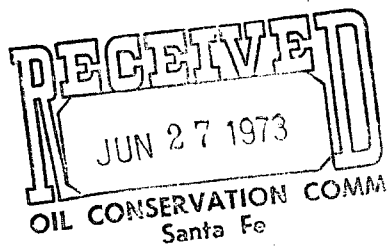

NEW MEXICO OIL CONSERVATION COMMISSION  
WELL LOCATION AND ACREAGE DEDICATION PLAT

Form C-102  
Supersedes C-128  
Effective 1-1-65

All distances must be from the outer boundaries of the Section.

Operator <b>EL PASO NATURAL GAS COMPANY</b>		Lease <b>SAN JUAN 28-4 UNIT (NM-03863)</b>		Well No. <b>36</b>
Unit Letter <b>N</b>	Section <b>29</b>	Township <b>28-N</b>	Range <b>4-W</b>	County <b>RIO ARriba</b>
Actual Postage Location of Well: <b>700</b> feet from the <b>SOUTH</b> line and <b>1470</b> feet from the <b>WEST</b> line				
Ground Level Elev. <b>7305</b>	Producing Formation <b>DAKOTA</b>	Pool <b>BASIN DAKOTA</b>	Dedicated Acreage <b>320.00</b> Acres	

- Outline the acreage dedicated to the subject well by colored pencil or hatchure marks on the plat below.
- If more than one lease is dedicated to the well, outline each and identify the ownership thereof (by name, ownership interest and royalty).
- If more than one lease of different ownership is dedicated to the well, have the interests of all owners consolidated by communitization, unitization, force-pooling, etc.

☒ Yes ☐ No If answer is "yes," type of consolidation

Unitization

If answer is "no," list the owners and tract descriptions which have actually been consolidated. (Use reverse side of this form if necessary.)

No allowable will be assigned to the well until all interests have been consolidated (by communitization, unitization, forced-pooling, or otherwise) or until a non-standard unit, eliminating such interests, has been approved by the Commission.

CERTIFICATION

I hereby certify that the information contained herein is true and complete to the best of my knowledge and belief.

Original Signed by

**D. G. Brisco**  
Drilling Clerk

Position  
**El Paso Natural Gas Company**

Company  
**June 20, 1973**

Date

I hereby certify that the well location shown on this plat was plotted from field notes of actual surveys made by me or under my supervision, and that the same is true and correct to the best of my knowledge and belief.

Date Surveyed  
**JUNE 4, 1973**

Registered Professional Engineer  
and/or Land Surveyor

*David O. Wilson*  
Certificate No. **1760**

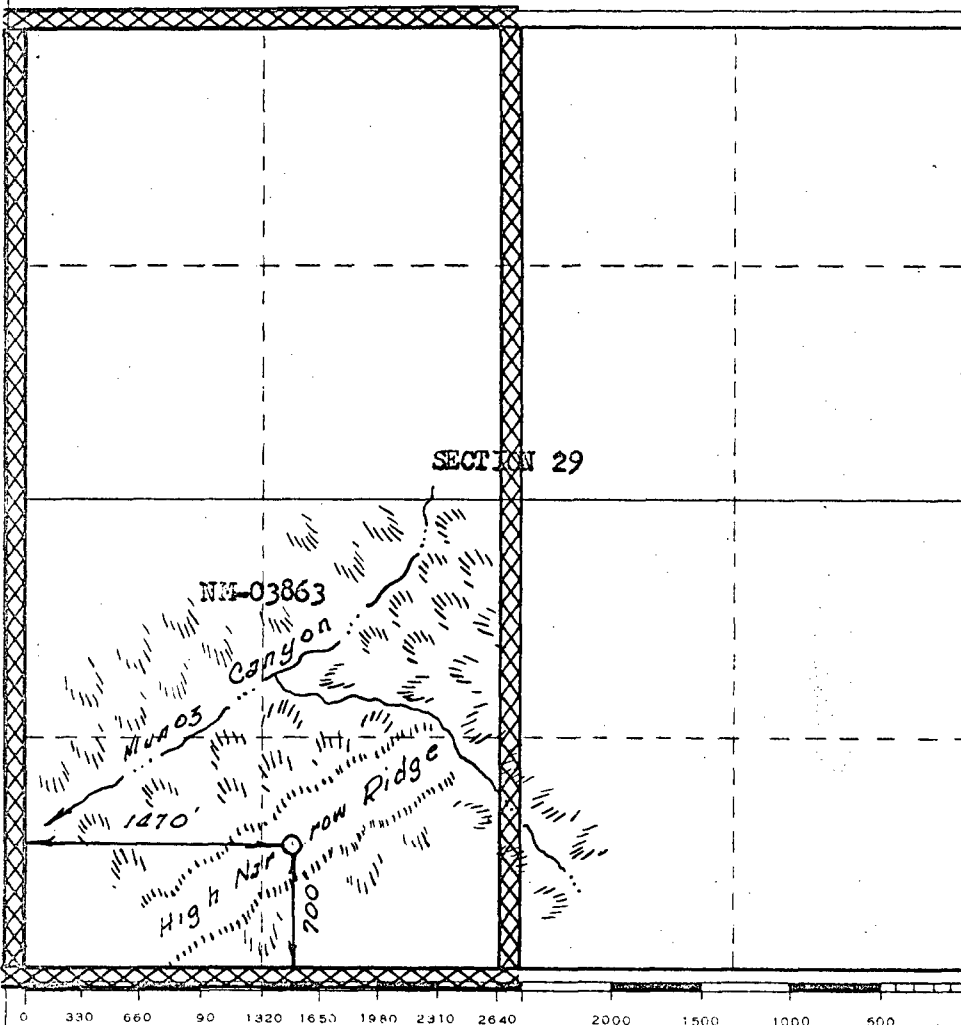



NEW MEXICO ENERGY, MINERALS  
& NATURAL RESOURCES DEPARTMENT

OIL CONSERVATION DIVISION  
2040 South Pacheco Street  
Santa Fe, New Mexico 87505  
(505) 827-7131

March 18, 1998

Burlington Resources Oil & Gas Company  
P. O. Box 4289  
Farmington, New Mexico 87499-4289  
Attention: Peggy Bradfield

*Administrative Order NSL-609-A*

Dear Ms. Bradfield:

Reference is made to your application dated March 17, 1998 for a non-standard Blanco-Mesaverde gas well location for your existing San Juan "28-4" Unit Well No. 36 (API No. 30-039-20674), located 700 feet from the South line and 1470 feet from the West line (Unit N) of Section 29, Township 28 North, Range 4 West, NMPM, Rio Arriba County, New Mexico. According to the well records on file with the New Mexico Oil Conservation Division in Santa Fe, the San Juan "28-4" Unit Well No. 36 was drilled in 1973 and completed in the Basin-Dakota Pool. By Division Administrative Order NSL-609, dated July 13, 1973, this location was approved as an unorthodox gas well location in the Basin-Dakota Pool for the standard 320-acre gas spacing and proration unit ("GPU") comprising the W/2 of said Section 29.

It is the Division's understanding that a cast iron bridge plug will be set above the Dakota perforations in order to temporarily abandon this interval. Depending upon the results of the recompletion of this well into the Mesaverde formation, gas production from both the Dakota and Mesaverde intervals may be commingled within the wellbore of said San Juan "28-4" Unit Well No. 36. Pursuant to **Rule 2(b)** of the "General Rules for the Prorated Gas Pools of New Mexico/ Special Rules and Regulations for the Blanco-Mesaverde Pool," as promulgated by Division Order No. R-8170, as amended, this location is considered to be unorthodox. Further, the S/2 of said Section 36 is to be dedicated to said well in order to form a standard 320-acre GPU for the Blanco-Mesaverde Pool.

By the authority granted me under the provisions of **Rule 2(d)** of said special Blanco-Mesaverde Pool rules, the above-described unorthodox Blanco-Mesaverde gas well location is hereby approved.

All provisions of said Administrative Order NSL-609 shall remain in full force and effect until further notice.

Sincerely,

A handwritten signature in cursive script that reads "Lori Wrotenberg".  
Lori Wrotenberg  
Director

LW/MES/kv

cc: New Mexico Oil Conservation Division - Aztec  
U. S. Bureau of Land Management - Farmington  
File: NSL-609