



OIL CONSERVATION DIVISION  
RECEIVED

**Amoco Production Company**

'90 MAR 19 AM 9:40

50 Westlake Park Boulevard  
Post Office Box 3092  
Houston, Texas 77253

March 15, 1990

State of New Mexico  
Energy and Mineral Department  
Oil Conservation Division  
P. O. Box 2088  
Santa Fe, New Mexico 87501

Attention: W. J. LeMay, Director

File: WDF-5082-WF

Gentlemen:

Application for Administrative Approval  
Unorthodox Gas Well  
Hondo Federal Gas Com. Well No. 1  
Logan Draw-Wolfcamp  
Eddy County, New Mexico

Amoco Production Company hereby makes application for administrative approval of an unorthodox gas well location under the provision of Statewide Rule 104(F). Amoco plans to recomplete this well from the Logan Draw-Morrow to the Logan Draw-Wolfcamp.

Amoco hereby certifies that on March 16, 1990, notice of this application was forwarded by certified mail to the operators offsetting this proration unit. (See attached list)

If there are any questions concerning this application, please contact Brian Taylor at (713) 584-7301 or Howard Black at (713) 584-7213.

Yours very truly,

*W.D. Fisher*  
HB

W. D. Fisher  
Administrative Services Manager

HIB/djh  
A:HIB-5082

Attachments

State of New Mexico  
P. O. Drawer DD  
Artesia, NM 88210



**Amoco Production Company**

501 WestLake Park Boulevard  
Post Office Box 3092  
Houston, Texas 77253

March 15, 1990

Offset Operators  
(See Attached List)

File: WDF-5083-WF

Gentlemen:

Notice of Application for Administrative Approval  
Unorthodox Gas Well Location  
Hondo Federal Gas Com. Well No. 1  
Logan Draw-Wolfcamp  
Eddy County, New Mexico

Amoco Production Company has made application to the New Mexico Oil Conservation Division for the administrative approval of an unorthodox gas well location under Statewide Rule 104(F). Amoco seeks approval to recomplete the subject well from the Logan Draw-Morrow to the Logan Draw-Wolfcamp.

We have attached a copy of our application submitted to the Bureau of Land Management. If you have any questions regarding this matter, please contact Brian Taylor at (713) 584-7301 or Howard Black at (713) 584-7213.

Yours very truly,

*W.D. Fisher*  
HB

W. D. Fisher  
Administrative Services Manager

HIB/djh  
A:HIB-5083

Attachments

State of New Mexico  
Energy and Mineral Department  
Oil Conservation Division  
P. O. Box 2088  
Santa Fe, NM 87501

OFFSET OPERATORS

Maralo, Inc.  
4600 Post Oak Place, Suite 307  
Houston, Texas 77027-9792

Santa Fe Energy Operating Partnership  
500 W. Illinois, Suite 500  
Midland, Texas 79701

Arco Oil and Gas Company  
P. O. Box 1610  
Midland, Texas 79702

Hondo Oil and Gas Company  
P. O. Box 2208  
Roswell, New Mexico 88201

Mesa Petroleum Company  
Vaugh Building, Suite 1000  
Midland, Texas 79701

UNITED STATES  
DEPARTMENT OF THE INTERIOR  
BUREAU OF LAND MANAGEMENT

APPLICATION FOR PERMIT TO DRILL, DEEPEN, OR PLUG BACK

1a. TYPE OF WORK

DRILL ☐

DEEPEN ☐

PLUG BACK ☒

b. TYPE OF WELL

OIL  
WELL ☐

GAS  
WELL ☒

OTHER

SINGLE  
ZONE ☒

MULTIPLE  
ZONE ☐

2. NAME OF OPERATOR

Amoco Production Company

3. ADDRESS OF OPERATOR

P. O. Box 3092 Houston, Texas 77253

4. LOCATION OF WELL (Report location clearly and in accordance with any State requirements.)  
At surface 1650 FSL X 2310 FEL Sec. 27 (Unit J, NW/4, SE/4)

At proposed prod. zone

14. DISTANCE IN MILES AND DIRECTION FROM NEAREST TOWN OR POST OFFICE\*

10. DISTANCE FROM PROPOSED\*  
LOCATION TO NEAREST  
PROPERTY OR LEASE LINE, FT.  
(Also to nearest drig. unit line, if any)

16. NO. OF ACRES IN LEASE

17. NO. OF ACRES ASSIGNED  
TO THIS WELL

320

18. DISTANCE FROM PROPOSED LOCATION\*  
TO NEAREST WELL, DRILLING, COMPLETED,  
OR APPLIED FOR, ON THIS LEASE, FT.

19. PROPOSED DEPTH

9778'

20. ROTARY OR CABLE TOOLS

Rotary

21. ELEVATIONS (Show whether DF, RT, GR, etc.)

3492' RDB

22. APPROX. DATE WORK WILL START\*

4-2-90

23.

PROPOSED CASING AND CEMENTING PROGRAM

SIZE OF HOLE	SIZE OF CASING	WEIGHT PER FOOT	SETTING DEPTH	QUANTITY OF CEMENT
11"	8 5/8"	32#	1792	835 SX
7 7/8"	5 1/2"	15.5-17#	9778	375 SX

1. Rig up service unit and pull out of hole with production equipment.
2. Set cast iron bridge plug at 9250 feet and cap with 35 feet cement.
3. Run pipe recovery log to determine top of cement.
4. Perforate at approximately 7000 feet and attempt to establish circulation. If unable to circulate, will perforate at approximately 6000 feet to circulate cement around perforations.
5. Run in hole with workstring and cement retainer to 6900 feet.
6. Establish circulation.
7. Cement with class H cement to bring cement top to approximately 5000 feet. Pull out of retainer and cap with cement and clear tubing and pull out of hole.
8. Perforate 6550'-6570', 6680'-6710', and 6716'-6723' at 4 jet shots per foot with casing gun.
9. Run in hole with production tubing and packer and shear disk to 6530 feet. Run tubing dry.
10. Drop bar to shear disk.
11. If well does not flow, acidize with 3000gallons 15% NEFE HCL with ball sealers. Flush tubing volume plus 15 barrels 2% KCL Water.
12. Swab to clean up and test. Return to production.

IN ABOVE SPACE DESCRIBE PROPOSED PROGRAM: If proposal is to deepen or plug back, give data on present productive zone and proposed new productive zone. If proposal is to drill or deepen directionally, give pertinent data on subsurface locations and measured and true vertical depths. Give blowout preventer program, if any.

Room 20.164

713-584-7213

24.

SIGNED H. I. Black (H. I. Black)

TITLE Staff Administrative Analyst DATE 3-14-90

(This space for Federal or State office use)

PERMIT NO. \_\_\_\_\_

APPROVAL DATE \_\_\_\_\_

APPROVED BY \_\_\_\_\_

TITLE \_\_\_\_\_

DATE \_\_\_\_\_

CONDITIONS OF APPROVAL, IF ANY:

\*See Instructions On Reverse Side

Title 18 U.S.C. Section 1001, makes it a crime for any person knowingly and willfully to make to any department or agency of the United States any false, fictitious or fraudulent statements or representations as to any matter within its jurisdiction.

NEW MEXICO OIL CONSERVATION COMMISSION  
WELL LOCATION AND ACREAGE DEDICATION PLAT

Form C-102  
Supersedes C-128  
Effective 1-1-65

All distances must be from the outer boundaries of the Section.

Operator <b>AMOCO PRODUCTION COMPANY</b>		Lease <b>HONDO FEDERAL GAS COM.</b>		Well No. <b>1</b>
Unit Letter <b>J</b>	Section <b>27</b>	Township <b>17 SOUTH</b>	Range <b>27 EAST</b>	County <b>EDDY</b>
Actual Footage Location of Well: <b>1650</b> feet from the <b>SOUTH</b> line and <b>2310</b> feet from the <b>EAST</b> line				
Ground Level Elev. <b>3878.2'</b>	Producing Formation <b>WOLF CAMP</b>		Pool <b>LOGAN DRAW-WOLF CAMP</b>	Dedicated Acreage: <b>320</b> Acres

1. Outline the acreage dedicated to the subject well by colored pencil or hatchure marks on the plat below.
2. If more than one lease is dedicated to the well, outline each and identify the ownership thereof (both as to working interest and royalty).
3. If more than one lease of different ownership is dedicated to the well, have the interests of all owners been consolidated by communitization, unitization, force-pooling, etc?

☐ Yes ☐ No If answer is "yes," type of consolidation \_\_\_\_\_

If answer is "no," list the owners and tract descriptions which have actually been consolidated. (Use reverse side of this form if necessary.) \_\_\_\_\_

No allowable will be assigned to the well until all interests have been consolidated (by communitization, unitization, forced-pooling, or otherwise) or until a non-standard unit, eliminating such interests, has been approved by the Commission.

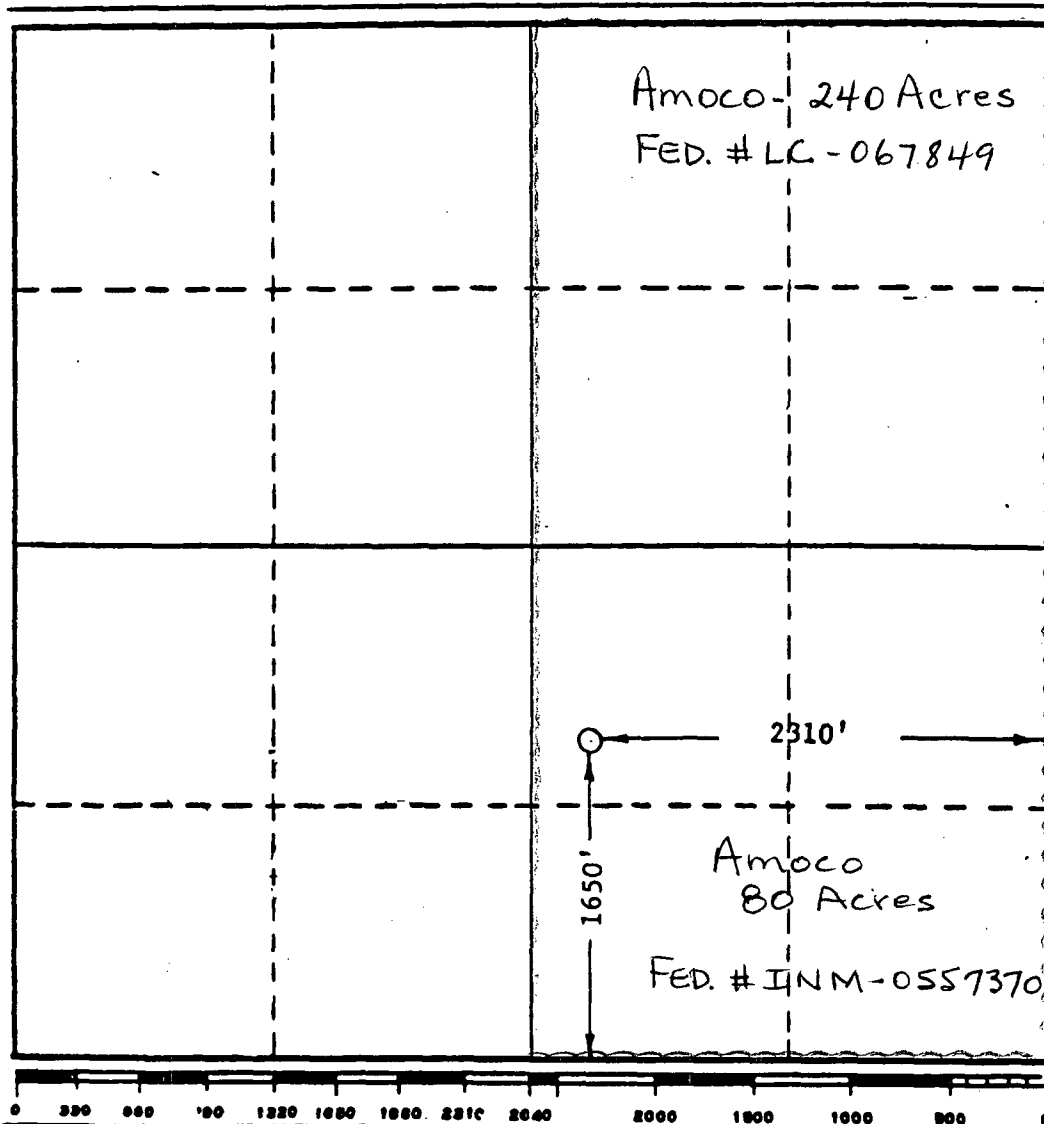

CERTIFICATION

I hereby certify that the information contained herein is true and complete to the best of my knowledge and belief.

Name  
**H. J. Blum**  
Position  
**Stf. Admin. Analyst**  
Company  
**Amoco Production**  
Date  
**January 12, 1990**

I hereby certify that the well location shown on this plat was plotted from field notes of actual surveys made by me or under my supervision, and that the same is true and correct to the best of my knowledge and belief.

Date Surveyed  
Registered Professional Engineer and/or Land Surveyor

Certificate No. **676**

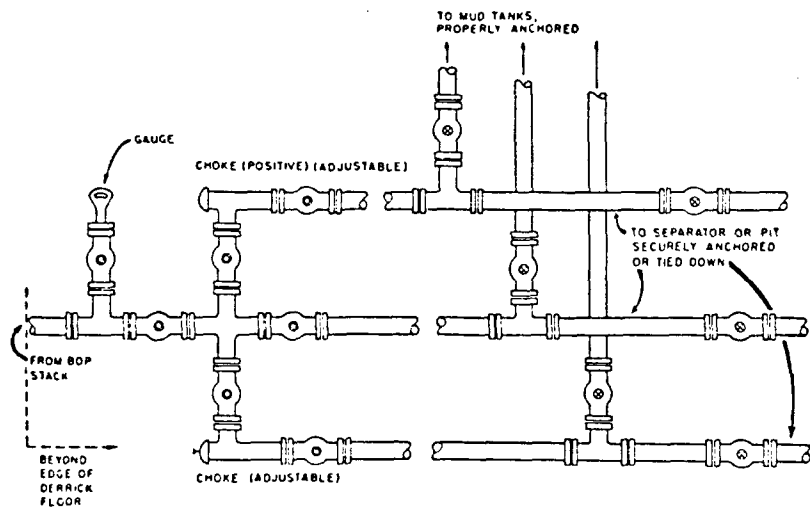
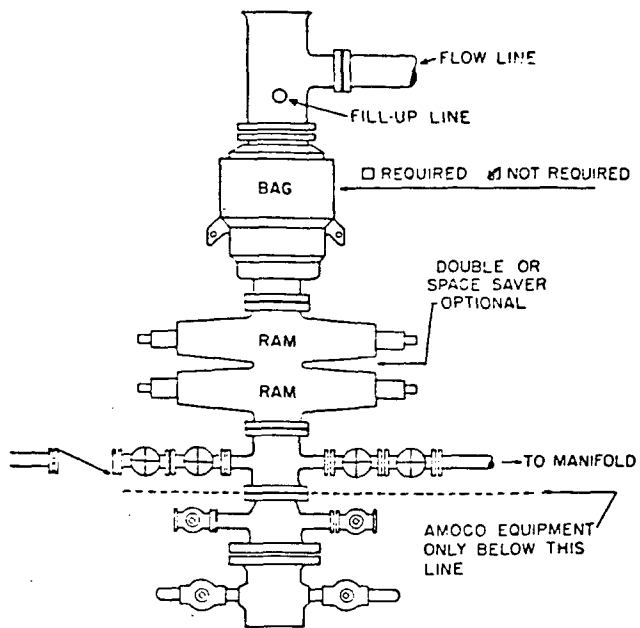



STATE OF NEW MEXICO  
ENERGY, MINERALS AND NATURAL RESOURCES DEPARTMENT  
OIL CONSERVATION DIVISION

GARREY CARRUTHERS  
GOVERNOR

POST OFFICE BOX 2088  
STATE LAND OFFICE BUILDING  
SANTA FE, NEW MEXICO 87504  
(505) 827-5800

March 19, 1990

Bureau of Land Management  
Carlsbad Resources Office  
P.O. Box 1778  
Carlsbad, NM 88220

Attention: Barry Hunt

RE: *Amoco Production Company, Application  
for administrative approval of an unorthodox  
gas well location, Hondo Federal Gas Com  
No. 1, 1650' FSL - 2310' FEL (Unit J), 27-  
T17S-R27E, Undesignated Logan Draw  
Wolfcamp Gas Pool, Eddy County, New  
Mexico*

Dear Mr. Hunt:

Enclosed please find a copy of an unorthodox gas well location request that the NMOCDD received on March 19, 1990. This information is being provided to you for your records since the well is within your jurisdiction. Should you have any comments or suggestions, please contact me.

Sincerely,

Michael E. Stogner  
Chief Hearing Officer/Engineer

MES/ag

cc: Oil Conservation Division - Artesia  
Amoco Production Company - Houston

*Left Word For  
Brian Taylor  
to call me back  
about off-sites  
BuSpar®  
Chuk [unclear] for [unclear] well  
in Unit*

In the event gas production is encountered in a well which was projected to an oil-producing horizon and which is located accordingly but does not conform to the above gas well location rules, it shall be necessary for the operator to bring the matter to a hearing before approval for the production of gas can be given.

III. All counties except Lea, Chaves, Eddy, Roosevelt, San Juan, Rio Arriba, and Sandoval

Any wildcat well which is projected as an oil well in any county other than Lea, Chaves, Eddy, Roosevelt, San Juan, Rio Arriba, and Sandoval shall be located on a tract consisting of approximately 40 surface contiguous acres substantially in the form of a square which is a legal subdivision of the U. S. Public Land Surveys, or on a governmental quarter-quarter section or lot and shall be located not closer than 330 feet to any boundary of such tract.

Any wildcat well which is projected as a gas well to a formation and in an area which, in the opinion of the Division representative approving the application to drill, may reasonably be presumed to be productive of gas rather than oil shall be located on a drilling tract consisting of 160 surface contiguous acres, more or less, substantially in the form of a square which is a quarter section, being a legal subdivision of the U. S. Public Land Surveys, and shall be located not closer than 660 feet to any outer boundary of such tract nor closer than 330 feet to any quarter-quarter section or subdivision inner boundary.

C. ACREAGE AND WELL LOCATION REQUIREMENTS FOR DEVELOPMENT WELLS

I. Oil Wells, All Counties

Unless otherwise provided in special pool rules, each development well for a defined oil pool shall be located on a tract consisting of approximately 40 surface contiguous acres substantially in the form of a square which is a legal subdivision of the U.S. Public Land Surveys, or on a governmental quarter-quarter section or lot, and shall be located not closer than 330 feet to any boundary of such tract nor closer than 330 feet to the nearest well drilling to or capable of producing from the same pool, provided however, only tracts committed to active secondary recovery projects shall be permitted more than four wells.

II. Gas Wells

(a) Lea, Chaves, Eddy, and Roosevelt Counties

Unless otherwise provided in special pool rules, each development well for a defined gas pool in a formation younger than the Wolfcamp formation, or in the Wolfcamp formation which was created and defined by the Division prior to November 1, 1975, or in a Pennsylvanian age or older formation which was created and defined by the Division prior to June 1, 1964, shall be located on a designated drilling tract consisting of 160 surface contiguous acres, more or less, substantially in the form of a square which is a quarter section being a legal subdivision of the U. S. Public Land Surveys, and shall be located not closer than 660 feet to any outer boundary of such tract nor closer than 330 feet to any quarter-quarter section or subdivision inner boundary nor closer than 1320 feet to the nearest well drilling to or capable of producing from the same pool.

Unless otherwise provided in the special pool rules, each development well for a defined gas pool in the Wolfcamp formation which was created and defined by the Division after November 1, 1975, or of Pennsylvanian age or older which was created and defined by the Division after June 1, 1964, shall be located on a designated drilling tract consisting of 320 surface contiguous acres, more or less, comprising any two contiguous quarter sections of a single



governmental section, being a legal subdivision of the U. S. Public Land Surveys. Any such well having more than 160 acres dedicated to it shall be located not closer than 660 feet to the nearest side boundary of the dedicated tract nor closer than 1980 feet to the nearest end boundary nor closer than 330 feet to any quarter-quarter section or subdivision inner boundary. (For the purpose of this rule, "side" boundary and "end" boundary are as defined in Section B I(a) of this rule.)

(b) San Juan, Rio Arriba, and Sandoval Counties

Unless otherwise provided in special pool rules, each development well for a defined gas pool shall be located on a designated drilling tract consisting of 160 surface contiguous acres, more or less, substantially in the form of a square which is a quarter section, being a legal subdivision of the U. S. Public Land Surveys, and shall be located not closer than 790 feet to any outer boundary of the tract nor closer than 130 feet to any quarter-quarter section line or subdivision inner boundary.

(c) All Counties except Lea, Chaves, Eddy, Roosevelt, San Juan, Rio Arriba, and Sandoval

Unless otherwise provided in special pool rules, each development well for a defined gas pool shall be located on a designated drilling tract consisting of 160 surface contiguous acres, more or less, substantially in the form of a square which is a quarter section, being a legal subdivision of the U. S. Public Land Surveys, and shall be located not closer than 660 feet to any outer boundary of such tract nor closer than 330 feet to any quarter-quarter section or subdivision inner boundary nor closer than 1320 feet to the nearest well drilling to or capable of producing from the same pool.

D. ACREAGE ASSIGNMENT, COMPLETED WELLS

I. Well Tests and Classification

It shall be the responsibility of the operator of any wildcat gas well or development gas well to which more than 40 acres has been dedicated to conduct a potential test within 30 days following completion of the well and to file the same with the Division within 10 days following completion of the tests. (See Rule 401.)

Date of completion for a gas well shall be the date a Christmas tree is installed or 30 days following conclusion of active completion work on the well, whichever date comes first.

Upon making a determination that the well should not properly be classified as a gas well, the Division will reduce the acreage dedicated to the well.

Failure of the operator to file the aforesaid tests within the specified time will also subject the well to such acreage reduction.

II. Non-Standard Units

Any completed gas well which does not have the required amount of acreage dedicated to it for the pool or formation in which it is completed may not be produced until a standard unit for the well has been formed and dedicated or until a non-standard unit has been approved.

The Division Director may grant administrative approval to non-standard gas units without notice and hearing when an application has been filed for a non-standard unit and the unorthodox

OIL CONSERVATION COMMISSION

P. O. BOX 2088

SANTA FE, NEW MEXICO 87501

August 28, 1973

C  
O  
P  
Y  
Amoco Production Company  
P. O. Box 68  
Hobbs, New Mexico 88240

Attention: Mr. J. E. York

Administrative Order NSL-615

Gentlemen:

Reference is made to your application for approval of a gas well location for your Hondo Federal Gas Com Well No. 1 to be located 1650 feet from the South line and 2310 feet from the East line of Section 27, Township 17 South, Range 27 East, NMPM, Logan Draw-Morrow Field, Eddy County, New Mexico.

Waivers of objection have been received from offsetting operators and the waiting period prescribed by Rule 104 F may be dispensed with in this instance.

Therefore, by authority granted me by the provisions of Rule 104 F of the Commission Rules and Regulations, the above-described unorthodox location is hereby approved.

Very truly yours,

A. L. PORTER, Jr.  
Secretary-Director

ALP/JEK/dr

cc: Oil Conservation Commission - Artesia  
Oil & Gas Engineering Committee - Hobbs  
U. S. Geological Survey - Artesia

COUNTY *Eddy*

POOL *Logan Draw - Wolfcamp Gas*

TOWNSHIP *17 South*

RANGE *27 East*

NMPM

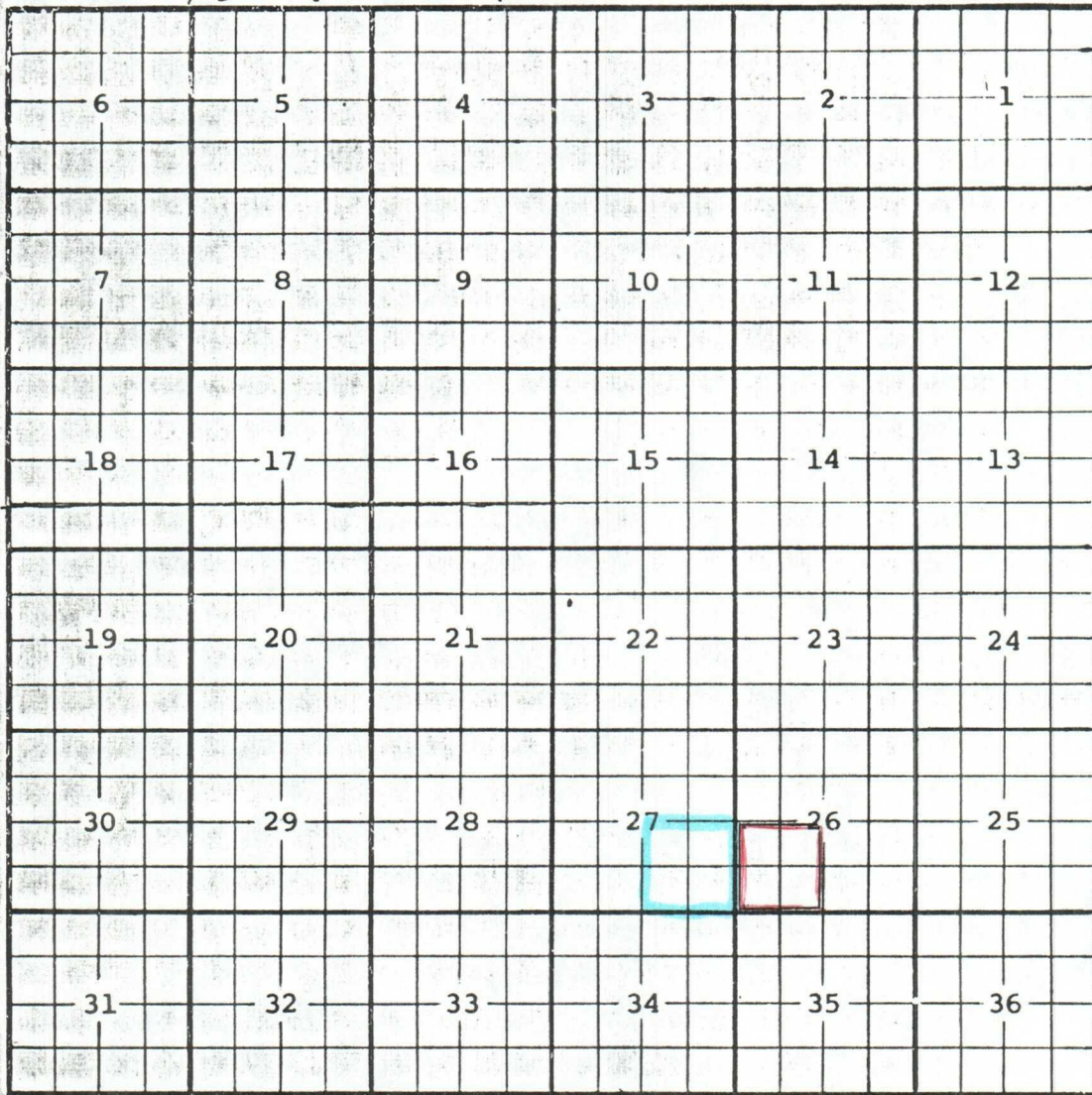

*Description: <sup>SW</sup>/<sub>4</sub> Sec 26 (R-4809, 6-18-74)*

## Facsimile Transmission

Addressee's Telecopier Phone

505-827-5741

Date

3-21-90

Page

1 of 3

To: MIKE STOREGNER	Company: NEW MEXICO OIL CON. DIV.	Location: SANTA FE, NM	Mail Code/Room:
From: HOWARD BLACK	Company: Amoco Production	Location: HOUSTON, TX	Mail Code/Room:
Initiated By:	Approved By:	<input type="checkbox"/> Call _____ for pickup. <input type="checkbox"/> Return to _____	

MIKE,

HERE IS THE INFO YOU REQUESTED ON HONDO FEDERAL  
GAS CON. WELL NO.1.

THX,

HOWARD

713-584-7213



## Amoco Production Company

## ENGINEERING CHART

SUBJECT HONDO FEDERAL Gas Com. Offsets  
DWH 3-14-90

SHEET NO. OF

FILE

APPN

DATE

BY

Rights Below 3000'

505-827-5811

MIKE STOREGHEIM

Amoco 56.25%  
Mesa 43.75%

Amoco 50%  
Mavalo, Inc. 25%  
Erma Low 25%

Amoco 50%  
Mavalo, Inc. 25%  
Erma Low 25%

Amoco 50%  
Hondo 50%

E/2  
Section 27

Santa Fe Energy  
operating Partnership 100%

Pauline V. and John H. Trigg 37.5%  
ARCO 25%  
Hondo 12.5%  
Amoco 25%

Amoco 50%  
ARCO 50%

Hondo Federal  
Gas Com.

Amoco 50%  
ARCO 50%

Amoco 50%  
Hondo 50%

Amoco 50%  
ARCO 50%

Amoco 50%  
ARCO 50%

E/2 Section 27, T-17-S, R-27-E

## Amoco Production Company

## ENGINEERING CHART

SUBJECT \_\_\_\_\_

SHEET NO. \_\_\_\_\_

OF \_\_\_\_\_

FILE \_\_\_\_\_

APPN \_\_\_\_\_

DATE \_\_\_\_\_

BY \_\_\_\_\_

Addresses of the Parties

Maralo, Inc.  
4600 Post Oak Place, Suite 307  
Houston, Texas 77027 -9792

OPERATOR ✓

Erma Lowe  
c/o Maralo, Inc.  
P.O. Box 2923  
Houston, TX 77252

NON-OPERATOR

Santa Fe Energy Operating Partnership  
500 W. Illinois, Suite 500  
Midland, Texas 79701

OPERATOR

Pauline V. and John H. Trigg  
P.O. Box 520  
Roswell, New Mexico 88202

NON-OPERATOR

ARCO Oil and Gas Company  
P.O. Box 1610  
Midland, Texas 79702

OPERATOR

Hondo Oil and Gas Company  
P.O. Box 2708  
Roswell, New Mexico 88201

OPERATOR

Mesa Petroleum Company  
Vaugh Building Suite 1000  
Midland, Texas 79701

OPERATOR

## Facsimile Transmission

Addressee's Teletypewriter Phone

505-827-5741

Date

3-21-90

Page

1 of 3

To:	MIKE STOREGHEIMER	Company:	NEW MEXICO OIL CONG. DIV.	Location:	SANTA FE, NM	Mail Code/Room:	
From:	HOWARD BLACK	Company:	Amoco Production	Location:	Houston, TX	Mail Code/Room:	
Initiated By:		Approved By:		<input type="checkbox"/> Call _____ for pickup. <input type="checkbox"/> Return to _____			

MIKE,

HERE IS THE INFO YOU REQUESTED ON HONDO FEDERAL  
GAS CON. WELL NO.1.

THX,

HOWARD

713-584-7213

# Amoco Production Company

## ENGINEERING CHART

SUBJECT HONDO FEDERAL GAS Com. Offsets  
DWIT 3-14-90

SHEET NO.

OF

FILE

APPN

DATE

BY

Rights Below 3000'

505-827-5811  
 MIKE STOREYHILL

Amoco 56.25%  
 Mesa 43.75%

Amoco 50%  
 Maralo, Inc. 25%  
 Erma Lowe 25%

Amoco 50%  
 Maralo, Inc. 25%  
 Erma Lowe 25%

Amoco 50%  
 Hondo 50%

E/2  
 Section 27

Santa Fe Energy  
 operating Partnership 100%

Pauline V. and John H. Trigg 37.5%  
 ARCO 25%  
 Hondo 12.5%  
 Amoco 25%

Amoco 50%  
 ARCO 50%

Hondo Federal  
 Gas Com.

Amoco 50%  
 ARCO 50%

Amoco 50%  
 Hondo 50%

Amoco 50%  
 ARCO 50%

Amoco 50%  
 ARCO 50%

E/2 Section 27, T-17-S, R-27-E



175





STATE OF NEW MEXICO  
ENERGY, MINERALS AND NATURAL RESOURCES DEPARTMENT  
OIL CONSERVATION DIVISION

GARREY CARRUTHERS  
GOVERNOR

POST OFFICE BOX 2088  
STATE LAND OFFICE BUILDING  
SANTA FE, NEW MEXICO 87504  
(505) 827-5800

April 10, 1990

Amoco Production Company  
P.O. Box 3092  
Houston, TX 77253

Attention: W.D. Fisher, Administrative Services Manager

*Amended Administrative Order NSL-615*

Dear Mr. Fisher:

Reference is made to your application dated March 15, 1990 to amend Division Administrative Order NSL-615, which authorized a non-standard gas well location in the Logan Draw-Morrow Gas Pool for the Hondo Federal Gas Com Well No. 1 located 1650 feet from the South line and 2310 feet from the East line (Unit J) of Section 27, Township 17 South, Range 27 East, NMPM, Eddy County, New Mexico.

It is our understanding that the Morrow zone will be plugged back in the subject well and recompleted in the Undesignated Logan Draw Wolfcamp Gas Pool, which pursuant to General Rule 104.C.II.(a) is located at an unorthodox gas well location for said pool. Also, the SE/4 of said Section 27 shall be dedicated to said well forming a standard 160-acre gas spacing and proration unit for said pool, pursuant to General Rule 104.A. and 104.C.II.(a).

By the authority granted me under the provisions of General Rule 104 (I), said Order NSL-615 shall be amended and the above-described unorthodox gas well location is hereby approved.

Sincerely,

A handwritten signature in black ink, appearing to read "William J. LeMay".

William J. LeMay  
Director

WJL/MES/ag

cc: Oil Conservation Division - Artesia